

(12) STANDARD PATENT
(19) AUSTRALIAN PATENT OFFICE

(11) Application No. **AU 2016203545 B2**

(54) Title
Surgical anastomosis apparatus

(51) International Patent Classification(s)
A61B 17/115 (2006.01)

(21) Application No: **2016203545** (22) Date of Filing: **2016.05.30**

(30) Priority Data

(31) Number	(32) Date	(33) Country
14/737,552	2015.06.12	US

(43) Publication Date: **2017.01.05**

(43) Publication Journal Date: **2017.01.05**

(44) Accepted Journal Date: **2020.07.02**

(71) Applicant(s)
Covidien LP

(72) Inventor(s)
Williams, Justin

(74) Agent / Attorney
Spruson & Ferguson, GPO Box 3898, Sydney, NSW, 2001, AU

(56) Related Art
US 2005/0116009 A1
EP 2873380 A1
EP 2656800 A1

SURGICAL ANASTOMOSIS APPARATUS

ABSTRACT

A surgical circular fastener apparatus (10) includes an elongated body (200) defining a longitudinal axis and having proximal and distal ends, a fastener cartridge (302) disposed adjacent the distal end of the body (200), an anvil retainer (204) releasably mounted relative to the fastener cartridge (302); and a manually operable release (404) configured to move between a first position corresponding to a secured condition of the anvil retainer (204) relative to the fastener cartridge (302) and a second position corresponding to a release condition of the anvil retainer (204) relative to the fastener cartridge (302).

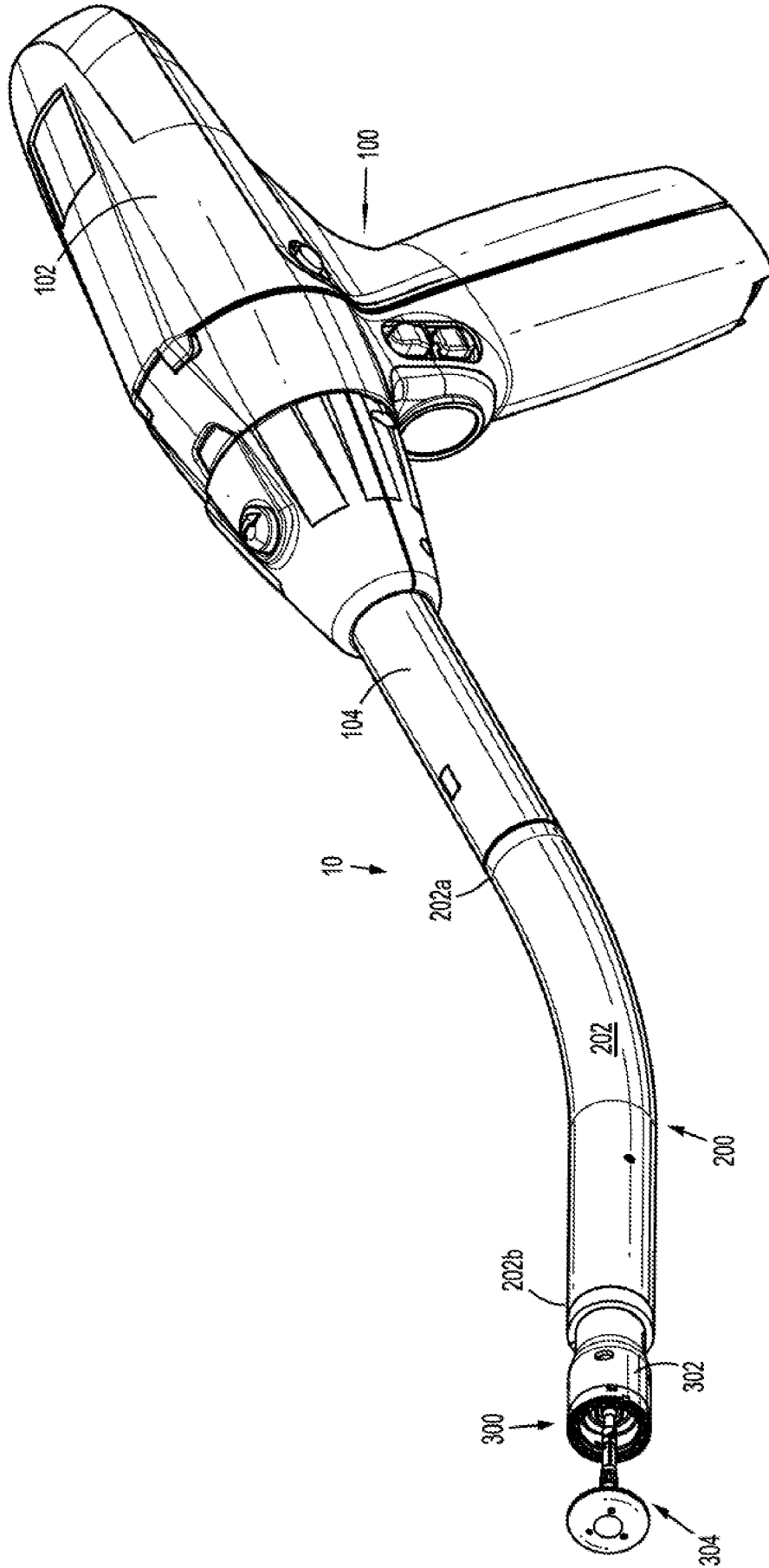

FIG. 1

SURGICAL ANASTOMOSIS APPARATUS

Field

[0001] The present disclosure relates to a surgical fastener instrument for applying surgical fasteners to body tissue and, more particularly, relates to a surgical circular fastener instrument incorporating a mechanism to permit selective mounting and release of an anvil retainer and/or anvil relative to the fastener head of the instrument.

Background

[0002] Anastomosis refers to the surgical joining of separate hollow tissue sections. Typically, an anastomosis procedure follows surgery in which a diseased or defective section of a hollow tissue or organ structure is removed, thus requiring the joining of the remaining end sections of the tissue. Depending on the particular procedure performed and/or other factors, the end sections of the tissue may be joined by circular anastomosis, e.g., end-to-end anastomosis, end-to-side anastomosis, or side-to-side anastomosis.

[0003] In a circular anastomosis procedure, a fastener instrument drives a circular array of fasteners or staples through each of two end sections of tissue to join the end sections in end-to-end relation, and simultaneously core any tissue within the newly joined sections to clear a passage therethrough. A conventional circular anastomosis instrument includes a handle, an elongated shaft and a fastener head or cartridge at the end of the elongated shaft. An anvil assembly including an anvil rod and an attached anvil head is mountable relative to the fastener cartridge. The tissue end sections are clamped between the anvil head and the fastener cartridge, and the instrument is actuated causing fasteners to be driven through the tissue end sections for crimping by the anvil head.

Object

[0004] It is an object of the present invention to substantially overcome or ameliorate one or more of the above disadvantages, or at least provide a useful alternative.

Summary of Invention

[0005] Accordingly, the present disclosure is directed to further improvements in end to end or circular anastomosis instruments, particularly, with instruments intended to be reused and sterilized in whole or in part. In one embodiment, a surgical circular fastener apparatus includes an elongated body defining a longitudinal axis and having proximal and distal ends, a fastener cartridge disposed adjacent the distal end of the body, an anvil retainer or trocar releasably mounted relative to the fastener cartridge and a manually operable release configured to move between a first position corresponding to a secured condition of the anvil retainer relative to the fastener cartridge and a second position corresponding to a release condition of the anvil retainer relative to the fastener cartridge. The anvil retainer or trocar may be coupleable to an anvil assembly.

[0006] In embodiments, the elongated body includes a release housing with the manually operable release being mounted for movement relative to the release housing. The release housing may include at least one lock. The at least one lock may be operatively coupled to the manually operable release and configured to move between a locked position in secured engagement with the anvil retainer to prevent removal of the anvil retainer relative to the fastener cartridge upon movement of the manually operable release to the first position, and an unlocked position released from the anvil retainer to permit removal or mounting of the anvil retainer relative to the fastener cartridge upon movement of the manually operable release to the second position.

[0007] In some aspects, the release housing includes a lock drive. The lock drive may be coupled to the manually operable release and configured to position the at least one lock in the locked position upon movement of the manually operable release to the first position and configured to position the at least one lock in the unlocked position upon movement of the manually operable release to the second position.

[0008] In certain embodiments, the release housing has at least one lock bore with the at least one lock being dimensioned and adapted to traverse the lock bore during movement between the locked position and the unlocked position. The release housing may define first and second lock bores and have first and second locks respectively disposed within the first and second lock

bores. The first and second locks traverse respective first and second lock bores during movement between the locked position and the unlocked position.

[0009] The manually operable release may be normally biased toward the first position.

[0010] In embodiments, the lock drive is dimensioned and adapted to move within the release housing between an unactuated position corresponding to the first position of the manually operable release and an actuated position corresponding to the second position of the manually operable release. A spring may be configured to engage the lock drive to bias the lock drive to the unactuated position and the manually operable release to the first position. The lock drive may be slidably mounted within the release housing between the unactuated position and the actuated position. In one aspect, the lock drive includes at least one cam segment dimensioned and configured to move the at least one lock to the locked position upon movement of the lock drive to the unactuated position and the manually operable release to the first position, and dimensioned and configured to move the at least one lock in a radial outward direction to the unlocked position released from the anvil retainer upon movement of the lock drive to the actuated position and the manually operable release to the second position.

[0011] In certain embodiments, the anvil retainer defines a lock opening whereby the at least one lock is dimensioned and configured to be at least partially received within the lock opening upon movement to the locked position and released from the lock opening upon movement to the unlocked position.

[0012] The present disclosure also relates to a surgical circular fastener apparatus including an elongated body defining a longitudinal axis and having leading and trailing ends, a fastener cartridge disposed adjacent the distal end of the elongated body, an anvil retainer or trocar releasably mounted relative to the fastener cartridge and defining at least one lock recess, and an anvil retainer release mechanism for selectively securing and releasing the anvil retainer relative to the fastener cartridge. The release mechanism includes a release housing, a manually operable release mounted to the release housing and configured to move between a first position and a second position, and at least one lock operably coupled to the manually operable release. The at least one lock is mounted for movement within the release housing between a locked position and an unlocked position upon movement of the manually operable release between respective first and second positions thereof. The at least one lock is configured to be received

within the at least one lock recess of the anvil retainer to secure the anvil retainer relative to the fastener cartridge when in the locked position, and configured to be released from the at least one lock recess to release the anvil retainer to permit mounting or release of the anvil retainer relative to the fastener cartridge when in the unlocked position. In embodiments, the anvil retainer release mechanism includes a pair of locks and the anvil retainer defines a pair of lock recesses.

[0013] In aspects, the release mechanism includes a lock drive coupled to the manually operable release and movable within the retainer housing during movement of the manually operable release between the first and second positions. The lock drive may define cam segments dimensioned to engage and position the locks in respective locked and unlocked positions thereof. The manually operable release may be normally biased toward the first position.

[0014] The anvil release mechanism of the present disclosure permits removal of the anvil retainer or trocar, with or without the mounted anvil, during or subsequent to the surgical procedure thereby facilitating replacement of a new or sterilized retainer and/or anvil for immediate reuse. The release mechanism may be operated with a single button or manually operable member to release the anvil retainer or trocar. Reinsertion of the anvil retainer or trocar may be readily effected through activation of the single button.

[0015] Other advantages of the present disclosure will be appreciated from the following description.

Brief Description of Drawings

[0016] Embodiments of the present disclosure will be appreciated by reference to the accompanying drawings wherein:

[0017] FIG. 1 is a perspective view of a surgical anastomosis apparatus for applying an annular or circular array of fasteners in accordance with the principles of the present disclosure illustrating the handle, the elongate tool and an end effector mounted to the elongated tool;

[0018] FIG. 2 is a perspective view illustrating the distal end of the elongated tool with the end effector removed;

[0019] FIG. 2A is an enlarged isolated view of the area of detail identified in FIG. 2;

[0020] FIG. 3 is a perspective view of an anvil retainer or trocar for mounting an anvil of the end effector to the elongated tool, illustrating the retainer sleeve and the retainer shaft at least partially disposed within the retainer sleeve;

[0021] FIG. 4 is a side elevation view of the elongated tool with the outer shell removed;

[0022] FIG. 5 is an enlarged isolated view of the area of detail identified in FIG. 4 illustrating the retainer release mechanism for releasably securing the anvil retainer relative to the elongated tool;

[0023] FIG. 6 is a perspective view of the retainer release mechanism;

[0024] FIG. 7 is an exploded perspective view of the retainer release mechanism;

[0025] FIG. 8 is a cross-sectional view of the retainer release mechanism taken along the lines 8-8 of FIG. 5 illustrating the relationship of the manually operable release, the lock drive and the locks relative to the anvil retainer when the manually operable member is in a first position corresponding to a secured condition of the anvil retainer relative to the elongated tool;

[0026] FIG. 9 is an exploded perspective view of the end effector including a fastener cartridge and an anvil;

[0027] FIG. 10 is an enlarged isolated view similar to the view of FIG. 5 illustrating the manually operable member of the retainer release mechanism in a second position corresponding to a release condition of the anvil retainer relative to the elongated tool;

[0028] FIG. 11 is a cross-sectional view of the retainer release mechanism taken along the lines 11-11 of FIG. 10 illustrating the relationship of the manually operable release, the lock drive and the locks relative to the anvil retainer when the manually operable member is in the second position;

[0029] FIG. 12 is a perspective view of the elongated body with the anvil retainer removed through movement of the manually operable release to the second position; and

[0030] FIG. 13 is a cross-sectional view of the anvil release mechanism illustrating the manually operable release returning to the first position under the influence of the biasing spring.

Description of Embodiments

[0031] Particular embodiments of the present disclosure are described hereinbelow with reference to the accompanying drawings; however, it is to be understood that the disclosed embodiments are merely examples of the disclosure and may be embodied in various forms. Well-known functions or constructions are not described in detail to avoid obscuring the present disclosure in unnecessary detail. Therefore, specific structural and functional details disclosed herein are not to be interpreted as limiting, but merely as a basis for the claims and as a representative basis for teaching one skilled in the art to employ the present disclosure in virtually any appropriately detailed structure.

[0032] Referring now to the drawings where like reference numerals indicate similar components throughout the several views, FIG. 1 illustrates the surgical fastener apparatus 10 in accordance with the principles of the present disclosure. The surgical fastener apparatus 10 may be adapted to apply an annular or circular array of fasteners or staples to tissue in connection with an end-to-end or circular anastomosis of tissue. The surgical fastener apparatus 10 includes a handle 100 and an elongated tool 200 connectable to the handle 100. The handle 100 may be any handle assembly having at least one actuator, and in some embodiments, two or more actuators adapted to control operation of the fastener apparatus 10. The handle 100 may be powered incorporating a motor and supporting circuitry to operate the apparatus 10. The handle 100 may include a handle frame 102 and a handle shaft 104 extending from the handle frame 102. The elongated tool 200 is couplable to the handle shaft 104. In the alternative, the handle 100 may be devoid of the handle shaft 104 whereby the tool 200 is directly connected to the handle frame 102. It is contemplated that the handle 100 may be reusable.

[0033] The elongated tool 200 may be a single use loading unit (SULU) or a multi-use loading unit (MULU) having an end effector 300 adapted, e.g., for single or multiple firing of one or

more fasteners. All or a portion of the elongated tool 200 and the end effector 300 may be reusable with the reusable components subject to sterilization procedures after use.

[0034] The end effector 300 may be a fastener firing effector, which in one embodiment, includes a staple or fastener cartridge 302 and an anvil 304. The fastener cartridge 302 may be mounted to, or a component of, the elongated tool 200, and houses a plurality of fasteners. In the alternative, the fastener cartridge 302 may be releasably mounted to the elongated tool 200, and replaced with another fastener cartridge 302 upon exhaustion of the supply of fasteners. The anvil 304 is releasably mountable relative to the fastener cartridge 302. When coupled to the elongated tool 200, the anvil 304 is movable relative to the fastener cartridge 302 between open and approximated positions. The fasteners are driven from the fastener cartridge 302 through tissue positioned about the components, and crimped by the anvil 304. Further details of the end effector 300 will be discussed in greater detail hereinbelow.

[0035] Referring now to FIGS. 2-3, the elongated tool 200 includes an outer body or shell 202 which houses the components of the fastener firing mechanism for firing the fasteners and the components of the approximating mechanism for approximating the anvil 304 and the fastener cartridge 302. The outer body 202 defines proximal or trailing and distal or leading ends 202a, 202b. The elongated tool 200 further includes an anvil retainer or trocar 204 which is releasably mounted to the outer body 202 and relative to the fastener cartridge 302. In FIG. 2, the fastener cartridge 302 is shown removed (for illustrative purposes) from the outer body 202 of the elongated tool 200. The anvil retainer 204 (only a portion of which is shown in FIG. 2) secures and/or mounts the anvil 304 relative to the fastener cartridge 302, and may function as a trocar assisting in advancing the elongated tool 200 through tissue in the absence of the mounted anvil 304.

[0036] As best depicted in FIG. 3, the anvil retainer 204 includes a retainer sleeve 206 and an anvil retainer shaft 208 releasably mounted to the sleeve 206. The sleeve 206 includes at least one mounting hole 210 extending at least partially or completely through the wall of the sleeve 206. In one embodiment, the sleeve 206 includes a pair of diametrically opposed mounting holes 210 disposed at the same axial location (only one mounting hole 210 is shown in FIG. 3). The mounting holes 210 may be circular in dimension although other configurations are envisioned as well. The sleeve 206 may include one or more relief holes 212, or optionally, be devoid of the relief holes 212. The relief holes 212 may permit a degree of expansion of the

outer sleeve 206 to facilitate insertion and/or retention of the retainer shaft 208 within the sleeve 206 or may engage cooperating structure of the retainer shaft 208 to assist in securing the retainer shaft 208 within the sleeve 206.

[0037] The retainer shaft 208 may be releasably secured within the sleeve 206 through conventional arrangements such as a friction fit, bayonet coupling, detent mechanism or the like. The retainer shaft 208 may include a distal trocar tip 214 having a tapered configuration to facilitate passage through tissue to assist the anvil retainer 204 in functioning like a trocar. The retainer shaft 208 is dimensioned to couple with corresponding structure of the anvil 304 to releasably couple the anvil 304 to the anvil retainer 204. In the alternative, the sleeve 206 and the retainer shaft 208 may be secured to each other in fixed relation therewith.

[0038] Referring now to FIGS. 4-7, the anvil retainer release mechanism 400 for releasably mounting the anvil retainer 204 relative to the outer body 202 of the elongated tool 200 will be discussed. The release mechanism 400 is mounted to the outer body 202 of the elongated tool 200 proximal of the end effector 300. In FIG. 4, the end effector 300 is not shown. Any conventional means for securing the release mechanism 400 to, or within, the outer body 202 are envisioned including mechanical arrangements, adhesives or the like. As best depicted in FIGS. 6-7, the release mechanism 400 includes a release housing 402 defining a housing axis "k", a manually operable release 404, a pair of locks 406 and a lock drive 408. The manually operable release 404, the locks 406 and the lock drive 408 are each mounted for movement within and relative to the release housing 402. In one embodiment, the release housing 402 includes upper and lower surfaces 410a, 410b, a central axial bore 412 for reception of the anvil retainer 204, first and second lock receiving bores 414 orthogonal to the housing axis "k" for receiving respective locks 406, and first and second channels 416 for at least partially receiving the lock drive 408. The release mechanism 400 further may include a pair of springs 418, e.g., leaf springs, having one end 418a secured within openings 420 of the release housing 402 and the other free ends 418b in engagement with the lock drive 408 as will be discussed hereinbelow.

[0039] With continued reference to FIGS. 4-7, the manually operable release 404 includes at least one cylindrical hinge or pivot 422 (e.g., two spaced hinges 422) and a manually engagement segment 424 extending from the pivot hinges 422. The hinges 422 rotate within recess(es) 425 (FIG. 5) within the upper surface 410a of the release housing 402 during movement of the manually operable release 404 between first and second position thereof.

Alternatively, a recess accommodating the hinges 422 may be associated with the outer body 202. In FIGS. 4-6, the manually operable release 404 is in the first position which may correspond to a secured condition of the anvil retainer 204 relative to the elongated tool 200 and/or the fastener cartridge 302. The manual engagement segment 424 of the manually operable release 404 is accessible through a window 202a in the outer body 202 of the elongated tool 200, as depicted in FIG. 2A, for access by the clinician.

[0040] With reference to FIGS. 5-7, in conjunction with the cross-sectional view of FIG. 8, the lock drive 408 depends downwardly or radially inwardly relative to the housing axis “k” from the manually operable release 404, and may or may not be secured to the manually operable release 404. As best depicted in FIGS. 7-8, the lock drive 408 includes a central beam 426 and two legs 428 extending from the central beam 426. The central beam 426 engages the manual engagement segment 424 of the manually operable release 404. The two legs 428 of the lock drive 408 include opposed leg segments 430 extending continuously from the central beam 426, leading to a pair of recessed or outward segments 432 disposed radially outwardly of the central beam 426. The legs 428 of the lock drive 408 further define a pair of inwardly tapered or cam segments 434 depending contiguously from the outward segments 432 and leading to lower leg segments 436.

[0041] With continued reference to FIGS. 7-8, the locks 406 of the release mechanism 400 each define passages 438 extending through the approximate midsection of the respective locks 406, and also define upper and lower relief areas 440, 442 communicating with the passages 438. The passages 438 at least partially receive the legs 428 (e.g., at least the lower leg segments 436) of the lock drive 408. In the first position of the manually operable release 404 corresponding to the locked position of the locks 406 with respect to the anvil retainer 204, the lower leg segments 436 are disposed within the passages 438 to position the locks 406 within the mounting holes 210 of the sleeve 206 of the anvil retainer 204 (FIG. 8). This corresponds to the secured condition of the anvil 204 relative to the fastener cartridge 302 and/or the elongated tool 200. The manually operable release 404 is normally biased to the first condition through the pair of springs 418 with the free ends 418b engaging the shelves 444 of the lock drive 408, thereby driving the lock drive 408 to the upward or unactuated position and the manually operable release 404 to the first position of FIG. 8.

[0042] FIG. 8 also depicts a pair of pushers 446 which extend through the release housing 402 (e.g., may ride along the upper and lower surfaces 410a, 410b) and couple with the fastener firing mechanism extending through the elongated tool 200 and with the fastener cartridge 302, and a pair of approximator shafts 448 which couple either with the anvil retainer 204 and/or the anvil 304 to move the anvil 304 between open and approximated conditions relative to the fastener cartridge 302. The approximator shafts 448 may extend between the spaced hinges 422 of the manually operable release 404.

[0043] Referring now to FIG. 9, one exemplary end effector 300 for use with the elongated tool 200 is illustrated. Features of the end effector 300 are disclosed in commonly assigned U.S. Patent Publication No. 2015/0014393 to Milliman, the entire contents of which are incorporated by reference herein. The fastener cartridge 302 of the end effector 300 includes a housing 306, a pusher assembly 308, a fastener cartridge 310, and a knife assembly 312. The pusher assembly 308 includes a pusher adapter 314 and a pusher member 316, which couples with the pair of pushers 446 (FIG. 8) extending within the outer body 202 of the elongated tool 200. The knife assembly 312 includes a knife carrier 318 and a circular knife 320, which may be operatively coupled to the pushers 446. The fastener cartridge 310 includes a plurality of fasteners or staples 322 mounted within recesses 324 of the fastener cartridge 310.

[0044] With continued reference to FIG. 9, the anvil 304 of the end effector 300 includes an anvil shaft 326 which defines a longitudinal bore 328 for at least partial reception of the retainer shaft 208 of the anvil retainer 204. When positioned within the longitudinal bore 328, the retainer shaft 208 and the anvil 304 are coupled to each other. The anvil 304 includes a circular anvil head 330 with pockets (not shown) which receive and crimp the fasteners or staples 322 ejected by the fastener cartridge 310. In embodiments, the anvil 304 and the anvil retainer 204 may be a single component. Thus, mounting and release of the anvil retainer 204 will cause corresponding mounting and release of the anvil 304.

[0045] In one exemplary use, the elongated tool 200 with the fastener cartridge 310 and the anvil retainer 204 mounted thereto is advanced within a section of a tubular body organ. As indicated, the distal trocar tip 214 of the retainer shaft 208 may facilitate passage through tissue the organ. The anvil 304 is advanced or positioned in a second section of tubular body organ in opposed relation to the fastener cartridge 310. The ends of the first and second sections of the tubular body organs are secured about the fastener cartridge 310 and the anvil head 330,

respectively. The anvil shaft 326 is mounted to the retainer shaft 208, and the anvil 304 and the fastener cartridge 302 are approximated through activation of one of the actuators of the handle frame 102. The pusher assembly 308 is advanced (through, e.g., actuation of the handle 100 and movement of the pushers 446 within the release housing 402) causes advancing movement of the pusher member 316 and the knife assembly 312 to eject the fasteners or staples 322 for crimping against the anvil head 330 and to carve any tissue disposed within the connected organs.

[0046] Referring now to FIGS. 10-11, the use of the release mechanism 400 will be described. When it is determined by the clinician that the anvil retainer 204 with or without the mounted anvil 304 is to be released from the outer body 202 of the elongated tool 200, such as, for example, subsequent to the aforescribed anastomosis procedure, the manually engagement segment 424 of the manually operable release 404 is pushed inwardly relative to axis “k” in the direction “m” to cause it to pivot about the pivot hinges 422 against the bias of the springs 418 and assume the second position thereof corresponding to the release condition of the anvil 204 relative to the fastener cartridge 302 and/or the elongated tool 200. This causes the lock drive 408 to also move in the direction “m” against the bias of the spring 418 to, e.g., its actuated position. During movement of the lock drive 408, the cam segments 434 of the legs 428 traverse the passages 438 of the locks 406, and displace the locks 406 in the radial outward direction (corresponding to directional arrow “b”) due to the camming action of the cam segments 434 with at least one of the internal surfaces 440i, 442i of the upper and lower relief areas 440, 442 and/or the internal surfaces 438i of the passages 438 of the locks 406. As a result of the radial outward movement of the locks 406, the locks 406 are displaced from the mounting holes 210 of the sleeve 206 (corresponding to the unlocked position of the locks 406) thereby freeing the sleeve 206 and the entire anvil retainer 204 (and the anvil 304 if mounted to the anvil retainer 204) for removal from the elongated tool 200 as depicted in FIG. 12. Thus, removal of the anvil retainer 204 may be effected through simple depression of the manually operable release 404.

[0047] As depicted in FIG. 13, upon release of the manually operable release 404, the lock drive 408 and the manually operable release 404 return to their respective unactuated and first positions under the influence of the bias of the springs 418 with the cam segments 434 of the lock drive 408 engaging at least one of the internal surfaces 438i, 440i, 442i defined by the passages 438 and relief areas 440, 442 of the locks 406 thereby positioning the locks 406 in the

locked position. To load another anvil retainer 204 (new or sterilized and reused), the manually operable release 404 may be depressed to cause movement to the second position thereof and radial outward displacement of the locks 406 to the unlocked position. The anvil retainer 204 is introduced within the central axial bore 412 of the release housing 402 and the manually operable release 404 is released to assume its second position locks whereby the locks 406 return to the locked position received within the mounting holes 210 of the sleeve 206 of the anvil retainer 204 securing the anvil retainer 204 or trocar relative to the elongated tool 200. An anvil 304 may be introduced within the sleeve 206 prior to, during or after mounting of the anvil retainer 204 to the release housing 402.

[0048] The above description and the drawings are provided for the purpose of describing embodiments of the present disclosure and are not intended to limit the scope of the disclosure in any way. For example, although a motorized handle is shown, the present locking apparatus can be provided on a device including a manually operable handle, or a robotic system. It will be apparent to those skilled in the art that various modifications and variations can be made without departing from the spirit or scope of the disclosure. Thus, it is intended that the present disclosure cover the modifications and variations of this disclosure provided they come within the scope of the appended claims and their equivalents.

CLAIMS

1. A surgical circular fastener apparatus, which comprises:
an elongated body defining a longitudinal axis and having proximal and distal ends;
a fastener cartridge disposed adjacent the distal end of the body;
an anvil retainer releasably mounted relative to the fastener cartridge; and
a manually operable release including at least one cylindrical pivot or hinge, a manual engagement segment extending from the pivot and being accessible through a window in the elongated body for manual operation of the release and at least one lock, the release being configured to move between a first position corresponding to a secured condition of the anvil retainer relative to the fastener cartridge in which the at least one lock is engaged with the anvil retainer to prevent removal of the anvil retainer relative to the fastener cartridge and a second position in which the at least one lock is disengaged with the anvil retainer to permit removal or mounting of the anvil retainer relative to the fastener cartridge.
2. The surgical fastener apparatus according to claim 1 wherein the elongated body includes a release housing, the manually operable release mounted for movement relative the release housing.
3. The surgical fastener apparatus according to claim 2 wherein the release housing includes a lock drive, the lock drive coupled to the manually operable release and configured to position the at least one lock in the locked position upon movement of the manually operable release to the first position and configured to position the at least one lock in the unlocked position upon movement of the manually operable release to the second position.
4. The surgical fastener apparatus according to claim 3 wherein the release housing has at least one lock bore, the at least one lock dimensioned and adapted to traverse the lock bore during movement between the locked position and the unlocked position.
5. The surgical fastener apparatus according to claim 4 wherein the release housing defines first and second lock bores and having first and second locks respectively disposed within the first and second lock bores, the first and second locks traversing respective first and second lock bores during movement between the locked position and the unlocked position.
6. The surgical fastener apparatus according to claim 4 wherein the manually operable release is normally biased toward the first position.

7. The surgical fastener apparatus according to claim 6 wherein the lock drive is dimensioned and adapted to move within the release housing between an unactuated position corresponding to the first position of the manually operable release and an actuated position corresponding to the second position of the manually operable release.
8. The surgical fastener apparatus according to claim 7 including a spring configured to engage the lock drive to bias the lock drive to the unactuated position and the manually operable release to the first position.
9. The surgical fastener apparatus according to claim 9 wherein the lock drive is slidably mounted within the release housing between the unactuated position and the actuated position.
10. The surgical fastener apparatus according to claim 9 wherein the lock drive includes at least one cam segment dimensioned and configured to move the at least one lock to the locked position upon movement of the lock drive to the unactuated position and the manually operable release to the first position, and dimensioned and configured to move the at least one lock in a radial outward direction to the unlocked position released from the anvil retainer upon movement of the lock drive to the actuated position and the manually operable release to the second position.
11. The surgical fastener apparatus according to claim 3 wherein the anvil retainer defines a lock opening, the at least one lock dimensioned and configured to be at least partially received within the lock opening upon movement to the locked position and released from the lock opening upon movement to the unlocked position.
12. The surgical circular fastener apparatus according to claim 1, wherein
the anvil retainer defines at least one lock recess; and
including an anvil retainer release mechanism
 - having a release housing;
 - the manually operably release being mounted to the release housing and configured to move between the first position and the second position; and
 - the at least one lock configured to be received within the at least one lock recess of the anvil retainer to secure the anvil retainer relative to the fastener cartridge when in the locked position, and configured to be released from the at least one lock recess to release the anvil retainer to permit mounting or release of the anvil retainer relative to the fastener cartridge when in the unlocked position.

13. The surgical fastener apparatus according to claim 12 wherein the anvil retainer release mechanism includes a pair of locks and the anvil retainer defines a pair of lock recesses.

14. The surgical fastener apparatus according to claim 13 wherein the anvil retainer release mechanism includes a lock drive coupled to the manually operable release and movable within the retainer housing during movement of the manually operable release between the first and second positions, the lock drive defining cam segments dimensioned to engage and position the locks in respective locked and unlocked positions thereof.

15. The surgical fastener apparatus according to claim 14 wherein the manually operable release is normally biased toward the first position.

Covidien LP
Patent Attorneys for the Applicant/Nominated Person
SPRUSON & FERGUSON

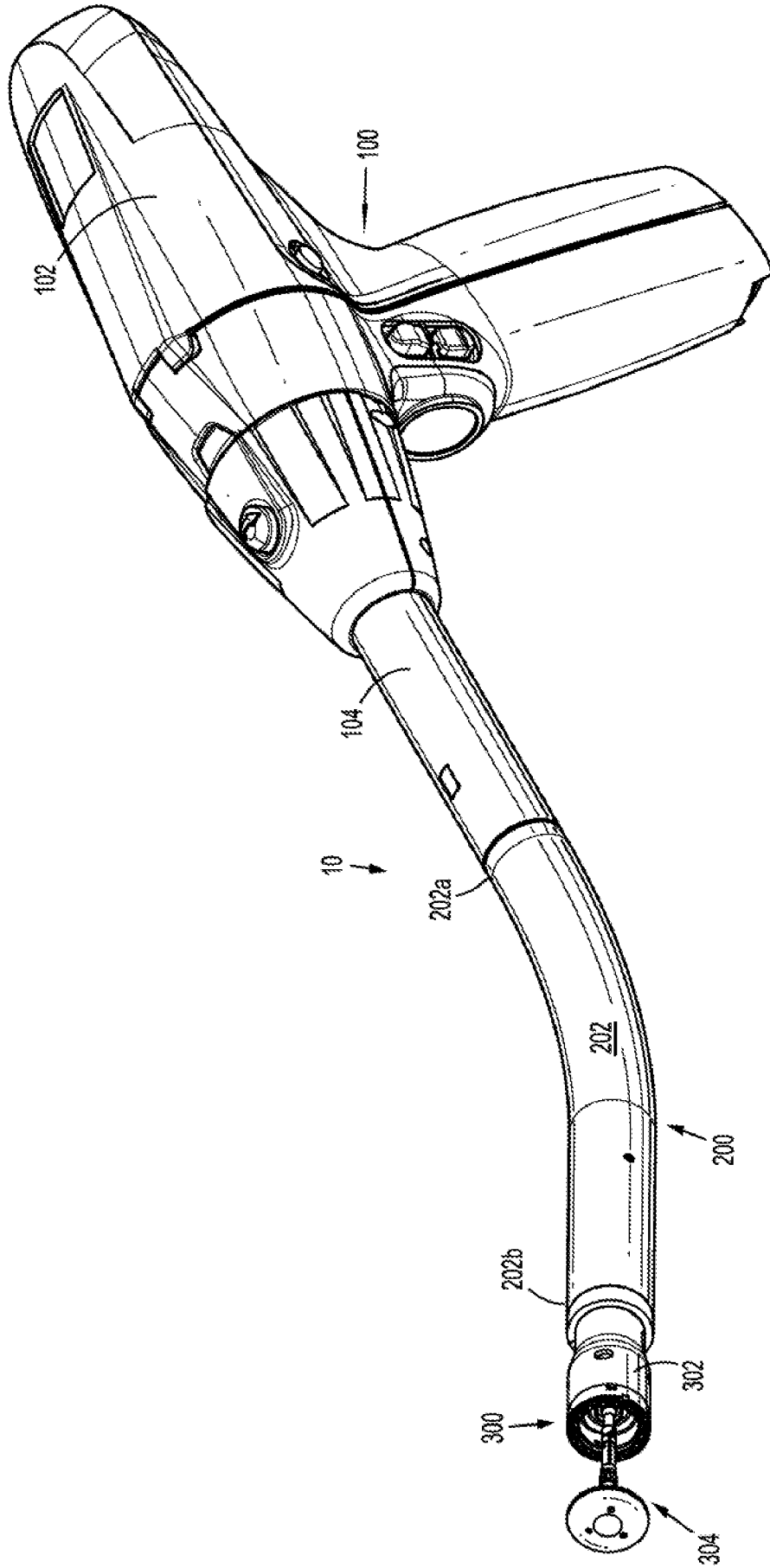

FIG. 1

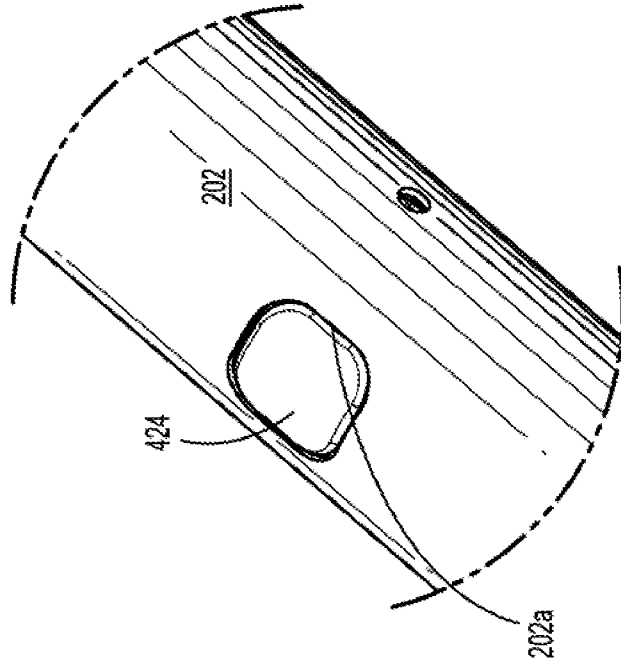

FIG. 2A

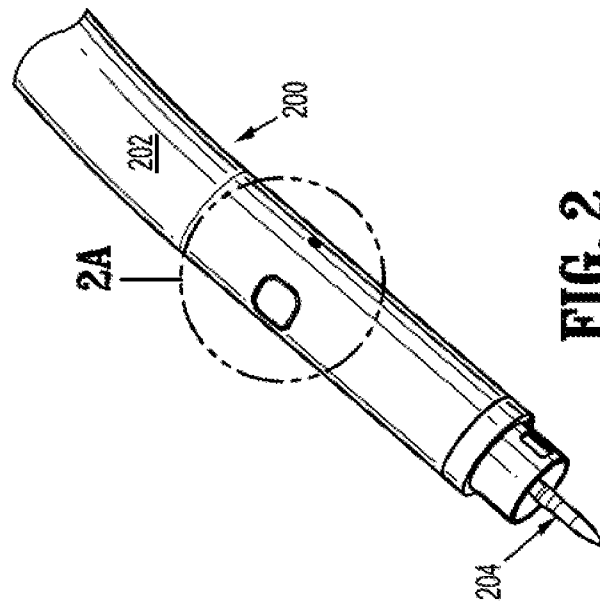

FIG. 2

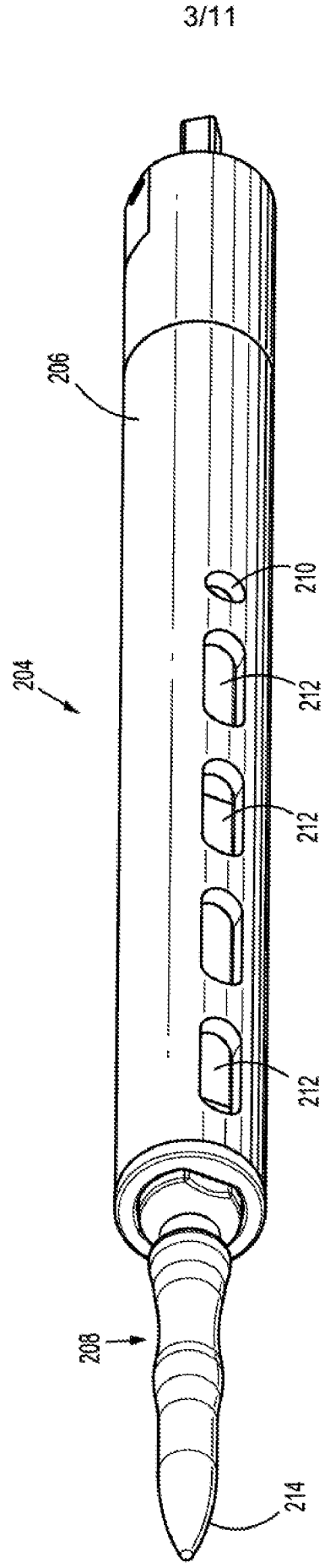

FIG. 3

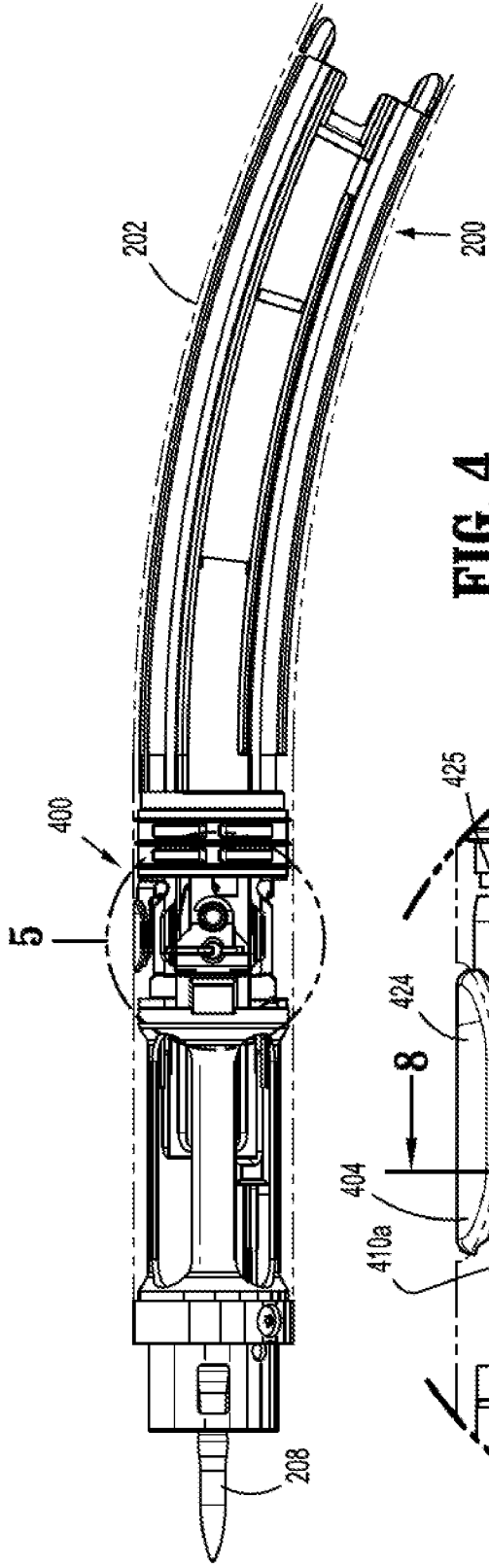

FIG. 4

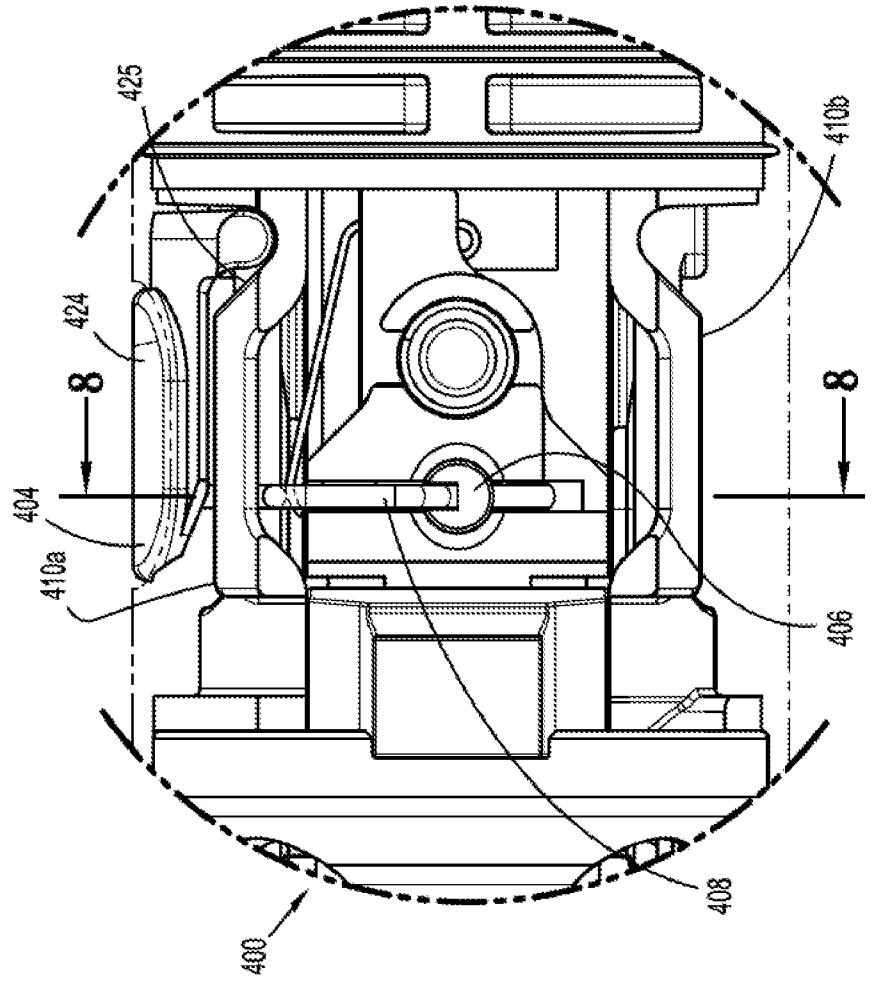

FIG. 5

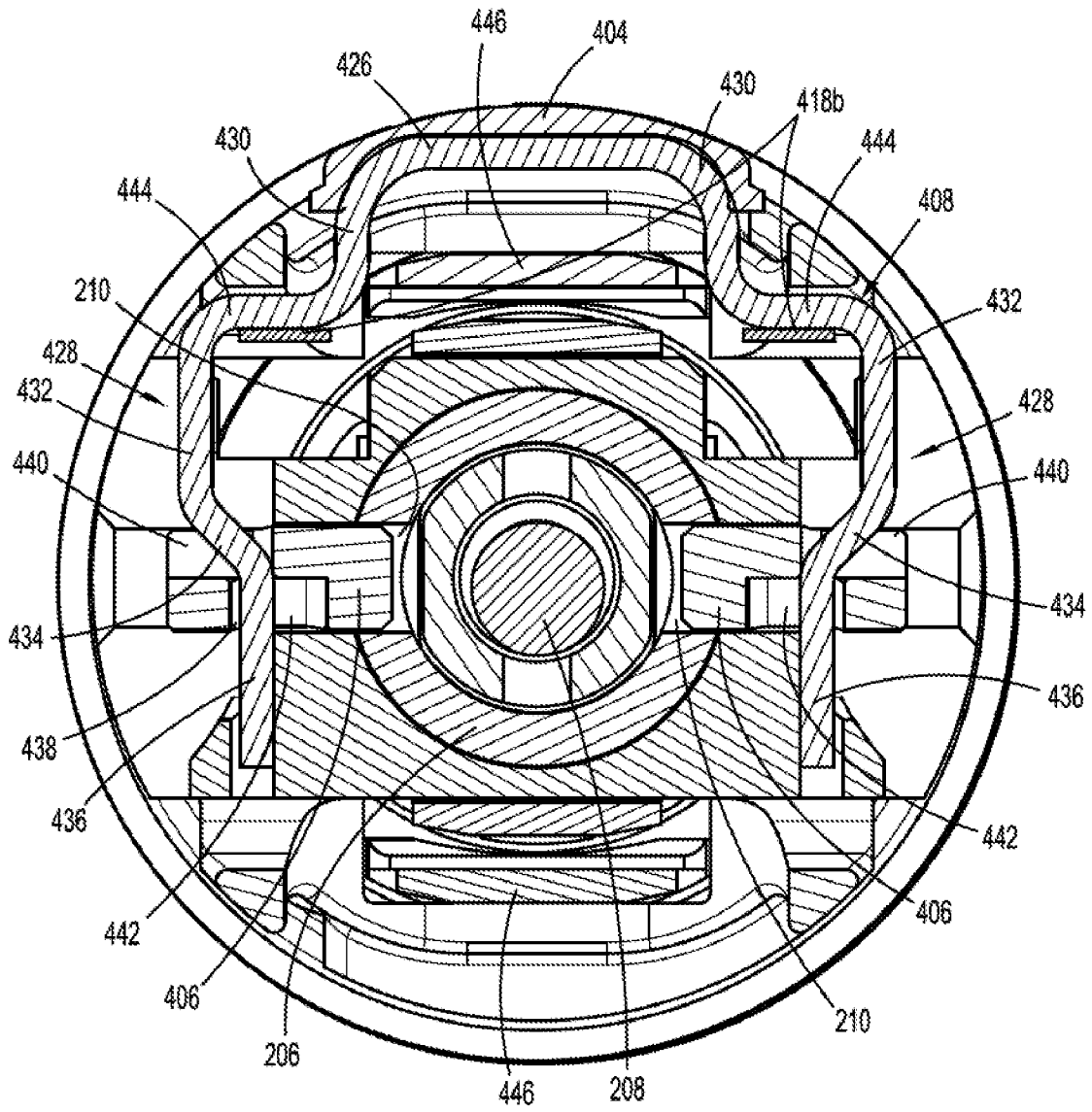

FIG. 8

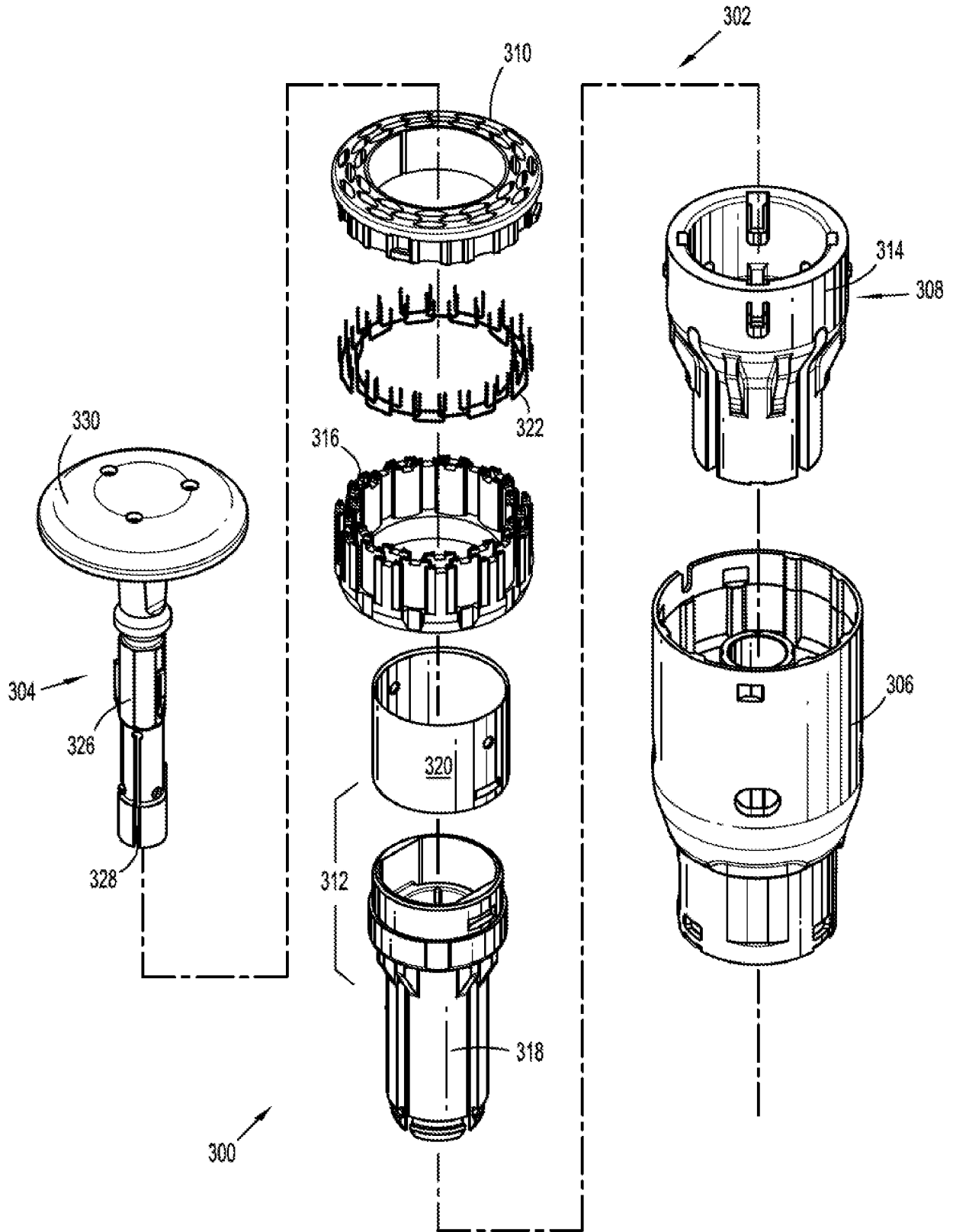

FIG. 9

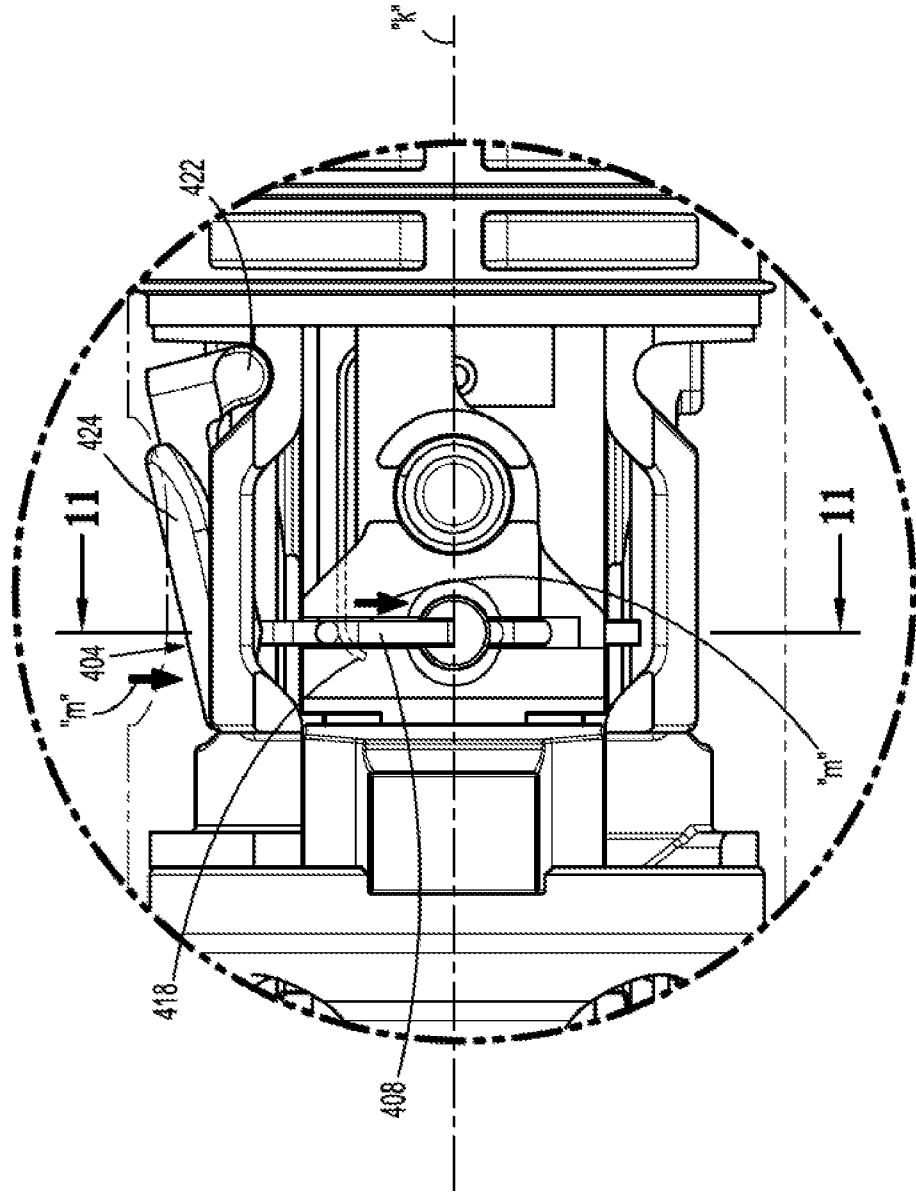

FIG. 10

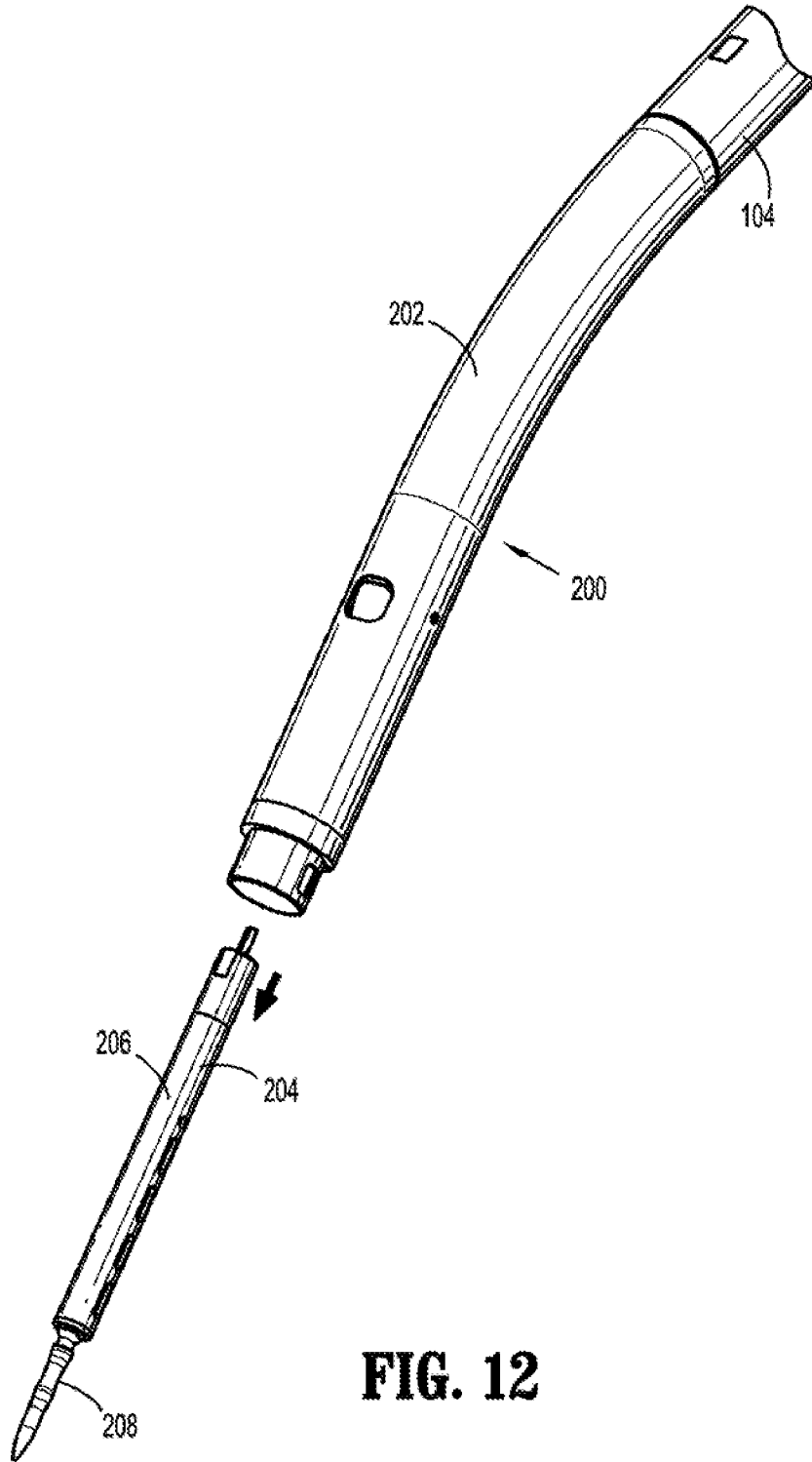

FIG. 12

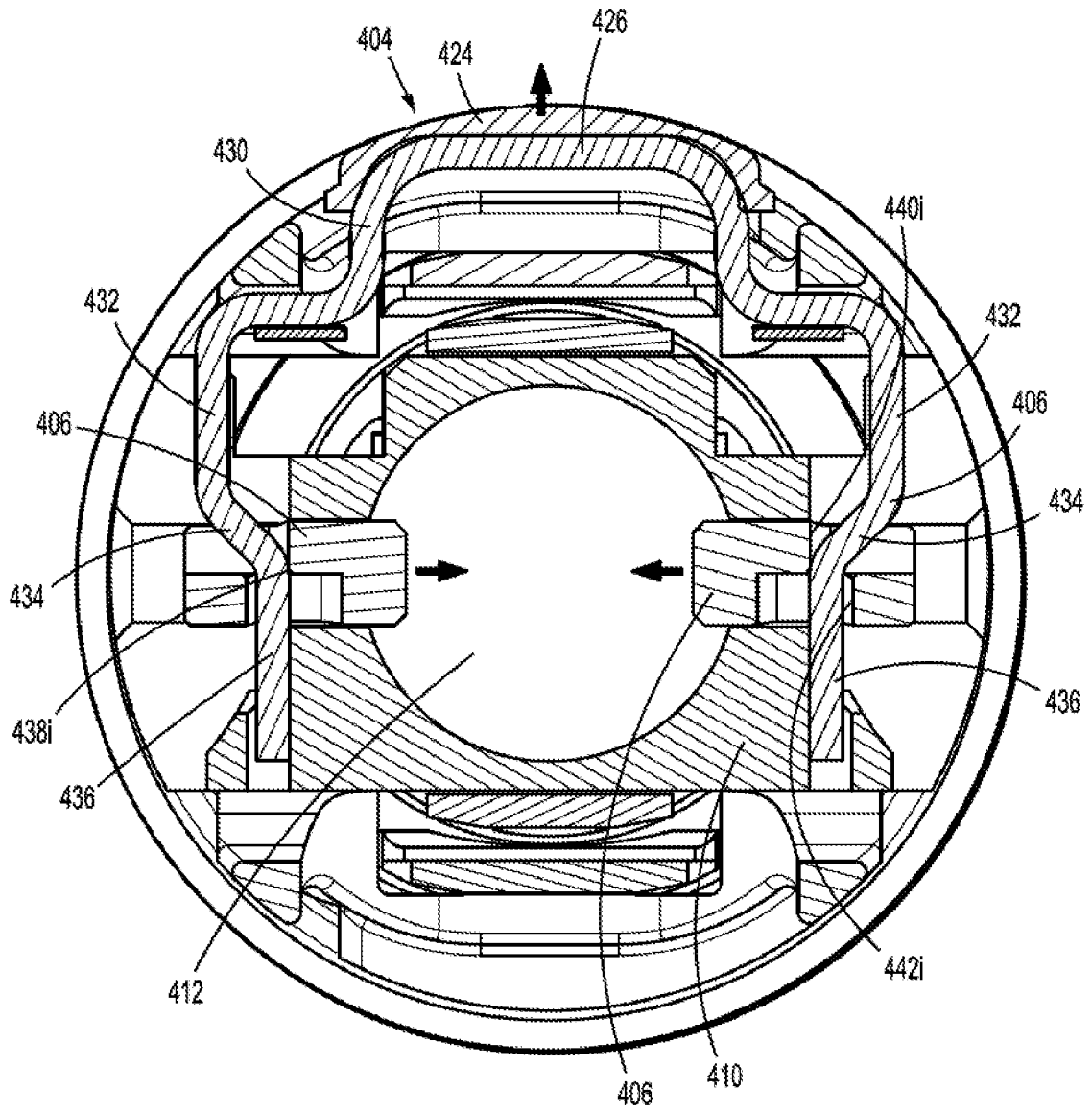

FIG. 13