



- (51) International Patent Classification:
A61B 17/29 (2006.01) *A61B 17/00* (2006.01)
- (21) International Application Number:
PCT/US2011/065382
- (22) International Filing Date:
16 December 2011 (16.12.2011)
- (25) Filing Language: English
- (26) Publication Language: English
- (30) Priority Data:
61/442,510 14 February 2011 (14.02.2011) US
13/326,911 15 December 2011 (15.12.2011) US
- (71) Applicant (for all designated States except US): **IMDS CORPORATION** [US/US]; 124 South 600 West, Logan, Utah 84321 (US).
- (72) Inventors; and
- (75) Inventors/Applicants (for US only): **PARK, Adrian E.** [CA/US]; 1604 John Worthington Way, Crownsville,

Maryland 21032 (US). **SHIRLEY, Brady R.** [US/US]; 825 Copper Woods Lane, Lewisville, Texas 75077 (US). **TRIPLETT, Daniel J.** [US/US]; 225 East 583 South, Providence, Utah 84332 (US). **EWER, Darin** [US/US]; 230 North 100 West, Providence, Utah 84332 (US).

(74) Agent: **PINKSTON, James;** IMDS Corporation, 124 South 600 West, Logan, Utah 84321 (US).

(81) Designated States (unless otherwise indicated, for every kind of national protection available): AE, AG, AL, AM, AO, AT, AU, AZ, BA, BB, BG, BH, BR, BW, BY, BZ, CA, CH, CL, CN, CO, CR, CU, CZ, DE, DK, DM, DO, DZ, EC, EE, EG, ES, FI, GB, GD, GE, GH, GM, GT, HN, HR, HU, ID, IL, IN, IS, JP, KE, KG, KM, KN, KP, KR, KZ, LA, LC, LK, LR, LS, LT, LU, LY, MA, MD, ME, MG, MK, MN, MW, MX, MY, MZ, NA, NG, NI, NO, NZ, OM, PE, PG, PH, PL, PT, QA, RO, RS, RU, RW, SC, SD, SE, SG, SK, SL, SM, ST, SV, SY, TH, TJ, TM, TN, TR, TT, TZ, UA, UG, US, UZ, VC, VN, ZA, ZM, ZW.

[Continued on next page]

(54) Title: ADJUSTABLE LAPAROSCOPIC INSTRUMENT HANDLE

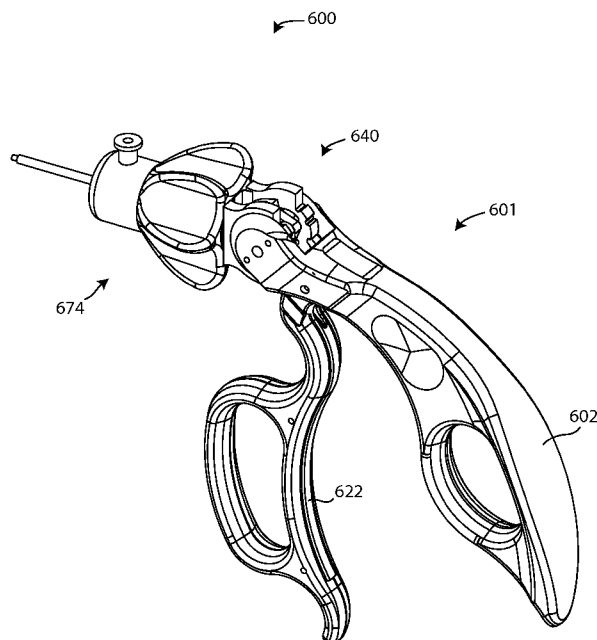

Fig. 60

(57) Abstract: Instrument handles are adjustable relative to an end effector of the instrument. The handles may be releasably locked in selected positions and/or orientations relative to the end effector. When the lock is released, the handles may be moved to a different position and/or orientation relative to the end effector, and locked in place. The handles may pivot relative to the end effector around one or more joints. The handles may pivot about an axis of a hinge joint or a point of a ball and socket joint. The axis of the hinge joint may be aligned parallel or perpendicular to a center longitudinal axis of the end effector, or of a shaft between the handles and the end effector.



(84) Designated States (*unless otherwise indicated, for every kind of regional protection available*): ARIPO (BW, GH, GM, KE, LR, LS, MW, MZ, NA, RW, SD, SL, SZ, TZ, UG, ZM, ZW), Eurasian (AM, AZ, BY, KG, KZ, MD, RU, TJ, TM), European (AL, AT, BE, BG, CH, CY, CZ, DE, DK, EE, ES, FI, FR, GB, GR, HR, HU, IE, IS, IT, LT, LU, LV, MC, MK, MT, NL, NO, PL, PT, RO, RS, SE, SI, SK, SM, TR), OAPI (BF, BJ, CF, CG, CI, CM, GA, GN, GQ, GW, ML, MR, NE, SN, TD, TG).

Published:

- with international search report (*Art. 21(3)*)
- before the expiration of the time limit for amending the claims and to be republished in the event of receipt of amendments (*Rule 48.2(h)*)

(88) Date of publication of the international search report:

8 November 2012

INTERNATIONAL SEARCH REPORT

International application No
PCT/US2011/065382

A. CLASSIFICATION OF SUBJECT MATTER
INV. A61B17/29 A61B17/00
ADD.

According to International Patent Classification (IPC) or to both national classification and IPC

B. FIELDS SEARCHED

Minimum documentation searched (classification system followed by classification symbols)
A61B

Documentation searched other than minimum documentation to the extent that such documents are included in the fields searched

Electronic data base consulted during the international search (name of data base and, where practicable, search terms used)

EPO-Internal

C. DOCUMENTS CONSIDERED TO BE RELEVANT

Category*	Citation of document, with indication, where appropriate, of the relevant passages	Relevant to claim No.
X	US 2007/299469 A1 (CARPENTER) 27 December 2007 (2007-12-27)	1-4,7-9
Y	. paragraphs [0002], [0034], [0038], [0050]; figures 2-2B,5,5A	5,6, 10-15
X	US 6 077 286 A (CUSCHIERI) 20 June 2000 (2000-06-20)	1-4,8,9
A	. column 2, line 66 - column 3, line 50; figures	14
X	US 5 520 678 A (HECKELE) 28 May 1996 (1996-05-28) column 3, lines 19-31 column 4, lines 8-13; figure 1	1
	----- -/-	



Further documents are listed in the continuation of Box C.



See patent family annex.

* Special categories of cited documents :

"A" document defining the general state of the art which is not considered to be of particular relevance

"E" earlier application or patent but published on or after the international filing date

"L" document which may throw doubts on priority claim(s) or which is cited to establish the publication date of another citation or other special reason (as specified)

"O" document referring to an oral disclosure, use, exhibition or other means

"P" document published prior to the international filing date but later than the priority date claimed

"T" later document published after the international filing date or priority date and not in conflict with the application but cited to understand the principle or theory underlying the invention

"X" document of particular relevance; the claimed invention cannot be considered novel or cannot be considered to involve an inventive step when the document is taken alone

"Y" document of particular relevance; the claimed invention cannot be considered to involve an inventive step when the document is combined with one or more other such documents, such combination being obvious to a person skilled in the art

"&" document member of the same patent family

Date of the actual completion of the international search

7 September 2012

Date of mailing of the international search report

17/09/2012

Name and mailing address of the ISA/

European Patent Office, P.B. 5818 Patentlaan 2
NL - 2280 HV Rijswijk
Tel. (+31-70) 340-2040,
Fax: (+31-70) 340-3016

Authorized officer

Klein, Christophe

INTERNATIONAL SEARCH REPORT

International application No
PCT/US2011/065382

C(Continuation). DOCUMENTS CONSIDERED TO BE RELEVANT		
Category*	Citation of document, with indication, where appropriate, of the relevant passages	Relevant to claim No.
Y	US 2001/027312 A1 (BACHER) 4 October 2001 (2001-10-04) paragraphs [0058] - [0060], [0070]; claim 6; figures 2,4,5 -----	5,6,10, 13-15
Y	US 2006/095074 A1 (LEE) 4 May 2006 (2006-05-04) -----	11,12
A	. paragraphs [0054], [0055], [0090]; figures 2a-3c,22 -----	15
A	US 2009/312773 A1 (CABRERA) 17 December 2009 (2009-12-17) paragraphs [0171] - [0177]; figures 32,38,74-82 -----	6
A	US 5 275 608 A (FORMAN) 4 January 1994 (1994-01-04) figures 1A-1C -----	12

INTERNATIONAL SEARCH REPORT

Information on patent family members

International application No

PCT/US2011/065382

Patent document cited in search report	Publication date	Patent family member(s)	Publication date
US 2007299469	A1	27-12-2007	CA 2655528 A1 03-01-2008
			CN 101534729 A 16-09-2009
			EP 2037823 A2 25-03-2009
			JP 2009541013 A 26-11-2009
			NZ 573625 A 30-09-2010
			RU 2008149553 A 10-08-2010
			US 2007299469 A1 27-12-2007
			WO 2008002574 A2 03-01-2008
US 6077286	A	20-06-2000	DE 19618291 A1 29-01-1998
			EP 0901347 A1 17-03-1999
			US 6077286 A 20-06-2000
			WO 9741783 A1 13-11-1997
US 5520678	A	28-05-1996	DE 4340707 A1 01-06-1995
			FR 2713129 A1 09-06-1995
			GB 2284242 A 31-05-1995
			US 5520678 A 28-05-1996
US 2001027312	A1	04-10-2001	DE 19860444 A1 13-07-2000
			EP 1082061 A1 14-03-2001
			US 2001027312 A1 04-10-2001
			WO 0038581 A1 06-07-2000
US 2006095074	A1	04-05-2006	KR 20080021598 A 07-03-2008
			US 2006095074 A1 04-05-2006
			US 2008262537 A1 23-10-2008
			WO 2006113216 A2 26-10-2006
US 2009312773	A1	17-12-2009	AU 2009202354 A1 07-01-2010
			CA 2668618 A1 13-12-2009
			EP 2133028 A2 16-12-2009
			JP 2010005386 A 14-01-2010
			US 2009312773 A1 17-12-2009
US 5275608	A	04-01-1994	US 5275608 A 04-01-1994
			WO 9307816 A1 29-04-1993