



(12) **EUROPEAN PATENT APPLICATION**

(43) Date of publication:
10.04.2019 Bulletin 2019/15

(51) Int Cl.:
A61M 1/00 (2006.01)

(21) Application number: **18183722.0**

(22) Date of filing: **18.11.2013**

(84) Designated Contracting States:
AL AT BE BG CH CY CZ DE DK EE ES FI FR GB GR HR HU IE IS IT LI LT LU LV MC MK MT NL NO PL PT RO RS SE SI SK SM TR

- **BLACK, Erin**
San Antonio, TX Texas 78249-2248 (US)
- **HALL, Colin John**
Poole, Dorset BH15 3LD (GB)
- **KAGAN, Jonathan**
Hopkins, MN Minnesota 55343 (US)

(30) Priority: **06.12.2012 US 201261734295 P**

(62) Document number(s) of the earlier application(s) in accordance with Art. 76 EPC:
13812222.1 / 2 928 515

(74) Representative: **CMS Cameron McKenna Nabarro Olswang LLP**
Cannon Place
78 Cannon Street
London EC4N 6AF (GB)

(71) Applicant: **IC Surgical, Inc.**
Grand Rapids MI 49503 (US)

Remarks:

- (72) Inventors:
- **CORNET, Douglas A.**
San Antonio, TX Texas 78258 (US)
 - **MANWARING, Michael**
San Antonio, TX Texas 78248 (US)
 - **GRIFFEY, Edward Sy**
Fair Oaks Ranch, TX Texas 78015 (US)

- This application was filed on 16.07.2018 as a divisional application to the application mentioned under INID code 62.
- Claims filed after the date of receipt of the divisional application (Rule 68(4) EPC)

(54) **ADAPTABLE WOUND DRAINAGE SYSTEM**

(57) Provided are drainage systems that may include a drainage manifold and may be suitable for draining fluid from a tissue site. The drainage manifold may include a plurality of elongate members having a moveable end that may be adapted to configure the drainage manifold

to treat a uniquely shaped tissue site. The drainage manifold may be coupled to a drainage tube with a transitional connector to provide a drainage system capable of distributing reduced pressure to the tissue site to enhance the drainage of fluids.

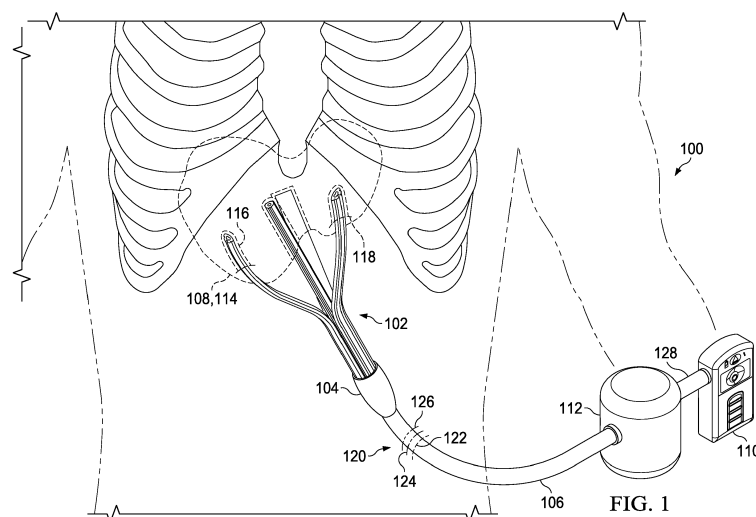

Description

RELATED APPLICATION

[0001] This application claims the benefit, under 35 USC § 119(e), of the filing of U.S. Provisional Patent Application Serial Number 61/734,295, entitled "Adaptable Wound Drainage System," filed December 6, 2012, which is incorporated herein by reference for all purposes.

BACKGROUND

[0002] The subject matter disclosed herein relates generally to medical wound care systems, and more particularly, but not by way of limitation, to wound drainage devices, systems, and methods. The devices, systems, and methods disclosed may provide increased configurability for adapting to multi-dimensional wounds, and may be particularly suitable for use with reduced pressure to enhance the drainage of fluids from the wound.

[0003] Common wound drainage devices, systems, and methods typically require multiple incision sites in a patient to provide treatment for a multi-dimensional wound that may have a large surface area or an unusual shape. Further, known devices, systems, and methods are typically difficult to configure and seal at the wound site, and can cause damage to tissue and pain for the patient upon removal.

[0004] Thus, improvements to wound drainage devices, systems, and methods that provide increased configurability and ease of placement for treatment of multi-dimensional wounds while reducing the potential for damage to tissue and pain for the patient are desirable. Such improvements may reduce the chance of infection, improve cosmetic appearance, reduce the pooling of fluids, and reduce the potential for seroma or hematoma.

SUMMARY

[0005] Shortcomings with certain aspects of wound drainage devices, systems, and methods are addressed as shown and described in a variety of illustrative, non-limiting embodiments herein.

[0006] According to an illustrative, non-limiting embodiment, a drainage system for draining fluid from a tissue site may include a drainage manifold, a transitional connector, and a drainage tube. The drainage manifold may have a longitudinal axis and may include a plurality of elongate members each having a first end, a second end, and an outer wall. The first end of each of the elongate members may be moveable between a gathered position and a dispersed position relative to the longitudinal axis of the drainage manifold. When the first end of each of the elongate members is in the gathered position, the elongate members may be releaseably secured longitudinally and circumferentially about the longitudinal axis of the drainage manifold. Each of the elongate members

may further include a longitudinal duct and a reinforced portion. The longitudinal duct may be positioned on the outer wall and between the first end and the second end of the elongate members. The reinforced portion may be positioned between the first end and the second end of the elongate members. The transitional connector may have a first end and an opposing second end. The first end of the transitional connector may be coupled to the drainage manifold. The drainage tube may be coupled to the second end of the transitional connector and in fluid communication with the drainage manifold and the longitudinal duct of each of the elongate members.

[0007] According to another illustrative, non-limiting embodiment, a drainage system for draining fluid from a tissue site may include a drainage manifold, a transitional connector, and a drainage tube. The drainage manifold may have a longitudinal axis and may include an elongate support, a plurality of elongate members, and a plurality of sacrificial webs. The elongate support may have a length and an external surface. The length of the elongate support may be positioned on the longitudinal axis of the drainage manifold. The plurality of elongate members may each have a first end, a second end, and an outer wall. The first end of each of the elongate members may be moveable between a gathered position and a dispersed position relative to the longitudinal axis of the drainage manifold. When the first end of the elongate member is in the gathered position, the elongate member may be releaseably secured longitudinally and circumferentially about the external surface of the elongate support. Each of the elongate members may further include a longitudinal duct positioned on the outer wall and between the first end and the second end of the elongate member. At least one of the plurality of sacrificial webs may be positioned between the elongate member and the elongate support to releaseably secure the elongate member about the elongate support when the first end of the elongate member is in the gathered position. The transitional connector may have a first end and an opposing second end. The first end of the transitional connector may be coupled to the drainage manifold. The drainage tube may be coupled to the second end of the transitional connector and in fluid communication with the drainage manifold and the longitudinal duct of each of the elongate members.

[0008] According to yet another illustrative, non-limiting embodiment, a drainage manifold for draining fluid from a tissue site may have a longitudinal axis and may include an elongate support, a plurality of elongate members, and a plurality of sacrificial webs. The elongate support may have a length, an external surface, and an inner lumen. The length of the elongate support may be positioned on the longitudinal axis of the drainage manifold. The plurality of elongate members may each have a first end, a second end, and an outer wall. The first end of each of the elongate members may be moveable between a gathered position and a dispersed position relative to the longitudinal axis of the drainage manifold.

When the first end of the elongate member is in the gathered position, the elongate member may be releaseably secured longitudinally and circumferentially about the external surface of the elongate support. Each of the elongate members may further include a longitudinal duct positioned on the outer wall and between the first end and the second end of the elongate member, an inner lumen, and an opening disposed through the outer wall. The opening may provide fluid communication between the inner lumen of the elongate member and the outer wall. At least one of the plurality of sacrificial webs may be positioned between the elongate member and the elongate support to releaseably secure the elongate member about the elongate support when the first end of the elongate member is in the gathered position.

[0009] According to still another illustrative, non-limiting embodiment, a drainage system for draining fluid from a tissue site may include a drainage manifold, a reduced-pressure source, and a fluid canister. The drainage manifold may include an elongate support and a plurality of elongate members. The elongate support may have a length, an external surface, an inner lumen, and a plurality of openings disposed through the external surface to provide fluid communication between the external surface and the inner lumen. The plurality of elongate members may each have a first end, a second end, and an outer wall. The first end of each of the elongate members may be moveable relative to the elongate support. The second end of each of the elongate members may be secured about the external surface of the elongate support. The outer wall of each of the elongate members may be in fluid communication with the inner lumen in the elongate support. The reduced-pressure source may be fluidly coupled to the elongate support and adapted to provide a reduced pressure to the drainage manifold and the inner lumen in the elongate support. The fluid canister may be positioned in fluid communication between the elongate support and the reduced-pressure source. The fluid canister may be adapted to retain fluid communicated from the drainage manifold.

[0010] Other features and advantages of the illustrative embodiments will become apparent with reference to the drawings and detailed description that follow.

BRIEF DESCRIPTION OF THE DRAWINGS

[0011] A more complete understanding of this specification may be obtained by reference to the following detailed description when taken in conjunction with the accompanying drawings, wherein:

FIG. 1 is a perspective view of an illustrative embodiment of a drainage system applied to a tissue site; FIG. 2A is a perspective, cut-away view of an illustrative embodiment of a drainage system depicting a drainage manifold having a plurality of elongate members in a gathered position; FIG. 2B is a perspective view of the drainage man-

ifold of FIG. 2A, illustrating the plurality of elongate members in a dispersed position; FIG. 2C is a cross-section view of the drainage manifold of FIG. 2A taken at line 2C-2C; FIG. 2D is a cross-section view of the drainage manifold of FIG. 2A taken at line 2D-2D; FIG. 3A is a perspective, cut-away view of another illustrative embodiment of a drainage system depicting a drainage manifold having a plurality of elongate members in a gathered position; FIG. 3B is a perspective view of the drainage manifold of FIG. 3A, illustrating the plurality of elongate members in a dispersed position; FIG. 3C is a cross-section view of the drainage manifold of FIG. 3A taken at line 3C-3C; FIG. 3D is a cross-section view of the drainage manifold of FIG. 3A taken at line 3D-3D; FIG. 4A is a perspective, cut-away view of another illustrative embodiment of a drainage system depicting a drainage manifold having a plurality of elongate members in a gathered position; FIG. 4B is a perspective view of the drainage manifold of FIG. 4A, illustrating the plurality of elongate members in a dispersed position; FIG. 4C is a cross-section view of the drainage manifold of FIG. 4A taken at line 4C-4C; FIG. 4D is a cross-section view of the drainage manifold of FIG. 4A taken at line 4D-4D; FIG. 5A is a perspective, cut-away view of another illustrative embodiment of a drainage system depicting a drainage manifold having a plurality of elongate members; and FIG. 5B is a perspective view of the drainage manifold depicted in FIG. 5A.

DETAILED DESCRIPTION

[0012] In the following detailed description of the non-limiting, illustrative embodiments, reference is made to the accompanying drawings that form a part hereof. Other embodiments may be utilized and logical, structural, mechanical, electrical, and chemical changes may be made without departing from the scope of this specification. To avoid detail not necessary to enable those skilled in the art to practice the embodiments described herein, the detailed description may omit certain information known to those skilled in the art. The following detailed description is, therefore, provided without limitation and with the scope of the illustrative embodiments being defined by the appended claims. As used herein, unless otherwise indicated, "or" does not require mutual exclusivity.

[0013] Referring generally to drawing FIGS. 1-5B, depicted therein are illustrative embodiments of a drainage system 100 that may include a drainage manifold 102, a transitional connector 104, and a drainage tube 106. The drainage system 100 may be particularly suitable for treating a tissue site 108, and may utilize reduced pres-

sure to enhance the drainage of fluids from the tissue site 108. Thus, the drainage system 100 may additionally include a reduced-pressure source 110 adapted to provide reduced pressure as part of the drainage system 100. Further, the drainage system 100 may include a fluid canister 112 adapted to retain fluid extracted from, for example, the tissue site 108.

[0014] The tissue site 108 may be, for example, a multi-dimensional tissue site 114 that may include multiple cavities 116 requiring drainage or treatment. The cavities 116 may be positioned or otherwise formed between multiple tissue layers 118. As depicted in FIG. 1, for example, the drainage system 100 may be applied to the tissue site 108 through an incision 120 that extends through or otherwise involves epidermis 122, dermis 124, and subcutaneous tissue 126. The drainage system 100 may be utilized at other tissue sites.

[0015] The tissue site 108 may be the bodily tissue of any human, animal, or other organism, including bone tissue, adipose tissue, muscle tissue, dermal tissue, vascular tissue, connective tissue, cartilage, tendons, ligaments, or any other tissue. Treatment of the tissue site 108 may include the removal of fluids, such as, for example, exudate or ascites, or the instillation of fluid to the tissue site 108.

[0016] As used herein, "reduced pressure" generally refers to a pressure less than the ambient pressure at the tissue site 108 being subjected to treatment. This reduced pressure may be less than the atmospheric pressure. In some embodiments, the reduced pressure may be less than a hydrostatic pressure at a tissue site. Unless otherwise indicated, values of pressure stated herein are gauge pressures. While the amount and nature of reduced pressure applied to a tissue site may vary according to the application, the reduced pressure may be between about -5 mm Hg to about -500 mm Hg. In some embodiments, the reduced pressure may be in a therapeutic range between about -100 mm Hg to about -200 mm Hg.

[0017] The reduced pressure delivered may be constant or varied, patterned or random, and may be delivered continuously or intermittently. Although the terms "vacuum" and "negative pressure" may be used to describe the pressure applied to a tissue site, the actual pressure applied to a tissue site may be more than the pressure normally associated with a complete vacuum. Consistent with the use herein, an increase in reduced pressure or vacuum pressure typically refers to a relative reduction in absolute pressure.

[0018] In the embodiments of FIGS. 1-5B, the reduced-pressure source 110 may be fluidly coupled to the drainage tube 106. The drainage tube 106 may be in fluid communication with the transitional connector 104 and the drainage manifold 102 as will be described below. Further, the fluid canister 112 may be fluidly coupled between the drainage tube 106 and the reduced-pressure source 110. As shown, the drainage tube 106 may be fluidly coupled to the fluid canister 112. A fluid conduit

128 may be coupled between the fluid canister 112 and the reduced-pressure source 110 to provide fluid communication and reduced pressure from the reduced-pressure source 110 to, for example, the fluid canister 112, the drainage tube 106, the transitional connector 104, and the drainage manifold 102. The drainage tube 106 and the fluid conduit 128 may be coupled to an upper portion of the fluid canister 112 to prevent the reduced pressure from interfering with fluid collecting at a lower portion of the fluid canister 112.

[0019] As used herein, the term "coupled" may include coupling with a separate object or direct coupling. The term "coupled" may also encompass two or more components that are continuous with one another by virtue of each of the components being formed from the same piece of material. Also, the term "coupled" may include chemical coupling, such as with a chemical bond, or mechanical, thermal, or electrical coupling. Fluid coupling may refer to a coupling permitting fluid to be in communication between the designated parts or locations.

[0020] The reduced-pressure source 110 may be any suitable device for providing reduced pressure as described herein, such as, for example, a vacuum pump, wall suction, or other source. The fluid canister 112 may be any suitable containment device capable of retaining fluid and communicating reduced pressure from the reduced-pressure source 110 to other components of the drainage system 100, such as the drainage manifold 102.

[0021] In some embodiments, one or more monitoring devices (not shown) may be fluidly coupled to the drainage system 100. The monitoring devices may be, for example, a pressure-feedback device, a volume detection system, a blood detection system, an infection detection system, a flow monitoring system, a temperature monitoring system, or similar device. In some embodiments, the monitoring devices may be formed integrally with the reduced-pressure source 110.

[0022] The transitional connector 104 may have a first end 130, an opposing second end 132, a center 134 positioned substantially equidistant between the first end 130 and the second end 132, an internal surface 136, and an external surface 138. The first end 130 of the transitional connector 104 may be fluidly coupled to the drainage manifold 102, and the second end 132 of the transitional connector 104 may be fluidly coupled to the drainage tube 106. Thus, the drainage tube 106 may be in fluid communication with the drainage manifold 102. The transitional connector 104 may be adapted to provide a smooth external profile between the drainage manifold 102 and the drainage tube 106. For example, in some embodiments, the transitional connector 104 may have a first taper 140 and an opposing second taper 142. The first taper 140 may provide a tapered transition from an outside diameter at the center 134 of the transitional connector 104 to a smaller outside diameter at the first end 130 of the transitional connector 104. Similarly, the second taper 142 may provide a tapered transition from the outside diameter at the center 134 to a smaller outside

diameter at the second end 132 of the transitional connector 104. The first taper 140 and the second taper 142 may have any shape or angle to provide an external profile for the transitional connector 104 suitable for a particular application. In other embodiments, the transitional connector 104 may be omitted and the drainage manifold 102 may be coupled to the drainage tube 106 or formed integrally with the drainage tube 106. Further, in some embodiments, the external surface 138 and the internal surface 136 of the transitional connector 104 may have a substantially circular cross-section.

[0023] The drainage manifold 102, the transitional connector 104, and the drainage tube 106 may be formed, for example, from a soft polymer or other pliable material. As non-limiting examples, the drainage manifold 102, the transitional connector 104, and the drainage tube 106 may be formed from a silicone elastomer, polyurethane, polyethylene, polypropylene, polyvinyl chloride (PVC), fluorosilicone, ethylene-propylene, acrylic, or similar material. In some embodiments, the drainage manifold 102 may be extruded from DEHP-free PVC. In another embodiment, the drainage manifold 102, the transitional connector 104, and the drainage tube 106 may be molded, casted, or extruded, and may be formed as an integral unit. In yet another embodiment, the transitional connector 104 may be a silicone curable adhesive bonded joint for coupling the drainage manifold 102 and the drainage tube 106 to one another. To suit a particular application, the drainage manifold 102 may additionally include color-coding, materials for X-Ray detection, graduation markings, and coatings to reduce clogging and the presence of bacteria.

[0024] Referring now to the embodiments of FIGS. 2A-2D, a drainage manifold 202 may have a longitudinal axis 250 and may include a plurality of elongate members 252, an elongate support 254, and a plurality of sacrificial webs 256. Each of the elongate members 252 may have a first end 258, a second end 260, and an outer wall 262. The first end 258 of each of the elongate members 252 may be moveable between a gathered position and a dispersed position relative to the longitudinal axis 250 of the drainage manifold 202. When the first end 258 of each of the elongate members 252 is in the gathered position, the elongate members 252 may be releaseably secured longitudinally and circumferentially about the longitudinal axis 250 of the drainage manifold 202. The second end 260 of each of the elongate members 252 may be coupled to the internal surface 136 of the transitional connector 104 and at the first end 130 of the transitional connector 104 such that the drainage tube 106 is in fluid communication with at least the outer wall 262 of each of the elongate members 252. Although FIGS. 2A-2D depict three of the elongate members 252, the drainage manifold 202 may include any number of the elongate members 252 to suit a particular application.

[0025] As shown in FIGS. 2A-2D, each of the elongate members 252 may have an oblong cross-sectional shape and may additionally include a longitudinal duct 264, an

inner lumen 266, an opening 268, a chamfer 270, a reinforced portion 272, a trimmable tip 274, and a mating surface 276. The longitudinal duct 264 may be positioned on the outer wall 262 and between the first end 258 and the second end 260 of the elongate member 252. As shown in FIGS. 2A-2D, each of the elongate members 252 may include a plurality of longitudinal ducts 264 positioned as described above. The drainage tube 106 may be in fluid communication with at least the longitudinal duct 264 of each of the elongate members 252.

[0026] Each of the elongate members 252 may carry the inner lumen 266, for example, internally along the length of the elongate member 252 and between the first and the second end 258, 260 of the elongate member 252. The drainage tube 106 may be in fluid communication with at least the inner lumen 266 in each of the elongate members 252. Each of the elongate members 252 may have the opening 268 disposed through the outer wall 262 of the elongate member 252 to provide fluid communication between the inner lumen 266 of the elongate member 252 and the outer wall 262 of the elongate member 252. The oblong cross-sectional shape of each of the elongate members 252 may enhance the ability of the elongate member 252 to resist collapsing of the inner lumen 266 when positioned at the tissue site 108.

[0027] As shown in FIGS. 2A-2D, the opening 268 may be a longitudinal channel 278 positioned between the first and the second end 258, 260 of the elongate member 252. In another embodiment, each of the elongate members 252 may have a plurality of the openings 268 disposed through the outer wall 262 of the elongate member 252. Each of the elongate members 252 may have the chamfer 270 positioned on the abutting surface between the opening 268 and the outer wall 262 of the elongate member 252.

[0028] Each of the elongate members 252 may carry the reinforced portion 272 between the first and the second end 258, 260 of the elongate member 252. The reinforced portion 272 may be, for example, a formable titanium wire formed integrally into each of the elongate members 252. Each of the elongate members 252 may carry the trimmable tip 274 at the first end 258 of the elongate member 252. If equipped with the trimmable tip 274, the elongate member 252 may carry the reinforced portion 272 between the trimmable tip 274 and the second end 260 of the elongate member 252. Thus, the trimmable tip 274 may be trimmed or otherwise cut to a desired length without exposing or otherwise interfering with the reinforced portion 272 of the elongate member 252.

[0029] Each of the elongate members 252 may carry the mating surface 276 that may be adapted to engage the internal surface 136 of the transitional connector 104. As shown in FIGS. 2A-2D, the mating surface 276 of each of the elongate members 252 may extend longitudinally between the first and the second end 258, 260 of the elongate member 252 and on the outer wall 262 of the elongate member 252. Further, each of the elongate members 252 may include a plurality of the mating sur-

faces 276. In another embodiment, each of the elongate members 252 may carry the mating surface 276 on a portion of the elongate member 252 at the second end 260 for engaging the internal surface 136 of the transitional connector 104. The mating surface 276 of each of the elongate members 252 may cooperate with one another to provide an outer boundary 280 for the drainage manifold 202 that may be compatible with the internal surface 136 of the transitional connector 104. For example, as shown in FIGS. 2C-2D, the outer boundary 280 of the drainage manifold 202 may be circular in shape and may have an outer dimension sized to interferingly engage a complementary circular shape and inner dimension of the internal surface 136 of the transitional connector 104.

[0030] The elongate support 254 may have a length and an external surface 282. The drainage manifold 202 may carry the elongate support 254 on the longitudinal axis 250 of the drainage manifold 202. When the first end 258 of the elongate member 252 is in the gathered position described above, the elongate member 252 may be releaseably secured longitudinally and circumferentially about the external surface 282 of the elongate support 254. The drainage tube 106 may be in fluid communication with at least the external surface 282 of the elongate support 254.

[0031] As shown in FIGS. 2A-2D, the elongate support 254 may additionally include a plurality of longitudinal protrusions 284, an inner lumen 286, an opening 288, and a chamfer 289. The elongate support 254 may carry the plurality of longitudinal protrusions 284 on the external surface 282 and along the length of the elongate support 254. The longitudinal protrusions 284 and the external surface 282 may cooperate to define at least one longitudinal groove 290. The drainage tube 106 may be in fluid communication with at least the longitudinal groove 290.

[0032] The elongate support 254 may carry the inner lumen 286, for example, internally along the length of the elongate support 254. The drainage tube 106 may be in fluid communication with at least the inner lumen 286 in the elongate support 254. The elongate support 254 may have the opening 288 disposed through the external surface 282 of the elongate support 254 to provide fluid communication between the inner lumen 286 of the elongate support 254 and the external surface 282 of the elongate support 254. As shown in FIG. 2B, the elongate support 254 may have a plurality of the openings 288 positioned along the length of the elongate support 254. Further, the elongate support 254 may have the chamfer 289 positioned on the abutting surface between the opening 288 and the external surface 282 of the elongate support 254.

[0033] The drainage manifold 202 may carry at least one of the sacrificial webs 256 between the elongate member 252 and the elongate support 254 to releaseably secure the elongate member 252 about the elongate support 254 when the first end 258 of the elongate member 252 is in the gathered position. The sacrificial web 256

may be severable upon application of a force, such as a pulling force, directed to pull or otherwise separate the elongate member 252 away from the elongate support 254. For example, the force may be applied on the elongate member 252 and directed transverse to the longitudinal axis 250 of the drainage manifold 202. The thickness of the sacrificial web 256 may be sized such that the sacrificial web 256 may sever upon application of a threshold amount of the force, permitting the elongate member 252 to separate from the elongate support 254. In some embodiments, the threshold amount of the force may be less than an amount of force required to sever another component of the drainage manifold 202. Thus, the application of the threshold force to the elongate member 252 may prevent damage to other components of the drainage manifold 202. In some embodiments, each of the sacrificial webs 256 may, for example, have a score or a perforation (not shown) that may be positioned along the length of the sacrificial web 256 and adapted to enhance the separation of the elongate member 252 from the elongate support 254. For example, the score or perforation may enhance the separation of the elongate member 252 from the elongate support 254 along a predictable or desired path defined by the score or perforation such as, for example, a substantially straight line. The threshold force required to sever the sacrificial web 256 along the score or perforation to separate the elongate member 252 from the elongate support 254 may be less than the force required to sever the sacrificial web 256 at another location. The plurality of the sacrificial webs 256 may permit a physician, for example, to configure the drainage manifold 202 to treat a larger surface area, without a cutting instrument or other instrument, by pulling the elongate members 252 away from the elongate support 254 by hand.

[0034] Referring now to the embodiments of FIGS. 3A-3D, a drainage manifold 302 may have a longitudinal axis 350 and may include a plurality of elongate members 352, an elongate support 354, and a plurality of sacrificial webs 356. Each of the elongate members 352 may have a first end 358, a second end 360, and an outer wall 362. The first end 358 of each of the elongate members 352 may be moveable between a gathered position and a dispersed position relative to the longitudinal axis 350 of the drainage manifold 302. When the first end 358 of each of the elongate members 352 is in the gathered position, the elongate members 352 may be releaseably secured longitudinally and circumferentially about the longitudinal axis 350 of the drainage manifold 302. The second end 360 of each of the elongate members 352 may be coupled to the internal surface 136 of the transitional connector 104 at the first end 130 of the transitional connector 104 such that the drainage tube 106 is in fluid communication with at least the outer wall 362 of each of the elongate members 352. Although FIGS. 3A-3D depict four of the elongate members 352, the drainage manifold 302 may include any number of the elongate members 352 to suit a particular application.

[0035] As shown in FIGS. 3A-3D, each of the elongate members 352 may additionally include a longitudinal duct 364, a reinforced portion 372, a trimmable tip 374, and a mating surface 376. The longitudinal duct 364 may be positioned on the outer wall 362 and between the first end 358 and the second end 360 of the elongate member 352. As shown in FIGS. 3A-3D, each of the elongate members 352 may include a plurality of longitudinal ducts 364 positioned as described above. The drainage tube 106 may be in fluid communication with at least the longitudinal duct 364 of each of the elongate members 352.

[0036] Each of the elongate members 352 may carry the reinforced portion 372 between the first and the second end 358, 360 of the elongate member 352. The reinforced portion 372 may be, for example, a formable titanium wire formed integrally into each of the elongate members 352. Each of the elongate members 352 may carry the trimmable tip 374 at the first end 358 of the elongate member 352. If equipped with the trimmable tip 374, the elongate member 352 may carry the reinforced portion 372 between the trimmable tip 374 and the second end 360 of the elongate member 352. Thus, the trimmable tip 374 may be trimmed or otherwise cut to a desired length without exposing or otherwise interfering with the reinforced portion 372 of the elongate member 352.

[0037] Each of the elongate members 352 may carry the mating surface 376 adapted to engage the internal surface 136 of the transitional connector 104. As shown in FIGS. 3A-3D, the mating surface 376 of each of the elongate members 352 may extend longitudinally between the first and the second end 358, 360 of the elongate member 352 and on the outer wall 362 of the elongate member 352. Further, each of the elongate members 352 may include a plurality of the mating surfaces 376. In some embodiments, each of the elongate members 352 may carry the mating surface 376 on a portion of the elongate member 352 at the second end 360 for engaging the internal surface 136 of the transitional connector 104. The mating surface 376 of each of the elongate members 352 may cooperate with one another to provide an outer boundary 380 for the drainage manifold 302 that is compatible with the internal surface 136 of the transitional connector 104. For example, as shown in FIGS. 3C-3D, the outer boundary 380 of the drainage manifold 302 may be circular in shape and may have an outer dimension sized to interferingly engage a complementary circular shape and inner dimension of the internal surface 136 of the transitional connector 104.

[0038] The elongate support 354 may have a length and an external surface 382. The drainage manifold 302 may carry the elongate support 354 on the longitudinal axis 350 of the drainage manifold 302. When the first end 358 of the elongate member 352 is in the gathered position described above, the elongate member 352 may be releaseably secured longitudinally and circumferentially about the external surface 382 of the elongate support 354. The drainage tube 106 may be in fluid communication with at least the external surface 382 of the elongate support 354.

gate support 354.

[0039] As shown in FIGS. 3A-3D, the elongate support 354 may additionally include an inner lumen 386, an opening 388, and a chamfer 389. The elongate support 354 may carry the inner lumen 386, for example, internally along the length of the elongate support 354. The drainage tube 106 may be in fluid communication with at least the inner lumen 386 in the elongate support 354. The elongate support 354 may have the opening 388 disposed through the external surface 382 of the elongate support 354 to provide fluid communication between the inner lumen 386 of the elongate support 354 and the external surface 382 of the elongate support 354. As shown in FIG. 3B, the elongate support 354 may have a plurality of the openings 388 positioned along the length of the elongate support 354. Further, the elongate support 354 may have the chamfer 389 positioned on the abutting surface between the opening 388 and the external surface 382 of the elongate support 354.

[0040] In some embodiments (not shown) the elongate support 354 may have similar elements as the elongate member 352. For example, the elongate support 354 may include the previously described longitudinal duct 364, the reinforced portion 372, and the trimmable tip 374. The elongate support 354 may carry the longitudinal duct 364 along the length and on the external surface 382 of the elongate support 354. Further, the elongate support 354 may carry the trimmable tip 374 on an end of the elongate support 354 with the reinforced portion 372 positioned between the trimmable tip 374 and an opposing end of the elongate support 354.

[0041] The drainage manifold 302 may carry at least one of the sacrificial webs 356 between the elongate member 352 and the elongate support 354 to releaseably secure the elongate member 352 about the elongate support 354 when the first end 358 of the elongate member 352 is in the gathered position. The sacrificial web 356 may be severable upon application of a force, such as a pulling force, directed to pull or otherwise separate the elongate member 352 away from the elongate support 354. For example, the force may be applied on the elongate member 352 and directed transverse to the longitudinal axis 350 of the drainage manifold 302. The thickness of the sacrificial web 356 may be sized such that the sacrificial web 356 may sever upon application of a threshold amount of the force, permitting the elongate member 352 to separate from the elongate support 354. In some embodiments, the threshold amount of the force may be less than an amount of force capable of severing another component of the drainage manifold 302. Thus, the application of the threshold force to the elongate member 352 may prevent damage to other components of the drainage manifold 302. In some embodiments, each of the sacrificial webs 356 may, for example, have a score or a perforation (not shown) along the length of the sacrificial web 356 that may be adapted to enhance the separation of the elongate member 352 from the elongate support 354. For example, the score or perforation

may define a predictable or desired path, such as a substantially straight line, for separation of the elongate member 352 from the elongate support 354. The threshold force required to sever the sacrificial web 356 along the score or perforation to separate the elongate member 352 from the elongate support 354 may be less than the force required to sever the sacrificial web 356 at another location. The plurality of the sacrificial webs 356 may permit a physician, for example, to configure the drainage manifold 302 to treat a larger surface area of tissue, without a cutting instrument or other instrument, by pulling the elongate members 352 away from the elongate support 354 by hand.

[0042] Referring now to the embodiments of FIGS. 4A-4D, a drainage manifold 402 may have a longitudinal axis 450 and may include a plurality of elongate members 452 and a plurality of sacrificial webs 456. Each of the elongate members 452 may have a first end 458, a second end 460, and an outer wall 462. The first end 458 of each of the elongate members 452 may be moveable between a gathered position and a dispersed position relative to the longitudinal axis 450 of the drainage manifold 402. When the first end 458 of each of the elongate members 452 is in the gathered position, the elongate members 452 may be releaseably secured longitudinally and circumferentially about the longitudinal axis 450 of the drainage manifold 402. The second end 460 of each of the elongate members 452 may be coupled to the internal surface 136 of the transitional connector 104 at the first end 130 of the transitional connector 104 such that the drainage tube 106 may be in fluid communication with at least the outer wall 462 of each of the elongate members 452. Although FIGS. 4A-4D depict three of the elongate members 452, the drainage manifold 402 may include any number of the elongate members 452 to suit a particular application.

[0043] As shown in FIGS. 4A-4D, each of the elongate members 452 may have an oblong cross-sectional shape and may additionally include a longitudinal duct 464, an inner lumen 466, an opening 468, a chamfer 470, a reinforced portion 472, a trimmable tip 474, and a mating surface 476. The longitudinal duct 464 may be positioned on the outer wall 462 and between the first end 458 and the second end 460 of the elongate member 452. In some embodiments, each of the elongate members 452 may include a plurality of the longitudinal ducts 464 positioned as described above. The drainage tube 106 may be in fluid communication with at least the longitudinal duct 464 of each of the elongate members 452.

[0044] Each of the elongate members 452 may carry the inner lumen 466, for example, internally along the length of the elongate member 452 and between the first and the second end 458, 460 of the elongate member 452. The drainage tube 106 may be in fluid communication with at least the inner lumen 466 in each of the elongate members 452. Each of the elongate members 452 may have the opening 468 disposed through the outer wall 462 of the elongate member 452 to provide fluid

communication between the inner lumen 466 of the elongate member 452 and the outer wall 462 of the elongate member 452. The oblong cross-sectional shape of each of the elongate members 452 may enhance the ability of the elongate member 452 to resist collapsing of the inner lumen 466 when positioned at the tissue site 108.

[0045] As shown in FIGS. 4A-4D, each of the elongate members 452 may have a plurality of the openings 468 disposed through the outer wall 462 of the elongate member 452. The plurality of the openings 468 may be positioned sequentially between the first and the second end 458, 460 of each of the elongate members 452. Each of the elongate members 452 may have the chamfer 470 positioned on the abutting surface between the opening 468 and the outer wall 462 of the elongate member 452.

[0046] Each of the elongate members 452 may carry the reinforced portion 472 between the first and the second end 458, 460 of the elongate member 452. The reinforced portion 472 may be, for example, a formable titanium wire formed integrally into each of the elongate members 452. Each of the elongate members 452 may carry the trimmable tip 474 at the first end 458 of the elongate member 452. If equipped with the trimmable tip 474, the elongate member 452 may carry the reinforced portion 472 between the trimmable tip 474 and the second end 460 of the elongate member 452. Thus, the trimmable tip 474 may be trimmed or otherwise cut to a desired length without exposing or otherwise interfering with the reinforced portion 472 of the elongate member 452.

[0047] Each of the elongate members 452 may carry the mating surface 476 that may be adapted to engage the internal surface 136 of the transitional connector 104. As shown in FIGS. 4A-4D, the mating surface 476 of each of the elongate members 452 may extend longitudinally between the first and the second end 458, 460 of the elongate member 452 and on the outer wall 462 of the elongate member 452. Further, each of the elongate members 452 may include a plurality of the mating surfaces 476. In some embodiments, each of the elongate members 452 may carry the mating surface 476 on a portion of the elongate member 452 at the second end 460 for engaging the internal surface 136 of the transitional connector 104. The mating surface 476 of each of the elongate members 452 may cooperate with one another to provide an outer boundary 480 for the drainage manifold 402 that is compatible with the internal surface 136 of the transitional connector 104. For example, as shown in FIGS. 4C-4D, the outer boundary 480 of the drainage manifold 402 may be circular in shape and may have an outer dimension sized to interferingly engage a complementary circular shape and inner dimension of the internal surface 136 of the transitional connector 104.

[0048] The drainage manifold 402 may carry the sacrificial webs 456 circumferentially about the longitudinal axis 450 of the drainage manifold 402 and between the elongate members 452 to releaseably secure the elongate members 452 to one another when the first end 458 of each of the elongate members 452 is in the gathered

position. For example, as shown in FIGS. 4A-4D, each of the elongate members 452 may have an oblong cross-sectional shape having a width dimension greater than a height dimension. Each of the elongate members 452 may have a pair of opposing sides 492 separated by the width of the elongate member 452. When the first end 458 of each of the elongate members 452 is in the gathered position, each of the sides 492 of one of the elongate members 452 may be adjacent one of the sides 492 of another elongate member 452. The drainage manifold 402 may carry at least one of the sacrificial webs 456 between the adjacent sides 492 of the elongate members 452.

[0049] Each of the sacrificial webs 456 may be severable upon application of a force, such as a pulling force, directed to pull or otherwise separate one of the elongate members 452 away from another of the elongate members 452. For example, the force may be applied on one of the elongate members 452 and directed transverse to the longitudinal axis 450 of the drainage manifold 402. The thickness of the sacrificial web 456 may be sized such that the sacrificial web 456 may sever upon application of a threshold amount of the force, permitting the elongate member 452 to separate from the other elongate members 452. In some embodiments, the threshold amount of the force may be less than an amount of force required to sever other components of the drainage manifold 402. Thus, the application of the threshold force to the elongate member 452 may prevent damage to other components of the drainage manifold 402. In some embodiments, each of the sacrificial webs 456 may, for example, have a score or a perforation (not shown) along the length of the sacrificial web 456 that may be adapted to enhance the separation of the elongate members 452 from one another. For example, the score or perforation may define a predictable or desired path, such as a substantially straight line, for the separation of the elongate members 452 from one another. The threshold force required to sever the sacrificial web 456 along the score or perforation to separate the elongate members 452 from one another may be less than the force required to sever the sacrificial web 456 at another location. The plurality of the sacrificial webs 456 may permit a physician, for example, to configure the drainage manifold 402 to treat a larger surface area, without a cutting instrument or other instrument, by pulling the elongate members 452 away from one another and away from the longitudinal axis 450 of the drainage manifold 402.

[0050] As shown in FIGS. 4A-4D, the outer wall 462 of each of the elongate members 452 may cooperate with one another and with each of the sacrificial webs 456 to define a central lumen 494 in the drainage manifold 402 when the first end 458 of each of the elongate members 452 is in the gathered position. The drainage tube 106 may be in fluid communication with at least the central lumen 494 in the drainage manifold 402. Further, as shown, at least one of the sacrificial webs 456 may coincide with at least one of the longitudinal ducts 464.

[0051] Referring now to the embodiments of FIGS. 5A-5B, the drainage manifold 502 may have a longitudinal axis 550 and may include a plurality of elongate members 552 and an elongate support 554. The elongate support 554 may have a length and an external surface 582 positioned on the longitudinal axis 550 of the drainage manifold 502. Each of the elongate members 552 may have a first end 558, a second end 560, and an outer wall 562. The first end 558 of each of the elongate members 552 may be moveable relative to the elongate support 554. The second end 560 of each of the elongate members 552 may be secured about the external surface 582 of the elongate support 554. The elongate support 554 may be coupled to the internal surface 136 of the transitional connector 104 at the first end 130 of the transitional connector 104 such that the drainage tube 106 may be in fluid communication with at least the outer wall 562 of each of the elongate members 552 and the external surface 582 of the elongate support 554.

[0052] The drainage manifold 502 may include any number of the elongate members 552 to suit a particular application. Further, the elongate members 552 may form an angle (not shown) relative to the elongate support 554, such as, for example, an angle of about 45 degrees measured between the elongate member 552 and the elongate support 554. The angle may reduce the trauma experienced by the patient upon withdrawal of the drainage manifold 502.

[0053] As shown in FIGS. 5A-5B, each of the elongate members 552 may additionally include a longitudinal duct 564, an inner lumen 566, an opening 568, a chamfer 570, a reinforced portion 572, and a trimmable tip 574. The longitudinal duct 564 may be positioned on the outer wall 562 and between the first end 558 and the second end 560 of the elongate member 552. As shown in FIGS. 5A-5B, each of the elongate members 552 may include a plurality of the longitudinal ducts 564 positioned as described above. The drainage tube 106 may be in fluid communication with at least the longitudinal duct 564 of each of the elongate members 552.

[0054] Each of the elongate members 552 may carry the inner lumen 566, for example, internally along the length of the elongate member 552 and between the first and the second end 558, 560 of the elongate member 552. The drainage tube 106 may be in fluid communication with at least the inner lumen 566 in each of the elongate members 552. Each of the elongate members 552 may have the opening 568 disposed through the outer wall 562 of the elongate member 552 to provide fluid communication between the inner lumen 566 of the elongate member 552 and the outer wall 562 of the elongate member 552. In some embodiments, each of the elongate members 552 may have a plurality of the openings 568 disposed through the outer wall 562 of the elongate member 552. Each of the elongate members 552 may have the chamfer 570 positioned on the abutting surface between the opening 568 and the outer wall 562 of the elongate member 552.

[0055] Each of the elongate members 552 may carry the reinforced portion 572 between the first and the second end 558, 560 of the elongate member 552. The reinforced portion 572 may be, for example, a formable titanium wire formed integrally into each of the elongate members 552. Each of the elongate members 552 may carry the trimmable tip 574 at the first end 558 of the elongate member 552. If equipped with the trimmable tip 574, the elongate member 552 may carry the reinforced portion 572 between the trimmable tip 574 and the second end 560 of the elongate member 552. Thus, the trimmable tip 574 may be trimmed or otherwise cut to a desired length without exposing or otherwise interfering with the reinforced portion 572 of the elongate member 552.

[0056] As shown in FIGS. 5A-5B, the elongate support 554 may additionally include a plurality of longitudinal protrusions 584, an inner lumen 586, an opening 588, and a chamfer 589. The elongate support 554 may carry the plurality of longitudinal protrusions 584 on the external surface 582 and along the length of the elongate support 554. The longitudinal protrusions 584 and the external surface 582 cooperate to define at least one longitudinal groove 590. The drainage tube 106 may be in fluid communication with at least the longitudinal groove 590.

[0057] The elongate support 554 may carry the inner lumen 586, for example, internally along the length of the elongate support 554. The drainage tube 106 may be in fluid communication with at least the inner lumen 586 in the elongate support 554 and the outer wall 562 of each of the elongate members 552. The elongate support 554 may have the opening 588 disposed through the external surface 582 of the elongate support 554 to provide fluid communication between the inner lumen 586 of the elongate support 554 and the external surface 582 of the elongate support 554. As shown in FIGS. 5A-5B, the elongate support 554 may have a plurality of the openings 588 positioned along the length of the elongate support 554. Further, the elongate support 554 may have the chamfer 589 positioned on the abutting surface between the opening 588 and the external surface 582 of the elongate support 554.

[0058] Referring generally to the drawings, in some embodiments, insertion of the drainage tube 106 through the incision 120 occurs with the drainage tube 106 beginning at the tissue site 108 and proceeding through the subcutaneous tissue 126, the dermis 124, and subsequently protruding through the epidermis 122. The drainage tube 106 may be draped with an external sealing member (not shown) in any suitable manner to enhance the seal of the drainage tube about the epidermis 122, external to the incision 120. The sealing member may be, for example, an adhesive polyurethane sheet or any material capable of providing a fluid seal suitable to maintain reduced pressure at the tissue site 108. As shown in FIG. 1, the transitional connector 104 may reside between the incision 120 and the tissue site 108, thereby permitting the incision 120 to seal about the drainage tube 106 at the epidermis 122 without requiring the ex-

ternal sealing member described above. In some embodiments, the transitional connector 104 may reside exterior to the incision 120 and the epidermis 122.

[0059] Through the single incision 120, the drainage manifold 102, 202, 302, 402, 502 may be configured to treat a large surface area at the tissue site 108 by hand and without the need for an instrument or tool. Specifically, the elongate members 252, 352, 452 may be separated as described above and positioned, for example, in the cavities 116 and between the tissue layers 118 in and around the tissue site 108. Similarly, the elongate members 552 may be moved about the elongate support 554 and positioned in and around the tissue site 108 in a similar manner as described above.

[0060] The reinforced portion 272, 372, 472, 572 may enhance the ability of the elongate members 252, 352, 452, 552 to retain a desired shape when positioned at the tissue site 108. Forming the reinforced portion 272, 372, 472, 572 into a desired shape may enhance the ability of a physician, for example, to configure the drainage manifold 102, 202, 302, 402, 502 to remain in fluid communication with the cavities 116 and the tissue layers 118 that may be present at the tissue site 108. For example, the tissue site 108 may have a unique size and shape requiring the drainage manifold 102, 202, 302, 402, 502 to be configured and positioned in a particular manner to reduce the possibility for fluids to become trapped at the tissue site 108. Fluids may become trapped at the tissue site 108, for example, in the cavities 116 and between the tissue layers 118 if the drainage manifold 102, 202, 302, 402, 502 does not remain in fluid communication with the cavities 116 and the tissue layers 118. Fluids trapped at the tissue site 108 may increase the chance for seroma or hematoma to occur. To enhance the ability of the elongate members 252, 352, 452, 552 to retain a desired shape and position at the tissue site 108, the physician may optionally utilize, for example, a biodegradable suture material and/or two-dimensional mesh material to secure the elongate members 252, 352, 452, 552 in and around the tissue site 108.

[0061] The trimmable tip 274, 374, 474, 574 may provide a portion of each of the respective elongate members 252, 352, 452, 552 suitable for trimming to a desired size to fit in and around the tissue site 108. Trimming the trimmable tip 274, 374, 474, 574 may not interfere with the reinforced portion 272, 372, 472, 572 or the operation of the drainage manifold 102, 202, 302, 402, 502.

[0062] As described above, the reduced-pressure source 110 may be in fluid communication with the drainage manifold 102, 202, 302, 402, 502. The drainage manifold 102, 202, 302, 402, 502 may be positioned at the tissue site 108 as described above and may be adapted to distribute reduced pressure from the reduced-pressure source 110 to the tissue site 108. Providing reduced pressure from the reduced-pressure source 110 to the drainage manifold 102, 202, 302, 402, 502 and the tissue site 108 may extract fluid from the tissue site 108. Further, distributing the reduced pressure to the tissue site 108

may exert force on the tissue site 108 that, for example, may draw the cavities 116 and the tissue layers 118 together and around the components of the drainage manifold 102, 202, 302, 402, 502. When reduced pressure is applied, the drainage tube 106 may remain in fluid communication with the components of the drainage manifold 102, 202, 302, 402, 502 as previously described. The components of the drainage manifold 102, 202, 302, 402, 502 may provide a separation or a fluid passageway between the drainage manifold 102, 202, 302, 402, 502 and, for example, the tissue layers 118. Thus, the previously described components of the drainage manifold 102, 202, 302, 402, 502 positioned at the tissue site 108 may cooperate with the tissue site 108 to form a network of fluid passageways with the tissue site 108 when the reduced pressure is applied. Fluid extracted from the tissue site 108 may travel in and along the fluid passageways and the previously described components of the drainage manifold 102, 202, 302, 402, 502 to the transitional connector 104 and through the drainage tube 106. The fluid may exit the drainage tube 106 into the fluid canister 112 for storage and disposal.

[0063] At the conclusion of treatment, the drainage manifold 102, 202, 302, 402, 502 may be withdrawn from the tissue site 108 by applying traction or otherwise pulling on the drainage tube 106, thereby withdrawing the transitional connector 104 and the drainage manifold 102, 202, 302, 402, 502 through the incision 120. Upon withdrawal, the drainage manifold 202, 302, 402 may retain a shape substantially similar to the shape of the drainage manifold 202, 302, 402 prior to placement at the tissue site 108. For example, the previously described components of the drainage manifold 202, 302, 402 may, upon withdrawal, retain the previously described configuration about the respective longitudinal axis 250, 350, 450 of the drainage manifold 202, 302, 402. In this manner, the drainage manifold 202, 302, 402 may reduce pain experienced by the patient during withdrawal.

[0064] Although this specification discloses the drainage system 100 in the context of certain illustrative, non-limiting embodiments, various changes, substitutions, permutations, and alterations may be made without departing from the scope of the specification as defined by the appended claims. Further, any feature described in connection with any one embodiment may also be applicable to any other embodiment.

Aspects of the invention are disclosed in the following numbered clauses:

1. A drainage system for draining fluid from a tissue site, comprising:
a drainage manifold having a longitudinal axis, and comprising:
a plurality of elongate members each having a first end, a second end, and an outer wall, the first end of each of the elongate members moveable between a gathered position and a dispersed position relative to the longitudinal axis of the drainage manifold,

wherein when the first end of each of the elongate members is in the gathered position, the elongate members are releaseably secured longitudinally and circumferentially about the longitudinal axis of the drainage manifold, each of the elongate members comprising:

- a longitudinal duct positioned on the outer wall and between the first end and the second end; and
- a reinforced portion positioned between the first end and the second end;
- a transitional connector having a first end and an opposing second end, the first end coupled to the drainage manifold; and
- a drainage tube coupled to the second end of the transitional connector and in fluid communication with the drainage manifold and the longitudinal duct of each of the elongate members.

2. The drainage system of clause 1, further comprising a reduced-pressure source fluidly coupled to the drainage tube and adapted to provide a reduced pressure to the drainage manifold.

3. The drainage system of clause 2, further comprising a fluid canister positioned in fluid communication between the drainage tube and the reduced-pressure source, wherein the fluid canister is adapted to retain fluid communicated from the drainage manifold.

4. The drainage system of clause 1, the drainage manifold further comprising an elongate support having a length and an external surface, the length of the elongate support positioned on the longitudinal axis of the drainage manifold, wherein when the first end of the elongate member is in the gathered position, the elongate member is secured longitudinally and circumferentially about the external surface of the elongate support.

5. The drainage system of clause 4, wherein the elongate support has an inner lumen, and wherein the drainage tube is in fluid communication with the inner lumen of the elongate support.

6. The drainage system of clause 5, wherein the elongate support has an opening disposed through the external surface of the elongate support to provide fluid communication between the inner lumen of the elongate support and the external surface of the elongate support.

7. The drainage system of clause 4, wherein the external surface of the elongate support has a plurality of longitudinal protrusions positioned along the length of the elongate support, the longitudinal protrusions and the external surface cooperating to define a longitudinal groove, wherein the drainage tube is in fluid communication with the longitudinal groove.

8. The drainage system of clause 4, the drainage

manifold further comprising a plurality of sacrificial webs, at least one of the sacrificial webs positioned between the elongate member and the elongate support to releaseably secure the elongate member about the elongate support when the first end of the elongate member is in the gathered position. 5

9. The drainage system of clause 1, wherein each of the elongate members further comprise an inner lumen, and wherein the drainage tube is in fluid communication with the inner lumen of each of the elongate members. 10

10. The drainage system of clause 9, wherein each of the elongate members further comprise an opening disposed through the outer wall of the elongate member to provide fluid communication between the inner lumen of the elongate member and the outer wall of the elongate member. 15

11. The drainage system of clause 10, wherein each of the elongate members further comprise a chamfer positioned on an abutting surface between the opening and the outer wall of the elongate member. 20

12. The drainage system of clause 10, wherein the opening is a longitudinal channel positioned between the first end and the second end of the elongate member. 25

13. The drainage system of clause 1, wherein each of the elongate members has an oblong cross-sectional shape. 30

14. The drainage system of clause 1, the drainage manifold further comprising a plurality of sacrificial webs positioned circumferentially about the longitudinal axis of the drainage manifold and releaseably secured between the elongate members when the first end of each of the elongate members is in the gathered position. 35

15. The drainage system of clause 14, wherein the outer wall of each of the elongate members cooperate with one another and with each of the sacrificial webs to define a central lumen in the drainage manifold when the first end of each of the elongate members is in the gathered position, and wherein the drainage tube is in fluid communication with the central lumen. 40

16. The drainage system of clause 9, wherein each of the elongate members further comprise a plurality of openings disposed through the outer wall of the elongate member to provide fluid elongate member, the plurality of openings positioned sequentially between the first end and the second end of the elongate member. 45

17. The drainage system of clause 1, wherein each of the elongate members further comprise a trimmable tip positioned at the first end of the elongate member, and wherein the reinforced portion of the elongate member extends from the trimmable tip to the second end of the elongate member. 50

18. The drainage system of clause 1, wherein the second end of each of the elongate members are 55

coupled to an internal surface of the transitional connector at the first end of the transitional connector.

19. The drainage system of clause 18, wherein each of the elongate members further comprise a mating surface positioned on the outer wall of the elongate member and adapted to engage the internal surface of the transitional connector.

20. The drainage system of clause 19, wherein the mating surface of each of the elongate members cooperate with one another to provide an outer boundary for the drainage manifold that is compatible with the internal surface of the transitional connector.

21. The drainage system of clause 18, wherein the internal surface of the transitional connector has a substantially circular cross-section.

22. The drainage system of clause 19, wherein the mating surface of each of the elongate members extends longitudinally between the first end and the second end of the elongate member.

23. A drainage system for draining fluid from a tissue site, comprising:
a drainage manifold having a longitudinal axis, and comprising:
25 an elongate support having a length and an external surface, the length of the elongate support positioned on the longitudinal axis of the drainage manifold;
a plurality of elongate members each having a first end, a second end, and an outer wall, the first end of each of the elongate members moveable between a gathered position and a dispersed position relative to the longitudinal axis of the drainage manifold, wherein when the first end of the elongate member is in the gathered position, the elongate member is releaseably secured longitudinally and circumferentially about the external surface of the elongate support, each of the elongate members further comprising a longitudinal duct positioned on the outer wall and between the first end and the second end of the elongate member; and
a plurality of sacrificial webs, at least one of the sacrificial webs positioned between the elongate member and the elongate support to releaseably secure the elongate member about the elongate support when the first end of the elongate member is in the gathered position;
a transitional connector having a first end and an opposing second end, the first end coupled to the drainage manifold; and
a drainage tube coupled to the second end of the transitional connector and in fluid communication with the drainage manifold and the longitudinal duct of each of the elongate members. 40

24. The drainage system of clause 23, further comprising a reduced-pressure source fluidly coupled to 45

the drainage tube and adapted to provide a reduced pressure to the drainage manifold.

25. The drainage system of clause 24, further comprising a fluid canister positioned in fluid communication between the drainage tube and the reduced-pressure source, wherein the fluid canister is adapted to retain fluid communicated from the drainage manifold.

26. The drainage system of clause 23, wherein the elongate support has an inner lumen and an opening disposed through the external surface of the elongate support to provide fluid communication between the inner lumen of the elongate support and the external surface of the elongate support, and wherein the drainage tube is in fluid communication with the inner lumen in the elongate support.

27. The drainage system of clause 23, wherein the external surface of the elongate support has a plurality of longitudinal protrusions positioned along the length of the elongate support, the longitudinal protrusions and the external surface cooperating to define a longitudinal groove, wherein the drainage tube is in fluid communication with the longitudinal groove.

28. The drainage system of clause 23, each of the elongate members further comprising an inner lumen and an opening disposed through the outer wall of the elongate member to provide fluid communication between the inner lumen of the elongate member and the outer wall of the elongate member, wherein the drainage tube is in fluid communication with the inner lumen of each of the elongate members.

29. The drainage system of clause 28, wherein the opening is a longitudinal channel positioned between the first end and the second end of the elongate member.

30. The drainage system of clause 23, each of the elongate members further comprising a reinforced portion positioned between the first end and the second end of the elongate member.

31. The drainage system of clause 23, wherein the second end of each of the elongate members are coupled to an internal surface of the transitional connector at the first end of the transitional connector.

32. The drainage system of clause 31, wherein each of the elongate members further comprise a mating surface positioned on the outer wall of the elongate member and adapted to engage the internal surface of the transitional connector.

33. The drainage system of clause 32, wherein the mating surface of each of the elongate members cooperate with one another to provide an outer boundary for the drainage manifold that is compatible with the internal surface of the transitional connector.

34. The drainage system of clause 32, wherein the mating surface of each of the elongate members extends longitudinally between the first end and the

second end of the elongate member.

35. A drainage manifold for draining fluid from a tissue site, the drainage manifold having a longitudinal axis, and comprising:

an elongate support having a length, an external surface, and an inner lumen, the length of the elongate support positioned on the longitudinal axis of the drainage manifold;

a plurality of elongate members each having a first end, a second end, and an outer wall, the first end of each of the elongate members moveable between a gathered position and a dispersed position relative to the longitudinal axis of the drainage manifold, wherein when the first end of the elongate member is in the gathered position, the elongate member is releaseably secured longitudinally and circumferentially about the external surface of the elongate support, each of the elongate members comprising:

a longitudinal duct positioned on the outer wall and between the first end and the second end;

an inner lumen; and

an opening disposed through the outer wall, the opening providing fluid communication between the inner lumen and the outer wall;

a plurality of sacrificial webs, at least one of the sacrificial webs positioned between the elongate member and the elongate support to releaseably secure the elongate member about the elongate support when the first end of the elongate member is in the gathered position.

36. The drainage manifold of clause 35, each of the elongate members further comprising a reinforced portion positioned between the first end and the second end of the elongate member.

37. The drainage manifold of clause 35, wherein the elongate support has an opening disposed through the external surface of the elongate support to provide fluid communication between the inner lumen of the elongate support and the external surface of the elongate support.

38. The drainage manifold of clause 35, wherein the external surface of the elongate support has a plurality of longitudinal protrusions positioned along the length of the elongate support, the longitudinal protrusions and the external surface cooperating to define a longitudinal groove.

39. The drainage manifold of clause 35, wherein the opening disposed through the outer wall of the elongate member is a longitudinal channel positioned between the first end and the second end of the elongate member.

40. The drainage manifold of clause 35, wherein

5

10

15

20

25

30

35

40

45

50

55

each of the elongate members further comprise a mating surface positioned on the outer wall of the elongate member and extending longitudinally between the first end and the second end of the elongate member, wherein the mating surface of each of the elongate members cooperate with one another to define an outer boundary of the drainage manifold.

41. The drainage manifold of clause 40, wherein the outer boundary of the drainage manifold is circular in shape.

42. A drainage system for draining fluid from a tissue site, comprising:
a drainage manifold, comprising:

an elongate support having a length, an external surface, an inner lumen, and a plurality of openings disposed through the external surface to provide fluid communication between the external surface and the inner lumen; and
a plurality of elongate members each having a first end, a second end, and an outer wall, the first end of each of the elongate members moveable relative to the elongate support and the second end of each of the elongate members secured about the external surface of the elongate support, wherein the outer wall of each of the elongate members is in fluid communication with the inner lumen in the elongate support;
a reduced-pressure source fluidly coupled to the elongate support and adapted to provide a reduced pressure to the drainage manifold and the inner lumen in the elongate support; and
a fluid canister positioned in fluid communication between the elongate support and the reduced-pressure source, wherein the fluid canister is adapted to retain fluid communicated from the drainage manifold.

43. The drainage system of clause 42, wherein each of the elongate members comprise a longitudinal duct positioned on the outer wall and between the first end and the second end.

44. The drainage system of clause 42, wherein each of the elongate members comprise an inner lumen and a plurality of openings disposed through the outer wall of the elongate member, the plurality of openings providing fluid communication between the inner lumen and the outer wall.

45. The drainage system of clause 42, wherein the elongate support comprises a longitudinal duct positioned along the length and on the external surface of the elongate support.

Claims

1. A drainage system for draining fluid from a tissue site (108), the drainage system comprising:

a drainage manifold (202, 302, 402) comprising a longitudinal axis;
an elongate support having a length and an external surface;
a plurality of elongate members (252, 352, 452) each having a first end, a second end, and an outer wall, each elongate member (252, 352, 452) comprising an inner lumen and an opening disposed through the outer wall and configured to provide fluid communication between the inner lumen of the elongate member (252, 352, 452) and the outer wall, the first end of each of the elongate members (252, 352, 452) being moveable between a gathered position and a dispersed position relative to the longitudinal axis of the drainage manifold (202, 302, 402) and the elongate member (252, 352, 452) being releasably secured longitudinally and circumferentially about the external surface of the elongate support;
a transitional connector (104) having a first end, coupled to the drainage manifold (202, 302, 402), and an opposing second end; and
a drainage tube (106) coupled to the second end of the transitional connector and in fluid communication with the drainage manifold (202, 302, 402) and the longitudinal duct of each of the elongate members (252, 352, 452).

2. The drainage system of Claim 1, wherein the drainage manifold (202, 302, 402) comprises a plurality of sacrificial webs (256, 356, 456), at least one sacrificial web (256, 356, 456) being positioned between the elongate member (252, 352, 452) and the elongate support to releasably secure the elongate member (252, 352, 452) about the elongate support when the first end of the elongate member (252, 352, 452) is in the gathered position, and optionally wherein each of the elongate members (252, 352, 452) comprise an oblong cross-sectional shape.

3. The drainage system of Claim 1, wherein the outer wall of each of the elongate members (252, 352, 452) is configured to cooperate with one another and with each of the sacrificial webs (256, 356, 456) to define a central lumen in the drainage manifold (202, 302, 402) when the first end of each of the elongate members (252, 352, 452) is in the gathered position, wherein the drainage tube (106) is configured to be in fluid communication with at least the central lumen in the drainage manifold (202, 302, 402).

4. The drainage system of Claim 1, wherein drainage system comprises a reduced-pressure source (110) adapted to provide reduced pressure to the drainage system, and optionally wherein the reduced-pressure source (110) is configured to be fluidly coupled to the drainage tube (106).

- 5. The drainage system of Claim 4, further comprising a fluid canister (112) adapted to retain fluid extracted from the tissue site (108), the fluid canister (112) being fluidly coupled between the drainage tube (106) and the reduced-pressure source (110). 5
- 6. The drainage system of Claim 1, wherein the elongate support comprises an inner lumen and wherein the drainage tube (106) is configured to be in fluid communication with at least the external surface of the elongate support. 10
- 7. The drainage system of Claim 1, wherein the elongate support comprises an opening disposed through the external surface of the elongate support to provide fluid communication between the inner lumen of the elongate support and the external surface of the elongate support, and optionally wherein the elongate support further comprises a plurality of longitudinal protrusions along the length of the elongate support, the longitudinal protrusions and the external surface cooperating to define at least one longitudinal groove, wherein the drainage tube (106) is in fluid communication with at least the longitudinal groove. 15
- 8. The drainage system of Claim 1, wherein the drainage tube (106) is configured to be in fluid communication with at least the inner lumen in each of the elongate members (252, 352, 452), and wherein each opening comprises a longitudinal channel positioned between the first end and the second end (258, 260) of the elongate member (252, 352, 452). 20
- 9. The drainage system of Claim 1, wherein each of the elongate members (252, 352, 452) comprises a plurality of openings (468) disposed through the outer wall of the elongate member (252, 352, 452), the plurality of openings providing fluid communication between the inner lumen of the elongate member (252, 352, 452) and the outer wall of the elongate member (252, 352, 452) and the plurality of the openings being positioned sequentially between the first and the second end of each of the elongate members (252, 352, 452). 25
- 10. The drainage system of Claim 1, wherein each of the elongate members (252, 352, 452) comprises a reinforced portion between the first and the second end of the elongate member (252, 352, 452), and optionally wherein each of the elongate members (252, 352, 452) comprises a trimmable tip positioned at the first end of the elongate member (252, 352, 452), and wherein the elongate member (252, 352, 452) is configured to extend the reinforced portion between the trimmable tip and the second end of the elongate member (252, 352, 452). 30

- 11. The drainage system of Claim 1, wherein the second end of each of the elongate members (252, 352, 452) is configured to be coupled to the internal surface of the transitional connector (104) and at the first end of the transitional connector (104), and optionally wherein each of the elongate members (252, 352, 452) comprise a mating surface adapted to engage the internal surface of the transitional connector (104). 35
- 12. The drainage system of Claim 11, wherein the mating surfaces of each of the elongate members (252, 352, 452) are configured to cooperate with one another to provide an outer boundary for the drainage manifold (202, 302, 402) that are compatible with the internal surface of the transitional connector (104). 40
- 13. The drainage system of Claim 11, wherein the mating surface of each of the elongate members (252, 352, 452) are configured to extend longitudinally between the first and the second end (258, 260) of the elongate member (252, 352, 452) and on the outer wall of the elongate member (252, 352, 452). 45
- 14. The drainage system of claim 1, wherein the external surface and the internal surface of the transitional connector (104) are configured to have a substantially circular cross-section. 50
- 15. The drainage system of claim 1, wherein each of the elongate members (252, 352, 452) comprises a longitudinal duct positioned on the outer wall and between the first end and the second end of the elongate member (252, 352, 452). 55

1/12

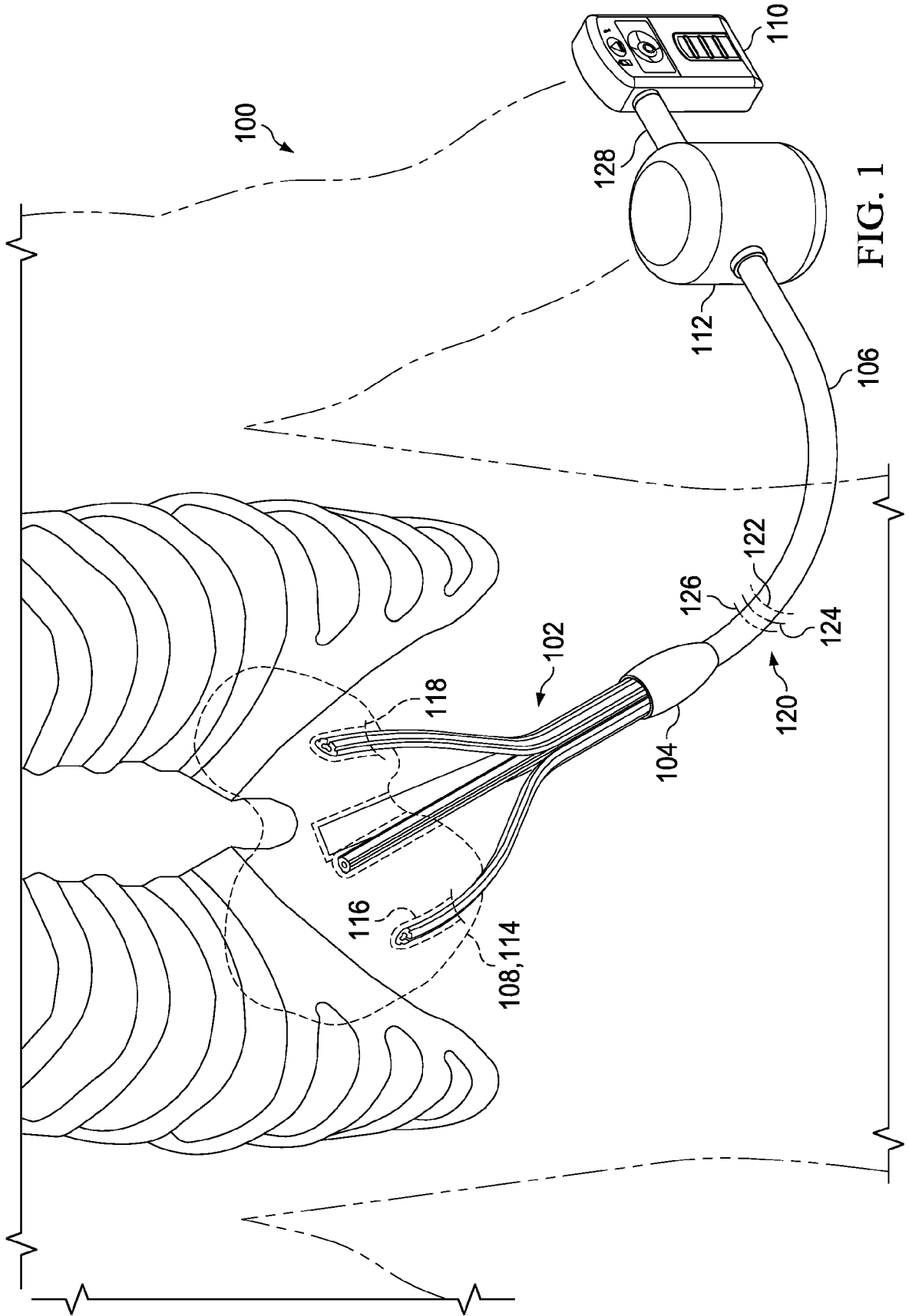

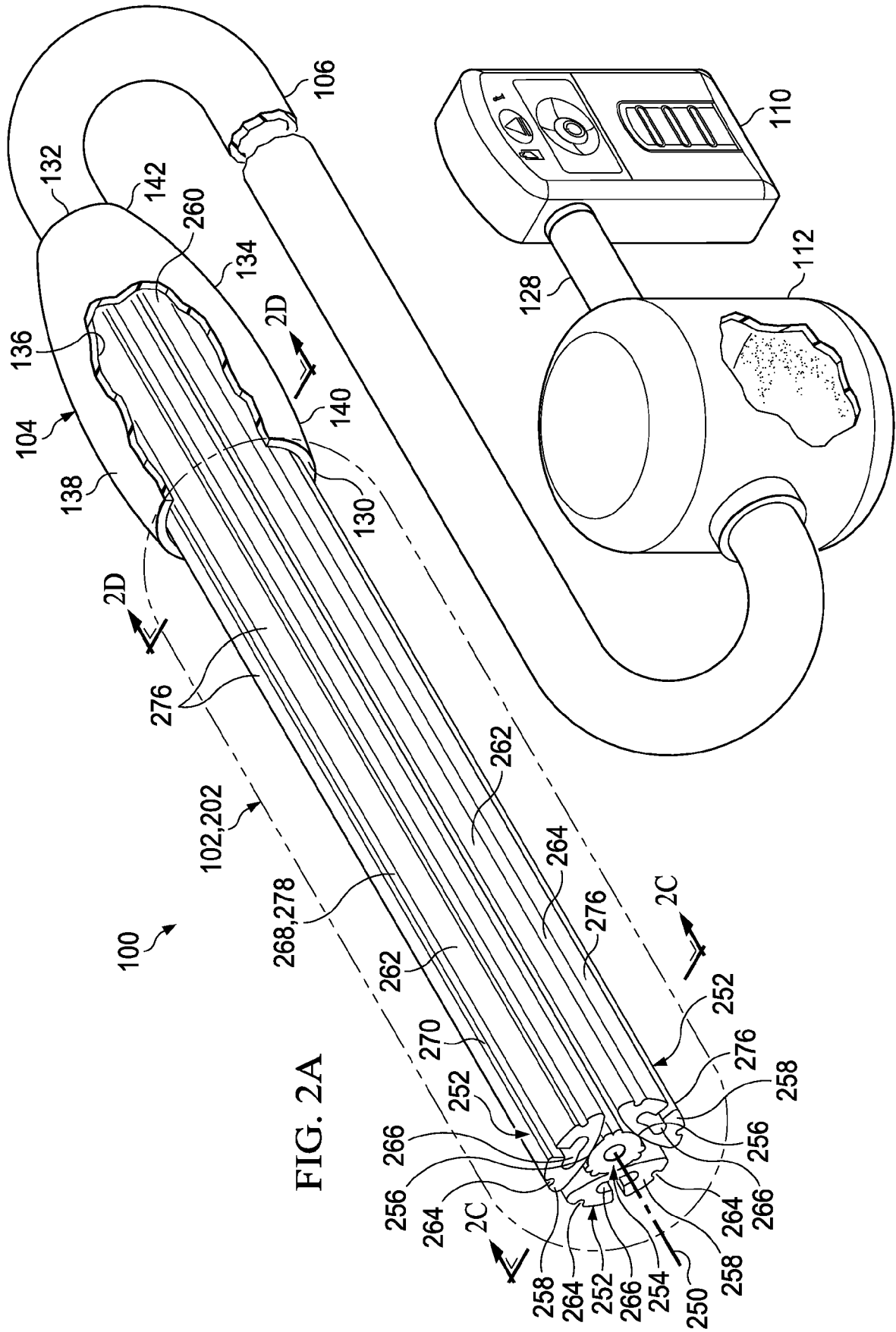

FIG. 2A

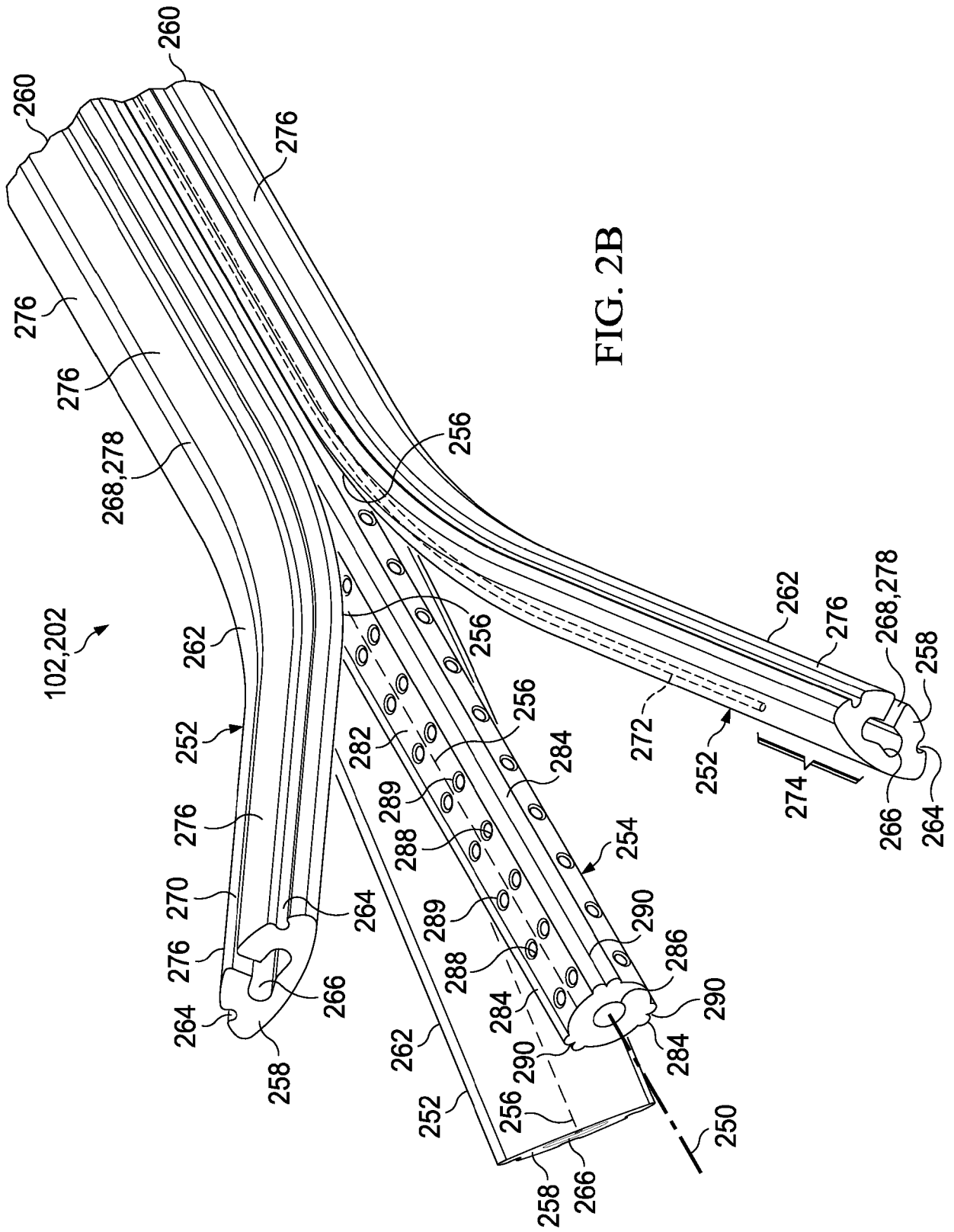

FIG. 2C

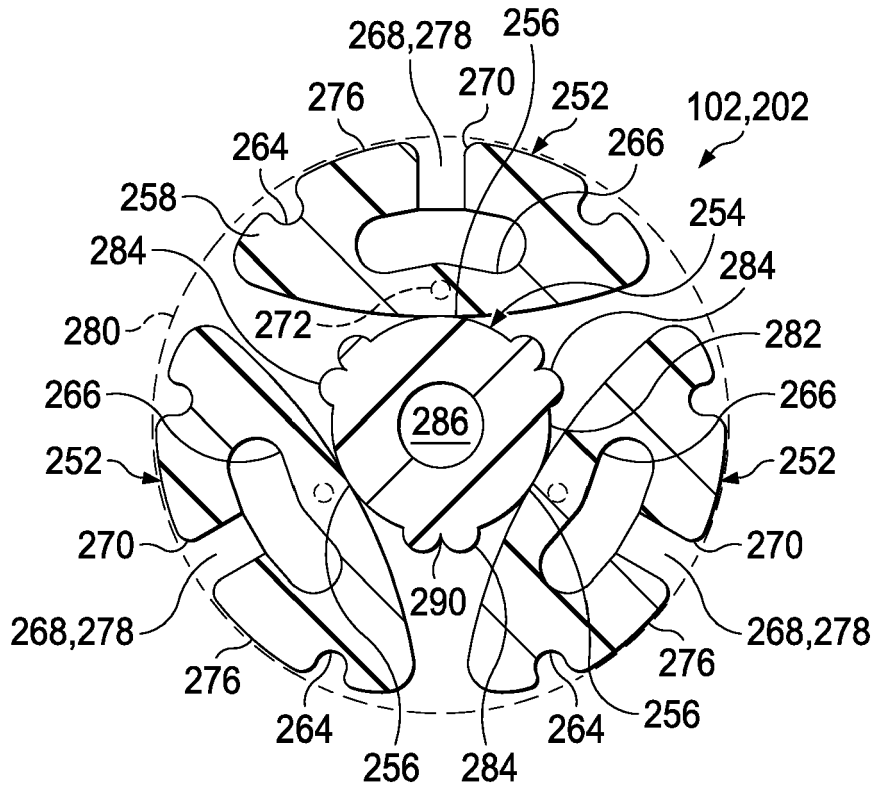
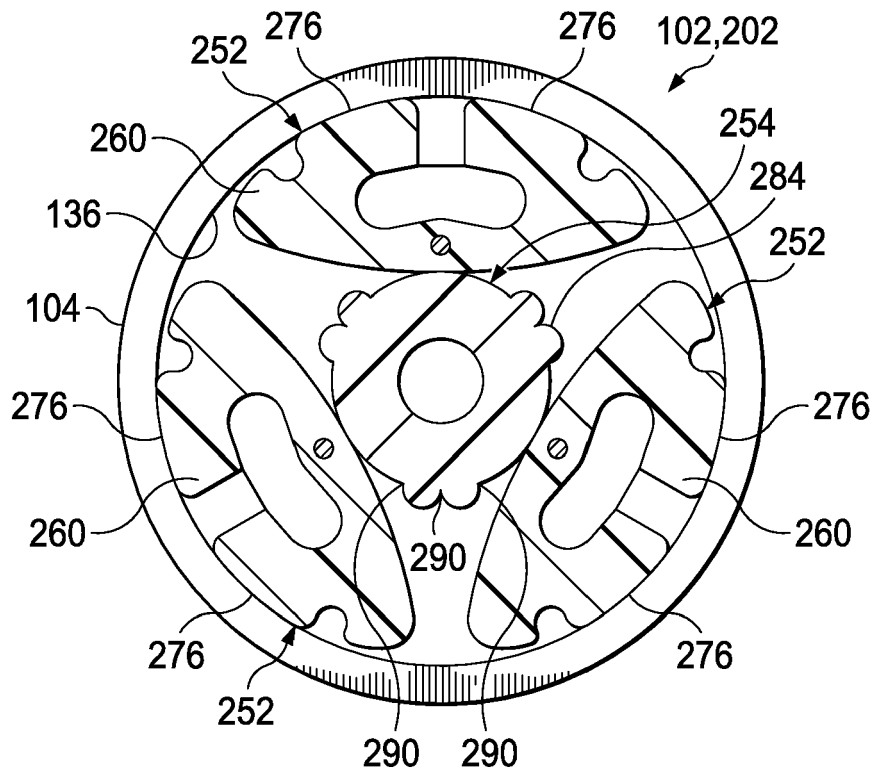
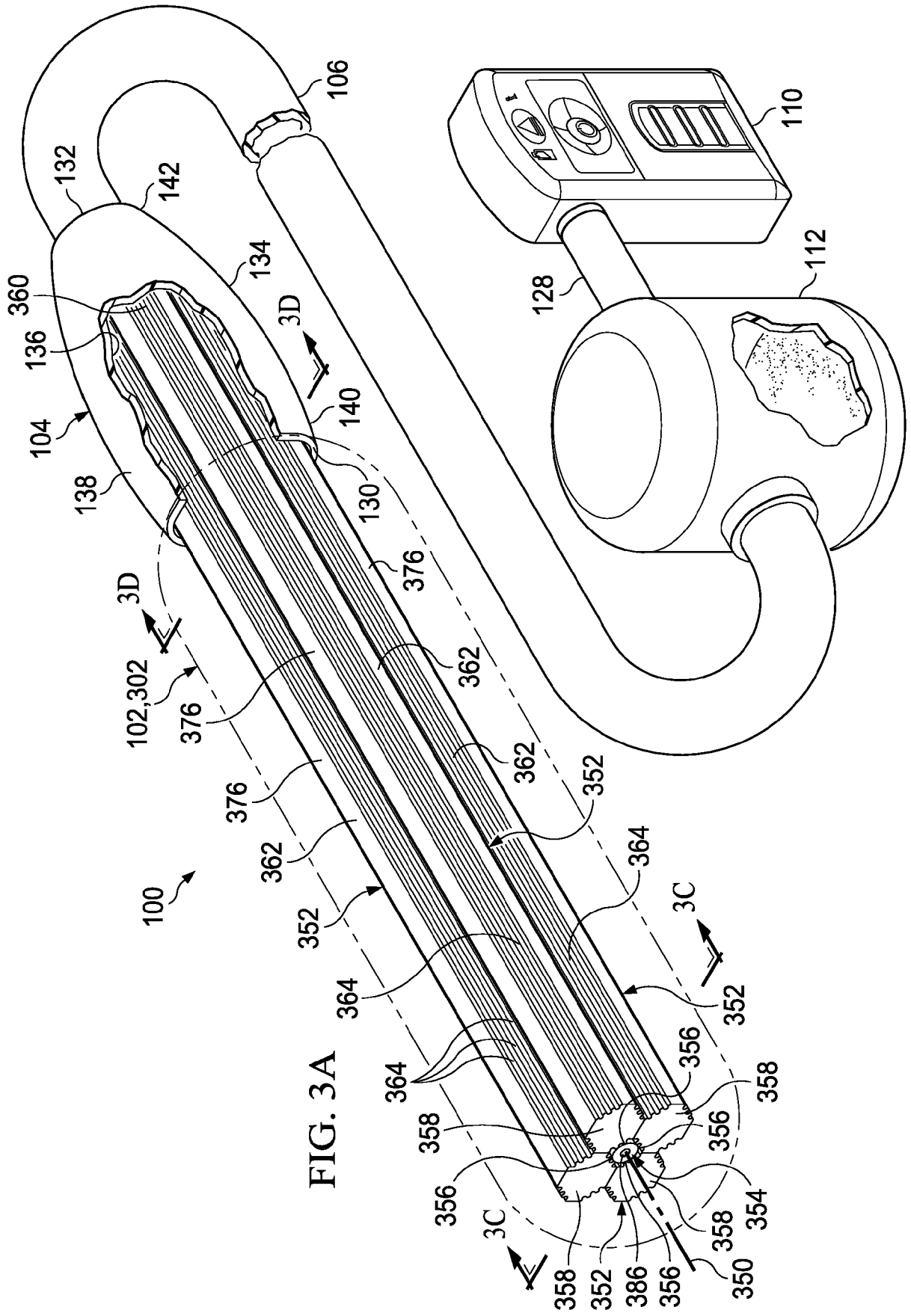

FIG. 2D





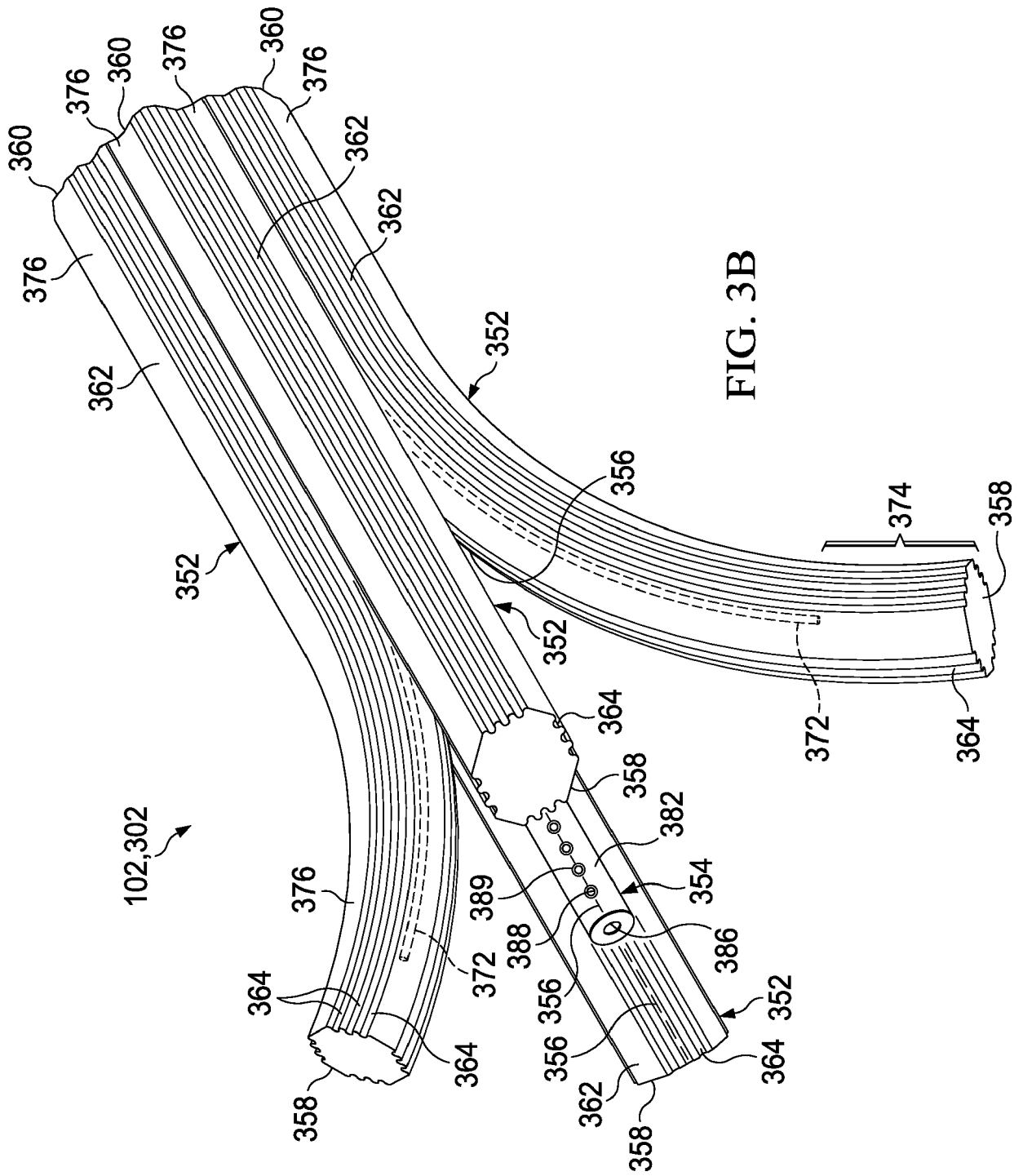

FIG. 3B

FIG. 3C

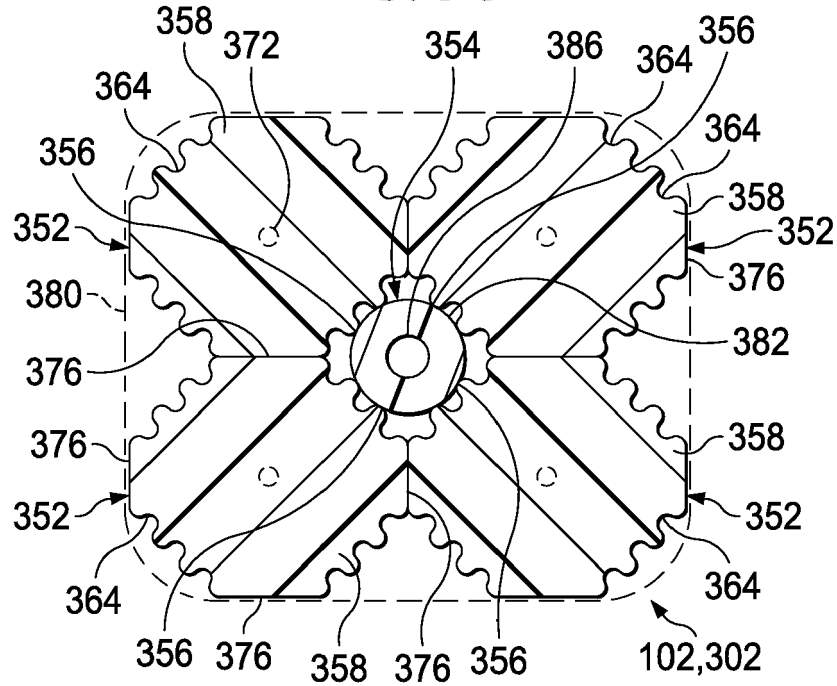
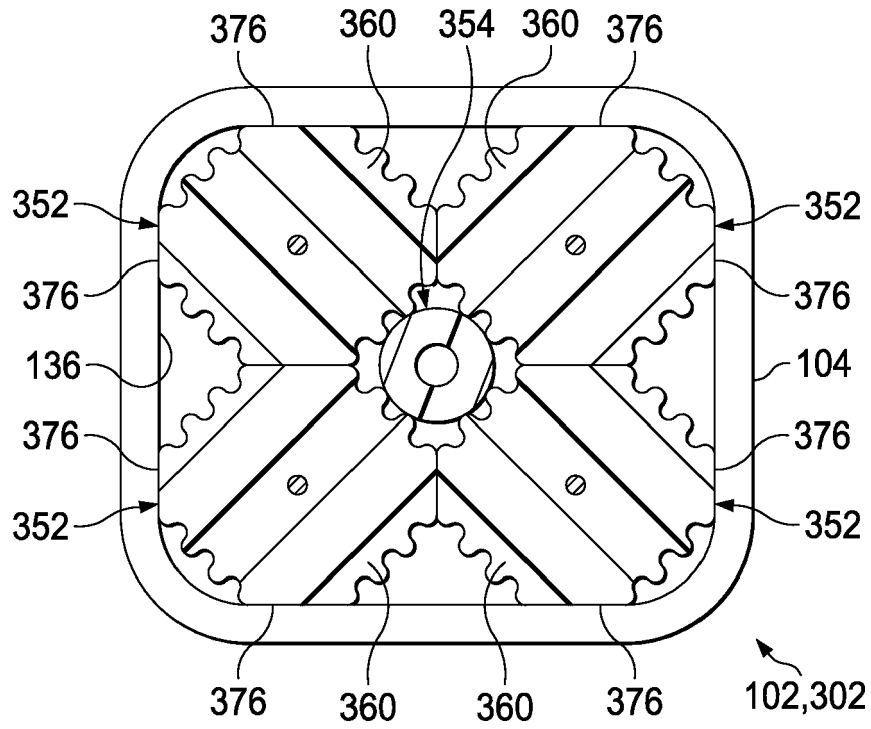
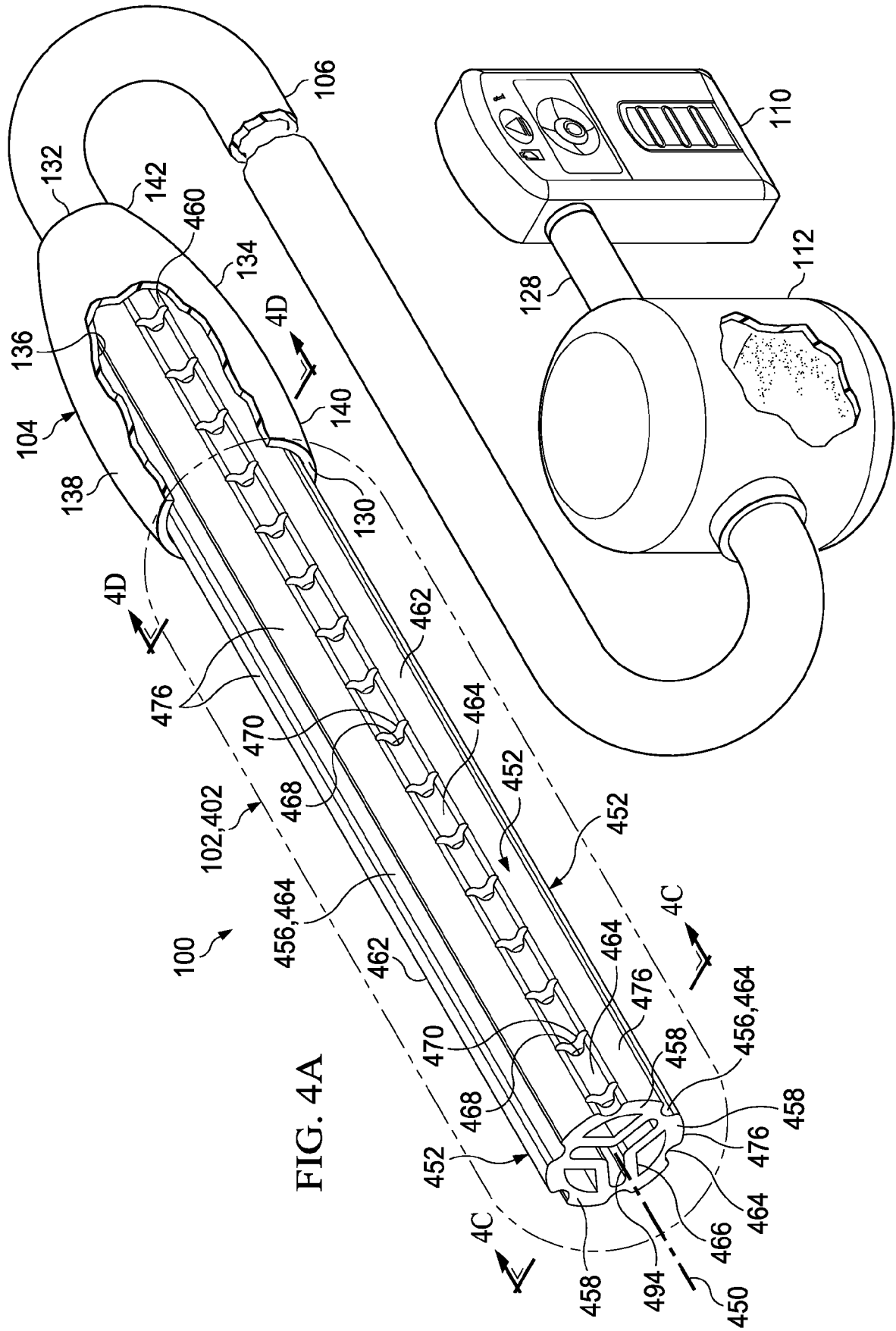

FIG. 3D





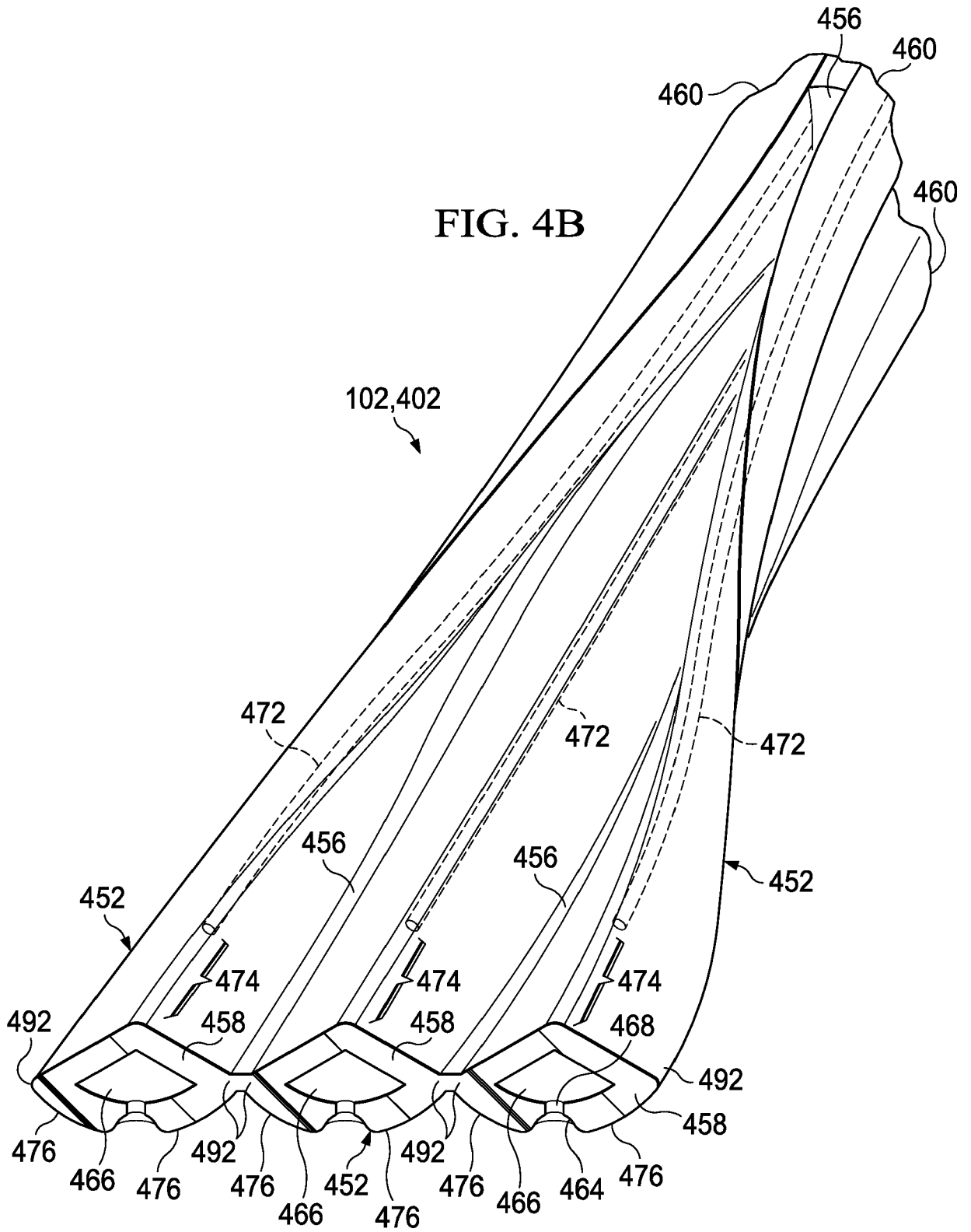

FIG. 4C

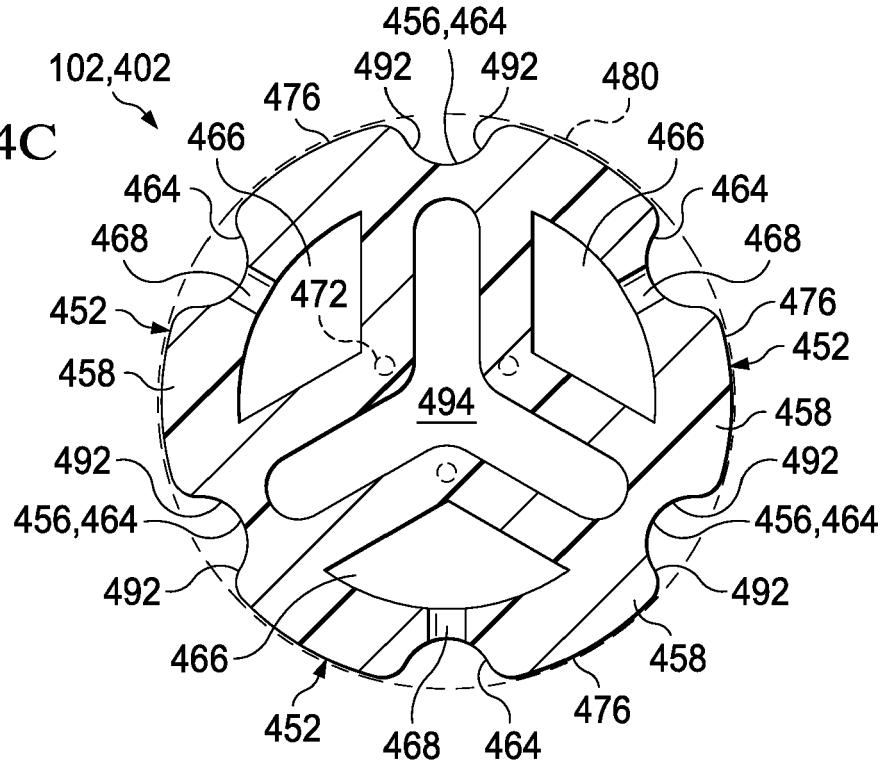
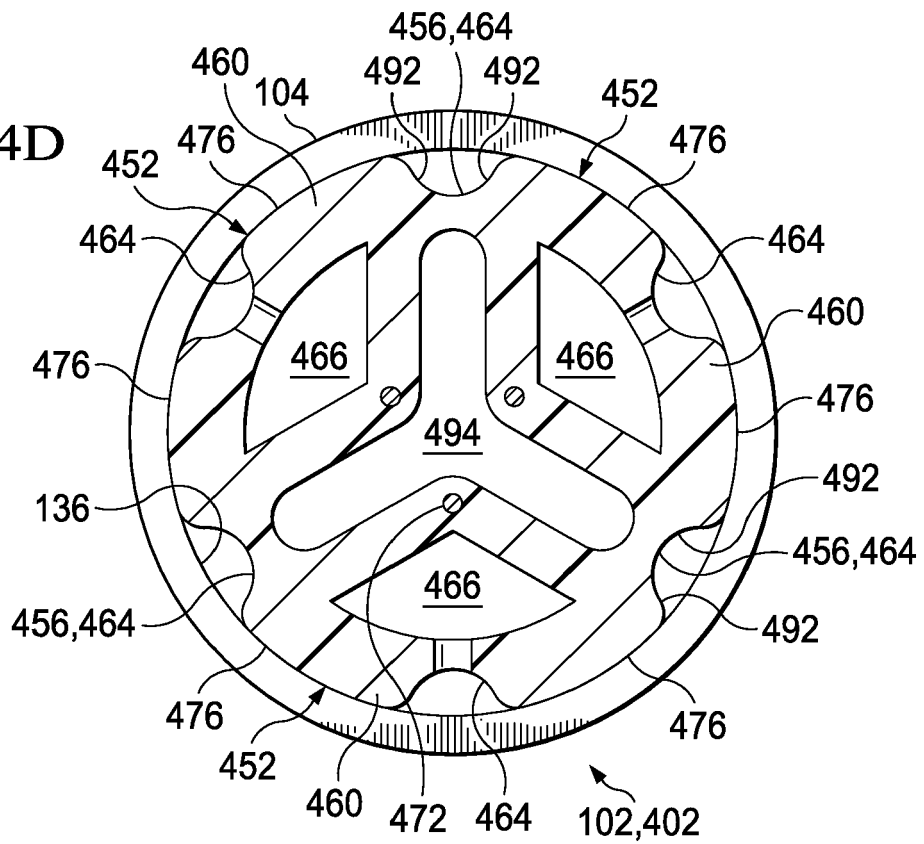

FIG. 4D



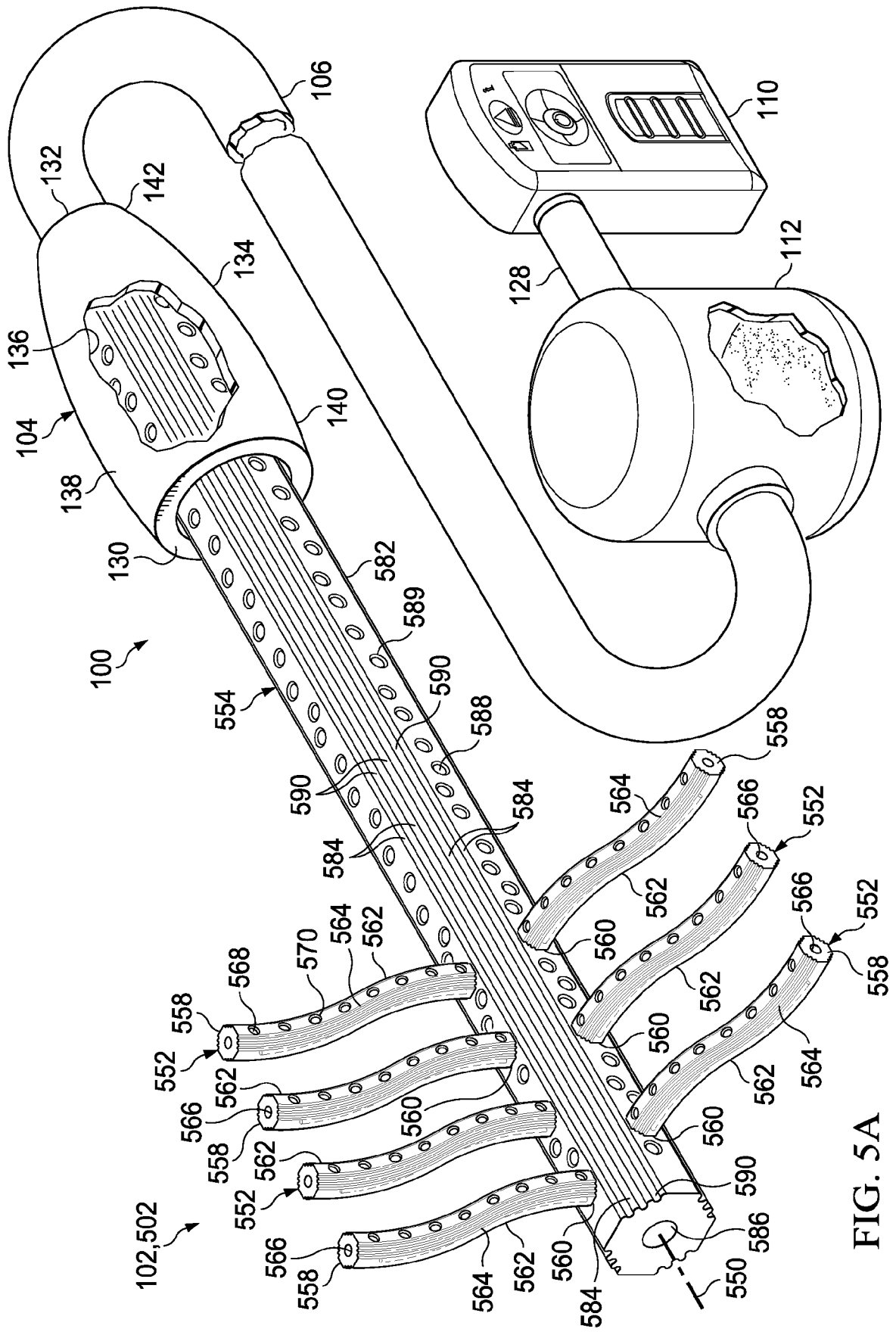

FIG. 5A

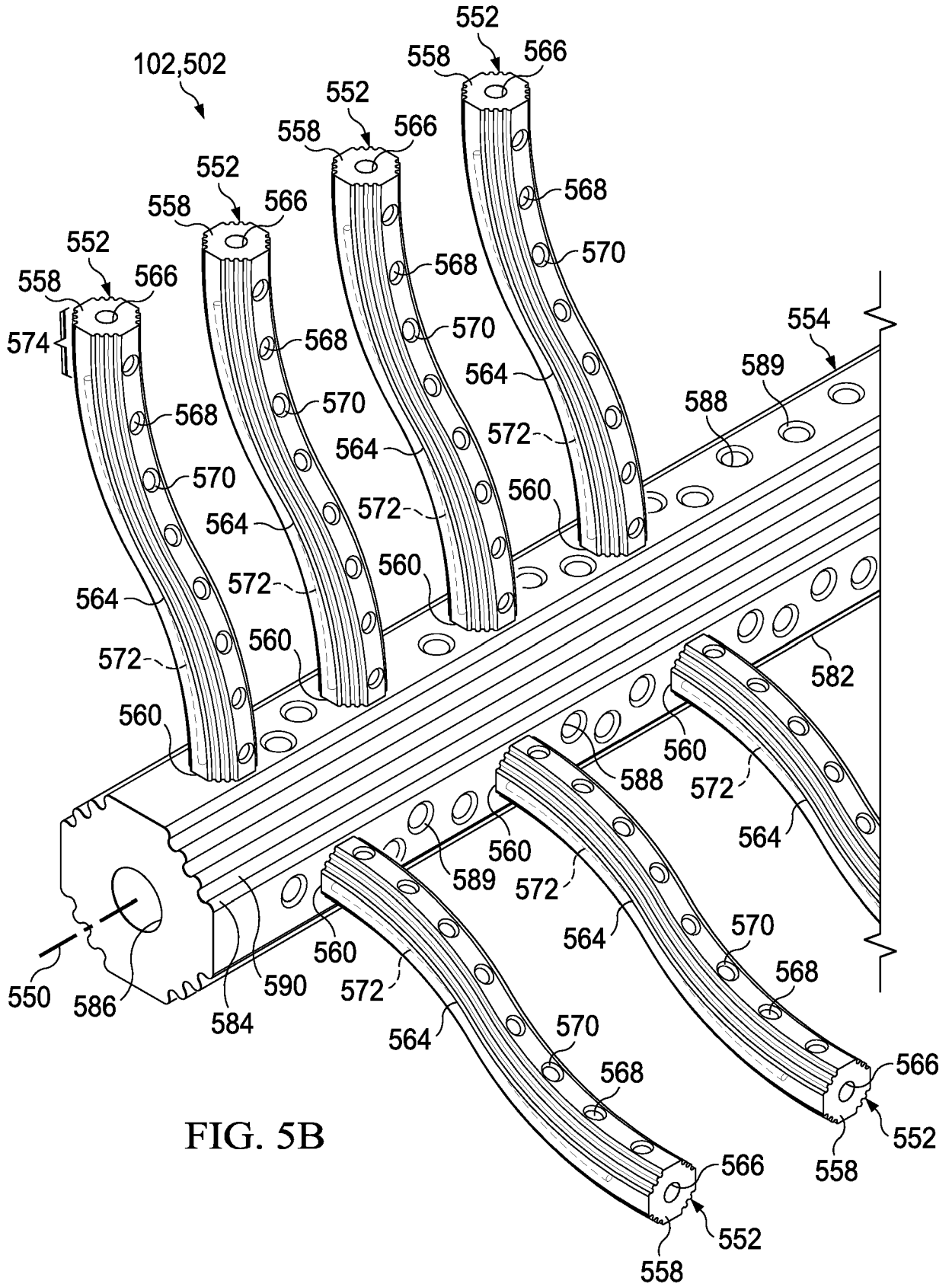

FIG. 5B



EUROPEAN SEARCH REPORT

Application Number
EP 18 18 3722

5

10

15

20

25

30

35

40

45

50

55

DOCUMENTS CONSIDERED TO BE RELEVANT				
Category	Citation of document with indication, where appropriate, of relevant passages	Relevant to claim	CLASSIFICATION OF THE APPLICATION (IPC)	
X	US 2011/054283 A1 (SHULER MICHAEL SIMMS [US]) 3 March 2011 (2011-03-03) * paragraphs [0298] - [0311]; figures 23, 24a-24e, 25a-b,26 *	1-15	INV. A61M1/00	
X	US 2010/069829 A1 (HUTCHINSON GEORGE [US] ET AL) 18 March 2010 (2010-03-18) * paragraphs [0068] - [0073]; figures 2-3 *	1-15		
X	US 7 790 945 B1 (WATSON JR RICHARD L [US]) 7 September 2010 (2010-09-07) * column 4, line 53- - column 5, line 21; figures 10,12 *	1-15		
A	US 7 658 735 B2 (SPEHALSKI STEPHAN R [US]) 9 February 2010 (2010-02-09) * paragraphs [0037] - [0039]; figures 1,4 *	1-15		
A	US 5 116 310 A (SEDER EDMUND V [US] ET AL) 26 May 1992 (1992-05-26) * the whole document *	1-15		TECHNICAL FIELDS SEARCHED (IPC)
A	US 2004/006331 A1 (SHCHERVINSKY SEMYON [US]) 8 January 2004 (2004-01-08) * paragraphs [0054] - [0055]; figure 2 *	1-15		A61M A61F
A	US 6 099 513 A (SPEHALSKI STEPHEN R [US]) 8 August 2000 (2000-08-08) * figure 2 *	1-15		
The present search report has been drawn up for all claims				
Place of search The Hague		Date of completion of the search 5 March 2019	Examiner Westsson, David	
CATEGORY OF CITED DOCUMENTS X : particularly relevant if taken alone Y : particularly relevant if combined with another document of the same category A : technological background O : non-written disclosure P : intermediate document T : theory or principle underlying the invention E : earlier patent document, but published on, or after the filing date D : document cited in the application L : document cited for other reasons & : member of the same patent family, corresponding document				

EPO FORM 1503 03.02 (P04C01)

ANNEX TO THE EUROPEAN SEARCH REPORT
ON EUROPEAN PATENT APPLICATION NO.

EP 18 18 3722

5 This annex lists the patent family members relating to the patent documents cited in the above-mentioned European search report.
The members are as contained in the European Patent Office EDP file on
The European Patent Office is in no way liable for these particulars which are merely given for the purpose of information.

05-03-2019

Patent document cited in search report	Publication date	Patent family member(s)	Publication date
US 2011054283 A1	03-03-2011	CA 2769671 A1	14-04-2011
		EP 2464412 A2	20-06-2012
		US 2011054283 A1	03-03-2011
		US 2014018752 A1	16-01-2014
		WO 2011043863 A2	14-04-2011

US 2010069829 A1	18-03-2010	AU 2009293592 A1	25-03-2010
		AU 2009293593 A1	25-03-2010
		BR PI0913550 A2	21-06-2016
		CA 2734961 A1	25-03-2010
		CA 2735103 A1	25-03-2010
		CN 102137688 A	27-07-2011
		CN 102143772 A	03-08-2011
		CN 104248780 A	31-12-2014
		CN 107865985 A	03-04-2018
		EP 2323711 A1	25-05-2011
		EP 2323712 A1	25-05-2011
		EP 2740501 A2	11-06-2014
		HK 1154816 A1	11-09-2015
		JP 5318957 B2	16-10-2013
		JP 5337248 B2	06-11-2013
		JP 2012502731 A	02-02-2012
		JP 2012502732 A	02-02-2012
		KR 20110058872 A	01-06-2011
		KR 20110058885 A	01-06-2011
		RU 2011107112 A	27-10-2012
		RU 2011107119 A	27-10-2012
		TW 201012494 A	01-04-2010
		TW 201019976 A	01-06-2010
US 2010069829 A1	18-03-2010		
US 2010069885 A1	18-03-2010		
US 2012259274 A1	11-10-2012		
US 2012283674 A1	08-11-2012		
US 2015105718 A1	16-04-2015		
US 2016193395 A1	07-07-2016		
US 2019054219 A1	21-02-2019		
WO 2010033271 A1	25-03-2010		
WO 2010033272 A1	25-03-2010		

US 7790945 B1	07-09-2010	US 7790945 B1	07-09-2010
		US 2010286635 A1	11-11-2010

US 7658735 B2	09-02-2010	US 2004249360 A1	09-12-2004
		US 2010198171 A1	05-08-2010
		US 2013345680 A1	26-12-2013

EPO FORM P0459

For more details about this annex : see Official Journal of the European Patent Office, No. 12/82

55

**ANNEX TO THE EUROPEAN SEARCH REPORT
ON EUROPEAN PATENT APPLICATION NO.**

EP 18 18 3722

5 This annex lists the patent family members relating to the patent documents cited in the above-mentioned European search report.
The members are as contained in the European Patent Office EDP file on
The European Patent Office is in no way liable for these particulars which are merely given for the purpose of information.

05-03-2019

10

Patent document cited in search report	Publication date	Patent family member(s)	Publication date
US 5116310	A	26-05-1992	NONE
US 2004006331	A1	08-01-2004	NONE
US 6099513	A	08-08-2000	NONE

15

20

25

30

35

40

45

50

EPO FORM P0459

55

For more details about this annex : see Official Journal of the European Patent Office, No. 12/82

REFERENCES CITED IN THE DESCRIPTION

This list of references cited by the applicant is for the reader's convenience only. It does not form part of the European patent document. Even though great care has been taken in compiling the references, errors or omissions cannot be excluded and the EPO disclaims all liability in this regard.

Patent documents cited in the description

- US 61734295 A [0001]