



(51) International Patent Classification:

A61M 25/01 (2006.01) A61M 5/178 (2006.01)
A61M 5/168 (2006.01) A61M 5/142 (2006.01)

(21) International Application Number:

PCT/US2012/028481

(22) International Filing Date:

9 March 2012 (09.03.2012)

(25) Filing Language:

English

(26) Publication Language:

English

(30) Priority Data:

61/450,895 9 March 2011 (09.03.2011) US

(71) Applicant (for all designated States except US):

H. LEE MOFFITT CANCER CENTER AND RESEARCH INSTITUTE, INC. [US/US]; 12902 Magnolia Drive, Tampa, Florida 33612-9497 (US).

(72) Inventors; and

(75) Inventors/Applicants (for US only): **ZAGER, Jonathan** [US/US]; 16359 Ashington Park Drive, Tampa, Florida

33647 (US). **STEWART, Stephen** [US/US]; 1203 Harmony Heights, Harmony, Pennsylvania 16037 (US).

(74) Agents: **HALL, Miles E.** et al.; McKeon, Meunier, Carlin & Curfman, LLC, Suite 500, 817 W. Peachtree Street NW, Atlanta, Georgia 30308 (US).

(81) Designated States (unless otherwise indicated, for every kind of national protection available): AE, AG, AL, AM, AO, AT, AU, AZ, BA, BB, BG, BH, BR, BW, BY, BZ, CA, CH, CL, CN, CO, CR, CU, CZ, DE, DK, DM, DO, DZ, EC, EE, EG, ES, FI, GB, GD, GE, GH, GM, GT, HN, HR, HU, ID, IL, IN, IS, JP, KE, KG, KM, KN, KP, KR, KZ, LA, LC, LK, LR, LS, LT, LU, LY, MA, MD, ME, MG, MK, MN, MW, MX, MY, MZ, NA, NG, NI, NO, NZ, OM, PE, PG, PH, PL, PT, QA, RO, RS, RU, RW, SC, SD, SE, SG, SK, SL, SM, ST, SV, SY, TH, TJ, TM, TN, TR, TT, TZ, UA, UG, US, UZ, VC, VN, ZA, ZM, ZW.

(84) Designated States (unless otherwise indicated, for every kind of regional protection available): ARIPO (BW, GH, GM, KE, LR, LS, MW, MZ, NA, RW, SD, SL, SZ, TZ, UG, ZM, ZW), Eurasian (AM, AZ, BY, KG, KZ, MD, RU, TJ, TM), European (AL, AT, BE, BG, CH, CY, CZ, DE,

[Continued on next page]

(54) Title: HIGH FLOW RATE ISOLATED INFUSION FOR REGIONAL TREATMENT OF CANCER AND MEDICAL CONDITIONS

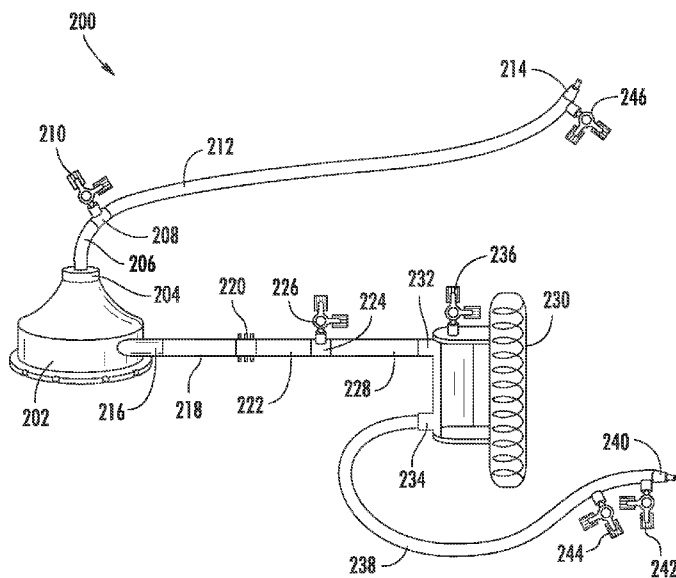

FIG. 2

(57) Abstract: The present application relates to high flow rate isolated regional treatment of cancer and proliferative disorders and conditions. For example, provided are methods, systems and devices for treating a cancer in a region of a subject using high flow rate isolated infusion.



DK, EE, ES, FI, FR, GB, GR, HR, HU, IE, IS, IT, LT, LU, LV, MC, MK, MT, NL, NO, PL, PT, RO, RS, SE, SI, SK, SM, TR), OAPI (BF, BJ, CF, CG, CI, CM, GA, GN, GQ, GW, ML, MR, NE, SN, TD, TG).

Published:

- *with international search report (Art. 21(3))*
- *before the expiration of the time limit for amending the claims and to be republished in the event of receipt of amendments (Rule 48.2(h))*

Declarations under Rule 4.17:

- *as to applicant's entitlement to apply for and be granted a patent (Rule 4.17(ii))*
- *as to the applicant's entitlement to claim the priority of the earlier application (Rule 4.17(iii))*
- *of inventorship (Rule 4.17(iv))*

(88) Date of publication of the international search report:

22 November 2012

INTERNATIONAL SEARCH REPORT

International application No.
PCT/US2012/028481**A. CLASSIFICATION OF SUBJECT MATTER***A61M 25/01(2006.01)i, A61M 5/168(2006.01)i, A61M 5/178(2006.01)i, A61M 5/142(2006.01)i*

According to International Patent Classification (IPC) or to both national classification and IPC

B. FIELDS SEARCHED

Minimum documentation searched (classification system followed by classification symbols)

A61M 25/01; A61M 3/00; A61M 35/00

Documentation searched other than minimum documentation to the extent that such documents are included in the fields searched

Korean utility models and applications for utility models

Japanese utility models and applications for utility models

Electronic data base consulted during the international search (name of data base and, where practicable, search terms used)

eKOMPASS(KIPO internal) & Keywords: cancer, ILP, ILI, isolated limb, perfusion, infusion, flow

C. DOCUMENTS CONSIDERED TO BE RELEVANT

Category*	Citation of document, with indication, where appropriate, of the relevant passages	Relevant to claim No.
X	AJIT et al. "Isolated limb infusion with cytotoxic agents", Cancer, 18 November 2009, Volume 116, Issue 2, pages 459-464. See the first paragraph in page 459;	24-25,32-35
Y	the right column in page 460; and figs. 1-2.	26-27,42-44
Y	US 05569182 A (TWARDOWSKI et al.) 29 October 1996 See the abstract; claim 1; and fig. 1.	26-27,42-44
A	BRADY et al. "Isolated limb infusion with melphalan", Wolters Kluwer Health, 15 January 2009, pages 106-111. See the abstract in page 106; and the 5th paragraph in page 107; and fig. 1.	24-27,32-35,42-44
A	US 05817046 A (GLICKMAN) 06 October 1998 See the abstract; claim 1; and fig. 1.	24-27,32-35,42-44

 Further documents are listed in the continuation of Box C. See patent family annex.

* Special categories of cited documents:

"A" document defining the general state of the art which is not considered to be of particular relevance

"E" earlier application or patent but published on or after the international filing date

"L" document which may throw doubts on priority claim(s) or which is cited to establish the publication date of citation or other special reason (as specified)

"O" document referring to an oral disclosure, use, exhibition or other means

"P" document published prior to the international filing date but later than the priority date claimed

"T" later document published after the international filing date or priority date and not in conflict with the application but cited to understand the principle or theory underlying the invention

"X" document of particular relevance; the claimed invention cannot be considered novel or cannot be considered to involve an inventive step when the document is taken alone

"Y" document of particular relevance; the claimed invention cannot be considered to involve an inventive step when the document is combined with one or more other such documents, such combination being obvious to a person skilled in the art

"&" document member of the same patent family

Date of the actual completion of the international search

28 SEPTEMBER 2012 (28.09.2012)

Date of mailing of the international search report

04 OCTOBER 2012 (04.10.2012)

Name and mailing address of the ISA/KR

Korean Intellectual Property Office
189 Cheongsu-ro, Seo-gu, Daejeon Metropolitan
City, 302-701, Republic of Korea

Facsimile No. 82-42-472-7140

Authorized officer

LEE, Cheol Soo

Telephone No. 82-42-481-8525



INTERNATIONAL SEARCH REPORT

International application No.

PCT/US2012/028481**Box No. II Observations where certain claims were found unsearchable (Continuation of item 2 of first sheet)**

This international search report has not been established in respect of certain claims under Article 17(2)(a) for the following reasons:

1. Claims Nos.: 1-23,50-52
because they relate to subject matter not required to be searched by this Authority, namely:
Claims 1-23 and 50-52 pertain to methods for treatment of the human body by therapy or surgery, and thus relate to a subject matter which this International Searching Authority is not required to search under Article 17(2)(a)(i) of the PCT and Rule 39.1(iv) of the Regulations under the PCT.
2. Claims Nos.: 8,10,12,19,21,23,37,46,49
because they relate to parts of the international application that do not comply with the prescribed requirements to such an extent that no meaningful international search can be carried out, specifically:
The claims refer to multiple dependent claims that refer to other multiple dependent claims. Therefore, the meaning of the technical feature to which they refer is vague and unclear.
3. Claims Nos.: 6-7,9,11,18,20,22,28-31,36,38-41,45,47-48
because they are dependent claims and are not drafted in accordance with the second and third sentences of Rule 6.4(a).

Box No. III Observations where unity of invention is lacking (Continuation of item 3 of first sheet)

This International Searching Authority found multiple inventions in this international application, as follows:

1. As all required additional search fees were timely paid by the applicant, this international search report covers all searchable claims.
2. As all searchable claims could be searched without effort justifying an additional fee, this Authority did not invite payment of any additional fee.
3. As only some of the required additional search fees were timely paid by the applicant, this international search report covers only those claims for which fees were paid, specifically claims Nos.:

4. No required additional search fees were timely paid by the applicant. Consequently, this international search report is restricted to the invention first mentioned in the claims; it is covered by claims Nos.:

Remark on Protest

- The additional search fees were accompanied by the applicant's protest and, where applicable, the payment of a protest fee.
- The additional search fees were accompanied by the applicant's protest but the applicable protest fee was not paid within the time limit specified in the invitation.
- No protest accompanied the payment of additional search fees.

INTERNATIONAL SEARCH REPORT

Information on patent family members

International application No.

PCT/US2012/028481

Patent document cited in search report	Publication date	Patent family member(s)	Publication date		
US 05569182 A	29. 10. 1996	AU 1996-49113 B2	10. 06. 1999		
		CA 2212511 C	28. 11. 2006		
		EP 0808188 A1	22. 01. 2003		
		EP 0808188 A4	09. 06. 1999		
		EP 0808188 B1	22. 09. 2004		
		JP 11-503336 A	26. 03. 1999		
		US 05209723 A	11. 05. 1993		
		US 05405320 A	11. 04. 1995		
		US 05509897 A	23. 04. 1996		
		US 05685867 A	11. 11. 1997		
		US 05961486 A	05. 10. 1999		
		US 7695450 B1	13. 04. 2010		
		WO 91-10456 A1	25. 07. 1991		
		WO 96-24399 A1	15. 08. 1996		
		US 05817046 A	06. 10. 1998	CA 2297080 A1	21. 01. 1999
				CA 2297080 C	27. 09. 2005
				EP 1027094 A1	16. 08. 2000
EP 1027094 B1	30. 03. 2011				
WO 99-02216 A1	21. 01. 1999				