

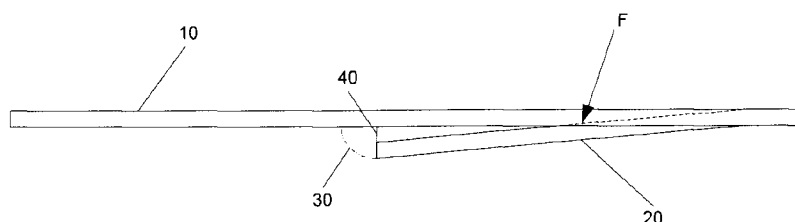

(86) **Date de dépôt PCT/PCT Filing Date:** 2013/11/29  
(87) **Date publication PCT/PCT Publication Date:** 2014/06/05  
(45) **Date de délivrance/Issue Date:** 2020/10/13  
(85) **Entrée phase nationale/National Entry:** 2015/05/22  
(86) **N° demande PCT/PCT Application No.:** EP 2013/075170  
(87) **N° publication PCT/PCT Publication No.:** 2014/083185  
(30) **Priorité/Priority:** 2012/11/30 (FR1261477)

(51) **Cl.Int./Int.Cl. G06K 7/00** (2006.01),  
**G06K 13/08** (2006.01)  
(72) **Inventeurs/Inventors:**  
JANOT, CYRIL, FR;  
PAVAGEAU, STEPHANE, FR  
(73) **Propriétaire/Owner:**  
INGENICO GROUP, FR  
(74) **Agent:** OYEN WIGGS GREEN & MUTALA LLP

(54) **Titre : TRAPPE POUR TERMINAL**  
(54) **Title: FLAP FOR TERMINAL**



(57) **Abrégé/Abstract:**

The invention relates to a flap (1) for closing off a cavity of a terminal (T), comprising a memory card reader. According to the invention, the flap comprises at least one slot (F) for inserting a memory card, and said slot is obtained by a difference in height (40) between a base plane and an insertion plane, and in that said slot has a guiding profile.

## (12) DEMANDE INTERNATIONALE PUBLIÉE EN VERTU DU TRAITÉ DE COOPÉRATION EN MATIÈRE DE BREVETS (PCT)

(19) Organisation Mondiale de la  
Propriété Intellectuelle  
Bureau international



(10) Numéro de publication internationale  
**WO 2014/083185 A1**

(43) Date de la publication internationale  
5 juin 2014 (05.06.2014)

WIPO | PCT

- (51) Classification internationale des brevets :  
*G06K 7/00* (2006.01) *G06K 13/08* (2006.01)
- (21) Numéro de la demande internationale :  
PCT/EP2013/075170
- (22) Date de dépôt international :  
29 novembre 2013 (29.11.2013)
- (25) Langue de dépôt : français
- (26) Langue de publication : français
- (30) Données relatives à la priorité :  
1261477 30 novembre 2012 (30.11.2012) FR
- (71) Déposant : COMPAGNIE INDUSTRIELLE ET FINANCIERE D'INGENIERIE "INGENICO" [FR/FR];  
28/32 Boulevard de Grenelle, F-75015 Paris (FR).
- (72) Inventeurs : JANOT, Cyril; 410A, Chemin de Riosset, F-26400 Grane (FR). PAVAGEAU, Stéphane; 1, allée des Tulipes, F-26600 La Roche de Glun (FR).
- (74) Mandataire : LE SAUX, Gaël; 90333, B, Cabinet VIDON, Technopole Atalante, 16B, rue de Jouanet, Bretagne F-35703 Rennes Cedex 7 (FR).
- (81) États désignés (sauf indication contraire, pour tout titre de protection nationale disponible) : AE, AG, AL, AM, AO, AT, AU, AZ, BA, BB, BG, BH, BN, BR, BW, BY, BZ, CA, CH, CL, CN, CO, CR, CU, CZ, DE, DK, DM, DO, DZ, EC, EE, EG, ES, FI, GB, GD, GE, GH, GM, GT, HN, HR, HU, ID, IL, IN, IR, IS, JP, KE, KG, KN, KP, KR, KZ, LA, LC, LK, LR, LS, LT, LU, LY, MA, MD, ME, MG, MK, MN, MW, MX, MY, MZ, NA, NG, NI, NO, NZ, OM, PA, PE, PG, PH, PL, PT, QA, RO, RS, RU, RW, SA, SC, SD, SE, SG, SK, SL, SM, ST, SV, SY, TH, TJ, TM, TN, TR, TT, TZ, UA, UG, US, UZ, VC, VN, ZA, ZM, ZW.
- (84) États désignés (sauf indication contraire, pour tout titre de protection régionale disponible) : ARIPO (BW, GH, GM, KE, LR, LS, MW, MZ, NA, RW, SD, SL, SZ, TZ, UG, ZM, ZW), eurasien (AM, AZ, BY, KG, KZ, RU, TJ, TM), européen (AL, AT, BE, BG, CH, CY, CZ, DE, DK, EE, ES, FI, FR, GB, GR, HR, HU, IE, IS, IT, LT, LU, LV, MC, MK, MT, NL, NO, PL, PT, RO, RS, SE, SI, SK, SM, TR), OAPI (BF, BJ, CF, CG, CI, CM, GA, GN, GQ, GW, KM, ML, MR, NE, SN, TD, TG).
- Publiée :  
— avec rapport de recherche internationale (Art. 21(3))

(54) Title : FLAP FOR TERMINAL

(54) Titre : TRAPPE POUR TERMINAL

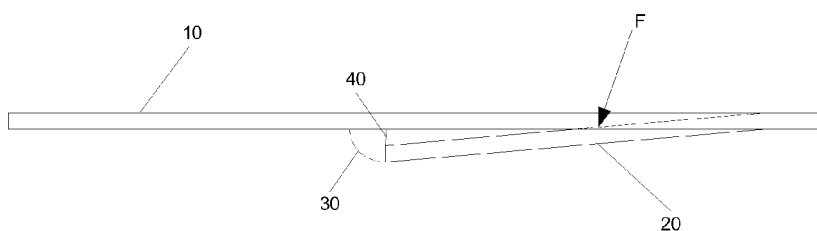

FIGURE 1

(57) Abstract : The invention relates to a flap (1) for closing off a cavity of a terminal (T), comprising a memory card reader. According to the invention, the flap comprises at least one slot (F) for inserting a memory card, and said slot is obtained by a difference in height (40) between a base plane and an insertion plane, and in that said slot has a guiding profile.

(57) Abrégé : L'invention concerne une trappe d'occultation (1) d'une cavité d'un terminal (T), comprenant un lecteur de carte à mémoire. Selon l'invention, la trappe comprend au moins une fente d'insertion (F) d'une carte à mémoire et ladite fente est obtenue par une différence de hauteur (40) entre un plan de base et un plan d'insertion et en ce que ladite fente présente un profil de guidage.



WO 2014/083185 A1

## Flap for terminal

### 1. Field of the invention

The invention relates to a terminal provided with several memory card readers. The invention relates more particularly to a terminal provided with a professional person's memory card reader and a user's memory card reader. The invention relates more particularly to a system intended to enable the insertion and withdrawal of a professional memory card in a terminal comprising the two types of readers mentioned here above.

### 2. Prior art

There are known terminals in the prior art that have two smartcard readers. These are for example terminals for medical use. A terminal of this type comprises for example a memory card reader to receive a card related to a patient and a memory card reader to receive a card related to a healthcare professional (such as a doctor or a pharmacist). These two types of cards do not have the same use: the professional card linked to the healthcare professional contains data associated with a profession or with permitted actions while the patient's card enables him or her to be identified.

On the same basis, bank payment terminals can also be provided with two memory card readers: a first reader for receiving a payment card associated with a customer while a second reader receives a professional identification card related to the merchant.

There can be other situations where two card readers are present and the above two examples are provided only by way of illustrations.

However, these situations share the following characteristics: the professional card used by the professional (the doctor, the merchant, etc) is often permanently connected to the terminal in question. Thus, for example, the merchant's card is inserted into the terminal in a prolonged way (it is indeed hard to imagine that the merchant would insert his card whenever a customer has to make a payment). On the contrary the customer's card is inserted into the terminal for the time during which the payment transaction is made.

Thus, to allow for these two types of use of cards, two different systems are employed: the first system, which is very conventional, enables the easy insertion and removal of the card in a memory card reader (smartcard reader, magnetic tape card reader, contactless card reader). This first system is intended for the patient, the customer, in other words the user of the service.

In the second system, the professional person's card is kept permanently in the terminal. To this end, in the prior art, the card is inserted into the reader and blocked in the terminal, for example under a flap situated for example beneath the reader (the rear face of the reader). Thus, the card is inserted for a prolonged period without the service user being simply able to discreetly carry out the fraudulent removal of this professional card. Indeed, a professional card often has extremely sensitive data and the theft of such a card can have disastrous effects. It is therefore by design that terminal manufacturers have hitherto seen to it that the professional card is concealed. In doing so, they have provided greater security for the card.

Although this situation can be considered to be satisfactory, it raises a problem since, driven by the wish to obtain greater security for their data, certain professional persons have adopted the habit of removing these professional cards from the terminal, for example at the end of a day or the weekend. Indeed, these merchants and professionals rightly fear the theft of the terminal and therefore the theft of their professional cards.

These daily insertions and withdrawals, which are not initially planned by the terminal manufacturers, raise problems, related mainly to mechanical resistance and accessorially to problems of security. Indeed, the insertion and withdrawal of the professional card requires the dismantling of the flap situated on the front face of the terminal. Now this flap is generally fixed to the terminal by means of plastic clips. Since these clips are not designed to be in action several times a day, they end up getting broken or they make the terminal unusable. The adaptation of these clips to cope with daily stresses is a delicate problem. Besides, the opening and closing of this flap ultimately deforms the plastic, thus making the terminal subject to attacks, for example through the insertion of small-sized probes into the terminal.

### 3. Summary of the invention

A solution therefore needs to be proposed to this problem posed by the prior art terminals. The invention does not have the drawbacks of the prior art. More specifically, the invention relates to a flap intended to close a cavity of a terminal, comprising a memory card reader. According to the invention, said flap comprises at least one slot for inserting a memory card.

Thus, unlike in the prior-art flaps and terminals, it is not necessary to remove the flap from the terminal to be able to extract the professional card. It is enough to make the card slide outside the slot.

5 According to one particular embodiment, said slot is obtained by a difference in height between a base plane and an insertion plane and said slot has a guiding profile.

Thus, in this embodiment, the flap comprises a base plane and an insertion plane. Overall, the base plane is generally parallel to the insertion plane and a particular profile is cut out on the base plane at the level of the insertion slot. The same profile is cut out on the insertion plane. This enables the card to be guided when it is being inserted. According to  
10 one particular characteristic, this profile has an overall wave shape. Thus, guidance is ensured.

According to one particular embodiment, said flap has a base plane generally reproducing the shape of a portion of the rear face of a terminal intended to receive said flap and an insertion plane at least partially tilted at a predetermined angle relative to said  
15 base plane, said insertion plane defining said insertion slot.

Thus, the insertion slot is the result of a difference of tilt and/or positioning of two planes relative to each other.

The two embodiments referred to earlier can naturally be combined with each other. They can also be implemented independently.

20 According to one particular characteristic, said angle of tilt of the insertion plane relative to said base plane is determined as a function of the thickness of the card to be received in said insertion slot and the thickness of said base plane.

Thus, the thickness of the slot is precisely that needed for the insertion of the card and the difference of tilt enables the card to be guided. Indeed, it must be borne in mind  
25 that the card inserted into the slot is intended to be read by a reading device situated inside the terminal. It is therefore important to guide the card accurately towards this reader. The tilting and/or positioning of the two planes especially make it possible to carry out this guidance.

According to one particular characteristic, the width of said insertion plane is  
30 generally equal to the width of a card to be inserted into a reader of said terminal.

According to one particular characteristic, the length of said insertion plane is generally equal to the difference between the length of a card to be inserted into a reader of

said terminal and the length necessary for connecting said card with a memory card connector situated in said terminal.

Thus, the card, once inserted into the flap, does not go beyond it.

5 According to one particular characteristic, the length of said insertion plane is smaller than the difference between the length of a card to be inserted into a reader of said terminal and the length necessary for connecting said card with a memory card connector situated in said terminal.

10 According to one particular characteristic, said flap furthermore comprises, on its front face, a card retaining zone taking the form of a wall resulting from a difference of positioning between said base plane and said plane of tilt.

Thus, this retention zone maintains the card in position when it is inserted into the slot (and therefore into the reader) and prevents the card from being stolen. Secondly, this retention zone is particularly useful when the length of said insertion plane is slightly smaller than the difference between the length of a card to be inserted into the reader and the length needed for the connection of said card with a memory card connector situated in  
15 said reader: the card is thus locked and cannot be stolen since the edge of the card rests against this retention zone.

20 According to one particular characteristic, said base plane comprises, at said slot F, a cut-out line forming a notch. This notch can for example have a wave shape and enables the card to be guided during its insertion.

According to one specific characteristic, said flap furthermore comprises, on its front face, a hollow for extracting a card. Thus, this hollow makes it possible to pass the finger beneath the card and hence get free of the retention zone.

25 Thus, when this card is supported on said retention zone, this hollow for extracting makes it easier to extract the card.

#### 4. Figures

Other features and advantages of the invention shall appear more clearly from the following description of a preferred embodiment given by way of an illustrative and non-exhaustive example and from the appended drawings, of which:

- 30 - Figure 1 is a longitudinal section of a simplified representation of a flap according to the invention;
- Figure 2 is a top view of a simplified representation of the flap of figure 1;

- Figure 3 is a simplified 3D representation of the flap of figure 1;
- Figure 4 is a 3D representation of the front or external face of the flap in this embodiment (rear face of the terminal);
- Figure 5 is a plan view of the rear face or interior face of the flap;
- 5 - Figure 6 is a view in section along the section A-A of figure 5;
- Figure 7 is a 3D representation of the rear face of the terminal on which the flap according to the invention is mounted;
- Figure 8 is a partially exploded view of the terminal and the flap shown in figure 7;
- Figure 9 is a partial view of the same terminal.

## 10 5. Detailed description

### 5.1. Reminder of the principle of the invention

The invention relates to a flap positioned on the rear face of a terminal. This flap enables the insertion of a card, more particularly a professional card, into the terminal. This flap can advantageously be mounted on an existing terminal instead of the existing flap. It then makes it possible to modify the terminal at low cost and resolve the problems  
15 mentioned (see here above). This flap can also be mounted on novel terminals. The object of this flap is to stop the professional person from having to dismantle it in order to insert and extract his professional card while continuing to offer guarantees of security against the removal of the professional card by a malicious person. The flap is specifically  
20 designed so that the insertion or withdrawal of the professional card is easy when the terminal is turned over (i.e. when the rear face of the terminal faces the professional person wishing to insert or withdraw the card).

The flap is specifically designed so that the insertion or withdrawal of the professional card is complicated when the terminal is in a position of use (i.e. when the  
25 front face of the terminal has to face the user, for example a patient or customer wishing to use the terminal to make a transaction). To this end, the direction of withdrawal of the card is reversed relative to the direction of use of the terminal and, according to one particular characteristic, it comprises a retention stop. More particularly, the terminal in its position of use faces the user. It generally comprises a screen and a keypad. It can possibly  
30 comprise a certain number of memory card reader devices (smartcard reader, magnetic

card reader, contactless reader) that can be used to identify or authenticate a user and/or make transactions. As a rule, such a terminal is designed to be held in one hand by the user while his other hand carries out the requested operation (for example the entry of a pin code). According to the invention, the flap is positioned beneath the terminal and it is  
5 shaped in order to prevent the user from withdrawing the professional card when the terminal is held in the hand. In one embodiment of the invention, this is done by making sure the card can be extracted only by a movement of translation towards the rear of the terminal, this movement being impossible with the hand holding the terminal although this hand is partly in contact with the professional card. This embodiment shall be presented  
10 here below.

In other embodiments, (partial or non-partial) concealment devices for concealing the portion of the card that is outside the terminal can be used. Such devices also fulfill the function of preventing the withdrawal of the card. However, they have to be added to the flap and this can cause problems either of manufacture or of cost. Among the devices  
15 envisaged, there are for example shutters (or other adapted fastening devices) which prevent the user from sensing the presence of the card in his palm.

The flap is therefore designed generally as an intersection of two planes: a base plane and an insertion plane. The insertion plane is tilted relative to the base plane. The size of the insertion plane is adapted to the size of the card. If it is a smartcard, the size of  
20 the insertion plane is adapted to this type of card (for example under the ISO IEC 7816-1 standard). More particularly, the size of the insertion plane is adapted to the part of the card that is not in the terminal. Besides, the tilt of the insertion plane is computed firstly according to the position of the card reader in the terminal and secondly according to the thickness of the base plane in order to have available an insertion slot whose height is  
25 substantially equal to the thickness of the card (for example according to the ISO IEC 7816-1 standard).

A drawing of a general embodiment of the flap according to the invention is presented with reference to figures 1, 2 and 3 in which only the above-described characteristics are included (the other characteristics of the flap such as the fastening  
30 systems and the gripping points are not shown for reasons of greater legibility). The flap comprises a base plane 10, an insertion plane 20 (the length L of which varies according to the embodiments). The non-visible part of the insertion plane is illustrated in dotted lines. In certain embodiments, the insertion plane is not extended beneath the base plane. The

insertion plane is tilted relative to the base plane by an angle 30 making it possible to define the height 40 of the slot F, generally corresponding to the thickness of the card.

## 5.2. Description of one embodiment

5 Referring to figures 4 to 9, we present a particular embodiment of the flap that is an object of the invention. In figures 4 to 6, the flap is represented alone. In figures 7 to 9, the flap is represented when it is fitted to into a payment terminal.

Figure 4 is a 3D representation of the front face of the flap in this embodiment. Figure 5 is a plan view of the rear face or interior face of the flap. Figure 6 is a view in  
10 section, along the section A-A of figure 5. Figure 7 is a representation in three dimensions of the rear face of the terminal on which the flap that is the object of the invention is mounted. Figure 8 is a partially exploded view of the terminal and of the flap represented in figure 7. Figure 9 is also a partially exploded view of the terminal and of the flap represented in figure 7.

15 Figures 4 to 9 represent an embodiment of the flap in which the base plane 10 is slightly domed. The domed shape of the base plane is adapted to the shape of the terminal T to which the flap is adjoined. In this embodiment, the flap 1 comprises two clips 102, 103 which enable the flap to be fixed into receiving elements provided for this purpose in the terminal T. The flap also comprises two tenons 104, 105 serving to position the flap in  
20 two corresponding housings of the terminal (not shown). As explained here above, the flap also comprises an insertion plane 20. This insertion plane is tilted by a given angle relative to the base plane. The base plane defines the slot F having a predetermined height 40 and a wave-shaped profile. According to the invention, the insertion plane 40 has a variable tilt 201, 202. This variable tilt relative to the base plane 10 makes it possible, when a card is  
25 inserted, to impart a curve to this card (reference 70, figures 8 and 9) which has the effect of placing the card in a state of tension against the card retention zone 50. In the embodiment presented, the card retention zone is constituted by the junction wall between the base plane and the insertion plane as can be seen in figure 4. The variable tilt also guides the card, during its insertion, towards its destination (which is the smartcard reader  
30 (reference 80, figures 8 and 9).

According to the invention, the flap also integrates an extraction hollow 60. This extraction hollow, which takes the form of a hole or a generally parallelepiped-shaped

recess, makes it possible, as shown in figure 8 for example, to lift the smart card when it is inserted into the reader.

According to the invention, in this embodiment, the shape of the cut-out portion of the slot F is also special; in this embodiment, the slot is generally wave-shaped. More particularly, the base plane comprises, at said slot F, a cut-out line forming a notch and having the general shape of a wave. Other shapes can also be adopted. This shape provides for optimal guidance of the card when it is inserted into the reader. Indeed, as will be understood from reading the figure, the card is supported on the central part (21) of the insertion plane while the left-hand and right-hand ends of the card are guided beneath the base plane (by the sides 11 and 12 of the base plane). To ensure that the insertion plane is not deformed by the force exerted during the insertion, the flap comprises, beneath the insertion plane, a support rib 90. This rib rests on one or more components or elements situated in the terminal. Since the left-hand and right-hand edges of the card are guided, it is not possible to insert the card in a wrong position.

In a complementary way, the shape of the slot can be defined according to other particular constraints, which for example can be related to the weight of the part (for example to save on plastic material).

Thus, in this embodiment of the invention, it is possible, on the one hand, to specifically manufacture terminals so that they can receive a professional card but, on the other hand, to replace an existing terminal flap by a new flap such as that of the invention.

**CLAIMS**

1. Flap for concealing a cavity of a terminal comprising a memory card reader, characterized in that said flap comprises:
  - two tenons (104, 105) for positioning the flap in two corresponding housings of said terminal,
  - two clips (102, 103) for fixing said flap into receiving elements of said terminal,
  - a base plane (10)
  - an insertion plane (20), said insertion plane being tilted relative to the base plane (10) by an angle (30) defining a height of at least one slot (F) for inserting a memory card in said slot (F) once said flap is fixed on said terminal.
2. Flap according to claim 1, characterized in that said slot (F) has a guiding profile.
3. Flap according to claim 1, characterized in that said base plane (10) generally reproduces the shape of a portion of a rear face of said terminal and in that said insertion plane (20) is at least partially tilted at said angle (30) relative to said base plane, said insertion plane (20) defining said slot (F).
4. Flap according to claim 3, characterized in that said angle (30) of said insertion plane (20) relative to said base plane (10) is determined as a function of the thickness of the card to be received in said slot (F) and the thickness of said base plane (10).
5. Flap according to any one of the claims 1 to 3, characterized in that the width of said insertion plane is generally equal to the width of said card to be inserted into said reader of said terminal.
6. Flap according to claim 1, characterized in that the length (L) of said insertion plane is generally equal to the difference between the length of said card to be inserted into said reader of said terminal and the length necessary for connecting said card with a memory card connector situated in said terminal.

7. Flap according to claim 1, characterized in that the length of said insertion plane is smaller than the difference between the length of said card to be inserted into said reader of said terminal and the length necessary for connecting said card with a memory card connector situated in said terminal.  
5
8. Flap according to claim 1, characterized in that it furthermore comprises, on its front face, a card retaining zone taking the form of a wall resulting from a difference of positioning between said base plane and said insertion plane.
- 10 9. Flap according to claim 1, characterized in that it furthermore comprises, on its front face, a hollow for extracting said card.
10. Flap according to claim 1, characterized in that said base plane comprises, at said slot (F), a cut-out line forming a notch.  
15
11. Terminal comprising a flap according to any one of the claims 1 to 10.

1/5

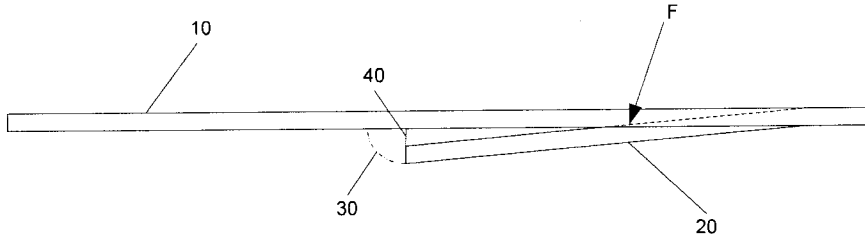

FIGURE 1

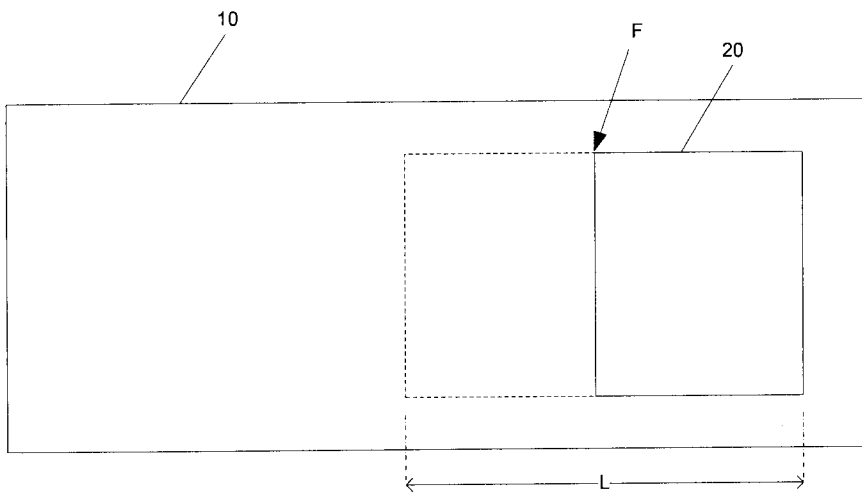

FIGURE 2

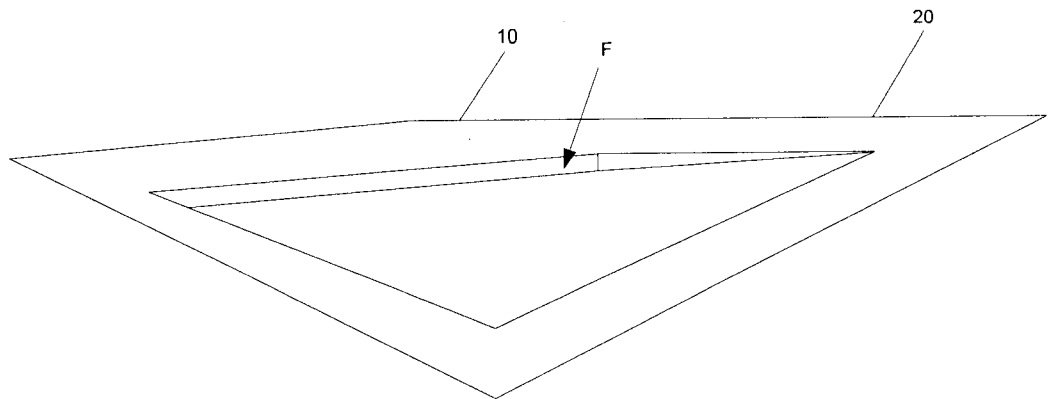

FIGURE 3

2/5

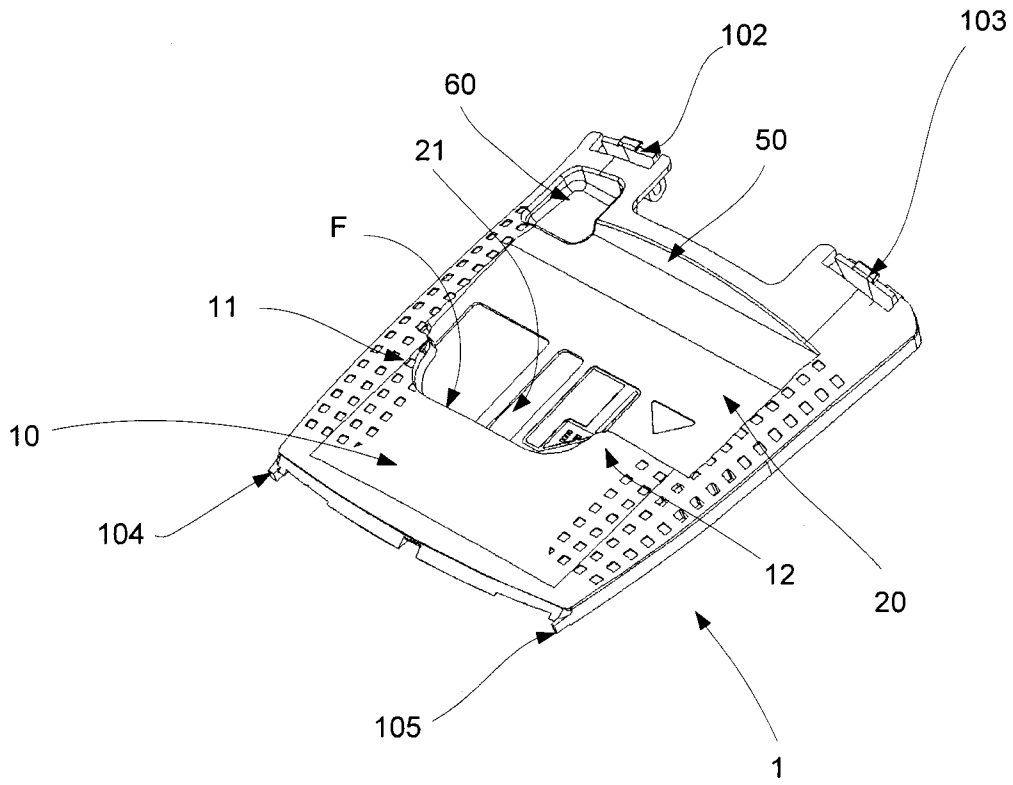

FIGURE 4

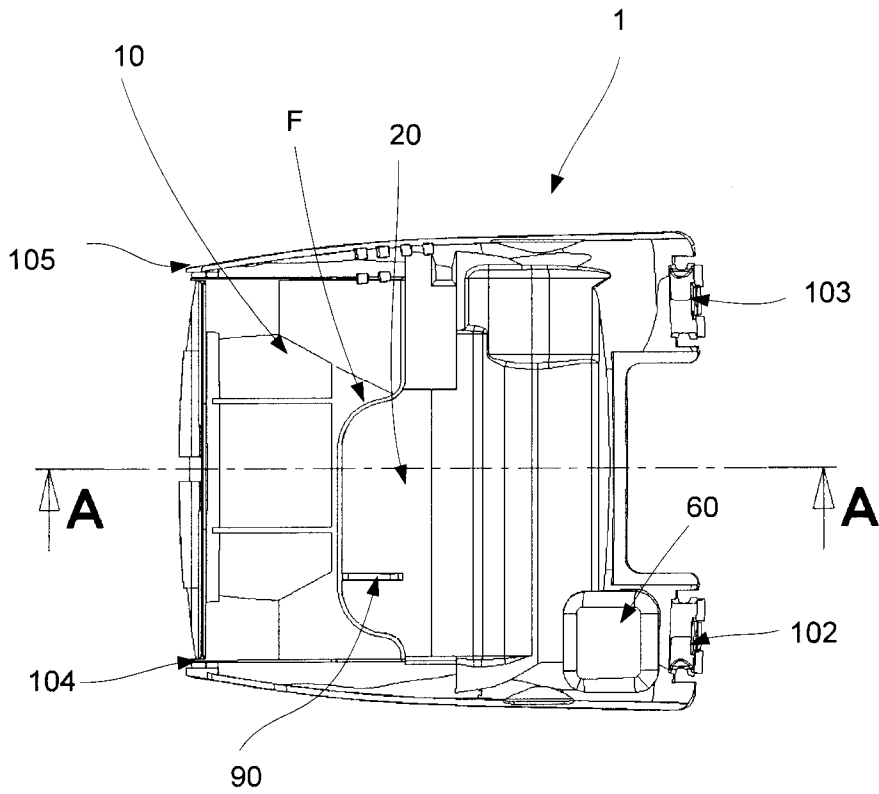

FIGURE 5

3/5

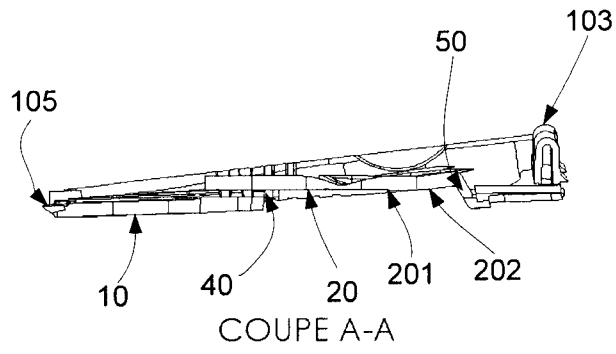

FIGURE 6

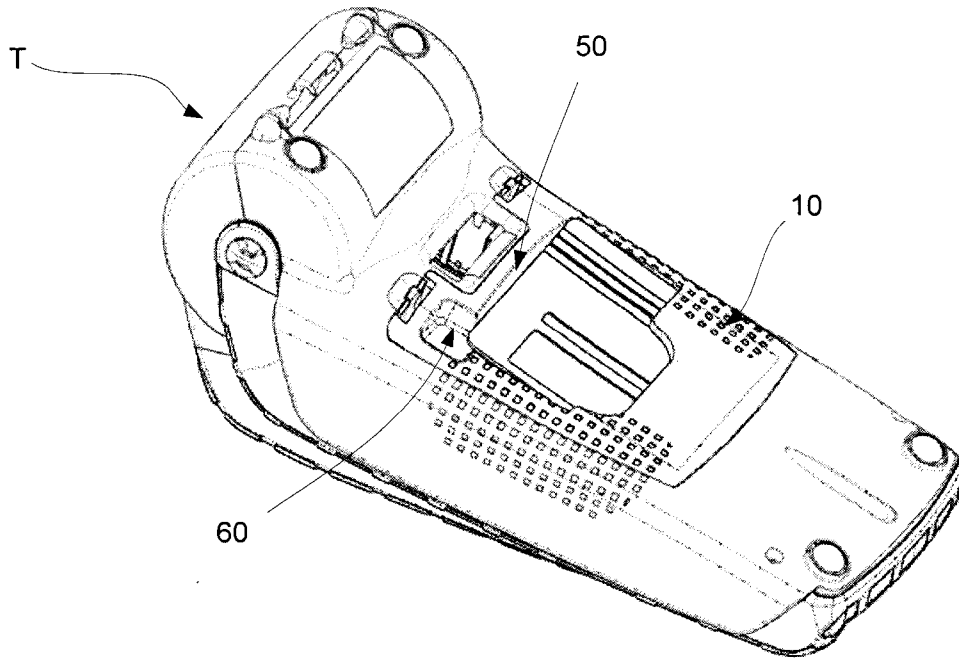

FIGURE 7

4/5

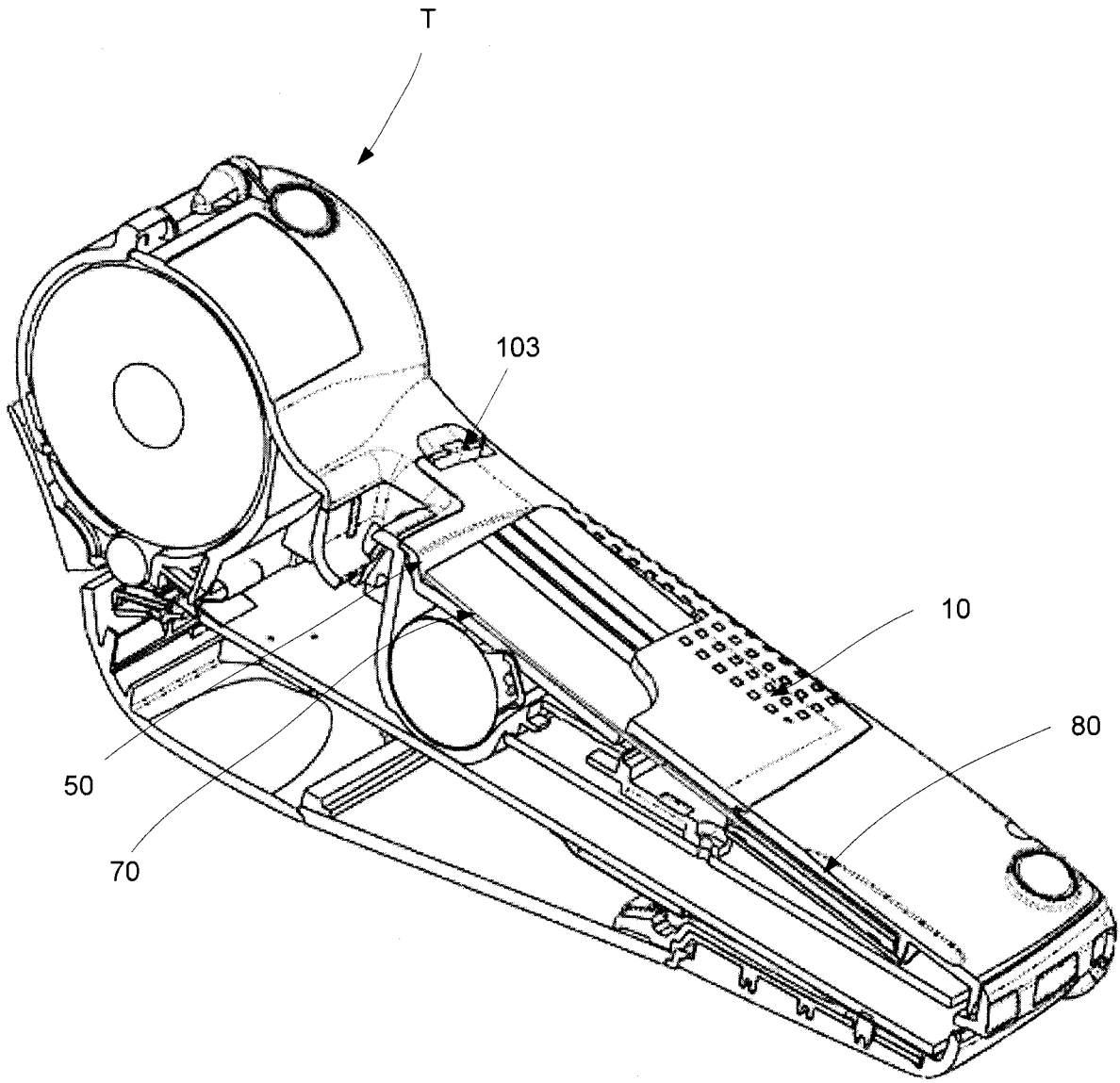

FIGURE 8

5/5

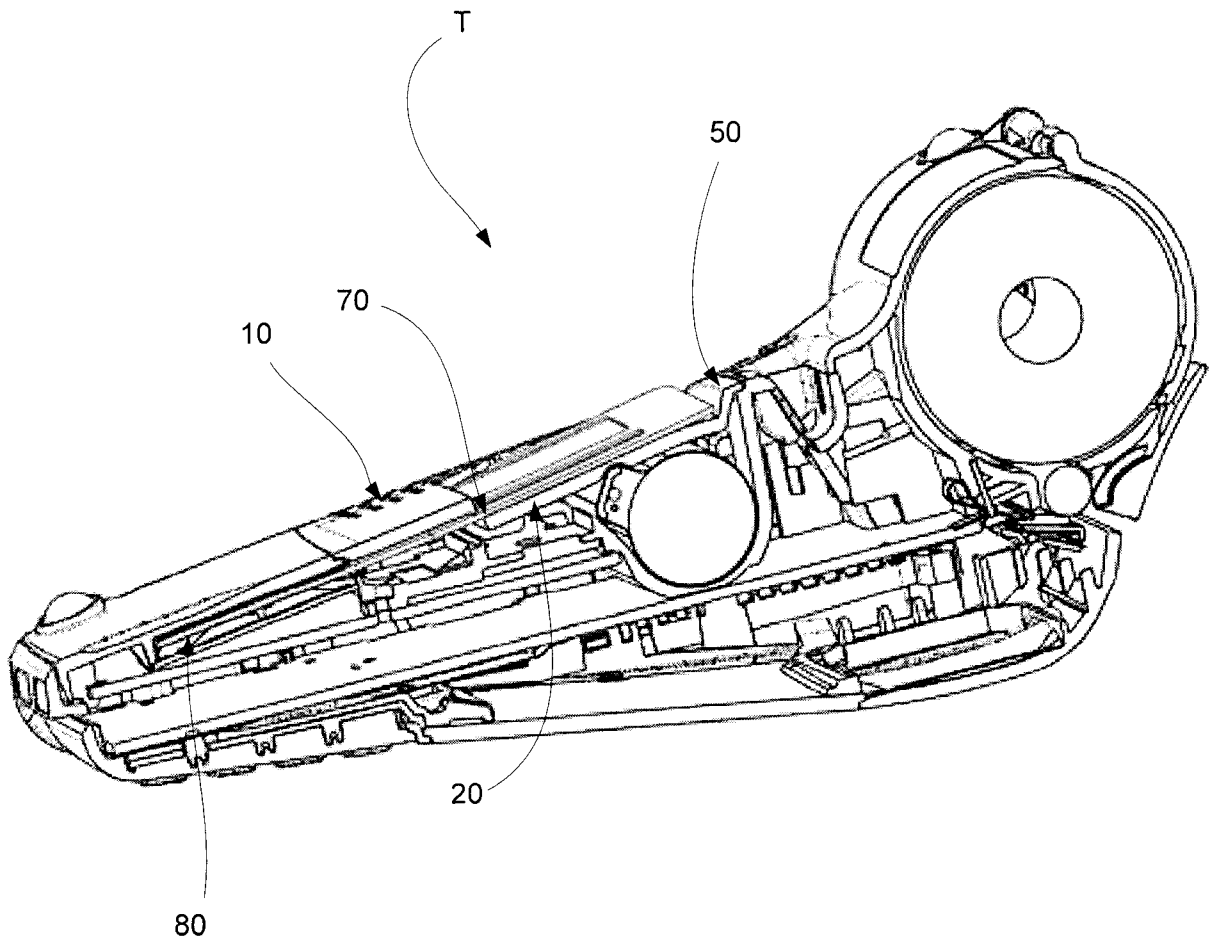

FIGURE 9

