

[54] MUSTACHE STYLING DEVICE

[76] Inventor: Charles E. Barbarow, 156 Barclay St., Paterson, N.J. 07503

[22] Filed: May 21, 1974

[21] Appl. No.: 472,000

[52] U.S. Cl. 132/10

[51] Int. Cl. A45d 2/50

[58] Field of Search 132/10, 9, 88, 7, 88.5; 15/209; 206/56

[56] References Cited

UNITED STATES PATENTS

2,248,533	7/1941	Gibert.....	132/88.7
2,606,565	8/1952	Sage, Sr.....	132/88.7

Primary Examiner—G. E. McNeill
Attorney, Agent, or Firm—Samuelson & Jacob

[57] ABSTRACT

A device for providing an outline pattern for styling a person's mustache includes a template, a clamping arrangement receivable within the mouth of the person whose mustache is to be styled, and a member coupling the template with the clamping arrangement to locate and hold the template against the person's upper lip in response to reception of the clamping arrangement in the mouth and application of clamping pressure by the mouth upon the clamping arrangement.

10 Claims, 3 Drawing Figures

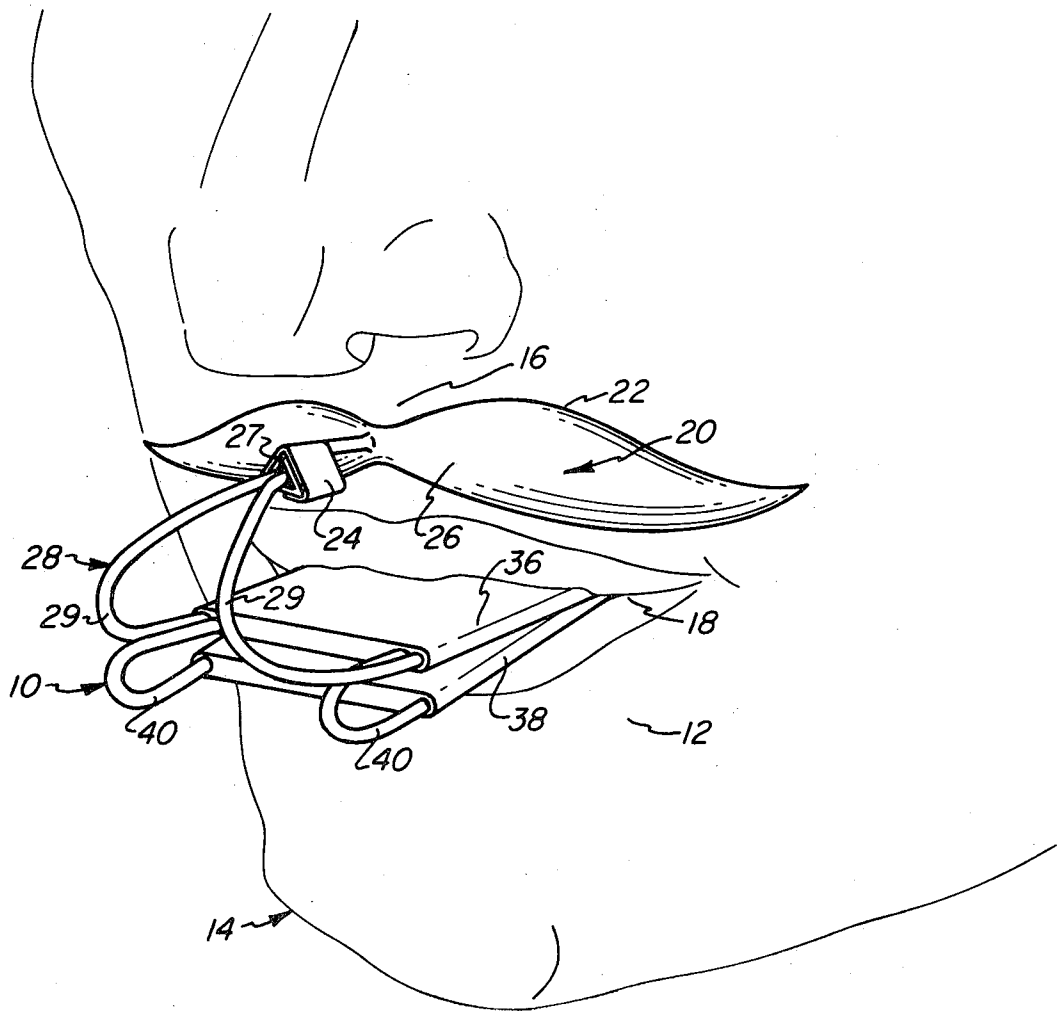

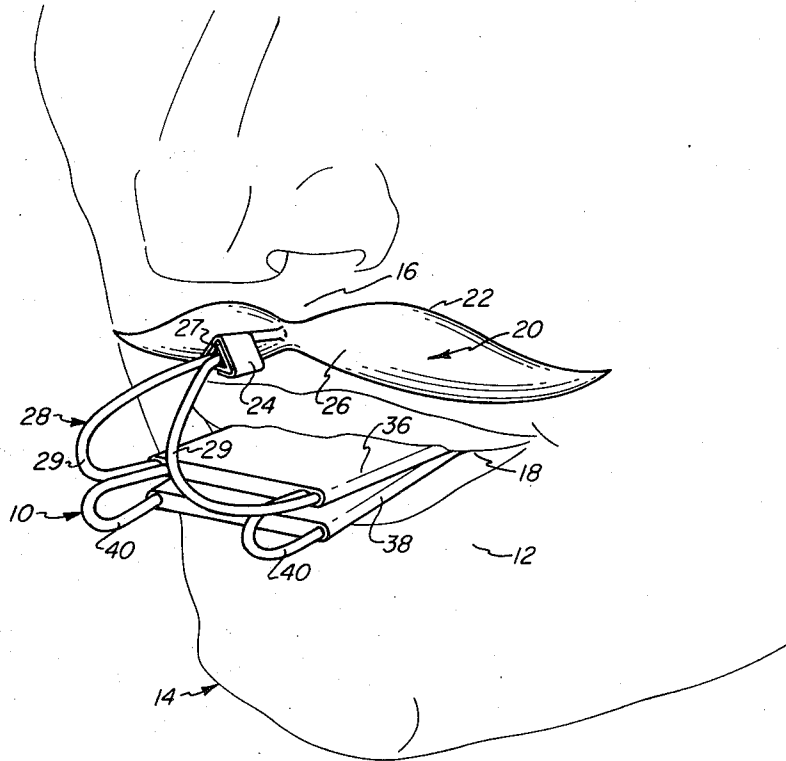

FIG. 1

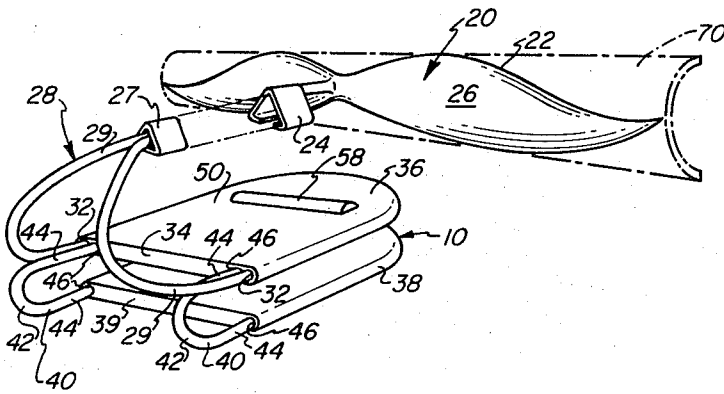

FIG. 2

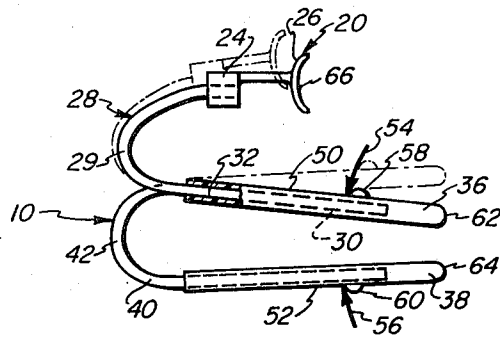

FIG. 3

MUSTACHE STYLING DEVICE

The present invention relates generally to personal grooming and pertains, more specifically, to a device for aid in styling a mustache.

The recent resurgence of mustaches as a style among young men, as well as the continuation of mustaches as a fashion for older men, has given rise to the need for a simple and effective device which could aid not only in the selection of an appropriate mustache style, but in the attainment and maintenance of the particular selected style. Such a device would contribute a useful implement to the fashion industry.

It is therefore an object of the invention to provide a device for styling a mustache, in which device a template having a selected outline pattern is held conveniently and securely in place over a mustache to enable trimming around the template to attain the desired mustache style.

Another object of the invention is to provide a template-type mustache styling device in which the template can be cut by the user to any desired shape and then held in place above the upper lip for evaluation of the style, as well as for a guide in trimming the mustache to the selected configuration.

A further object of the invention is to provide simplified means by which a mustache template can be located properly for use as a trimming guide without requiring the use of the user's hands to maintain the template in place.

A still further object of the invention is to provide a simplified, knock-down construction in a mustache styling device so as to promote ease of packing and carrying as well as ease of cleaning, assembly and use.

The above objects, as well as still further objects and advantages, are attained by the invention which may be described briefly as a device for providing a pattern for styling a person's mustache, the device comprising a template for providing a selected mustache pattern, the template having an obverse surface and a reverse surface, clamping means receivable within the mouth, and means for attaching the template to the clamping means, the attaching means locating the template such that the reverse surface will be juxtaposed with the upper lip when the clamping means are held within the mouth of the person, and the clamping means including placement means responsive to clamping pressure of the mouth on the clamping means to urge the template toward the upper lip.

The invention will be more fully understood, while still further objects and advantages will become apparent, in the following detailed description of an embodiment of the invention illustrated in the accompanying drawing, in which:

FIG. 1 is a pictorial view of a device constructed in accordance with the invention and shown in place upon a user;

FIG. 2 is a perspective view of the device; and

FIG. 3 is a side elevational view of the device illustrating its operation.

Referring now to the drawing, and especially to FIG. 1 thereof, a device constructed in accordance with the invention is illustrated generally at 10 and is seen to be in place upon the face 12 of a person 14 who is using the device to style a mustache on his upper lip 16, just above his mouth 18.

As best seen in FIG. 2, as well as in FIG. 1, the mustache styling device 10 includes a template 20 which has been shaped to an outline pattern 22 corresponding to the shape of the mustache desired by the person 14.

Template 20 has an integral clip 24 projecting forward from the obverse surface 26 of the template. Clip 24 is removably received on a complementary holder 27 located at the top of a pedestal 28 formed of two bowed, wire-like members 29. The lower ends 30 (see FIG. 3) of the members 29 are received within sockets 32 in a forward end 34 of an upper clamping member shown in the form of upper plate 36. A lower clamping member in the form of lower plate 38 having a forward end 39 is juxtaposed with the upper plate 36 and is held in place, relative to the upper plate, by holding means in the form of a pair of U-shaped members 40.

The U-shaped members 40 are also wire-like and include a base portion 42 and legs 44 extending rearwardly from the base portion longitudinally generally parallel to one another. The legs 44 are received in complementary sockets 46 in the forward ends 34 and 39 of the upper and lower plates 36 and 38 and hold the plates 36 and 38 juxtaposed with one another in generally parallel relationship.

When it is desired to put the device 10 to use, the template 20 is located on the holder 27 and the plates 36 and 38 are placed in the mouth 18, as seen in FIG. 1. Referring now to FIG. 3, the user's teeth are then placed against the outer surfaces 50 and 52 of the upper and lower plates 36 and 38, respectively, and are made to exert a clamping force, in the direction of arrows 54 and 56, tending to urge the plates toward one another against the resilient biasing forces of the U-shaped members 40, which tend to return the plates to the more-or-less open, parallel relationship illustrated in phantom in FIG. 3 (and in full lines in FIG. 2). The teeth are located and retained upon the outer surfaces 50 and 52 with the aid of transverse ridges 58 and 60 located on the surfaces 50 and 52, respectively.

The inward forces represented by arrows 54 and 56 will rock the plates 36 and 38 about the base portions 42 of U-shaped members 40 and will thus swing the pedestal 28 backwards, that is, toward the rearward ends 62 and 64 of the plates 36 and 38, respectively, to bring the template 20 back toward the user's upper lip 16. In this manner, the pedestal serves as placement means assuring that the template is properly located in juxtaposition with the upper lip. The wire-like members 29 enable the height of the pedestal 28 to be adjusted to a particular person 14 by merely bending the members 29 to the desired height.

The reverse surface 66 of the template 20 is concave so as to match the profile contour of the mustache against which the template is placed. Thus, the template 20 can be utilized as a guide for trimming a mustache to a desired contour.

Where no mustache is present, template 20 serves as a convenient means by which the user can determine if a particular style mustache is suitable for his face. To this end, the template preferably is fabricated of an easily cut material, such as a synthetic resin material, and can be provided in the form of blanks, as illustrated in phantom at 70 in FIG. 2, which can be cut to any desired shape by the user of device 10.

Materials such as polyethylene, polystyrene, celluloid, and polyvinylchloride are suitable for template

blanks. Other suitable materials will be apparent to those skilled in the art of materials.

The illustrated construction of device 10 lends itself to a knock-down arrangement which is well-suited to compact storage for travel and for ease of cleaning, as well as ease of manufacture. Thus, the plates 36 and 38 may be identical molded plastic items and the sockets 32 and 46 may be resiliently dilatable to receive the complementary wire-like members 29 and 40 in a temporary assembly which is easily dismantled. The templates 20 are easily replaced in the assembly by virtue of the clip 24 and holder 27.

It is to be understood that the above detailed description of an embodiment of the invention is provided by way of example only. Various details of design and construction may be modified without departing from the true spirit and scope of the invention as set forth in the appended claims.

The embodiments of the invention in which an exclusive property or privilege is claimed are defined as follows:

1. A device for providing an outline pattern for styling a person's mustache, said device comprising:

a template for providing a prescribed mustache outline pattern, said template having an obverse surface and a reverse surface;

clamping means receivable within the mouth; and means for attaching the template to the clamping means, said attaching means locating the template such that the reverse surface will be juxtaposed with the person's upper lip when the clamping means are held within the mouth of the person; said clamping means including placement means responsive to clamping pressure of the mouth on the clamping means to urge the template toward the upper lip.

2. The invention of claim 1 wherein the clamping means include:

upper and lower clamping members; means for holding said members juxtaposed with one another;

means resiliently biasing the upper and lower clamping members away from one another to normally hold said members spaced from one another;

said clamping members having outer surfaces engageable by the mouth for exerting clamping pressure upon said members to urge the members toward one another against the resilient biasing means;

said holding means being arranged to cause rocking of the clamping members relative to one another upon exertion of said clamping pressure;

said placement means being responsive to the rocking of at least one clamping member toward the other to swing the attaching means, and the template therewith, toward the upper lip.

3. The invention of claim 2 wherein said outer surfaces include at least one transverse ridge engageable by the teeth of the person's mouth.

4. The invention of claim 2 wherein the reverse surface of the template is concave.

5. The invention of claim 2 wherein the template is constructed of a material, such as a synthetic resin material, which is readily cut to a desired outline pattern.

6. The invention if claim 1 wherein:

the clamping means include

upper and lower plates, each extending longitudinally between opposite ends, said plates having outer surfaces engageable by the mouth for exerting clamping pressure upon said plates to urge the plates toward one another;

at least one generally U-shaped member having a base portion and opposite legs extending longitudinally from the base, each leg being affixed to a plate at one end thereof to hold the plates juxtaposed with one another, said legs being resiliently deflectable toward one another such that upon the exertion of clamping pressure adjacent the other ends of the plates, in the direction tending to urge the plates toward one another, the plates will rock about the base portion of the U-shaped member; and

the placement means include:

an upwardly extending pedestal affixed to said one end of the upper plate;

said attaching means being carried by the pedestal for swinging movement longitudinally in the direction toward the other ends of the plates as the plates are urged toward one another.

7. The invention of claim 6 wherein the plates include sockets in said one end of each plate and the clamping means include a pair of U-shaped members having legs received within said sockets to hold the plates in said juxtaposed relationship.

8. The invention of claim 6 wherein said outer surfaces include at least one transverse ridge engageable by the teeth of the person's mouth.

9. The invention of claim 6 wherein the reverse surface of the template is concave.

10. The invention of claim 6 wherein the template is constructed of a material, such as a synthetic resin material, which is readily cut to a desired outline pattern.

* * * * *