



US010751514B2

(12) **United States Patent**
Brenizer et al.

(10) **Patent No.:** **US 10,751,514 B2**

(45) **Date of Patent:** **Aug. 25, 2020**

(54) **GUIDE EXTENSION CATHETER**

(71) Applicant: **Teleflex Life Sciences Limited**,
Valletta, MT (US)

(72) Inventors: **Joshua Brenizer**, Maple Grove, MN
(US); **Dean Peterson**, Minneapolis, MN
(US)

(73) Assignee: **Teleflex Life Sciences Limited**, Valletta
(MT)

(*) Notice: Subject to any disclaimer, the term of this
patent is extended or adjusted under 35
U.S.C. 154(b) by 409 days.

(21) Appl. No.: **15/581,176**

(22) Filed: **Apr. 28, 2017**

(65) **Prior Publication Data**

US 2018/0161547 A1 Jun. 14, 2018

Related U.S. Application Data

(60) Provisional application No. 62/431,911, filed on Dec.
9, 2016, provisional application No. 62/440,438, filed
on Dec. 30, 2016.

(51) **Int. Cl.**

A61M 25/06 (2006.01)

A61M 25/01 (2006.01)

A61M 25/00 (2006.01)

(52) **U.S. Cl.**

CPC **A61M 25/0662** (2013.01); **A61M 25/0023**
(2013.01); **A61M 25/0045** (2013.01);

(Continued)

(58) **Field of Classification Search**

CPC **A61M 25/0662**; **A61M 25/0023**; **A61M**
25/0045; **A61M 25/0113**;

(Continued)

(56) **References Cited**

U.S. PATENT DOCUMENTS

4,000,739 A 1/1977 Stevens

4,289,128 A 9/1981 Rusch

(Continued)

FOREIGN PATENT DOCUMENTS

CA 2008784 C 7/2002

DE 69928825 7/2006

(Continued)

OTHER PUBLICATIONS

Vascular Solutions, Inc. "GuideLiner V3 catheter: Guide Extension
Catheter with Half-Pipe Technology" [Brochure], Dec. 2013, Min-
neapolis, MN.

(Continued)

Primary Examiner — Scott J Medway

Assistant Examiner — Courtney B Fredrickson

(74) *Attorney, Agent, or Firm* — Gregory W. Smock;

Robert B. Madden

(57) **ABSTRACT**

Guide extension catheters and related methods are disclosed. A guide extension catheter can comprise an elongate tube member and a lumenless push member. The push member can be eccentrically coupled to the tube member for slidably positioning the tube member within and partially beyond a distal end of a guide catheter. At least a proximal end portion of the push member can include a cross-section defined by an arcuate first surface and an opposing second surface. The first surface can engage an inner wall surface of the guide catheter along an arc length, and the second surface can be spaced furthest from the first surface at its center point. The first surface can have the same or substantially the same radius of curvature as the guide catheter's inner wall surface, and the second surface can be flat or substantially flat. This configuration of the push member can provide an advantageous blend of stiffness and flexibility, as well as space conservation through the guide catheter.

20 Claims, 7 Drawing Sheets

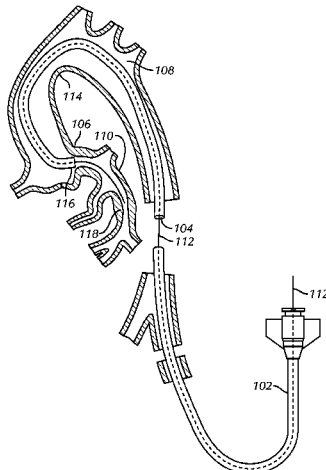

- (52) **U.S. Cl.**
 CPC *A61M 25/0052* (2013.01); *A61M 25/0068*
 (2013.01); *A61M 25/0102* (2013.01); *A61M*
25/0113 (2013.01); *A61M 2025/0047*
 (2013.01); *A61M 2025/0175* (2013.01)

- (58) **Field of Classification Search**
 CPC .. *A61M 2025/0113*; *A61M 2025/0047*; *A61M*
2025/0175

See application file for complete search history.

(56) **References Cited**

U.S. PATENT DOCUMENTS

4,723,936 A	2/1988	Buchbinder et al.	5,902,290 A	5/1999	Peacock et al.
4,762,129 A	8/1988	Bonzel	5,911,715 A	6/1999	Berg et al.
4,813,930 A	3/1989	Elliott	5,961,510 A	10/1999	Fugoso et al.
4,832,028 A	5/1989	Patel	5,980,486 A	11/1999	Enger
4,838,268 A	6/1989	Keith et al.	6,042,578 A	3/2000	Dinh et al.
4,838,269 A	6/1989	Robinson et al.	6,071,273 A	6/2000	Euteneuer et al.
4,909,252 A	3/1990	Goldberger	6,159,195 A	12/2000	Ha et al.
4,921,483 A	5/1990	Wijay et al.	6,190,358 B1	2/2001	Fitzmaurice et al.
4,932,413 A	6/1990	Shockey et al.	6,193,686 B1	2/2001	Estrada et al.
4,943,278 A	7/1990	Euteneuer et al.	6,199,262 B1	3/2001	Martin
4,946,440 A	8/1990	Hall	6,270,465 B1	8/2001	Keith et al.
4,994,745 A	2/1991	Mizuta	6,299,628 B1	10/2001	Harrison et al.
5,002,531 A	3/1991	Bonzel	6,338,725 B1	1/2002	Hermann et al.
5,040,548 A	8/1991	Yock	6,398,773 B1	6/2002	Bagaoisan et al.
5,061,273 A	10/1991	Yock	6,409,863 B1	6/2002	Williams et al.
5,074,845 A	12/1991	Miraki et al.	6,443,912 B1	9/2002	Mazzola et al.
5,098,412 A	3/1992	Shiu	6,475,195 B1	11/2002	Voda
5,102,403 A	4/1992	Alt	6,488,655 B1	12/2002	Wantink et al.
5,120,323 A	6/1992	Shockey et al.	6,503,223 B1	1/2003	Sekido et al.
5,122,125 A	6/1992	Deuss	6,503,353 B1	1/2003	Peterson et al.
5,156,594 A	10/1992	Keith	6,548,010 B1	4/2003	Stivland et al.
5,232,445 A	8/1993	Bonzel	6,575,958 B1	6/2003	Happ et al.
5,234,416 A	8/1993	Macaulay et al.	6,591,472 B1	7/2003	Noone et al.
5,257,974 A	11/1993	Cox	6,595,952 B2	7/2003	Forsberg
5,267,958 A	12/1993	Buchbinder et al.	6,610,068 B1	8/2003	Yang
5,290,247 A	3/1994	Crittenden	6,620,149 B1	9/2003	Lenz et al.
5,328,472 A	7/1994	Steinke et al.	6,635,029 B1	10/2003	Venturelli
5,350,395 A	9/1994	Yock	6,638,268 B2	10/2003	Niazi
5,368,567 A	11/1994	Lee	6,648,874 B2	11/2003	Parisi et al.
5,383,853 A	1/1995	Jung et al.	6,689,144 B2	2/2004	Gerberding
5,413,560 A	5/1995	Solar	6,706,018 B2	3/2004	Westlund et al.
5,415,639 A	5/1995	VandenEinde et al.	6,733,487 B2	5/2004	Keith et al.
5,439,445 A	8/1995	Kontos	6,755,812 B2	6/2004	Peterson et al.
5,441,489 A	8/1995	Utsumi et al.	6,860,876 B2	3/2005	Chen
5,445,624 A	8/1995	Jimenez	6,997,908 B2	2/2006	Carrillo, Jr. et al.
5,445,625 A	8/1995	Voda	7,169,162 B2	1/2007	Garakani
5,451,209 A	9/1995	Ainsworth et al.	7,232,452 B2	6/2007	Adams et al.
5,472,425 A	12/1995	Teirstein	7,294,124 B2	11/2007	Eidenschink
5,489,278 A	2/1996	Abrahamson	7,374,560 B2	5/2008	Ressemann et al.
5,527,292 A	6/1996	Adams et al.	7,422,579 B2	9/2008	Wahr et al.
5,531,721 A	7/1996	Pepin et al.	7,544,201 B2	6/2009	Pepper
5,545,149 A	8/1996	Brin et al.	7,604,612 B2	10/2009	Ressemann et al.
5,549,553 A	8/1996	Ressemann et al.	7,697,996 B2	4/2010	Manning et al.
5,562,620 A	10/1996	Klein et al.	7,717,899 B2	5/2010	Bowe et al.
5,567,203 A	10/1996	Euteneuer et al.	7,736,355 B2	6/2010	Itou et al.
5,571,087 A	11/1996	Ressemann et al.	7,762,984 B2	7/2010	Kumoyama et al.
5,578,009 A	11/1996	Kraus et al.	7,763,012 B2	7/2010	Petrick et al.
5,599,326 A	2/1997	Carter	7,959,603 B2	6/2011	Wahr et al.
5,620,417 A	4/1997	Jang et al.	8,048,032 B2	11/2011	Root et al.
5,649,909 A	7/1997	Cornelius	8,142,413 B2	3/2012	Root et al.
5,658,263 A	8/1997	Dang et al.	8,292,850 B2	10/2012	Root et al.
5,690,613 A	11/1997	Verbeek	8,814,890 B2	8/2014	Miyata et al.
5,704,926 A	1/1998	Sutton	RE45,380 E	2/2015	Root et al.
5,720,300 A	2/1998	Fagan et al.	8,996,095 B2 *	3/2015	Anderson A61M 25/0105 600/434
5,720,724 A	2/1998	Ressemann et al.	9,144,662 B2 *	9/2015	Di Caprio A61M 25/0068
5,743,876 A	4/1998	Swanson	RE45,760 E	10/2015	Root et al.
5,772,642 A	6/1998	Ciamacco et al.	RE45,776 E	10/2015	Root et al.
5,776,141 A	7/1998	Klein et al.	9,352,123 B2 *	5/2016	Zhou A61M 25/0069
5,785,685 A	7/1998	Kugler et al.	RE46,116 E	8/2016	Root et al.
5,792,124 A	8/1998	Horrigan et al.	9,486,611 B2 *	11/2016	Petersen A61M 25/01
5,843,022 A	12/1998	Willard et al.	10,173,029 B2	1/2019	Webster et al.
5,860,963 A	1/1999	Azam et al.	RE47,379 E	5/2019	Root et al.
5,891,056 A	4/1999	Ramzipoor	2001/0016712 A1	8/2001	Hamilton
			2002/0165598 A1	11/2002	Wahr et al.
			2003/0195546 A1	10/2003	Solar et al.
			2003/0233117 A1	12/2003	Adams et al.
			2004/0010280 A1	1/2004	Adams et al.
			2004/0127927 A1	7/2004	Adams
			2004/0236215 A1	11/2004	Mihara et al.
			2005/0004523 A1	1/2005	Osborne et al.
			2005/0015073 A1	1/2005	Kataishi et al.
			2005/0182437 A1	8/2005	Bonnette et al.
			2006/0247661 A1	11/2006	Richards et al.
			2007/0260219 A1	11/2007	Root et al.
			2008/0243171 A1	10/2008	Ressemann et al.
			2009/0005755 A1	1/2009	Keith et al.
			2009/0264865 A1	10/2009	Kawai
			2013/0072904 A1	3/2013	Musbach et al.

(56)

References Cited

U.S. PATENT DOCUMENTS

2013/0116701	A1	5/2013	Wang et al.	
2013/0197483	A1	8/2013	Anderson et al.	
2014/0018773	A1	1/2014	Wang et al.	
2014/0039461	A1	2/2014	Anderson et al.	
2014/0081243	A1	3/2014	Zhou et al.	
2014/0142506	A1	5/2014	Prindle et al.	
2014/0276618	A1	9/2014	Di Caprio et al.	
2015/0151090	A1*	6/2015	Sutton	A61M 25/0662 600/585
2016/0346515	A1	12/2016	Buller et al.	

FOREIGN PATENT DOCUMENTS

EP	0313558	B1	1/1991
EP	0380873	B1	5/1994
EP	0365993	B1	12/1994
EP	0881921	A1	12/1998
EP	1084728	A1	3/2001
EP	099260	B1	9/2007
JP	2004275435	A	10/2004
WO	1984003633	A1	9/1984
WO	1997037713	A1	10/1997
WO	2000024451	A9	11/2000
WO	2016191415	A1	12/2016
WO	2017019900	A1	2/2017

OTHER PUBLICATIONS

PCT International Search Report dated Apr. 29, 2019, in PCT application No. PCT/US2019/016234.

Bertrand, Michel E. "The Evolution of Cardiac Catheterization and Interventional Cardiology," European Society of cardiology, 2006, 10 pages.

Bonzel, T. et al. "The Sliding Rail System (Monorail): Description of a New Technique for Intravascular Instrumentation and its Application to Coronary Angioplasty," Z. Kardiol. 76, Supp. 6 (1987), pp. 119-122.

Iqbal et al. "Coronary stents: historical development, current status and future directions," British Medical Bulletin, 2013, 106: 193-211.

Topol, Eric J. "Textbook of Interventional Cardiology," Saunders Elsevier, 5th Edition, 2008, p. 277-280.

Tully, Shawn. "Blood Feud This little piece of metal is worth \$4.5 billion this year, generates more profits than a blockbuster drug, and has sparked one of the weirdest corporate battles ever. It could also save your life." CNN Money, May 31, 2004, 5 pages. Retrieved Jan. 14, 2019 on the Internet: .

Takahashi, Saeko. "New Method to Increase a Backup Support of a 6 French Guiding Coronary Catheter," Catheterization and Cardiovascular Interventions 63:452-456 (2004), 5 pages, published online in Wiley InterScience (www.interscience.wiley.com).

EP search report dated Apr. 16, 2018, in European Application No. 17193571.1 filed Sep. 27, 2017.

PCT International Preliminary Report on Patentability dated Dec. 16, 2019, in PCT application No. PCT/US2019/016235.

* cited by examiner

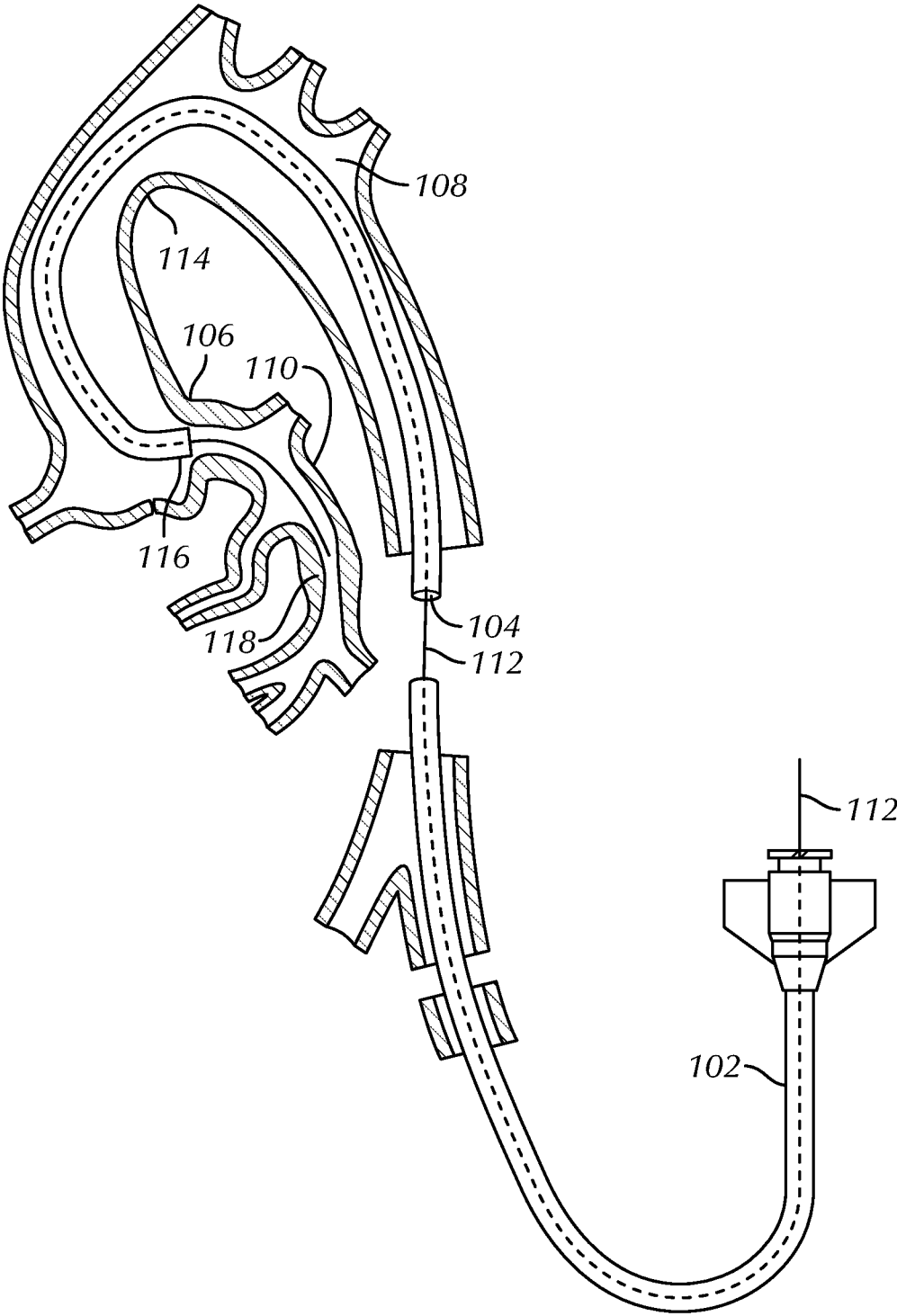

FIG. 1

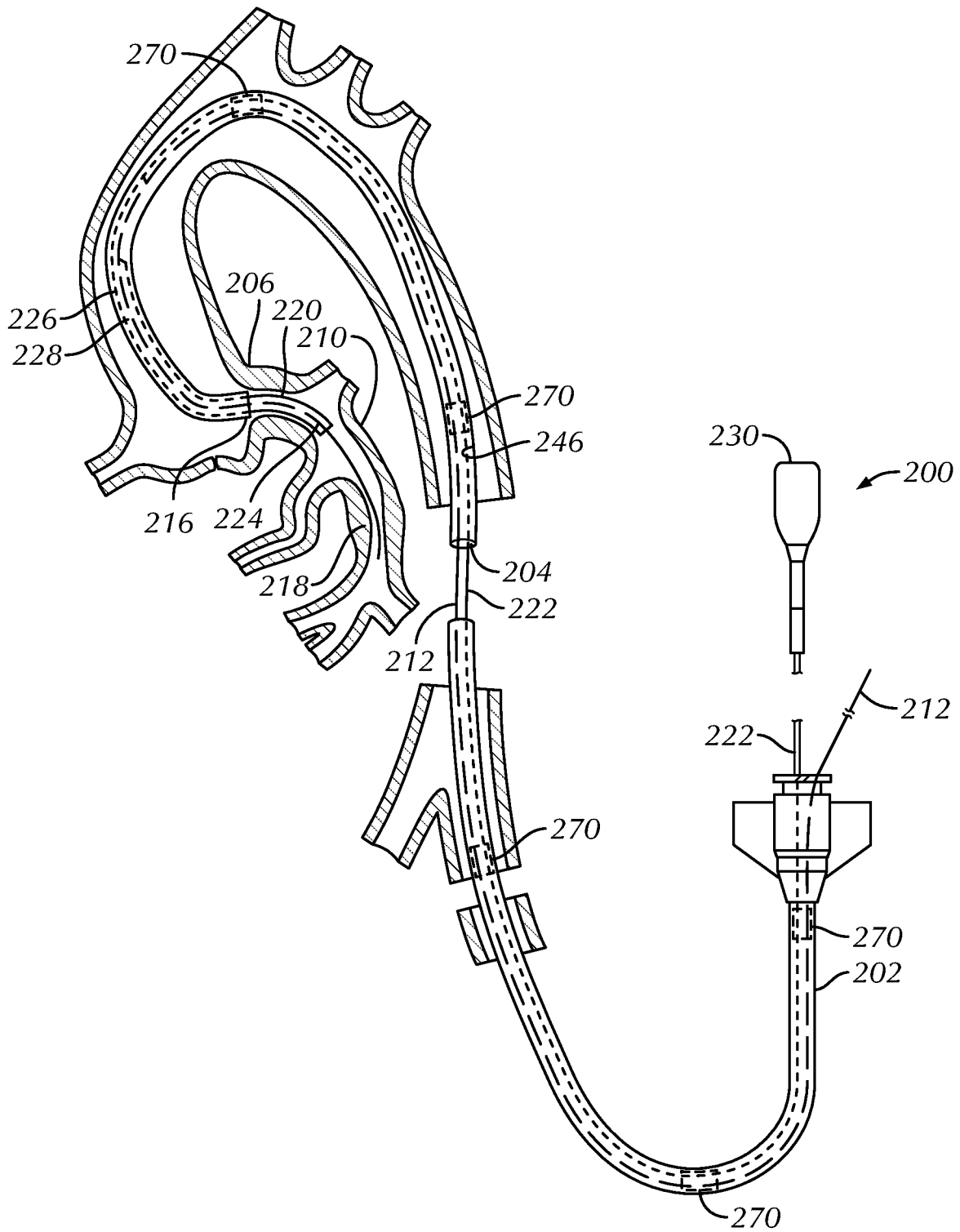

FIG. 2

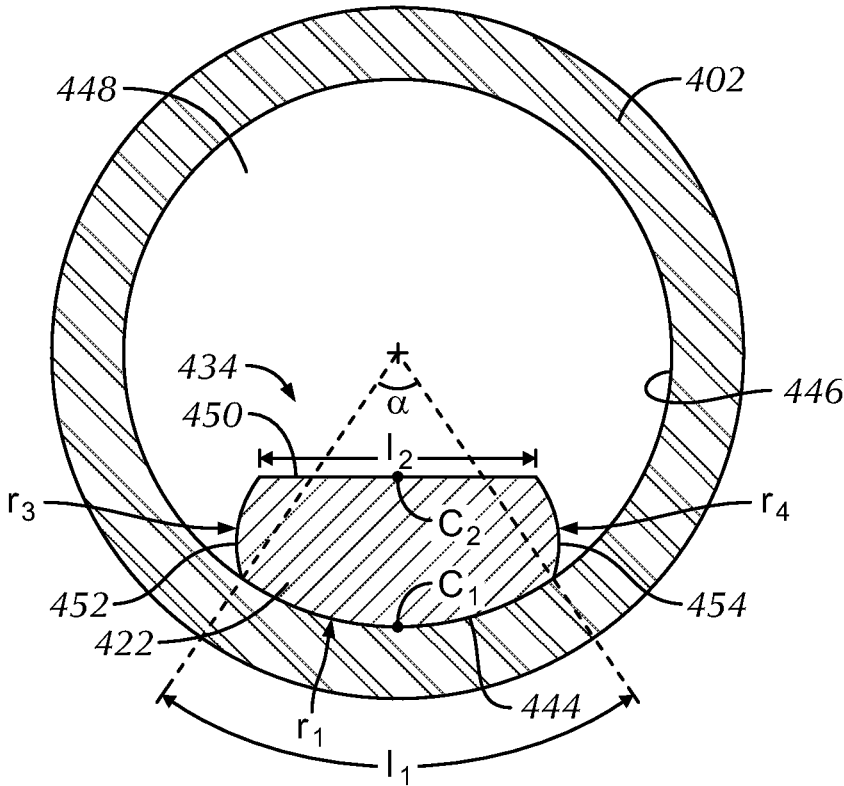

FIG. 4

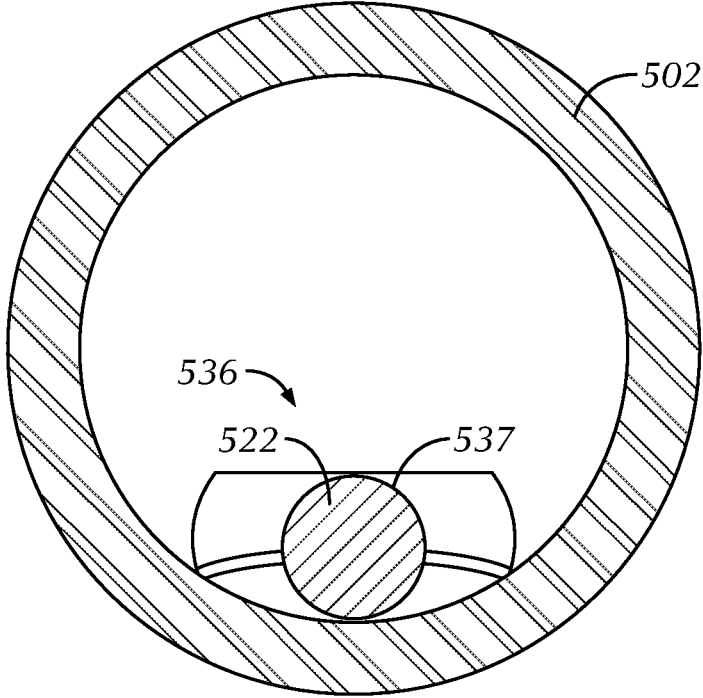

FIG. 5

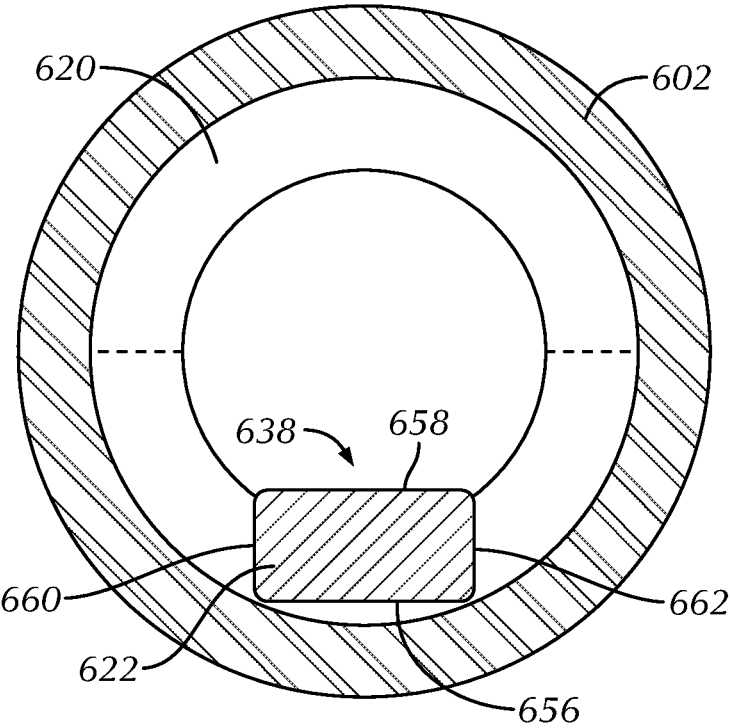

FIG. 6

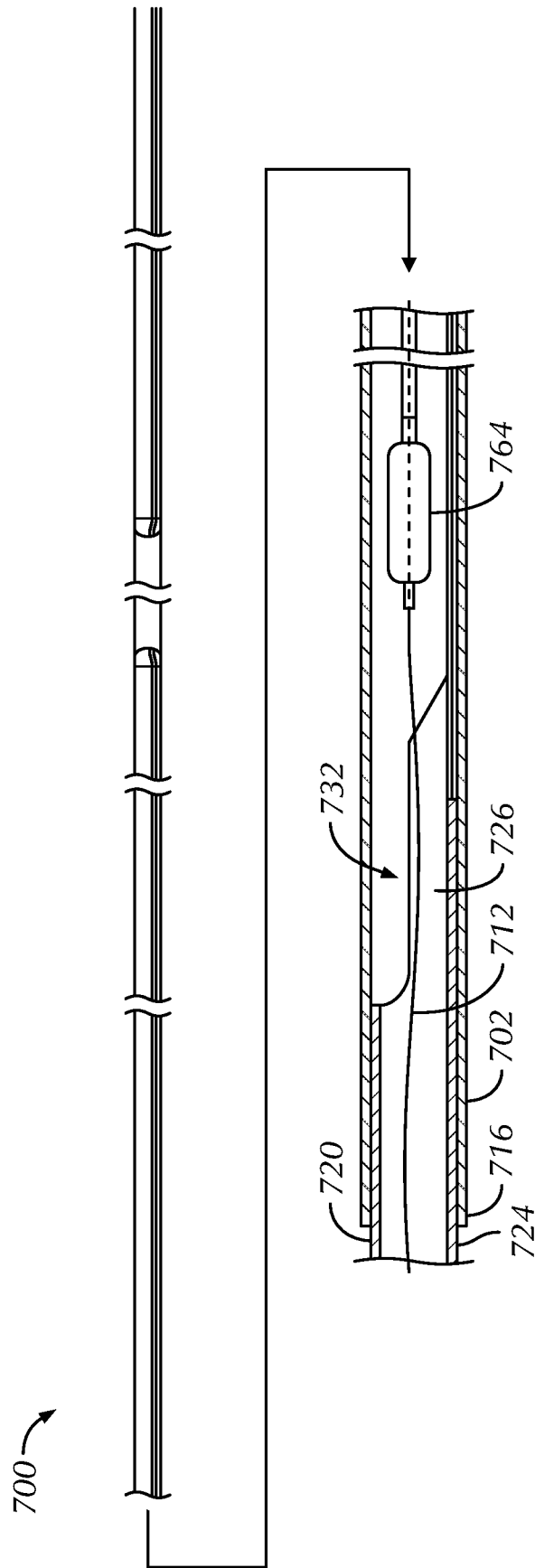

FIG. 7

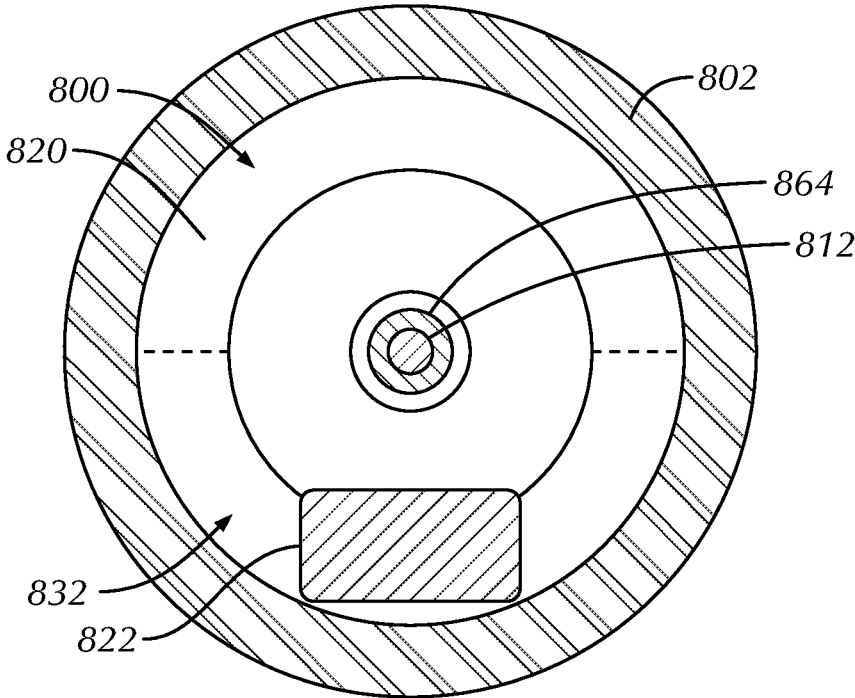

FIG. 8

GUIDE EXTENSION CATHETER

CLAIM OF PRIORITY

This non-provisional patent document claims the benefit of priority under 35 U.S.C. § 119(e) to Brenizer et al., U.S. Provisional Patent Application Ser. No. 62/431,911, entitled “GUIDE EXTENSION CATHETER” and filed on Dec. 9, 2016, and to Brenizer et al., U.S. Provisional Patent Application Ser. No. 62/440,438, entitled “GUIDE EXTENSION CATHETER” and filed on Dec. 30, 2016, each of which is herein incorporated by reference in its entirety.

TECHNICAL FIELD

This patent document relates to medical devices. More particularly, but not by way of limitation, the patent document relates to guide extension catheters for use with guide catheters.

BACKGROUND

A guide catheter can back-out and withdraw from a vessel’s ostium or branch when an interventional device, such as a guidewire, balloon catheter, stent or stent catheter, is passed through it and advanced beyond the guide catheter’s distal end. This backing out of the guide catheter can cause the operating physician to lose the ability to further distally advance the interventional device.

OVERVIEW

The present inventors recognize that there is a need to provide increased back-up support to interventional devices and guide catheters during interventional procedures. A guide extension catheter can be used in conjunction with a guide catheter to access discrete regions of coronary or peripheral vasculature and to facilitate accurate placement of interventional devices without guide catheter back-out from a vessel ostium or branch of interest. The guide extension catheter can also provide a means for delivering drugs or providing negative pressure to and from a treatment site. The present inventors further recognize that the interventional art would benefit from the availability of a guide extension catheter that can be effectively and efficiently urged through a guide catheter and have its distal end deep-seated into the vessel portion of interest without kinking or bending improperly, without reducing the device delivery area through the guide catheter, and without becoming entangled with a guidewire.

Guide extension catheters and related methods are disclosed in this patent document. A guide extension catheter can comprise an elongate tube member and a lumenless push member. The push member can be eccentrically coupled to the tube member for slidably positioning the tube member within and partially beyond a distal end of a guide catheter and a vessel ostium of interest. At least a proximal end portion of the push member can include a cross-section defined by an arcuate first surface and an opposing second surface. The first surface can engage an inner wall surface of the guide catheter along an arc length, and the second surface can be spaced furthest from the first surface at its center point. The first surface can have the same or substantially the same radius of curvature as the guide catheter’s inner wall surface, and the second surface can be flat or substantially flat, for example. This configuration of the push member can provide an advantageous blend of stiff-

ness, flexibility and space conservation through the guide catheter. The push member can include one or more means along its length to urge the push member to one side of the guide catheter’s inner wall surface, thereby providing a clear path through the guide catheter and into the guide extension catheter for an interventional device.

These and other embodiments and features of the present guide extension catheters and related methods will be set forth, at least in part, in the following Detailed Description. This Overview is intended to provide non-limiting embodiments of the present subject matter—it is not intended to provide an exclusive or exhaustive explanation of the disclosed embodiments. The Detailed Description below is included to provide further information about the present guide extension catheters and methods.

BRIEF DESCRIPTION OF THE DRAWINGS

In the drawings, like numerals can be used to describe similar features and components throughout the several views. The drawings illustrate generally, by way of example, but not by way of limitation, various embodiments discussed in this patent document.

FIG. 1 illustrates a plan view of a guide catheter advanced through an aorta to an ostium of a coronary vessel.

FIG. 2 illustrates a plan view of a guide extension catheter, as constructed in accordance with at least one embodiment, used in conjunction with a guide catheter for the delivery of an interventional device into an occluded vessel for treatment.

FIG. 3 illustrates a side view of a guide extension catheter, as constructed in accordance with at least one embodiment, partially within a sectioned guide catheter.

FIGS. 4-6 illustrate cross-sectional views along the length of a guide extension catheter’s push member, as constructed in accordance with at least one embodiment, within a guide catheter.

FIG. 7 illustrates a side view of a guide extension catheter, as constructed in accordance with at least one embodiment, and an interventional device partially within a sectioned guide catheter.

FIG. 8 illustrates a cross-sectional view of a guide extension catheter, as constructed in accordance with at least one embodiment, and an interventional device within a guide catheter.

The drawings are not necessarily to scale. Certain features and components may be shown exaggerated in scale or in schematic form, and some details may not be shown in the interest of clarity and conciseness.

DETAILED DESCRIPTION

This patent document discloses guide extension catheters to be placed within guide catheters for providing support and guidance in a vessel when percutaneously advancing interventional devices, such as guidewires, balloon catheters, stents or stent catheters. A guide extension catheter is configured to be passed through a main lumen of a guide catheter so that its distal end portion can be extended past a distal end of the guide catheter and into the desired vessel while its intermediate portions remain within the guide catheter. The guide extension catheter improves the ability of the guide catheter to remain seated in the desired vessel’s ostium or branch during an interventional procedure.

It is believed that the present guide extension catheters will find great utility by interventional cardiologists performing percutaneous transluminal coronary interventions.

Although the remainder of this patent document generally discusses and illustrates such uses, it should be understood that the guide extension catheters can also be used for treating other non-coronary diseased vessels or other hollow structures (e.g., biliary tract, ureter, etc.) throughout a patient's body where interventional devices are or can be employed.

Minimally-invasive cardiac interventions are utilized throughout the world and include the use of a guidewire 112 and a guide catheter 102, as illustrated in FIG. 1. The guidewire 112 is an elongate, small-diameter member designed to navigate vessels to reach a diseased site or vessel segment of interest. Guidewires come in two basic configurations: solid steel or nitinol core wires and solid core wire wrapped in a smaller wire coil or braid. The guide catheter 102 is an elongate tube member defining a main lumen 104 along its length. The guide catheter 102 can be formed of polyurethane, for example, and can be shaped to facilitate its advancement to a coronary ostium 106 (or other region of interest within a patient's body). In the embodiment of FIG. 1, a 4 F, 5 F, 6 F, 7 F or 8 F guide catheter 102, where F is an abbreviation for the French catheter scale (a unit to measure catheter diameter (1 F=1/4 mm)), can be inserted at a femoral or radial artery and advanced through an aorta 108 to a position adjacent to the ostium 106 of a coronary artery 110.

In a typical procedure, the guidewire 112 is advanced through the arch 114 of the aorta 108 to the ostium 106. The guide catheter 102 is then passed over the guidewire 112 until its distal end 116 is seated near the ostium 106. The diameter and rigidity of the guide catheter's distal end 116 oftentimes does not permit the device to be advanced beyond the ostium 106 and into the coronary artery 110.

Maintaining the position of the guide catheter's distal end 116 at the ostium 106 can facilitate the guidewire 112 or other interventional device successfully reaching the diseased site (e.g., a stenotic lesion 118) through its further distal advancement. With the guide catheter 102 in position, force can be applied to the guidewire's proximal end to push the guidewire 112 to and beyond the lesion 118, and a treating catheter (optionally including a balloon or stent) can be passed over the guidewire 112 to treat the site. The application of force to the guidewire 112 or the treating catheter can sometimes cause the guide catheter 102 to dislodge from the ostium 106 of the coronary artery 110, and, in such instances, the guidewire or treating catheter must be further distally advanced independently of the guide catheter's alignment and support to reach the lesion 118. This can occur in the case of a tough stenotic lesion 118 or tortuous anatomy, where it is difficult to pass the guidewire 112 or the treating catheter to and beyond the lesion. A heart's intrinsic beat can also cause the guide catheter's distal end 116 to lose its positioning or otherwise be shifted so that it no longer is positioned to align and support the guidewire 112 or the treating catheter into the portion of the coronary artery 110 including the lesion 118.

As illustrated in FIG. 2, the present guide extension catheter 200 can improve access to a coronary artery 210 and a stenotic lesion 218. The guide extension catheter 200 can include a relatively flexible elongate tube member 220 and a push member 222 having a collective length that is greater than a length of a guide catheter 202 (e.g., 130 cm-175 cm). An outer diameter of the tube member 220 can be sized to permit insertion of its distal end portion 224 into a coronary artery or its branches containing the lesion 218, thereby providing alignment and support for an interventional device (e.g., a treating catheter) beyond the distal end 216 of the

guide catheter 202 to the lesion and beyond. The extension of the tube member 220 into the smaller-sized artery or branch also serves to maintain the position of the guide catheter 202 at an artery's ostium 206 during operation.

The operating physician can advance the distal end portion 224 of the tube member 220 over a guidewire 212 and through and beyond the guide catheter's distal end 216 into the coronary artery 210. A proximal end portion 226 of the tube member 220 can remain within the guide catheter 202. The physician can then deliver the treating catheter over the guidewire 212, through a main lumen 204 of the guide catheter 202, and through a lumen 228 of the tube member 220 until the working portion of the treating catheter is located beyond the distal end portion 224 of the tube member. The operating physician can then treat the lesion 218 using standard techniques with added back-up support on the guide catheter 202, thereby providing an extra ability to push and advance the treating catheter.

In general, the lumen 228, and hence the tube member 220, can be sized and shaped to pass one or more interventional devices such as the guidewire and the treating catheter therethrough. The cross-sectional shape of the lumen 228 can be similar to the cross-sectional shape of the guide catheter's main lumen 204. The outer diameter of the tube member 220 can assume maximum cross-sectional dimensions that allow the tube member 220 to coaxially slide into and through the guide catheter 202. In other embodiments, the outer cross-sectional dimensions of the tube member 220 can be less than the allowable maximum. For example, in an 8 F guide catheter, the tube member 220 can have a 7 F, 6 F, 5 F, 4 F or lesser diameter. In some embodiments, a diameter of the lumen 228 of the tube member 220 is not more than one French size smaller than a diameter of the lumen 204 of the guide catheter 202. The length of the tube member 220 can be substantially less than the length of the guide catheter 202; however, the tube member 220 can be designed with any length according to a desired application, such as about 6 cm-45 cm.

The push member 222 can be attached at least to the proximal end portion 226 of the tube member 220 and can extend proximally from this attachment to a handle member 230 accessible to an operating physician outside of a patient's body. The handle member 230 and the push member 222 can allow the physician to position the tube member 220 between a first position, entirely within the guide catheter 202, and the illustrated second position, in which the tube member's distal end 224 extends beyond that of the guide catheter 202 and into the coronary artery 210. The push member 222 can include one or more tubular bands 270 or other means along its length to urge the member to one side of the guide catheter's inner wall surface 246, thereby providing a clear path through the guide catheter and into the guide extension catheter 202 for the guidewire 212 and treating catheter. This clear path can avoid or reduce the guidewire 212 becoming entangled with (e.g., wrapped around) the push member 222 during use of the guide extension catheter 202.

FIG. 3 illustrates a side view of a guide extension catheter 300 partially positioned within a guide catheter 302. This side view illustrates in greater detail the two primary components of the guide extension catheter 300—a relatively flexible elongate tube member 320 and a push member 322. In certain embodiments, the push member 322 can include a plurality of segments or portions having different stiffness and flexibility profiles to provide the guide extension catheter 300 with a desired combination of pushing force and vessel placement capabilities. In one embodiment, as shown

in cross-sections at FIGS. 4-6, the push member 322 can include three segments 334, 336, 338 having different stiffness and flexibility profiles: relative high stiffness and low flexibility at a proximal end portion of the push member, relative medium stiffness and flexibility in an intermediate portion of the push member, and relative low stiffness and high flexibility at a distal end portion of the push member. In some embodiments, the length of the first segment 334 makes up between 50% to 90% of the entire length of the guide extension catheter 300, the length of the third segment 338 makes up between 2% to 10% of the catheter's length, and the remaining length can be attributed to the second segment 336. More or less segments of differing stiffness and flexibility profiles can also be used and accomplished through variation of one or more of materials, geometrical shapes or geometrical sizes of the push member 322.

The push member 322 can be an elongated solid wire of constant or varying dimensions and can be made of a polymeric or metallic material, such as high tensile stainless steel (e.g., 304V, 304L or 316LV), mild steel, nickel-titanium alloys, nickel-chromium-molybdenum alloys, nickel-copper alloys, nickel-tungsten alloys or tungsten alloys. The push member 322 can be coated with a hydrophilic, silicone or other friction-reducing material. A handle member (FIG. 2) at the push member's proximal end can be formed of a polycarbonate material, for example.

The tube member 320 can be formed from an inner polymer layer, an outer polymer layer, and a reinforcement member (e.g., braid or coil) disposed between the polymer layers. The inner polymer layer can be composed of, or coated with, silicone, polytetrafluoroethylene (PTFE) or another lubricious material to provide a slippery surface for received interventional devices. The outer polymer layer can include one or more flexible materials, such as polyurethane, polyethylene or polyolefin of sequentially diminishing durometers along the tube member's length, and it can be coated with a friction-reducing material (e.g., a hydrophilic material) to facilitate insertion and trackability through vasculature and a guide catheter. The reinforcing braid or coil can be formed of stainless steel or a platinum alloy, for example, and can extend between the polymer layers along at least a portion of the tube member's length.

A proximal end portion 326 of the tube member 320 can be eccentrically coupled to a distal end portion 340 of the push member 322 at its periphery or circumference and can provide a smooth transition between the members. The arrangement or configuration of this coupling can vary. For example, the tube member 320 can have an opening formed in its peripheral wall and the push member 322 can be disposed within the opening. Inserting the push member 322 into the opening can result in a mechanical coupling between the members and additional or alternative bonds (e.g., adhesive bonds, thermal bonds, welds, brazes, etc.) can be utilized. The distal end portion 340 of the push member 322 can be flattened to provide a larger surface area to secure to the tube member 320. Coupling mechanisms facilitated by a third component 332 (e.g., a metal or polymer skived (slanted) collar or concave track) bonded between or integrated with the proximal end portion 326 of the tube member 320 or the distal end portion 340 of the push member 322 are also contemplated. Metallic or polymeric structures forming the third component 332 can become less stiff and more flexible in a proximal-to-distal direction to provide a gradual flexibility transition between the more rigid push member 322 and the more flexible tube member 320.

Markers on the push member 322 or the tube member 320 can allow an operating physician to identify positioning of

the guide extension catheter's components relative to patient anatomy, the guide catheter 302, and any interventional devices used during a procedure. For example, one or more depth markers can be printed on an outer surface of the push member 322 and can be positioned at predetermined lengths relative to a distal end of the tube member 320. One or more radiopaque marker bands can be positioned on the tube member 320. The marker bands can be composed of tungsten, platinum or an alloy thereof and can have a metallic band structure. Alternatively, for space conservation reasons, the marker bands can be formed by impregnating portions of the tube member 320 with a radiopaque filler material, such as barium sulfate, bismuth trioxide, bismuth carbonate, powdered tungsten, powdered tantalum or the like. A first marker band can be positioned slightly distal to a fully-round entrance of the tube member 320 and a second marker band can be positioned near the tube member's distal end, for example.

FIG. 4 illustrates a cross-sectional view of a proximal end portion 434 of a push member 422, such as along line 4-4 of FIG. 3, within a guide catheter 402. The cross-section can be defined by an arcuate first surface 444 configured to engage an inner wall surface 446 of the guide catheter 402 along an arc length (l_1) (e.g., 0.030 in) defined by a guide catheter central angle (α) of at least 20 degrees, at least 30 degrees, at least 40 degrees, at least 50 degrees or at least 60 degrees, with greater arc lengths (l_1) associated with greater central angles (α). The arcuate or curved shape of the first surface 444 follows the inner wall surface 446 of the guide catheter 402 providing smooth relative movements between the guide extension catheter and the guide catheter. The arcuate shape of the first surface 444 can also help to maximize axial or column strength of the push member 422 for force transfer from an operating physician to the rest of the guide extension catheter without reducing the effective delivery area 448 within the guide catheter 402 through which an interventional device can be advanced. In an embodiment, the first surface 444 can have the same or substantially the same radius of curvature (r_1) as the guide catheter's inner wall surface 446, such as a radius of curvature of about 0.035 in.

A second surface 450 of the proximal end portion's cross-section, which is positioned opposite the first surface 444, can be flat or substantially flat and have a length (l_2) (e.g., 0.026 in) that is less than the arc length (l_1) of the first surface. The second surface 450 can be spaced furthest from the first surface at its center point (c_2). In an embodiment, the center point (c_2) of the second surface 450 is at least 0.010 in (e.g., 0.014 in) from a center portion (c_1) of the first surface 444. In an embodiment, a distance between center points (c_1 , c_2) of the first and second surfaces 444, 450 can be between 40-60% of the arc length (l_1) of the first surface.

The cross-section at the proximal end portion of the push member 422 can be further defined by third and fourth arcuate surfaces 452, 454 that connect the first and second surfaces 444, 450. The third and fourth surfaces 452, 454 can have a radius of curvature ($r_{3,4}$) less than the radius of curvature (r_1) of the first surface 444. In an embodiment, the radius of curvature (r_1) of the first surface (e.g., 0.035 in) is at least three times greater than the radius of curvature ($r_{3,4}$) of the third and fourth surfaces (e.g., 0.010 in).

It has been found that this cross-sectional configuration of the proximal end portion 434 of the push member 422 can be desirable for a number of reasons. The configuration, which resembles a bread loaf in its cross-sectional shape, can increase the push force capability and the torque control of the push member 422 as compared to a flat rectangular

ribbon. Accordingly, greater axial and rotational force applied by the operating physician to the push member's proximal end portion **434** can be transmitted to the tube member. In this manner, the tube member can more reliably be urged through obstructions or into a tortuous portion of the patient's vasculature.

FIG. 5 illustrates a cross-sectional view of an intermediate portion **536** of a push member **522**, such as along line 5-5 of FIG. 3, within a guide catheter **502**. As shown, the intermediate portion **536** can be circular or oval in cross-section and defined by a circumferential surface **537**, which can reduce the tendency for a guidewire to become engaged with the push member **522** during use. In an embodiment, the circumferential surface **537** has a diameter of about 0.013 in.

Alternatively, the intermediate portion **536** can be rectangular in cross-section and defined by first, second, third and fourth flat surfaces, or can be bread loaf in cross-section and defined by three arcuate surfaces and one flat surface similar to the proximal end portion. In these alternative embodiments, a distance change between center points of the first and second surfaces at the push member's proximal end portion (FIG. 4) to center points of the first and second surfaces at the push member's intermediate portion is less than a distance change between center points of the third and fourth surfaces at the push member's proximal end portion to center points of the third and fourth surfaces at the push member's intermediate portion.

As yet another alternative, the intermediate portion **536** can have a cross-section defined by arcuate first and second surfaces. An arcuate first surface can have the same or substantially the same radius of curvature as the guide catheter's inner wall surface. An arcuate second surface can extend from a first end of the first surface to a second end of the first surface. Regardless of shape, the cross-section of the intermediate portion **536** of the push member can define an area less than an area of the cross-section of the proximal end portion (FIG. 4) of the push member **522**.

FIG. 6 illustrates a cross-sectional view of a distal end portion **638** of a push member **622**, such as along line 6-6 of FIG. 3, within a guide catheter **602**. The distal end portion **638** can be rectangular in cross-section and defined by first, second, third and fourth flat surfaces **656**, **658**, **660**, **662**. The cross-section of the distal end portion **638** can define an area less than an area of the cross-section of the proximal end (FIG. 4) and intermediate (FIG. 5) portions of the push member **622**. In an embodiment, the first and second surfaces **656**, **658** have a length of 0.020 in., and the third and fourth surfaces **660**, **662** have a length of 0.010 in. The cross-section of the stiffer proximal end portion can gradually transition along the length of the push member **622** to the more flexible cross-section of the distal end portion **638**, which can couple to a tube member **620**. The flattened rectangular cross-section of the distal end portion **638** can provide sufficient attachment surface area to attach the push member **622** to the tube member **620**. Alternatively, the distal end portion **638** can be bread loaf in cross-section and defined by three arcuate surfaces and one flat or substantially flat surface similar to the proximal end portion.

FIGS. 4-6 illustrate that the push member **422**, **522**, **622** of a guide extension catheter can be designed to be sufficiently small taking up relatively little space within the lumen of a guide catheter, while still being sufficiently sized and configured for exceptional pushability and kink resistance when advancing the extension catheter during an interventional procedure. Accordingly, use of the present guide extension catheters allows for an interventional device

to be advanced through and beyond the guide catheter in order to reach a desired distal target location for intervention.

FIG. 7 illustrates a side view of a guide extension catheter **700** positioned within a guide catheter **702** and used in conjunction with a guidewire **712** and a treating catheter **764**. With the guidewire **712** and the guide catheter **702** positioned as desired, a tube member **720** of the guide extension catheter **700** can be backloaded from its distal end portion **724** onto a proximal end of the guidewire **712** and advanced through a hemostasis valve coupled to the guide catheter **702**. As shown, the tube member **720** of the guide extension catheter **700** can be advanced beyond a distal end **716** of the guide catheter **702** under fluoroscopy. When so arranged, portions of the tube member **720** can engage an ostium and extend within a portion of a coronary artery to help maintain the position of the guide catheter **702** as the treating catheter **764** is advanced.

FIG. 8 illustrates a cross-sectional view of a guide extension catheter **800**, a guidewire **812** and a treating catheter **864** within a guide catheter **802**, such as along line 8-8 of FIG. 7. It can be seen that use of the present eccentrically-positioned push member **822** to adjust a position of a tube member **820** of the guide extension catheter **800** can provide several advantages. As a first example, the relatively small dimensions of the push member **822** create low surface friction during its longitudinal movement within the guide catheter **802**. Low frictional force allows ease in extending and retrieving the tube member **820**. As another example, the small cross-sectional dimensions of the push member **822** do not significantly interfere with the delivery of the treating catheter **864** through the guide catheter **802**.

Delivery of the treating catheter **764**, **864** through the guide catheter **702**, **802** and into the tube member **720**, **820** can be facilitated by a concave track **732**, **832** defining a partially cylindrical opening and having a length of about 1 cm to 18 cm. The concave track **732**, **832** is accessible from a longitudinal side defined transverse to a longitudinal axis of the tube member **720**, **820** and provides a larger area to receive an interventional device into the tube member than an area associated with an opening oriented perpendicular to the longitudinal axis of the tube member. Optionally, the concave track **732**, **832** can be sized larger than the tube member **720**, **820** (e.g., 7 F or 8 F outer diameter for the concave track and 6 F outer diameter for the tube member) to more effectively align and funnel the treating catheter **764**, **864** across the coupling transition and into the tube member **720**, **820**. This larger size of the concave track **732**, **832** can be accomplished by incorporating a nickel-titanium alloy, for example, which can expand post-implant to a size of the guide catheter's inner wall surface.

The concave track **732**, **832** can be positioned between or integrated with the proximal end portion of the tube member **720**, **820** or the distal end portion of the push member **722**, **822**. In an embodiment, a first segment of the concave track **732**, **832** can have an arcuate cross-sectional shape extending for a length of at least 0.5 cm and radially extending 25% to 40% of a cross-sectional circumference of the guide catheter **702**, **802** or the tube member **720**, **820**. A second segment of the concave track **732**, **832** can have a hemicylindrical cross-sectional shape extending for a length of at least 0.5 cm and radially extending 40% to 70% of a cross-sectional circumference of the guide catheter **702**, **802** or the tube member **720**, **820**.

In lieu of the concave track **732**, **832**, the proximal end portion **726** of the tube member **720**, **820** can be partially (e.g., top half only) or completely radially flared to be larger

in size than other portions of the tube member and coincide with the inner diameter of the guide catheter **702, 802**. The close fit between the flared proximal end portion and the guide catheter **702, 802** can be used to align and funnel the treating catheter **764, 864**, for example, from the guide catheter lumen into the tube member lumen, as well as direct fluid injected through the guide catheter into the tube member lumen. The flare can be accomplished by molding the tube member's **720, 820** proximal end portion or by incorporating a size- or shape-changing alloy (e.g., a nickel-titanium alloy) into the tube member's **720, 820** proximal end portion.

EXAMPLES

The above Detailed Description is intended to be illustrative and not restrictive. The above-described embodiments (or one or more features or components thereof) can be used in varying combinations with each other unless clearly stated to the contrary. Other embodiments can be used, such as by one of ordinary skill in the art upon reviewing the above Detailed Description. Also, various features or components have been grouped together to streamline the disclosure. This should not be interpreted as intending that an unclaimed disclosed feature is essential to any claim. Rather, inventive subject matter can lie in less than all features of a particular disclosed embodiment. Thus, the following claim examples are hereby incorporated into the Detailed Description, with each example standing on its own as a separate embodiment.

In Example 1, a guide extension catheter for use with a guide catheter can comprise an elongate tube member and a push member eccentrically coupled to the tube member. The tube member can define a lumen and have an outer diameter smaller than a lumen of the guide catheter. The push member can extend proximally from its point of coupling with the tube member for slidably positioning the tube member within and partially beyond a distal end of the guide catheter. At least a proximal end portion of the push member can include a cross-section defined by an arcuate first surface, which is configured to engage an inner wall surface of the guide catheter along an arc length defined by a guide catheter central angle of least 20 degrees, and a second surface, which is opposite the first surface and has a center point at least 0.010 inches from a center point of the first surface.

In Example 2, the guide extension catheter of Example 1 can optionally be configured such that the first surface of the push member's proximal end portion has the same radius of curvature as the guide catheter's inner wall surface.

In Example 3, the guide extension catheter of Example 2 can optionally be configured such that the cross-section of the proximal end portion of the push member is further defined by third and fourth arcuate surfaces that connect the first and second surfaces. The third and fourth surfaces can have a radius of curvature less than the radius of curvature of the first surface.

In Example 4, the guide extension catheter of Example 3 can optionally be configured such that the radius of curvature of the first surface is at least three times greater than the radius of curvature of the third and fourth surfaces.

In Example 5, the guide extension catheter of any one or any combination of Examples 1-4 can optionally be configured such that the second surface is flat.

In Example 6, the guide extension catheter of any one or any combination of Examples 1-5 can optionally be configured such that the push member is solid.

In Example 7, the guide extension catheter of any one or any combination of Examples 1-6 can optionally be configured such that an intermediate or distal end portion of the push member includes a rectangular cross-section defining an area less than an area of the cross-section of the proximal end portion of the push member.

In Example 8, the guide extension catheter of any one or any combination of Examples 1-7 can optionally be configured such that an intermediate or distal end portion of the push member includes a circular cross-section defining an area less than an area of the cross-section of the proximal end portion of the push member.

In Example 9, the guide extension catheter of any one or any combination of Examples 1-7 can optionally be configured such that an intermediate or distal end portion of the push member includes a cross-section defined by an arcuate first surface, which has the same or substantially the same radius of curvature as the guide catheter's inner wall surface, and an arcuate second surface, which extends from a first end of the first surface to a second end of the first surface.

In Example 10, the guide extension catheter of any one of Examples 7, 8 or 9 can optionally be configured such that the cross-sectional area of the distal end portion of the push member is less than the cross-sectional area of the intermediate portion of the push member.

In Example 11, the guide extension catheter of any one of Examples 7, 8 or 9 can optionally be configured such that a stiffness of the push member's proximal end portion is greater than a stiffness of the push member's intermediate and distal end portions.

In Example 12, the guide extension catheter of any one or any combination of Examples 1-11 can optionally be configured such that the arc length of the first surface is greater than a length of the second surface.

In Example 13, the guide extension catheter of any one or any combination of Examples 1-12 can optionally further comprise one or more bands along the length of the push member to urge it to one side of the guide catheter's inner wall surface.

In Example 14, the guide extension catheter of any one or any combination of Examples 1-13 can optionally be configured such that a diameter of the lumen of the tube member is not more than one French size smaller than a diameter of the lumen of the guide catheter.

In Example 15, the guide extension catheter of any one or any combination of Examples 1-14 can optionally further comprise a concave track defining a partially cylindrical opening leading into the tube member.

In Example 16, the guide extension catheter of Example 15 can optionally be configured such that a first segment of the concave track includes an arcuate cross-sectional shape.

In Example 17, the guide extension catheter of Example 16 can optionally be configured such that a second segment of the concave track includes a hemicylindrical cross-sectional shape.

In Example 18, the guide extension catheter of any one or any combination of Examples 1-14 can optionally be configured such that a proximal end of the tube member is partially or completely radially flared.

In Example 19, the guide extension catheter of any one or any combination of Examples 1-18 can optionally be configured such that a proximal end of the tube member is skived.

In Example 20, a guide extension catheter for use with a guide catheter can comprise an elongate tube member and a lumenless push member eccentrically coupled to the tube member at a distal end portion. The tube member can define

a lumen and have an outer diameter smaller than a lumen of the guide catheter. The push member can extend proximally from its point of coupling with the tube member for slidably positioning the tube member within and partially beyond a distal end of the guide catheter. A proximal end portion of the push member can include a cross-section defined by an arcuate first surface, which is configured to engage an inner wall surface of the guide catheter, and an opposing second surface, which is spaced furthest from the first surface as its center point. One or both of an intermediate portion and the distal end portion of the push member can include a cross-section defined by opposing first and second flat surfaces and opposing third and fourth flat surfaces.

In Example 21, the guide extension catheter of Example 20 can optionally be configured such that the proximal end portion of the push member has a proximal stiffness and the distal end portion of the push member has a distal stiffness, which is less than the proximal stiffness.

In Example 22, the guide extension catheter of any one of Examples 20 or 21 can optionally be configured such that the cross-section of the push member's proximal end portion transitions along the length of the push member to the cross-section of the push member's distal end portion.

In Example 23, the guide extension catheter of any one or any combination of Examples 20-22 can optionally be configured such that the proximal end portion has a relatively low flexibility, the distal end portion has a relatively high flexibility, and the intermediate portion has a middle flexibility between that of the relatively low flexibility of the proximal end portion and the relatively high flexibility of the distal end portion.

In Example 24, the guide extension catheter of any one or any combination of Examples 20-23 can optionally be configured such that the cross-section of the push member's proximal end portion is further defined by third and four arcuate surfaces that connect the first and second surfaces.

In Example 25, the guide extension catheter of Example 24 can optionally be configured such that a distance change between center points of the first and second surfaces at the push member's proximal end portion to center points of the first and second surfaces at the push member's intermediate portion is less than a distance change between center points of the third and fourth surfaces at the push member's proximal end portion to center points of the third and fourth surfaces at the push member's intermediate portion.

In Example 26, the guide extension catheter of any one or any combination of Examples 20-25 can optionally be configured such that a distance between center points of the first and second surfaces at the push member's proximal end portion is between 40%-60% of an arc length of the first surface at the push member's proximal end portion.

In Example 27, the guide extension catheter of any one or any combination of Examples 1-26 can optionally be configured such that all components or options recited are available to use or select from.

CLOSING NOTES

The present guide extension catheters and methods can provide support or guidance for an interventional device beyond the distal end of a guide catheter. Additionally, the guide extension catheters can allow for the position of the guide catheter to be maintained relative to an ostium or branch of a target vessel during an interventional procedure. The guide extension catheters include a proximal push member and a distal tube member extendible beyond the distal end of the guide catheter. The configuration of the

push member can provide an advantageous blend of stiffness, flexibility and space conservation, such that an operating physician can push the guide extension catheters where desired without kinking or improper bending and without reducing the effective device delivery area through the guide catheter.

The above Detailed Description includes references to the accompanying drawings, which form a part of the Detailed Description. The Detailed Description should be read with reference to the drawings. The drawings show, by way of illustration, specific embodiments in which the present guide extension catheters and related methods can be practiced. These embodiments are also referred to herein as "examples."

Certain terms are used throughout this patent document to refer to particular features or components. As one skilled in the art will appreciate, different people may refer to the same feature or component by different names. This patent document does not intend to distinguish between components or features that differ in name but not in function. For the following defined terms, certain definitions shall be applied unless a different definition is given elsewhere in this patent document. The terms "a," "an," and "the" are used to include one or more than one, independent of any other instances or usages of "at least one" or "one or more." The term "or" is used to refer to a nonexclusive or, such that "A or B" includes "A but not B," "B but not A," and "A and B." All numeric values are assumed to be modified by the term "about," whether or not explicitly indicated. The term "about" refers to a range of numbers that one of skill in the art considers equivalent to the recited value (i.e., having the same function or result). In many instances, the term "about" can include numbers that are rounded to the nearest significant figure. The recitation of numerical ranges by endpoints includes all numbers and sub-ranges within and bounding that range (e.g., 1 to 4 includes 1, 1.5, 1.75, 2, 2.3, 2.6, 2.9, etc. and 1 to 1.5, 1 to 2, 1 to 3, 2 to 3.5, 2 to 4, 3 to 4, etc.). The terms "patient" and "subject" are intended to include mammals, such as for human or veterinary applications. The terms "distal" and "proximal" are used to refer to a position or direction relative to an operating physician. "Distal" and "distally" refer to a position that is distant from, or in a direction away from, the physician. "Proximal" and "proximally" refer to a position that is near, or in a direction toward, the physician. And the term "interventional device(s)" is used to include, but is not limited to, guide-wires, balloon catheters, stents and stent catheters.

The scope of the present guide extension catheters and methods should be determined with reference to the appended claims, along with the full scope of equivalents to which such claims are entitled. In the appended claims, the terms "including" and "in which" are used as the plain-English equivalents of the respective terms "comprising" and "wherein." Also, in the following claims, the terms "including" and "comprising" are open-ended; that is, a device or method that includes features or components in addition to those listed after such a term in a claim are still deemed to fall within the scope of that claim. Moreover, in the following claims, the terms "first," "second" and "third," etc. are used merely as labels, and are not intended to impose numerical requirements on their objects.

The Abstract is provided to allow the reader to quickly ascertain the nature of the technical disclosure. It is submitted with the understanding that it will not be used to interpret or limit the scope or meaning of the claims.

What is claimed is:

1. A guide extension catheter for use with a guide catheter, comprising:
 - an elongate tube member defining a lumen and having an outer diameter smaller than a lumen of the guide catheter; and
 - a push member eccentrically coupled relative to an axis of the tube member and extending proximal of the tube member for slidably positioning the tube member within and partially beyond a distal end of the guide catheter,
 wherein at least a proximal end portion of the push member includes a cross-section defined by an arcuate first surface, which is configured to engage an inner wall surface of the guide catheter along an arc length defined by a guide catheter central angle of least 20 degrees, and a flat second surface, which is located opposite the first surface, the second surface having a center point at least 0.010 inches from a center point of the first surface and wherein the center point of the second surface is spaced furthest away from the first surface, and
 - wherein an intermediate portion or a distal end portion of the push member includes a rectangular cross-section defining an area less than an area of the cross-section of the proximal end portion of the push member.
2. The guide extension catheter of claim 1, wherein the first surface of the push member's proximal end portion has the same radius of curvature as the guide catheter's inner wall surface.
3. The guide extension catheter of claim 2, wherein the cross-section of the proximal end portion of the push member is further defined by third and fourth arcuate surfaces that connect the first and second surfaces,
 - the third and fourth surfaces having a radius of curvature less than the radius of curvature of the first surface.
4. The guide extension catheter of claim 3, wherein the radius of curvature of the first surface is at least three times greater than the radius of curvature of the third and fourth surfaces.
5. The guide extension catheter of claim 1, wherein the push member is solid.
6. The guide extension catheter of claim 1, wherein the arc length of the first surface is greater than a length of the second surface.
7. The guide extension catheter of claim 1, further comprising one or more bands along the length of the push member.
8. The guide extension catheter of claim 1, wherein a diameter of the lumen of the tube member is not more than one French size smaller than a diameter of the lumen of the guide catheter.
9. The guide extension catheter of claim 1, further comprising a concave track defining a partially cylindrical opening leading into the tube member.
10. The guide extension catheter of claim 9, wherein a first segment of the concave track includes an arcuate cross-sectional shape.
11. The guide extension catheter of claim 10, wherein a second segment of the concave track extends circumferentially 40% to 70%, inclusive, of a cross-sectional circumference of the tube member.

12. The guide extension catheter of claim 1, wherein a proximal end of the tube member is at least partially radially flared.
13. The guide extension catheter of claim 1, wherein a proximal end of the tube member is skived.
14. A guide extension catheter for use with a guide catheter, comprising:
 - an elongate tube member defining a lumen and having an outer diameter smaller than a lumen of the guide catheter; and
 - a lumenless push member eccentrically coupled to the tube member at a distal end portion and extending proximally therefrom to a proximal end portion for slidably positioning the tube member within and partially beyond a distal end of the guide catheter,
 the proximal end portion of the push member including a cross-section defined by an arcuate first surface configured to engage an inner wall surface of the guide catheter, and an opposing flat second surface, the second surface spaced furthest away from the first surface at a center point of the second surface, and
 - both an intermediate portion and the distal end portion of the push member including a cross-section defined by opposing first and second surfaces and opposing third and fourth surfaces, each of the surfaces having a flat geometry.
15. The guide extension catheter of claim 14, wherein the proximal end portion of the push member has a proximal stiffness and the distal end portion of the push member has a distal stiffness, which is less than the proximal stiffness.
16. The guide extension catheter of claim 14, wherein the cross-section of the push member's proximal end portion transitions along the length of the push member to the cross-section of the push member's distal end portion.
17. The guide extension catheter of claim 14, wherein the proximal end portion has a first flexibility, the distal end portion has a second flexibility that is higher than the first flexibility, and the intermediate portion has a third flexibility between that of the first flexibility of the proximal end portion and the second flexibility of the distal end portion.
18. The guide extension catheter of claim 14, wherein the cross-section of the push member's proximal end portion is further defined by third and fourth arcuate surfaces that connect the first and second surfaces.
19. The guide extension catheter of claim 18, wherein a distance change between center points of the first and second surfaces at the push member's proximal end portion to center points of the first and second surfaces at the push member's intermediate portion is less than a distance change between center points of the third and fourth surfaces at the push member's proximal end portion to center points of the third and fourth surfaces at the push member's intermediate portion.
20. The guide extension catheter of claim 14, wherein a distance between center points of the first and second surfaces at the push member's proximal end portion is between 40%-60% of an arc length of the first surface at the push member's proximal end portion.

* * * * *