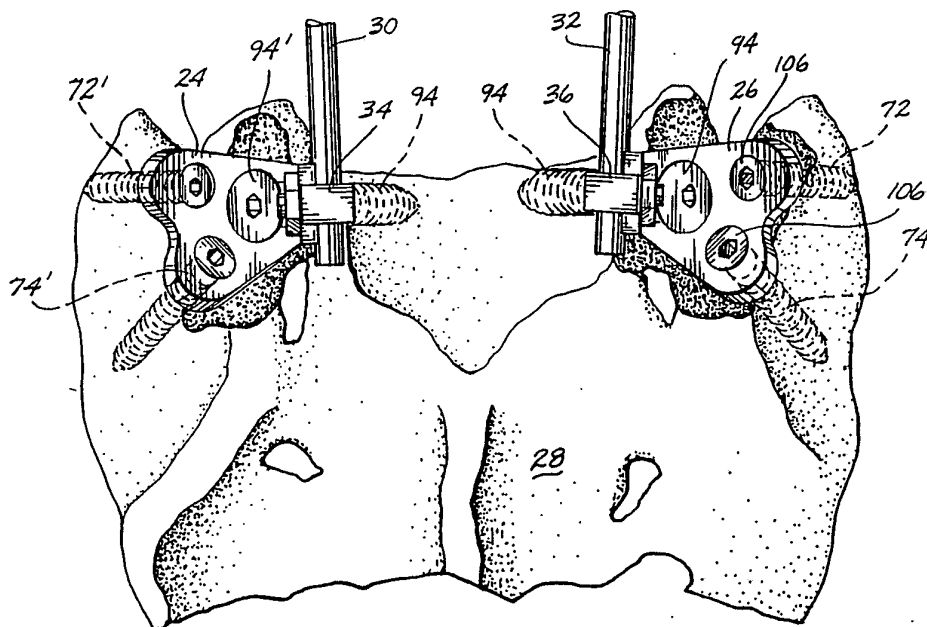

INTERNATIONAL APPLICATION PUBLISHED UNDER THE PATENT COOPERATION TREATY (PCT)

(51) International Patent Classification ⁵ : A61F 5/01	A1	(11) International Publication Number: WO 93/14721
		(43) International Publication Date: 5 August 1993 (05.08.93)
(21) International Application Number: PCT/US92/11113 (22) International Filing Date: 18 December 1992 (18.12.92) (30) Priority data: 826,839 28 January 1992 (28.01.92) US (71) Applicant: SALUT, LTD. [US/US]; 1515 South "K" Street, Tacoma, WA 98405 (US). (72) Inventors: RAY, R., Charles ; 5425 87th Avenue W., Tacoma, WA 98467 (US). ASHMAN, Richard, B. ; 7047 Tokalon Drive, Dallas, TX 75214 (US). (74) Agents: BECK, Michael, D. et al.; Woodard, Emhardt, Naughton, Moriarty & McNett, Bank One Center/Tower, 111 Monument Circle, Suite 3700, Indianapolis, IN 46204 (US).		(81) Designated States: AU, BB, BG, BR, CA, CS, FI, HU, JP, KP, KR, LK, MG, MN, MW, NO, NZ, PL, RO, RU, SD, UA, European patent (AT, BE, CH, DE, DK, ES, FR, GB, GR, IE, IT, LU, MC, NL, PT, SE), OAPI patent (BF, BJ, CF, CG, CI, CM, GA, GN, ML, MR, SN, TD, TG). Published <i>With international search report.</i>

(54) Title: SACRAL IMPLANT SYSTEM**(57) Abstract**

A sacral implant system includes first and second sacral plates (24, 26) that are affixed on opposite sides of the sacrum (28) adjacent the lumbosacral junction. The sacral plates (24, 26) include at least a pedicle and an oblique mounting means for rigidly affixing the sacral plates (24, 26) to the sacrum. First and second fixation rods (30, 32) extend in a superior direction along the lumbar portion of the spine. One or more connecting members tie the rods together. The superior most vertebra to be fixed is tied to the implant system with a special offset fixation plate and pedicle screw. Conventional vertebra hooks can also be used as necessary. Intermediate vertebra are tied to the system with a straight fixation plate and pedicle screw.

FOR THE PURPOSES OF INFORMATION ONLY

Codes used to identify States party to the PCT on the front pages of pamphlets publishing international applications under the PCT.

AT	Austria	FR	France	MR	Mauritania
AU	Australia	GA	Gabon	MW	Malawi
BB	Barbados	GB	United Kingdom	NL	Netherlands
BE	Belgium	GN	Guinea	NO	Norway
BF	Burkina Faso	GR	Greece	NZ	New Zealand
BG	Bulgaria	HU	Hungary	PL	Poland
BJ	Benin	IE	Ireland	PT	Portugal
BR	Brazil	IT	Italy	RO	Romania
CA	Canada	JP	Japan	RU	Russian Federation
CF	Central African Republic	KP	Democratic People's Republic of Korea	SD	Sudan
CG	Congo	KR	Republic of Korea	SE	Sweden
CH	Switzerland	KZ	Kazakhstan	SK	Slovak Republic
CI	Côte d'Ivoire	LI	Liechtenstein	SN	Senegal
CM	Cameroon	LK	Sri Lanka	SU	Soviet Union
CS	Czechoslovakia	LU	Luxembourg	TD	Chad
CZ	Czech Republic	MC	Monaco	TG	Togo
DE	Germany	MG	Madagascar	UA	Ukraine
DK	Denmark	ML	Mali	US	United States of America
ES	Spain	MN	Mongolia	VN	Viet Nam
FI	Finland				

SACRAL IMPLANT SYSTEM

Background of the Invention

The present invention relates to sacral implants, and more particularly to an improved implant system for fixing a stabilizing appliance to the sacrum and to the
5 lumbar vertebrae.

Spinal fusion, especially in the lumbar and sacral region is regularly employed to correct and stabilize spinal curves, to prevent recurrence of spinal curves and to stabilize weakness in trunks that result from degenerative discs and joint disease, deficient posterior elements, spinal fracture, and other debilitating
10 problems. Spinal implant systems have been used regularly to stabilize the lumbar and sacral spine temporarily while solid spinal fusions develop.

Several temporary stabilization systems are currently in use. All perform adequately, however leave room for improvement. For example, an implant system for attaching the superior most lumbar vertebra (L1) to the implant without
15 interfering with normal motion of the next superior vertebra needs to be developed. Additionally, implant systems that achieve stronger sacral fixation, easier use for multiple segment fixation, and easier use with spinal deformity are needed. Further, better implant systems for rigidly tying the base of the system to the sacrum must be developed.

Summary of the Invention

The present invention provides a sacral implant system that rigidly affixes the base of the implant system to the sacrum while allowing ease of installation and flexibility of design. Moreover, the present system provides apparatus for securing the upper portion of the implant system to, for example, the L-1 vertebra, without interfering with the next superior most vertebra (T-12) and any or all vertebrae in between. The sacral implant system of the present invention comprises first and second sacral plates for mounting on opposite sides of the sacrum adjacent the lumbosacral junction. Each of the sacral plates has at least a pedicle and oblique mounting means for rigidly affixing each of the sacral plates to the sacrum. The system also includes first and second rods extending in a superior direction and generally parallel relationship from respective ones of the sacral plates. The rods are situated on opposite sides of the sagittal plane. Means are also provided for rigidly affixing the rods to respective sacral plates. At least one connecting member is employed to rigidly interconnect the rods at a location superior to the sacral plates. Finally, a superior fixation plate having a lateral portion and a medial portion is employed to affix the superior most vertebra to be fused to the implant system. A pedicle screw is fixed to and through the pedicle of the vertebra. The lateral portion of the fixation plate is rigidly affixed to the pedicle screw. The medial portion of the fixation plate is offset in an inferior direction sufficiently far so that it avoids the inferior articulate process of the next superior vertebra. In this manner the next superior vertebra can move in a normal fashion relative to the vertebra to be fused during the temporary stabilization. Preferably, a lateral fixation plate is also used for pedicle fixation of intermediate vertebrae.

In another aspect of the invention, a specialized pedicle screw is provided for attachment of the offset and lateral fixation plates to the vertebra. The screw includes a first threaded portion for threading into the vertebra, a subhead portion and a second threaded portion projecting above the subhead. The second threaded portion is adapted to receive a nut. The subhead has a diameter greater than the second threaded portion and an upwardly facing shoulder lying in a plane substantially orthogonal to the axis of the screw. In use, the shoulder engages the anterior surface of the fixation plate while the nut is threaded on the second threaded portion and bears down against the posterior surface of the plate to secure the plate and screw together.

Brief Description of the Drawings

The foregoing aspects and many of the attendant advantages of this invention will become more readily appreciated as the same becomes better understood by reference to the following detailed description, when taken in conjunction with the accompanying drawings, wherein:

FIGURE 1 is an isometric view of the spinal implant system of the present invention as applied to the lumbar spine;

FIGURE 2 is an isometric view of a right lateral sacral plate constructed in accordance with the present invention;

FIGURE 3 is a plan view (in the sacral plane) of a sacral plate shown in FIGURE 2;

FIGURE 4 is a cross-sectional view taken along section line 4-4 of FIGURE 3;

FIGURE 5 is a cross-sectional line taken along broken cross-sectional line 5-5 of FIGURE 3;

FIGURE 6 and FIGURE 7 are elevation views of fixation screws for use with the sacral plate;

FIGURE 8 is a plan view of the offset fixation plate that is constructed in accordance with the present invention;

FIGURE 9 is a elevation view of a pedicle screw for use with the fixation plate of FIGURE 8;

FIGURE 10 is an exploded isometric view of the fixation plate and screw of FIGURE 9 shown in conjunction with a fixation rod and fastening system used in accordance with the present invention;

FIGURE 11 is a plan view of a straight fixation plate;

FIGURE 12 is an enlarged dorsal view of a superior portion of the sacrum showing the sacral plates implanted in accordance with the present invention;

FIGURE 13 is an enlarged cross-sectional view taken along section line 13-13 of FIGURE 1 through the sacrum looking in an inferior direction at the sacral implant system of the present invention;

FIGURE 14 is an enlarged cross-sectional view taken along section line 14-14 of FIGURE 1 of the pedicle screw and offset fixation plate implanted in accordance with the present invention looking in an inferior direction;

FIGURE 15 is a lateral view looking from right to left of the offset fixation plate shown in FIGURE 14;

FIGURE 16 is a plan view (in the sacral plane) of a second embodiment of the sacral plate shown in FIGURES 2 and 3; and

FIGURE 17 is a cross-sectional view taken along broken cross-sectional line 17-17 of FIGURE 16.

5 Detailed Description of the Preferred Embodiment

Referring first to FIGURE 1, the spinal implant system 20 constructed in accordance with the present invention is affixed to the lumbar spine, generally designated 22. The implant system includes a pair of sacral plates 24 and 26 affixed to the sacrum 28 adjacent the lumbosacral joint. A pair of fixation rods 30 and 32 extend in a superior direction on opposite sides of the sagittal plane from the sacral plates posterior to the lumbar vertebrae L5, L4, L3, L2 and L1. Rods 30 and 32 terminate adjacent the superior portion of vertebra L1. Conventional fasteners 34 and 36 securely affix the rods 30 and 32, respectively, to the sacral plates 24 and 26.

15 At the superior end of the rods, a pair of offset fixation plates 40 and 42 affix the upper ends of the rods to the L1 vertebra. Inferior to that location, a pair of conventional inferior hooks 44 and 46 grasp the inferior portion of the L1 vertebra to secure it relative to the rods 30 and 32. At intermediate locations a straight fixation plate 48 is employed to affix vertebra L3 to the rods 30 and 32. 20 Immediately superior to the sacral plates, a connecting member 50 rigidifies the rods 30 and 32 relative to each other. One of ordinary skill in this technique will readily recognize that one or more connecting members 50, straight fixation plates 48, and hooks 44 can be employed as needed.

The implant system 20 constructed and employed in accordance with the present invention provides a rigid stabilization system for the lumbar spine. The system rigidly ties the sacrum to one or more of the lumbar vertebrae. Moreover, the offset fixation plates 40 and 42 allow the upper portion of the implant system to be rigidly affixed to the superior lumbar vertebra L1 while avoiding contact with the inferior processes of the next superior vertebra T12. In this manner the T12 vertebra can move in a normal manner while stabilization of the lumbar spine occurs.

Referring now to FIGURES 2, 3, 4 and 5, the right sacral plate is illustrated. The right sacral plate is a mirror image of the left sacral plate; therefore, only the right plate will be described in detail. The right sacral plate 26 has a base 60 having a posterior surface and an anterior surface. The anterior surface of the plate is designed to intimately contact the posterior surface of the

sacrum adjacent the lumbosacral joint. In position, the base 60 lies generally in a plane generally tangential to the portion of the sacrum adjacent the lumbosacral joint. For purposes of this description, that plane will be referred to as the sacral or dorsal plane.

5 A U-shaped flange 62 extends posteriorly from the medial portion of the base 60. The medial surface of the flange 62 carries a groove 64 oriented in a superior/inferior direction for receiving a fixation rod 32. A conventional rod clamp 68 is employed to securely and rigidly affix the rod 32 in the groove 64 on the flange 62. The lateral portion of the sacral plate 26 carries three bores that
10 extend from the posterior surface of the base 60 in a generally anterior direction. These bores are the pedicle bore 70, the lateral bore 72 and the oblique bore 74. The bores 70, 72 and 74, while extending in an anterior direction, are not orthogonal to the sacral plane.

 Instead, the pedicle bore 70 has a cylindrical section 80 having an axis 82
15 extending in an anterior and medial direction that is offset in the medial direction preferably at an angle of 15 degrees to a line orthogonal to the sacral plane. A countersink bore 81 is located posterior to the cylindrical section 80 and emerges onto the posterior surface of the sacral plate. This angle can be varied from 0 degrees to 20 degrees, depending upon the particular sacral anatomy being fixed.
20 However, it is understood that the screw that extends through this opening extends through the pedicle of the sacrum and must always lie within the pedicle. It has been found that 15 degrees is the angle most universally acceptable for this orientation. In the present embodiment, the axis 82 is not inclined in a superior or inferior direction relative to a plane perpendicular to the sacral plate. It however
25 can be inclined superiorly so that the vertebral end plate, rather than the anterior cortex, can be engaged by the end of the screw.

 The lateral bore 72 has a cylindrical section 84 having an axis 86 extending in an anterior and lateral direction that is preferably offset in the lateral direction at an angle of 30 degrees from a line orthogonal to the sacral plane. If desired, one
30 of ordinary skill may also vary the lateral angle from 30 degrees up to 45 degrees. Preferably the axis 86 is not canted in either an inferior or superior direction relative to the sacral plate. However, depending upon the sacral anatomy, the axis can be canted from 0 degrees to 15 degrees in the superior direction when viewed in the sacral plane. A countersink bore 85 is located posterior to the cylindrical
35 section 84 and emerges onto the posterior surface of the sacral plate.

The oblique bore 74 also has a cylindrical section 88 having an axis 90 having two offsets in the lateral and inferior directions. The axis 90 when viewed in the sacral plane is first preferably offset 45 degrees from a lateral line, but may be varied from 30 degrees to 60 degrees. Secondly, the axis 90 is offset in the lateral direction preferably 30 degrees from a line orthogonal to the sacral plane but again may be varied from 30 degrees to 45 degrees. A countersink 89 is located posterior to the cylindrical section 88 and also emerges onto the posterior surface of the sacral plate.

Referring now to FIGURE 6, the pedicle screw 94 employed with the sacral plate has a unique construction. It has a lower threaded portion 96, an upper flared head 98 and a cylindrical section 100 immediately below the head 98. The head also carries an allen socket 102 so that the screw can be rotated into a hole drilled in the pedicle. The bone engaging threads on the lower threaded portion 96 are of conventional design. The cylindrical section 100 has a diameter slightly less than the diameter of the cylindrical section 80 of pedicle bore 70. The diameters are chosen such that when the cylindrical section 100 is in the cylindrical section 80, the screw 94 can rotate and reciprocate. However, the tolerances are such that the screw cannot angulate or toggle relative to the axis 82. The upper flared portion 98 is configured to mate with countersink 81 when the screw is completely threaded into the sacrum.

Referring to FIGURE 7, the same screw 106 is employed in both the lateral bore 72 and the oblique bore 74. Screw 106 also has a lower threaded portion 108, a flared head 110 and a cylindrical section 112. Cylindrical section 112 is sized relative to the cylindrical sections 84 and 88 to allow rotation and reciprocation but not angulation. The flared head 110 is configured to mate with the countersinks 85 and 89 when the screws are completely threaded into the sacrum.

Referring now to FIGURES 8 and 10, the offset fixation plate 40 includes a medial portion 122 and a lateral portion 124. The fixation plate of FIGURE 8 is employed on the left side of the fixation system. A similar fixation plate, having the mirror image of plate 40, is employed on the right side; however, it is not shown in the drawings. The lateral portion 124 carries a bore 126 that extends in a posterior/anterior direction when installed. The medial portion 122 is offset in an inferior direction from the lateral portion 124. The medial portion 122 carries a lateral slot 127. The anterior surface of the medial portion 122 carries a plurality of grooves 128 that extend in an inferior/superior direction and intersect the

slot 127. These grooves have a diameter equivalent to the fixation rod 30. A conventional rod to clamp fastener 58 is employed to secure the fixation plate 40 to the fixation rod 30.

A special pedicle screw 129 is employed with the offset fixation plate. Referring to FIGURE 9, the pedicle screw includes a lower threaded portion 130, a subhead portion 132 and an upper threaded portion 134. The upper threaded portion 134 has an allen socket 136 extending axially into its upper end. The subhead has a diameter larger than the upper threaded portion 134 and terminates in its upward end in a shoulder 138 that is positioned in a plane orthogonal to the axis of the screw. Referring now to FIGURE 10, the pedicle screw 129 is received by the bore 126, which is sized just slightly larger than the upper threaded portion 134 so that the pedicle screw can reciprocate relative to the offset fixation plate 40, but cannot angulate relative to the screw axis when engaging the bore 126. A conventional nut 140 is threaded onto the upper portion 134 of the pedicle screw 129 securing the shoulder 138 against the anterior surface of the fixation plate while the nut 140 snugs against the posterior surface, thus rigidly interlocking the pedicle screw 129 and the fixation plate.

A straight fixation plate 48 is illustrated in FIGURE 11. The straight fixation plate 48 is similar in construction to the offset fixation plate 40 except that it does not contain the offset. It carries a similar bore 144 for receiving a pedicle screw similar to screw 129, a lateral slot 146 and rod engaging grooves 148 for securing the plate 48 to a fixation rod.

Referring to FIGURES 12 and 13, in use, the sacral plates 24 and 26 are affixed to the sacrum 28 adjacent the lumbosacral junction. As desired and as necessary, the anterior surface of the sacrum can be smoothed so as to receive the anterior surface of the sacral plates 24 and 26 in snug relationship. The pedicle screws 94 and 94', for use in the pedicle bores of the sacral plates, are threaded into appropriate bores made by the surgeon through the pedicle of the sacrum. The pedicle screws are snugged down so that the flared heads are seated firmly in the countersinks in the respective plates. A torque ranging from 6 to 10 in./lb. can be used to snug the screws. The physician also makes appropriate bores into the sacrum that are aligned with the lateral bores 72 and 72' and with the oblique bores 74 and 74'. Screws 106 are inserted through the lateral and oblique bores 72 and 74 in the right plate, and bores 72' and 74' in the left plate. All the screws 106 are snugged down so that the flared heads seat snugly in the

countersinks in the anterior surface of the sacral plates. Again a torque of 6 to 10 in./lb. is appropriate for snugging the screws into the plate.

In this manner, the three screws in each sacral plate all diverge from each other. As a result, the screws cannot be easily pulled from the bores in the bone.

5 A force in the direction of the axis of one of the screws will be partially distributed over the bone on which the remaining two screws bear. In this manner, full force cannot be exerted in the direction of the axis of a single screw and thus a single screw cannot be sheared from its bore in an easy manner. This construction provides significant advantages over the prior art while allowing independent

10 placement of a sacral plate on each side of the sacrum. For example, screw placement is designed to achieve fixation in the proximal part of the sacrum, which has the strongest bone. The oblique screw is designed to be proximal to and parallel the S1 foramin, thereby avoiding damage to the S1 nerve. The medial screw is inclined medially to allow bicortical fixation while avoiding neurovascular

15 structures directly anterior to the S1 pedicle. The lateral screw is also designed to allow bicortical fixation lateral to the significant neurovascular structures.

Referring now to FIGURES 14 and 15, offset fixation plates 40 and 42 are shown affixed by conventional fasteners 58 to fixation rods 30 and 32. The pedicle screws 129 are threaded into suitable bores in the left and right pedicle 150

20 and 152 of the L1 vertebra. Nuts 140 are threaded onto the upper portions of the pedicle screws 129 and tightened against the anterior surfaces of the fixation plates 40. The fasteners 58 thereafter are tightened to secure the other end of the plate to the fixation rods 30 and 32. In this manner, the upper end of the lumbar spine implant system can be secured to the L1 vertebra without interfering with the

25 next superior vertebra.

Referring now to FIGURES 16 and 17, a second embodiment of a right sacral plate 150 according to the present invention is shown. A left sacral plate is configured as a mirror image of the right sacral plate; therefore, only the right sacral plate will be described in detail. The sacral plate 150 has a base 152 having

30 a posterior surface and an anterior surface. The anterior surface of the plate is designed to intimately contact the posterior surface of the sacrum adjacent the lumbosacral joint. In position, the base 152 lies in a plane generally tangential to the portion of the sacrum adjacent the lumbosacral joint.

A U-shaped flange 154 is configured in the same way as flange 64 shown in

35 FIGURE 2. The medial surface of the flange 154 carries a groove 156 oriented in a superior/inferior direction for receiving a fixation rod 32 that is held in place

with a conventional rod clamp 68 as shown in FIGURE 2. The lateral portion of the sacral plate 150 carries two bores that extend from the posterior surface of the base 152 in a generally anterior direction. These bores are the pedicle bore 158 and the oblique bore 160. The bores 158 and 160, while extending in the anterior direction, are not orthogonal to the sacral plane.

The pedicle bore has a cylindrical section 162 having an axis 164 extending in an anterior and medial direction that is offset in the medial direction preferably at an angle of 15 degrees to a line orthogonal to the sacral plane. A countersink bore 166 is located posterior to the cylindrical section 162 and emerges onto the posterior surface of the sacral plate. The angle of the axis 164 can be varied from 0 degrees to 20 degrees, depending upon the particular sacral anatomy being fixed. However, it is understood that a screw that extends through this opening into the pedicle of the sacrum must always lie within the pedicle. In the present embodiment of the sacral plate 150, the axis 164 is not inclined in the superior or inferior direction relative to a plane perpendicular to the sacral plate. However, the axis can be inclined superiorly so that the vertical end plate rather than the anterior cortex can be engaged by the end of the screw.

The oblique bore 160 also has a cylindrical section 166 having a axis 168 having two offsets in the lateral and inferior directions. The axis 168 when viewed in the sacral plane is first preferably offset at 45 degrees from a lateral line, but may be varied from 30 degrees to 60 degrees. Secondly, the axis 168 is offset in the lateral direction preferably 30 degrees from a line orthogonal to the sacral plane but again may be varied from 30 degrees to 45 degrees. A countersink 170 is located posterior to the cylindrical section 166 and also emerges onto the posterior surface of the sacral plate.

The sacral plate 152 is designed for patients having a lumbosacral joint that is too small to accept the sacral plate 26 shown in FIGURES 2 and 3. By providing a sacral plate 150 having only the pedicle bore and oblique bore, the sacral implant system according to the present invention can be adapted to fit patients having smaller skeletal structures.

The present invention has been described in connection with the preferred embodiment. However, one of ordinary skill will be able to effect various alterations, substitutions of equivalents and other changes without departing from the broad concepts imparted herein. It is, therefore, intended that the letters patent issued hereon be limited only by the definition contained in the appended claims and equivalents thereof.

The embodiments of the invention in which an exclusive property or privilege is claimed are defined as follows:

1. A sacral implant system comprising:

first and second discrete sacral plates for mounting on opposite sides of said
5 sacrum adjacent the lumbosacral junction, each of said sacral plates having at least
a pedicle and oblique mounting means for rigidly fixing each of said sacral plates
independently to opposite lateral portions of said sacrum,

first and second rods extending in a superior direction in a generally
parallel relationship from respective ones of said sacral plates on opposite sides of
10 the centerline of said lumbar spine, and means rigidly fixing said rods to said
sacral plates,

at least one connecting member rigidly interconnecting said rod superior to
said sacral plates, and

a superior offset fixation plate rigidly affixed to at least one of said rods, a
15 pedicle screw fixed to and through the pedicle of a vertebra, and means rigidly
affixing said pedicle screw to said offset fixation plate,

each of said pedicle and oblique mounting means including a fixation screw
having a lower threaded portion, a head and a cylindrical section adjacent said
head, said sacral plate including cylindrical bores corresponding to each of said
20 pedicle and oblique mounting means, each of said bores having a diameter slightly
greater than a respective cylindrical section on a respective fixation screw enabling
said screw to rotate and reciprocate in said bore while substantially eliminating
angular movement of said screw relative to said plate, said cylindrical bore of said
pedicle mounting means having an axis that extends in a medial and anterior
25 direction from said sacral plate, said cylindrical bore of said pedicle mounting
means being located medially from the cylindrical bore of said oblique mounting
means.

2. The sacral implant system of Claim 1, wherein said axis of said
pedicle mounting means is oriented in a medial direction at an angle ranging from
30 0 degrees to 20 degrees relative to a line orthogonal to the sacral plane.

3. The sacral implant system of Claim 2, wherein said axis of said
pedicle mounting means is oriented in the medial direction at an angle of about
15 degrees relative to a line orthogonal to the sacral plane.

4. The sacral implant system of Claim 1, wherein the cylindrical bore of said oblique mounting means has an axis extending in a lateral, anterior and inferior direction relative to said sacral plane.

5. A sacral plate for use in a sacral implant system comprising:
5 a plate having a posterior surface and an anterior surface, said anterior surface being configured to be positioned against the posterior surface of the sacrum adjacent the lumbosacral junction, said sacral plate having means for attaching to a fixation rod, said sacral plate also having a pedicle and oblique mounting means for rigidly fixing said sacral plate to said sacrum at a location
10 lateral from the sagittal plane, each of said pedicle and oblique mounting means including a cylindrical bore, the cylindrical bore of said pedicle mounting means having an axis that extends in a medial and anterior direction relative to the sacral plane, the cylindrical bore of said pedicle mounting means being positioned medially relative to the cylindrical bore of said oblique mounting means.

15 6. The sacral plate of Claim 5, wherein said axis of said pedicle mounting means is oriented in the medial direction at an angle of about 0 degrees to 20 degrees relative to a line orthogonal to the sacral plane.

7. The sacral plate of Claim 6, wherein said axis of said pedicle mounting means is oriented in the medial direction at an angle of about 15 degrees
20 relative to a line orthogonal to the sacral plane.

8. The sacral plate of Claim 5, wherein the cylindrical bore of said oblique mounting means has an axis extending in a lateral, anterior and inferior direction relative to the sacral plane.

9. The sacral plate of Claim 8, wherein said axis of said oblique
25 mounting means, when viewed in the sacral plane, is offset in the inferior direction at an angle of about 30 degrees to about 60 degrees relative to a lateral line in said sacral plane and is offset in the lateral direction from about 30 degrees to about 45 degrees relative to a line orthogonal to said sacral plane.

9. The sacral plate of Claim 9, wherein said axis is offset inferior at an angle of about 45 degrees relative to a lateral line in the sacral plane and is offset laterally at an angle of about 30 degrees relative to a line orthogonal to the sacral plane.

5 10. A sacral implant system comprising:

first and second sacral plates for mounting on opposite sides of said sacrum adjacent the lumbosacral junction, each of said sacral plates having at least a pedicle and oblique mounting means for rigidly fixing each of said sacral plates to opposite lateral portions of said sacrum,

10 first and second rods extending in a superior direction in a generally parallel relationship from respective ones of said sacral plates on opposite sides of the centerline of said lumbar spine, and means rigidly fixing said rods to said sacral plates,

at least one connecting member rigidly interconnecting said rods superior to
15 said sacral plates,

a superior offset fixation plate rigidly affixed to at least one of said rods, a pedicle screw fixed to and through the pedicle of a vertebra, and means rigidly affixing said pedicle screw to said offset fixation plate, said offset fixation plate having a medial portion and an integral lateral portion offset in the superior
20 direction, the medial portion being positioned below the interior processes of the next superior vertebra relative to the vertebra to be fixed, the offset portion being positionable over the pedicle of the vertebra to be fixed.

11. The sacral implant system of Claim 11, wherein the medial portion of said offset plate has a lateral slot, the anterior side thereof having a plurality of
25 slots oriented in the superior/inferior direction for receiving said rod at a plurality of lateral distances from an adjacent pedicle fixation screw.

13. A sacral implant system comprising:

first and second sacral plates for mounting on opposite sides of said sacrum adjacent the lumbosacral junction, each of said sacral plates having at least a
30 pedicle and oblique mounting means for rigidly fixing each of said sacral plates to opposite lateral portions of said sacrum,

first and second rods extending in a superior direction in a generally parallel relationship from respective ones of said sacral plates on opposite sides of

the centerline of said lumbar spine, and means rigidly fixing said rods to said sacral plates,

at least one connecting member rigidly interconnecting said rods superior to said sacral plates,

5 a superior offset fixation plate rigidly affixed to at least one of said rods, a pedicle screw fixed to and through the pedicle of a vertebra, and means rigidly affixing said pedicle screw to said offset fixation plate, and

a straight fixation plate for fixing an intermediate vertebra to one of said rods, said straight fixation plate having a medial portion and an integral lateral
10 portion, said lateral portion including an aperture for receiving a pedicle fixation screw, said medial portion having a plurality of slots on its anterior side oriented in a superior/inferior direction for receiving a rod at a plurality of lateral distances from an adjacent pedicle fixation screw.

12. A sacral implant system comprising:

15 first and second sacral plates for mounting on opposite sides of said sacrum adjacent the lumbosacral junction, each of said sacral plates having means for attaching to a fixation rod, each of said sacral plates also having pedicle and oblique mounting means for rigidly fixing each of said sacral plates to opposite lateral portions of said sacrum, each of said pedicle and oblique mounting means
20 including a fixation screw having a lower threaded portion, a head and a cylindrical section adjacent said head, said sacral plate including cylindrical bores corresponding to each of said pedicle and oblique mounting means, each of said bores having a diameter slightly greater than a respective cylindrical section on a fixation screw enabling said screw to rotate and reciprocate in said bore while
25 substantially eliminating angular movement of said screw relative to said plate, said cylindrical bore of said oblique mounting means having an axis extending in a lateral, anterior and inferior direction relative to said sacral plate, said axis of said oblique mounting means when viewed in the sacral plane being offset in the inferior direction at an angle of about 30 degrees to about 60 degrees relative to a
30 lateral line in the sacral plane and being offset in the lateral direction at an angle of about 30 degrees to about 45 degrees relative to a line orthogonal to the sacral plane.

13. The system of Claim 14, wherein said axis of said oblique mounting means is offset inferior at an angle of about 45 degrees relative to a lateral line in

the sacral plane and is offset laterally at an angle of about 30 degrees relative to a line orthogonal to the sacral plane.

16. A sacral plate for use in a sacral implant system comprising:
a plate having a posterior surface and an anterior surface, said anterior
5 surface being configured to be positioned against the posterior surface of the
sacrum adjacent the lumbosacral junction, said sacral plate having means for
attaching to a fixation rod, said sacral plate also having at least a pedicle and
oblique mounting means for rigidly fixing said sacral plate to said sacrum at a
location lateral from the sagittal plane, each of said pedicle and oblique mounting
10 means including a fixation screw having a lower threaded portion, a head, and a
cylindrical section intermediate said head and said threaded portion, said plate
including cylindrical bores corresponding to each of said pedicle and oblique
mounting means, each of said bores having a diameter slightly greater than a
respective cylindrical section enabling said cylindrical section to rotate and
15 reciprocate in said bore while substantially eliminating angular movement of said
screw relative to said plate, said cylindrical bore of said oblique mounting means
having an axis extending in a lateral, anterior, and inferior direction relative to said
sacral plate, said axis when viewed in the sacral plane being offset in the inferior
direction at an angle of about 30 degrees to about 60 degrees relative to a lateral
20 line in said sacral plane and is offset in the lateral direction from about 30 degrees
to about 45 degrees relative to a line orthogonal to said sacral plane.

14. The sacral plate of Claim 16, wherein said axis of said oblique
mounting means is offset inferior at an angle of about 45 degrees relative to a
lateral line in the sacral plane and is offset laterally at an angle of about 30 degrees
25 relative to a line orthogonal to the sacral plane.

15. A sacral implant system comprising:
first and second sacral plates for mounting on opposite sides of said sacrum
adjacent the lumbosacral junction, each of said sacral plates having at least a
pedicle and oblique mounting means for rigidly fixing each of said sacral plates to
30 opposite lateral portions of said sacrum,
first and second rods extending in a superior direction in a generally
parallel relationship from respective ones of said sacral plates on opposite sides of

the centerline of said lumbar spine, and means rigidly fixing said rods to said sacral plates,

at least one connecting member rigidly interconnecting said rods superior to said sacral plates,

5 a superior offset fixation plate rigidly affixed to at least one of said rods, a pedicle screw fixed to and through the pedicle of a vertebra, and means rigidly affixing said pedicle screw to said offset fixation plate, said offset fixation plate having a medial portion and an integral lateral portion offset in the superior direction, the medial portion being positioned below the inferior processes of the
10 next superior vertebra relative to the vertebra to be fixed, the offset portion being positionable over the pedicle of the vertebra to be fixed.

19. The system of Claim 18, wherein the medial portion of said offset plate has a lateral slot, the anterior side thereof having a plurality of slots oriented in the superior/inferior direction for receiving said rod at a plurality of lateral
15 distances from an adjacent pedicle fixation screw.

16. A sacral implant system comprising:

first and second sacral plates for mounting on opposite sides of said sacrum adjacent the lumbosacral junction, each of said sacral plates having at least a pedicle and oblique mounting means for rigidly fixing each of said sacral plates to
20 opposite lateral portions of said sacrum,

first and second rods extending in a superior direction in a generally parallel relationship from respective ones of said sacral plates on opposite sides of the centerline of said lumbar spine, and means rigidly fixing said rods to said sacral plates,

25 at least one connecting member rigidly interconnecting said rods superior to said sacral plates,

a superior offset fixation plate rigidly affixed to at least one of said rods, a pedicle screw fixed to and through the pedicle of a vertebra, and means rigidly affixing said pedicle screw to said offset fixation plate, and

30 a straight fixation plate for fixing an intermediate vertebra to one of said rods, said straight fixation plating having a medial portion and an integral lateral portion, said lateral portion including an aperture for receiving a pedicle fixation screw, said medial portion having a plurality of slots on its anterior side oriented in

a superior/inferior direction for receiving a rod at a plurality of lateral distances from an adjacent pedicle fixation screw.

17. A pedicle fixation screw comprising:

a threaded portion,

5 a subhead portion above said threaded portion for threading into bone, and
a second threaded portion above said subhead for receiving a nut, said
subhead having a diameter greater than said second threaded portion, said subhead
having a shoulder oriented in a plane substantially orthogonal to the axis of said
screw and facing upwardly toward said threaded portion.

10 18. The screw of Claim 21, in combination with a fixation plate, said
fixation plate having a medial portion for connecting to a fixation rod and a lateral
portion having a bore therethrough sized to receive said threaded portion, said
fixation plate having an anterior surface and a posterior surface, said shoulder
15 adapted to contact said anterior surface, and a nut threaded onto said second
threaded portion adapted to bear against the posterior surface of said fixation plate.

19. A fixation plate for use in conjunction with a sacral implant system
comprising:

20 a medial portion and a lateral portion, said lateral portion having a bore
therein for receiving a portion of the pedicle fixation screw, said plate having an
anterior side and a posterior side, said medial portion having a laterally oriented
slot therein, said anterior surface of said plate underlying said slot having a
plurality of grooves therein oriented in a superior/inferior direction, said grooves
for receiving a fixation rod.

25 20. A fixation plate of Claim 23, wherein the lateral portion of said
plate is offset in a superior direction relative to said medial portion.

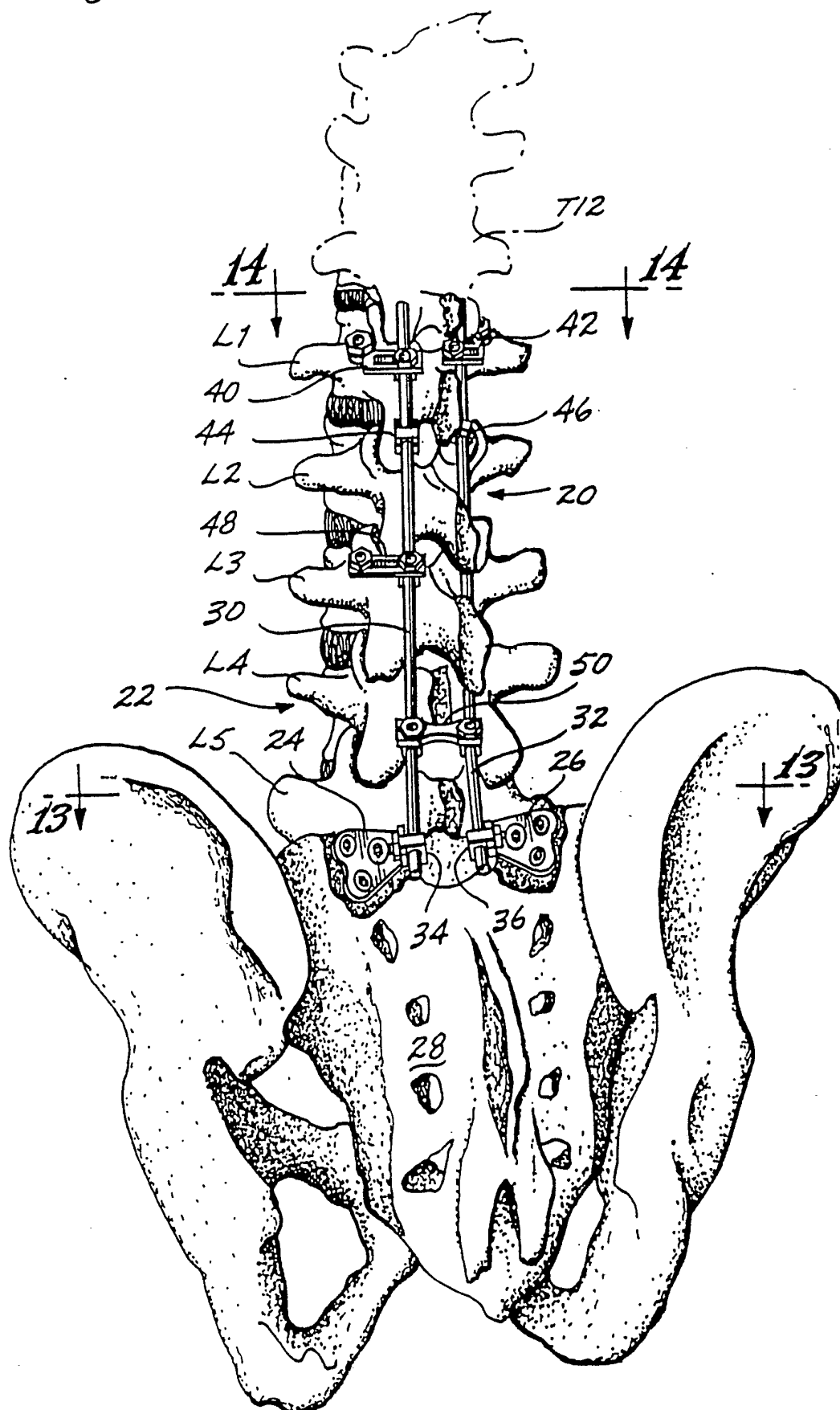
Fig. 1.

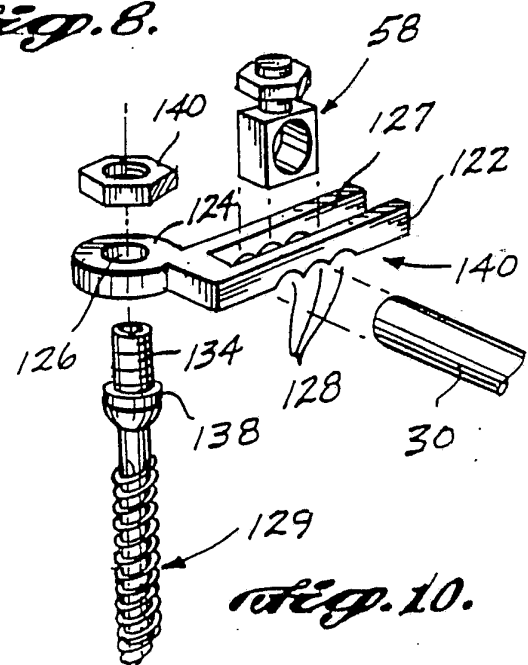
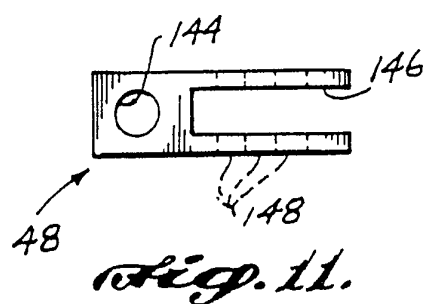
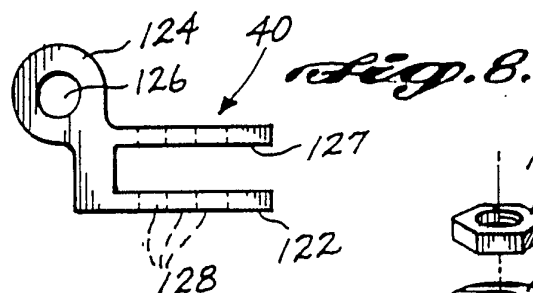
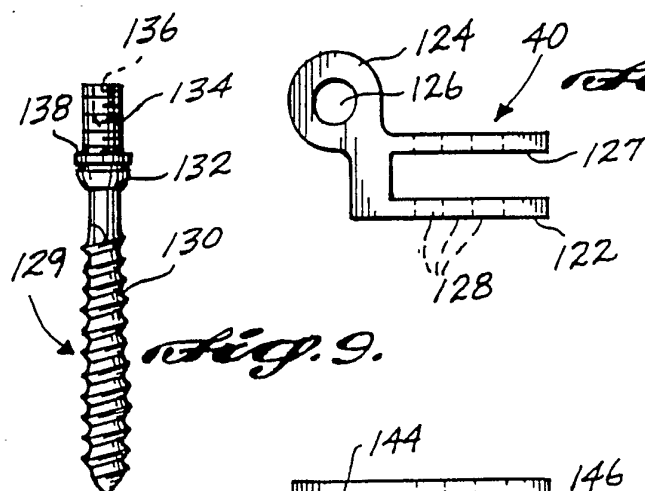
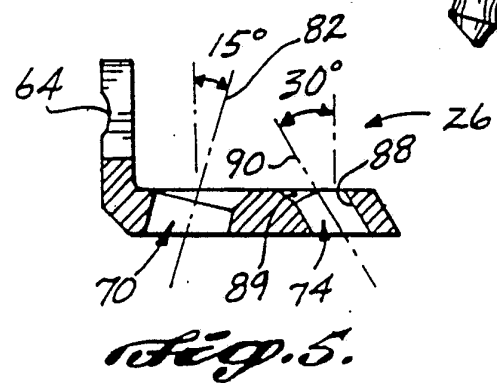
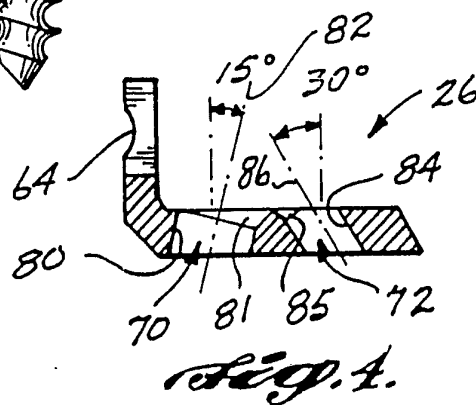
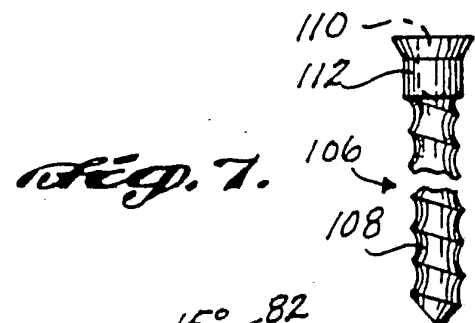
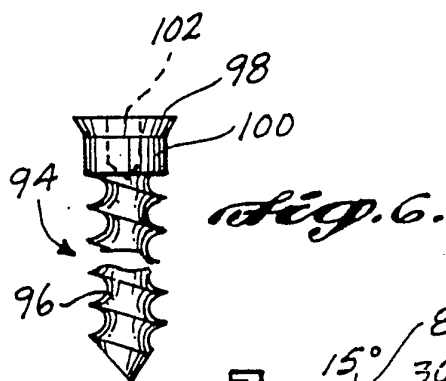
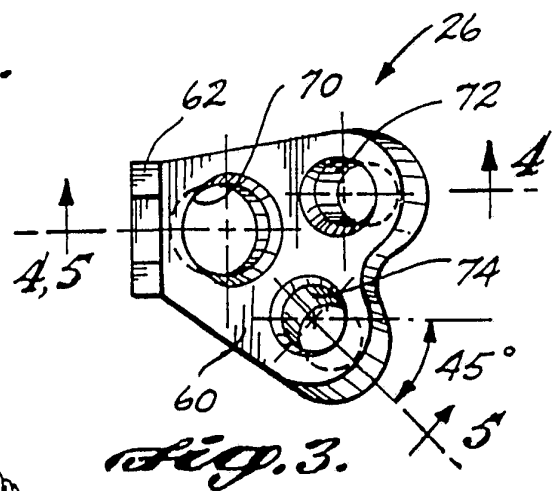
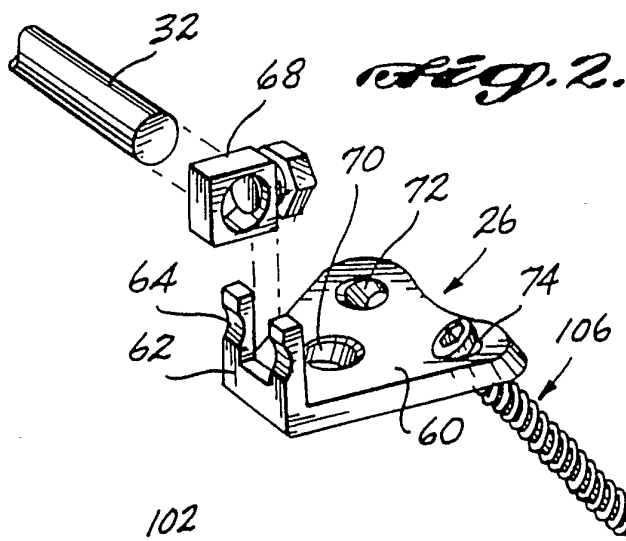

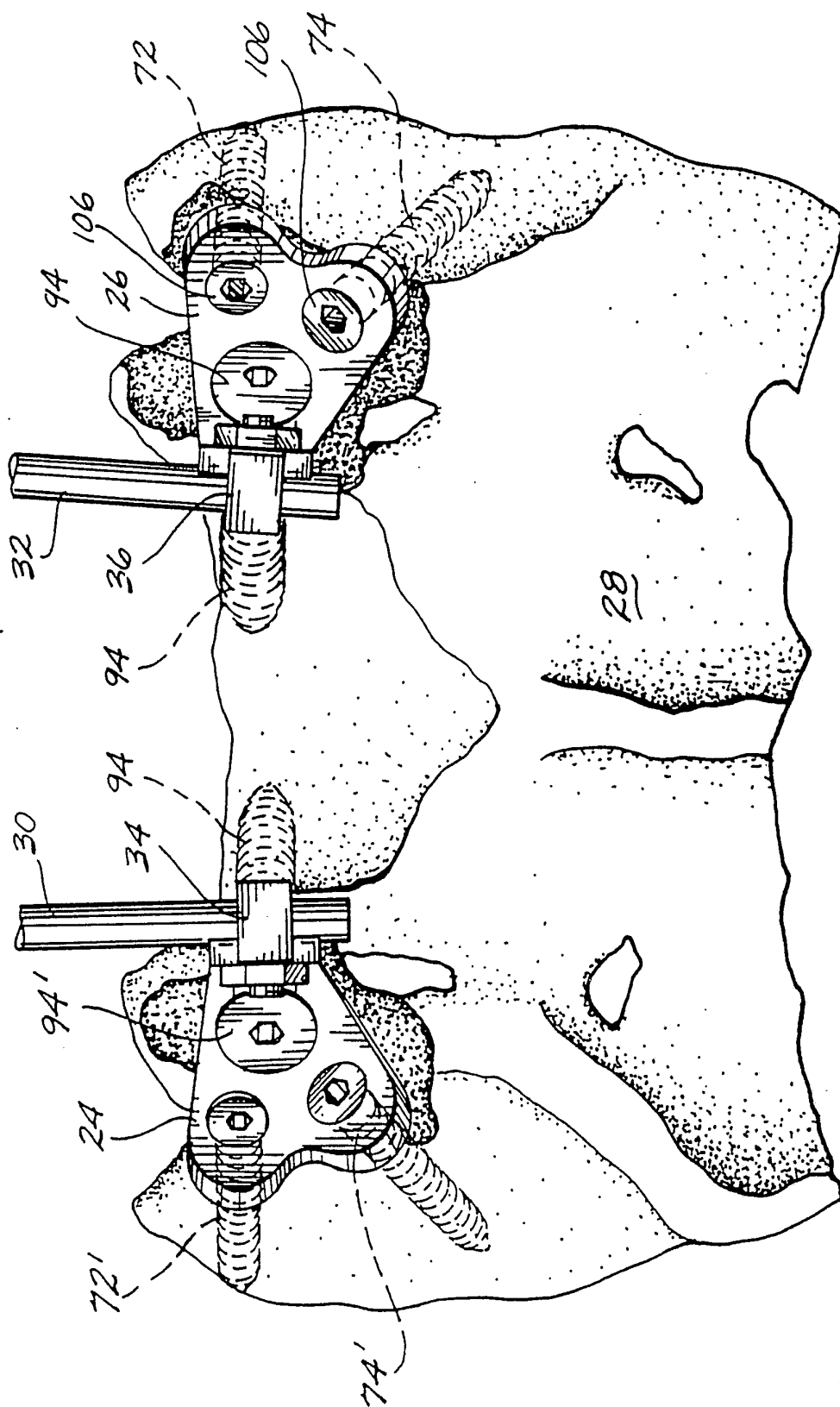

Fig. 12.

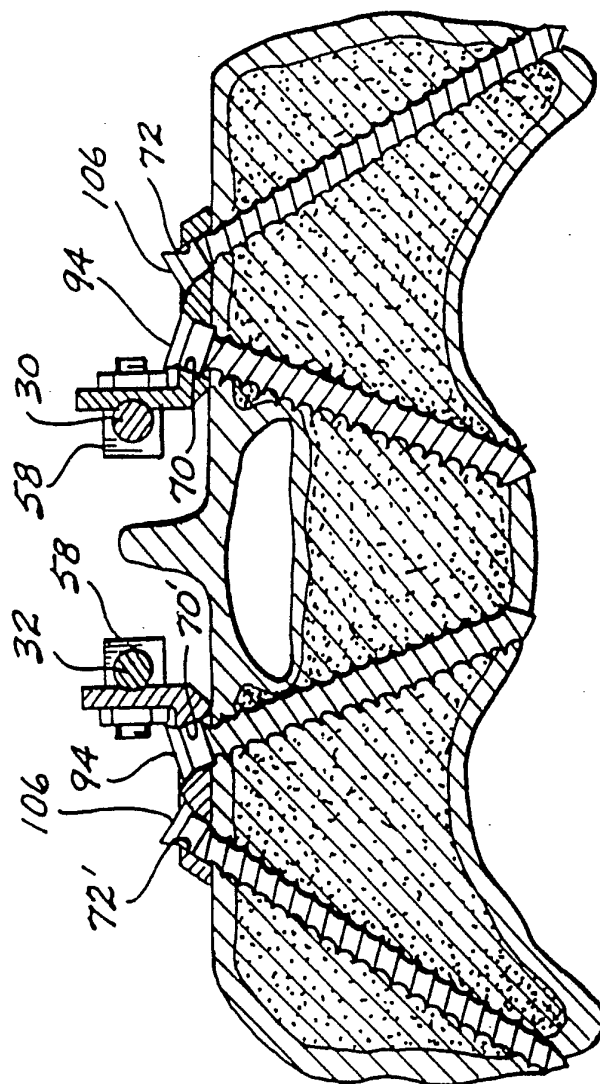
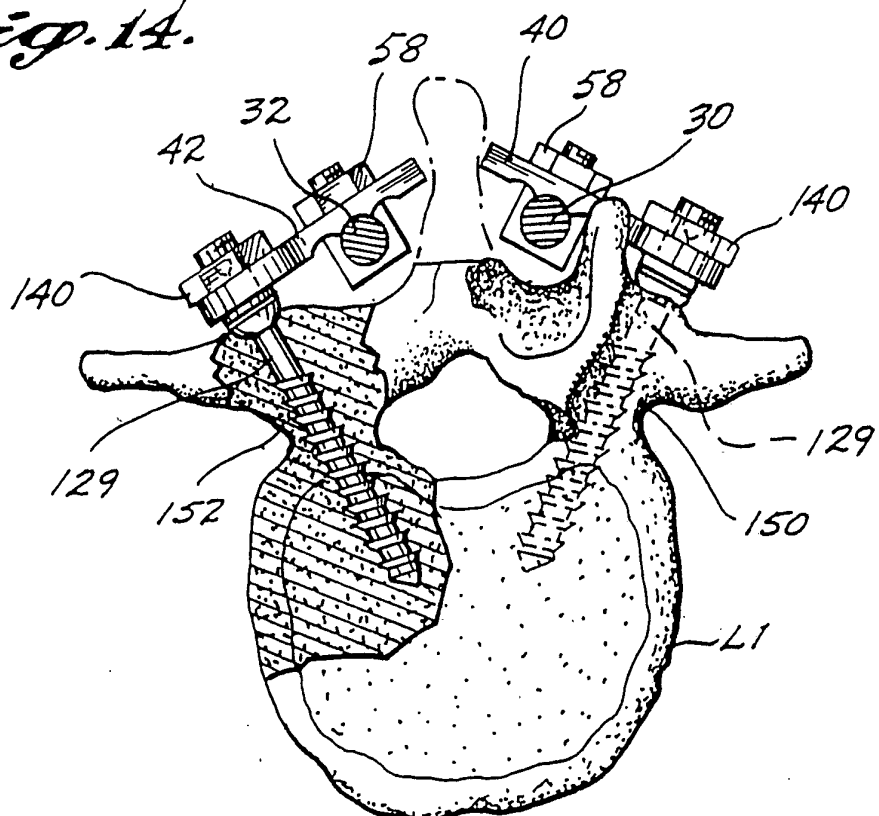
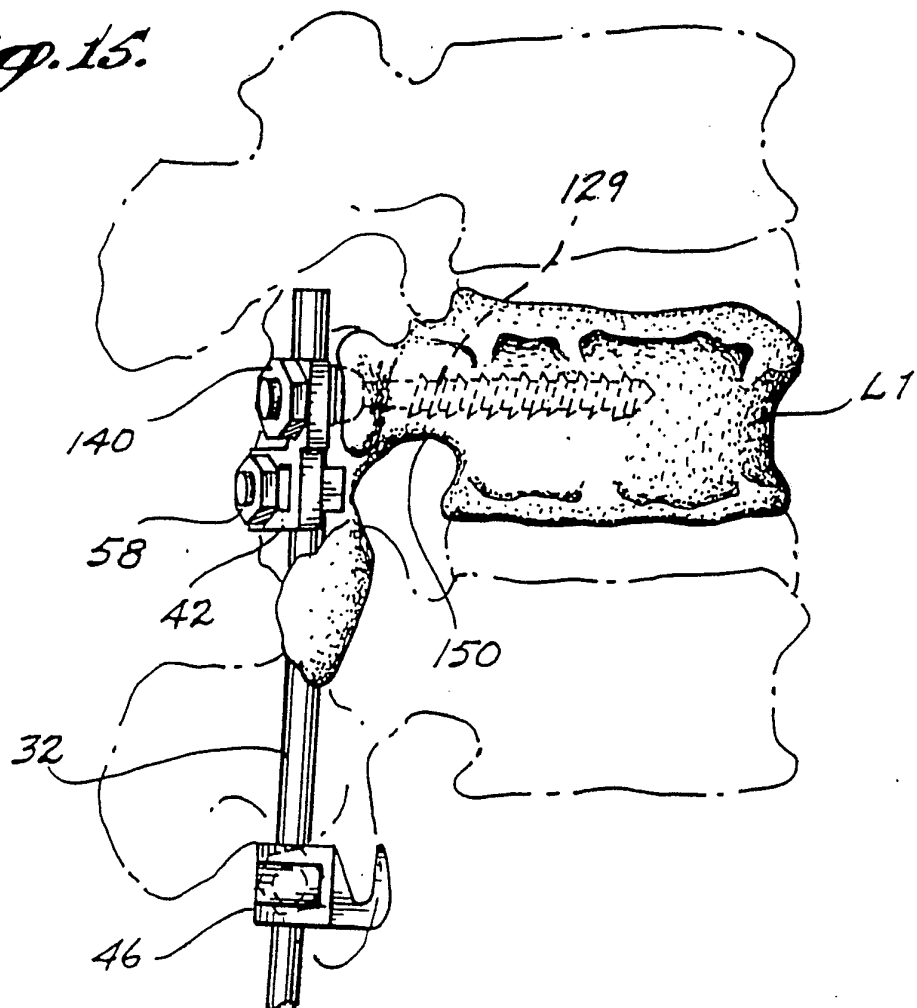
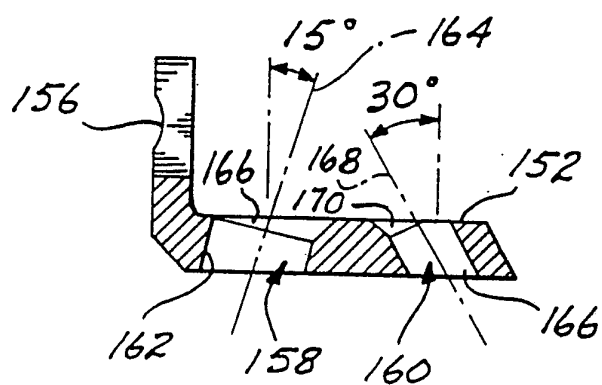
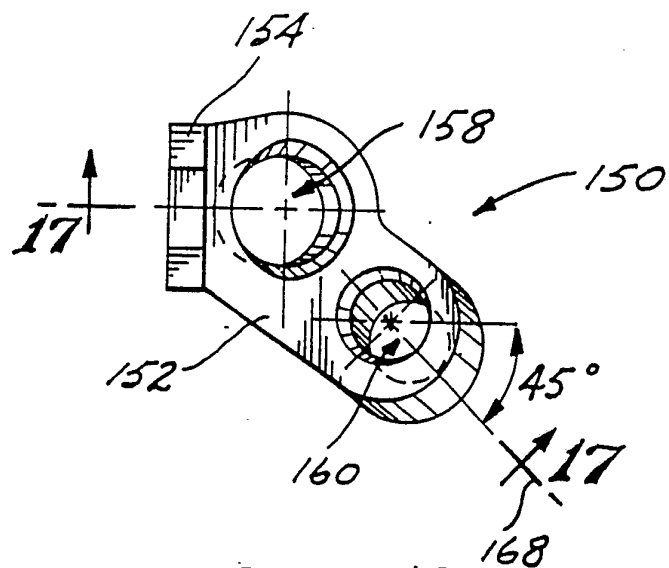

Fig. 13.

Fig. 14.*Fig. 15.*



INTERNATIONAL SEARCH REPORT

International application No.
PCT/US92/11113

A. CLASSIFICATION OF SUBJECT MATTER

IPC(5) :A61F 5/01

US CL :606/61

According to International Patent Classification (IPC) or to both national classification and IPC

B. FIELDS SEARCHED

Minimum documentation searched (classification system followed by classification symbols)

U.S. : 606/59,60,72,73

Documentation searched other than minimum documentation to the extent that such documents are included in the fields searched

Electronic data base consulted during the international search (name of data base and, where practicable, search terms used)

C. DOCUMENTS CONSIDERED TO BE RELEVANT

Category*	Citation of document, with indication, where appropriate, of the relevant passages	Relevant to claim No.
Y,P	US,A, 5,133,717 (Chopin) 28 July 1992 Entire document.	1-20
Y,P	US,A, 5,147,360 (Dubousset) 15 September 1992 Entire document.	1-20
Y	US,A, 4,719,905 (Steffee) 19 January 1988 Entire document.	1-20
Y,P	US,A, 5,147,361 (Ojima et al.) 15 September 1992 entire document.	1-20

☐ Further documents are listed in the continuation of Box C.☐ See patent family annex.

* Special categories of cited documents:	*T* later document published after the international filing date or priority date and not in conflict with the application but cited to understand the principle or theory underlying the invention
A document defining the general state of the art which is not considered to be part of particular relevance	*X* document of particular relevance; the claimed invention cannot be considered novel or cannot be considered to involve an inventive step when the document is taken alone
E earlier document published on or after the international filing date	*Y* document of particular relevance; the claimed invention cannot be considered to involve an inventive step when the document is combined with one or more other such documents, such combination being obvious to a person skilled in the art
L document which may throw doubts on priority claim(s) or which is cited to establish the publication date of another citation or other special reason (as specified)	*Z* document member of the same patent family
O document referring to an oral disclosure, use, exhibition or other means	
P document published prior to the international filing date but later than the priority date claimed	

Date of the actual completion of the international search

11 MARCH 1993

Date of mailing of the international search report

29 APR 1993

Name and mailing address of the ISA/US
Commissioner of Patents and Trademarks
Box PCT
Washington, D.C. 20231Authorized officer *my means*
DAVID J. ISABELLA

Facsimile No. NOT APPLICABLE

Telephone No. (703) 308-0858