

Sept. 5, 1933.

J. L. COYLE

1,925,792

FILLER FOR EGGS AND THE LIKE

Filed Jan. 30, 1931

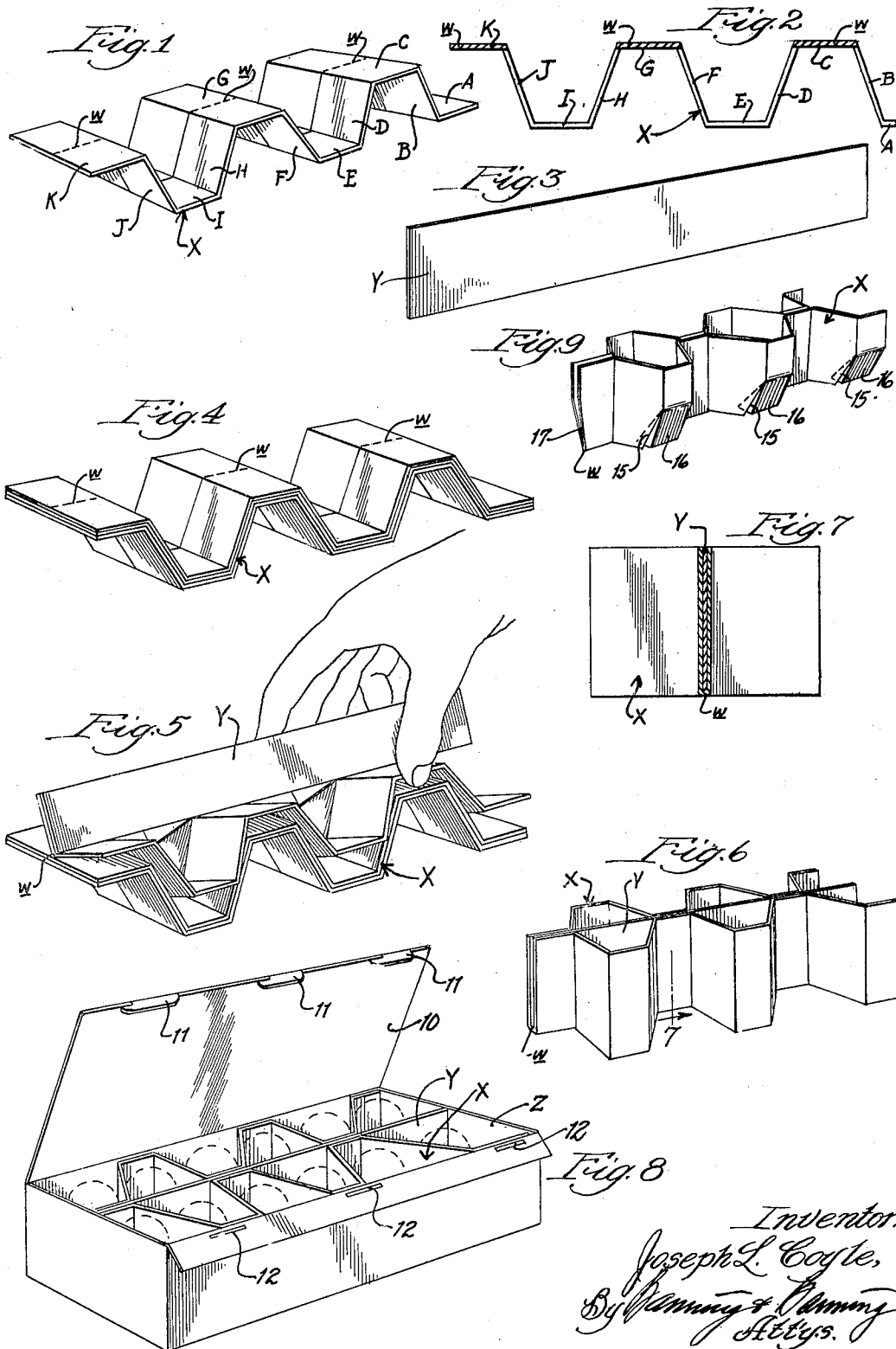

Inventor:  
Joseph L. Coyle,  
By *Wm. & Wm. Atty.s.*

# UNITED STATES PATENT OFFICE

1,925,792

## FILLER FOR EGGS AND THE LIKE

Joseph L. Coyle, London, Ontario, Canada, assignor to Leon Benoit, Chicago, Ill.

Application January 30, 1931, Serial No. 512,245,  
and in Canada March 26, 1930

2 Claims. (Cl. 217—23)

The present invention is concerned with a filler for eggs or other desired commodities. It embodies in its construction certain improvements having to do with simplicity, low cost of production, facility in nesting, ease of assembling, and secure protection to the articles contained within its several cells.

A suggestive embodiment of this invention is set forth in the accompanying drawing wherein—  
10 Figure 1 is a perspective view of the filler blank as it appears ready for nesting, shipping, storing, or assembling with a second component;

Fig. 2 is a central longitudinal section there-through;

15 Fig. 3 shows in perspective the partition strip designed for assembly with the filler blank;

Fig. 4 illustrates in perspective a number of filler blanks nested together;

20 Fig. 5 which is a perspective view shows a filler blank and partition in the relationship occupied at the commencement of the assembling operation;

Fig. 6 is a perspective view of the filler fully assembled;

25 Fig. 7 is a transverse section through the filler on line 7 of Fig. 6;

Fig. 8 shows in perspective the filler placed within an enclosing carton; and

30 a slightly modified construction.

In the construction of the present filler, I may utilize two components—an elongated blank X and a partition strip Y. For a 2 x 6 filler the blank is produced with a plurality of transverse bends defining walls A to K which provide a series of alternately facing flaring channels. The channel bottom walls A, E and I lie in one plane with other bottom walls C, G and K disposed in another plane, and between these two planes the walls B, F and J extend slantingly in parallel relation, the remaining walls D and H being slanted in another direction.

The blank is severed centrally through all the walls except the bottoms C, G and K, which lie in one plane to form webs *w* by which to connect the two sections of the blank lying on opposite sides of a plane extending centrally of its length. A blank having these characteristics may be nested with others, as shown in Fig. 4, so that a large number will occupy but a very small space. With each such blank I may associate a partition strip Y, which, as shown in Fig. 3, is of plain rectangular form.

55 The operation of assembling the strips and blanks may be performed expeditiously in some

such manner as is suggested in Fig. 5. Here I have shown a plurality of nested blanks X, upon the top one of which may be placed a partition strip Y with one longitudinal edge rested close to a line running centrally of the length of the blank. The opposite side edges of the blank may then be seized by the fingers to perform a folding operation in which the connecting webs *w* of the sections C, G and K serve as hinges.

With the two sections of the blank folded into adjacent relation, a partition strip may be confined therebetween in the manner shown in Figs. 6 and 7. The structure resulting from this operation is one which provides a series of alternately facing channels or pockets on opposite sides of the central partition strip. The filler when so assembled need not be secured in any way, inasmuch as the confinement afforded by an enclosing carton or wrapper Z, as shown in Fig. 8, is sufficient to maintain the filler parts in the position shown. It will be noted by reference to Fig. 8 that the several channels or pockets defined by the blank sections provide parallel rows of cells lying on opposite sides of the central partition strip. Within these cells may be placed any desired commodities, such as eggs or the like. When so received, the surrounding walls of the cells provided by the filler and carton or wrapper, will afford the desired protection to the contents. As shown, the carton may be equipped with the usual cover 10 having locking tongues 11 for co-operation with slits 12 along one carton edge by which to secure the cover in closed position.

In case the present filler be used with a carton having outwardly slanted sides and ends, it is desirable that the filler walls and edges contacting therewith should be similarly inclined. To meet this condition, I have shown in Fig. 9 a construction in which diverging slits 15 extend partly across each blank section to provide intervening tongues 16 which can be inwardly slanted in conformity with the inclination of the carton walls adjacent which such tongues will lie. The end edges of the blank, and of the partition also, may be inclined as at 17, for the same purpose.

The filler herein described is advantageous in that it may consist of two components, both of which may be nested or stacked to occupy a minimum of space. In the assembling of the filler, a partition taken from one stack may be laid on the uppermost blank in the other stack, and by the operation of one hand the blank sections are folded up to enclose the partition in a central

position preliminary to introducing the assembled filler in a carton.

I claim:

1. A collapsible filler formed from an elongated  
 5 blank having a series of bends providing a plu-  
 rality of inner walls lying in one plane, a plu-  
 rality of outer walls lying in another plane paral-  
 lel thereto, and a plurality of intermediate walls  
 10 extending between the two planes, said inter-  
 mediate walls being angularly slitted adjacent  
 said outer walls, whereby portions of said outer  
 walls may be inclined relative to said other walls,  
 there being a central cut extending longitudinally  
 15 of the blank through all the walls in the two  
 planes last noted, permitting the two sections of  
 the blank on opposite sides of the center to be  
 folded upon itself with the continuous walls in

the plane first noted providing hinges therefor and a partition strip extending between the two folded sections of the blank and confined in place therebetween.

2. A collapsible filler comprising a sheet of 80  
 material slitted at intervals between the longi-  
 tudinal edges thereof and bent transversely of  
 the sheet at the slitted portions to provide com-  
 85plementary oppositely bowed portions when fold-  
 ed between the slits, and a longitudinal partition  
 resting upon and laterally supported at intervals  
 by said folded unslitted portions of the sheet  
 and dividing said intermediate oppositely bowed  
 90portions into cells of substantially uniform dimen-  
 sions.

JOSEPH L. COYLE.

20	95
25	100
30	105
35	110
40	115
45	120
50	125
55	130
60	135
65	140
70	145
75	150