

(21) Application No: 0820976.9

(22) Date of Filing: 29.09.2006

(30) Priority Data:  
(31) 60795046 (32) 26.04.2006 (33) US(86) International Application Data:  
PCT/US2006/038404 En 29.09.2006(87) International Publication Data:  
WO2007/123571 En 01.11.2007(71) Applicant(s):  
**Stryker Corporation**  
(Incorporated in USA - Michigan)  
PO Box 4085, 2725 Fairfield Road,  
Kalamazoo, MI 49003-4085,  
United States of America

(continued on next page)

(51) INT CL:  
**A61G 1/00** (2006.01) **A61G 1/02** (2006.01)  
**A61G 1/04** (2006.01) **A61G 1/06** (2006.01)(56) Documents Cited by ISA:  
**WO 2005/105480 A** **WO 2002/039944 A**  
**DE 008711456 U1** **US 6766547 B1**  
**US 5537700 A** **US 4579381 A**  
**US 4489449 A** **US 4097941 A**  
**US 4037871 A** **US 2958873 A**  
**US 1958494 A** **US 20060031990 A1**  
**US 20050241063 A1** **US 20020056162 A1**(58) Field of Search by ISA:  
INT CL **A61G**  
Other:(54) Abstract Title: **Ambulance cot docking assembly and patient support articulation features**

(57) An ambulance cot and accessories therefor. The ambulance cot has (1) a docking mechanism for facilitating an anchoring of the litter frame to the floor of the cargo area of an ambulance; (2) an articulated patient support deck on the litter frame capable of raising and lowering a head section while simultaneously raising and lowering a foot section or orienting the foot section to form an inverted V-shaped gatch supporting the knees at a position elevated with respect to the patient's hip; (3) a pair of stowable pull handles at opposite ends of the ambulance cot are provided to facilitate an ease of manipulation of the ambulance cot while the wheels are engaged with the floor for transport of the patient from one location to another; (4) an upstanding push bar in each of the four corners of the cot; and (5) a support of an incubator assembly.

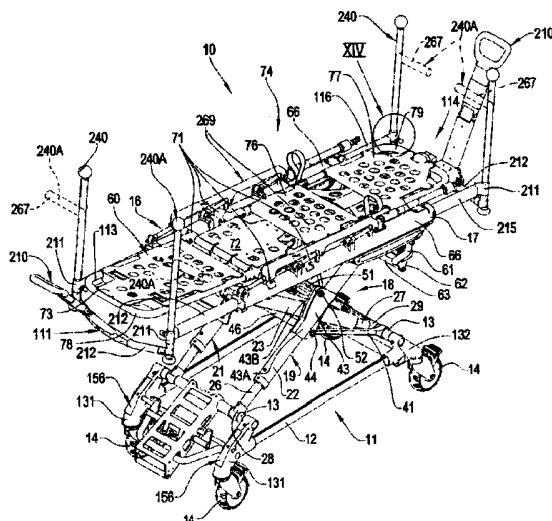

**GB 2451045 A continuation**

(72) Inventor(s):

**Clifford E Lambarth  
Adam D Kammers  
Joshua Colvin  
Daniel K Kruse  
Kurosh Nahavandi  
Steve Knipfel  
Maxwell Petersen  
Michael W Steffler  
Christopher B Way**

(74) Agent and/or Address for Service:

**Gill Jennings & Every LLP  
Broadgate House, 7 Eldon Street,  
LONDON, EC2M 7LH, United Kingdom**