



- (51) International Patent Classification:  
*B62K 5/00* (2013.01)      *B62K 7/00* (2006.01)
- (21) International Application Number:  
PCT/US2016/042523
- (22) International Filing Date:  
15 July 2016 (15.07.2016)
- (25) Filing Language: English
- (26) Publication Language: English
- (30) Priority Data:  
14/805,563      22 July 2015 (22.07.2015)      US
- (71) Applicant: **MONTAGUE CORPORATION** [US/US];  
1035 Cambridge Street, Suite 29, Cambridge, Massachusetts 02141 (US).
- (72) Inventor: **MONTAGUE, David**; c/o Montague Corporation,  
1035 Cambridge Street, Suite 29, Cambridge, Massachusetts 02141 (US).
- (74) Agents: **BIRD, John** et al.; Sughrue Mion, PLLC, 2100  
Pennsylvania Ave. NW, Suite 800, Washington, District of  
Columbia 20037 (US).

- (81) Designated States (unless otherwise indicated, for every kind of national protection available): AE, AG, AL, AM, AO, AT, AU, AZ, BA, BB, BG, BH, BN, BR, BW, BY, BZ, CA, CH, CL, CN, CO, CR, CU, CZ, DE, DK, DM, DO, DZ, EC, EE, EG, ES, FI, GB, GD, GE, GH, GM, GT, HN, HR, HU, ID, IL, IN, IR, IS, JP, KE, KG, KN, KP, KR, KZ, LA, LC, LK, LR, LS, LU, LY, MA, MD, ME, MG, MK, MN, MW, MX, MY, MZ, NA, NG, NI, NO, NZ, OM, PA, PE, PG, PH, PL, PT, QA, RO, RS, RU, RW, SA, SC, SD, SE, SG, SK, SL, SM, ST, SV, SY, TH, TJ, TM, TN, TR, TT, TZ, UA, UG, US, UZ, VC, VN, ZA, ZM, ZW.
- (84) Designated States (unless otherwise indicated, for every kind of regional protection available): ARIPO (BW, GH, GM, KE, LR, LS, MW, MZ, NA, RW, SD, SL, ST, SZ, TZ, UG, ZM, ZW), Eurasian (AM, AZ, BY, KG, KZ, RU, TJ, TM), European (AL, AT, BE, BG, CH, CY, CZ, DE, DK, EE, ES, FI, FR, GB, GR, HR, HU, IE, IS, IT, LT, LU, LV, MC, MK, MT, NL, NO, PL, PT, RO, RS, SE, SI, SK, SM, TR), OAPI (BF, BJ, CF, CG, CI, CM, GA, GN, GQ, GW, KM, ML, MR, NE, SN, TD, TG).

Published:  
— with international search report (Art. 21(3))

(54) Title: NON-OVERLAPPING FRAME FOLDING BIKE

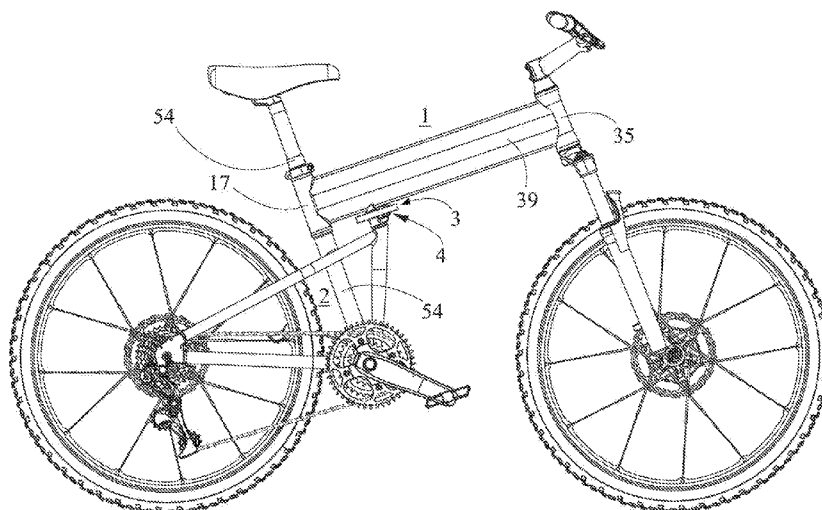

Figure 1

(57) Abstract: A folding bike designed such that when the bicycle is folded, the front and rear frame structural members bypass each other in a non-overlapping manner except at folding and fastening positions using an axis of rotation at or near the seat tube, wherein the folding bicycle maintains a rigid riding position using an innovative fastening mechanism positioned to fasten by actuation of a member located not above the uppermost surface of the front frame, and which may be equipped with primary and secondary retention wherein the secondary retention may automatically engage when the bike is unfolded to the operative riding position.

WO 2017/015121 A1

# Non-overlapping Frame Folding Bike

## BACKGROUND

### A. Field of the Invention

This invention relates to a folding bike that folds on or near the seat tube wherein the front and rear structural frame members bypass each other during folding and do not overlap except at folding and fastening positions and which uses an innovative mechanism to lock the front and a rear frames together in the operative riding position.

### B. Background Information

Many folding bicycles have been designed to date which insert a hinging member into a cut main tube near the middle of the bicycle which both hinges and locks the bicycle in the riding position. These bicycles are typically weak and require a number of folding steps making for a bicycle that is complicated to fold and structurally weak. To date the strongest folding bicycles have been those that do not break a structural member and instead fold about concentric tubes located at or near the seat tube such as those shown in U.S. Pat. No. 4,448,437, U.S. Pat. No. 4,900,047, and U.S. 5,975,551.

There are however still areas for improvement in order to increase the strength of the frame assembly and to enhance and simplify the folding operation. In this application, a novel fastening assembly and assembly location is introduced.

## SUMMARY OF THE INVENTION

It is the objective of this invention to define a folding bicycle designed such that when the bicycle is folded, the front and rear frame structural members bypass each other in a non-overlapping manner except at folding and fastening positions using a folding axis on or near the seat tube, wherein the folding bicycle maintains a rigid riding position using an innovative

fastening mechanism positioned to fasten by actuation of a member located not above the uppermost surface of the front frame, and which may be equipped with primary and secondary retention wherein the secondary retention automatically engages during unfolding. Finally, it is an objective of this invention to define a folding and fastening assembly that is easy to use, simple to manufacture, adjustable to allow for manufacturing tolerances, lightweight, inexpensive, and acts to reduce hinge/axis of rotation tolerances when fastened to provide a rigid riding condition.

This objective is achieved by incorporating an innovative fastening system strategically placed where it does not protrude above the upper-most surface of the front frame. The novel fastening system may use an assembly of wedges that are at varying angles relative to one another and working together to allow for a system where the secondary retention may automatically engage, the act of locking the primary retention may also preload the hinging mechanism to remove unwanted manufacturing tolerance and thereby provide a rigid frame, and the forces encountered during riding may be handled primarily by fixed meeting surfaces and not by the actuating mechanism.

Alternate derivative embodiments that will be apparent to those skilled in the trade that are not shown but which should be considered as embodiments of this invention including but are not limited to: the front or rear frame being made of two or more sub-frame assemblies which may comprise additional hinging and fastening systems; configuring the rear frame to be located above the front frame; the front and/or rear frame of the bicycle made of a single tube or open shapes formed of multiple tubes, or any combination thereof; the axis of rotation located in front of, or in back of the seat tube, or at the mid-point between the two wheels; the fastening mechanism being located at, or in back of, the seat tube; the hinge positioned such as to allow the folded package to have the front wheel left on; the position of the hinging and the position of the fastening devices interchanged; multiple fastening mechanisms; the bicycle equipped with secondary retention that requires manual engagement in order to unfold the bicycle; the fastening mechanism being actuated by something other than a cam quick release; different bicycle types including smaller wheel folding bikes, mountain bikes,

pavement bikes, engine or non-human powered bicycles, traditional "women's" style bicycles with a lower top tube; children's bikes; and different frames sizes and wheel sizes. It is apparent to those skilled in the art that these and other modifications of this invention may be practiced without departing from the scope of this invention.

This invention will be described in greater detail by referring to the attached drawing and the description of the preferred embodiment which follows.

#### BRIEF DESCRIPTION OF THE DRAWINGS

Referring now to the attached drawings which form a part of this original disclosure:

FIG. 1 is a side view of the complete bicycle with front frame 1, rear frame 2 and lock assembly 4 positioned in the operative riding position.

FIG. 2 is a side view of the complete bicycle in the folded position with front frame 1 and rear frame 2 having been pivoted to such a position causing front lock member 3 to separate from lock assembly 4.

FIG. 3 is an exploded view of the component parts of lock assembly 4.

FIG. 4 is a perspective view of the seat tube folding/hinging area and the fastening area with the bicycle in the operative riding position. FIG. 4 is the first of a sequence of four figures showing the method of operation of lock assembly 4 during the folding process.

FIG. 5 is a perspective view of the seat tube hinging area and the fastening area with the bicycle approaching the operative riding position but with the first step of folding having been accomplished; lever 10 is opened. FIG. 5 is the second of a sequence of four figures showing the method of operation of lock assembly 4 during the folding process.

FIG. 6 is a perspective view of the seat tube hinging area and the fastening area with front frame 1 having been partially folded. FIG. 6 is the third of a sequence of four figures showing the method of operation of lock assembly 4 during the folding process.

FIG. 7 is a perspective view of the seat tube hinging area and the fastening area with the bicycle in the folded position. FIG. 7 is the fourth of a sequence of four figures showing the method of operation of lock assembly 4 during the folding process.

FIG. 8 is a section view (Section A-A as shown in FIG. 21) of the hinging area and fastening area with the bicycle approaching the operative riding position but before front lock member 3 has engaged lock assembly 4. FIG. 8 is the first of a sequence of five figures showing the method of operation of lock assembly 4 during the unfolding process.

FIG. 9 is a section view of the hinging area and fastening area with the bicycle approaching the operative riding position when front lock member 3 has initial contact with lock assembly 4. FIG. 9 is the second of a sequence of five figures showing the method of operation of lock assembly 4 during the unfolding process.

FIG. 10 is a section view of the hinging area and fastening area with the bicycle approaching the operative riding position when front lock member 3 has caused the spring loaded assembly of lock assembly 4 to ride up into a loaded, but not yet engaged, position. FIG. 10 is the third of a sequence of five figures showing the method of operation of lock assembly 4 during the unfolding process.

FIG. 11 is a section view of the hinging area and fastening area with the bicycle approaching the operative riding position when front lock member 3 has caused the spring loaded assembly of lock assembly 4 to move to a position where the secondary retention is engaged. FIG. 11 is the fourth of a sequence of five figures showing the method of operation of lock assembly 4 during the unfolding process.

FIG. 12 is a section view of the hinging area and fastening area with the bicycle in the operative riding position with the primary retention engaged. FIG. 12 is the fifth of a sequence of five figures showing the method of operation of lock assembly 4 during the unfolding process.

FIG. 13 is a perspective view of front lock member 3.

FIG. 14 is a perspective view of front lock member 3.

FIG. 15 is a perspective view of lock body 6.

FIG. 16 is a perspective view of lock body 6.

FIG. 17 is a perspective view of wedge 8.

FIG. 18 is a perspective view of how corresponding surfaces of front lock member 3, lock body 6, and wedge 8 assemble and fit together.

FIG. 19 is a cutaway view of the hinging and fastening area with the secondary retention engaged, but the primary retention not yet engaged. FIG. 19 is the first of a sequence of two figures showing how the operation of fastening the primary retention also preloads the hinging mechanism.

FIG. 20 is a cutaway view of the hinging and fastening area with the primary retention being engaged and the hinge being preloaded. FIG. 20 is the second of a sequence of two figures showing how the operation of fastening the primary retention also preloads the hinging mechanism.

FIG. 21 is a side view of the hinging area and fastening area showing the locations of Sections A-A and B-B.

FIG. 22 is a view of Section B-B (as shown in FIG. 21) with the secondary retention engaged, but the primary retention not yet engaged. FIG. 22 is the first of a sequence of two figures showing how the operation of fastening the primary retention draws the two frames together in multiple directions.

FIG. 23 is a view of Section B-B (as shown in FIG. 21) with the primary retention engaged. FIG. 23 is the second of a sequence of two figures showing how the operation of fastening the primary retention draws the two frames together in multiple directions thus preloading the hinging mechanism.

FIG. 24 is a view of a vertical section taken through lock assembly 4 on a plane parallel to the bicycle wheels and 90 degrees (around a vertical axis) from the section shown in FIG.'s 19 and 20. FIG. 24 shows the adjustability of lock assembly 4 and having been adjusted with the front (left) side down as far as possible. FIG. 24 is the first of a sequence of two figures showing that lock assembly 4 is adjustable to account for tolerances found in the manufacturing process.

FIG. 25 is a view of a vertical section taken through lock assembly 4 on a plane parallel to the bicycle wheels and 90 degrees (around a vertical axis) from the section shown in FIG.'s 19 and 20. FIG. 25 shows the adjustability of lock assembly 4 and having been adjusted with the front (left) side up as far as possible. FIG. 25 is the second of a sequence of two figures showing that lock assembly 4 is adjustable to account for tolerances found in the manufacturing process.

FIG. 26 is a perspective view of one method of mounting lock assembly 4 to rear frame 2.

FIG. 27 is a perspective view of lock assembly 4 mounted to rear frame 2. FIG. 27 is the first of a sequence of two figures showing a method of pushing on the end of lever 10 causing wedge 8 to disengage.

FIG. 28 is a perspective view of lock assembly 4 mounted to rear frame 2. FIG. 28 is the second of a sequence of two figures showing a method of pushing on the end of lever 10 causing wedge 8 to disengage.

#### DETAILED DESCRIPTION OF EMBODIMENTS

Selected embodiments of the present invention will be described in the following, and shown in the figures. It will be apparent to those skilled in the art that these descriptions and figures are provided for illustration purposes only and not for the purpose of limiting the invention which is as defined by the included claims and their equivalents.

In the embodiments described herein, with reference to the accompanying figures, one numeral designates identical or corresponding elements throughout all figures, where the

numbers used to designate the front frame components are generally odd numbers and the numbers used to designate rear frame components are generally even numbers.

A folding bicycle is presented which comprises a seat tube 54, a front frame 1 for mounting a front wheel steering assembly, and a rear frame 2 for mounting a rear wheel. The front frame generally extends from the head tube 35 back to the seat tube area, and the rear frame generally extends from the seat tube area back to the rear wheel center. The front and rear frames are oriented so that when folding each frame can be rotated about a common axis of rotation 15 backward or forward without contacting a structural member of the other frame except at folding and fastening locations, where the axis of rotation is located at or near the seat tube, and the fastening point is located at or near the seat tube. A bicycle fastening mechanism is positioned to fasten the front and rear frames in a locked operative riding position by actuation of a member located not above the uppermost surface of the front frame. One portion of the fastening mechanism may be fastened to a lower surface of the front frame 1 while another portion may be fastened to an upper surface of the rear frame 2. The axis of rotation may consist of a frame member 17 from the front frame and a frame member 54 from the rear frame positioned concentrically and rotatable relative to one another. Positioning of the axis of rotation may be on or near the seat tube including a position proximate to a midpoint between the front and rear wheels.

The folding bicycle contains a hinge mechanism axis of rotation and a fastening system where the fastening system is generally located at a position which is, as measured along the direction of travel of the bicycle, different from the axis of rotation. The fastening system may serve two purposes, the first is to fasten the bicycle together in the operative riding position, and the second is to load the axis of rotation in a manner so as to remove the tolerances in the hinge members such as to reduce movement between the various hinge members during riding.

One example of the folding process will now be described. During folding, the front wheel may or may not be removed depending on design. After consideration of the front wheel, the locking assembly may be operated by first operating lever 10 to unlock primary retention.

Then secondary retention is released and front frame 1 and rear frame 2 are rotated relative to one another to the desired folded position.

Referring now to FIG. 1, many of the elements used on the present invention can be found on a standard conventional bicycle, such as the wheels, drive-train, seat, seat post, handlebar, handle bar stem, brakes, pedals, fork, etc. These elements are not labeled as they are well known. As shown, the steering assembly including handlebar, stem, front fork, front wheel etc. are rotatably mounted to front frame 1 through head tube 35. The drive train, rear wheel, and seat post may be mounted to rear frame 2. Outer seat tube 17 may be a component of front frame 1 and mounted concentrically and rotatably on seat tube 54 which may be a component of rear frame 2. Front main tube 39 is shown with no protrusions such as a locking assembly or locking lever on its upper surface. In the embodiment shown, front lock member 3 and lock assembly 4 are mounted below the front main tube 39 with no components protruding above main tube 39. Front lock member 3 and lock assembly 4 are the two joining components of the locking assembly that hold the bike in the operative riding position. Front lock member 3 may be mounted to front frame 1 and lock assembly 4 may be mounted to rear frame 2. Lock assembly 4 contains the various moving parts required to lock front lock member 3 and lock assembly 4 together however, these parts could also be mounted to front frame 1. Now referring to FIG. 2, the bicycle is shown in the folded position wherein the front wheel has been removed from front fork 37 and lock assembly 4 has separated from front lock member 3 allowing outer seat tube 17 to rotate around seat tube 54 to a folded position. Not shown but apparent to those skilled in the trade are variations on the configurations set forth herein in the figures such as the front and/or rear frames being composed of multiple sub-frame assemblies or different configurations from those shown, variations in the location of the folding axis and fastening points, variations in wheel sizes, embodiments that leave the front wheel fastened to the bicycle during folding, and other variations with non-overlapping frames except at folding and fastening points.

Now referring to FIG. 3, shown is an exploded view of a lock assembly 4 with lock body 6 being the main member to which most components are mounted. Lock body 6 may be mounted in

an adjustable manner using fixing bolt 16 and bowl washer 24 to rear frame 2 (not shown). Mounted through skewer hole 44 in lock body 6 is skewer 12 which holds axle 18 upon which is rotatably mounted lever 10. Lever 10 comprises a cam surface which acts on cam follower 20 which in turn acts on cam acting surface 62 on lock body 6 to create tension in skewer 12 thereby pulling on adjusting nut 14 which is mounted by threading to skewer 12. Wedge 8 is mounted to adjusting nut 14 and held to adjusting nut 14 by c-clip 28 such that wedge 8 moves with skewer 12 as skewer 12 is moved in an axial direction. As lever 10 and skewer 12 are moved axially, spring 22 is compressed and wedge 8 moves relative to lock body 6. Spring 22 also pushes against cam acting surface 62 and biases wedge 8 towards lock body 6. Anti-vibration nylon 26 acts to prevent unwanted rotation of adjusting nut 14 around skewer 12. Wedge 8 is equipped with wedge secondary retention faces 32 and wedge primary retention faces 34 on its inside surface and lock body 6 is equipped with stop face 30. It will be apparent to those skilled in the trade that while a quick release cam is shown, any number of other fastening mechanisms could be used.

Now referring to FIGS. 4 through 7, shown is the sequence of operations of folding the bicycle. FIG. 4 shows the bicycle in the operative riding position with lever 10 in the fastened state and lock assembly 4 fastened to front lock member 3. Front frame 1 is in line with rear frame 2. FIG. 5 shows lever 10 having been opened and the cam tension having been released. In this state front frame 1 is still generally in line with rear frame 2 and secondary retention is still engaged, but primary retention has been released. FIG. 6 shows lever 10 having been pushed axially against spring 22 (not shown) allowing front lock member 3 to escape from wedge 8 thus releasing secondary retention and allowing front frame 1 to rotate relative to rear frame 2. FIG. 7 shows front frame 1 having rotated to the folded position relative to rear frame 2. FIGS. 4 through 7 demonstrate that in order to release the fastening mechanism and fold the bicycle, the primary retention must be released as in FIG. 5 and the secondary retention must be released as in FIG. 6. The secondary retention system may be biased to remain in the retaining position at all times due to spring 22 causing wedge 8 to capture both lock body 6 and front lock member 3. Thus, if the bicycle is in the operative riding position, the secondary will be in a retaining position for safety. In order to fold the bicycle in the embodiment set forth in the

figures, the user must disengage the secondary retention and actively hold it disengaged during the initial act of folding of the bicycle. In this way, the user is not able to leave the bicycle unattended with the secondary retention disengaged which could be dangerous for a would-be rider.

Now referring to FIGS. 8 through 12, one configuration of a folding bicycle locking assembly is shown comprising a secondary retention system wherein the secondary retention system is configured to be biased to an engaged position when the bicycle is in the operative riding position and which automatically engages when the bicycle is unfolded to the operative riding position. Shown is the sequence of operations of the fastening mechanism during the unfolding of the bicycle. For clarity, the view is looking downward, however, front main tube 39 is dotted in to show the location of front frame 1. Rear frame 2 is not shown. Shown is the sequence as the front and rear frames fold about axis of rotation 15 where FIG 8 shows the bicycle approaching the operative riding position but before front lock member 3 has engaged lock assembly 4. Lever 10 is in the open position and automatic secondary face 5 is about to engage wedge automatic secondary face 36. Secondary retention face 9 and primary retention face 7 have not yet come into contact with their corresponding surfaces on wedge 8. FIG. 9 shows automatic secondary face 5 having just touched wedge automatic secondary face 36 and FIG. 10 shows that automatic secondary face 5 has pushed on wedge automatic secondary face 36 causing wedge 8 to move to the right compressing spring 22. FIG. 11 shows wedge 8 having moved back to the left after the edge has cleared front lock member edge 41 and spring 22 has acted. In this state, the secondary retention is engaged as secondary retention face 9 and rear secondary retention face 40 are now captured by wedge secondary retention faces 32 and due to the angle of secondary retention face 9 and rear secondary retention face 40 being close to perpendicular to the tangent of the path of rotation of front lock member 3, front lock member 3 is no longer able to separate from lock assembly 4 because wedge 8 prevents the separation. Spring 22 acts to keep wedge secondary retention face 32 and wedge 8 retaining front lock member 3, thus engaging secondary retention. Finally, FIG. 12 shows lever 10 having been closed thus engaging the primary retention by causing wedge primary retention faces 34 to push with cam pressure against primary retention face 7 and rear primary retention face 38. In

this way, the secondary retention is shown to engage automatically and then the primary retention is manually engaged in order to fasten the bicycle in the operative riding position. It can be seen that Wedge 8 has some ability to move side to side on adjusting nut 14 during this process. As shown wedge 8 fastens front lock member 3 and lock assembly 4 together from moving apart in the hinging direction. However, not shown in this sequence is what prevents front lock member 3 and lock assembly 4 from movement in the vertical plane relative to one another. This will be shown in FIGS. 19 and 20.

Now referring to FIGS. 13 through 18, shown in FIGS. 13 and 14 is front lock member 3 where front lock member 3 may be permanently attached to a lower surface of front main tube 39 at fastening surface 13. The various surfaces that cause the automatic engagement of secondary retention are shown which include automatic secondary face 5 and front lock member edge 41. Secondary retention face 9 is also shown. Primary retention face 7 is also shown. Newly shown here is angled face 11 which can serve two functions. The first function is to extend below a corresponding surface on lock assembly 4 in order to secure front lock member 3 to lock assembly 4 such that front lock member 3 is not able to raise up in a vertical direction relative to lock assembly 4 during the large forces experienced during riding. These forces are transferred from one frame to the other through angled face 11. Therefore, angled face 11 allows for a system which does not cause the forces experienced during riding to be born exclusively by skewer 12. It is novel and important to note that angled face 11 is at approximately a right angle from primary retention face 7. This relative angle causes movement of various components in various directions during locking of lever 10 as will be described subsequently.

FIGS. 15 and 16 show the details of lock body 6 wherein rear secondary retention face 40 and rear primary retention face 38 have been discussed in the sequence of FIGS. 8 through 12. Newly shown here is rear angled face 42 wherein rear angled face 42 acts upon angled face 11 shown in FIGS. 13 and 14 to prevent relative vertical movement of front lock member 3 and lock assembly 4 during the forces experienced during riding. Also newly shown in FIGS. 15 and 16 are convex adjusting surface 46, oversized hole 48, and washer cavity 52 which allow lock

body 6 to be adjustably mounted to a bicycle frame such as rear frame 2 so as to account for manufacturing tolerances. In this way lock body 6, a component of lock assembly 4, may be attached to an upper surface of rear frame 2. Anti-rotation tab 50 prevents unwanted rotation of lock body 6 relative to rear frame 2 in an adjustable manner. Like front lock member 3, lock body 6 has two sloping surfaces at approximately a 90 degree angle from one another that cause movement in multiple directions during the fastening of lever 10. FIG. 17 shows wedge 8 with wedge secondary retention faces 32 and wedge primary retention faces 34 and wedge skewer hole 66 which allows for some lateral movement of wedge 8 so as to be able to center for correct alignment during the engaging of the secondary retention surfaces and the primary retention surfaces. Also shown is wedge automatic secondary face 36. FIG. 18 shows how front lock member 3, lock body 6, and wedge 8 fit together with secondary retention surfaces 31 meeting and primary retention surfaces 29 meeting as shown. Also shown is how angled face 11 meets rear angled face 42.

Now referring to the sequence shown in FIGS. 19 and 20, a folding bicycle is desirable which comprises a folding mechanism, and wherein the fastening mechanism is characterized by an assembly that, when actuated to a locked operative riding position, applies a force 23 on the folding mechanism in a manner so as to reduce any construction tolerance that exists in the folding mechanism. In order to accomplish this the fastening mechanism may comprise an upper element 3 extending downward from the upper frame 1 (which is shown as the front frame but could also be the rear frame), and a lower element 6 extending upward from the lower frame 2 (which is shown as the rear frame but could be the front frame) and wherein, in the act of unfolding the bicycle to the operative riding position, the upper element 3 and lower element 6 meet and are held together by a third retaining element such as wedge 8 (not shown). The upper element 3 contains a catch portion 45 that extends below a portion of the lower element and the lower element contains a catch portion 68 that extends above a portion of the upper element. The upper catch portion 45 and the lower catch portion 68 have corresponding sloping surfaces 11 and 42 that meet when the bicycle is moved to the operative riding position and wherein a third retaining element 8 (not shown) acts to cause the corresponding sloping surfaces to compress causing the upper catch portion and the upper

frame 1 to pull up on the lower catch portion and the lower frame 2. Upper element 3 and lower element 6 may contain a plurality of corresponding sloping surfaces with one set 11 and 42 generally parallel to the ground, and one set 38 and 7 (not shown) generally perpendicular to the ground and wherein the third retaining element 8 is actuated by an actuation device 10 and 12 and such actuation causes corresponding sloping surfaces to compress and fasten in both horizontal and vertical directions. This allows for the side to side forces encountered during riding to be generally transferred from front frame 1 to rear frame 2 and from rear frame 1 to front frame 2 through the actuation device 8. Likewise, the vertical forces encountered during riding are generally transferred from front frame 1 to rear frame 2 and rear frame 2 to front frame 1 through the corresponding sloping surfaces 11 and 42 and not through the actuation device 12. This is desirable as the actuation device 12 is often a moving member and not as strong. In summary, when wedge 8 is actuated by lever 10 and skewer 12, wedge primary retention face 34 pushes angled primary retention face 7 and rear primary retention face 38 toward each other thus causing angled face 11 and rear hinge preload face 42 to slide against each other. Angled surface pairs 38, 34 and 7, 34 and 11, 42 are shown at right angles to one another, however, it will be apparent to those skilled in the trade that they could be replaced by surfaces at other angles relative to one another or a different shaped surface such as a circular conical shape which would function similarly. More specifically, FIG 19 shows the bicycle in the unfolded position with the secondary retention engaged, but with lever 10 in the open position such that the primary retention system is not engaged. Moving lever 10 to the closed position shown in FIG 20 can accomplish two things. First, it serves to fasten the primary retention system as demonstrated in FIGS. 11 and 12. Second, it can cause rear hinge preload face 42 to slide upward along angled face 11 thereby causing hinge preload 23 which removes unwanted tolerance in the hinging mechanism. This transpires because the downward slide by angled face 11 along rear hinge preload face 42 pulls front lock member 3 downward, which in turn pulls front main tube 39 downward thus applying a moment arm force on outer seat tube 17 which in turn removes any manufacturing tolerance found between bushings 27 and outer seat tube 17 and seat tube 54. In this way primary unlocked space 19 is reduced to primary locked space 21 or eliminated. Seat tube clamp 56 is clamped to seat tube 54 which is part of

rear frame 2 and holds bushing 27 and outer seat tube 17 in place. Also shown are one or more vertical adjusting spacers 25 which adjust front frame 1 up or down relative to rear frame 2 to account for manufacturing tolerances. This process is further demonstrated in the sections drawn in FIGS. 22 and 23.

Manufacturing tolerances are always present and therefore incorporating systems to account for them is important in any assembly. The present invention can require angled surfaces fastened to different frames, and usually offset from the hinging position, to meet at the correct location and angle, and therefore the ability to make angle adjustments post-manufacturing is important. FIGS. 24 through 26 show a folding bicycle wherein the fastening mechanisms 3 and/or 4 are attached to the front frame 1 or the rear frame 2 in a manner allowing them to be adjusted from time to time relative to the front or rear frame to allow for manufacturing tolerances. One method of accomplishing this is as shown, where lock assembly 4 can be adjusted in an angular manner by loosening fixing bolt 16, which is threaded into threaded hole 60, and having convex adjusting surface 46 slide on adjusting bowl 64, and bowl washer 24 slide on washer cavity 52 while fixing bolt 16 moves inside oversized hole 48 to the desired position. As these surfaces are spherical, angle adjustment is possible in any direction but is only shown in FIGS. 24 and 25 in a direction parallel to the wheels of the bicycle. This adjustability combined with vertical adjustment using vertical adjusting spacers 25 allows for a wide range of adjustment. Not shown but apparent to those skilled in the trade is an assembly also adjustable in a direction parallel to the centerline of the bicycle frame.

Ease of use of any locking assembly on a folding bicycle is desired, and FIGS. 27 and 28 show how, after lever 10 is operated to release primary retention, a second operation is required in order to release secondary retention. One method of operation consists of moving wedge 8 forward by pushing on lever 10 which pivots off outer seat tube 17 at axis of rotation point 43.

Throughout these figures, it should be noted that front frame 1 is shown as a single main tube, however, it may be comprised of a plurality of frame members fastened together in a fixed manner or a hinged, or suspension manner, or a removable manner, or a manner where

members are moveable relative to one another such as those found on folding bikes. In addition, rear frame 2 may be comprised of a single member, or a plurality of frame members fixed together as shown, or a plurality of frame members fastened together in a hinged, suspension, or removable manner which are moveable relative to one another such as those commonly found in bicycle suspension or folding bikes.

In considering the breadth of the present invention, the terms "member," "portion," "component", "part" or "element" when used in the singular form can also be considered to include the plural form including multiple parts. The term "comprising" when used is intended to specify the inclusion of the described features, components or steps, but does not exclude other features, components or steps not described. The terms "hinging", "pivoting", "rotating", and "folding" and their derivatives are used interchangeably and have the same meaning. The terms "locking", and "fastening" and their derivatives are used interchangeably and have the same meaning. The term "engaged" means to be fastened together. The term "primary retention" refers to the system that is the primary lock. The term "secondary retention" refers to the system that holds or locks the assembly if the primary retention is released or fails.

While only selected embodiments have been chosen to illustrate the present invention, it will be apparent to those skilled in the art from this disclosure that various changes and modifications can be made herein without departing from the scope of the invention as defined in the appended claims. Furthermore, the foregoing descriptions of the embodiments according to the present invention are provided for illustration only, and not for the purpose of limiting the invention as defined by the appended claims and their equivalents.

## Claims:

1. A folding bicycle comprising a seat tube, a front frame for mounting a front wheel fork assembly, and a rear frame for mounting a rear wheel, said front and rear frames oriented so that when folding each frame can be rotated about a common axis of rotation backward or forward without contacting a structural member of the other frame except at folding and fastening locations, said axis of rotation located at or near the seat tube, and said fastening location positioned near but not on the seat tube, further comprising a fastening mechanism positioned to fasten said front and rear frames in a locked operative riding position by actuation of a member located not above the uppermost surface of said front frame.
2. A folding bicycle of Claim 1 further comprising a folding mechanism located at said axis or rotation, wherein said fastening mechanism, when actuated to a locked operative riding position, applies a force on said folding mechanism in a manner so as to reduce any construction tolerance in said folding mechanism.
3. A folding bicycle of Claim 1 further comprising a secondary retention system wherein said secondary retention system automatically engages when the bicycle is unfolded to the operative riding position.
4. A folding bicycle of Claim 3 wherein said secondary retention system is configured to be biased to an engaged position when the bicycle is in the operative riding position.
5. A folding bicycle of claim 4 wherein said secondary retention system must be manually held disengaged during the initial act of folding said bicycle.
6. A folding bicycle of claim 1 wherein said fastening mechanism is fastened to a lower surface of the front frame and an upper surface of the rear frame.

7. A folding bicycle of claim 1 wherein at least a portion of said fastening mechanism is attached to at least one of said front frame or said rear frame in a manner allowing said portion of fastening mechanism to be adjusted from time to time relative to said front or rear frame to allow for manufacturing tolerances.

8. A folding bicycle of claim 1 wherein said front frame is either an upper or lower frame and said rear frame is the corresponding opposite lower or upper frame and wherein said fastening mechanism further comprises an upper element extending downward from the upper frame, and a lower element extending upward from said lower frame and wherein, in the act of unfolding the bicycle to the operative riding position, said upper element and said lower element meet and are held together by a third retaining element.

9. A folding bicycle of claim 8 wherein said upper element contains a catch portion that extends below a portion of said lower element and said lower element contains a catch portion that extends above a portion of said upper element.

10. A folding bicycle of claim 9 wherein said upper catch portion and said lower catch portion have corresponding sloping surfaces that meet when the bicycle is moved to the operative riding position and wherein said third retaining element acts to cause said corresponding sloping surfaces to compress causing said upper catch portion and said upper frame to pull up on said lower catch portion and said lower frame.

11. A folding bicycle of claim 8 wherein said upper and lower elements further contain a plurality of corresponding sloping surfaces with one set generally parallel to the ground, and one set generally perpendicular to the ground and wherein said third retaining element is actuated by an actuation device and such actuation causes the corresponding sloping surfaces to compress and fasten in both horizontal and vertical directions.

12. A folding bicycle of claim 11 wherein the side to side forces encountered during riding are

generally transferred from front frame to rear frame and from rear frame to front frame through said actuation device.

13. A folding bicycle of claim 11 wherein the vertical forces encountered during riding are generally transferred from front frame to rear frame and rear frame to front frame through said corresponding sloping surfaces and not through said actuation device.

14. A folding bicycle of claim 1 wherein the front frame is comprised of a plurality of frame members.

15. A folding bicycle of claim 1 wherein the rear frame is comprised of a plurality of frame members.

16. A folding bicycle of claim 1 wherein said axis of rotation consists of a frame member from said front frame and a frame member from said rear frame configured in a concentric manner.

17. A folding bicycle of claim 1 wherein said axis of rotation is a substantially vertical axis located at a position proximate to a midpoint between the front and rear wheels.

18. A folding bicycle comprising an axis of rotation and a fastening system wherein said axis of rotation comprises hinge members and wherein said fastening system is located at a position which is, as measured along the direction of travel of the bicycle, different from said axis of rotation, and wherein said fastening system functions to both fasten the bicycle together in the operative riding position and to load the axis of rotation in a manner so as to reduce the manufacturing tolerances in said hinge members so as to reduce relative movement between the hinge members during riding.

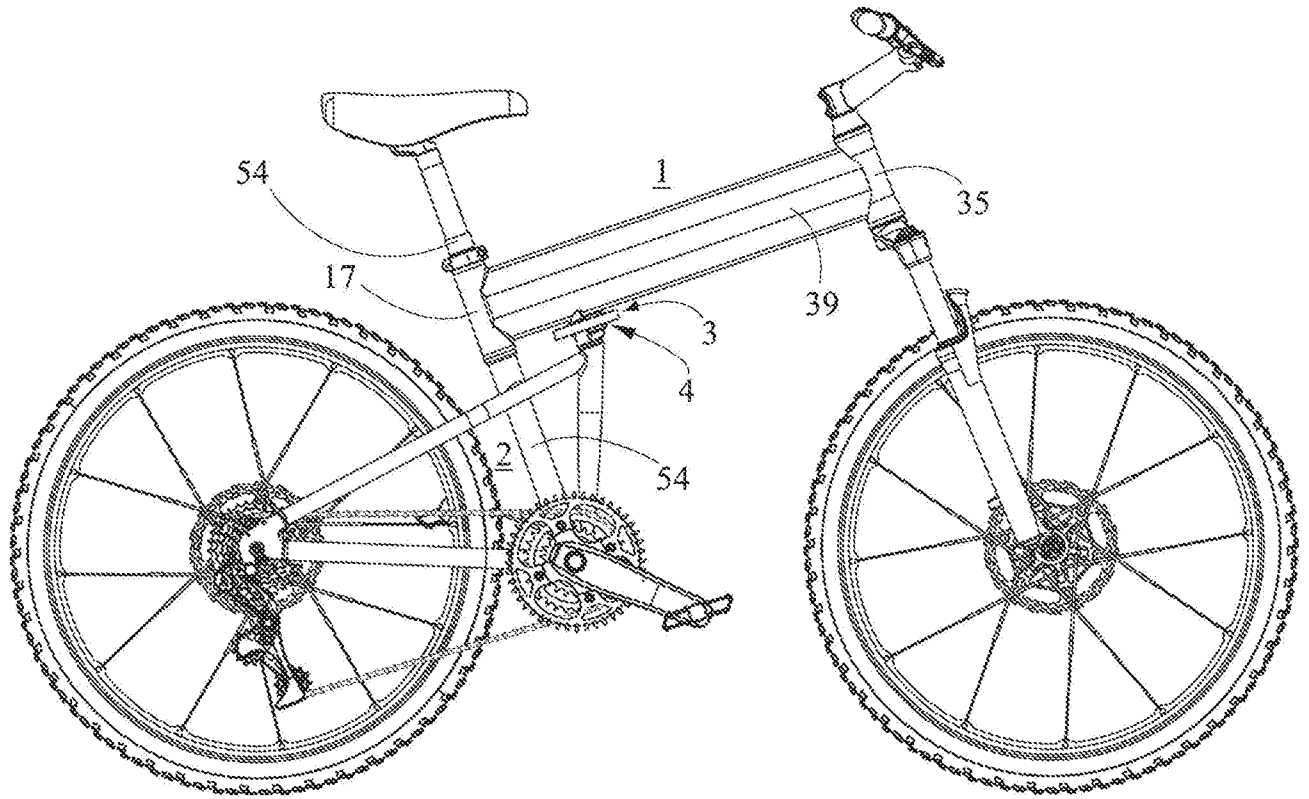

Figure 1

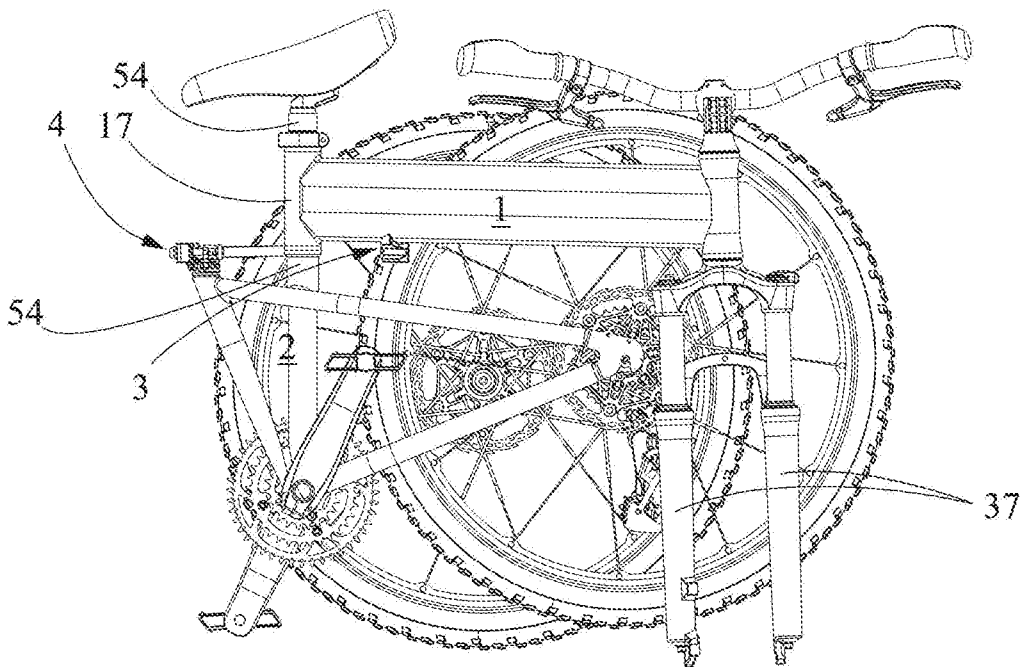

Figure 2

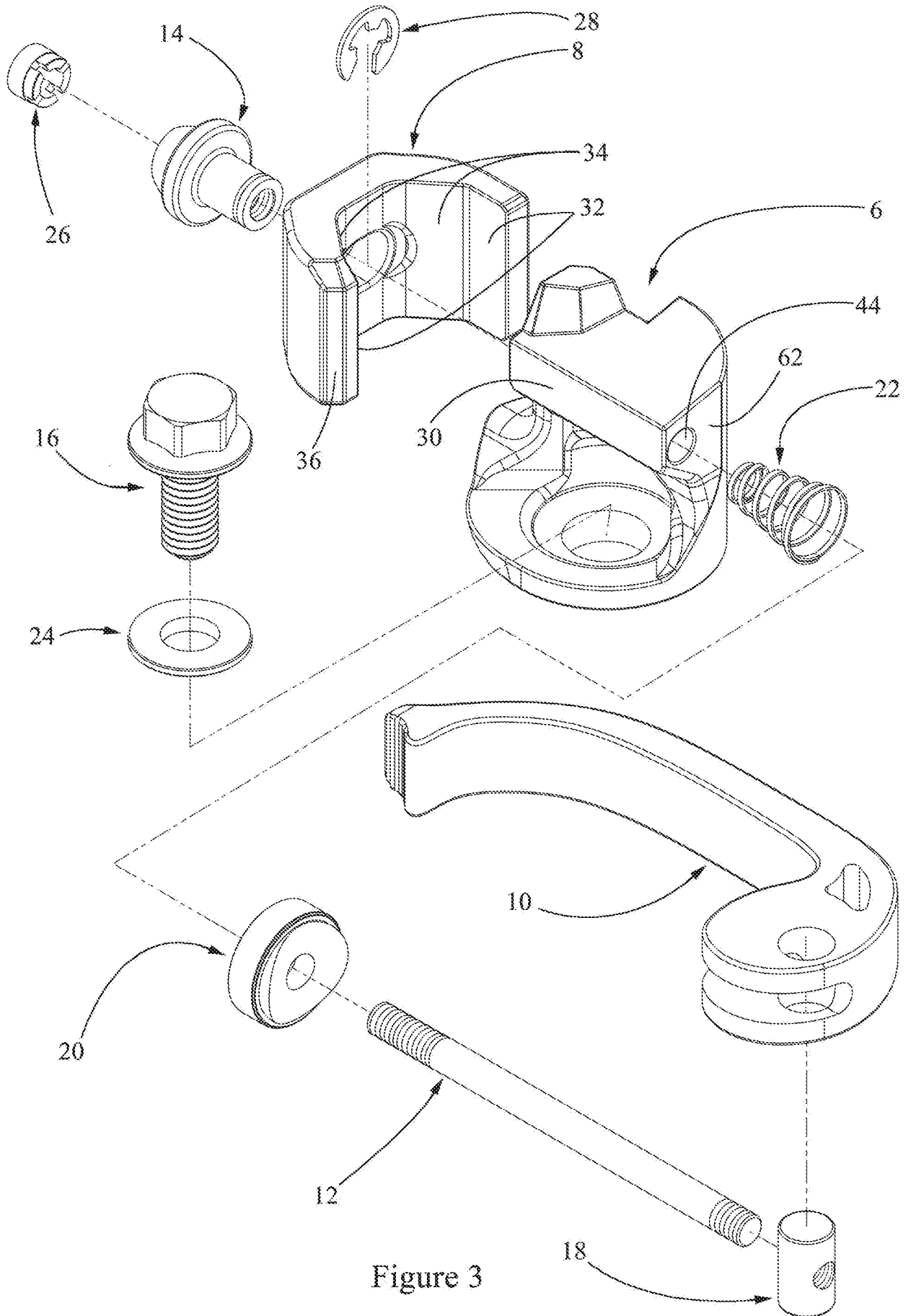

Figure 3

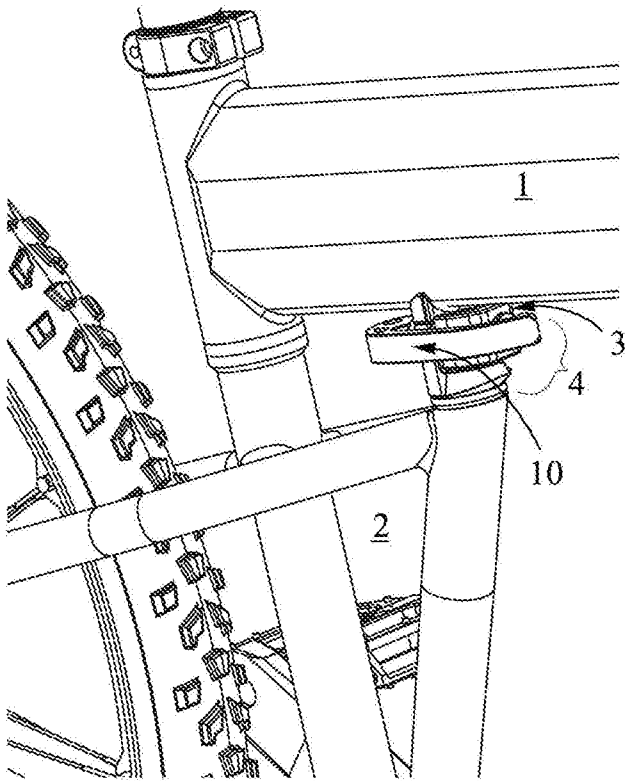

Figure 4

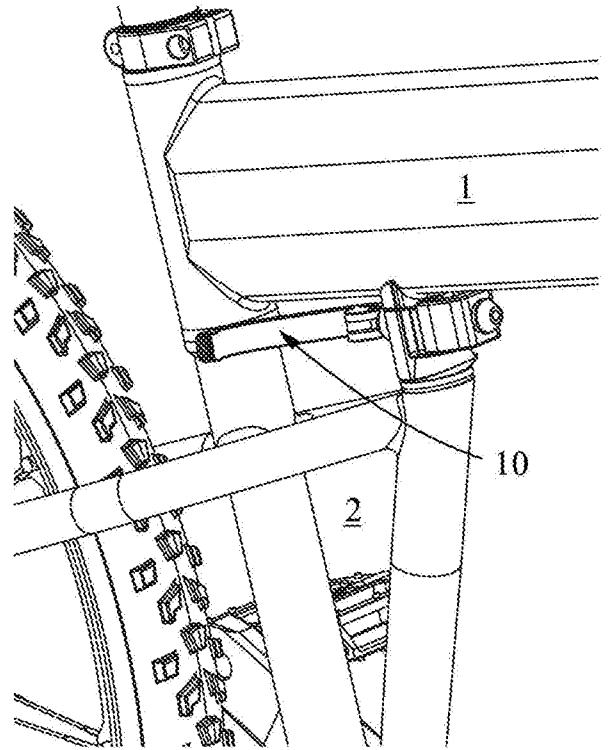

Figure 5

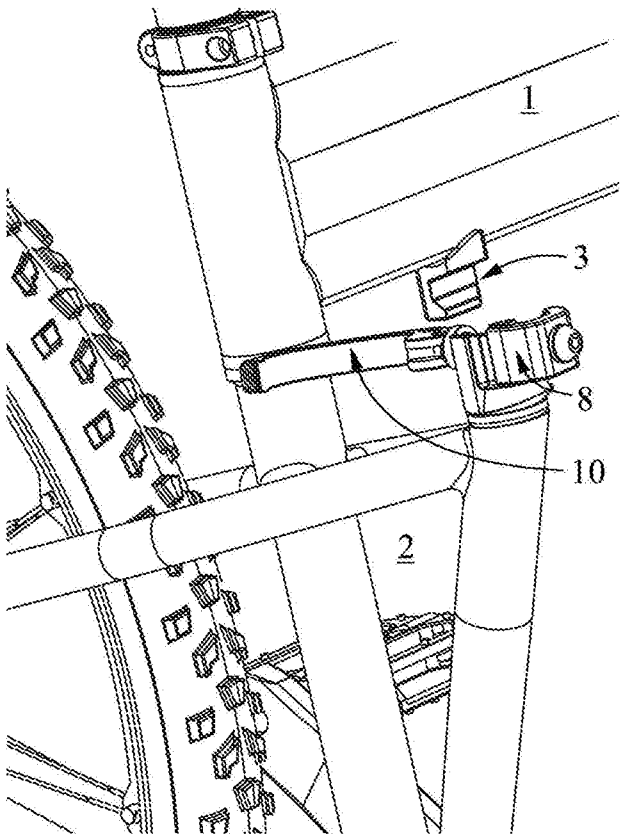

Figure 6

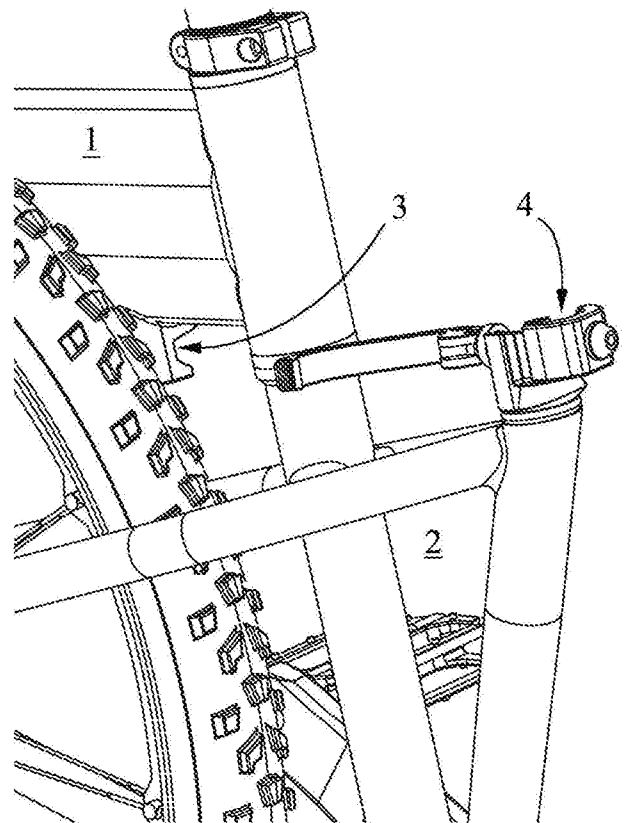
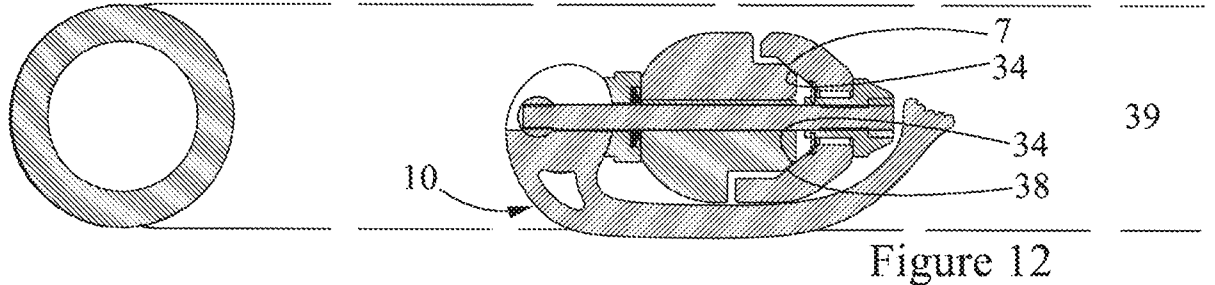
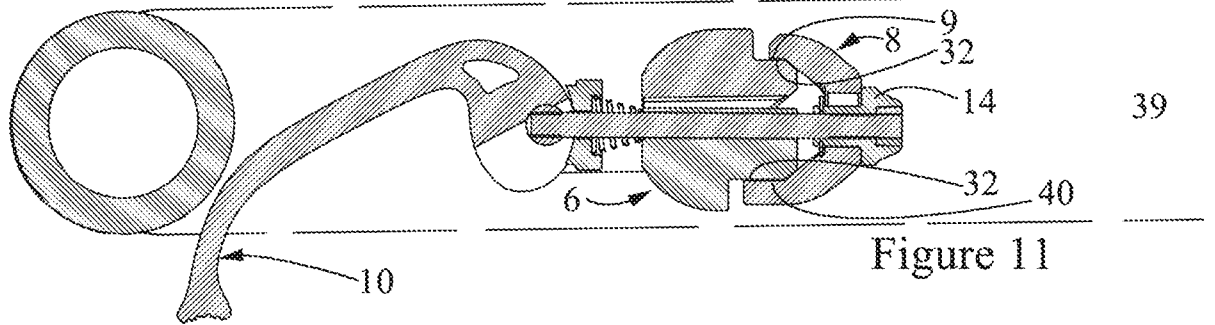
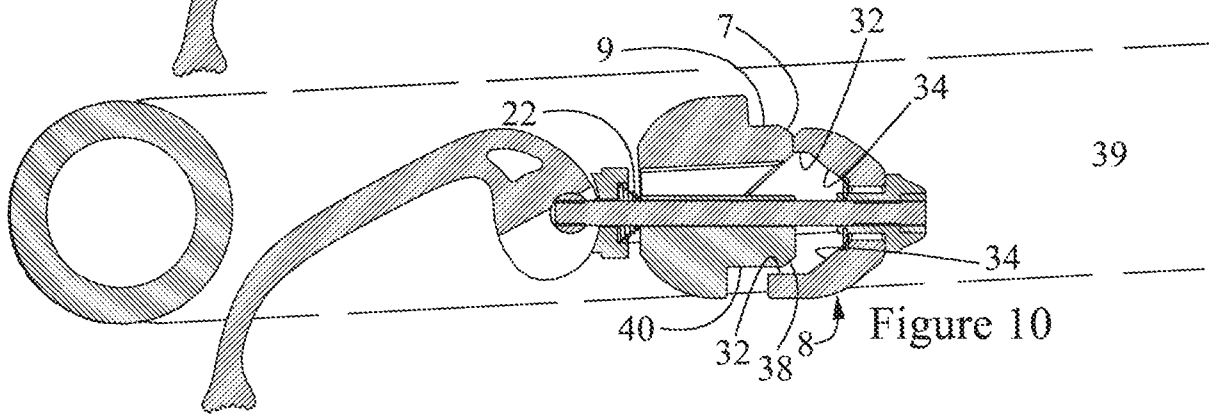
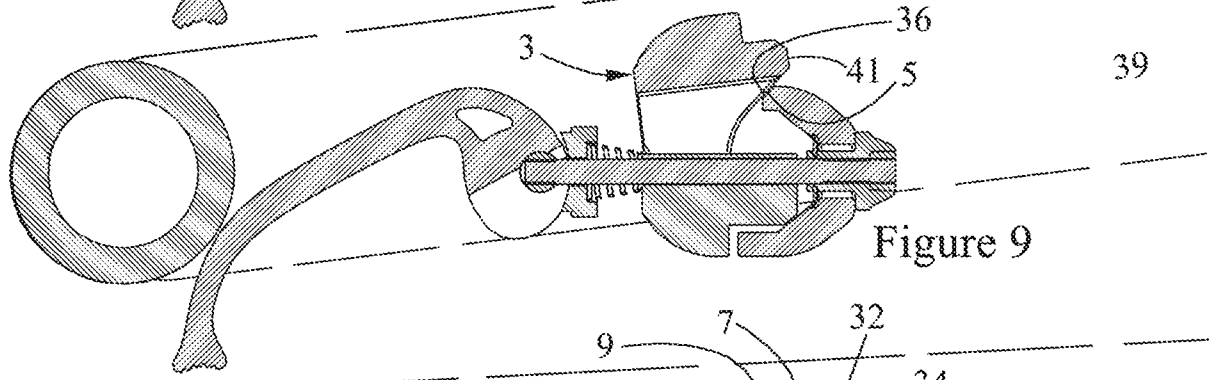
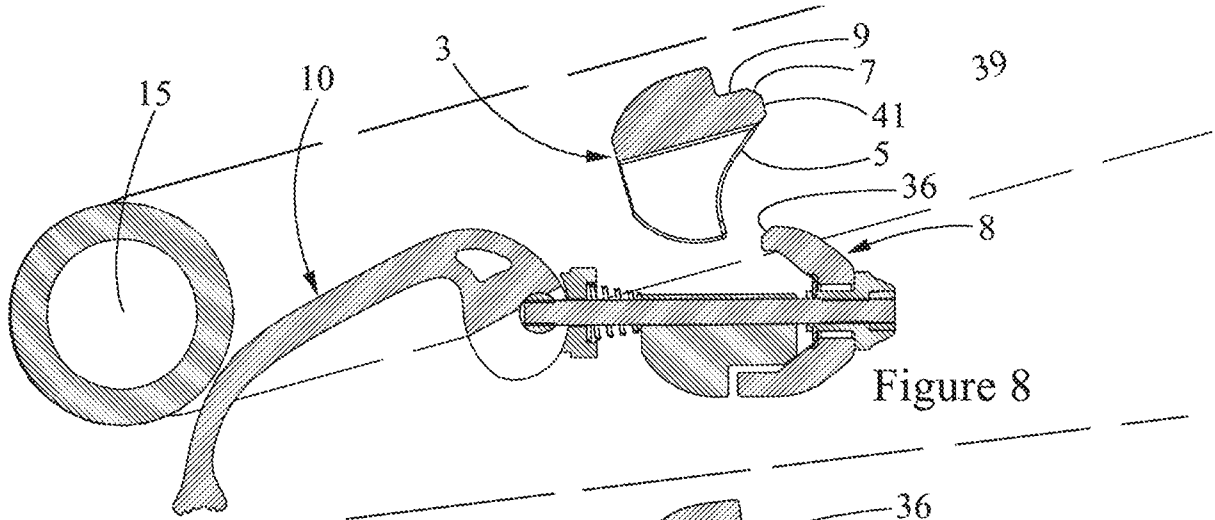

Figure 7



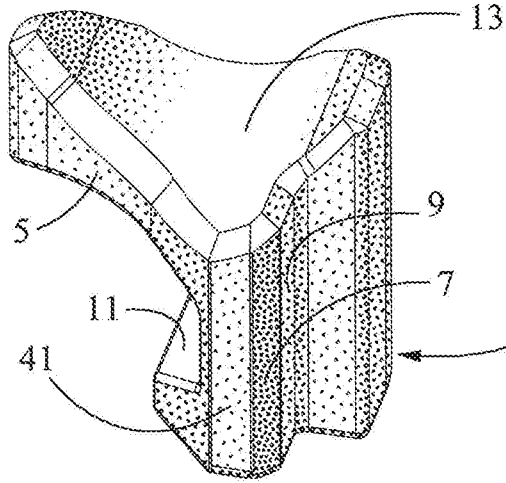

Figure 13

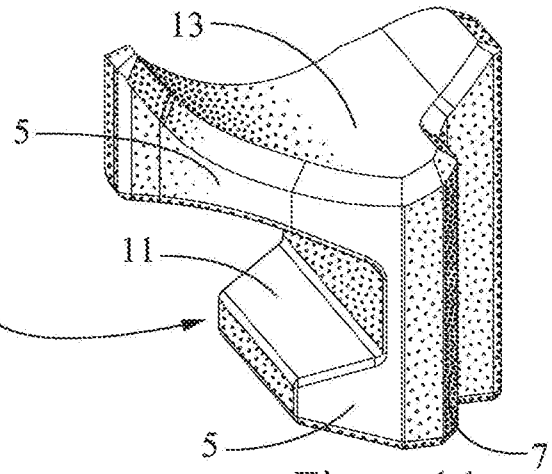

Figure 14

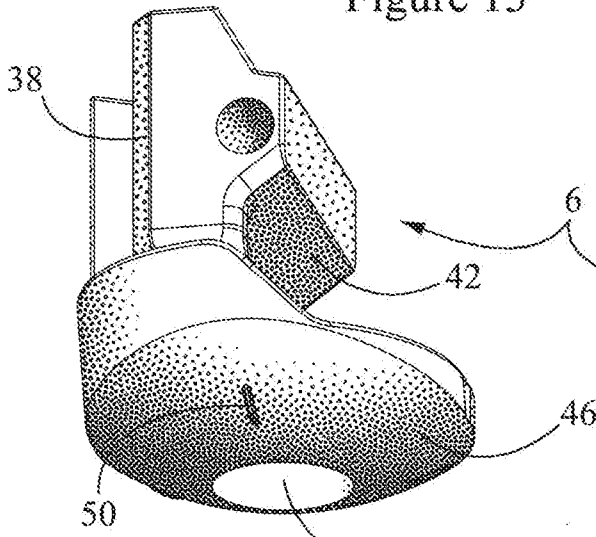

Figure 15

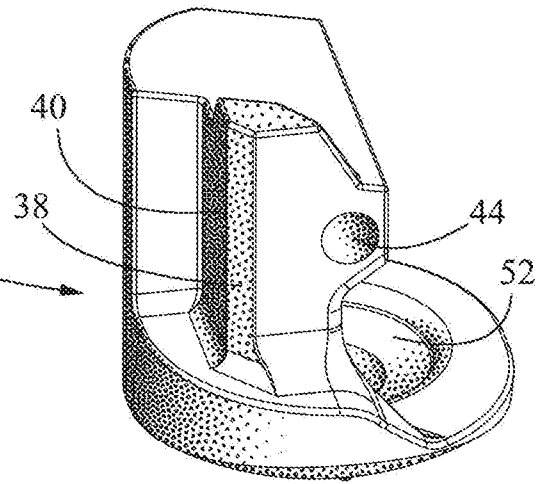

Figure 16

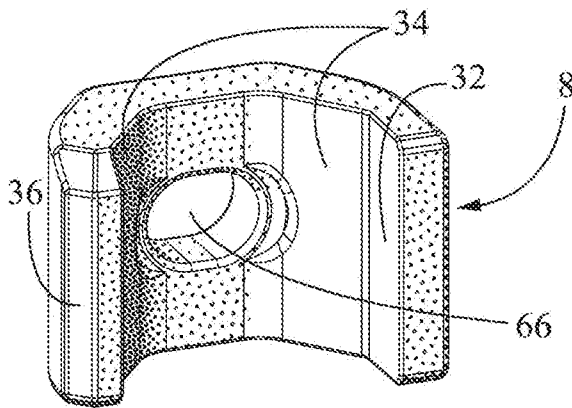

Figure 17

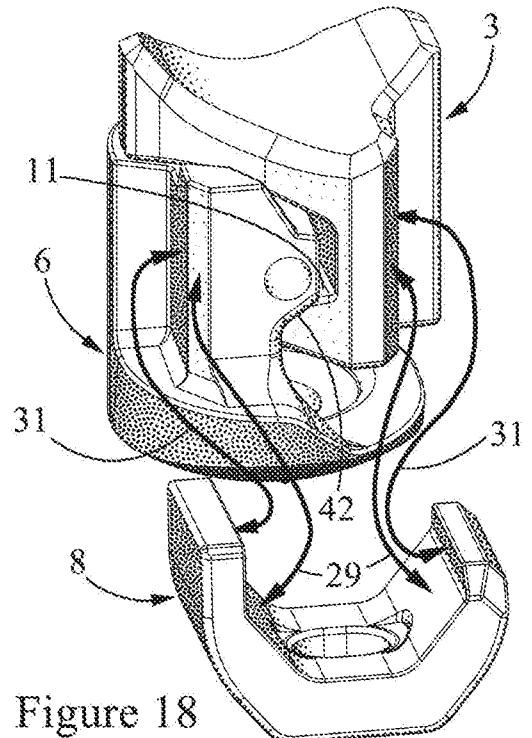

Figure 18

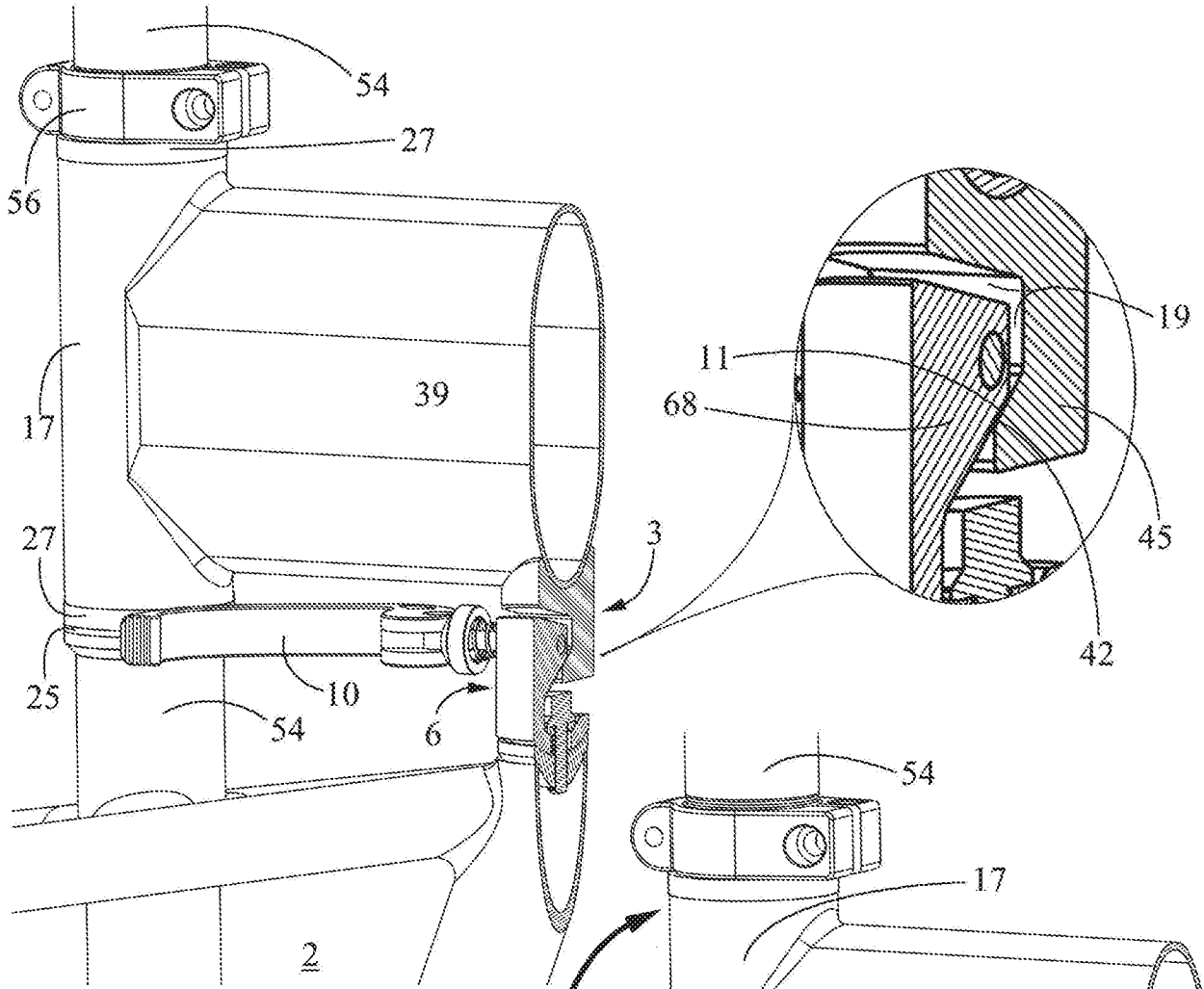

Figure 19

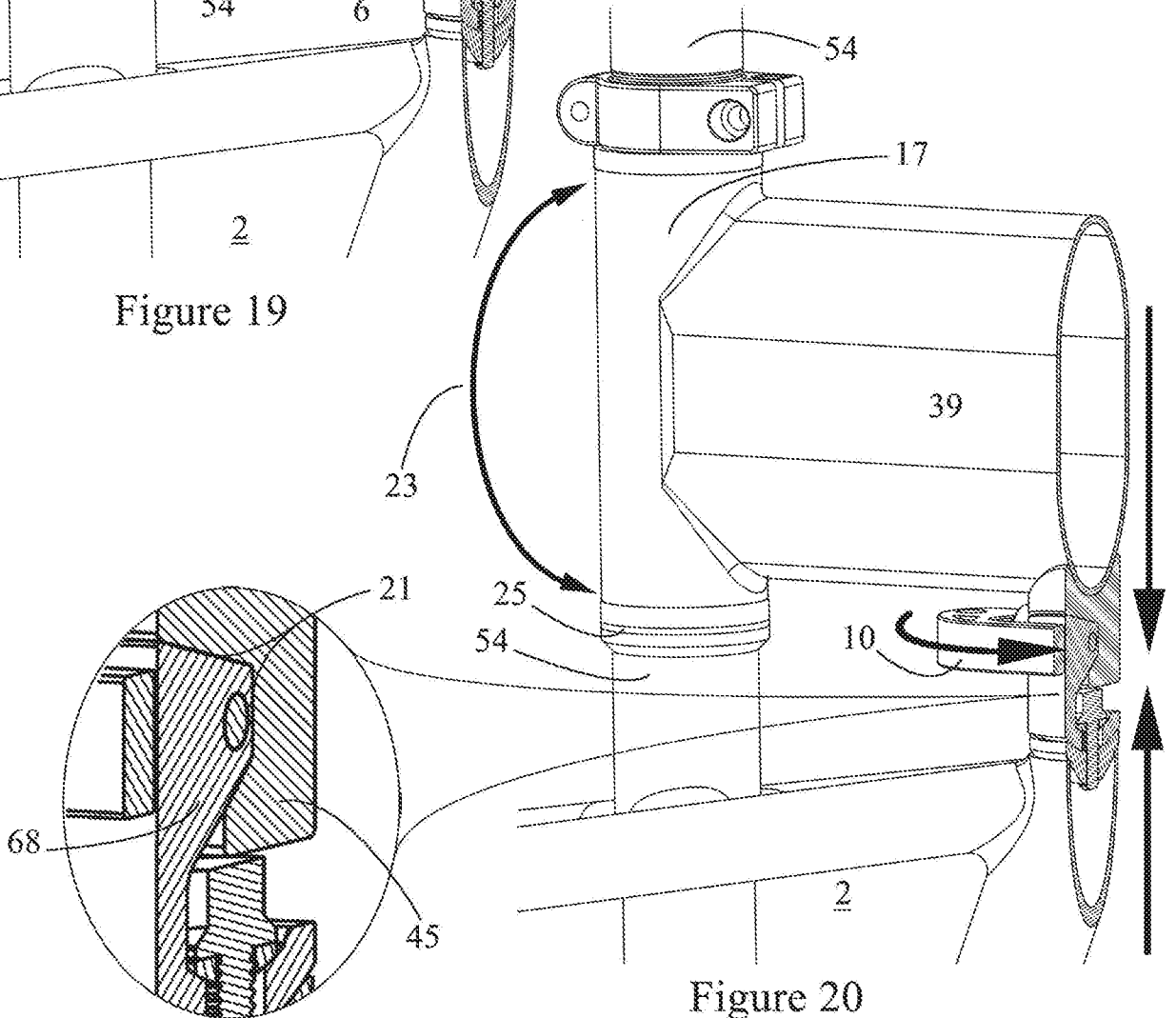

Figure 20

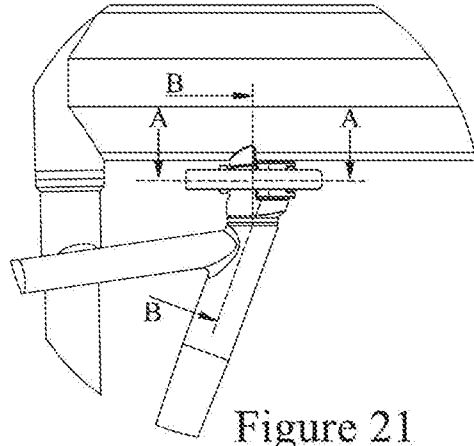
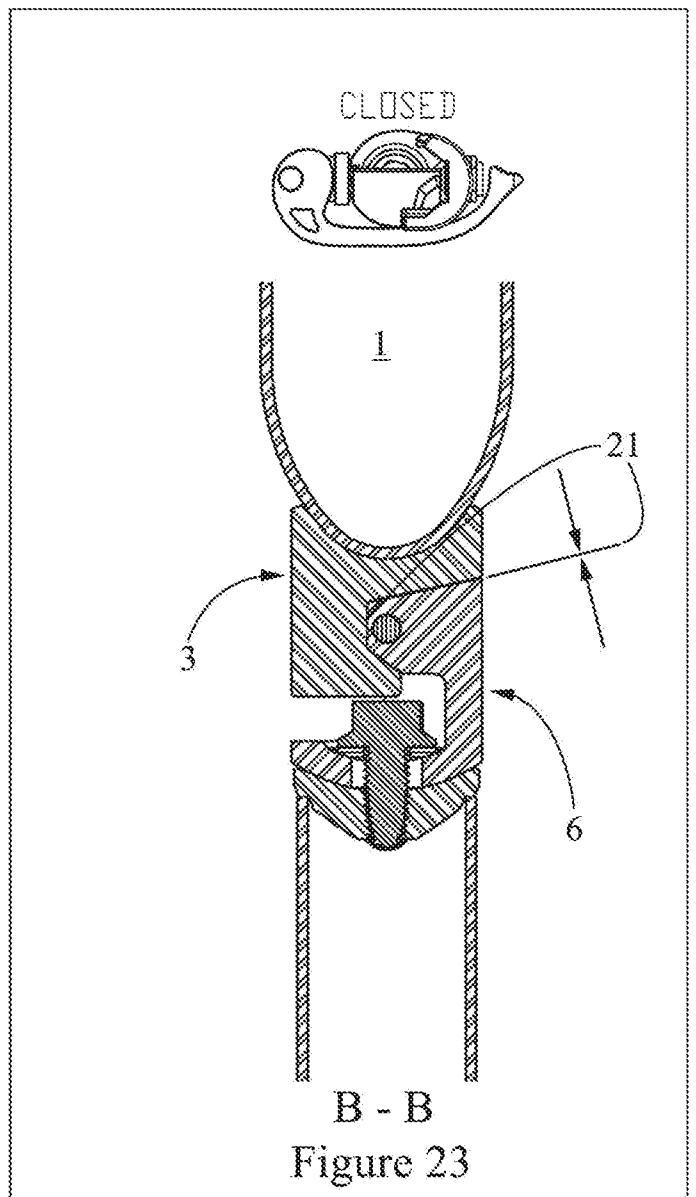
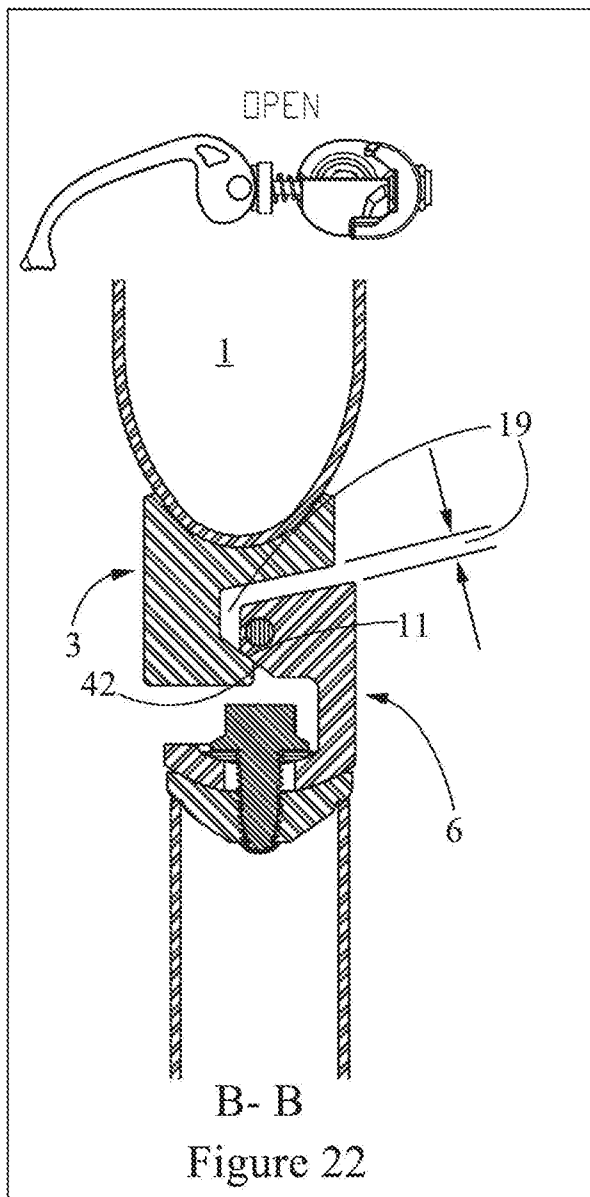

Figure 21



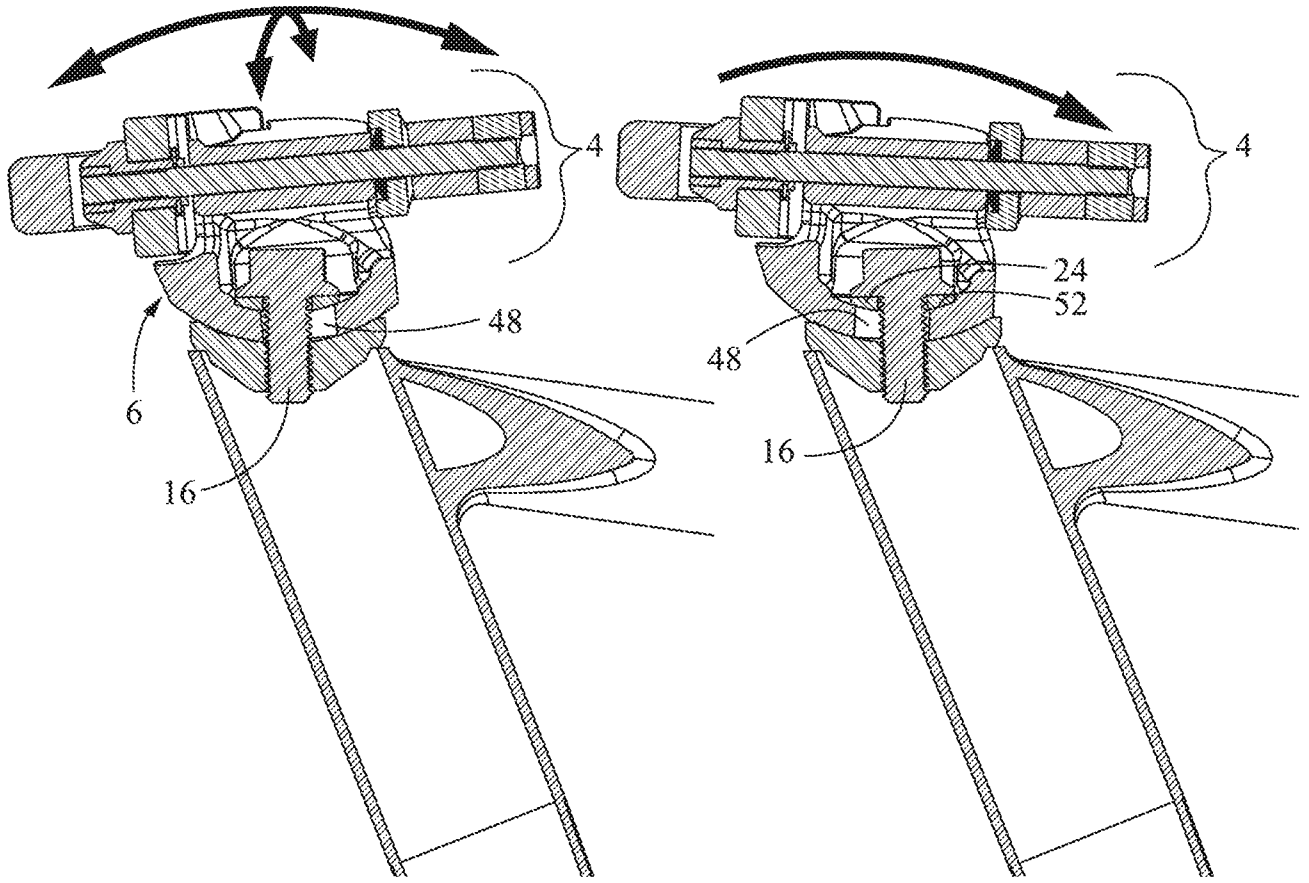

Figure 24

Figure 25

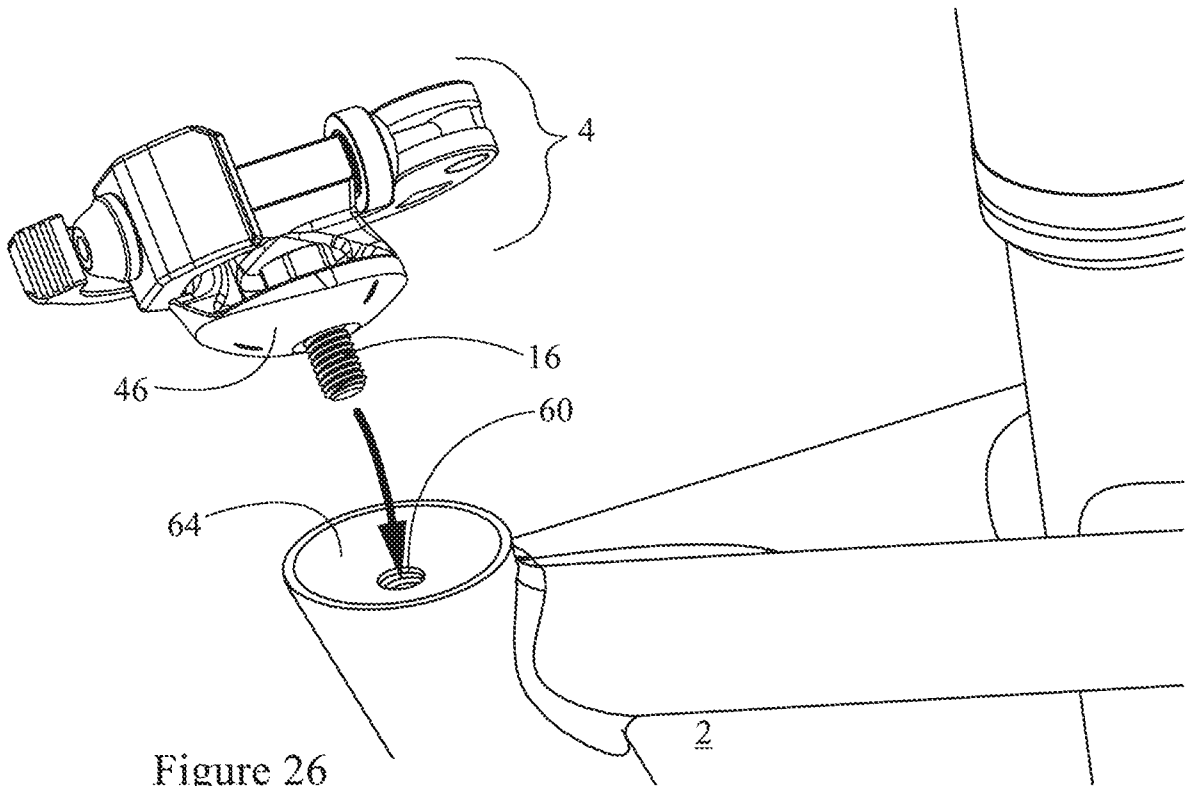

Figure 26

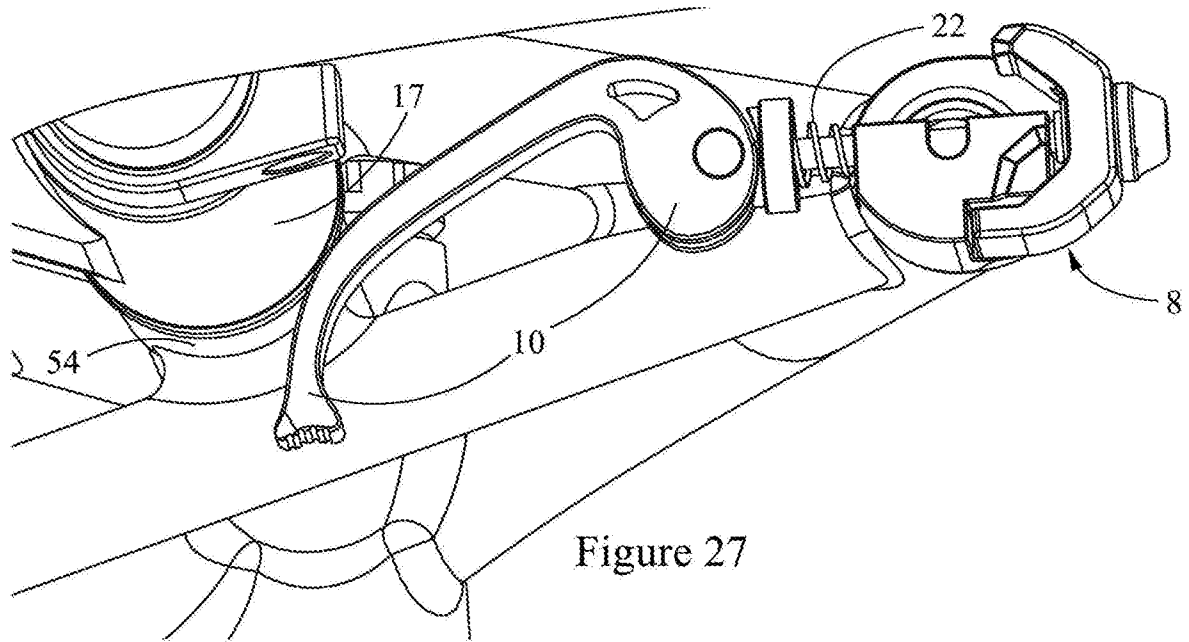

Figure 27

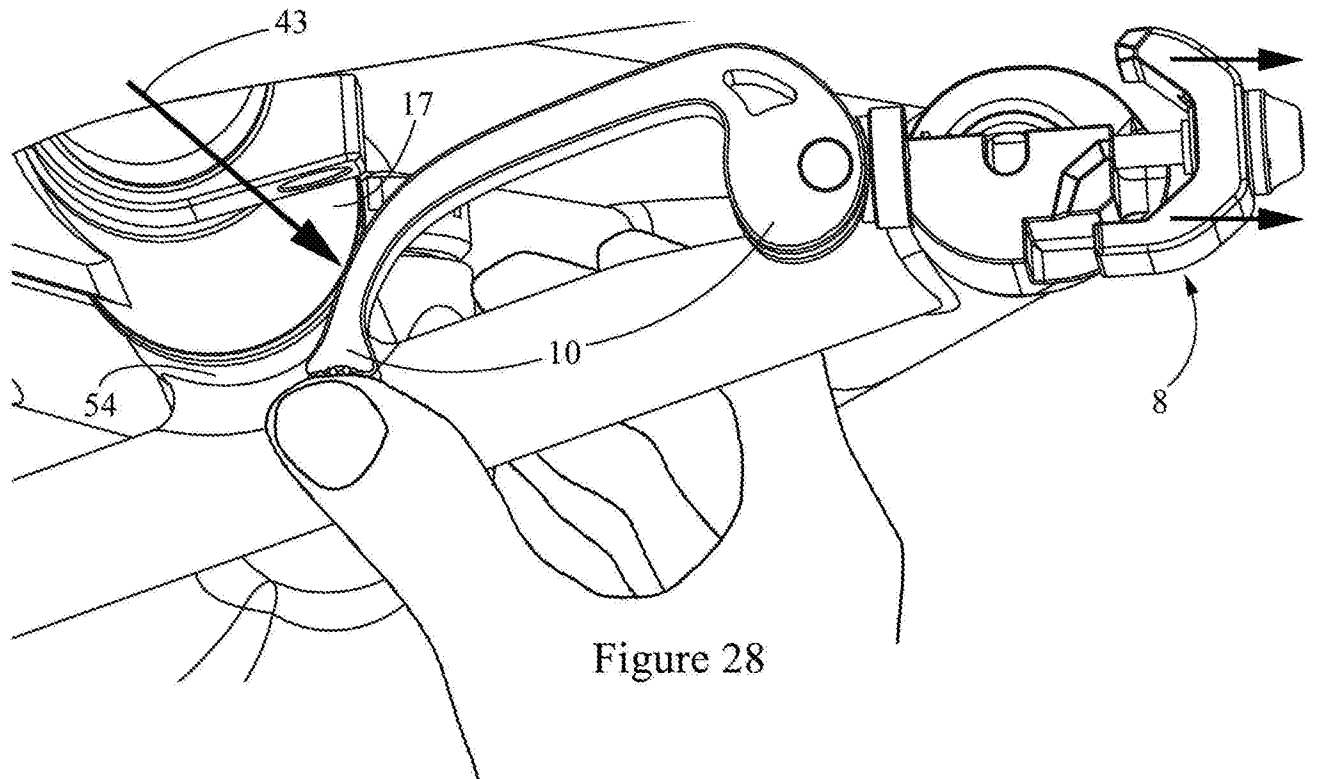

Figure 28

<b>INTERNATIONAL SEARCH REPORT</b>		International application No.  PCT/US16/42523
<b>A. CLASSIFICATION OF SUBJECT MATTER</b> IPC: <b>B62K 5/00( 2013.01),7/00( 2006.01)</b>  USPC:       280/283 According to International Patent Classification (IPC) or to both national classification and IPC		
<b>B. FIELDS SEARCHED</b>		
Minimum documentation searched (classification system followed by classification symbols) U.S. : 280/283		
Documentation searched other than minimum documentation to the extent that such documents are included in the fields searched		
Electronic data base consulted during the international search (name of data base and, where practicable, search terms used)		
<b>C. DOCUMENTS CONSIDERED TO BE RELEVANT</b>		
<b>Category *</b>	<b>Citation of document, with indication, where appropriate, of the relevant passages</b>	<b>Relevant to claim No.</b>
X	US 2012/0169029 A1(MARAIS et al.) 05 July 2012, see entire document.	1-18
A	US 4,417,745 (SHOMO) 29 November 1983, see entire document.	1-18
A	US 6,270,103 B1 (Grimm) 07 August 2001, see entire document.	1-18
<input type="checkbox"/> Further documents are listed in the continuation of Box C. <input type="checkbox"/> See patent family annex.		
* Special categories of cited documents:		
"A" document defining the general state of the art which is not considered to be of particular relevance  "E" earlier application or patent published on or after the international filing date  "L" document which may throw doubts on priority claim(s) or which is cited to establish the publication date of another citation or other special reason (as specified)  "O" document referring to an oral disclosure, use, exhibition or other means  "P" document published prior to the international filing date but later than the priority date claimed	"T" later document published after the international filing date or priority date and not in conflict with the application but cited to understand the principle or theory underlying the invention  "X" document of particular relevance; the claimed invention cannot be considered novel or cannot be considered to involve an inventive step when the document is taken alone  "Y" document of particular relevance; the claimed invention cannot be considered to involve an inventive step when the document is combined with one or more other such documents, such combination being obvious to a person skilled in the art  "&" document member of the same patent family	
Date of the actual completion of the international search 19 September 2016 (19.09.2016)		Date of mailing of the international search report <b>26 SEP 2016</b>
Name and mailing address of the ISA/US Mail Stop PCT, Attn: ISA/US Commissioner for Patents P.O. Box 1450 Alexandria, Virginia 22313-1450 Facsimile No. (571) 273-8300		Authorized officer  John Nguyen  Telephone No. 571-272-4300

INTERNATIONAL SEARCH REPORT		International application No. PCT/US16/42523
C (Continuation). DOCUMENTS CONSIDERED TO BE RELEVANT		
Category *	Citation of document, with indication, where appropriate, of the relevant passages	Relevant to claim No.

<b>INTERNATIONAL SEARCH REPORT</b>	International application No. PCT/US16/42523
<b>Box No. I Nucleotide and/or amino acid sequence(s) (Continuation of item 1.c of the first sheet)</b>	
<p>1. With regard to any nucleotide and/or amino acid sequence disclosed in the international application, the international search was carried out on the basis of:</p> <p>a. type of material</p> <p><input type="checkbox"/> a sequence listing</p> <p><input type="checkbox"/> table(s) related to the sequence listing</p> <p>b. format of material</p> <p><input type="checkbox"/> on paper</p> <p><input type="checkbox"/> in electronic form</p> <p>c. time of filing/furnishing</p> <p><input type="checkbox"/> contained in the international application as filed</p> <p><input type="checkbox"/> filed together with the international application in electronic form</p> <p><input type="checkbox"/> furnished subsequently to this Authority for the purposes of search</p> <p>2. <input type="checkbox"/> In addition, in the case that more than one version or copy of a sequence listing and/or table relating thereto has been filed or furnished, the required statements that the information in the subsequent or additional copies is identical to that in the application as filed or does not go beyond the application as filed, as appropriate, were furnished.</p> <p>3. Additional comments:</p>	

<b>INTERNATIONAL SEARCH REPORT</b>	International application No. PCT/US16/42523
<b>Box No. II Observations where certain claims were found unsearchable (Continuation of item 2 of first sheet)</b>	
This international search report has not been established in respect of certain claims under Article 17(2)(a) for the following reasons:	
1. <input type="checkbox"/>	Claims Nos.: because they relate to subject matter not required to be searched by this Authority, namely:
2. <input type="checkbox"/>	Claims Nos.: because they relate to parts of the international application that do not comply with the prescribed requirements to such an extent that no meaningful international search can be carried out, specifically:
3. <input type="checkbox"/>	Claims Nos.: because they are dependent claims and are not drafted in accordance with the second and third sentences of Rule 6.4(a).
<b>Box No. III Observations where unity of invention is lacking (Continuation of item 3 of first sheet)</b>	
This International Searching Authority found multiple inventions in this international application, as follows:	
1. <input type="checkbox"/>	As all required additional search fees were timely paid by the applicant, this international search report covers all searchable claims.
2. <input type="checkbox"/>	As all searchable claims could be searched without effort justifying additional fees, this Authority did not invite payment of any additional fees.
3. <input type="checkbox"/>	As only some of the required additional search fees were timely paid by the applicant, this international search report covers only those claims for which fees were paid, specifically claims Nos.:
4. <input type="checkbox"/>	No required additional search fees were timely paid by the applicant. Consequently, this international search report is restricted to the invention first mentioned in the claims; it is covered by claims Nos.:
<b>Remark on Protest</b>	<input type="checkbox"/> The additional search fees were accompanied by the applicant's protest and, where applicable, the payment of a protest fee.
	<input type="checkbox"/> The additional search fees were accompanied by the applicant's protest but the applicable protest fee was not paid within the time limit specified in the invitation.
	<input type="checkbox"/> No protest accompanied the payment of additional search fees.