

(19) World Intellectual Property Organization
International Bureau



(43) International Publication Date
10 April 2008 (10.04.2008)

PCT

(10) International Publication Number
WO 2008/042987 A3

- (51) International Patent Classification:
A61B 17/22 (2006.01)
- (21) International Application Number:
PCT/US2007/080348
- (22) International Filing Date: 3 October 2007 (03.10.2007)
- (25) Filing Language: English
- (26) Publication Language: English
- (30) Priority Data:
60/828,209 4 October 2006 (04.10.2006) US
60/894,173 9 March 2007 (09.03.2007) US
- (71) Applicant (for all designated States except US): **PATHWAY MEDICAL TECHNOLOGIES, INC.** [US/US];
10801 - 120th Avenue N.E., Kirkland, WA 98033 (US).
- (72) Inventors; and
- (75) Inventors/Applicants (for US only): **TORRANCE, Casey** [US/US]; 6528 Latona Ave. N.E., Seattle, WA 98115 (US). **WALSH, Kate** [US/US]; Pathway Medical Technologies, Inc., 10801 - 120th Ave. N.E., Kirkland, WA 98033 (US). **SALSTROM, Jarod** [US/US]; Pathway

Medical Technologies, Inc., 10801 - 120th Ave. N.E., Kirkland, WA 98033 (US). **YOUMANS, Scott** [US/US]; 16410 - 122nd Place N.E., Bothell, WA 98011 (US). **AUTH, David** [US/US]; 537 - 5th Ave. West, Kirkland, WA 98033 (US). **WULFMAN, Edward, I.** [US/US]; 18807 - 186th Ave. N.E., Woodinville, WA 98072 (US).

(74) Agents: **SPECKMAN, Ann, W.** et al.; Speckman Law Group PLLC, 1201 Third Avenue, Suite 330, Seattle, WA 98101 (US).

(81) Designated States (unless otherwise indicated, for every kind of national protection available): AE, AG, AL, AM, AT, AU, AZ, BA, BB, BG, BH, BR, BW, BY, BZ, CA, CH, CN, CO, CR, CU, CZ, DE, DK, DM, DO, DZ, EC, EE, EG, ES, FI, GB, GD, GE, GH, GM, GT, HN, HR, HU, ID, IL, IN, IS, JP, KE, KG, KM, KN, KP, KR, KZ, LA, LC, LK, LR, LS, LT, LU, LY, MA, MD, ME, MG, MK, MN, MW, MX, MY, MZ, NA, NG, NI, NO, NZ, OM, PG, PH, PL, PT, RO, RS, RU, SC, SD, SE, SG, SK, SL, SM, SV, SY, TJ, TM, TN, TR, TT, TZ, UA, UG, US, UZ, VC, VN, ZA, ZM, ZW.

[Continued on next page]

(54) Title: INTERVENTIONAL CATHETERS

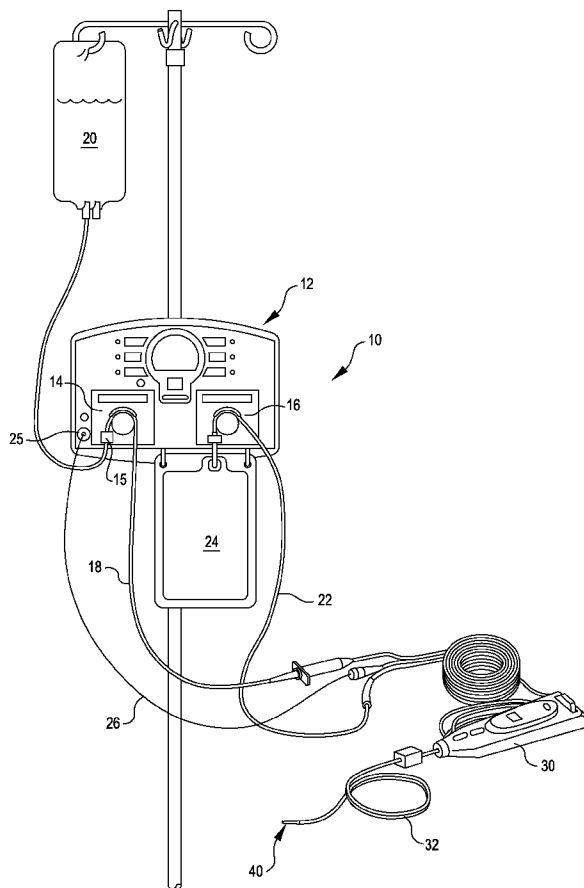

(57) Abstract: An interventional catheter incorporates an advanceable, rotatable operating head having a fixed blade cutter assembly and an adjustable blade cutter assembly. Aspiration ports and/or infusion ports providing access to a sealed lumen and aspiration and infusion systems are provided on, or in proximity to, the operating head. A shearing device may be provided within an aspiration port to further reduce the size of unwanted material during removal from a body lumen. A drive shaft provides rotation and torque from a drive system to the cutter assemblies and shearing device, and may be coupled to the cutter assembly by means of an articulating bearing assembly.

WO 2008/042987 A3



(84) Designated States (*unless otherwise indicated, for every kind of regional protection available*): ARIPO (BW, GH, GM, KE, LS, MW, MZ, NA, SD, SL, SZ, TZ, UG, ZM, ZW), Eurasian (AM, AZ, BY, KG, KZ, MD, RU, TJ, TM), European (AT, BE, BG, CH, CY, CZ, DE, DK, EE, ES, FI, FR, GB, GR, HU, IE, IS, IT, LT, LU, LV, MC, MT, NL, PL,

PT, RO, SE, SI, SK, TR), OAPI (BF, BJ, CF, CG, CI, CM, GA, GN, GQ, GW, ML, MR, NE, SN, TD, TG).

Published:

— *with international search report*

(88) Date of publication of the international search report:
9 October 2008

INTERNATIONAL SEARCH REPORT

International application No.
PCT/US2007/080348

<p>A. CLASSIFICATION OF SUBJECT MATTER IPC(8) - A61B 17/22 (2007.10) USPC - 606/159 According to International Patent Classification (IPC) or to both national classification and IPC</p>																													
<p>B. FIELDS SEARCHED</p> <p>Minimum documentation searched (classification system followed by classification symbols) IPC(8) - A61B 17/22 (2007.10) USPC - 606/159</p> <p>Documentation searched other than minimum documentation to the extent that such documents are included in the fields searched</p> <p>Electronic data base consulted during the international search (name of data base and, where practicable, search terms used) MicroPatent</p>																													
<p>C. DOCUMENTS CONSIDERED TO BE RELEVANT</p> <table border="1"> <thead> <tr> <th>Category*</th> <th>Citation of document, with indication, where appropriate, of the relevant passages</th> <th>Relevant to claim No.</th> </tr> </thead> <tbody> <tr> <td>X</td> <td>WO 2004/080345 A2 (WULFMAN et al) 23 September 2004 (23.09.2004) entire document</td> <td>13-20, 26-32, 34, 41-44</td> </tr> <tr> <td>-</td> <td></td> <td></td> </tr> <tr> <td>Y</td> <td>WO 2004/080507 A2 (WULFMAN et al) 23 September 2004 (23.09.2004) entire document</td> <td>33, 35-40, 45-47</td> </tr> <tr> <td>Y</td> <td>WO 2004/080507 A2 (WULFMAN et al) 23 September 2004 (23.09.2004) entire document</td> <td>45-54</td> </tr> <tr> <td>Y</td> <td>US 6,565,588 B1 (CLEMENT et al) 20 May 2003 (20.05.2003) entire document</td> <td>1-12, 21-25, 33, 35-40</td> </tr> <tr> <td>Y</td> <td>US 6,503,261 B1 (BRUNEAU et al) 07 January 2003 (07.01.2003) entire document</td> <td>1-12, 21-25</td> </tr> <tr> <td>Y</td> <td>US 6,666,874 B2 (HEITZMANN et al) 23 December 2003 (23.12.2003) entire document</td> <td>4-5, 22-23, 48-54</td> </tr> <tr> <td>Y</td> <td>US 6,063,069 (CRAGG et al) 16 May 2000 (16.05.2000) entire document</td> <td>53</td> </tr> </tbody> </table>			Category*	Citation of document, with indication, where appropriate, of the relevant passages	Relevant to claim No.	X	WO 2004/080345 A2 (WULFMAN et al) 23 September 2004 (23.09.2004) entire document	13-20, 26-32, 34, 41-44	-			Y	WO 2004/080507 A2 (WULFMAN et al) 23 September 2004 (23.09.2004) entire document	33, 35-40, 45-47	Y	WO 2004/080507 A2 (WULFMAN et al) 23 September 2004 (23.09.2004) entire document	45-54	Y	US 6,565,588 B1 (CLEMENT et al) 20 May 2003 (20.05.2003) entire document	1-12, 21-25, 33, 35-40	Y	US 6,503,261 B1 (BRUNEAU et al) 07 January 2003 (07.01.2003) entire document	1-12, 21-25	Y	US 6,666,874 B2 (HEITZMANN et al) 23 December 2003 (23.12.2003) entire document	4-5, 22-23, 48-54	Y	US 6,063,069 (CRAGG et al) 16 May 2000 (16.05.2000) entire document	53
Category*	Citation of document, with indication, where appropriate, of the relevant passages	Relevant to claim No.																											
X	WO 2004/080345 A2 (WULFMAN et al) 23 September 2004 (23.09.2004) entire document	13-20, 26-32, 34, 41-44																											
-																													
Y	WO 2004/080507 A2 (WULFMAN et al) 23 September 2004 (23.09.2004) entire document	33, 35-40, 45-47																											
Y	WO 2004/080507 A2 (WULFMAN et al) 23 September 2004 (23.09.2004) entire document	45-54																											
Y	US 6,565,588 B1 (CLEMENT et al) 20 May 2003 (20.05.2003) entire document	1-12, 21-25, 33, 35-40																											
Y	US 6,503,261 B1 (BRUNEAU et al) 07 January 2003 (07.01.2003) entire document	1-12, 21-25																											
Y	US 6,666,874 B2 (HEITZMANN et al) 23 December 2003 (23.12.2003) entire document	4-5, 22-23, 48-54																											
Y	US 6,063,069 (CRAGG et al) 16 May 2000 (16.05.2000) entire document	53																											
<p><input type="checkbox"/> Further documents are listed in the continuation of Box C. <input type="checkbox"/></p>																													
<p>* Special categories of cited documents:</p> <table border="0"> <tr> <td> <p>"A" document defining the general state of the art which is not considered to be of particular relevance</p> <p>"E" earlier application or patent but published on or after the international filing date</p> <p>"L" document which may throw doubts on priority claim(s) or which is cited to establish the publication date of another citation or other special reason (as specified)</p> <p>"O" document referring to an oral disclosure, use, exhibition or other means</p> <p>"P" document published prior to the international filing date but later than the priority date claimed</p> </td> <td> <p>"T" later document published after the international filing date or priority date and not in conflict with the application but cited to understand the principle or theory underlying the invention</p> <p>"X" document of particular relevance; the claimed invention cannot be considered novel or cannot be considered to involve an inventive step when the document is taken alone</p> <p>"Y" document of particular relevance; the claimed invention cannot be considered to involve an inventive step when the document is combined with one or more other such documents, such combination being obvious to a person skilled in the art</p> <p>"&" document member of the same patent family</p> </td> </tr> </table>			<p>"A" document defining the general state of the art which is not considered to be of particular relevance</p> <p>"E" earlier application or patent but published on or after the international filing date</p> <p>"L" document which may throw doubts on priority claim(s) or which is cited to establish the publication date of another citation or other special reason (as specified)</p> <p>"O" document referring to an oral disclosure, use, exhibition or other means</p> <p>"P" document published prior to the international filing date but later than the priority date claimed</p>	<p>"T" later document published after the international filing date or priority date and not in conflict with the application but cited to understand the principle or theory underlying the invention</p> <p>"X" document of particular relevance; the claimed invention cannot be considered novel or cannot be considered to involve an inventive step when the document is taken alone</p> <p>"Y" document of particular relevance; the claimed invention cannot be considered to involve an inventive step when the document is combined with one or more other such documents, such combination being obvious to a person skilled in the art</p> <p>"&" document member of the same patent family</p>																									
<p>"A" document defining the general state of the art which is not considered to be of particular relevance</p> <p>"E" earlier application or patent but published on or after the international filing date</p> <p>"L" document which may throw doubts on priority claim(s) or which is cited to establish the publication date of another citation or other special reason (as specified)</p> <p>"O" document referring to an oral disclosure, use, exhibition or other means</p> <p>"P" document published prior to the international filing date but later than the priority date claimed</p>	<p>"T" later document published after the international filing date or priority date and not in conflict with the application but cited to understand the principle or theory underlying the invention</p> <p>"X" document of particular relevance; the claimed invention cannot be considered novel or cannot be considered to involve an inventive step when the document is taken alone</p> <p>"Y" document of particular relevance; the claimed invention cannot be considered to involve an inventive step when the document is combined with one or more other such documents, such combination being obvious to a person skilled in the art</p> <p>"&" document member of the same patent family</p>																												
<p>Date of the actual completion of the international search 18 January 2008</p>		<p>Date of mailing of the international search report 11 APR 2008</p>																											
<p>Name and mailing address of the ISA/US Mail Stop PCT, Attn: ISA/US, Commissioner for Patents P.O. Box 1450, Alexandria, Virginia 22313-1450 Facsimile No. 571-273-3201</p>		<p>Authorized officer: Blaine R. Copenheaver PCT Helpdesk: 571-272-4300 PCT OSP: 571-272-7774</p>																											