

OPI DATE 11/06/97 APPLN. ID 41814/96
AOJP DATE 07/08/97 PCT NUMBER PCT/FR95/01520



AU9641814

(PCT)

DEM.

(51) Classification internationale des brevets ⁶ :

B65B 9/15, 67/12, B65F 1/06

A1

(11) Numéro de publication internationale:

WO 97/18992

(43) Date de publication internationale:

29 mai 1997 (29.05.97)

(21) Numéro de la demande internationale: PCT/FR95/01520

(22) Date de dépôt international: 17 novembre 1995 (17.11.95)

(72) ~~Déposant et~~ inventeur: LECOMTE, Michel [FR/FR]; 7, impasse du ruisseau, Chagnolet, F-17139 Dompierre-sur-Mer (FR).

see
folio
3

(71) CAPTIVA HOLDING

61 Rue de l'Arcade

F- 75009 Paris

France

(81) Etats désignés: AM, AT, AU, BG, BR, BY, CA, CH, CN, CZ, DE, DK, EE, ES, FI, GB, GE, HU, IS, JP, KE, KP, KR, KZ, LK, LR, LT, LU, LV, MG, MN, MX, NO, NZ, PL, PT, RO, RU, SD, SE, SG, SI, SK, UA, UG, US, UZ, VN, brevet européen (AT, BE, CH, DE, DK, ES, FR, GB, GR, IE, IT, LU, MC, NL, PT, SE).

Publiée

Avec rapport de recherche internationale.



(54) Title: DEVICE FOR COLLECTING AND CONFINING HOSPITAL AND HOUSEHOLD WASTE

(54) Titre: DISPOSITIF POUR COLLECTER ET CONFINER LES DECHETS HOSPITALIERS ET MENAGERS

(57) Abstract

A device for wrapping contaminant or non-contaminant waste resulting from the medical treatment of humans or animals, as well as household waste. The device shown in the figure consists of a housing (1) used as a frame supporting a dispenser (2) for a heat-sealable plastic sleeve (3) forming a receptacle in which the waste may be deposited, a drive mechanism (4) for moving the sleeve, a heat-sealing mechanism (5), and a removable storage receptacle (6). The device is characterised in that the size of the wrapping may be selectively adapted to that of the waste objects. The device is useful for confining waste in wrappings that are impervious to volatile fumes, odours and liquids regardless of the position of the wrappings during storage and transport.

(57) Abrégé

L'invention concerne un dispositif pour emballer les déchets contaminants ou non issus des soins médicaux prodigués aux êtres humains ou aux animaux ainsi que les déchets ménagers. En référence à la figure le dispositif est constitué d'un carter (1) faisant châssis supportant un dévidoir (2) de gaine plastique thermosoudable (3) formant réceptacle pour déposer les déchets puis un mécanisme d'entraînement (4) de ladite gaine suivi d'un mécanisme de thermosoudage (5) puis d'un réceptacle amovible de stockage (6). La particularité du dispositif est d'adapter à volonté la dimension de l'emballage aux objets. L'invention permet de confiner les déchets dans des enveloppes étanches aux émanations volatiles, odeurs et liquides et ce quelle que soit la position desdites enveloppes étanches pendant leur stockage et leur transport.

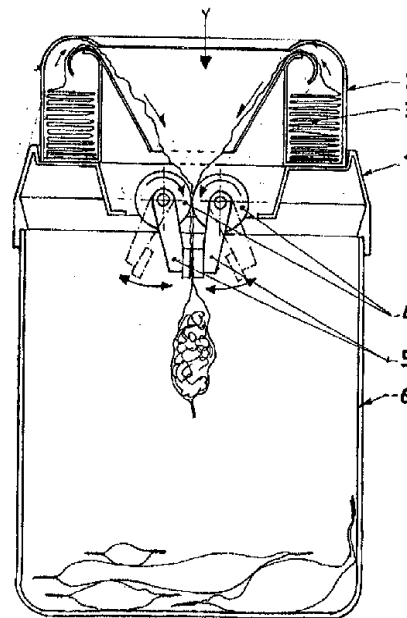

ABSTRACT

The invention relates to a device for wrapping contaminant or non-
5 contaminant waste resulting from the medical treatment of humans or animals, as
well as household waste. The device shown in Figure 1 consists of a housing (1)
used as a frame supporting a dispenser (2) for a heat-sealable plastic sleeve (3)
forming a receptacle in which the waste may be deposited, a driving mechanism
(4) for moving the sleeve, a heat-sealing mechanism (5), and a removable storage
10 receptacle (6). The device is characterized in that the size of the wrapping may
be selectively adapted to that of the waste objects. The device is useful for
confining waste in wrappings that are impervious to volatile fumes, odours and
liquids regardless of the position of the wrappings during storage and transport.

15



DEVICE FOR COLLECTING AND CONFINING HOSPITAL AND
HOUSEHOLD WASTE

The present invention relates to a device for wrapping household refuse
and waste and waste resulting from medical care administered to humans and
5 animals as well as the waste produced by the activities connected with this care.

At the present time, the wrapping of waste is taken care of by using plastic
bags or plastic-coated boxes. This type of wrapping does not enable the gases or
odours issuing from the waste, to be correctly confined.

This results in a volatile propagation of pathogenic germs and unpleasant
10 smells, which presents a problem of potential contamination, particularly in health
care facilities, maternity hospitals, veterinary clinics, medical laboratories, public
toilets through women's sanitary towels, and more simply waste disposal units of
apartment blocks.

The device according to the invention overcomes this shortcoming by
15 wrapping the waste in envelopes which are air-, odour- and liquid-tight whatever
the position of said envelopes after closure.

The device can in particular be fixed on waste disposal unit openings in
apartment blocks, therefore guaranteeing constant cleanliness of the ducts and
performing the role of anti-odour trap when being used.

20 Similar systems have already been studied, for example the one described
in European Patent No. 281 355, but the latter obliges the user to push the objects
in order to obtain advance of the sleeve; there is no driving system and the bags
obtained are simply closed by twisting, which does not allow a real tightness.

In European Patent No. 05660, the system described does not enable the
25 dimensions of the wrapping to be automatically adjusted and a system of pliers
rather than rollers is used to advance the sleeve.



The dimensions of the wrapping can be modified by replacing an element of the mechanism, but giving another standardised dimension. The mechanism described is not functional for the systematic wrapping of each unitary deposit with systematic adaptation of the dimension of sleeve necessary;

The main innovation of the present invention is the systematic adaptation of the dimension of the wrapping to the waste.

Summary

The present invention is a device for wrapping waste resulting from medical care administered to humans or animals and waste of household type, of the type comprising a housing acting as frame supporting in its upper part a dispenser of heat-sealable plastic sleeve forming a primary waste receptacle, a mechanism for driving said sleeve just underneath, followed by a heat-sealing mechanism thus producing envelopes tight with respect to the volatile and liquid emanations, characterised in that the waste thrown in the primary receptacle drops to the bottom thereof and is driven by said sleeve, itself driven by friction between at least two rollers or wheels rotating in opposite directions with respect to each other, the latter disposed on the one hand so as permanently to obtain a contact pressure with the sleeve, disposed on the other hand so that the contact surfaces of said rollers move apart upon passage of the waste while conserving a contact pressure with the sleeve, the quantity of the sleeve necessary for wrapping the waste and for regenerating the soiled surfaces being connected with the number of rotations of rollers, said number of rotations being adjustable as desired by the user or automatically by a detection system, the advance of the sleeve thus obtained driving the imprisoned waste under the rollers, tight closure being effected as desired or automatically by actuation of heat-sealing pliers capable of cutting the sleeve in the middle of a wide weld, ensuring at the same time tightness of the envelope created and the bottom of the following envelope.



Description of Drawings

Referring to figure 1, the device is constituted by a housing (1) acting as frame supporting in its upper part a dispenser (2) of heat-sealable plastic sleeve (3) forming receptacle for depositing the waste, a mechanism (4) for driving said sleeve just underneath, followed by a heat-sealing mechanism (5) then a removable receptacle (6) allowing the installation of a secondary wrapping with a view to periodic emptying.

The waste dropped into the primary receptacle drops to the bottom thereof, to be driven by said sleeve (3), itself driven by friction between at least two rollers or wheels rotating in opposite directions with respect to each other, being disposed on the one hand so as to obtain a permanent contact pressure with the sleeve, disposed on the other hand so that the contact surface of said rollers move apart upon passage of the waste while conserving a contact pressure with the sleeve, the quantity of sleeve necessary for wrapping the waste and regenerating the soiled surfaces being connected with the number of rotations of said rollers, said number of rotations being adjustable as desired by the user or automatically by detection system, the advance of the sleeve thus obtained driving the imprisoned waste beneath the rollers, tight closure being effected as desired or automatically by a actuating heat-sealing pliers capable of cutting the sleeve in the middle of a wide weld effecting at the same time tightness of the envelope created and the bottom of the following envelope.



A mechanism for automatically or manually dispensing a neutralizing product of germicidal or like type, may be installed above the dispenser forming receptacle. Its operation may be determined by mechanical or electrical link by the operation of the sleeve driving mechanism.

5 The housing (1) may have an articulated hood mounted thereon.

According to the different embodiments and in accordance with Figures 1, 2 and 3:

- The "dispenser, driving mechanism, heat-sealing mechanism" assembly may be disconnected from the receptacle part and be fitted on any type of
10 container designed for waste collection, and may even replace a waste disposal trap or can be integrated in a work surface of a fitted kitchen.

- The dispenser (2) forming receptacle is removable and may be changed entirely whenever a new sleeve is reloaded.

- The shape of the dispenser/receptacle makes it possible to obtain a
15 surface for deposit of the waste protected from soiling by the presence of the sleeve. The polluted sleeve surface is enclosed with the waste during advance of the sleeve and the deposit surface is regenerated by a portion of new sleeve.

- The driving mechanism (4) is constituted by a set of drive rollers (13) actuated manually by a steering wheel , a lever (14) or electrically by a motor.

20 - Said mechanism may be actuated via a rack itself connected directly or indirectly to a manually operated lever. Such a configuration may allow a possible cap to be connected to said lever and to actuate the mechanism by manipulating said cap.

- In any case, the rollers can be rotated only in the desired direction by the
25 interposition of a disengagement system. Disengagement may be obtained by a blade or ball ratchet on the axes of the rollers.



- The drive rollers are constituted by a rigid central pin of small diameter coated with an elastomer foam of large diameter. This choice allows a fixed distance between axes, the passage of the waste being effected by deformation of said elastomer foam coating, the rollers are mounted against one another by force
5 in order to guarantee driving of the sleeve empty.

- The rollers are fast in rotation thanks to gears (15) disposed at the end of the pin. These gears are of identical diameters to ensure that the rollers effect the same number of rotations.

- In the case of actuation being effected by manual or motorized direct
10 rotation, these gears are in direct engagement. In the case of actuation employing the translation of a rack, the latter may be placed between the gears, against a reduction in diameter of the latter.

- The gears disposed at the end of roller axes can be mounted so as to rotate and present a notched bore whose shape allows blockage in one direction
15 of rotation of one or more spring blades fast with the axes. Such an assembly ensures disconnection of the rollers in the case of reversal of the direction of rotation by manual steering wheel, lever, electric motor or rack.

- The coating of the drive rollers present several circular openings (16) in order not to drive back the liquids contained in the waste.

20 - The rollers may be designed with a thin coating on axes of small diameters; the distances between axes are then variable and the contact pressure maintained by return spring between the rollers.

- Depending on the configurations, the quantity of sleeve necessary is obtained either by manual action with visual control, or by automatic detection by
25 means of photoelectric cells or mechanical feelers installed above the dispenser/receptacle on a possible support or hood.



- The quantity of sleeve used for each deposit may be standard for specific applications such as the collection of women's sanitary towels in public places, trains, railway stations, aircraft, hotels, maternity clinics, etc...

5 - Closure of the wrapping by heat-sealing is effected thanks to a set of retractable heating pliers (5).

- Closure of said pliers may be obtained by electrically switching on an electro-magnet (7) and heating resistors (8) simultaneously, or via a lever.

10 - Said switching on is obtained by actuating a contactor. Said contactor may be actuated, depending on the configurations, either manually or automatically at the end of rotation of the drive rollers.

- The heating temperature for welding is pre-adjusted during manufacture in the factory, and the time required for the heating pliers to close, like the soldering time, is defined by a timing device.

15 - The supports (9) of heating resistors (8) for heat-sealing may be fixed free to rotate on the rigid pin of the drive rollers (13) and thus constitute the jaws for gripping the sleeve. Such an assembly guarantees the positioning of the weld and simplifies the overall set-up.

- Said supports (9) are rendered fast in rotation thanks to the partial gears (10) disposed at their ends.

20 - Closure of the pliers thus constituted may be ensured by displacing an articulated rod fixed on one of the jaws on the one hand and fixed to an electromagnet (7) on the other hand.

25 - The pressure of closure may be limited by a spring device (11) integrated with said rod or placed in interface with the electromagnet or between the master jaw and the rod.



- The welding resistors (8) disposed on the supports (9) may present at their ends mechanical contacts for example incorporating plates enabling the electric circuit to be closed during contact.

- Such an assembly prevents untimely heating of the resistors in the event
5 of defective closure of the pliers. Welding can therefore not be effected in the presence of insufficiently dropped waste. Wiring is therefore simplified.

- The timing device releases the pliers for a complementary advance.

- A manual contactor may shunt the timing device to that end.

- The shape of the surfaces of the heating part of the jaws which comes
10 into contact with the sleeve upon closure of the pliers may present an excrescence capable of cutting said sleeve wholly or partly in the middle of the zone welded by creeping in the softening phase.

- In a configuration using a direct manual lever (14), the rotation of the
latter may be coaxial with a roller and in constant engagement with the
15 disconnectable gear of said roller. Alternative actuation of the lever allows the advance of the sleeve and at the end of stroke closes the heating resistor supports which may be switched on thanks to the closure of the circuit by plate contacts upon contact.

- In a simplified configuration, wrapping may be effected without welding
20 at each deposit, the sleeve thus forming a sock of which closure by welding or the like is ensured solely at the end of stock or periodic emptying. On the other hand, this configuration is not applicable on a waste disposal unit by reason of the dimensions of the common duct.

- In order to facilitate the leader function during replacement, the new
25 sleeve cartridges present a cardboard or like tongue which is engaged in the drive mechanism.



- In relation with the different technical elements of set-up, the following modes of operation are demonstrated:

In Automatized configuration: The user drops or deposits his/her waste in the upper receptacle, the presence detector triggers off an electric motor actuating the
5 rollers, driving the sleeve and the waste. The detector no longer detecting presence in the upper receptacle, the rollers continue to rotate in cooperation with a timing device adjusted to guarantee a complementary advance. Such complementary advance is intended not to try to weld in the presence of waste and, if desired, totally to regenerate the zones likely to be soiled. Stoppage of the
10 motor triggers off closure of the welding pliers, welding being effected in cooperation with a timing device and the cut sachet drops into the lower receptacle. The user necessarily triggers off wrapping as soon as he/she deposits the waste.

In Semi-manual configuration: The operator actuates a contactor to rotate the
15 rollers and to maintain contact until the waste disappears. Abandon of this contact provokes stoppage of the motor and therefore of the advance and simultaneously via a timed relay actuates the welding/cutting mechanism. At the end of timing, all the relays become inactive again. If the welding pliers cannot close correctly, a warning lamp lights up and indicates to the user to reactuate the advance.

In Manual configuration: The operator actuates advance and welding/cutting as
20 desired by means of two distinct contactors, a relay preventing the simultaneous switching on of the two contactors. If the welding pliers cannot close, a warning lamp lights up and indicates to the user to reactuate the advance.

In Configuration with direct manual rotation: The operator actuates as desired
25 a lever or a steering wheel connected mechanically to the rollers until the waste disappears, then by means of a contactor proceeds with welding/cutting. If the



pliers cannot close, a warning lamp lights up and indicates to the user to reactuate the advance.

In the manual configuration, the operator may omit to proceed with welding, the waste then being wrapped in a "sock", but the constant pressure of
5 the rollers on the sleeve allows an already consequent confinement, in the same way as in the case of breakdown of the pliers in the automatized version. A configuration provided without welding may be envisaged depending on the application and thus provide an independent, simple, inexpensive dustbin or trash can.



THE CLAIMS DEFINING THE INVENTION ARE AS FOLLOWS:-

- 5 1. Device for wrapping waste resulting from medical care administered to humans or animals and waste of household type, of the type comprising a housing acting as frame supporting in its upper part a dispenser of heat-sealable plastic sleeve forming a primary waste receptacle, a mechanism for driving said sleeve just underneath, followed by a heat-sealing mechanism thus producing envelopes tight with respect to the volatile and liquid emanations, characterised in that the waste thrown in the primary receptacle drops to the bottom thereof and is driven by said sleeve, itself driven by friction between at least two rollers or wheels rotating in opposite directions with respect to each other, the latter disposed on the one hand so as permanently to obtain a contact pressure with the sleeve, disposed on the other hand so that the contact surfaces of said rollers move apart upon passage of the waste while conserving a contact pressure with the sleeve, the quantity of the sleeve necessary for wrapping the waste and for regenerating the soiled surfaces being connected with the number of rotations of said rollers, said number of rotations being adjustable as desired by the user or automatically by a detection system, the advance of the sleeve thus obtained driving the imprisoned waste under the rollers, tight closure being effected as desired or automatically by actuation of heat-sealing pliers capable of cutting the sleeve in the middle of a wide weld, ensuring at the same time tightness of the envelope created and the bottom of the following envelope.
- 10 2. Device according to claim 1, characterised in that at least one of the drive rollers may be constituted by a rigid pin of small diameter coated with a considerable thickness of a material with high elastic deformation allowing passage of the sleeve laden with cumbersome waste by simple deformation.
- 15 3. Device according to claims 1 and 2, characterised in that at least one of the rollers may present one or more reductions in diameter in order not to drive back the liquids.
- 20
- 25
- 30



4. Device according to claim 1, characterised in that the switching on of the resistors for heat-sealing the sleeve at the end of cycle is determined by a correct closure of the pliers formed by the supports of said resistors in order to prevent welding in the presence of waste, said switching on being ensured by the presence of mechanical contactors mounted directly on said supports actuated for closure upon contact.

5. Device according to any one of claims 1, 2 and 3, characterised in that the distance between axes of the drive rollers may vary upon passage of the waste, the contact pressure necessary between said rollers and the sleeve then being ensured by return springs possibly placed between the axes at their ends.

6. Device according to any one of claims 1, 2 and 5, characterised in that the system for driving the rollers presents a disconnection mechanism for preventing reversal of the direction of rotation of said rollers constituted for example by gears mounted to rotate at the end of the roller axes and each presenting a notched bore whose shape allows blockage in one direction for rotation only of one or more spring blades fast with the axes, thus forming a ratchet.

7. Device according to any one of claims 1, 2, 4 and 5, characterised in that the axes of the articulations of the supports of the heat-sealing heating resistors may be coaxial with the axes of the drive rollers in order to ensure a precise and repetitive localisation of the weld.

8. Device according to any one of claims 1, 2, 4, 5 and 6, characterised in that the mechanism in motorised version may automatically determine the quantity of sleeve to be advanced for wrapping thanks to a detection of presence in the dispenser/receptacle by means of example of photoelectric cells or mechanical feelers installed on a specific support or on the inner face of a possible hood.

9. Device according to any one of claims 1, 2, 5 and 6, characterised in that the new sleeve refills present a leader for example in the form of a cardboard tongue pushed manually between the rollers.



10. Device according to any one of claims 1, 2 and 5, characterised in that
it may be fitted as waste disposal unit trap preventing the odours from
escaping from the duct thanks to the permanent pressure of the rollers on the
5 sleeve and guaranteeing cleanliness thereof thanks to the tight wrapping
produced.

11. A device substantially as herein described with reference to the
figures.

Dated this thirtieth day of August 1999

CAPTIVA HOLDING
Patent Attorneys for the Applicant:

F B RICE & CO

4
5
6
7
8
9
0



1/2

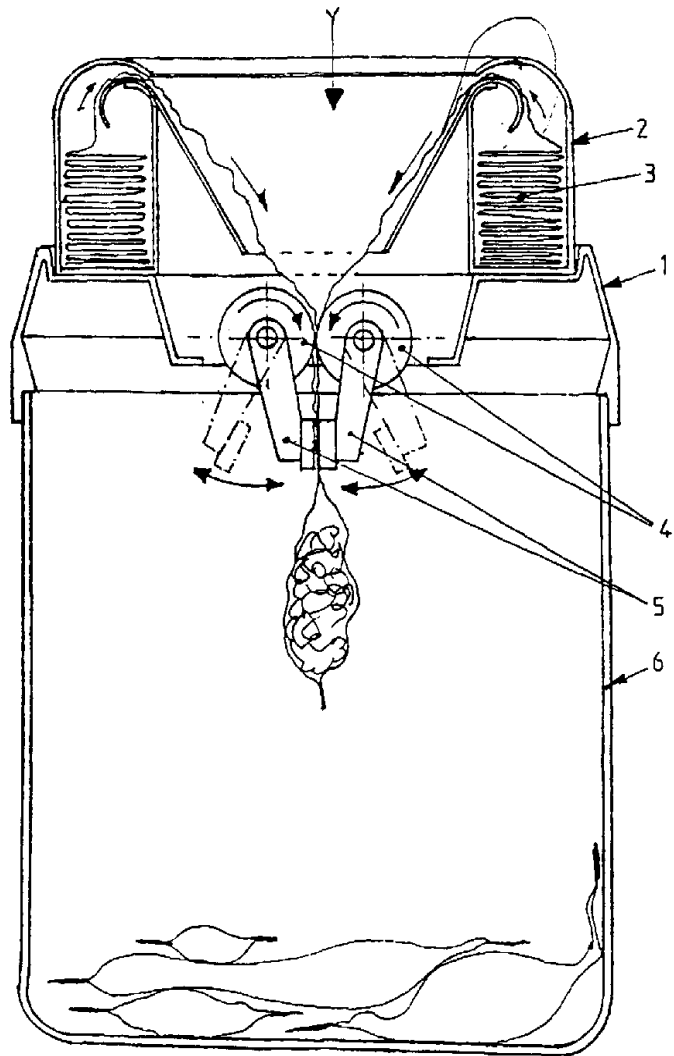

FIG. 1

2 / 2

FIG. 2

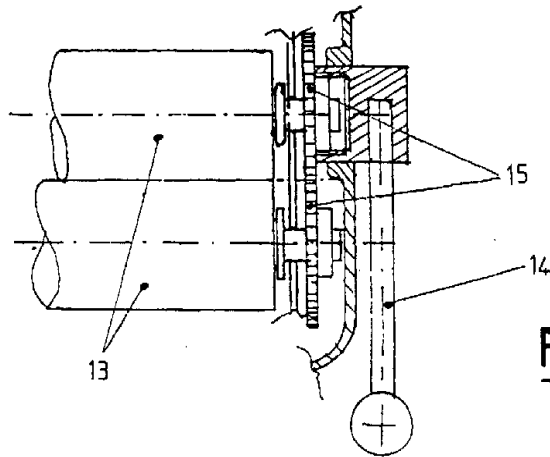
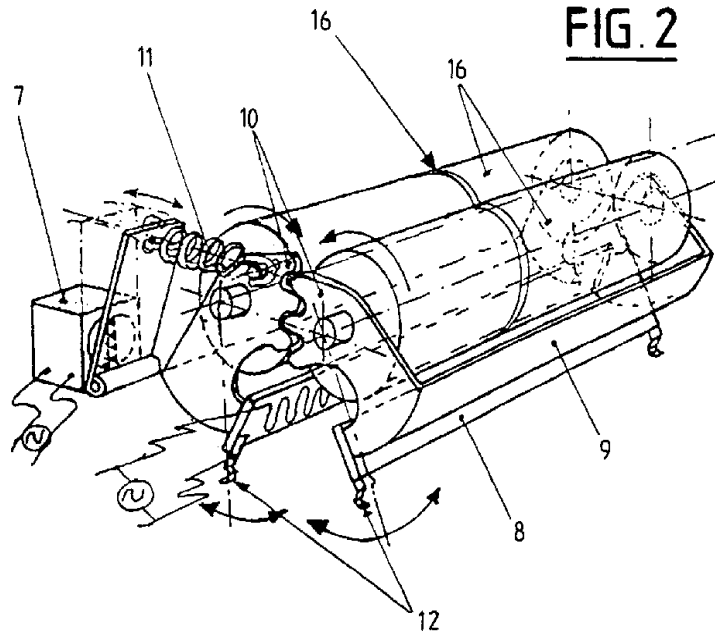

FIG. 3