

(19) World Intellectual Property Organization
International Bureau



(43) International Publication Date
18 May 2007 (18.05.2007)

PCT

(10) International Publication Number
WO 2007/056342 A2

(51) International Patent Classification:
A61B 5/00 (2006.01) **G08B 21/02** (2006.01)

(21) International Application Number:
PCT/US2006/043290

(22) International Filing Date:
7 November 2006 (07.11.2006)

(25) Filing Language: English

(26) Publication Language: English

(30) Priority Data:
60/734,083 7 November 2005 (07.11.2005) US

(71) Applicant (for all designated States except US):
STRYKER CORPORATION [US/US]; 2725 Fair-
field Road, Kalamazoo, MI 49002 (US).

(72) Inventors; and

(75) Inventors/Applicants (for US only): **BECKER, David, Terrance** [US/US]; 1621 Royce Avenue, Kalamazoo, MI 49001 (US). **HOPPER, Christopher, John** [US/US]; 8257 Mystic Trail, Kalamazoo, MI 49009 (US). **HAYES, Michael, Joseph** [US/US]; 8231 West Q Avenue, Kalamazoo, MI 49009 (US). **SHANKAR, Vivek** [IN/US]; 2256 E. Cork Street, Apt. 3A, Kalamazoo, MI 49001 (US). **MAYORAS, Richard, C., Jr.** [US/US]; 5355 Telluride Road, Kalamazoo, MI 49009 (US).

(74) Agent: **COLLINS, Catherine, S.**; Van Dyke, Gardner, Linn & Burkhart, LLP, 2851 Charlevoix Drive, S.E., Suite 207, P.O. Box 888695, Grand Rapids, MI 49588-8695 (US).

(81) Designated States (unless otherwise indicated, for every kind of national protection available): AE, AG, AL, AM, AT, AU, AZ, BA, BB, BG, BR, BW, BY, BZ, CA, CH, CN, CO, CR, CU, CZ, DE, DK, DM, DZ, EC, EE, EG, ES, FI, GB, GD, GE, GH, GM, GT, HN, HR, HU, ID, IL, IN, IS, JP, KE, KG, KM, KN, KP, KR, KZ, LA, LC, LK, LR, LS, LT, LU, LV, LY, MA, MD, MG, MK, MN, MW, MX, MY, MZ, NA, NG, NI, NO, NZ, OM, PG, PH, PL, PT, RO, RS, RU, SC, SD, SE, SG, SK, SL, SM, SV, SY, TJ, TM, TN, TR, TT, TZ, UA, UG, US, UZ, VC, VN, ZA, ZM, ZW.

(84) Designated States (unless otherwise indicated, for every kind of regional protection available): ARIPO (BW, GH, GM, KE, LS, MW, MZ, NA, SD, SL, SZ, TZ, UG, ZM, ZW), Eurasian (AM, AZ, BY, KG, KZ, MD, RU, TJ, TM), European (AT, BE, BG, CH, CY, CZ, DE, DK, EE, ES, FI, FR, GB, GR, HU, IE, IS, IT, LT, LU, LV, MC, NL, PL, PT, RO, SE, SI, SK, TR), OAPI (BF, BJ, CF, CG, CI, CM, GA, GN, GQ, GW, ML, MR, NE, SN, TD, TG).

Published:

— without international search report and to be republished upon receipt of that report

For two-letter codes and other abbreviations, refer to the "Guidance Notes on Codes and Abbreviations" appearing at the beginning of each regular issue of the PCT Gazette.

(54) Title: PATIENT HANDLING DEVICE INCLUDING LOCAL STATUS INDICATION, ONE-TOUCH FOWLER ANGLE ADJUSTMENT, AND POWER-ON ALARM CONFIGURATION

(57) Abstract: A patient handling device (20) includes a controller (44), with a plurality of sensors (54), control panels (68, 70, 72), and lamps (86, 88, 92) electrically connected to the controller (44). The patient handling device (20) records the normal/desired state of the various components when power is applied. When one of the components goes outside the normal/desired state, the controller (44) issues an alarm. This alarm includes illuminating a plurality of amber alert lamps (86, 88) which can normally be viewed by a user at any position around the outside of the patient handling device (20). The patient handling device (20) also includes a position control (106). This control (106) restricts movement of an upper/fowler portion (32) of the patient handling device (20) in a certain range of angular positions, while permitting movement of the upper portion (32) outside the certain range.



WO 2007/056342 A2

**PATIENT HANDLING DEVICE INCLUDING LOCAL STATUS
INDICATION, ONE-TOUCH FOWLER ANGLE ADJUSTMENT,
AND POWER-ON ALARM CONFIGURATION**

CROSS REFERENCE TO RELATED APPLICATION

[0001] This application claims the benefit of U.S. Provisional Patent Application Serial Number 60/734,083 filed November 7, 2005, which is hereby incorporated by reference.

BACKGROUND OF THE INVENTION

1. Field of the Invention

[0002] The subject invention relates to a patient handling device such as a hospital bed and associated methods of operation.

2. Description of the Related Art

[0003] Modern patient handling devices are becoming increasingly integrated with advanced electronic devices, such as a microprocessors, communication busses, network interfaces, wireless networks, high-tech displays, and advanced sensors. These electronic devices have the potential to greatly enhance patient care. But too often, these electronic devices are complex and do not adequately address ease of use, which can be essential for patient care by accounting for the stresses of a hospital/medical environment. As a result, modern patient handling device controls and user interfaces may be difficult to operate.

[0004] One difficulty is the complexity involved in setting the desired state of the components of the patient handling device in order to produce an alarm should the components be in a non-desired state. Another difficulty is the ability to even notice when the patient handling device is alarming due to one or more components in a non-desired state. Yet another difficulty is the ability to prevent a patient from lowering a fowler of the patient handling device past prescribed angular position, yet maintaining the ability for the patient to still selectively adjust the fowler

between a plurality of angular positions above the prescribed angular position. Therefore, there is a need in the art for a patient handling device that can address the difficulties described above.

SUMMARY OF THE INVENTION AND ADVANTAGES

[0005] A first aspect of the present invention provides a method of monitoring a patient handling device. The patient handling device includes a plurality of sensors sensing a plurality of features of the patient handling device and a controller in communication with the sensors. The method includes the step of receiving a control signal at the controller to initiate monitoring of the patient handling device. Sensor signals are acquired at the controller from the sensors in response to receiving the control signal. Initial sensor data is generated from the sensor signals based on the initial state of the sensors to establish a desired state of the patient handling device. The method continues with the steps of periodically acquiring the sensor signals from the sensors after generating the initial sensor data and generating current sensor data from the sensor signals based on the current state of the sensors. The current sensor data is compared to the initial sensor data and an alarm is generated in response to a substantial variation between the current sensor data and the initial sensor data.

[0006] A second aspect of the invention provides a patient handling device having a plurality of features for patient care. The patient handling device includes a frame for supporting a patient and a plurality of sensors supported by the frame for generating a plurality of sensor signals, wherein each sensor signal corresponds to one of the features of the device. A user-selectable control produces a control signal to initiate monitoring of the patient handling device. A controller is in communication with the sensors and the user-selectable control for receiving the control signal, acquiring the sensor signals from the sensors in response to receiving the control signal, and generating initial sensor data from the sensor signals based on the initial state of the sensors. The controller also periodically acquires the sensor signals from the sensors and generates current sensor data from the sensor signals based on the current state of the sensors. The controller then compares the current sensor data to the initial sensor data and alarms in response to a substantial variation between the current sensor data and the initial sensor data.

[0007] A third aspect of the invention provides a patient handling device having a plurality of features for patient care and a frame for supporting a patient. A plurality of sensors are supported by the frame, wherein each sensor senses a feature of the patient handling device and generates a sensor signal corresponding to one of the features of the patient handling device. The patient handling device further includes a controller in communication with the plurality of sensors for periodically acquiring the sensor signals from the plurality of sensors to generate current sensor data. The controller also compares the current sensor data to predetermined data. An alert lamp in communication with the controller produces light in response to a substantial variation between the current sensor data and the predetermined data. The light produced by the alert lamp is viewable outward from the frame along at least 180 degrees of a circle defined around the frame.

[0008] A fourth aspect of the invention provides a patient handling device including a frame for supporting a patient above a surface. The frame includes an upper portion which is angularly adjustable with respect to the surface. An actuator is operatively connected to the upper portion for adjusting the upper portion between a plurality of angular positions relative to the surface. An actuator control generates an actuator control signal and an angular position sensor is coupled to the frame for sensing the angular position of the upper portion with respect to the surface. The patient handling device further includes a position lock control for generating a position lock signal. A controller is in communication with the actuator control and the actuator for controlling the actuator to selectively adjust the upper portion between the plurality of angular positions. The controller is also in communication with the position lock control and the angular position sensor for preventing operation of the actuator and thereby preventing adjustment of the upper portion to at least one restricted angular position in response to the position lock signal.

[0009] In a fifth aspect of the invention, a method of operating a patient handling device is provided. The patient handling device includes a frame for supporting a patient above a surface. The frame includes an upper portion which is angularly adjustable with respect to the surface and an actuator for adjusting the upper portion. The method includes the step of receiving an actuator control signal to adjust the upper portion between a plurality of angular positions relative to the surface. The method also includes the step of sensing an angular position of the upper portion with

respect to the surface. When a position lock signal is received, operation of the actuator is prevented, which thereby prevents adjustment of the upper portion to at least on restricted angular position.

[0010] The first and second aspects of the invention allow a user of the patient handling device to easily configure the desired state of the patient handling device. This is accomplished by simply setting the patient handling device to the desired configuration (e.g., setting angles, heights, and siderail positions) and turning the patient handling device on. The initial state of the patient handling device is recorded and the patient handling device produces an alarm when the patient handling device is no longer in this initial state.

[0011] The third aspect of the invention provides at least one alert lamp which is viewable to alert the user when any of a number of sensors indicates an alarm condition. The light produced by the alert lamp is viewable at numerous locations around the bed.

[0012] The fourth and fifth aspects of the invention provide a simple, one-touch lockout that allows a patient to adjust a fowler of the patient handling device, but prevents the patient from lowering the fowler past a certain point.

BRIEF DESCRIPTION OF THE DRAWINGS

[0013] Other advantages of the present invention will be readily appreciated, as the same becomes better understood by reference to the following detailed description when considered in connection with the accompanying drawings wherein:

[0014] Figure 1 is a perspective view of a patient handling device with a mattress;

[0015] Figure 2 is a perspective view of the patient handling device with the mattress removed to illustrate the upper portion in an inclined position;

[0016] Figure 3 is a schematic block diagram of the various electrical and electronic components of the patient handling device;

[0017] Figure 4 is a detailed view of a footboard control panel and annunciator;

[0018] Figure 5 is a detailed view of a display of the footboard control panel showing an example of several alarms;

[0019] Figures 6A and 6B are detailed views of the display of the footboard control panel showing a low height alarm;

[0020] Figures 7A and 7B are detailed views of the display of the footboard control panel showing a brake alarm;

[0021] Figures 8A and 8B are detailed views of the display of the footboard control panel showing a siderail alarm;

[0022] Figures 9A and 9B are detailed views of the display of the footboard control panel showing a bed exit alarm;

[0023] Figure 10 is a detailed view of an outside siderail control panel;

[0024] Figure 11 is a detailed view of an inside siderail control panel;

[0025] Figure 12 is a detailed view of the display of the footboard control panel showing a menu;

[0026] Figure 13 is a detailed view of the display of the footboard control panel showing an instructional message;

[0027] Figure 14 is a schematic view of a healthcare facility with a network and a patient handling device bay ID system;

[0028] Figure 15 is a schematic view of alternative room modules in the patient handling device bay ID system illustrating their communication with the patient handling device and non-patient handling device devices; and

[0029] Figure 16 is a display representation at a remote computer illustrating a user interface of the present invention.

DETAILED DESCRIPTION OF THE INVENTION

[0030] Referring to the Figures, wherein like numerals indicate corresponding parts throughout the several views, a patient handling device **20** is shown in Figure 1. Those skilled in the art realize that the patient handling device **20** of the present invention may be implemented as a gurney, stretcher, surgical table, examination table, wheel chair, ambulance cot, or other suitable device as is known to the art. Furthermore, the patient handling device **20** need not be utilized solely in a hospital, but in any suitable environment.

[0031] The patient handling device **20** includes a frame **22** for supporting a patient (not shown). A mattress **24** is preferably disposed on the frame **22** for comfortably supporting the patient. However, those skilled in the art realize

that the patient handling device **20** may be implemented without the mattress **24** or with numerous alternatives for the mattress **24**, such as cushions. The mattress **24** could be a therapy mattress such as that disclosed in U.S. Patent Application Serial No. 11/260,452, filed October 27, 2005, which is hereby incorporated by reference.

[0032] The patient handling device **20** also preferably includes a plurality of wheels **26** supporting the frame **22**. The wheels **26** allow the patient handling device **20** to be easily moved along a surface **28** (i.e., the floor). Of course, the patient handling device **20** may be implemented without the wheels **26**, such that the patient handling device **20** is relatively stationary. When implemented with the wheels **26**, the patient handling device **20** preferably includes a brake for immobilizing at least one of the wheels **26** and more preferably immobilizing all of the wheels **26**. The brake is applied via a brake pedal **30**. In alternative embodiments, the brake may be applied utilize a handle, button, or other suitable activation technique. Braking systems employed on patient handling devices are well known in the art and any suitable system may be employed here, thus the braking system is not described in detail.

[0033] Referring to Figure 2, the frame **22** includes an upper portion **32** and a lower portion **34**. The upper portion **32** is often referred to as a “fowler portion” or simply a “fowler”. The upper and lower portions **32**, **34** are angularly adjustable with respect to the surface **28** between a plurality of angular positions. Said another way, the upper and lower portions **32**, **34** may be adjusted such that they are non-parallel with the surface **28**. This allows the patient to be positioned in a variety of configurations as are well known to those skilled in the art. The angular position of the upper portion **32** with respect to the surface **28** is commonly referred to as a “fowler angle” or “fowler position”.

[0034] The frame **22** defines two sides **36** running lengthwise with the arms and legs of a patient lying in the patient handling device **20** and two ends (not labeled) transverse to the sides **36**. A footboard **38** is disposed transverse to the sides **36** and adjacent to one of the ends. Likewise, a headboard **40** may be disposed transverse to the sides **36** and adjacent to the other end of the frame **22**. Obviously, the footboard **38** is typically disposed near the feet of a patient lying on the patient handling device **20** while the headboard **40** is disposed near the head of the patient.

[0035] The patient handling device 20 also includes at least one siderail 42 disposed adjacent one of the sides 36 of the frame 22. The siderail 42 is moveable between an up position and a down position. In the up position, the siderail 42 prevents the patient from accidentally rolling off the patient handling device 20 or easily exiting the patient handling device 20. It is preferred that the siderail 42 include a locking mechanism (not shown) to lock the siderail 42 in the up position, such that it may not be easily lowered by the patient. In the preferred embodiment, the at least one siderail is implemented as a plurality of siderails, and more preferably as four siderails: two adjacent the upper portion 32 with one on each side 36 of the frame 22 and two adjacent the lower portion 34 with one on each side 36 of the frame 22. In Figures 1 and 2, three of the siderails 42 are shown in the up position and one (not shown) is in the down position.

[0036] Referring now to Figure 3, the patient handling device 20 includes a controller 44 for controlling operation of the patient handling device 20 and monitoring various features of the patient handling device 20. The controller 44 is preferably a microprocessor-based device, such as a microcontroller. However, those skilled in the art realize that other suitable implementations may be employed for the controller 44. The patient handling device 20 also includes a variety of electrical and electronic components (not shown) interfaced with or integrated into the controller 44 for enabling operation of the controller 44 and communication with the controller 44. These components may include, but are not limited to, power supplies, communication interface circuits, networking circuits, amplifiers, multiplexers, logic gates, resistors, capacitors, inductors, and diodes. At least one analog-to-digital converter 46 (ADC) is electrically connected to the controller 44 to convert analog signals from variable voltage/current devices to digital signals which are usable by the controller 44. The at least one ADC 46 may be separate (i.e., stand-alone) from the controller 44 and/or integrated within the controller 44. Furthermore, the patient handling device 20 may also include a plurality of distributed nodes (not shown) electrically connected to the controller 44 and various electrical/electronic devices as described herein. The distributed nodes facilitate communication between the devices and the controller 44 while reducing overall wiring costs and complexity.

[0037] The patient handling device 20 includes an upper portion actuator 48 operatively connected to the upper portion 32. The upper portion actuator

48 moves the upper portion 32 to adjust the upper portion 32 between a plurality of angular positions. The upper portion actuator 48 is in communication with the controller 44 to receive control signals from the controller 44. The upper portion actuator 48 is preferably a bi-directional motor such that the upper portion actuator 48 can increase and decrease the angular position of the upper portion 32 with respect to a horizontal surface 28 such as the floor upon which the patient handling device 20 is supported. The patient handling device 20 also includes a lower portion actuator 50 operatively connected to the lower portion 34 for moving the lower portion 34 to adjust the lower portion 34 between a plurality of angular positions. The lower portion actuator 50 is electrically connected to the controller 44 and is preferably a bi-directional motor and operates similarly to the upper portion actuator 48 described above. The patient handling device 20 also includes a lifting mechanism 52 operatively connected to the frame 22 for lifting and lowering the frame 22 with respect to the surface 28. The lifting mechanism 52 is electrically connected to the controller 44 and preferably includes a bi-directional motor. Of course, those skilled in the art realize that the patient handling device 20 may include other actuators for operating features of the patient handling device 20. The actuators 48, 50 and lifting mechanism 52 are well known to those skilled in the art and any suitable actuator 48, 50 or lifting mechanism 52 may be implemented; therefore, the actuators 48, 50 and lifting mechanism 52 are not described in further detail.

[0038] A plurality of sensors 54 are supported by the patient handling device 20 with each sensor 54 being associated with the various features of the patient handling device 20. Each sensor 54 senses at least one feature of the patient handling device 20 and generates a sensor signal corresponding to that feature of the patient handling device 20. These sensors 54 include, but are not limited to:

- at least one siderail switch 56 for sensing the position of each siderail 42, specifically, whether each siderail 42 is in the up position;
- a brake sensor 58 for sensing the activation of the brake;
- a height sensor 60 for sensing the height of the frame 22 with respect to the surface 28.
- an upper portion potentiometer 62 for sensing an angular position of the upper portion 32 with respect to the surface 28;

- a lower portion potentiometer 64 for sensing an angular position of the lower portion 34 with respect to the surface 28;
- at least one load cell 66, and preferably four load cells 66, for sensing the weight, presence, and/or position of the patient on the patient handling device 20; and
- an arm/disarm signal from a bed exit system.

Those skilled in the art will realize numerous techniques for implementing the sensors 54 with the patient handling device 20. For example, in the preferred embodiment, the siderail switches 56 are implemented as mechanical rocker-type switches. However, the siderail switches 56 may alternatively be implemented as inductive or capacitive sensing proximity switches, photosensitive detectors, etc. Furthermore, those skilled in the art will realize that additional sensors that may be utilized to monitor a feature of the patient handling device 20.

[0039] The bed exit system detects patient exit from the patient handling device 20 and/or detects a position of the patient on the patient handling device 20. Such a bed exit system is described in United States Patent No. 5,276,432, which is hereby incorporated by reference. The bed exit system is preferably incorporated as one or more software routines in the controller 44 and utilizes the preferred four load cells 66 as described above. The load cells 66, via the bed exit system, may be used to track the patient's center of gravity. By knowing the patient's center of gravity, pressure ulcer management can be performed by knowing that the patient hasn't moved or turned. Furthermore, the load cells 66, via the bed exit system, may be utilized to predict a bed exit before it occurs.

[0040] Referring again to Figure 1, the patient handling device 20 also preferably includes several control panels 68, 70, 72 in communication with the controller 44. In the preferred embodiment, the patient handling device 20 includes a footboard control panel 68 disposed in the footboard 38 of the patient handling device 20. The footboard control panel 68, as shown in detail in Figure 4, includes a plurality of membrane-style pushbuttons for controlling various features of the patient handling device 20. Of course, the footboard control panel 68 may use different styles of pushbuttons, switches, or knobs as is well known to those skilled in the art. The footboard control panel 68 also includes a display 74 for displaying information regarding the patient handling device 20 to a user (e.g., nurse, doctor, technician,

etc.). The display 74 in the preferred embodiment is a back-lit liquid crystal-type device, however, other types of displays 74, including touch-screen displays 74 for accepting user input, are known to those skilled in the art. A cover 76 is pivotally hinged to the footboard 38 adjacent to the footboard control panel 68 for concealing and protecting the footboard control panel 68 when closed. The cover 76 may include a window (not shown) to allow viewing of the display 74 when the cover 76 is closed.

[0041] The patient handling device 20 also preferably includes at least one outside siderail control panel 70, shown in detail in Figure 10, and at least one inside siderail control panel 72, shown in detail in Figure 11. The inside siderail control panel 72 is disposed on the inside (i.e., close to the patient) of at least one of the siderails 42 to allow convenient control of the patient handling device 20 and an interface to other off-bed features (e.g., television control, nurse call, etc.). The outside siderail control panel 70 is disposed on the outside (i.e., away from the patient) of at least one of the siderails to allow convenient control of the patient handling device 20 by users other than the patient. The siderail control panels 70, 72 preferably include membrane-style pushbuttons, but other alternatives are known to those skilled in the art.

[0042] The patient handling device 20 includes an upper portion control 78, a lower portion control 80, and a height control 82, each control electrically connected to the controller 44. Each of these controls 78, 80, 82 is preferably implemented as a pair of membrane-style pushbuttons (one for up and one for down). In the preferred embodiment, the upper and lower portion controls 78, 80 are disposed on each of the control panels 68, 70, 72 while the height control 82 is disposed on the outside siderail control panel 70 and the footboard control panel 68, i.e., not on the inside siderail control panel 72. The upper portion control 78 generates an upper portion control signal, the lower portion control 80 generates a lower portion control signal, and the height control 82 generates a height control signal. Each of these control signals is communicated to the controller 44. The controller 44 typically responds to each control signal by controlling the actuator corresponding to the control signal in the appropriate direction. A patient or user of the patient handling device 20 can then use the controls 78, 80, 82 to selectively adjust the height, upper portion angular position, and/or lower portion angular position of the patient handling device 20.

[0043] The patient handling device 20 includes a user-selectable control for producing a control signal. In the preferred embodiment, the user-selectable control is a power button 84, preferably as part of the footboard control panel 68, as shown in Figure 4. However, other controls for producing the control signal and other locations for the power button 84 are also acceptable. The power button 84 produces the control signal, which is sent to the controller 44 to initiate monitoring of the patient handling device 20. In the preferred embodiment, the power button 84 also controls the flow of power to the patient handling device 20. Furthermore, the power button 84 cannot be activated (i.e., power will not flow to the patient handling device 20) unless the brake has been set to immobilize the patient handling device 20.

[0044] The controller 44 receives the control signal and begins to initiate the monitoring of the patient handling device 20. Specifically, in response to receiving the control signal, the controller 44 acquires the sensor signal from each of the sensors 54 that is to be monitored. The controller 44 generates initial sensor data based on the initially acquired sensor signals. This initial sensor data then becomes the "setpoint" and is stored in a memory of the controller 44, thus establishing a desired state of the patient handling device. For example, if the sensors 54 to be monitored are the four siderail switches 56, the brake sensor 58, and the load cells 66, then the position of each siderail 42 and the brake and the weight measured by the load cells 66 are stored in the memory. If the sensors 54 to be monitored are the four siderail switches 56, the brake sensor 58, and the arm/disarm signal from the bed exit system, then the position of each siderail 42 and the brake and the current configuration of the arm/disarm signal (e.g., armed or disarmed) are stored in the memory. Thus, the initial sensor data is based on the position of the components being monitored when the power button 84 is depressed.

[0045] After generating the initial sensor data, the controller 44 then will periodically acquire the sensor signal from each of the monitored sensors 54 to generate current sensor data. This current sensor data is then compared to the initial sensor data. An alarm may be then issued in response to a substantial variation between the current sensor 54 data and the initial sensor data. This variation indicates a change from the desired state to an undesired state. Of course, the amount of variation between the current and initial sensor data that results in triggering the alarm

may be adjusted, depending on the nature of the data. For example, a variation of a few pounds in the weight of the patient (between initial and current sensor data) need not trigger the alarm, but a variation of fifty pounds could. Furthermore, the step of periodically acquiring the sensor signals may be described as the controller 44 routinely examining the sensor signals to determine the current state of the sensors 54. Alternatively, the step of periodically acquiring the sensor signals may be described as being immediately triggered by a state change, such as, but not limited to, the presence of an interrupt signal at the controller 44.

[0046] Alternative methods to issuing the alarm are contemplated within the scope of the invention. In one method, the current sensor data is compared to predetermined data. This predetermined data may be set by the manufacturer of the patient handling device 20 or may be set by the user. In an embodiment in which the predetermined data is set by the user, configuration controls are provided as part of the footboard control panel 68. Those skilled in the art realize that the initial sensor data may be considered to be the predetermined data since the initial sensor data is set (i.e., predetermined) by the user's act of turning the patient handling device 20 on via the power button 84.

[0047] The alarm may be conveyed in several forms. In one instance, the alarm may be conveyed by activating an alert lamp which produces light. Referring to Figures 1 and 2, in the preferred embodiment, the patient handling device 20 includes a plurality of alert lamps: at least one footboard alert lamp 86 and a pair of side alert lamps 88. The footboard alert lamp 86 is coupled to the footboard 38 and disposed in a footboard lamp housing 90 located below the footboard control panel 68.

[0048] One side alert lamp 88 is disposed on one side 36 of the patient handling device 20 while the other side alert lamp 88 is disposed on the other side 36 of the patient handling device 20. The alert lamps 86, 88 are positioned such that the light produced by the alert lamp is viewable outward from the patient handling device 20 along at least 180 degrees of a circle defined around the patient handling device 20 and more preferably viewable at least 270 degrees of the circle defined by the patient handling device 20. Since the headboard 40 of the patient handling device 20 is traditionally positioned against a wall, the light produced by the alert lamps 86, 88 is viewable no matter where a user is around the patient handling device 20.

Furthermore, alert lamps may be positioned such that light is viewable at any point (i.e., 360 degrees) around the patient handling device 20.

[0049] Preferably, the alert lamps 86, 88 are light emitting diodes (LEDs) such that replacement of the alert lamps 86, 88 is a rarity. It is also preferred that the alert lamps 86, 88 produce an amber (or yellow) colored light. Light having an amber color typically has a wavelength in the range of 577 to 597 nanometers. Furthermore, it is preferred that the alert lamp flash on and off, to emphasize the alarm condition. Those skilled in the art will realize other locations, configurations, colors, and wavelengths for the alert lamps 86, 88. The alert lamps 86, 88 are deactivated, i.e., turned off, when there is no substantial variation between the current sensor data and the predetermined data (or initial sensor data).

[0050] To deactivate the alarm and the alert lamps 86, 88, a user may simply correct the problem (e.g., raise a siderail that was lowered). Alternatively, deactivating the alert lamps 86, 88 may be accomplished by simply turning off power to the patient handling device 20 by pressing the power button 84 and then turning power back on, by again pressing the power button 84. When the patient handling device 20 is restarted, the initial sensor data will be set to the current (and desired) state.

[0051] The patient handling device 20 may also include a normal lamp 92 which is activated (i.e., illuminated) when there is no substantial variation between the current sensor data and the predetermined data (or initial sensor data). Said another way, the normal lamp 92 is illuminated when there is no alarm. The normal lamp 92 is also preferably disposed within the footboard lamp housing 90. The normal lamp 92 produces a light having a wavelength different from the wavelength of the light produced by the alert lamp. Preferably, the normal lamp 92 is at least one LED that produces a green colored light. Those skilled in the art realize that green color light has a wavelength in the range of 492 to 577 nanometers. The normal lamp 92 is deactivated, i.e., turned off, when there is a substantial variation between the current sensor data and the predetermined data (or initial sensor data), i.e., when the patient handling device 20 is in the undesired state.

[0052] Thus, in the preferred embodiment, it is easy for a user (e.g., nurse, doctor, orderly, etc.) to quickly determine if there is a problem with the patient

handling device 20 that needs to be addressed. The user need simply notice whether the patient handling device 20 is producing a green light or a flashing amber light.

[0053] In another instance, the alarm may be conveyed to a user by sounding an audible signal. The patient handling device 20 may include a speaker 94 in communication with the controller 44 for sounding this audible signal.

[0054] In yet another instance, the alarm may be conveyed by transmitting alarm data to a remote computer 95, external from the patient handling device 20. The controller 44 of the patient handling device 20 is in communication with a network interface 96. The network interface 96 may then communicate the alarm data (as well as other data) to the remote computer 95 over a network 97. Those skilled in the art realize that the network 97 may be a hardwired network (e.g., Ethernet) or a wireless network (e.g., WiFi, cellular telephone, GSM, Bluetooth, etc.).

[0055] The alarm may also be conveyed by transmitting a nurse call signal to a nurse call system. Nurse call systems are well known to those skilled in the art, but typically lack functionality for detailed data handling. Rather, nurse call systems typically provide a simple on/off signal to alert the user (e.g., a nurse) to a problem.

[0056] The patient handling device 20 of the present invention also provides functionality for limiting (or locking out) operation of the patient handling device 20. The footboard control panel 68 includes an upper portion lockout control 98, a lower portion lockout control 100, a height lockout control 102, and a motion lockout control 104. Each of these lockout controls 98, 100, 102, 104 is electrically connected to the controller 44 and sends a corresponding lockout control signal to the controller 44 when activated. For example, when the lower portion lockout control 98 is activated, the lower portion actuator 50 will not function when the lower portion controls 80 on the siderails 42 and/or the footboard control panel 68 are depressed. The same reasoning extends to the upper portion lockout control 100, the height lockout control 102, and the motion lockout control 104.

[0057] The patient handling device 20 of the present invention also provides a position lock control 106. The position lock control 106 is preferably a membrane-style pushbutton located in the footboard control panel 68 and electrically connected to the controller 44. The position lock control 106 generates a position

lock signal which is received by the controller 44. The activation of the position lock control 106 in the preferred embodiment provides several results. First, the lower portion actuator 48 is actuated to position the lower portion to a horizontal position (i.e., parallel with the surface 28). Next, the upper portion actuator 48 is actuated to position the upper portion 32 outside of a restricted range of angular positions of the upper portion 32. In the preferred embodiment, this restricted range is between 0 and 30 degrees with respect to the surface 28. However, different ranges of angular positions may also be utilized. For example, in one alternative embodiment, the restricted range may be between 0 and 45 degrees. In another alternative embodiment, the restricted range may be any angular position greater than 45 degrees. If the upper portion 32 is already positioned outside the restricted range of angular positions, then no actuation takes place. The controller 44 receives feedback (i.e., the current position of the upper portion 32) from the upper position sensor 54.

[0058] Finally, activation of the position lock control 106 results in preventing the operation of the upper portion actuator 48 utilizing the upper portion control 78 into the restricted range of angular positions. Thus, in the preferred embodiment, the patient (or other user) is not able to lower the upper portion 32 under 30 degrees utilizing the pushbuttons of the upper portion control 78. This allows a simple and convenient technique for a user to place the patient in an inclined position and keep the patient in that position. In some embodiments, however, even when the position lock control 106 is actuated, the upper portion 32 can be adjusted through a plurality of permitted angular positions that fall outside the restricted range of angular positions, such as those positions above 30 degrees with respect to the surface 28. Those skilled in the art realize that certain medical conditions necessitate positioning patients in these permitted positions for extended periods of time. Those skilled in the art realize other restricted range of angular positions that have clinical or operational significance. Two examples of restricted ranges of angular positions are related to the commonly known Trendelenberg position (where the patient's feet are disposed higher than their head) and the knee gatch position. Of course, if CPR is to be initiated, a CPR button allows immediate movement of the upper and lower portions of the bed to a fully horizontal position.

[0059] In the preferred embodiment described above, the position lock control 106 restricted the range of angular positions of the upper portion 32. In other

embodiments, however, the position lock control **106** may alternatively restrict the range of angular positions of other portions of the patient handling device **20**, such as, but not limited to, the lower portion **34**.

[0060] The patient handling device **20** also includes an annunciator **110** for quickly alerting the user to status conditions of the patient handling device **20**. The annunciator **110** is preferably located adjacent to and below the footboard control panel **68**, however other locations may also be acceptable. The annunciator **110** includes annunciator lamps (not shown) electrically connected to the controller **44**. A cover plate is affixed over the annunciator lamps, such that messages are illuminated when appropriate. These messages may include, but are not limited to:

- Motion Lockout Set
- Siderail Lockout Set
- Low Height
- Brake Set
- Bed Exit Alarm
- Zero Weight Alarm
- Siderail Alarm
- Power On

One advantageous feature of the annunciator **110** is that it remains visible to the user, even when the cover **76** of the footboard control panel **68** is closed.

[0061] The display **74** of the footboard control panel **68** is used as an interface between a user of the patient handling device **20** and the controller **44**. As shown in Figure 4, the display may provide information to the user, such as the upper portion angular position and the lower portion angular position. Referring to Figure 5, the display **74** may provide a graphical representation and/or a schematic map of the patient handling device **20** to indicate which component is triggering an alarm. The triggering component may be blinking or otherwise indicated as is known to those skilled in the art. For example, Figures 6A and 6B will alternate on the display **74**, creating a blinking effect to inform the user that the height of the patient handling device **20** is low (i.e., lower than the desired state). Figures 7A and 7B will alternate on the display **74** to show the user that the brake is no longer set. Likewise, Figure 8A and 8B show that one of the siderails **42** is out of position and Figures 9A and 9B indicate that a bed exit alarm is tripped.

[0062] As shown in Figure 12, the display may provide a menu from which the user can configure features of the patient handling device, by utilizing user interface controls **108** located on the footboard control panel **68**. The display **74** can also convey non-alarm messages to the user, such as in Figure 13, instructing the user not to touch the bed (e.g., while the patient is weighed).

[0063] Referring now to Figure 14, the patient handling device **20** of the present invention may be a part of a location detection system (not labeled). The location detection system locates patient handling devices **20** in a facility such as a hospital. Such a location detection system is described in U.S. Patent Application Serial Number 11/277,838, filed on March 29, 2006, which is hereby incorporated by reference.

[0064] The location detection system includes a locator **112** mounted at each bay location in each room of the hospital. The locator **112** is programmed with a location ID to transmit to the patient handling device **20** once the patient handling device **20** has “docked” with the locator **112**. The locator **112** could be mounted on the ceiling, wall, floor, or any location that permits the locator **112** to carry out its intended function.

[0065] Referring to FIG. 15, the locator **112** could also include additional features to provide an intelligent room module **112A**. For instance, the intelligent room module **112A** may include interface buttons **118** for operator selection that correspond to the patient handling device **20** or room being clean, dirty, empty, occupied, ready for occupancy, etc. An alternative intelligent room module **112B** may also include a graphic display **120** such as a touch-screen display with multiple nested user screens to access or transmit patient data, patient handling device data, or room data. The intelligent room module **112A**, **112B** may transmit this information, e.g., clean/dirty, etc., directly or indirectly to the hospital network **97** using wired and/or wireless communication paths. Communication can occur from the intelligent room modules **112A**, **112B** directly to the hospital network **97**, from the intelligent room modules **112A**, **112B** to other patient handling devices and then to the hospital network **97** or to more than one available hospital network, or directly from the intelligent room modules **112A**, **112B** to the computer **95** or to more than one computer **95**. The intelligent room modules **112A**, **112B** may also be configured as access points between the patient handling devices **20** and multiple non-bed

devices **122** such as patient monitoring devices, patient treatment devices, diagnostic devices, and the like, or the intelligent room modules **112A**, **112B** may be configured as access points between the hospital network **12** and the non-bed devices **122**.

[0066] As stated above, data may be transmitted to the remote computer **95** from the patient handling device **20** via the network **97**. This data may include, but is not limited to, any data collected by the controller **44** of the patient handling device **20**, alarm data, location ID data, and non-bed device data from non-bed devices **122** in communication with the patient handling device **20**. This data may also be utilized by other systems present on the network **97**. For instance, the data may be automatically transmitted to an electronic medical record system **99**. Furthermore, the controller **44** of the patient handling device **20** may receive commands initiated at the remote computer **95**.

[0067] Referring to FIG. 16, one possible configuration of a display **124** at the remote computer **95** is shown. As shown, the remote computer **95** includes a touch-sensitive user interface (not labeled) that allows hospital personnel such as a nurse to not only view the patient handling device data transmitted to the network **97** from the patient handling device **20**, but also remotely activate features of the patient handling device **20** such as a scale, the bed exit system, brakes, articulation locks, and the like. The user interface may also include configuration controls to allow the users to set the desired state of the patient handling device **20**.

[0068] The display **124** may also include amber **126** and green **128** indicators activated in the same manner as the alert and normal lamps **86**, **92** on the patient handling device **20**. Audible alarms may also be provided at the remote computer **95** or other locations to indicate whether the patient handling device **20** is in a desired or undesirable state or configuration.

[0069] The remote computer **95** may be in communication with a portable device (e.g., cellular phones, PDAs, pagers, etc.) to deliver information about one or more patient handling devices **20** to a user. This information may include not only that an alarm has occurred, but the exact nature of the alarm. For instance, the portable device may display data similar to that displayed on the display **74** of the footboard control panel **68**.

[0070] Obviously, many modifications and variations of the present invention are possible in light of the above teachings. The invention may be practiced

otherwise than as specifically described within the scope of the appended claims. In addition, the reference numerals in the claims are merely for convenience and are not to be read in any way as limiting.

CLAIMS

What is claimed is:

1. A method of monitoring a patient handling device (20) having a plurality of sensors (54), each of the plurality of sensors (54) associated with at least one of a plurality of features of the patient handling device (20), and a controller (44) in communication with the sensors (54), said method comprising the steps of:

receiving a control signal at the controller (44) to initiate monitoring of the patient handling device (20);

acquiring a plurality of sensor signals at the controller (44) from the sensors (54) in response to receiving the control signal;

generating initial sensor data from the plurality of sensor signals based on the initial state of the plurality of sensors (54) to establish a desired state of the patient handling device (20);

periodically acquiring the plurality of sensor signals at the controller (44) from the sensors (54) after generating the initial sensor data;

generating current sensor data from the plurality of sensor signals based on the current state of the plurality of sensors (54);

comparing the current sensor data to the initial sensor data; and

alarming in response to a substantial variation between the current sensor data and the initial sensor data which represents a change from the desired state to an undesired state of the patient handling device (20).

2. A method as set forth in claim 1 wherein said step of alarming is further defined as activating an alert lamp (86, 88).

3. A method as set forth in claim 1 wherein said step of alarming is further defined as sounding an audible signal.

4. A method as set forth in claim 1 wherein said step of alarming is further defined as transmitting alarm data to a remote computer (95).

5. A patient handling device (20) having a plurality of features for patient care, said patient handling device (20) comprising:

a frame (22) for supporting a patient;

a plurality of sensors (54) supported by said frame (22) for generating a plurality of sensor signals, each of the sensor signals corresponding to one of the plurality of features of the patient handling device (20);

a user-selectable control (84) for producing a control signal to initiate monitoring of the patient handling device (20); and

a controller (44) in communication with said sensors (54) and said user-selectable control for receiving the control signal, acquiring the sensor signals from said sensors (54) in response to receiving the control signal, generating initial sensor data from the sensor signals based on the initial state of said sensors(54), periodically acquiring the sensor signals from said sensors(54), generating current sensor data from the sensor signals based on the current state of said sensors (54), comparing the current sensor data to the initial sensor data, and alarming in response to a substantial variation between the current sensor data and the initial sensor data.

6. A patient handling device (20) as set forth in claim 5 further comprising a plurality of wheels (26) supporting said frame (22) and a brake for immobilizing at least one of said wheels.

7. A patient handling device (20) as set forth in claim 6 wherein one of said sensors (54) is further defined as a brake sensor (58) for sensing the activation of said brake.

8. A patient handling device (20) as set forth in claim 5 further comprising a lifting mechanism (52) for adjusting a height of said frame (22) with respect to a surface (28).

9. A patient handling device (20) as set forth in claim 8 wherein one of said sensors (54) is further defined as a height sensor (60) for sensing the height of the frame (22) with respect to the surface (28).

10. A patient handling device (20) as set forth in claim 5 wherein said frame (22) includes an upper portion (32) which is angularly adjustable with respect to a surface (28) and further comprising an upper portion actuator (48) operatively connected to said upper portion (32) for actuating said upper portion (32) to angularly adjust said upper portion (32).

11. A patient handling device (20) as set forth in claim 10 wherein one of said sensors (54) is further defined as an angular position sensor (62) for sensing an angular position of said upper portion (32) with respect to the surface (28).

12. A patient handling device (20) as set forth in claim 11 further comprising at least one siderail (42) moveable between an up position and a down position.

13. A patient handling device (20) as set forth in claim 12 wherein one of said sensors (54) is further defined as a siderail sensor (56) for sensing the position of said at least one siderail (42).

14. A patient handling device (20) as set forth in claim 13 wherein said at least one siderail (42) is further defined as a plurality of siderails (42) with one of said siderail sensors (56) being associated with each of said siderails (42).

15. A patient handling device (20) as set forth in claim 5 wherein one of said sensors (54) is further defined as a load cell (66) for sensing a weight of the patient.

16. A patient handling device (20) as set forth in claim 5 wherein said user-selectable control (84) is further defined as a power button (84) for producing the control signal and controlling the flow of power to the patient handling device (20).

17. A patient handling device (20) as set forth in claim 5 wherein one of said sensors (54) is further defined as an arm/disarm signal from a bed exit system.

18. A patient handling device (20) having a plurality of features for patient care, said patient handling device (20) comprising:

a frame (22) for supporting a patient;

a plurality of sensors (54) supported by said frame (22), each of said sensors (54) generating a sensor signal corresponding to one of the plurality of features of the patient handling device (20);

a controller (44) in communication with said plurality of sensors (54) for periodically acquiring the sensor signals from said plurality of sensors (54) to generate current sensor data and comparing the current sensor data to predetermined data; and

an alert lamp (86, 88) in communication with said controller (44) for producing light in response to a substantial variation between the current sensor data and the predetermined data, wherein the light produced by said alert lamp is viewable outward from said frame (22) along at least 180 degrees of a circle defined around said frame (22).

19. A patient handling device (20) as set forth in claim 18 wherein the light produced by said alert lamp (86, 88) is viewable outward from said frame (22) along 270 degrees of a circle defined around said frame (22).

20. A patient handling device (20) as set forth in claim 18 wherein said frame (22) defines two sides (36) and a footboard (38) disposed transverse to the sides (36).

21. A patient handling device (20) as set forth in claim 20 wherein said alert lamp (86, 88) is further defined as three alert lamps (86, 88) wherein one alert lamp (88) is coupled to each of said sides (36) and another alert lamp (86) is coupled to said footboard (38) such that the light produced by at least one of said three alert lamps (86, 88) is viewable outward from said frame (22) along 270 degrees of a circle defined around said frame (22).

22. A patient handling device (20) comprising:

a frame (22) for supporting a patient above a surface (28), said frame (22) including an upper portion (32) which is angularly adjustable with respect to the surface (28);

an actuator (48) operatively connected to said upper portion (32) for adjusting said upper portion (32) between a plurality of angular positions relative to the surface (28);

an actuator control (78) for generating an actuator control signal;

an angular position sensor (62) coupled to said frame (22) for sensing the angular position of said upper portion (32) with respect to the surface (28);

a position lock control (106) for generating a position lock signal;

a controller (44) in communication with said actuator control (78) and said actuator (48) for controlling said actuator (48) to selectively adjust said upper portion (32) between the plurality of angular positions; and

said controller (44) also in communication with said position lock control (106) and said angular position sensor (62) for preventing operation of said actuator (48) and thereby preventing adjustment of said upper portion (32) to at least one restricted angular position in response to the position lock signal.

23. A patient handling device (20) as set forth in claim 22 wherein said controller (44) allows control of said upper portion (32) with said actuator control (78) to adjust said upper portion (32) to at least one permitted angular position while preventing adjustment of said upper portion (32) to the at least one restricted angular position in response to the position lock signal.

24. A patient handling device (20) as set forth in claim 22 wherein said at least one restricted angular position is further defined as a predetermined range of restricted angular positions in which the upper portion forms an angle less than about 30 degrees with respect to the surface (28).

25. A patient handling device (20) as set forth in claim 22 wherein said at least one restricted angular position is further defined as a predetermined range of restricted angular positions and wherein the predetermined range of angular positions is configurable by a user.

26. A patient handling device (20) as set forth in claim 22 wherein said position lock control (106) is further defined as a single pushbutton (106).

27. A method of operating a patient handling device (20) having a frame (22) for supporting a patient above a surface (28) wherein the frame (22) includes an upper portion (32) which is angularly adjustable with respect to the surface (28) and an actuator (48) for adjusting the upper portion (32), said method comprising the steps of:

receiving an actuator control signal to adjust the upper portion (32) between a plurality of angular positions relative to the surface (28);

sensing an angular position of the upper portion (32) with respect to the surface (28);

receiving a position lock signal; and

preventing operation of the actuator (48) and thereby preventing adjustment of the upper portion (32) to at least one restricted angular position in response to receiving the position lock signal.

28. A method as set forth in claim 26 further comprising the step of operating the actuator (48) to position the upper portion (32) to a permitted angular position in response to receiving the position lock signal.

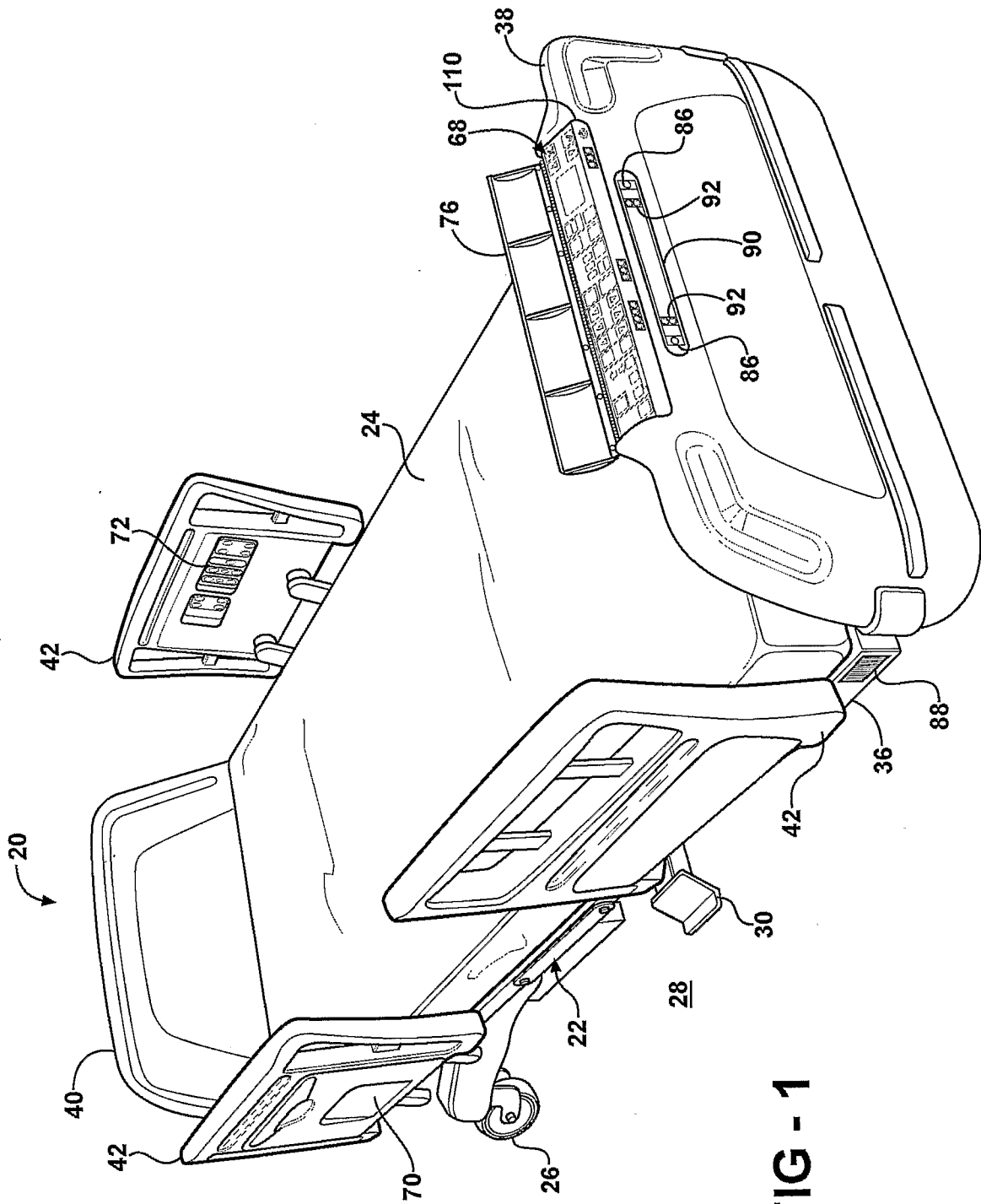

FIG - 1

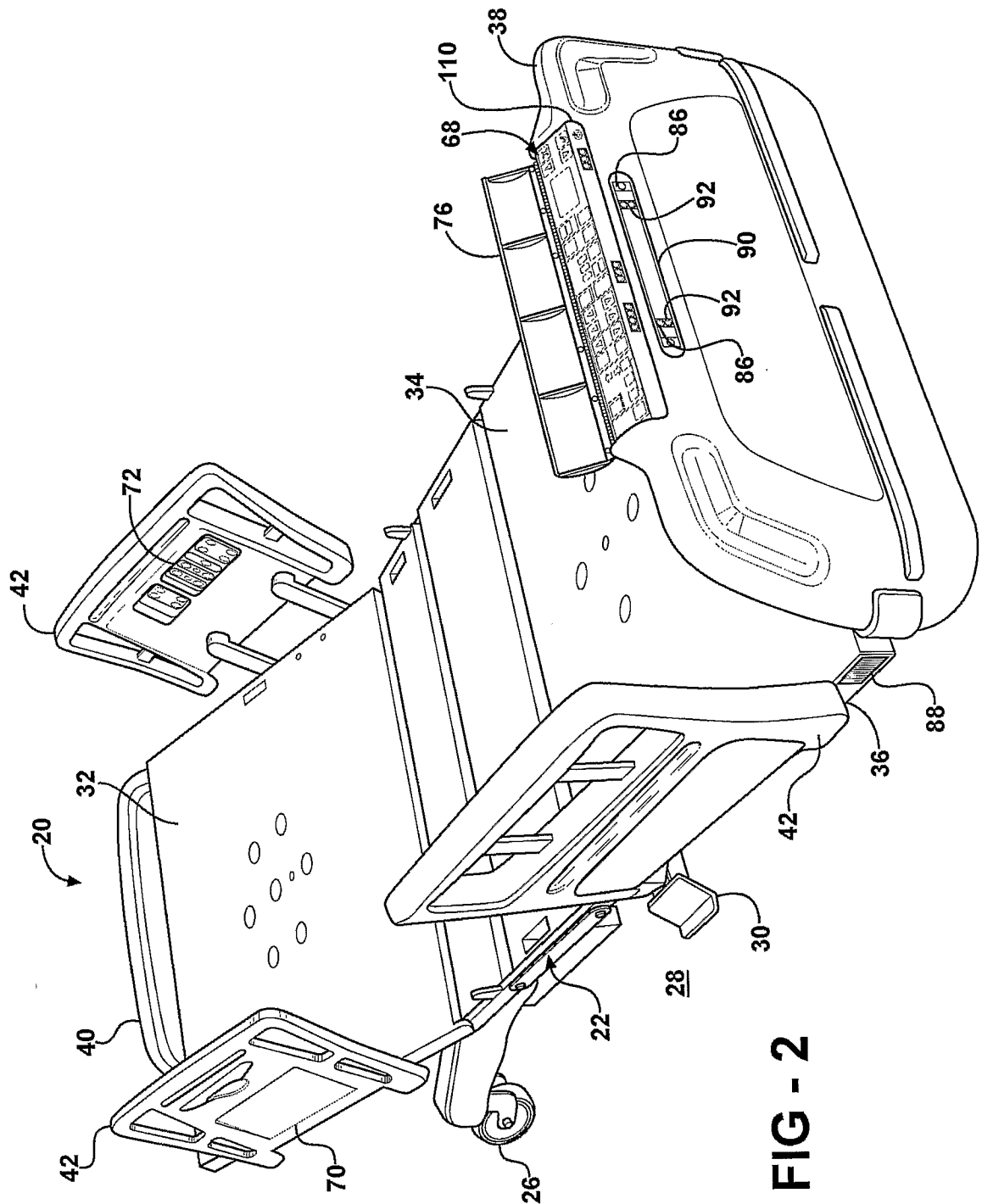
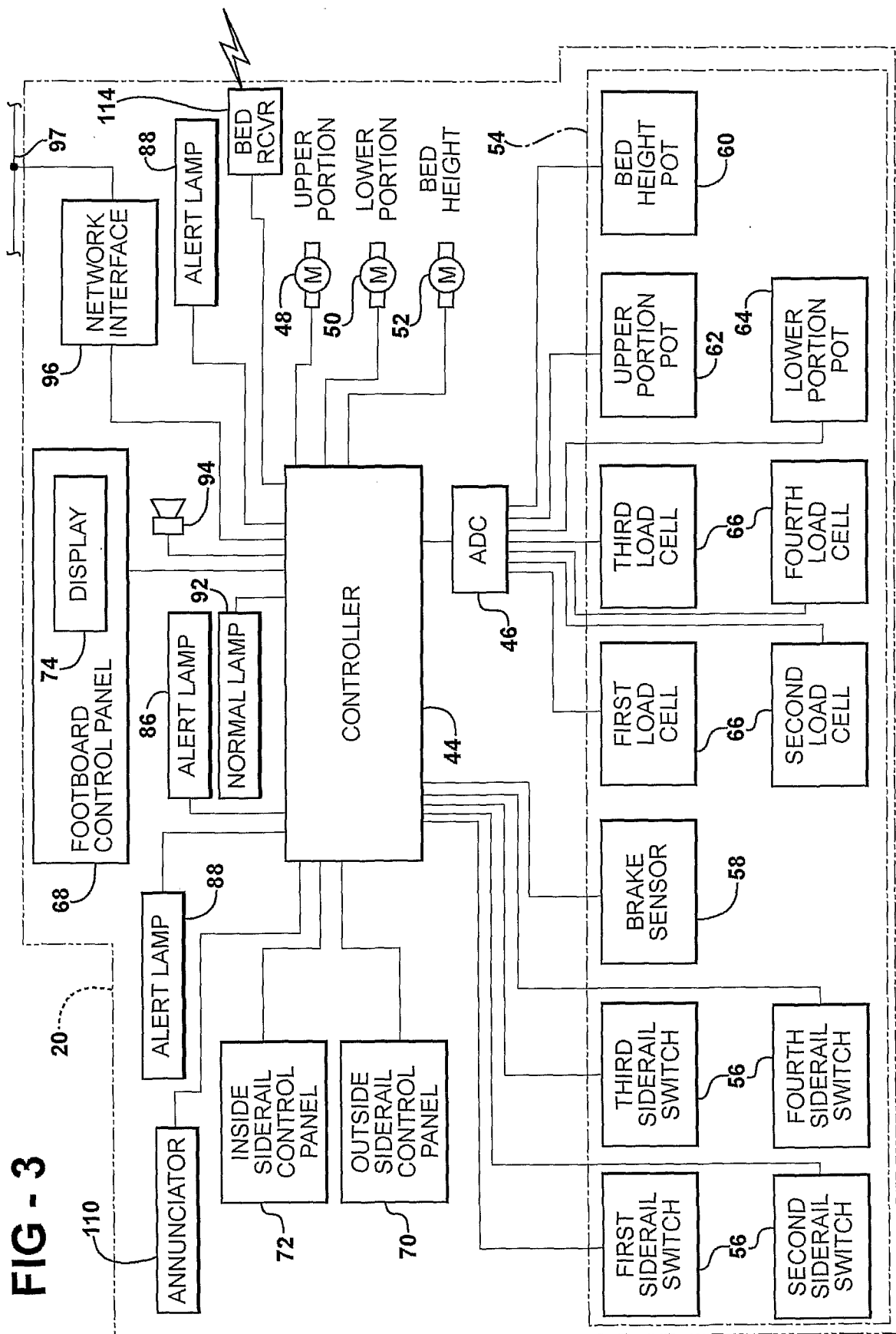

FIG - 2



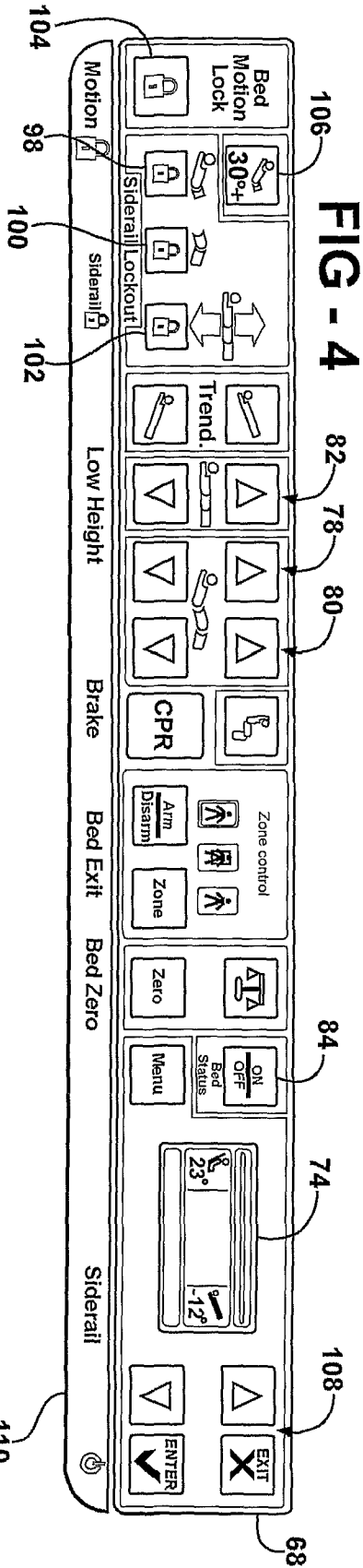

FIG - 5

FIG - 6A

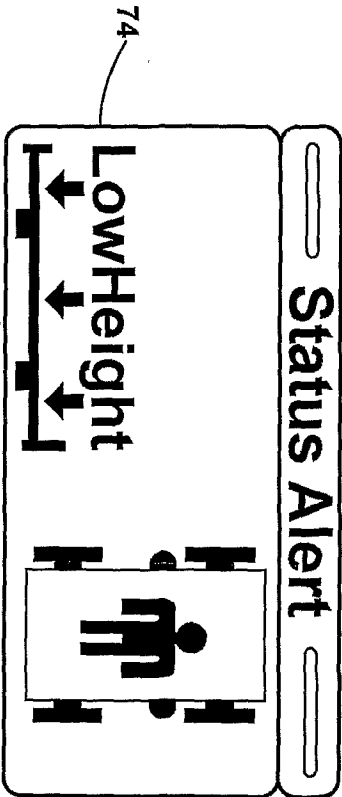
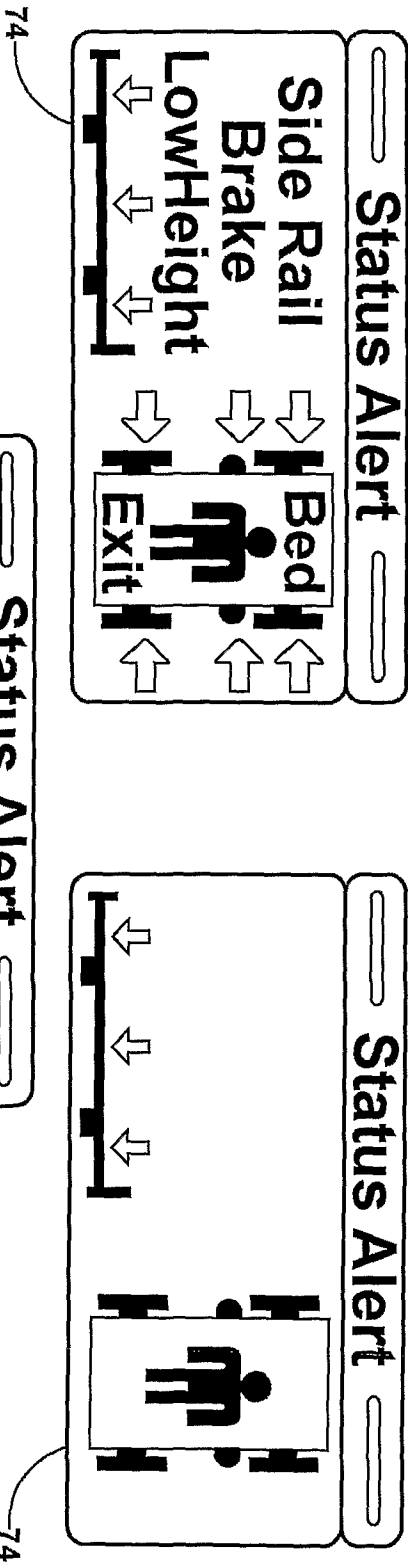

FIG - 6B

FIG - 7A

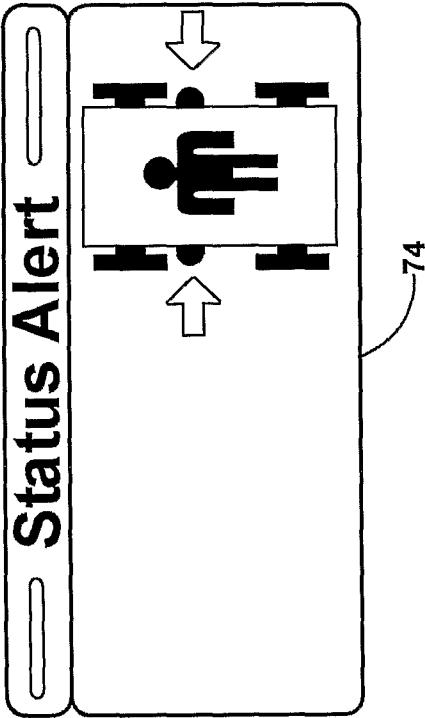

FIG - 7B

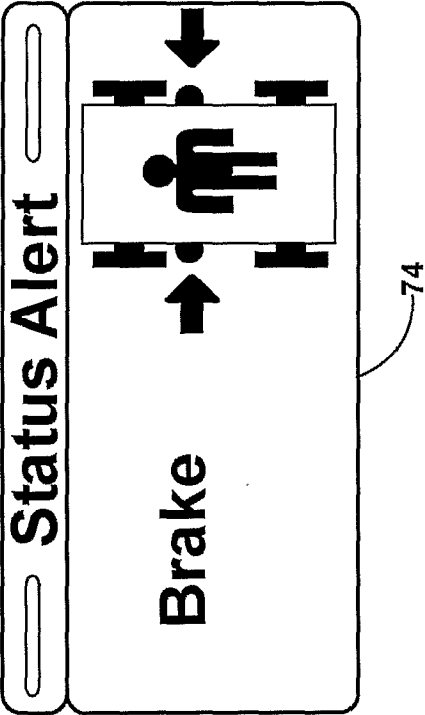

FIG - 8A

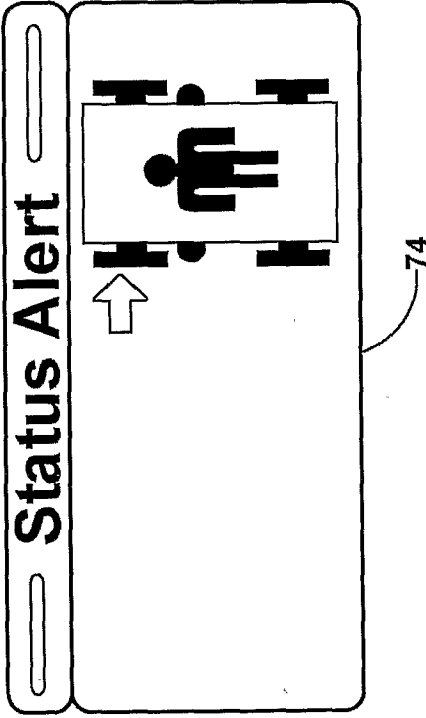

FIG - 8B

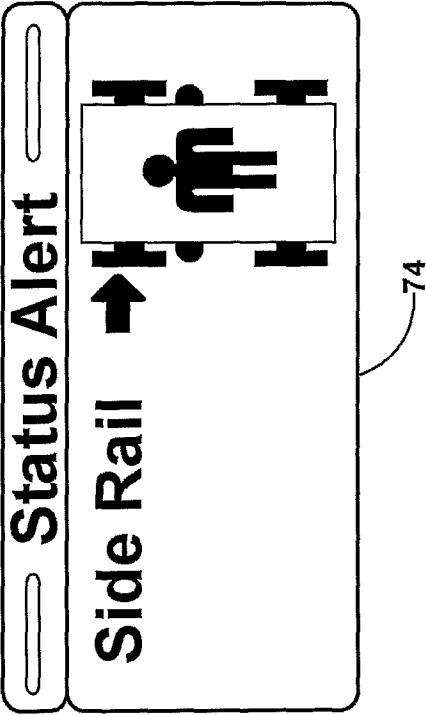

FIG - 9A

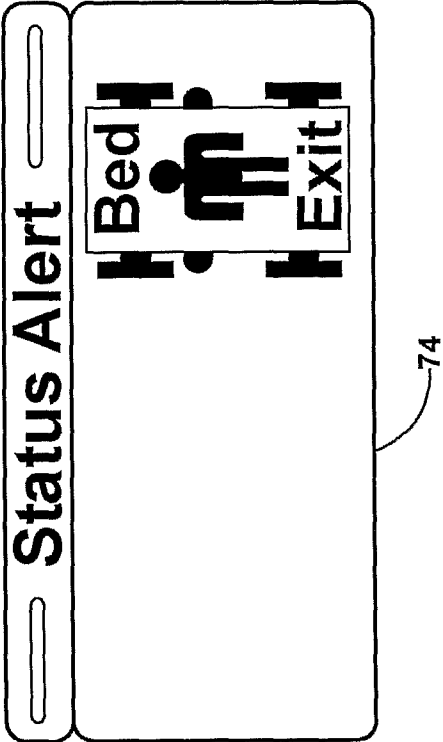
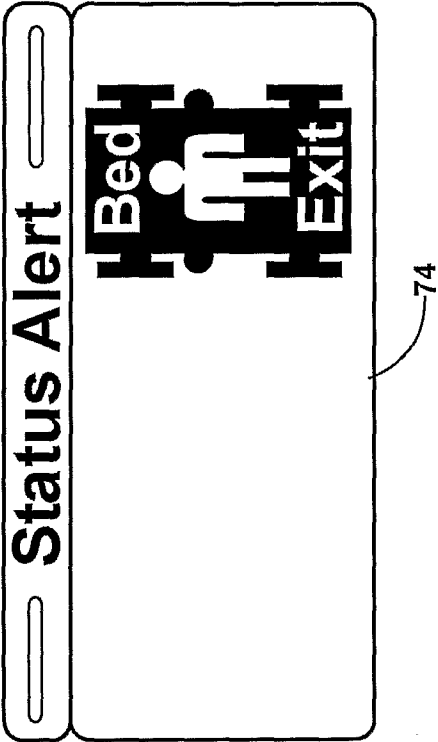

FIG - 9B



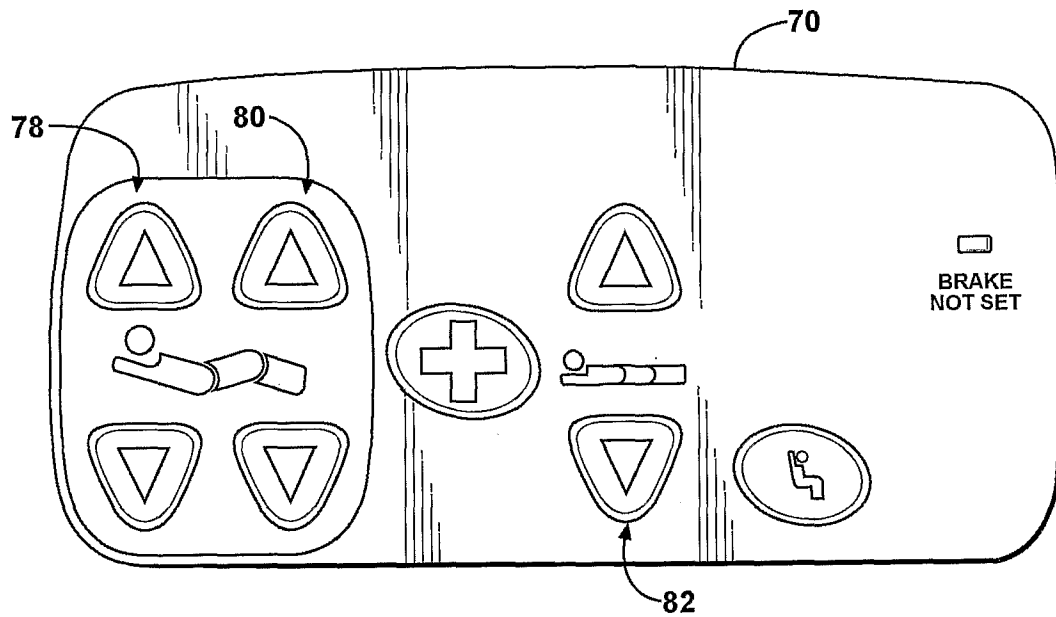

FIG - 10

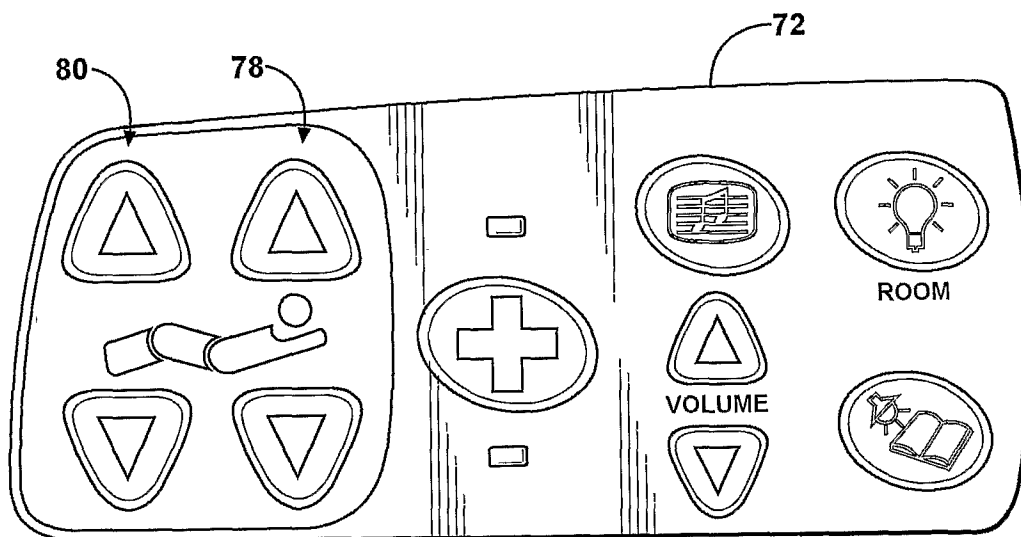

FIG - 11

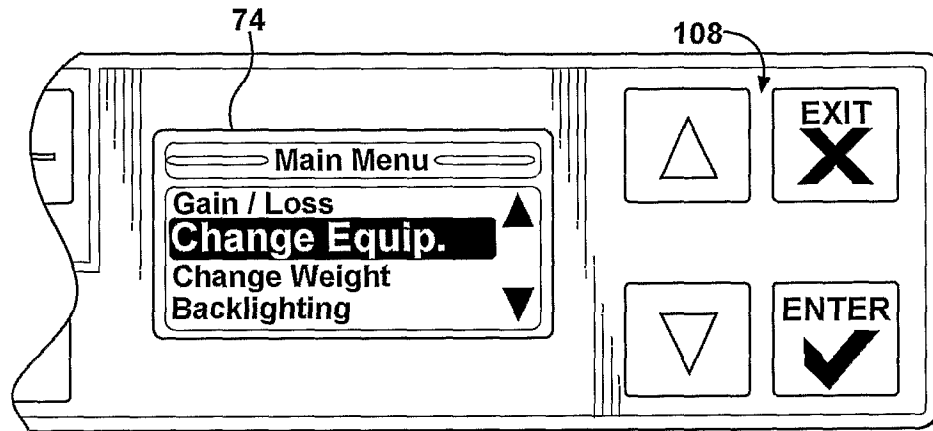

FIG - 12

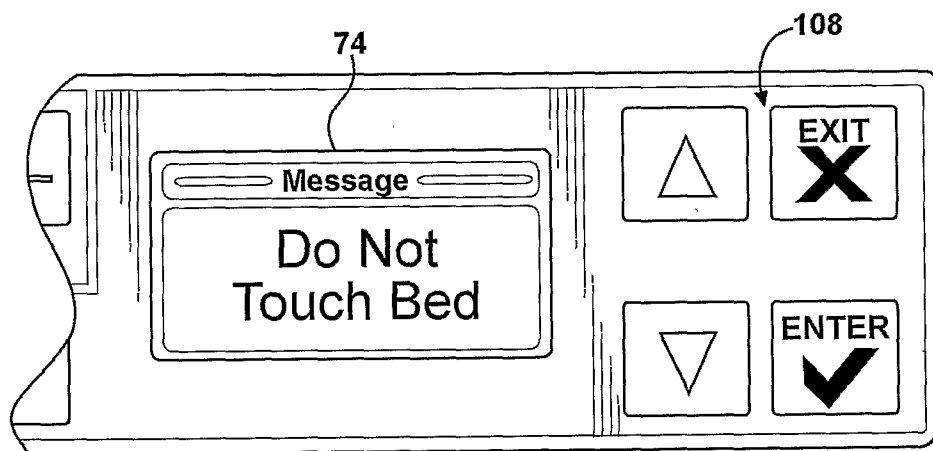

FIG - 13

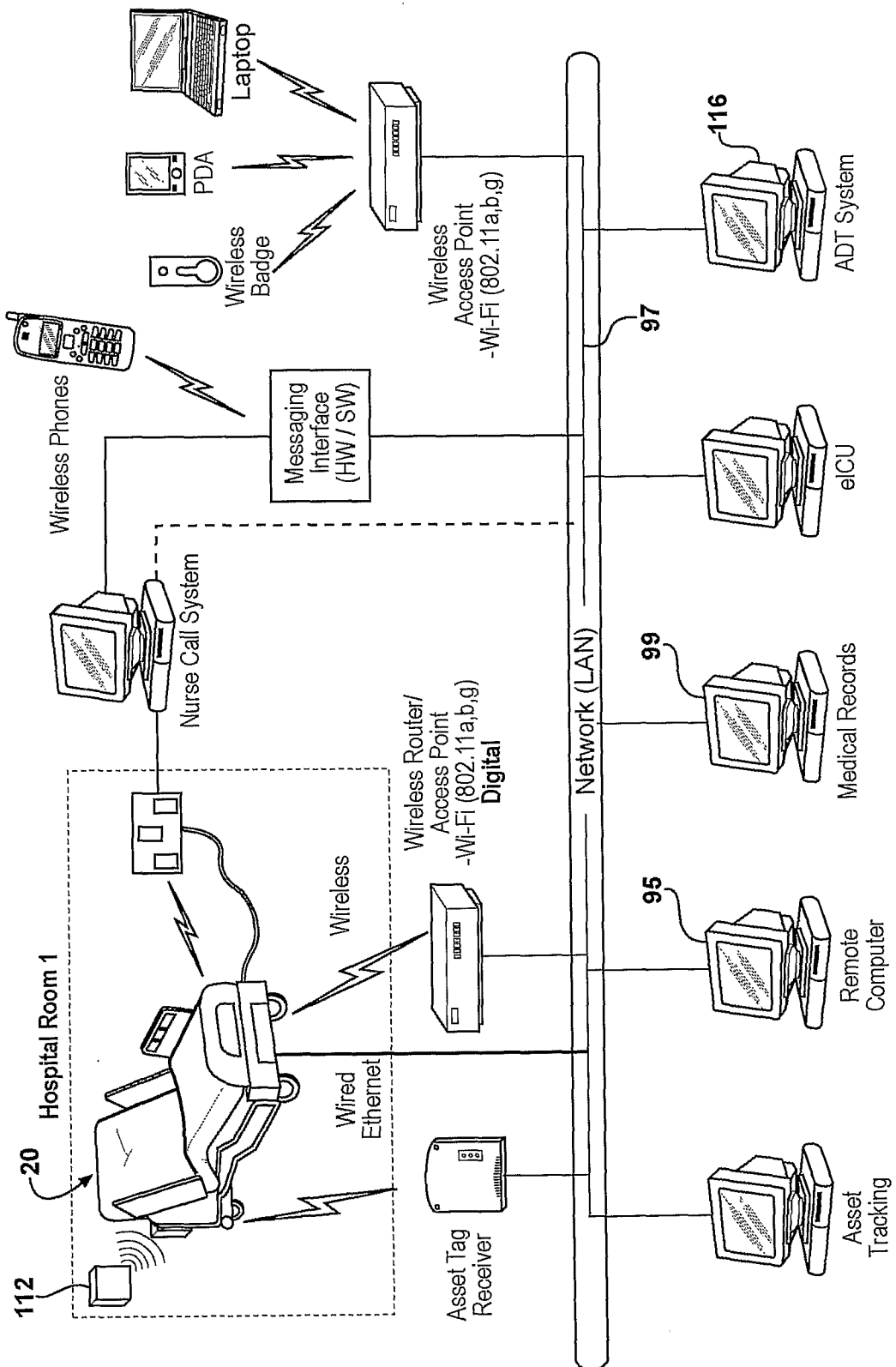
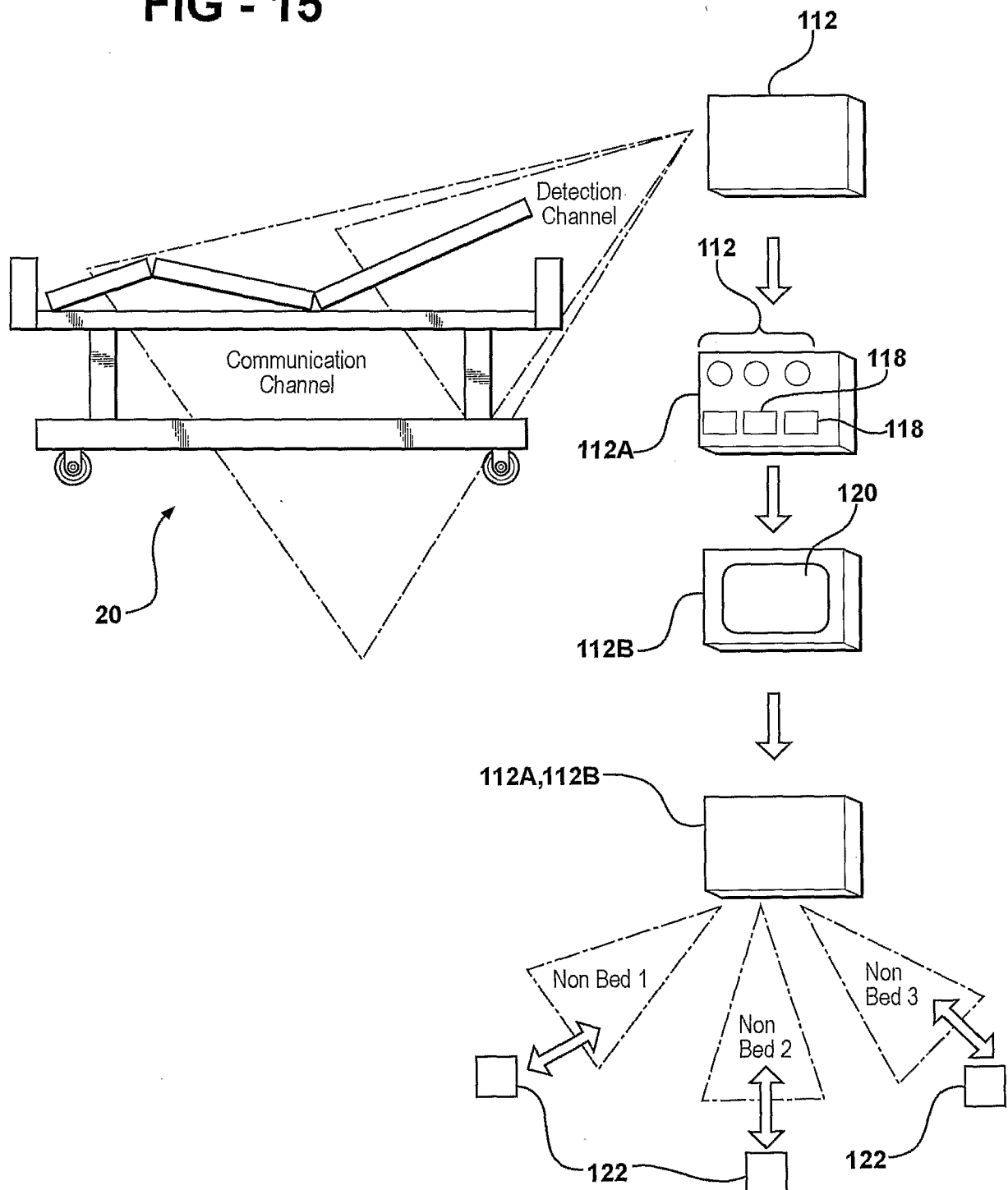

FIG - 14

FIG - 15

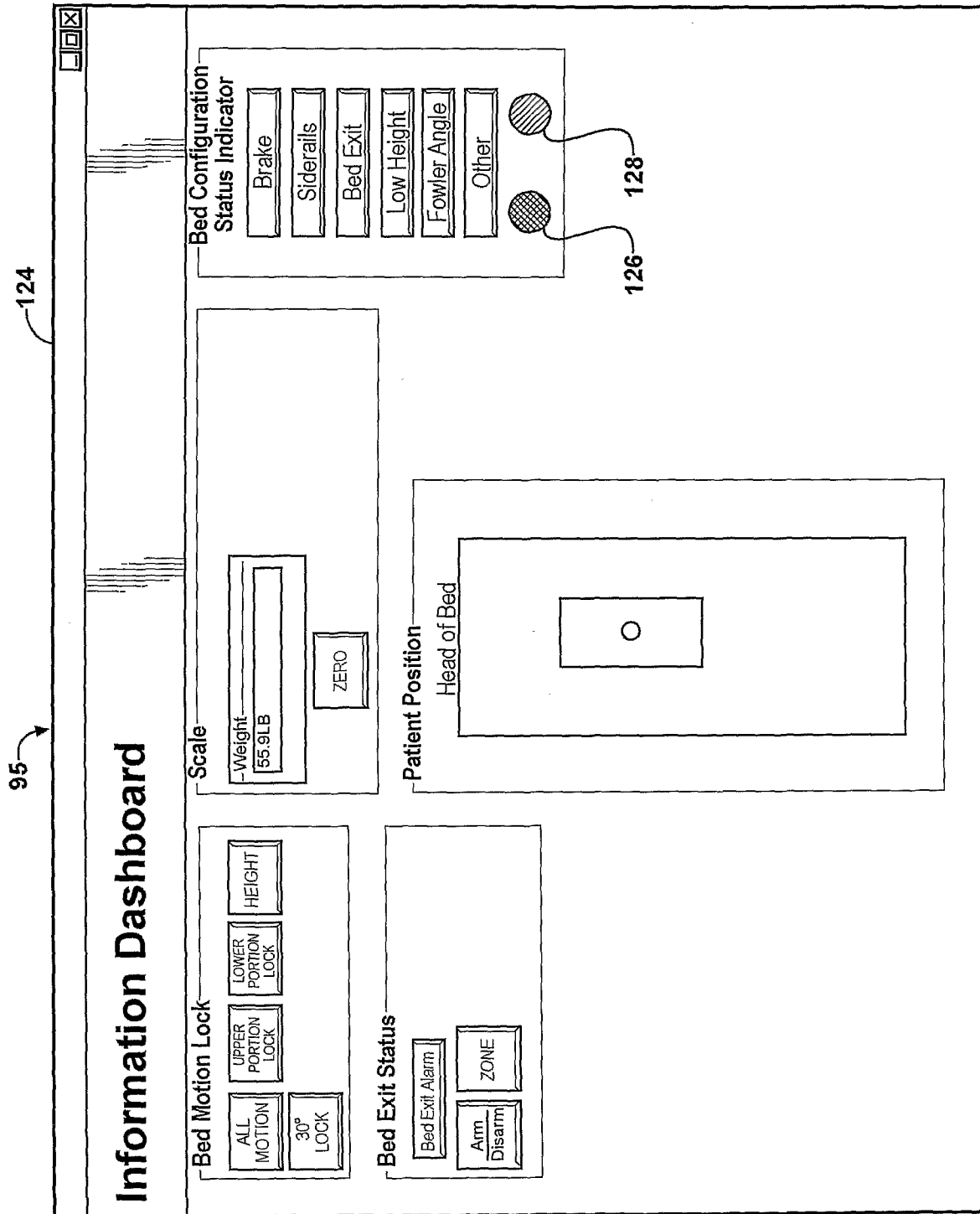

FIG - 16