



(12) **EUROPEAN PATENT APPLICATION**

(88) Date of publication A3:  
**23.12.2009 Bulletin 2009/52**

(51) Int Cl.:  
**A24D 3/02 (2006.01)**

(43) Date of publication A2:  
**26.03.2008 Bulletin 2008/13**

(21) Application number: **07116468.5**

(22) Date of filing: **14.09.2007**

(84) Designated Contracting States:  
**AT BE BG CH CY CZ DE DK EE ES FI FR GB GR HU IE IS IT LI LT LU LV MC MT NL PL PT RO SE SI SK TR**  
 Designated Extension States:  
**AL BA HR MK RS**

(72) Inventors:  
 • **Balletti, Leonardo**  
**40068 San Lazzaro di Savena (Bologna) (IT)**  
 • **Righetti, Marco**  
**40033 Casalecchio di Reno (Bologna) (IT)**  
 • **Sgrignuoli, Vittorio**  
**40127 Bologna (IT)**

(30) Priority: **20.09.2006 IT BO20060647**

(74) Representative: **Ghioni, Carlo Raoul Maria**  
**c/o Bugnion S.p.A.**  
**Via Goito 18**  
**40126 Bologna (IT)**

(71) Applicant: **G.D.S.p.A.**  
**40133 Bologna (IT)**

(54) **A machine for manufacturing cigarette filters**

(57) In a cigarette filter maker, at least one continuous web or strip (5) of fibrous filter material advances along a feed path (P) and through at least one device

(11) by which the fibrous material is processed; the feed path (P) extends at least in part through an enclosed duct (14a) swept by a laminar flow (F) of air.

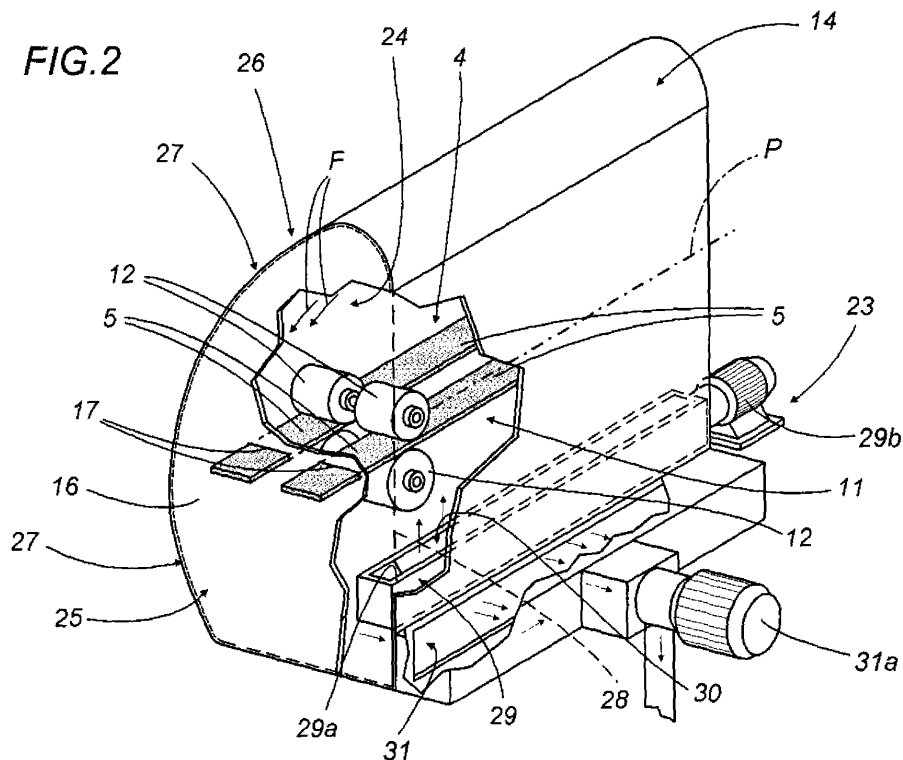



EUROPEAN SEARCH REPORT

Application Number  
EP 07 11 6468

DOCUMENTS CONSIDERED TO BE RELEVANT			
Category	Citation of document with indication, where appropriate, of relevant passages	Relevant to claim	CLASSIFICATION OF THE APPLICATION (IPC)
A	EP 0 941 673 A1 (HAUNI MASCHINENBAU AG [DE]) 15 September 1999 (1999-09-15) * paragraph [0010] - paragraph [0011]; figures 1-3 *	1-12	INV. A24D3/02
A	----- US 2 954 036 A (SCHUR MILTON O ET AL) 27 September 1960 (1960-09-27) * column 1, line 57 - column 2, line 16; figure 1 *	1	
A	----- DE 101 23 351 A1 (RHODIA ACETOW GMBH [DE]) 5 December 2002 (2002-12-05) * paragraph [0019] - paragraph [0020]; figure 1 *	1-12	
			TECHNICAL FIELDS SEARCHED (IPC)
			A24D
The present search report has been drawn up for all claims			
Place of search Munich		Date of completion of the search 13 November 2009	Examiner Maier, Michael
CATEGORY OF CITED DOCUMENTS		T : theory or principle underlying the invention E : earlier patent document, but published on, or after the filing date D : document cited in the application L : document cited for other reasons	
X : particularly relevant if taken alone Y : particularly relevant if combined with another document of the same category A : technological background O : non-written disclosure P : intermediate document		& : member of the same patent family, corresponding document	

1  
EPO FORM 1503 03.82 (P04/C01)

ANNEX TO THE EUROPEAN SEARCH REPORT  
ON EUROPEAN PATENT APPLICATION NO.

EP 07 11 6468

This annex lists the patent family members relating to the patent documents cited in the above-mentioned European search report. The members are as contained in the European Patent Office EDP file on  
The European Patent Office is in no way liable for these particulars which are merely given for the purpose of information.

13-11-2009

Patent document cited in search report	Publication date	Patent family member(s)	Publication date	
EP 0941673	A1	15-09-1999	CN 1228946 A	22-09-1999
			WO 9948342 A1	23-09-1999
			DE 19811014 A1	16-09-1999
			ES 2179563 T3	16-01-2003
			JP 4319281 B2	26-08-2009
			JP 11290055 A	26-10-1999
			JP 2002507831 T	12-03-2002
			PL 331916 A1	27-09-1999
			US 6263882 B1	24-07-2001
-----				
US 2954036	A	27-09-1960	CH 376829 A	15-04-1964
			DE 1198264 B	05-08-1965
			FR 1226268 A	11-07-1960
			GB 869846 A	07-06-1961
-----				
DE 10123351	A1	05-12-2002	NONE	
-----				