



(51) International Patent Classification:
A01D 34/00 (2006.01)

(21) International Application Number:
PCT/US2009/047548

(22) International Filing Date:
16 June 2009 (16.06.2009)

(25) Filing Language: English

(26) Publication Language: English

(30) Priority Data:
12/214,023 16 June 2008 (16.06.2008) US

(71) Applicant (for all designated States except US): **BRIGGS AND STRATTON CORPORATION** [US/US];
12301 West Wirth Street, Wauwatosa, WI 53222 (US).

(72) Inventors; and

(75) Inventors/Applicants (for US only): **MARSHALL, James, F.** [US/US]; RR2 Box 262e, Munnsville, NY 13409 (US). **HATCH, Matthew, R.** [US/US]; 308 North Main Street, Canastota, NY 13032 (US). **CAMENGA, Derrick, R.** [US/US]; 215 Pleasant Valley Road, Sherburne, NY 13460 (US). **WILLIAMS, Joshua, S.** [US/US]; 2744 State Route 12b, Deansboro, NY 13328 (US). **DECKER, William, J.** [US/US]; 5299 Cooper Street, Vernon, NY 13476 (US).

(74) Agent: **DAUGHERTY, Raye, Lynn**; Greenbert Traurig, LLP, 2450 Colorado Avenue, Ste. 400e, Santa Monica, CA 90404 (US).

(81) Designated States (unless otherwise indicated, for every kind of national protection available): AE, AG, AL, AM, AO, AT, AU, AZ, BA, BB, BG, BH, BR, BW, BY, BZ, CA, CH, CL, CN, CO, CR, CU, CZ, DE, DK, DM, DO, DZ, EC, EE, EG, ES, FI, GB, GD, GE, GH, GM, GT, HN, HR, HU, ID, IL, IN, IS, JP, KE, KG, KM, KN, KP, KR, KZ, LA, LC, LK, LR, LS, LT, LU, LY, MA, MD, ME, MG, MK, MN, MW, MX, MY, MZ, NA, NG, NI, NO, NZ, OM, PE, PG, PH, PL, PT, RO, RS, RU, SC, SD, SE, SG, SK, SL, SM, ST, SV, SY, TJ, TM, TN, TR, TT, TZ, UA, UG, US, UZ, VC, VN, ZA, ZM, ZW.

(84) Designated States (unless otherwise indicated, for every kind of regional protection available): ARIPO (BW, GH, GM, KE, LS, MW, MZ, NA, SD, SL, SZ, TZ, UG, ZM, ZW), Eurasian (AM, AZ, BY, KG, KZ, MD, RU, TJ, TM), European (AT, BE, BG, CH, CY, CZ, DE, DK, EE, ES, FI, FR, GB, GR, HR, HU, IE, IS, IT, LT, LU, LV, MC, MK, MT, NL, NO, PL, PT, RO, SE, SI, SK, TR), OAPI (BF, BJ, CF, CG, CI, CM, GA, GN, GQ, GW, ML, MR, NE, SN, TD, TG).

Published:

— with international search report (Art. 21(3))

[Continued on next page]

(54) Title: LAWN MOWER WITH SUSPENDED ERGONOMIC SEAT

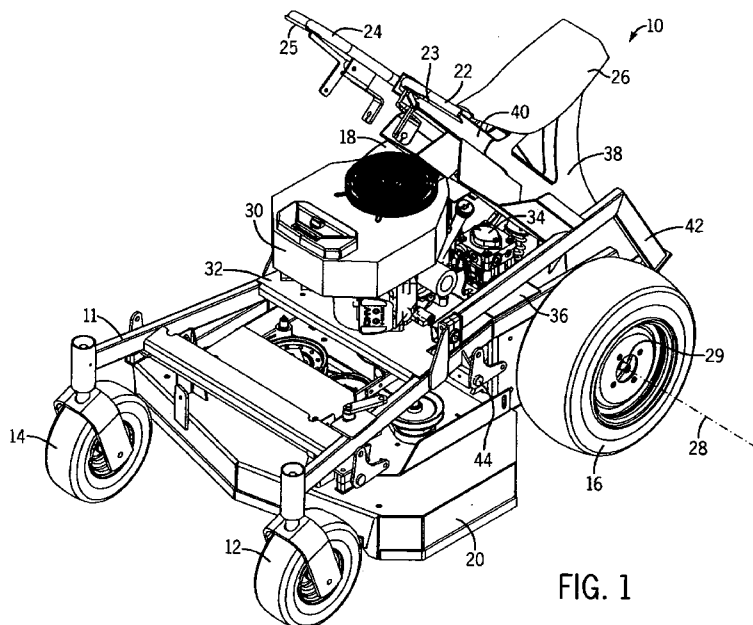

FIG. 1

(57) Abstract: Embodiments of the invention provide a lawn mower including a frame, a seat or operator station, one or more handles, and a suspension unit coupled between the frame and the seat or operator station. The lawn mower can include one or more pivot members with a first portion coupled to the frame at a pivot location forward of the seat or operator station and a second portion coupled to the seat or operator station. The one or more pivot members can allow the seat or operator station and the one or more handles to move with respect to the frame while the suspension unit absorbs a portion of shock caused by riding over the uneven terrain. The seat can be positioned at least partially between a first drive wheel and a second drive wheel and at least partially along a drive axis. The seat can be declined with respect to a horizontal plane so that the operator's upper torso leans forward at an angle with respect to a vertical plane when the operator is sitting on the seat.



(88) Date of publication of the international search report:

22 April 2010

INTERNATIONAL SEARCH REPORT

International application No.

PCT/US 09/47548

A. CLASSIFICATION OF SUBJECT MATTER

IPC(8) - A01D 43/00 (2009.01)

USPC - 56/153

According to International Patent Classification (IPC) or to both national classification and IPC

B. FIELDS SEARCHED

Minimum documentation searched (classification system followed by classification symbols)

USPC: 56/153

Documentation searched other than minimum documentation to the extent that such documents are included in the fields searched
 USPC: 56/10.8, 131, 154, 155, 156, 157, 323, DIG10; 297/195.1, 313, 423.1, 423.11; 248/371; 280/755; 296/65.02; 180/900, 89.12; 74/473.16 (text search - see terms below)

Electronic data base consulted during the international search (name of data base and, where practicable, search terms used)

PubWEST(USPT, PGPB, EPAB, JPAB); Google Patents; Google.

Search Terms: mower, vehicle, frame, seat, chair, stool, handle, steering, suspension, spring, biasing, wheels, pivot, support.

C. DOCUMENTS CONSIDERED TO BE RELEVANT

Category*	Citation of document, with indication, where appropriate, of the relevant passages	Relevant to claim No.
Y	US 5,367,864 A (OGASAWARA et al.) 29 November 1994 (29.11.1994) FIG. 1, 2, col 1, from ln 53 to col 2, ln 4, col 2, ln 50-60, col 3, ln 8-19, 22-26, 47-50	1-51, 57
Y	US 5,913,802 A (MULLET et al.) 22 June 1999 (22.06.1999), FIG. 1, 3, 4, 5, col 3, ln 13-46, col 4, ln 19-67	1-51, 56
Y	US 6,205,753 B1 (VELKE et al.) 27 March 2001 (27.03.2001), FIG. 1, 4, 8, col 3, ln 55-65, col 4, ln 3-7, 37-39, 58-65, col 7, ln 49-62	17, 18, 47, 48, 52-61
Y	US 2007/0034435 A1 (BERG et al.) 15 February 2007 (15.02.2007), FIG. 2C, 9, 11, 12, para [0037], [0039], [0043], [0055], [0056]	22-29, 30, 52-67
Y	US 6,490,849 B1 (SCAG et al.) 10 December 2002 (10.12.2002), FIG. 1, 6, 7A, 7B, col 4, ln 3-9, 32-34, 45-47, col 5, ln 23-35, 49-51	62-67
Y	US 2008/0034958 A1 (KORTHALS) 14 February 2008 (14.02.2008), FIG. 1, 2, 4, abstract, para [0018], [0019]	6, 7, 36, 37
Y	US 6,845,829 B2 (HAFENDORFER) 25 January 2005 (25.01.2005), col 1, ln 61-63, col 4, ln 48-51, col 6, ln 38-42, 60-64, 65-67, col 7, ln 44-50	12, 13, 15-19, 22-29, 30, 42, 43, 45-49, 53-61
Y	US 3,774,711 A (LACEY) 27 November 1973 (27.11.1973), FIG. 1, col 1, from ln 49 to col 2, ln 8	66

☐ Further documents are listed in the continuation of Box C.

* Special categories of cited documents:

"A" document defining the general state of the art which is not considered to be of particular relevance

"E" earlier application or patent but published on or after the international filing date

"L" document which may throw doubts on priority claim(s) or which is cited to establish the publication date of another citation or other special reason (as specified)

"O" document referring to an oral disclosure, use, exhibition or other means

"P" document published prior to the international filing date but later than the priority date claimed

"T" later document published after the international filing date or priority date and not in conflict with the application but cited to understand the principle or theory underlying the invention

"X" document of particular relevance; the claimed invention cannot be considered novel or cannot be considered to involve an inventive step when the document is taken alone

"Y" document of particular relevance; the claimed invention cannot be considered to involve an inventive step when the document is combined with one or more other such documents, such combination being obvious to a person skilled in the art

"&" document member of the same patent family

Date of the actual completion of the international search

13 December 2009 (13.12.2009)

Date of mailing of the international search report

07 JAN 2010

Name and mailing address of the ISA/US

Mail Stop PCT, Attn: ISA/US, Commissioner for Patents
P.O. Box 1450, Alexandria, Virginia 22313-1450

Facsimile No. 571-273-3201

Authorized officer:

Lee W. Young

PCT Helpdesk: 571-272-4300
PCT OSP: 571-272-7774