



(51) International Patent Classification:

E21D 9/00 (2006.0 1) F42D 3/04 (2006.0 1)
E21B 7/02 (2006.01)

(21) International Application Number:

PCT/EP2013/059613

(22) International Filing Date:

8 May 2013 (08.05.2013)

(25) Filing Language:

English

(26) Publication Language:

English

(71) Applicant: SANDVIK MINING AND CONSTRUCTION OY [FI/FI]; Pihtisulunkatu 9, FI-33330 Tampere (FI).

(72) Inventor: MUONA, Jouko; Sandvik Mining and Construction, Pihtisulunkatu 9, FI-33330 Tampere (FI).

(81) Designated States (unless otherwise indicated, for every kind of national protection available): AE, AG, AL, AM, AO, AT, AU, AZ, BA, BB, BG, BH, BN, BR, BW, BY, BZ, CA, CH, CL, CN, CO, CR, CU, CZ, DE, DK, DM, DO, DZ, EC, EE, EG, ES, FI, GB, GD, GE, GH, GM, GT, HN, HR, HU, ID, IL, IN, IS, JP, KE, KG, KM, KN, KP,

KR, KZ, LA, LC, LK, LR, LS, LT, LU, LY, MA, MD, ME, MG, MK, MN, MW, MX, MY, MZ, NA, NG, NI, NO, NZ, OM, PA, PE, PG, PH, PL, PT, QA, RO, RS, RU, RW, SC, SD, SE, SG, SK, SL, SM, ST, SV, SY, TH, TJ, TM, TN, TR, TT, TZ, UA, UG, US, UZ, VC, VN, ZA, ZM, ZW.

(84) Designated States (unless otherwise indicated, for every kind of regional protection available): ARIPO (BW, GH, GM, KE, LR, LS, MW, MZ, NA, RW, SD, SL, SZ, TZ, UG, ZM, ZW), Eurasian (AM, AZ, BY, KG, KZ, RU, TJ, TM), European (AL, AT, BE, BG, CH, CY, CZ, DE, DK, EE, ES, FI, FR, GB, GR, HR, HU, IE, IS, IT, LT, LU, LV, MC, MK, MT, NL, NO, PL, PT, RO, RS, SE, SI, SK, SM, TR), OAPI (BF, BJ, CF, CG, CI, CM, GA, GN, GQ, GW, ML, MR, NE, SN, TD, TG).

Declarations under Rule 4.17:

— as to applicant's entitlement to apply for and be granted a patent (Rule 4.1 7(H))

Published:

— with international search report (Art. 21(3))

(54) Title: ARRANGEMENT FOR ASSIGNING AND DRILLING BORE HOLES

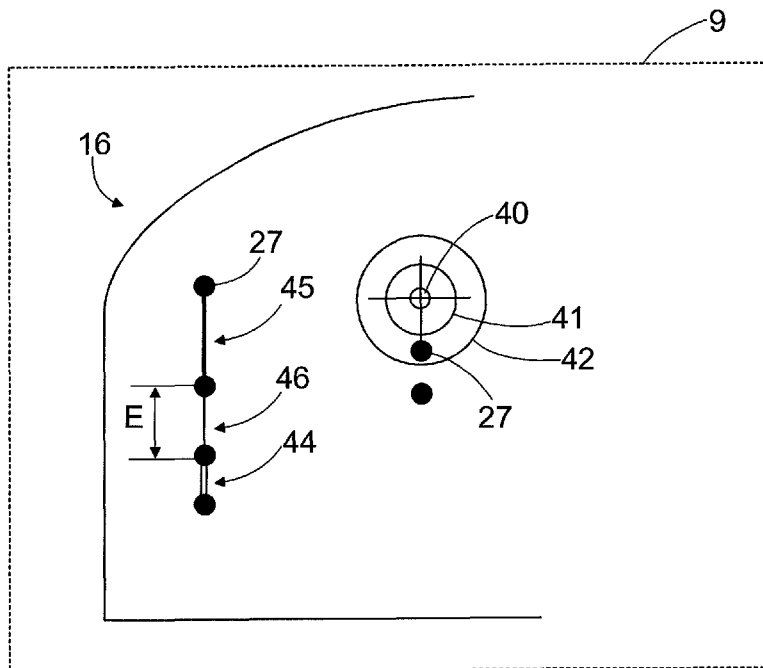

FIG. 6

(57) Abstract: The invention relates to an apparatus for assigning drill holes and to a method and a computer program product. The apparatus is arranged to determine a forthcoming position of a bottom of a new drill hole before it is drilled. The forthcoming position of the drill hole bottom is determined on the basis of the current location and direction of a tool and a planned length of the drill hole.

WO2014/180502 A1

Arrangement for assigning and drilling bore holes

Background of the invention

The invention relates to an apparatus for assigning positions of drill holes for a round to be drilled by a rock drilling rig.

5 The invention further relates to a method for drilling a round and to a software product for executing the disclosed method.

The field of the invention is defined more specifically in the preambles of the independent claims.

10 In mines rock is excavated in rounds. Several successive rounds produce a production tunnel having a tunnel face. At first drill holes are drilled to the tunnel face, where after the drilled holes are charged and blasted. Rock material of the amount of one round is detached from the rock at one blasting time. The detached rock material is transported away from the production tunnel for further treatments. For excavating the rock, a drilling pattern, or drill
15 hole pattern, is made in advance and information on the rock type, for example, is determined. In general, also the owner of the mine may set various quality requirements for the excavation process. Typically, the drilling pattern is designed as office work for each round. The pattern is provided for the rock drilling rig to drill holes in the rock in such a way that a desired round can be
20 formed. However, use of the beforehand planned drilling patterns have some disadvantages.

Brief description of the invention

An object of the invention is to provide a novel and improved apparatus, method and software for drilling a round.

25 The apparatus according to the invention is characterized in that the apparatus is configured to: determine the actual position of at least one realized drill hole bottom by detecting the position of the tool on the bottom of the round during the drilling process; determine for a new, currently active drill hole the forthcoming position of the drill hole bottom before drilling the new drill
30 hole, wherein the determining is based on the current location and direction of the tool and on the predetermined length of the new drill hole; and indicate the determined position of the forthcoming drill hole bottom of the new drill hole in relation to the realized drill hole bottoms on the bottom of the round.

35 The method according to the invention is characterized by determining the forthcoming position of the bottom of a new drill hole before drilling the

new drill hole, wherein the position of the new drill hole bottom is determined on the basis of the current location and direction of the tool and on the planned length of the new drill hole.

5 The software product according to the invention is characterized in that the computer program product comprises program code means configured to execute the steps and procedures disclosed in the independent claims when being run on a computer or a data processing device.

10 An idea of the disclosed solution is that the forthcoming position of the bottom of a new drill hole is determined before drilling a new drill hole. The forthcoming position of the new drill hole bottom is determined on the basis of a current location and direction of a drilling tool and a planned length of the new drill hole.

15 An advantage of the disclosed solution is that the disclosed assigning feature of the forthcoming positions of the drill hole bottoms aids the operator of the rock drilling rig when drilling the round. This facilitates positioning of the drilling tool at starting points of drill holes and directing the tool for the drilling so that the drill hole bottom will be positioned at the desired place. The disclosed assigning feature allows accurate manual designing of the drill hole positions.

20 According to an embodiment, the apparatus is arranged in a rock drilling rig. The rock drilling rig comprises a carrier, at least one drilling boom, at least one rock drilling unit, a drilling tool connected to the drilling unit, and at least one control unit. The rock drilling rig may be an underground rock drilling rig. The rock drilling rig may comprise only one drilling boom and one drilling unit, or alternatively, it may comprise several drilling booms provided with the drilling units. The rock drilling rig may be a production drilling rig the only purpose being drilling holes, which are being charged in a separate charging step.

25 According to an embodiment, the data processing unit of the apparatus is integrated in the control unit of the rock drilling rig. Alternatively, the rock drilling rig may comprise at least one dedicated processing unit for executing the disclosed solution and its embodiments.

30 According to an embodiment, the rock drilling rig is provided with sensing means for determining the current position and direction of a drill bit of the tool. The drilling boom may be equipped with sensors, which detect positions of the boom parts. Articulations between the boom parts may be provided with sensors. The sensing data may be provided to the data processing unit

wherein the position and direction may be calculated. Alternatively, the position and direction of the tool can be detected by external measuring or sensing means. A laser measuring device arranged to a work site may be utilized, for example.

5 According to an embodiment, the drilling of the round is initiated without a predetermined drilling pattern defining the positions and directions of the drill holes to be drilled. Thus, the drilling is executed without any drilling pattern made as office work. Instead, the drilling control takes into account re-
10 realized drill holes when determining the positions and directions of the undrilled drill holes. Thanks to this, the drilling process is simpler and does not require any dedicated designer. Since the realized drill holes affect to the forthcoming drill holes, the end result is precise too. Further, the disclosed solution suits well to situations where successive rounds differ from each other and a plurali-
15 ty of individual drilling patterns are needed for them.

15 According to an embodiment, the apparatus determines actual position of the realized drill hole bottom when drilling of the drill hole is completed. Then position and direction of the tool on the bottom of the round is deter-
20 mined in a processing device by means of received sensing data. Since the realized drill hole positions are detected, the apparatus is capable of placing or assigning a new drill hole next to the realized drill holes. The apparatus may also indicate the position of the forthcoming drill hole bottom of the new drill hole in relation to the at least one realized drill hole bottom on the bottom of the round.

25 According to an embodiment, a new drill hole is placed according to at least one predetermined allowable spacing range defining a minimum drill hole spacing and a maximum drill hole spacing between drill hole bottoms. The allowable spacing range may be determined according to the used explosive and charging, and also taking into account location of the drill hole to be drilled. Then, the allowable spacing range may be different in different sections
30 of a facing of the round. One or more spacing ranges may be determined as office work and may be input to the processing device. The spacing ranges may also be stored in a memory device and may be retrieved by the processing device.

35 According to an embodiment, drill holes are placed in two or more rows at the face of the round to be drilled. At first, new drill hole bottoms are placed in one drill hole row and two or more drill holes are drilled in the row.

Thereafter actual spacing between the realized drill hole bottoms in the drill hole row is determined. Based on the determined realized spacing burdens are determined for the realized drill hole bottoms. Minimum and maximum burdens corresponding to the predetermined minimum drill hole spacing and maximum
5 drill hole spacing are predetermined and may be input to the processing device. The processing device employs the predetermined minimum and maximum burdens when determining the burdens. The burdens can be determined using interpolation between the minimum burden and the maximum burden
10 when the determined spacing of the realized drill hole bottoms are taken into account. Then position of a next drill hole row can be determined according to the determined burdens of the realized drill hole bottoms locating in the previous drill hole row. The determined burdens define distances between the realized drill hole bottoms and the successive drill hole row. New drill hole bottoms may be determined and placed in the next drill hole row.

15 According to an embodiment, drilling of the round is initiated at a contour of the face of the round to be drilled. Then, a first drill hole row is a contour row. Inside the contour row are placed one or more aid rows. At first, two or more holes are placed in the contour row and their realized spacing is defined so that burdens can be determined by means of interpolation between
20 the predetermined minimum and maximum burdens as disclosed above. A first aid row is then determined at a distance inside the contour row, the distance corresponding to the interpolated burdens. As the drilling of the face proceeds, several drill rows may be determined one after each other towards a cut. Thus, the design of the drilling pattern is generated during the drilling procedure out-
25 side-in.

According to an embodiment, the rock drilling rig comprises two or more drilling booms provided with drilling units. A first drilling unit may continue drilling of a previous drill hole row, such as a contour row, whereas a second drilling unit may drill holes of the determined successive drill hole row, such as
30 in a first aid row. Alternatively, the drilling of the previous drill hole row is first completed by using all available drilling units and only thereafter drilling of the successive drill hole row is initiated.

According to an embodiment, the apparatus comprises at least one display device. The apparatus may indicate the determined position of the new
35 forthcoming drill hole bottom on one or more display devices. The position of the new drill hole bottom may be shown in relation to the realized drill hole bot-

toms whereby a clear view of the situation is offered for the operator of the rock drilling rig. This embodiment allows easily understandable visual data to be served for the operator of the rock drilling rig. Visualization facilitates significantly the work of the operator.

5 According to an embodiment, the apparatus is configured to employ a predetermined spacing range for the new drill hole bottom. Further, the apparatus comprises one or more display devices and the apparatus is configured to indicate on the display device allowable spacing according to the spacing range and in relation to the closest realized drill hole bottom.

10 According to an embodiment, the apparatus indicates the forthcoming drill hole bottom as a symbol on the display device. A visual symbol is fast and easy to note on the display. The visual symbol may be a circle, or alternatively, it may be any other suitable geometrical pattern, character or symbol.

 According to an embodiment, the apparatus employs a predetermined spacing range and indicates a minimum drill hole spacing as a first circle around the symbol. Further, maximum drill hole spacing may be indicated as a second circle around the first circle. Thus, between the first and second circle is an acceptable tolerance for the drill hole spacing. Diameters of the first and second circles correspond to the predetermined minimum and maximum
15 drill hole spacing. Thus, the greater the space between the circles is, the greater is the allowed tolerance, and vice versa. The circles may be shown on the display device using different colors or shadings too. This embodiment facilitates the work of the operator. The operator may fine-adjust positioning and directioning of the tool by monitoring the circles so that the desired drill hole
20 spacing is obtained. Thus, the circles may also improve quality and accuracy of the drilling.

 According to an embodiment, the apparatus indicates on the display device realized drill hole spacing by means of visual attention markings. Thanks to the attention markings, the operator notes instantly situation of the
30 realized spacing and the operator may take that information into account when drilling next drill holes. Thus, the visual attention markings provide the operator with instant feedback.

 According to an embodiment, the apparatus indicates on the display device a first attention marking indicating too short a drill hole spacing relative
35 to the determined minimum drill hole spacing. The first attention marking may be a double line, which is generated between the realized drill hole bottoms.

According to an embodiment, the apparatus indicates on the display device a second attention marking indicating too long a drill hole spacing relative to the determined maximum drill hole spacing. The second attention marking may be a single line with attention coloring. Thus, the second attention marking may be a single red line, which is generated between the realized drill hole bottoms.

According to an embodiment, the apparatus indicates on the display device a third attention marking indicating a drill hole spacing being according to the predetermined set spacing range. The first attention marking may be a single line, which is generated between the realized drill hole bottoms. The color of the single line may be the same as other basic objects, or it may be green, for example.

According to an embodiment, the apparatus is arranged to monitor realization of the set spacing ranges. Then the apparatus may be configured to observe exceed of the allowed maximum spacing of the drill hole bottoms. On the basis of such an observation, the apparatus may propose an additional drill hole to be drilled close to the previous realized drill hole. Thus, it is easy for the operator to execute an instant corrective action when a deviation is detected.

According to an embodiment, the apparatus is arranged monitor realization of the set spacing ranges and is arranged to observe if the realized spacing is shorter than the allowed minimum spacing. On the basis of that, the apparatus may produce a data element comprising identification of the observed drill hole and information of the observed drill hole spacing. Thus, on the basis of the data element, the deviating drill hole can be noted afterwards when the drilling of the round is completed and then suitable measures following the drilling may considered.

According to an embodiment, the apparatus observes if the realized spacing is shorter than the allowed minimum spacing and may produce and store a charging data element. The charging data element comprises information allowing decreased charging of the observed drill hole. The charging data element may be input to a control device of an automated charging device, which diminishes charging in the deviating drill hole, or alternatively the post drilling charging device executes the charging with another explosive as used in the neighboring drill holes.

According to an embodiment, the apparatus is configured to show the drill hole bottoms on a display device as a drill hole pattern. The drill hole

pattern comprises several drill hole rows such as an outermost contour row of the round and an outermost first aid row inside the contour row. Inside the first aid row may be one or more additional aid rows. The contour row and aid rows each comprise wall sections, bottom sections and roof sections. Individual spacing ranges are determined for the wall, bottom and roof sections of each of the drill hole rows. Further, the sections may also be provided with individual minimum and maximum burdens. The operator informs the apparatus what drill hole row and what section of the drill hole row is under operation. User interface of a control unit may allow the operator to make easily selections on a display device, for example.

According to an embodiment, the apparatus employs at least one predetermined drilling scenario comprising at least one allowable spacing range of the drill hole bottoms and a predetermined minimum burden and a maximum burden calculated for a minimum spacing and a maximum spacing of the at least one spacing range. Further, the apparatus defines realized spacing between the realized drill hole bottoms. Burdens are determined for the realized drill hole bottoms according to the realized spacing by means of interpolation between the minimum burden and the maximum burden. The interpolation is rather simple and does not require efficient processing capacity. Thus, there is no need to input complex blasting-technical data to the control unit of the rock drilling rig and to any perform complex blasting calculations therein.

According to an embodiment, the apparatus is configured to define the realized spacing between the realized drill hole bottoms on a first drill hole row. Based on that, the apparatus may assign the second drill hole row at a distance from the first drill hole row. The distance between the drill hole lines is set according to the determined burdens of the realized drill hole bottoms on the first drill hole row. Thus, the calculation of burdens, and the resulting distances between successive drill hole rows, is based on positions of the realized drill hole bottoms.

According to an embodiment, the apparatus determines look-out angles for drill holes located in an outermost drill hole row of the round. The processing device may propose for the operator suitable look-out angles and the operator may select and confirm them. The angles may be predetermined, or the processing device may calculate them based on current situation. This feature may also facilitate the work of the operator.

According to an embodiment, the apparatus retrieves a predetermined drilling scenario which comprises a predetermined cut for the round. The cut may comprise several precisely determined drill holes forming a drill hole group. The operator may place the cut to a desired location inside the innermost aid row. Then the operator does not need to design the cut. Designing the cut is typically a time consuming task.

According to an embodiment, several selectable predefined cuts are stored in a memory device. The operator may then select a suitable cut and place the selected cut to a desired location in the drill hole pattern.

According to an embodiment, the apparatus retrieves a predetermined drilling scenario comprising a sketch of an outer contour of the round. The scenario may further comprise a cut, and also spacing ranges and minimum and maximum burdens for different sections of the drilling pattern.

According to an embodiment, the operator may define basic profile and dimension of the outer contour by selecting a basic shape of the profile and feeding dimensions. Several basic profiles may be loaded to the processing device allowing the selection before starting the drilling.

According to an embodiment, the apparatus may comprise automated positioning and drilling features. The apparatus may position the tool automatically at the starting points of the drill holes in a drill hole line and it may also control drilling of the holes. When the drilling of the previous drill hole line is completed, then the operator may manually position and drill some drill holes in the determined next drill hole line. The apparatus may thereafter continue drilling of the next drill hole line and complete the drilling. The operator may at any instance take control of the positioning and drilling operations. The apparatus may be arranged to receive a control command to initiate an automatic mode for drilling the new drill hole or the drill hole line.

According to an embodiment, the apparatus may comprise cracking control means. Then the apparatus determines a cracking area for one or more realized drill hole bottoms. The determined cracking area may be displayed on a display device and it may be shown on the display in relation to a predetermined greatest allowable cracking zone. Thus, the operator may instantly see on the display device the determined cracking area and the allowable cracking zone, whereby easily noted data is served for the operator.

The above disclosed embodiments can be combined in order to form suitable solutions provided with necessary features.

Brief description of the figures

Some embodiments are described in more detail in the accompanying drawings, in which

Figure 1 is a schematic side view showing a rock drilling rig,

Figure 2 is a schematic view showing a drilling pattern,

Figure 3 is a schematic top view showing a round,

Figure 4 illustrates a simplified control block diagram of an apparatus allowing at least assigning of drill hole bottoms,

Figure 5 is a schematic view showing an outer contour and a first aid row of a drilling pattern generated during drilling,

Figure 6 is a schematic view showing some visual symbols on a display device for assisting the work of the operator,

Figure 7 is a schematic view showing procedure for defining position of a next drill hole line, and

Figure 8 is a schematic illustration of determining burdens by means of interpolation.

For the sake of clarity, the figures show some embodiments of the disclosed solution in a simplified manner. In the figures, like reference numerals identify like elements.

Detailed description of some embodiments

Figure 1 shows a rock drilling rig 1 comprising a movable carrier 2, one or more drilling booms 3 and drilling units 4 arranged in the drilling booms 3. The drilling unit 4 comprises a feed beam 5 on which a rock drilling machine 6 can be moved by means of a feed device. Further, the drilling unit 4 comprises a tool 7 with which the impact pulses given by the percussion device of the rock drilling machine are transmitted to the rock to be drilled. The rock drilling rig 1 further comprises at least one control unit 8 arranged to control actuators of the rock drilling rig 1, for example. The control unit 8 may be a computer, processing device or a corresponding device, and it may comprise a user interface with a display device 9 as well as control means for giving commands and information to the control unit 8. The control unit 8 may be one computer equipped with appropriate software, or an entity consisting of a plurality of computers.

Typically a drilling pattern is designed in an office 10 and is loaded to the control unit 8 of the rock drilling rig 1 and implemented. However, in this application it is disclosed a differing solution according to which no pre-designed complete drilling pattern is needed. Instead the drilling pattern may be
5 generated during the drilling process taking into account already realized drill holes. A supervisor 10 or the owner of the mine may set remote from the rock drilling rig 1, for example in the office 11, one or more drilling scenarios or other basic data elements 12, which are to be taken into consideration during the drilling. The set data may be input to the control unit 8 or it may be stored to
10 one or more memory devices so that it can be retrieved by the control unit 8. The operator 12 of the rock drilling rig 1 controls the drilling interactively with the control unit 8.

Figure 1 further discloses that measuring or sensing means 13 may be arranged to determine current position and direction of the tool 7. Needed
15 sensor means 13 may locate in the boom 3, or alternatively the sensing may be executed remotely from the carrier of even elsewhere. The sensing data is provided to the control unit 8, which may execute needed calculations.

In Figure 1 a face 14 of a tunnel 15 is also shown.

Figure 2 shows a drilling pattern 16 as a general concept. The drill-
20 ing pattern 16 may comprise several drill holes 17 arranged in several drill hole rows 18 to 20 within each other. Further, the drilling pattern 16 may comprise field holes 21 arranged in the section between an innermost drill hole row 20 and a cut 22. The cut 22 comprises several drill holes, which are not shown in Figure 2. The outermost drill hole row is a contour row 18, the next inner drill
25 hole row is a first aid row 19, the next inner row after that is a second aid row 20 etc. Thus, there may be one or more aid rows. In the drilling pattern 16, the drill hole 17 may be shown as a circle. Further, the direction of each drill hole 17 may be denoted by a line of direction in the drilling pattern 12. An xz projec-
30 tion of the drilling pattern 16 having one or more corresponding features as shown in Figure 2 may be shown in the display device 9 of the rock drilling rig 1.

Figure 3 shows from above the principle of drilling a round 23. In a face 14 of a tunnel 15 to be excavated, or in front of the face 14 there may be a navigation plane 24, to which the coordinate system of the drilling rig 1 is
35 attached. Starting points 25 of the drill holes 17 are placed on the navigation plane 24. The drill holes 17 extend to a bottom 26 of the round 23. Drill hole

bottoms 27 are then placed on the bottom 26. Length L of the round 23 defines a distance between the navigation plane 24 and the bottom 26 of the round 23. Drill holes locating on a contour line may be angled outwards. Thus, these drill holes have look-out angles 28.

5 As it is discussed above in this application, the apparatus may determine the forthcoming position of the bottom of a new drill hole before drilling a new drill hole. The forthcoming position of the drill hole bottom may be shown on a display device. The drilling situation may be examined on the bottom of the round, whereby the display device shows the drill hole bottoms and
10 their relative position.

Figure 4 is a simplified control block illustrating a configuration of the disclosed apparatus. As shown, the apparatus may be arranged to a rock drilling rig. The apparatus comprises at least a processing device 29 for determining current position and direction of a tool and assigning a forthcoming drill
15 hole bottom on a bottom of a round. Drill hole length 30 is input to the processing device 29 as well as sensing data 31 received from sensors detecting position and direction of a boom and the tool. A drilling scenario 32 may also be input to the processing device 29. The scenario 32 may comprise a predetermined spacing range data 33 and burden data 34 for drill holes locating in
20 different sections of a face of the round or in a drilling pattern. The scenario 32 may further comprise a predetermined cut data 35 and selectable outer profiles data 36 of the drilling pattern. The spacing ranges, burdens, cut and profile data may also be input to the processing device 29 as individual data elements or may be retrieved from one or more memory devices. The processing device
25 29 comprises a computer program product, which is executed. The computer program may be recorded on non-transitory computer-readable media including program instructions for implementing various operations executed by a computer. The operator may input data and make selections via one or more input devices 37. The input device 37 may be a touch screen, a keypad, a
30 mouse or any other suitable control device. By means of the input device 37, the operator of the rock drilling rig may inform the processing device 29 in which drill hole line and in which section of the drill hole line the tool is currently located, for example. The operator may also instruct the processing device 29 to calculate a position of a successive drill hole row, and to give any other control commands to the processing device 29. The processing device 29 may
35 execute needed calculations and may display drilling data on a display device

9. The processing device 29 may also provide the operator with predetermined drilling aid 38 and may show assisting symbols and data on the display device 9. Further, the apparatus may comprise an output device 39 for storing produced data on a memory device or transmitting the data to another control unit or mining vehicle. Let it be mentioned that the processing device 29 and a control unit 8 of the rock drilling rig 1 may be separate devices or they can be integrated.

Figure 5 discloses a drilling situation on a bottom of a round. Several drill holes are drilled and their bottoms 27 locate in a contour row 18. Inside the contour row 18 is a first aid row 19. The drill hole rows comprise sections such as wall sections W, roof sections R and bottom sections B. Different charge classes are used in different sections, and based on that, spacing E1 and E2 between the drill hole bottoms 27 may be different in different sections. Further, burdens V1 and V2 may be differ in different sections, whereby distance between the successive drill hole rows varies. These basic principles facilitate understanding of the embodiments disclosed in this application.

Figure 6 discloses a display device 9 view on a bottom of a round. On the display device 9 a symbol 40 of a forthcoming drill hole bottom may be shown. Around the symbol 40 there may be a first circle 41 indicating minimum drill hole spacing and a second circle 42 indicating maximum drill hole spacing. Between the circles is an allowable spacing. At the currently shown position the new drill hole bottom will be formed at an allowable spacing from the realized drill hole bottom 27.

Figure 6 further discloses that the apparatus may indicate on the display device whether the realized drill hole bottoms 27 are according to the spacing range or not. A first visual attention marking 44 may visualize that the spacing E is too short. A second attention marking 45 may visualize that the spacing E is too long, and a third attention marking 46 may visualize that the spacing is proper.

Figure 7 discloses principles for defining position of a next drill hole line. At first two or more drill holes are drilled in a contour row 18. The drilling may be executed using one or more drilling units. In the shown situation there are two drilling units 4a and 4b, which are operating in different sections of the drill hole row. As can be noted, around realized drill hole bottoms 27 burden circles 47 may be shown after burdens are determined for the drill holes according to principles disclosed in this application. Thereafter a burden line 48

may be defined and shown on a display device. The next drill hole row will be placed according to the defined burden line 48.

Figure 8 shows how a burden can be determined by means of interpolation. When the realized spacing E between realized drill hole bottoms is between the predetermined spacing range, then a burden V can be interpolated between given minimum and maximum burdens. Arrows 49 and 50 illustrates the interpolation.

The computer program disclosed in this patent application may be recorded in non-transitory computer-readable media including program instructions to implement various operations embodied by a computer. The media may also include, alone or in combination with the program instructions, data files, data structures, and the like. Examples of computer-readable media or computer-readable storage devices include magnetic media such as hard disks, and optical media such as CR-ROM disks and DVDs, flash memory means, and hardware devices that are configured to store software. The computer-readable media may be a plurality of computer-readable storage devices in a distributed network, so that the program instructions are stored in a plurality of computer-readable storage devices and executed in a distributed fashion. The program instructions may be executed by one or more processors or processing devices.

The drawings and the related description are only intended to illustrate the idea of the invention. In its details, the invention may vary within the scope of the claims.

Claims

1. An apparatus comprising at least one data processing device (29) for assigning positions of drill holes for a round (23) to be drilled by a rock drilling rig (1),

5 the apparatus being configured to:

receive data on drill holes (17) to be drilled for the round (23); and
receive actual position and direction data on a tool (7) connected to
a rock drilling unit (4) of the rock drilling rig (1);

characterized in that the apparatus is further configured to:

10 determine the actual position of at least one realized drill hole bottom (27) by detecting the position of the tool (7) on the bottom of the round (26) during the drilling process;

determine for a new, currently active drill hole the forthcoming position of the drill hole bottom before drilling the new drill hole, wherein the determining is based on the current location and direction of the tool (7) and on the
15 predetermined length of the new drill hole; and

indicate the determined position of the forthcoming drill hole bottom of the new drill hole in relation to the realized drill hole bottoms (27) on the bottom of the round (26).

20

2. The apparatus as claimed in claim 1, characterized in that
the apparatus comprises at least one display device (9); and

the apparatus is configured to indicate the determined position of
the new forthcoming drill hole bottom on the display device (9) and in relation
25 to the realized drill hole bottoms (27).

3. The apparatus as claimed in claim 2, characterized in that
the apparatus is configured to:

30 employ a predetermined spacing range for the new drill hole bottom; and

indicate on the display device (9) allowable spacing according to the
spacing range and in relation to the closest realized drill hole bottom (27).

4. The apparatus as claimed in claim 2 or 3, characterized in
35 that the apparatus is configured to:

indicate the forthcoming drill hole bottom as a symbol (40) on the display device (9).

5 5. The apparatus as claimed in claim 4, characterized in that the apparatus is configured to:

indicate a minimum drill hole spacing as a first circle (41) around the symbol (40), and

10 indicate a maximum drill hole spacing as a second circle (42) around the first circle, whereby between the first and second circle there remains an acceptable tolerance for the drill hole spacing.

6. The apparatus as claimed in claims 2 - 5, characterized in that the apparatus is configured to:

15 indicate on the display device (9) the realized drill hole spacing by means of visual attention markings.

7. The apparatus as claimed in claim 6, characterized in that the apparatus is configured to:

20 indicate on the display device at least one of the following visual attention markings: a first attention marking (44) indicating too short a drill hole spacing relative to the determined minimum drill hole spacing; a second attention marking (45) indicating too long a drill hole spacing relative to the determined maximum drill hole spacing; a third attention marking (46) indicating a drill hole spacing being according to the set spacing range.

25

8. The apparatus as claimed in claims 3 - 7, characterized in that the apparatus is configured to:

30 observe exceeding of the allowed maximum spacing; and propose an additional drill hole to be placed next to the previous realized drill hole.

9. The apparatus as claimed in claims 3 - 8, characterized in that the apparatus is configured to:

35 observe if the realized spacing is shorter than the allowed minimum spacing; and

produce a data element comprising identification of the observed drill hole and information on the observed drill hole spacing.

5 10. The apparatus as claimed in claim 9, characterized in that
the data element is a charging data element comprising information for decreasing the charging of the observed drill hole.

10 11. The apparatus as claimed in any one of the preceding claims, characterized in that
the apparatus is configured to show the drill hole bottoms in a display device as a drill hole pattern (16), wherein
the first drill hole row is an outermost contour row (18) of the round;
the second drill hole row is an outermost aid row (19) of the round
15 and is located inside the contour row (18); and
the contour row (18) and aid row (19) each comprise wall sections (W), bottom sections (B) and roof sections (R);
and wherein individual spacing ranges are determined for the wall, bottom and roof sections of each drill hole row.

20 12. The apparatus as claimed in any one of the preceding claims, characterized in that the apparatus is configured to:
employ at least one predetermined drilling scenario (32) comprising at least one allowable spacing range (33) of the drill hole bottoms (27) and a predetermined minimum burden and a maximum burden (34) calculated for a minimum spacing and a maximum spacing of the at least one spacing range;
25 define the realized spacing between the realized drill hole bottoms (27); and
determine burdens (V) for the realized drill hole (27) bottoms according to the realized spacing by means of interpolation between the minimum burden and the maximum burden.

30 13. The apparatus as claimed in claims 11 and 12, characterized in that the apparatus is configured to:
35 define the realized spacing between the realized drill hole bottoms (27) in the first drill hole row (18); and

assign the second drill hole row (19) at a distance from the first drill hole row (18) and according to the determined burdens (V) of the realized drill hole bottoms (27) in the first drill hole row (18).

5 14. The apparatus as claimed in any one of the preceding claims, characterized in that the apparatus is configured to:

receive a control command to initiate an automatic mode for drilling the new drill hole;

10 execute, in the automatic mode, positioning of a tool at the starting point of the new drill hole; and

execute, in the automatic mode, drilling of the new drill hole.

15 15. The apparatus as claimed in any one of the preceding claims, characterized in that the apparatus is configured to:

15 determine a cracking area for at least one realized drill hole bottom; display the cracking area in the display device; and

receive a predetermined greatest allowable cracking zone and display the determined cracking area in relation to the allowable cracking zone in the display device.

20

16. The apparatus as claimed in any one of the preceding claims, characterized in that the apparatus is configured to:

determine look-out angles (28) for drill holes locating in an outermost drill hole row (18) of the round (23).

25

17. The apparatus as claimed in any one of the preceding claims, characterized in that

30 the apparatus is arranged in the rock drilling rig (1) comprising a carrier (2), at least one drilling boom (3), at least one rock drilling unit (4), a drilling tool (7) connected to the drilling unit (4), and at least one control unit (8).

18. The apparatus as claimed in claim 17, characterized in that

35 the data processing unit (29) of the apparatus is integrated in the control unit (8) of the rock drilling rig (1).

19. A method for drilling a round, the method comprising:
using in the drilling a rock drilling rig (1) comprising at least one rock
drilling unit (4) and a tool (7) connected to the drilling unit (4);
5 drilling several drill holes (17) for the round (23); and
determining the actual position and direction of the tool (7);
c h a r a c t e r i z e d by
determining the forthcoming position of the bottom of a new drill
hole_before drilling the new drill hole, wherein the position of the new drill hole
10 hole_bottom is determined on the basis of the current location and direction of the
tool (7) and on the planned length of the new drill hole.

20. The method according to claim 19, c h a r a c t e r i z e d by
initiating the drilling of the round without a predetermined drilling
15 pattern defining the positions of the drill holes to be drilled.

21. The method according to claim 19 or 20, c h a r a c t e r i z e d
by
determining the actual position of at least one realized drill hole bot-
20 torn by detecting the position of the tool (7) on the bottom (26) of the round
(23) during drilling;
placing the new drill hole next to the realized drill hole; and
indicating the position of the forthcoming drill hole bottom of the new
drill hole in relation to the at least one realized drill hole bottom (27) on the bot-
25 torn of the round.

22. The method according to any one of the preceding claims 19 -
21, c h a r a c t e r i z e d by
placing the new drill hole according to at least one predetermined al-
30 lowable spacing range defining a minimum drill hole spacing and a maximum
drill hole spacing between the drill hole bottoms.

23. The method according to claim 22, c h a r a c t e r i z e d by
placing new drill hole bottoms in a drill hole row;
35 drilling at least two drill holes of the drill hole row;

determining the spacing between the realized drill hole bottoms in the drill hole row;

employing predetermined minimum and maximum burdens corresponding to the predetermined minimum drill hole spacing and maximum drill
5 hole spacing;

determining burdens for the realized drill hole bottoms according to the determined spacing by means of interpolation between the minimum burden and the maximum burden; and

10 defining the position of a next drill hole row according to the determined burdens of the realized drill hole bottoms located in the previous drill hole row.

24. A computer program product,
c h a r a c t e r i z e d in that

15 the computer program product comprises program code means configured to execute the steps and procedures disclosed in the independent claims when being run on a computer or a data processing device.

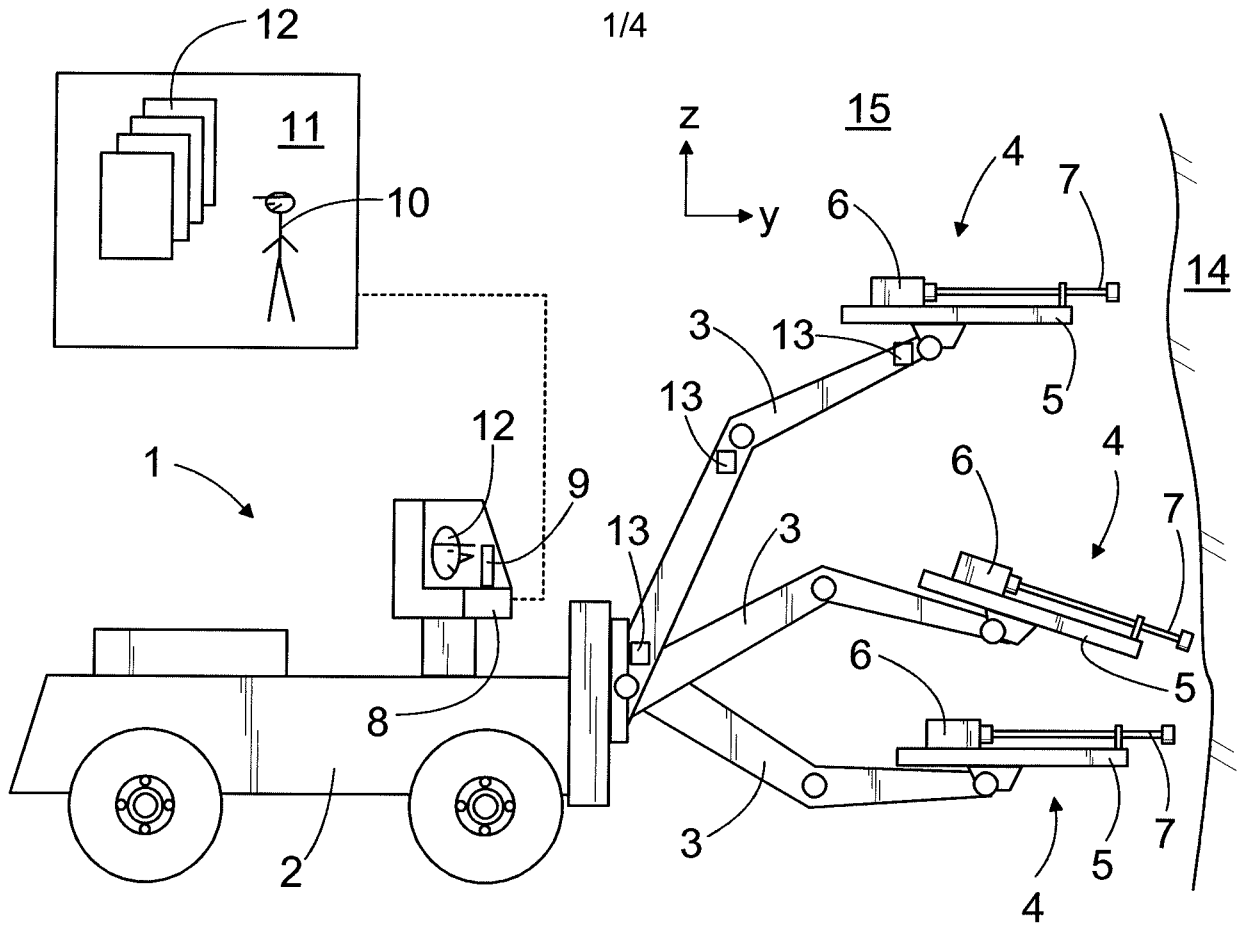

FIG. 1

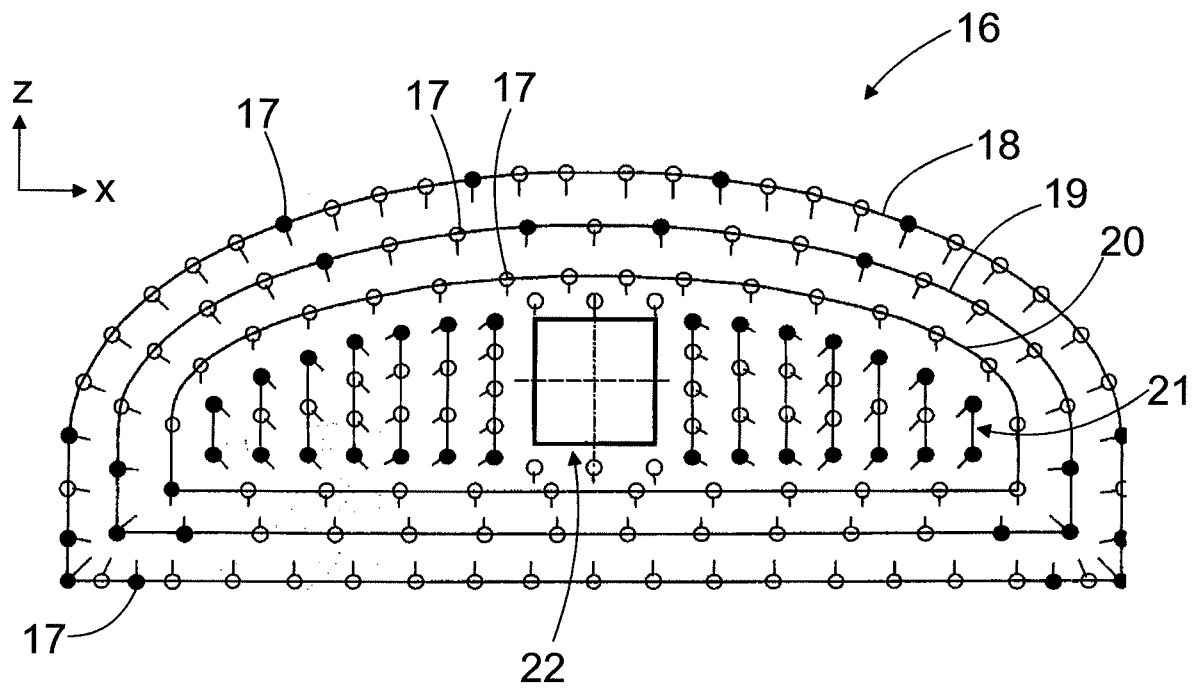

FIG. 2

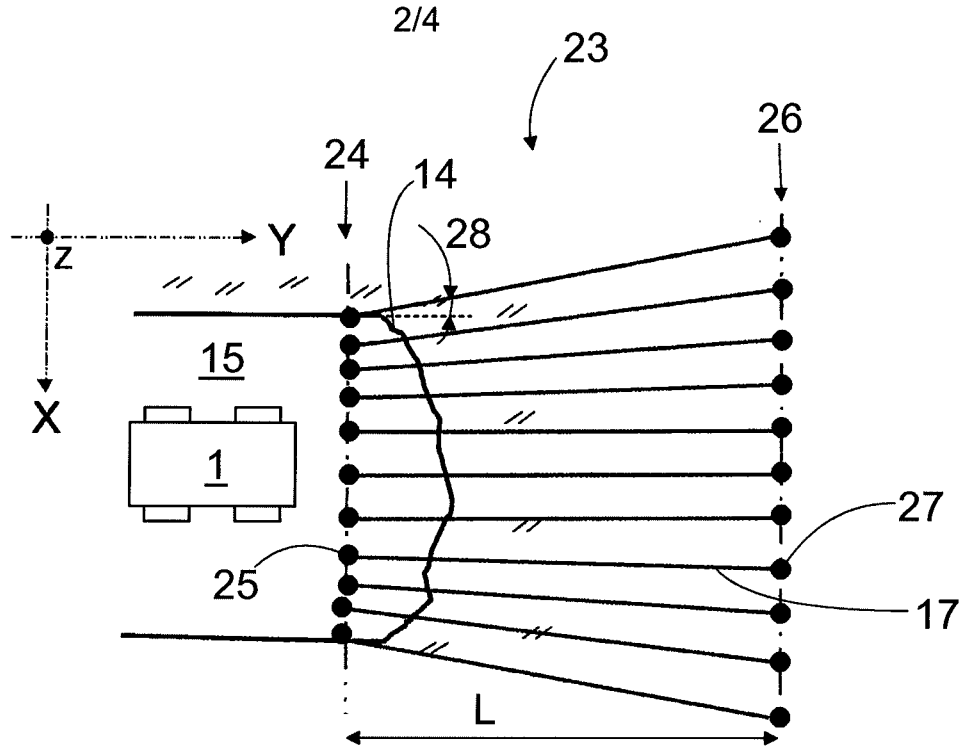

FIG. 3

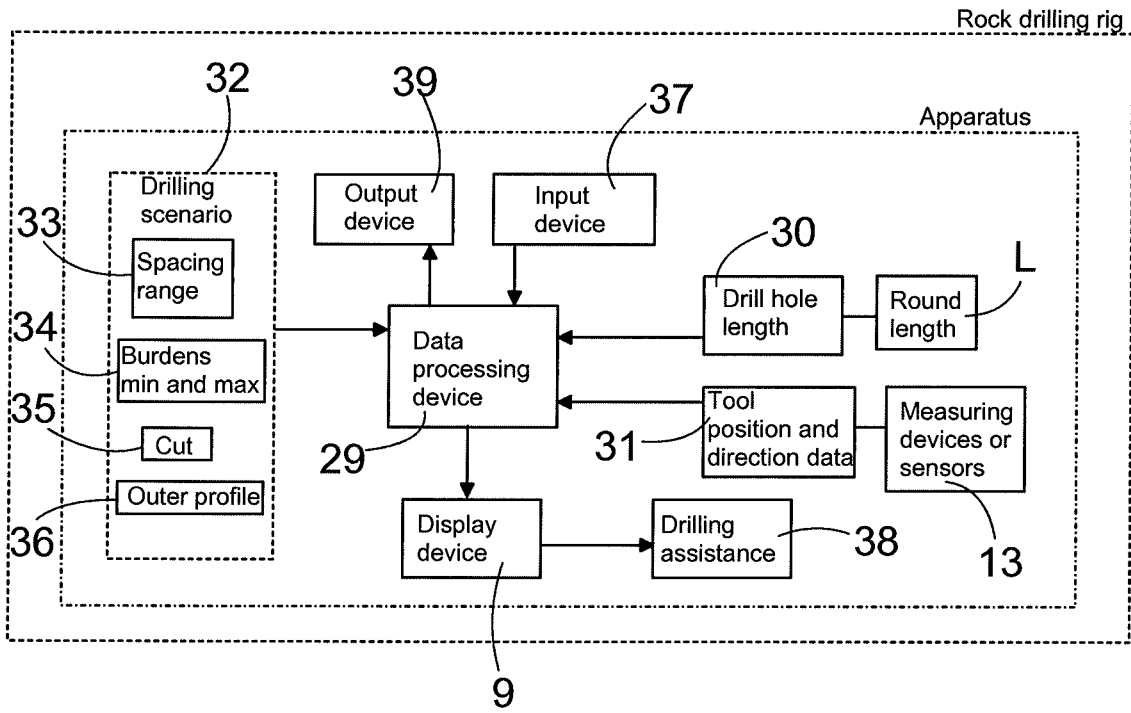

FIG. 4

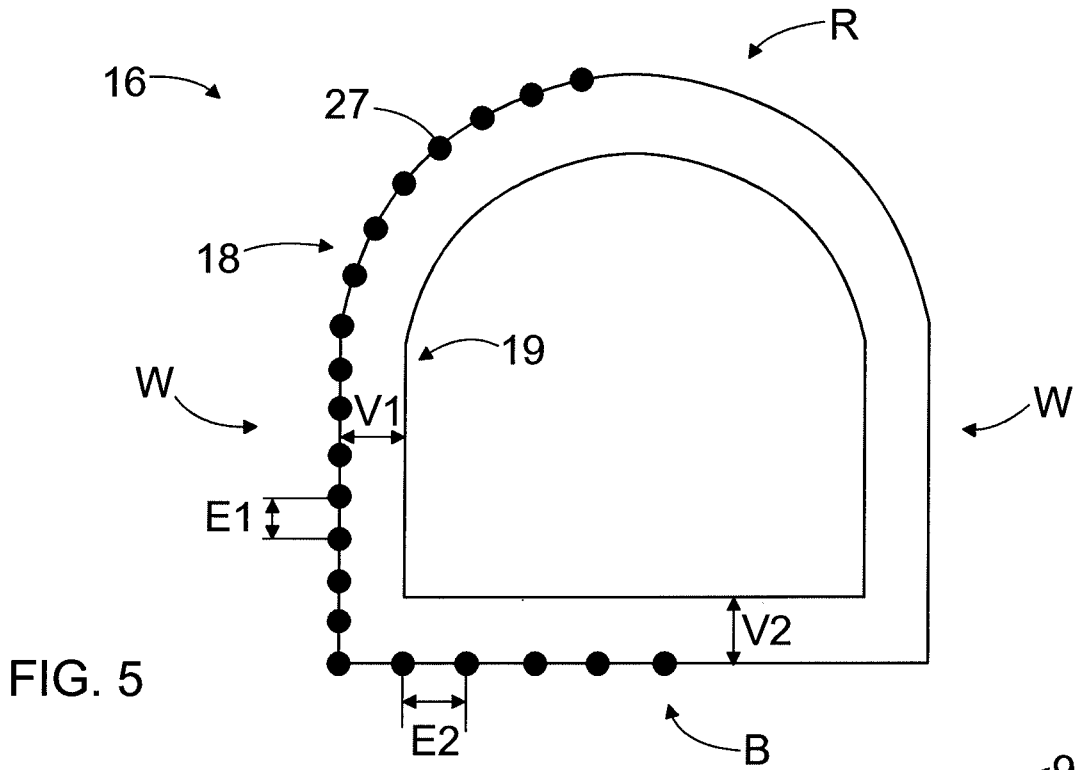

FIG. 5

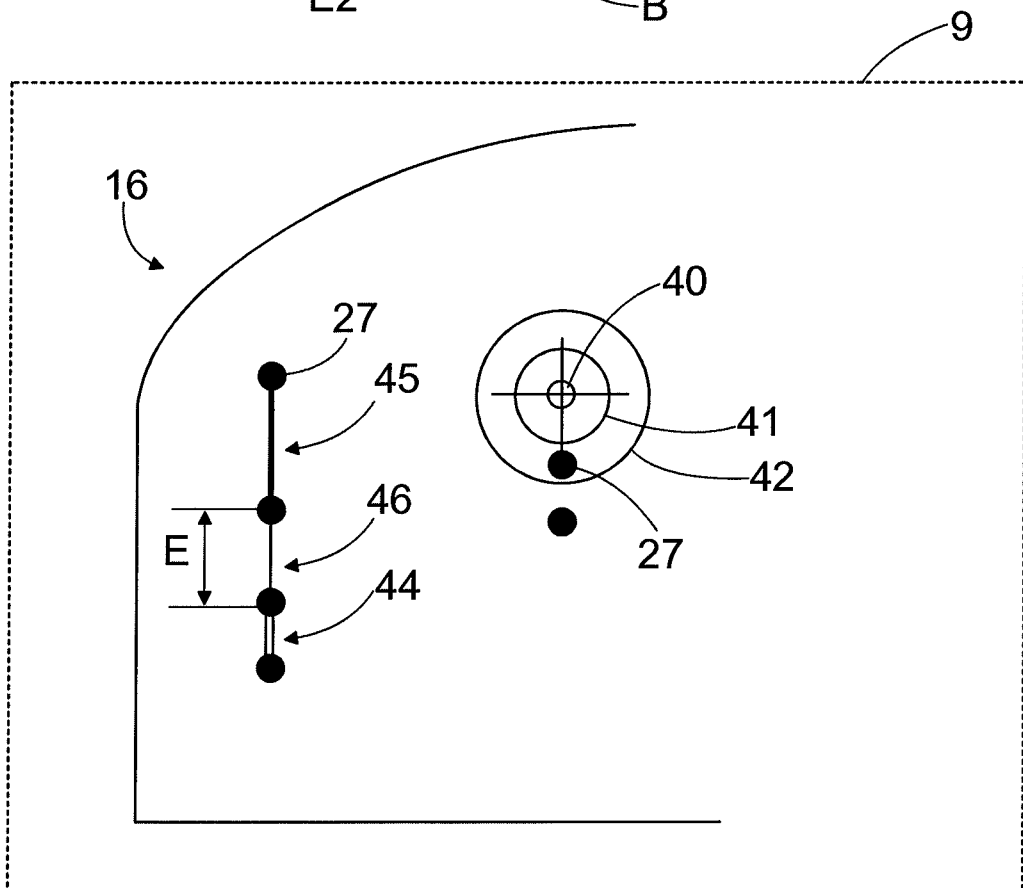
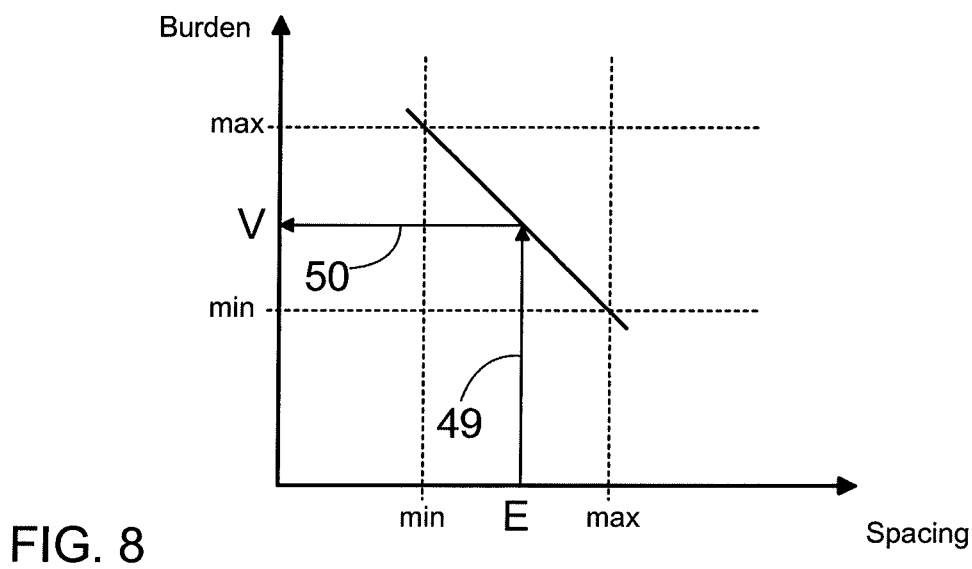
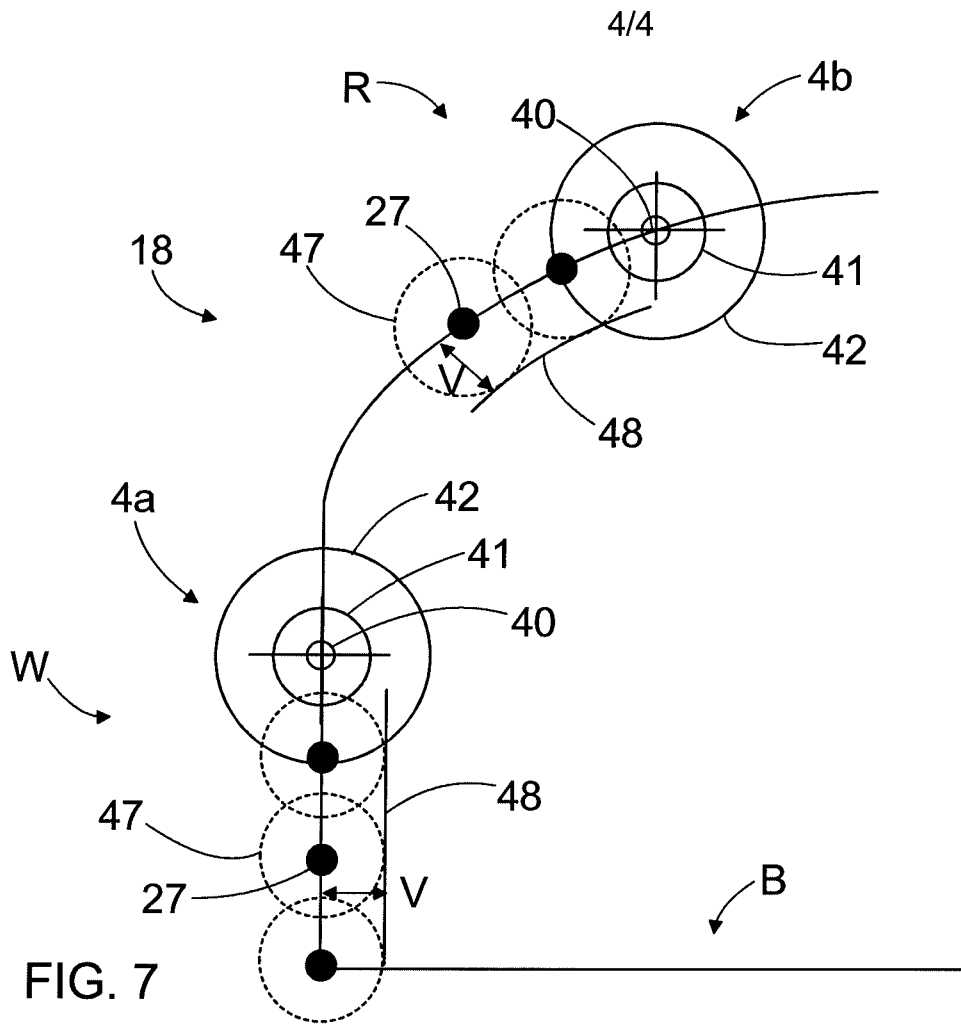

FIG. 6



INTERNATIONAL SEARCH REPORT

International application No
PCT/EP2013/059613

A. CLASSIFICATION OF SUBJECT MATTER
INV. E21D9/00 E21B7/02 F42D3/04
ADD.
According to International Patent Classification (IPC) or to both national classification and IPC

B. FIELDS SEARCHED
Minimum documentation searched (classification system followed by classification symbols)
E21D E21B F42D
Documentation searched other than minimum documentation to the extent that such documents are included in the fields searched
Electronic data base consulted during the international search (name of data base and, where practicable, search terms used)
EPO-Internal , WPI Data

C. DOCUMENTS CONSIDERED TO BE RELEVANT		
Category*	Citation of document, with indication, where appropriate, of the relevant passages	Relevant to claim No.
A	WO 2008/129128 A1 (SANDVIK MINING & CONSTR OY [FI]; SAELENI EMI TOMMI [FI]) 30 October 2008 (2008-10-30) claims 1,17 figures 1,2	1-24
A	WO 2008/078001 A1 (SANDVIK MINING & CONSTR OY [FI]; SAELENI EMI TOMMI [FI] ; EILO ERKKI [FI] 3 July 2008 (2008-07-03) paragraphs [0024], [0039], [0047], [0048] figures 1-5,9,10	1-24
A	WO 2009/037381 A1 (SANDVIK MINING & CONSTR OY [FI]; SAELENI EMI TOMMI [FI] ; EILO ERKKI [FI] 26 March 2009 (2009-03-26) claim 1	1-24
	----- -/- .	

Further documents are listed in the continuation of Box C.

See patent family annex.

* Special categories of cited documents :

"A" document defining the general state of the art which is not considered to be of particular relevance
"E" earlier application or patent but published on or after the international filing date
"L" document which may throw doubts on priority claim(s) or which is cited to establish the publication date of another citation or other special reason (as specified)
"O" document referring to an oral disclosure, use, exhibition or other means
"P" document published prior to the international filing date but later than the priority date claimed

"T" later document published after the international filing date or priority date and not in conflict with the application but cited to understand the principle or theory underlying the invention

"X" document of particular relevance; the claimed invention cannot be considered novel or cannot be considered to involve an inventive step when the document is taken alone

"Y" document of particular relevance; the claimed invention cannot be considered to involve an inventive step when the document is combined with one or more other such documents, such combination being obvious to a person skilled in the art

"&" document member of the same patent family

Date of the actual completion of the international search 3 January 2014	Date of mailing of the international search report 14/01/2014
Name and mailing address of the ISA/ European Patent Office, P.B. 5818 Patentlaan 2 NL - 2280 HV Rijswijk Tel. (+31-70) 340-2040, Fax: (+31-70) 340-3016	Authorized officer Schouten, Adri

INTERNATIONAL SEARCH REPORT

International application No
PCT/EP2013/059613

C(Continuation). DOCUMENTS CONSIDERED TO BE RELEVANT		
Category*	Citation of document, with indication, where appropriate, of the relevant passages	Relevant to claim No.
A	wo 2008/078002 AI (SANDVIK MINING & CONSTR OY [FI] ; KESKINEN MARTTI [FI]) 3 July 2008 (2008-07-03) claim 1	1-24
A	----- wo 98/57034 AI (TAMROCK OY [FI] ; KOIVUNEN PERTTI [FI] ; SANERMA SIMO [FI] ; EI LO ERKKI []) 17 December 1998 (1998-12-17) claim 1 figures 1-3	1-24
A	----- US 4 230 189 A (MASHIMO TORU) 28 October 1980 (1980-10-28) claim 1 figure 4 -----	1-24

INTERNATIONAL SEARCH REPORT

Information on patent family members

International application No

PCT/EP2013/059613

Patent document cited in search report	Publication date	Patent family member(s)	Publication date
wo 2008129128	AI	30-10-2008	AU 2008240564 AI 30-10-2008
			CA 2684423 AI 30-10-2008
			CN 101663464 A 03-03-2010
			EP 2137377 AI 30-12-2009
			FI 20075279 A 21-10-2008
			JP 5037678 B2 03-10-2012
			JP 2010525193 A 22-07-2010
			US 2010086359 AI 08-04-2010
			wo 2008129128 AI 30-10-2008
			ZA 200906419 A 26-05-2010
			wo 2008078001
CA 2670750 AI 03-07-2008			
CN 101568697 A 28-10-2009			
EP 2094942 AI 02-09-2009			
FI 20065854 A 23-06-2008			
JP 5043126 B2 10-10-2012			
JP 2010513757 A 30-04-2010			
RU 2009128236 A 27-01-2011			
US 2010078215 AI 01-04-2010			
US 2013151207 AI 13-06-2013			
wo 2008078001 AI 03-07-2008			
ZA 200903673 A 28-04-2010			
wo 2009037381	AI	26-03-2009	AU 2008300440 AI 26-03-2009
			CA 2698692 AI 26-03-2009
			CN 101802346 A 11-08-2010
			EP 2188491 AI 26-05-2010
			FI 20075661 A 22-03-2009
			JP 5260661 B2 14-08-2013
			JP 2010539363 A 16-12-2010
			RU 2010115787 A 27-10-2011
			US 2010286965 AI 11-11-2010
			wo 2009037381 AI 26-03-2009
			wo 2008078002
CA 2670078 AI 03-07-2008			
EP 2094943 AI 02-09-2009			
FI 20075118 A 23-06-2008			
JP 5167269 B2 21-03-2013			
JP 2010513758 A 30-04-2010			
US 2010044107 AI 25-02-2010			
wo 2008078002 AI 03-07-2008			
wo 9857034	AI	17-12-1998	AT 254237 T 15-11-2003
			AU 747378 B2 16-05-2002
			AU 7534198 A 30-12-1998
			CA 2293746 AI 17-12-1998
			DE 69819746 D1 18-12-2003
			DE 69819746 T2 30-09-2004
			EP 1009912 AI 21-06-2000
			FI 972447 A 08-01-1999
			JP 3904242 B2 11-04-2007
			JP 2002503301 A 29-01-2002
			NO 996037 A 08-12-1999
			US 6293355 B1 25-09-2001
			wo 9857034 AI 17-12-1998
			ZA 9804719 A 04-01-1999

INTERNATIONAL SEARCH REPORT

Information on patent family members

International application No

PCT/EP2013/059613

Patent document cited in search report	Publication date	Patent family member(s)	Publication date	
US 4230189	A	28-10-1980	JP S5415403 A	05-02-1979
			JP S5751517 B2	02-11-1982
			US 4230189 A	28-10-1980