



## INTERNATIONAL APPLICATION PUBLISHED UNDER THE PATENT COOPERATION TREATY (PCT)

<b>(51) International Patent Classification <sup>7</sup> :</b>  <b>A61F 2/06</b>	<b>A1</b>	<b>(11) International Publication Number:</b> <b>WO 00/45741</b>  <b>(43) International Publication Date:</b> 10 August 2000 (10.08.00)
<b>(21) International Application Number:</b> PCT/US00/02884 <b>(22) International Filing Date:</b> 2 February 2000 (02.02.00)  <b>(30) Priority Data:</b> 60/118,269                      2 February 1999 (02.02.99)      US 09/388,496                      2 September 1999 (02.09.99)      US  <b>(71) Applicant:</b> IMPRA, INC. [US/US]; 1625 West 3rd Street, P.O. Box 1740, Tempe, AZ 85280-1740 (US).  <b>(72) Inventors:</b> LAYNE, Richard; 1717 Woodland Avenue #314, E. Palo Alto, CA 94308 (US). CUNDY, Sandra; 1648 South Ash, Mesa, AZ 85202 (US). BEBB, Debra; 2308 West Osage Avenue, Mesa, AZ 85202 (US).  <b>(74) Agents:</b> KIRCHANSKI, Stefan, J. et al.; Graham & James LLP, 14th Floor, 801 South Figueroa Street, Los Angeles, CA 90017-5554 (US).		<b>(81) Designated States:</b> CA, JP, MX, European patent (AT, BE, CH, CY, DE, DK, ES, FI, FR, GB, GR, IE, IT, LU, MC, NL, PT, SE).  <b>Published</b> <i>With international search report.</i> <i>Before the expiration of the time limit for amending the claims and to be republished in the event of the receipt of amendments.</i>
<b>(54) Title:</b> PARTIAL ENCAPSULATION OF STENTS  <div style="text-align: center;"> </div> <b>(57) Abstract</b>  <p>Partially encapsulated stents are made using gaps cut into ePTFE covering material. Ring stents are placed over an inner ePTFE tube (e.g., supported on a mandrel) and are covered by a "lacey" graft sleeve, which is constructed by cutting apertures into an ePTFE tube so that a series of circumferential and longitudinal strips is created. This "lacey" sleeve is then laminated to the inner ePTFE tube to capture the stents. By selecting the size and position of the apertures in the ePTFE covering, it is possible to leave critical parts of the stent unencapsulated to facilitate flexibility and expansion. Alternatively, the gaps can consist of slits cut into the ePTFE covering material. These slits can be cut in any direction including longitudinally, radially, or diagonally. In addition, the slits can be spaced at varying intervals around the covering material to maximize flexibility and expandability. Although a single stent can be used, these approaches lend themselves to use of a plurality of individual ring stents spaced apart along the inner ePTFE tube.</p>		

**FOR THE PURPOSES OF INFORMATION ONLY**

Codes used to identify States party to the PCT on the front pages of pamphlets publishing international applications under the PCT.

AL	Albania	ES	Spain	LS	Lesotho	SI	Slovenia
AM	Armenia	FI	Finland	LT	Lithuania	SK	Slovakia
AT	Austria	FR	France	LU	Luxembourg	SN	Senegal
AU	Australia	GA	Gabon	LV	Latvia	SZ	Swaziland
AZ	Azerbaijan	GB	United Kingdom	MC	Monaco	TD	Chad
BA	Bosnia and Herzegovina	GE	Georgia	MD	Republic of Moldova	TG	Togo
BB	Barbados	GH	Ghana	MG	Madagascar	TJ	Tajikistan
BE	Belgium	GN	Guinea	MK	The former Yugoslav Republic of Macedonia	TM	Turkmenistan
BF	Burkina Faso	GR	Greece	ML	Mali	TR	Turkey
BG	Bulgaria	HU	Hungary	MN	Mongolia	TT	Trinidad and Tobago
BJ	Benin	IE	Ireland	MR	Mauritania	UA	Ukraine
BR	Brazil	IL	Israel	MW	Malawi	UG	Uganda
BY	Belarus	IS	Iceland	MX	Mexico	US	United States of America
CA	Canada	IT	Italy	NE	Niger	UZ	Uzbekistan
CF	Central African Republic	JP	Japan	NL	Netherlands	VN	Viet Nam
CG	Congo	KE	Kenya	NO	Norway	YU	Yugoslavia
CH	Switzerland	KG	Kyrgyzstan	NZ	New Zealand	ZW	Zimbabwe
CI	Côte d'Ivoire	KP	Democratic People's Republic of Korea	PL	Poland		
CM	Cameroon	KR	Republic of Korea	PT	Portugal		
CN	China	KZ	Kazakstan	RO	Romania		
CU	Cuba	LC	Saint Lucia	RU	Russian Federation		
CZ	Czech Republic	LI	Liechtenstein	SD	Sudan		
DE	Germany	LK	Sri Lanka	SE	Sweden		
DK	Denmark	LR	Liberia	SG	Singapore		
EE	Estonia						

## PARTIAL ENCAPSULATION OF STENTS

### BACKGROUND OF THE INVENTION

5           This application claims the benefit of U.S. Provisional Application No. 60/118,269, filed February 2, 1999 and U.S. Serial No. 09/388,496 filed September 2, 1999.

#### 1.     Field of the Invention

          The present invention relates generally to the field of medical devices, and  
10   more particularly, to encapsulation of stents.

#### 2.     Description of Related Art

          Stents and related endoluminal devices are currently used by medical practitioners to treat portions of the vascular system that become so narrowed that blood flow is restricted. Stents are tubular structures, usually of metal, which are  
15   radially expandable to hold a narrowed blood vessel in an open configuration. Such narrowing (stenosis) occurs, for example, as a result of the disease process known as arteriosclerosis. Angioplasty of a coronary artery to correct arteriosclerosis may stimulate excess tissue proliferation which then blocks (restenosis) the newly reopened vessel. While stents are most often used to "prop open" blood vessels,  
20   they can also be used to reinforce collapsed or narrowed tubular structures in the respiratory system, the reproductive system, biliary ducts or any other tubular body structure. However, stents are generally mesh-like so that endothelial and other cells can grow through the openings resulting in restenosis of the vessel.

          Polytetrafluoroethylene (PTFE) has proven unusually advantageous as a  
25   material from which to fabricate blood vessel grafts or prostheses used to replace damaged or diseased vessels. This is partially because PTFE is extremely biocompatible causing little or no immunogenic reaction when placed within the human body. This is also because in its preferred form, *expanded* PTFE (ePTFE), the material is light and porous and is potentially colonized by living cells becoming  
30   a permanent part of the body. The process of making ePTFE of vascular graft grade is well known to one of ordinary skill in the art. Suffice it to say that the critical step in this process is the *expansion* of PTFE into ePTFE following extrusion from a

paste of crystalline PTFE particles. Expansion represents a controlled longitudinal stretching in which the PTFE is stretched up to several hundred percent of its original length. During the expansion process fibrils of PTFE are drawn out of aggregated PTFE particle (nodes), thereby creating a porous structure.

5           If stents could be enclosed in ePTFE, cellular infiltration could be limited, hopefully preventing or limiting restenosis. Early attempts to produce a stent enshrouded with ePTFE focused around use of adhesives or physical attachment such as suturing. However, such methods are far from ideal, and suturing, in particular, is very labor intensive. More recently, methods have been developed for  
10   encapsulating a stent between two tubular ePTFE members whereby the ePTFE of one-member contacts and bonds to the ePTFE of the other member through the openings in the stent. However, such a monolithically encapsulated stent tends to be rather inflexible. In particular, radial expansion of the stent may stress and tear the ePTFE. There is a continuing need for a stent that is encapsulated to prevent cellular  
15   intrusion and to provide a smooth inner surface blood flow and yet still capable of expansion without tearing or delaminating and is relatively more flexible.

#### SUMMARY OF THE INVENTION

The present invention is directed to encapsulated stents wherein flexibility of the stent is retained, despite encapsulation.

20           It is an object of this invention to provide a stent device that has improved flexibility, yet maintains its shape upon expansion.

It is also an object of this invention to provide a stent encapsulated to prevent cellular infiltration wherein portions of the stent can move during radial expansion without stressing or tearing the encapsulating material.

25           These and additional objects are accomplished by an encapsulation process that leaves portions of the stent free to move during expansion without damaging the ePTFE covering. The most basic form of this invention is produced by placing a stent over an inner ePTFE member (e.g., supported on a mandrel) and then covering the outer surface of the stent with an outer ePTFE tube into which slits have been  
30   cut. The outer ePTFE tube is then laminated to the inner ePTFE through openings in the stent structure to capture the stent. By selecting the size and location of the slits it is possible to leave critical parts of the stent unencapsulated to facilitate flexibility

and expansion. Not only does the slit prevent capture of the underlying PTFE, it forms a focal point for the PTFE to flex. A more complex form of the process is to place over the stent an ePTFE sleeve into which apertures have been cut. This “lacey” outer sleeve leaves portions of the stent exposed for increased flexibility and for movement of the stent portions during expansion without damaging the ePTFE. Although a single stent can be used, these approaches lend themselves to use of a plurality of individual ring stents spaced apart along an inner ePTFE tube and covered by a “lacey” ePTFE sleeve.

In the present invention, individual ring stents are partially encapsulated using the procedure outlined above. Preferably, ring stents of zigzag sinusoidal structure are placed “in phase” (e.g., peaks and valleys of one stent aligned with those of a neighboring stent) on the surface of a tubular ePTFE graft supported by a mandrel. A sleeve of ePTFE is cut using CO<sub>2</sub> laser so that openings are created, resulting in a “lacey” pattern. This “lacey” sleeve is then placed over the ring stents. The resulting structure is then subjected to heat and pressure so that regions of ePTFE become laminated or fused together where the lacey sleeve contacts the tubular graft. In addition, the ends of the stent can be completely encapsulated, by known methods, to stabilize the overall structure.

A more complete understanding of the encapsulation process will be afforded to those skilled in the art, as well as a realization of additional advantages and objects thereof, by a consideration of the following detailed description of the preferred embodiment. Reference will be made to the appended sheets of drawings which will first be described briefly.

#### BRIEF DESCRIPTION OF THE DRAWINGS

Fig. 1 is a perspective view of a tubular ePTFE member with individual ring stents arranged thereon.

Fig. 2 is a perspective view of the “lacey” sleeve of the present invention.

Fig. 3 is a perspective view of the sleeve in Fig. 2 placed over the structure of Fig. 1.

Fig. 4 is a perspective view of one configuration of the slitted sleeve of the present invention with longitudinally oriented slits.

Fig. 5 is a perspective view of a second configuration of the slitted sleeve of the present invention with circumferentially oriented slits.

Fig. 6 is a perspective view of a third configuration of the slitted sleeve as it is placed over the structure in Fig. 1.

5

#### DETAILED DESCRIPTION OF THE PREFERRED EMBODIMENT

The present invention satisfies the need for an encapsulated stent device to prevent restenosis that is flexible upon expansion and contraction so that the general structural form is retained. This is accomplished encapsulating a stent or a plurality of stent rings using an ePTFE covering into which openings have been cut.

Referring now to the drawings, in which like reference numbers represent similar or identical structures throughout, Fig. 1 illustrates an initial step in constructing the partially encapsulated stent of the present invention. A tubular ePTFE graft **20** is placed over a mandrel for the assembly of a device **10** (Fig. 3). A stent is then placed over the graft **20**. In a preferred embodiment, as shown in Fig. 1, a series of zigzag sinusoidal ring stents **30** are placed over the outer surface of the graft **20**. Alternatively, one or more stents wherein each stent comprises more than one ring or hoop (e.g., where the rings are helically connected) can be used. The ring stents **30** can be made of any material but a preferred material is metal. The zigzag ring stents **30** may be assembled "in phase" with each adjacent ring stent having peaks and valleys aligned. Alternatively, the individual stents **30** can be "out of phase" to different degrees. It will be apparent that the phase relation of adjacent stents **30** will alter the lateral flexibility as well as the longitudinal compressibility of the structure. The phase relationship can be varied along the length of the device **10**, thereby altering the physical properties in different portions of the device **10**. Having individual ring stents **30**, as opposed to a single tubular stent, provides the advantage that the periodicity, or the number and precise shape of the zigzags per ring, can readily be varied along the length of the graft to influence flexibility and stability properties of the structure. Also, spacing of the individual stents (number of stents per unit length) as well as the phase relationship of stent to stent can be varied to produce stent grafts with desired properties. By placing the ring stents **30** over the outer surface of the tubular ePTFE graft **20**, the resulting structure has an inner

(luminal) surface that is completely smooth to facilitate the flow of blood. However, there may be instances where the ring stents **30** or other tubular stents are advantageously placed in contact with the inner graft surface or on both the inner and outer surfaces, as one of ordinary skill in the art will readily appreciate.

5           Fig. 2 shows the structure of a “lacey” graft comprising a sleeve of ePTFE **40** into which apertures have been cut. This “lacey” graft **40** is placed over the ring stents **30** in the preferred embodiment. The “lacey” graft **40** is created by cutting openings **44** in a tubular ePTFE graft **42**. The openings **44** were cut into the sleeve by a CO<sub>2</sub> laser, although any other cutting technology could readily be employed.

10       The “lacey” graft **40** is slid over the ring stents **30** and the underlying tubular graft **20** to form the preferred structure **10** shown in Fig. 3. The structure **10** is then exposed to heat and pressure, such as that caused by wrapping with PTFE tape followed by heating in an oven, thereby causing the ePTFE regions of the “lacey” graft **40** to fuse or laminate to the tubular graft **20** wherever they touch each other.

15       It should be appreciated that the circumferential sections of ePTFE **46** that are placed over the ring stents **30** can encompass many different designs. As illustrated, a sleeve **42** with openings **44** cut out is one way of accomplishing the goal of flexibility and stability. The openings **44** between the rings of ePTFE **46** can be altered to control the degree of flexibility and stability desired. In the preferred

20       embodiment shown in Fig. 3, the “lacey” graft **40** forms a number of circumferential sections **46**, which are intended to cover a portion of the circumference of each ring stent **30**, leaving the ends of the zigzags uncovered. By circumferentially covering only a portion of each ring stent **30**, the maximum amount of lateral flexibility is provided.

25           However, circumferentially covering the individual ring stents **30** without any longitudinal support would result in a structure with little longitudinal strength and stability that would be prone to “telescoping”. Thus, the longitudinal sections **48** that connect the rings of ePTFE **46** are important, because the longitudinal sections **48** are completely laminated to the underlying graft **20** and act as “anti-compression” devices by resisting the shortening of the structure **10** (the double

30       thickness of ePTFE resists telescoping of the longitudinal sections **48**). The width of the circumferential sections **46** and the longitudinal sections **48** control longitudinal

strength and stability versus lateral flexibility. By adjusting these parameters, grafts can be made more or less flexible with greater or lesser anti-compression strength. In the preferred embodiment, four longitudinal sections **48** are formed and the ends of the structure **10** are completely encapsulated for greater stability. Of course, a larger number of longitudinal sections **48** could be formed. Also the longitudinal sections **48** may themselves zigzag or may be helically arranged depending on how the openings **44** are cut into the sleeve **42**. Each different structure will possess different properties. Similarly, the circumferential sections **46** can have different forms and may be undulating. There is nothing to preclude a covering with a more complex pattern where circumferential sections and longitudinal sections are difficult to discern or are even nonexistent.

A second embodiment of the present invention can be seen in Figs. 4-6. Instead of having a "lacey" graft structure, a slitted outer sleeve is used to provide partial encapsulation of the stent, the slits providing flexibility to the structure, allowing the stent to expand and retract more readily. In Fig. 4, four longitudinal slits **52** run the length of the stent, leaving 5 to 10mm of uncut sleeve at the ends. The slits are formed at 0°, 90°, 180°, and 270°, and are oriented to pass over a peak portion of each zigzag ring stent **30** (Fig. 6). Fig. 5 shows circumferential slits **62**, wherein slits are cut circumferentially around the sleeve **60** at spaced intervals, preferably to coincide with a stent ring. At each radial section, two slits are cut around the circumference at evenly spaced intervals. In a first radial section, the slits span from 0° to 90° and from 180° to 270°. Each successive radial section has a pair of slits which are offset 90° from the previous pair. Thus, a second radial section will have slits spanning from 90° to 180° and from 270° to 0°. Beside the configurations shown in Figs. 4 and 5, a number of other slit configurations are possible, including diagonal and sinusoidal as will be appreciated by one skilled in the art. As shown in Fig. 6, a sleeve **70** is placed over the ring stents **30** and the underlying tubular graft **20** to form a new structure **80**. The longitudinal slits **72**, which are cut into sleeve **70**, differ from the slits **52** shown in Fig. 4 in that they do not span the length of the structure **80** and are staggered around the circumference of the sleeve **70**. Ideally, the slits are aligned over the peaks in the zigzag ring stents **30**. Once the slits **72** are cut into the sleeve **70** using any of the known methods, the



structure 80 is exposed to heat and pressure, such as that caused by wrapping with PTFE tape and heating in an oven, thereby causing the ePTFE regions of the slitted graft 70 to fuse or laminate to the tubular graft 20. The slits 72 in the slitted outer sleeve 70 can be formed by using a CO<sub>2</sub> laser, razor blade or any other suitable technique known in the art. The slits enhance the flexibility of the encapsulated structure and allow radial expansion without tearing of the ePTFE. In addition, a plurality of slits help the expanded graft to grip onto the vessel wall. This is particularly important where an encapsulated stent graft is spanning a region of damaged or weakened vessel as in an aneurysm. Further, during the healing process tissues readily grow into the slits further anchoring the graft to the vessel wall.

An advantage that cutting slits into an ePTFE sleeve offers is that it is somewhat easier to manufacture than is the "lacey" graft. Because no material is removed the sleeve is somewhat stronger than a "lacey graft". There are a multitude of configurations possible, including cutting the slits in asymmetric fashion to achieve desired results, such as using radial, longitudinal and diagonal cuts simultaneously. Moreover, a greater number of slits can be cut into a region of the structure in which greater expansion is desired.

Although the above examples are described with the "lacey" and slitted grafts being placed over a stent which is itself placed over a tubular graft, this orientation can be readily reversed. That is, the "lacey" or slitted grafts can be placed on a mandrel; a stent or stents can be then placed over the "lacey" or slitted grafts, and a tubular graft can be then placed over the stent or stents. This results in a structure wherein part or much of the luminal surface is provided by the outer graft, resulting in superior healing as only a single layer of ePTFE would separate body tissues from the blood. Similarly, a structure with two "lacey" or slitted grafts is possible. By keeping the openings in one graft out of phase with those in the other graft a blood tight structure results. Nevertheless, a majority of the final surface area of the device would comprise a single layer separating body tissue from the circulating blood. Only the area actually occupied by the stent(s) and by overlap between the two grafts would present a barrier to cellular infiltration. Further such a structure would have a smaller profile when compressed because the overall amount of PTFE is reduced. Likewise, a combination of the "lacey" graft and slitted graft

could be employed.

Having thus described preferred embodiments of the partial encapsulation of stents, it will be apparent by those skilled in the art how certain advantages of the present invention have been achieved. It should also be appreciated that various  
5 modifications, adaptations, and alternative embodiments thereof may be made within the scope and spirit of the present invention. For example, zigzag stent rings have been illustrated, but it should be apparent that the inventive concepts described above would be equally applicable to sinusoidal and other stent designs. Moreover, the words used in this specification to describe the invention and its various  
10 embodiments are to be understood not only in the sense of their commonly defined meanings, but to include by special definition in this specification structure, material or acts beyond the scope of the commonly defined meanings. Thus, if an element can be understood in the context of this specification as including more than one meaning, then its use in a claim must be understood as being generic to all possible  
15 meanings supported by the specification and by the word itself. The definitions of the words or elements of the following claims are, therefore, defined in this specification to include not only the combination of elements which are literally set forth, but all equivalent structure, material or acts for performing substantially the same function in substantially the same way to obtain substantially the same result.  
20 The described embodiments are to be considered illustrative rather than restrictive. The invention is further defined by the following claims.

CLAIMS

1. A radially expandable reinforced vascular graft, comprising:  
a first expanded polytetrafluoroethylene layer;  
5 a radially expandable support layer comprising at least one stent,  
wherein said support layer is in contact with a surface of said  
first expanded polytetrafluoroethylene layer; and  
a second expanded polytetrafluoroethylene layer, securing said  
radially expandable support layer to said first expanded  
10 polytetrafluoroethylene layer, wherein said second expanded  
polytetrafluoroethylene layer includes a plurality of gaps.
2. The radially expandable reinforced vascular graft of Claim 1,  
wherein said gaps comprise spaced apart apertures in said second expanded  
polytetrafluoroethylene layer.
- 15 3. The radially expandable reinforced vascular graft of Claim 1,  
wherein said gaps comprise spaced apart slits in said second expanded  
polytetrafluoroethylene layer.
4. The radially expandable reinforced vascular graft of Claim 3,  
wherein said slits are oriented longitudinally.
- 20 5. The radially expandable reinforced vascular graft of Claim 3,  
wherein said slits are oriented circumferentially.
6. The radially expandable reinforced vascular graft of Claim 1,  
wherein said radially expandable support layer comprises a plurality of ring stents.
7. The radially expandable reinforced vascular graft of Claim 6,  
25 wherein each of said ring stents is formed in a zigzag pattern of alternating peaks  
and valleys.
8. The radially expandable reinforced vascular graft of Claim 7,  
wherein said zigzag ring stents are disposed with the alternating peaks and valleys of  
neighboring ring stents in phase.
- 30 9. The radially expandable reinforced vascular graft of Claim 1,  
wherein said stent is made of metal.

10. The radially expandable reinforced vascular graft of Claim 1, wherein an end region of said radially expandable reinforced vascular graft is fully encapsulated.

5 11. A radially expandable reinforced vascular graft, comprising:  
a first expanded polytetrafluoroethylene layer;  
a radially expandable support layer comprising at least one stent,  
wherein said support layer is in contact with a surface of said  
first expanded polytetrafluoroethylene layer; and  
10 a second expanded polytetrafluoroethylene layer, securing said  
radially expandable support layer to said first expanded  
polytetrafluoroethylene layer, wherein said second expanded  
polytetrafluoroethylene layer includes a plurality of spaced  
apart apertures.

12. The radially expandable reinforced vascular graft of Claim 11,  
15 wherein said radially expandable support layer comprises a plurality of ring stents.

13. The radially expandable reinforced vascular graft of Claim 12,  
wherein each of said ring stents is formed in a zigzag pattern of alternating peaks  
and valleys.

14. The radially expandable reinforced vascular graft of Claim 13,  
20 wherein said zigzag ring stents are disposed with the alternating peaks and valleys in  
phase.

15. The radially expandable reinforced vascular graft of Claim 11,  
wherein said stent is made of metal.

16. The radially expandable reinforced vascular graft of Claim 11,  
25 wherein an end of said radially expandable reinforced vascular graft is fully  
encapsulated.

17. A radially expandable reinforced vascular graft, comprising:  
a first expanded polytetrafluoroethylene layer;  
a radially expandable support layer comprising at least one stent,  
30 wherein said support layer is in contact with a surface of said  
first expanded polytetrafluoroethylene layer; and

a second expanded polytetrafluoroethylene layer, securing said radially expandable support layer to said first expanded polytetrafluoroethylene layer, wherein said second expanded polytetrafluoroethylene layer includes a plurality of slits.

5           18.     The radially expandable reinforced vascular graft of Claim 17, wherein said slits are oriented longitudinally.

          19.     The radially expandable reinforced vascular graft of Claim 17, wherein said slits are oriented circumferentially.

          20.     The radially expandable reinforced vascular graft of Claim 17,  
10    wherein said radially expandable support layer comprises a plurality of ring stents.

          21.     The radially expandable reinforced vascular graft of Claim 20, wherein each of said ring stents is formed in a zigzag pattern of alternating peaks and valleys.

          22.     The radially expandable reinforced vascular graft of Claim 21,  
15    wherein said zigzag ring stents are disposed with the alternating peaks and valleys in phase.

          23.     The radially expandable reinforced vascular graft of Claim 17, wherein said stent is made of metal.

          24.     The radially expandable reinforced vascular graft of Claim 17,  
20    wherein an end of said radially expandable reinforced vascular graft is fully encapsulated.

25. A method for making a partially encapsulated radially expandable reinforced vascular graft, comprising:

providing a first tubular expanded polytetrafluoroethylene layer of material;

5 disposing a radially expandable support layer comprising at least one stent over said tubular layer;

placing a second tubular layer of expanded polytetrafluoroethylene over said radially expandable support layer;

10 cutting a plurality of apertures into said second tubular layer, leaving a portion of said support layer exposed through the apertures; and

laminating said second tubular layer to said first tubular layer.

26. The method of Claim 25, wherein the first and second tubular layers are physically exchanged for each other.

15 27. The method of Claim 25, wherein the step of cutting occurs prior to the step of placing.

28. The method of Claim 25, further comprising the step of fully encapsulating an end of said radially expandable reinforced vascular graft.

20 29. The method of Claim 25, wherein said radially expandable support layer comprises a plurality of ring stents formed in a zigzag pattern of alternating peaks and valleys, wherein said placing step further comprises placing said peaks and valleys of successive stents in phase.

30. A method for making a partially encapsulated radially expandable reinforced vascular graft, comprising:

25 providing a first tubular expanded polytetrafluoroethylene layer of material;

disposing a radially expandable support layer comprising at least one stent over said tubular layer;

30 placing a second tubular layer of expanded polytetrafluoroethylene over said radially expandable support layer;

cutting a plurality of slits into said second tubular layer; and

laminating said second tubular layer to said first tubular layer.

31. The method of Claim 30, further comprising the step of fully encapsulating an end of said radially expandable reinforced vascular graft.

32. The method of Claim 30, wherein said radially expandable support layer comprises a plurality of ring stents formed in a zigzag pattern of  
5 alternating peaks and valleys, wherein said placing step further comprises placing said peaks and valleys of successive stents in phase.

33. The method of Claim 30, wherein the first and second tubular layers are physically exchanged for each other.

34. The method of Claim 30, wherein the step of cutting occurs  
10 prior to the step of placing.

1/2

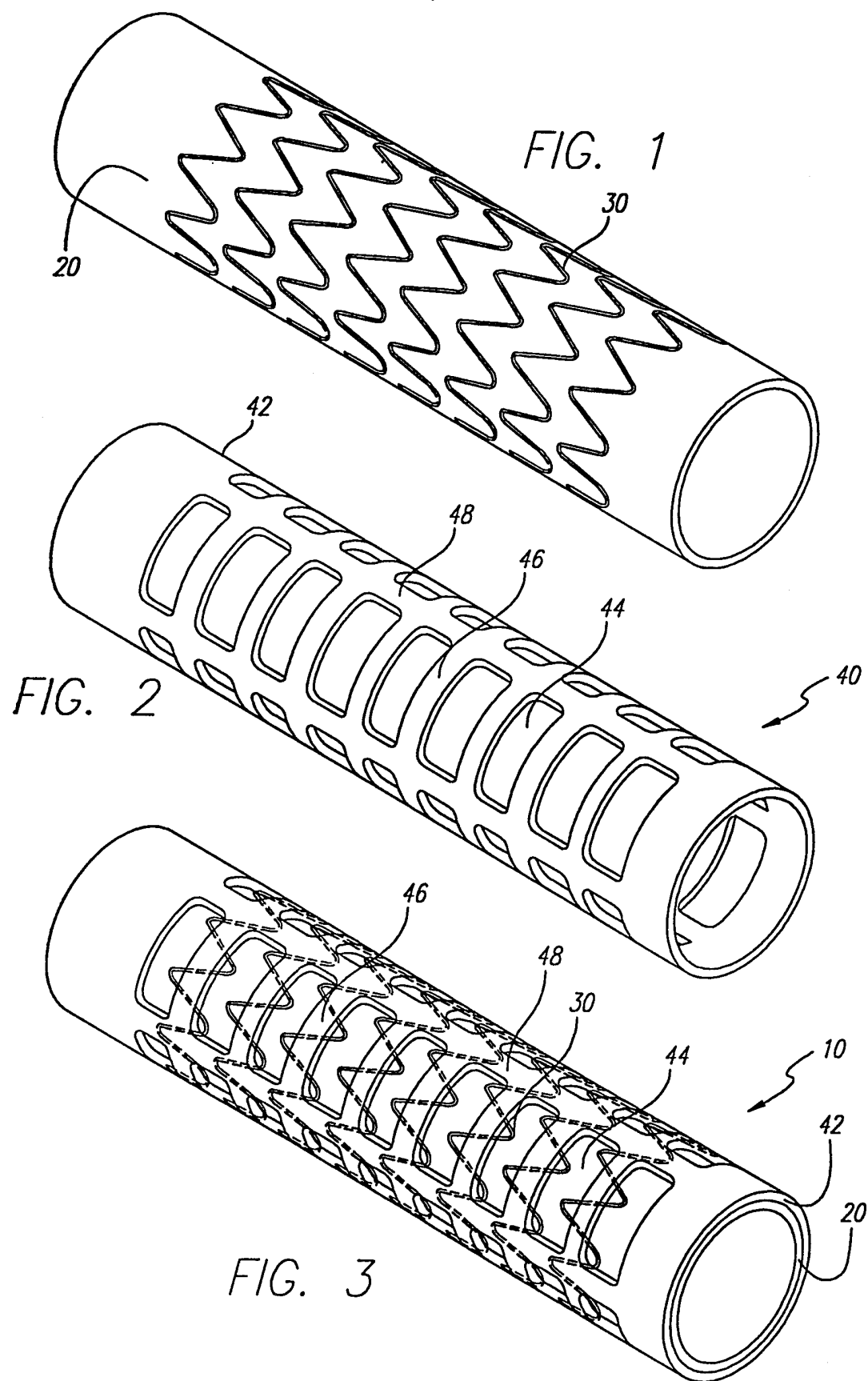



2/2

FIG. 4

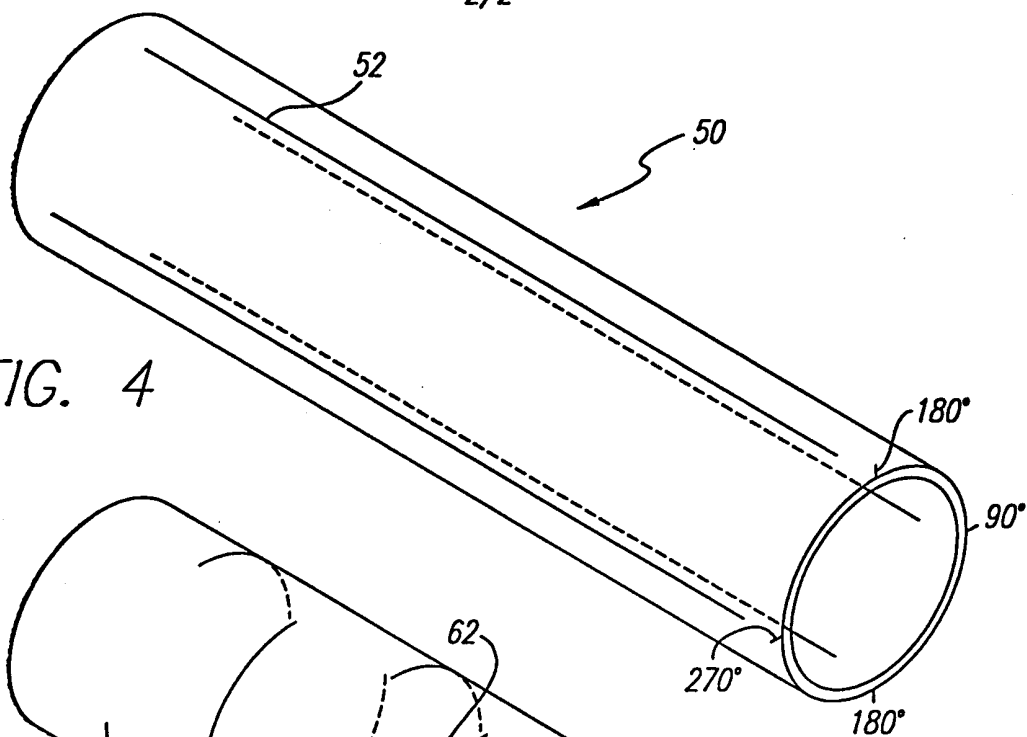

FIG. 5

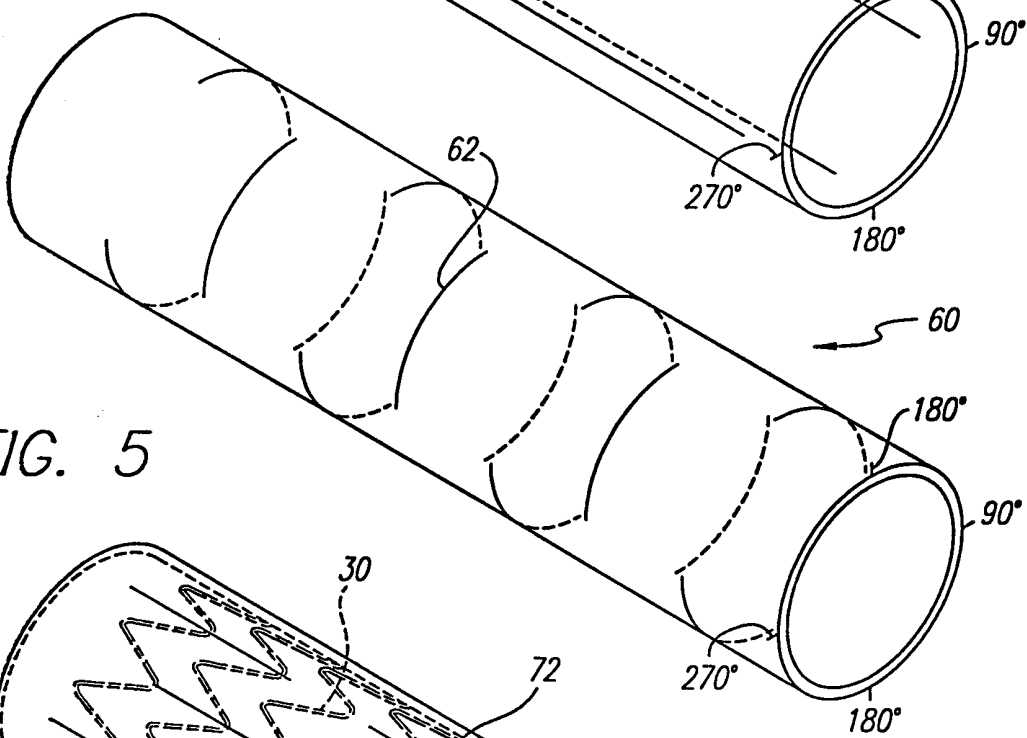
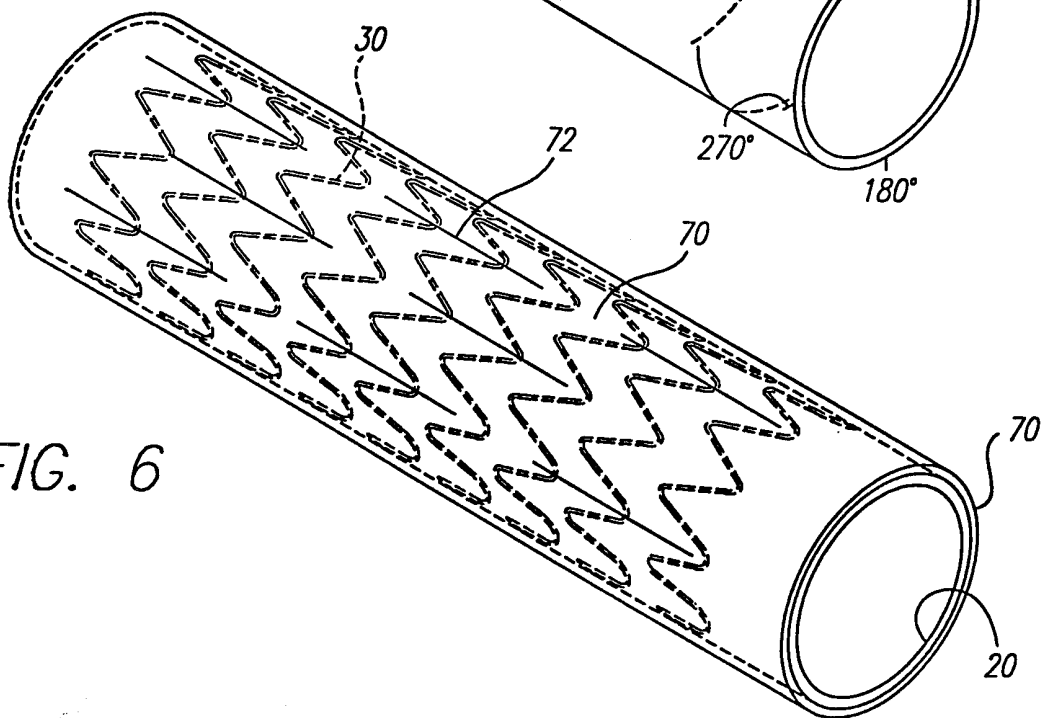

FIG. 6



# INTERNATIONAL SEARCH REPORT

Internal Application No  
PCT/US 00/02884

## A. CLASSIFICATION OF SUBJECT MATTER

IPC 7 A61F2/06

According to International Patent Classification (IPC) or to both national classification and IPC

## B. FIELDS SEARCHED

Minimum documentation searched (classification system followed by classification symbols)

IPC 7 A61F

Documentation searched other than minimum documentation to the extent that such documents are included in the fields searched

Electronic data base consulted during the international search (name of data base and, where practical, search terms used)

## C. DOCUMENTS CONSIDERED TO BE RELEVANT

Category °	Citation of document, with indication, where appropriate, of the relevant passages	Relevant to claim No.
A	WO 96 28115 A (IMPRA, INC.) 19 September 1996 (1996-09-19) the whole document -----	1, 11, 17, 25, 30

☐ Further documents are listed in the continuation of box C.

☒ Patent family members are listed in annex.

° Special categories of cited documents :

"A" document defining the general state of the art which is not considered to be of particular relevance

"E" earlier document but published on or after the international filing date

"L" document which may throw doubts on priority claim(s) or which is cited to establish the publication date of another citation or other special reason (as specified)

"O" document referring to an oral disclosure, use, exhibition or other means

"P" document published prior to the international filing date but later than the priority date claimed

"T" later document published after the international filing date or priority date and not in conflict with the application but cited to understand the principle or theory underlying the invention

"X" document of particular relevance; the claimed invention cannot be considered novel or cannot be considered to involve an inventive step when the document is taken alone

"Y" document of particular relevance; the claimed invention cannot be considered to involve an inventive step when the document is combined with one or more other such documents, such combination being obvious to a person skilled in the art.

"&" document member of the same patent family

Date of the actual completion of the international search

10 July 2000

Date of mailing of the international search report

14/07/2000

Name and mailing address of the ISA

European Patent Office, P.B. 5818 Patentlaan 2  
NL - 2280 HV Rijswijk  
Tel. (+31-70) 340-2040, Tx. 31 651 epo nl,  
Fax: (+31-70) 340-3016

Authorized officer

Smith, C

# INTERNATIONAL SEARCH REPORT

Information on patent family members

International Application No

PCT/US 00/02884

Patent document cited in search report	Publication date	Patent family member(s)	Publication date
WO 9628115 A	19-09-1996	US 5749880 A	12-05-1998
		CA 2215027 A	19-09-1996
		EP 0814729 A	07-01-1998
		JP 10510196 T	06-10-1998
		US 6004348 A	21-12-1999
		ZA 9510700 A	25-11-1996
-----			