

(19)  
(12)

(KR)  
(A)

(51) 。 Int. Cl.<sup>7</sup>  
B41J 2/14

(11)  
(43)

2003-0084685  
2003 11 01

(21) 10-2003-0025635  
(22) 2003 04 23

(30) JP-P-2002-00121156 2002 04 23 (JP)  
JP-P-2003-00114484 2003 04 18 (JP)

(71) 가 가 3 30 2

(72) 가 3 30 2 가 가

3 30 2 가 가

3 30 2 가 가

3 30 2 가 가

3 30 2 가 가

(74)

:

(54)

가 ,

do) 가 , (dhc) 가 (

, , , ,

1 1 ,

2a 2b 가 1  
, 2a , 2b .

3 1 .

4a 4b 2 , 4a , 4b ,

5 3 ,

6a 6b 5 , 6a , 6b 가 .

7a, 7b 7c 4 , 7a , 7c .

8a, 8b 8c 7a, 7b 7c 가 .

9 .

10a 10b , 10a , 10b .

11 .

12 1 (misdirection) .

< >

1 :

2 :

3 :

4 :

5 :

18 :

19 :





가

( 1 )

1 1

(2)가 (1) (1)

1) (3) (3b) (3) (3a) (3a) (2) (2) (3a) ( )

(4) (5) (5) (5)

6) ( ) (3b) (5) (2) (6) (6) ( )

(5)

(2) (4)

a (dhc) (5) (4) (do) (2) (4) (2) 가 2

(4) (2)

(4)

(4)

(4)가 (2)

(4) 2a 2b (2)

(4) (2)

(4) (4) 가 가 [ , ]

(4) (2) (4)

(4) 11-188870

(5)

(2) (5) 가 , 2b

(2) (4)

(4) (do) 11 μm (2)

12 μm (2) 27 μm (dhc) 14 μm (5) (dhh) 3 μm (3) [ (4)가 (1) ] 25 μm

$\mu s$  (2) 2 mm 가 (2) (4)가 ( ) 38 cm/ (15 inch/second) , 0.9  
 (4) (derr) (2) (4) (derr)  
 (derr) 2  $\mu m$  가 (2)  
 2  $\mu m$  가 (derr) [ (4) (do)] + (  
 x2) (2) (dhn) 2 (2) (dhh) (3a) (3a) (dhn) 2  $\mu m$  , (2) (dhh) 4  $\mu m$   
 (4) 12 (do) (2) (dhc)가 , 2a 2b 가 (2) (dhc)가 , 2a 2b  
 2a 2b 가 (dhc)가 가  
 5 , 99 %, dhc = 13 (satellite) 95 %, dhc = 10.5 90 %, dhc = 9 85 % dhc = 1  
 (2)가 (1102) (2)  
 3.5 6 , 10a 10b 가가 (2) 가가  
 가 (5) (5) (4) (2), (2)  
 ( 2 )  
 4a 4b , 2 4a 4b  
 4a (2) (5)  
 X (5) X X Y , (2) (2)  
 Y (4) (2) (2)

(do) 1 (derr)×2 (2) (dhc) (4)  
(3a) (2) (3a) (dhn) 2 (2) (dhh)

(4) 가 Y X

(4)

가 Y 1 (2) (4)

(4) 가 Y X

(5) ( ) (2) 1 2 (5)

(dhc) 가 (dhh) 가

( 3 )

5 3

1 (2) 3 가 1 가 (5)

(dhh) 4μm (2) 11μm (2) 27μm (dhc) 15μm (2)  
(OH) 40μm (do) 10.5μm (1)

(4) (1) (2)

(2) (4)

6a 6b (4) 가 (2)

) 가 (2) 6a 6b 5 6a 6b (2) (4)

(4) (2)

5pl

1 (4) (4)

(OH) 가 (4) (1) (4)

(4) (4) (2)

가

2 (2) 가 (2) 가 (2) (2) (2)가 (2)

(2) 가 (2) 가 (2) 가 (2)가 (2)

5 (dhc) X (2) (2) (4) (2) (4) (2) (2) 가 (2) (2)

(4) 가 (2) (4) (2) (4) (2) (4) (2)

( 4 )

7a, 7b 7c 4 , 7a , 7b , 7c

7c (17) (31) (300) (31) (30) (15a, 15b) (16)

(17) <100> (1) (16) (15a, 15b), (15a, 1 5b) (33) (19) (33) (19) (33) (18) (17) (33)가 (18) (19) (21a, 21b, 22a, 22b, 23a, 23b, 24a, 24b, 25a, 25b) (32) 7 (16) (32)

(21a, 21b, 22a, 22b, 23a, 23b, 24a, 24b, 25a, 25b) (21, 22, 23 , 24, 25) (32) 2 (21, 25) (M) (21, 22, 23, 24 , 25) (C) (22, 24) (Y) (23) (12, 22, 23, 24, 25) ta (23) 7b ta

(17) (16) (16) (31) (30) 62-264957 (15a, 15b) 9-11479

(30)가 (17) (32)가 (16) (31)

8a, 8b 8c 7a, 7b 7c (17) (16) (300)



(15a, 15b) 가 8a  
(300) (32) (12)  
(19) (13) (11)가 (13) ( )  
300)가  
(12) (Bk) (40, 41) (400)  
(Y, M, C) (300)  
(100) (300, 400)  
8b 8c (300) (100) 8c  
(100) (200Y, 200M, 200C) (1  
2) (150)  
7a, 7b 7c (300) (21a, 21b, 22a, 22b, 23a, 23b,  
24a, 24b, 25a, 25b) (32) (17)  
(32)  
(200Y, 200M, 200C, 200Bk) (12)  
(32) (17) (17)  
(31) (30) (31) (15a, 15b) (3  
1) (31)  
(C), (M), (Y), (M) (C) 7a  
(32) (21a, 21b, 25a, 25b)  
(23a, 23b) (300)가 7a (22a, 22b, 24a, 24b) (2  
1, 22, 23) (300)가 7a (25, 24, 23) 가 (300)가  
7a (300) (shading)  
가  
(300) (21, 25)  
(22, 24) 가 (21, 25)  
(21a, 25a) (21b, 25b)  
) (22a, 24a) (22, 24) (22b, 24b)  
a, 24a) (15a) (21a, 22a, 23  
(21b, 22b, 23b, 24b) (15b)  
(31b) (31a)  
) 가  
(21b, 22b, 24b, 25b)  
( ) (21a, 22a, 24a, 25a)  
( ) 2:1  
a) (23a) (23a) (21a, 22a, 24a, 25a) (15  
(23)

(30) (21a, 22a, 23a, 24a, 25a) (31a)  
 12 μm 가 19.5 μm (2  
 1b, 22b, 23b, 24b, 25b) (31b) 11 μm  
 (15a)가 (31a)가 가 16 μm (30) 12 μm 가 28 μm  
 가 27 μm (15a)가 (31b)가 가 4 μm 12 μm  
 [ 3 μm (17) (31a, 31b) [ 가 15 μm (30) 25 μm ,  
 13 μm (16) ] (31a, 31b)  
 (300) (31a) 5 pl  
 (300) (31b) 2.5 pl  
 (32)  
 ( )  
 9 9 가  
 9 (100) (102) 가 ( )  
 100) 가 ( )가 (100)  
 (100) (102) 가 (102)  
 (102) (103) (103)  
 (102) (105), (106), (107) (104)  
 30)가 (102) (102) (130)가 (home) (136) (1  
 가 (102)가  
 (135) (108) (131) (108) (10  
 9) (109) LF (134)가 (100) LF (134) ( ) )  
 108) 가 (133) 가 (133) , (108) 가 (133) ,  
 (108) (102) (100) (102) (108)  
 (102) (100) (102)  
 9) (102) (100) (108) (10  
 가 (do) (dhc)

가

가

가

가

가

(57)

1.

가

가

(do)

(dhc)

2.

1  
o)

derr

(dhc)

(d

dhc > do + derr x2

3.

1

(dhh)

(dhh)

가

(dhn) 2

4.

가

가

4  
5.

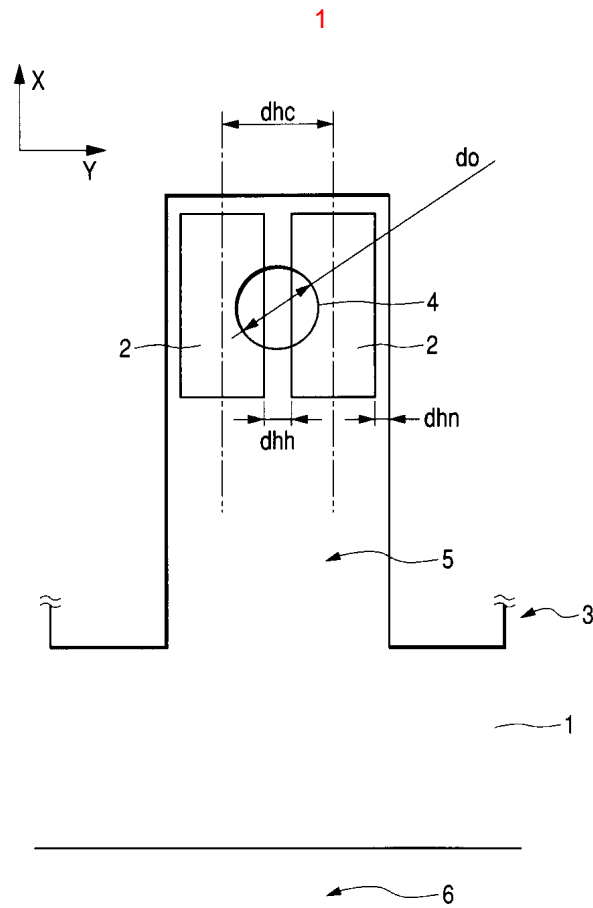

2a

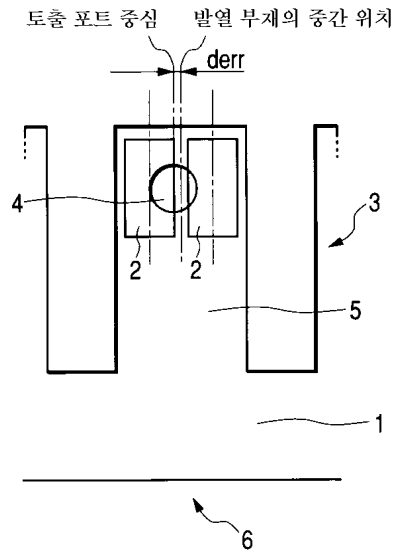

2b

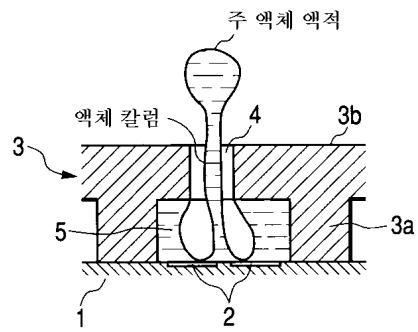

3

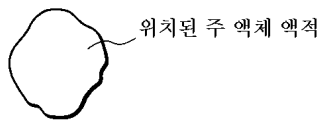

4a

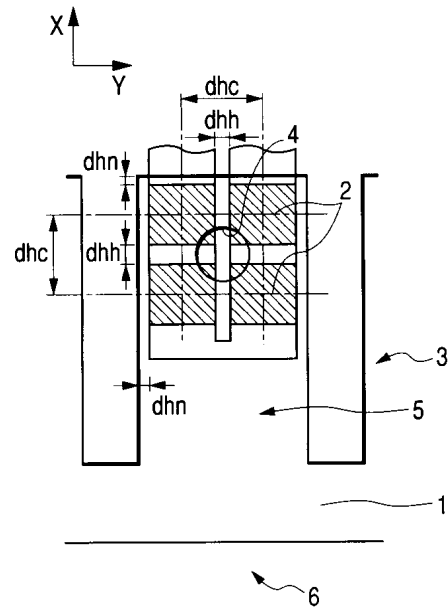

4b

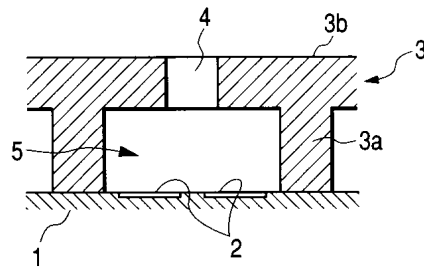

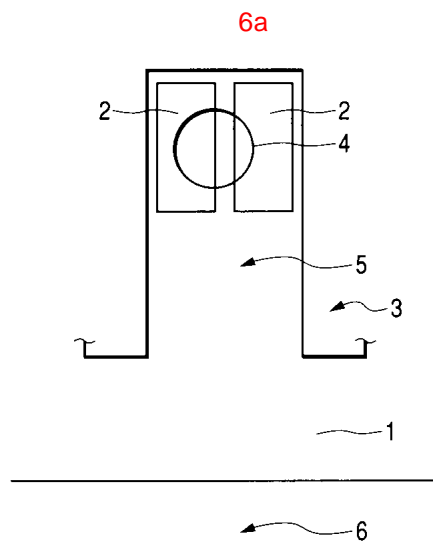
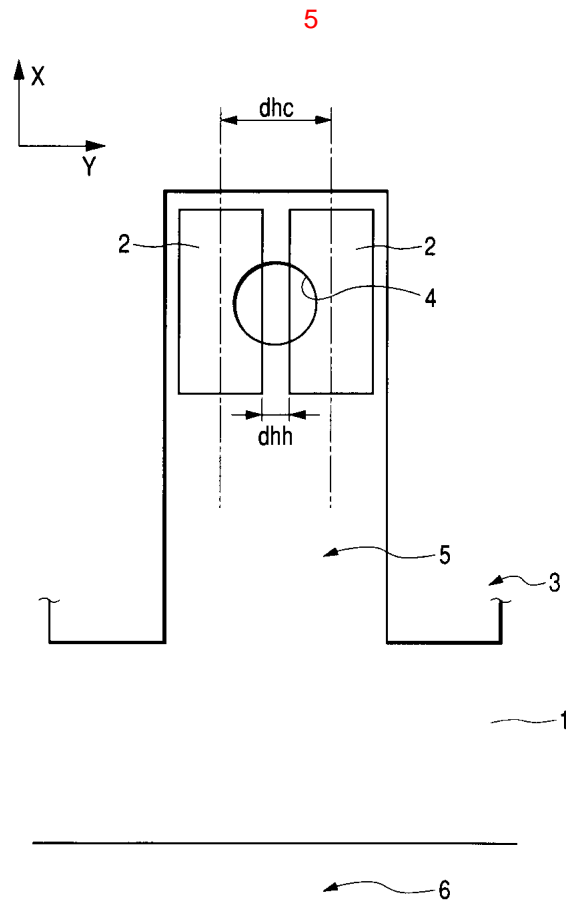

6b

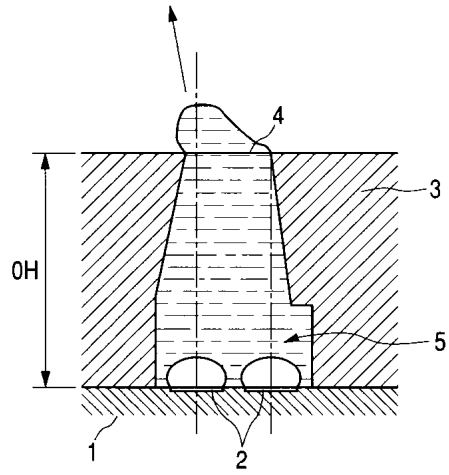

7a

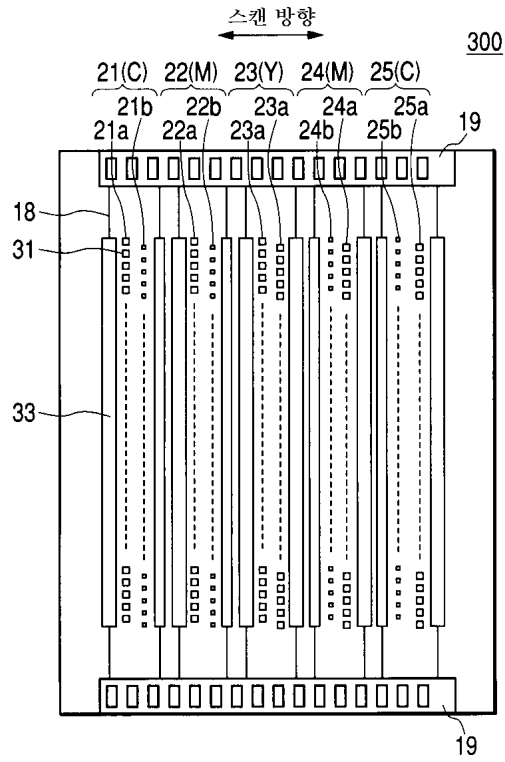

7b

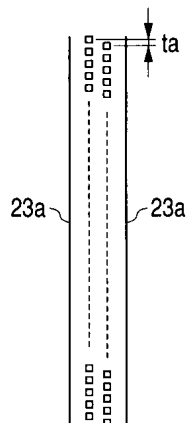



7c

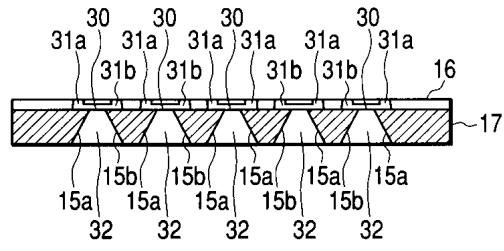

8a

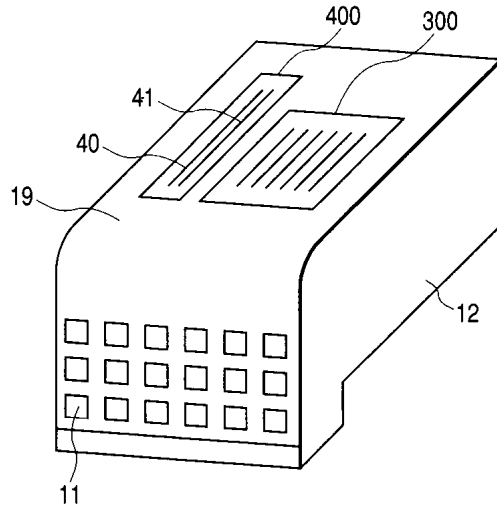

8b

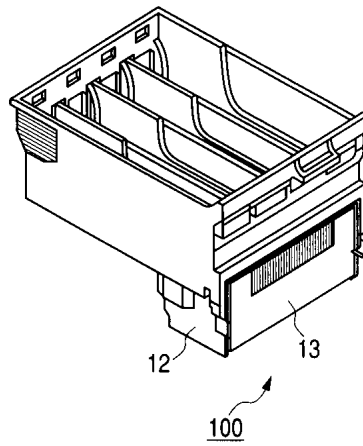

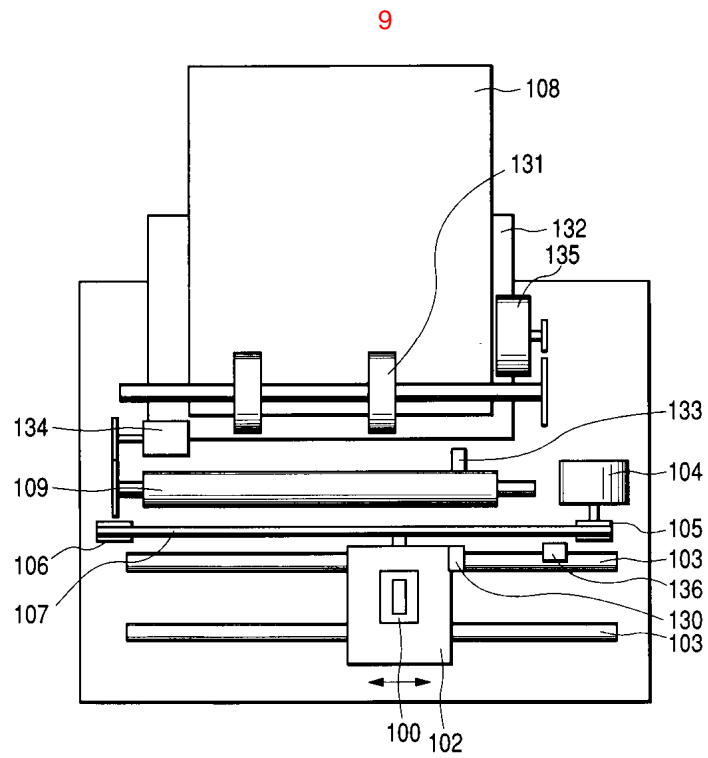
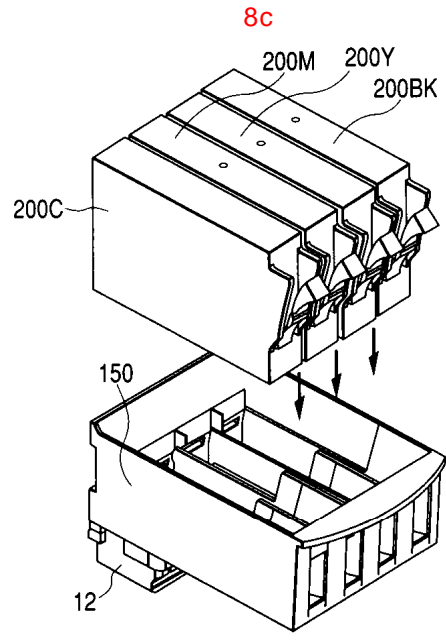

10a

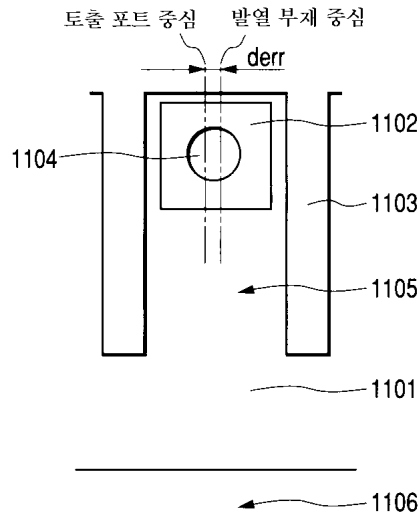

10b

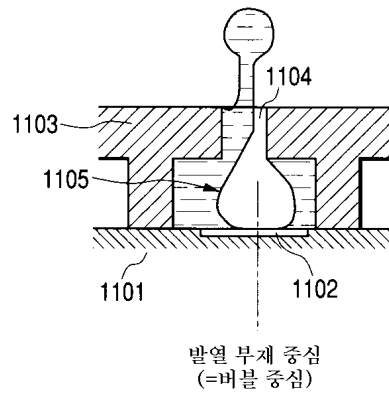

11

위치된 주 액체 액적에 의해 형성된 도트

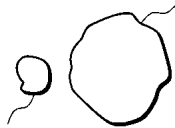

위치된 미세 액체 액적에 의해 형성된 도트

12

