



(12) **EUROPEAN PATENT APPLICATION**

(88) Date of publication A3:
19.06.2002 Bulletin 2002/25

(51) Int Cl.7: **B65H 29/04**

(43) Date of publication A2:
07.03.2001 Bulletin 2001/10

(21) Application number: **00810105.7**

(22) Date of filing: **08.02.2000**

(84) Designated Contracting States:
**AT BE CH CY DE DK ES FI FR GB GR IE IT LI LU
MC NL PT SE**
Designated Extension States:
AL LT LV MK RO SI

(72) Inventors:
• **Uera, Yoshinori**
Kawasaki-shi, Kanagawa-ken (JP)
• **Motojima, Kazuyuki**
Kawasaki-shi, Kanagawa-ken (JP)

(30) Priority: **30.08.1999 JP 24393699**

(74) Representative: **Isler & Pedrazzini AG**
Gotthardstrasse 53
Postfach 6940
8023 Zürich (CH)

(71) Applicant: **TOKYO KIKAI SEISAKUSHO LTD.**
Tokyo (JP)

(54) **Printed matter transport device**

(57) In a printed matter transport device wherein a printed matter is gripped by a gripping mechanism of a chain and made to travel along a guide rail, to improve the durability of the guide rail and chain, to prevent misalignment, falling out and damage when an external force acts on the printed matter, to improve durability of a connecting part of a chain link (2) (base) and the gripping mechanism, to reduce manufacturing costs, and to enable the printed matter to be firmly gripped. A chain with grips comprising first rollers (23) respectively arranged on two sides in the center of the longitudinal direction of the bases (21), a second roller (24) on one side perpendicular to the common center line of the first rollers (23) and a grip mechanism (20) on the opposite side, a guide rail, a chain drive means and a cam member are provided.

FIG. 1

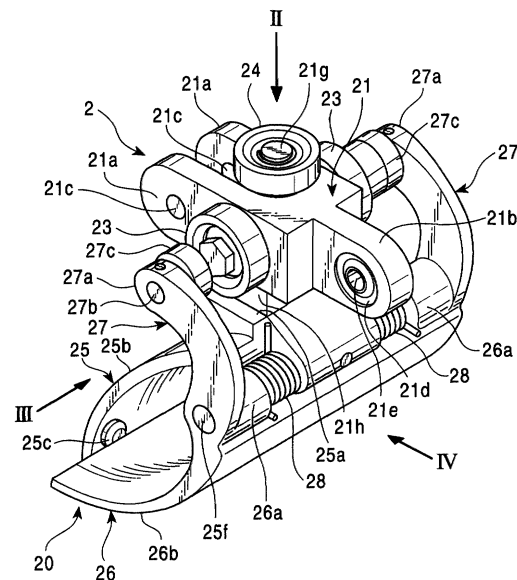



European Patent
Office

EUROPEAN SEARCH REPORT

Application Number
EP 00 81 0105

DOCUMENTS CONSIDERED TO BE RELEVANT			
Category	Citation of document with indication, where appropriate, of relevant passages	Relevant to claim	CLASSIFICATION OF THE APPLICATION (Int.CI.7)
A,D	US 4 638 906 A (WINIASZ MICHAEL E) 27 January 1987 (1987-01-27) * column 2, line 20 - column 4, line 52; figures * ---	1,2	B65H29/04
A,D	PATENT ABSTRACTS OF JAPAN vol. 017, no. 443 (M-1463), 16 August 1993 (1993-08-16) & JP 05 097302 A (KANEDA KIKAI SEISAKUSHO:KK;OTHERS: 02), 20 April 1993 (1993-04-20) * abstract; figures *	1,2	
A	US 4 381 056 A (EBERLE JUERG) 26 April 1983 (1983-04-26) * figures *	1,2	
A	US 5 261 656 A (GUTOV SERGEI K ET AL) 16 November 1993 (1993-11-16) * the whole document *	3-5	
A,D	PATENT ABSTRACTS OF JAPAN vol. 1996, no. 11, 29 November 1996 (1996-11-29) & JP 08 188313 A (KANEDA KIKAI SEISAKUSHO:KK), 23 July 1996 (1996-07-23) * abstract; figure 10 * -----	6	
The present search report has been drawn up for all claims			TECHNICAL FIELDS SEARCHED (Int.CI.7)
			B65H B65G
Place of search		Date of completion of the search	Examiner
THE HAGUE		17 April 2002	Lemmen, R
CATEGORY OF CITED DOCUMENTS			
X : particularly relevant if taken alone Y : particularly relevant if combined with another document of the same category A : technological background O : non-written disclosure P : intermediate document		T : theory or principle underlying the invention E : earlier patent document, but published on, or after the filing date D : document cited in the application L : document cited for other reasons & : member of the same patent family, corresponding document	

EPO FORM 1503 03/82 (P04C01)

**ANNEX TO THE EUROPEAN SEARCH REPORT
ON EUROPEAN PATENT APPLICATION NO.**

EP 00 81 0105

This annex lists the patent family members relating to the patent documents cited in the above-mentioned European search report. The members are as contained in the European Patent Office EDP file on
The European Patent Office is in no way liable for these particulars which are merely given for the purpose of information.

17-04-2002

Patent document cited in search report		Publication date		Patent family member(s)	Publication date
US 4638906	A	27-01-1987	DE	3666217 D1	16-11-1989
			EP	0223999 A2	03-06-1987

JP 05097302	A	20-04-1993	NONE		

US 4381056	A	26-04-1983	CH	644816 A5	31-08-1984
			AT	387002 B	25-11-1988
			AT	23481 A	15-04-1988
			AU	539376 B2	27-09-1984
			AU	6633181 A	13-08-1981
			BE	887422 A1	06-08-1981
			BR	8100733 A	18-08-1981
			CA	1148493 A1	21-06-1983
			DE	3102242 A1	04-02-1982
			FR	2475511 A1	14-08-1981
			GB	2068892 A ,B	19-08-1981
			GR	73826 A1	04-05-1984
			IT	1134982 B	20-08-1986
			JP	1581604 C	11-10-1990
			JP	2000241 B	05-01-1990
			JP	56122710 A	26-09-1981
			MX	151986 A	23-05-1985
			NL	8100260 A ,B,	01-09-1981
			SE	435918 B	29-10-1984
SE	8008916 A	09-08-1981			
ZA	8000515 A	28-01-1981			

US 5261656	A	16-11-1993	RU	2053184 C1	27-01-1996
			CH	682230 A5	13-08-1993
			DE	4191772 C2	25-02-1999
			DE	4191772 T	10-12-1992
			FI	921498 A	06-04-1992
			JP	2534175 B2	11-09-1996
			JP	5502654 T	13-05-1993
			SE	469558 B	26-07-1993
			SE	9201085 A	06-04-1992
			WO	9202442 A1	20-02-1992

JP 08188313	A	23-07-1996	NONE		

EPO FORM P0489

For more details about this annex : see Official Journal of the European Patent Office, No. 12/82