

(19) World Intellectual Property Organization
International Bureau



(43) International Publication Date
11 December 2003 (11.12.2003)

PCT

(10) International Publication Number
WO 03/102398 A1

- (51) **International Patent Classification**⁷: **F02B 75/22**, F02M 35/10, F01B 1/12
- (21) **International Application Number**: PCT/GB03/02406
- (22) **International Filing Date**: 2 June 2003 (02.06.2003)
- (25) **Filing Language**: English
- (26) **Publication Language**: English
- (30) **Priority Data**:
0212733.0 31 May 2002 (31.05.2002) GB
- (71) **Applicant** (for all designated States except US): **MAN B & W DIESEL LTD.** [GB/GB]; Bramhall Moor Lane, Hazel Grove, Stockport, Cheshire SK7 5AQ (GB).
- (72) **Inventor; and**
- (75) **Inventor/Applicant** (for US only): **MCCULLAGH, David, Gerard** [GB/GB]; 22 Beresford Street, Warrington WA1 3SA (GB).
- (74) **Agent**: **GIBBS, Christopher, Stephen**; Haseltine Lake, Imperial House, 15-19 Kingsway, London WC2B 6UD (GB).
- (81) **Designated States (national)**: AE, AG, AL, AM, AT, AU, AZ, BA, BB, BG, BR, BY, BZ, CA, CH, CN, CO, CR, CU, CZ, DE, DK, DM, DZ, EC, EE, ES, FI, GB, GD, GE, GH, GM, HR, HU, ID, IL, IN, IS, JP, KE, KG, KP, KR, KZ, LC, LK, LR, LS, LT, LU, LV, MA, MD, MG, MK, MN, MW, MX, MZ, NI, NO, NZ, OM, PH, PL, PT, RO, RU, SC, SD, SE, SG, SK, SL, TJ, TM, TN, TR, TT, TZ, UA, UG, US, UZ, VC, VN, YU, ZA, ZM, ZW.
- (84) **Designated States (regional)**: ARIPO patent (GH, GM, KE, LS, MW, MZ, SD, SL, SZ, TZ, UG, ZM, ZW), Eurasian patent (AM, AZ, BY, KG, KZ, MD, RU, TJ, TM), European patent (AT, BE, BG, CH, CY, CZ, DE, DK, EE, ES, FI, FR, GB, GR, HU, IE, IT, LU, MC, NL, PT, RO, SE, SI, SK, TR), OAPI patent (BF, BJ, CF, CG, CI, CM, GA, GN, GQ, GW, ML, MR, NE, SN, TD, TG).
- Published:**
— with international search report
- For two-letter codes and other abbreviations, refer to the "Guidance Notes on Codes and Abbreviations" appearing at the beginning of each regular issue of the PCT Gazette.*



WO 03/102398 A1

(54) **Title**: INTERNAL-COMBUSTION ENGINE

(57) **Abstract**: An internal-combustion engine has cylinders 21 arranged preferably in a V-formation with corresponding cylinder heads (27) including connectors for the supply and discharge of fluids. The cylinders are mounted in a crankcase (41) and are supplied with air for combustion by a cast air manifold (51) running the length of the engine, the air manifold being located adjacent to the row of cylinders, preferably in the V. To reduce the amount of pipework the manifold has shaped connectors for at least one of the fluids, in particular the air intake (33) and the water coolant (55), these connectors connecting directly to the relevant connectors on the cylinder head and being pressed against them by the pressure in the manifold.

INTERNAL-COMBUSTION ENGINE

BACKGROUND

The present invention relates to internal-
5 combustion engines, in particular large engines such as
are used in fast boats such as ferries or generally for
industrial power generation.

Manufacturers of engines are of course always trying
to increase the specific power output of their engines.
10 One way of doing this is by reducing the weight of the
engine. Another important characteristic is the ease of
maintenance of such engines, which is partly dependent
upon the ease of access to the internal components.
Also, of course, reducing the cost of manufacture is a
15 constant requirement. The present invention aims to make
improvements in all these areas.

For background on the layout of engines one can
consult the following documents. US 3809032 (G O Morris)
describes a manifold for with separate passages for a
20 multiple-barrel carburettor. US 4,267,812 (Ford) shows a
manifold system providing an integral mounting of an EGR
cooler/carburettor. US 4,458,491 (MTU) has an exhaust
manifold system within the V of a V-engine. US 6,032,634
(Hitachi) shows a multi-part engine air manifold system
25 located on the engine, where two design options are
provided for an optimised air charging system as well as
providing cooling for the engine control unit. The
manifold system includes a longitudinal partition wall
and mounts other engine components such as the injectors.
30 JP 10-030445A (Nissan) shows an intake manifold with an
integral supercharger, mounted on top of the engine. EP
0162272 A1 (KHD) shows an enclosed assembly containing
lubricant and fuel pipes. EP 0644326 A1 (Hitachi) is an
air duct with integral air filter/throttle valve and a
35 plurality of suction pipes. Described in EP 1069301 A2
(DDC) is a wedge-shaped cylinder head with integral air
manifold mounted on top of and spanning the cylinder
heads. Finally GB 2174454 A (Rover) shows an air

induction system with variable plenum length. The design allows ease of manufacturing by plastic mouldings and metal pressing.

5 SUMMARY OF THE INVENTION

According to the invention there is provided an internal-combustion engine having cylinders arranged in a row with corresponding cylinder heads including connectors for the supply and discharge of fluids, the cylinders being mounted in a casing and being supplied with air for combustion by an air manifold running the length of the engine, in which the air manifold is locked adjacent to the row of cylinders, and has shaped connectors for at least one of the fluids, these connectors connecting directly to the relevant connectors on the cylinder head.

This arrangement does away with at least some of the piping between the air manifold and the cylinders that is a feature of prior-art engines. The connecting parts of air manifold and cylinder head abut each other directly, but a good seal can nevertheless be achieved because (in contrast to the engines described above) the pressure in the air manifold during operation of the engine presses outwards and seals the connection.

For pressure within the air manifold to improve the seal of the connectors on the manifold abutting against the cylinder heads there must be a support opposite the cylinders against which the air manifold can bear. For an in-line engine a special support can be designed, but the invention is particularly advantageous for V-engines because the manifold can simply be located within the V, between the rows of cylinders, in use bearing outwardly against them on both sides. Preferably it rests directly on the crankcase, and the connectors are designed to have substantially vertical planes of abutment.

The fluid or fluids in question can be combustion fluids, such as the air directed towards the inlet valves in the cylinder head, or heat-exchange fluids, in

particular the water used for cooling the cylinders. Advantageously both such possibilities are made use of, so that the air manifold has no external pipes along its length (though it will generally have pipes at the end
5 for supply and discharge).

It is possible to achieve further integration if further channels, not necessarily communicating directly with the cylinder heads and being for instance for oil and/or water, are integrated into the manifold,
10 preferably on its underside, i.e. adjacent to the casing, in other words the crankcase. Moreover, in the part between the rows of cylinders and directly under the air manifold the crankcase may itself contain passages for water, one over the other, the upper or outer one of
15 which is sealed directly by the air manifold, i.e. the wall of the manifold also forms part of the wall of the passage. This reduces the number of parts of the engine. Furthermore the intercooler for a turbocharger arrangement can be mounted directly on top of the air
20 manifold. This does away with the support brackets that would otherwise be needed, saving weight and space. The air manifold is preferably cast, so as to be able to achieve the necessary shape, and may for instance be of aluminium. With the intercooler supported along its
25 entire length on the manifold the strength of aluminium is entirely adequate.

For a better understanding of the invention an embodiment will now be described with reference to the
30 accompanying drawings, in which:

- Figure 1 shows a perspective view of a complete engine, representing an embodiment of the invention;
- 35 Figure 2 shows a cross-section through the engine perpendicular to the axis; and
- Figure 3 shows a perspective view of the engine with the cylinder heads removed showing the air

manifold; and

Figure 4 shows the air manifold itself.

Figure 1 shows a V12 engine which can be used, for instance, in fast cross-channel ferries. The cylinder head 27 on one side can be seen, as can the intercooler 61 on top of the engine and next to it on either side the exhaust heat shields 73. All the drives are at one end of the engine, and in the Figure the lubricating oil pump 85, sea water pump 89 and fresh water pumps 91 can be seen. Also visible is a damper 87 and the twin air filters 93 leading into the turbochargers which in turn lead via twin emergency shut-off valves 97 into the intercooler 61.

Figure 2 shows a cross-section through this engine. The engine is of a modular design and can be produced in varying configurations - currently as a twelve-, sixteen- or twenty-cylinder engine - with a minimal stock of parts such as air manifold, cylinder head. The section is taken through a crank 3 of the crank shaft 1 to which is connected a two-piece dowelled angle split connecting rod 5 leading to the gudgeon pin 7 at the small end. The gudgeon pin is connected in the usual way to a piston 11 which in its crown 13 has a central chamber 14 surrounded by an annular chamber 15. To form the chambers the piston is made in two parts split by a plane perpendicular to its axis by a proprietary process.

The piston 11 slides in cylinders 21 having at their upper ends, i.e. at the ends away from the crank shaft, a thicker portion 23 surrounded by a sleeve or water jacket 25 defining the chamber for cooling of the cylinder. On top of each cylinder is a cast cylinder head 27 with two pairs of valves 29 mounted in the usual way. The cylinder head is cast in iron and has an exhaust outlet 31 and an air inlet 33. The cylinders are mounted in a V formation in a cast crankcase 41, being sealed to it approximately at the bottom end of their thicker portions 23. The crankcase contains at least one

passage, here two cast passages 43 and 45, for water running axially to the engine, located generally in the V between the lower ends of the cylinder liners 21. The upper passage 45 is the hot feed to the cylinder heads, and the lower passage 43 is the cold return.

An air manifold 51, likewise made of cast aluminium and having a generally rectangular section with sidewalls 52, runs the length of the engine and is mounted approximately between the cylinder heads 27 of the two banks of cylinders. The manifold 51 has a central passage running along its length and off this passage along each side in the sidewalls 52 has air terminals or connectors 59 that abut the ends of the air passages 33 of the cylinder heads. The plane of their abutment is substantially vertical, i.e. perpendicular to the axis of the V. Likewise the manifold 51 has, near the top of the sidewalls, integral cast passages 55 for hot water that communicate with a chamber surrounding the exhaust passages 31 in the cylinder heads. In use the pressure in the manifold pushes the sidewalls 52, with the connecting terminals, outwards against the corresponding terminals on the cylinder heads, reinforcing the sealing effect.

The air manifold 51 also has twin axial water and oil passages 53 in its bottom section, the lower walls of which act to seal the upper water passage 45 in the crank casing. The water passage in the air manifold supplies cold water to a second intercooler, if present.

On top of the air manifold 51 is mounted the intercooler 61 which is a two-stage intercooler with integral air intake passage, surrounded by a single casing which has a waist so that it forms a figure of eight in section, the upper part being the air passage and the lower part enclosing the heat exchanger pipes 63. A line can also be seen which notionally splits the intercooler into two stages: the pipes above this line are connected to the hot (c. 80°C) water from the passages 55, and the pipes below are connected to the

cold (c. 40°C) supply. The air spreads axially along the air passage and then down between the pipes and into the manifold. Next to the intercooler on either side are the exhaust manifolds 71 connected to the exhaust passages 31
5 of the cylinder heads, again directly. The exhaust manifolds are protected by covers 73, which as can be seen are in two parts.

Figures 1 and 2 also shows the cam shafts 101, the fuel pump 105, the sump 83, twin bearing caps 85 and cast
10 mounting feet 81 for mounting the engine in a frame, such as a ship's frame, the lubricating oil cooler 74, an intercooler water diverting valve 57, a duplex lubricating oil filter 76, a fuel pump and tappet cover 77, crankcase doors 79, a lubricating oil pump 84
15 and a lubricating oil filler 86. For a twelve-cylinder ferry engine the bore is 280mm, the stroke is 330mm and the power output may be about 5.4 MW at a speed of about 1000r/min. However the invention is not limited to ships' engines.

20 **Figure 3** shows a 16-cylinder version of the engine in perspective, with the cylinder heads 27 removed so that the air manifold box 51 is visible. The cast air connections 59, a pair for each cylinder, are visible. In the 16-cylinder version (as for the 20-cylinder) two
25 intercoolers 61 are used, the cold water supply to the second being by way of one of the lower passages 53 in the manifold. The manifold 51 is shown on its own in **Figure 4**, the seals between sections also being shown in a partially exploded view that reveals the hot-water
30 passages 55. These Figures also show the modular nature of the engine and manifold, the cross-section of the manifold being essentially uniform, with passages running only axially within it along its length.

CLAIMS:

1. An internal-combustion engine having cylinders (21) arranged in a row with corresponding cylinder heads (27) including connectors for the supply and discharge of fluids, the cylinders being mounted in a casing (41) and being supplied with air for combustion by an air manifold (51) running the length of the engine, in which the air manifold is located adjacent to the row of cylinders, and has shaped connectors (59) for at least one of the fluids, these connectors connecting directly to the relevant connectors on the cylinder head and in use being pressed against them by the pressure in the manifold.
2. An engine according to claim 1, in which the fluid or fluids include combustion fluids, such as the air directed towards the inlet valves in the cylinder head, or heat-exchange fluids, in particular water used for cooling the cylinders, or both.
3. An engine according to claim 1 or 2, in which the air manifold has no external pipes along its length, and contains passages for the fluids that run essentially along its entire length.
4. An engine according to any preceding claim, in which further channels (53), not communicating directly with the cylinder heads and being for instance for oil and/or water, are integrated into the air manifold.
5. An engine according to any preceding claim, in which, in the part adjacent to the row of cylinders and directly under the air manifold, the engine crankcase itself contains passages (43, 45) for water, the upper one of which is sealed directly by the air manifold.
6. An engine according to any preceding claim, in which

the engine is a V-engine and the manifold is located within the V, between the rows of cylinders, in use bearing outwardly against them on both sides.

5 7. An engine according to any preceding claim, further comprising an intercooler (61) for a turbocharger arrangement mounted directly on top of the air manifold.

10 8. An engine according to any preceding claim, in which the air manifold is cast, for instance of aluminium, and has a generally rectangular cross-section.

15 9. An engine according to any preceding claim, in which the air manifold is of modular design, being adapted to be fitted to further such manifolds, end to end.

20 10. An internal-combustion engine having cylinders (21) arranged in a row with corresponding cylinder heads (27) including connectors for the supply and discharge of fluids, the cylinders being mounted in a casing (41) and being supplied with air for combustion by an air manifold (51) running the length of the engine, in which the air manifold is located adjacent to the row of cylinders, and has shaped connectors (59) for at least
25 one of the fluids, these connectors connecting directly to the relevant connectors on the cylinder head, and further channels (53), not communicating directly with the cylinder heads and being for instance for oil and/or water, integrated into and running the length of the air
30 manifold.

11. A water craft having an engine according to any preceding claim.

Figure 1

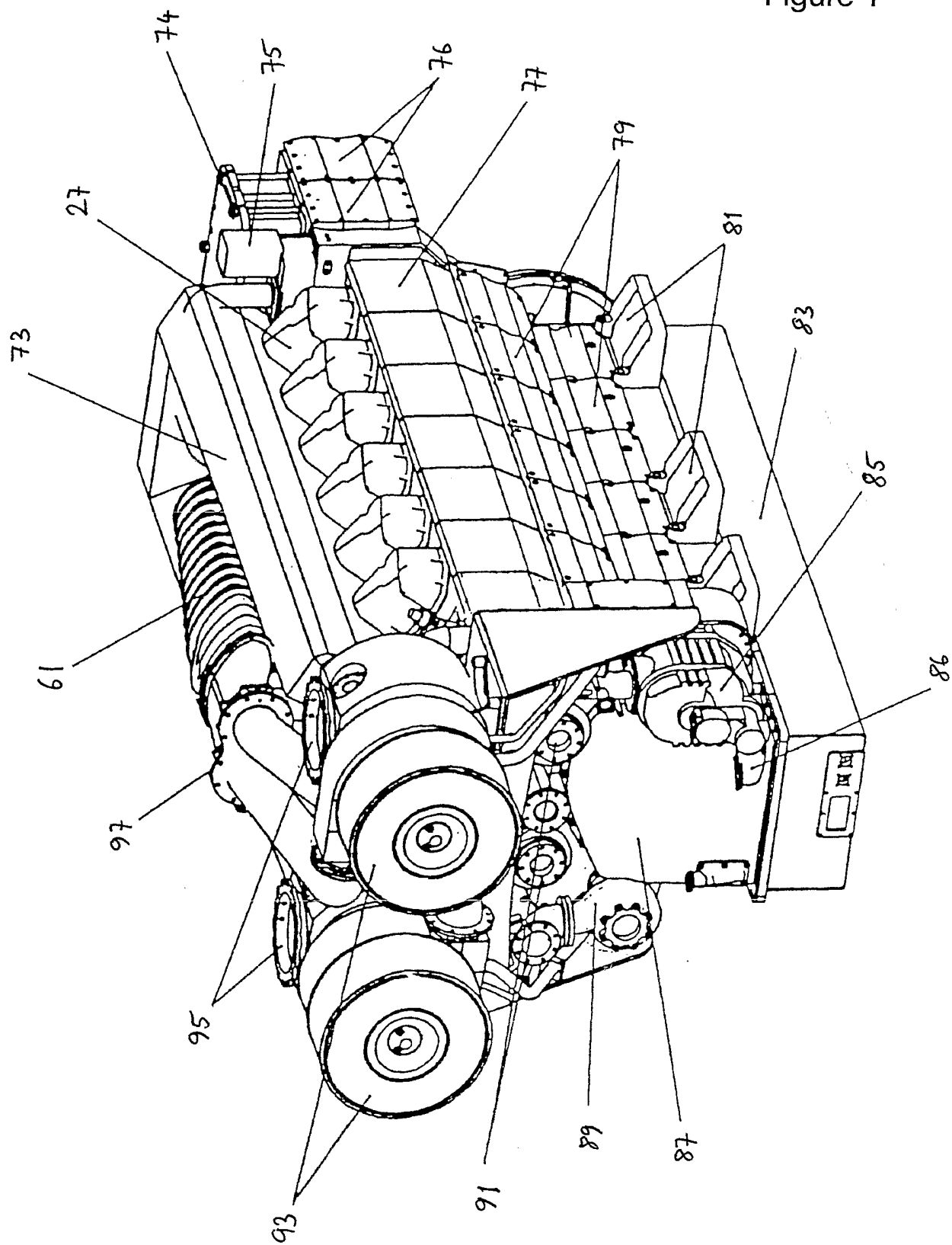
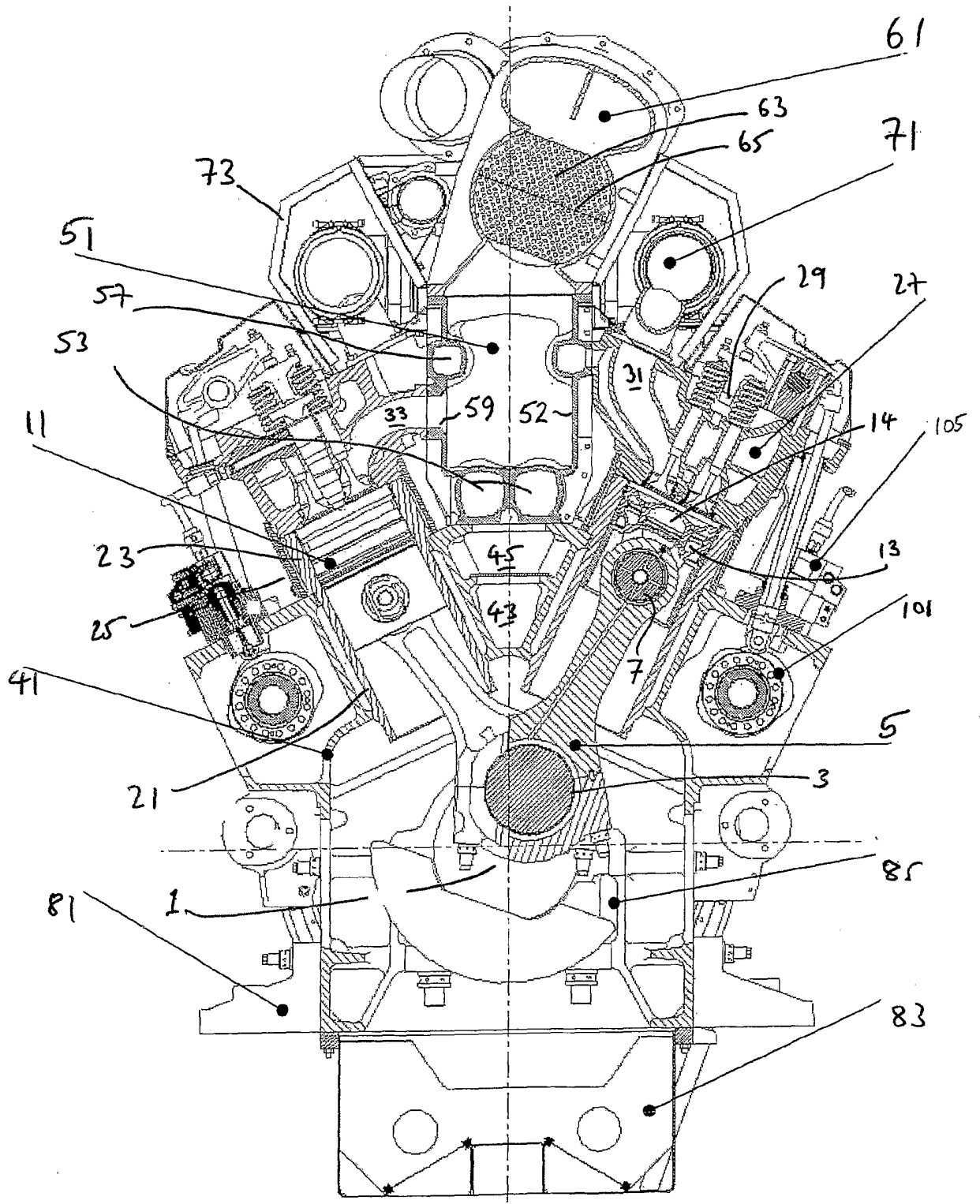

Figure 2



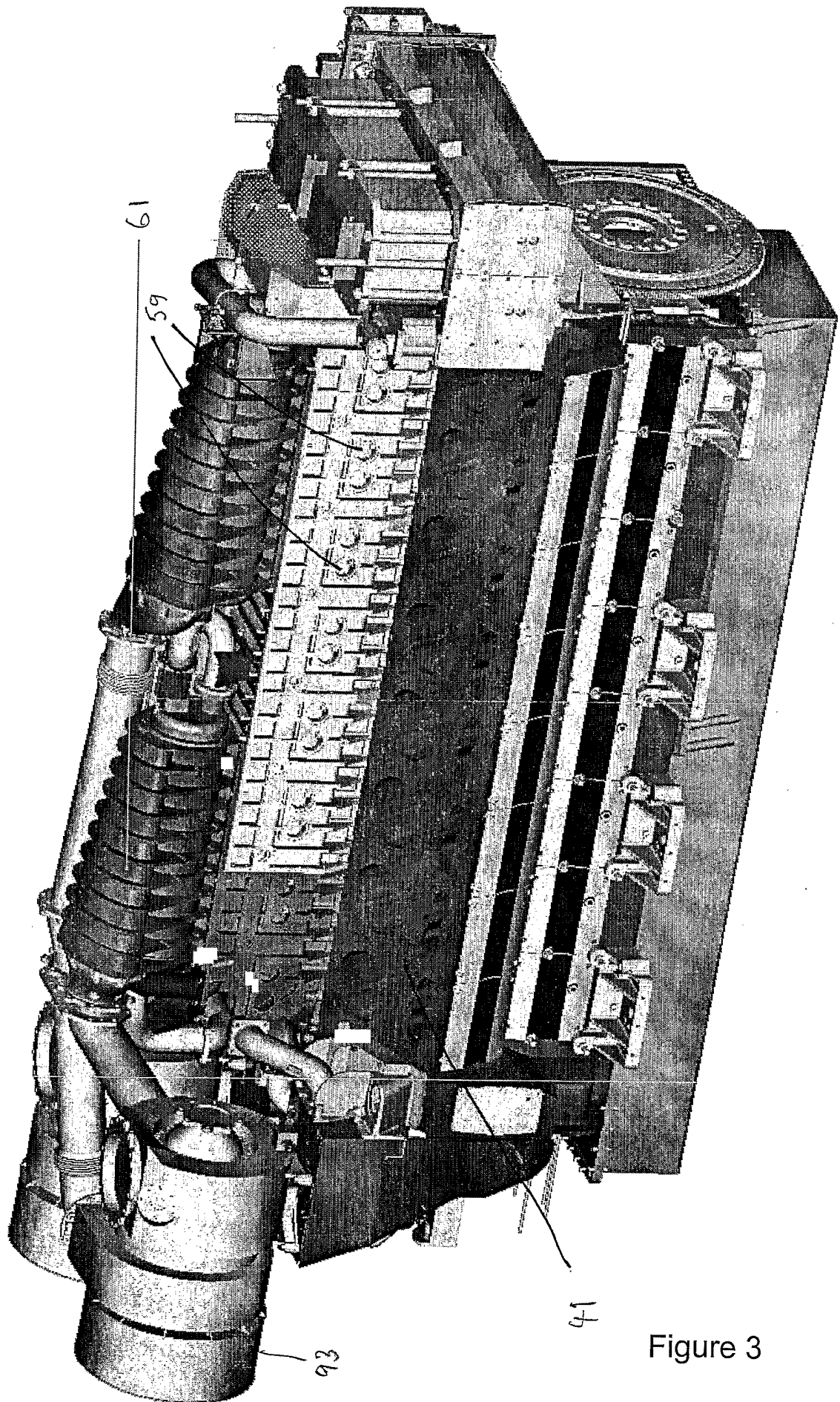

Figure 3

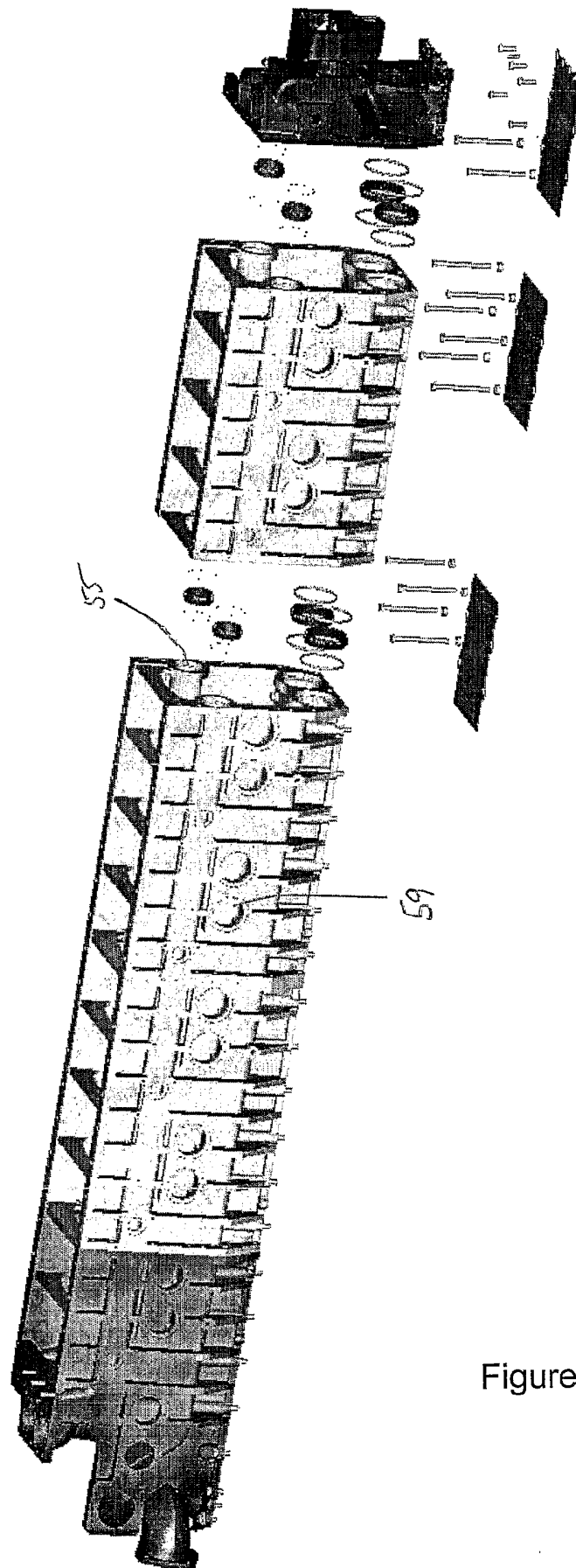

Figure 4

INTERNATIONAL SEARCH REPORT

 Int
 national Application No
 PCT/GB 03/02406

A. CLASSIFICATION OF SUBJECT MATTER IPC 7 F02B75/22 F02M35/10 F01B1/12		
According to International Patent Classification (IPC) or to both national classification and IPC		
B. FIELDS SEARCHED Minimum documentation searched (classification system followed by classification symbols) IPC 7 F02B F02M F01B F16L F16J		
Documentation searched other than minimum documentation to the extent that such documents are included in the fields searched		
Electronic data base consulted during the international search (name of data base and, where practical, search terms used) EPO-Internal, PAJ		
C. DOCUMENTS CONSIDERED TO BE RELEVANT		
Category °	Citation of document, with indication, where appropriate, of the relevant passages	Relevant to claim No.
A, P	KOEHLER H W: "DER NEUE MAN B&W DIESELMOTOR 48/60B" SCHIFF UND HAFEN, SEEHAFEN-VERLAG ERIK BLUMENFELD. HAMBURG, DE, vol. 54, no. 7, July 2002 (2002-07), pages 40-46, XP001126094 ISSN: 0938-1643 the whole document --- -/--	1
<input checked="" type="checkbox"/> Further documents are listed in the continuation of box C.		
<input checked="" type="checkbox"/> Patent family members are listed in annex.		
° Special categories of cited documents :		
A document defining the general state of the art which is not considered to be of particular relevance *E* earlier document but published on or after the international filing date *L* document which may throw doubts on priority claim(s) or which is cited to establish the publication date of another citation or other special reason (as specified) *O* document referring to an oral disclosure, use, exhibition or other means *P* document published prior to the international filing date but later than the priority date claimed		*T* later document published after the international filing date or priority date and not in conflict with the application but cited to understand the principle or theory underlying the invention *X* document of particular relevance; the claimed invention cannot be considered novel or cannot be considered to involve an inventive step when the document is taken alone *Y* document of particular relevance; the claimed invention cannot be considered to involve an inventive step when the document is combined with one or more other such documents, such combination being obvious to a person skilled in the art. *&* document member of the same patent family
Date of the actual completion of the international search 15 August 2003		Date of mailing of the international search report 21/08/2003
Name and mailing address of the ISA European Patent Office, P.B. 5818 Patentlaan 2 NL - 2280 HV Rijswijk Tel. (+31-70) 340-2040, Tx. 31 651 epo nl, Fax: (+31-70) 340-3016		Authorized officer Wassenaar, G

INTERNATIONAL SEARCH REPORT

International Application No

PCT/GB 03/02406

C.(Continuation) DOCUMENTS CONSIDERED TO BE RELEVANT		
Category °	Citation of document, with indication, where appropriate, of the relevant passages	Relevant to claim No.
A	ECKER H-J ET AL: "DIE NEUE V12- UND V16-MOTORENBAUREIHE DER ANGLO BELGIAN CORPORATION" MTZ MOTORTECHNISCHE ZEITSCHRIFT, FRANCKH'SCHE VERLAGSHANDLUNG, ABTEILUNG TECHNIK. STUTTGART, DE, vol. 62, no. 7/8, July 2001 (2001-07), pages 550-557, XP001053852 ISSN: 0024-8525 the whole document ----	1
A	WO 94 13948 A (MAN B & W DIESEL GMBH) 23 June 1994 (1994-06-23) figure 1 abstract ----	1
A	US 2002/053331 A1 (YAMAGUCHI JUNICHI ET AL) 9 May 2002 (2002-05-09) figure 1 abstract ----	1
A	DE 44 33 285 A (MOTOREN WERKE MANNHEIM AG) 21 March 1996 (1996-03-21) figures 1,2 abstract claims 1-9 ----	1
A	PATENT ABSTRACTS OF JAPAN vol. 1998, no. 10, 31 August 1998 (1998-08-31) & JP 10 122071 A (YAMAHA MOTOR CO LTD), 12 May 1998 (1998-05-12) abstract -----	1

INTERNATIONAL SEARCH REPORT

Information on patent family members

International Application No

PCT/GB 03/02406

Patent document cited in search report		Publication date	Patent family member(s)	Publication date
WO 9413948	A	23-06-1994	DK 147792 A	21-05-1993
			WO 9413948 A1	23-06-1994
			JP 2977902 B2	15-11-1999
			JP 8504493 T	14-05-1996
			KR 245083 B1	02-03-2000
US 2002053331	A1	09-05-2002	JP 7083132 A	28-03-1995
			US 5960759 A	05-10-1999
			US 2003098004 A1	29-05-2003
			DE 69410719 D1	09-07-1998
			DE 69410719 T2	11-03-1999
			DE 69426425 D1	18-01-2001
			DE 69426425 T2	12-07-2001
			DE 69432912 D1	07-08-2003
			EP 1283352 A2	12-02-2003
			EP 0644326 A1	22-03-1995
			EP 0793012 A2	03-09-1997
			EP 0913571 A2	06-05-1999
			US 5638784 A	17-06-1997
			DE 4433285	A
AT 168449 T	15-08-1998			
DE 59502847 D1	20-08-1998			
DK 782667 T3	01-03-1999			
WO 9609469 A1	28-03-1996			
EP 0782667 A1	09-07-1997			
FI 971135 A	18-03-1997			
JP 10122071	A	12-05-1998	NONE	