



- (51) **International Patent Classification:**  
A01K 15/00 (2006.01)
- (21) **International Application Number:**  
PCT/US2019/057449
- (22) **International Filing Date:**  
22 October 2019 (22.10.2019)
- (25) **Filing Language:** English
- (26) **Publication Language:** English
- (30) **Priority Data:**  
16/167,907 23 October 2018 (23.10.2018) US
- (71) **Applicant: RADIO SYSTEMS CORPORATION**  
[US/US]; 10427 Petsafe Way, Knoxville, TN 37932 (US).
- (72) **Inventors: WEIMIN, Bai;** 10427 Petsafe Way, Knoxville, TN 37932 (US). **REINHART, Anthony, J.;** 10427 Petsafe Way, Knoxville, TN 37932 (US).
- (74) **Agent: SAWRIE, David, F.;** 211 Commerce Street, Suite 800, Nashville, TN 37201 (US).

KR, KW, KZ, LA, LC, LK, LR, LS, LU, LY, MA, MD, ME, MG, MK, MN, MW, MX, MY, MZ, NA, NG, NI, NO, NZ, OM, PA, PE, PG, PH, PL, PT, QA, RO, RS, RU, RW, SA, SC, SD, SE, SG, SK, SL, SM, ST, SV, SY, TH, TJ, TM, TN, TR, TT, TZ, UA, UG, US, UZ, VC, VN, ZA, ZM, ZW.

- (84) **Designated States** (unless otherwise indicated, for every kind of regional protection available): ARIPO (BW, GH, GM, KE, LR, LS, MW, MZ, NA, RW, SD, SL, ST, SZ, TZ, UG, ZM, ZW), Eurasian (AM, AZ, BY, KG, KZ, RU, TJ, TM), European (AL, AT, BE, BG, CH, CY, CZ, DE, DK, EE, ES, FI, FR, GB, GR, HR, HU, IE, IS, IT, LT, LU, LV, MC, MK, MT, NL, NO, PL, PT, RO, RS, SE, SI, SK, SM, TR), OAPI (BF, BJ, CF, CG, CI, CM, GA, GN, GQ, GW, KM, ML, MR, NE, SN, TD, TG).

**Published:**  
— with international search report (Art. 21(3))

- (81) **Designated States** (unless otherwise indicated, for every kind of national protection available): AE, AG, AL, AM, AO, AT, AU, AZ, BA, BB, BG, BH, BN, BR, BW, BY, BZ, CA, CH, CL, CN, CO, CR, CU, CZ, DE, DJ, DK, DM, DO, DZ, EC, EE, EG, ES, FI, GB, GD, GE, GH, GM, GT, HN, HR, HU, ID, IL, IN, IR, IS, JO, JP, KE, KG, KH, KN, KP,

(54) **Title:** PET SPRAY TRAINING SYSTEM

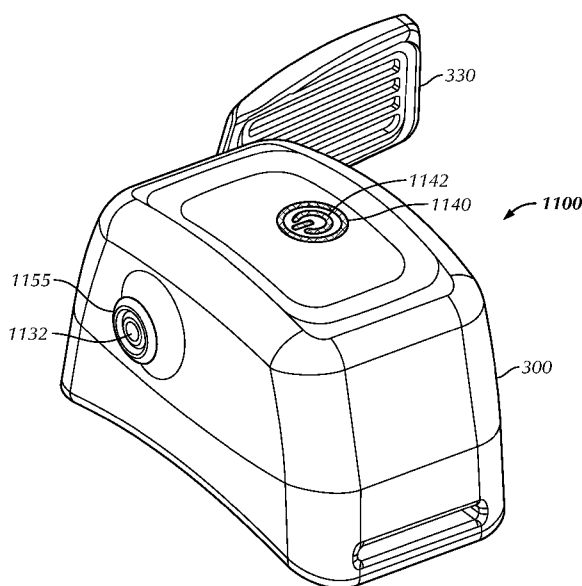

FIG. 11

(57) **Abstract:** An pet spray training system is provided. The system includes a sound, vibration or motion sensor that is configured to generate electrical signals in response to an occurrence. The system may include a filter, which is tuned to recognize a dog barking event, and generate an electrical signal in response to recognizing an input signal indicative of a dog's bark. The system further includes a removably pressurized gas reservoir that holds a deterrent fluid under pressure. The system additionally comprises a motor module configured to rotate a shaft in response to the electrical signal from the filter. The canister has a spray nozzle for releasing fluid that affects the dog's senses. In response to rotating the shaft, the spray nozzle is depressed.

## PET SPRAY TRAINING SYSTEM

### CROSS REFERENCE TO RELATED APPLICATIONS

[0001] This application claims the benefit of U.S. Application No. 16/167,907, filed October 23, 2018.

### STATEMENT REGARDING FEDERALLY SPONSORED RESEARCH OR DEVELOPMENT

[0002] Not applicable.

### THE NAMES OF THE PARTIES TO A JOINT RESEARCH AGREEMENT

[0003] Not applicable.

### BACKGROUND OF THE INVENTION

[0004] This section is intended to introduce various aspects of the art, which may be associated with exemplary embodiments of the present disclosure. This discussion is believed to assist in providing a framework to facilitate a better understanding of particular aspects of the present disclosure. Accordingly, it should be understood that this section should be read in this light, and not necessarily as admissions of prior art.

### Field of the Invention

[0005] The present inventive concept relates to the field of pet training. More particularly, the invention relates to an improved portable spray system used as an aversive for animal behavior modification, such as controlling the barking of a pet dog.

### Technology in the Field of the Invention

[0006] Many people who live in populated areas enjoy the companionship of dogs. Such individuals frequently live in apartment complexes, condominium complexes, garden home communities, zero lot line homes, lofts or high rise developments. In these instances, residents are living in close proximity to one another. Such close living arrangements may provide a

feeling of community, may provide a convenient location for work, may provide affordable housing, may provide for a low-maintenance lifestyle, or may provide a lifestyle deemed to be vibrant or culturally stimulating.

**[0007]** At the same time, dog owners living in these circumstances face the challenge of controlling excessive or unwanted barking from a pet dog. In this respect, dogs have a habit of barking at strange noises, either as a protective habit or out of unwarranted fear or territorialism. Dogs also bark at other pets and at people. Such barking is a nuisance to neighbors living close by, and even to the dog owners themselves. This can produce conflicts between neighbors, and even litigation where barking is deemed to be an ongoing nuisance.

**[0008]** Various techniques have been developed to control the barking of a dog. First, barking can be controlled by the surgical removal of the larynx. However, this solution is usually unacceptable to pet owners as unnecessarily cruel and expensive. Second, standard obedience techniques can be used to train a dog not to bark, but this is time consuming and often requires the presence of the owner to correct the dog. If the owner is absent from the home for long periods of time, such as at work, the dog may learn to refrain from barking only when the owner is present, remaining a nuisance while the owner is away. Third, a muzzle can be utilized to prevent a dog from barking. However, the muzzle must be periodically removed to allow the dog to eat or drink which restores the need for supervision. Finally, remote and automatic systems using various trigger mechanisms (primarily electrical stimuli) have been developed to control the barking of a dog. However, not every pet owner wants to apply electrodes to the throat of a pet, particularly when the pet is small or frail.

**[0009]** One technique that has proved successful and that has been deemed particularly humane is the use of a spray canister. U.S. Patent No. 4,627,385 entitled "Bark Restraining system for Dogs" discloses a collar unit having an electronic circuit. The circuit includes a microphone with a filter, such as the filter shown in U.S. Patent No. 8,714,113. Such a filter is sensitive to frequencies that correspond to those of the bark of a dog. When barking is sensed, the circuit actuates a valve that is associated with a pressurized tank of compressed gas or other fluid. When activated, the valve releases a spray of the fluid from a tank in the region of the

head of the dog. The substance is designed to affect the senses of the dog, particularly the sense of smell. The '113 patent is incorporated herein by reference in its entirety.

**[0010]** In one aspect of the '385 patent, the electronic circuit is responsive to a signal from a remote transmitter carried by the pet owner or a trainer. The remote transmitter is shown in Figure 7 of the '385 patent. The transmitter permits the owner or trainer to remotely actuate the release of the spray as part of the training of the dog. U.S. Patent No. 4,627,385 is also incorporated herein by reference in its entirety.

**[0011]** Since the '385 patent issued in 1986, a variety of "spray trainers" have been placed on the market. Some spray trainers are associated with a dog collar, while others (typically directed towards cats) represent free-standing spray canisters equipped with motion sensors. In any of these instances, pressurized canisters having a solenoid release mechanism have been used. The canisters are filled in a "clean room," under pressure, at the factory before packaging for sale.

**[0012]** The currently-available collar-mounted, pressurized spray canisters utilize a refill valve, a separate spray valve and a solenoid releasing mechanism. These canisters can be difficult or complex to produce in high volume.

**[0013]** Accordingly, a need exists for an improved spray mechanism used for training pets that utilizes easily replaceable pressurized canisters. A need further exists for a spray training system that does not require a refillable tank or a pump mechanism for an unpressurized canister. Further, a need exists for a spray training mechanism that utilizes a small electrical motor that releases pressurized fluid rather than a pump that acts on an unpressurized container, which is prone to leakage.

## **BRIEF SUMMARY OF THE INVENTION**

**[0014]** An pet spray training system is first provided herein. In one embodiment, the pet spray training system includes a sensor (such as a microphone). The sensor is configured to receive an input (such as sound frequencies), and to generate electrical signals in response.

**[0015]** The system also includes a filter. The filter is tuned to recognize input signals received by and emitted in proximity to the sensor. The filter is part of circuitry that generates an electrical behavior modification signal in response to recognizing signal input characteristic of the bark of a dog.

**[0016]** The system further includes a first canister. The first canister holds a bark deterrent fluid at positive pressure. Preferably, the bark deterrent fluid comprises a solution that stimulates one or more senses of a dog. For example, the solution may be sensed by the dog's sense of smell, hearing or touch. In one aspect, the stimulation is an offensive or "aversive" stimulation. In one aspect, the fluid is an irritant to a membrane of a dog.

**[0017]** The system additionally comprises a motor module. The motor module is configured to rotate a shaft for a designated period of time in response to conditioned electrical signals from the filter indicative of the bark of a dog.

**[0018]** In one embodiment, the system includes an elongated motor arm. In this embodiment, the system includes a gear operatively connected to the shaft and configured to move the elongated motor arm linearly in response to rotation of the shaft. Preferably, the gear is part of a gear assembly having at least two gears, and possibly three or four gears of progressive size, with one of the gears engaging the elongated motor arm. In this instance, the elongated motor arm will comprise teeth that mate with teeth of the engaging gear.

**[0019]** Still further, the system comprises a spray nozzle. The spray nozzle is associated with the first canister.

**[0020]** The system additionally includes an actuation arm. The actuation arm is pivotally connected to the elongated motor arm and is configured to depress the spray nozzle when the electrical motor is actuated to move the elongated motor arm in a first linear direction. This serves to release a short stream of bark deterrent fluid. The actuation arm is further configured to disengage the spray nozzle when the electrical motor remains actuated to move the motor arm in a second opposite linear direction, thereby closing off the release of bark deterrent fluid.

**[0021]** In another embodiment, the system include a cam. The cam defines a cam surface that acts on an actuation arm. In this embodiment, the system again includes a gear operatively connected to the shaft. However, in this instance the gear (or gear assembly) rotates the cam and associated cam surface in order to momentarily depress the spray nozzle. In this arrangement, continued actuation of the electrical motor causes the cam to continue rotating, which in turn cyclically depresses and releases the spray nozzle. Preferably, only one spray cycle is provided.

**[0022]** The system also comprises a battery. The battery is arranged to provide power to the electrical motor module and to any other electrical components, such as an optional wireless receiver or programmable logic controller.

**[0023]** Preferably, the pet spray training system also includes a housing. The housing is configured to hold at least the sensor, the filter, the motor module and the battery. The housing includes a connector, such as a slot or opposing loops, for connecting the housing to the collar of a dog.

**[0024]** In one embodiment, the housing includes a spray opening through which the deterrent fluid is emitted under pressure when the actuation arm engages the spray nozzle. In addition, the housing includes a slot for receiving the first canister. The spray nozzle aligns with the spray opening when the canister is placed in the slot. The housing may further comprise an access cover. The access cover is configured to expose the slot when the cover is pivotally opened. This enables removal and replacement of the first canister, as needed.

**[0025]** In one embodiment, the system communicates with a remote transmitter. The transmitter is configured to send a wireless bark deterrent signal in response to manual actuation, such as by a pet owner pushing a button. The system also includes a receiver located on the collar, such as on the housing. The receiver is configured to receive the bark deterrent signal wirelessly, and in response generate the electrical behavior modification signal. The electrical motor is configured to rotate the shaft for the designated period of time in response to the electrical behavioral modification signal from the receiver. This ultimately causes a stream of

the bark deterrent fluid to be released through the spray nozzle. In this way, the system can also be remotely operated by a pet owner.

**[0026]** In another embodiment, the system is part of a system that includes a remote transmitter that is part of a stationary unit. The transmitter is configured to send a wireless bark deterrent signal to the receiver on the collar in response to on-board bark sensing and filtering electronics on a stationary bark-sensing and transmitting system. The system also includes a receiver co-located on the collar or otherwise along the housing. The receiver is configured to receive the bark deterrent signal as transmitted by the remote, stationary bark-sensing system, and in response, generate an electrical behavior modification signal. The electrical motor is configured to rotate the shaft and ultimately cause the actuation arm to engage the spray nozzle of the first canister in response to the electrical behavior modification signal delivered by the receiver (or related processor). Ultimately, this causes a stream of the bark deterrent fluid to be released through the spray nozzle along the collar. In this way, the system can discourage barking in a designated location such as a nursery.

**[0027]** In yet another embodiment, the system is generally free-standing, that is, no portion resides along a collar, and includes a sensor, a filter, an electric motor module and a fluid canister. The sensor and filter are configured to receive input signals (such as sound frequencies) and to generate electrical signals in response to recognizing input signals characteristic of the bark of a dog. The electrical motor module is configured to cause fluid to be emitted from the canister in response to the electrical signal from the sensor/filter, and to cause a stream of fluid to be released upon the recognition of a bark. In this way, the system is free-standing and can be moved to a room to discourage barking in the room where the bark deterrent system is located.

**[0028]** In yet another embodiment, the system is again free-standing and portable, but this time includes a motion sensor along with the filter, electric motor module and the fluid canister. The motion sensor is configured to receive motion signals and to generate electrical signals in response to sensing motion characteristic of the movement of a pet. The electrical motor is configured to rotate a gear in response to the electrical signal from the motion sensor, and to ultimately cause a stream of deterrent fluid to be released upon the recognition of pet movement

in an area. In this way, the system can discourage the presence of a pet in a designated location where the system is placed, such as a kitchen or nursery or office.

**[0029]** In still another embodiment, the system comprises a second canister containing a behavior reinforcement fluid, wherein the behavior reinforcement fluid comprises a solution that is pleasing to a dog's sense of smell to provide positive reinforcement. A remote transmitter is again offered, which is configured to send a behavior reinforcement signal in response to manual actuation to a receiver. The receiver is located along a collar, such as within a housing. The electrical motor is configured to rotate a shaft, which causes a spray nozzle to be depressed, which then causes fluid from the second canister to be released in response to the electrical behavior modification signal from the receiver.

**[0030]** In another embodiment, the system further comprises a tone generation element that can be used independently or in concert with either the deterrent fluid or the reinforcement fluid. The generated tone may be a deterrent tone or a reinforcement tone, used with the deterrent fluid or the reinforcement fluid, respectively. Alternatively, the system further comprises a vibratory element such as a micro-motor that delivers vibration to the dog as a deterrent signal.

**[0031]** A method for modifying the behavior of an animal is also provided herein. The method employs the pet spray training systems described above, in any of their various embodiments.

#### **BRIEF DESCRIPTION OF THE DRAWINGS**

**[0032]** So that the manner in which the present inventions can be better understood, certain illustrations, charts and/or flow charts are appended hereto. It is to be noted, however, that the drawings illustrate only selected embodiments of the inventions and are therefore not to be considered limiting of scope, for the inventions may admit to other equally effective embodiments and applications.

**[0033]** Figure 1 is a schematic view of the pet spray training system of the present invention, in one embodiment.

**[0034]** Figure 2A is a schematic view of a single stroke pet spray system that utilizes an electric motor module to turn a shaft, in one embodiment. Rotation of the shaft ultimately causes a spray nozzle associated with a canister to be depressed, thereby releasing a spray of behavior modification fluid. In this view, a canister having a cylindrical configuration is used.

**[0035]** Figure 2B is another schematic view of a single stroke pet spray system that utilizes an electrical motor module to turn a shaft, in a second embodiment. Rotation of the shaft again ultimately causes a spray nozzle associated with a canister to be depressed, thereby releasing a spray of behavior modification fluid. In this view, the canister has a rectangular prism configuration.

**[0036]** Figure 3A is a perspective view of an illustrative housing as may be used to hold the systems of either Figure 2A or Figure 2B.

**[0037]** Figure 3B is a perspective view of the housing of Figure 3A, wherein an access cover is opened. In addition, a portion of the front panel of the housing has been lifted off.

**[0038]** Figure 3C is an enlarged perspective view of a portion of the housing of Figure 3A. In this view, an access cover is shown in an opened position.

**[0039]** Figure 4A is a perspective view of the housing of Figure 3A, wherein a front panel has been removed to expose a pet spray training system of the present invention, in a first embodiment. The system includes an electric motor module, a gear assembly, an elongated motor arm and an actuation arm. The canister has been removed from the slot and is not visible.

**[0040]** Figure 4B is an enlarged perspective view of the electric motor module of the pet spray training system of Figure 4A, in one embodiment. The electric motor module, elongated motor arm and gear assembly are visible as well.

**[0041]** Figure 4C is another perspective view of the housing of Figure 3A. Here, the housing is cut-away, exposing the pet spray training system of Figures 4A and 4B.

**[0042]** Figure 5A is a perspective view of the housing of Figure 3A, wherein a front panel has again been removed to expose a pet spray training system of the present invention, but in a second embodiment. The system includes an electric motor module, a gear assembly, a cam and an actuation arm. A canister is also visible here.

**[0043]** Figure 5B is an enlarged perspective view of the electric motor module of Figure 5A.

**[0044]** Figure 5C is another enlarged perspective view of the electric motor module of Figure 5A. Here, a portion of the housing of the module is removed, exposing the internal gears of the gear assembly.

**[0045]** Figure 5D is a cross-sectional view of the electric motor module of Figure 5A. Selected gears are also seen in cross-section, along with the drive shaft and cam.

**[0046]** Figure 6 is a schematic view of the pet spray training system of Figure 1, shown with a pet dog and affixed to a pet dog collar. The system is within the housing of Figure 3A. Figure 6 shows a remote transmitter that communicates with the system via manually actuated wireless signals.

**[0047]** Figure 7 is a schematic view of the pet spray training system of Figure 1, shown with a pet dog and affixed to a pet dog collar. Figure 7 shows a remote stationary receiver that communicates with the system via wireless signals.

**[0048]** Figure 8 is a schematic view of the pet spray training system of Figure 1, shown with a pet dog. Figure 8 shows a remote stationary system with a microphone that senses the barking of a dog.

**[0049]** Figure 9 is a schematic view of the pet spray training system of Figure 1, shown with a pet dog. Figure 9 shows a remote stationary system with a motion detecting sensor and a spray canister.

**[0050]** Figure 10 is a schematic view of the pet spray training system of Figure 1, shown with a pet dog and affixed to a pet dog collar. Figure 10 also shows a stationary system with a motion detecting sensor. Here, the spray canister is associated with a dog collar.

**[0051]** Figure. 11 is a perspective view of an pet spray training system of the present invention, in another embodiment.

**[0052]** Figure 12 is a cross-sectional view of the pet spray training system of Figure 11.

**[0053]** Figure. 13 is a perspective view of the removable reservoir portion of the pet spray training system of Fig. 11.

**[0054]** Figure. 14 is an exploded view of the removable reservoir portion of the pet spray training system of Fig. 11.

**[0055]** Figure. 15 is a cross-sectional view of the pet spray training system of Figure 11.

**[0056]** Figure 16 is a side view of the gear assembly, motor and reservoir of the pet spray training system of Figure 11.

## **DETAILED DESCRIPTION OF CERTAIN EMBODIMENTS**

### **Definitions**

**[0057]** For purposes of the present disclosure, it is noted that spatially relative terms, such as “up,” “down,” “right,” “left,” “beneath,” “below,” “lower,” “above,” “upper” and the like, may be used herein for ease of description to describe one element or feature's relationship to another element(s) or feature(s) as illustrated in the figures. It will be understood that the spatially relative terms are intended to encompass different orientations of the system in use or operation in addition to the orientation depicted in the figures. For example, if the system in the figures is turned over or rotated, elements described as “below” or “beneath” other elements or features

would then be oriented “above” the other elements or features. Thus, the exemplary term “below” can encompass both an orientation of above and below.

### **Description of Selected Specific Embodiments**

**[0058]** **Figure 1** is a schematic view of pet spray training system or device **100** of the present invention, in one embodiment. A plurality of components for the system **100** are shown. In some embodiments, the components are intended to reside on the collar of a dog. An illustrative collar is shown at **600** in **Figure 6**, placed around a pet **650**. It is understood that the term “collar” may include a harness or other similar system.

**[0059]** Referring back to **Figure 1**, the system **100** first includes a sensor **110**. The sensor **110** may be any system that is responsive to the bark of the dog. In one embodiment, the sensor **110** is a piezoelectric vibration sensor that is in contact with the dog for measuring vibrations produced by the dog. The piezoelectric sensor is a low current device used for detecting the barking of a dog. In one aspect, the sensor **110** is placed in contact with the throat of the dog so as to measure vibrations produced by the vocal cords of the dog. Such an embodiment is described in detail in U.S. Patent No. 6,668,760 entitled “Spray Control Anti-Bark Collar,” the entirety of which is incorporated herein by reference in its entirety.

**[0060]** In a more preferred embodiment, the sensor **110** is a microphone. The microphone **110** is configured to receive sound frequencies emitted in proximity to the dog collar. In response, the microphone **110** generates electrical signals.

**[0061]** The electrical signals from the microphone **110** are taken through a conditioning process. In one aspect, this includes amplification. Thus, the pet spray training system **100** may also include an amplifier **120**. The amplifier **120** is coupled to the sensor **110** and amplifies the electrical signal output of the vibration (or sound) sensor **110** to increase the level of the sensor output for further processing and more accurate sampling.

**[0062]** The pet spray training system **100** optionally includes a circuit **130** for further signal conditioning of the electrical signal output of the amplifier **120**. The signal conditioning circuit

**130** serves to discriminate among the vibrations or sound frequencies measured by the sensor **110** so as to pass only measured vibrations or frequencies that meet specified criteria. For example, the signal conditioning circuit **130** may be configured to filter out frequencies not indicative of the bark of a dog, or to pass only those vibrations signals occurring within a specified frequency range or those meeting certain durational limits. The signal conditioning circuit **130** may be configured to eliminate unwanted output electrical signals from the sensor **110** output. Those skilled in the art will recognize the various filters, amplifiers and other signal conditioning devices that can be used to prepare the measured frequencies or vibrations for further processing. Those skilled in the art will also recognize that the type of signal conditioning depends upon the input signal, the corresponding sensor and the desired characteristics of the input signal that are to be monitored. For example, the signal conditioning or filter may be active or passive and may be set to pass a specific frequency range or to remove high or low frequency noise. Further, depending upon the various components used, the output signal may not require additional amplification. Finally, other conditioning may be required to present a useable sensor output to the remainder of the circuit.

**[0063]** As part of the filtering process, a controller or processor **140** monitors the amplified output and activates a stimulus delivery mechanism **160**. In the present invention, the stimulus delivery mechanism **160** is a so-called spray trainer. Decision-making logic within the processor **140** determines whether a spray is needed through the actuation of the stimulus delivery mechanism **160**. Typically, the input to the processor **140** is compared against a reference value to determine whether a spray-type stimulus is warranted. A conventional processing device **140** includes an internal timer, memory registers and math capabilities allowing sophisticated signal processing to occur; however, those skilled in the art will recognize that these capabilities can be achieved using other components without departing from the spirit and scope of the present invention, such as through firmware. Further, those skilled in the art will recognize that the electrical components used depend on various factors including the cost of manufacture, size and weight constraints and the complexity of the decision process. For example, the size and weight of the training collar worn by the animal is reduced by implementing the controller in a single application specific integrated circuit (ASIC) or a microprocessor, both of which allow complex

decision making capabilities. For lower cost, larger units implementing a simple decision tree, or an array of discrete logic components can be used.

**[0064]** In the illustrated embodiment for the pet spray training system **100**, the stimulus delivery mechanism **160** is a spray mechanism that delivers a controlled dose of a bark deterrent substance or fluid. The spray delivery mechanism **160** includes a first canister (or cartridge, or tank) **162**, a motor module **164** and a depressible spray valve or nozzle **166**. The bark deterrent substance is held within the canister **162** under pressure, and represents a solution that affects the olfactory (or other) senses of the dog.

**[0065]** The deterrent substance is selected to be irritating or disturbing to the dog. A commonly used deterrent stimulus is a citronella liquid; however, those skilled in the art will recognize other deterrent substances that can be used without departing from the scope and spirit of the present invention, for example compressed air or water. In addition, those skilled in the art will recognize that the sound of the substance escaping under pressure provides a secondary deterrent function. Thus, in one aspect the pet spray training system **100** also includes a speaker **610**. The speaker **610** is associated with the processor **140**, and is configured to emit a sound that emulates a spray of fluid in response to conditioned electrical signals from the filter indicative of the bark of a dog. This is particularly useful if the canister **162** becomes depleted of fluid. Alternatively, a micro-motor is provided as element **610**, which vibrates in response to receiving an actuation signal.

**[0066]** **Figure 2A** is a schematic view of a single-stroke pet spray system **200A**, in one embodiment. The pet spray system **200A** includes a pressurized canister **210A**. In this arrangement, the canister **210A** has a cylindrical configuration and sealingly holds a behavior modification fluid such as a bark deterrent fluid.

**[0067]** The canister **210A** has an upper end **211** and a lower end **214**. The upper end **211** comprises a bell-shaped shoulder **212** fixedly connected to a spray nozzle **215**. When the shoulder **212** is depressed, the bark deterrent fluid is released as a spray or mist from the canister **210A** through the spray nozzle **215**.

**[0068]** The pet spray system **200A** also includes electrical circuitry, shown schematically as printed circuit board (circuitry) **220**. The circuitry/board **220** includes the sensor **110**, the amplifier **120**, the signal conditioning circuit **130** and the processor **140** of **Figure 1**. The circuitry **220** may also, in some embodiments described further below, include a receiver. The receiver, shown in **Figure 1** at **155**, is designed to receive an external actuation signal.

**[0069]** The pet spray system **200A** utilizes an electrical motor module **230**. The motor module **230** receives an electrical behavior modification signal from the circuitry **220** when a sound indicative of the bark of a dog is picked up or sensed. This causes the motor module **230** to rotate a shaft **235**, which is mechanically engaged with a gear assembly (seen best at **260** in **Figure 4A**). The gear assembly **260** will include at least one gear configured to engage an elongated motor arm **250**. The motor arm **250** may be a rack portion of a rack and pinion type arrangement, which moves linearly while being driven by the turning of the gear for a designated period of time.

**[0070]** The pet spray system **200A** also includes an actuation arm **255**, as seen in **Figure 2A**. The actuation arm **255** has a proximal end **251** and a distal end **259**. The proximal end **251** is pivotally connected to an upper end of the motor arm **250** while the distal end **259** is pivotally connected to a housing (seen at **300** in **Figures 4A** and **4C**). The actuation arm **255** is connected to or otherwise passes along the shoulder **212** at the spray nozzle **215**.

**[0071]** The pet spray system **200A** further includes one or more batteries **240**. The batteries **240** are configured to supply electrical power to the components of the circuitry **220** and to the electric motor module **230**. In one aspect, the circuitry **220** includes a timer that controls the length of time the motor module **230** is actuated to turn the shaft **235**.

**[0072]** In operation, a signal is sent from the electrical circuitry **220** to the electric motor module **230**. The signal may be sent in response to a condition being sensed by a sensor **110**. In one aspect, the sensor **110** is an on-board microphone that detects the barking of the dog. In another aspect, the sensor is a microphone located in a separate (or remote) sensing unit. In still another aspect, the condition is the sensed motion of a dog detected in a room that is considered

off-limits to the dog. In this latter arrangement, the motion detector is again a separate (or remote) sensing unit. The remote sensing unit has a transmitter that sends an actuation signal as discussed more fully below in connection with **Figures 8, 9 and 10**.

**[0073]** In any instance, upon receipt of the actuation signal, the motor module **230** is activated for a designated period of time according to the timer of the electrical circuitry **220**. Activation of the motor module **230** rotates the shaft **235**, which in turn rotates one or more gears in a gear assembly **260**. An ultimate gear (shown in **Figure 4B** at **262**) engages the elongated motor arm **250**, causing the motor arm **250** to move linearly. In the arrangement of **Figure 2A**, the motor arm **250** is caused to move down relative to the spray nozzle **215** upon the sensing of a bark by the sensor **110** and the resulting electronic signal sent to and processed by the processor **140**.

**[0074]** As noted, the upper end **254** of the elongated motor arm **250** is pivotally connected to the proximal end **251** of the actuation arm **255**. Movement of the motor arm **250** downwardly causes the actuation arm **255** to engage the shoulder **212** at the spray nozzle **215**, causing the spray nozzle **215** to also move downwardly with respect to the canister **210A**. This, in turn, releases a spray of the pressurized bark deterrent (or other behavior modification) fluid from the nozzle **215**. Thus, rotation of the shaft **235** ultimately causes the spray nozzle **215** associated with the canister **210A** to be depressed, releasing a spray of behavior modification fluid under pressure.

**[0075]** **Figure 2B** is a cross-sectional schematic view of another single-stroke pet spray system **200B** that utilizes an electrical motor module **230** to turn a shaft **235**. The system **200B** works in accordance with the system **200A** of **Figure 2A**. In this respect, a sensor **110** is used to detect a condition such as the barking of a dog or the movement of a dog. Upon sensing, an actuation signal is sent to cause the motor module **230** to rotate the shaft **235**. This ultimately causes the spray nozzle **215** associated with a canister **210B** to be depressed, releasing a spray of behavior modification fluid under pressure.

[0076] In the arrangement of **Figure 2B**, the canister **210B** has a rectangular prism configuration. For pricing advantage, the canister **210B** may be a modified cigarette lighter housing. Of course, the pressurized fluid inside the canister **210B** would be a behavior modification fluid such as a bark deterrent fluid and not so-called lighter fluid.

[0077] **Figure 3A** is a perspective view of an illustrative housing **300** as may be used to hold the system **200A** or **200B** of **Figure 2A** or **Figure 2B**, respectively. The housing **300** is preferably fabricated from a light-weight but durable polycarbonate material. The housing **300** includes a front panel **310** that in one aspect is removable, such as through a clamshell or snap-on / snap-off arrangement or screws. The housing **300** may offer a power button **350** that enables the pet owner to turn the pet spray system **200A** or **200B** on and off. The housing **300** also includes an opening **311** along an edge which is aligned with the nozzle to allow the spray from the nozzle **215** through the opening **311** upon actuation of the system.

[0078] The housing arrangement **300** of **Figure 3A** is designed to be attached to a collar (such as collar **600** shown in **Figures 6, 7 and 10**) of a pet dog **650**. To this end, the illustrative housing **300** offers opposing loops **320** with respective through-openings **325**. The through-openings **325** are dimensioned to receive the collar **600** to secure the housing **300** and pet spray system (**200A** or **200B**) to the animal. It is understood that for purposes of the present disclosure, a collar includes a harness of any type.

[0079] **Figure 3B** is a perspective view of the housing **300** of **Figure 3A**, wherein an access cover **330** is opened. In addition, a portion of the front panel **310** of the housing **300** has been lifted off.

[0080] **Figure 3C** is an enlarged perspective view of the housing **300** of **Figure 3A**. In this view, the access cover **330** of the housing **300** remains open, revealing the canister slot **335**. In addition, screws (not shown) have been loosened to partially remove or lift off a portion of the front panel **310**.

[0081] **Figure 4A** is a perspective view of the interior of the housing **300** of **Figure 3A**. In this view, the front panel **310** has been completely removed to expose internal components of the

pet spray system **200B**. These components include an electric motor module **230**, a gear assembly **260**, an elongated motor arm **250** and an actuation arm **255**. The canister **210B** has been removed and is not visible. It is further observed in **Figure 4A** that the access cover **330** is closed covering a canister slot **335**.

**[0082]** Of interest from the view of **Figure 4A**, a linking pin **257** is visible. As explained more fully in connection with **Figure 4C**, the linking pin **257** enables a pivoting connection between the upper end **254** of the elongated motor arm **250** and the proximal end **251** of the actuation arm **255**. At the same time, the distal end **259** of the actuation arm **255** is pinned to the housing **300** through pin **317**.

**[0083]** The gear assembly **260** may include more than one gear, at least in this arrangement. Thus, rotation of the shaft **235** causes a progression of engaged gears to turn, ultimately moving the elongated motor arm **250** to move linearly.

**[0084]** **Figure 4B** is an enlarged perspective view of the electric motor module **230** of the pet spray training system **300** of **Figure 4A**, in one embodiment. The motor arm **250** is visible along with the last or ultimate gear **262**. The gear **262** engages the elongated motor arm **250**. The motor arm **250** is held in place relative to the motor module **230** by means of opposing clips **232**. The clips **232** secure the arm **250** laterally, but permit linear movement in the up and down directions depending on rotational direction of the shaft **235** and gear **262**. Alternatively, continued rotation of the gear **262** in the same angular direction will cause the linear direction of movement of the elongated motor arm **250** to reverse in accordance with operation of a rack-and-pinion assembly.

**[0085]** It is noted that in this arrangement, the elongated motor arm **250** comprises two opposing legs **253**. The legs **253** come together to form the lower end **252** and the upper end **254** of the arm **250**. The linking pin **257** is seen at the upper end **254** of each leg **253**. It is further observed that internal surfaces of the legs **253** have gear surfaces **256**. The gear surfaces **256** define teeth that receive the engaging gear **262** of the gear assembly **260**. As such, the gear arrangement or assembly including the motor arm **250** is of a rack and pinion type arrangement.

[0086] **Figure 4C** provides an enlarged perspective view of the housing of **Figure 4A**. Here, the housing **300** is cut-away, exposing parts of the pet spray training system **200B** of **Figure 2B**. The spring **337** is seen positioned within the canister slot **335**. The spring is configured to apply a biasing force upon the canister **210B** to maintain its proper position and to insure proper actuation of the actuation arm **255** upon the nozzle **215**.

[0087] The pet spray training system **200B** relies upon an elongated pivoting actuation arm **255** that is momentarily pulled downward by the motor arm **250**. This pulling action momentarily depresses the nozzle shoulder **212** (seen in **Figure 2B**) associated with the canister **210B**. The motor arm **250**, in turn, is driven linearly (up and down) by a rack-and-pinion type arrangement driven by gears **260** (seen best in **Figure 4A**). When the motor arm **250** travels downward, the actuation arm **255** pivots downward upon the nozzle shoulder **212**, causing behavior modification fluid under pressure within the canister **210B** to be expelled through the opening **311**. When the motor arm **250** returns to its upward position, the actuation arm **255** pivots back upward, thereby releasing the nozzle **212** and shutting off the pressurized release of fluid.

[0088] It is observed that the same result, that is, momentary depression of the nozzle shoulder **212**, may be accomplished by substituting the motor arm **250** and the actuation arm **255** with a rotating cam. In this embodiment, the rotating cam has a sinusoidal surface that acts against a transverse actuation arm. Thus, a rotational movement generated by a shaft again produces a linear movement that acts upon the nozzle shoulder **212**.

[0089] **Figures 5A** through **5C** present a pet spray training system (or an pet spray training system **500**) in this alternate embodiment. In this respect, a cam **550** is provided having a cam surface **552**. In addition, a transverse actuation arm **555** is employed to act against a spray nozzle **515**.

[0090] **Figure 5A** is a perspective view of the housing **300** of **Figure 3A**, wherein a front panel **310** has again been removed. The pet spray training system **500** (as an pet spray training system) is seen therein. Visible in **Figure 5A** is an electric motor module **530**. The electric

motor module **530** operates off of battery power to drive a shaft **535**. The electric motor module includes a gear housing (seen at **532** in **Figure 5B**) and a motor housing **534**.

**[0091]** **Figure 5B** is an enlarged perspective view of the electric motor module **530** of **Figure 5A**. Gear housing **532** and module wall **556** are shown. **Figure 5C** is another enlarged perspective view of the electric motor module **530** of **Figure 5A**. Here, the module wall **556** is removed, exposing the gears of a gear assembly **560**. **Figure 5D** is a cross-sectional view of the electric motor module of **Figure 5A**. Selected gears are seen in cross-section, along with the drive shaft **535** and cam **550**.

**[0092]** Referring to **Figures 5B, 5C** and **5D** together, the shaft **535** turns a gear, which is part of the gear assembly **560**. The gears within the gear assembly **560** have respective shafts anchored within a gear housing **532**. As the shaft **535** is turned, the progression of gears within the gear assembly **560** are rotated. In the illustrative arrangement of the system **500**, the progression of gears represent a first gear **541**, a second gear **542**, a third gear **543**, a fourth gear **544**, a fifth gear **545** and a sixth gear **546**. The first gear **541** and the third gear **543** are connected by the drive shaft **535**, while the second gear **542** and the fourth gear **544** are connected by a separate geared shaft **540**. It is understood that the present invention is not limited by the number or arrangement of gears used unless expressly so stated in the claims.

**[0093]** In the arrangement of **Figure 5D**, the sixth gear **546** is integral to the cam body **550**. Thus, as the gear **546** turns, the cam body **550** is also turned **550**. The cam body **550** has a cam surface **552**. The cam surface **552** has a sinusoidal profile. An actuation arm **555** resides along the cam surface **552**, but is connected to the canister **210B**. Those of ordinary skill in the intuitive arts will understand that as the cam **550** rotates with its cam surface **552**, the actuation arm **555** will be cyclically depressed and released. Depression of the actuating arm **555** causes the shoulder **212** of the canister **210B** to be depressed, momentarily releasing pressurized behavior modification fluid through the nozzle **215**.

**[0094]** Based on the above description of the pet spray training system **100** and electric motor modules **230, 530**, methods for modifying the behavior of an animal is offered herein. In

one embodiment, a method first includes providing a spray training system. The spray training system may be arranged in accordance with any of the embodiments described above. Of interest, the spray training system will have a canister containing a pre-pressurized fluid. The spray training system also includes an electrical motor module configured to cause the pre-pressurized fluid to be released from the canister in response to an electrical signal from a signal filter and processor (120, 130 and/or 140).

**[0095]** The electric motor module comprises a drive shaft, and then one or more gears making up a gear assembly. Rotation of the shaft induces a turning of the gears within a gear assembly, which ultimately converts rotational movement into a linear movement. The linear movement produces a momentary downward force to a shoulder associated with a spray nozzle on the canister.

**[0096]** In one embodiment, the linear movement is produced in a motor arm. The motor arm, in turn, causes a pivoting actuation arm to depress the spray nozzle associated with the canister. This briefly releases a bark deterrent fluid from the canister. Thereafter, the motor module reverses the rotational direction of the shaft, causing the elongated motor arm to reverse linear course and to return to its original position. This, in turn, pivots the actuation arm back to its resting position, wherein the spray nozzle is closed and bark deterrent fluid is no longer released. Alternatively, the reversal of the motor module may be accomplished through the contact and actuation of an electric switch positioned in the path of the moving actuation arm. Alternatively still, the elongated arm is returned to its original position by continuing to rotate the last gear 262 in accordance with a rack-and-pinion arrangement.

**[0097]** In another embodiment, the linear movement is produced by means of a cam body having a cam surface. Rotation of the cam surface against a transverse actuation arm associated with the spray nozzle causes a cyclical depression of the nozzle. Note that this is not a pumping action.

**[0098]** The method next includes securing the pet spray training system 100 to a collar. As noted above, a collar is shown at 600, affixed to a dog 650. Securing the system 100 to a collar

**600** of a dog **650** preferably comprises connecting the housing **300** to the collar **600**. The system **100** is positioned so that as the stream of bark deterrent fluid is released from the spray nozzle **166**, the fluid affects the dog's senses, such as smell. Of course, the collar **600** may represent a harness as well.

**[0099]** In one aspect, the bark deterrent fluid comprises a solution that is offensive to one or more senses of a dog. For example, the fluid may contain a component that presents an offensive smell. In another example, the fluid contains a component that temporarily stimulates the dog's senses of smell, hearing or touch. For example, the stimulant may be a deterrent fluid that mildly irritates the dog's eyes or nose.

**[00100]** In one aspect, the pet spray training system **100** further comprises a speaker **610**. The speaker **610** is configured to emit a sound that emulates a spray of fluid. The sound is emitted in response to conditioned electrical signals from the signal conditioning **130** indicative of the bark of a dog. In this instance, the sense will be the sense of hearing.

**[00101]** In one embodiment, the method also includes removing a first canister **162** from the fluid intake when the bark deterrent fluid is substantially exhausted, and then replacing the canister with a second canister having also a bark deterrent fluid.

**[00102]** In one embodiment, the method further comprises adjusting the spray nozzle. Adjusting the spray nozzle may mean adjusting the nozzle to create a fine mist or, alternatively, a heavy fluid stream of the bark deterrent fluid.

**[00103]** In one aspect, the pet spray training system **100** further comprises a remote transmitter (seen in **Figure 1** at **150**) The remote transmitter **150** is configured to send a wireless activation signal in response to manual actuation by a trainer or pet owner. The signal is sent to a receiver **155** associated with the system **100**.

**[00104]** **Figure 6** illustrates use of the pet spray training system **100** of **Figure 1**, with a remote transmitter. The remote transmitter **150** is intended to be held and used by an owner or

trainer (not shown). In this arrangement, the system **100** is shown secured to a collar **600** placed around the neck of a dog **650**.

**[00105]** In this instance, the system **100** will further include the receiver **155** configured to receive wireless activation signals sent manually by the operator of the remote transmitter **150**, and in response generate an electrical behavior modification signal. The signal activates the motor module **164**, which in turn activates the actuation arm that then releases pressurized fluid from the first canister **162**. This, in turn, causes a stream of the bark deterrent fluid to be released through the spray valve **166** and through the opening **515**.

**[00106]** Button **152** is shown in **Figure 6**, indicating a button **152** that may be pushed by the pet owner or trainer to manually and remotely actuate the motor module **164**. Pushing button **152** sends a bark deterrent signal, which ultimately causes the canister **162** to emit the deterrent spray through the valve **166** and the through-opening **515**.

**[00107]** In one embodiment, the pet spray training system **100** further comprises a second canister **168**. The second canister **168** contains a behavior reinforcement fluid. The behavior reinforcement fluid comprises a solution or otherwise contains a component that is pleasing to a dog's sense of smell. The first canister **162** is removed from the housing **300**, and the second canister **168** is installed in the slot **335**.

**[00108]** In this instance, the system **100** may again include a remote transmitter **150** configured to send a wireless activation signal in response to manual actuation, and a receiver **155** configured to receive the wireless activation signal. Here, the wireless activation signal is a behavior reinforcement signal. Pushing button **154** sends a behavior reinforcement signal, which ultimately causes the spray mechanism **160** to emit the reinforcement spray through the nozzle or valve **166**.

**[00109]** In response to the signal, an electrical behavior modification signal is sent to the motor module **164**. Here, the electrical motor **164** is configured to operate for a time to depress the spray nozzle **166** and to release fluid pressurized from the second canister **168**. This, in turn, causes a stream of the behavior reinforcement fluid to be released through the spray nozzle **166**.

**[00110]** In one arrangement, each of the canisters (or tanks) **162, 168** is fabricated from a biodegradable material, such as a bioplastic. Examples include cellulose esters, polybutylene succinate (PBS), polyanhydrides, polyhydroxyalkanoates (PHA's), lignin based plastics and polylactic acid (PLA).

**[00111]** Variations of the method for modifying the behavior of an animal using a behavior modification system may fall within the spirit of the claims, below. For example, in one embodiment the pet training system may be set up as two different components, with one component housing the tank(s) **162, 168** and associated motor module **164**, and another component housing the sound detection device and associated signal processing circuitry.

**[00112]** **Figure 7** illustrates a pet training system **700** in such an alternative embodiment. Here, the pet training system **700** includes a remote transmitter **701** housed separately and apart from the collar mounted spray system **702**. The remote transmitter **701** includes a sound detector **705**, in the form of a microphone. The remote transmitter **701** is configured to send a wireless activation signal in response to the detection of recognized frequencies characteristic of the bark of a dog or other designated sound. The wireless activation signal is received by the collar mounted spray system **702**, which then automatically actuates the electrical motor **164** to release fluid from the canister **162**. This, in turn, causes a stream of the bark deterrent fluid to be automatically released through the spray nozzle **166**. Thus, a person does not have to be present to active the remote transmitter **701**. Accordingly, the remote transmitter may be placed in an area wherein the dog is taught not to bark such as a bedroom, office or nursery. At the same time, the dog's bark does not activate the system should the barking occur outside the range of the remote transmitter.

**[00113]** In a related arrangement, all components of the pet spray training system are housed in a single remote housing that is apart from an animal collar. **Figure 8** illustrates a pet training system **800** in such an alternative embodiment. The pet training system **800** is separate and apart from the pet **650** to be trained and is therefore referenced herein as stationary or free-standing even though it may be moved to different locations.

**[00114]** The system **800** is similar to the previously disclosed system **700** except that it is not coupled to a collar worn by the pet **650**. This is ideal for pets who do not wear a collar. Here, the system **800** includes a sound detector **805** in the form of a microphone and filter. The microphone **805** is configured to send an activation signal in response to the detection of recognized frequencies characteristic of the bark of a dog or other designated sound. The activation signal automatically actuates the electrical motor **164** to depress a spray nozzle **166** associated with the canister **162**. This, in turn, causes a stream of the pressurized bark deterrent fluid to be automatically released through the spray nozzle **166**. Thus, a person does not have to be present to activate the system **800**.

**[00115]** The system **800** may be placed in an area wherein the dog is taught not to bark. Examples again include a nursery or a bedroom. Other examples include a kitchen, an office, a dining room or at the front door. The dog's bark does not activate the system should the barking occur outside the range of the microphone **805**. In the arrangement for the system **800**, components are all held within a single housing **820**.

**[00116]** In another embodiment, an pet spray training system in the form of a spray trainer may be used to deter a pet from entering an area. The area may be, for example, a bed, a couch, a kitchen, a table top or an item of furniture. **Figures 9** and **10** demonstrate embodiments of such spray training systems.

**[00117]** First, **Figure 9** illustrates another pet training system **900** wherein the training system **900** is separate and apart from the pet **650** to be trained. Such a system is similar to system **800** of **Figure 7** in that it is portable and free-standing. In this instance, again, the pet **650** need not wear a collar. The system **900** may be moved from room-to-room or even packed and taken with the owner in a car to a new location.

**[00118]** Instead of a sound detection system, the system **900** includes a motion sensor **901**. The motion sensor **901** is configured to sense the proximity of the pet **650**. The system again includes a housing **920** to which the motion sensor **901** is mounted. The motion sensor **901** sends an activation signal in response to the detection of animal movement in the area of the

system. The system **100** of **Figure 1** demonstrating a sensor **110** along with an optional amplifier **120**, signal conditioner **130** and processor **140** is applicable to a motion sensor and its resulting electrical signal.

**[00119]** The system also includes a canister **162**. The canister **162** is again configured to hold a deterrent fluid at positive pressure. The deterrent fluid may include a fragrance or chemical that is offensive to one or more senses of the pet. The canister **162** is further configured to reside on a surface, such as a table or a counter. In this embodiment, the system is not secured to the animal itself by means of a collar; rather, the system is free-standing and resides in the area from which the pet **650** is to be deterred from entering.

**[00120]** The system additionally includes a motor module and a gear assembly as previously described. The motor module **164** is electrically coupled to the motion sensor **110** and is in fluid communication with the canister. The motor module **164** depresses a spray nozzle **166** associated with a canister **162** for releasing, or discharging, a stream of the deterrent fluid in response to the electrical signals.

**[00121]** Ideally, the system **900** is placed in an area wherein the dog **650** is taught not to enter, while the dog's movement does not activate the system **900** outside the range of the motion detector **901**. In this manner, the dog **650** is taught not to enter select areas of a home or other space.

**[00122]** **Figure 10** illustrates a pet training system **1000** in a related alternative embodiment. Here, the system **1000** again includes a motion detector **1005**. The pet training system **1000** also includes a remote transmitter **1001**. The motion detector **1005** and the transmitter **1001** are housed separately and apart from the collar **600** with the mounted spray system **1002**. A housing for the motion detector **1005** and the transmitter **1001** is shown at **1020**.

**[00123]** In operation, the remote transmitter **1001** sends a wireless activation signal in response to the detection of pet movement by the motion sensor **1005**. The wireless activation signal is received by the collar mounted spray system **1002** which then automatically actuates the electrical motor to activate a motor module **164** for a period of time and cause a spray nozzle **166**

associated with the canister **162** to be depressed. The period of time may be, for example, 1 to 5 seconds, or 2 to 3 seconds. This, in turn, causes an emission of the deterrent fluid through the spray nozzle **166** associated with the collar **600**. Thus, a person does not have to be present to activate the remote transmitter **1001**. Accordingly, the remote transmitter may be placed in an area wherein the dog is taught not to enter, while the dog's movement does not activate the system **1002** should the movement occur outside the range of the remote transmitter **1001**. In this manner, the dog **650** is taught not to enter only select areas of a home.

**[00124]** In one aspect of the pet training system **1000**, either the housing **1020** or the collar **600** includes a speaker (shown at **610** in **Figure 1**). The speaker **610** may emit ultrasonic sound waves audible only to the dog **650**. The sound waves serve as a bark deterrent. Alternatively, the speaker **610** simulates the sound of the spray nozzle to elicit a Pavlovian stopping of the barking.

**[00125]** **Figure 11** illustrates the pet spray training system **1100** in a form of the present invention. The pet training system **1100** is intended to reside on the collar placed upon a dog or as a stand-alone structure.

**[00126]** The pet spray training system **1100** has an external housing or receiver **300** that partially defines an interior holding compartment or chamber **1113**. The housing **300** has a pivotal cover or door **330** which opens to expose the interior holding chamber **1113** through a canister opening **1115** and closes to enclose the interior holding chamber **1113**, as shown in **Figure 12**.

**[00127]** The housing **300** houses a DC motor or motor module **164** and a DC battery **1120** which is electrically coupled to the motor **164**. The motor **164** has a geared shaft **1120** which meshes with a series of gears or gear assembly **260**. The gear assembly **260** and any ancillary structure coupled thereto may be considered to be a mechanical assembly, which may alternatively be configured in other conventionally known forms, such as those using levers, cams, gears or a combination of such. The gears **260** are mechanically coupled to a tubular plunger **1124** or alternatively previously described pivotal actuator arm or camming system

including the final cam **1125** which is best shown in **Figure 16**. The plunger **1124** is generally cylindrical with a central channel or passage **1126** extending from a lower end or opening **1128** to an upper end or opening **1130**. The upper end **1130** is in the form of a spray nozzle **1132** to create a spray, mist or gas vapor.

**[00128]** The pet spray training system **1100** has an electric circuit **220** coupled to the motor **164** that includes a bark sensor **110** and an on/off switch **1140** which includes a light **1142** to indicate select conditional statuses, such as low gas condition, on condition, etc. The bark sensor **110** may be any system that is responsive to the bark of the dog. In one embodiment, the bark sensor **110** is a piezoelectric vibration sensor that is in contact with the dog for measuring vibrations produced by the dog. The piezoelectric sensor is a low current device used for detecting the barking of a dog. In one aspect, the bark sensor **110** is placed in contact with the throat of the dog so as to measure vibrations produced by the vocal cords of the dog. Such an embodiment is described in detail in U.S. Pat. Nos. 9,943,067 entitled "Pet Spray Training System"; and 6,668,760 entitled "Spray Control Anti-Bark Collar", the entirety of which is incorporated herein by reference in its entirety.

**[00129]** As an alternative, the bark sensor **110** is a microphone. The microphone is configured to receive sound frequencies emitted in proximity to the dog collar. In response, the microphone generates electrical signals.

**[00130]** The electrical signals are taken through a conditioning process, which may include amplification. The amplifier is coupled to the bark sensor **110** and amplifies the output of the vibration (or sound) bark sensor **110** to increase the level of the sensor output for further processing and more accurate sampling. The conditioned signal may be used to output a sound through a speaker **1174** as previously described.

**[00131]** The circuit **220** may also optionally include further signal conditioning of the output of the amplifier. The signal conditioning circuit serves to discriminate among the vibrations or sound frequencies measured by the bark sensor **110** so as to pass only measured vibrations or

frequencies that meet specified criteria. For example, the signal conditioning circuit may be configured to filter out frequencies not indicative of the bark of a dog, or to pass only those vibrations occurring within a specified frequency range or those meeting certain durational limits. The signal conditioning circuit may be configured to remove unwanted components of the sensor output. Those skilled in the art will recognize the various filters, amplifiers and other signal conditioning devices that can be used to prepare the measured frequencies or vibrations for further processing. Those skilled in the art will also recognize that the type of signal conditioning depends upon the input signal, the corresponding sensor and the desired characteristics of the input signal that are to be monitored. For example, the signal conditioning or filter may be active or passive and may be set to pass a specific frequency range or to remove high or low frequency noise. Further, depending upon the various components used, the output signal may not require additional amplification. Finally, other conditioning may be required to present a useable sensor output to the remainder of the circuit.

**[00132]** The pet spray training system **1100** also includes a removable and replaceable pressurized gas reservoir **1150** which is configured to be received within the interior holding chamber **1113**. The replaceable reservoir **1150** includes a reservoir housing **1152** having an upper portion **1154** and a lower portion **1156** welded to the upper portion **1154**. The upper portion **1154** has a nozzle opening **1155** there through. The lower portion **1156** has a generally cylindrical valve mount **1158** configured to receive a valve assembly **1160** therein. The valve assembly **1160** is in fluid communication with a pressurized gas canister or canister portion **1162** positioned within the replaceable reservoir **1150** and containing a bark deterrent gas. Alternatively, the interior of the replaceable reservoir **1150** may be pressurized with the bark deterrent gas so that the replaceable reservoir does not require a separate canister.

**[00133]** The valve assembly **1160** has a generally cylindrical and tubular valve housing **1164** configured to receive a depressible, elongated nozzle **1166** which is biased upwardly, in reference to the drawings, by a spring **1168** mounted within the valve housing **1164**. The elongated nozzle **1166** is configured to extend through nozzle opening **1155** in the reservoir

housing upper portion **1154** and be received within the lower end **1128** of the central passage **1126** of the plunger **1124**.

**[00134]** Lastly, the replaceable reservoir **1150** includes a circuitry in the form of a printed circuit board assembly (PCBA) **1170** coupled to the upper portion **1154** of the reservoir housing **1152**. The PCBA **1170** may be coupled to the housing through deformable staked pins, or any other conventionally known mounting means. The PCBA **1170** has circuitry which accumulates and stores data which allows for the reservoir **1150** to monitor the current deterrent gas capacity in terms of the number of spray actuations and durations.

**[00135]** In use, the deterrent gas filled replaceable reservoir **1150** is positioned within the interior chamber **1113** with the nozzle **1166** positioned within the lower end **1128** of the plunger **1124**, as best shown in **Figure 12**. The door **330** is closed to maintain the position of the reservoir **1150**.

**[00136]** Should the dog bark, the sensor **110** receives the vibration input or sound input and generates a signal to the circuit **130/220**. In turn, the circuit **130** energizes the motor module **164** which actuates the gear assembly **260** to move the plunger **1124** linearly downwardly (axial force) against the nozzle **1166** through the movement of the cam **1125**. The downward movement or depressing of the nozzle **1166** causes an actuation of the valve assembly **1160** which causes the release of bark deterrent gas from the canister portion **1115** upon reaching a predetermined trigger point to release the gas. The deterrent gas passes through the nozzle **1166** and through the central passage **1126** of the plunger **1124**. The gas is emitted as a spray from the spray nozzle **1132** of the plunger **1124**. The circuit **130** then reverses the process to cause the valve assembly **1160** to return the nozzle **1166** to its original position through the biasing force of spring **1168**.

**[00137]** The circuit or PCBA **1170** records the actuation and duration of the deterrent spray through the actuation of the motor. The number of actuations and durations of the deterrent spray are maintained so that the PCBA **1170** can determine when the reservoir **1150** should be

depleted of the deterrent gas and replaced. When the threshold limit or calculated depletion of deterrent gas is reached, the circuit may illuminate the indicator light **1142** (with a different color to differentiate an on condition from a low gas condition) or produce an audio signal to indicate the depletion through the speaker **1174**.

**[00138]** To replace the reservoir **1150**, a user simply opens the pivotal door **330** and removes the depleted reservoir **1150** from the interior chamber **1113** through canister opening **1115**. A new, fully charged or gas filled reservoir **1150** may then be inserted into the interior chamber **1113**. The new reservoir **1150** has a PCBA **1170** which starts the actuation count and duration over again.

**[00139]** It should be understood that the removable reservoir **1150** is a self-contained unit which is not intended to be rechargeable or refillable by a user, although the removable reservoir **1150** may be refilled at a manufacturer location or the like. The PCBA **1170** associated with each reservoir **1150** records the number of actuations and durations for purposes of determining when the reservoir **1150** is depleted. Therefore, the PCBA **1170** is not intended to be reset or reprogrammed by the user. This complete replacement of the reservoir **1150** maintains an accurate calculation of the deterrent gas. This also allows for a quick and easy replacement of the replaceable reservoir **1150** without the problems associated with manually refilling the reservoir with a deterrent gas.

**[00140]** The pet spray training system **1100** may also, as an alternative, be controlled through a wireless receiver **155** and transmitter **150**, as previously described. As such, the pet training system **1100** may or may not include the bark sensor, as controlled release of the spray from the pressurized gas reservoir **1150** may be controlled remotely through the use of the wireless receiver **155** and transmitter **150** rather than, or in addition to, the actual sensing of a bark.

**[00141]** An pet spray training system **1100** of an embodiment is comprising an external housing defining a gas reservoir holding chamber **1113**, a sound sensor **110**, an electrical circuit **130** electrically coupled to the sound sensor **110** which processes electrical output signals to determine whether the sound sensor **110** has sensed the bark of a dog, a motor **164** electrically

coupled to the electrical circuit **130**, a battery **1120** electrically coupled to the motor **164**, and a gear assembly **260** coupled to the motor **164**. The pet spray training system **1100** also includes a pressurized gas reservoir **1150** containing a bark deterrent fluid under pressure, the pressurized gas reservoir **1150** being removably mounted within the external housing reservoir holding chamber **1113**, the gas reservoir **1150** having a gas reservoir housing **1152**, a nozzle **1166** coupled to a release valve **1158** mechanically coupled to the gear assembly **260** for actuation of the release valve **1158** in response to the electrical circuit **130** determining a bark has been detected by the sound sensor **110**.

**[00142]** The pet spray training system **1100** also comprises the pressurized gas reservoir **1150** including a gas reservoir circuit **1170** which is configured to record the number of actuations of the pet spray training system.

**[00143]** The pet spray training system **1100** also comprises the gas reservoir circuit **1170** also records the duration of the actuation of the pet spray training system.

**[00144]** The pet spray training system **1100** also comprises a tubular plunger **1124** mechanically coupled to the gear assembly, the tubular plunger having a channel **1126** there through extending from a plunger bottom opening **1128** to a plunger top opening **1130**. The nozzle **1166** of the pressurized gas reservoir is mounted within the plunger bottom opening **1130**.

**[00145]** The pet spray training system **1100** also comprising the plunger **1124** being mounted for reciprocal movement relative to the external housing. The inward movement of the plunger **1124** actuates the release valve **1160**.

**[00146]** The pet spray training system **1100** also comprising the gas reservoir housing **1152** having a tubular valve mount **1158** configured to receive the release valve **1160** therein.

**[00147]** The pet spray training system **1100** also comprising the gas reservoir housing **1152** has a nozzle opening **1155** there through. The nozzle **1166** extends through the nozzle opening **1155** of the gas reservoir housing **1152**.

**[00148]** An pet spray training system **1100** is comprising a receiver housing having an internal gas reservoir holding chamber **1113**, a sensor **110** configured to produce electrical output signals in response to the sensing of a noise, an electrical circuit **130** electrically coupled to the sensor, the electrical circuit processes the electrical output signals from the sensor to determine whether the sensor has sensed the bark of a dog. The pet spray training system also includes a motor **164** electrically coupled to the electrical circuit, a battery electrically coupled to the motor, a mechanical assembly **260** coupled to the motor, a pressurized gas reservoir containing a bark deterrent fluid under pressure. The pressurized gas reservoir **1150** is removably mounted within the internal gas reservoir holding chamber. The pressurized gas reservoir has a gas reservoir housing **1152**, a nozzle , **1166** a release valve **1158** in fluid communication with the nozzle and actuateable by the mechanical assembly upon actuation of the motor.

**[00149]** An pet spray training system **1100** is comprising a receiver housing, a bark sensor **110**, a processor **130** coupled to the bark sensor, a motor **164** electrically coupled to the processor, a battery **1120** electrically coupled to the motor and the processor, and a mechanical assembly **260** coupled to the motor. The pet spray training system also includes a pressurized gas reservoir **1150** containing a pressurized bark deterrent gas, the pressurized gas reservoir being removably mounted within the receiver housing. The pressurized gas reservoir has a gas reservoir housing **1152**, a nozzle **1166**, a release valve **1158** in fluid communication with the nozzle. The release valve is actuated by the mechanical assembly upon actuation of the motor in response to the bark sensor and processor sensing a dog's bark.

**[00150]** An pet spray training system **1100** is comprising an external housing defining a gas reservoir chamber, a wireless receiver, an electrical circuit electrically coupled to the wireless receiver which processes electrical output signals from the wireless receiver, a motor **164** electrically coupled to the electrical circuit, a battery electrically coupled to the motor, a gear

assembly coupled to the motor, and a pressurized gas reservoir **1150** containing a bark deterrent fluid under pressure. The pressurized gas reservoir is removably mounted within the external housing gas reservoir chamber. The pressurized gas reservoir has a gas reservoir housing, a nozzle **1166** coupled to a release valve **1158** mechanically coupled to the gear assembly for actuation of the release valve in response to the electrical circuit receiving a signal from the wireless receiver.

**[00151]** An pet spray training system **1100** comprising a receiver housing, a wireless receiver, a processor **130** coupled to the wireless receiver, a motor **164** electrically coupled to the processor, a battery electrically coupled to the motor and the processor, a mechanical assembly coupled to the motor, and a pressurized gas reservoir **1150** containing a pressurized bark deterrent gas. The pressurized gas reservoir being removably mounted within the receiver housing. The pressurized gas reservoir having a gas reservoir housing **1152**, a release valve **1158** in fluid communication with the nozzle. Whereby, the release valve is actuated by the mechanical assembly upon actuation of the motor in response to the wireless receiver receiving a wireless signal.

**[00152]** It will be appreciated that the inventions are susceptible to modification, variation and change without departing from the spirit thereof.

## CLAIMS

We claim:

1. An pet spray training system, comprising:
  - an external housing defining a gas reservoir chamber;
  - a sound sensor;
  - an electrical circuit electrically coupled to the sound sensor which processes electrical output signals to determine whether the sound sensor has sensed the bark of a dog;
  - a motor electrically coupled to the electrical circuit;
  - a battery electrically coupled to the motor;
  - a gear assembly coupled to the motor;
  - a pressurized gas reservoir containing a bark deterrent fluid under pressure, the pressurized gas reservoir being removably mounted within the external housing gas reservoir chamber, the pressurized gas reservoir having a gas reservoir housing, a nozzle coupled to a release valve mechanically coupled to the gear assembly for actuation of the release valve in response to the electrical circuit determining a bark has been detected by the sound sensor.
2. The pet spray training system of claim 1 wherein the pressurized gas reservoir includes a gas reservoir circuit which is configured to record the number of actuations of the pet spray training system.
3. The pet spray training system of claim 2 wherein the gas reservoir circuit also records the duration of the actuation of the pet spray training system.
4. The pet spray training system of claim 1, wherein a tubular plunger is mechanically coupled to the gear assembly, the tubular plunger has a channel there through extending from a plunger bottom opening to a plunger top opening, and wherein the nozzle of the pressurized gas reservoir is mounted within the plunger bottom opening.

5. The pet spray training system of claim 4 wherein the plunger is mounted for reciprocal movement relative to the external housing, and wherein an inward movement of the plunger actuates the release valve.
6. The pet spray training system of claim 1, wherein the gas reservoir housing includes a tubular valve mount configured to receive the release valve therein.
7. The pet spray training system of claim 1, wherein the gas reservoir housing includes a nozzle opening there through, and wherein the nozzle extends through the nozzle opening of the gas reservoir housing.
8. An pet spray training system, comprising:
  - a receiver housing having an internal gas reservoir holding chamber;
  - a sensor configured to produce electrical output signals in response to the sensing of a noise;
  - an electrical circuit electrically coupled to the sensor, the electrical circuit processes the electrical output signals from the sensor to determine whether the sensor has sensed the bark of a dog;
  - a motor electrically coupled to the electrical circuit;
  - a battery electrically coupled to the motor;
  - a mechanical assembly coupled to the motor;
  - a pressurized gas reservoir containing a bark deterrent fluid under pressure, the pressurized gas reservoir being removably mounted within the internal gas reservoir holding chamber, the pressurized gas reservoir having a gas reservoir housing, a nozzle, a release valve in fluid communication with the nozzle and actuateable by the mechanical assembly upon actuation of the motor.

9. The pet spray training system of claim 8 wherein the pressurized gas reservoir includes a gas reservoir circuit which is configured to record the number of actuations of the pet spray training system.
10. The pet spray training system of claim 9 wherein the gas reservoir circuit also records the duration of the actuation of the pet spray training system.
11. The pet spray training system of claim 8, wherein a tubular plunger is mechanically coupled to the mechanical assembly, the tubular plunger has a channel there through extending from a plunger bottom opening to a plunger top opening, and wherein the nozzle of the pressurized gas reservoir is mounted within the plunger bottom opening.
12. The pet spray training system of claim 11 wherein the plunger is mounted for reciprocal movement relative to the receiver housing, and wherein the inward movement of the plunger actuates the release valve.
13. The pet spray training system of claim 8, wherein the gas reservoir housing includes a tubular valve mount configured to receive the release valve therein.
14. The pet spray training system of claim 8, wherein the gas reservoir housing includes a nozzle opening there through, and wherein the nozzle extends through the nozzle opening of the gas reservoir housing.
15. An pet spray training system, comprising:
  - a receiver housing;
  - a bark sensor;
  - a processor coupled to the bark sensor;
  - a motor electrically coupled to the processor;
  - a battery electrically coupled to the motor and the processor;
  - a mechanical assembly coupled to the motor;

a pressurized gas reservoir containing a pressurized bark deterrent gas, the pressurized gas reservoir being removably mounted within the receiver housing, the pressurized gas reservoir having a gas reservoir housing, a release valve in fluid communication with the nozzle,

whereby the release valve is actuated by the mechanical assembly upon actuation of the motor in response to the bark sensor and processor sensing a dog's bark.

16. The pet spray training system of claim 15 wherein the pressurized gas reservoir includes a gas reservoir circuit which is configured to record the number of actuations of the pet spray training system.

17. The pet spray training system of claim 16 wherein the gas reservoir circuit also records the duration of the actuation of the pet spray training system.

18. The pet spray training system of claim 15, wherein the pressurized gas reservoir includes a nozzle coupled to the release valve, and wherein a tubular plunger is mechanically coupled to the mechanical assembly, the tubular plunger has a channel there through extending from a plunger bottom opening to a plunger top opening, and wherein the nozzle of the pressurized gas reservoir is mounted within the plunger bottom opening.

19. The pet spray training system of claim 18 wherein the plunger is mounted for reciprocal movement relative to the receiver housing, and wherein the inward movement of the plunger actuates the release valve.

20. The pet spray training system of claim 15, wherein the gas reservoir housing includes a tubular valve mount configured to receive the release valve therein.

21. The pet spray training system of claim 18, wherein the gas reservoir housing includes a nozzle opening there through, and wherein the nozzle extends through the nozzle opening of the gas reservoir housing.

22. An pet spray training system, comprising:  
an external housing defining a gas reservoir chamber;  
a wireless receiver;  
an electrical circuit electrically coupled to the wireless receiver which processes electrical output signals from the wireless receiver;  
a motor electrically coupled to the electrical circuit;  
a battery electrically coupled to the motor;  
a gear assembly coupled to the motor;  
a pressurized gas reservoir containing a bark deterrent fluid under pressure, the pressurized gas reservoir being removably mounted within the external housing gas reservoir chamber, the pressurized gas reservoir having a gas reservoir housing, a nozzle coupled to a release valve mechanically coupled to the gear assembly for actuation of the release valve in response to the electrical circuit receiving a signal from the wireless receiver.
23. The pet spray training system of claim 22 wherein the pressurized gas reservoir includes a gas reservoir circuit which is configured to record the number of actuations of the pet spray training system.
24. The pet spray training system of claim 23 wherein the gas reservoir circuit also records the duration of the actuation of the pet spray training system.
25. The pet spray training system of claim 22, wherein a tubular plunger is mechanically coupled to the gear assembly, the tubular plunger has a channel there through extending from a plunger bottom opening to a plunger top opening, and wherein the nozzle of the pressurized gas reservoir is mounted within the plunger bottom opening.
26. The pet spray training system of claim 25 wherein the plunger is mounted for reciprocal movement relative to the external housing, and wherein an inward movement of the plunger actuates the release valve.

27. The pet spray training system of claim 22, wherein the gas reservoir housing includes a tubular valve mount configured to receive the release valve therein.

28. The pet spray training system of claim 22, wherein the gas reservoir housing includes a nozzle opening there through, and wherein the nozzle extends through the nozzle opening of the gas reservoir housing.

29. The pet spray training system of claim 22 further comprising a wireless transmitter in wireless communication with the wireless receiver.

30. An pet spray training system, comprising:

a receiver housing;

a wireless receiver;

a processor coupled to the wireless receiver;

a motor electrically coupled to the processor;

a battery electrically coupled to the motor and the processor;

a mechanical assembly coupled to the motor;

a pressurized gas reservoir containing a pressurized bark deterrent gas, the pressurized gas reservoir being removably mounted within the receiver housing, the pressurized gas reservoir having a gas reservoir housing, a release valve in fluid communication with the nozzle,

whereby the release valve is actuated by the mechanical assembly upon actuation of the motor in response to the wireless receiver receiving a wireless signal.

31. The pet spray training system of claim 30 wherein the pressurized gas reservoir includes a gas reservoir circuit which is configured to record the number of actuations of the pet spray training system.

32. The pet spray training system of claim 31 wherein the gas reservoir circuit also records the duration of the actuation of the pet spray training system.

33. The pet spray training system of claim 30, wherein the pressurized gas reservoir includes a nozzle coupled to the release valve, and wherein a tubular plunger is mechanically coupled to the mechanical assembly, the tubular plunger has a channel there through extending from a plunger bottom opening to a plunger top opening, and wherein the nozzle of the pressurized gas reservoir is mounted within the plunger bottom opening.

34. The pet spray training system of claim 33 wherein the plunger is mounted for reciprocal movement relative to the receiver housing, and wherein the inward movement of the plunger actuates the release valve.

35. The pet spray training system of claim 30, wherein the gas reservoir housing includes a tubular valve mount configured to receive the release valve therein.

36. The pet spray training system of claim 33, wherein the gas reservoir housing includes a nozzle opening there through, and wherein the nozzle extends through the nozzle opening of the gas reservoir housing.

37. The pet spray training system of claim 30 further comprising a wireless transmitter in wireless communication with the wireless receiver.

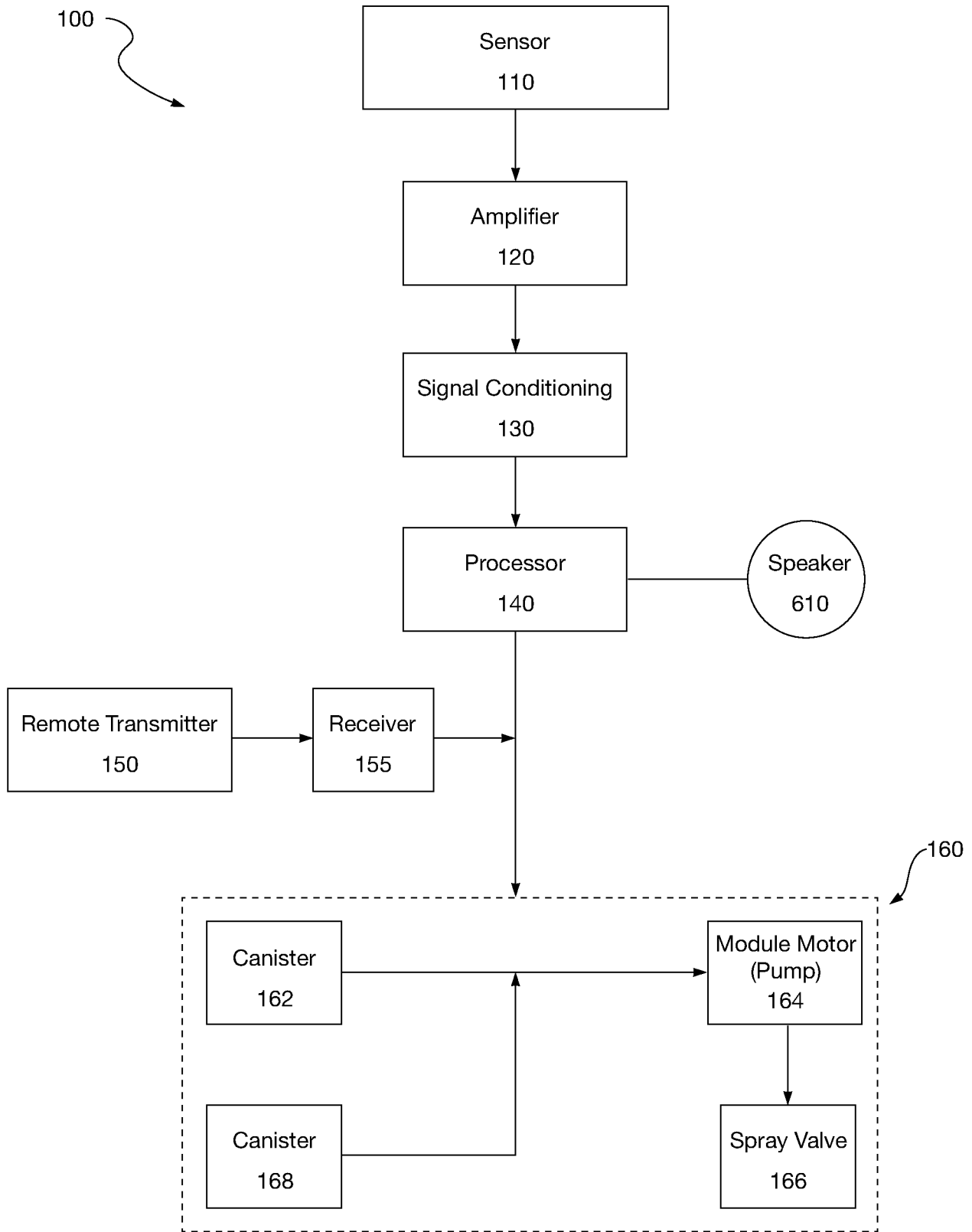

Fig. 1

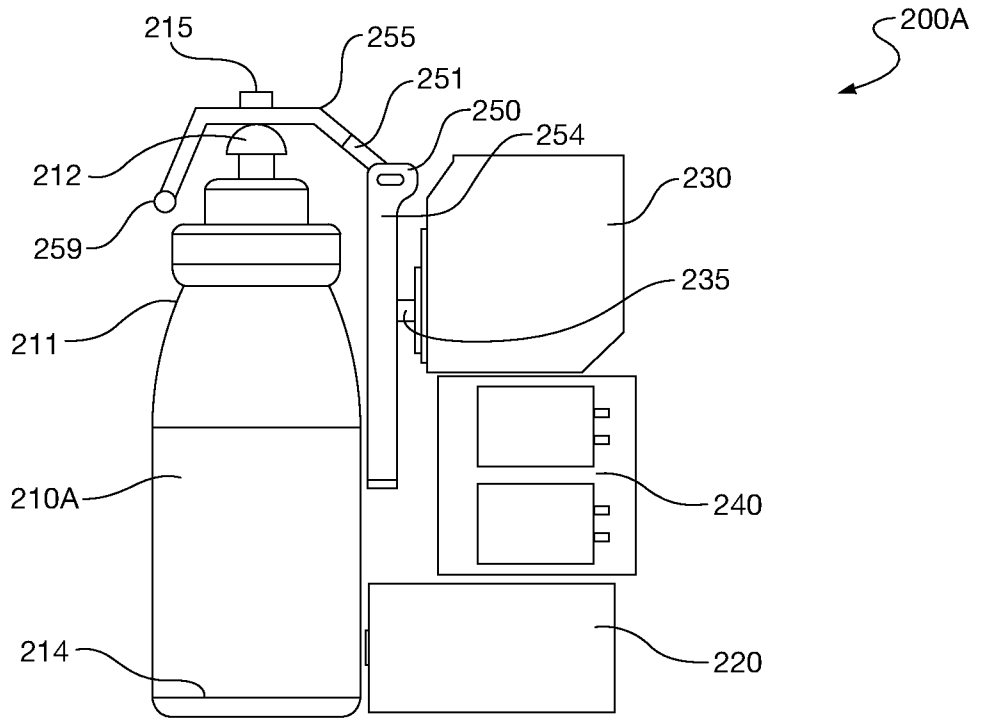

Fig. 2A

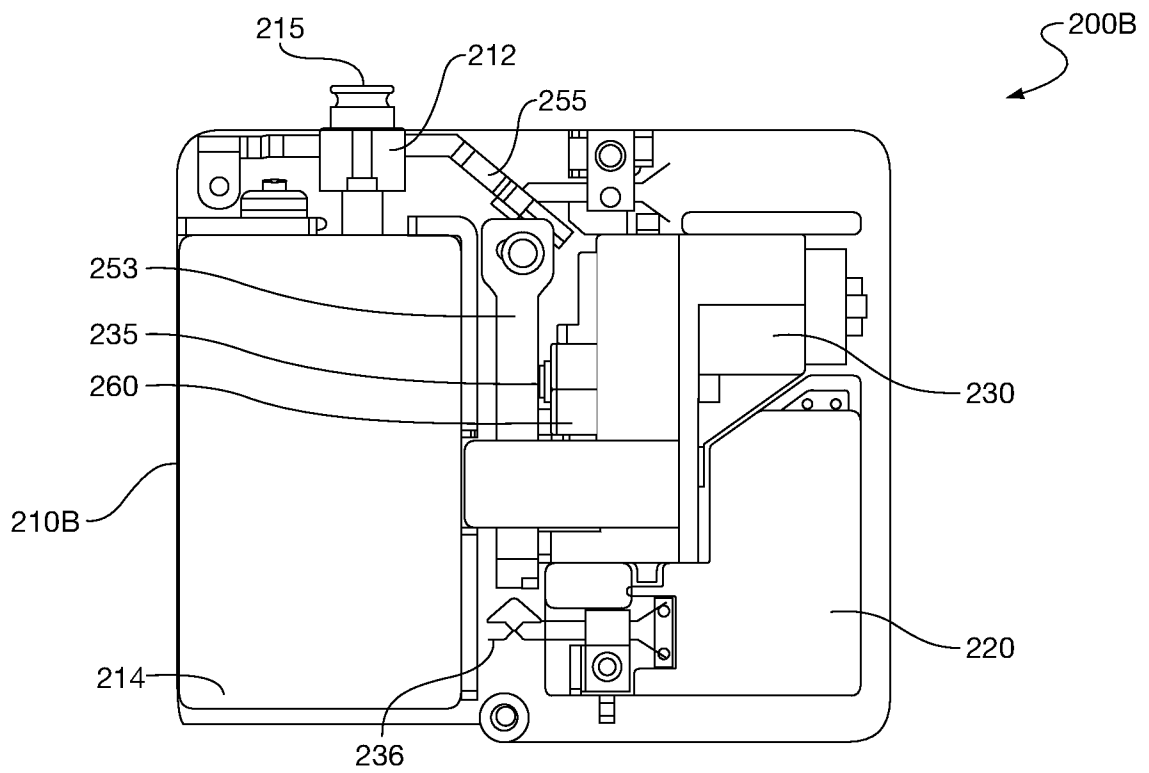

Fig. 2B

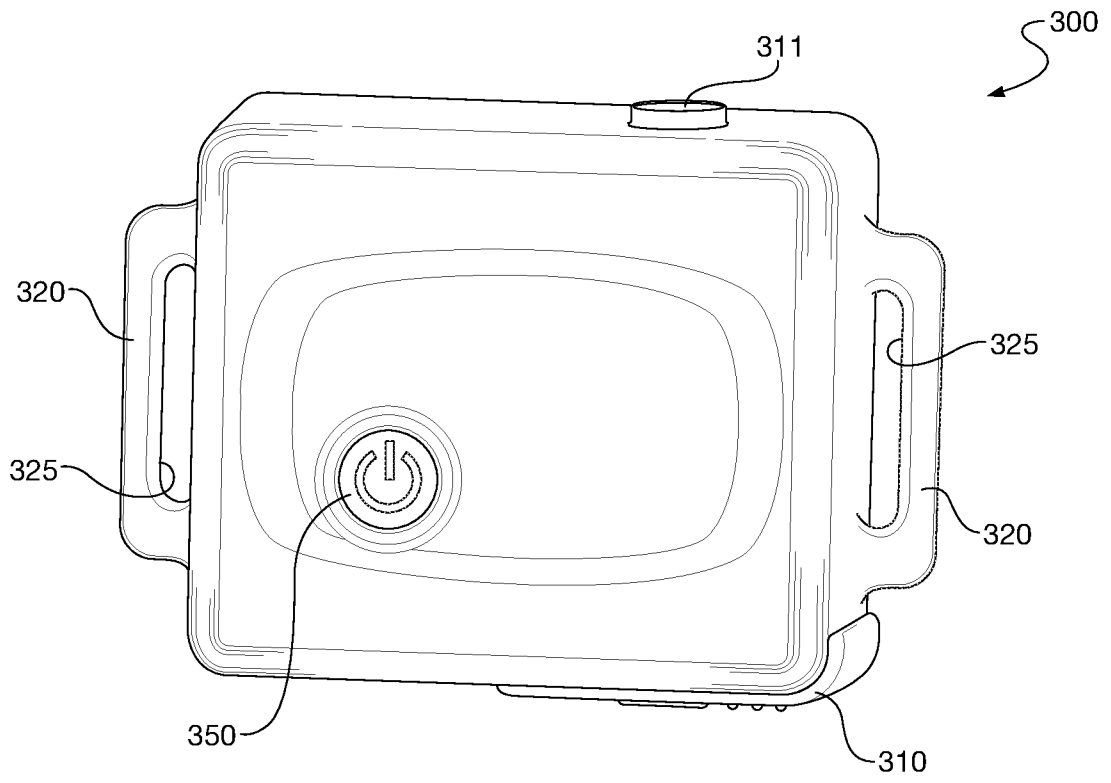

Fig. 3A

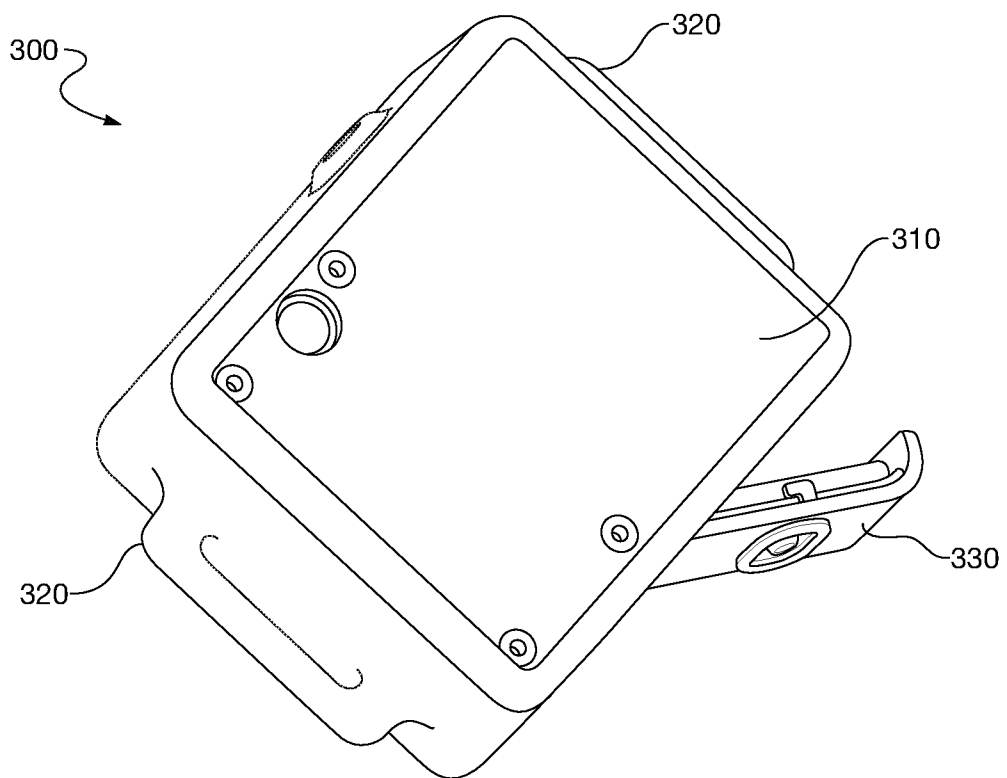

Fig. 3B

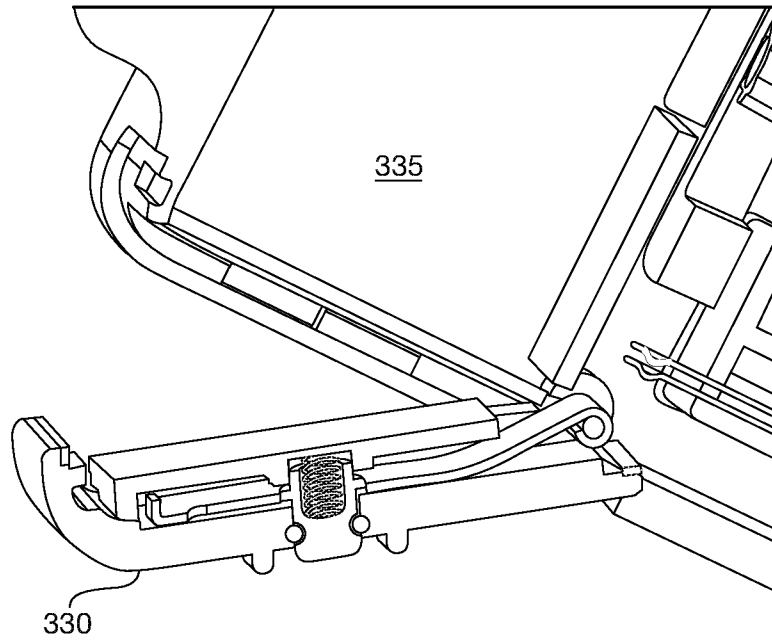

Fig. 3C

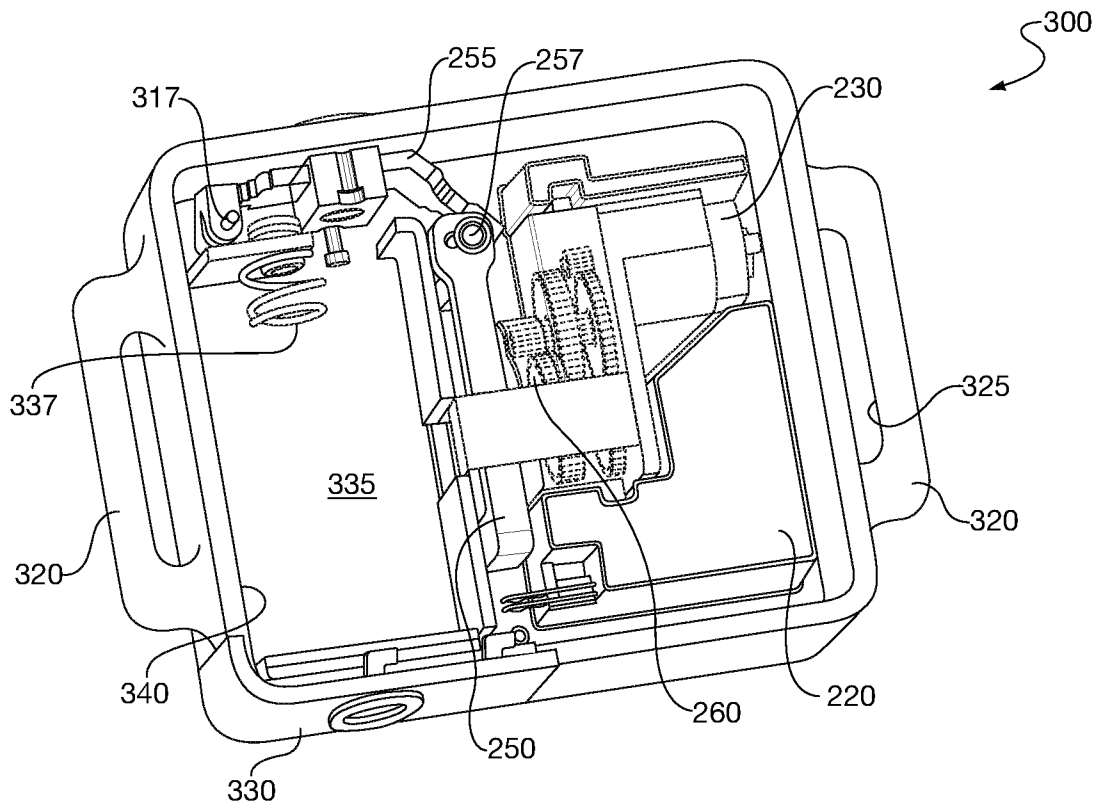

Fig. 4A

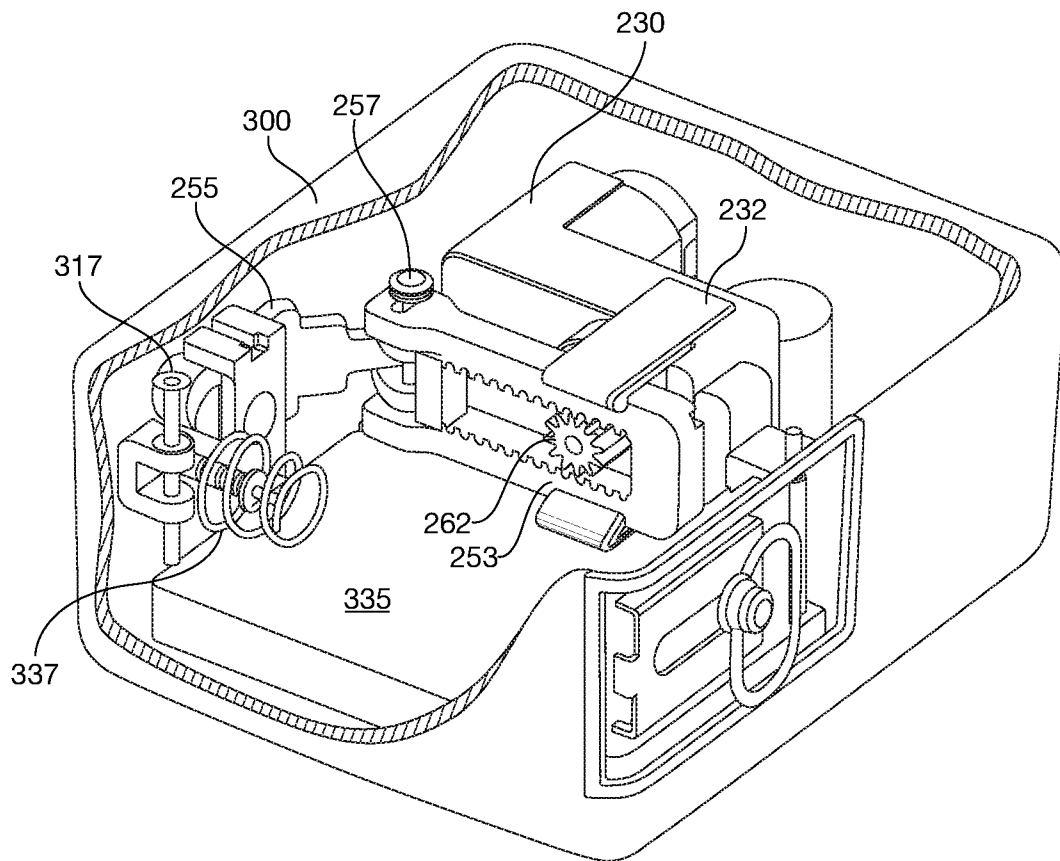

Fig. 4C

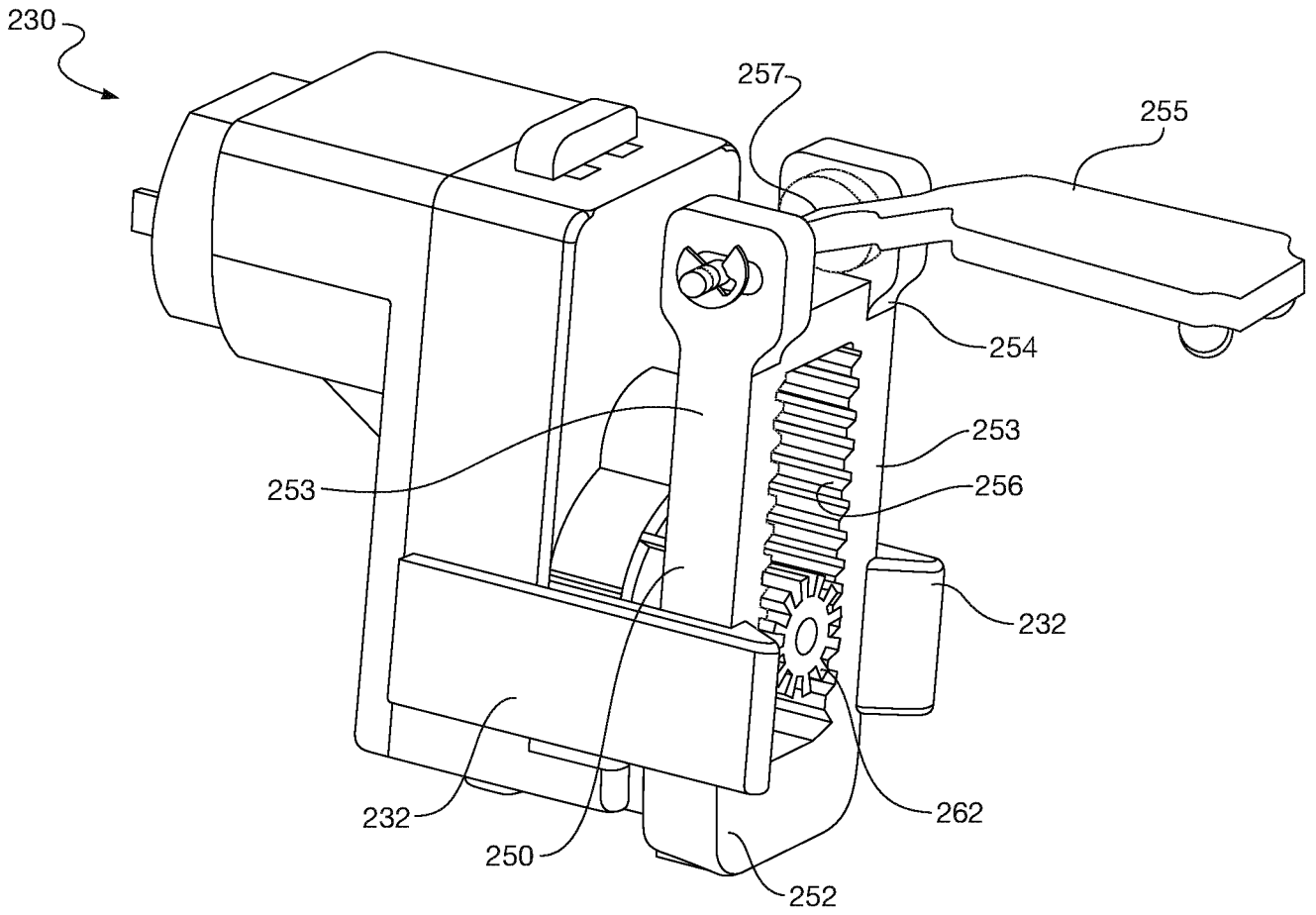

Fig. 4B

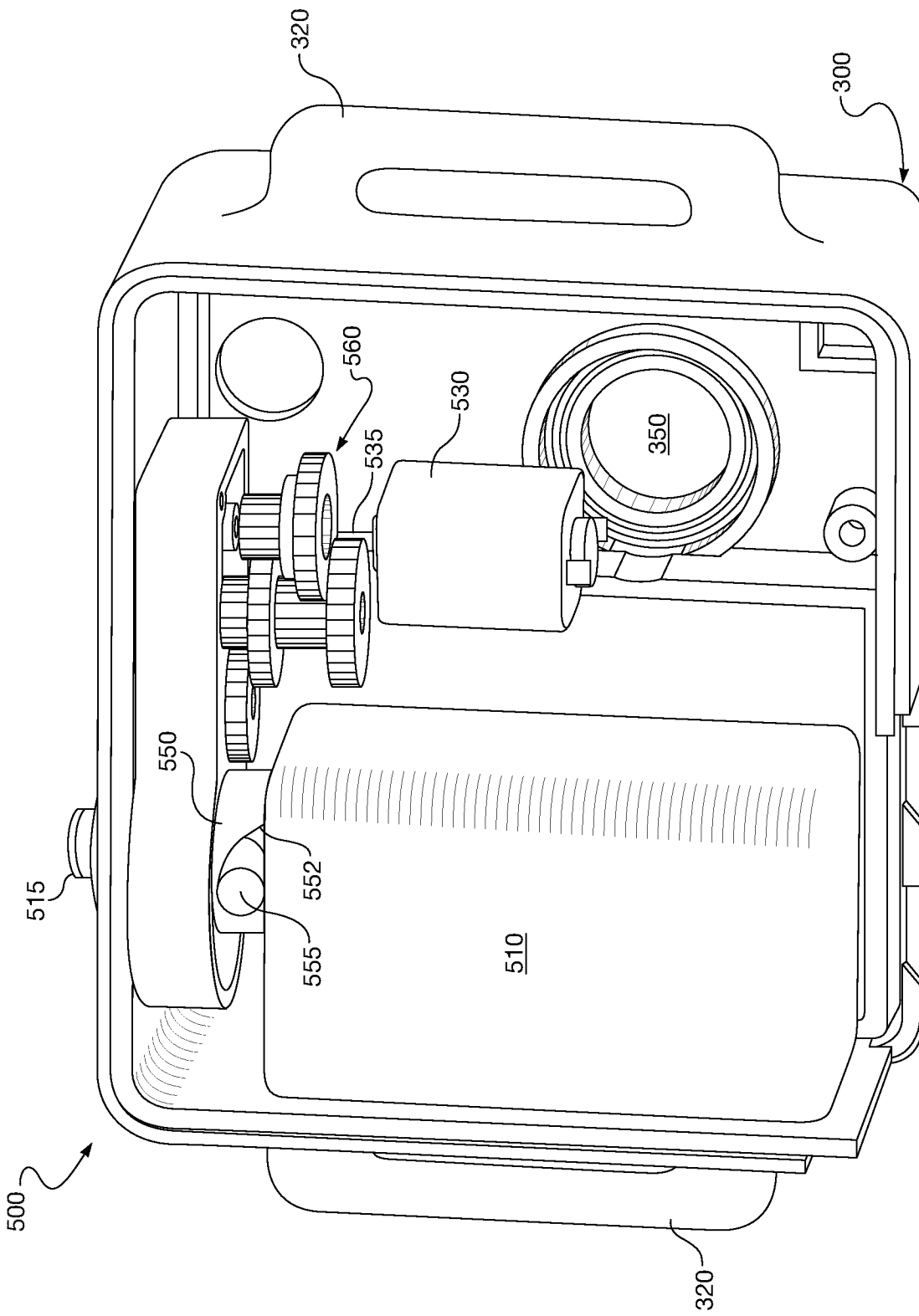

Fig. 5A

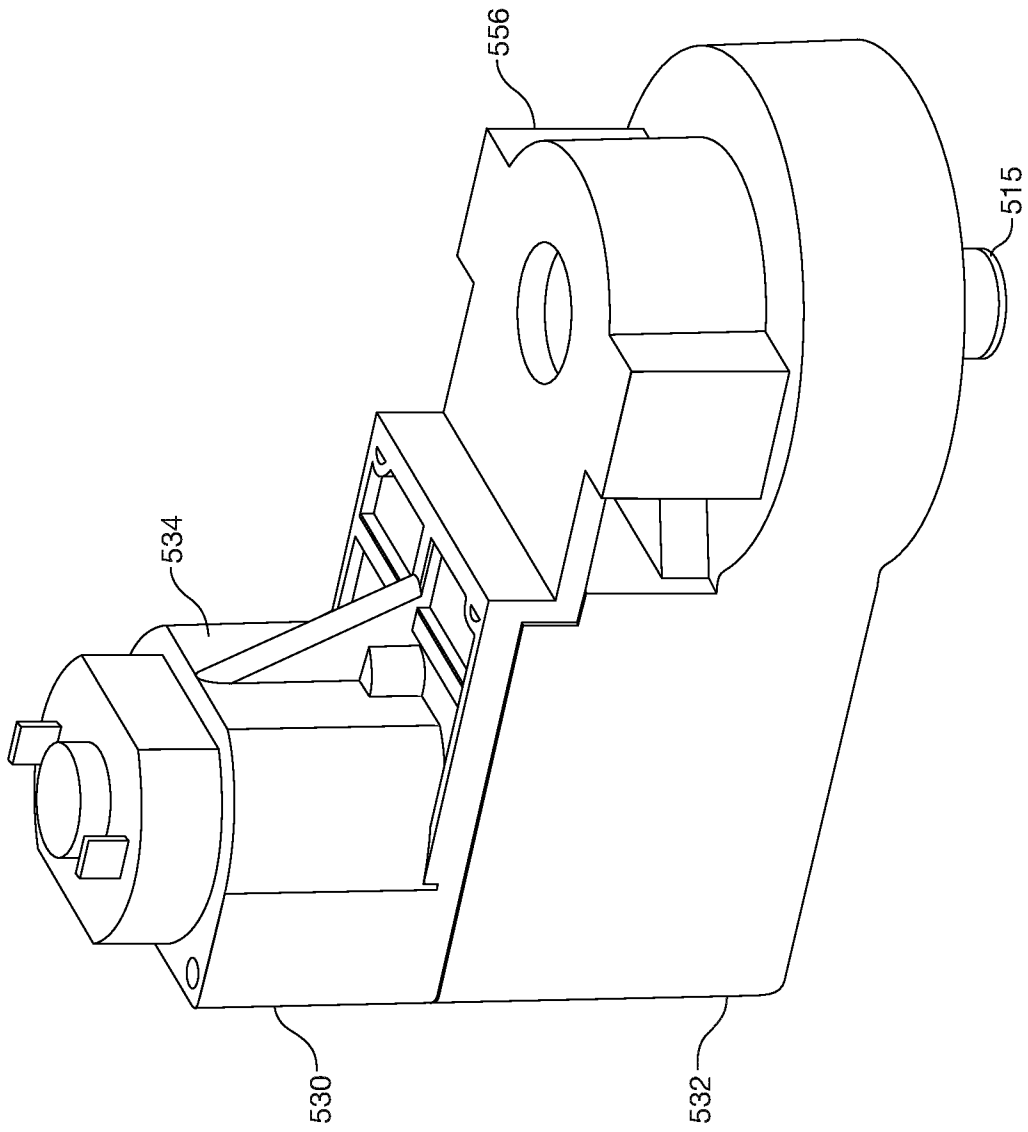

Fig. 5B

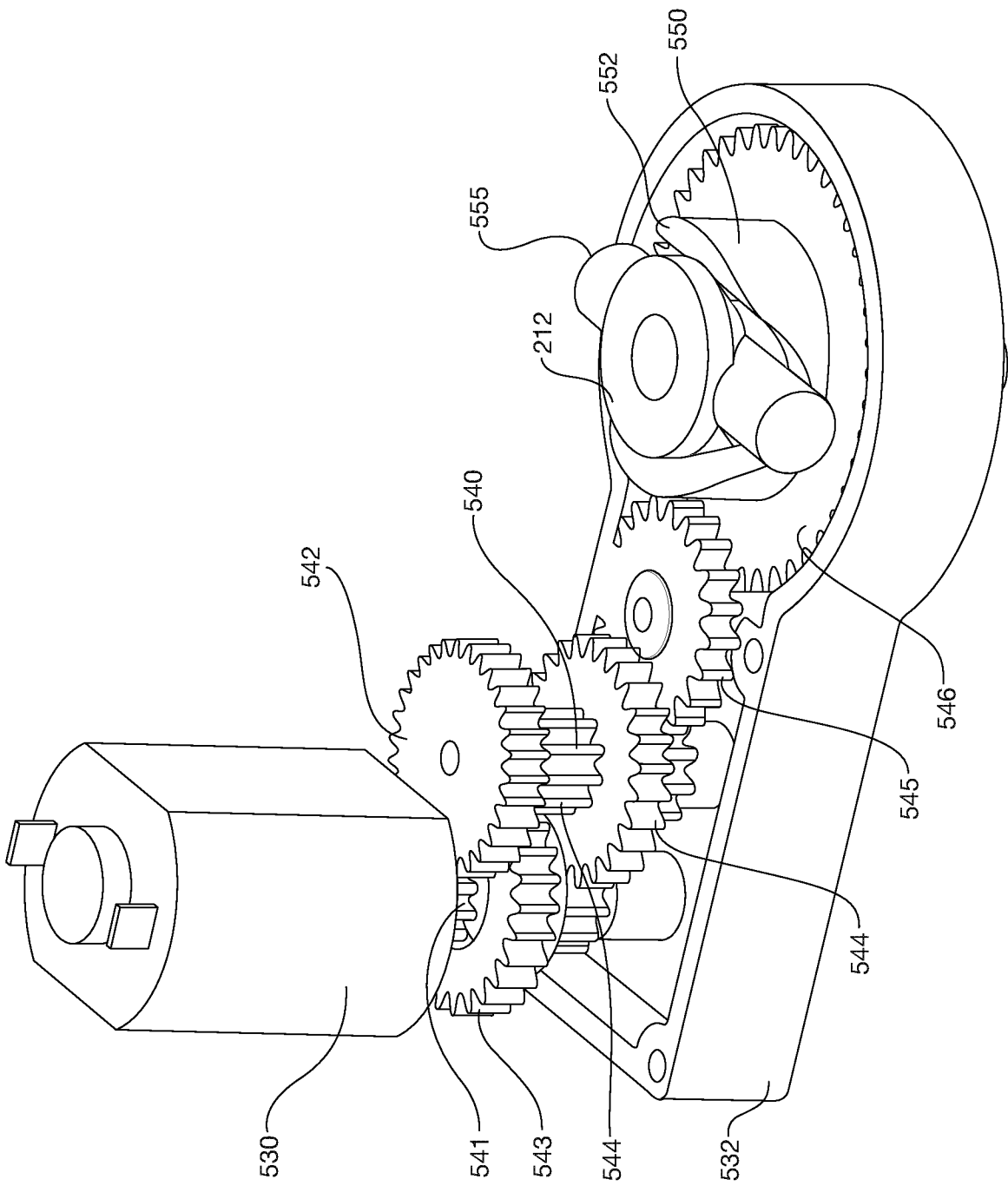

Fig. 5C

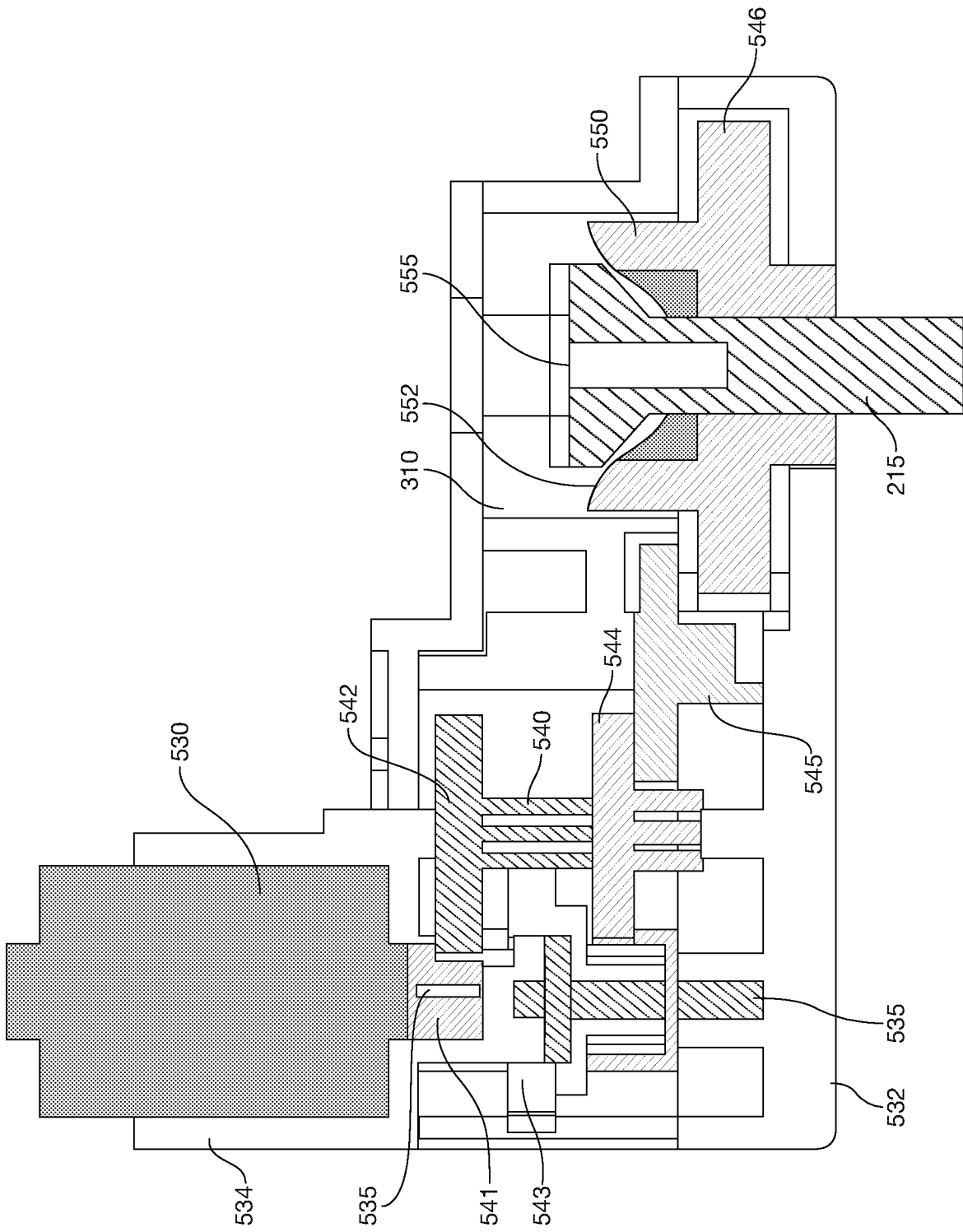

Fig. 5D

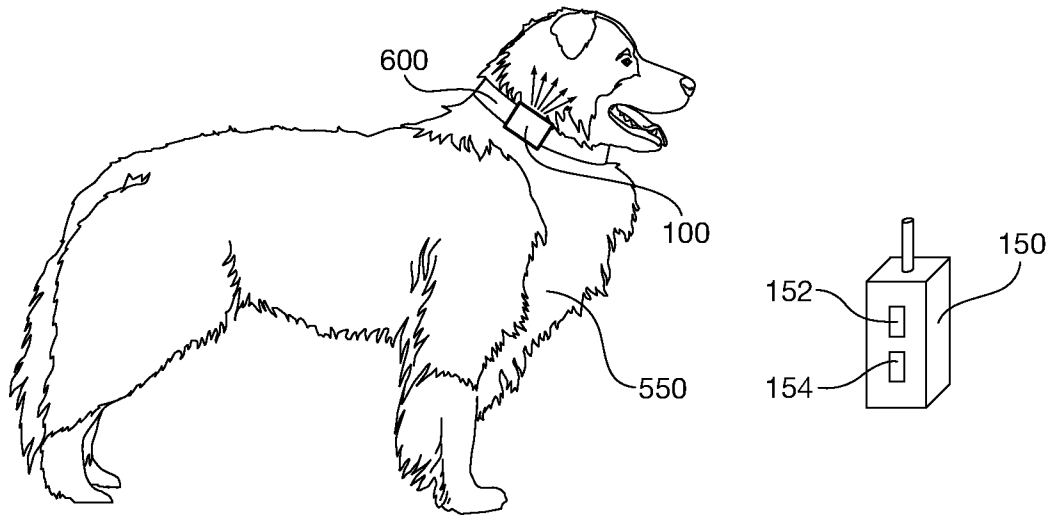

Fig. 6

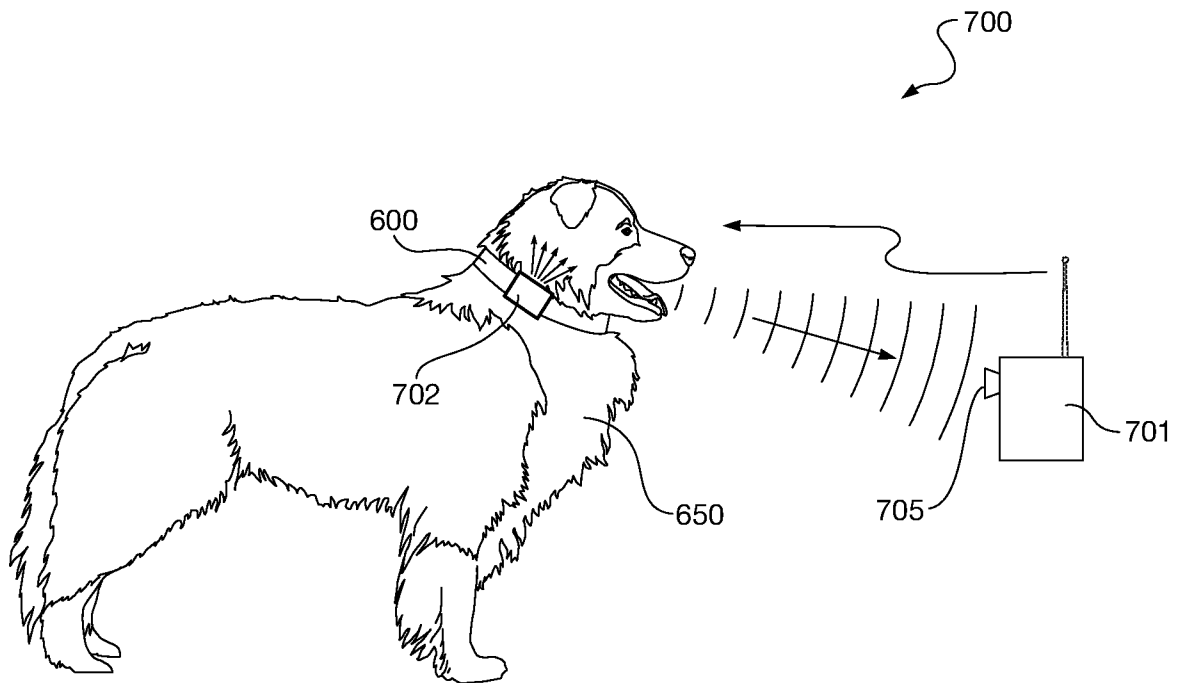

Fig. 7

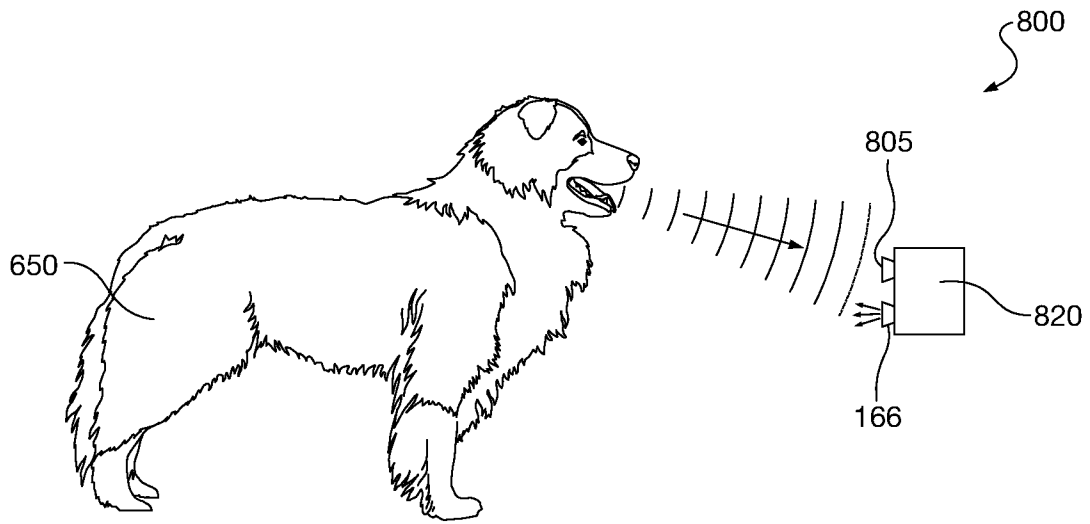

Fig. 8

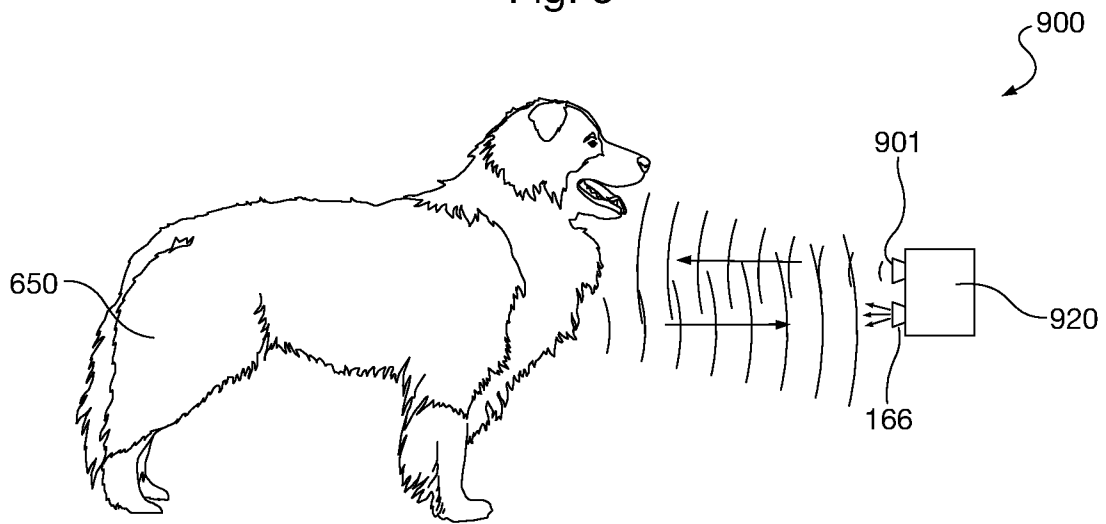

Fig. 9

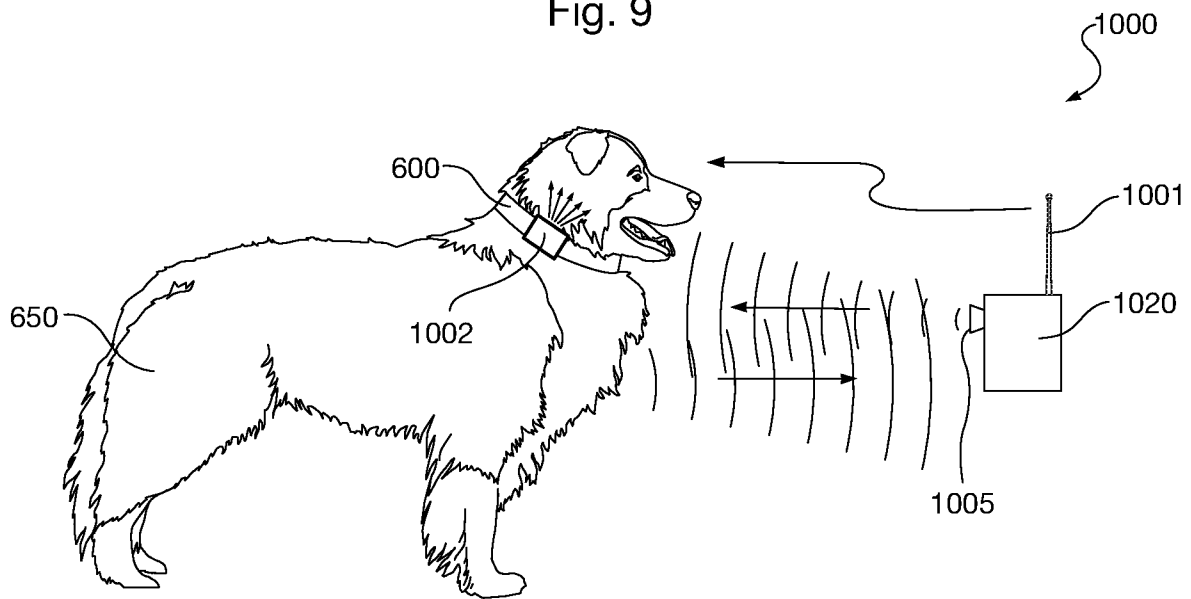

Fig. 10

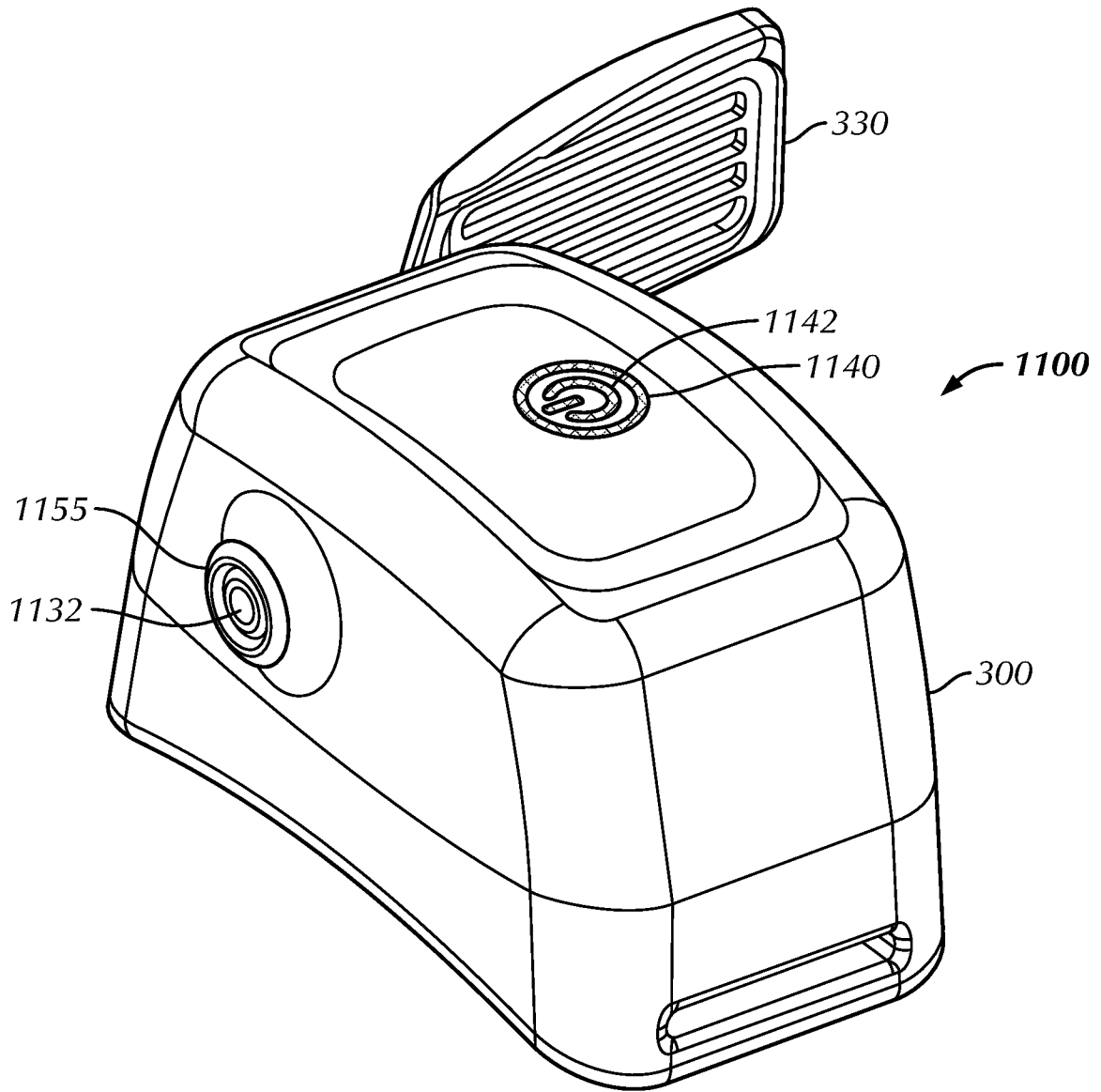

FIG. 11

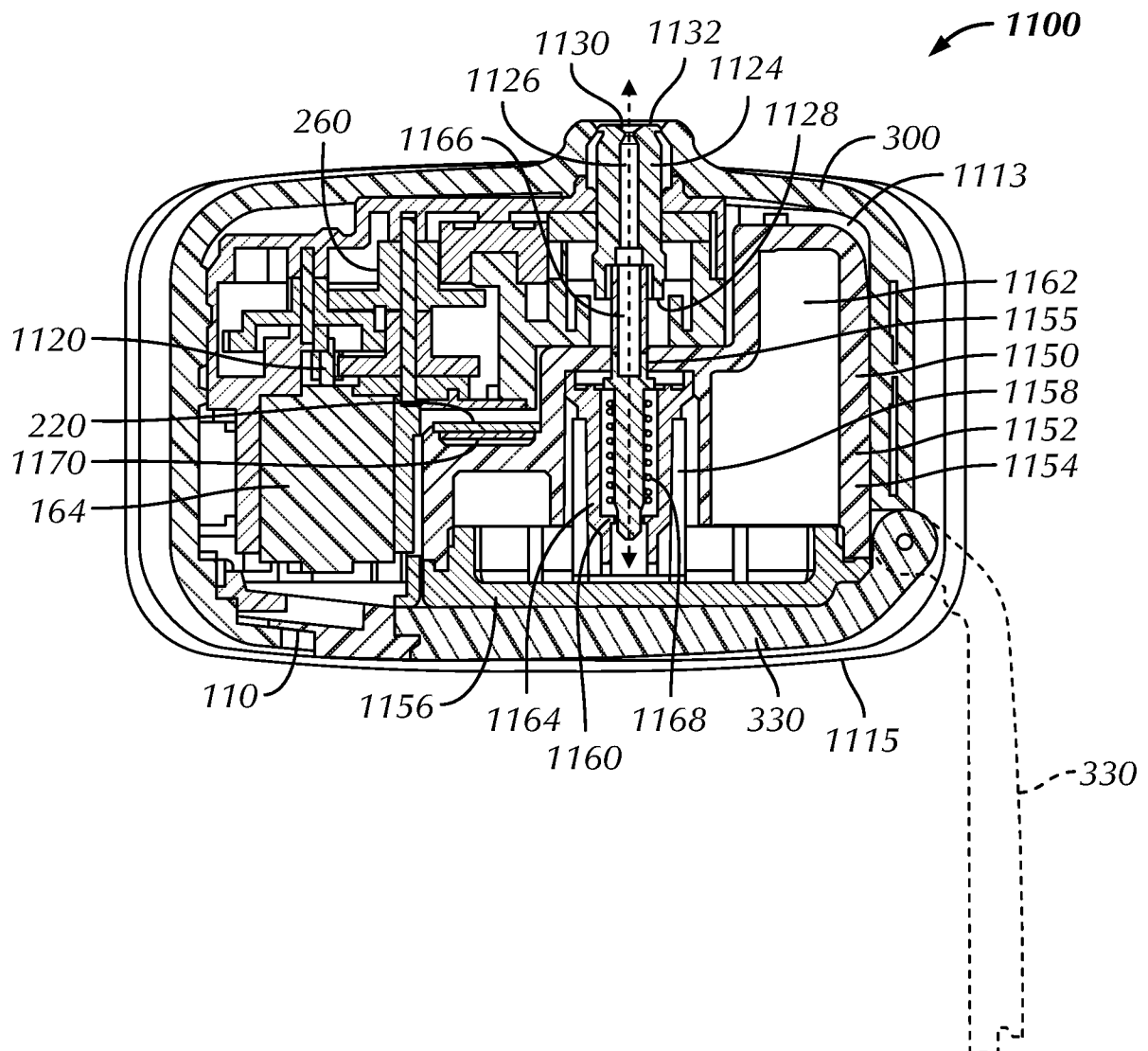
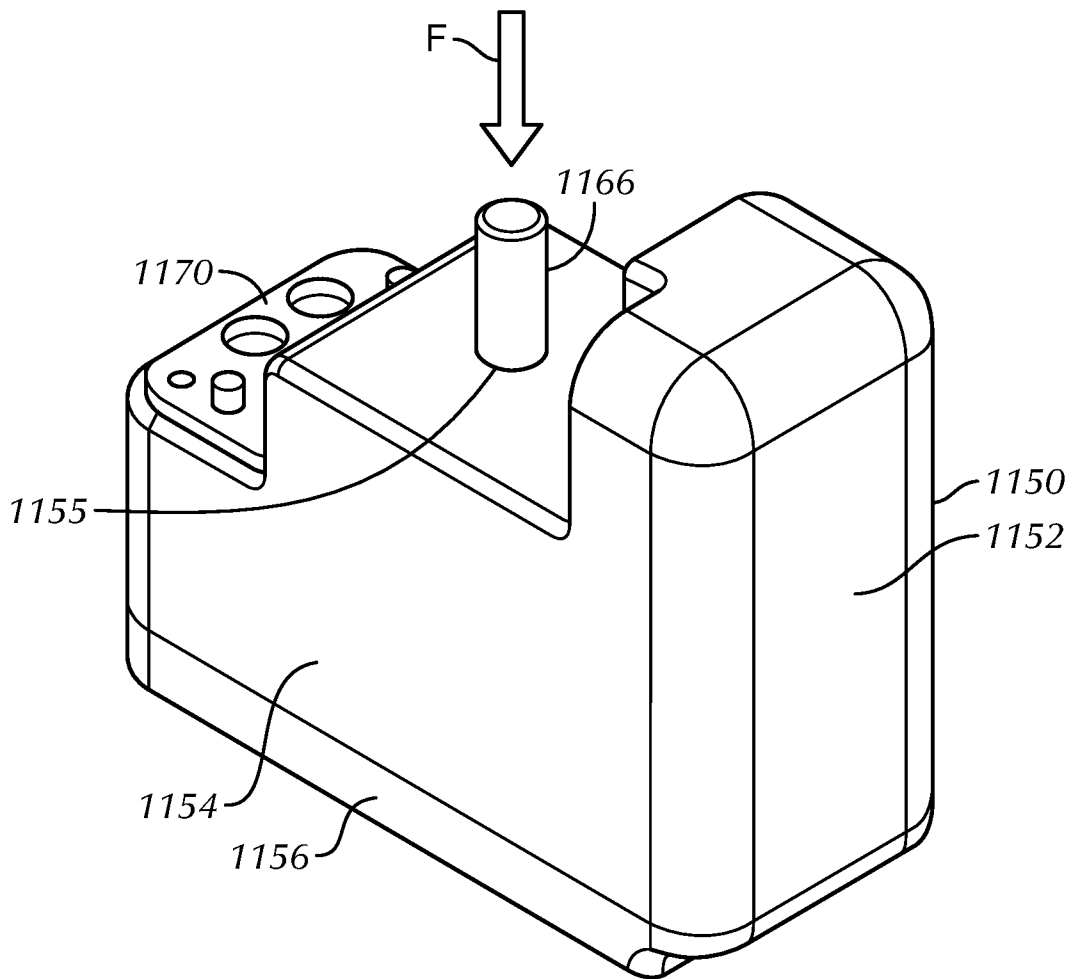
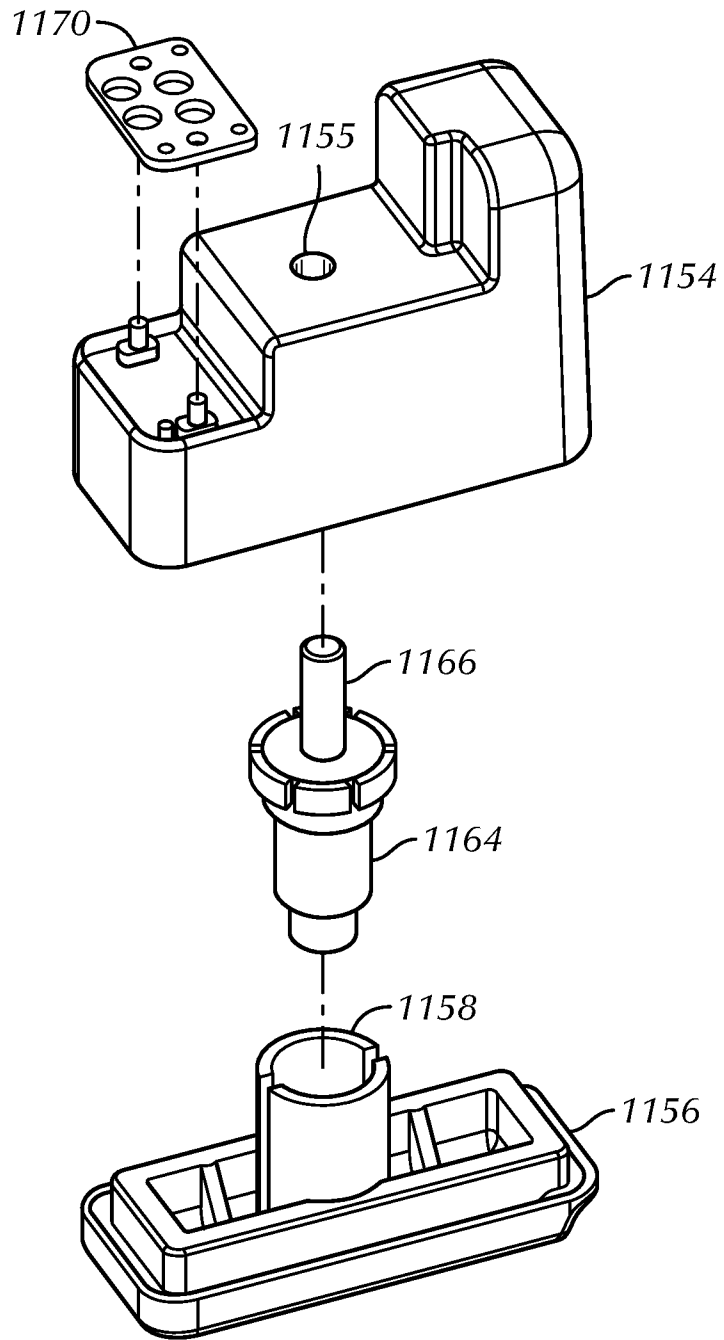

FIG. 12



**FIG. 13**



**FIG. 14**

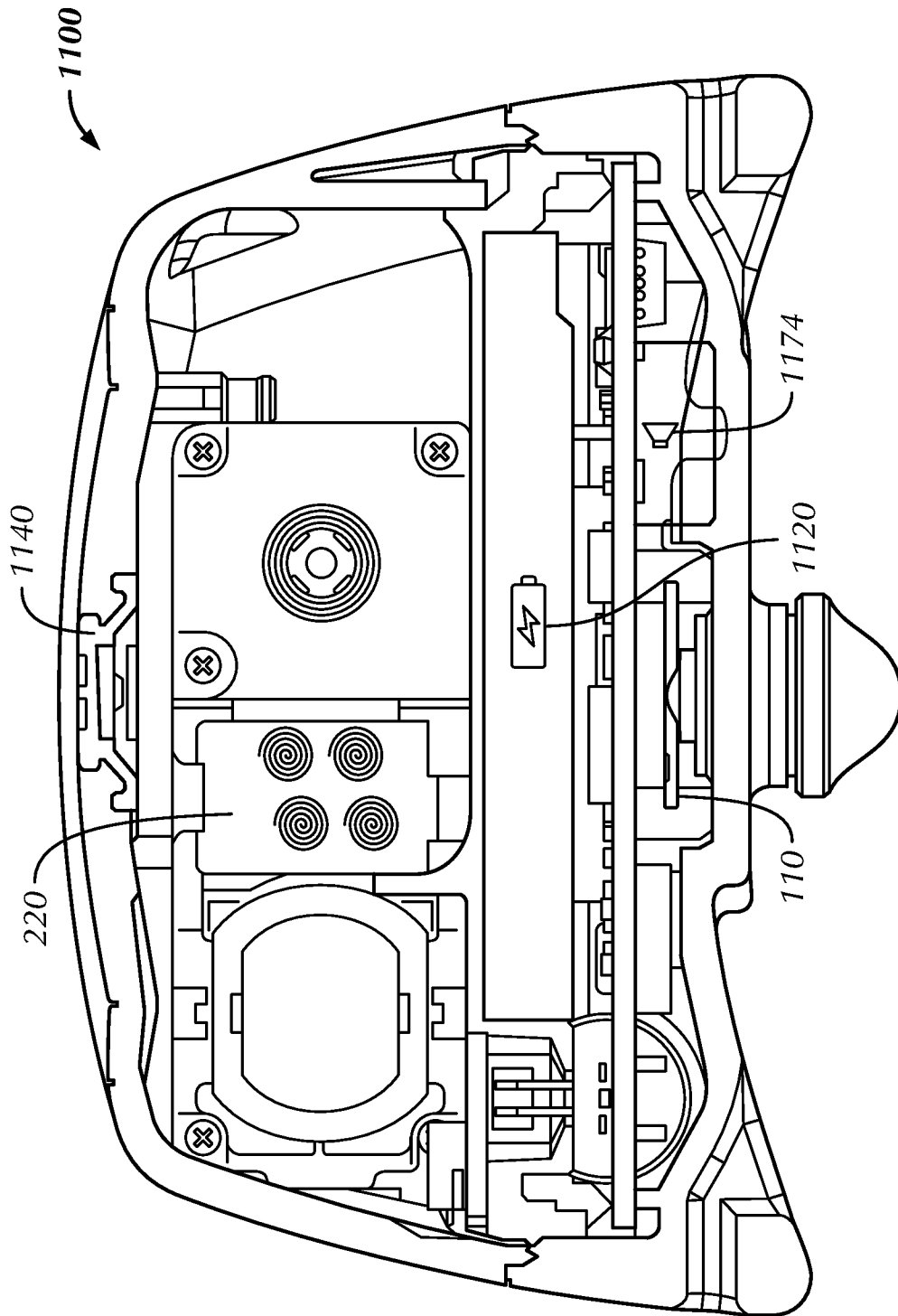

FIG. 15

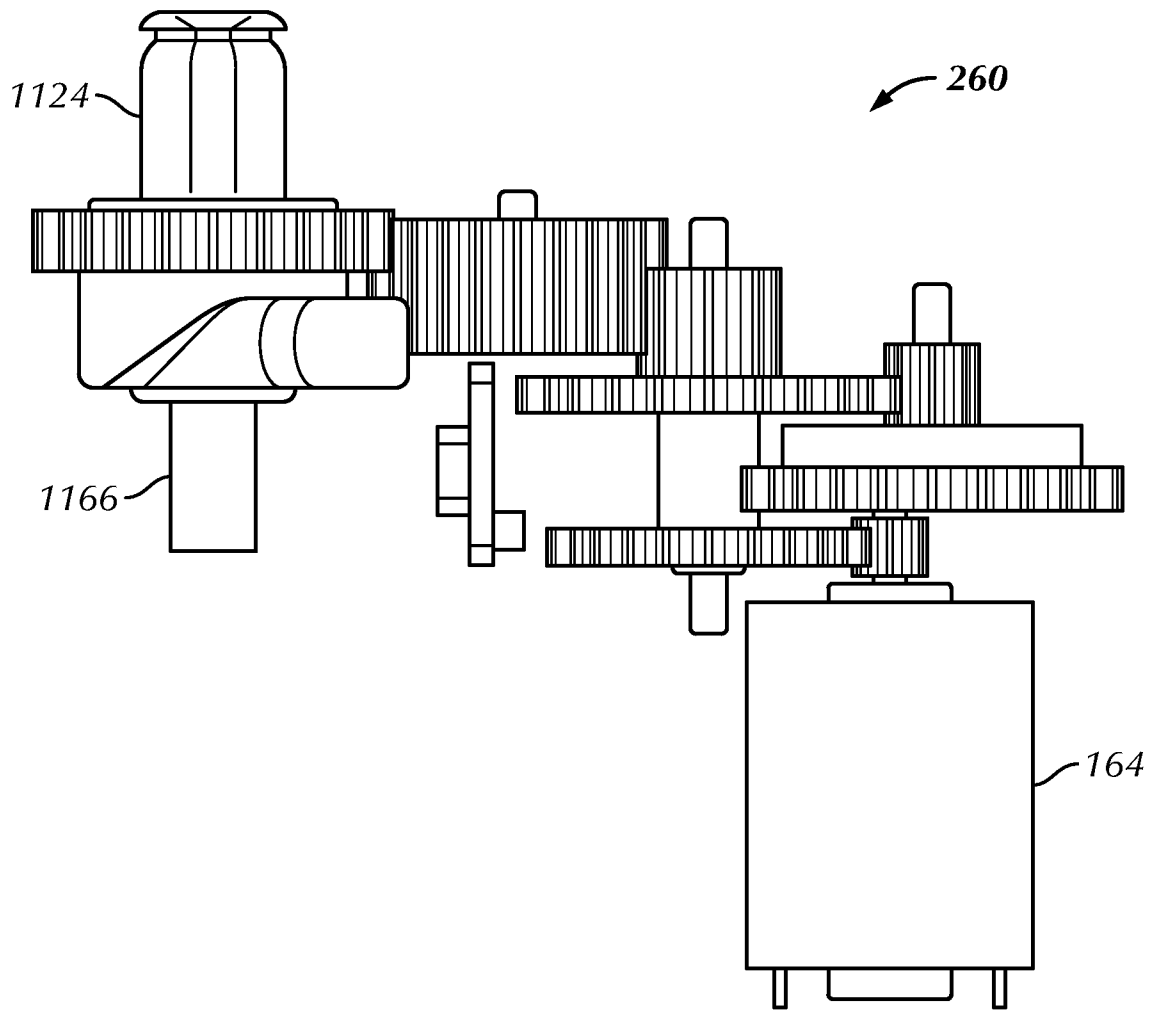

FIG. 16

INTERNATIONAL SEARCH REPORT

International application No.

PCT/US 19/57449

A. CLASSIFICATION OF SUBJECT MATTER

IPC - A01K 15/00 (2019.01)

CPC - A01K 15/022

According to International Patent Classification (IPC) or to both national classification and IPC

B. FIELDS SEARCHED

Minimum documentation searched (classification system followed by classification symbols)

See Search History document

Documentation searched other than minimum documentation to the extent that such documents are included in the fields searched

See Search History document

Electronic data base consulted during the international search (name of data base and, where practicable, search terms used)

See Search History document

C. DOCUMENTS CONSIDERED TO BE RELEVANT

Category*	Citation of document, with indication, where appropriate, of the relevant passages	Relevant to claim No.
Y -- A	US 4,627,385 A (VINCI); 9 December 1986 (09.12.1986); entire document, especially Figs. 2-3; Abstract; col. 2, ln 48-62; col. 3, ln 4-6; col. 3, ln 27-31.	1-3, 6, 8-10, 13, 15-17, 20, 22-24, 27, 29-32, 35, 37 ----- 4-5, 7, 11-12, 14, 18-19, 21, 25-26, 28, 33-34, 36
Y -- A	US 2013/0264355 A1 (JODOIN); 10 October 2013 (10.10.2013); entire document, especially Fig. 1, Abstract; para. [0032]-[0034].	1-3, 6, 8-10, 13, 15-17, 20, 22-24, 27, 29-32, 35, 37 ----- 4-5, 7, 11-12, 14, 18-19, 21, 25-26, 28, 33-34, 36
Y	US 2017/0208775 A1 (E-COLLAR TECHNOLOGIES, INC); 27 July 2017 (27.07.2017); entire document, especially para. [0057].	2-3, 9-10, 16-17, 23-24, 31-32
A	US 6,588,376 B1 (GROH); 8 July 2003 (08.07.2003); entire document, especially Abstract, Fig. 3-4; col. 1, ln 32-46; col. 3, ln 36-40; col. 3, ln 55-61.	1-37
A	US 2015/0250143 A1 (KLOSSNER); 10 September 2015 (10.09.2015); entire document.	1-37

Further documents are listed in the continuation of Box C.

See patent family annex.

* Special categories of cited documents:	"T" later document published after the international filing date or priority date and not in conflict with the application but cited to understand the principle or theory underlying the invention
"A" document defining the general state of the art which is not considered to be of particular relevance	"X" document of particular relevance; the claimed invention cannot be considered novel or cannot be considered to involve an inventive step when the document is taken alone
"D" document cited by the applicant in the international application	"Y" document of particular relevance; the claimed invention cannot be considered to involve an inventive step when the document is combined with one or more other such documents, such combination being obvious to a person skilled in the art
"E" earlier application or patent but published on or after the international filing date	"&" document member of the same patent family
"L" document which may throw doubts on priority claim(s) or which is cited to establish the publication date of another citation or other special reason (as specified)	
"O" document referring to an oral disclosure, use, exhibition or other means	
"P" document published prior to the international filing date but later than the priority date claimed	

Date of the actual completion of the international search  
3 December 2019

Date of mailing of the international search report

09 JAN 2020

Name and mailing address of the ISA/US  
Mail Stop PCT, Attn: ISA/US, Commissioner for Patents  
P.O. Box 1450, Alexandria, Virginia 22313-1450  
Facsimile No. 571-273-8300

Authorized officer

Lee Young

Telephone No. PCT Helpdesk: 571-272-4300