

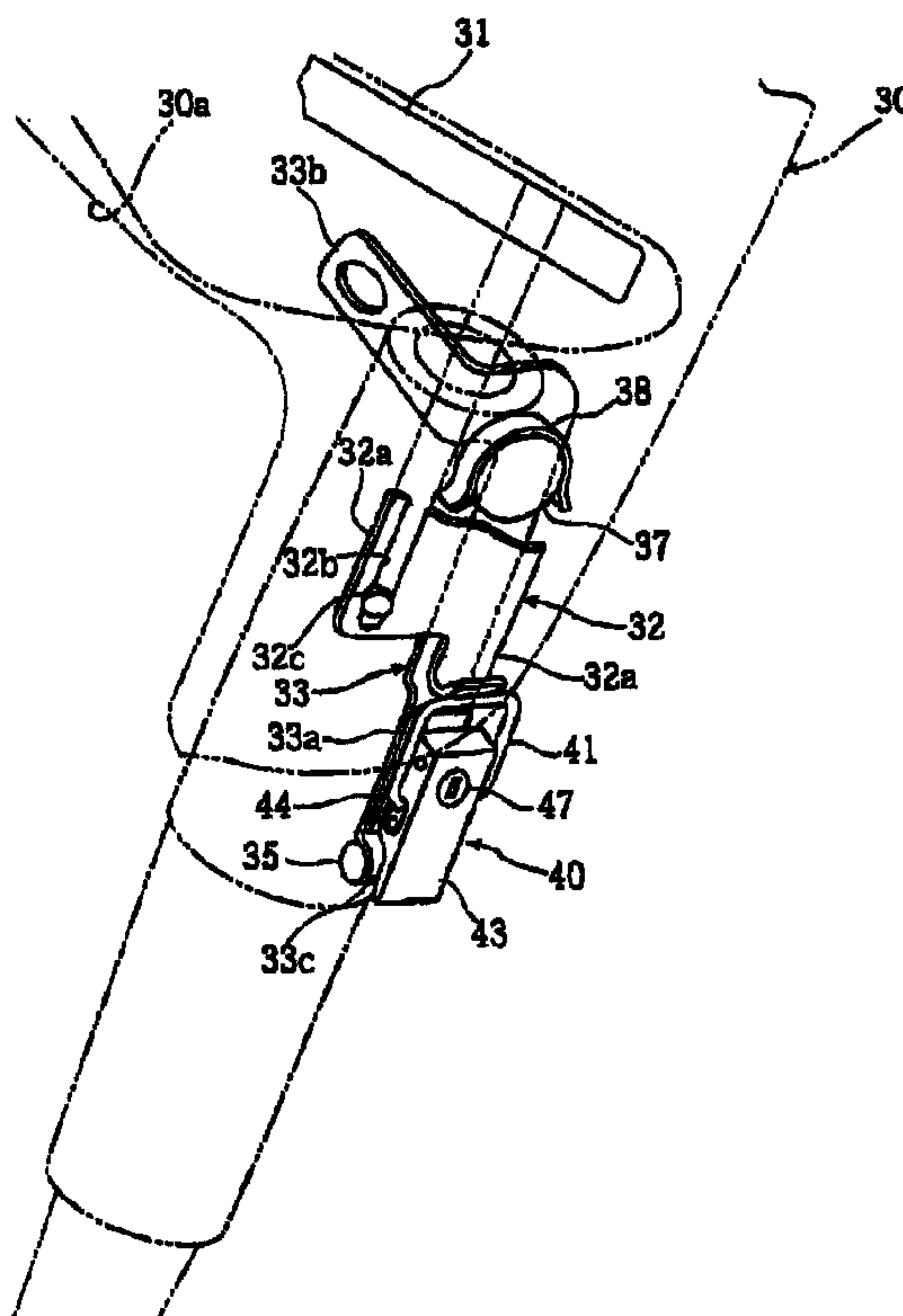

(22) Date de dépôt/Filing Date: 2003/11/07
 (41) Mise à la disp. pub./Open to Public Insp.: 2004/05/11
 (45) Date de délivrance/Issue Date: 2007/12/04
 (30) Priorité/Priority: 2002/11/11 (JP2002-327183)

(51) Cl.Int./Int.Cl. *B62J 17/04* (2006.01)
 (72) Inventeur/Inventor:
 SUZUKI, YASUHITO, JP
 (73) Propriétaire/Owner:
 YAMAHA HATSUDOKI KABUSHIKI KAISHA, JP
 (74) Agent: OYEN WIGGS GREEN & MUTALA LLP

(54) Titre : PARE-BRISE POUR MOTOCYCLETTE
 (54) Title: WINDSCREEN DEVICE FOR MOTORCYCLE



(57) Abrégé/Abstract:

A windscreen attaching/detaching device includes a mount bracket including a stopper and a hook, with the mount bracket secured to a windscreen and a mount stay including a damper member and a lock mechanism, with the mount stay secured to a vehicle body. The lock mechanism urges the hook to a locked position. The lock mechanism includes an arm disengaging with the hook and a lever linking to the arm and turnable between the locked position and an unlocked position. The windscreen engages the damper member with the stopper as well as engages the arm with the hook to turn the lever to the locked position that allows the windscreen to be secured to the vehicle body.

ABSTRACT

A windscreen attaching/detaching device includes a mount bracket including a stopper and a hook, with the mount bracket secured to a windscreen and a mount stay including a damper member and a lock mechanism, with the mount stay secured to a vehicle body. The lock mechanism urges the hook to a locked position. The lock mechanism includes an arm disengaging with the hook and a lever linking to the arm and turnable between the locked position and an unlocked position. The windscreen engages the damper member with the stopper as well as engages the arm with the hook to turn the lever to the locked position that allows the windscreen to be secured to the vehicle body.

WINDSCREEN DEVICE FOR MOTORCYCLE

BACKGROUND OF THE INVENTION

Field of the Invention

[0001]

This invention relates to a windscreen device for a motorcycle with the windscreen removably attached to a vehicle body so as to cover the front of a rider.

Description of Related Art

[0002]

Some motorcycles include a windscreen disposed in front of a rider to block headwinds. A conventional windscreen, attached to the vehicle body, is generally secured to steering handlebars through brackets with bolts or secured to a headlight through brackets with bolts.

[0003]

A demand has been made for motorcycles provided with a removable windscreen such that a rider can attach or detach the windscreen depending on highway driving or local street driving, or on the rider's preference. However, attaching and detaching the windscreen was not sufficiently taken into consideration in the conventional windscreen device. Attaching and detaching the windscreen involves the cumbersome task of securing or loosening bolts by means of tools in order to attach or detach the windscreen.

[0004]

An advantage of the present invention made in view of the situations with the prior art described above is to provide a windscreen device for a motorcycle in which the windscreen can be easily attached or detached without tools.

SUMMARY OF THE INVENTION**[0005]**

According to one embodiment of the present invention, a windscreen device for a motorcycle having a windscreen removably attached to a vehicle body so as to cover the front of a rider, includes a damper member provided on one of the vehicle body and the windscreen, a stopper engageable with the damper member provided on the other one, a hook attached to one of the vehicle body and the windscreen, a lock mechanism for urging the hook to a locked position provided on the other one, and an arm disengageably engaged with the hook, and a lever linking to the arm and turnable between a locked position and an unlocked position. The windscreen engages the damper member with the stopper as well as engages the arm with the hook to turn the lever to the locked position allowing the windscreen to be secured to the vehicle body.

[0006]

According to the present invention, the arm is urged toward the locked position by a spring.

[0007]

According to the present invention, the lever is provided with a key cylinder for securing the lever to the locked position.

[0008]

Further according to the present invention, a key into the key cylinder also serves as a main key for a main switch disposed on the vehicle body.

[0009]

In the windscreen device of the present invention, the windscreen is attached to the vehicle body by engaging the stopper with the damper member, and engaging the arm with the hook to turn the lever to the locked position. This allows the damper member and the stopper to be securely engaged with each other using a tensile force produced by the lock mechanism so that the windscreen is secured to the vehicle body. The windscreen is removed by turning the lever from the locked position to the unlocked position to release the arm from the hook.

[0010]

According to the present invention, the windscreen can be attached to or detached from the vehicle body through simple work without tools, that is, turning the lever between the locked position and the unlocked position.

[0011]

Also, according to the present invention, the arm urged toward the locked position by the spring allows the windscreen to be further tightly secured to the vehicle body. This can prevent a windscreen rattle and vibration while driving.

[0012]

Further, the key cylinder is disposed for securing the lever to the locked position. This can prevent the windscreen from being tampered and stolen.

[0013]

Also, the key to the key cylinder also serves as a main key for the main switch. There is thus no need for an extra key.

BRIEF DESCRIPTION OF DRAWINGS

[0014]

Fig. 1 is a side view of a motorcycle provided with a windscreen device according to an embodiment of the present invention.

[0015]

Fig. 2 is a side view of the windscreen device.

[0016]

Fig. 3 is a front view of the windscreen device.

[0017]

Fig. 4 is a perspective view of the windscreen device.

[0018]

Fig. 5 is a perspective view of the windscreen device.

[0019]

Fig. 6 is a sectional view of a boss member of the windscreen device.

[0020]

Fig. 7 are views showing a hook and a lock mechanism of the windscreen device.

[0021]

Fig. 8 are views showing the hook and the lock mechanism.

DETAILED DESCRIPTION OF THE PREFERRED EMBODIMENTS

[0022]

The embodiments of the present invention will be hereinafter described in reference to the appended drawings.

[0023]

Figs. 1 through 8 are explanatory drawings of a windscreen device for a motorcycle according to an embodiment of the present invention. Fig. 1 is a side view of a motorcycle provided with the windscreen device. Figs. 2 and 3 are a side view and a front view of the windscreen device, respectively. Figs. 4 and 5 are perspective views of the windscreen device. Fig. 6 is a sectional view of a rubber damper of the windscreen device. Fig. 7(a) and 7(b) are plan views of a hook and a lock mechanism, respectively. Fig. 8(a) and 8(b) are side views of the hook and the lock mechanism, respectively.

[0024]

In the drawings, reference numeral 1 denotes the motorcycle. This motorcycle is constituted, in rough description, with a water-cooled 4-cycle V4-cylinder engine 3 mounted on a double-cradle body frame 2, and a fuel tank 4 as well as a seat 5 disposed on the upper portion of the body frame 2.

[0025]

At the lower rear end of the body frame 2, a pair of left and right rear arms 7 are pivotably supported with a pivot shaft 6 for upward and downward swing. A rear wheel 8 is supported between the rear ends of the rear arms 7.

[0026]

A drive shaft (not shown) for transmitting the engine power to the rear wheel 8 is fitted in the rear arms 7. A rear suspension 9 is suspended between the rear arms 7

and the body frame 2.

[0027]

A rear fender 10 is provided above the rear wheel 8. A rear seat 11 is provided above the rear fender 10. The body frame 2 has footrest boards 12 which allow the rider to rest his/her feet at its left and right lower ends below the fuel tank 4.

[0028]

A head pipe 15 is connected to the front end of the body frame 2. The head pipe 15 is provided with a steering shaft 16 rotatable via a bearing (not shown). The steering shaft 16 has an upper bracket 17 and an under bracket 18 tightly secured to its upper and lower ends, respectively. A pair of left and right front forks 20 are fixedly connected to both the brackets 17 and 18. A front wheel 21 is supported between the bottom ends of the front forks 20.

[0029]

To the upper bracket 17 is secured a pair of left and right handle crowns 22 via interposed rubber bushes (not shown). Steering handlebars 23 are fixed to each handle crown 22 with bolts. The left and right front forks 20 have a headlight 24 attached to their upper ends while having a front fender 25, for covering the upper portion of the front wheel 21, attached to their lower ends.

[0030]

Approximately the upper half of each front fork 20 is covered with a cylindrical fork cover 26. The fork cover 26 is fixed to the upper and under brackets 17 and 18. A main switch 27 is provided rearward of the upper bracket 17. The main switch 27 has a key cylinder 27a through which a main key 28 is inserted.

[0031]

At the front end of the body frame 2, a windscreen device 50 is disposed for blocking headwinds. The windscreen device 50 has a windscreen 30 and an attachment/detachment mechanism 51 for attaching or detaching the windscreen 30 to or from the vehicle body.

[0032]

The windscreen 30 made of polycarbonate is large enough to cover the front of the

rider seated on the seat 5. The windscreen 30 is formed with opposite sides edges curved toward the rear of the vehicle. At the lower edge of the windscreen 30, a recess 30a is formed to avoid interfering with the headlight 24.

[0033]

In the attachment/detachment mechanism 51, a lock mechanism 40 locks or unlocks a mount bracket 52 secured to the windscreen 30, and a mount stay 33 secured to the vehicle body.

[0034]

In the mount bracket 52, a band-shaped horizontal plate 31 extending in the lateral direction of the vehicle is secured to the bottom of the windscreen 30, and left and right vertical plates 32, 32 extend downward along the outer side surface of each fork cover 26 from the left and right ends of the horizontal plate 31.

[0035]

Each of the left and right vertical plates 32 has vertically extending holes 32b formed on its band-shaped support member 32a vertically extending. The windshield 30 is secured to the vertical plates 32, 32 with bolts 32c inserted through the vertically extending holes 32b so that the vertical position of the windscreen 30 can be adjusted.

[0036]

Each of the vertical plates 32 includes a base portion 32d integrally formed with the lower half of the support member 32a, and extending rearward. The laterally inner side of the base portion 32d is provided with a stopper 38 formed into a semi-circular band. A hook 32e is integrally formed with the lower edge of the base portion 32d to extend downward. The hook 32e is formed with its lower end curved upward and toward the outer side of the vehicle into a J-shape.

[0037]

The mount stay 33 is disposed behind the vertical plates 32 of the mount bracket 52. The mount stay 33 has a fixed portion 33b integrally formed with the upper edge of a band-shaped main stay 33a vertically extending, from which the fixed portion 33b curves toward the vehicle body. The fixed portion 33b is tightly fixed to

the front wall of the upper bracket 17 with a bolt 34. The main stay 33a has a lower end 33c interconnected by welding to a bar member 35, which is secured to the vehicle body.

[0038]

A portion corresponding to the stopper 38 and formed on the upper part of the main stay 33a or near the mount bracket 52 is provided with a cylindrical damper member 37. As shown in Fig. 6, the damper member 37 includes a metal boss 37a and a hard rubber damper 37b fixed to the metal boss 37a, while being tightly screwed by a bolt 37c to the mount stay 33.

[0039]

The lock mechanism 40 is provided on the mount stay 33 and below the hook 32e. The lock mechanism 40 includes an arm 41 disengageably engaged with the hook 32e and a lever 43 to which ends 41a, 41a of the arm 41 are swingably connected via a connecting pin 42. The lever 43 has a front end supported for turning between the locked position and the unlocked position with a turning pin 45 inserted through a base 44 which is secured to the mount stay 33 with bolts.

[0040]

The arm 41 made of a bar material is curved into an approximately U-shape. The connecting pin 42 journaling the arm 41 can be moved by (t) relative to the lever 43 in the longitudinal direction (See Fig. 8(b)). A spring 46 interposed between the pins 42 and 45 urges the connecting pin 42 as well as the arm 41 toward the locked position.

[0041]

A key cylinder 47 having a key insertion part 47a is disposed on the lever 43. Inserting the main key 28 for the main switch 27 into the key insertion part 47a for locking up allows the lever 43 to be fixed to the locked position. This can prevent the lever 43 from turning.

[0042]

The windscreen 30 to be attached to the vehicle body is positioned from above such that each of the left and right stoppers 38 is engaged with the damper member

37, to turn the lever 43 to the unlocked position whereby the hook 32e is engaged with the arm 41 to turn the lever 43 to the locked position (See Fig. 2).

[0048]

This allows the damper member 37 and the stopper 38 to be securely engaged with each other using a tensile force produced by the lock mechanism 40 so that the windscreen 30 is secured to the front forks 20. The windscreen 30 is removed by turning the lever 43 from the locked position to the unlocked position to release the arm 41 from the hook 32e, so that the windscreen 30 is removed from above.

[0044]

According to the embodiment of the present invention as described above, the damper member 37 is attached to the mount stay 33 fixedly supported with the front fork 20. Also, each vertical plate 32 of the mount bracket 52 which is secured to the windscreen 30 is provided with the stopper 38, and the lock mechanism 40 is provided to allow the arm 41 to be engaged with the hook 32e of the vertical plate 32 so as to pull them downward. The windscreen 30 can be thus attached to or detached from the vehicle body with ease and without tools, that is, turning the lever 43 between the locked position and the unlocked position.

[0045]

The damper member 37 including the rubber damper 37b, and the arm 41 urged toward the locked position by the spring 46 can prevent the windscreen 30 from rattling and vibrating while driving.

[0046]

According to the embodiment of the present invention, the lever 43 has the key cylinder 47 disposed for securing the lever 43 to the locked position. This can prevent the windscreen from being tampered with and stolen. The key 28 into the key cylinder 47 also serves as a main key 28 for the main switch 27. There is thus no need for an extra key.

WHAT IS CLAIMED IS:

1. A windscreen attaching/detaching device, comprising:
 - 5 a mount bracket including a stopper and a hook, with the mount bracket secured to a windscreen; and
 - a mount stay including a damper member and a lock mechanism, with the mount stay secured to a vehicle body,
 - 10 wherein the lock mechanism urges the hook to a locked position, with the lock mechanism including an arm disengaging with the hook and a lever linking to the arm and turnable between the locked position and an unlocked position, and
 - 15 wherein the windscreen engages the damper member with the stopper as well as engages the arm with the hook to turn the lever to the locked position that allows the windscreen to be secured to the vehicle body.
2. The windscreen attaching/detaching device according to claim 1, wherein the arm is urged towards the locked position by a spring.
- 20 3. The windscreen attaching/detaching device according to claim 2, wherein the lever is provided with a key cylinder for securing the lever to the locked position.
- 25 4. The windscreen attaching/detaching device according to claim 8, wherein a key into the key cylinder also serves as a main key for a main switch disposed on the vehicle body.
- 30 5. The windscreen attaching/detaching device according to claim 2, wherein the mount bracket includes a band-shaped plate secured to a bottom portion of the windscreen.

6. The windscreen attaching/detaching device according to claim 2, wherein the mount bracket includes side vertical plates including vertically extending holes wherein the windscreen is secured to the vertical plates with bolts to adjust the windscreen.
- 5
7. The windscreen attaching/detaching device according to claim 8, wherein the vertical plates include a base portion provided with the stopper.
- 10 8. The windscreen attaching/detaching device according to claim 7, wherein the hook is integrally formed with a lower edge of the base portion.
9. The windscreen attaching/detaching device according to claim 6, wherein the mount stay is disposed behind the vertical plates.
- 15
10. The windscreen attaching/detaching device according to claim 2, wherein the lock mechanism is provided below the hook.
- 20 11. The windscreen attaching/detaching device according to claim 2, wherein the windscreen is made of a polycarbonate.
12. The windscreen attaching/detaching device according to claim 2, further comprising a recess formed on a lower edge of the wind-
screen.
- 25
13. The windscreen attaching/detaching device according to claim 2, wherein the lock mechanism locks and unlocks the mount bracket.
- 30 14. The windscreen attaching/detaching device according to claim 2, wherein the stopper is formed into a semi-circular band.

15. A windscreen attaching/detaching device, comprising:
a mount bracket including a stopper and a hook, with the
mount bracket secured to a windscreen;
a mount stay including a damper member and a lock mech-
anism, with the mount stay secured to a vehicle body; and
wherein the lock mechanism urges the hook to a locked
position, with the lock mechanism including an arm disengaging
with the hook and a lever linking to the arm and turnable between
the locked position and an unlocked position, and
wherein the windscreen engages the damper member with
the stopper as well as engages the arm with the hook to turn the
lever to the locked position that allows the windscreen to be
secured to the vehicle body; and
means for securing the lever to the locked position.
16. A method for attaching/detaching a windscreen to a vehicle body
comprising:
placing a windscreen on a vehicle body;
engaging a stopper with a damper member; and
engaging an arm with a hook to turn a lever to a locked
position,
wherein the damper member and the stopper are securely
engaged with each other using a tensile force produced by the arm
and the lever.
17. The method according to claim 16, further comprising turning the
lever from the locked position to an unlocked position to release
the arm from the hook.
18. The method according to claim 16, further comprising urging the
arm towards the locked position by a spring.

19. The method according to claim 16, further comprising providing the lever with a key cylinder for securing the lever to the locked position.
- 5 20. The method according to claim 16, further comprising providing a recess formed on a lower edge of the windscreen.

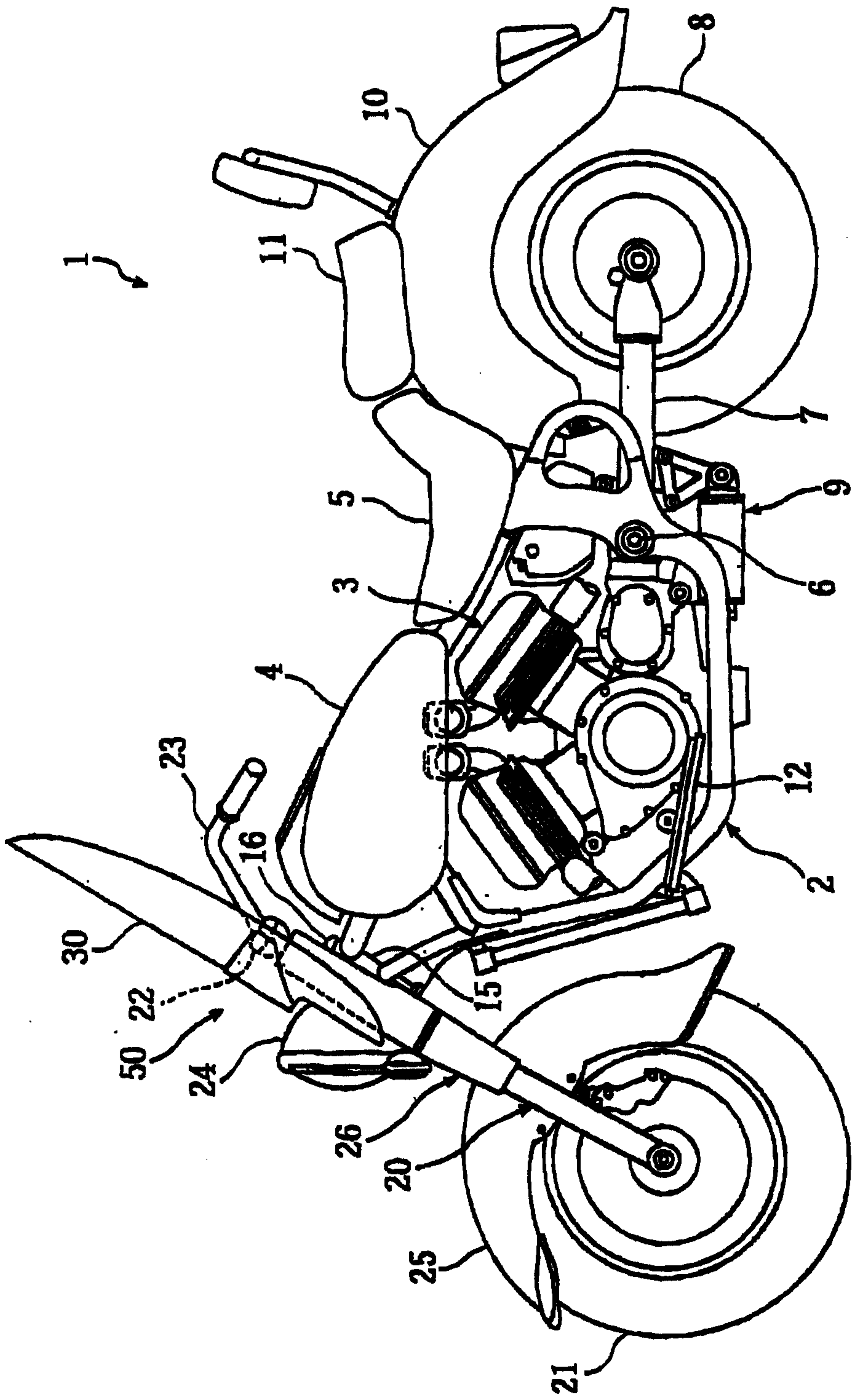

FIG. 1

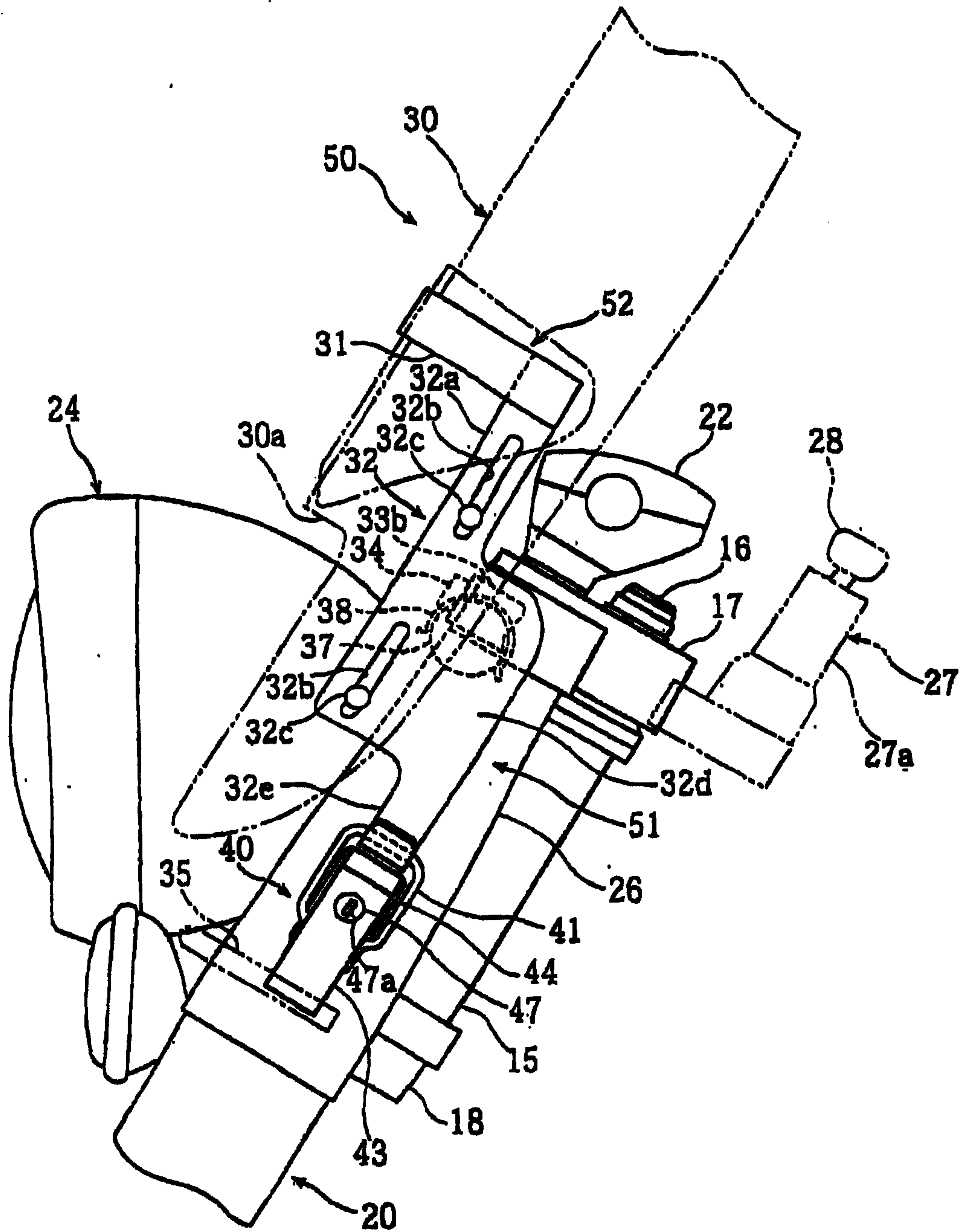

FIG. 2

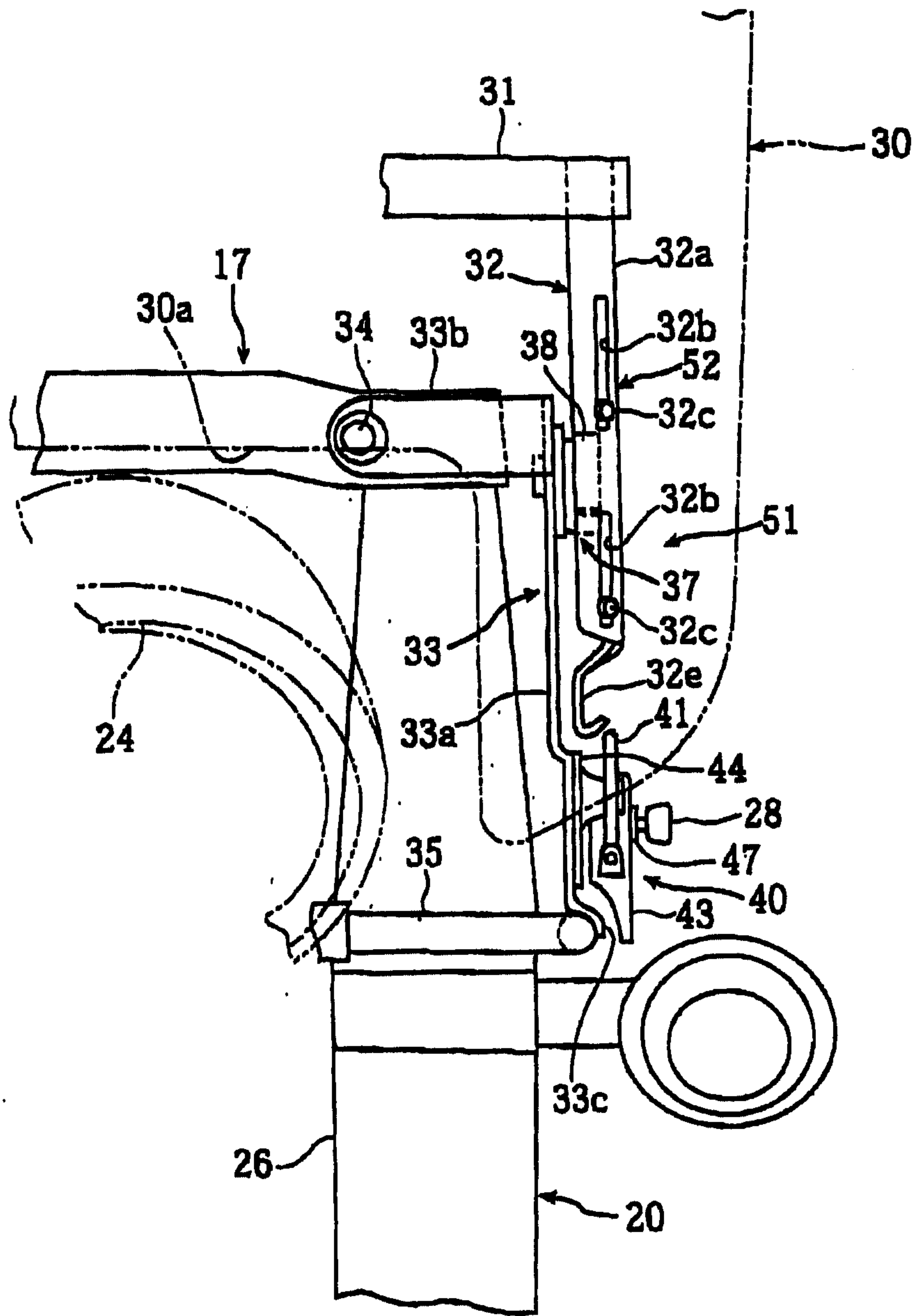

FIG. 3

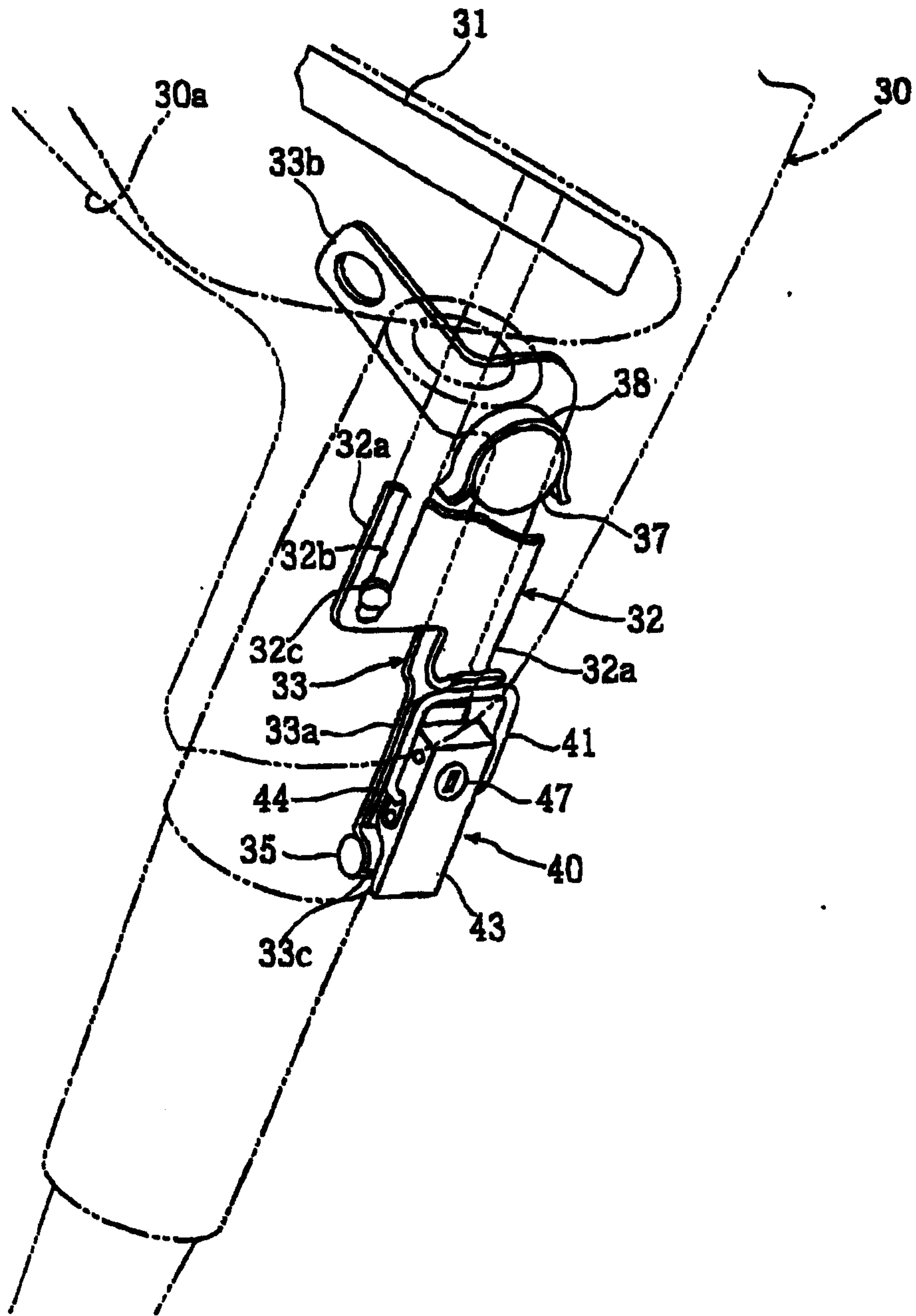

FIG. 4

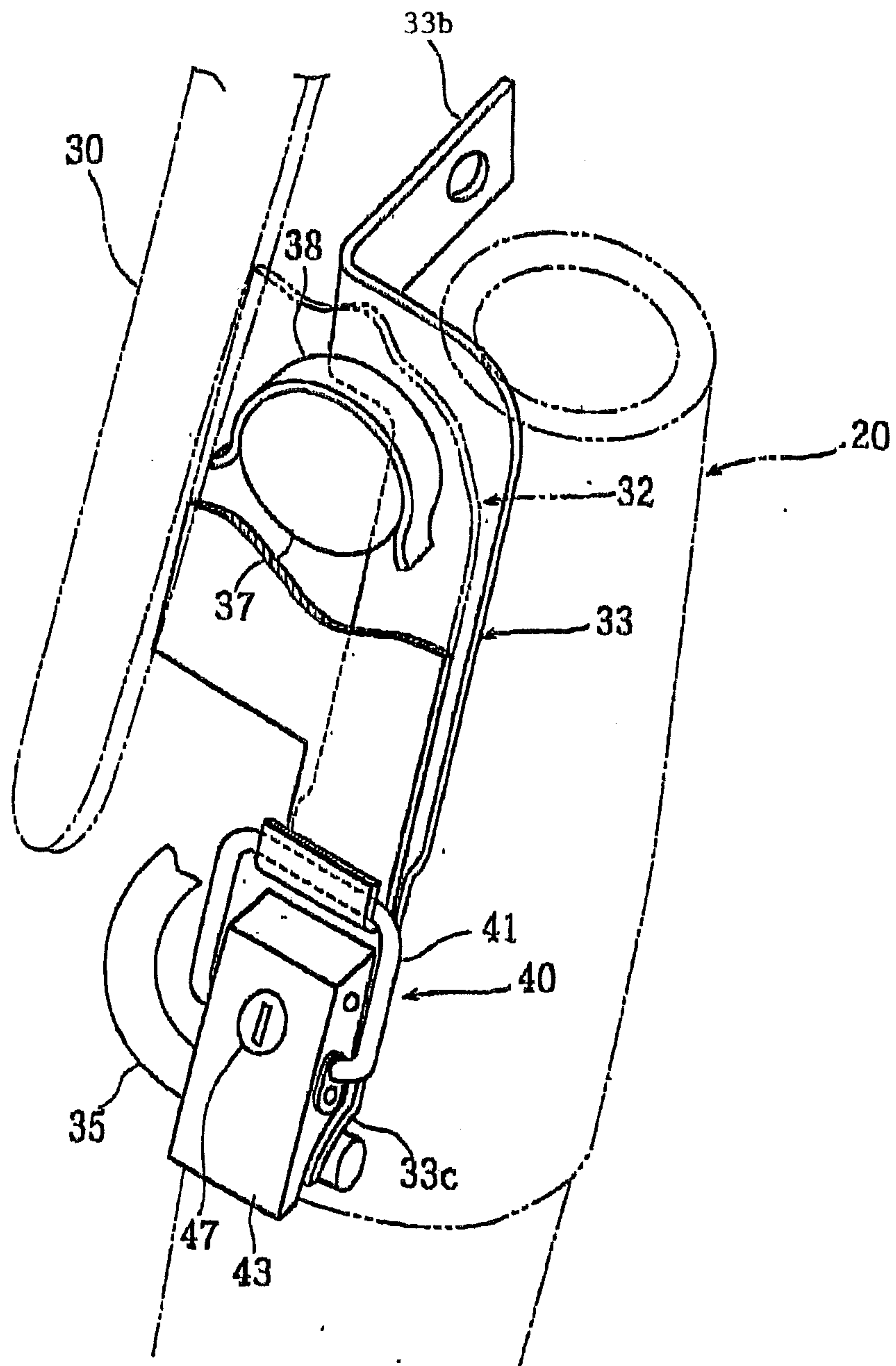

FIG. 5

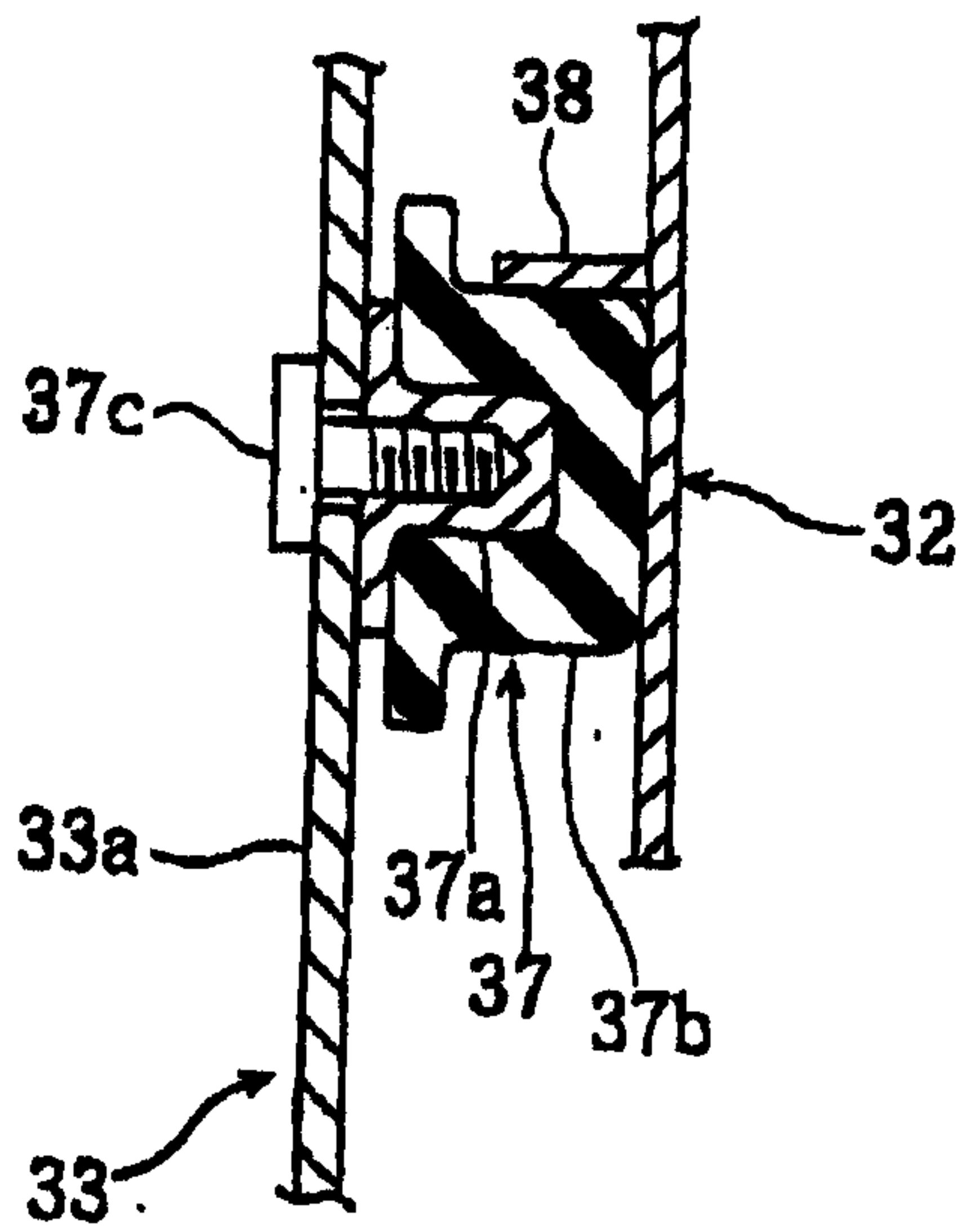

FIG. 6

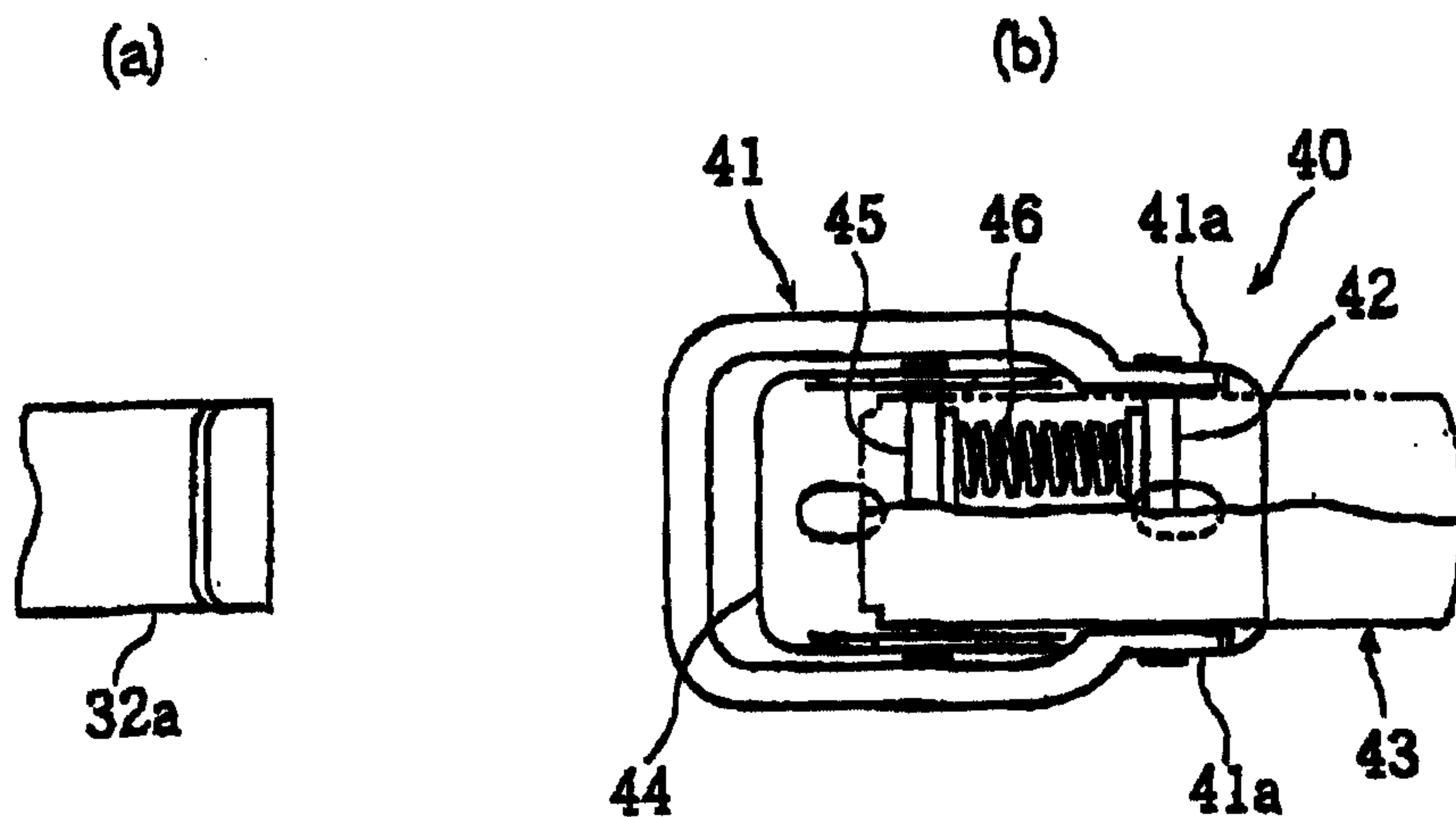

FIG. 7

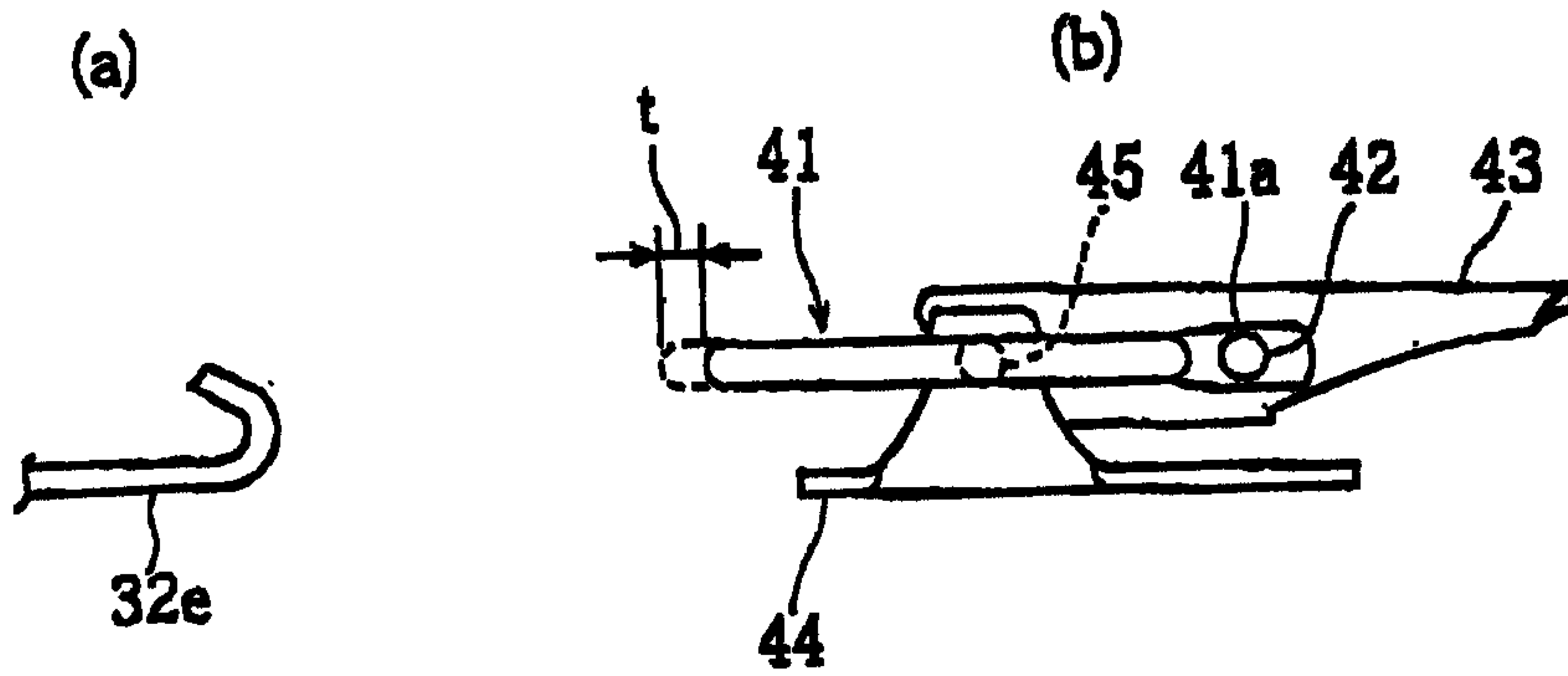

FIG. 8

