



- (51) International Patent Classification:
B65G 19/08 (2006.01) B65G 19/24 (2006.01)
- (21) International Application Number:
PCT/US2015/042431
- (22) International Filing Date:
28 July 2015 (28.07.2015)
- (25) Filing Language: English
- (26) Publication Language: English
- (30) Priority Data:
14/445,981 29 July 2014 (29.07.2014) US
14/577,587 19 December 2014 (19.12.2014) US
- (71) Applicant: THE CINCINNATI MINE MACHINERY COMPANY [US/US]; 2950 Jonrose Avenue, Cincinnati, OH 45239-5319 (US).
- (72) Inventors: MORRIS, Randall, Lee; 4930 Ginger Way, Cincinnati, OH 45244-1211 (US). MEYER, Aaron, Daniel; 10744 Edgewood Road, Hamilton, OH 45030 (US).
- (74) Agents: SUMME, Kurt, A. et al.; Wood, Herron & Evans, LLP, 2700 Carew Tower, 441 Vine Street, Cincinnati, OH 45202-2917 (US).

- (81) Designated States (unless otherwise indicated, for every kind of national protection available): AE, AG, AL, AM, AO, AT, AU, AZ, BA, BB, BG, BH, BN, BR, BW, BY, BZ, CA, CH, CL, CN, CO, CR, CU, CZ, DE, DK, DM, DO, DZ, EC, EE, EG, ES, FI, GB, GD, GE, GH, GM, GT, HN, HR, HU, ID, IL, IN, IR, IS, JP, KE, KG, KN, KP, KR, KZ, LA, LC, LK, LR, LS, LU, LY, MA, MD, ME, MG, MK, MN, MW, MX, MY, MZ, NA, NG, NI, NO, NZ, OM, PA, PE, PG, PH, PL, PT, QA, RO, RS, RU, RW, SA, SC, SD, SE, SG, SK, SL, SM, ST, SV, SY, TH, TJ, TM, TN, TR, TT, TZ, UA, UG, US, UZ, VC, VN, ZA, ZM, ZW.
- (84) Designated States (unless otherwise indicated, for every kind of regional protection available): ARIPO (BW, GH, GM, KE, LR, LS, MW, MZ, NA, RW, SD, SL, ST, SZ, TZ, UG, ZM, ZW), Eurasian (AM, AZ, BY, KG, KZ, RU, TJ, TM), European (AL, AT, BE, BG, CH, CY, CZ, DE, DK, EE, ES, FI, FR, GB, GR, HR, HU, IE, IS, IT, LT, LU, LV, MC, MK, MT, NL, NO, PL, PT, RO, RS, SE, SI, SK, SM, TR), OAPI (BF, BJ, CF, CG, CI, CM, GA, GN, GQ, GW, KM, ML, MR, NE, SN, TD, TG).

Published:

- with international search report (Art. 21(3))
- before the expiration of the time limit for amending the claims and to be republished in the event of receipt of amendments (Rule 48.2(h))

(54) Title: CONVEYOR CHAIN

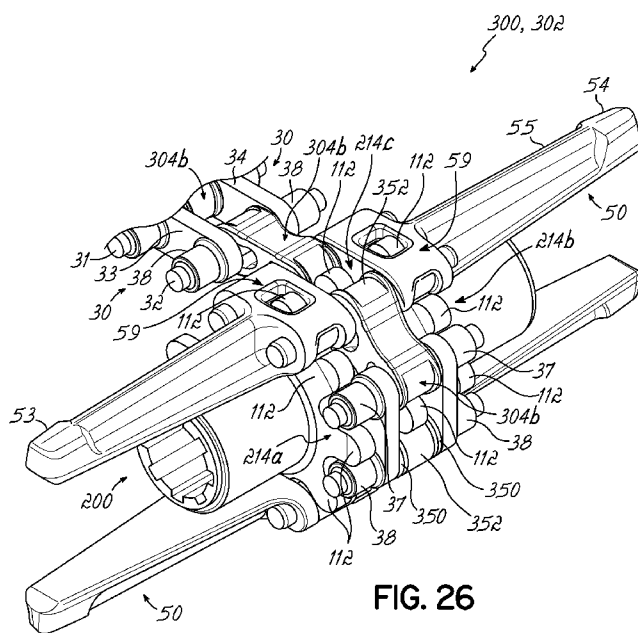

FIG. 26

(57) Abstract: A conveyor chain includes side link assemblies (35) and flight arm assemblies (50) coupled to form a chain (25). The flight arm assemblies include opposing flight arms (53, 54) each including an elongated body (55) extending from an integral base (56) and a vertical sprocket opening (59). The sprocket opening engages a tooth of a drive sprocket to drive the flight arm. The side link assemblies (35) include opposing side straps (33, 34) each including a base and a pair of side strap bosses (37, 38) extending from the base. An articulating connector (304, 404) is positioned between a flight arm assembly (50) and a side link assembly (35) and includes a solid piece and side surfaces (315, 317) having profiled surfaces therein and configured for receiving at least one of a portion of a side strap (33, 34) of a side link assembly (35) or a portion of a base (56) of a flight arm assembly (50). In one embodiment, the articulating connector (404) includes wings (450) that extend from the connector.

WO 2016/018893 A1

CONVEYOR CHAIN

PRIORITY

[0001] This Application is a PCT Application claiming priority to U.S. Patent Application Serial No. 14/577,587, entitled "CONVEYOR CHAIN", filed December 19, 2014 and U.S. Patent Application Serial No. 14/445,981, entitled "CONVEYOR CHAIN", filed July 29, 2014; which Applications are Continuation-in-Part Applications of U.S. Patent Application Serial No. 13,908,343, entitled "CONVEYOR CHAIN", filed June 3, 2013, now Issued U.S. Patent No. 8,936,146, issued January 20, 2015; which Application is a Continuation-in-Part Application of U.S. Patent Application Serial No. 12/559,799, entitled "CONVEYOR CHAIN", filed September 15, 2009, now Issued U.S. Patent No. 8,453,826, issued June 4, 2013; which Application claims the benefit of U.S. Provisional Patent Application Serial No. 61/098,870, entitled "CONVEYOR CHAIN", filed September 22, 2008, and U.S. Provisional Patent Application Serial No. 61/234,398, entitled "CONVEYOR CHAIN", filed August 17, 2009, the applications, patents, and disclosures of which are incorporated by reference herein in their entireties.

BACKGROUND

[0002] Pusher-type chain conveyors, as used in the mining industry, are found both in the form of separate conveying units, and as integral parts of continuous mining machines. One example of a continuous mining machine is a self-propelled mining machine. It is provided at its forward end with cutting means shiftable in such a way that an entry is cut in the material being mined. The entry is so sized as to

permit passage of the mining machine therethrough. Since the cutting operation is a continuous one, it is advantageous to provide means to move the cut material from in front of the mining machine and to convey it out of the entry.

[0003] One or several conveyors may be incorporated into the mining machine's construction that acts successively to transport the cut material rearwardly from the machine. One example of a conveyor that is incorporated into the mining machine extends from the front to the rear of the machine. The purpose of this conveyor is to remove the cut material from entry and deliver the cut material to other conveying means. The other conveying means may comprise mine cars or other vehicles used for hauling, portable belt conveyors or other conveyors designed for loading and unloading mined material from the mining machine, or the like.

[0004] An example of a conveyor that has been encountered in association with a continuous mining machine includes a section of conveyor base means mounted on the mining machine body. One or more additional sections of conveyor base means are connected thereto end-to-end, and extend beyond the rearward end of the mining machine body. All of the base means sections are characterized by a bottom portion provided with longitudinally extending, upstanding side guides or flanges. The various sections of the tail conveyor can be capable of both lateral and vertical movement with respect to each other, which enables the cut material to be delivered to a desired point despite changes of position of the mining machine as it advances in the entry and changes in level of the entry floor. The lateral and vertical movement capability of the conveyor sections may also enable the shifting of the desired delivery point for the material being mined, as required.

[0005] This type of conveyor may incorporate a continuous pusher-type conveyor chain, which is driven along the length of the conveyor base sections. The chain may be provided with a plurality of rigid pusher elements, normally extending substantially transversely of the conveying direction. The pusher elements are located at spaced intervals along the chain. Adjacent pusher elements may be joined together by a series of alternate block-like links and plate-like links. At one end of the machine's conveyor, the continuous chain passes over a driven sprocket. At the other end of the conveyor, the chain passes over a driven or idler sprocket, or roller.

[0006] Various embodiments of a conveyor chain configured to be used in conjunction with a dual drive sprocket on a mining machine are disclosed in the following applications: U.S. Provisional Patent Application No. 60/238,877, filed October 6, 2000; PCT Patent Application Serial No. PCT/US01/31746, filed October 9, 2001; and U.S. Nonprovisional Patent Application Serial No. 10/398,387, which was filed on April 7, 2003 and is now issued as U.S. Patent No. 8,016,102; the disclosures of which are incorporated by reference herein.

[0007] Typically in the underground mining industry, machine downtime is very expensive. Should a conveyor chain fail (due to sudden impact or wear), the chain often would come apart during production causing several hours of expensive and unproductive downtime while the chain was repaired. Most often a conveyor chain fails from impact loads on the flight arms or other parts of the chain.

[0008] Accordingly, it is desirable to provide a conveyor chain that has specific features and structures to provide a robust design which functions as desired, are quiet, and will not fail under rigorous usage.

BRIEF DESCRIPTION OF THE DRAWINGS

[0009] The accompanying drawings, which are incorporated in and constitute a part of this specification, illustrate speech recognition system components and embodiments of the invention and, together with the detailed description of the embodiments given below, serve to explain the principles of the invention.

[00010] Figure 1 is a plan view of a typical continuous mining machine having a tail conveyor for initializing the chain of the invention.

[00011] Figure 2 depicts a perspective view of a segment of an exemplary conveyor chain in accordance with an embodiment of the invention.

[00012] Figure 3 depicts a perspective view of an exemplary side strap of an embodiment of the invention.

[00013] Figure 4 depicts a perspective view of an exemplary connecting pin of an embodiment of the invention.

[00014] Figure 5 depicts a perspective view of an exemplary universal link of an embodiment of the invention.

[00015] Figure 5A is a top view of an exemplary universal link of an embodiment of the invention.

[00016] Figure 5B is a side view of the exemplary universal link of Figure 5A.

[00017] Figure 6 depicts a perspective view of an exemplary connector link of an embodiment of the invention.

[00018] Figure 6A is a top view of an exemplary connector link of an embodiment of the invention.

[00019] Figure 6B is a side view of the exemplary connector link of Figure 6A.

[00020] Figure 7 depicts a perspective view of an exemplary universal connector assembly of an embodiment of the invention.

[00021] Figure 8 depicts a side cross-sectional view of the exemplary universal connector assembly of Figure 7 of an embodiment of the invention.

[00022] Figure 9 depicts a top plan view of an exemplary flight arm of an embodiment of the invention.

[00023] Figure 10 depicts a side elevation view of the exemplary flight arm of Figure 9 of an embodiment of the invention.

[00024] Figure 11 depicts an end view of the exemplary flight arm of Figure 9 of an embodiment of the invention.

[00025] Figure 12 depicts a perspective view of an exemplary flight pin of an embodiment of the invention.

[00026] Figure 13 depicts a perspective view of a section of exemplary conveyor chain engaged with an exemplary driving member comprising a dual drive sprocket of an embodiment of the invention.

[00027] Figure 14 depicts a perspective view of a section of exemplary conveyor chain engaged with an exemplary driving member comprising a triple drive sprocket of an embodiment of the invention.

[00028] Figure 15A is an exploded perspective view of an exemplary side link assembly of an embodiment of the invention.

[00029] Figure 15B is a side view of the exemplary side link assembly of Figure 15A.

[00030] Figure 16 is an exploded perspective view of an exemplary side link assembly of an embodiment of the invention.

[00031] Figure 17 is a perspective view of a segment of an exemplary conveyor chain in accordance with an embodiment of the invention.

[00032] Figure 18 is a perspective view of a segment of an exemplary conveyor chain in accordance with another embodiment of the invention.

[00033] Figure 19 is another perspective view of a portion of the exemplary conveyor chain illustrated in Figure 18.

[00034] Figure 20 is an exploded perspective view of a portion of the exemplary conveyor chain illustrated in Figure 19.

[00035] Figure 21 is a top cross-sectional view of the solid articulating connector of Figure 22 in accordance with one embodiment of the invention.

[00036] Figure 22 is a side view of the solid articulating connector of Figure 20 to provide articulation in a conveyor chain.

[00037] Figure 23 is a top perspective view of another embodiment of a solid articulating connector in accordance with the invention.

[00038] Figure 24 is a perspective view of a segment of another exemplary conveyor chain in accordance with an embodiment of the invention.

[00039] Figure 25 is a top perspective view of another embodiment of a solid articulating connector of the invention.

[00040] Figure 26 is a perspective view of a segment of another exemplary chain, in accordance with an embodiment of the invention.

[00041] Figure 27 is a perspective view of a segment of another exemplary conveyor chain in accordance with an embodiment of the invention.

[00042] Figure 28 is a perspective view of a segment of an exemplary conveyor chain in accordance with another embodiment of the invention.

[00043] Figure 29 is a perspective view of another embodiment of a solid articulating connector in accordance with the invention.

[00044] Figure 30 is a top cross-sectional view of the solid articulating connector of Figure 29 in accordance with one embodiment of the invention.

[00045] Figure 31 is a side view of the solid articulating connector of Figure 29 to provide articulation in a conveyor chain.

[00046] Figure 32 is another perspective view of a portion of the exemplary conveyor chain illustrated in Figure 28.

[00047] Figure 33 is an exploded perspective view of a portion of the exemplary conveyor chain illustrated in Figure 32.

[00048] Figure 34 is an end view of the solid articulating connector of Figure 29 to provide articulation in a conveyor chain.

[00049] Figure 35 is a top cross-sectional view of the solid articulating connector of Figure 29 in accordance with one embodiment of the invention

[00050] The drawings are not intended to be limiting in any way, and it is contemplated that various embodiments of the invention may be carried out in a variety of other ways, including those not necessarily depicted in the drawings. The accompanying drawings incorporated in and forming a part of the specification illustrate several aspects of the present invention, and together with the description serve to explain the principles of the invention; it being understood, however, that this invention is not limited to the precise arrangements shown.

DETAILED DESCRIPTION

[00051] The following description of certain examples of the invention should not be used to limit the scope of the present invention. Other examples, features, aspects, embodiments, and advantages of the invention will become apparent to those skilled in the art from the following description, which is by way of illustration,

one of the best modes contemplated for carrying out the invention. As will be realized, the invention is capable of other different and obvious aspects, all without departing from the invention. Accordingly, the drawings and descriptions should be regarded as illustrative in nature and not restrictive.

[00052] For better understanding of the invention, reference is first made to Figure 1, illustrating an exemplary environment for the chains of the present invention. Figure 1 diagrammatically illustrates a typical continuous mining machine generally indicated at 2 and provided with a tail conveyor, generally indicated at 3. The mining machine has a body portion 4 which is usually mounted on wheels or treads and is self-propelled. At the forward end of the mining machine, cutting elements are provided as shown at 5 and 6. These cutting elements 5 and 6 may take various well known forms and are suitably mounted such as on the frame 7, enabling the cutting means to be shifted in such a way that they will cut an entry large enough to receive and to permit advancement of the mining machine 2 in the cutting direction indicated by arrow A.

[00053] By various well-known conveying means, the cut material at the forward end of the mining machine is gathered and transported over or through the mining machine to the tail conveyor 3. This last mentioned conveyor comprises a conveyor base element, illustrated in Figure 1 as made up of two sections 8 and 9. The base element section 8 has a bottom portion 10 and upstanding side guide or flanges 11 and 12. Similarly, the section 9 has a bottom portion 13 and upstanding side guides or flanges 14 and 15. The section 9 is mounted on a boom 16 articulated to the rearward end of the mining machine body 4 as at point 17. The articulation is such that the boom 16 and its conveyor base element section 9 are shiftable with respect to the conveyor base element section 8 both in the vertical

plane and the horizontal plane. A pusher-type conveyor chain, generally indicated at 18, extends along the length of the conveyor base element sections 8 and 9 and is adapted to be driven along the upper surface of their bottom portions 10 and 13. It will be understood that the chain 18 is a continuous chain. Normally it will be driven by a sprocket positioned at least at one end of the tail conveyor 3.

[00054] As shown in Figure 1, a typical chain 18 is provided with a plurality of spaced pusher elements arms 19, extending substantially transversely of the conveying direction indicated by arrow B. It will be seen that the pusher elements preferably extend to both side of the chain 18 and that the pusher elements are located at predetermined intervals along the length of the chain.

[00055] Figure 2 illustrates a section of a conveyor chain 25 for use in a device such as that illustrated in Figure 1. The chain section illustrated in Figure 2 comprises two side link assemblies 35, four connector assemblies 40, and two flight arm assemblies 50. Of course, conveyor chain 25 will comprise any suitable number of side link assemblies, connector assemblies, and flight assemblies to produce a chain of sufficient length for a particular application. It will be appreciated that there is some appropriate duplication in the link assemblies. For example, side strap 33 may be virtually identical to side strap 34 in the side link assembly. In the illustrated embodiment, each universal connector assembly 40 comprises a universal link 42 Figure 5 and a connector link 43 Figure 6 with a universal pin 41 Figure 7 extending through the universal link 42 and the connector link 43. As shown in Figure 2, each flight arm assembly 50 comprises a pair of flight arm pins 51, 52 and a pair of flight arms 53, 54.

[00056] In the illustrated embodiment, the two side straps 33, 34 of each side link assembly 30 are spaced apart and positioned so that the two side strap bosses 37, 38 are facing outwardly with respect to a center line of the chain. In this example, each side strap boss 37, 38 comprises a hollow circular protrusion that includes an opening 39 that extends through the side strap boss 37, 38 and through base 35. Each side strap boss 37, 38 is configured to receive at least a portion of a connecting pin 31, 32. The connecting pins span between the side straps and connect the opposing side straps. Of course, side strap bosses 37, 38 may comprise any suitable shape, including but not limited to circular and square.

[00057] As shown in Figures 13 and 14, when the chain is driven, the side strap bosses 37, 38 are configured to engage a tooth 112 of a sprocket, such as one of sprockets 114a, 114b of drive mechanism 100 or outer sprockets 214a, 214b of drive mechanism 200. The chain is engaged and driven by a suitable driving member, such as a dual drive sprocket 100 Figure 13, a triple drive sprocket 200 Figure 14 or any other suitable driving member. The chain of the present invention is configured to be able to handle both a dual drive sprocket arrangement, as illustrated in Figure 13, or a triple drive sprocket arrangement as in Figure 14 depending on its use. In the illustrated embodiments, the side strap 33 in each side link assembly 30 is aligned with side strap 34 such that each side strap boss 37, 38 of side strap 33 is aligned with a corresponding side strap boss 37, 38 of side strap 34. In the embodiments, a first connecting pin 31 is inserted through the aligned side strap bosses 37 in side straps 33, 34, while a second connecting pin 32 is inserted through the aligned side strap bosses 38 in side straps 33, 34. Collectively, the side straps 33, 34 and connecting pins 31, 32 form a side link assembly 30.

[00058] The diameter of the connecting pins 31, 32 may be about 1-1/8 inch, or any other suitable dimension. By way of example only, in some embodiments the diameter of the connecting pin 31, 32 may range from about 1 inch to about 1- ¼ inch. Increasing the diameter of the connecting pins 31, 32 compared to bearing pins used in existing conveyor chains will improve the strength and reliability of the conveyor chain during operation while reducing the chance of chain breakage. The connecting pins 31, 32 and side strap bosses 37, 38 may be configured to provide a press fit, a sliding close tolerance fit, or any other suitable fit between the components to form the complete side link assembly. Connecting pins 31, 32 may be retained within side strap bosses 37, 38 by keeper pins, retaining rings, by press fit alone, or by any other suitable method or device. In one embodiment a ring is press fit onto the end of the connecting pin to engage groove 21 and hold the pins in the side straps 33, 34 of the side link assemblies (see Figure 4).

[00059] While the embodiment of the invention is illustrated in Figure 2 shows connecting pins 31, 32 that are retained within the side strap bosses 47, 48 by a press fit ring and a ring 23, Figures 15A, 15B and 16 illustrate alternative embodiments to the invention wherein alternative securing elements are utilized with the connecting pins, 31, 32 for forming the side link assembly 30. Specifically, as illustrated in Figure 15A, the connecting pins 31, 32 are inserted into the corresponding and aligning side strap bosses 37, 38 of the opposing side straps 33, 34. The connecting pins 31, 32 include connector grooves 21 formed therein at each end. When the connecting pins 31, 32 extend through the side strap bosses 37, 38, the corresponding grooves 21 at either end of the connecting pins are exposed adjacent the end of the respective bosses 37, 38. Retaining rings 80 in the form of external retaining are expandable rings that may be expanded or spread apart, are

appropriately positioned around an end of the connecting pins 31, 32 and are then dimensioned in an unexpanded state to engage the grooves 21 and fit snugly against the ends of the bosses 37, 38 to secure the connecting pins in the side straps 33, 34. The retaining rings 80 are illustrated in Figures 15A and 15B on one side of the assembly 30, but it will be readily understood that the retaining rings are implemented on both ends of the connecting pins 31, 32 for holding the pins in each of the side straps 33, 34. The external retaining rings or snap rings 80 may be formed with a suitably strong material such as stainless steel and may have an inner diameter around 1 1/16 inches. Figure 15B illustrates a side view of side link assembly 30 with rings 80 in place with the connecting pins 31, 32.

[00060] Turning now to Figure 16, that figure illustrates a side link assembly 30 and incorporates other retaining elements. Specifically, one or more spiral retaining rings 82 are utilized to fit into the grooves 21 of connecting pins 31, 32. The spiral retaining ring may be single turn or multi-turn spiral retaining rings. As illustrated in Figure 16, multiple spiral rings might be utilized to hold the connecting pins 31, 32. Alternatively, only a single spiral retaining ring might be utilized in the embodiment as shown in Figure 16. The external retaining rings 80 and spiral retaining rings 82 provide for an easier disassembly of the side link assembly such as for replacement or repair. The rings, 80, 82 may be removed and re-installed numerous times without destroying the rings or weakening their engagement with the pins.

[00061] Figures 5-8 depict one embodiment of a universal connector assembly 40. In the illustrated embodiment, universal connector assembly 40 comprises a universal pin 41, a universal link 42, and a connector link 43. The universal link 42 as pictured in Figure 5, comprises an upper lip 61 and lower lip 62 each having a vertical thru-hole 63, 64 that is configured to receive at least a portion of the

universal pin 41. The universal link 42 can also be described as the female link. In this example, universal link 42 further comprises connecting portion 65 that extends between upper lip 61 and lower lip 62. As shown, connecting portion 65 is rounded and has an inside surface that forms a horizontal bore/thru-hole 67 configured to receive at least a portion of a connecting pin 31, 32 of a side link assembly or a flight pin 51, 52 of a flight arm assembly. The universal link 42 also includes a groove 45 formed on the outside surface of the connecting portion 65. The groove 45 of universal connector assembly 40 provides a surface for engagement by a center or third sprocket for driving the chain discussed herein. In the illustrated embodiment, connector link 43 comprises a projecting member 71 sized and shaped to fit between the upper lip 61 and lower lip 62 of the universal link 42 as shown in Figure 7. The connector link 43 can also be described as a male link. In this version, projecting member 71 includes a vertical bore or thru-hole 72 that is configured to receive a universal pin 41. In this example, connector link 43 further comprises a horizontal bore or opening 73 that extends through the width of connector link 43 and is configured to receive at least a portion of a connecting pin 31, 32 or a flight pin 51, 52. The connector link 43 also includes a groove 47 formed on an end of the connector link opposite the projecting member. Groove 47 also provides a surface for engagement by a center/third sprocket for driving the chain if desired.

[00062] As shown in Figures 7 and 8, when universal connector assembly 40 is fully assembled, the projecting member 71 of the connector link 43 is inserted between the upper lip 61 and lower lip 62 of the universal link 42. In this example, vertical thru-holes 63, 64 of the universal link 42 are axially aligned with vertical thru-hole 72 of the connector link, such that the universal pin 41 may pass through the vertical thru-holes 64, 63, 72 as shown in Figures 7 and 8. The universal pin 41 may

be configured to increase mobility of the chain, allow the chain to articulate past objects, and reduce the load transmitted to the connecting pins 31, 32 when an obstruction in a conveying deck is encountered. Figures 5A-5B and 6A-6B illustrate alternative universal links and connector links respectively in accordance with another embodiment of the invention. Specifically, the universal link 42a and connector link 43a include thru-holes or bores that are induction hardened to have a greater hardness than the remaining portions of the respective links. For example, referring to Figures 5A and 5B, the horizontal bore or thru-hole 67 is hardened at a specific depth around the bore to a greater hardness rating than the rest of the link. For example, while the universal link 42a, after machining, might have a hardness of around 40-44 on the Rockwell C Scale (40-44 Rc) the thru-hole bore 67 might be induction hardened to have a hardness rating of around 50-54 Rc. In accordance with one embodiment of the invention, such hardness may be induced to a depth D of 1/8 inch to 3/16 inches deep around the thru-hole and completely through that hole 67.

[00063] Connector link 43a as shown in Figures 6A-6B might also be hardened in accordance with an embodiment of the invention. To that end, vertical bore or thru-hole 72 and horizontal bore or opening 73 might also be hardened to a hardness of 50-54 Rc around the bore or hole to a depth D of 1/8 inch to 3/16 inches.

[00064] In accordance with an aspect of the invention, the localized bore or thru-hole hardening in the links, 42a, 43a of a universal connector assembly with respect to the overall link elements will reduce the wear in those various high bore and wear areas where the pins 41 and 31, 32, 51, 52 engage and thus extend the overall life of the chain. Generally, a universal pin 41, as illustrated in Figure 7, is

held in place in holes 63, 64, such as by a weld 49. Therefore the hardening of hole 72 provides desirable wear resistance. Similarly, as the hole 67 and opening 73 rotate around connecting pins 31, 32 or flight pins 51, 52, the hardening of those holes and openings provide additional wear resistance to extend the overall life of the chain.

[00065] When the various elements of the universal connector assembly are hardened, they are induction hardened by positioning a coil in the various holes or bores introducing significant heat, such as around 1600° Fahrenheit to that coil. The temperature and length of time of the induction hardening may be adjusted accordingly in order to achieve the desired depth of induction hardening of the noted bores and thru-holes.

[00066] As shown in Figure 2, flight arm assembly 50 comprises a pair of flight pins 51, 52 and a pair of flight arms 53, 54 positioned on either side of the chain. In the example of Figures 9-11, each flight arm 53, 54 comprises an elongated body 55 extending substantially perpendicular from an integral base 56. In this embodiment, each base 56 includes a pair of flight arm attachment apertures 57, 58 or pockets that extend transversely through the base 56. Each flight arm attachment aperture 57, 58 may be configured to receive at least a portion of one of the flight pins 51, 52. As shown, each base 56 further comprises a vertical sprocket opening 59 that is formed through the base and extends vertically through the base 56. The diameter of the flight pin may be about 1-1/8 inch, or any other suitable dimension. By way of example only, in some embodiments the diameter of the flight pin 51, 52 may range from about 1 inch to about 1-1/4 inch. Increasing the diameter of the flight pins 51, 52 compared to bearing pins used in existing conveyor chains will improve the strength and reliability of the conveyor chain during operation while reducing the chance of

chain breakage. The flight pins 51, 52 and bases 56 may be configured to provide a press fit, a sliding close tolerance fit, or any other suitable fit between the components. Flight pins 51, 52 may be retained within the flight arm attachment apertures 57, 58 of bases 56 by keeper pins, welding by press fit, by press fit and weld, or by any other suitable method or device.

[00067] As shown in Figures 9-11, flight arm 53, 54 comprises an elongated body 55 having a flat, planar bottom surface 111 and an integral base 56. In this version, elongated body 55 comprises a central rib 101 that may act as a pusher for the material being conveyed. In this example, the outer free end of flight arm 53, 54 is provided with a knob-like portion 102 which can ride against side guide elements associated with the conveyors. The base 56 may be provided with a vertical sprocket opening 59. As shown in Figures 13 and 14, sprocket opening 59 is sized and shaped to engage a tooth 112 of a drive sprocket such as one of sprockets 114a, 114b of driving member 100 or sprockets 214a, 214b of driving member 200 when the chain is engaged and driven by a suitable driving member, such as a dual drive sprocket 100, a triple drive sprocket 200 or any other suitable driving member. While sprocket opening 59 is substantially rectangular in the illustrated embodiment, it will be appreciated that sprocket opening 59 may comprise any suitable shape configured to receive and engage a tooth 112, including but not limited to circular, oval, square, and rectangular. The base 56 also has a groove 61 formed in the base 56 along a bottom of the base for proper engagement and clearance of any sprocket teeth 102. In the illustrated version, base 56 also comprises the two flight arm attachment aperture 57, 58. As shown in Figure 2, flight arm 53 in each flight arm assembly 50 is aligned with flight arm 54 on the other side of the chain such that the flight arm attachment apertures 57, 58 of flight arm 53 are aligned with the flight arm

attachment apertures 57, 58 of flight arm 54. In this example, a first flight pin 51 is inserted through the aligned flight arm attachment apertures 57 in flight arms 53, 54, while a second flight pin 52 is inserted through the aligned flight arm attachment apertures 58 in the flight arms 53, 54. In addition, each of the flight pins 51, 52 are inserted through appropriate horizontal openings 73 of a pair of connector links 43 or holes 67 a pair of universal links positioned between the flight arms 53, 54.

[00068] As shown in Figure 2, section of conveyor chain 25 comprises a plurality of alternating side link assemblies 30 and flight arm assemblies 50 connected by connector assemblies 40. In this version, each universal connector assembly 40 is configured and arranged to be connected to both a side link assembly 30 and a flight arm assembly 50. In this example, conveyor chain 25 comprises a side link assembly 30 connected to a first universal connector assembly 40, a flight arm assembly 50 connected to both the first universal connector assembly 40 and a second universal connector assembly 40, and the second universal connector assembly 40 is connected to a second side link assembly 30 and so on in a repeating pattern. While the illustrated version depicts a chain comprising alternating side strap assemblies 30 and flight arm assemblies 50, it will be appreciated that a section of chain may comprise any suitable arrangement of side strap assemblies 30 and flight arm assemblies 50. By way of example only, in an alternate embodiment (not shown), a section of conveyor chain may comprise two side strap assemblies positioned between a pair of flight arm assemblies. As shown in Figure 2, a side link assembly 30 is connected to a universal connector assembly 40 via a connecting pin 32. In this version, connecting pin 32 is positioned such that it passes through the aligned side strap bosses 38 of side straps 33, 34 and the opening 67 formed by connecting member 65 of universal link 42. (Alternatively, a

side link assembly 30 may be connected to a universal connector assembly 40 via a connecting pin 31 such that connecting pin 31 is positioned so that it passes through the aligned side strap bosses 37 of side straps 33, 34 and the horizontal opening 73 in connector link 43.) Similarly, flight assembly 50 may be connected to a universal connector assembly 40 by positioning a flight pin 51, 52 through a pair of aligned flight arm attachment apertures 57, 58 in two opposing flight arms 53, 54 and the horizontal opening 73 in connector link 43. (Alternatively, a flight assembly 50 may be connected to a universal connector assembly 40 by positioning a flight pin 51, 52 through a pair of aligned flight arm attachment apertures 57, 58 in two opposing flight arms 53, 54 and the opening 67 formed by connecting member 65 in a universal link 42.)

[00069] Figure 17 illustrates another embodiment of the invention. Chain 250 is similar to the chains described herein in many details but also incorporates flight assemblies having an alternative construction. Specifically, chain 250 incorporates flight arm assemblies 260 that incorporate flight arms that are covered in a suitable urethane material 270. The urethane material, in accordance with one aspect of the invention, provides for a reduction in the noise generated when the chain 250 is in operation. While chain 250, incorporates different flight arm assemblies 260, other components of the chain, such as the side link assemblies and universal connector assemblies may be constructed as noted herein. Each of the flight arm assemblies 260 includes a pair of flight pins 51, 52 as discussed above. Each of the flight arms 262 also includes an elongated body 264 which extends substantially perpendicular from an integral base 266. Base 266 may resemble base 56 illustrated in other figures and discussed herein. That is, the base includes a pair of flight arm

attachment apertures 57, 58 that extend transversely through the base. Each base also includes a vertical sprocket opening 59 that is formed through the base and extends vertically therethrough, such as to receive the teeth of drive sprockets.

[00070] Each flight assembly 260 includes a layer of urethane material 270 that is formed or appropriately applied to the elongated body 262 of the flight arms. The elongated body 262 incorporates a series of apertures that are formed in the body 262. The embodiment illustrated in Figure 17 shows 5 apertures, including apertures 272 having a circular diameter of 1.25 inches and two larger apertures 274 having a circular diameter of approximately 2 inches. The apertures are formed through each of the flight arms from top to bottom and provide passages for the flow of urethane material therethrough to form an integral attachment of the urethane material layer 270 to the flight arm bodies 262. For example, the urethane material may be flowed or formed over the flight arm bodies 262 in a liquid or semi liquid form which flows or extends through the apertures 272, 274. The urethane material then hardens and secures the material layer 270 to the flight arm 262 to become an integral part of the flight assembly 260. The urethane material layer is illustrated over most or all of the elongated body of the flight arm, but urethane material might be used over at least a portion of the elongated body. It would be understood by person of ordinary skill in the art that apertures having a shape or cross section that is different than a circular cross section may be implemented. Furthermore, a greater or lesser number of apertures may be utilized along the length of the flight arm bodies 262. Still further, different sizes of apertures may be implemented along the length of the flight arm bodies 262, therefore the invention is not limited to the number, size or shape of the apertures formed in the flight arm as illustrated in the example of the Figures. Each flight arm body 262 has a generally flat upper surface 276 and lower surface 278.

Similarly, the urethane material layer 270 in the embodiment illustrated in Figure 17, is shown to have a similar flat upper, lower surface conforming with the surfaces 276, 278 of the flight arm bodies 262. In that way, the flight arm slides freely along a conveyor surface. Also, although the urethane material layer 270 illustrated in Figure 17 is shown to be somewhat clear, thus revealing the elongated the flight arm bodies 262, urethane material 270 might also be opaque in order to hide the internal flight arm body 262.

[00071] In another alternative embodiment of the invention, elements of the chain are covered with a corrosion protective coating. For example, the elements might be galvanized, or maybe covered with a nickel coating. In one embodiment, various connecting pins 31, 32 and flight pins 51, 52 as well as the universal pin 41, universal link 42 and connector link 43 are all coated as appropriate for protection against corrosion. Additionally, the elements of the side link assembly, including the base 35 and side strap bosses 37, 38 and any internal openings 39 may be coated with a suitable corrosion protective coating.

[00072] As shown in Figure 13, conveyor chain 115 is driven by a driving member 100. In this example, driving member 100 comprises a dual drive sprocket that includes sprockets 114a, 114b. It will be appreciated that driving member 100 may comprise any suitable number of sprockets, including but not limited to a dual drive sprocket as shown in Figure 13, a triple drive sprocket as shown in Figure 14, or any other suitable number of sprockets. It will further be appreciated that driving member may comprise any suitable size sprockets, including but not limited to a four tooth sprocket, five tooth sprocket, a six-tooth sprocket, an eight tooth sprocket, and various combinations thereof. Use of a dual drive sprocket, such as driving member 100 shown in Figure 13, and a corresponding conveyor chain configured to be used

with a dual drive sprocket, such as conveyor chains 25, 115, 205, may reduce operational noise and improve sprocket tooth life. The two sprockets 114a, 114b comprising driving member 100 may be substantially identical to each other and configured to rotate in unison with each other. By way of example only, in the embodiments shown in Figure 13, sprockets 114a, 114b are each eight-tooth sprockets.

[00073] As shown, sprockets 114a, 114b are spaced apart so that they are aligned with the side strap bosses 37, 38 and the vertical sprocket openings 59 along each side of the chain 115. In the illustrated embodiment, as conveyor chain 115 wraps around driving member 100, each sprocket tooth 112 engages a side strap boss 37, 38 or the base 56 of a flight arm 53, 54 via a vertical sprocket opening 59 along both sides of the chain 115. As shown, a first sprocket tooth 112 may abut a first side strap boss 37, while a second sprocket tooth 112 may abut a second side strap boss 38, while a third sprocket tooth 112 may be received by and extend at least partially through a vertical sprocket opening 59. Although not shown in Figure 13, additional sprocket teeth may engage additional side strap bosses and vertical sprocket openings as the chain wraps around the dual sprocket. In the illustrated embodiment, the sprocket teeth 112 do not directly engage or contact connecting pins 31, 32) or flight pins 51, 52. Because the points of engagement between conveyor chain 115 and sprocket teeth 112 (i.e. side strap bosses 37, 38 and flight arm bases 56) are thicker than the points of engagement in some prior art conveyor chains (where sprocket teeth directly engage bearing pins in the chain), conveyor chain 115 may provide improved chain life and strength.

[00074] As shown in Figure 14, conveyor chain 205 is driven by a driving member 200. In this example, driving member 200 comprises a triple drive sprocket that includes two outer sprockets 214a, 214b and a central sprocket 214c. It will be appreciated that driving member 200 may comprise any suitable number of sprockets, including but not limited to a dual drive sprocket as shown in Figure 13, a triple drive sprocket as shown in Figure 14, or any other suitable number of sprockets. It will further be appreciated that the driving member may comprise any suitable size sprockets, including but not limited to a four tooth sprocket, five tooth sprocket, a six-tooth sprocket, an eight tooth sprocket, and various combinations thereof. Use of a triple drive sprocket, such as driving member 200 shown in Figure 14, and a corresponding conveyor chain configured to be used with a triple drive sprocket, such as conveyor chains 25, 115, 205, may reduce operational noise and improve sprocket tooth life. The two outer sprockets 214a, 214b may be substantially identical to each other, while central sprocket 214c may be configured to have half as many sprocket teeth as outer sprockets 214a, 214b. Other suitable relationships between the outer sprockets and the central sprocket may be apparent to those of ordinary skill in the art. All three sprockets 214a, 214b, 214c may be configured to rotate in unison with each other. By way of example only, in the embodiment shown in Figure 14, outer sprockets 214a, 214b are each eight-tooth sprockets and central sprocket 214c is a four-tooth sprocket.

[00075] As shown, outer sprockets 214a, 214b are spaced apart so that they are aligned with the side strap bosses 37, 38 and the vertical sprocket openings 59 along each side of the chain 205. Also, in this example, central sprocket 214c is positioned so that the teeth 112 of central sprocket 214c are received in the gap between adjacent universal connector assemblies 40 and engage a universal

connector assembly 40. In the illustrated embodiment, as conveyor chain 205 wraps around driving member 200, each sprocket tooth 112 of the outer sprockets 214a, 214b engages a side strap boss 37, 38 or the base 56 of a flight arm 53, 54 via a vertical sprocket opening 59 along both sides of the chain 205. At the same time, each sprocket tooth 112 of central sprocket 214c engages a universal connector assembly 40 along the central longitudinal axis of the chain 205. The sprocket teeth of central sprocket 214c engage grooves 45, 47 formed in universal connector assembly 40. As shown, a first sprocket tooth 112 of an outer sprocket 214a, 214b may abut a first side strap boss 37, while a second sprocket tooth 112 of an outer sprocket 214a, 214b may abut a second side strap boss 38, while a third tooth 112 of an outer sprocket 214a, 214b may be received by and extend at least partially through a vertical sprocket opening 59. At the same time, a first sprocket tooth 112 of central sprocket 214c may be received by and extend at least partially through an opening between a first pair of adjacent universal connector assemblies 40, while a second sprocket tooth 112 of central sprocket 214c may be received by and extend at least partially through an opening between a second pair of adjacent universal connector assemblies 40. Although not shown in Figure 14, additional sprocket teeth 112 on outer the outer sprockets 214a, 214b may engage additional side strap bosses and vertical sprocket openings and additional sprocket teeth 112 on central sprocket 214c may engage additional openings between additional pairs of adjacent universal connector assemblies 40 as the chain wraps around the driving member 200. In the illustrated embodiment, the sprocket teeth 112 do not directly engage or contact connecting pins 31, 32 or flight pins 51, 52. Because the points of engagement between conveyor chain 205 and sprocket teeth 112 (i.e. side strap bosses 37, 38, flight arm bases 56, and universal connector assemblies 40) are

thicker than the points of engagement in some prior art conveyor chains (such as chains where sprocket teeth directly engage bearing pins in the chain), conveyor chain 205 may provide improved chain life and strength.

[00076] In an alternate embodiment (not shown), the driving member may comprise a single sprocket, such as central sprocket 214c described above. In such an embodiment, the single sprocket may be positioned and configured to engage the chain by having the teeth of the sprocket received between adjacent universal connector assemblies, similar to the central sprocket 214c described above.

[00077] Figure 18 illustrates an alternative embodiment of the invention, wherein a solid articulating connector 304 is utilized to replace some or all of the universal connector assemblies 40, along the length of the chain 300. Figure 24 illustrates another embodiment 302, wherein all of the universal connector assemblies 40 are replaced by the solid articulating connector 304. The articulating connector 304 is in the form of a solid single piece or body that is formed of an appropriate steel material, such as a carbon alloy steel. In the chains of Figures 18 and 24, like reference numerals will be utilized for those parts and portions of the chain previously discussed herein. Specifically, chains 300 and 302 include a plurality of flight arm assemblies 50 connected with side link assemblies 35, with appropriate connectors. In the embodiment illustrated in Figure 18, every other universal connector is a single piece solid articulating connector 304 of the invention, along with other universal connector assemblies 40. As discussed herein, the chain can be driven by a suitable drive mechanism 200, including either a dual sprocket arrangement, or a triple sprocket arrangement, for example (See Figure 14).

[00078] Referring to Figures 18 and 19, universal connector 304 is coupled with each of the respective side link assemblies and flight arm assemblies by respective flight pins 51, 52, and connecting pins 31, 32. The connectors 304 are captured between the side straps 33, 34, and flight arms 53, 54. The pins pass through apertures 306, 308 formed in the connector 304 to extend transversely, or from side to side in the body, as illustrated in Figures 20-22. The apertures 306, 308 extend laterally or from side to side in the articulating connector, and are dimensioned with respect to the diameter of the pins, and are configured so as to provide movement and articulation of the pins within the connector, and thus, provide articulation of the chain 300, 302, as illustrated in Figures 18 - 20 and 24. In one embodiment, the apertures 306, 308 are dimensional in length L, with respect to the pin to be larger than the diameter D of a pin (31, 32, 51, 52) length so as to provide articulation in the path of chain movement. Generally, the height dimension H will be similar to the pin diameter D, with some nominal clearance. In one exemplary embodiment, the length L may be up to three times (3x) diameter D in length, while the height may be around D with a +0.015 inch clearance or more.

[00079] Turning to Figures 21-23, unique solid articulating connector 304 of the invention operates similar to a universal connector but provides greater chain strength and eliminates the need for the more complicated universal connector assembly 40. As such, this eliminates the need for universal link 42, the connector link 43, as well as the various universal pins 41. As such, the articulating connector 304 reduces the complexity of the chain, increases the chain strength and also reduces potential breakage points associated with a universal connector assembly. Furthermore, the solid single piece articulating universal connectors 304 weigh around 2-3 pounds less than a typical universal assembly 40, and thus, can

significantly reduce the weight of the chain by, on average, 200 pounds, for a typical chain length. The articulating connector 304 is uniquely formed and shaped with specific curved and profiled apertures and surfaces to provide the articulation and universal movement of the chains, as desired, and as necessary for their proper operation. In one embodiment of the invention, the connector may be configured to provide an articulation angle in the range from 0° - 150° .

[00080] Turning to Figures 21-23, the articulating connector 304 has a unique configuration and shape to provide the desired universal movement, articulation, and robustness of the solid articulating connector, in accordance with the invention. The solid articulating connector is shaped so as to provide the desired articulation, as well as to allow the necessary clearance around portions of the drive mechanism, such as a sprocket shaft and/or tail shaft roller, as discussed herein. Therefore, the invention provides a solid single piece articulating connector with a profile design to allow articulation of a conveyor chain on bulk material conveyor equipment. The solid articulating connector profile is dimensioned, and can be modified, within a range to allow essentially no articulation for straight running conveyors, or up to 150° total articulation for a single articulating connector around a pin, such as pins 51, 52, and pins 31 and 32, as shown in Figures 18-20.

[00081] Turning to Figure 21, a top cross-sectional view of a solid articulating connector 304 is illustrated, showing apertures 306, 308 therein at both ends of the connector. The apertures are in the form of uniquely configured and profiled holes that will have a diameter D dimension reflective of the size of the various flight pins, or connecting pins handled by connector 304. The connector is dimensioned to have a block height H_b and a block width W_b . Block height H_b may be in the range of a hole diameter plus 0.125 inches (hole $D + 0.125$) to $(3x \text{ hole } D)$. The hole diameter

D might be in the range of 0.25 inches – 2.50 inches. As such, a suitable block height H_b might be from 0.375 inches – 7.5 inches. In one embodiment, the $H_b = 2.25$ inches. The width W_b might be in the range of 1 inch – 5 inches. In one embodiment, the $W_b = 2.25$ inches.

[00082] Articulating connector 304 may be dimensioned to have a suitable pitch P of 1 inch – 10 inches. In one embodiment, the pitch P is around 3.63 inches. The embodiments of the articulating connector 304 illustrated also has a center section 310 having a certain material thickness. The center section spans between the top and bottom walls 311, 313 of the connector. The center section 310 might also be eliminated. The material thickness of the center section 310 (Dimension C in Figure 22) might be anywhere from 0 inches up to 9.75 inches, which would reflect an upper limit of approximately the pitch P minus the hole diameter D. In one embodiment, such thickness is around 0.75 inches. In the center section 310, because of the radiused shape of holes of apertures 306, 308, the thickness will vary along the height of section 310. Furthermore, the connector includes a wall thickness T that may be from approximately 0.0625 inches up to 2.5 inches. This reflects a wall thickness T that is from 0.0625 inches up to one-half of the block height H minus the hole diameter D ($(\text{block height } H - \text{hole diameter } D)/2$). In one embodiment, the thickness T = 0.55 inches.

[00083] In accordance with one aspect of the solid articulating connector 304 of the invention, the side connector surfaces are appropriately curved and profiled inwardly to provide the desired articulation, as well as operation with the drive mechanism driving a chain. To that end, the solid articulating connector 304 includes contoured profiles in the sides, top, and bottom of the connector. Referring to Figure 21, the sides 315, 317 of the connector have an exterior profile that is

contoured with an indent or inwardly profiled surface 312 that is dimensioned in depth D_1 and width W_1 , on both sides of the connector. The inwardly profiled surfaces 312 provide a suitable articulation angle A , as illustrated in Figure 20. The profiled surfaces 312 are configured to receive a portion of the flight arm assembly or a portion of the side link assembly to provide articulation of the chain. More specifically, as illustrated in Figures 19 and 20, the profiled surfaces 312 are configured to receive an end portion 360 of side straps 33, 34, or to receive an end portion 362 of a base 56 for providing articulation of the flight arm assembly and side link assembly with respect to each other and articulation of the conveyor chain along its path of travel 364, as shown in Figure 19. The profiled surfaces 312 may be comprised of suitable angled or chamfered surfaces, or curved/radiused surfaces to allow proper articulation, the depth D_1 and the width W_1 and radius R_1 provide the desired articulation, as shown in Figures 19 and 20. To that end, in one embodiment of the invention, the depth D_1 might be anywhere from 0 inches – 2.5 inches, or from essentially 0 inches – one-half of block width W_b . As may be understood by a person of ordinary skill in the art, a profile surface 312 having a depth D_1 of 0 inches would essentially be a straight block, without a particular side profile. The width W_1 might be anywhere from 0 inches – 12.5 inches, or essentially from 0 inches to the dimension of the pitch plus the hole diameter (pitch P + hole D).

[00084] In one embodiment, the surface is dimensioned with $D_1 = 0.25$ inches, $W_1 = 2.18$ inches, and an $R_1 = 2.50$ inches. The edges 319 might form radiused transition edges at a radius of around 0.75 inches in one embodiment. Referring to Figure 21, the overall block length L_b might be in the range of 1.25 inches – 15 inches. Generally, the block length L_b might be in the range of 1 inches plus the hole

diameter D_1 , up to the pitch P dimension plus the hole diameter D , plus two times the wall thickness T ((pitch P + hole D + (2x wall thickness T)). In one embodiment, the $L_b = 5.88$ inches.

[00085] Referring again to Figure 21, solid articulating connector 304 includes opposing ends of the connector that include profiled end surfaces 316 that work in tandem with the exterior side profiled surfaces 312 to provide the articulation of connector 304. The profiled surfaces 316 may be suitably chamfered, or may be outwardly radiused, or could be in the form of a sharp corner. In Figure 21, a radiused edge or surface is shown, and may have a radius range of 0 inches (sharp corner) to 5 inches, or generally from 0 – (wall thickness T + hole D). In one embodiment, the radius is around 0.25 inches. The profiled surfaces 316 engage a portion of either the side straps 33, 34, or the base 56, as shown in Figure 19, when the chain articulates. As seen in Figure 19, the profiled surfaces 312 and profiled surfaces 316 are engaged on opposite sides of the chain during articulation.

[00086] As seen in Figures 21 and 22, each of the holes or apertures 306, 308 is configured to receive one of the noted pins (31, 32, 51, 52) that couple the connector to various side link assemblies or flight arm assemblies. In accordance with one aspect of the invention, each of the aperture openings includes a pin hole profiled surface that forms a curved or radiused surface along an outer surface, as indicated by reference numeral 320 in the figures, and along an inner surface 321. The profiled or curved surfaces 320, 321 of apertures 306, 308, allow a smooth articulation between each of the various pins, and the solid articulating connector 304. The surfaces 320, 321 open up the holes 306 and 308 to have a diameter that is equal to the hole size or larger. The diameter D is reflective of the diameter of a pin 32, 51 in the solid articulating connector 304 (See Figure 20). Surfaces 320, 321

also follows a radiused profile that is sized based on the articulation angle that is desired, such as from 0 - 150° articulation, as illustrated in articulation angle A of Figure 21. The profiled or curved surface 320 allows the solid articulating connector to roll on the pin during articulation. In one embodiment, the profiled surfaces 320, 321 reflect a radius of around 1.25 inches. The ends of the solid articulating connector might also be appropriately chamfered at an angle A_2 of around 5 degrees, or suitable draft angle. The profiled surfaces 320, which will bear most of the load from the pins 31, 32, 51, 52, may be induction hardened to have a greater hardness. The surfaces 320 of the apertures 306, 308 are hardened at a specific depth around the apertures to a greater hardness rating than the rest of the link. For example, while the articulating connector might have a hardness of around 40-44 on the Rockwell C Scale (Rc), the surfaces 320 might be induction hardened to have a hardness rating of around 50-54 Rc. In accordance with one embodiment of the invention, the hardness may be induced to a depth D of 1/8 inch to 3/16 inches deep around the surfaces 320 and extending through the apertures from side to side.

[00087] Turning to Figure 22, the connector 304 is profiled inwardly along the top and bottom surfaces in accordance with one aspect of the invention, to provide clearance and articulation around the rollers of the drive shaft and tail shaft. For example, the top and bottom connector surfaces include inwardly profiled surfaces 323, 325 therein that allow clearance and articulation around the sprocket foot shaft and/or tail shaft roller. As illustrated, the profiled surfaces are shown to have a depth of D_2 , and a width of W_2 and a radius R_2 , and may be comprised of cooperative surfaces to form the profile, or curve, which will provide a clearance of the rollers, as the articulating connectors move over the rollers. A suitable profile for the depth D_2 would be from 0 to 3.75 inches, or roughly 0 – one-half the block height H_b . The

width dimension W_2 might be in the range of 0 – 12.5 inches, or from 0 to (pitch + hole diameter). As would be understood by a person of ordinary skill in the art, if a depth and width of 0 inches would essentially refer to a block that does not have the noted clearance profile, as illustrated in Figure 22. Other embodiments would have the desirable angled chamfer or radius curves for providing the profile illustrated in Figure 22 along the top and bottom of the connector 304. In one embodiment, the profiled surface has $D_2 = .25$ inches, $W_2 = 2.13$ inches, and $R_2 = 2.40$ inches. Corner edge surfaces 327 have a radius of around 0.75 inches.

[00088] The aperture diameter D might be in the range of 0.25 – 2.5 inches to define the curved inner surfaces from top to bottom of apertures 306, 308 to accommodate the pins. In one embodiment $D = 1.14$ inches.

[00089] Figure 23 illustrates an alternative embodiment of the invention, wherein the exterior side surfaces 324 of the sides of the solid articulating connector on either end of the connector and either end profiled surfaces 312 are also profiled. Specifically, surfaces 324 are chamfered or radiused to, or otherwise profiled outwardly from, the connector sides to increase the effective block width W_b . Specifically, as shown by solid articulating connector 304a in Figure 23, side surfaces 324 are profiled with a suitable radius or chamfer to provide an effective widening of the block width W_b outwardly from the ends of solid articulating connector 304a. Generally, the top profile would then more aptly resemble a “bow tie” shape, as illustrated in Figure 23. For example, an 11° chamfer angle A_c might be provided on opposite ends of the point defining the widest W_b . The chamfer works with radiused surfaces reflect by R_3 to form a $W_b = 2.44$ in one embodiment. Connector 304a may have aperture dimensions and profiling, as well as top and bottom dimensions shown in Figure 22.

[00090] Referring to Figure 20, providing a profiled, radiused, or chamfered surface, and thus, a wider block width W_b at the surfaces 324, as illustrated in Figure 23, will add additional material on the side, and thus, take up space or slack in between the various side straps and/or flight arms in the chain. As shown in Figures 19 and 20, when the chain articulates, uniquely profiled openings 306 and 308, and the various profiled surfaces 312, 323, 325, 320, 321, 316 provide movement of the solid articulating connector 304 around the pins 32 and 51. However, when the chain is straight, as shown in portions of Figure 18, there may be spacing between the opposing side straps or flight arms that provides some slack between the sides of the solid articulating connector 304 and those components of the chain. By providing a profiled, radiused, or chamfered surface 324, as shown in Figure 23, such slack may be addressed, while still providing suitable articulation of the link assemblies, with respect to the solid articulating connector 304. The side profiled surfaces 312 provide clearance to prevent interference with the flights and the base or head 56 of the flights, as shown in Figure 20. Profiled surfaces 320, 321 provide smooth articulation between the pins and the connector. Profiled surfaces 316 prevent interference between the connector and opposing flight bases 56. The profiled surfaces 323, 325 provide clearance around sprocket rollers.

[00091] Figure 24 illustrates another embodiment of the chain, wherein the solid articulating connectors 304 are utilized between each of the link assemblies in the chain 302, rather than every other one, as illustrated in Figure 18. Thus, Figure 24 provides a chain that is even lighter, and which still maintains the ability to articulate as desired, similar to the articulation provided by the universal connector

assembly, as utilized in other embodiments. Thus, chain 24 eliminates any of the drawbacks associated with the universal connector assemblies 40, by utilizing only the invented solid single-piece articulating connector 304 of the invention.

[00092] Figures 25 and 26 illustrate additional embodiments of the invention. Figure 25 illustrates a solid articulating connector 304b. The solid articulating connector 304b is somewhat similarly configured and shaped with various profiled and contoured surfaces, as the articulating connector 304 is illustrated in Figures 20-22, for example, although it might also be made to incorporate the design of connector 304a as illustrated in Figure 23. The solid articulating connector 304b also includes raised ribs 350 at the end of the articulating connector. The raised ribs, on opposite sides of the connector, and along the top and bottom surface (partially) essentially form or define a grooved surface or groove 352 in each end of the connector. The ribs provide added strength at the ends of the articulating connector. The defined groove 352 is configured for sprocket alignment, such as when a third sprocket is utilized to drive the chain.

[00093] Referring to Figure 26, an embodiment of the chain is illustrated utilizing the solid articulating connector 304b, as illustrated in Figure 25. The drive mechanism is a triple drive sprocket 200 that incorporates three sprockets. The outer sprockets and the teeth thereof engage sections of the flight arm assemblies 50 and side link assemblies 30, as shown. A center sprocket engages the chain at each of the solid articulating connectors 304b, as shown in Figure 26. More specifically, as illustrated, the third sprocket or center sprocket has teeth which engage the various grooves 352 of the solid articulating links 304b.

[00094] In another embodiment of the invention, a chain design provides significant noise reduction, while maintaining proper movement and spacing of the various links. In such an embodiment, as illustrated in Figure 27, the various solid articulating connectors 304, 304a, 304b of a chain, incorporate flexible spacers 350 on either side of the solid articulating connector. More specifically, the spacers 350 are positioned between an appropriate connector (e.g., 304, 304a, 304b) and the bases 56 of a flight arm in an assembly, or the side straps 33, 34 of an assembly. As illustrated in Figure 27, an exemplary embodiment incorporates a spacer 350 between the solid articulating connector and each of the flight arm or side link assemblies. That is, the spacers are positioned on each side of the articulating connects.

[00095] The flexible spacer 350 may be made of a suitably soft material for providing flexibility and cushioning, such as urethane, to provide noise reduction between the solid articulating connector and the assemblies that make up the links of the chain. Furthermore, the spacers provide a suitable distance or spacing between the solid articulating connector and the various chain components so as to maintain a specific alignment and spacing of the various links while the chain moves and articulates, and is driven by the sprockets. In one exemplary embodiment, the spacer would generally be a circular or washer-type component. A center opening is formed therein for passage of flight pins or connecting pins, and has an inner diameter of around 1.125 inches. The outer diameter might be around 2 inches. Of course, other material or size embodiments might be utilized, in accordance with the invention, to maintain the desired noise reduction and spacing. In one exemplary

embodiment, the thickness of the spacer 35 is around 0.094 inches. Of course, that dimension might also be varied, and still achieve the desired noise reduction and spacing of the invention.

[00096] Figure 28 illustrates another alternative embodiment of the invention, wherein a solid articulating connector 404 is utilized to replace some or all of the universal connector assemblies 40, along the length of the chain 402. Figure 28 illustrates an embodiment 402, where each universal assembly is replaced with connectors 404. As discussed above for connector 304, the articulating connector 404 is in the form of a solid single piece or body that is formed of an appropriate steel material, such as a carbon alloy steel. In the chains of Figures 28, 32, and 33, like reference numerals will be utilized for those parts and portions of the chain previously discussed herein. Specifically, chain 402 includes a plurality of flight arm assemblies 50 connected with side link assemblies 30, with appropriate connectors. In the embodiment illustrated in Figure 28, each universal connector is a single piece solid articulating connector 404 of the invention. As discussed herein, the chain can be driven by a suitable drive mechanism 200, including either a dual sprocket arrangement, or a triple sprocket arrangement, for example (See Figure 14).

[00097] Referring to Figures 28 and 32, universal connector 404 is coupled with each of the respective side link assemblies and flight arm assemblies by respective flight pins 51, 52, and connecting pins 31, 32. The connectors 404 are captured between the side straps 33, 34, and flight arms 53, 54. The pins pass through apertures 406, 408 formed in the connector 404, to extend transversely, or from side to side, in the solid body, as illustrated in Figures 29-31. The apertures 406, 408 extend laterally or from side to side in the articulating connector 404, and are dimensioned with respect to the diameter of the pins. The apertures 406, 408 are

configured so as to provide movement and articulation of the pins within the connector, and thus, provide articulation of the chain 402, as illustrated in Figures 28, 32 and 33. In one embodiment, the apertures 406, 408 are dimensioned in length L, with respect to the pin to be larger than the diameter D of a pin (31, 32, 51, 52) length so as to provide articulation in the path of chain movement (See Figure 30). Generally, the height dimension H will be similar to the pin diameter D, with some nominal clearance. In one exemplary embodiment, the length L may be up to three times (3x) diameter D in length, while the height may be around D with a +0.015 inch clearance or more.

[00098] Turning to Figures 29-31, unique solid articulating connector 404 of the invention operates similar to a connector 304, and provides greater chain strength and eliminates the need for the more complicated universal connector assembly 40. As such, the articulating connector 404 also reduces the complexity of the chain, increases the chain strength and also reduces potential breakage points associated with a universal connector assembly. Furthermore, the solid single articulating universal connectors 404 weigh around 2-3 pounds less than a typical universal assembly 40, and thus, can significantly reduce the weight of the chain by, on average, 200 pounds, for a typical chain length. The articulating connector 404 is also uniquely formed and shaped with specific curved and profiled apertures and surfaces, as well as wing components and some flat surfaces, to provide the articulation and universal movement of the chains, as desired, and as necessary for their proper operation. In one embodiment of the invention, the connector may be configured to provide an articulation angle in the range from 0° - 150°.

[00099] Turning to Figures 29-31, the articulating connector 404 has a unique configuration and shape to provide the desired universal movement, articulation, and robustness of the solid articulating connector, in accordance with the invention. The solid articulating connector is shaped so as to provide the desired articulation, as well as to allow the necessary clearance around portions of the drive mechanism, such as a sprocket shaft and/or tail shaft roller, as discussed herein. Furthermore, the connector 404 is shaped to reduce noise of the chain as it runs over the tail roller. Therefore, the invention provides a solid single piece articulating connector with a profile design to allow articulation of a conveyor chain on bulk material conveyor equipment. The solid articulating connector profile is dimensioned, and can be modified, within a range to allow essentially no articulation for straight running conveyors, or up to 150° total articulation for a single articulating connector around a pin, such as pins 51, 52, and pins 31 and 32, as shown in Figures 28, 32-33.

[000100] Figure 29 is a perspective view of a solid articulating connector 404, in accordance with one embodiment of the invention. Connector 404 incorporates a solid body that incorporates top and bottom connector surfaces 423, 425 that have portions that are essentially flat, or are flattened, rather than contoured, as in the embodiment of connector 304. While most of the top and bottom surfaces are illustrated as flattened, there may still be portions of those surfaces that have some contours, such as portions, near the end of the connector body. Furthermore, connector 404 incorporates wing components, or wings 450, that extend from the connector 404, and form part of the top and bottom surfaces 423 and 425. The wings 450 extend from both sides of the connector 404, at the top and bottom surfaces 423, 425, as illustrated in Figure 29. In the embodiment of Figure 29, a pair of wings are positioned on the top of the connector proximate to top surface 423,

and a pair of wings is also positioned along the bottom of the connector proximate the bottom surface 425. In an alternative embodiment of the invention, as illustrated in Figure 29, the pair of wings 450 might only be positioned on one of the top or the bottom of the connector, and proximate a top or bottom surface. Portions of the surfaces 453 of the wings 450 might also be flattened similar to the flattened surfaces 423, 425 to form flattened top and bottom surfaces to the connector body. The wings are positioned along the length L_B of the connector body, generally at the middle of the connector body. Referring to Figure 30, the wings might be positioned to coincide with the center section 410 of the connector.

[000101] In accordance with one aspect of the invention, the combination of the wings 450 and the flattened top and bottom surfaces 423 and 425 provide a wider effective connector 404 at the top and bottom that does not have profiled top and bottom surfaces. The connector 404 contacts the surfaces and rollers of the drive system for chain 402. The effectively wider connector rides flat on various chain rollers, such as the tail roller, similar to the side straps 33, 34, and the flight arms 53, 54. In that way, as the overall chain progresses over a roller, such as the tail roller, the solid connector 404 does not sink onto the tail roller like a connector that has profiled top and bottom surfaces. That is, the wings 450 effectively widen the profile of the solid connector 404, and in combination with the flattened top and bottom surfaces 423, 425, provides a solid connector 404 that has a profile along the top and bottom surfaces closer to the top and bottom profile of a side strap of the conveyor chain. The solid connector 404 thus, prevents a change in the profile or contour between the various side straps, flight arms, and solid connectors 404, as the chain 402 moves over the rollers, and thus, prevents the chain from bouncing, or

going up and down, as each of the various link elements of the chain pass over a roller. This, in turn, keeps the chain smoothly on the roller, and reduces the noise generated as the chain passes over a roller.

[000102] Turning to Figures 30 and 31, a top cross-sectional view and side view of a solid articulating connector 404 are illustrated, showing apertures 406, 408 therein at both ends of the connector. The solid articulating connector 404 has similarities to connector 304 in construction, which will be described. The apertures are in the form of uniquely configured and profiled holes that will have a diameter D dimension reflective of the size of the various flight pins, or connecting pins handled by connector 404. The connector is dimensioned to have a block height H_b and a block width W_b . Block height H_b may be in the range of a hole diameter plus 0.125 inches (hole $D + 0.125$) to (3x hole D). The hole diameter D might be in the range of 0.25 inches – 2.50 inches. As such, a suitable block height H_b might be from 0.375 inches – 7.5 inches. In one embodiment, the H_b is around 2.25 inches. The width W_b might be in the range of 1 inch – 5 inches. In one embodiment, the W_b is around 2.25 inches.

[000103] Articulating connector 404 may be dimensioned to have a suitable pitch P of 1 inch – 10 inches. In one embodiment, the pitch P is around 3.50 inches. The embodiment of the articulating connector 404 illustrated also has a center section 410 having a certain material thickness. The center section spans between the top and bottom walls 411, 413 of the connector. The center section 410 might also be eliminated. The material thickness of the center section 410 (Dimension C in Figure 31) might be anywhere from 0 inches up to 9.75 inches, which would reflect an upper limit of approximately the pitch P minus the hole diameter D . In one embodiment, such thickness is around 0.75 inches. In the center section 410, because of the

radiused shape of holes of apertures 406, 408, the thickness will vary along the height of section 410. Furthermore, the connector includes a wall thickness T that may be from approximately 0.0625 inches up to 2.5 inches. This reflects a wall thickness T that is from 0.0625 inches up to one-half of the block height H minus the hole diameter D $((\text{block height H} - \text{hole diameter D})/2)$. In one embodiment, the thickness T is around 0.55 inches.

[000104] In accordance with one aspect of the solid articulating connector 404 of the invention, the side connector surfaces 412 between the wings 450 on the top surface 423 and the wings on the bottom surface 425 are appropriately curved and profiled inwardly to provide the desired articulation, as well as operation with the drive mechanism driving the chain. To that end, the solid articulating connector 404 includes contoured profiles in the sides of the connector. Referring to Figure 30, the sides 415, 417 of the connector have an exterior profile that is contoured with an indent or inwardly profiled surface 412 at the center of the connector between the wings 450 that is dimensioned in depth D_1 and width W_1 , on both sides of the connector and between an upper set of wings and a lower set of wings. The inwardly profiled surfaces 412, in combination with the wings will provide a suitable articulation angle A, as illustrated in Figure 33. The profiled surfaces 412 are configured to receive a portion of the flight arm assembly when the chain bends or a portion of the side link assembly to provide articulation of the chain. More specifically, as illustrated in Figures 32 and 33, the profiled surfaces 412 are configured to receive an end portion 460 of side straps 33, 34, or to receive an end portion 462 of a base 56 for providing articulation of the flight arm assembly and side link assembly with respect to each other and articulation of the conveyor chain along its path of travel 464, as shown in Figure 32. The profiled surfaces 412 may be

comprised of suitable angled or chamfered surfaces, or curved/radiused surfaces to allow proper articulation, the depth D_1 and the width W_1 and radius R_1 provide the desired articulation, as shown in Figures 32 and 33. To that end, in one embodiment of the invention, the depth D_1 might be anywhere from 0 inches – 2.5 inches, or from essentially 0 inches – one-half of block width W_b . As may be understood by a person of ordinary skill in the art, a profile surface 412 having a depth D_1 of 0 inches would essentially be a straight block, without a particular side profile. The width W_1 might be anywhere from 0 inches – 12.5 inches, or essentially from 0 inches to the dimension of the pitch plus the hole diameter (pitch P + hole D).

[000105] In one embodiment, the surface is dimensioned with D_1 of around 0.25 inches, W_1 of around 1.5 inches, and an R_1 of around 3.00 inches. The edges 419 of surface 412 might form radiused transition edges at a radius of around 0.75 inches in one embodiment. Referring to Figure 30 the overall block length L_b might be in the range of 1.25 inches – 15 inches. Generally, similar to connector 304 the block length L_b might be in the range of 1 inches plus the hole diameter D_1 , up to the pitch P dimension plus the hole diameter D , plus two times the wall thickness T ((pitch P + hole D + (2x wall thickness T)). In one embodiment, the L_b is around 5.827 inches.

[000106] Referring again to Figure 30, solid articulating connector 404 includes opposing ends of the connector that include profiled end surfaces 416 that work in tandem with the exterior side profiled surfaces 412 to provide the articulation of connector 404. The profiled surfaces 416 may be suitably chamfered, or may be outwardly radiused, or could be in the form of a sharp corner. In Figure 30, a radiused edge or surface is shown, and may have a radius range of 0 inches (sharp corner) to 5 inches, or generally from 0 – (wall thickness T + hole D). In one

embodiment, the radius is around 0.25 inches. The profiled surfaces 416 engage a portion of either the side straps 33, 34, or the base 56, as shown in Figure 32, when the chain articulates. As seen in Figure 32, the profiled surfaces 412 and profiled surfaces 416 are engaged on opposite sides of the chain during articulation.

[000107] As seen in Figures 30 and 31, each of the holes or apertures 406, 408 is configured to receive one of the noted pins (31, 32, 51, 52) that couple the connector to various side link assemblies or flight arm assemblies. In accordance with one aspect of the invention, each of the aperture openings includes a pin hole profiled surface that forms a curved or radiused surface along an outer surface, as indicated by reference numeral 420 in the figures, and along an inner surface 421. The profiled or curved surfaces 420, 421 of apertures 406, 408, allow a smooth articulation between each of the various pins, and the solid articulating connector 404. The surfaces 420, 421 open up the holes 406 and 408 to have a diameter that is equal to the hole size or larger. The diameter D is reflective of the diameter of a pin 32, 51 in the solid articulating connector 404 (See Figure 31). Surfaces 420, 421 also follows a radiused profile that is sized based on the articulation angle that is desired, such as from 0 - 150° articulation, as illustrated in articulation angle A of Figure 33. The profiled or curved surface 420 allows the solid articulating connector to roll on the pin during articulation. In one embodiment, the profiled surfaces 420, 421 reflect a radius of around 1.25 inches. The ends 416 of the solid articulating connector might also be appropriately chamfered at an angle A_2 of around 5 degrees, or suitable draft angle (See Figure 30). The profiled surfaces 420, which will bear most of the load from the pins 31, 32, 51, 52, may be induction hardened to have a greater hardness. The surfaces 420 of the apertures 406, 408 are hardened at a specific depth around the apertures to a greater hardness rating than the rest of

the link. For example, while the articulating connector might have a hardness of around 40-44 on the Rockwell C Scale (Rc), the surfaces 420 might be induction hardened to have a hardness rating of around 50-54 Rc. In accordance with one embodiment of the invention, the hardness may be induced to a depth D of 1/8 inch to 3/16 inches deep around the surfaces 420 and extending through the apertures from side to side.

[000108] Turning to Figure 31, the connector 404 has a generally flat (i.e. non-radiused) top and bottom surfaces that include the wings 450 in accordance with one aspect of the invention, to provide smooth travel around the tail roller.

[000109] Referring to Figure 34, the wings 450 may provide an overall effective width of the connector 404 W_w in the range of 1.0 to 6.0 inches. In one embodiment, W_w might be around 3.5 inches. The wings may have a thickness T_w in the range of 0.25 to 1.5 inches. In one embodiment, T_w is around 0.83 inches. Also, as illustrated in Figure 34, the wings, while flat on the upper and lower surfaces 423, 425, may be angled with respect to each other at the surfaces 460, in an angular range A_w from 0 degrees to 90 degrees. In one embodiment of the invention, A_w is around 10 degrees.

[000110] Referring to Figure 35, the wings 450 may be formed to have an overall effective width W_w in the range of 0 inches to $L_B / 3$ inches. In one embodiment, W_w is around 1.25 inches. The side surfaces 451 of the wings 450 might also be tapered in an angle with respect to each other A_s in the range of 0 degrees to 150 degrees. The wings 450 cannot be made too wide with respect to dimension W_w because articulation is necessary between the various links, as illustrated in the Figures 32, 33. Generally, because the wings 450 are located at the top and bottom surfaces 423, 425 of connector 404, and are kept somewhat thinner in their overall

side profile dimension T_w the end portions 460, 462 of the various links which engage connector 404 will pass somewhat under the wings during articulation, as illustrated in Figures 32 and 33, to otherwise engage the profiled surfaces 412. However, there may be some engagement of the wings 450 with the end portions 460, 462 of each of the respective links that are coupled to connector 404.

[000111] Figure 28 illustrates an embodiment of the chain, wherein the solid articulating connectors 404 are utilized between each of the link assemblies in the chain 402. However, similar to Figure 18, the connectors 404 might be used at every other universal connector position.

[000112] In another embodiment of the invention, a chain design provides significant noise reduction, while maintaining proper movement and spacing of the various links, and, as shown in Figure 27, the various solid articulating connectors may incorporate flexible spacers 350 on either side of the solid articulating connector. Such spaces might also be used with the connectors 404 described herein.

[000113] The various conveyor chains disclosed herein may comprise an even pitch along substantially the entire length of the conveyor chain, although this is not required. The pitch may comprise the distance between adjacent connecting pins 31, 32 and flight pins 51, 52. In one embodiment, the pitch may comprise about $3\frac{1}{2}$ inches, although any suitable pitch may be used depending on the particular application. By way of example only, the pitch may also range from about 1 inch to about 5 inches in length, or more particularly from about $2\frac{1}{2}$ inches to about $4\frac{1}{2}$ inches in length. A conveyor chain with an even pitch may provide for an increased number of sprocket teeth engaged with the chain and may allow for the use of a driving member that comprises two or more individual sprockets.

[000114] The present chain, as described and illustrated herein, provides a particularly robust and wear resistant chain that improves upon the chain design provided by the flight assemblies and universal connector assemblies. The inventive chain allows more sprocket engagement and thus provides better inset chain flow over a foot shaft with more teeth engaged to carry the chain load. Furthermore, the chain provides an improved and higher breaking strength. Because the dual sprockets drive in the flight arm attachment apertures and on the side strap bosses, the chain eliminates significant pin wear and failure caused from pin breakage. Also, the solid articulating connectors provide increased flight articulation in the movement of the chain. Still further, the chain provides noise reduction and maintains a desired spacing of the various links for proper operation.

[000115] It should be appreciated that the various components may be comprised of any suitable material known in the art that exhibits the requisite strength and durability characteristics based on the intended application of the chain. By way of example only, the various components may comprise forged steel, cast steel, spring steel, composite steel, plastic, other suitable materials and combinations thereof. Each of the components may comprise the same material, or alternatively, different components may comprise different materials. In addition, by way of example only the flight arms 53, 54 or any other suitable components, may be made of composite steel and plastic, urethane, or other material that can reduce noise levels during operation, although this is not required.

[000116] Having shown and described various embodiments of the present invention, further adaptations of the methods and systems described herein may be accomplished by appropriate modifications by one of ordinary skill in the art without departing from the scope of the present invention. Several of such potential

modifications have been mentioned, and others will be apparent to those skilled in the art. For instance, the examples, embodiments, geometrics, materials, dimensions, ratios, steps, and the like discussed above are illustrative and are not required. Accordingly, the scope of the present invention should be considered in terms of the following claims and is understood not to be limited to the details of structure and operation shown and described in the specification and drawings.

[000117] What is claimed is:

1. A conveyor chain comprising:

a plurality of side link assemblies and flight arm assemblies coupled together to form an elongated chain;

at least one side link assembly including a pair of opposing side straps positioned on either side of the chain;

at least one flight arm assembly including a pair of opposing flight arms positioned on either side of the chain;

at least one articulating connector positioned between a flight arm assembly and a side link assembly to couple the assemblies together, the at least one articulating connector including:

a solid piece for coupling the flight arm assembly and side link assembly together;

side surfaces of the solid piece having profiled surfaces therein configured for receiving a portion of a side link assembly or a portion of a flight arm assembly for providing articulation in the chain along a path of travel.

2. The conveyor chain of claim 1, the articulating connector further including a pair of wings positioned proximate at least one of a top surface or a bottom surface of the solid piece, a wing of the pair extending to each side of the solid piece.

3. The conveyor chain of claim 1 comprising a pair of wings positioned on each of the top surface and the bottom surface of the articulating connector solid piece, a wing from each pair extending to each side of the solid piece from the respective top or bottom surface.

4. The conveyor chain of claim 2 further comprising a flattened surface where the pair of wings is positioned in the articulating connector.
5. The conveyor chain of claim 1 wherein the at least one flight arm assembly includes a flight arm having an elongated body extending from an integral base, a vertical sprocket opening formed to extend vertically through the integral base and being configured for engaging a tooth of a drive sprocket to drive the flight arm.
6. The conveyor chain of claim 5 wherein the opposing flight arms have respective integral bases, the integral bases having respective sprocket openings each configured to engage a respective tooth of a drive sprocket positioned on either side of the chain for driving the flight arm assembly on both sides of the chain.
7. The conveyor chain of claim 1 wherein the at least one side link assembly includes a side strap having a base and at least a pair of side strap bosses extending outwardly from the base and configured to engage a tooth of a drive sprocket to drive the side strap.
8. The conveyor chain of claim 7 wherein the opposing side straps have respective side strap bosses, the bosses configured to engage a respective tooth of a drive sprocket positioned on either side of the chain for driving the side link assembly on both sides of the chain.

9. The conveyor chain of claim 1 further comprising at least one flight pin coupled between the opposing flight arms, the articulating connector including at least one aperture extending laterally in the solid piece that is configured to receive the flight pin for coupling the articulating connector with the flight arm assembly.
10. The conveyor chain of claim 1 further comprising at least one connecting pin coupled between the opposing side straps, the articulating connector including at least one aperture extending laterally in the solid piece that is configured to receive the connecting pin for coupling the articulating connector with the side link assembly.
11. The conveyor chain of claim 1 wherein the articulating connector includes at least one aperture extending laterally in the solid piece, the aperture configured to receive a pin for coupling the articulating connector with at least one of the flight arm assembly or the side link assembly, the aperture including at least one profiled surface to allow the articulating connector to rotate on the pin.
12. The conveyor chain of claim 11 wherein the aperture is dimensioned in length to be larger than a diameter of the pin.
13. The conveyor chain of claim 1 wherein the articulating connector has opposing ends, the opposing ends including profiled surfaces configured for engaging at least one of a portion of a side strap of a side link assembly or a portion of a base of a flight arm assembly for providing articulation of the flight arm assembly and side link assembly with respect to each other.

14. The conveyor chain of claim 1 wherein the profiled surfaces of the side surfaces of the solid piece are configured for providing an articulation angle in the chain in the range of 1-150 degrees.
15. The conveyor chain of claim 1 wherein the articulating connector has side surfaces on ends of the solid piece that are profiled outwardly from the profiled surfaces of the solid piece to increase an effective width of the articulating connector.
16. The conveyor chain of claim 1 wherein the articulating connector includes ridges defining a groove in at least one end of the articulating connector, the groove configured for engaging a tooth of a drive sprocket to drive articulating connector.
17. The conveyor chain of claim 1 wherein the articulating connector has top and bottom surfaces, the top and bottom surfaces including inwardly profiled surfaces therein.
18. The conveyor chain of claim 1 further comprising at least one flexible spacer positioned between the articulating connector and at least one of a side link assembly or flight arm assembly.
19. A conveyor chain system comprising:
 - a driving member, the driving member including a first drive sprocket and second drive sprocket, each of the first drive sprocket and the second drive sprocket having a plurality of teeth;

a conveyor chain positioned between the drive sprockets for being driven by the drive sprockets of the driving member;

the conveyor chain comprising:

a plurality of side link assemblies and flight arm assemblies coupled together to form an elongated chain;

at least one side link assembly including a pair of opposing side straps positioned on either side of the chain, the side straps engaging a drive sprocket;

at least one flight arm assembly including a pair of opposing flight arms positioned on either side of the chain, the flight arms engaging a drive sprocket;

at least one articulating connector, an articulating connector positioned between a flight arm assembly and a side link assembly to couple the assemblies together, the at least one articulating connector including:

a solid piece for coupling the flight arm assembly and side link assembly together;

side surfaces of the solid piece having profiled surfaces therein configured for receiving a portion of a side link assembly or a portion of a flight arm assembly for providing articulation in the chain along a path of travel.

20. The conveyor chain system of claim 19, the articulating connector further including a pair of wings positioned proximate at least one of a top surface or a bottom surface of the solid piece, a wing of the pair extending to each side of the solid piece.

21. The conveyor chain system of claim 19 comprising a pair of wings positioned on each of the top surface and the bottom surface of the articulating connector solid piece, a wing from each pair extending to each side of the solid piece from the respective top or bottom surface.
22. The conveyor chain system of claim 20 further comprising a flattened surface where the pair of wings is positioned in the articulating connector.
23. The conveyor chain system of claim 19 wherein the at least one flight arm assembly includes a flight arm having an elongated body extending from an integral base, a vertical sprocket opening formed to extend vertically through the integral base and being configured for engaging a tooth of a drive sprocket to drive the flight arm.
24. The conveyor chain system of claim 19 wherein the at least one side link assembly includes a side strap having a base and at least a pair of side strap bosses extending outwardly from the base and configured to engage a tooth of a drive sprocket to drive the side strap.
25. The conveyor chain system of claim 19 wherein the articulating connector includes at least one aperture extending laterally in the solid piece, the aperture configured to receive a pin for coupling the articulating connector with at least one of the flight arm assembly or the side link assembly, the aperture including at least one profiled surface to allow the articulating connector to rotate on the pin.

26. The conveyor chain system of claim 25 wherein the aperture is dimensioned in length to be larger than a diameter of the pin.
27. The conveyor chain system of claim 19 wherein the articulating connector has opposing ends, the opposing ends including profiled surfaces configured for engaging at least one of a portion of a side strap of a side link assembly or a portion of a base of a flight arm assembly for providing articulation of the flight arm assembly and side link assembly with respect to each other.
28. The conveyor chain system of claim 19 wherein the profiled surfaces of the side surfaces of the solid piece are configured for providing an articulation angle in the chain in the range of 1-150 degrees.
29. The conveyor chain system of claim 19 wherein the articulating connector has side surfaces on ends of the solid piece that are profiled outwardly from the profiled surfaces of the solid piece to increase an effective width of the articulating connector.
30. The conveyor chain system of claim 19 wherein the articulating connector includes ridges defining a groove in at least one end of the articulating connector, the groove configured for engaging a tooth of a drive sprocket to drive articulating connector.
31. The conveyor chain system of claim 19 wherein the articulating connector has top and bottom surfaces, the top and bottom surfaces including inwardly profiled surfaces therein.

32. The conveyor chain system of claim 19 further comprising at least one flexible spacer positioned between the articulating connector and at least one of a side link assembly or flight arm assembly.

33. The conveyor chain system of claim 19 wherein the driving member includes a third drive sprocket, the articulating connector including ridges defining a groove in at least one end of the articulating connector that is configured for engaging a tooth of the third drive sprocket to drive the articulating connector.

34. An articulating connector for use in a chain to connect link assemblies of the chain, the articulating connector comprising:

a solid body having a top surface, a bottom surface and side surfaces;

at least one aperture formed in the solid body and extending from side to side in the body;

side surfaces of the solid body having profiled surfaces therein configured for receiving a portion of a link assembly of a chain for providing articulation in the chain;

a pair of wings positioned proximate at least one of the top surface or the bottom surface of the solid body, a wing of the pair extending to each side of the solid body.

35. The articulating connector of claim 34 further comprising a pair of wings positioned proximate to each of the top surface and the bottom surface of the articulating connector solid piece, a wing from each pair extending to each side of the solid piece from the respective top or bottom surface.

36. The articulating connector of claim 34 further wherein portions of the wings and portions of at least one of the top and bottom surfaces are flattened.

37. The articulating connector of claim 34 wherein the wings are positioned along the length of the connector body generally at the middle of the connector body.

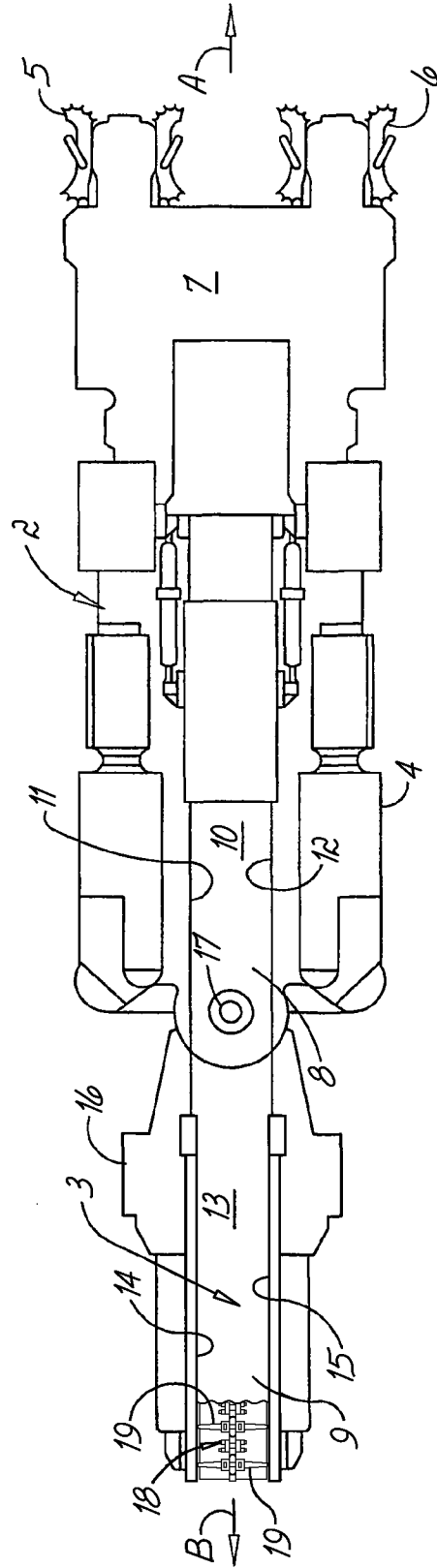

FIG. 1

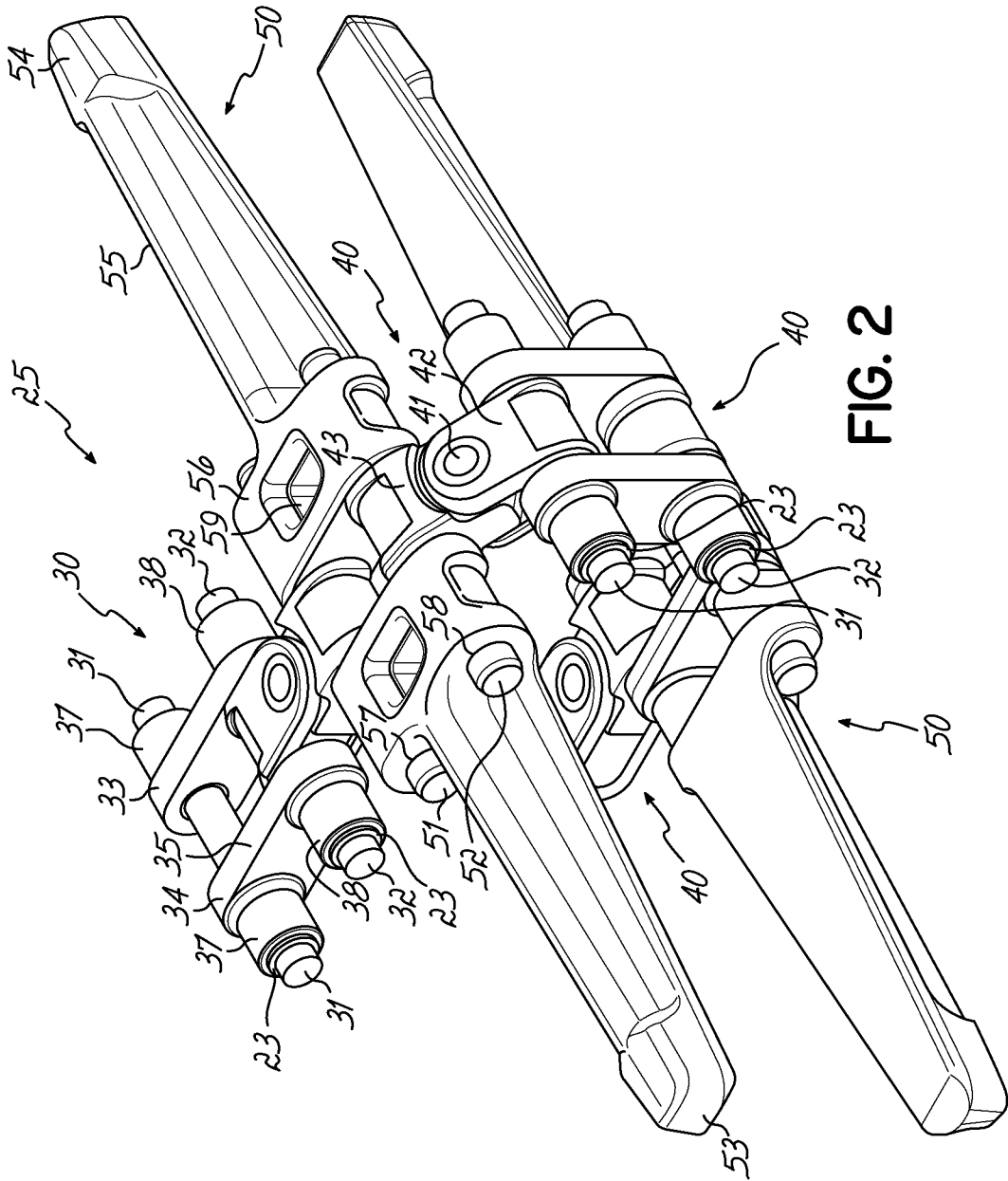

FIG. 2

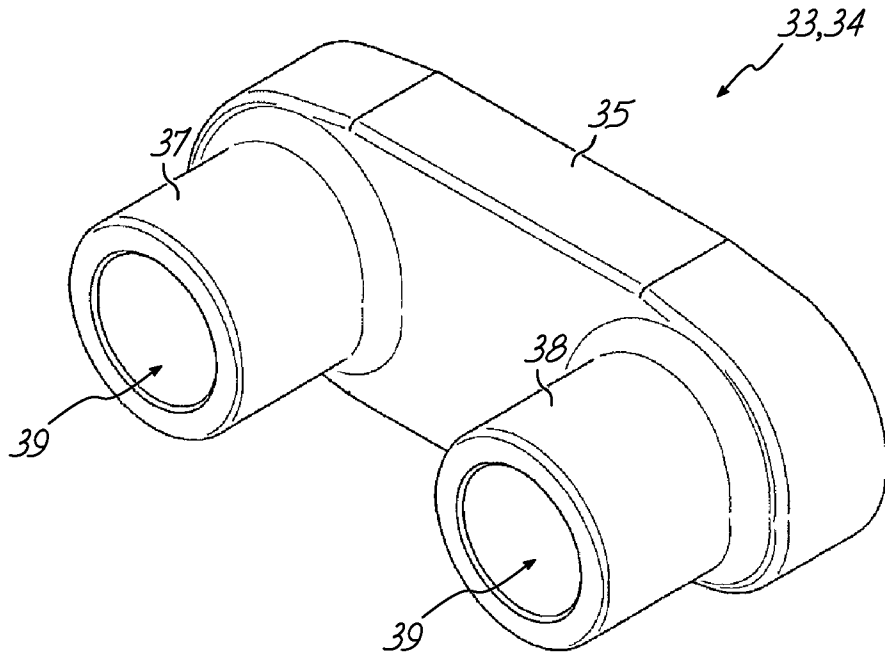

FIG. 3

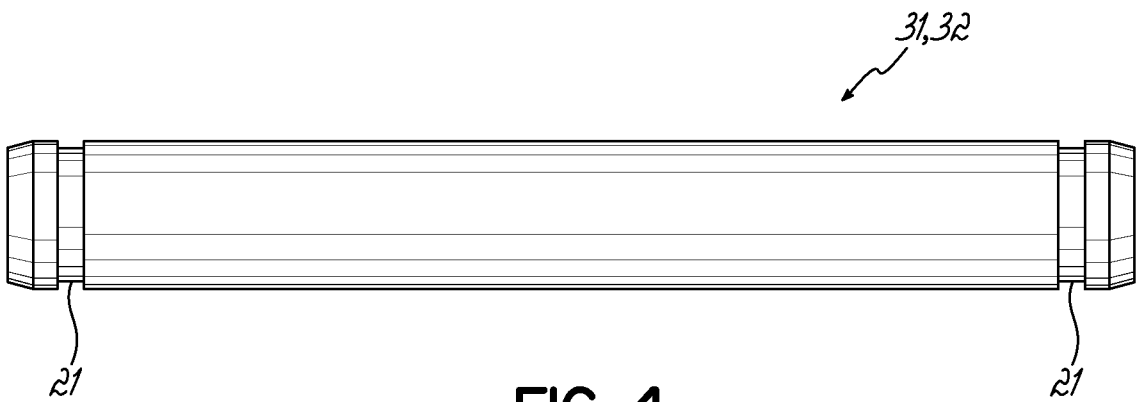

FIG. 4

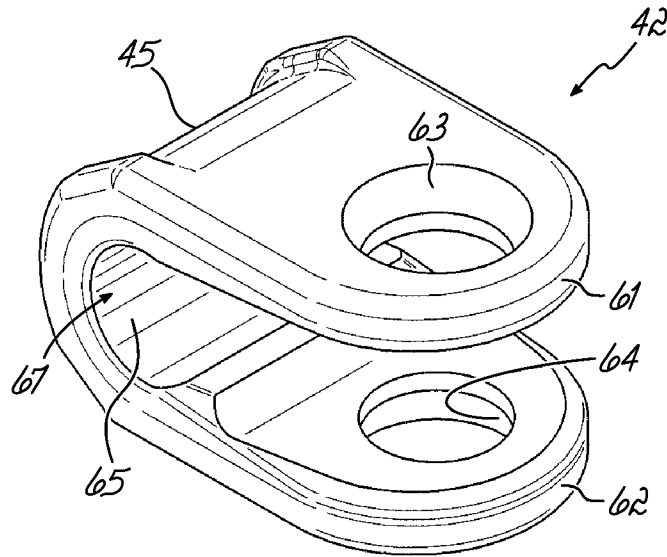

FIG. 5

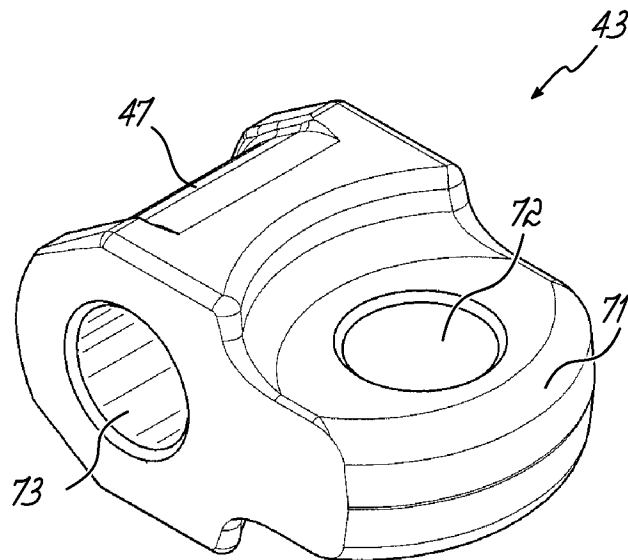

FIG. 6



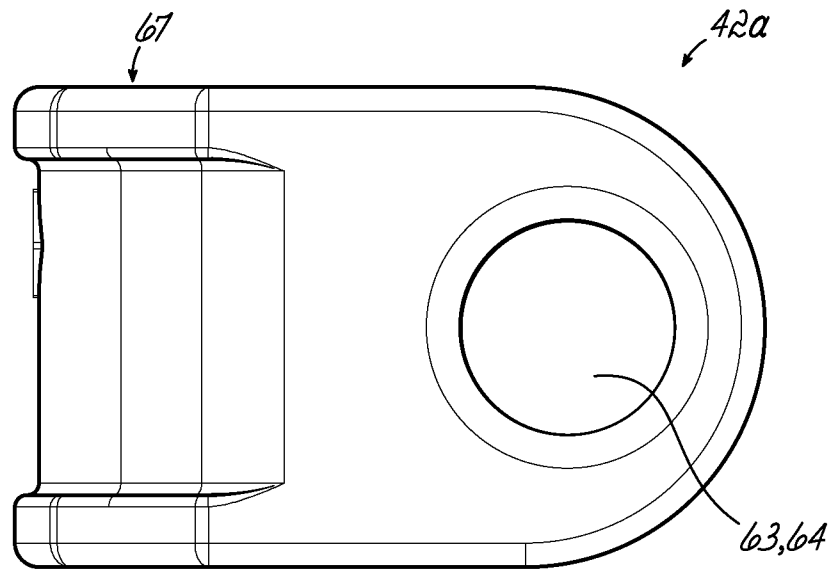

FIG. 5A

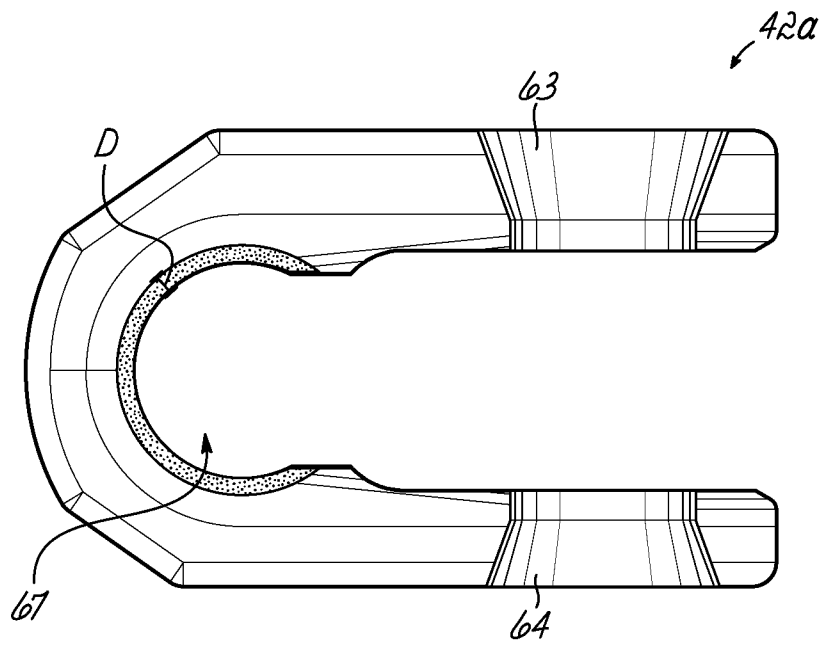

FIG. 5B



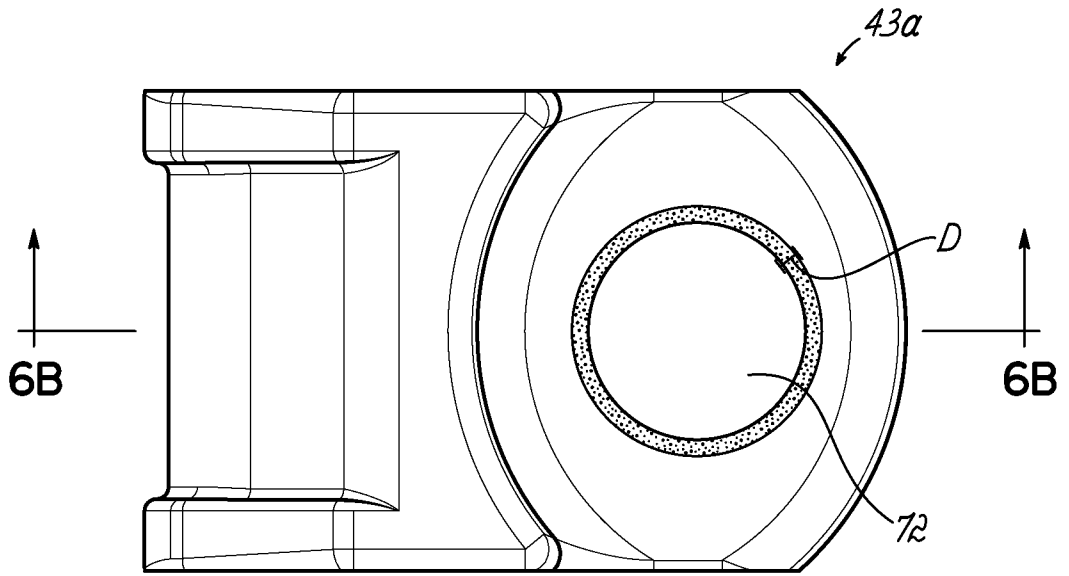

FIG. 6A

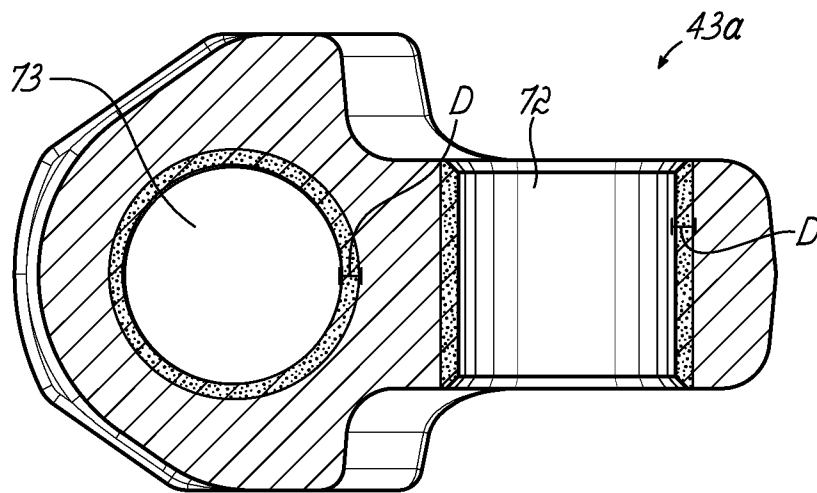

FIG. 6B

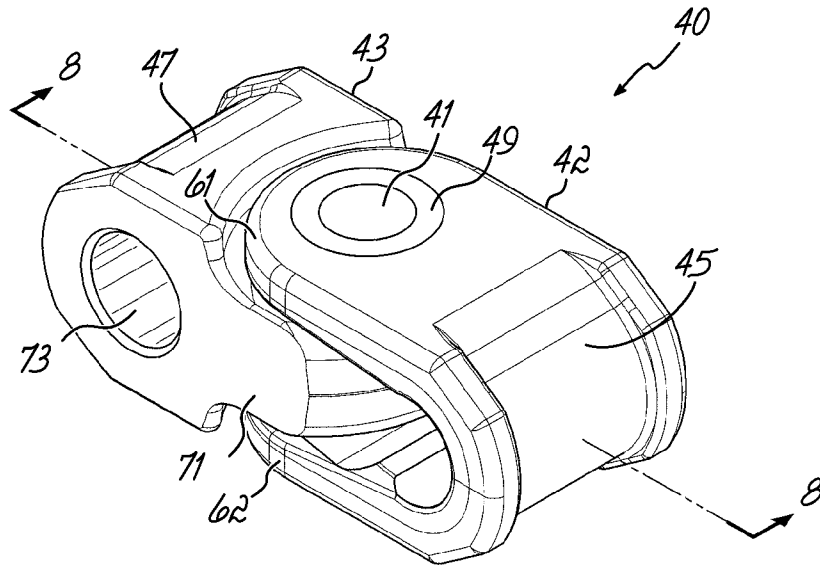

FIG. 7

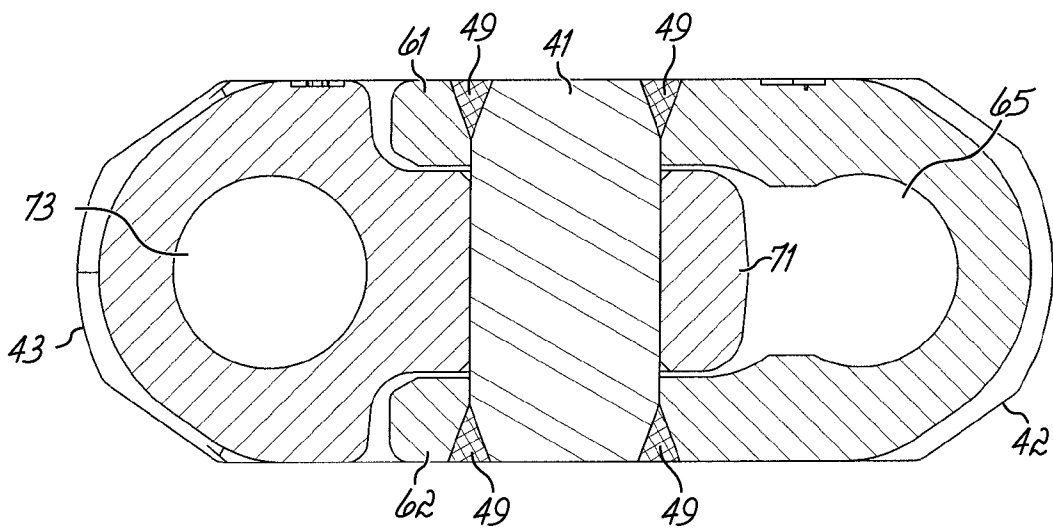
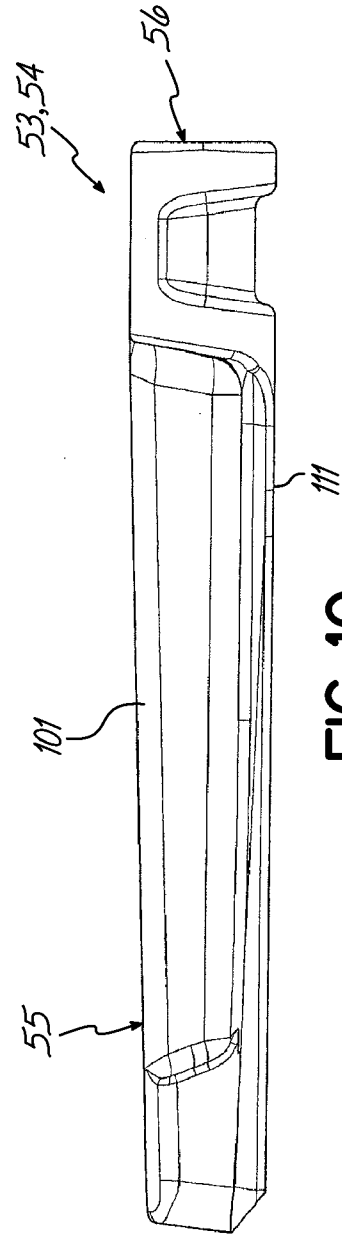
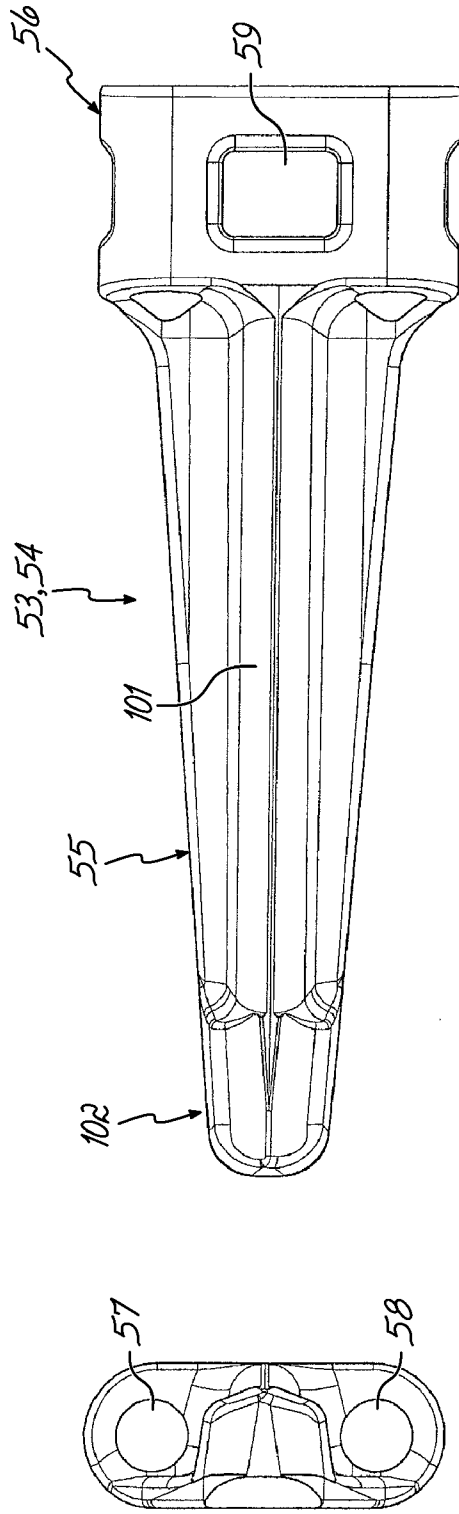

FIG. 8



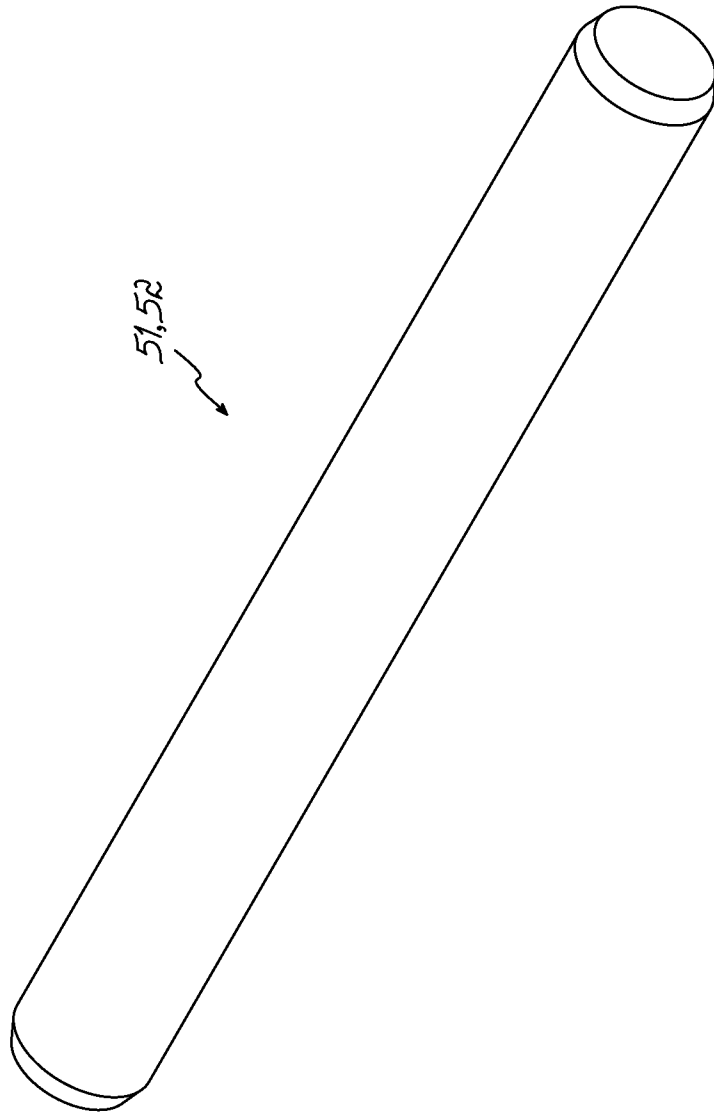

FIG. 12



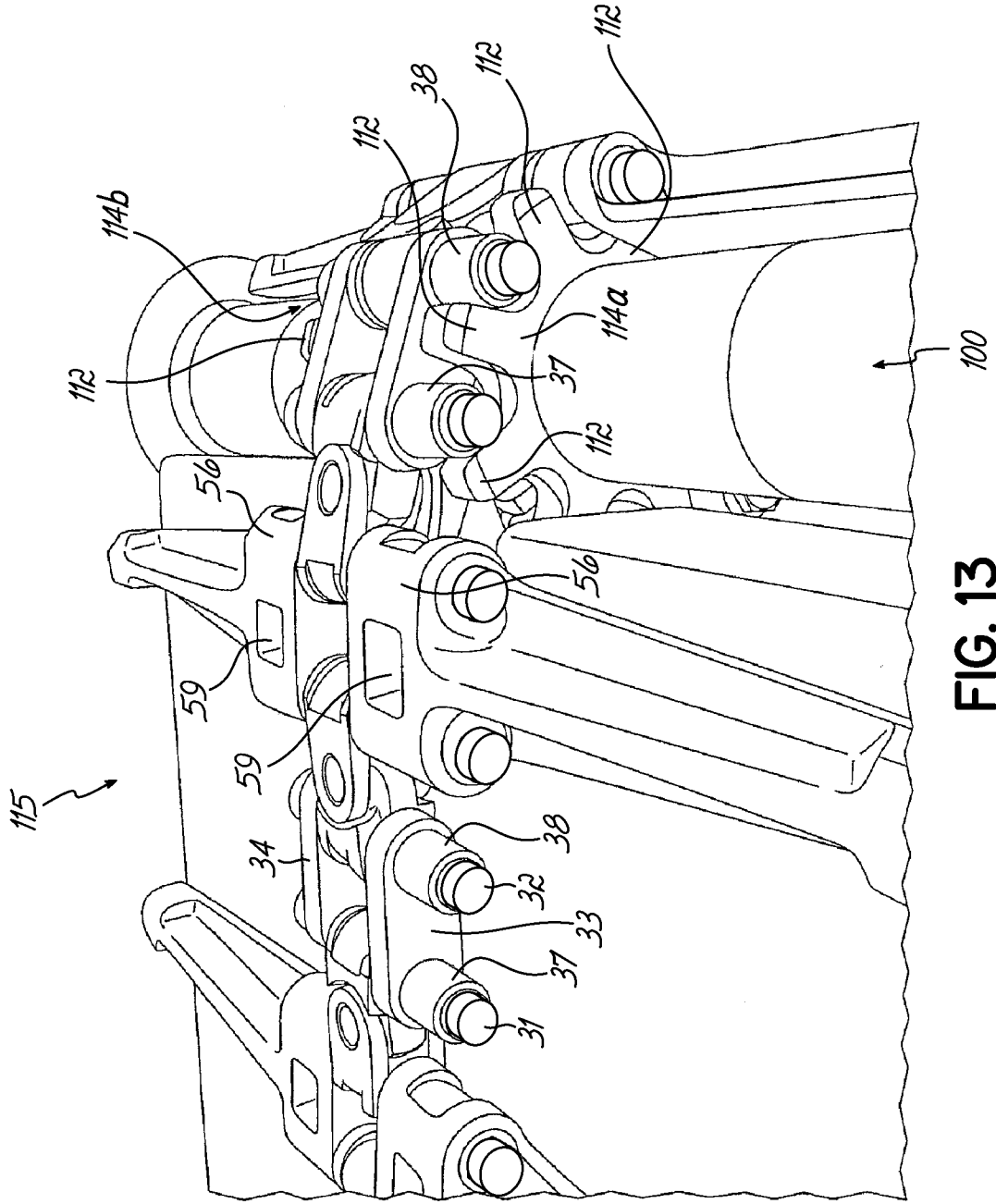

FIG. 13

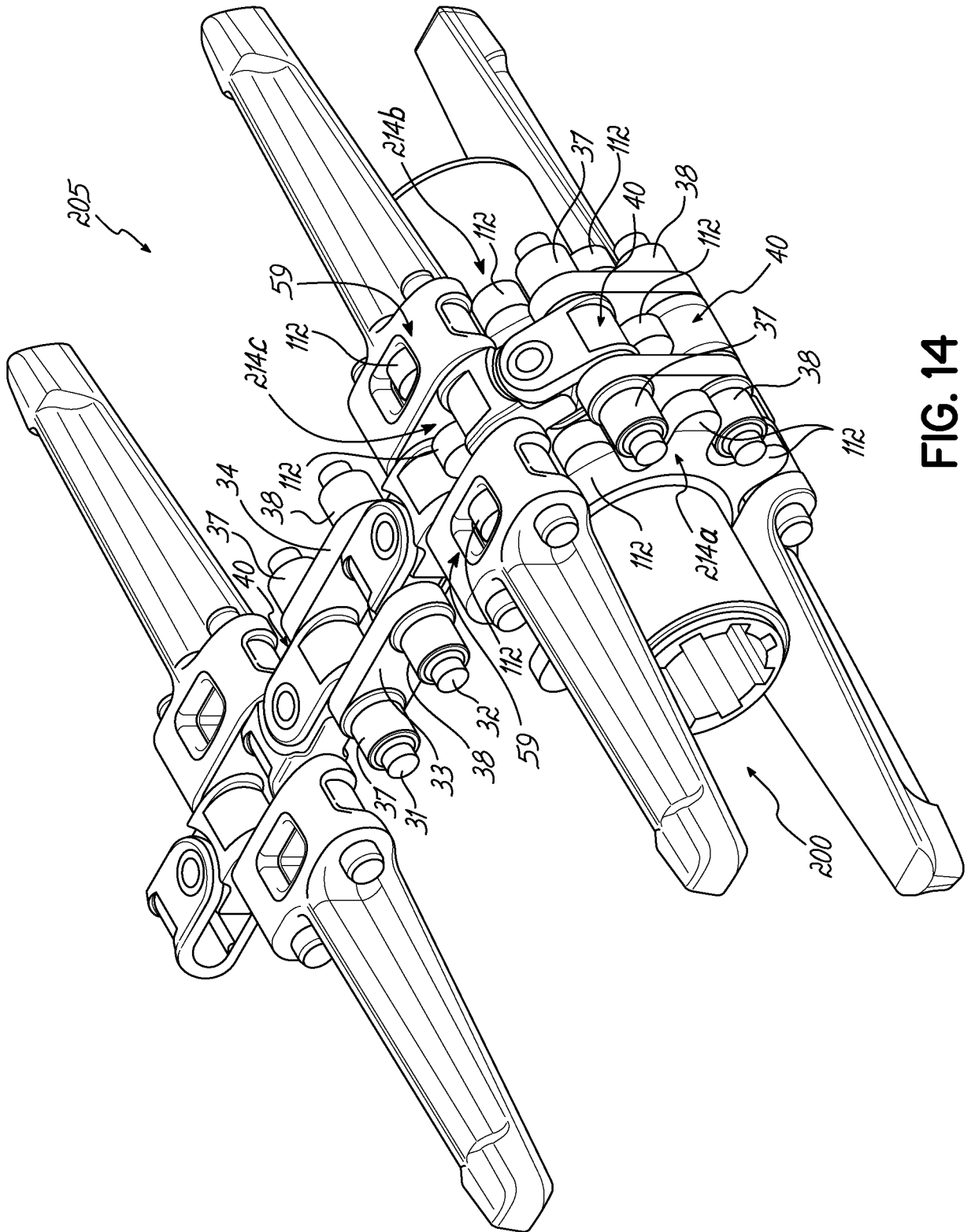

FIG. 14

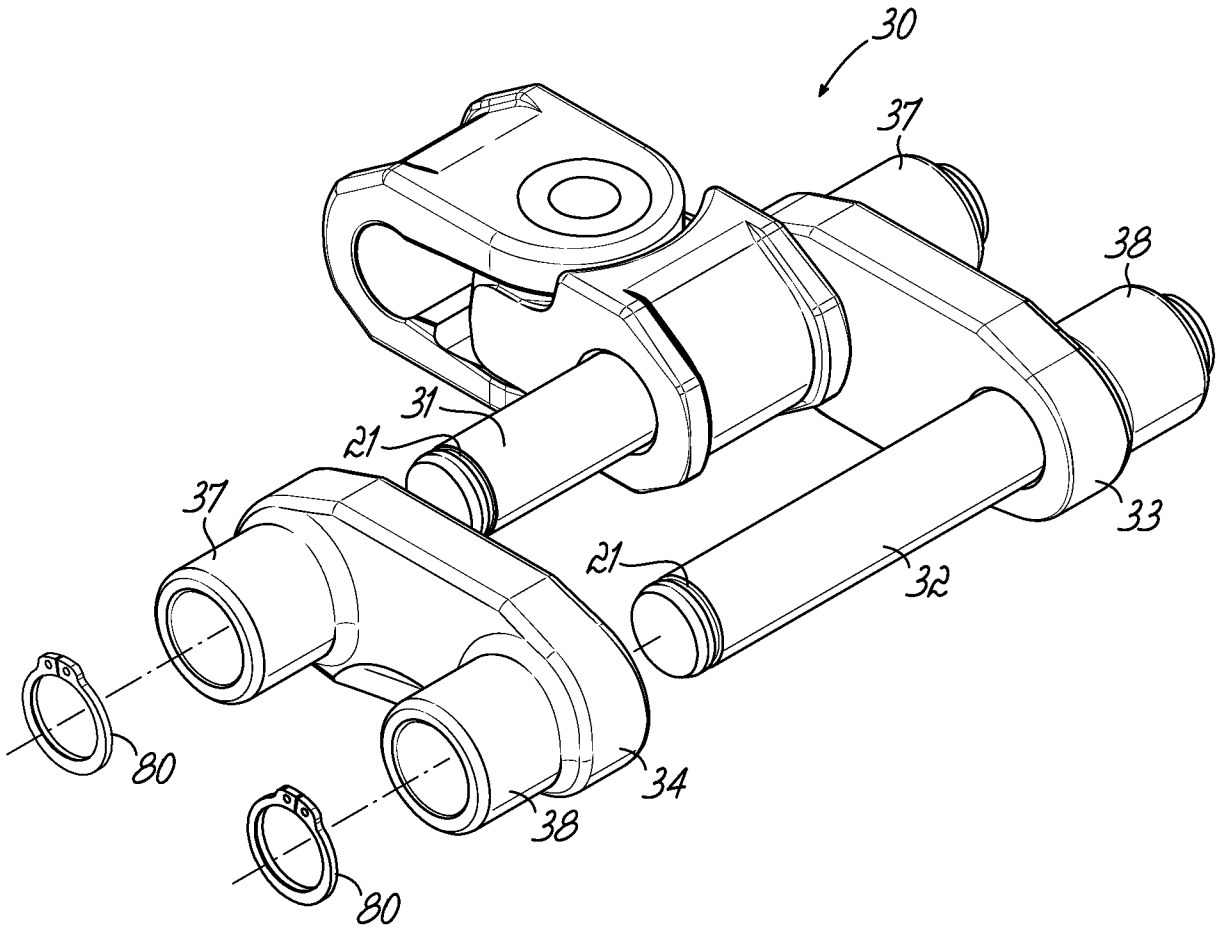

FIG. 15A

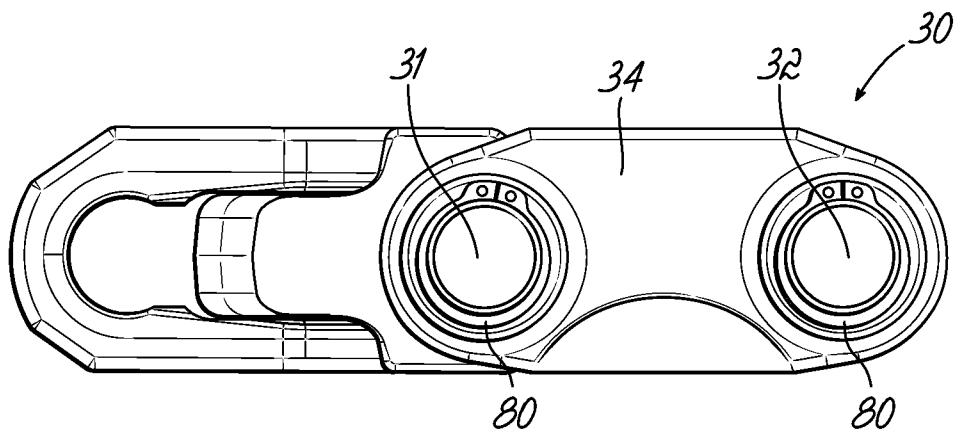

FIG. 15B

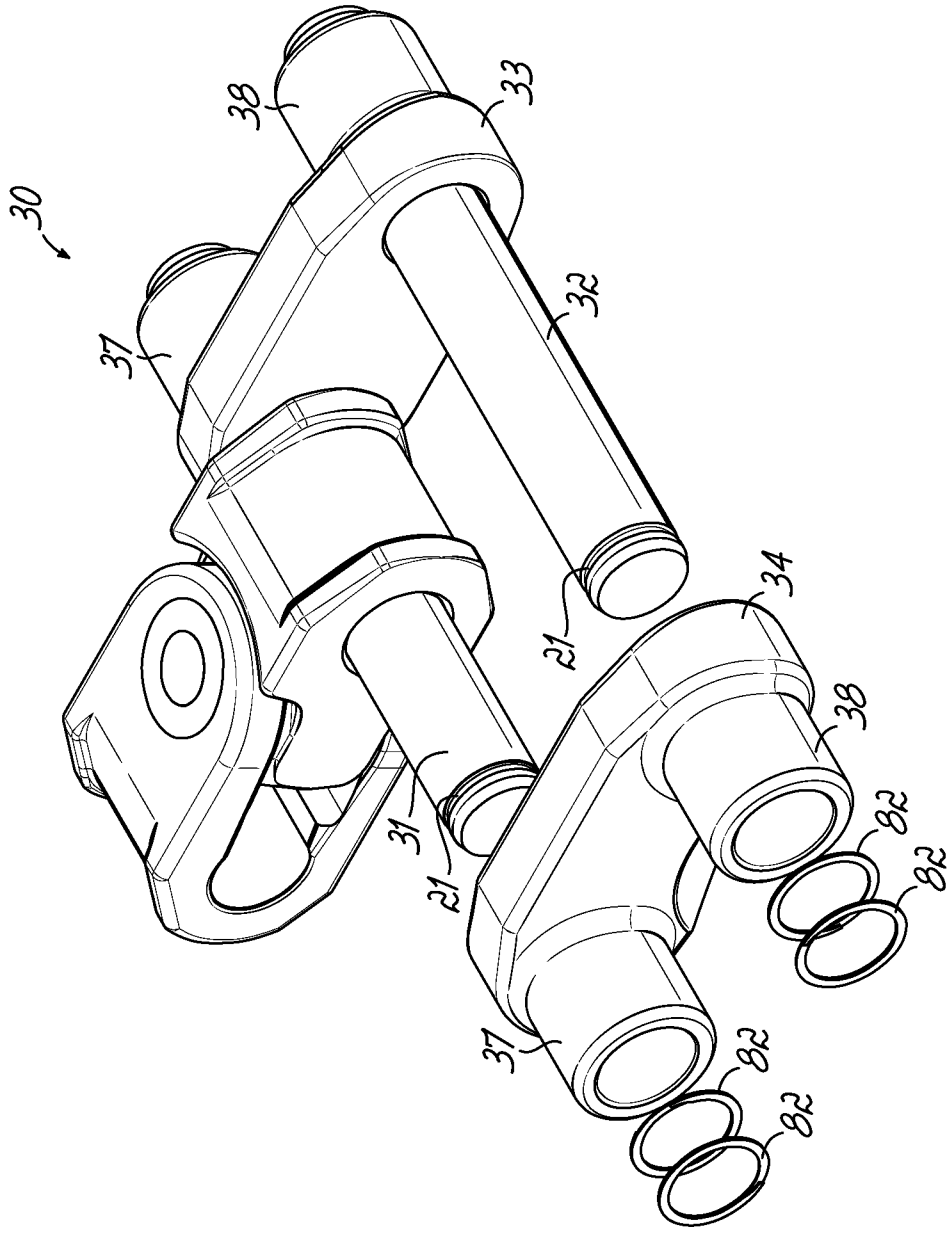

FIG. 16

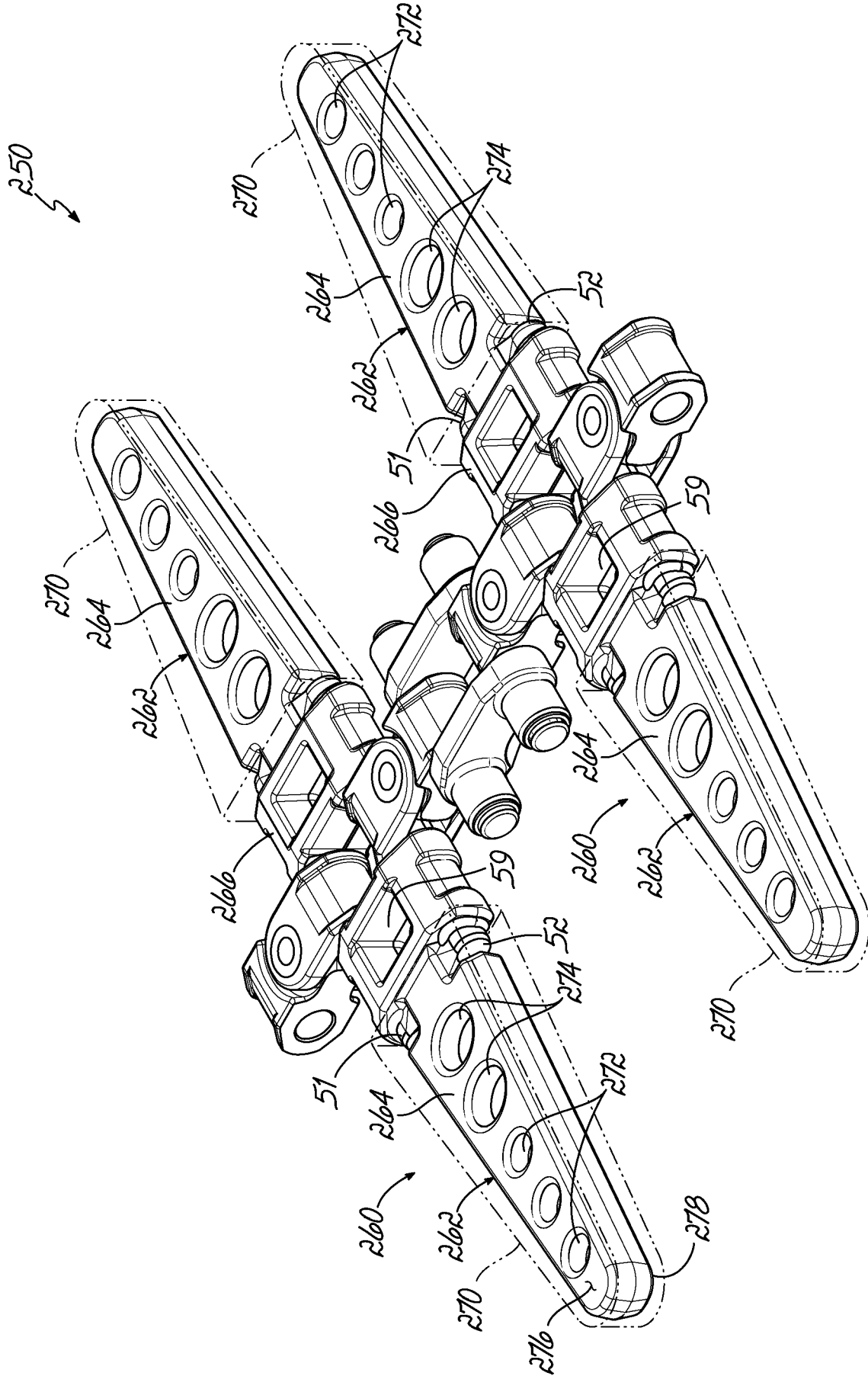

FIG. 17

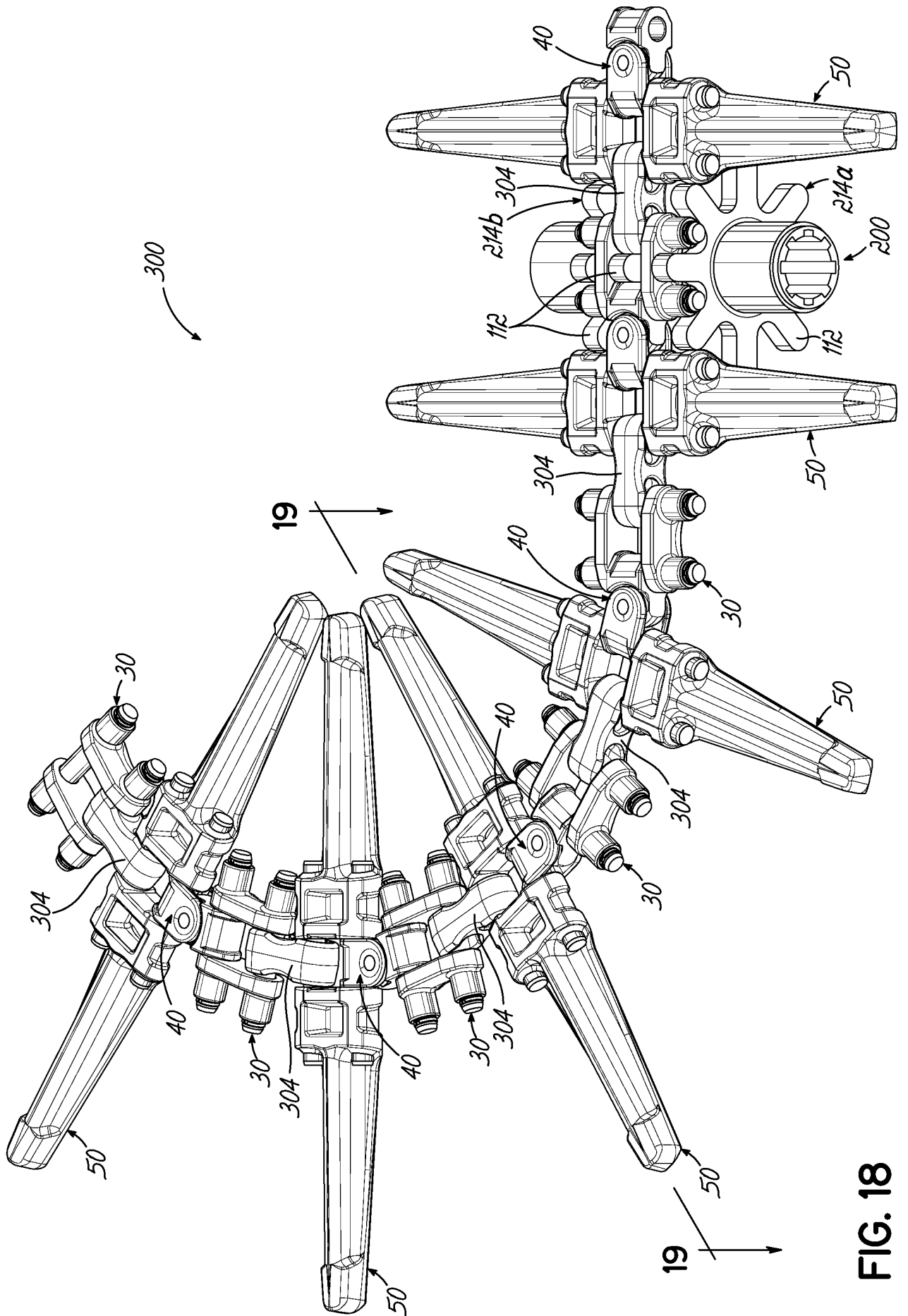
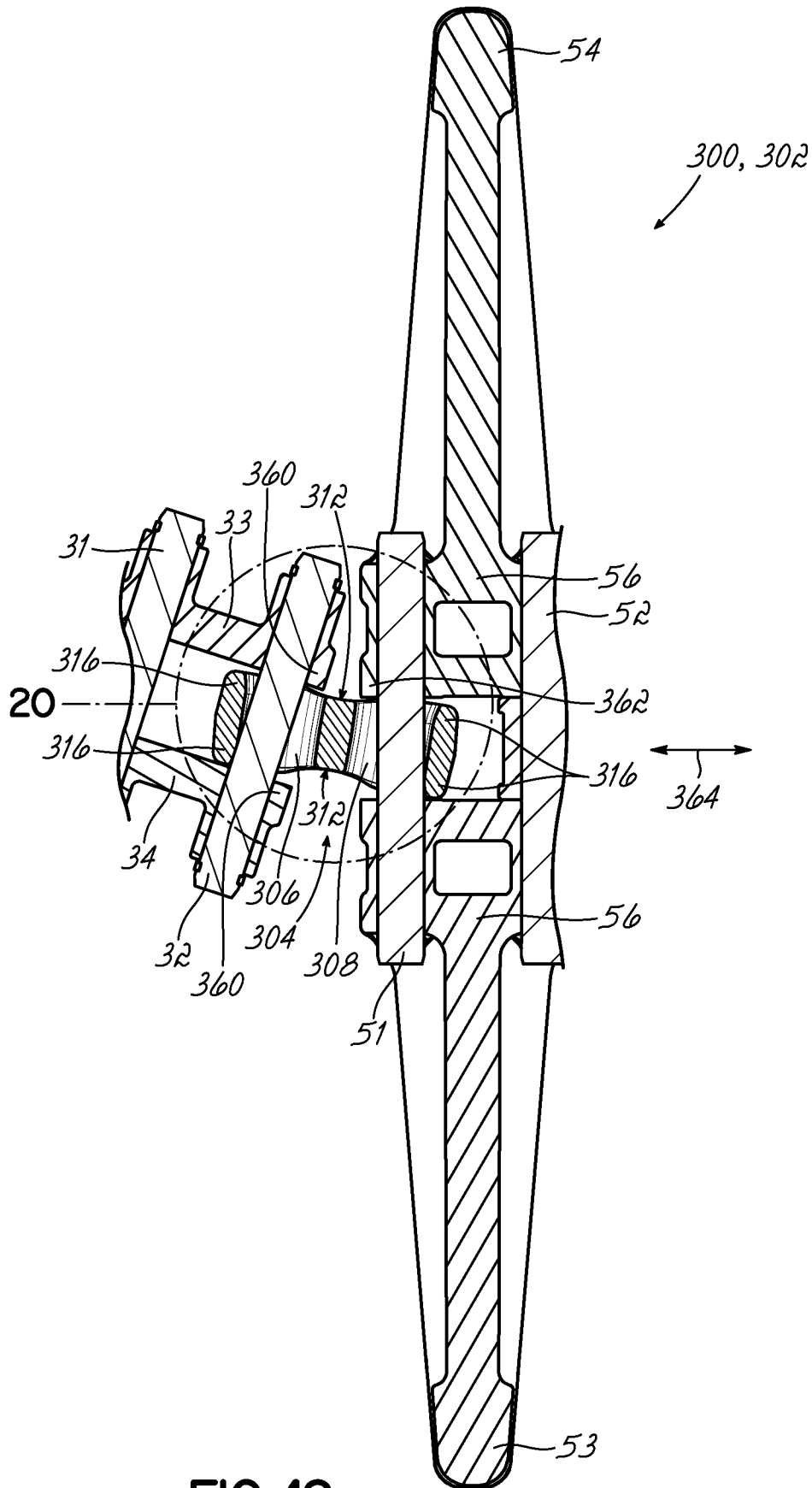

FIG. 18



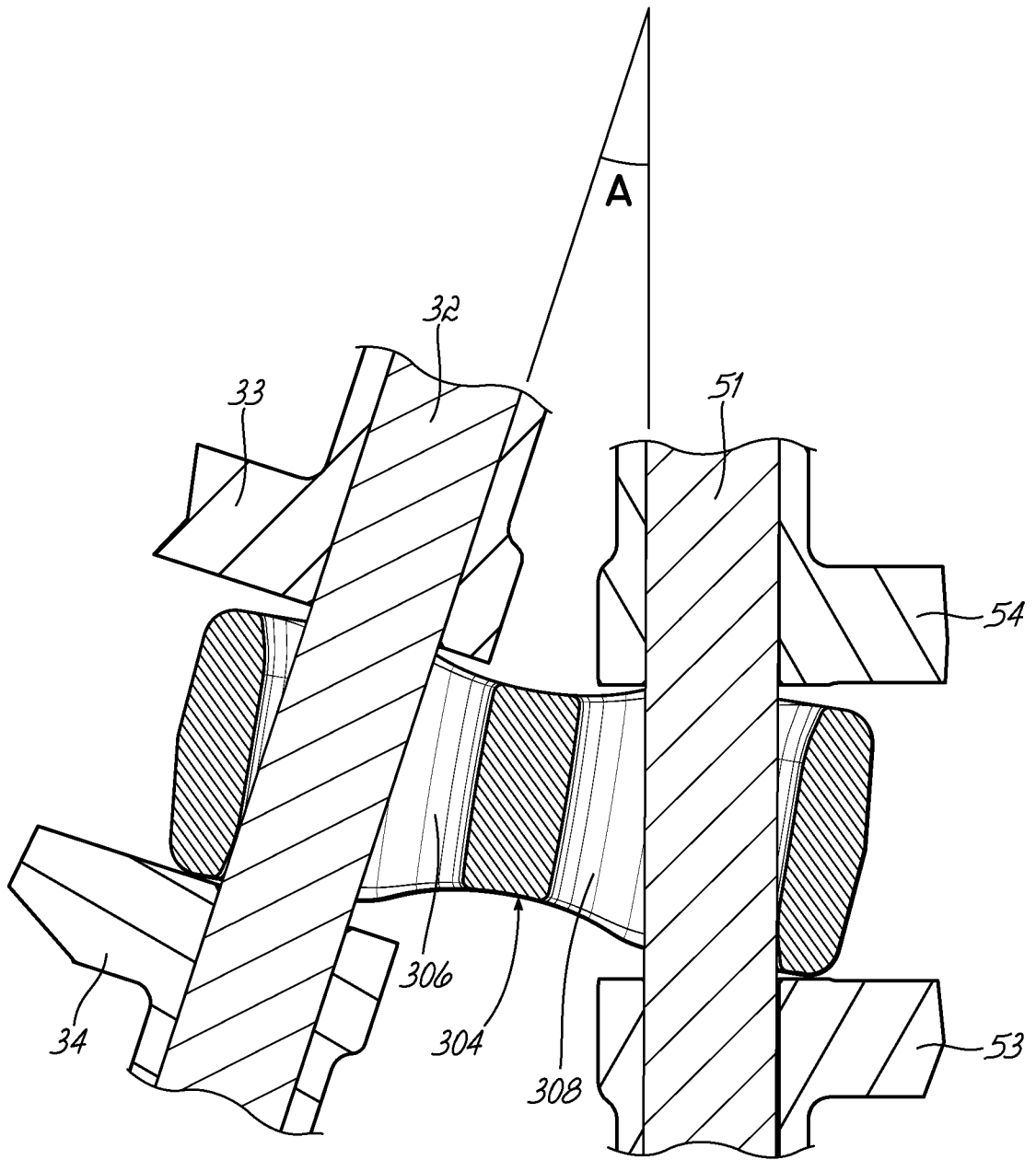

FIG. 20

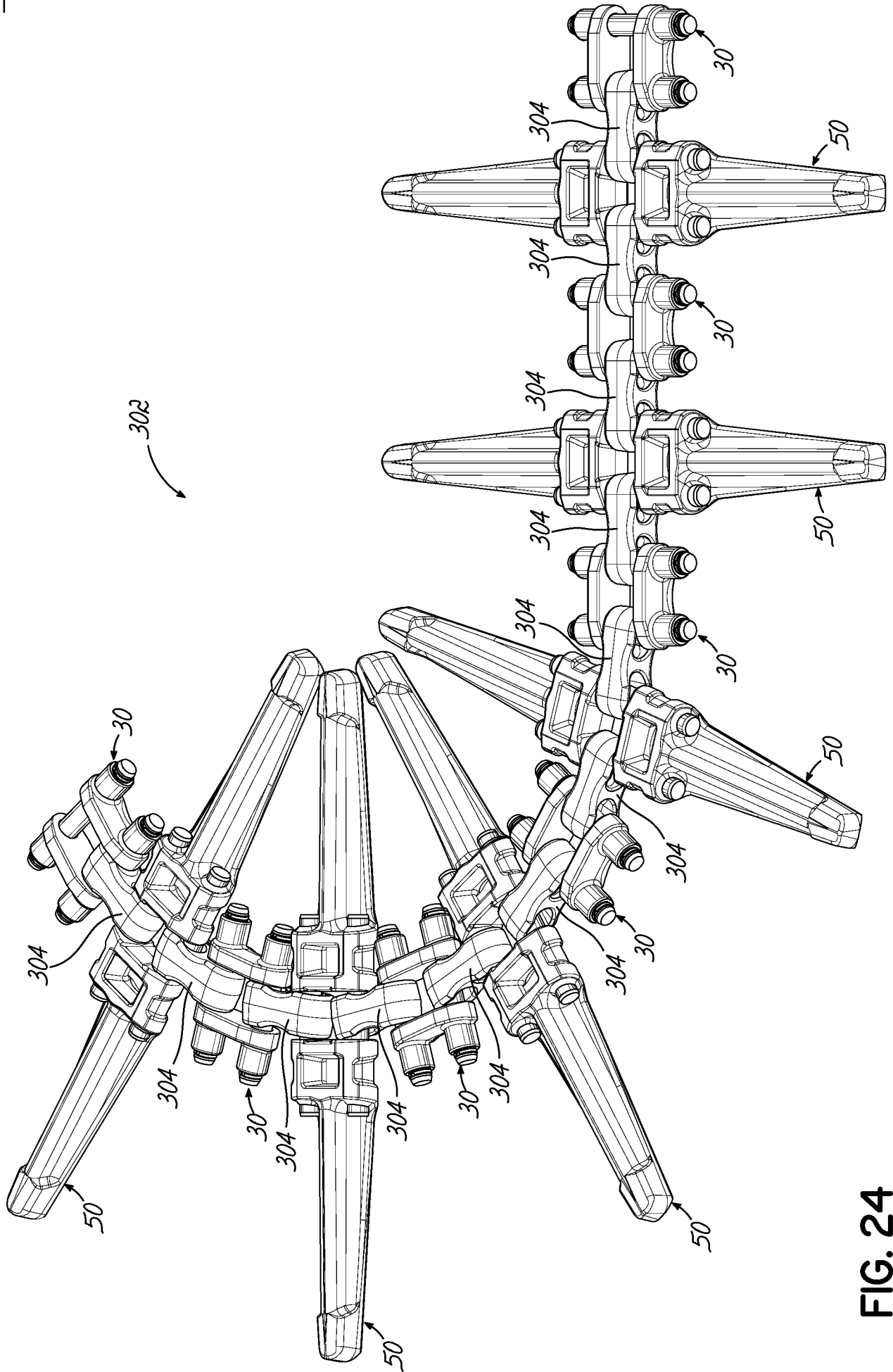

FIG. 24

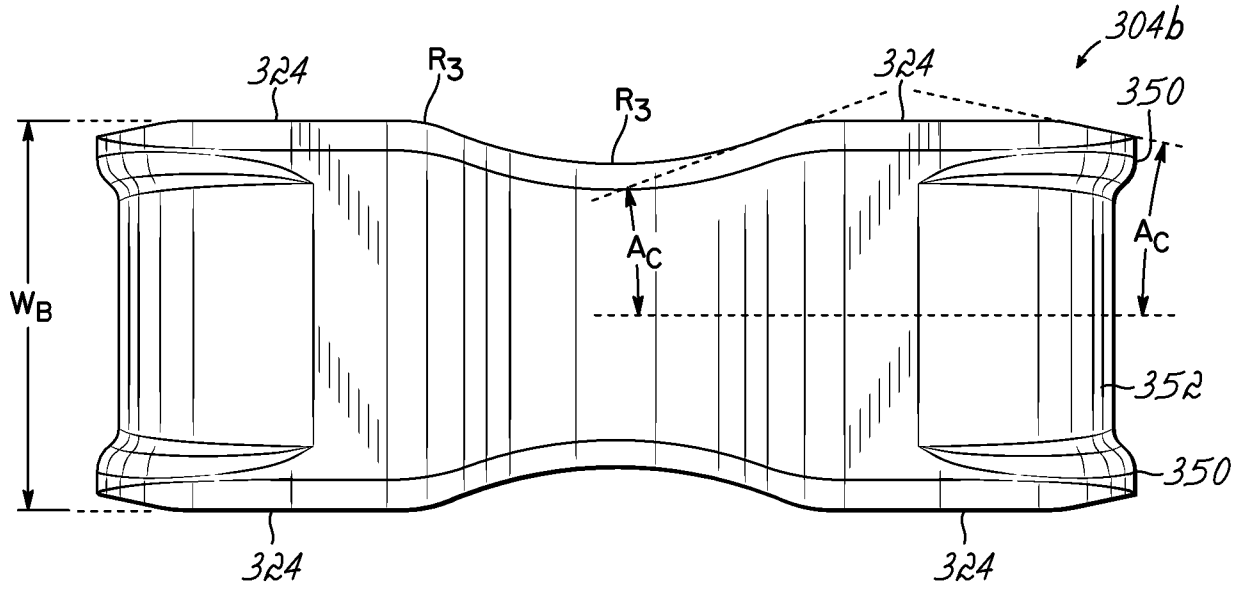

FIG. 25

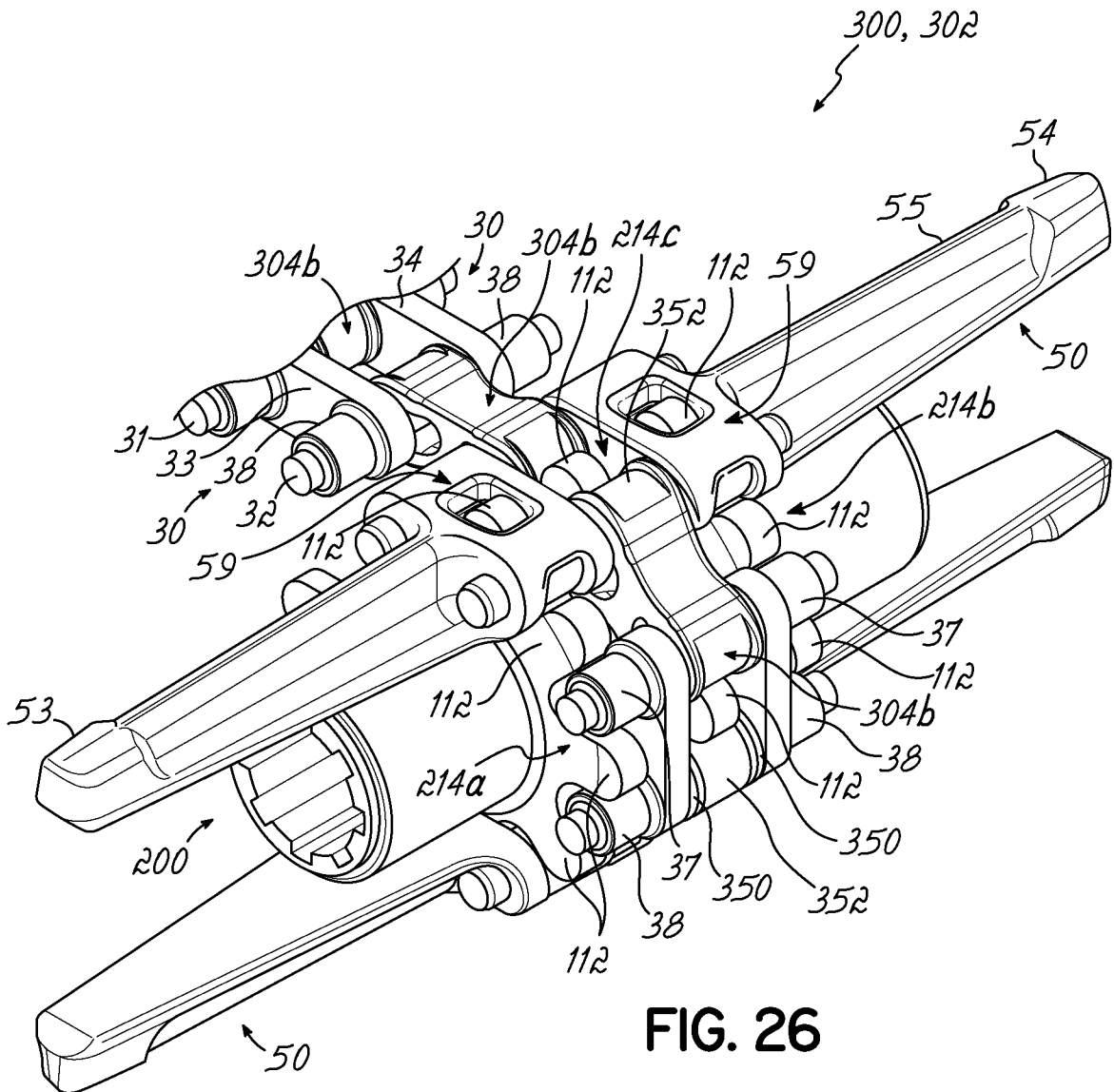

FIG. 26

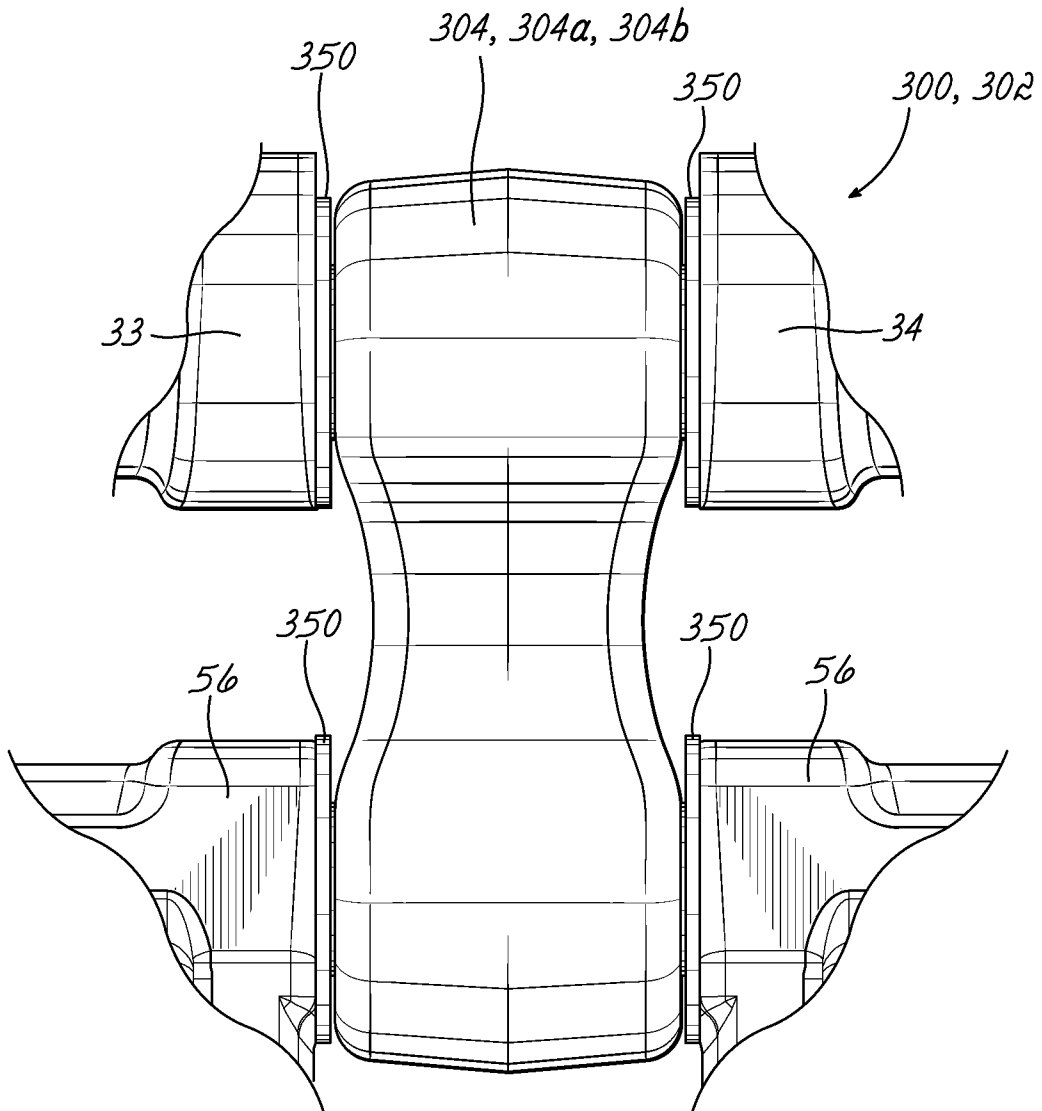

FIG. 27

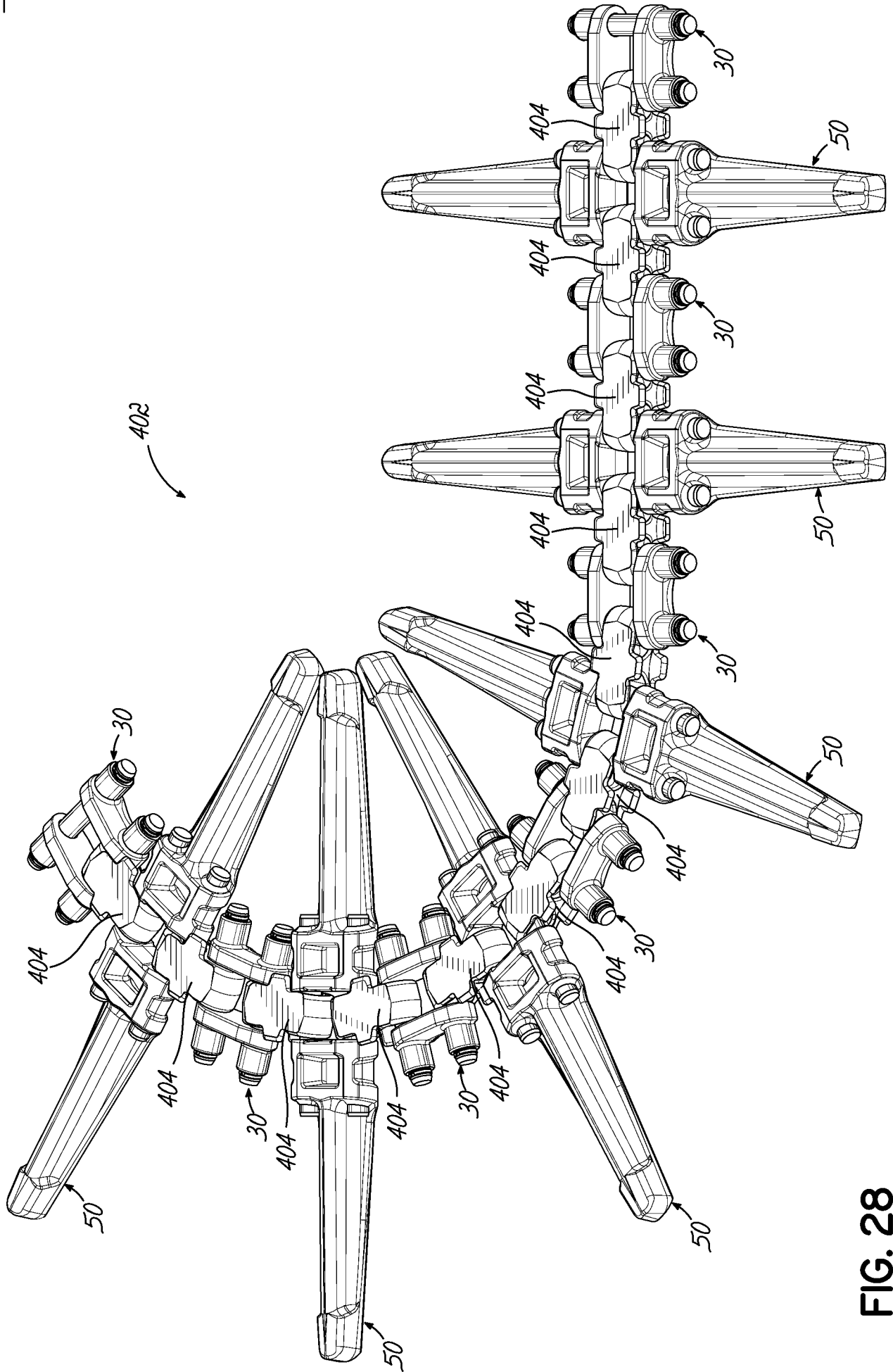
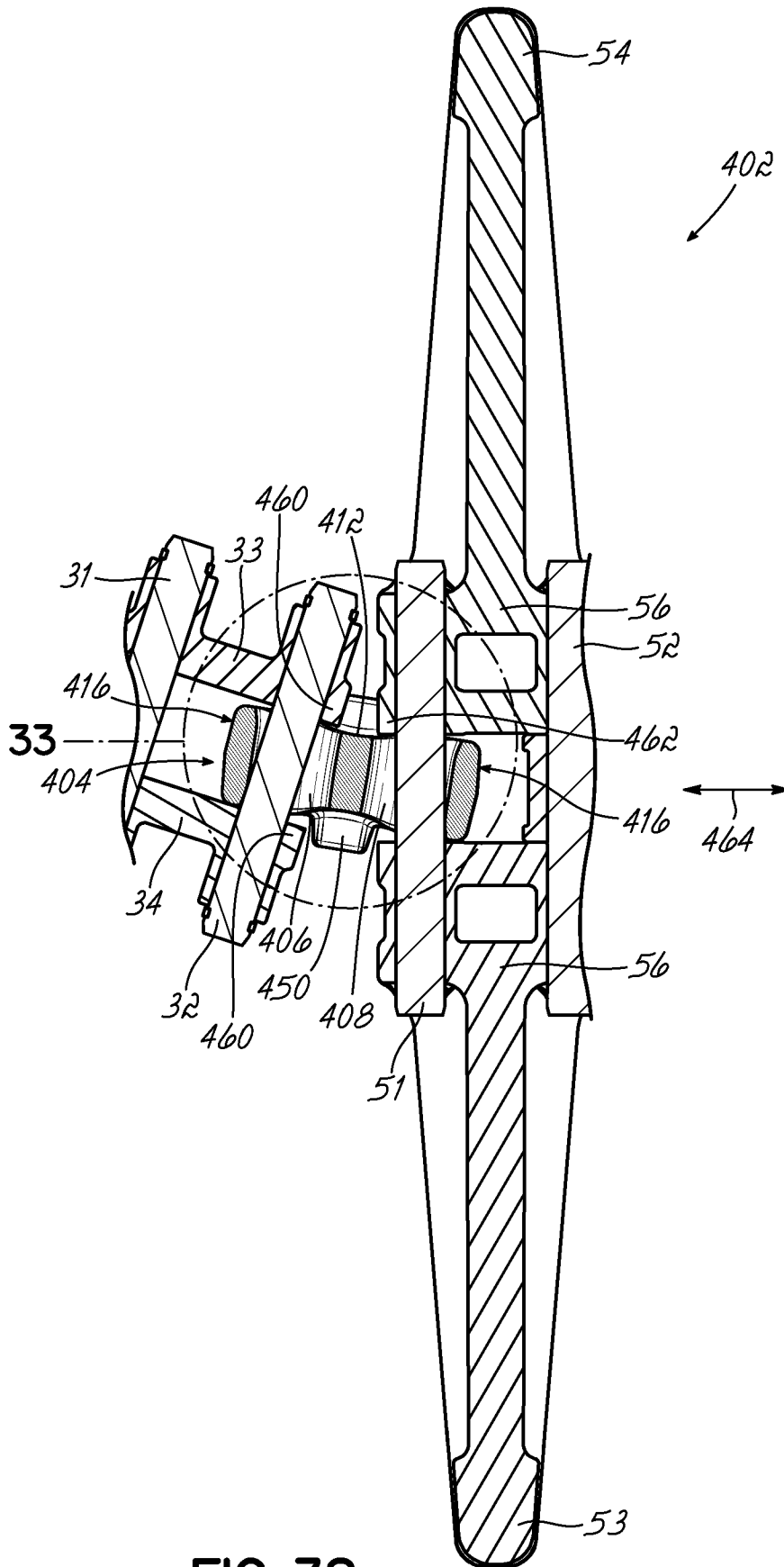

FIG. 28



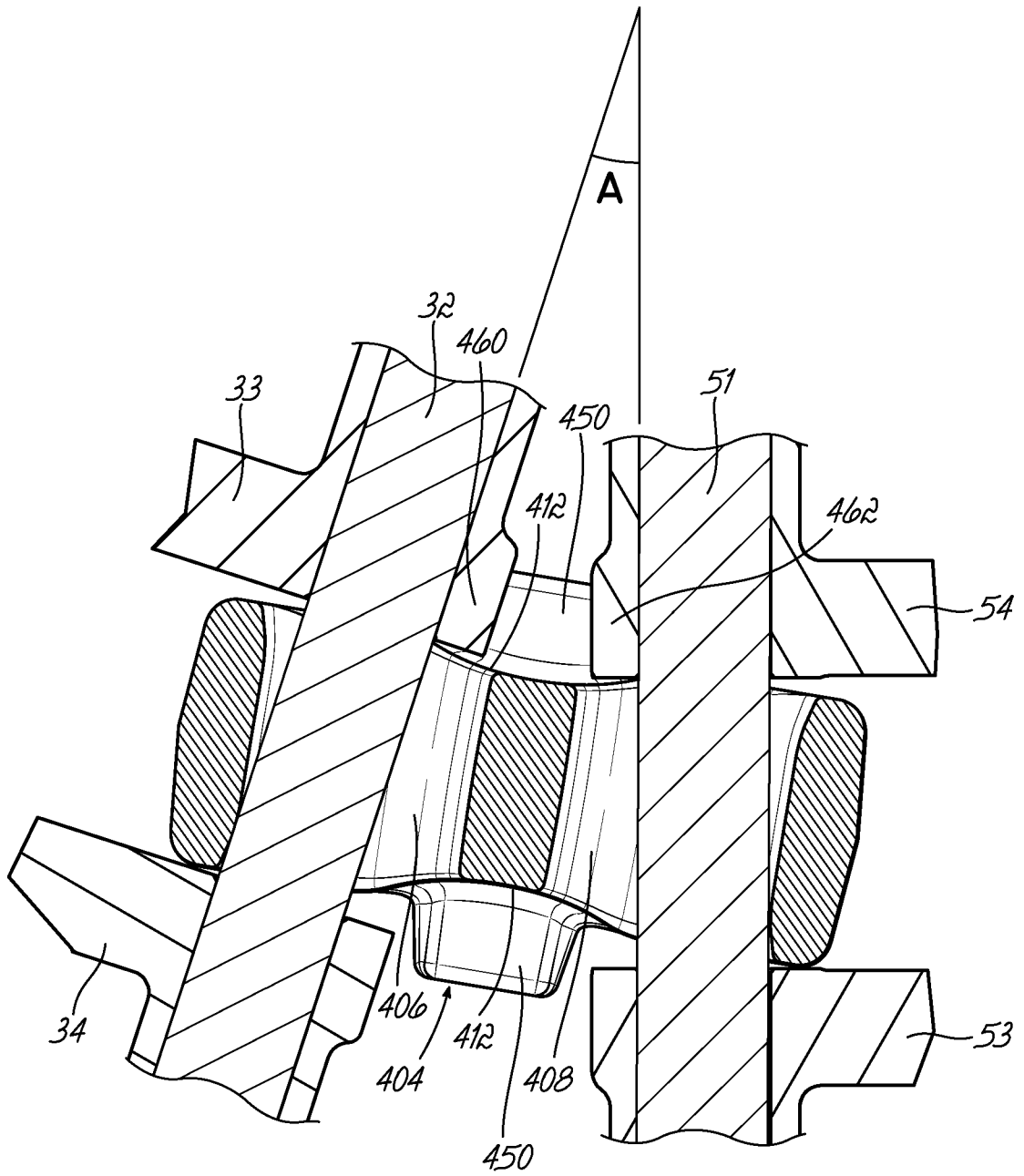

FIG. 33

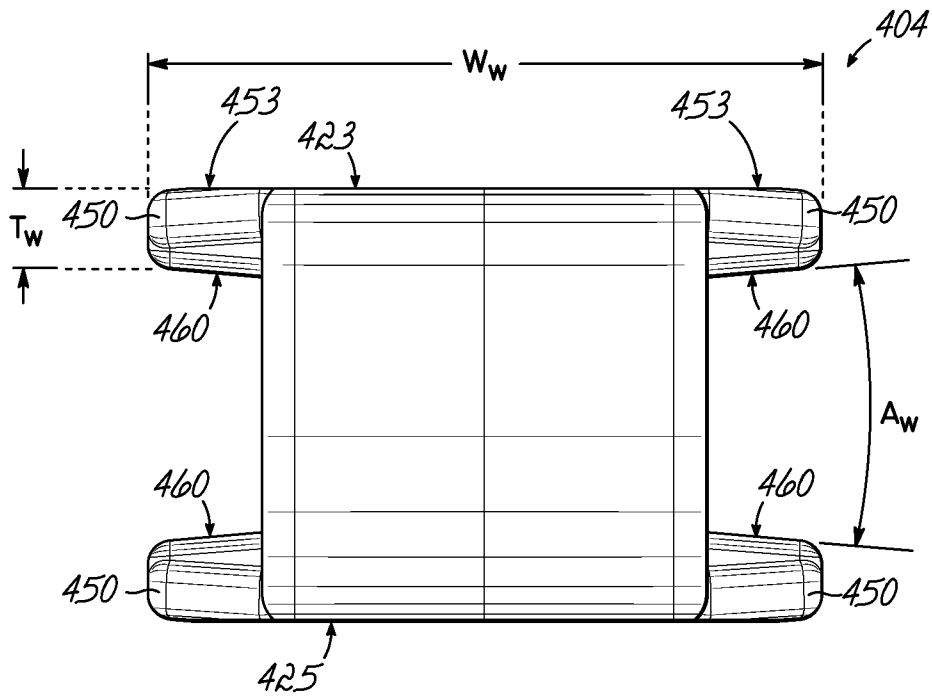

FIG. 34

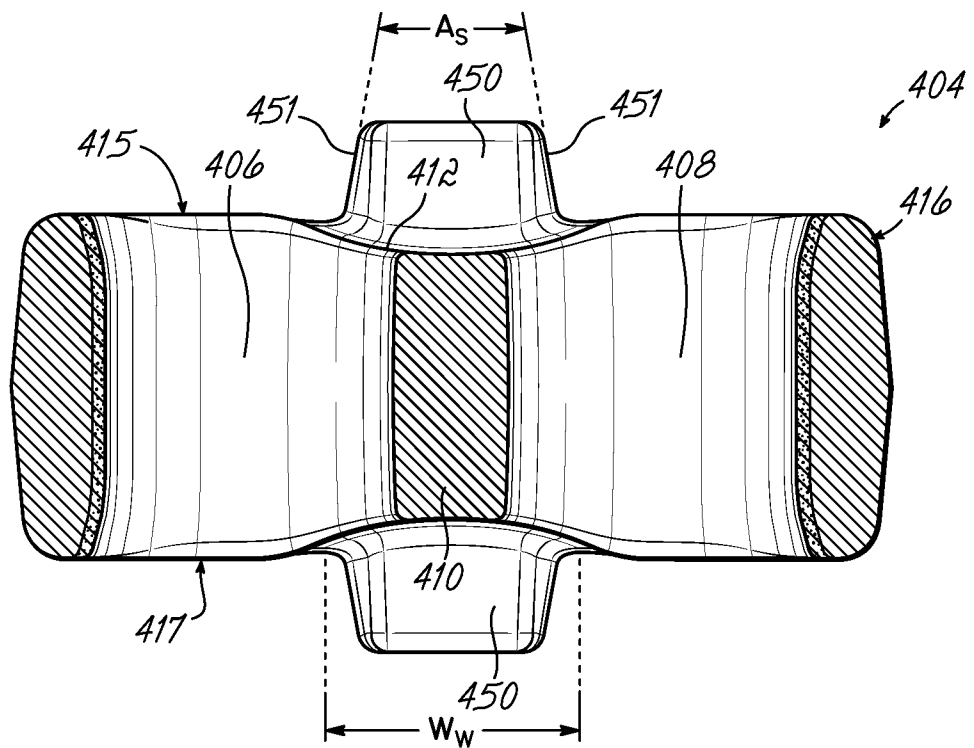

FIG. 35

INTERNATIONAL SEARCH REPORT

International application No.
PCT/US2015/042431

Box No. II Observations where certain claims were found unsearchable (Continuation of item 2 of first sheet)

This international search report has not been established in respect of certain claims under Article 17(2)(a) for the following reasons:

1. Claims Nos.:
because they relate to subject matter not required to be searched by this Authority, namely:

2. Claims Nos.:
because they relate to parts of the international application that do not comply with the prescribed requirements to such an extent that no meaningful international search can be carried out, specifically:

3. Claims Nos.:
because they are dependent claims and are not drafted in accordance with the second and third sentences of Rule 6.4(a).

Box No. III Observations where unity of invention is lacking (Continuation of item 3 of first sheet)

This International Searching Authority found multiple inventions in this international application, as follows:

see additional sheet

1. As all required additional search fees were timely paid by the applicant, this international search report covers all searchable claims.

2. As all searchable claims could be searched without effort justifying an additional fees, this Authority did not invite payment of additional fees.

3. As only some of the required additional search fees were timely paid by the applicant, this international search report covers only those claims for which fees were paid, specifically claims Nos.:

4. No required additional search fees were timely paid by the applicant. Consequently, this international search report is restricted to the invention first mentioned in the claims; it is covered by claims Nos.:

1-33

Remark on Protest

- The additional search fees were accompanied by the applicant's protest and, where applicable, the payment of a protest fee.
- The additional search fees were accompanied by the applicant's protest but the applicable protest fee was not paid within the time limit specified in the invitation.
- No protest accompanied the payment of additional search fees.

INTERNATIONAL SEARCH REPORT

International application No
PCT/US2015/042431

A. CLASSIFICATION OF SUBJECT MATTER
INV. B65G19/08 B65G19/24
ADD.
According to International Patent Classification (IPC) or to both national classification and IPC

B. FIELDS SEARCHED
Minimum documentation searched (classification system followed by classification symbols)
B65G

Documentation searched other than minimum documentation to the extent that such documents are included in the fields searched

Electronic data base consulted during the international search (name of data base and, where practicable, search terms used)
EPO-Internal, WPI Data

C. DOCUMENTS CONSIDERED TO BE RELEVANT

Category*	Citation of document, with indication, where appropriate, of the relevant passages	Relevant to claim No.
Y	CN 103 224 115 A (SANYHE INTERNAT HOLDINGS CO) 31 July 2013 (2013-07-31) figures 1-3 -----	1,5-19, 23-33
Y	US 2006/185344 A1 (WILKIE DONALD [US]) 24 August 2006 (2006-08-24) figure 1 -----	1,5-19, 23-33
A	US 2013/264177 A1 (MORRIS RANDALL LEE [US]) 10 October 2013 (2013-10-10) figures 1-17 -----	1,19

Further documents are listed in the continuation of Box C.

See patent family annex.

* Special categories of cited documents :

- "A" document defining the general state of the art which is not considered to be of particular relevance
- "E" earlier application or patent but published on or after the international filing date
- "L" document which may throw doubts on priority claim(s) or which is cited to establish the publication date of another citation or other special reason (as specified)
- "O" document referring to an oral disclosure, use, exhibition or other means
- "P" document published prior to the international filing date but later than the priority date claimed

- "T" later document published after the international filing date or priority date and not in conflict with the application but cited to understand the principle or theory underlying the invention
- "X" document of particular relevance; the claimed invention cannot be considered novel or cannot be considered to involve an inventive step when the document is taken alone
- "Y" document of particular relevance; the claimed invention cannot be considered to involve an inventive step when the document is combined with one or more other such documents, such combination being obvious to a person skilled in the art
- "&" document member of the same patent family

Date of the actual completion of the international search 27 October 2015	Date of mailing of the international search report 12/01/2016
--	--

Name and mailing address of the ISA/ European Patent Office, P.B. 5818 Patentlaan 2 NL - 2280 HV Rijswijk Tel. (+31-70) 340-2040, Fax: (+31-70) 340-3016	Authorized officer Thenert, Alexander
--	--

INTERNATIONAL SEARCH REPORT

Information on patent family members

International application No

PCT/US2015/042431

Patent document cited in search report	Publication date	Patent family member(s)	Publication date
CN 103224115	A	31-07-2013	NONE
US 2006185344	A1	24-08-2006	NONE
US 2013264177	A1	10-10-2013	NONE

FURTHER INFORMATION CONTINUED FROM PCT/ISA/ 210

This International Searching Authority found multiple (groups of) inventions in this international application, as follows:

1. claims: 1-33

A conveyor chain

2. claims: 34-37

An articulating connector
