

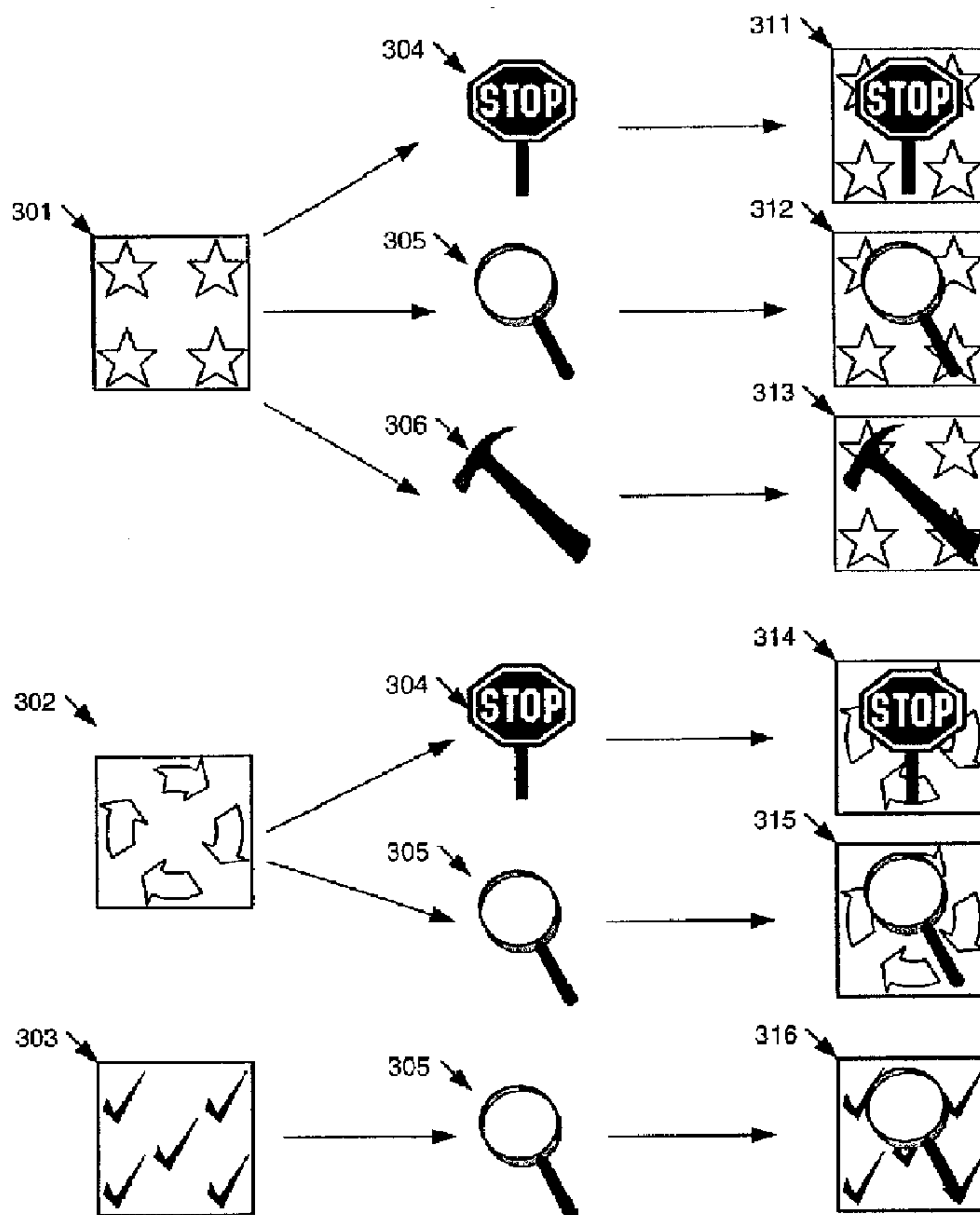

(22) Date de dépôt/Filing Date: 2000/03/01
 (41) Mise à la disp. pub./Open to Public Insp.: 2000/09/03
 (45) Date de délivrance/Issue Date: 2004/06/01
 (30) Priorité/Priority: 1999/03/03 (09/261,657) US

(51) Cl.Int.⁷/Int.Cl.⁷ G06F 3/14, G11B 23/00
 (72) Inventeurs/Inventors:
 PERROUX, FRANCOIS, FR;
 VU, DU Y MINH, FR
 (73) Propriétaire/Owner:
 DASSAULT SYSTEMES, FR
 (74) Agent: MCCARTHY TETRAULT LLP

(54) Titre : INTERFACE LOGICIELLE
 (54) Title: SOFTWARE INTERFACE



(57) Abrégé/Abstract:

A software control method includes forming groups of software application functions. A different characteristic is associated with each of the groups, and a different graphical user interface (GUI) object is formed for each function in each of the groups. Each GUI object includes the characteristic associated with its function's group and a second characteristic that distinguishes its

(57) Abrégé(suite)/Abstract(continued):

function from other functions within its function's group. A computer program residing on a computer-readable medium includes instructions for causing a computer to form a different graphical user interface (GUI) object for each of a collection of software functions. Each GUI object may include a first visual characteristic that identifies a first characteristic of the object's associated function, and a second visual characteristic that identifies a second characteristic of the object's associated function.

ABSTRACT

A software control method includes forming groups of software application functions. A different characteristic is associated with each of the groups, and a different graphical user interface (GUI) object is formed for each function in each of the groups. Each GUI object includes the characteristic associated with its function's group and a second characteristic that distinguishes its function from other functions within its function's group. A computer program residing on a computer-readable medium includes instructions for causing a computer to form a different graphical user interface (GUI) object for each of a collection of software functions. Each GUI object may include a first visual characteristic that identifies a first characteristic of the object's associated function, and a second visual characteristic that identifies a second characteristic of the object's associated function.

SOFTWARE INTERFACE

BACKGROUND

Computer systems can have a graphical user interface (GUI) through which operating system and application software functionality is accessed. A GUI can represent computer application programs, documents, and data files as graphically displayed GUI objects, such as icons and menus. GUI objects can be manipulated by a user to control and activate system and application functions. A user may manipulate GUI objects by means of a pointing device such as a mouse. A mouse is an input device which, when moved over a surface, moves a display screen pointer in a corresponding direction. A mouse typically has a number of buttons which can be pressed (“clicked”) to select a GUI object being pointed at by the pointer, and to activate the GUI object’s associated function. GUI operating systems and applications may also be referred to as “point-and-click” systems. The Microsoft Windows 98® and the Apple Macintosh MacOS® operating systems are examples of common GUI-based computer operating systems that support GUI-based applications.

A well-designed GUI interface can facilitate a user’s understanding of a software application. Some GUI objects, such as icons, can include a picture or other characteristic that is intended to suggest the function associated with the GUI object. Such function-suggesting GUI objects can assist a user in operating a software application. For example, to remind a user how to access printing functionality, an application can use an icon bearing a picture of a printer (a “printer icon”).

There are numerous references teaching the design of the software systems controlled by GUI interfaces. The following contain examples of the known teachings:

“Effective Visual Communication for Graphical User Interface” (from S. Martin, Presentations for the 1995 course on advanced topics in computer graphics, Worcester Polytechnic Institute) provides various advice for improving the visual communication thanks to graphical user interface but only from a design point of view.

Similarly, “Handbook of Usability Principles” (Allen B.S., Eckols S. L., Center for learning instructions and performance technologies, San Diego State University) disclosed some guidelines to design a graphical user interface and to make a software interface communicate

functional information.

US Patent No. 5,689,286 relates to a system and a method for constructing and customizing icons for use in a graphical user interface. The user creates an icon by manipulating sets of objects associated with individual components of the icon. The icon is designed based on
5 the selection of various objects chosen by the user.

Icons may be displayed by way of a toolbar (e.g., in the drawing toolbar of the Microsoft® Word application). The toolbar comprises several icons, which may be invoked separately for carrying out certain actions (draw a line, draw a circle, etc.). The toolbar with its icons may be moved to several locations.

10 If a group of applications use GUI objects with similar visual characteristics to represent similar functions, then a user's understanding of one application can help the user understand other applications in the group. For example, once a user has learned that a printer icon activates a print function in one application, the user may intuitively understand that when the same printer icon appears in another application, it will activate a similar printing function. Similarly,
15 when GUI objects have dissimilar characteristics, it suggests that the functions associated with such objects will have dissimilar characteristics. The use of

dissimilar GUI objects may thereby reinforce a user's understanding of different functions within an application.

A software application designer may want to use dissimilar GUI objects for dissimilar functions and similar GUI objects for similar functions. Such an objective can be difficult to meet when a group of functions have characteristics that are similar, suggesting that similar GUI objects should be used, and other characteristics that are dissimilar, suggesting that dissimilar GUI objects should be used. For example, a word processing application may support two different print operation. The first print operation may print document text and the second print operation may print document statistical information, such as the number of words in the document and the last time the document was changed. From one perspective, these operations are similar in that each operation is a print operation. From another perspective, these operations are dissimilar in that the information printed is different. An application designer can use similar icons for these functions to suggest that each icon is associated with a printing function. However, if similar icons are used, a user may be confused as to whether a particular icon causes document text or document statistical information to be printed. Alternatively, the application designer can use dissimilar icons. However, the use of dissimilar icons may reduce the icon's ability to suggest their associated function. Consequently, an improved way of expressing application functionality through the use of GUI objects is desired.

20

SUMMARY

GUI objects that can simultaneously express multiple characteristics can be used in GUI interfaces. Multiple characteristic GUI objects can simultaneously suggest both similar and dissimilar associations to a user, thereby enabling an application designer to indicate functions that are similar, while simultaneously highlighting differences.

25

In general, in one aspect, the invention features a software control method. The method includes forming a plurality of groups each including one or more functions of a software application. A different characteristic is associated with each of the groups, and a different graphical user interface (GUI) object is formed for each function in each of the groups. Each GUI object includes the characteristic associated with its function's group and a

second characteristic that distinguishes its function from other functions within its function's group.

In general, in another aspect, the invention features a computer program residing on a computer-readable medium. The program includes instructions for causing a computer to form a different graphical user interface (GUI) object for each of a collection of software functions. Each GUI object may include a first visual characteristic that identifies a first characteristic of the object's associated function, and a second visual characteristic that identifies a second characteristic of the object's associated function.

In general, in another aspect, the invention features a computer system having a graphical user interface (GUI). The GUI includes different graphical user interface (GUI) objects each user-selectable to access functionality associated with a software application. Each GUI object has a first visual characteristic that identifies a first characteristic of the object's associated function, and a second visual characteristic that identifies a second characteristic of the object's associated function.

Implementations may include one or more of the following features. GUI objects may have some characteristics in common and other characteristics that distinguishes the GUI objects from each other. GUI object characteristics may include background images, foreground images, and colors. Software application functions may having some characteristics in common and others that differ. Such functions may be associated with GUI objects that have corresponding characteristics in common and corresponding others that differ. A user selection may be received to identify a GUI object and to execute a function associated with the selected GUI object.

In another aspect, a method for controlling operational aspects of a software program is provided. The method comprises: forming groups comprising one or more functions of a software application; associating a different visual characteristic with each of the groups; associating another visual characteristic with each function in each group, with the other visual characteristic being different for each function within a group; and forming a different single graphical user interface (GUI) object for each function in each of the groups, with each single GUI object comprising the visual characteristic associated with the function's group and the other visual characteristic associated with the function.

The method may further comprise displaying at least one single GUI object.

In the method, the visual characteristic associated with a group may be an icon background image.

In the method, the other characteristic associated with the function may be a foreground image.

The method may further comprise receiving a user selection of a single GUI object and performing the function associated with the selected single GUI object.

In the method the another visual characteristic associated with a function within a group may be the same visual characteristic associated with the function within another group.

In the method, the different visual characteristics associated with groups may comprise different colors.

In the method each GUI object may be an icon.

In yet another aspect, a computer program residing on a computer-readable medium is provided. The computer program has function groups each comprising one or more program functions. Further, the program has instructions for causing a computer to: associate a different visual characteristic with each of the groups; associate another visual characteristic with each function in each group, where the other visual characteristic are different for each function within a group; and form a different single GUI object for each function in each of the groups, where each single GUI object comprises the visual characteristic associated with the function's group and the other visual characteristic associated with the function.

The computer program may further comprise instructions for causing a computer to display at least one single GUI object.

In the computer program the visual characteristic associated with a group may be an icon background image.

In the computer program the other characteristic associated with the function may be a foreground image.

The computer program may further comprise instructions for causing a computer: to receive a user selection of a single GUI object; and to perform the function associated with the selected single GUI object.

In the computer program, the another visual characteristic associated with a function within a group may be the same visual characteristic associated with the function within another group.

In the computer program the different visual characteristics associated with groups may comprise different colors.

In the computer program each GUI object may be an icon.

In yet another aspect, a computer system is provided having a processor operatively interconnected to a memory, a graphical display device, and a user input device, the memory containing the computer program described in the previous aspect.

In other aspects of the invention, various combinations and subset of the above aspects are provided. Further, details of one or more embodiments of the invention are set forth in the accompanying drawings and the description below. Implementations may provide advantages such as facilitating access to localized data without requiring user location input. Other features, objects, and advantages of the invention will be apparent from the description and drawings, and from the claims.

DESCRIPTION OF DRAWINGS

FIG. 1 is a block diagram of a computer system.

FIG. 2 is an exemplary graphical user interface application display.

Fig. 3 depicts multiple-characteristic GUI interface objects.

Figs. 4A-4D show exemplary images for use in a CAD/CAM/CAE environment.

DETAILED DESCRIPTION

5 Fig. 1 depicts physical resources of a computer system 100. The computer 100 has a central processor 101 connected to a processor host bus 102 over which it provides data, address and control signals. The processors 101 may be any conventional general purpose single- or multi-chip microprocessor such as a Pentium® processor, a Pentium® Pro processor, a Pentium II® processor, a MIPS® processor, a Power PC® processor or an
10 ALPHA® processor. In addition, the processor 101 may be any conventional special purpose microprocessor such as a digital signal processor or a graphics processor. The microprocessor 101 has conventional address, data, and control lines coupling it to a processor host bus 102.

The computer 100 includes a system controller 103 having an integrated RAM memory controller 104. The system controller 103 is connected to the host bus 102 and
15 provides an interface to random access memory 105 and read only memory 107. The system controller 103 also provides host bus to peripheral bus bridging functions. The controller 103 thereby permits signals on the processor host bus 102 to be compatibly exchanged with signals on a peripheral bus 110. The peripheral bus 110 may be, for example, a Peripheral Component Interconnect (PCI) bus, an Industry Standard Architecture (ISA) bus, or a Micro-
20 Channel bus.

Accessory devices including, for example, a hard disk drive control interface 111 coupled to a hard disk drive 114, a video display controller 112 and keyboard and mouse controller 114 can be coupled to the peripheral bus 110 and controlled by the processor 101.

ROM memory 107 may store system 100 configuration information and basic
25 computer software routines that allow an operating system to be "booted" from the disk 114. The operating system is, for example, the Microsoft Disk Operating System (DOS)™, Windows 95™, Windows NT™, a UNIX operating system, the Apple MacOS™ operating system, or other operating system.

An operating system may be fully loaded in the RAM memory 105 or may include portions in RAM memory 105 ,ROM memory 107 and in disk drive storage 114. For example, the Microsoft Windows 95™ operating system includes some functionality that remains in memory 105 during the use of Windows 95™ and other functionality that can be periodically loaded into RAM memory 105 on an as-needed basis from disk 114. An operating system, such as Windows 95™ or Windows NT™ provides functionality to execute software applications. A software applications and/or operating system can access the display controller 112 and other resources of the computer system 100 to provide a graphical user interface (GUI).

Fig. 2 shows a visual image 200 that can be produced by a GUI-based software application by accessing operating system functionality to send control commands to the display controller 112. A GUI-based application can include one or more interrelated programs providing numerous user accessible and controllable functions. Each function may be controlled by one or more GUI objects, including GUI objects such as a menu 201, icons 202, text input window 203, and other GUI interface elements. To create an intuitive user interface, each GUI object should have a characteristic that is well-known or otherwise suggests the function associated with the GUI object. At the same time, each GUI object should have a distinct characteristic so as to prevent confusion regarding the object's associated function.

A GUI interface can be design using GUI objects that having multiple characteristics, and in which each characteristic of an object can suggest a different associated property. Multiple-characteristic GUI objects can be advantageous where, for example, an application has one or more similar functions, thus suggesting the use of similar GUI objects, while at the same time requiring that each GUI object be distinct to prevent user confusion.

In an exemplary implementation, multiple-characteristic GUI objects can be used to express both an operational domain (i.e., a functional category) associated with an icon, and a particular functions within the icon's operational domain. This use of multiple-characteristic GUI objects is further illustrated by reference to a computer aided design and manufacturing (CAD/CAM) application. A CAD/CAM application can include a number of operational domains, each of which includes interrelated functions that are used together to accomplish a

particular CAD/CAM task. For example, a CAD/CAM application can have three different operational domains; a first providing part assembly functions, a second providing part design functions, and a third providing stress analysis functions. The part assembly domain may include functions to assemble pre-designed parts into a finished product, the part design domain may include functions to design the available parts from a library of available tools and materials, and the stress analysis domain may include functions to perform stress analysis calculations on finished products or on designed parts. Each domain may be implemented as a separate application program able to exchange data with other domain programs. Alternatively, each domain may be a separate module or library within an application program. Still other implementation variations may be used.

The functions within each CAD/CAM operational domain can be accessed by icons that use multiple characteristics to express both an associated domain and an associated function within the domain. As shown in Fig. 3, multiple characteristic icons 311-316 can be formed by combining background images 301-303 with foreground images 304-306. Each background image 301-303 may be associated with a particular CAD/CAM domain. For example, background image 301 may be associated with the part assembly domain, image 302 may be associated with the part design domain, and image 303 may be associated with the stress analysis domain. Thus, each image 301-303 can be used to express a functional domain characteristic. Foreground image 304-306 may be used to provide a domain-independent suggestion of a particular tasks or operation to be performed. For example, the stop sign image 304 may be associated with a cancel operation, the magnifying glass image 305 may be associated an operation to displaying information, and the hammer image 306 may be associated with an assembly operation. Thus, icon images 304-306 can be used to express characteristics related to a particular function regardless of the function's domain. The combination of background images 301-303 with foreground images 304-306 results in icons 311-316 that suggest the CAD/CAM operations shown in Table 1.

Table 1: Exemplary Multiple-Characteristic Icons

<u>ICON</u>	<u>SUGGESTED OPERATION</u>
311	Cancel a part assembly operation.

312	Display part assembly information.
313	Perform part assembly operation.
314	Cancel a part design operation.
315	Display part design information.
316	Display stress analysis information.

As described in Table 1 and as shown in Fig. 3, similar characteristics can be used for multiple GUI object while maintaining GUI object distinctiveness. For example, the magnifying glass image 305 is a characteristic that is associated with three icons 312, 315, and 316 indicating that each icon 312, 315, and 316 is used to display information. Even though the icons 312, 315 and 316 have a similar characteristic 305, each icon 312, 315, 316 remains distinct through the use of a differing second characteristic 301-303, respectively.

Figs. 4A-4D show exemplary images that can be combined to form multi-characteristic icons for use in a computer aided drawing / computer aided manufacturing / computer aided engineering (CAD/CAM/CAE) environment. Fig. 4A shows background images 401-408. Each of the images 401-408 is associated with a group of interrelate CAD/CAM/CAE functions. For example, image 404 may be associated with analysis and simulation functions while image 402 is associated with mechanical design. Figs. 4B and 4C show foreground images that can be combined with the background images of Fig. 4A. Image 411 may be associated with the design of a shape, image 412 with a knowledge or advising function, and image 413 with the design of individual parts. Images 421-423 may be qualifiers that can be further added to combinations of the images of Figs. 4A with the images of Fig. 4B. Qualifier images 421-423 may be associated with generative, dynamic, and optimization functions of a CAD/CAM/CAE application, respectively. The icon images of Figs. 4A-4C can combined to express a descriptive icon language. Fig. 4D shows icons 431-445 formed by combination of images include the images of Figs. 4A-4C. For example, icons 436-440 each include a background mechanical design image 402 indicating that each of the icons 436-440 is associated with a mechanical design operation.

Information gained from and icon's background image 401-408 is further refined by combinations of foreground images, such as the images 411-413 and 421-423. For example,

icon 436's use of the part design image 413 along with the mechanical design background image 402 indicates that icon 436 is associated with the mechanical design of a part. Even further refinement can be obtained by the use of a second foreground image on an icon. For example, icons 439-440 each include an analysis and simulation background image 404, a foreground
5 image, and a generative qualifier image 421. The presence of the generative qualifier image indicates that each of the icons 439-440 is associated with a generative function.

Multiple-characteristic GUI objects can also be formed by using characteristics, in addition to, or instead of, pictorial images. For example, a red, a green, and a blue colored background may be substituted in place of the background images 301-303 to produce distinct
10 multiple-characteristic icons having foreground images 304-306 over a red, green, or blue background. In a menu-based implementation, different background colors can be associated with different operational domains, and text labels can be used to identify particular functions within an operational domain. Multi-characteristic GUI object images may be formed manually, such as by combining images using an icon image editor, or may be formed using an automated
15 program to overlay various icon images to form a composite image.

Multiple-characteristic icons can be used within applications, among multiple applications in a suite of applications, and for icon images on a operating-system provided "desktop." For example, multiple-characteristic icons can be used to represent particular groupings of applications accessible by program applications on a Windows 95 "desktop."

20 The invention may be implemented in digital electronic circuitry, or in computer hardware, firmware, software, or in combinations of them. Apparatus of the invention may be implemented in a computer program product tangibly embodied in a machine-readable storage device for execution by a programmable processor; and method steps of the invention may be performed by a programmable processor executing a program of instructions to perform
25 functions of the invention by operating on input data and generating output. The invention may advantageously be implemented in one or more computer programs that are executable on a programmable system including at least one programmable processor coupled to receive data and instructions from, and to transmit data and instructions to, a data storage system, at least one input device, and at least on output device. Each computer program may

be implemented in a high-level procedural or object-oriented programming language, or in assembly or machine language if desired; and in any case, the language may be a compiled or interpreted language. Suitable processors include, by way of example, both general and special purpose microprocessors. Generally, a processor will receive instructions and data
5 from a read-only memory and/or a random access memory. Storage devices suitable for tangibly embodying computer program instructions and data include all forms of non-volatile memory, including by way of example semiconductor memory devices, such as EPROM, EEPROM, and flash memory devices; magnetic disks such as internal hard disks and removable disks; magneto-optical disks; and CD-ROM disks. Any of the foregoing may be
10 supplemented by, or incorporated in, specially-designed ASICs (application-specific integrated circuits).

A number of embodiments of the present invention have been described. Nevertheless, it will be understood that various modifications may be made without departing from the spirit and scope of the invention. For example, in some GUI implementations, different
15 shapes may be associated with GUI objects and used to express different characteristics associated with the GUI objects. In other implementations, GUI objects can express more than two characteristics. Accordingly, other embodiments are within the scope of the following claims.

WHAT IS CLAIMED IS

Claims

We Claim:

1. A method for controlling operational aspects of a software program, said method comprising:
forming a plurality of groups each comprising one or more functions of a software application;
associating a different visual characteristic with each of the groups;
associating another visual characteristic with each function in each group, the other visual characteristic being different for each function within a group; and
forming a different single graphical user interface (GUI) object for each function in each of the groups, each single GUI object comprising the visual characteristic associated with the function's group and the other visual characteristic associated with the function.
2. The method of claim 1 further comprising displaying at least one single GUI object.
3. The method of claim 1 or 2, wherein the visual characteristic associated with a group is an icon background image.
4. The method of one of claims 1 to 3, wherein said other characteristic associated with the function is a foreground image.
5. The method of one of claims 1 to 4, further comprising receiving a user selection of a single GUI object and performing the function associated with the selected single GUI object.
6. The method of one of claims 1 to 5, wherein said another visual characteristic associated with a function within a group is the same visual characteristic associated with the function within another group.
7. The method of one of claims 1 to 6, wherein the different visual characteristics associated with groups comprise different colors.
8. The method of one of claims 1 to 7, wherein each GUI object is an icon.

9. A computer program residing on a computer-readable medium, the computer program having a plurality of function groups each comprising one or more program functions, the program comprising instructions for causing a computer to:
 - associate a different visual characteristic with each of the groups;
 - associate another visual characteristic with each function in each group, the other visual characteristic being different for each function within a group; and
 - form a different single graphical user interface (GUI) object for each function in each of the groups, each single (GUI) object comprising the visual characteristic associated with the function's group and the other visual characteristic associated with the function.
10. The computer program of claim 9, further comprising the instructions for causing a computer to display at least one single GUI object.
11. The computer program of claim 9, wherein the visual characteristic associated with a group is an icon background image.
12. The computer program of one of claims 9 to 11, wherein said other characteristic associated with the function is a foreground image.
13. The computer program of one of claims 9 to 12, further comprising the instructions for causing a computer to receive a user selection of a single GUI object and to perform the function associated with the selected single GUI object.
14. The computer program of one of claims 9 to 13, wherein said another visual characteristic associated with a function within a group is the same visual characteristic associated with the function within another group.
15. The computer program of one of claims 9 to 14, wherein the different visual characteristics associated with groups comprise different colors.
16. The computer program of one of claims 9 to 15, wherein each GUI object is an icon.

17. A computer system having a processor operatively interconnected to a memory, a graphical display device, and a user input device, the memory containing the computer program according to one of the claims 9 to 16.

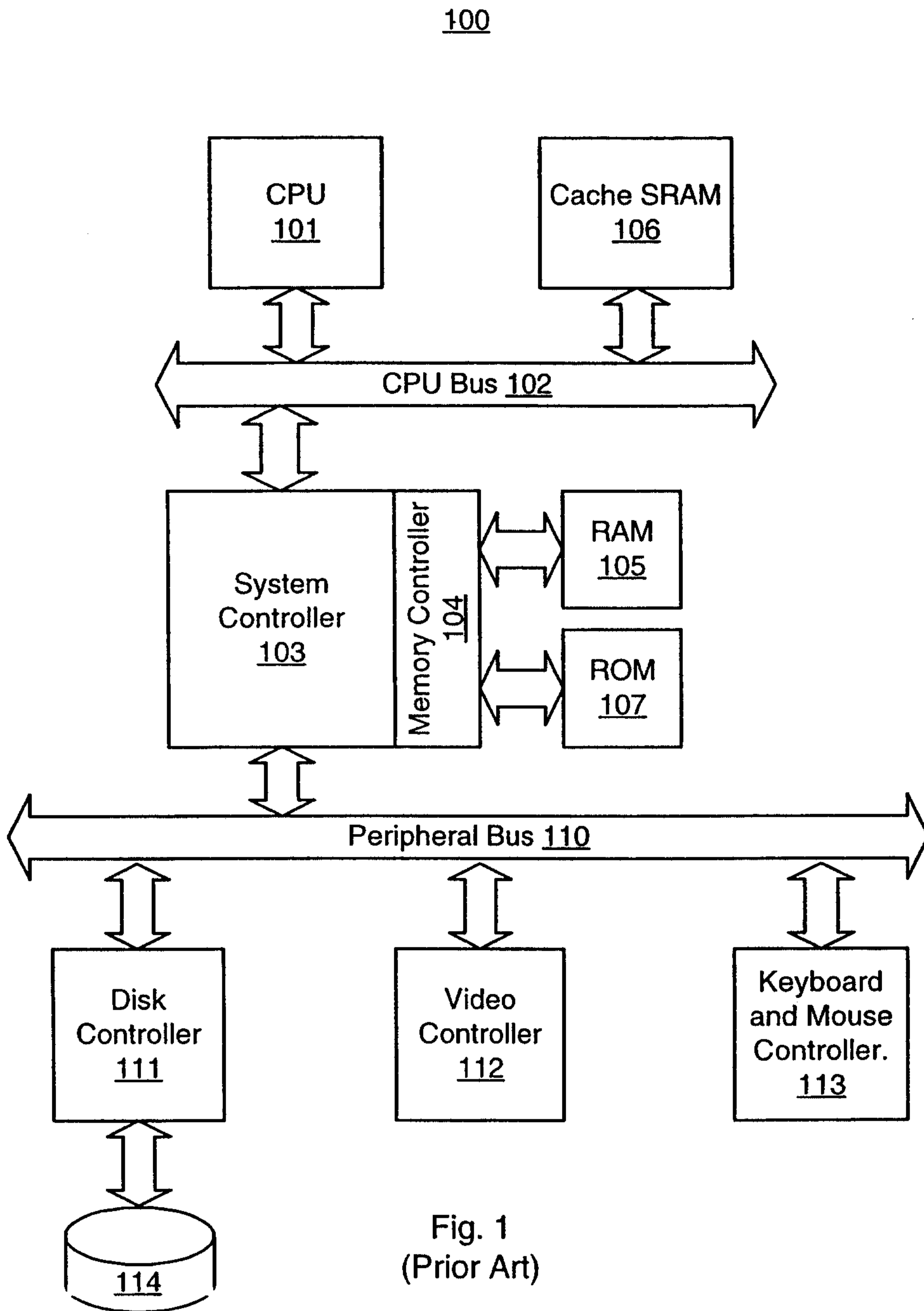

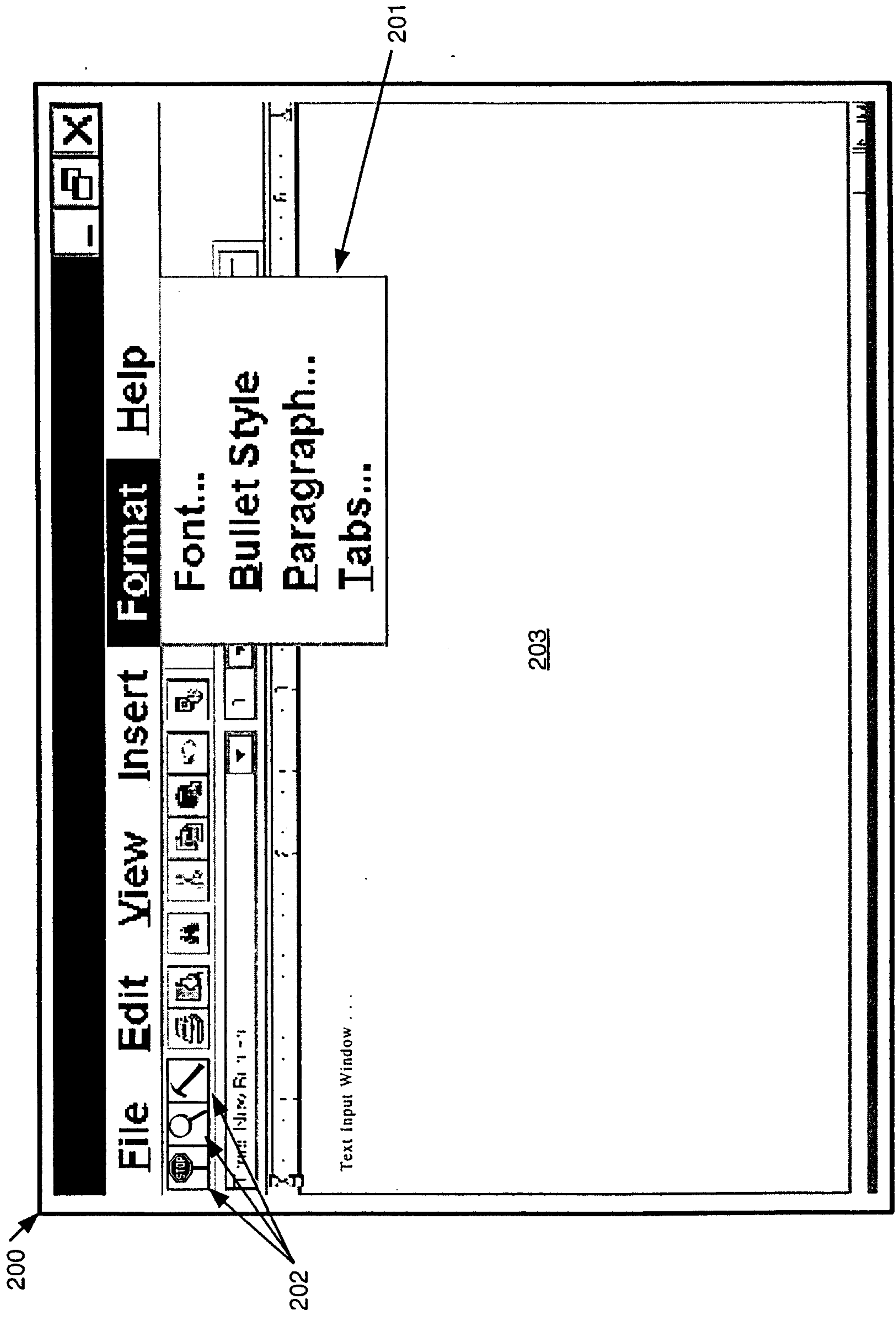

Fig. 2

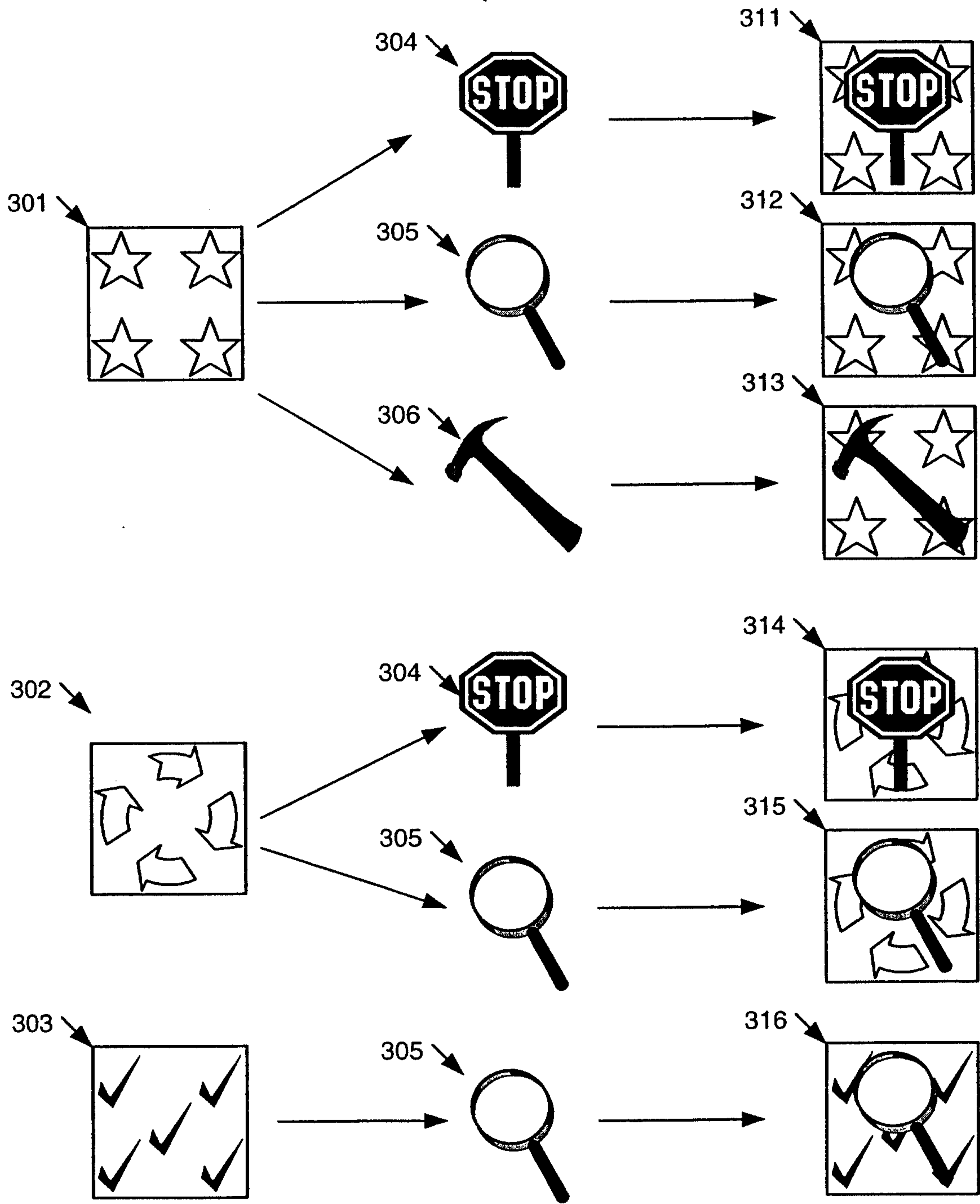

Fig. 3

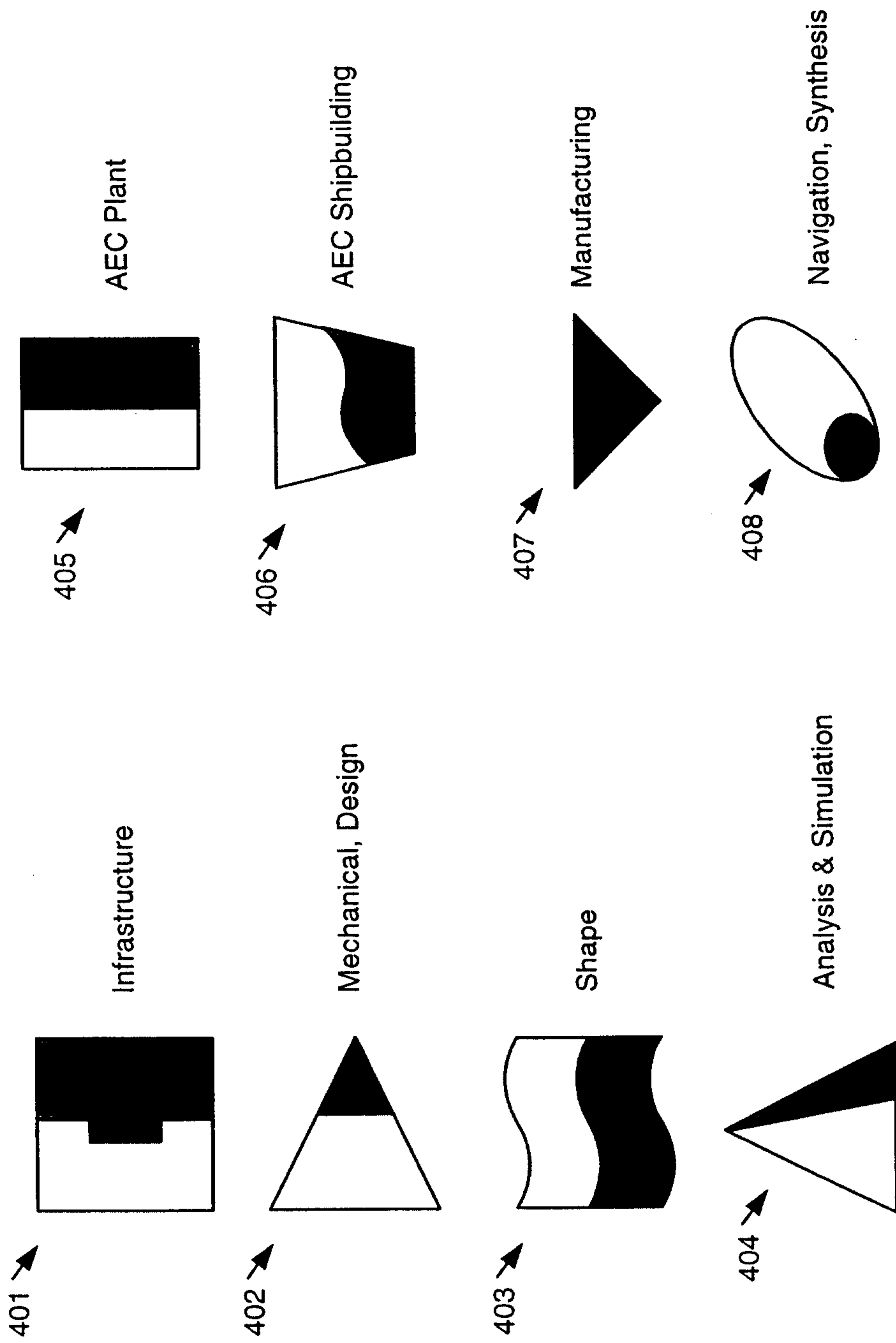

Fig. 4A

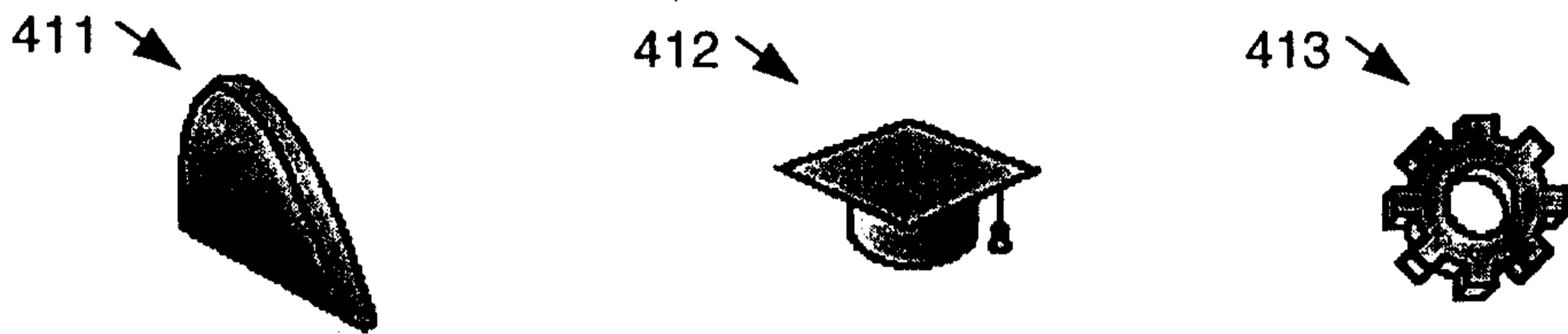

Fig. 4B

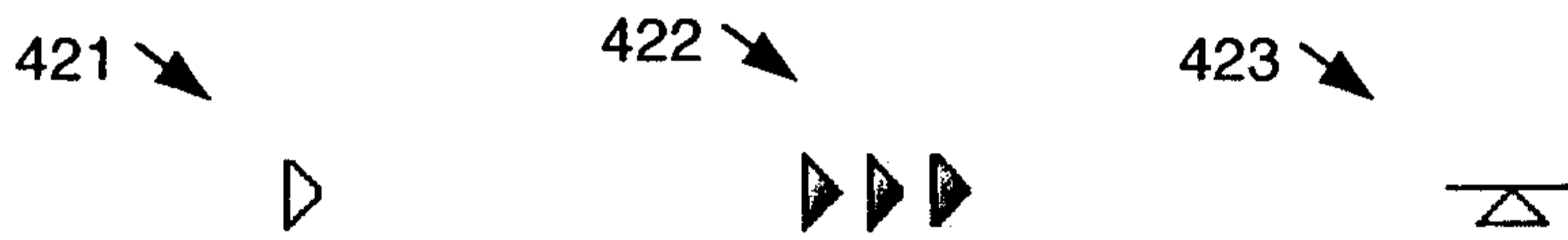

Fig. 4C

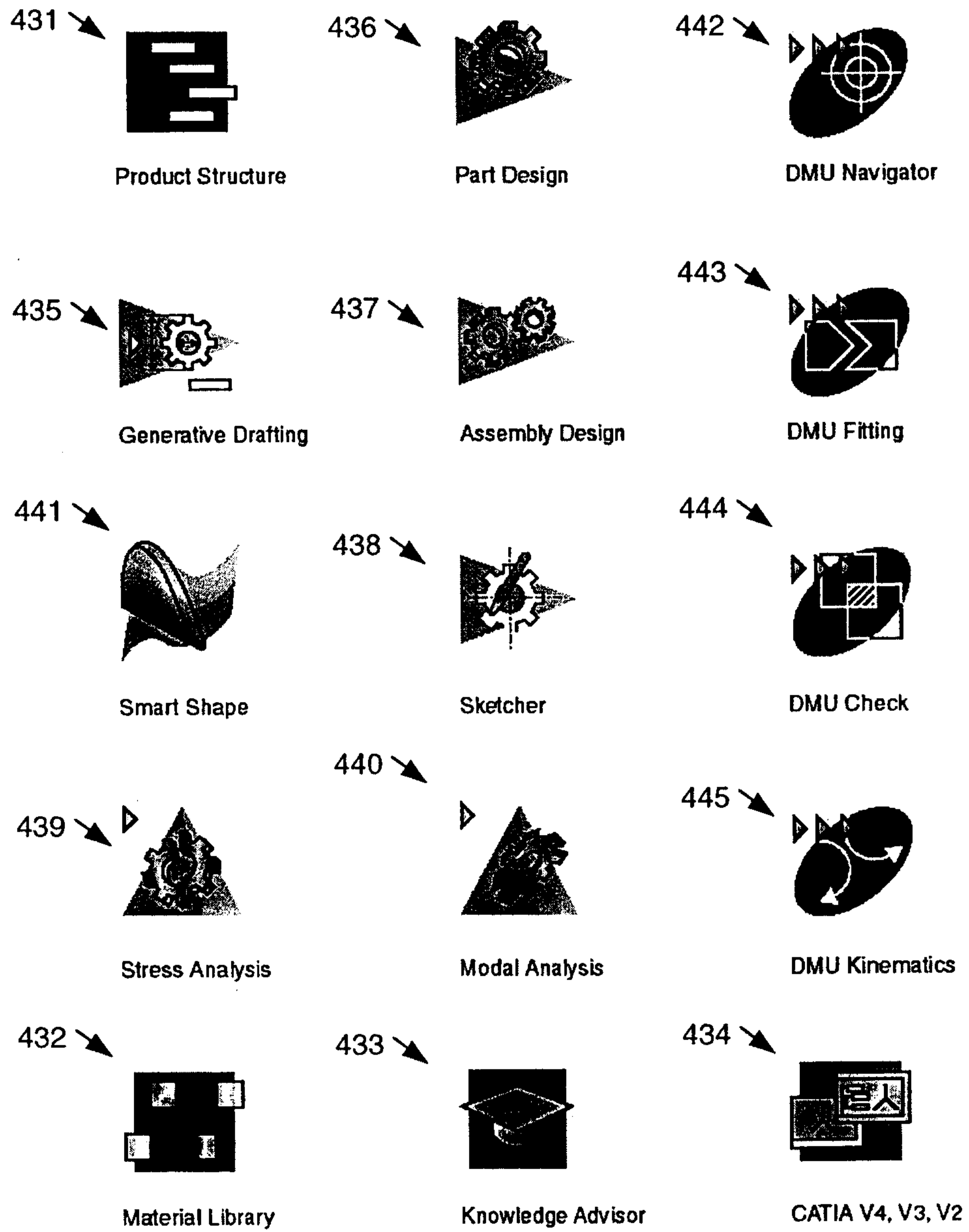

Fig. 4D

