

(12) STANDARD PATENT
(19) AUSTRALIAN PATENT OFFICE

(11) Application No. **AU 2014241994 B2**

(54) Title
Apparatus for bone stabilization and distraction and methods of use

(51) International Patent Classification(s)
A61B 17/70 (2006.01)

(21) Application No: **2014241994**

(22) Date of Filing: **2014.02.28**

(87) WIPO No: **WO14/158695**

(30) Priority Data

(31) Number
13/804,521

(32) Date
2013.03.14

(33) Country
US

(43) Publication Date: **2014.10.02**

(44) Accepted Journal Date: **2018.11.08**

(71) Applicant(s)
Spinal Elements, Inc.

(72) Inventor(s)
Blain, Jason; Martin, Greg

(74) Agent / Attorney
Davies Collison Cave Pty Ltd, Level 15 1 Nicholson Street, MELBOURNE, VIC, 3000, AU

(56) Related Art
US 2012/0150231 A1



(51) International Patent Classification:
A61B 17/70 (2006.01)

(21) International Application Number:

PCT/US2014/019325

(22) International Filing Date:

28 February 2014 (28.02.2014)

(25) Filing Language:

English

(26) Publication Language:

English

(30) Priority Data:

13/804,521 14 March 2013 (14.03.2013) US

(71) Applicant: SPINAL ELEMENTS, INC. [US/US]; 2744
Locker Avenue West, Ste. 100, Carlsbad, CA 92008 (US).

(72) Inventors: BLAIN, Jason; 1266 Orchard Glen Circle, Encinitas, CA 92024 (US). MARTIN, Greg; 270 Neptune, Encinitas, CA 92024 (US).

(74) Agent: ALTMAN, Daniel, E.; Knobbe, Martens, Olson & Bear, Llp, 2040 Main Street, 14th Floor, Irvine, CA 92614 (US).

(81) Designated States (unless otherwise indicated, for every kind of national protection available): AE, AG, AL, AM, AO, AT, AU, AZ, BA, BB, BG, BH, BN, BR, BW, BY, BZ, CA, CH, CL, CN, CO, CR, CU, CZ, DE, DK, DM, DO, DZ, EC, EE, EG, ES, FI, GB, GD, GE, GH, GM, GT, HN, HR, HU, ID, IL, IN, IR, IS, JP, KE, KG, KN, KP, KR, KZ, LA, LC, LK, LR, LS, LT, LU, LY, MA, MD, ME, MG, MK, MN, MW, MX, MY, MZ, NA, NG, NI, NO, NZ, OM, PA, PE, PG, PH, PL, PT, QA, RO, RS, RU, RW, SA, SC, SD, SE, SG, SK, SL, SM, ST, SV, SY, TH, TJ, TM, TN, TR, TT, TZ, UA, UG, US, UZ, VC, VN, ZA, ZM, ZW.

(84) Designated States (unless otherwise indicated, for every kind of regional protection available): ARIPO (BW, GH, GM, KE, LR, LS, MW, MZ, NA, RW, SD, SL, SZ, TZ, UG, ZM, ZW), Eurasian (AM, AZ, BY, KG, KZ, RU, TJ, TM), European (AL, AT, BE, BG, CH, CY, CZ, DE, DK, EE, ES, FI, FR, GB, GR, HR, HU, IE, IS, IT, LT, LU, LV,

[Continued on next page]

(54) Title: APPARATUS FOR BONE STABILIZATION AND DISTRACTION AND METHODS OF USE

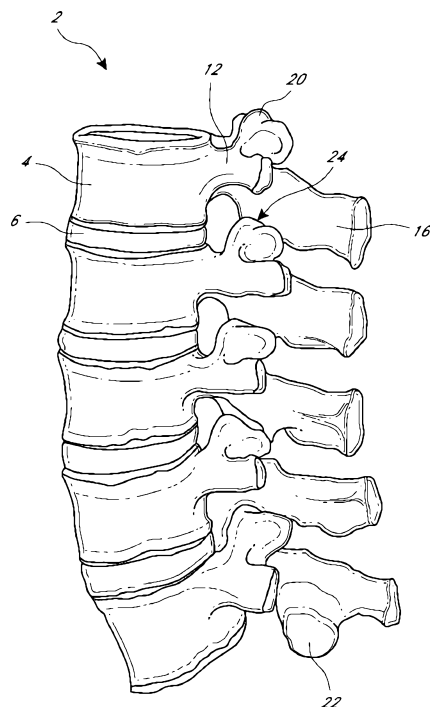

FIG. 1

(57) Abstract: In some embodiments, a method includes disposing a flexible band through an aperture of a support member, the support member having a fixation portion configured to secure the support member to a first bone portion. The method includes advancing a portion of the flexible band through an attachment portion of the flexible band until the flexible band is secured to a second bone portion. The method includes advancing a portion of the fixation portion of the support member into the first bone portion until the support member is secured to the first bone portion.



MC, MK, MT, NL, NO, PL, PT, RO, RS, SE, SI, SK, **Published:**
SM, TR), OAPI (BF, BJ, CF, CG, CI, CM, GA, GN, GQ, — *with international search report (Art. 21(3))*
GW, KM, ML, MR, NE, SN, TD, TG).

Editorial note

2014241994

Please note that there are two pages numbered 2c on file. Please notionally renumber the second to 2d.

APPARATUS FOR BONE STABILIZATION AND DISTRACTION AND METHODS OF USE

[1001] Some embodiments described herein relate generally to methods and apparatus for stabilizing bone, for example, stabilizing vertebrae by securing the articular processes of the vertebrae.

[1002] Traumatic, inflammatory, and degenerative disorders of the spine can lead to severe pain and loss of mobility. One source of back and spine pain is related to degeneration of the facets of the spine or facet arthritis. Bony contact or grinding of degenerated facet joint surfaces can play a role in some pain syndromes. While many technological advances have focused on the intervertebral disc and artificial replacement or repair of the intervertebral disc, relatively little advancement in facet repair has been made. Facet joint and disc degeneration frequently occur together.

[1003] The current standard of care to address the degenerative problems with the facet joints is to fuse the two adjacent vertebrae. By performing this surgical procedure, the relative motion between the two adjacent vertebrae is stopped, thus stopping motion of the facets and any potential pain generated as a result thereof. Procedures to fuse two adjacent vertebrae often involve fixation and/or stabilization of the two adjacent vertebrae until the two adjacent vertebrae fuse.

[1004] Injuries and/or surgical procedure on and/or effecting other bones can also result in the desire to fixate and/or stabilize a bone until the bone, or bone portions, can fuse, for example, to stabilize a sternum after heart surgery, to stabilize a rib after a break, etc. Current procedures to fixate and/or stabilize adjacent vertebrae and/or other bones, however, can be slow and/or complex.

[1005] Accordingly, a need exists for an apparatus and methods to better stabilize and/or fixate a bone.

[1005A] According to a first aspect of the present invention, there is provided an apparatus, comprising: a flexible elongate body comprising a distal end portion, a body portion, and a proximal end portion, the proximal end portion comprising an attachment portion that is configured to receive the distal end portion and the body portion to form a loop around a first vertebra, wherein the attachment portion is configured to permit movement of

the body portion in a first direction but substantially limit the movement of the body portion in a second direction, wherein the attachment portion is monolithically formed with the flexible elongate body; and a support member comprising: a first portion comprising an aperture configured to receive the distal end portion and the body portion of the flexible elongate body, and further comprising a first coupler portion configured to be selectively adjusted to receive and secure a third portion; a second portion comprising a fixation portion that is configured to be coupled to a second vertebra that is adjacent the first vertebra and a second coupler portion configured to be selectively adjusted to receive and secure the third portion; and the third portion disposed between the first portion and the second portion; wherein a distance between the coupler portion of the first portion and the fixation portion of the second portion defines a distraction distance between the first vertebra and the second, adjacent vertebra.

[1005B] According to a second aspect of the present invention, there is provided an apparatus, comprising: a flexible elongate body comprising a distal end portion, a body portion, and a proximal end portion, the proximal end portion comprising an attachment portion that is configured to receive the distal end portion and the body portion when the body portion couples to a first vertebra, wherein the attachment portion is configured to permit movement of the body portion in a first direction but substantially limit the movement of the body portion in a second direction, wherein the attachment portion is monolithically formed with the flexible elongate body; and a support member comprising: an elongate member comprising a first end with an aperture configured to receive the distal end portion and the body portion of the flexible elongate body, and a second end comprising a first coupler portion configured to selectively receive an extension member; a fixation portion comprising a second coupler portion configured to selectively receive the extension member, the fixation portion configured to secure the support member to a second vertebra that is adjacent the first vertebra; and the extension member configured to be selectively coupled to the first coupler portion and

to the second coupler portion; wherein a distance between the first coupler portion of the elongate member and the second coupler portion of the fixation portion defines a distraction distance between the first vertebra and the second, adjacent vertebra.

[1005C] According to a third aspect of the present invention, there is provided a kit, comprising: a flexible band configured to be secured to a first vertebra, the flexible band comprising a distal end portion, a body portion, and a proximal end portion, the proximal end portion comprising an attachment portion that is configured to receive the distal end portion and the body portion to form a loop, wherein the attachment portion is configured to permit movement of the body portion in a first direction but substantially limit the movement of the body portion in a second direction, wherein the attachment portion is monolithically formed with the flexible band; and a support member comprising: an elongate member with a first end comprising an interface portion configured to receive at least a portion of the flexible band, and a second end comprising a coupler portion, the coupler portion having a locking mechanism configured to receive and secure an extension portion; and a fixation portion selectively coupleable to the coupler portion via the extension portion, the fixation portion configured to secure the support member to a second vertebra that is adjacent the first vertebra, such that the first vertebra and the second vertebra are stabilized; wherein a distance between the coupler portion of the elongate member and the fixation portion is adjustable by securing the extension portion at different points along the length of the extension portion to define a distraction distance between the first vertebra and the second, adjacent vertebra.

[1005D] According to a fourth aspect of the present invention, there is provided a method, comprising: forming a loop around a first vertebra with a flexible elongate body comprising a distal end portion, a body portion, and a proximal end portion, the proximal end portion comprising an attachment portion that receives the distal end portion and the body portion to form the loop, wherein the attachment portion permits movement of the body portion in a first direction but substantially limits the movement of the body portion in a second direction, wherein the attachment portion is monolithically formed with the flexible elongate body; and positioning a support member comprising: receiving the distal end portion and the body portion of the flexible elongate body within an aperture of a first portion of the support member; selectively adjusting a first coupler portion of the first portion of the support member to receive and secure a third portion; coupling a fixation portion of a second portion of the support member to a second vertebra that is adjacent the first vertebra; selectively adjusting

a second coupler portion of the second portion to receive and secure the third portion; wherein the third portion is disposed between the first portion and the second portion; wherein a distance between the first coupler portion of the first portion and the fixation portion of the second portion defines a distraction distance between the first vertebra and the second vertebra.

[1005E] According to a fifth aspect of the present invention, there is provided a method, comprising: coupling a flexible elongate body to a first vertebra, wherein the flexible elongate body comprises a distal end portion, a body portion, and a proximal end portion, wherein the proximal end portion comprises an attachment portion that receives the distal end portion and the body portion when the body portion couples to the first vertebra, wherein the attachment portion permits movement of the body portion in a first direction but substantially limits the movement of the body portion in a second direction, wherein the attachment portion is monolithically formed with the flexible elongate body; and positioning a support member comprising: receiving the distal end portion and the body portion of the flexible elongate body within an aperture of a first end of an elongate member, selectively receiving and coupling an extension member with a first coupler portion of a second end of the elongate member; selectively receiving and coupling the extension member with a second coupler portion of a fixation portion; securing the support member to a second vertebra that is adjacent the first vertebra with the fixation portion; and wherein a distance between the first coupler portion of the elongate member and the second coupler portion of the fixation portion defines a distraction distance between the first vertebra and the second, adjacent vertebra.

[1005F] According to a sixth aspect of the present invention, there is provided a method, comprising: securing a flexible band to a first vertebra, the flexible band comprising a distal end portion, a body portion, and a proximal end portion, the proximal end portion comprising an attachment portion that receives the distal end portion and the body portion to form a loop, wherein the attachment portion permits movement of the body portion in a first direction but substantially limits the movement of the body portion in a second direction, wherein the attachment portion is monolithically formed with the flexible band; and positioning a support member comprising: receiving at least a portion of the flexible band with an interface portion of a first end of an elongate member, wherein the elongate member comprises a second end comprising a coupler portion, the coupler portion having a locking mechanism to receive and secure an extension portion; and selectively coupling a fixation portion to the coupler portion via the extension portion, wherein the fixation portion secures

the support member to a second vertebra that is adjacent the first vertebra; wherein a distance between the coupler portion of the elongate member and the fixation portion is adjustable by securing the extension portion at different points along the length of the extension portion to define a distraction distance between the first vertebra and the second, adjacent vertebra.

[1005G] The present invention will now be described, by way of non-limiting example only, with reference to the accompanying drawings briefly described as follows.

[1006] In some embodiments, a method includes disposing a flexible band through an aperture of a support member, the support member having a fixation portion configured to secure the support member to a first bone portion. The method includes advancing a portion of the flexible band through an attachment portion of the flexible band until the flexible band is secured to a second bone portion. The method includes advancing a portion of the fixation portion of the support member into the first bone portion until the support member is secured to the first bone portion.

[1007] FIG. 1 is a lateral elevational view of a portion of the vertebral column.

[1008] FIG. 2A is an example of a superior view of an isolated thoracic vertebra.

[1009] FIG. 2B is an example of a side view of an isolated thoracic vertebra.

[1010] FIG. 3A is an example of a posterior elevational view of a portion of the vertebral column.

[1011] FIG. 3B is an example of a posterior-oblique elevational view of a portion of the vertebral column.

[1012] FIG. 4A is an example of a side view of a facet joint in the cervical vertebrae.

[1013] FIG. 4B is an example of a superior view of a facet joint in the cervical vertebrae.

[1014] FIG. 5A is an example of a side view of a facet joint in the thoracic vertebrae.

[1015] FIG. 5B is an example of a superior view of a facet joint in the thoracic vertebrae.

2014241994 16 Jul 2018

[1016] FIG. 6A is an example of a side view of a facet joint in the lumbar vertebrae.

[1017] FIG. 6B is an example of a superior view of a facet joint in the lumbar vertebrae.

[1018] FIG. 7 is a block diagram of a bone stabilization and distraction apparatus according to an embodiment.

[1019] FIGS. 8A and 8B are schematic illustrations of a flexible elongate body according to an embodiment.

[1020] FIGS. 9A – 9C are various views of a flexible elongate body according to another embodiment.

[1021] FIG. 10A is a posterior perspective view of a portion of the vertebral column depicting a stabilized vertebra including bone stabilization and distraction apparatus according to an embodiment.

[1022] FIG. 10B is an enlarged view of a portion of the vertebral column of FIG. 10A identified as region X₁.

[1023] FIG. 11A is a posterior view of the portion of the vertebral column depicting a stabilized vertebra including a bone stabilization and distraction apparatus according to an embodiment.

[1024] FIG. 11B is an enlarged view of a portion of the vertebral column of FIG. 11A identified as region X₂.

[1025] FIG. 12A is a posterior view of the portion of the vertebral column depicting a stabilized vertebra including a bone stabilization and distraction apparatus according to an embodiment.

[1026] FIG. 12B is an enlarged view of a portion of the vertebral column of FIG. 12A identified as region X₃.

[1027] FIG. 13A is a posterior view of the portion of the vertebral column depicting a stabilized vertebra including a bone stabilization and distraction apparatus according to an embodiment.

[1028] FIG. 13B is an enlarged view of a portion of the vertebral column of FIG. 13A identified as region X₄.

[1029] FIG. 14A is a posterior view of the portion of the vertebral column depicting a stabilized vertebra including a bone stabilization and distraction apparatus according to an embodiment.

[1030] FIG. 14B is an enlarged view of a portion of the vertebral column of FIG. 14A identified as region X5.

[1031] FIG. 15A is a posterior view of the portion of the vertebral column depicting a stabilized vertebra including a bone stabilization and distraction apparatus according to an embodiment.

[1032] FIG. 15B is an enlarged view of a portion of the vertebral column of FIG. 15A identified as region X6.

[1033] FIG. 16 is a flowchart illustrating a method of stabilizing a bone portion according to an embodiment.

[1034] FIG. 17 is a flowchart illustrating a method of stabilizing a bone portion according to an embodiment.

[1035] In some embodiments, a method includes disposing a flexible band through an aperture of a support member, the support member having a fixation portion configured to secure the support member to a first bone portion. The method includes advancing a portion of the flexible band through an attachment portion of the flexible band until the flexible band is secured to a second bone portion. The method includes advancing a portion of the fixation portion of the support member into the first bone portion until the support member is secured to the first bone portion.

[1036] In some embodiments, a method includes disposing a first flexible band through a first aperture of a support member and disposing a second flexible band through a second aperture of the support member. The method includes advancing a portion of the first flexible band through an attachment portion of the first flexible band until the first flexible band is secured to a first bone portion. The method includes advancing a portion of the second flexible band through an attachment portion of the second flexible band until the second flexible band is secured to a second bone portion.

[1037] In some embodiments, an apparatus includes a flexible elongate body including a distal end portion, a body portion, and an attachment portion that is configured to receive the

distal end portion. The apparatus includes a support member including (1) a first portion that includes an aperture configured to receive the distal end portion of the first flexible elongate body; and (2) a second portion configured to be coupled to a bone portion.

[1038] In some embodiments, an apparatus includes a flexible elongate body including a distal end portion, a body portion, and an attachment portion that is configured to receive the distal end portion. The apparatus includes a support member including (1) an aperture configured to receive the distal end portion of the flexible elongate body, and (2) a fixation portion configured to secure the support member to a first bone portion. The attachment portion configured to receive the distal end portion of the flexible elongate body when the body portion of the flexible elongate body is surrounds a second bone portion.

[1039] In some embodiments, a kit includes a flexible band configured to be secured to a first bone portion. The kit includes a support member having an interface portion configured to receive at least a portion of the flexible band, the support member having a fixation portion configured to secure the support member to a second bone portion such that the first bone portion and the second bone portion are stabilized.

[1040] As used in this specification, the singular forms “a,” “an” and “the” include plural referents unless the context clearly dictates otherwise. Thus, for example, the term “a ratchet” is intended to mean a single ratchet or multiple ratchets. As used in this specification, a substance can include any biologic and/or chemical substance, including, but not limited to, medicine, adhesives, etc. While exemplary references are made with respect to vertebra, in some embodiments another bone can be involved. While specific reference may be made to a specific vertebra, a subset of vertebrae, and/or a grouping of vertebrae, it is understood that any vertebra, subset, and/or grouping, or combination of vertebrae can be used.

[1041] The words “proximal” and “distal” generally refer to the direction closer to and away from, respectively, a center of a body. The embodiments described herein, however, can be arranged in any orientation relative to the center of the body. Thus, when discussing the embodiments described herein (specifically a flexible elongate body), the terms “proximal” and “distal” refer to a direction closer to and away from, respectively, an attachment connection or fastener mechanism, for example, the position of which is visually presented with respect to specific embodiments in the attached figures.

[1042] As shown in FIG. 1, the vertebral column 2 includes a series of alternating vertebrae 4 and fibrous discs 6 that provide axial support and movement to the upper portions of the body. The vertebral column 2 typically comprises thirty-three vertebrae 4, with seven cervical (C1-C7), twelve thoracic (T1-T12), five lumbar (L1-L5), five fused sacral (S1-S5) and four fused coccygeal vertebrae. FIGS. 2A and 2B depict a typical thoracic vertebra. Each vertebra includes an anterior body 8 with a posterior arch 10. The posterior arch 10 includes two pedicles 12 and two laminae 14. The two laminae 14 join posteriorly to form a spinous process 16. Projecting from each side of the posterior arch 10 is a transverse process 18, a superior process 20, and an inferior articular process 22. The facets 24, 26 of the superior processes 20 and the inferior articular processes 22 form facet joints 28 with the articular processes of the adjacent vertebrae (see FIGS. 3A and 3B). The facet joints are synovial joints with cartilaginous surfaces and a joint capsule.

[1043] The orientation of the facet joints vary, depending on the level of the vertebral column. In the C1 and C2 vertebrae, for example the facet joints are parallel to the transverse plane. FIGS. 4A to 6B depict examples of the orientations of the facet joints at different levels of the vertebral column. In the C3 to C7 vertebrae examples shown in FIGS. 4A and 4B, the facets are oriented at a 45-degree angle to the transverse plane 30 and parallel to the frontal plane 32, respectively. This orientation allows the facet joints of the cervical vertebrae to flex, extend, lateral flex and rotate. At a 45-degree angle in the transverse plane 30, the facet joints of the cervical spine can guide, but do not limit, the movement of the cervical vertebrae. FIGS. 5A and 5B depict examples of the thoracic vertebrae, where the facets are oriented at a 60-degree angle to the transverse plane 30 and a 20-degree angle to the frontal plane 32, respectively. This orientation is capable of providing lateral flexion and rotation, but only limited flexion and extension. FIGS. 6A and 6B illustrate examples of the lumbar region, where the facet joints are oriented at 90-degree angles to the transverse plane 30 and a 45-degree angle to the frontal plane 32, respectively. The lumbar vertebrae are capable of flexion, extension and lateral flexion, but little, if any, rotation because of the 90-degree orientation of the facet joints in the transverse plane. The actual range of motion along the vertebral column can vary considerably with each individual vertebra.

[1044] In addition to guiding movement of the vertebrae, the facet joints also contribute to the load-bearing ability of the vertebral column. One study by King et al. Mechanism of Spinal Injury Due to Caudocephalad Acceleration, Orthop. Clin. North Am., 6:19 1975,

found facet joint load-bearing as high as 30% in some positions of the vertebral column. The facet joints may also play a role in resisting shear stresses between the vertebrae. Over time, these forces acting on the facet joints can cause degeneration and arthritis.

[1045] In some embodiments described herein, a bone stabilization and distraction apparatus can be used to stabilize and/or fixate a first vertebra to a second vertebra, and/or distract a first vertebra relative to a second vertebra, to reduce the pain, to reduce further degradation of a spine (e.g., a specific vertebra and/or a specific disc of a spine), and/or until the first vertebra and the second vertebra have fused. In some embodiments described herein, a bone stabilization and distraction apparatus can be used in conjunction with a bone fusion procedure, for example, in conjunction with a fusion cage and/or bone cement. In such embodiments, the bone stabilization and distraction apparatus can stabilize one or more bones and/or maintain a distraction between one or more bones while the bone fusion process takes place. The bone stabilization and distraction apparatus and methods described herein can include a bone distraction tool, for example, to define an initial and/or final distraction between one or more bones prior to or during installation of a bone stabilization and distraction apparatus.

[1046] FIG. 7 is a schematic block diagram of a flexible elongate body 140 (also referred to herein as “flexible band” or simply “band”) and a support member 120, according to an embodiment. The band 140 includes at least a body portion 145, a distal end portion 148, and an attachment connection 150 (alternatively referred to herein as “fastener mechanism”). The band 140 can be formed from any suitable biocompatible material such as, for example, stainless steel, titanium, polyether ether ketone (PEEK), nylon, or the like. Moreover, the band 140 can be any suitable shape, size, or configuration. In some embodiments, the size or shape of the band 140 can be associated with an intended usage. For example, in some embodiments, a first band can be intended to stabilize and/or fixate one or more cervical vertebra and a second band can be intended to stabilize and/or fixate one or more lumbar vertebra. In this manner, the first band can have a first size that is substantially smaller than a second size of the second band. In other embodiments, the size and shape need not be associated with an intended usage.

[1047] The fastener mechanism 150 is configured to accept at least a portion of distal end portion 148 and/or the body portion 145, as further described herein. The fastener mechanism 150 is disposed at a proximal end of the band 140. In some embodiments, the

fastener mechanism 150 defines a lumen (not shown in FIG. 7) configured to accept at least a portion of distal end portion 148 and/or the body portion 145. In some embodiments, the lumen of fastener mechanism 150 can have a cross-sectional area that is significantly smaller than a cross-sectional area of at least a portion of the body portion 145. In this manner, the portion of the body portion 145 can be prevented from advancing through fastener mechanism 150. In some embodiments, the fastener mechanism 150 can include a ratchet (not shown in FIG. 7) configured to engage a surface of the distal end portion 148 and/or the body portion 145. In this manner, the fastener mechanism 150 can be configured to allow the distal end portion 148 and/or the body portion 145 to advance through fastener mechanism 150 in a first direction and substantially limit the movement of the distal end portion 148 and/or the body portion 145 in a second direction, opposite the first direction.

[1048] The body portion 145 is an elongate that extends from a portion of the fastener mechanism 150. More specifically, the body portion 145 of the band 140 can be monolithically (or unitarily) formed with the fastener mechanism 150 such that the body portion 145 is a linear portion between the fastener mechanism 150 and the distal end portion 148. In other embodiments, the body portion 145 can be formed separately from and coupled to the fastener mechanism 150 in any suitable manner (e.g., coupled via an adhesive, a weld, a friction fit, a threaded fit, or the like). The body portion 145 can be any suitable configuration. For example, in some embodiments, the body portion 145 can have a cross-sectional shape that is polygonal (e.g., square, rectangular, trapezoidal, etc.) or oval (e.g., circular, elliptical, oblong, etc.). In some embodiments, the cross-sectional shape of the body portion 145 can be associated with one or more characteristics of the bone or bone portion against which the body portion 145 may contact. For example, while the body portion 145 can have a substantially square cross-sectional shape, a set of edges of the body portion 145 can be rounded, partially rounded, and/or otherwise shaped to compliment the shape of a bone or bone portion, and/or to reduce digging or grinding into the bone or bone portion. In this manner, use of band 140 can cause little or no damage to the bone or bone portions contacted by band 140.

[1049] In some embodiments, the body portion 145 can define a substantially uniform cross-sectional area along a longitudinal axis (e.g., a centerline) of the band 140. In other embodiments, the cross-sectional area of the body portion 145 can vary along the longitudinal axis (centerline) of the band 140. For example, in some embodiments, the body portion 145

can have a cross-sectional area that is substantially tapered (i.e., reduced) from a proximal end (e.g., adjacent the fastener mechanism 150) to a distal end (e.g., adjacent the distal end portion 148). In some embodiments, the cross-sectional area of the body portion 145 can be associated with or complementarily fit with the cross-sectional area of the lumen defined by the fastener mechanism 150 (the attachment connection 150 described above). In this manner, at least a portion of the body portion 145 can have a cross-sectional area that is sufficiently small such that the body portion 145 can be at least partially disposed within the lumen of the fastener mechanism 150.

[1050] The body portion 145 can be configured to include a gear rack (not shown in FIG. 7) configured to engage the ratchet (not shown in FIG. 7) of the fastener mechanism 150. As described above, the gear rack can be configured to engage the ratchet of the fastening member 150 such that the ratchet allows the body portion 145 to travel through the fastener mechanism 150 in the first direction and substantially limits the movement of the body portion in the second direction, opposite the first direction. In some embodiments, the gear rack can be configured to include a set of individual gears that extend from a surface of the body portion 145. In other embodiments, the body portion 145 can define the set of individual gears (e.g., the gears each include a top surface that is disposed at or below a surface of the body portion 145). The gears included in the set of gears can be any suitable shape, size, or configuration. For example, in some embodiments, the gears are substantially cubed. In other embodiments, the gears can be triangular such that the gears form, for example, teeth. In this manner, the gears included in the gear rack can be configured to engage the ratchet of the fastener mechanism 150, as described above.

[1051] The distal end portion 148 is configured to extend from the body portion 145 of the band 140. More specifically, the distal end portion 148 is disposed adjacent the distal end of the body portion 145 such that the body portion 145 is disposed between the distal end portion 148 and the fastener portion 150. In some embodiments, the distal end portion 148 can have a cross-sectional area that is substantially similar to the cross-sectional area of the body portion 145. In other embodiments, the distal end portion 148 can have a cross-sectional area that is substantially smaller than the cross-sectional area of the body portion 145. In such embodiments, the distal end portion 148 and the body portion 145 can collectively define a discontinuity defining a stepwise reduction in the cross-sectional area. In other embodiments, the body portion 145 and/or the distal end portion 148 can define a

tapered portion such that the band 140 is tapered between smaller cross-sectional area of the distal end portion 148 and the larger cross-sectional area of the body portion 145.

[1052] While not shown in FIG. 7, in some embodiments, the distal end portion 148 can include a gear rack that is substantially similar to the gear rack of the body portion 145. In this manner, the gear rack can extend substantially continuously across a portion of the distal end portion 148 and a portion of the body portion 145. In other embodiments, the distal end portion 148 of the band 140 does not include or define a gear rack.

[1053] The support member 120 includes a first portion 122 and a second portion 135. The support member 120 can be formed from any suitable biocompatible material such as, for example, stainless steel, titanium, polyether ether ketone (PEEK), nylon, or the like. The first portion 122 can include an aperture (not shown in FIG. 7) that is configured to receive the distal end portion 148 of band 140. In such embodiments, a proximal end portion of the first portion 122 can define the aperture.

[1054] The second portion 135 is configured to be coupled to a bone portion. In some embodiments, the second portion 135 can be substantially similar to the first portion 122 and can include an aperture that is configured to receive a distal end portion of a second band 140 (not shown in FIG. 7) that is configured to surround a bone portion. The second portion 135 can include a fixation portion and can be configured to be coupled to a bone portion. In such embodiments, the fixation portion of the second portion 135 can include a screw, such as for example, a bone screw.

[1055] In some embodiments, the support member 120 can include a third portion (not shown in FIG. 7) configured to couple the first portion 122 to the second portion 135. In such embodiments, a distal end portion of the first portion 122 can define a coupler portion configured to secure the first portion 122 to the third portion. In such embodiments, the coupler portion can include a threaded portion and a screw portion. In some embodiments, the second portion 135 can be coupled directly to the first portion 122 (see, e.g., FIG. 12A).

[1056] In use, the band 140 and the support member 120 can stabilize a first vertebra and/or a second vertebra, and/or can be configured to define a distraction between the first vertebra and the second vertebra. In some uses, the band 140 and the support member 120 can stabilize the first vertebra to a second vertebra by securing an articular process of the first vertebra to an articular process of a second vertebra by securing a facet of the articular

process of the first vertebra with a facet of the articular process of the second vertebra (see, e.g., FIG. 10A). In some other uses, the band 140 and the support member 120 can stabilize the first vertebra to a second vertebra by securing an articular process of the first vertebra to a transverse process of a second vertebra by securing a facet of the articular process of the first vertebra with a facet of the transverse process of the second vertebra (see, e.g., FIGS. 11A and 13A). In yet some other uses, the band 140 and the support member 120 can stabilize the first vertebra to a second vertebra by securing an articular process of the first vertebra to at least one of an articular process of the second vertebra, a transverse process of the first vertebra, or to a transverse process of a second vertebra by securing a facet of the articular process of the first vertebra to at least one of a facet of the articular process of the second vertebra, a facet of the transverse process of the first vertebra, or a facet of the transverse process of the second vertebra (see, e.g., FIG. 12A). In some other uses, the band 140 and the support member 120 can stabilize the first vertebra to a second vertebra by securing a transverse process of the first vertebra to a transverse process of a second vertebra by securing a facet of the transverse process of the first vertebra with a facet of the transverse process of the second vertebra (see, e.g., FIGS. 14A and 15A).

[1057] For example, the band 140 can be placed into a suitable position relative to the first vertebra and/or the second vertebra, and the distal end portion 148 of the band can be inserted into the lumen of the fastener member 150 such that the body portion 145 substantially encircles at least a portion of the first vertebra and/or the second vertebra. Similarly stated, the distal end portion 148 can be inserted in to the lumen of the fastener mechanism 150 such that the band 140 forms a loop about a process of the first vertebra and/or a process of the second vertebra. In this manner, the distal end portion 148 and/or the body portion 145 can be advanced through the lumen of the fastener mechanism 150 such that the volume disposed within the loop formed by the band 140 is reduced. Thus, the band 140 exerts a compressive force on the articular process of the first vertebra and the articular process of the second process.

[1058] In some instances, with the band 140 at least partially tightened and/or fully tightened, a fixation portion of the second portion 135 of the support member 120 can be fixed to a bone portion, for example a transverse process of a vertebra. In some instances, fixing the second portion 135 to a bone portion can include advancing a fastener, for example a screw, through the fixation portion and into the bone portion. In some instances, with the

band 140 at least partially tightened and/or fully tightened, a distal end portion of a second band (not shown in FIG. 7) can be disposed through an aperture (not shown in FIG. 7) of the second portion 135 of the support member 120, and the distal end portion of the second band can be secured to a bone portion as described above with reference to band 140.

[1059] In some embodiments, a third portion (not shown in FIG. 7) of the support member 120 can be disposed between the first portion 122 and the second portion 135. In such embodiments, the first portion 122 can be coupled to the third portion at a first point along a length of the third portion, and the second portion 135 can be coupled to the third portion at a second point along the length of the third portion. The first point and the second point can be spaced apart to define a distraction between the first portion 122 and the second portion 135 to define a corresponding distraction between a first vertebra and a second vertebra. In this manner, the distance between the first point and the second point, e.g., the distance between the first portion 122 and the second portion 135, can be increased (or decreased) to increase (or decrease) the distraction between the first vertebra and the second vertebra.

[1060] FIG. 8A is a side view and FIG. 8B is a top view of a flexible elongate body 240 (also referred to herein as “band”) according to an embodiment. The band 240 can be similar to the band 140 described above and can include similar components. For example, the band 240 includes an attachment connection 250 (also referred to herein as “fastener mechanism”) including a ratchet 262, a body portion 245 including a gear rack 247, and a distal end portion 248. Accordingly, components of the band 240 that are similar to corresponding components of the band 140 described above with reference to FIG. 7 are not described in further detail herein.

[1061] As shown in FIG. 8A, each gear 264 included in the gear rack 247 includes a cross sectional area that is rectangular in shape. Said another way, each gear 264 can be a rectangular protrusion configured to extend from a surface of the band 240 (e.g., the body portion and/or the distal end portion 248). The gear rack 247 is configured to engage the ratchet 262 of the fastener mechanism 250, as further described herein. The fastener mechanism 250 defines a lumen 266. The lumen 266 can be any suitable shape, size, or configuration. For example, as shown in FIG. 8B the lumen 266 can have a substantially circular cross-sectional area. The ratchet 262 extends from an inner surface of the fastener member 250 such that the ratchet 262 substantially reduces the size (e.g., the perimeter,

circumference, and/or cross-sectional area) of the lumen 266. In this manner, the ratchet 266 can engage the gear rack 247. More specifically, as described in detail with reference to FIG. 7, the distal end portion 248 can be inserted into the lumen 266 of the fastener mechanism 250 and advanced in a first direction such that the gear rack 247 of the distal end portion 248 engages the ratchet 262. In some embodiments, the distal end portion 248 can be advanced through the lumen 266 a sufficient distance such that a portion of the body portion 245 is disposed within the lumen 266. In such embodiments, a portion of the gear rack 247 disposed on (e.g., included in or defined by) the body portion 245 can engage the ratchet 262. In this manner, the arrangement of the ratchet 262 and the gear rack 247 can be such that the distal end portion 248 can be moved in the first direction, thereby tightening the band 240, and the distal end portion 248 can be prevented from moving in a second direction, opposite the first direction, thereby preventing the band 240 from loosening.

[1062] The band 240 can be used in any suitable procedure to stabilize and/or fixate a first bone portion to a second bone portion. For example, in some embodiments, the band 240 can be disposed about an articular process of a first vertebra and/or an articular process of a second vertebra. In this manner, the distal end portion 248 and/or the body portion 245 can be positioned within the lumen 266 of the fastener mechanism 250 such that the band 240 forms a loop of suitable tightness about the first vertebra and/or the second vertebra. The band 240 can be used in conjunction with any suitable support member configured to facilitate the stabilization, fixation and/or distraction of the first vertebra to the second vertebra.

[1063] In some embodiments, the band 240 can be used in any procedure described in or similar to those in U.S. Patent App. No. 12/859,009; filed August 18, 2010, and titled “Vertebral Facet Joint Drill and Method of Use” (referred to as “the ‘009 application”), the disclosure of which is incorporated herein by reference in its entirety. In some embodiments, the band 240 can be used in conjunction with a spacer such as those described in the ‘009 application. For example, the spacer can be implanted and deployed to restore the space between facets of a superior articular process of a first vertebra and an inferior articular process of an adjacent vertebra. The spacer can be implanted and deployed to help stabilize adjacent vertebrae with adhesives and/or to deliver a medication. For example, in some embodiments, the spacer can be at least temporarily maintained in a desired position via an adhesive while the band 240 is positioned relative to the first vertebra and/or second vertebra.

In some embodiments, an adhesive can be used in conjunction with the band 240 to stabilize and/or fixate the first vertebra to the second vertebra.

[1064] In some embodiments, the spacer can be, for example, substantially disc shaped. In other embodiments, the spacer can be other shapes, e.g., square, elliptical, or any other shape. The spacer can include a first side and a second side. The first side and/or the second side can be, for example, convex, concave, or flat. Said another way, the first side of the spacer can be concave, convex, or flat, and the second side of the spacer can be concave, convex, or flat, for example, the first side can be concave and the second side concave, the first side can be concave and the second side convex, etc. The spacer can include the same materials as band 140. In some embodiments, the spacer can include substances configured to release medication and/or increase the stability of a vertebra and/or band 140. As discussed above, the substances can include a medicine(s) and/or an adhesive(s).

[1065] FIGS. 9A - 9C illustrate a flexible elongate body 340 (also referred to herein as “band”) according to an embodiment. The band 340 can be similar to band 140 described above with reference to FIG. 7 and can include similar components. By way of example, band 340 includes a fastener mechanism 350, a body portion 345, and a distal end portion 348. As shown in FIGS. 9A-9C, the band 340 can be monolithically (or unitarily) constructed in an elongate shape and can have a substantially rectangular cross-sectional shape. More specifically, the band 340 can have a substantially rectangular shape including rounded edges configured to reduce digging or grinding into the bone or portion thereof. The fastener mechanism 350 defines a lumen 366 and includes ratchet 362. The body portion 345 includes a gear rack 347 having a set of gears 364. In this manner, the distal end portion 348 can be inserted into the lumen 366 of the fastener member 350 such that the gear rack 347 engages the ratchet 362, as described in detail above.

[1066] FIGS. 10A and 10B depict a bone stabilization and distraction apparatus, specifically a band 440, a band 440', a support member 420, and a support member 420' stabilizing a vertebra 4A of spinal column 2 with a vertebra 4B of spinal column 2, and defining a distraction between vertebra 4A and vertebra 4B. The bands 440, 440' can be similar to the band 140 described above and can include similar components. For example, the band 440 includes an attachment connection 450 (also referred to herein as “fastener mechanism”). Support members 420, 420' can be similar to the support member 120 described above and can include similar components.

[1067] As shown in FIGS. 10A and 10B, the band 440 can be used to stabilize a first vertebra 4A and a second vertebra 4B, and to define a distraction between the first vertebra 4A and a second vertebra 4B, via the spinous articular process SP4A (also referred to herein as “process SP4A”) of the first vertebra 4A and the spinous articular process SP4B (also referred to herein as “process SP4B”) of the second vertebra 4B. Specifically, a distal end portion (not shown) of the band 440 can be inserted into an aperture 424 of a first portion 422 of a support member 420, and the distal end portion of the band 440 can be inserted into the aperture 424’ of a first portion 422’ of a support member 420’. The fastener mechanism 450 can receive the distal end portion of the band 440 such that the body portion 445 forms a loop that substantially encircles the process SP4A of the first vertebra 4A. Similarly, a distal end portion (not shown) of the band 440’ can be inserted into an aperture 436 of a second portion 435 of the first support member 420 and the distal end portion of the band 440’ can be inserted into the aperture 436’ of the second portion 435’ of the support member 420’. The fastener mechanism 450’ can receive the distal end portion (not shown) of the band 440’ such that the body portion 445’ forms a loop that substantially encircles the process SP4B of the second vertebra 4B, (as described in detail above).

[1068] A third portion 430 of first support member 420 can be disposed between first portion 422 and second portion 435. The third portion 430 can be coupled to a coupler portion 426 of first portion 420 at point P1 and can be coupled to a coupler portion 437 of second portion 435 at P2. Similarly a third portion 430’ of support member 420’ can be disposed between first portion 422’ and second portion 435’. The third portion 430’ can be coupled to a coupler portion 426’ of first portion 422’ at point P1’ (not labeled in FIG. 10A) and can be coupled to a coupler portion 437’ of second portion 435’ at point P2’ (not labeled in FIG. 10A). A length L1 between point P1 and point P2, along with a length L1’ between point P1’ and point P2’, can define a distraction between vertebra 4A and vertebra 4B.

[1069] For example, support member 420 and support member 420’ are rigid structures that maintain a distraction by pushing on band 440 and band 440’, which are fixedly coupled to process SP4A and process SP4B. Specifically, first portion 422 and first portion 422’ can push, in a first direction, on band 440, which is fixedly coupled to process SP4A. Similarly, second portion 435 and second portion 435’ can push, in a second direction opposite the first direction, on band 440’, which is fixedly coupled to process SP4B.

[1070] FIGS. 11A and 11B depict a bone stabilization and distraction apparatus, specifically a band 540, a support member 520, and a support member 520' stabilizing a vertebra 4A of spinal column 2 with a vertebra 4B of spinal column 2, and defining a distraction between vertebra 4A and vertebra 4B. The band 540 can be similar to the band 140 described above and can include similar components, and support members 520, 520' can be similar to the support member 120 described above and can include similar components. For example, the band 540 includes an attachment connection 550 (also referred to herein as "fastener mechanism").

[1071] As shown in FIGS. 11A and 11B, the band 540, the support member 520 and the support member 520' can be used to stabilize a first vertebra 4A and a second vertebra 4B, and to define a distraction between the first vertebra 4A and a second vertebra 4B, via the spinous articular process SP4A (also referred to herein as "process SP4A") of the first vertebra 4A and the transverse articular process SP4B (also referred to herein as "process SP4B") of the second vertebra 4B. Specifically, a distal end portion (not shown) of the band 540 can be inserted into an aperture 524 of a first portion 522 of the support member 520, and the distal end portion of the band 540 can be inserted into the aperture 524' of the first portion 522' of the support member 520'. The fastener mechanism 550 can receive the distal end portion of the band 540 such that the body portion 545 forms a loop that substantially encircles the process SP4A of the first vertebra 4A. A fastener 539 can be advanced through a fixation portion 538 of second portion 535 of support member 520 and into transverse process TP4B. A fastener 539' can be advanced through a fixation portion 538' of second portion 535' of support member 520' and into transverse process TP4B'.

[1072] A third portion 530 of support member 520 can be disposed between first portion 520 and second portion 535. The third portion 530 can be coupled to a coupler portion 526 of first portion 520 at point P1 and can be coupled to a coupler portion 537 of second portion 535 at P2. Similarly a third portion 530' of support member 520' can be disposed between first portion 520' and second portion 535'. The third portion 530' can be coupled to a coupler portion 526' of first portion 520' at point P1' (not labeled in FIG. 10A) and can be coupled to a coupler portion 537' of second portion 535' at point P2' (not labeled in FIG. 10A). A length L between point P1 and point P2, along with a length L' (not labeled in FIG. 10A) between point P1' and point P2', can define a distraction between vertebra 4A and vertebra 4B.

[1073] For example, support member 520 and support member 520' are rigid structures that maintain a distraction by pushing on band 540 which is fixedly coupled to SP4A and processes TP4B, TP4B'. Specifically, first portion 522 and first portion 522' can push, in a first direction, on band 540, which is fixedly coupled to process SP4A. Similarly, second portion 535 and second portion 535' can push, in a second direction opposite the first direction, on process TP4B and process TP4B', respectively.

[1074] FIGS. 12A and 12B depict a bone stabilization and distraction apparatus, specifically a band 640, a support member 620, and a support member 620' stabilizing a vertebra 4A of spinal column 2 with a vertebra 4B of spinal column 2, and defining a distraction between vertebra 4A and vertebra 4B. The band 640 can be similar to the band 140 described above and can include similar components, and support members 620, 620' can be similar to the support member 120 described above and can include similar components. For example, the band 640 includes an attachment connection 650 (also referred to herein as "fastener mechanism"). As seen in FIGS. 12A and 12B, unlike support member 520 of FIGS. 11A and 11B, which includes a first portion 522, a second portion 535 and a third portion 530, the support member 620 includes a first portion 622, a second portion 635, a third portion 630, and a fourth portion 665. The fourth portion 665 can be similar to the second portion 635.

[1075] As shown in FIGS. 12A and 12B, the band 640, the support member 620, and the support member 620' can be used to stabilize a first vertebra 4A and a second vertebra 4B, and to define a distraction between the first vertebra 4A and a second vertebra 4B, via the spinous articular process SP4A (also referred to herein as "process SP4A") of the first vertebra 4A and the transverse articular processes TP4A, TP4A' (also referred to herein as "process TP4A" and "process TP4A'") of the first vertebra 4A, and via the spinous articular process SP4B (also referred to herein as "process SP4B") of the second vertebra 4B and the transverse articular processes TP4B, TP4B' (also referred to herein as "process TP4B" and "process TP4B'") of the second vertebra 4B. Specifically, a distal end portion (not shown) of the band 640 can be inserted into an aperture 624 of a first portion 622 of the support member 620, and the distal end portion of the band 640 can be inserted into the aperture (not shown in FIG. 12A) of the first portion 622' of the support member 620'. The fastener mechanism 650 can receive the distal end portion of the band 640 such that the body portion 645 forms a loop that substantially encircles the process SP4A and process SP4B. A fastener 639 can be

advanced through a fixation portion 638 of second portion 635 of support member 620 and into transverse process TP4B. A fastener 669 can be advanced through a fixation portion 668 of fourth portion 665 of support member 620 and into transverse process TP4A. A fastener (not shown in FIG. 12A) can be advanced through a fixation portion 638' of second portion 635' of support member 620' and into transverse process TP4B'. A fastener 669' can be advanced through a fixation portion 668' of fourth portion 665' of support member 620' and into transverse process TP4A.

[1076] A third portion 630 of support member 620 can be disposed through first portion 620 and between second portion 635 and fourth portion 665. The third portion 630 can be coupled to a coupler portion 626 of first portion 620, can be coupled to a coupler portion 637 of second portion 635 at P2, and can be coupled to a coupler portion 667 of fourth portion 665 at P1. Similarly a third portion 630' of support member 620' can be disposed through first portion 620' and between second portion 635' and fourth portion 665'. The third portion 630' can be coupled to a coupler portion 626' of first portion 620', can be coupled to a coupler portion 637' (not shown in FIG. 12A) of second portion 635' at P2' (not shown in FIG. 12A), and can be coupled to a coupler portion 667' (not shown in FIG. 12A) of fourth portion 665 at P1' (not shown in FIG. 12A). A length L1 between point P1 and point P2, along with a length L1' between point P1' and point P2', can define a distraction between vertebra 4A and vertebra 4B.

[1077] For example, support member 620 and support member 620' are rigid structures that maintain a distraction by pushing on processes TP4B, TP4B' and processes TP4A, TP4A'. Specifically, fourth portion 665 and fourth portion 665', which are fixedly coupled to second portion 635 and second portion 635', can push, in a first direction, on process TP4A and process TP4A', and second portion 635 and second portion 635' can push, in a second direction opposite the first direction, on process TP4B and process TP4B', respectively.

[1078] FIGS. 13A and 13B depict a bone stabilization and distraction apparatus, specifically a band 740 and a support member 720 stabilizing a vertebra 4A of spinal column 2 with a vertebra 4B of spinal column 2, and defining a distraction between vertebra 4A and vertebra 4B. The band 740 can be similar to the band 140 described above and can include similar components, and support member 720 can be similar to the support member 120

described above and can include similar components. For example, the band 740 includes an attachment connection 750 (also referred to herein as “fastener mechanism”).

[1079] As shown in FIGS. 13A and 13B, the band 740 and support member 720 can be used to stabilize a first vertebra 4A and a second vertebra 4B, and to define a distraction between the first vertebra 4A and the second vertebra 4B, via the spinous articular process SP4A (also referred to herein as “process SP4A”) of the first vertebra 4A and the transverse articular processes TP4B, TP4B’ (also referred to herein as “process TP4B” and “process TP4B’”) of the second vertebra 4B. Specifically, a distal end portion (not labeled) of the band 740 can be inserted into an aperture 724 of a first portion 722 of the support member 720. The fastener mechanism 750 can receive the distal end portion of the band 740 such that the body portion 745 forms a loop that substantially encircles the process SP4A of the first vertebra 4A. A fastener (not shown in FIG. 13A) can be advanced through a fixation portion 738 of second portion 735 of support member 720 and into transverse process TP4B. A fastener 769 can be advanced through a fixation portion 768 of fourth portion 765 of support member 720 and into transverse process TP4B’. In some embodiments, second portion 735 and/or second portion 735’ can be moved along a length of the first portion 722. In this manner, a location on processes TP4A and/or TP4B where second portion 735 and/or second portion 735’ are fixed can be adjusted.

[1080] For example, support member 720 is a rigid structure that maintains a distraction by pushing on processes TP4B, TP4B’. Specifically, second portion 635 and fourth portion 665’ can push, in a first direction, on process TP4B and process TP4B’. Similarly, portion 722 can push, in a second direction opposite the first direction, on process SP4B.

[1081] FIGS. 14A and 14B depict a bone stabilization and distraction apparatus, specifically a band 840, a band 840’, a band 840’’, a band 840’’’, a support member 820, and a support member 820’ stabilizing a vertebra 4A of spinal column 2 with a vertebra 4B of spinal column 2, and defining a distraction between vertebra 4A and vertebra 4B. The bands 840, 840’, 840’’, and 840’’’ can be similar to the band 140 described above and can include similar components, and support members 820, 820’ can be similar to the support member 120 described above and can include similar components. For example, the band 840 includes an attachment connection 850 (also referred to herein as “fastener mechanism”). As seen in FIGS. 14A and 14B, unlike support member 520 of FIGS. 11A and 11B, which

includes a first portion 522, a second portion 535 and a third portion 530, the support member 820 includes only a first portion 822.

[1082] As shown in FIGS. 14A and 14B, the bands 840, 840', 840'', and 840''' and the support members 820, 820' can be used to stabilize a first vertebra 4A and a second vertebra 4B, and to define a distraction between the first vertebra 4A and a second vertebra 4B, via the transverse articular processes TP4A, TP4A' (also referred to herein as “process TP4A” and “process TP4A'”) of the first vertebra 4A, and via the transverse articular processes TP4B, TP4B' (also referred to herein as “process TP4B” and “process TP4B'”) of the second vertebra 4B. Specifically, a distal end portion (not shown) of the band 840 can be inserted into an aperture 824 of a portion 822 of the support member 820, and a distal end portion of the band 840' can be inserted into the aperture 824 of the portion 822 of the support member 820. The fastener mechanism 850 can receive the distal end portion of the band 840 such that the body portion 845 forms a loop that substantially encircles the process TP4A. The fastener mechanism 850' can receive the distal end portion of the band 840' such that the body portion 845' forms a loop that substantially encircles the process TP4B. The process described above with reference to bands 840, 840', support member 820, and processes TP4A, TP4B can be similarly applied to bands 840'', 840''', support member 820', and processes TP4A', TP4B'.

[1083] As shown in FIGS. 14A and 14B, the distraction between vertebra 4A and vertebra 4B can correspond to a length of the first support member 820 and a length of the support member 820'. While not shown in FIGS. 14A and 14B, the length of one or both of support members 820, 820' can be adjustable (e.g., a single support member can be configured to have a variety of length) or selectable (e.g., a support member can be selected based on its length to provide a particular distraction), and the distraction can be changed depending on an adjusted length of one or both of support members 820, 820' or based on the selected length of one or both of support members 820, 820'.

[1084] FIGS. 15A and 15B depict bone stabilization and distraction apparatus, specifically a band 940, a band 940', a support member 920, and a support member 920' stabilizing a vertebra 4A of spinal column 2 with a vertebra 4B of spinal column 2, and defining a distraction between vertebra 4A and vertebra 4B. The bands 940, 940' can be similar to the band 140 described above and can include similar components, and support members 920, 920' can be similar to the support member 120 described above and can

include similar components. For example, the band 940 includes an attachment connection 950 (also referred to herein as “fastener mechanism”). As seen in FIGS. 15A and 15B, unlike support member 520 of FIGS. 11A and 11B, which includes a first portion 522 coupled to a second portion 535 via a third portion 530, the support member 920 includes a first portion 922 directly coupled to the a second portion 935.

[1085] As shown in FIGS. 15A and 15B, the bands 940, 940' and the support members 920, 920' can be used to stabilize a first vertebra 4A and a second vertebra 4B, and to define a distraction between the first vertebra 4A and a second vertebra 4B, via the transverse articular processes TP4A, TP4A' (also referred to herein as “process TP4A” and “process TP4A'”) of the first vertebra 4A, and via the transverse articular processes TP4B, TP4B' (also referred to herein as “process TP4B” and “process TP4B'”) of the second vertebra 4B. Specifically, a distal end portion (not shown) of the band 940 can be inserted into an aperture 924 of a portion 922 of the support member 920. The fastener mechanism 950 can receive the distal end portion of the band 940 such that the body portion 945 forms a loop that substantially encircles the process TP4A. A fastener 939 can be advanced through a fixation portion 938 of second portion 935 of support member 920 and into transverse process TP4B. The process described above with reference to bands 940 and support member 920, and processes TP4A, TP4B can be similarly applied to bands 940' and support member 920', and processes TP4A', TP4B'.

[1086] As shown in FIGS. 15A and 15B, the distraction between vertebra 4A and vertebra 4B can correspond to a length of the support member 920 and a length of the support member 920'. While not shown in FIGS. 15A and 15B, the length of one or both of support members 920, 920' can be adjustable (e.g., a single support member can be configured to have a variety of length) or selectable (e.g., a support member can be selected based on its length to provide a particular distraction), and the distraction can be changed depending on an adjusted length of one or both of support members 920, 920' or based on the selected length of one or both of support members 920, 920'.

[1087] FIG. 16 is a flowchart illustrating method 1090 of stabilizing a first bone portion to a second bone portion. The method 1090 includes disposing a flexible band through an aperture of a support member, at 1091. The support member has a fixation portion configured to secure the support member to a first bone portion. The method 1090 includes advancing a portion of the flexible band through an attachment portion of the flexible band

until the flexible band is secured to a second bone portion, at 1092. The method 1090 includes advancing a portion of the fixation portion of the support member into the first bone portion until the support member is secured to the first bone portion, at 1093. In some embodiments, the method 1090 can include disposing the flexible band through an aperture of a second support member. In such embodiments, the second support member can have a fixation portion configured to secure the second support member to a third bone portion. In such embodiments, the method can include advancing a portion of the fixation portion of the second support member into the third bone portion until the second support member is secured to the third bone portion. In some embodiments, the method 1090 can include adjusting a distance between a support portion of the support member and the fixation portion of the support member to define a distraction between the first bone portion and the second bone portion. In some embodiments, the method 1090 can include disposing the flexible band into contact with a fourth bone portion. In such embodiments, the method 1090 can include advancing the portion of the flexible band through the attachment portion of the flexible band includes advancing the portion of the flexible band through the attachment portion until the flexible band is secured to the second bone portion.

[1088] FIG. 17 is a flowchart illustrating method 1190 of stabilizing a first bone portion to a second bone portion. The method 1190 includes disposing a first flexible band through a first aperture of a support member, at 1191. The method 1190 includes disposing a second flexible band through a second aperture of the support member, at 1192. The method 1190 includes advancing a portion of the flexible band through an attachment portion of the first flexible band until the first flexible band is secured to a bone portion, at 1193. The method 1190 includes advancing a portion of the flexible band through an attachment portion of the second flexible band until the second flexible band is secured to a second bone portion, at 1194. In some embodiments, the method 1190 can include disposing a third flexible band through a first aperture of a second support member. In such embodiments, the method 1190 can include disposing a fourth flexible band through a second aperture of the second support member. In such embodiments, the method 1190 can include advancing a portion of the third flexible band through an attachment portion of the third flexible band until the third flexible band is secured to a third bone portion. In such embodiments, the method 1190 can include advancing a portion of the fourth flexible band through an attachment portion of the fourth flexible band until the fourth flexible band is secured to a fourth bone portion. In some embodiments, the support member can have a length that is adjustable, and the method 1190

can includes adjusting the length of the support member to define a distraction between the first bone portion and the second bone portion.

[1089] Any of the embodiments, described above can be packaged independently or in any suitable combination. For example, in some embodiments, a kit can include at least flexible elongate body (e.g., a band) and a support member. For example, the band can be similar to or the same as the bands 140-940. In this manner, the flexible band is configured to stabilize, and or define a distraction between, a first bone portion and/or a second bone portion. The support member can include an interface portion configured to receive at least a portion of the flexible band. For example, the support member can be similar to or the same as support members 120-920. In this manner the support member is configured to stabilize, and or define a distraction between, a first bone portion and/or a second bone portion. The support member can includes a fixation portion configured to secure the support member to a second bone portion such that the first bone portion and the second bone portion are stabilized. In some embodiments, the kit can include additional bands and/or support members according to any of the embodiments described herein.

[1090] While various embodiments have been described above, it should be understood that they have been presented by way of example only, not limitation, and various changes in form and details may be made. For example, while the embodiments are illustrated here as being disposed about a spinous articular process of a first vertebra and a spinous articular process of a second vertebra, in other embodiments, a flexible elongate body (e.g., a band) can be disposed about another portion of one or more vertebra. In such embodiments, the band can be tightened about the vertebrae to offset or correct misalignment of a portion of the spine (e.g., scoliosis, or the like).

[1091] While the descriptions given are with reference to stabilizing vertebra, another bone(s) such as for example, a sternum and/or a rib(s) could be stabilized using the flexible fastening bands described herein. In another example, a flexible fastening band can be used to stabilize and/or fixate an intramedullary (IM) rod or nail. For example, the flexible fastening band can be used at different longitudinal locations along an IM rod or nail, and used to couple adjacent bone portions to the IM rod or nail. In such situations, a given flexible fastening band can fix a first bone portion, the IM rod or nail, and a second bone portion, all of which are positioned between the distal portion and the attachment connection of the flexible fastening band. In yet another example, a flexible fastening band can be used

to stabilize and/or fixate a bone fragment. While various embodiments have been described above with regard to natural bone spaces, (e.g., the space between an inferior articulate process and a superior articulate process), in other embodiments, the bone spacing can be man-made (e.g., sternum split during a heart procedure), and/or due to an injury (e.g., broken bone).

[1092] Where methods described above indicate certain events occurring in certain order, the ordering of certain events can be modified. Additionally, certain of the events can be performed concurrently in a parallel process when possible, as well as performed sequentially as described above. For example, while the method 1090 described above includes advancing a portion of the band into the attachment connection prior to advancing the a portion of the fixation portion, in some embodiments, the portion of the fixation portion can be at least partially advanced into a bone portion prior to the portion of the band being advanced through the attachment portion. In some embodiments, at least a portion of the advancing of the portion of the fixation portion into the bone portion and at least a portion of the advancing of the portion of the band into the attachment connection can be done concurrently (e.g., simultaneously or alternatively in relatively small increments).

[1093] Any portion of the apparatus and/or methods described herein may be combined in any combination, except mutually exclusive combinations. The embodiments described herein can include various combinations and/or sub-combinations of the functions, components and/or features of the different embodiments described.

[1094] Throughout this specification and the claims which follow, unless the context requires otherwise, the word "comprise", and variations such as "comprises" and "comprising", will be understood to imply the inclusion of a stated integer or step or group of integers or steps but not the exclusion of any other integer or step or group of integers or steps.

[1095] The reference in this specification to any prior publication (or information derived from it), or to any matter which is known, is not, and should not be taken as an acknowledgment or admission or any form of suggestion that that prior publication (or information derived from it) or known matter forms part of the common general knowledge in the field of endeavour to which this specification relates.

THE CLAIMS DEFINING THE INVENTION ARE AS FOLLOWS:**1. An apparatus, comprising:**

a flexible elongate body comprising a distal end portion, a body portion, and a proximal end portion, the proximal end portion comprising an attachment portion that is configured to receive the distal end portion and the body portion to form a loop around a first vertebra, wherein the attachment portion is configured to permit movement of the body portion in a first direction but substantially limit the movement of the body portion in a second direction, wherein the attachment portion is monolithically formed with the flexible elongate body; and

a support member comprising:

a first portion comprising an aperture configured to receive the distal end portion and the body portion of the flexible elongate body, and further comprising a first coupler portion configured to be selectively adjusted to receive and secure a third portion;

a second portion comprising a fixation portion that is configured to be coupled to a second vertebra that is adjacent the first vertebra and a second coupler portion configured to be selectively adjusted to receive and secure the third portion; and

the third portion disposed between the first portion and the second portion;

wherein a distance between the coupler portion of the first portion and the fixation portion of the second portion defines a distraction distance between the first vertebra and the second, adjacent vertebra.

2. The apparatus of claim 1, wherein the flexible elongate body is a first flexible elongate body, the apparatus further comprising:

a second flexible elongate body comprising a distal end portion, a body portion, and an attachment portion that is configured to receive the distal end portion; and

the third portion having a length configured to define a distraction between the second vertebra and the first vertebra when the body portion of the first flexible elongate body surrounds the first vertebra and when the body portion of the second flexible elongate body surrounds the second vertebra.

3. The apparatus of claim 1 or claim 2, wherein the support member is a first support member, the apparatus further comprising a second support member comprising a first portion

that includes an aperture configured to receive the distal end portion of the flexible elongate body; and a second portion configured to be coupled to the second vertebra.

4. The apparatus of any one of claims 1 to 3, wherein the first portion of the support member is configured to be coupled to the third portion of the support member via a setscrew.

5. The apparatus of any one of claims 1 to 4, wherein the first portion and the second portion are separate components.

6. The apparatus of any one of claims 1 to 5, wherein the third portion is a rod.

7. The apparatus of any one of claims 1 to 6, wherein: the fixation portion of the second portion is a bone screw.

8. An apparatus, comprising:

a flexible elongate body comprising a distal end portion, a body portion, and a proximal end portion, the proximal end portion comprising an attachment portion that is configured to receive the distal end portion and the body portion when the body portion couples to a first vertebra, wherein the attachment portion is configured to permit movement of the body portion in a first direction but substantially limit the movement of the body portion in a second direction, wherein the attachment portion is monolithically formed with the flexible elongate body; and

a support member comprising:

an elongate member comprising a first end with an aperture configured to receive the distal end portion and the body portion of the flexible elongate body, and a second end comprising a first coupler portion configured to selectively receive an extension member;

a fixation portion comprising a second coupler portion configured to selectively receive the extension member, the fixation portion configured to secure the support member to a second vertebra that is adjacent the first vertebra; and

the extension member configured to be selectively coupled to the first coupler portion and to the second coupler portion;

wherein a distance between the first coupler portion of the elongate member and the second coupler portion of the fixation portion defines a distraction distance between the first vertebra and the second, adjacent vertebra.

9. The apparatus of claim 8, wherein the fixation portion of the support member is a first fixation portion, the support member further comprising a second fixation portion configured to secure the support member to the first vertebra.
10. The apparatus of claim 8 or claim 9, wherein the fixation portion includes a screw.
11. The apparatus of any one of claims 8 to 10, wherein the fixation portion is movable relative to the second coupler portion.
12. A kit, comprising:
a flexible band configured to be secured to a first vertebra, the flexible band comprising a distal end portion, a body portion, and a proximal end portion, the proximal end portion comprising an attachment portion that is configured to receive the distal end portion and the body portion to form a loop, wherein the attachment portion is configured to permit movement of the body portion in a first direction but substantially limit the movement of the body portion in a second direction, wherein the attachment portion is monolithically formed with the flexible band; and
a support member comprising:
an elongate member with a first end comprising an interface portion configured to receive at least a portion of the flexible band, and a second end comprising a coupler portion, the coupler portion having a locking mechanism configured to receive and secure an extension portion; and
a fixation portion selectively coupleable to the coupler portion via the extension portion, the fixation portion configured to secure the support member to a second vertebra that is adjacent the first vertebra, such that the first vertebra and the second vertebra are stabilized;
wherein a distance between the coupler portion of the elongate member and the fixation portion is adjustable by securing the extension portion at different points along the length of the extension portion to define a distraction distance between the first vertebra and the second, adjacent vertebra.
13. The kit of claim 12, wherein the support member is a first support member, the kit further comprising: a second support member having an interface portion configured to receive at least a portion of the flexible band, the second support member having a fixation portion configured to secure the second support member to the second vertebra such that the first vertebra is stabilized relative to the second vertebra.

14. The kit of claim 12 or claim 13, wherein the fixation portion includes a screw.
15. A method, comprising:
- forming a loop around a first vertebra with a flexible elongate body comprising a distal end portion, a body portion, and a proximal end portion, the proximal end portion comprising an attachment portion that receives the distal end portion and the body portion to form the loop, wherein the attachment portion permits movement of the body portion in a first direction but substantially limits the movement of the body portion in a second direction, wherein the attachment portion is monolithically formed with the flexible elongate body; and
 - positioning a support member comprising:
 - receiving the distal end portion and the body portion of the flexible elongate body within an aperture of a first portion of the support member;
 - selectively adjusting a first coupler portion of the first portion of the support member to receive and secure a third portion;
 - coupling a fixation portion of a second portion of the support member to a second vertebra that is adjacent the first vertebra;
 - selectively adjusting a second coupler portion of the second portion to receive and secure the third portion;
 - wherein the third portion is disposed between the first portion and the second portion;
 - wherein a distance between the first coupler portion of the first portion and the fixation portion of the second portion defines a distraction distance between the first vertebra and the second vertebra.
16. The method of claim 15, further comprising positioning a second flexible elongate body comprising a distal end portion, a body portion, and an attachment portion that receives the distal end portion, wherein the body portion of the second flexible elongate body surrounds the second vertebra.
17. The method of claim 15 or claim 16, further comprising positioning a second support member comprising: positioning a first portion of the second support member, which portion includes an aperture that receives the distal end portion of the flexible elongate body, and coupling a second portion of the second support member to the second vertebra.

18. A method, comprising:

coupling a flexible elongate body to a first vertebra, wherein the flexible elongate body comprises a distal end portion, a body portion, and a proximal end portion, wherein the proximal end portion comprises an attachment portion that receives the distal end portion and the body portion when the body portion couples to the first vertebra, wherein the attachment portion permits movement of the body portion in a first direction but substantially limits the movement of the body portion in a second direction, wherein the attachment portion is monolithically formed with the flexible elongate body; and

positioning a support member comprising:

receiving the distal end portion and the body portion of the flexible elongate body within an aperture of a first end of an elongate member,

selectively receiving and coupling an extension member with a first coupler portion of a second end of the elongate member;

selectively receiving and coupling the extension member with a second coupler portion of a fixation portion;

securing the support member to a second vertebra that is adjacent the first vertebra with the fixation portion; and

wherein a distance between the first coupler portion of the elongate member and the second coupler portion of the fixation portion defines a distraction distance between the first vertebra and the second, adjacent vertebra.

19. The method of claim 18, further comprising securing a second fixation portion of the support member to the first vertebra.

20. The method of claim 18 or claim 19, wherein the fixation portion is movable relative to the second coupler portion.

21. A method, comprising:

securing a flexible band to a first vertebra, the flexible band comprising a distal end portion, a body portion, and a proximal end portion, the proximal end portion comprising an attachment portion that receives the distal end portion and the body portion to form a loop, wherein the attachment portion permits movement of the body portion in a first direction but substantially limits the movement of the body portion in a second direction, wherein the attachment portion is monolithically formed with the flexible band; and

positioning a support member comprising:

receiving at least a portion of the flexible band with an interface portion of a first end of an elongate member, wherein the elongate member comprises a second end comprising a coupler portion, the coupler portion having a locking mechanism to receive and secure an extension portion; and

selectively coupling a fixation portion to the coupler portion via the extension portion, wherein the fixation portion secures the support member to a second vertebra that is adjacent the first vertebra;

wherein a distance between the coupler portion of the elongate member and the fixation portion is adjustable by securing the extension portion at different points along the length of the extension portion to define a distraction distance between the first vertebra and the second, adjacent vertebra.

22. The method of claim 21, further comprising positioning a second support member having an interface portion to receive at least a portion of the flexible band, the second support member having a fixation portion to secure the second support member to the second vertebra.

1/15

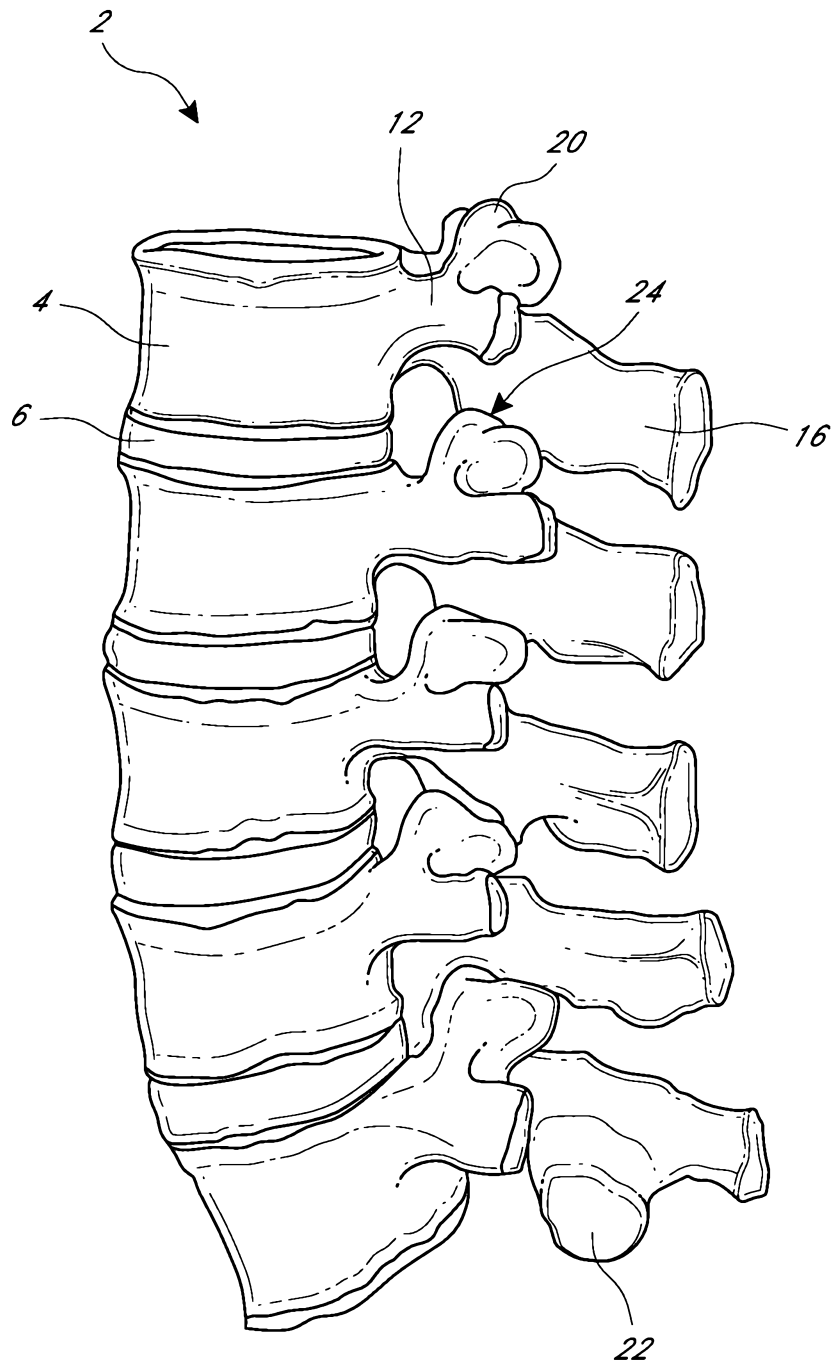
*FIG. 1*

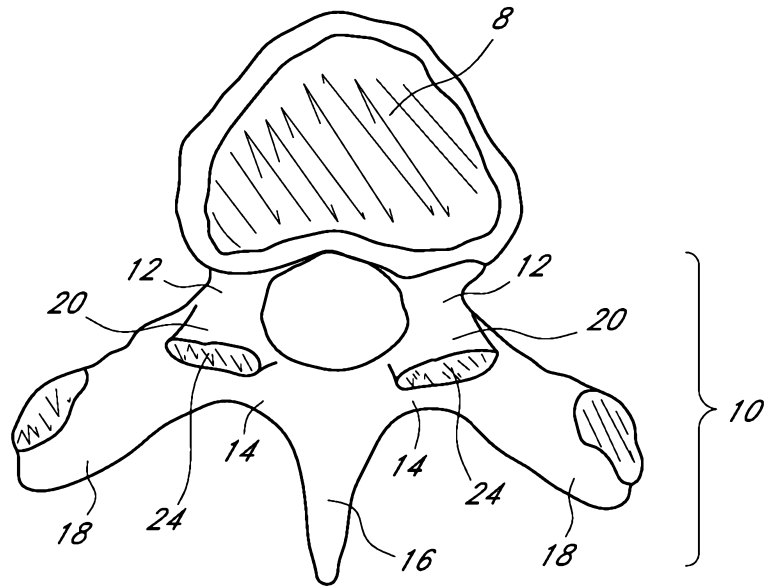

FIG. 2A

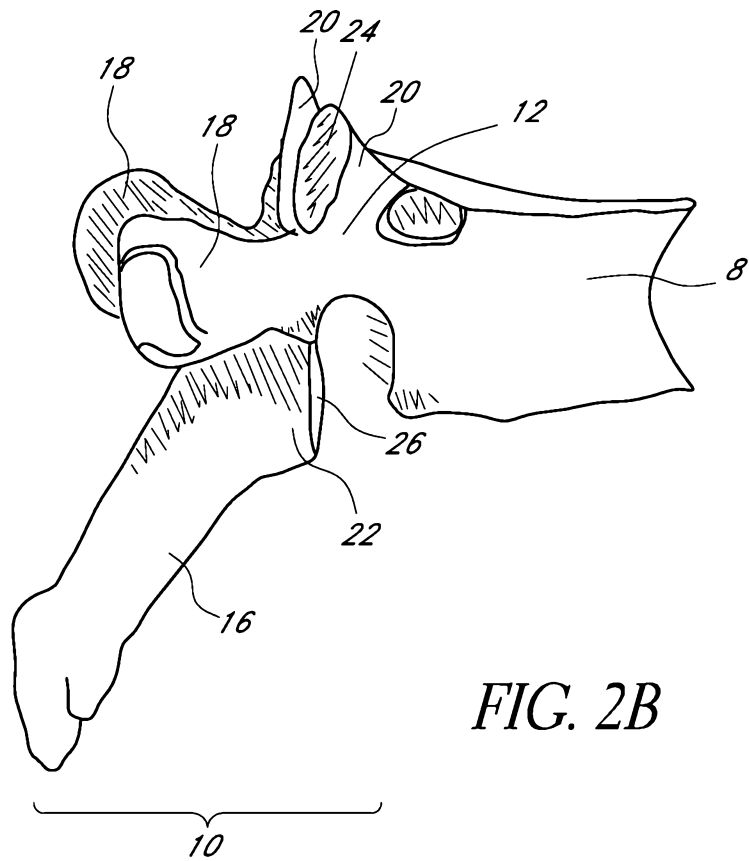
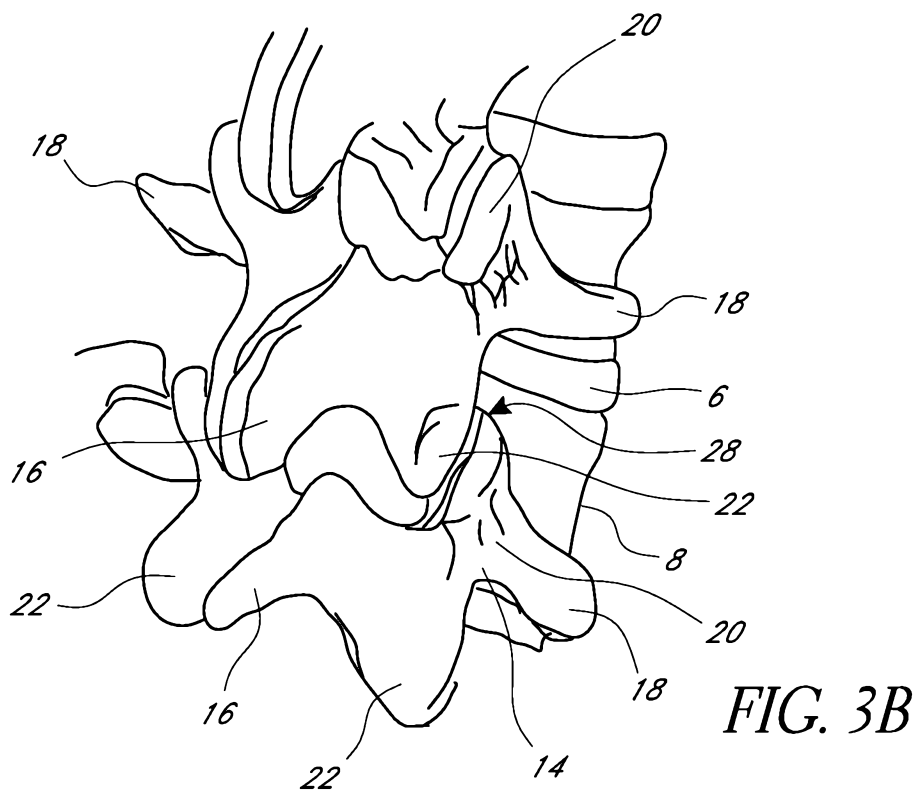
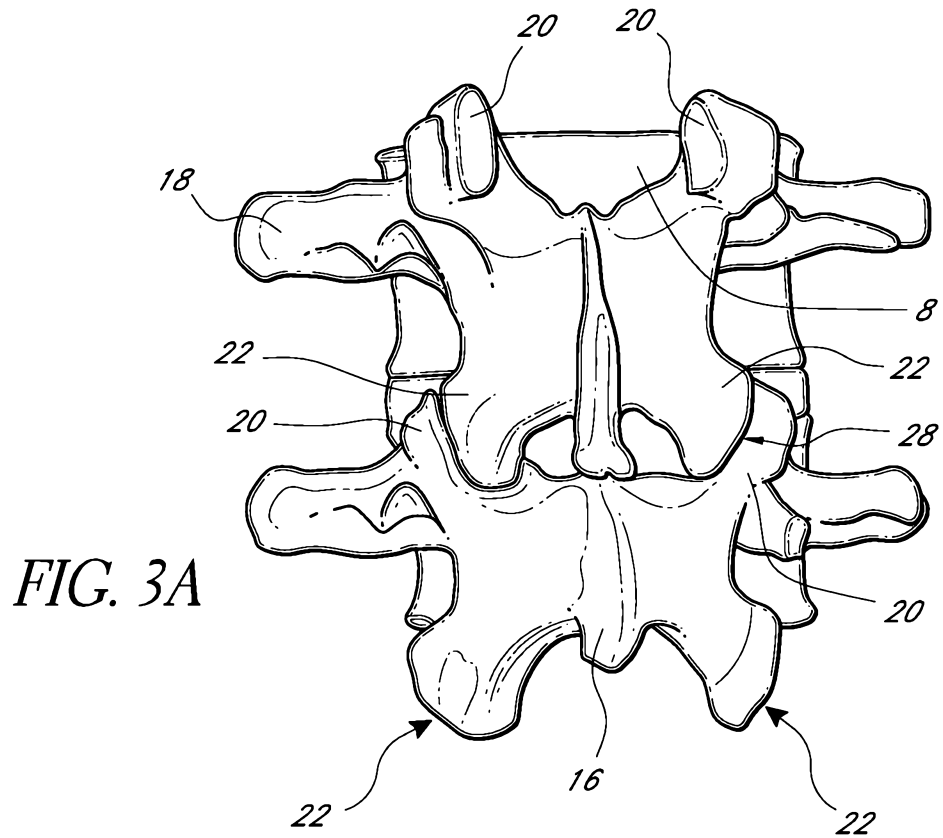

FIG. 2B

3/15



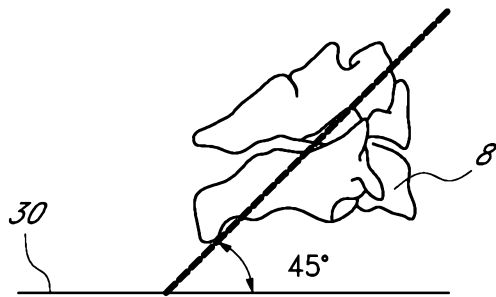

FIG. 4A

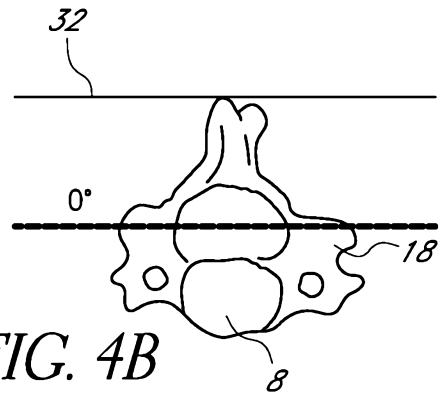

FIG. 4B

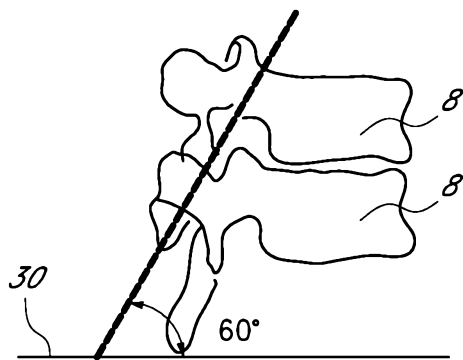

FIG. 5A

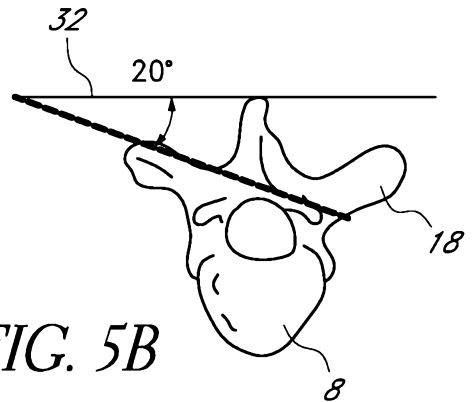

FIG. 5B

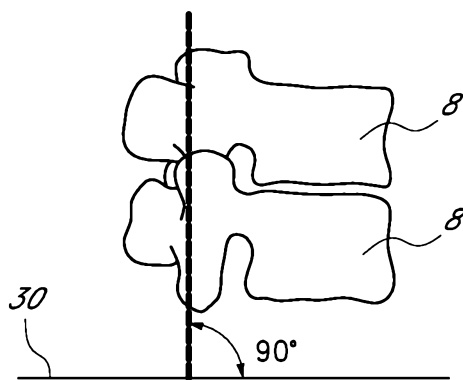

FIG. 6A

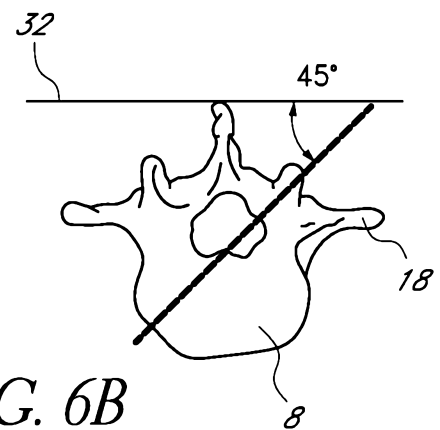
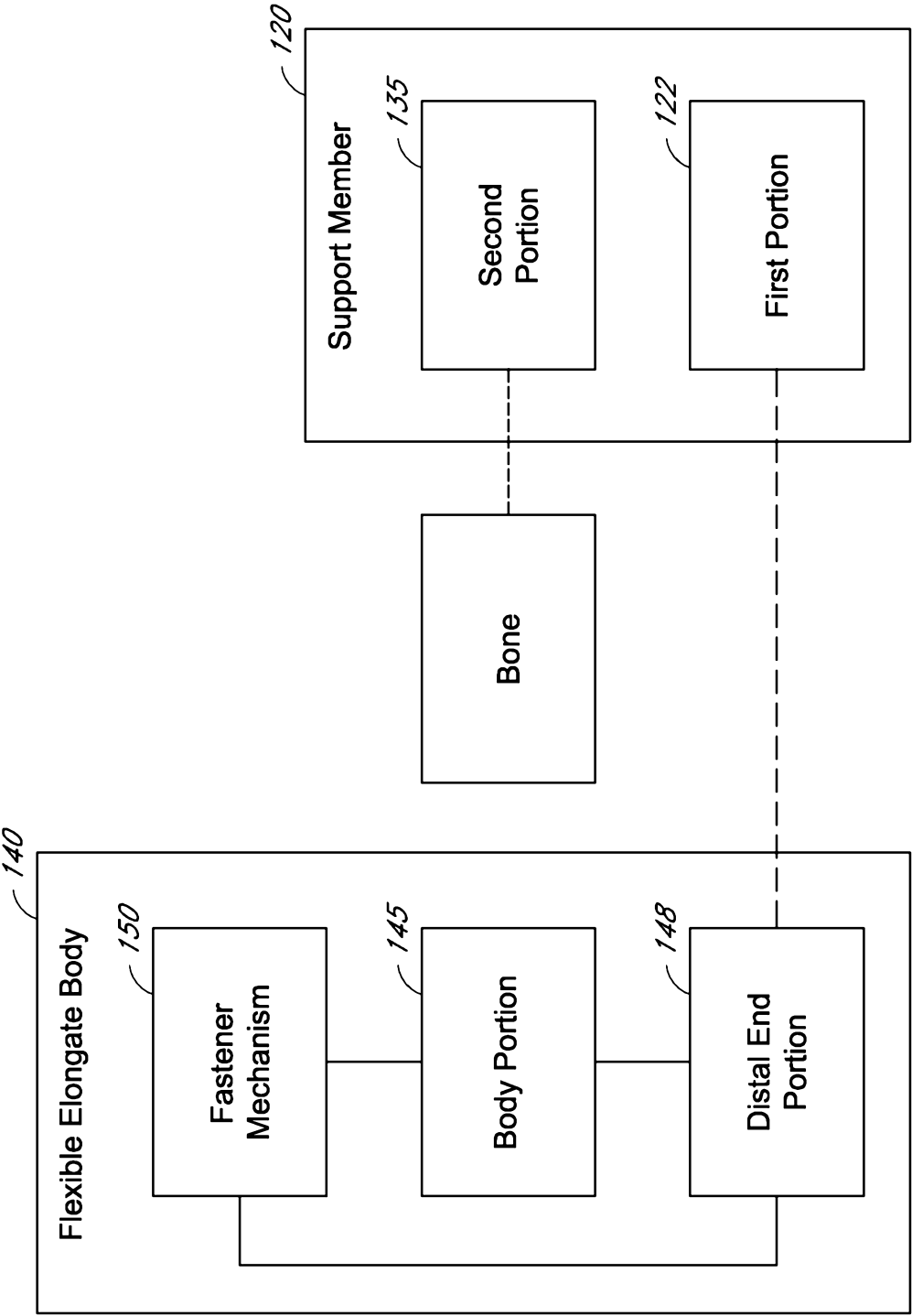
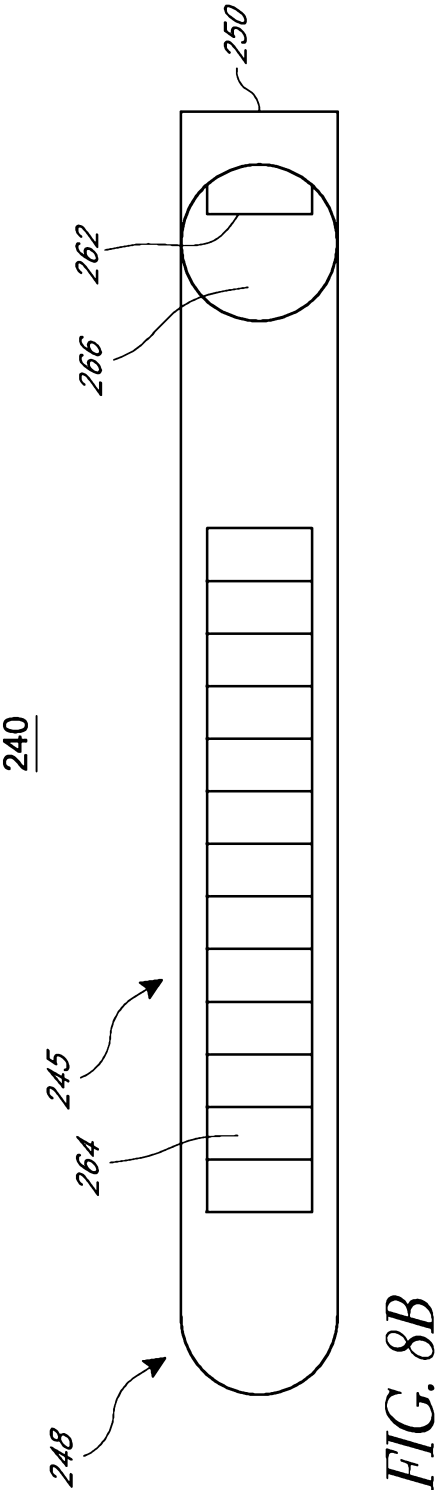
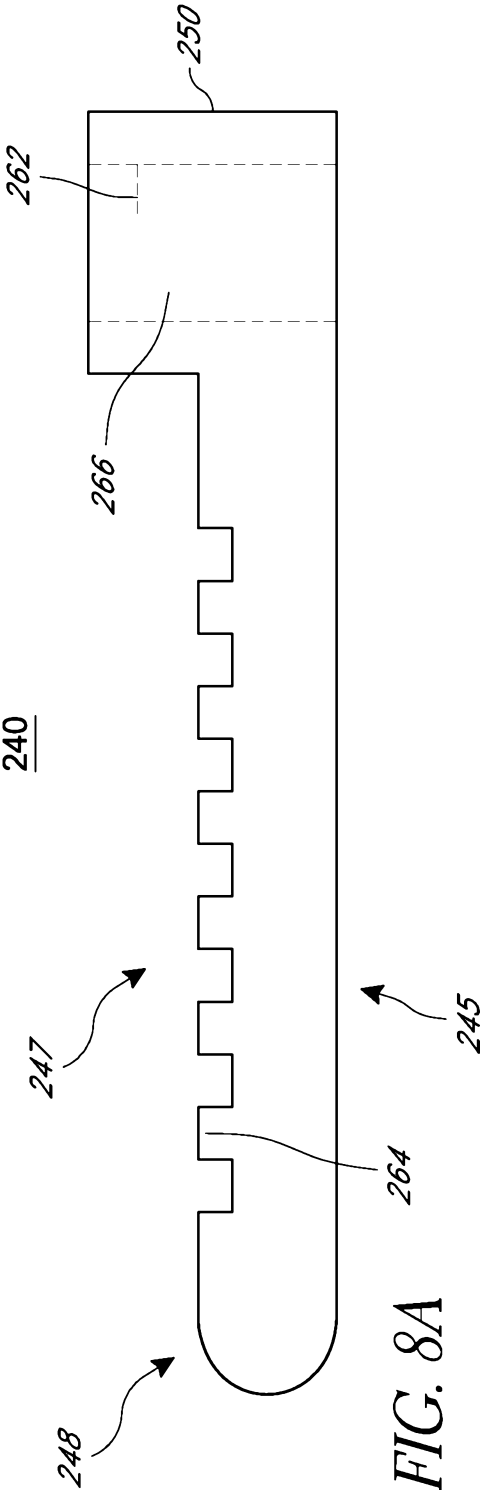
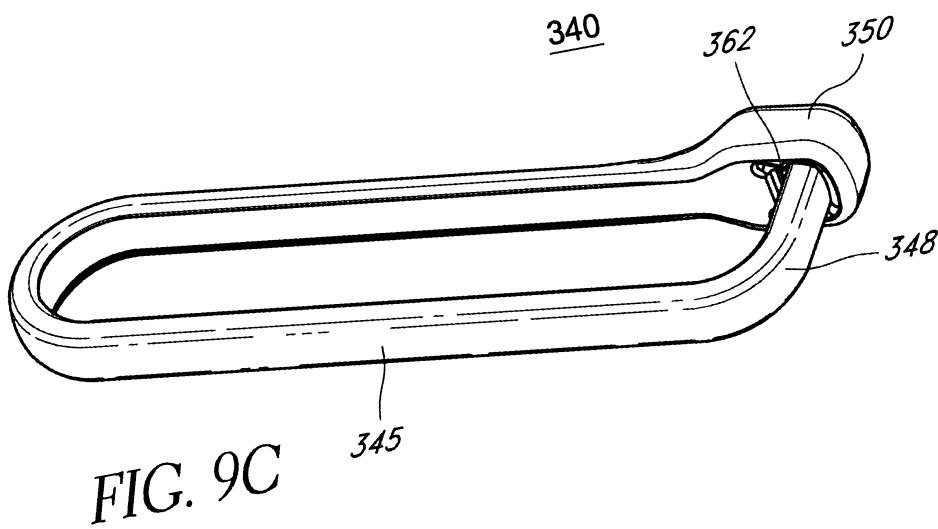
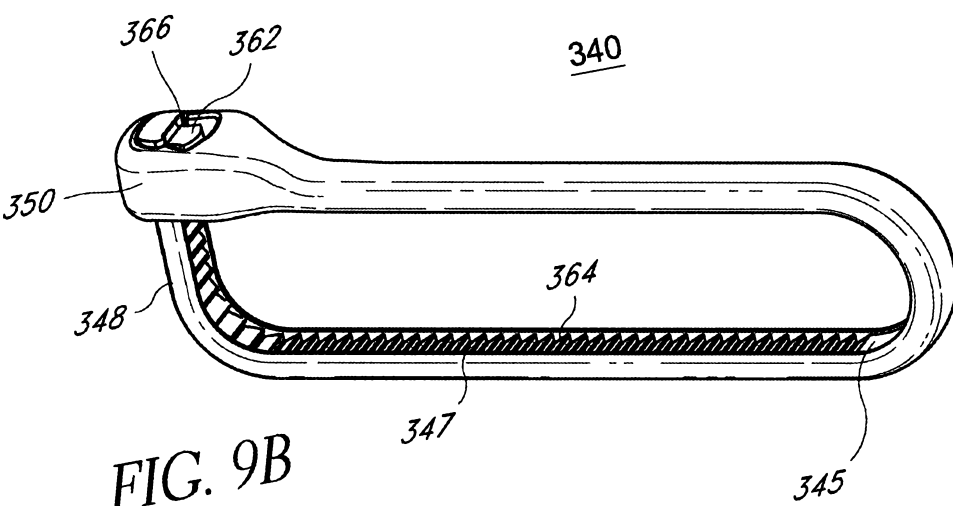
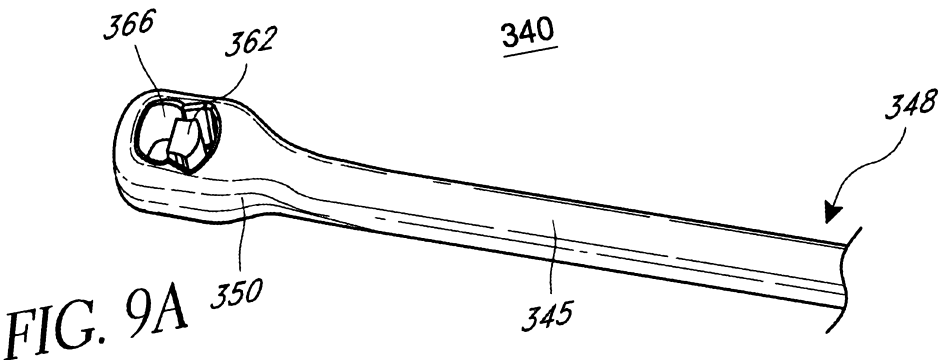

FIG. 6B

FIG. 7







8/15

FIG. 10A

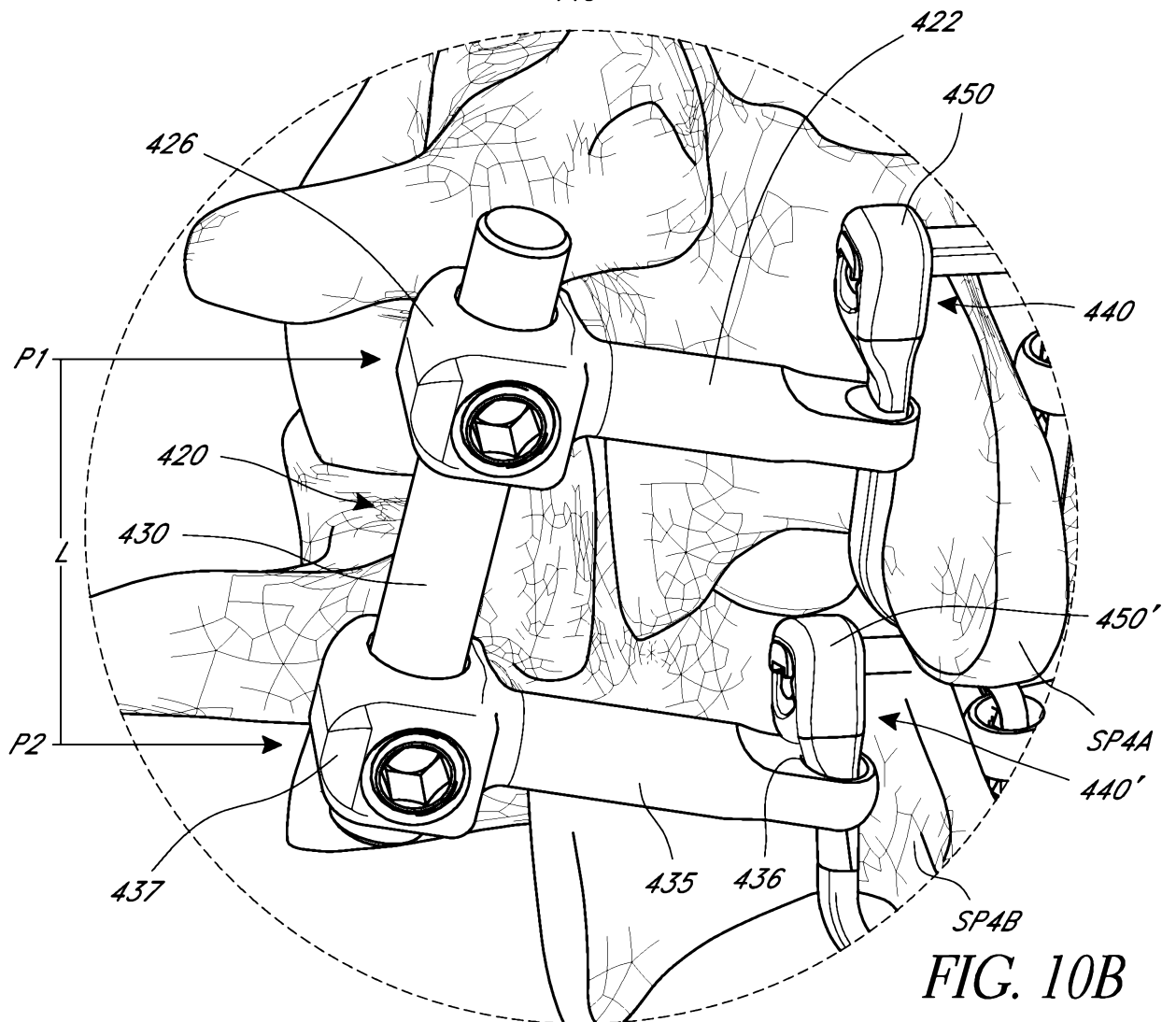
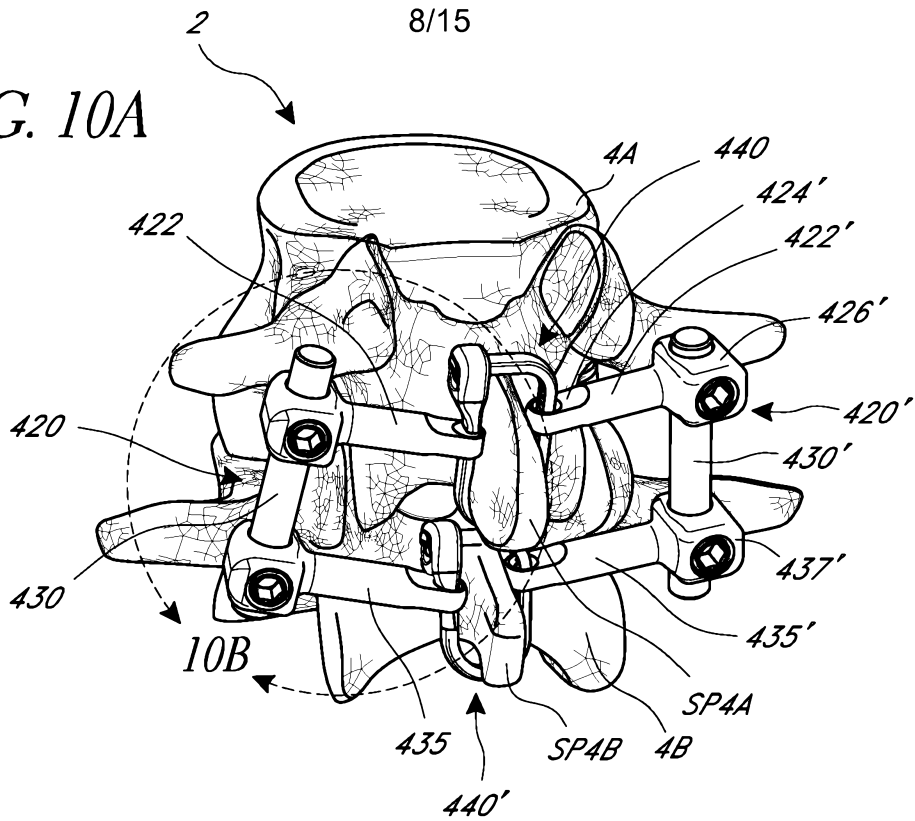

FIG. 10B

FIG. 11A

9/15

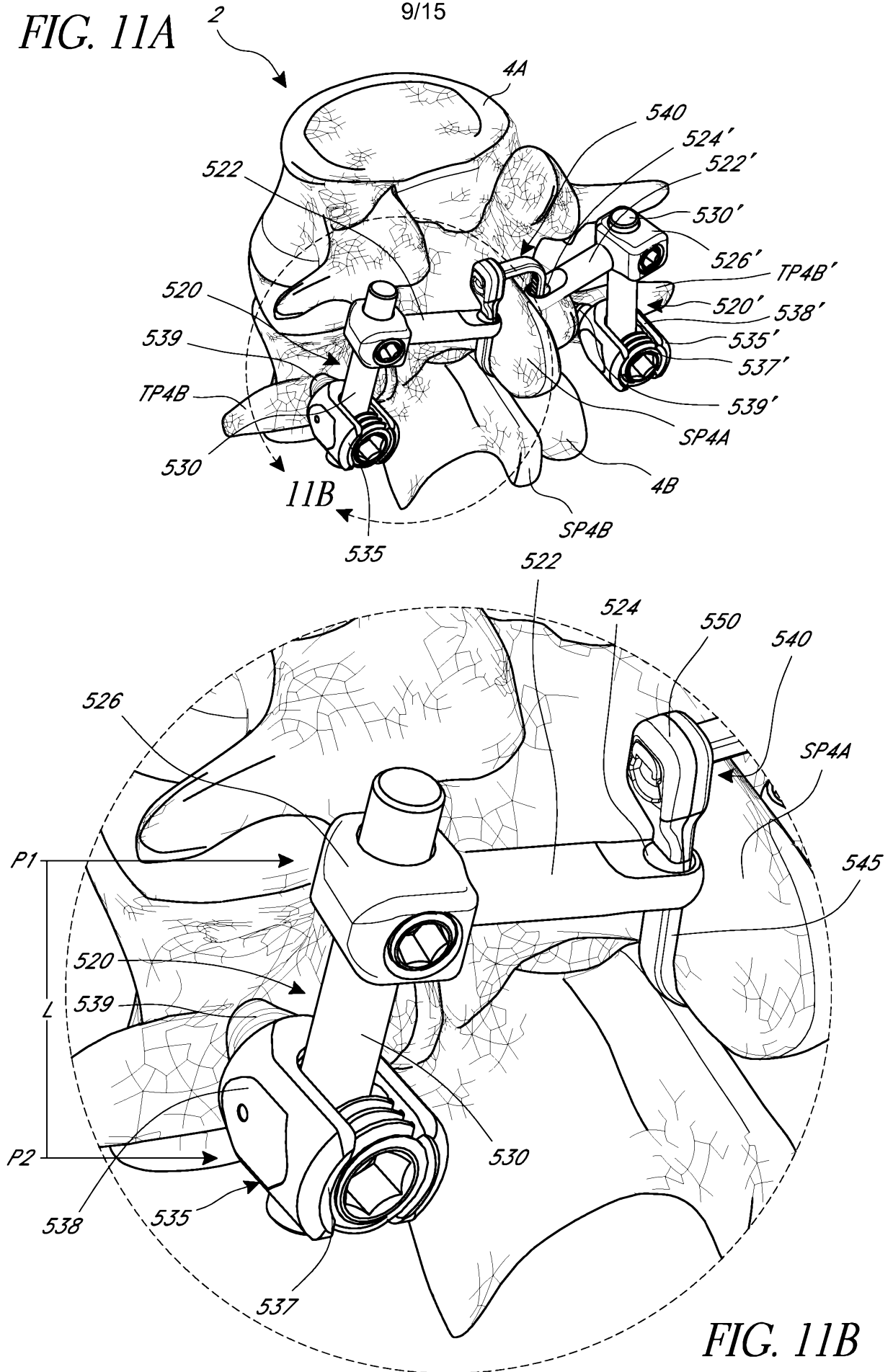

FIG. 11B

FIG. 12A

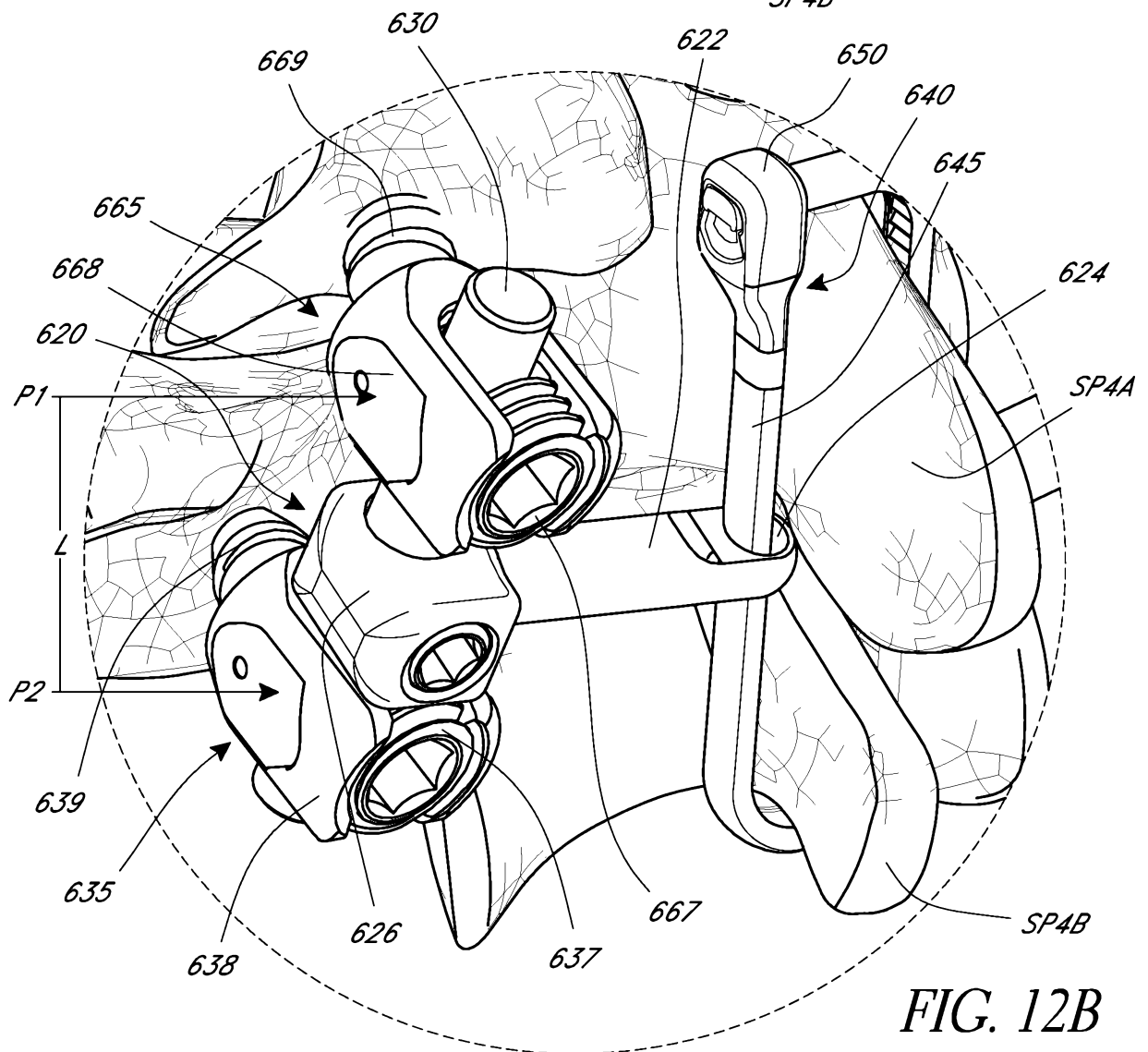
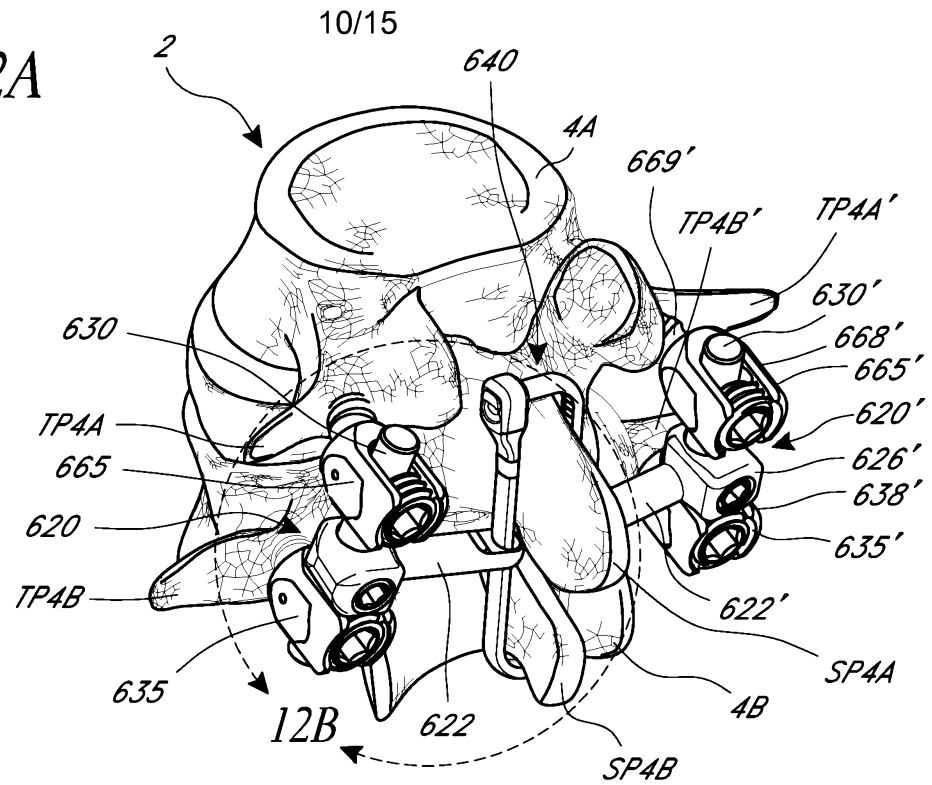
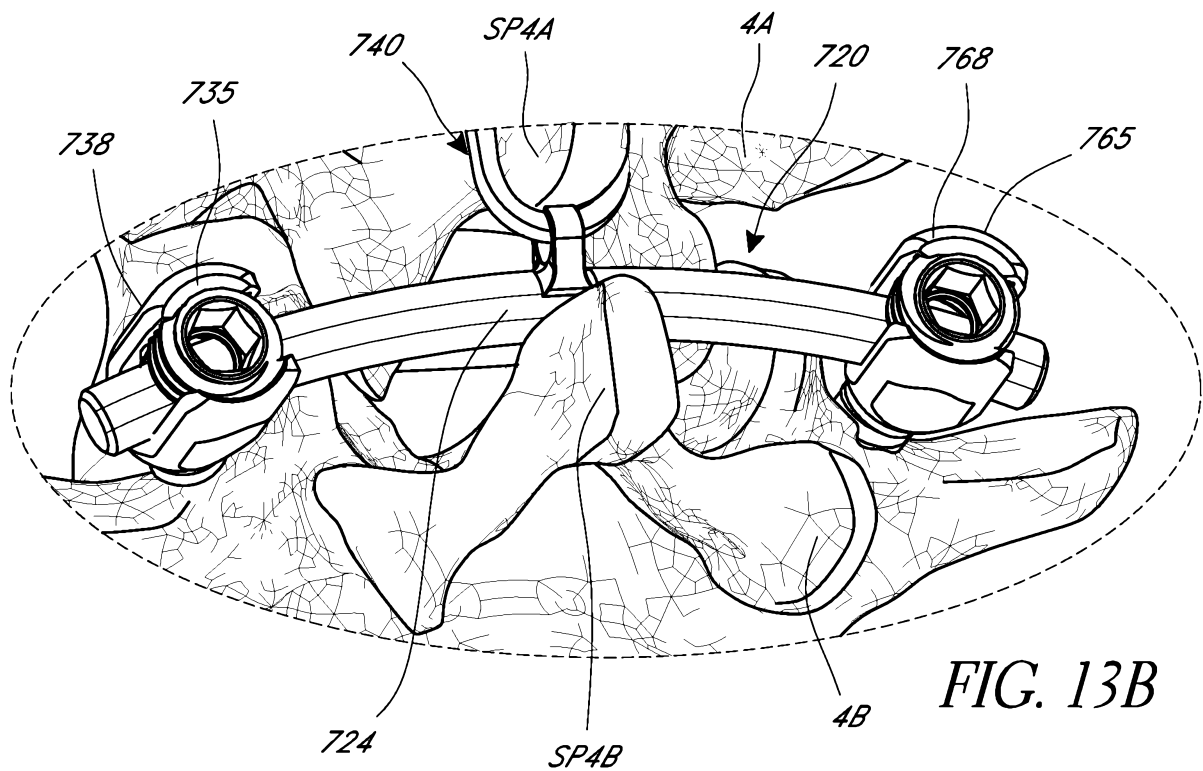
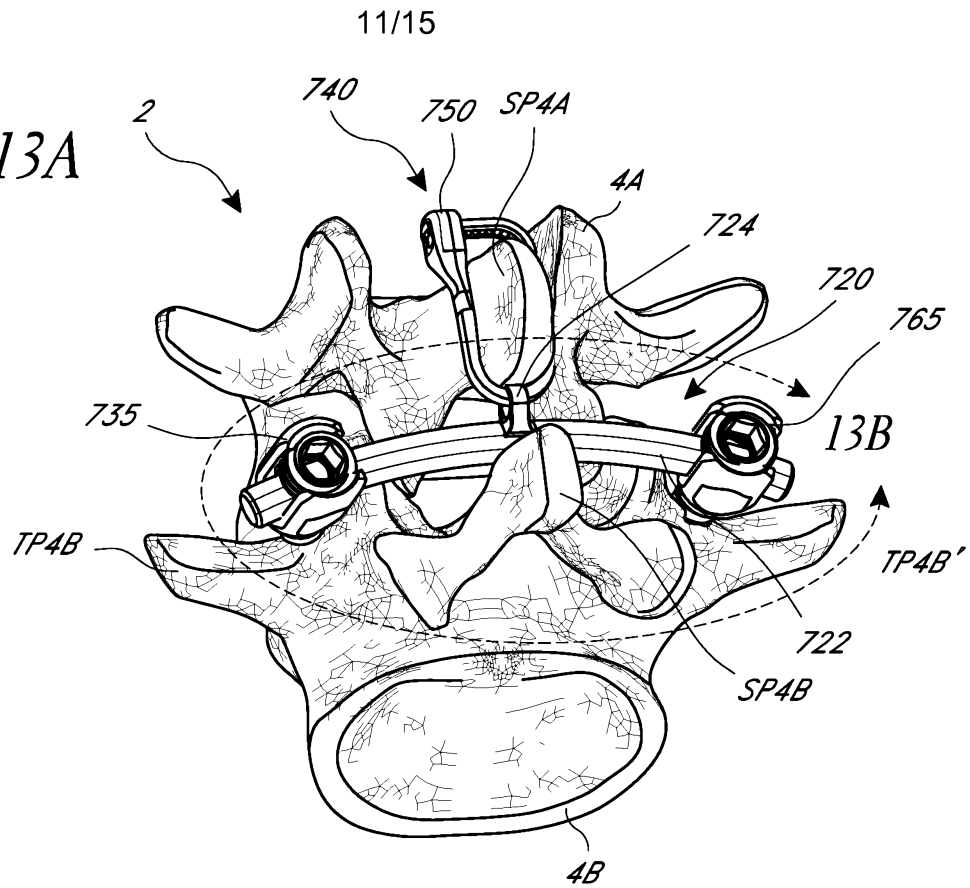

FIG. 12B

FIG. 13A



12/15

FIG. 14A

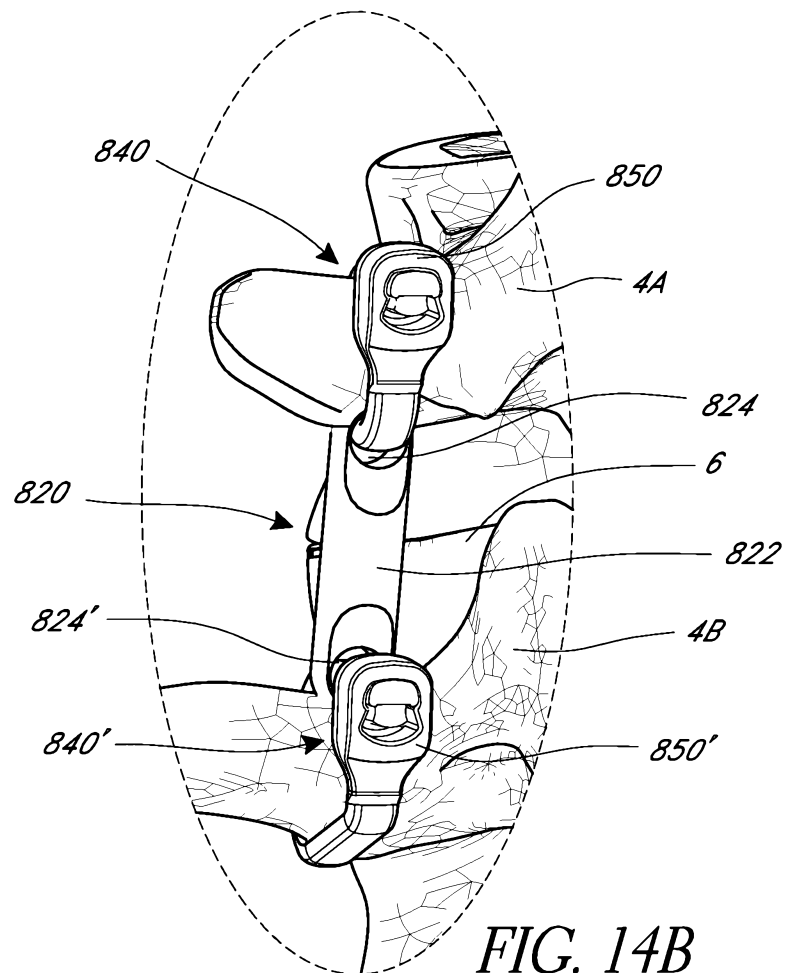
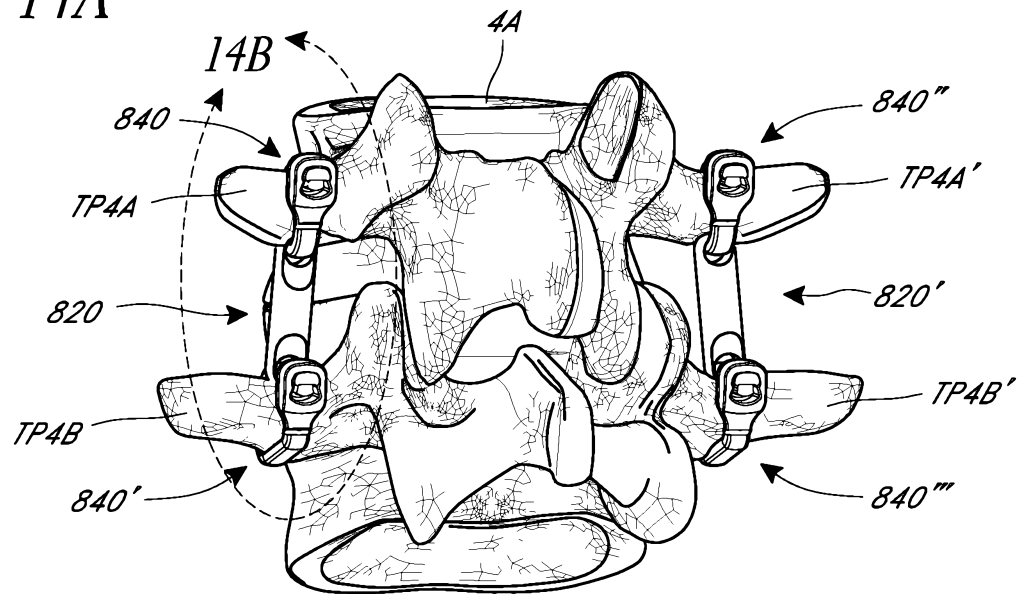

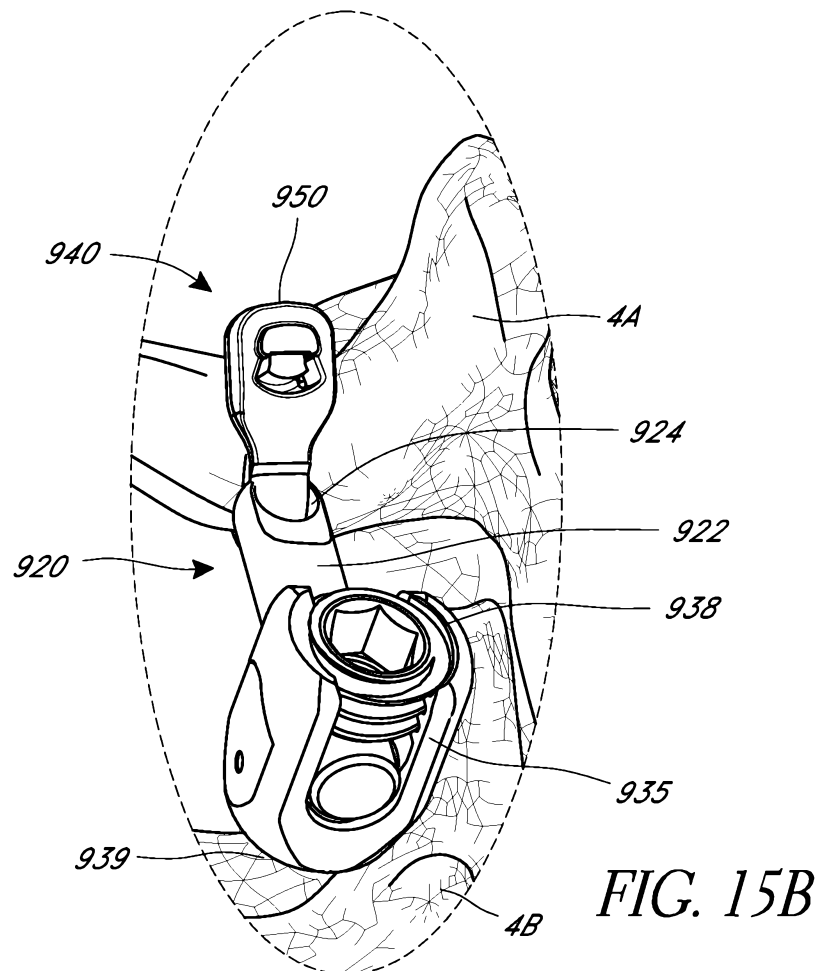
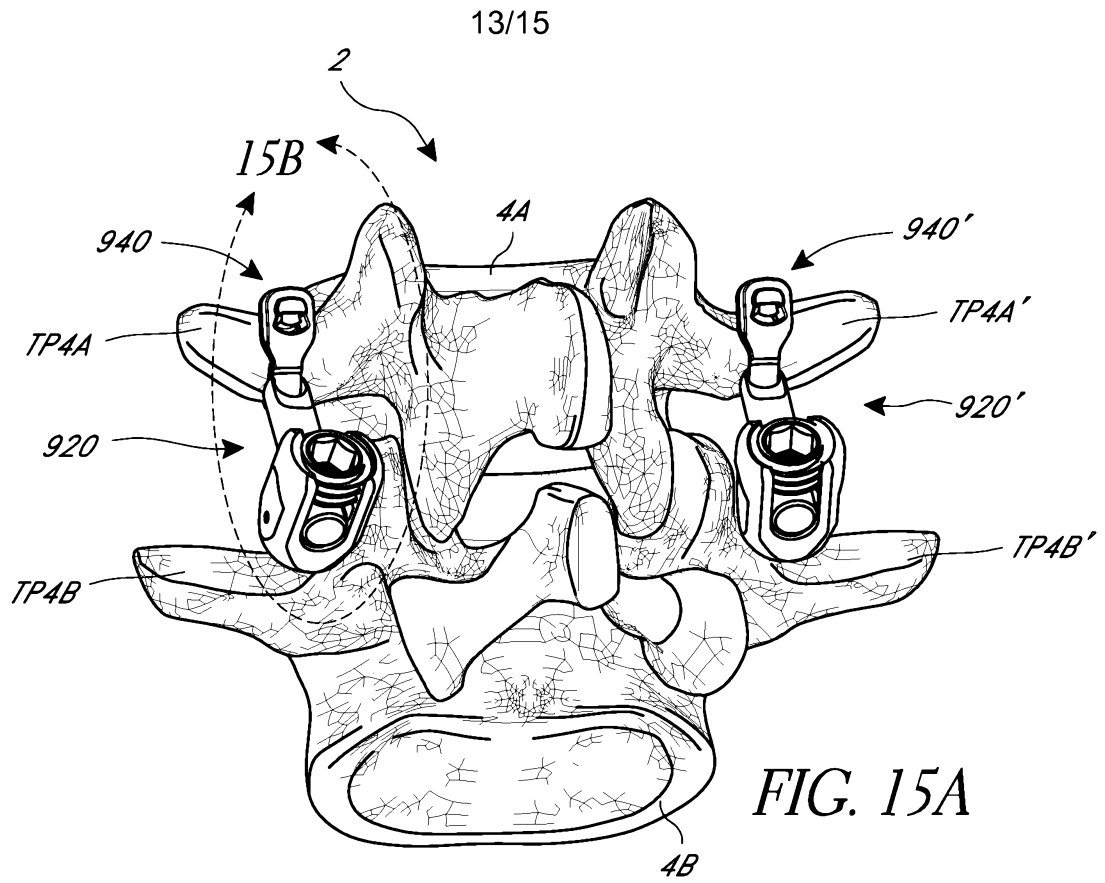

14/15

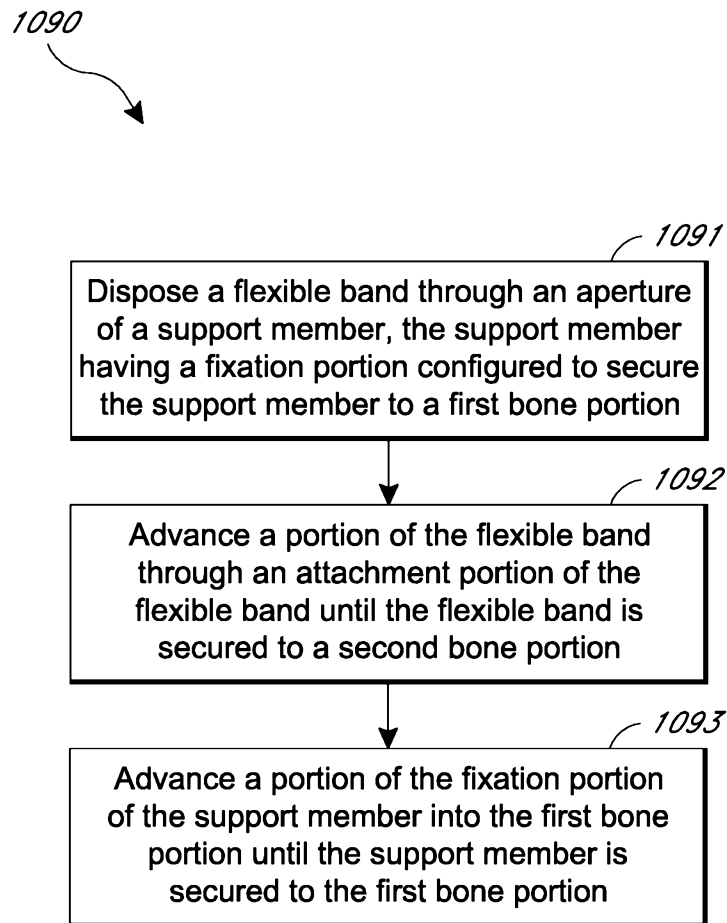
*FIG. 16*

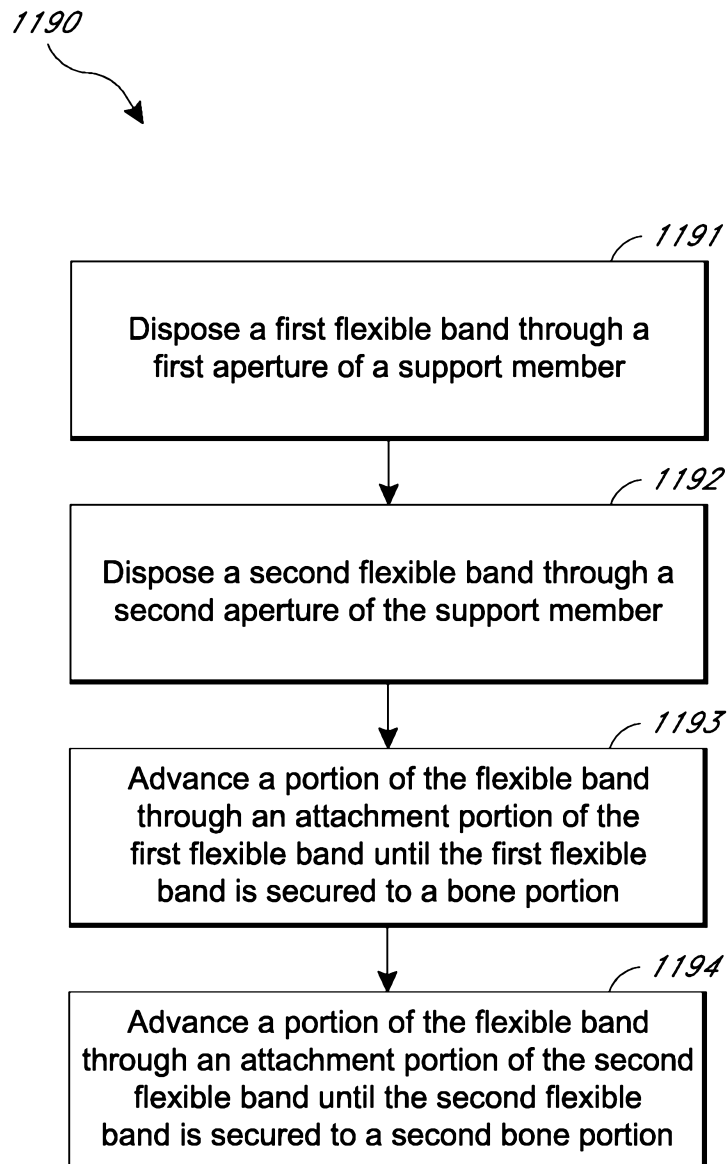
*FIG. 17*