

(19)



(11)

EP 3 023 068 A3

(12)

EUROPEAN PATENT APPLICATION

(88) Date of publication A3:
31.08.2016 Bulletin 2016/35

(51) Int Cl.:
A61B 17/80 (2006.01)

(43) Date of publication A2:
25.05.2016 Bulletin 2016/21

(21) Application number: **15195121.7**

(22) Date of filing: **18.11.2015**

(84) Designated Contracting States:
AL AT BE BG CH CY CZ DE DK EE ES FI FR GB GR HR HU IE IS IT LI LT LU LV MC MK MT NL NO PL PT RO RS SE SI SK SM TR
 Designated Extension States:
BA ME
 Designated Validation States:
MA MD

(71) Applicant: **Paragon 28, Inc.**
Englewood, Colorado 80112 (US)

(72) Inventor: **DaCosta, Albert**
Lone Tree, CO Colorado 80124 (US)

(74) Representative: **Buzzi, Franco**
Buzzi, Notaro & Antonielli d'Oulx
Via Maria Vittoria 18
10123 Torino (IT)

(30) Priority: **19.11.2014 US 201414547616**

(54) **BONE PLATES, PLATE ALIGNMENT SYSTEMS, AND METHODS OF USE**

(57) The present invention discloses a step off bone plate, bone plate insertion system, and method of use. The step off bone plate includes a body with a first end and a second end, the body includes a first portion with a first curvature, a second portion with a second curva-

ture, and a connecting portion coupled to the first portion at a first end and coupled to the second portion at a second end. The bone plate insertion system includes a step off bone plate and an alignment guide apparatus. A method of using the step off bone plate is also disclosed.

100

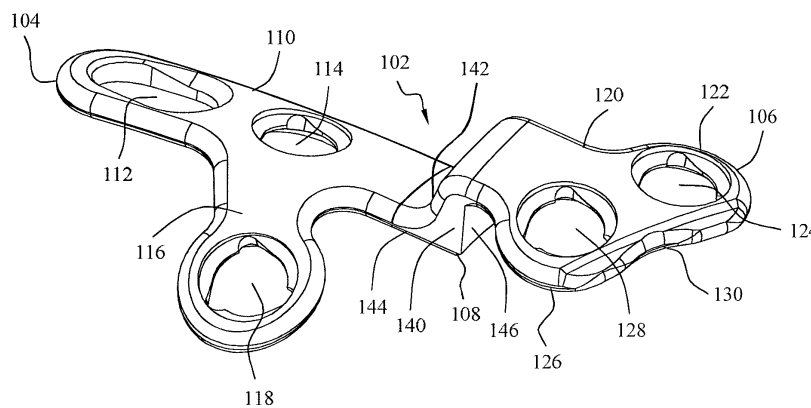

FIG. 1

EP 3 023 068 A3



EUROPEAN SEARCH REPORT

Application Number
EP 15 19 5121

5

10

15

20

25

30

35

40

45

DOCUMENTS CONSIDERED TO BE RELEVANT				
Category	Citation of document with indication, where appropriate, of relevant passages	Relevant to claim	CLASSIFICATION OF THE APPLICATION (IPC)	
X	WO 2014/140886 A2 (MERETE MEDICAL GMBH [DE]) 18 September 2014 (2014-09-18) * paragraph [0036]; figures 1-2,9 * -----	1-5	INV. A61B17/80	
X	WO 2009/105201 A1 (ORTHOHELIX SURGICAL DESIGNS [US]; DUCHARME DUSTIN [US]; DEN HARTOG BRY) 27 August 2009 (2009-08-27) * paragraph [0040]; figures 9,12-14 * -----	1,2,4-6		
Y	-----	7-11		
A	-----	3		
X	WO 2010/059497 A1 (AMEI TECHNOLOGIES INC [US]; BLITZ NEAL [US]; GEORGE MICHAEL [US]) 27 May 2010 (2010-05-27) * paragraph [0025]; figures 2,4,3A-B * -----	1		
A	-----	7		
X	DE 10 2007 047576 A1 (NORMED MEDIZIN TECHNIK VERTRIE [DE]) 23 April 2009 (2009-04-23) * paragraph [0011]; figures * -----	1		
Y	-----	10,11		
X	EP 1 897 509 A1 (SURGE FOOT [FR]) 12 March 2008 (2008-03-12) * paragraphs [0015] - [0017], [0029]; figures 1-4,7 * -----	1,4,5		TECHNICAL FIELDS SEARCHED (IPC)
Y	-----	7-11		A61B
X	EP 2 762 098 A2 (OSTEOMED LLC [US]) 6 August 2014 (2014-08-06) * figures * -----	1,4-6		
Y	-----	7-9		
A	-----	10,11		
X	US 2008/021452 A1 (DUCHARME DUSTIN [US] ET AL) 24 January 2008 (2008-01-24) * paragraph [0024]; figures 1-3 * -----	1,2		
X	US 2014/309703 A1 (DUCHARME DUSTIN [US] ET AL) 16 October 2014 (2014-10-16) * figures 1-5,12-15 * -----	1,4-6		
Y	-----	7-9		
	-/--			
The present search report has been drawn up for all claims				
Place of search Berlin		Date of completion of the search 21 July 2016	Examiner Nice, Philip	
CATEGORY OF CITED DOCUMENTS X : particularly relevant if taken alone Y : particularly relevant if combined with another document of the same category A : technological background O : non-written disclosure P : intermediate document		T : theory or principle underlying the invention E : earlier patent document, but published on, or after the filing date D : document cited in the application L : document cited for other reasons & : member of the same patent family, corresponding document		

EPO FORM 1503 03.82 (P04C01)

4

50

55



EUROPEAN SEARCH REPORT

Application Number
EP 15 19 5121

5

10

15

20

25

30

35

40

45

DOCUMENTS CONSIDERED TO BE RELEVANT				
Category	Citation of document with indication, where appropriate, of relevant passages	Relevant to claim	CLASSIFICATION OF THE APPLICATION (IPC)	
X	US 2014/148859 A1 (TAYLOR ALAN G [US] ET AL) 29 May 2014 (2014-05-29)	1,4-6		
Y	* paragraph [0100]; figures 13A-B *	7-11		
X	CN 203 417 254 U (JIANGSU SHUANGYANG MEDICAL INSTR CO LTD) 5 February 2014 (2014-02-05)	1,4-6		
Y	* figure *	7-9		
X	US 2011/264149 A1 (PAPPALARDO DANA [US] ET AL) 27 October 2011 (2011-10-27)	1,4-6		
Y	* paragraph [0071]; figures 4A-B *	7-11		
X	CN 202 218 914 U (TAIZHOU ZHONGXING MEDICAL & MACHANICAL TECHNOLOGY CO LTD) 16 May 2012 (2012-05-16)	1,4-6,12		
Y	* figure *	7-9		
X	CN 201 223 440 Y (HONG FU [CN]) 22 April 2009 (2009-04-22)	1,4,5,12		
				TECHNICAL FIELDS SEARCHED (IPC)
X	CN 201 365 972 Y (KAIXI ZHAN [CN]) 23 December 2009 (2009-12-23)	1,4,5,12		
X	WO 2014/105750 A1 (PARAGON 28 INC [US]) 3 July 2014 (2014-07-03)	13-15		
	* page 8, line 5 - page 10, line 8; figures 9-18 *			
X	US 2007/239168 A1 (KUENZI THOMAS [CH] ET AL) 11 October 2007 (2007-10-11)	13,14		
	* figures 1-2 *			
X	US 2006/189996 A1 (ORBAY JORGE L [US] ET AL) 24 August 2006 (2006-08-24)	13,14		
	* figures 8,19,22 *			
	----- -/--			
The present search report has been drawn up for all claims				
Place of search Berlin		Date of completion of the search 21 July 2016	Examiner Nice, Philip	
CATEGORY OF CITED DOCUMENTS X : particularly relevant if taken alone Y : particularly relevant if combined with another document of the same category A : technological background O : non-written disclosure P : intermediate document		T : theory or principle underlying the invention E : earlier patent document, but published on, or after the filing date D : document cited in the application L : document cited for other reasons & : member of the same patent family, corresponding document		

EPO FORM 1503 03.82 (P04C01)

4

50

55



EUROPEAN SEARCH REPORT

Application Number
EP 15 19 5121

5

10

15

20

25

30

35

40

45

50

55

DOCUMENTS CONSIDERED TO BE RELEVANT			
Category	Citation of document with indication, where appropriate, of relevant passages	Relevant to claim	CLASSIFICATION OF THE APPLICATION (IPC)
X	EP 0 617 927 A1 (GOTFRIED YEHIEL [IL]) 5 October 1994 (1994-10-05) * figure 8 *	13,14	
X	----- US 2009/036931 A1 (PECH UWE [DE] ET AL) 5 February 2009 (2009-02-05) * figures 4,6,7a-b *	13,14	
A	----- FR 2 706 763 A1 (IMPLANTS IND SA [FR]; BOLZE JEAN MARIE; PERSIKOFF RENE) 30 December 1994 (1994-12-30) * page 2, line 32 - page 13, line 3 * * page 13, line 20 - line 22; figures 1-2 * -----	7-11	
			TECHNICAL FIELDS SEARCHED (IPC)
The present search report has been drawn up for all claims			
Place of search Berlin		Date of completion of the search 21 July 2016	Examiner Nice, Philip
CATEGORY OF CITED DOCUMENTS X : particularly relevant if taken alone Y : particularly relevant if combined with another document of the same category A : technological background O : non-written disclosure P : intermediate document		T : theory or principle underlying the invention E : earlier patent document, but published on, or after the filing date D : document cited in the application L : document cited for other reasons & : member of the same patent family, corresponding document	

EPO FORM 1503 03.82 (P04C01)



Application Number
EP 15 19 5121

5

10

15

20

25

30

35

40

45

50

55

CLAIMS INCURRING FEES

The present European patent application comprised at the time of filing claims for which payment was due.

Only part of the claims have been paid within the prescribed time limit. The present European search report has been drawn up for those claims for which no payment was due and for those claims for which claims fees have been paid, namely claim(s):

No claims fees have been paid within the prescribed time limit. The present European search report has been drawn up for those claims for which no payment was due.

LACK OF UNITY OF INVENTION

The Search Division considers that the present European patent application does not comply with the requirements of unity of invention and relates to several inventions or groups of inventions, namely:

see sheet B

All further search fees have been paid within the fixed time limit. The present European search report has been drawn up for all claims.

As all searchable claims could be searched without effort justifying an additional fee, the Search Division did not invite payment of any additional fee.

Only part of the further search fees have been paid within the fixed time limit. The present European search report has been drawn up for those parts of the European patent application which relate to the inventions in respect of which search fees have been paid, namely claims:

None of the further search fees have been paid within the fixed time limit. The present European search report has been drawn up for those parts of the European patent application which relate to the invention first mentioned in the claims, namely claims:

The present supplementary European search report has been drawn up for those parts of the European patent application which relate to the invention first mentioned in the claims (Rule 164 (1) EPC).

**LACK OF UNITY OF INVENTION
SHEET B**Application Number
EP 15 19 5121

5

The Search Division considers that the present European patent application does not comply with the requirements of unity of invention and relates to several inventions or groups of inventions, namely:

10

1. claims: 1-5

Curved bone plate with specified radii of curvature

15

2. claims: 6-11

Curved bone plate with one lobe offset from another

20

3. claim: 12

Curved bone plate with one portion comprising an extension arm which is angled toward another portion

25

4. claims: 13-15

Curved bone plate with alignment guide apparatus

30

35

40

45

50

55

ANNEX TO THE EUROPEAN SEARCH REPORT
ON EUROPEAN PATENT APPLICATION NO.

EP 15 19 5121

5 This annex lists the patent family members relating to the patent documents cited in the above-mentioned European search report.
The members are as contained in the European Patent Office EDP file on
The European Patent Office is in no way liable for these particulars which are merely given for the purpose of information.

21-07-2016

Patent document cited in search report	Publication date	Patent family member(s)	Publication date
WO 2014140886 A2	18-09-2014	US 2014277176 A1 WO 2014140886 A2	18-09-2014 18-09-2014
WO 2009105201 A1	27-08-2009	AU 2009215830 A1 BR PI0907523 A2 CA 2715491 A1 EP 2254522 A1 IL 218517 A WO 2009105201 A1	27-08-2009 28-07-2015 27-08-2009 01-12-2010 31-01-2013 27-08-2009
WO 2010059497 A1	27-05-2010	AU 2009316867 A1 EP 2355731 A1 ES 2528243 T3 JP 5539375 B2 JP 2012509143 A US 2010125300 A1 US 2014379036 A1 WO 2010059497 A1	27-05-2010 17-08-2011 05-02-2015 02-07-2014 19-04-2012 20-05-2010 25-12-2014 27-05-2010
DE 102007047576 A1	23-04-2009	NONE	
EP 1897509 A1	12-03-2008	AT 435620 T DK 1897509 T3 EP 1897509 A1 FR 2905590 A1	15-07-2009 03-08-2009 12-03-2008 14-03-2008
EP 2762098 A2	06-08-2014	AU 2010245194 A1 BR PI1014411 A2 EP 2424454 A1 EP 2762098 A2 JP 2012525213 A JP 2015044053 A US 2010274293 A1 US 2014074173 A1 WO 2010129156 A1	20-10-2011 05-04-2016 07-03-2012 06-08-2014 22-10-2012 12-03-2015 28-10-2010 13-03-2014 11-11-2010
US 2008021452 A1	24-01-2008	AT 527946 T AU 2007275776 A1 BR PI0714325 A2 CA 2658077 A1 EP 2040631 A2 IL 196257 A US 2008021452 A1 WO 2008011018 A2	15-10-2011 24-01-2008 02-04-2013 24-01-2008 01-04-2009 29-12-2011 24-01-2008 24-01-2008
US 2014309703 A1	16-10-2014	US 2009306724 A1	10-12-2009

EPO FORM P0459

For more details about this annex : see Official Journal of the European Patent Office, No. 12/82

ANNEX TO THE EUROPEAN SEARCH REPORT
ON EUROPEAN PATENT APPLICATION NO.

EP 15 19 5121

5 This annex lists the patent family members relating to the patent documents cited in the above-mentioned European search report.
The members are as contained in the European Patent Office EDP file on
The European Patent Office is in no way liable for these particulars which are merely given for the purpose of information.

21-07-2016

Patent document cited in search report	Publication date	Patent family member(s)	Publication date
		US 2012109214 A1	03-05-2012
		US 2014296921 A1	02-10-2014
		US 2014296923 A1	02-10-2014
		US 2014296924 A1	02-10-2014
		US 2014309701 A1	16-10-2014
		US 2014309703 A1	16-10-2014
		US 2016120581 A1	05-05-2016
		WO 2010098817 A1	02-09-2010

US 2014148859 A1	29-05-2014	AU 2013353413 A1	12-03-2015
		CA 2883745 A1	05-06-2014
		CN 104869928 A	26-08-2015
		EP 2879603 A1	10-06-2015
		JP 2015536733 A	24-12-2015
		US 2014148859 A1	29-05-2014
		WO 2014084974 A1	05-06-2014

CN 203417254 U	05-02-2014	NONE	

US 2011264149 A1	27-10-2011	CA 2795819 A1	03-11-2011
		CN 102858263 A	02-01-2013
		EP 2563250 A1	06-03-2013
		JP 5808393 B2	10-11-2015
		JP 2013525026 A	20-06-2013
		KR 20130069578 A	26-06-2013
		TW 201206390 A	16-02-2012
		US 2011264149 A1	27-10-2011
		US 2015080968 A1	19-03-2015
		WO 2011137163 A1	03-11-2011

CN 202218914 U	16-05-2012	NONE	

CN 201223440 Y	22-04-2009	NONE	

CN 201365972 Y	23-12-2009	NONE	

WO 2014105750 A1	03-07-2014	EP 2938279 A1	04-11-2015
		US 2015359580 A1	17-12-2015
		WO 2014105750 A1	03-07-2014

US 2007239168 A1	11-10-2007	AT 448739 T	15-12-2009
		AU 2004317395 A1	29-09-2005
		BR PI0418545 A	22-05-2007
		CA 2557153 A1	29-09-2005
		CN 1917821 A	21-02-2007
		EP 1718222 A1	08-11-2006

EPO FORM P0459

For more details about this annex : see Official Journal of the European Patent Office, No. 12/82

ANNEX TO THE EUROPEAN SEARCH REPORT
ON EUROPEAN PATENT APPLICATION NO.

EP 15 19 5121

5 This annex lists the patent family members relating to the patent documents cited in the above-mentioned European search report.
The members are as contained in the European Patent Office EDP file on
The European Patent Office is in no way liable for these particulars which are merely given for the purpose of information.

21-07-2016

Patent document cited in search report	Publication date	Patent family member(s)	Publication date
		ES 2336789 T3	16-04-2010
		JP 2007522858 A	16-08-2007
		US 2007239168 A1	11-10-2007
		WO 2005089660 A1	29-09-2005

US 2006189996 A1	24-08-2006	AU 2006207962 A1	03-08-2006
		CA 2596266 A1	03-08-2006
		EP 1855605 A1	21-11-2007
		US 2006189996 A1	24-08-2006
		US 2006200157 A1	07-09-2006
		WO 2006081483 A1	03-08-2006
		WO 2007109437 A2	27-09-2007

EP 0617927 A1	05-10-1994	DE 69416020 D1	04-03-1999
		EP 0617927 A1	05-10-1994
		IL 105183 A	23-07-1996
		US 5429641 A	04-07-1995

US 2009036931 A1	05-02-2009	DE 102007036943 A1	19-02-2009
		US 2009036931 A1	05-02-2009

FR 2706763 A1	30-12-1994	NONE	
