

(19) World Intellectual Property Organization
International Bureau



(43) International Publication Date
13 December 2007 (13.12.2007)

PCT

(10) International Publication Number
WO 2007/140782 A1

(51) International Patent Classification:
F24D 3/14 (2006.01)

(21) International Application Number:

PCT/DK2007/000272

(22) International Filing Date: 7 June 2007 (07.06.2007)

(25) Filing Language: Danish

(26) Publication Language: English

(30) Priority Data:

BA 2006 00166 9 June 2006 (09.06.2006) DK

PA 2006 01146 6 September 2006 (06.09.2006) DK

BA 2007 00012 16 January 2007 (16.01.2007) DK

(81) Designated States (unless otherwise indicated, for every kind of national protection available): AE, AG, AL, AM, AT, AU, AZ, BA, BB, BG, BH, BR, BW, BY, BZ, CA, CH, CN, CO, CR, CU, CZ, DE, DK, DM, DO, DZ, EC, EE, EG, ES, FI, GB, GD, GE, GH, GM, GT, HN, HR, HU, ID, IL, IN, IS, JP, KE, KG, KM, KN, KP, KR, KZ, LA, LC, LK, LR, LS, LT, LU, LY, MA, MD, MG, MK, MN, MW, MX, MY, MZ, NA, NG, NI, NO, NZ, OM, PG, PH, PL, PT, RO, RS, RU, SC, SD, SE, SG, SK, SL, SM, SV, SY, TJ, TM, TN, TR, TT, TZ, UA, UG, US, UZ, VC, VN, ZA, ZM, ZW.

(84) Designated States (unless otherwise indicated, for every kind of regional protection available): ARIPO (BW, GH, GM, KE, LS, MW, MZ, NA, SD, SL, SZ, TZ, UG, ZM, ZW), Eurasian (AM, AZ, BY, KG, KZ, MD, RU, TJ, TM), European (AT, BE, BG, CH, CY, CZ, DE, DK, EE, ES, FI, FR, GB, GR, HU, IE, IS, IT, LT, LU, LV, MC, MT, NL, PL, PT, RO, SE, SI, SK, TR), OAPI (BF, BJ, CF, CG, CI, CM, GA, GN, GQ, GW, ML, MR, NE, SN, TD, TG).

(71) Applicants and

(72) Inventors: PEDERSEN, Asker Højlund [DK/DK]; Lærkevej 5, DK-9550 Mariager (DK). DEJLIGBJERG, Torben [DK/DK]; Norupvej 4, DK-9550 Mariager (DK).

Published:

— with international search report

(74) Agent: LARSEN & BIRKEHOLM A/S; Skandinavisk Patentbureau, Banegårdspladsen 1, DK-1570 Copenhagen V (DK).

For two-letter codes and other abbreviations, refer to the "Guidance Notes on Codes and Abbreviations" appearing at the beginning of each regular issue of the PCT Gazette.

(54) Title: A MOUNTING CLAMP FOR A FLOOR HEATING SYSTEM

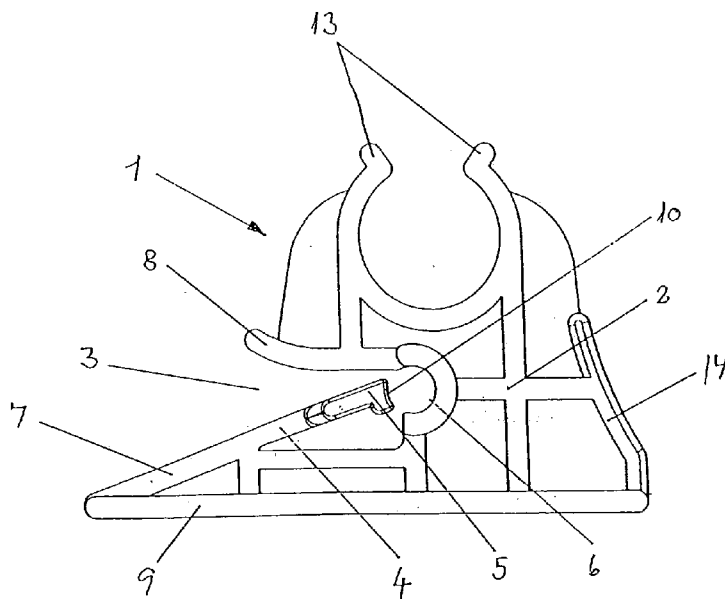

(57) Abstract: When, according to the invention, a mounting clamp (1) for a floor heating system and for mounting on a reinforcement net is constructed such that it comprises a frame (2) on a foot plate (9) as well as means for gripping and securing a pipe or cable-like heat generator to the mounting clamp (1) and to the reinforcement net, and the frame (2) is provided with a means in the form of a substantially horizontally extending incision (3) having a locking pawl (4) for receiving a wire from the reinforcement net, it is ensured that the mounting clamp may be snapped on to the reinforcement net in one movement. When the frame (2) is additionally provided with a means in the form of a funnel (15) having an upwardly directed mouth with guide plates (18, 19) and with a locking pawl (17), it may advantageously be used for electrical heating cables.

WO 2007/140782 A1

A MOUNTING CLAMP FOR A FLOOR HEATING SYSTEM

The prior art

5 The invention relates to a mounting clamp, in particular for a floor heating system, and for mounting on a reinforcement net, which comprises a frame, a foot plate as well as means for gripping and securing a pipe or cable-like heat generator to the mounting clamp and to the reinforcement net, and wherein the means for securing the mounting clamp to the reinforcement
10 net comprise a substantially horizontally extending incision, said incision being funnel-shaped and equipped with guide plates which are directed inwards toward a seat for a wire, and wherein a guide plate extends with a slightly upwardly rising inclination from the front edge of the foot plate at the mouth of the incision and forwards to the seat.

15

Floor heating systems are frequently used in new built houses or are provided in connection with a renovation of heating systems in older houses and basements. The floor heating system is constructed by placing a capillary interrupting layer on the ground and placing a layer of concrete
20 thereon. Then, insulation bats or blocks are placed on the concrete layer in order to reduce the heat distribution downwards. A reinforcement net is placed above the insulation on a number of blocks in order to create spacing to the insulation bats, so that the reinforcement net will be disposed centrally in the upper concrete layer, thereby making room for a reasonable
25 concrete thickness below the net, but also in order to create a base for the attachment of the floor heating coils. When the floor heating coils have been placed, the upper concrete layer is applied and smoothed.

The floor heating coils are laid in large loops so that the distance between
30 the various loops is in the vicinity of 30 cm. In order to secure the coils during laying and during casting, the coils are secured to the reinforcement

net. Generally, the coils are secured manually by strips or steel wire.

5 A second method of securing the coils is described in the published document WO 2006/029627, in which a mounting clamp is used, configured to be placed in the wire intersections on a reinforcement net. The mounting clamp is relatively high and slender, and it must be assumed that it may be problematic to make the heating coils lie stably, because the coils are not supported between the clamps, and also because the supporting faces of the clamps are relatively small.

10

A third method of securing floor heating coils is described in the document FR 2700349 A1, which discloses a mounting clamp for heating coils for floor heating systems, which comprises arms for gripping the heating coil. The arms are mounted on a frame which is equipped with an opening for receiving a wire from a reinforcement net, said opening being adapted to secure the mounting clamp with a locking element. The opening is oriented in a vertical direction, so that the mounting clamp may be mounted by pressing the holder downwards toward the reinforcement net. Moreover, the opening is adapted to receive up to two reinforcement nets disposed above each other, only the upper one of which being secured by the locking element. On the face of it, the frame appears to be too fragile for the task, and the frame does not have a large tread face.

15

A fourth mounting clamp is described in Danish Patent DK 174344, which discloses a clamp provided with a horizontally extending incision having a plurality of depressions for receiving a wire from the reinforcement net. The clamp is locked to the reinforcement net by pressing a heating pipe down into the depression provided for the purpose, whose one arm is so flexible as to deflect when the pipe is introduced. The configuration of the clamp does not appear to be expedient, and must be assumed to cause problems in the mounting.

25

30

The patent DE 4304698 A1 discloses a mounting clamp which is constructed on the basis of a circular foot member. The foot member is formed with a horizontally disposed funnel having guide plates which lead into a seat for a wire, the upper guide plate of which being configured as a locking pawl. The clamp is mounted by placing the clamp above the wire by means of a mounting stick and then rotating the clamp 45 degrees to the one or the other side. The structure shown is complex and requires sophisticated plastics moulding tools, and, therefore, it must be assumed that the production costs are somewhat higher than for the mounting clamp according to the invention. The position of the wire and the distance from the base and to the seat of the wire seem to be insufficient if there is to be room for a reasonable amount of concrete below the net, in order to avoid cracking caused by loading or corrosion.

An additional method of laying and securing floor heating coils is shown on the Uponor and Wirsbo homepage: www.wirsbo.dk. It is shown there how the coils are laid in a mounting band placed directly on the insulation bats, and that the reinforcement net is then laid on top of the coils, following which casting takes place. Here, the coils are not secured to the reinforcement net.

The work involved by the laying of the heating coils and tying them firmly to the reinforcement net by strips or metal wire, is cumbersome and time-consuming and involves an extreme strain on the knees and the back, because the coils are to be unrolled and laid while being tied to the reinforcement net. The rolls are heavy and cumbersome to handle. In addition, it is a problem to walk on the net which yields and deflects because of the assembly on blocks.

In addition, it may give rise to problems if the coils are tied tightly and firmly to the reinforcement net. In operation, the coils will be heated and cooled

regularly. The expansions of the material may then cause leaks on the coils in the areas where they are tied because of the wear against the reinforcement net.

- 5 The above-mentioned techniques for securing and embedding heating coils and cables also find application in the laying of hoses for water supply. Here, however, also an outer hose is used for the protection of the water hose.

10 The object of the invention

The object of the invention is to remedy the above-mentioned drawbacks and to improve mounting clamps for pipe or cable-like heat generators to the greatest extent possible, and this is achieved by a set of guide plates
15 where the lower guide plate is additionally provided with a locking pawl at its most remote end opposite the mouth of the incision and is moreover configured such that it extends forwards in front of the upper guide plate, which upper guide plate extends substantially horizontally from the mouth of the incision and forwards to the seat and is additionally provided with a
20 bend directed outwardly relative to the mouth of the incision.

In this surprisingly simple manner, a mounting clamp is achieved, which can stand stably on the base without turning over because of the size and the shape of the frame and the foot plate, and which may be snapped on to
25 the reinforcement net in one horizontally extending movement, whereby the wire is caught by the incision and is guided by the guide plates forwards to the seat, where the wire is secured by the seat and the locking pawl in combination.

- 30 The movement of the mounting clamp above the base is controlled and supported by the foot plate and is implemented by pressing on the pressure

plate, which is arranged on the rear edge of the frame. Then, the necessary number of clamps may be arranged quickly, and subsequently the heat generator is pressed into position in the means for securing the heat generator by the foot. Further, the reinforcement net and the heat generator are separated, so that the heat generators are not subjected to wear at the tying points.

When, as stated in claim 2, the mounting clamp is equipped with securing means for a pipe or cable-like heat generator, said securing means being configured as a pipe depression between a set of arms, it is ensured that the clamp may secure pipes or cables of different sizes.

When, as stated in claim 3, the mounting clamp is equipped with securing means for a pipe or cable-like heat generator, said securing means being configured as a funnel with an upwardly directed mouth and with sides pointing inwards and downwards toward a seat behind a locking pawl, it is ensured that electrical heating cables may be laid and secured.

When, as stated in claim 4, the centre of the seat is arranged at a distance from the bottom of the foot plate, spacing is advantageously provided between the insulation and the reinforcement net, so that the net will be disposed more centrally in the concrete layer so as to stabilize the concrete floor as best as possible. When the seat is additionally given a circular arc-shaped cross-section of a diameter corresponding to the wire diameter of the reinforcement net and a length corresponding to the width of the foot plate, it is ensured that the mounting clamp may be mounted safely on a reinforcement net having a corresponding wire diameter.

When, as stated in claim 5, the locking pawl is configured so that it is resilient at the free end, and so that, over a distance which at least constitutes one-half of the length of the locking pawl, it is configured with a dimension

in the width corresponding to the width of the foot plate, it is ensured on the one hand that a reinforcement wire may be pressed past the locking pawl and into the seat in the application, and on the other hand that a mounting clamp which is placed wrongly may be released by pressing the locking pawl aside, and when additionally the free end of an engagement face is configured with a radius of curvature which corresponds to the radius of curvature of the seat, it is ensured that a wire from the reinforcement net may be locked and secured in a safe and expedient manner.

When, as stated in claim 6, the frame is constructed as a structure of connected ribs with intermediate transversely arranged body plates and with guide plates, pressure plates, foot plates and arms as stiffening elements, a rigid and stable mounting clamp is achieved, which is capable of withstanding tension and torsion from the heat generators during laying.

Finally, as stated in claims 7 and 8, it is expedient to make the mounting clamp with the stated dimensions and materials, so that the stability and heating capacity requirements may be satisfied.

The drawing

An example of an embodiment according to the invention will be described more fully below with reference to the drawing, in which

Fig. 1 shows the mounting clamp according to the invention, seen from the side,

Fig. 2 shows a perspective view of the mounting clamp according to the invention, seen obliquely from above,

Fig. 3 shows a perspective view of the mounting clamp according to the

invention, seen obliquely from below, and

Fig. 4 shows a side view of a mounting clamp with a securing means for heating cables.

5

Description of an exemplary embodiment

Fig. 1 shows a side view of the mounting clamp 1 according to the invention. It will be seen in the figure that the mounting clamp is provided with a pipe depression having arms 13, which are configured to grip a pipe or cable-like heat generator. The arms 13 are built together with and placed centrally above the frame 2, which stands on the foot plate 9.

The frame 2 is provided with a substantially horizontally extending incision 3 for receiving a wire from the reinforcement net. Opposite the incision 3, the frame is additionally equipped with a pressure plate 14 which is used in the mounting of the mounting clamp. The incision 3 is funnel-shaped and is provided with lower and upper guide plates 7, 8, which define the funnel and point inwards toward the centre of the frame to a seat 6 for the wire.

20

The lower guide plate 7 extends with a slightly upwardly rising inclination from the front edge of the foot plate 9 at the mouth of the incision 3 and forwards to the seat 6, and is configured as a resilient locking pawl 4 at its most remote end opposite the mouth of the incision. The upper guide plate 8 extends substantially horizontally from the mouth of the incision and forwards to the seat 6 and is additionally provided with a bend directed outwardly relative to the mouth of the incision. The course of the guide plates makes it an easy matter to catch a wire on the reinforcement net and guide it into the seat.

25
30

Figs. 1, 2 and 3 show that the guide plate 7 is configured as the locking

pawl 4. However, the guide plate 8 might equally well be configured as a locking pawl, and both embodiments are therefore comprised by the invention.

5 Fig. 4 shows a variant of a means for securing a pipe or cable-like heat generator. The means is configured as a funnel 15 with an upwardly directed mouth whose sides 18, 19 point inwards and down to a seat 16 behind a locking pawl 17. The side 18 is configured as a flexible guide plate, where the free end forms the locking pawl 17. The other side 19 is formed
10 by the edge of the body plate 20. This means may be released by pressing on the thickenings of the locking pawl 17 and pressing the pawl aside. A heating cable is easily mounted by pressing it into the funnel 15 and down into the seat 16 behind the locking pawl 17.

15 In fig. 1, the locking pawl 4 is configured with a free end 5 which is flexible, and the free end will therefore deflect when a wire from the reinforcement net is pressed in. The outer half of the free end 5 is configured with a larger dimension in the width than the other half, so that it is possible to affect the locking pawl by the fingers – a possibility which might be useful if a mounting clamp is to be removed for some reason. Moreover, the free end is provided with an engagement face 10 which is configured with a radius of curvature corresponding to the radius of curvature of the seat 6.
20

The seat 6 is intended to receive a wire from the reinforcement net and secure it together with the locking pawl 4. For this purpose, the seat is configured as a portion of a circular arc. The circular arc of the seat may be configured with radii of curvature from 2 to 6 mm.
25

The centre of the circular arc of the seat is positioned at a distance above the bottom of the foot plate 9. The distance is determined by the dimensions of the wire diameter of the reinforcement net, the diameter of the heat
30

generator and the desired thickness of the concrete layer, and forms the basis for the selection of the size of the mounting clamp.

5 The distance from the bottom of the foot plate 9 to the centre of the circular arc of the seat may be from 16 to 20 mm. This distance is important in order to ensure that the concrete layer above the insulation, but below the reinforcement net, always has a thickness and thereby strength so that it does not crack when loaded or by heat impacts in operation.

10 The mounting clamp 1 is moulded of plastics, and the frame 2 is constructed as a rib structure with transversely arranged body plates for stiffening between the ribs. The guide plates 7, 8, the pressure plate 14, the foot plate 9 and the arms 13 are likewise incorporated as stiffening elements or ribs. This structure results in a very rigid and sturdy mounting
15 clamp with a minimum consumption of materials. The foot plate 9 is configured with the purpose of creating a stable engagement face against the base and is dimensioned so suitably large that the clamp does not turn over because of the forces that are produced when the heat generators are placed in a loop.

20 The arms 9 are provided with outer projecting ends configured to catch a pipe, a cable or a hose. The arms are moreover supported by ribs and body plates. The frame 2 is provided with a pressure plate 14 which is positioned opposite the opening 3, and which is used in the mounting of the mounting
25 clamp.

Mounting of the mounting clamp 1 on a reinforcement net is performed by applying the clamp to the insulation at a reinforcement wire with the opening 3 facing toward the wire. Then, the clamp 1 is moved toward the wire by
30 a pressure on the pressure plate 14 until the wire is pressed completely into the seat 6, and the locking pawl 4 blocks the wire.

Dismounting of a mounting clamp takes place by forcing the locking pawl 4 aside by pressing the wide area of the free end 5 of the locking pawl. The clamp is then pulled away from the wire.

5

Of course, the mounting clamp 1 may be used in connection with the laying of flexible pipes or cables for heating, but also for pipes or hoses for water supply.

PATENT CLAIMS

1. A mounting clamp, in particular for a floor heating system, and for mounting on a reinforcement net, comprising a frame (2), a foot plate (9) as well as means for gripping and securing a pipe or cable-like heat generator to the mounting clamp (1) and to the reinforcement net, and wherein the means for securing the mounting clamp to the reinforcement net comprise a substantially horizontally extending incision (3), said incision (3) being funnel-shaped and equipped with guide plates (7, 8) which are directed inwards toward a seat (6) for the wire, and wherein the guide plate (7) extends with a slightly upwardly rising inclination from the front edge of the foot plate (9) at the mouth of the incision (3) and forwards to the seat (6), characterized in that the guide plate (7) is additionally configured as a locking pawl (4) at its most remote end opposite the mouth of the incision, and which is moreover configured such that it extends forwards in front of the guide plate (8), which guide plate (8) extends substantially horizontally from the mouth of the incision and forwards to the seat (6), and which is provided with a bend directed outwardly relative to the mouth of the incision.

20

2. A mounting clamp according to claim 1, characterized in that the means for securing a pipe or cable-like heat generator are configured as a pipe depression in order to receive pipes or cables of a diameter from 10 to 30 mm between the arms (13).

25

3. A mounting clamp according to claim 1, characterized in that the means for securing a pipe or cable-like heat generator are configured as a funnel (15) having an upwardly directed mouth, whose sides (18, 19) point downwards and inwards toward a seat (16) behind a locking pawl (17), and wherein the side (18) is configured as a guide plate which is flexible, and wherein the free end of the plate forms

30

the locking pawl (17), and wherein the side (19) is formed by the edge of the body plate (20).

4. A mounting clamp according to claim 1,
5 c h a r a c t e r i z e d in that the centre of the seat (6) is arranged at a distance from the bottom of the foot plate (9), and that the seat is additionally shaped as a circular arc and is configured with a length corresponding to the width of the foot plate (9) and a diameter corresponding to the wire.
- 10 5. A mounting clamp according to claim 1 or 4,
c h a r a c t e r i z e d in that the locking pawl (4) comprises a resilient free end (5), and that, over a distance which at least constitutes one half of the length of the locking pawl, it is configured with at least a dimension in the width corresponding to the width of the foot plate (9), and that it is additionally
15 configured with an engagement face (10) having a radius of curvature which corresponds to the radius of curvature of the seat (6).
6. A mounting clamp according to claim 1,
c h a r a c t e r i z e d in that the frame (2) is constructed as a structure of
20 connected ribs (11) with intermediate transversely arranged body plates (12), and wherein each rib (14) is moreover a pressure plate, and wherein the guide plates (7, 8), the pressure plate (14), the foot plate (9) and the arms (13) also form stiffening elements.
- 25 7. A mounting clamp according to any one of claims 1, 4, 5 or 6,
c h a r a c t e r i z e d in that the length of the foot plate (9) is typically from about 6 to 12 cm, and that the length is 3 to 6 times larger than the width.
8. A mounting clamp according to any one of the preceding claims,
30 c h a r a c t e r i z e d in that it is made of plastics.

fig. 2

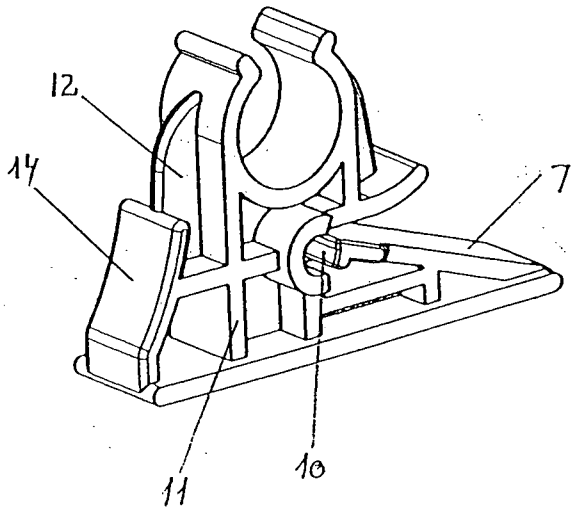

fig. 3

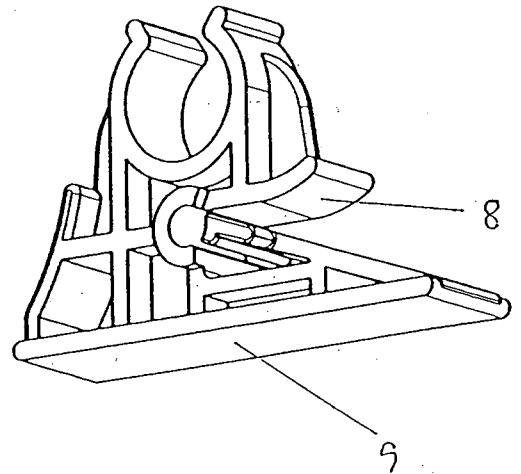
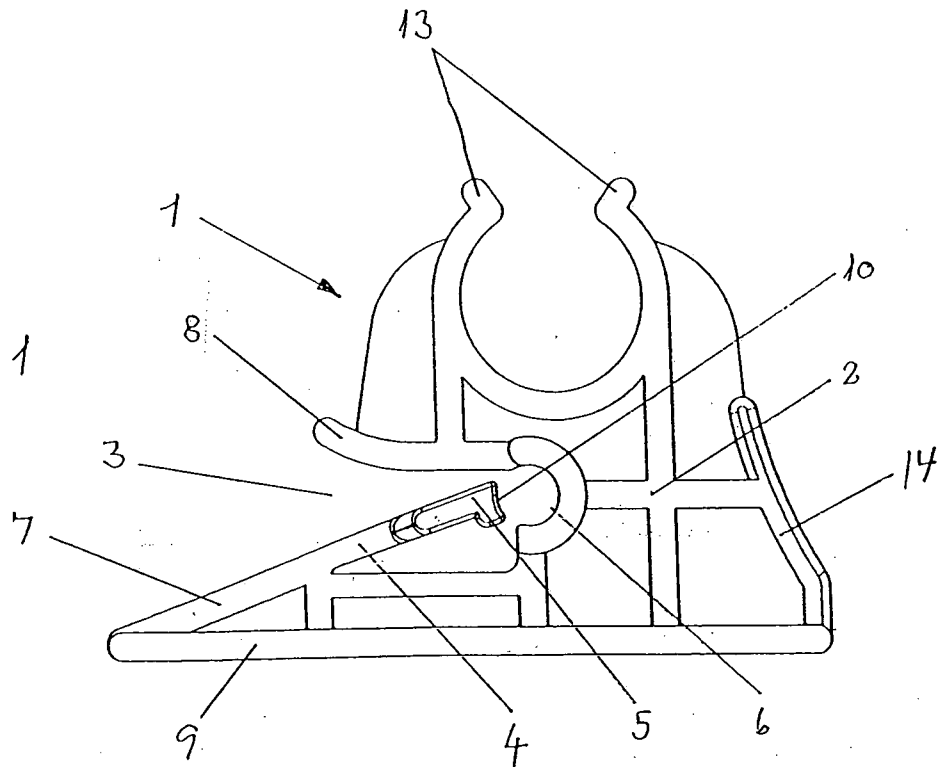
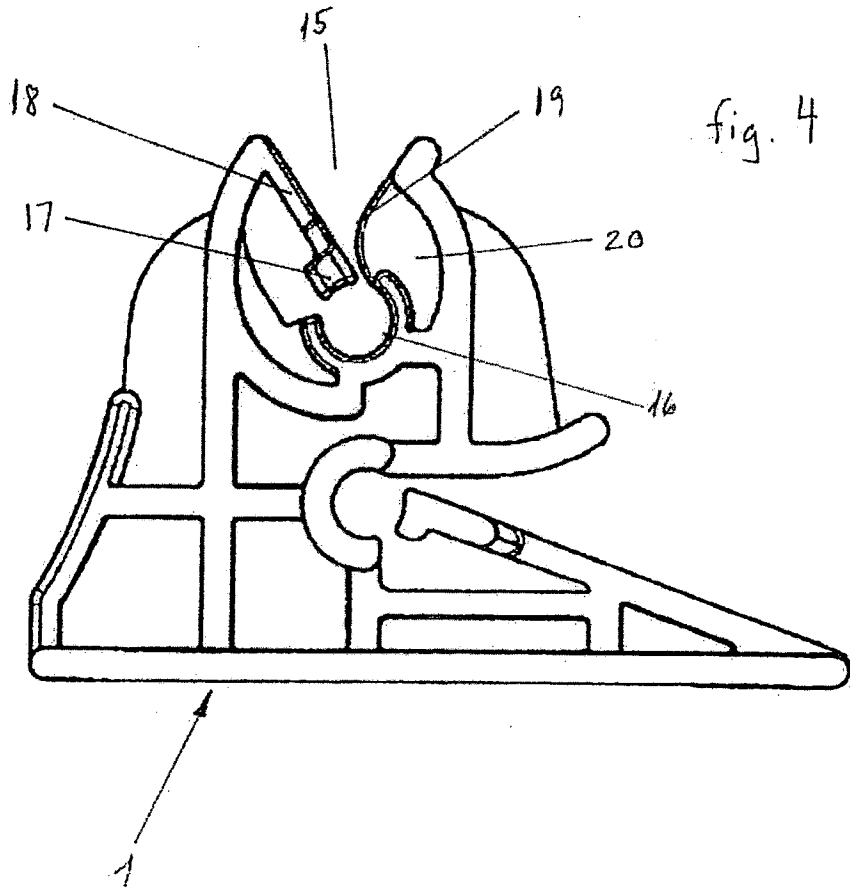

fig 1





INTERNATIONAL SEARCH REPORT

International application No
PCT/DK2007/000272

A. CLASSIFICATION OF SUBJECT MATTER INV. F24D3/14		
According to International Patent Classification (IPC) or to both national classification and IPC		
B. FIELDS SEARCHED		
Minimum documentation searched (classification system followed by classification symbols) F16B F24D		
Documentation searched other than minimum documentation to the extent that such documents are included in the fields searched		
Electronic data base consulted during the international search (name of data base and, where practical, search terms used) EPO-Internal		
C. DOCUMENTS CONSIDERED TO BE RELEVANT		
Category*	Citation of document, with indication, where appropriate, of the relevant passages	Relevant to claim No.
Y	DE 32 29 971 C1 (DEGEN GEB RADAU) 17 November 1983 (1983-11-17) column 3, line 9 - column 4, line 20; figure 1	1-8
Y	DE 43 04 698 A1 (POLY PLAST GMBH [DE]) 18 August 1994 (1994-08-18) cited in the application claims; figures	1-8
A	EP 0 104 494 A2 (NORDROHR WERKE KG [DE]) 4 April 1984 (1984-04-04) page 8, paragraph 3 - page 9, paragraph 2; figures	1-8
<input type="checkbox"/> Further documents are listed in the continuation of Box C. <input checked="" type="checkbox"/> See patent family annex.		
* Special categories of cited documents : *A* document defining the general state of the art which is not considered to be of particular relevance *E* earlier document but published on or after the international filing date *L* document which may throw doubts on priority claim(s) or which is cited to establish the publication date of another citation or other special reason (as specified) *O* document referring to an oral disclosure, use, exhibition or other means *P* document published prior to the international filing date but later than the priority date claimed *T* later document published after the international filing date or priority date and not in conflict with the application but cited to understand the principle or theory underlying the invention *X* document of particular relevance; the claimed invention cannot be considered novel or cannot be considered to involve an inventive step when the document is taken alone *Y* document of particular relevance; the claimed invention cannot be considered to involve an inventive step when the document is combined with one or more other such documents, such combination being obvious to a person skilled in the art. *&* document member of the same patent family		
Date of the actual completion of the international search 31 August 2007	Date of mailing of the international search report 20/09/2007	
Name and mailing address of the ISA/ European Patent Office, P.B. 5818 Patentlaan 2 NL - 2280 HV Rijswijk Tel. (+31-70) 340-2040, Tx. 31 651 epo nl. Fax: (+31-70) 340-3016	Authorized officer Granger, Hugo	

INTERNATIONAL SEARCH REPORT

Information on patent family members

International application No

PCT/DK2007/000272

Patent document cited in search report	Publication date	Patent family member(s)	Publication date
DE 3229971	C1	17-11-1983	NONE
DE 4304698	A1	18-08-1994	NONE
EP 0104494	A2	04-04-1984	NONE