

**(12) STANDARD PATENT**  
**(19) AUSTRALIAN PATENT OFFICE**

(11) Application No. **AU 2011283048 B2**

(54) Title  
**Surgical positioning and support system**

(51) International Patent Classification(s)  
**A61B 34/00** (2016.01) **B25J 9/06** (2006.01)  
**A61B 17/94** (2006.01) **B25J 18/06** (2006.01)

(21) Application No: **2011283048** (22) Date of Filing: **2011.07.21**

(87) WIPO No: **WO12/015659**

(30) Priority Data

(31)	Number	(32)	Date	(33)	Country
	<b>61/368,257</b>		<b>2010.07.28</b>		<b>US</b>

(43) Publication Date: **2012.02.02**

(44) Accepted Journal Date: **2016.02.11**

(71) Applicant(s)  
**Medrobotics Corporation**

(72) Inventor(s)  
**Oyola, Arnold;Stand, Joseph;Gilmartin, Kevin;Darisse, Ian;Didomenico, Robert;Flaherty, J. Christopher**

(74) Agent / Attorney  
**Watermark Patent and Trade Marks Attorneys, Level 2 302 Burwood Road, HAWTHORN, VIC, 3122**

(56) Related Art  
**US 2008/0188869**  
**US 2009/0171151**  
**US 2004/0138529**

(12) INTERNATIONAL APPLICATION PUBLISHED UNDER THE PATENT COOPERATION TREATY (PCT)

(19) World Intellectual Property

Organization

International Bureau



(10) International Publication Number

**WO 2012/015659 A3**

(43) International Publication Date  
2 February 2012 (02.02.2012)

(51) International Patent Classification:

*A61B 19/00* (2006.01) *B25J 9/06* (2006.01)  
*A61B 17/94* (2006.01) *B25J 18/06* (2006.01)  
*A61B 17/34* (2006.01)

(21) International Application Number:

PCT/US2011/044811

(22) International Filing Date:

21 July 2011 (21.07.2011)

(25) Filing Language:

English

(26) Publication Language:

English

(30) Priority Data:

61/368,257 28 July 2010 (28.07.2010) US

(71) Applicant (for all designated States except US): **MEDRO-BOTICS CORPORATION** [US/US]; 475 Paramount Drive, Raynham, Massachusetts 02767 (US).

(72) Inventors; and

(75) Inventors/Applicants (for US only): **OYOLA, Arnold** [US/US]; 405 Whitney Street, Northborough, Massachusetts 01532 (US). **STAND, Joseph** [US/US]; 273 Holden Street, Holden, Massachusetts 01520 (US). **GILMARTIN, Kevin** [US/US]; #1, 14 Concord Square, Boston, Massachusetts 02118 (US). **DARISSE, Ian** [US/US]; 157-A Prospect Hill Street, Newport, Rhode Island 02840 (US). **DIDOMENICO, Robert** [US/US]; 67 Medway Street, Norfolk, Massachusetts 02056 (US). **FLAHERTY, J. Christopher** [US/US]; 242 Ipswich Road, Topsfield, Massachusetts 01983 (US).

(74) Agents: **ONELLO, Anthony P., Jr.** et al.; Three Burlington Woods, Suite 203, Burlington, MA 01803-4532 (US).

(81) Designated States (unless otherwise indicated, for every kind of national protection available): AE, AG, AL, AM, AO, AT, AU, AZ, BA, BB, BG, BH, BR, BW, BY, BZ, CA, CH, CL, CN, CO, CR, CU, CZ, DE, DK, DM, DO, DZ, EC, EE, EG, ES, FI, GB, GD, GE, GH, GM, GT, HN, HR, HU, ID, IL, IN, IS, JP, KE, KG, KM, KN, KP, KR, KZ, LA, LC, LK, LR, LS, LT, LU, LY, MA, MD, ME, MG, MK, MN, MW, MX, MY, MZ, NA, NG, NI, NO, NZ, OM, PE, PG, PH, PL, PT, RO, RS, RU, SC, SD, SE, SG, SK, SL, SM, ST, SV, SY, TH, TJ, TM, TN, TR, TT, TZ, UA, UG, US, UZ, VC, VN, ZA, ZM, ZW.

(84) Designated States (unless otherwise indicated, for every kind of regional protection available): ARIPO (BW, GH, GM, KE, LR, LS, MW, MZ, NA, SD, SL, SZ, TZ, UG, ZM, ZW), Eurasian (AM, AZ, BY, KG, KZ, MD, RU, TJ, TM), European (AL, AT, BE, BG, CH, CY, CZ, DE, DK, EE, ES, FI, FR, GB, GR, HR, HU, IE, IS, IT, LT, LU, LV, MC, MK, MT, NL, NO, PL, PT, RO, RS, SE, SI, SK, SM, TR), OAPI (BF, BJ, CF, CG, CI, CM, GA, GN, GQ, GW, ML, MR, NE, SN, TD, TG).

Published:

- with international search report (Art. 21(3))
- before the expiration of the time limit for amending the claims and to be republished in the event of receipt of amendments (Rule 48.2(h))

(88) Date of publication of the international search report:

24 May 2012



**WO 2012/015659 A3**

(54) Title: SURGICAL POSITIONING AND SUPPORT SYSTEM

(57) Abstract: A system for performing a medical procedure is provided comprising at least one tool and a tool support for supporting a distal portion of the tool. An operator manipulates a human interface device and produces control signals sent to a controller. The controller manipulates the tool support based on the received control signals.

## **SURGICAL POSITIONING AND SUPPORT SYSTEM**

### **RELATED APPLICATIONS**

This application claims the benefit of United States Provisional Application Serial No. 61/368,257 filed July 28, 2010, which is incorporated herein by reference, in its entirety.

### **FIELD**

Embodiments relate generally to the field of robotics and more particularly, to three dimensional, flexible, steerable robotic devices.

### **BACKGROUND**

[001] There are numerous types of steerable multi-linked probes, and such devices are utilized in a variety of different applications. Robert Sturges' U.S. Pat. No. 5,759,151, which is hereby incorporated by reference in its entirety, discloses a flexible, steerable device for conducting exploratory procedures. The device includes at least one spine, each having stiffening means for selectively rendering the spine rigid and flexible along its length. A flexible sheath surrounds the spine and is axially slidably moveable relative to the spine so that the sheath will follow and conform to the shape of a spine in the rigid state and resist further flexure when the spine is in a relaxed state. A steerable distal tip is provided on the distal end of the device. Controls for the distal tip are mounted on the proximal end of the device. Mechanisms are provided on the distal end of the device for selectively activating and deactivating the stiffening means of the spine. An instrument conduit may be mounted on the sheath. Howie Choset's U.S. Pat. Application Serial # 11/630,279, which is hereby incorporated by reference in its

entirety, discloses a feeder mechanism for advancing and retracting both an inner core and an outer sleeve, as well as selectively applying tension to control cables used for steering and causing either the inner core or outer sleeve to transition between a rigid state and a limp state.

[002] U.S. Pat. No. 6,610,007 to Amir Belson, et. al., incorporated herein by reference in its entirety, discloses a steerable endoscope having an elongated body with a selectively steerable distal portion and an automatically controlled proximal portion. The endoscope body is inserted into a patient and the selectively steerable distal portion is used to select a desired path within the patient's body. When the endoscope body is advanced, an electronic motion controller operates the automatically controlled proximal portion to assume the selected curve of the selectively steerable distal portion. Another desired path is selected with the selectively steerable distal portion and the endoscope body is advanced again. As the endoscope body is further advanced, the selected curves propagate proximally along the endoscope body, and when the endoscope body is withdrawn proximally, the selected curves propagate distally along the endoscope body. This creates a serpentine motion in the endoscope body allowing it to negotiate tortuous curves along a desired path through or around and between organs within the body.

[003] For medical use and other critical applications, it is extremely important that each device not only perform as intended and within known specifications, but have repeatable performance and otherwise consistent operation from use to use. For these and other reasons, there is a need for systems, devices and methods which provide integrated calibration routines and mechanisms.

2011283048 31 Jan 2013

**SUMMARY**

[004] According to a first aspect, a system for performing a medical procedure, such as a TransOral Robotic Surgery (TORS) procedure, is disclosed. The system includes at least one tool comprising a proximal portion and a distal portion with a distal end. A tool support is configured to support the distal portion of the tool. A human interface device (HID) is used by an operator to manipulate the tool support. The human interface device produces control signals which are received by a controller which manipulates the tool support. In a preferred embodiment, the operator receives direct tactile feedback from the at least one tool. For example, during advancement, retraction, rotation or flexion, forces imparted on a distal portion of the tool are transmitted down the tool shaft to a handle held by the operator.

[005] In one embodiment, the tool support comprises an inner core of links and an outer sleeve of links, each configured to transition between a limp state and a rigid state. In another embodiment, the tool support is malleable, or includes a malleable component, such as to be hand formed into a preferred shape. In another embodiment, the tool support is made rigid by one or more of: cables; temperature change; chemical change such as change to an epoxy, glue or cement, or combinations of these.

[006] The tool support may include one or more guide holes or guide tubes configured to slidingly receive the shaft of one or more tools.

[007] According to another aspect, a method of performing a medical procedure is disclosed.

[008] In one aspect, a system for performing a medical procedure comprises: at least one tool comprising a proximal portion and a distal portion with a distal end; a tool support comprising at least one radially extending side lobe constructed and arranged to support the distal portion of the at least one tool; a human interface device constructed and arranged to create control signals based on operator input; and a controller constructed and arranged to receive the control signals and manipulate the tool support based on the received control signals.

[009] In some embodiments, the system is constructed and arranged to perform a TORS procedure.

[010] In some embodiments, the system is constructed and arranged to provide direct tactile feedback of forces encountered by the at least one tool.

[011] In some embodiments, the forces are forces encountered during advancement or retraction of the at least one tool.

[012] In some embodiments, the tool support comprises at least a malleable portion.

[013] In some embodiments, the tool support comprises a highly articulated probe comprising at least a portion that is controllably rigid and flexible.

[014] In some embodiments, the system further comprises at least one cable, wherein the tool support is constructed and arranged to transition between flexible and rigid when the at least one cable is tensioned.

[015] In some embodiments, the tool support is constructed and arranged to transition between flexible and rigid by a temperature change.

[016] In some embodiments, the tool support is constructed and arranged to transition between flexible and rigid by a chemical change.

2011283048 31 Jan 2013

[017] In some embodiments, the system further comprises a substance selected from the group consisting of: an epoxy; a cement; a glue; and combinations thereof, wherein the chemical change is a chemical change to said substance.

[018] In some embodiments, the tool support comprises at least a rigid portion.

[019] In some embodiments, the tool support comprises at least a flexible portion.

[020] In some embodiments, the tool support further comprises at least a rigid portion.

[021] In some embodiments, the tool support comprises a sleeve comprising a first set of links.

[022] In some embodiments, the set of links comprises a distal portion and the distal portion comprises at least one guide hole.

[023] In some embodiments, the system further comprises a guide tube.

[024] In some embodiments, the tool support further comprises an inner core surrounded by the sleeve and comprising a second set of links.

[025] In some embodiments, the at least one second set link is shorter than at least one first set link.

[026] In some embodiments, the tool support further comprises at least one flange surrounding at least one link of the first set of links and the at least one flange comprises at least one guide hole.

[027] In some embodiments, the flange comprises at least two guide holes.

[028] In some embodiments, the tool support further comprises at least two flanges surrounding at least two links of the first set of links.

[029] In some embodiments, a first flange has a geometry different than a second flange.

2011283048 31 Jan 2013

[030] In some embodiments, the tool support comprises at least three flanges surrounding at least three links of the first set of links.

[031] In some embodiments, the at least one flange is fixedly attached to the at least one link of the first set of links.

[032] In some embodiments, the at least one flange is rotatably attached to the at least one link of the first set of links.

[033] In some embodiments, the at least one flange is removably attached to the at least one link of the first set of links.

[034] In some embodiments, the first set of links includes at least one guide hole.

[035] In some embodiments, the system further comprises a guide tube positioned into or through the at least one guide hole.

[036] In some embodiments, the first set of links includes at least two guide holes.

[037] In some embodiments, a first guide hole is linearly aligned with a second guide hole. In some embodiments, a first guide hole is positioned approximately 180° from a second guide hole. In some embodiments, a first guide hole is positioned approximately 120° from a second guide hole.

[038] In some embodiments, the system further comprises a camera lens positioned approximately 120° from the first guide hole and the second guide hole.

[039] In some embodiments, the tool support comprises a distal portion comprising at least one guide hole.

[040] In some embodiments, the system further comprises a guide tube comprising a lumen that is collinear with the at least one guide hole.



2011283048 31 Jan 2013

[041] In some embodiments, the guide tube is constructed and arranged to be inserted into the guide hole.

[042] In some embodiments, the guide tube is fixedly attached to the guide hole.

[043] In some embodiments, the system further comprises at least one guide tube.

[044] In some embodiments, the tool support comprises a distal portion and the at least one guide tube is attached to said distal portion.

[045] In some embodiments, the at least one guide tube is removably attached to said distal portion.

[046] In some embodiments, the system further comprises a tool support introducer wherein the at least one guide tube is attached to the tool support introducer.

[047] In some embodiments, the at least one guide tube is removably attached to the tool support introducer.

[048] In some embodiments, the at least one guide tube comprises at least one flexible portion.

[049] In some embodiments, the at least one guide tube comprises at least one rigid portion.

[050] In some embodiments, the at least one guide tube comprises at least one flexible portion and at least one rigid portion.

[051] In some embodiments, the tool support comprises a distal portion comprising a distal end.

[052] In some embodiments, the distal portion comprises a distal link.

[053] In some embodiments, the distal link is constructed and arranged to be rotated.

2011283048 31 Jan 2013

[054] In some embodiments, the distal portion further comprises a camera component selected from the group consisting of: a camera such as a CCD; a lens; a fiber optic; and combinations thereof.

[055] In some embodiments, the camera component comprises a center and said center is positioned off center from a central axis of the distal portion.

[056] In some embodiments, the distal end comprises a diameter and said camera component center is positioned at least 25% of the diameter from the central axis.

[057] In some embodiments, the system further comprises a guide hole wherein the camera component is constructed and arranged to move in synchrony with an axis of the guide hole.

[058] In some embodiments, the distal portion further comprises at least one light element.

[059] In some embodiments, the at least one light element comprises at least one LED.

[060] In some embodiments, the at least one light element is constructed and arranged to emit one or more of: visible light; infrared light; and ultraviolet.

[061] In some embodiments, the distal portion further comprises at least one tool channel and exit hole.

[062] In some embodiments, the tool support comprises an outer sleeve and an inner core, and wherein the tool channel extends proximally between the outer sleeve and the inner core.

[063] In some embodiments, the at least one tool channel is constructed and arranged to supply a tool to the distal end of the tool support.

[064] In some embodiments, the distal end is constructed and arranged to minimize reflections of visible light.

[065] In some embodiments, the distal end comprises a matte surface.

[066] In some embodiments, the distal end comprises a dark color.

[067] In some embodiments, the distal end comprises a color approximating black.

[068] In some embodiments, the distal portion comprises at least one recess along its length.

[069] In some embodiments, the at least one tool comprise a shaft and wherein the recess is constructed and arranged to allow said shaft to pass therethrough.

[070] In some embodiments, the tool support comprises a highly articulated probe, comprising: an outer sleeve comprising a first plurality of links; an inner core comprising a second plurality of links; a first cable extending through either said plurality of links of the inner core or said plurality of links of the outer sleeve and a plurality of cables running through the other of said plurality of links of the inner core or said plurality of links of the outer sleeve.

[071] In some embodiments, the system further comprises a feeder assembly constructed and arranged to alternate each of said inner core and outer sleeve between a limp mode and a rigid mode, for advancing and retracting said inner core and outer sleeve, and for steering at least one of said inner core and outer sleeve.

[072] In some embodiments, the controller comprises a CPU.

[073] In some embodiments, the controller comprises a cable tensioning assembly.

[074] In some embodiments, the controller comprises a temperature modifying assembly.

2011283048 31 Jan 2013

[075] In some embodiments, the controller comprises a delivery device.

[076] In some embodiments, the controller is constructed and arranged to deliver one or more of: epoxy; cement; and glue.

[077] In some embodiments, the at least one tool comprises a handle attached to the at least one tool proximal portion.

[078] In some embodiments, the handle comprises a control.

[079] In some embodiments, the control is selected from the group consisting of: a trigger; a knob; a lever; a button; a lock; and combinations thereof.

[080] In some embodiments, the control is constructed and arranged to perform one or more of the following actions; operate the at least one tool such as to apply power to the at least one tool; and move a portion of the at least one tool such as to advance, retract or rotate a portion of the tool.

[081] In some embodiments, the at least one tool distal portion comprises a functional element.

[082] In some embodiments, the functional element is selected from the group consisting of: grasper; cutter; ablater; cauterizer; drug delivery element; radiation source; sensor such as an EKG electrode, pressure sensor or blood sensor; magnet; heating element; cryogenic element; and combinations thereof.

[083] In some embodiments, the at least one tool distal portion is a steerable.

[084] In some embodiments, the at least one tool comprises a rigid portion proximal said steerable tool distal portion.

[085] In some embodiments, the at least one tool comprises a flexible portion proximal said rigid portion.

[086] In some embodiments, the at least one tool comprises a flexible portion proximal said steerable tool distal portion.

2011283048 31 Jan 2013

[087] In some embodiments, the at least one tool comprises a rigid portion proximal said tool flexible portion.

[088] In some embodiments, the at least one tool comprises a rigid portion between said tool steerable portion and said tool flexible portion.

[089] In some embodiments, the system further comprises a tool holder constructed and arranged to attach to the at least one tool proximal portion.

[090] In some embodiments, the tool holder comprises mounting means.

[091] In some embodiments, the mounting means is configured to rapidly release.

[092] In some embodiments, the mounting means is configured to rapidly rotate.

[093] In some embodiments, the tool holder is constructed and arranged to operably position the at least one tool.

[094] In some embodiments, the tool holder is constructed and arranged to allow the distal portion to advance and/or retract when the at least one tool is attached to the tool holder.

[095] In some embodiments, the tool holder is constructed and arranged to allow the distal portion to rotate when the at least one tool is attached to the tool holder.

[096] In some embodiments, the tool holder is constructed and arranged to prevent movement of at least a portion of the at least one tool when the at least one tool is attached to the tool holder.

[097] In some embodiments, the human interface device is constructed and arranged to simultaneously advance and steer the tool support.

[098] In some embodiments, the tool support comprises an outer sleeve comprising a first set of links and an inner core comprises a second set of links.

2011283048 31 Jan 2013

[0099] In some embodiments, the system is constructed and arranged to advance and steer the outer sleeve simultaneously based on input from the human interface device.

[0100] In some embodiments, the outer sleeve comprises a distal end and the inner core comprises a distal end and wherein the system is constructed and arranged to advance the outer sleeve distal end up to approximately 2.5 cm beyond the inner core distal end.

[0101] In some embodiments, the system is constructed and arranged to advance the inner core distal end up to the outer sleeve distal end without operator input after the outer sleeve has been simultaneously advanced and steered.

[0102] In some embodiments, the human interface device comprises a haptic controller.

[0103] In some embodiments, the system further comprises a console.

[0104] In some embodiments, the human interface device is attached and/or integral to the console.

[0105] In some embodiments, the console comprises a user interface.

[0106] In some embodiments, the system further comprises a second tool comprising a proximal portion and a distal portion with a distal end.

[0107] In some embodiments, the tool support is further constructed and arranged to support the second tool distal portion.

[0108] In some embodiments, the system further comprises a tool support introducer comprises a tube constructed and arranged to slidably receive the tool support.

[0109] In some embodiments, the tool support introducer is constructed and arranged for insertion into the esophagus.

[0110] In some embodiments, the tool support introducer further comprises at least one guide tube.

[0111] In some embodiments, the at least one guide tube comprises a rotatable coupler along its length.

[0112] In some embodiments, the rotatable coupler is constructed and arranged to frictionally engage and gravitationally support the at least one guide tube.

[0113] In some embodiments, the rotatable coupler is constructed and arranged to lock the at least one guide tube such that movement is prevented when a force is applied to the at least one guide tube.

[0114] In some embodiments, the rotatable coupler comprises a cam lock.

[0115] In some embodiments, the cam is operably attached to a lever.

[0116] In some embodiments, the at least one guide tube comprises a flared proximal end.

[0117] Deleted

[0118] In some embodiments, the tool support comprises a proximal end comprising two or more projections constructed and arranged to guide and/or orient insertion of the tool support.

[0119] In some embodiments, the tool support tube comprises a proximal portion and a distal portion.

[0120] In some embodiments, the tool support further comprises a second proximal portion different than the first proximal portion.

[0121] In some embodiments, the tool support further comprises a second distal portion different than the first distal portion.

[0122] In some embodiments, the tool support introducer further comprises an attachment mechanism.

[0123] In some embodiments, the system further comprises an intubation tube.

[0124] In some embodiments, the tool support is constructed and arranged to be positioned anterior to the intubation tube in the esophagus.

[0125] In some embodiments, the operator is a clinician.

[0126] In some embodiments, the clinician is a surgeon.

[0127] In another aspect, a method of performing a surgical procedure comprises: selecting the system of any embodiments described herein; and manipulating the tool support to position the at least one tool.

[0128] In some embodiments, the method further comprises placing the tool support in a curvilinear configuration and transitioning the tool support to a rigid state.

[0129] In some embodiments, transitioning the tool support to a rigid state comprises placing one or more cables in tension.

[0130] In some embodiments, transitioning the tool support to a rigid state comprises freezing at least a portion of the tool support.

[0131] In some embodiments, transitioning the tool support to a rigid state comprises hardening one or more of: cement; epoxy; glue; and combinations thereof.

[0132] In some embodiments in a system as described in reference to the figures, the tool shafts exit the patient's mouth and travel in a superior direction.

[0133] In some embodiments in a system as described in reference to the figures, the tool support shaft exits the patient's mouth and does not travel in a superior direction.

[0134] In some embodiments in a system as described in reference to the figures, the tool support shaft exits the patient's mouth and travels in an inferior direction.



2011283048 31 Jan 2013

[0135] In another aspect, a tool support is described in reference to the embodiments described herein.

[0136] In another aspect, a method of performing a medical procedure is described in reference to the system of any of the embodiments described herein.

### **BRIEF DESCRIPTION OF THE DRAWINGS**

[0137] The accompanying drawings, which are incorporated in and constitute a part of this specification, illustrate various embodiments of the present inventive concepts, and together with the description, serve to explain the principles of the inventive concepts. In the drawings:

[0138] Fig. 1 illustrates a perspective view of a system for performing a medical procedure, in accordance with the present inventive concepts;

[0139] Fig. 2 illustrates a perspective view of the system of Fig. 1 with a tool support in a curvilinear configuration, in accordance with the present inventive concepts;

[0140] Fig. 3 illustrates a perspective view of the system of Fig. 1 with a tool support advanced, in accordance with the present inventive concepts;

[0141] Fig. 4 illustrates a side view of the distal end of a tool support and the distal portions of two tools, in accordance with the present inventive concepts;

[0142] Fig. 4A illustrates a perspective view of handles of the two tools of Fig. 4, in accordance with the present inventive concepts;

[0143] Fig. 5 illustrates a perspective view of the distal end of the tool support and tools of Fig. 4, in accordance with the present inventive concepts;

[0144] Fig. 5A illustrates a perspective view of the handles of Fig. 5;

2011283048 31 Jan 2013

[0145] Fig. 6 illustrates a perspective view of the distal end of the tool support and tools of Fig. 4, in accordance with the present inventive concepts;

[0146] Fig. 6A illustrates a perspective view of the handles of Fig. 5;

[0147] Fig. 7 illustrates a perspective view of a system for performing a medical procedure, in accordance with the present inventive concepts;

[0148] Fig. 8 illustrates a perspective view of a tool support introducer, in accordance with the present inventive concepts;

[0149] Fig. 9 illustrates a side view of a tool, in accordance with the present inventive concepts;

[0150] Fig. 9A illustrates a side view of the tool of Fig. 9 with a distal portion manipulated to a curvilinear configuration, in accordance with the present inventive concepts;

[0151] Fig. 10 illustrates a side sectional view of a tool support and two tools, in accordance with the present inventive concepts;

[0152] Fig. 10A illustrates an end view of the distal end of the tool support of Fig. 10, in accordance with the present inventive concepts;

[0153] Fig. 11 illustrates a side sectional view of a tool support and two tools, in accordance with the present inventive concepts;

[0154] Fig. 11A illustrates a side sectional view of the distal end of the tool support of Fig. 10, in accordance with the present inventive concepts;

[0155] Fig. 12 illustrates a side sectional view of a tool support and two tools, in accordance with the present inventive concepts;

[0156] Fig. 13 illustrates a perspective view of a system for performing a medical procedure, in accordance with the present inventive concepts;

2011283048 31 Jan 2013

[0157] Fig. 14A illustrates a perspective view of a tool support introducer including lockable, rotatable couplers, in accordance with the present inventive concepts; and

[0158] Fig. 14B illustrates a detailed view of the lockable, rotatable couplers of Fig. 14A, in accordance with the present inventive concepts.

### DETAILED DESCRIPTION OF EMBODIMENTS

[0159] Reference will now be made in detail to the present embodiments of the invention, examples of which are illustrated in the accompanying drawings. Wherever possible, the same reference numbers will be used throughout the drawings to refer to the same or like parts.

[0160] Provided herein is a system for performing a medical procedure including one or more tools that are operably attached to a tool support. An operator, such as a clinician, operates a human interface device (HID) to manipulate or otherwise control the tool support. A controller receives signals from the HID and controls the tool support based on these signals.

[0161] **Referring now to Fig. 1**, a system in accordance with the present inventive concepts is illustrated, with the patient removed for clarity. System 100 comprises probe 10, such as a highly articulated probe described in U.S. Patent Application Serial # 11/630,279 titled STEERABLE, FOLLOW THE LEADER DEVICE, or U.S. Patent Application Serial #11/838,519 titled STEERABLE MULTI LINKED DEVICE HAVING MULTIPLE WORKING PORTS, both incorporated by reference in their entirety herein. Probe 10, an exemplary tool support of the present invention, comprises feeder 110 which controllably advances one or more cables within outer sleeve 30 of probe 10, such as a cable, not shown, but extending to distal link 31.

System 100 further comprises console 160 which includes user interface 161, monitor 120, and HID 150. Monitor 120 may be used to display output of a camera, such as a camera integral to distal link 31 of probe 10.

[0162] HID 150, typically a haptic controller, joystick, track ball, mouse, or other control device known to those of skill in the art of robotics or other electromechanical device control. HID 150 includes handle 151 configured to manipulate distal end 31 of probe 10.

[0163] Outer sleeve 30 includes near its distal end, guide tube 339a and guide tube 339b, each including at least one lumen, not shown, but configured to slidably receive the distal portion of one or more tools, also not shown but described in detail herebelow. Guide tubes 339a and 339b may be flexible, rigid, or include flexible and rigid portions.

[0164] Feeder 110 is mounted to table T via support 111. Alternatively or additionally, feeder 110 may be mounted to console 160 or a separate support device.

[0165] **Referring now to Fig. 2**, system 100 of Fig. 1 is illustrated with the outer sleeve 30 flexed toward the right of the page, such as via manipulation of handle 151 of HID 150 to the left of the page, as shown. In an alternative embodiment, handle 151 is manipulated to the right to cause outer sleeve 30 to flex to the right. Other manipulations of handle 151 (e.g. rotating, pulling or pushing, and twisting) and manipulations of other portions or components of HID 150 can be used to advance or retract outer sleeve 30, rotate or flex sleeve 30, activate one or more functional elements of sleeve 30 or probe 10, and the like.

2011283048 31 Jan 2013

[0166] Referring now to Fig. 3, system 100 of Fig. 1 is illustrated with the outer sleeve 30 and distal end 31 advanced forward, such as via manipulation of handle 151 HID 150 forward, bending elbow 152, as shown.

[0167] Referring now to Fig. 4, a tool support of the present disclosure is illustrated supporting two tools, with the patient removed for clarity. Probe 10 includes outer sleeve 30 comprising a plurality of outer links 29. At the distal end of sleeve 30 is distal link 31 which typically includes a camera, lighting elements and exits for one or more tool channels, all not shown, but described in detail herebelow. Outer sleeve 30 further includes flanges 36a and 36b which comprise guide holes 37a and 37b, respectively. Tool shaft 230a of tool 200a has been passed through guide hole 37a and tool shaft 230b of tool 200b has been passed through guide hole 37b. Located on the distal end of tool 200a is a functional element, working end 220a. Located on the distal end of tool 200b is another functional element, working end 220b. Functional elements are typically selected from the group consisting of: grasper; cutter; ablater; cauterizer; drug delivery element; radiation source; sensor such as an EKG electrode, pressure sensor or blood sensor; magnet; heating element; cryogenic element; and combinations of these. Referring additionally to Fig. 4A, handle 210a of tool 200a and handle 210b of tool 200b are illustrated. Handles 210a and 210b may include one or more controls, such as triggers; knobs; levers; buttons; locks; and combinations of these. As illustrated, handles 210a and 210b include triggers 211a and 211b, respectively, such as a trigger to actuate, deploy or otherwise control the working elements 220a and 220b, respectively. Handles 210a and 210b include rotating knobs 212a and 212b, respectively, such as knobs configured to rotate shafts 230a and 230b, respectively. Handles 210a and 210b include locking levers 213a and 213b, respectively, such as

levers configured to lock one or more movable portions of tools 200a and 200b. Handles 210a and 210b include pivot joints 214a and 214b, respectively, which are configured to allow handles 210a and 210b to flex such as to flex shafts 230a and 230b, respectively.

[0168] Referring now to Figs. 5 and 5A, probe 10 of Fig. 4 and 4A is illustrated with the distal portion of tool 200b flexed toward the left of the page, such as by rotating handle 210b left an angle  $\beta$ . Shaft 230b and working portion 220b have been rotated, such as by rotating knob 212b. Lock 213b has been engaged such that shaft 230b will maintain the flexed position shown in Fig. 5.

[0169] Also as shown in Fig. 5, distal link 31 includes camera 50 positioned toward the bottom of distal link 31, as shown on the page. At 120° separation from camera 50 are channels 32 and 33, preferably working lumens or ports, such as those described in reference to U.S. Patent Application Serial #11/838,519, titled STEERABLE MULTI LINKED DEVICE HAVING MULTIPLE WORKING PORTS, incorporated herein by reference, in its entirety, and extending proximally to the proximal end of probe 10 such that one or more devices can be inserted therethrough. In a particular embodiment, channels 32 and/or 33 are used as a flush port, such as to improve an image provided by camera 50. Distal link 31 further includes light elements, LEDs 51, typically visible light devices, but alternatively or additionally infrared or ultraviolet sources used to enhance or create an image from camera 50.

[0170] Distal link 31 also includes recesses 38a and 38b which allow shafts 230a and 230b of tools 200a and 200b, respectively, to pass therethrough. Distal link 31 is provided with a chamfered or rounded edge 34 such as to avoid trauma to tissue during insertion into the human body.

2011283048 31 Jan 2013

[0171] Distal link 31 can be constructed to minimize reflections of visible light, for example, distal link 31 can be a matte material and/or a dark color, such as black.

[0172] **Referring now to Figs. 6 and 6A**, probe 10 of Fig. 5 and 5A is illustrated with the distal portion of tool 200a flexed toward the right of the page, such as by rotating handle 210a right at angle  $\alpha$ . Lock 213a has been engaged such that shaft 230a will maintain the flexed position shown in Fig. 6.

[0173] **Referring now to Fig. 7**, a system in accordance with the present inventive concepts is illustrated including two tools and a tool support, patient not shown for clarity. System 100 includes feeder 110 which is fixedly attached to support 111, attached to table T. Probe 10 is positioned and configured as has been described in detail hereabove, and is operably attached to console 160, attachment not shown but typically a conduit including electrical wires, fiber optic cables, fluid tubing (e.g. for flushing or hydraulic/pneumatics), mechanical linkages, and the like. Tool 200a and tool 200b are shown operably attached to tool holder 250a and tool holder 250b, respectively. Tools 200a and 200b include handles 210a and 210b, respectively. Tools shafts 230a and 230b extend from handles 210a and 210b, respectively. Tool shafts 230a and 230b have been inserted into funnels 342a and 342b, respectively, of guide tubes 339a and 339b, respectively. Guide tubes 339a and 339b each include a guide hole, as described herein, typically a lumen extending from one end to the other of guide tubes 339a and 339b, sized to accommodate the working portions 220a and 220b, and associated shafts 230a and 230b of tools 200a and 200b.

2011283048 31 Jan 2013

[0174] **Referring now to Fig. 8**, a tool support introducer in accordance with the present inventive concepts is illustrated. Introducer 300 includes a shaft comprising upper portion 310a which is attachable to lower portion 310b via coupler 320. Coupler 320 comprises bracket 321 which includes slot 322 positioned and sized to fit over a device such as a retractor placed in the patient's mouth.

[0175] Introducer 300 includes lumen 301 extending from its proximal end 311 to its distal end 312. Lumen 301 is sized to slidably receive a tool support of the present disclosure, such as probe 10 of Fig. 1. Proximal end 311 includes projections 313 which are sized and positioned to orient a tool support, such as a tool support including radially extending flanges, such as probe 10 of Fig. 4. Introducer 300 includes radially extending side lobes 302a and 302b, which are sized and positioned to slidably receive a radially extending member, such as the radially extending flanges of probe 10 of Fig. 4.

[0176] Introducer 300 includes two guide tubes comprising proximal portions 340a and 340b, and distal portions 341a and 341b (not shown but located behind upper shaft 310a), connected with rotating couplers 330a and 330b, respectively. Rotatable couplers 330a and 330b, typically frictionally engaged ball joints configured to provide gravitational support, may be detachable. Rotatable couplers 330a and 330b frictionally engage the guide tubes such that guide tube proximal portions 340a and 340b are supported and free to move relative to the rotation means within coupler 330a and 330b, respectively. Rotatable couplers 330a and 330b can be locked once the guide tubes are in a desired position and orientation relative to the user. In a locked state, couplers 330a and 330b prevent movement of the guide tubes when a force is applied, such as a force applied during manipulation of a tool. Funnels 342a and 342b are configured to



ease insertion of the distal portion of one or more tools, and are attached to guide tube proximal portions 340a and 340b, respectively.

[0177] **Referring now to Fig. 9**, a tool in accordance with the present inventive concepts is illustrated. Tool 200 includes handle 210 which includes control 215, typically a button, lever, switch, knob, trigger, and the like. Extending from handle 210 is shaft 230, shown in a relatively linear orientation, which comprises a rigid portion 231, a flexible portion 232, a second rigid portion 233, a pivot point 234, and a distal portion 235, typically a flexible portion. Distal portion 235 includes working end 220, such as has been described in detail hereabove. Referring now to Fig. 9A, distal portion 235 has been rotated about pivot point 234, such as via rotation or other form of activation of control 215 of handle 210.

[0178] **Referring now to Fig. 10**, a sectional view of a tool support in accordance with the present inventive concepts is illustrated. Probe 10 comprises an inner core comprising a set of inner links 21, and an outer sleeve comprising a set of outer links 29. Near the distal portion of probe 10, multiple flanges 36 surround outer links 29. One or more flanges 36 may be attachable and/or detachable to or from outer links 29, and/or they may be permanently attached. Flanges 36 may be configured to rotate about outer links 29. At the distal end of probe 10 is distal link 31. One or more cables passes through a lumen and/or wall of inner link 21, cable not shown but described in detail in reference to U.S. Patent Application Serial #11/630,279 titled "STEERABLE FOLLOW THE LEADER DEVICE", incorporated herein by reference, in its entirety. Typically three cables 35 (two shown) pass through the walls of outer links 29 and terminate at fixation

point 39 within distal link 31. Movement of the inner cables or outer cables 35 can be used to bend probe 10 and make the inner and outer sleeve rigid, respectively.

[0179] Tools 200a and 200b include shafts 230a and 230b, respectively, which have been inserted through guide holes 37a and 37b of flanges 36. Tools 200a and 200b include working ends 220a and 220b, respectively.

[0180] Referring now to Fig. 10A, an end view of the probe of Fig. 10 is illustrated. Distal link 31 includes camera 50, LEDS 51, channel 32, channel 33, and recess 38a and recess 38b, as has been described hereabove. Also shown is flange 36 which includes guide holes 37a and 37b. In one embodiment, guide holes 37a and 37b are spaced 180° apart. In an alternate embodiment, guide holes 37a and 37b are spaced 120° apart.

[0181] **Referring now to Fig. 11**, a sectional view of the tool support of Fig 10 is illustrated with the inner core retracted with its distal link just proximal to the distal link of the outer sleeve. Distal most inner link 21' has been retracted, such as via one or more cables, not shown but controlled by a controller of the present invention, such that no portion of inner link 21' is within distal link 31. Cable 39' has been retracted such that distal link 31 pivots toward the bottom of the page (cable 39'' may be simultaneously advanced to support the rotation). Since distal flange 36' has not rotated, working ends 220a and 220b of tools 200a and 200b remain as positioned in Fig. 10. Camera 50, not shown but described in reference to Fig. 10a, has its viewing window moved proportional with the movement of distal link 31. As shown in Fig. 11a, as distal link 31 is pivoted, tool shaft 230b enters recess 38b of distal link 31.

2011283048 31 Jan 2013

[0182] Referring now to Fig. 12, a sectional view of the tool support of Figs. 10 and 11 is illustrated with the inner core retracted with its distal link just proximal to the last outer link prior to the distal link. Distal most inner link 21' has been retracted, such as via one or more cables, not shown but controlled by a controller of the present invention, such that no portion of inner link 21' is within outer link 29'. Cable 39' has been retracted such that distal link 31 and outer link 29' pivots toward the bottom of the page (cable 39' may be simultaneously advanced to support the rotation). Distal link 31 and outer link 29' may be fixedly attached, attachment not shown, such that they remain in the linear alignment shown in Fig. 12. Distal flange 36' has rotated with outer link 29', and working ends 220a and 220b of tools 200a and 200b rotate accordingly. Camera 50, not shown but described in reference to Fig. 10a, has its viewing window moved proportional with the movement of distal link 31, outer link 29' and flange 36'.

[0183] Referring now to Figs. 13 and 13A, a perspective view of a system in accordance with the present inventive concepts is illustrated inserted into the esophagus of a patient. System 100 includes probe 10 which has integral and/or feeder 110 attached to tool support introducer 300. Outer sleeve 30 is slidingly received by tool support 300, with both positioned in the esophagus of patient P. Guide tubes 339a and 339b (339a not shown), each of which include a lumen or other guide hole of the present invention therethrough, are attached to outer sleeve 30 at or near distal link 31. Tool 200b, which includes controls 211b, 212b and 213b as have been described hereabove, is supported by tool holder 250b such that shaft 230b can be can be advanced, retracted, and/or rotated. Tool 200b shaft 230b is inserted through funnel 342b and into a guide tube 339b. Tool 200a is similarly positioned and inserted.

2011283048 31 Jan 2013

[0184] Referring now to Fig. 14A, a tool support introducer including lockable, rotatable couplers is illustrated. Fig. 14B illustrates a detailed view of the components of the lockable, rotatable couplers, with some components removed for clarity. Introducer 300 includes shaft 310, typically including a lumen, not shown, but sized to fit a probe, for example, probe 10 as described in reference to Fig. 1 hereabove.

[0185] Introducer 300 includes two guide tubes 339a and 339b, each configured for insertion of the shaft of a tool, not shown but typically a tool configured to controllably manipulate and/or operate one or more of: a grasper; a cutter; an ablater; a cauterizer; a drug delivery element; a radiation source; a sensor such as an EKG electrode, a pressure sensor or blood sensor; a magnet; a heating element; a cryogenic element; and combinations of these. Alternatively or additionally, guide tubes 339a and 339b may be configured for insertion of an additional guide tube, such as a semi-rigid guide tube or a flexible guide tube that can extend and provide support beyond the distal ends of guide tube 339a or 339b. Guide tubes 339a and 339b are connected to lockable, rotatable couplers 400a and 400b, respectively. Couplers 400a and 400b, typically cam-lockable ball joints, may be detachable. Coupler 400a includes an actuator, lever 401a. Movement of lever 401a in one direction, for example, a downward direction relative to a user, rotates cam sleeve 402a to apply a force that linearly displaces cam 403a which closes gap 405a, locking ball 406a in place, thus placing guide tube 339a in a locked state. In this locked state, movement of guide tube 339a is prevented, including when a force is applied, such as when a force is applied during manipulation of a tool whose shaft has been inserted through guide tube 339a.

[0186] Conversely, movement of lever 401a in the opposite direction, i.e. an upward direction relative to the user, rotates cam sleeve 402a to release the force applied to cam 403a allowing cam 403a to linearly displace in the opposite direction,

increasing gap 405a. The increase in gap 405a releases the force applied to ball 406a, placing guide tube 339a in an unlocked state. In this unlocked state, guide tube 339a remains frictionally engaged with coupler 400a, such that guide tube 339a is gravitationally supported but free to move (e.g. by the hand of an operator) relative to ball 406a. Additionally, coupler 400a may include a screw, including screw head 407a, that is fixed in place, such as via an adhesive, to prevent loosening. Screw head 407a can provide a bearing surface for cam sleeve 402a. Coupler 400a includes insert 404a that provides a surface against which cam 403a translates.

[0187] Coupler 400b components are similar to that of coupler 400a, for example, coupler 400b includes lever 401b, gap 405b, and ball 406b. Additionally, the functionality of the coupler 400b and its components are typically the same or similar to that of coupler 400a.

[0188] While the preferred embodiments of the devices and methods have been described in reference to the environment in which they were developed, they are merely illustrative of the principles of the present inventive concepts. Modification or combinations of the above-described assemblies, other embodiments, configurations, and methods for carrying out the inventive concepts, and variations of aspects of the inventive concepts that are obvious to those of skill in the art are intended to be within the scope of the claims. In addition, where this application has listed the steps of a method or procedure in a specific order, it may be possible, or even expedient in certain circumstances, to change the order in which some steps are performed, and it is intended that the particular steps of the method or procedure claim set forth herebelow not be construed as being order-specific unless such order specificity is expressly stated in the claim.

[0189] The terms “comprises,” “comprising,” “including,” and “having,” and variations thereof are inclusive and therefore specify the presence of stated features, integers, steps, operations, elements, and/or components, but do not preclude the presence or addition of one or more other features, integers, steps, operations, elements, components, and/or groups thereof.

THE CLAIMS DEFINING THE INVENTION ARE AS FOLLOWS:

1. A system for performing a medical procedure comprising:
  - at least one tool comprising a proximal portion and a distal portion with a distal end;
  - a tool support comprising at least one radially extending side lobe constructed and arranged to support the distal portion of the at least one tool, wherein the tool support comprises a highly articulated probe, comprising:
    - an outer sleeve comprising a first plurality of links; and
    - an inner core comprising a second plurality of links, wherein the at least one side lobe extends radially from an outermost surface of at least one link of the first plurality of links of the outer sleeve;
  - a human interface device constructed and arranged to create control signals based on operator input; and
  - a controller constructed and arranged to receive the control signals and manipulate the tool support based on the received control signals.
2. The system of claim 1 wherein the tool support comprises a highly articulated probe, comprising:
  - a first cable extending through either said plurality of links of the inner core or said plurality of links of the outer sleeve and a plurality of cables running through the other of said plurality of links of the inner core or said plurality of links of the outer sleeve.
3. The system of claim 2 further comprising a feeder assembly constructed and arranged to alternate each of said inner core and outer sleeve between a limp mode and a rigid mode, for advancing and retracting said inner core and outer sleeve, and for steering at least one of said inner core and outer sleeve.
4. The system of any one of the preceding claims wherein the tool support comprises a highly articulated probe comprising at least a portion that is controllably rigid and flexible.

5. The system of any one of the preceding claims wherein the at least one radially extending side lobe comprises multiple radially extending side lobes each constructed and arranged to support the distal portion of the at least one tool.
6. The system of claim 2 or 3 wherein the at least one radially extending side lobe is rotatably attached to the at least one link of the plurality of links of the outer sleeve.
7. The system of any one of claims 2, 3, or 6 wherein the at least one radially extending side lobe is removably attached to the at least one link of the plurality of links of the outer sleeve.
8. The system of any one of the preceding claims further comprising at least one guide tube constructed and arranged to slidingly receive the at least one tool.
9. The system of claim 8 wherein the tool support comprises a distal portion and the at least one guide tube is attached to said distal portion.
10. The system of claim 9 wherein the at least one guide tube is removably attached to said distal portion.
11. The system of any one of claims 8 to 10 further comprising a tool support introducer wherein the at least one guide tube is attached to the tool support introducer.
12. The system of claim 11 wherein the at least one guide tube is removably attached to the tool support introducer.
13. The system of any one of claims 8 to 12 wherein the at least one guide tube comprises at least one of: a flexible portion, a rigid portion, or a rotatable coupler.

14. The system of any one of claims 8 to 13 wherein the at least one guide tube comprises a funnel shaped opening.

15. The system of any one of the preceding claims 8 to 14 wherein the at least one guide tube comprises a first guide tube, wherein the at least one tool comprises a first tool, and wherein the system further comprises a second tool and a second guide tube constructed and arranged to slidingly receive the second tool.

16. The system of any one of the preceding claims wherein the controller comprises a cable tensioning assembly.

17. The system of any one of the preceding claims wherein the at least one tool distal portion comprises a functional element elected from the group consisting of: grasper; cutter; ablater; cauterizer; drug delivery element; radiation source; sensor such as a EKG electrode, pressure sensor or blood sensor; magnet; heating element; cryogenic element; and combinations thereof.

18. The system of any one of the preceding claims further comprising a tool holder constructed and arranged to attach to the at least one tool proximal portion.

19. The system of any one of the preceding claims further comprising a tool support introducer comprises a tube constructed and arranged to slidingly receive the tool support.

20. The system of claim 19 wherein the tool support introducer is constructed and arranged for insertion into the esophagus.



Fig. 1

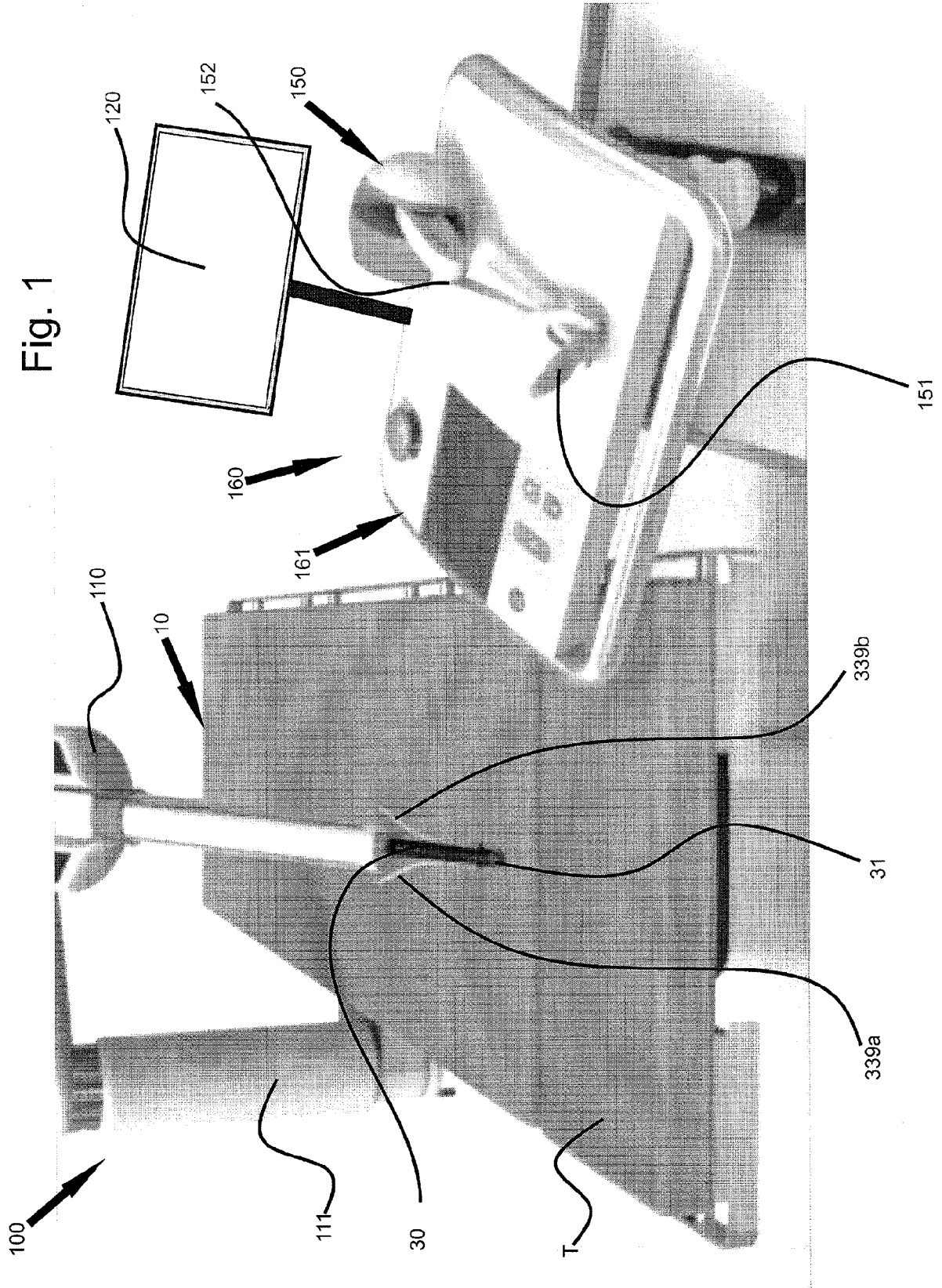

Fig. 2

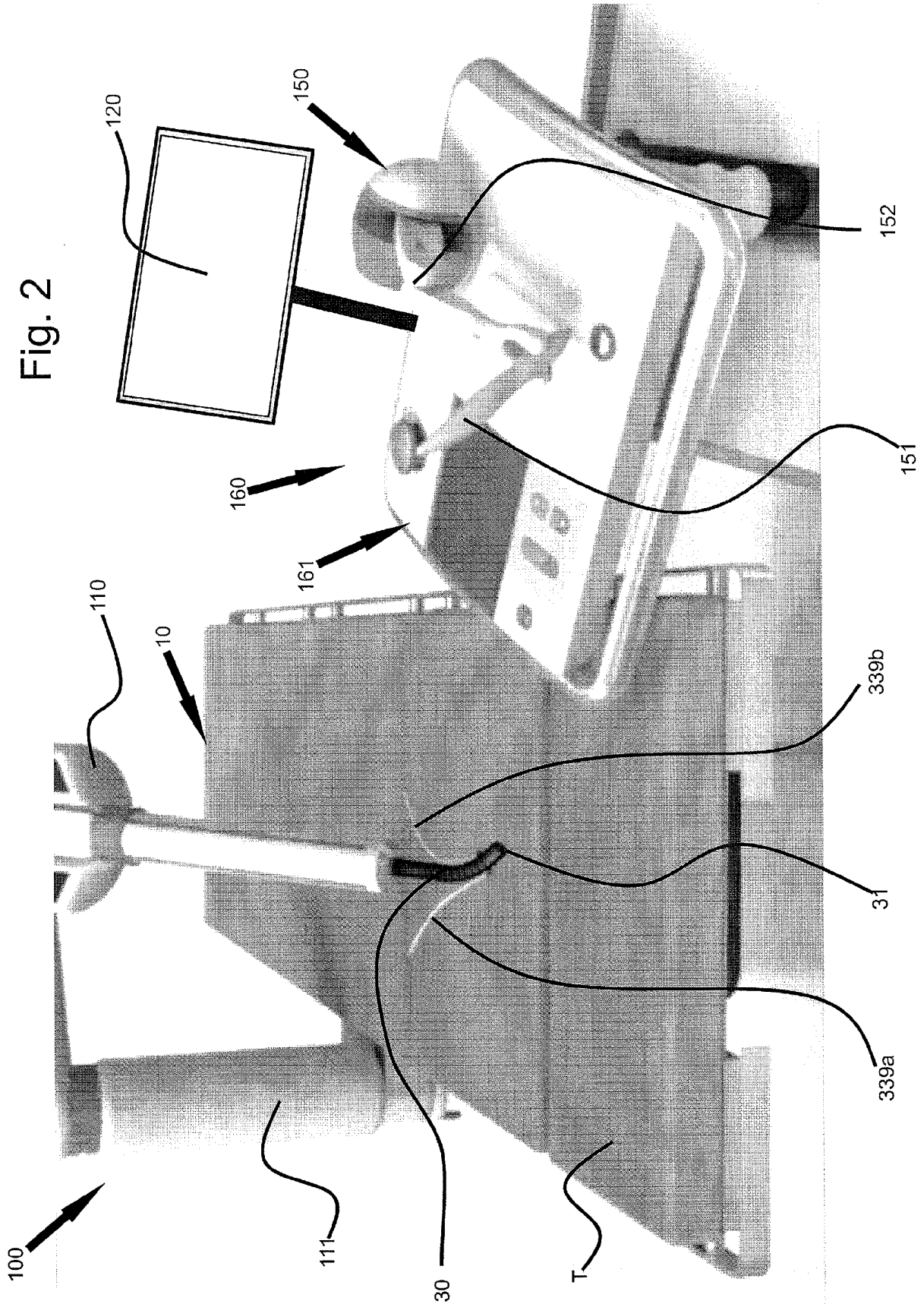
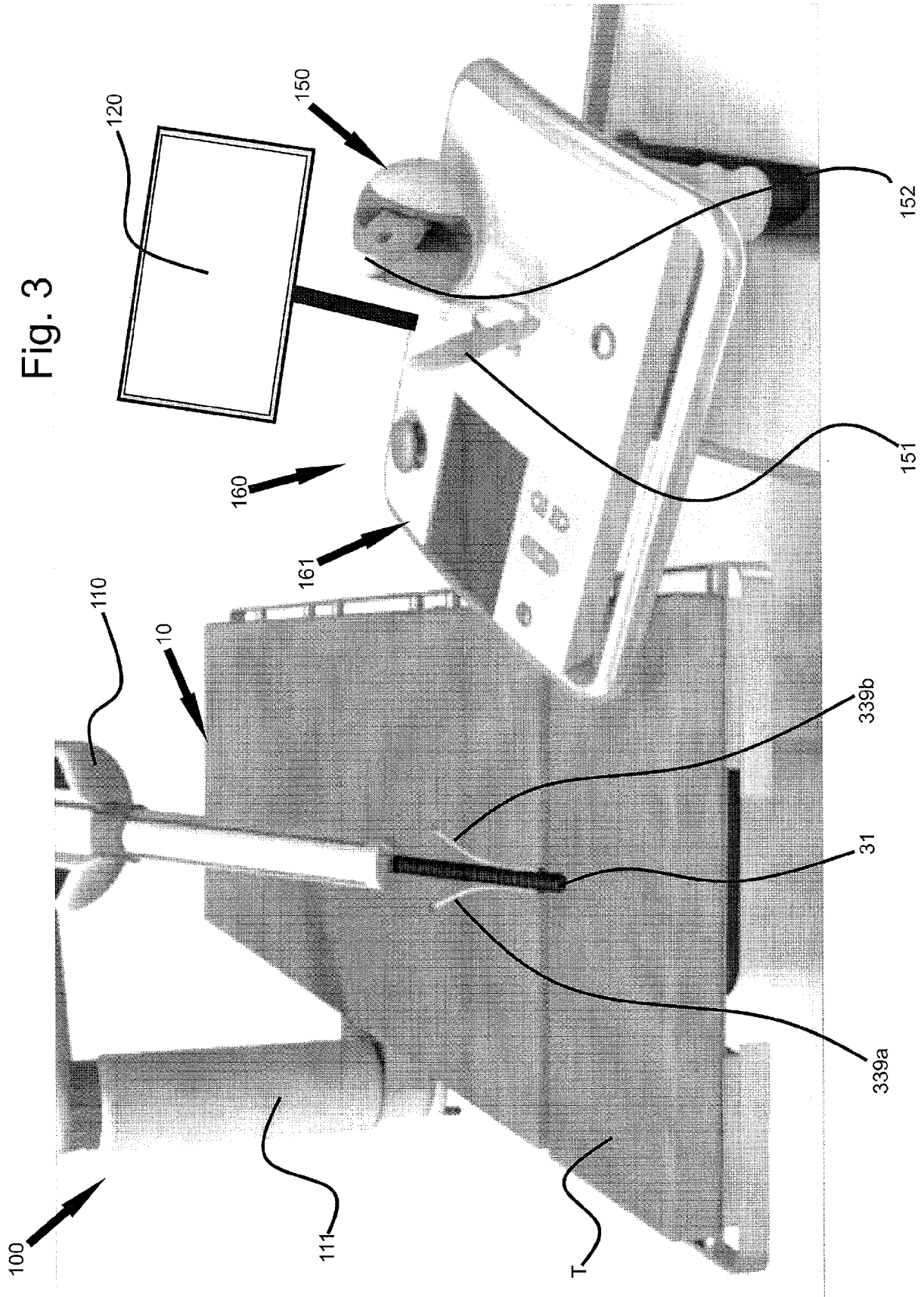
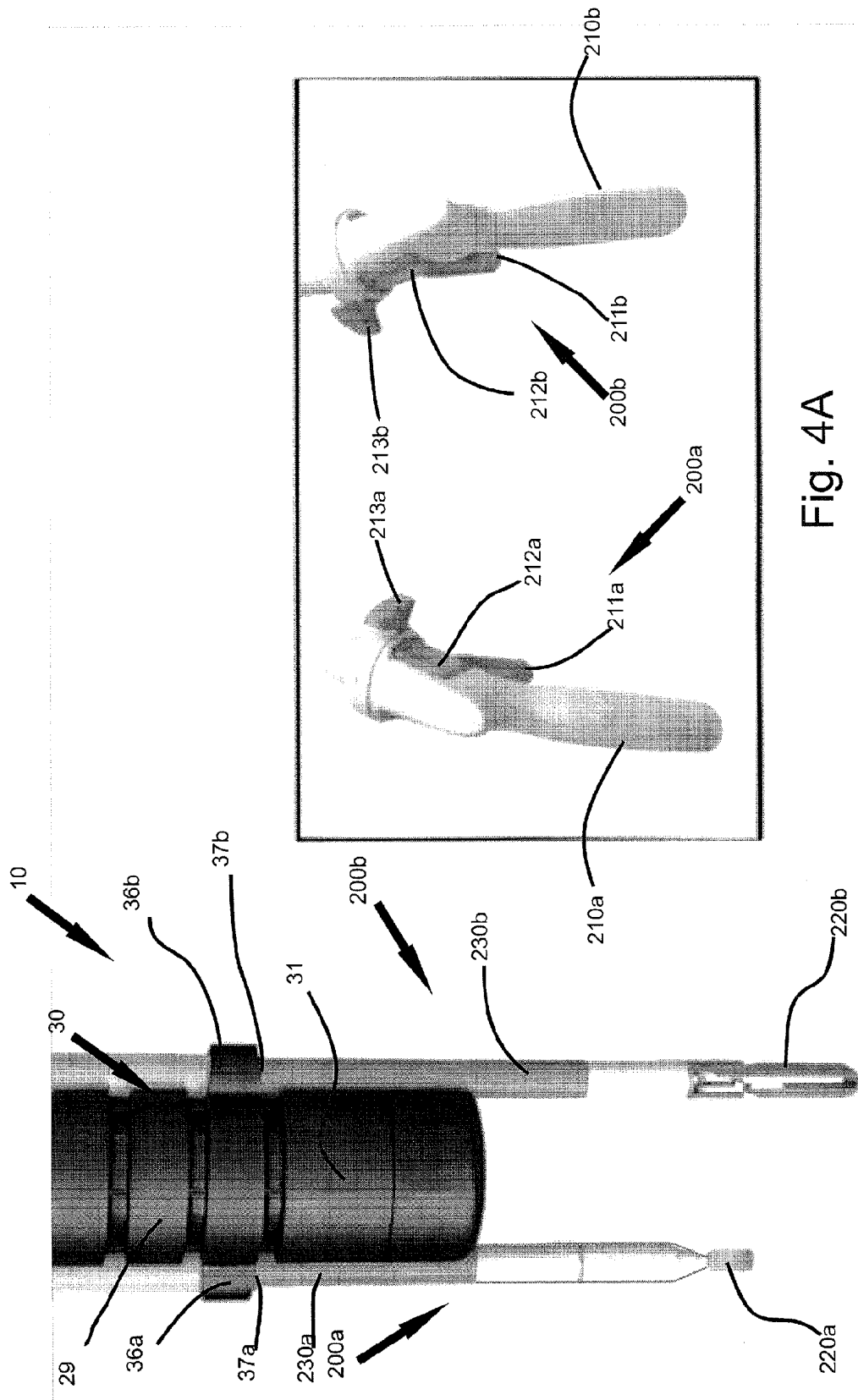

Fig. 3



4/15



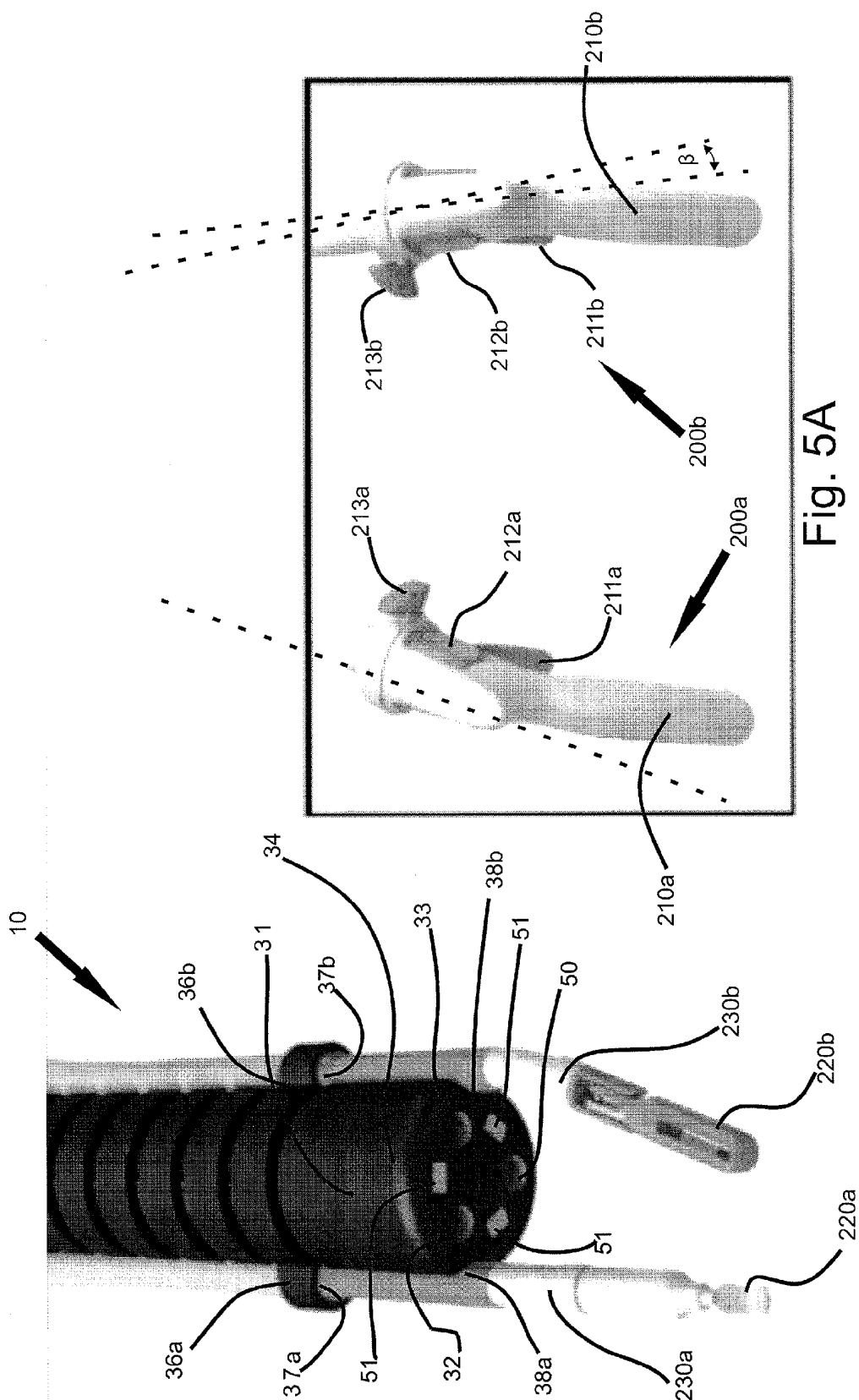

Fig. 5

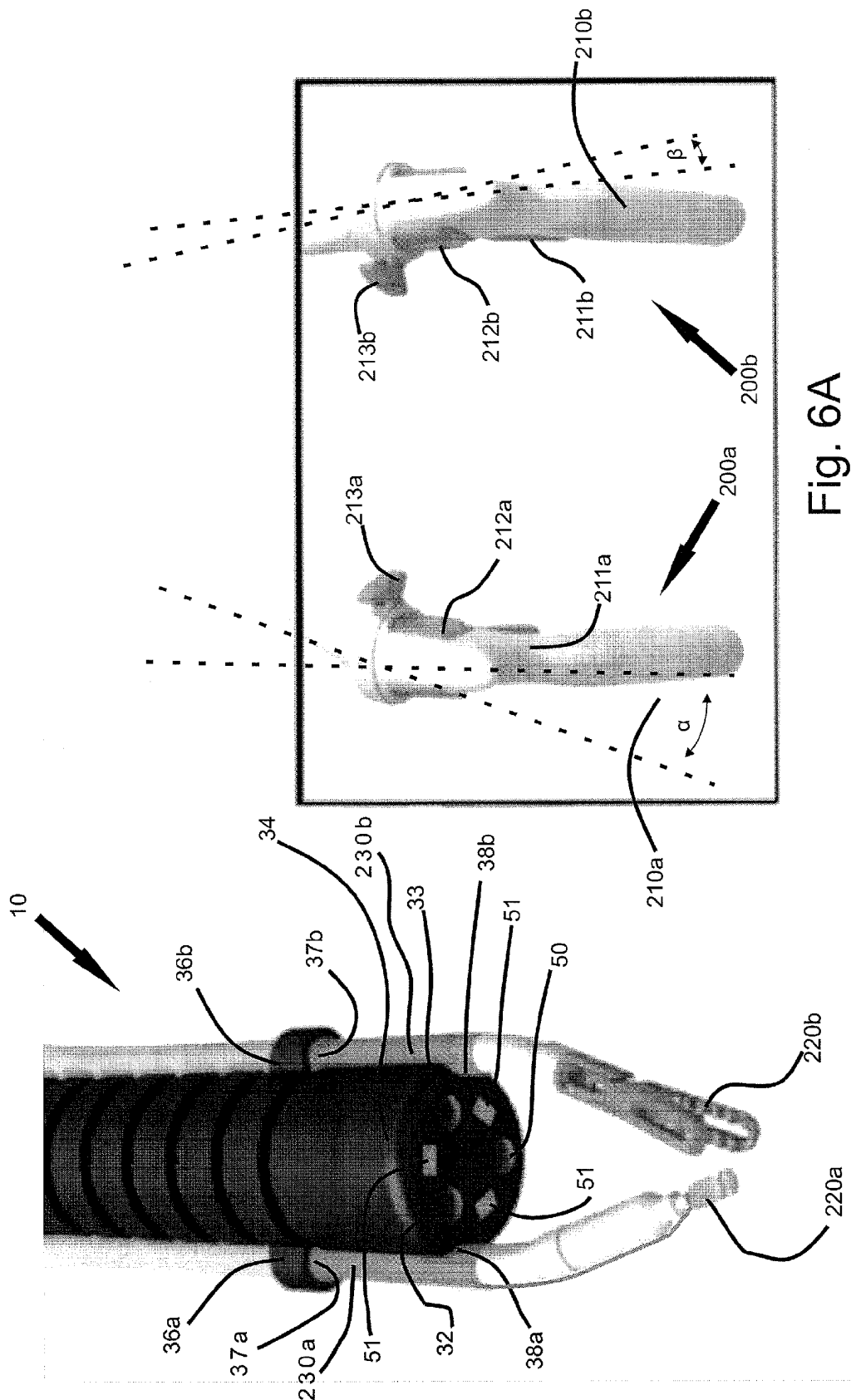

Fig. 6



7/15

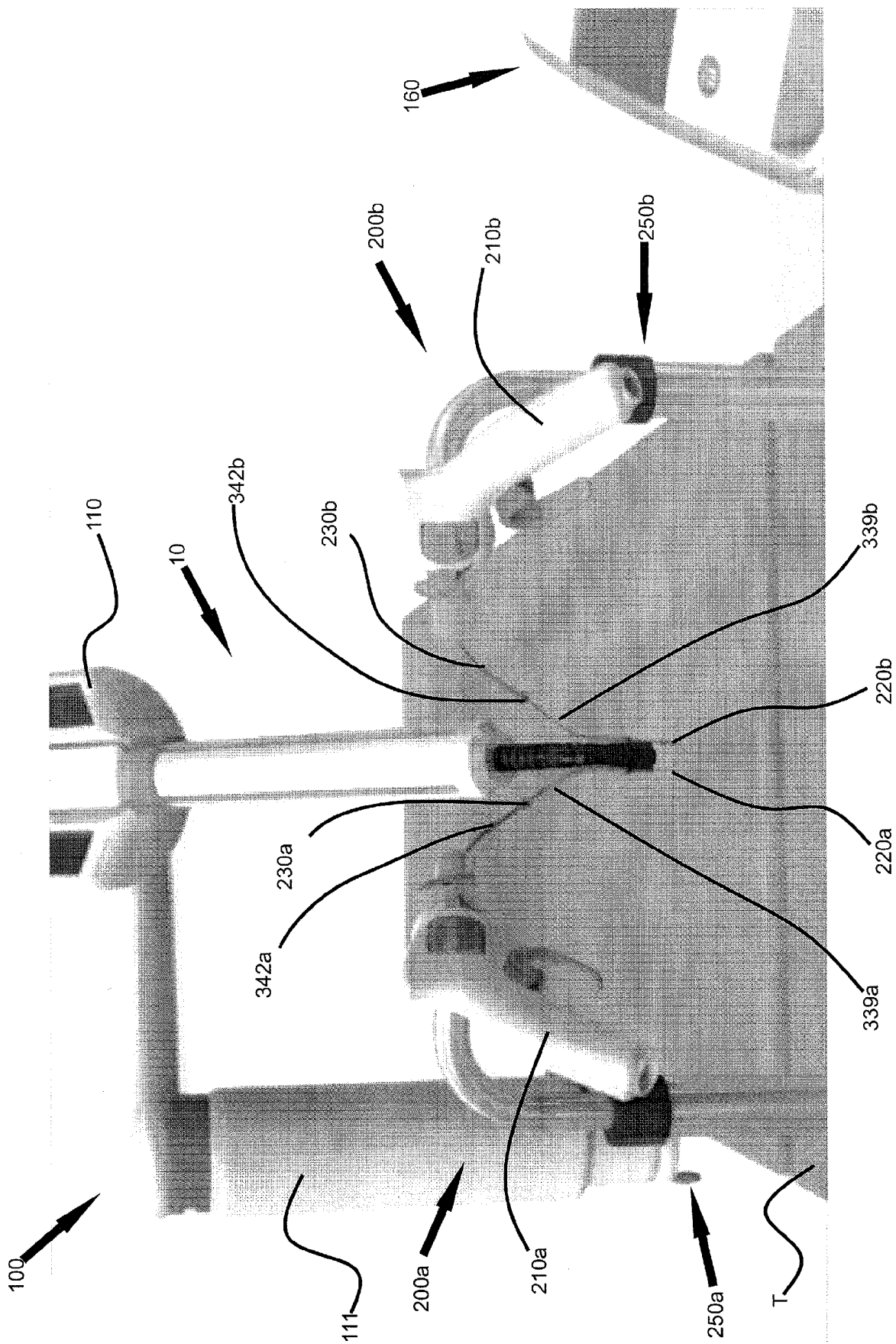
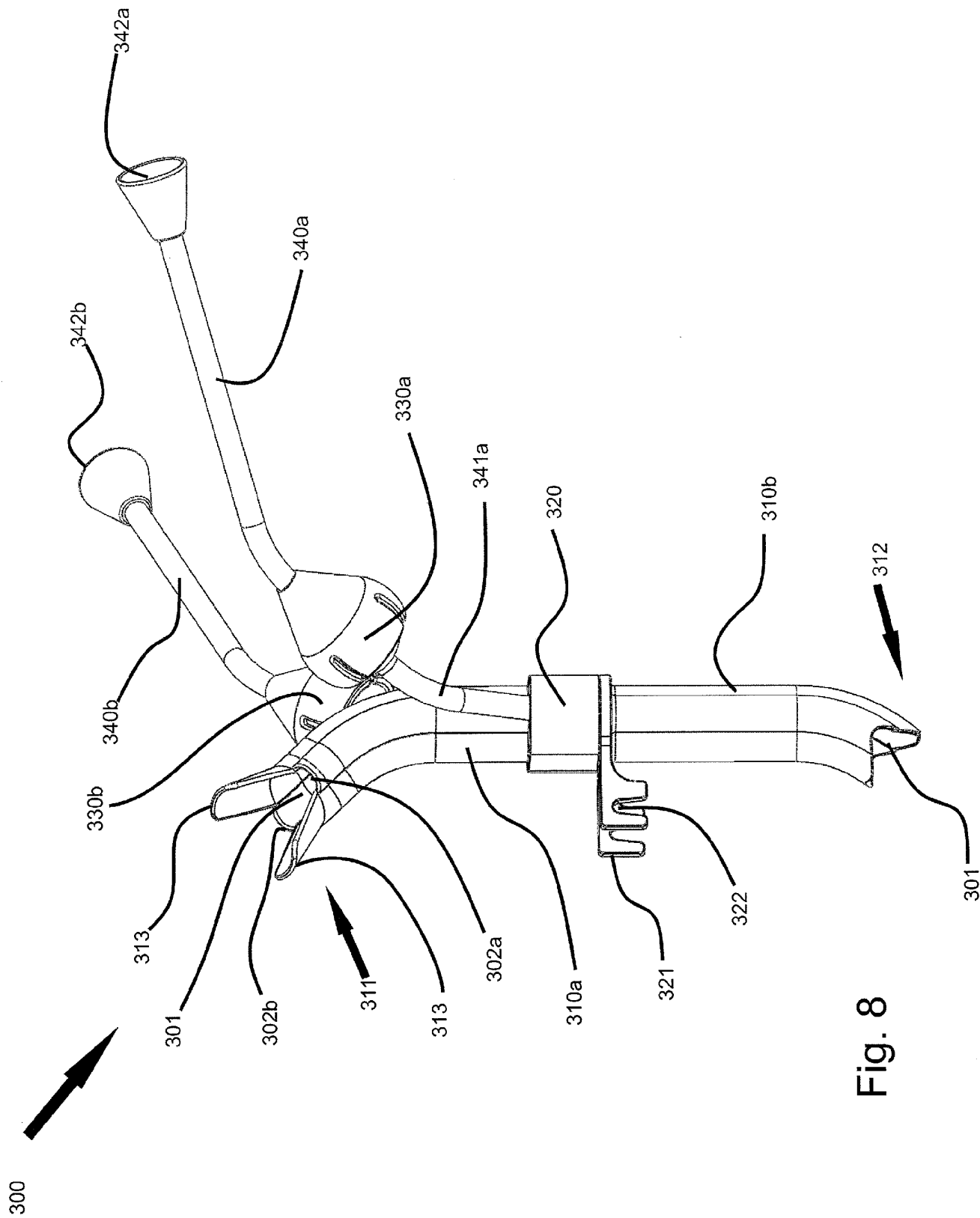

Fig. 7





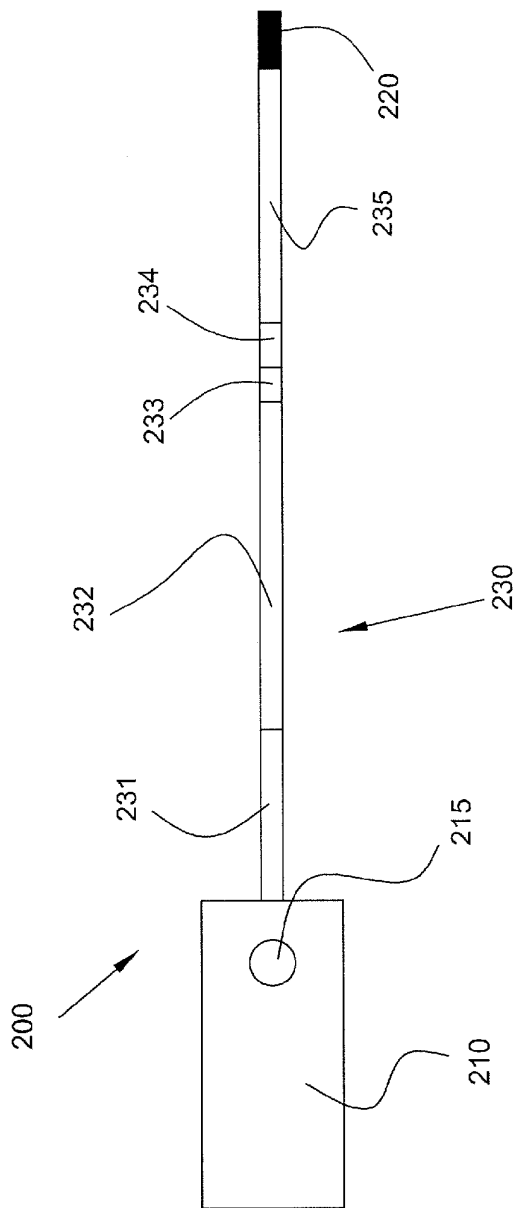

Fig. 9

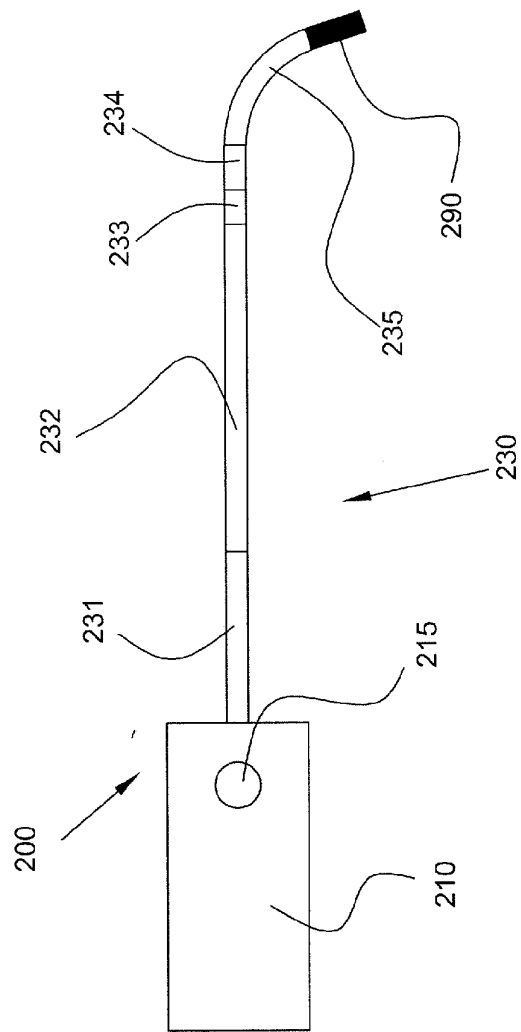

Fig. 9a

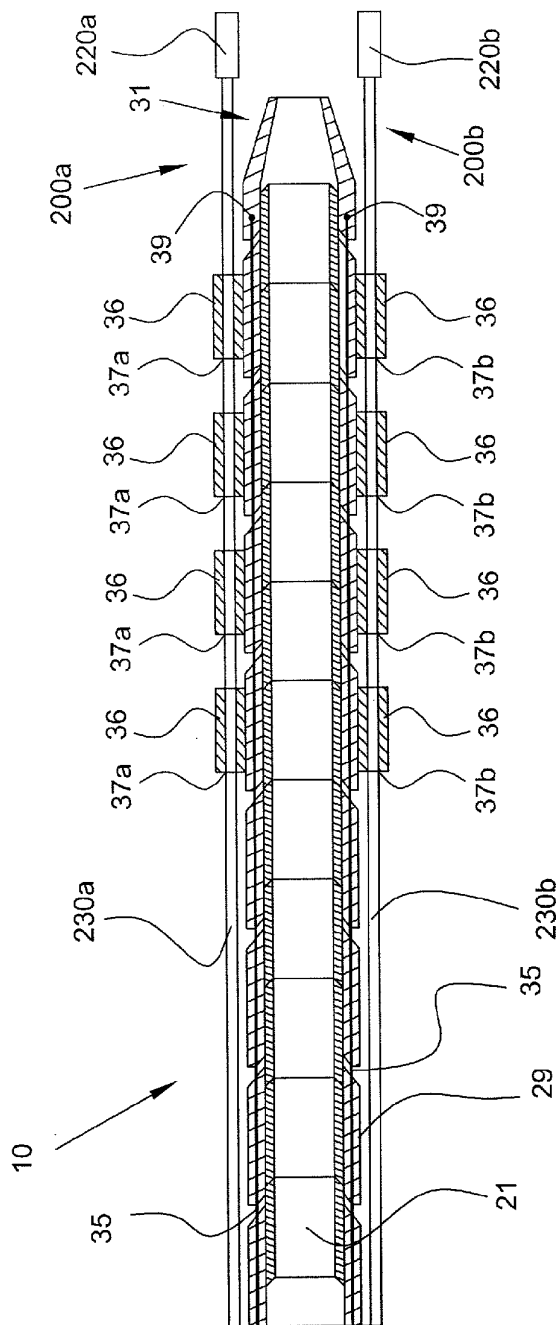

Fig. 10

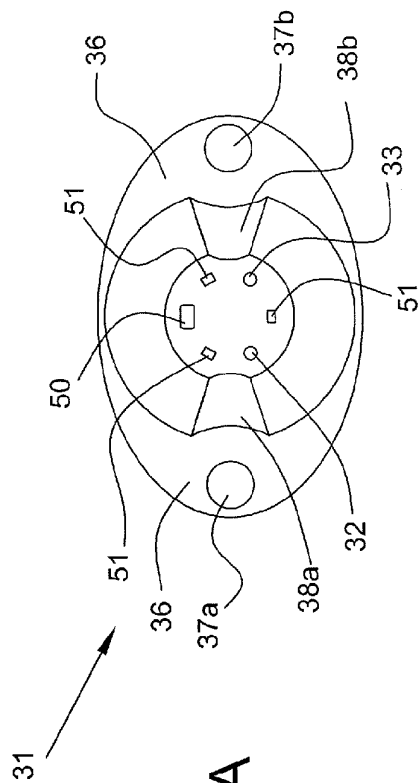

Fig. 10A

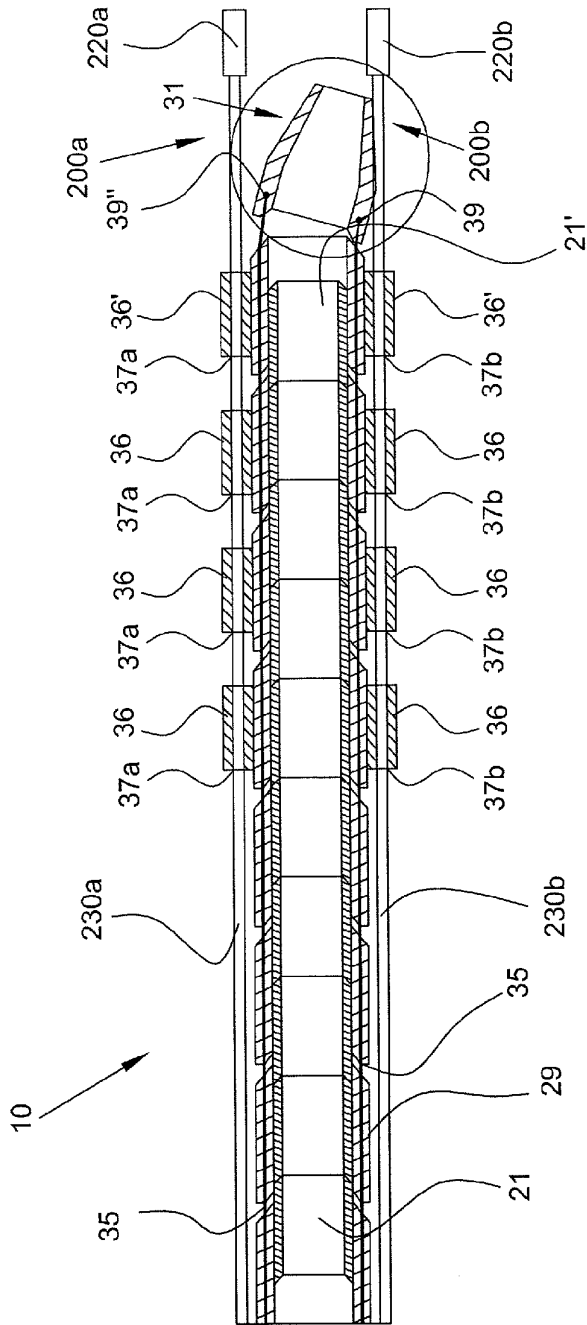

Fig. 11

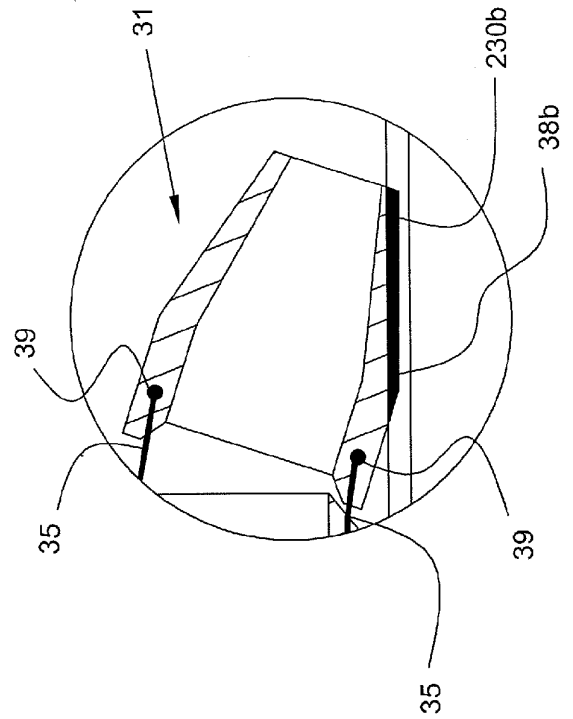

Fig. 11A

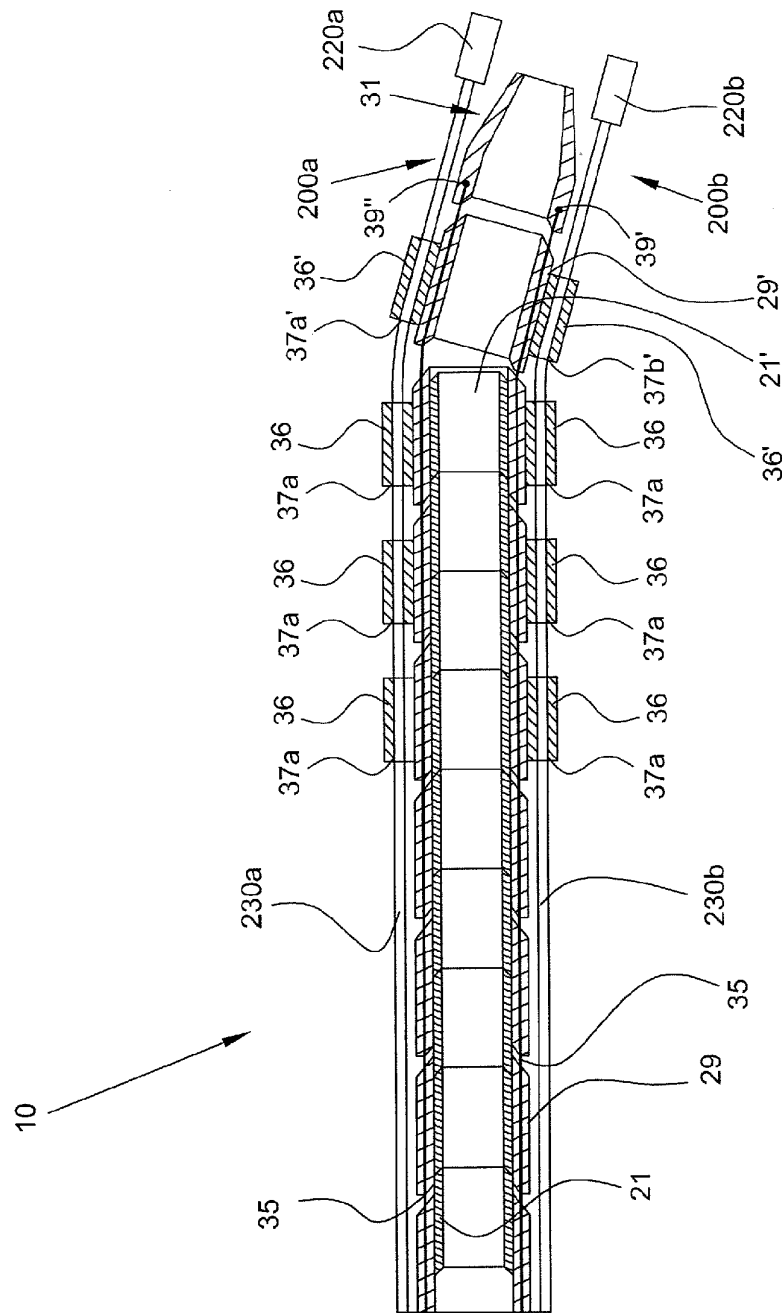
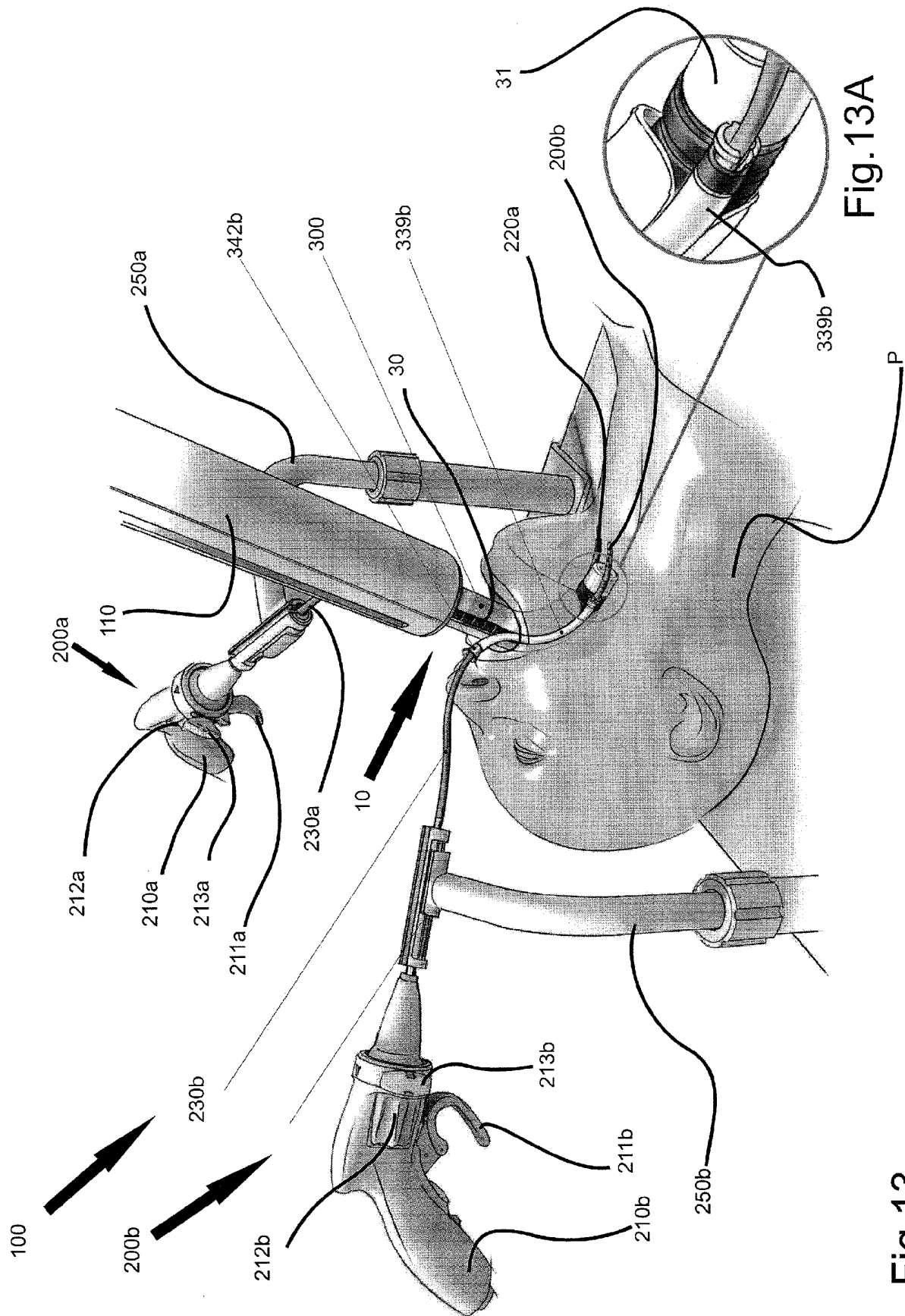

Fig. 12



**Fig. 13**

Fig. 13A

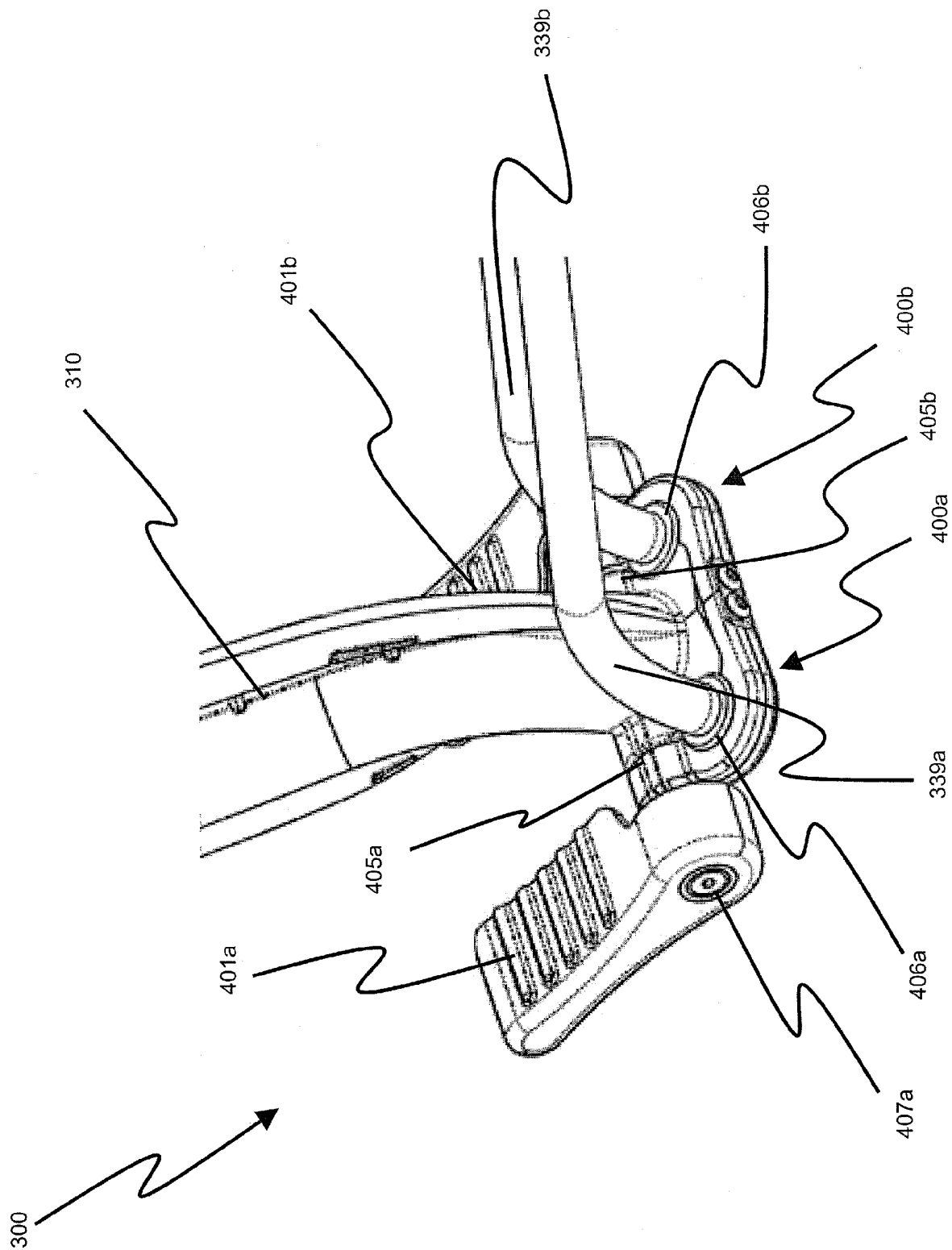

FIG 14A

