

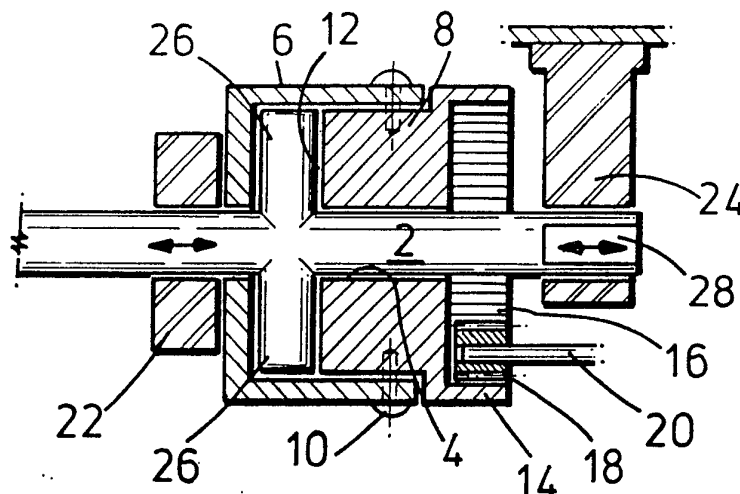

INTERNATIONAL APPLICATION PUBLISHED UNDER THE PATENT COOPERATION TREATY (PCT)

<p>(51) International Patent Classification ⁵ : B25D 11/10, 16/00</p>	<p>A1</p>	<p>(11) International Publication Number: WO 93/11910</p> <p>(43) International Publication Date: 24 June 1993 (24.06.93)</p>
<p>(21) International Application Number: PCT/GB92/02352</p> <p>(22) International Filing Date: 18 December 1992 (18.12.92)</p> <p>(30) Priority data: 9126970.4 19 December 1991 (19.12.91) GB</p> <p>(71)(72) Applicant and Inventor: FISHER, Hugh, Edward [GB/GB]; Dunree Farm Cottage, Dalrymple, Ayrshire KA6 6BA (GB).</p> <p>(74) Agents: McCALLUM, William, Potter et al.; Cruikshank & Fairweather, 19 Royal Exchange Square, Glasgow G1 3AE (GB).</p>		<p>(81) Designated States: CA, GB, JP, KR, US, European patent (AT, BE, CH, DE, DK, ES, FR, GB, GR, IE, IT, LU, MC, NL, PT, SE).</p> <p>Published <i>With international search report. Before the expiration of the time limit for amending the claims and to be republished in the event of the receipt of amendments.</i></p>

(54) Title: POWER TOOL



(57) Abstract

The invention relates to portable power tool means intended to form part of a power tool or a conversion unit adapted to be fitted to the shaft of a power tool. The tool means includes a rotary cam member (6, 8) having an internal sinusoidal cam track (12) in which cam followers (26) of an output shaft (2) are received. When the cam member (6, 8) rotates, the shaft (2) is caused to partake of a lengthwise reciprocating movement suitable for application to a scraper bit or other tool kit such as a chisel. In an example of the invention, the shaft (86) passes through a fixed bearing ring (88), a slidable sleeve (96) being provided to control engagement of the shaft (86) via a key member (104) with portions of the ring (88) or the cam member (76), so as to enable the shaft (86) to partake of lengthwise movement or to be convertible to rotational movement, as selected by the operator.

FOR THE PURPOSES OF INFORMATION ONLY

Codes used to identify States party to the PCT on the front pages of pamphlets publishing international applications under the PCT.

AT	Austria	FR	France	MR	Mauritania
AU	Australia	GA	Gabon	MW	Malawi
BB	Barbados	GB	United Kingdom	NL	Netherlands
BE	Belgium	GN	Guinea	NO	Norway
BF	Burkina Faso	GR	Greece	NZ	New Zealand
BG	Bulgaria	HU	Hungary	PL	Poland
BJ	Benin	IE	Ireland	PT	Portugal
BR	Brazil	IT	Italy	RO	Romania
CA	Canada	JP	Japan	RU	Russian Federation
CF	Central African Republic	KP	Democratic People's Republic of Korea	SD	Sudan
CG	Congo	KR	Republic of Korea	SE	Sweden
CH	Switzerland	KZ	Kazakhstan	SK	Slovak Republic
CI	Côte d'Ivoire	LI	Liechtenstein	SN	Senegal
CM	Cameroon	LK	Sri Lanka	SU	Soviet Union
CS	Czechoslovakia	LU	Luxembourg	TD	Chad
CZ	Czech Republic	MC	Monaco	TG	Togo
DE	Germany	MG	Madagascar	UA	Ukraine
DK	Denmark	ML	Mali	US	United States of America
ES	Spain	MN	Mongolia	VN	Viet Nam
FI	Finland				

- 1 -

POWER TOOL

The invention is concerned with power tools, particularly but not exclusively, with power tools which are relatively lightweight and suitable for use by the general public.

In my British Patent No. 2219958 there is described a portable power tool which comprises a housing and a drive means for operating a range of interchangeable tool bits such as scrapers and chisels or even tool bits which perform the function of a small spade in breaking up soil. All these power tools provide the user with the advantages of a linear path for the powered stroke of the bit, without a component of rotary motion. This is achieved by provided a cylinder cam mounted for rotation with an output shaft and provided with a circumferential sinusoidal cam track in which run cam followers associated with the drive shaft, which is captive against rotation. Tools made in accordance with the invention described in that specification are remarkably efficient in use as small hand-held tools, but if the intended purpose of the tool requires a greater cam throw range and/or a larger cam cylinder for smoothing action, the shaft portion carrying the cam followers is also enlarged making the components too cumbersome for ease of use and incorporation into a reasonably sized housing.

The present invention seeks to provide an arrangement which will increase the versatility and capability of a

portable tool such as referred to above while tending to avoid the penalty of increased size of component parts.

The invention provides a portable power tool means comprising a housing, a drive means and a mounting arrangement for a selected tool bit, said drive means being adapted to drive an output shaft means in a reciprocatory axial motion with respect to a longitudinal axis thereof to drive said tool bit, wherein there is provided a rotatable cam member to convert rotary motion from the drive means into said reciprocatory motion, said cam member being provided with an axially arranged bore into which is received a portion of the output shaft means, inner walls of said bore being formed to provide a continuous sinusoidal cam track, said output shaft means portion being provided with cam follower means projecting outwardly therefrom to engage with the cam track, and means being provided to restrain said output shaft means against rotation when said output shaft means is partaking of said reciprocatory motion.

Conveniently said output shaft means may pass through the bore of the cam member and be received in bearing devices adapted to permit longitudinal motion.

Alternatively, the bore may be provided with an end wall so as to form a blind bore, an end portion only of the shaft means being received therein.

It will be understood that the power tool means of the present invention may be used as a conversion unit for a

conventional power tool or may form part of a combination power tool assembly.

In one example of a device according to the invention, the means to restrain the output shaft means against rotation during the reciprocal motion thereof may comprise a bearing arrangement in which a non-circular or splined portion of the shaft means is slidably received in a corresponding-shaped passage.

In a further example of another device according to the invention, said means to restrain the output shaft means against rotation may be adapted to be releasable at the operator's option. Selection means may therefore be provided which are capable of controlling the adoption of a first mode in which said output shaft means is in a drive sequence for reciprocal motion and a second mode in which said output shaft means is in a drive sequence for rotary motion. Conveniently said selection means may comprise a slidable key arrangement.

There will now be described three examples of tools according to the invention. It will be understood that the description which is intended to be read with reference to the drawings is given by way of example only and not by way of limitation.

In the drawings:-

Figure 1 is a fragmentary view in longitudinal section through a first example of a tool according to the invention;

Figure 2 is an exploded view of the parts shown in Figure 1;

Figure 3 is a longitudinal sectional view of the second example of a tool in an assembled condition;

Figure 4 is a fragmentary view of parts comprising the second example of a tool;

Figure 5 is an exploded view of the parts shown in Figure 4;

Figures 6 and 7 are longitudinal sectional views of the second tool with a tool bit thereof in fully forward and fully retracted positions, respectively;

Figures 8 and 9 are top plan and side views respectively of operating parts in a third example of a tool;

Figures 10, 11, and 12 are plan, side and end views of a key member of a key arrangement of the third example;

Figure 13 is a perspective view of a cam member of the third example;

Figure 14 is a perspective view of an output shaft means of Figures 8 and 9;

Figure 15 is a perspective view of a slidable sleeve member of the key arrangement of Figures 8 and 9; and

Figures 16 and 17 show similar views to those of Figures 8 and 9 with the key arrangement set for a second mode of operation.

Figures 1 and 2 illustrate the components parts of a first example of a tool, being those parts adapted to

convert rotary motion from a motor or from an output shaft of a conventional power drill. In the latter case the parts shown in Figures 1 and 2 will be assembled, with an intermediate gear arrangement, into sub-housing for attachment to a power drill.

A shaft 2 passes through an axial bore 4 in a cam member comprises two parts 6, 8, secured together by fastening means, in the present example, bolts 10. The cam member 6, 8 is generally annular in shape, the inner wall of the bore 4 being formed with a recessed sinusoidal cam track 12.

It will be understood that the cam member is constructed from the two parts 6 and 8 in order to simplify manufacture. The part 6 is a sleeve member including an annular undulating flange on which is formed one side 12' of the recessed track 12. The part 8 is an annular block which has an undulating surface 12", the part 8 being received within the sleeve so that the surfaces 12' and 12" confront each other in a spaced-apart manner.

An annular flange 14 extends from the part 8 in a direction to the right of Figure 1. The flange 14 is provided on its inner surface with splines 16 which are engaged by a pinion 18 which is connected by a shaft 20 through suitable gearing to a motor or other drive source (not shown). The parts 6 and 8 are thus rotatable by the driving pinion 18.

The shaft 2 however is restrained from rotation by being mounted in sliding bearings 22,24 the right hand end portion of the shaft being provided with flats 28 which are received in the bearing 24. Cam follower means in the form of pins or studs 26 are formed on an intermediate region of the shaft 2 so as to be received in the cam track 12 as shown in Figure 1. Alternatively, rolling members may be preferred to the studs 26.

Thus, when the operation of the motor causes the pinion to drive the cam member 6, 8 so that it rotates, the cam followers 26 are acted upon by the curvature of the cam track so as to cause the shaft 2 to partake of axial reciprocatory movement in the bearings 22,24. The free end portion of the shaft is adapted in any suitable way to hold and retain a tool bit such as a scraper.

A second example is illustrated in Figures 3 to 7, in which there is shown a housing 30 which is of a shape suitable to be held in the hand. The housing 30 has a nose portion 32 to which is releasably secured a scraper bit 34. A cable 36 is provided at the rear end of the housing which provided electrical power to a motor 38 in a conventional manner. A suitable gearing arrangement 40 links the output member of the motor to an eccentrically mounted pinion 42, which is similar to the pinion 18 described above.

In this second example there is also provided a shaft 44 passing through an axial bore 46 in a cam member

comprising two parts 48 and 50. However, in contrast to the first example, the bore 46 is blind having an end wall 52 formed in the part 50. The shaft 44 itself is terminated at a region to the right of studs 48, equivalent to studs 26 of Figures 1 and 2.

The studs 54 are arranged to act as cam-followers in a sinusoidal cam track formed by surface 56 on component part 48 and by surface 58 on component part 50 of the cam member. This camming arrangement operates in a manner similar to that described in respect of Figures 1 and 2, the shaft 44 sliding in a longitudinally reciprocating movement in a bearing 60, grooves 62 of which receive splines 64 on the shaft to prevent rotation thereof as the pinion 42 drives the cam member in a rotary motion through its engagement with gear teeth on the inner surface of a flange 66, similar to the flange 14 in Figure 1. However, in the present example, the cam member 48,50 is provided with an integrally constructed shaft 68 which turns in a bearing 70.

Whereas Figure 3 is a top view of the second device, Figures 6 and 7 are side views thereof, illustrating the two extremes of the scraper bit travel. The lengthwise movement of the shaft 44 is apparent from a comparison of the two Figures. Operation of the motor 38 is controlled by a thumb-operated on-off switch 72.

Figures 8 and 9 illustrate the operating component parts of a third example of a tool, comprising those parts

adapted to convert rotary motion from a motor or a power-drill into reciprocal movement of an output shaft means thereof. Particularly in the case of a hand-held power drill, it is found more convenient if either reciprocating motion or rotary motion is available for selection by the operator without the need to exchange or replace the device according to the invention. This clearly increases the range and versatility of use of a drill assembly in which a single housing contains a motor having its output shaft coupled to an arrangement to be described below.

Figure 8 shows an output shaft 74 from an electric motor similar to that shown at 38 in Figures 1 to 3. In the present example, the shaft 74 is connected directly to a cam member 76 for rotation thereof but it will be understood that suitable gearing may be interposed as required. The cam member 76 is of two-part construction similar to that of cam member 6, 8 or 48, 50 described above. The cam member 76 has an outer face 78 which is provided with two notched or contoured grooves indicated at 80, the purpose of which will be described below.

Received in a sinusoidal cam track 82 of the cam member 76 are two cam followers 84 arranged to project in diametrically opposed directions from an output shaft 86 of the device. The shaft 86 is further received at a position spaced bearing ring 88 fixed to a housing (not shown) by lugs 90. A surface 92 of the fixed bearing ring

88 is provided with contoured grooves 94.

External circumferential surfaces of the bearing 88 and the cam member 76 are at least partially enclosed by a sleeve member 96 which is adapted to slide between two end positions, one of which is shown in Figures 8 and 9. Spring means (not shown) are provided to urge the sleeve member 96 into one or other of the two positions as determined by actuation of an operating member 98.

The sleeve member 96 is provided with an annular groove 100 formed in the internal cylindrical surface thereof, in which groove are received two pins 102 provided on opposite end portions of a key member 104 shown in detail in Figures 10 to 12. The key member 104 is provided with chamfered side surfaces 106, 106' which give the member a prow or boat-like cross-section as shown in Figure 12. As may be seen more clearly from Figure 11, the key member 104 passes through a slot 108 formed in the shaft 86.

It will be observed that in Figures 8 and 9 the key member 104 is positioned at the left hand end of the slot 108 as viewed in that Figure. It is therefore in engagement with the fixed bearing ring 88 since the surfaces 106 are received in the grooves 94 which are complementarily shaped to accept the chamfered surfaces of the prow configuration of the key member 104.

The operation of the device as described above is similar to that of the previous two examples. Rotation of

the shaft 74 and therefore of the cam member 76 causes the shaft 86 to partake of reciprocating axial movement. The key member 104, being held axially captive by the entry of the pins 102 in the groove 100 of the sleeve 96, remains stationary relative to the shaft 86 and within the slot 108 thereof.

However, in Figures 16 and 17 a second operating mode is described. This mode is engaged by movement of the sleeve member 96 to the right as viewed in the drawings, by means of the operating member 98. This action causes the key member 104 to move along the slot towards the right hand end thereof and the surfaces 106' to engage with the groove 94 of the housing of the cam member 76. While a shoulder portion of the groove 94 is cut away at 110 to allow ease of entry of the key member surfaces 106' into the groove 94, an opposite shoulder 112 provides a thrust portion against which the rotational motion of the cam member 76 is transmitted to the key member 104. Because the key member is captive in a rotational sense within the slot 108, the shaft 86 is forced to rotate. Because the cam followers 85 thus remain stationary relative to the cam member 76, there is no reciprocatory movement of the shaft and the power tool device may be used in the manner of a conventional power drill.

Various modifications may be made within the scope of the invention as defined in the following claims.

CLAIMS:

1. A portable power tool means comprising a housing, a drive means and a mounting arrangement for a selected tool bit, said drive means being adapted to drive an output shaft means in a reciprocatory axial motion with respect to a longitudinal axis thereof to drive said tool bit, wherein there is provided a rotatable cam member to convert rotary motion from the drive means into said reciprocatory motion, said cam member being provided with an axially arranged bore into which is received a portion of the output shaft means, inner walls of said bore being formed to provide a continuous sinusoidal cam track, said output shaft means portion being provided with cam follower means projecting outwardly therefrom to engage with the cam track, and means being provided to restrain said output shaft means against rotation when said output shaft means is partaking of said reciprocatory motion.
2. A power tool means as claimed in claim 1, wherein said cam follower means comprises projecting pins or rolling members adapted to engage in said cam track.
3. A power tool means as claimed in either of claims 1 and 2, wherein the output shaft means comprises a shaft received in a sliding bearing arrangement in which rotational movement is prevented.

4. A power tool means as claimed in any one of the preceding claims, wherein the bore of the cam member is a through-bore through which the output shaft passes, said cam member being rotated through an eccentric gearing arrangement from an electric motor.

5. A power tool means as claimed in any of claims 1 to 3, wherein the bore of the cam member is a blind bore into which an end portion of the shaft means carrying said cam follower means is received, means being provided to transfer rotational motion to said cam member from a motor or other source of electricity.

6. A power tool means as claimed in either one of claims 1 or 2, wherein there is provided a bearing ring surrounding said output shaft means and a sleeve member adapted to be mounted so as to receive at one end thereof at least a portion of said bearing ring and at an opposite end thereof at least a portion of said cam member, a key member being provided so as to project from the output shaft means and capable of engaging with a housing of said bearing ring to prevent rotational movement of the output shaft means.

7. A power tool means as claimed in claim 6, wherein the key member is received in a longitudinal slot or recess in the output shaft means for sliding movement along said

slot or recess between a position in which the key member engages the housing of the bearing ring and a further position in which the key member engages a housing of the cam member to transfer rotational movement of the output shaft means from the cam member to the output shaft means.

8. A power tool means as claimed in claim 7, wherein the key member is provided with projection means adapted to engage with an annular groove formed in the interior of the sleeve member, said sleeve member being adapted for sliding movement with respect to the bearing ring and the cam member to move the key member between the first mentioned position and the further position.

9. A power tool means as claimed in either one of claim 7 and 8, wherein said key member is provided with chamfered leading edge surfaces adapted to engage in notched recesses or grooves provided on the housing portion of the bearing ring or the cam member as selected.

10. A power tool as claimed in any one of the preceding claims, wherein the cam member is comprised of two component portions, each portion defining a sinusoidal surface of said cam track, said surfaces being parallel and arranged to confront each other in a spaced-apart manner.

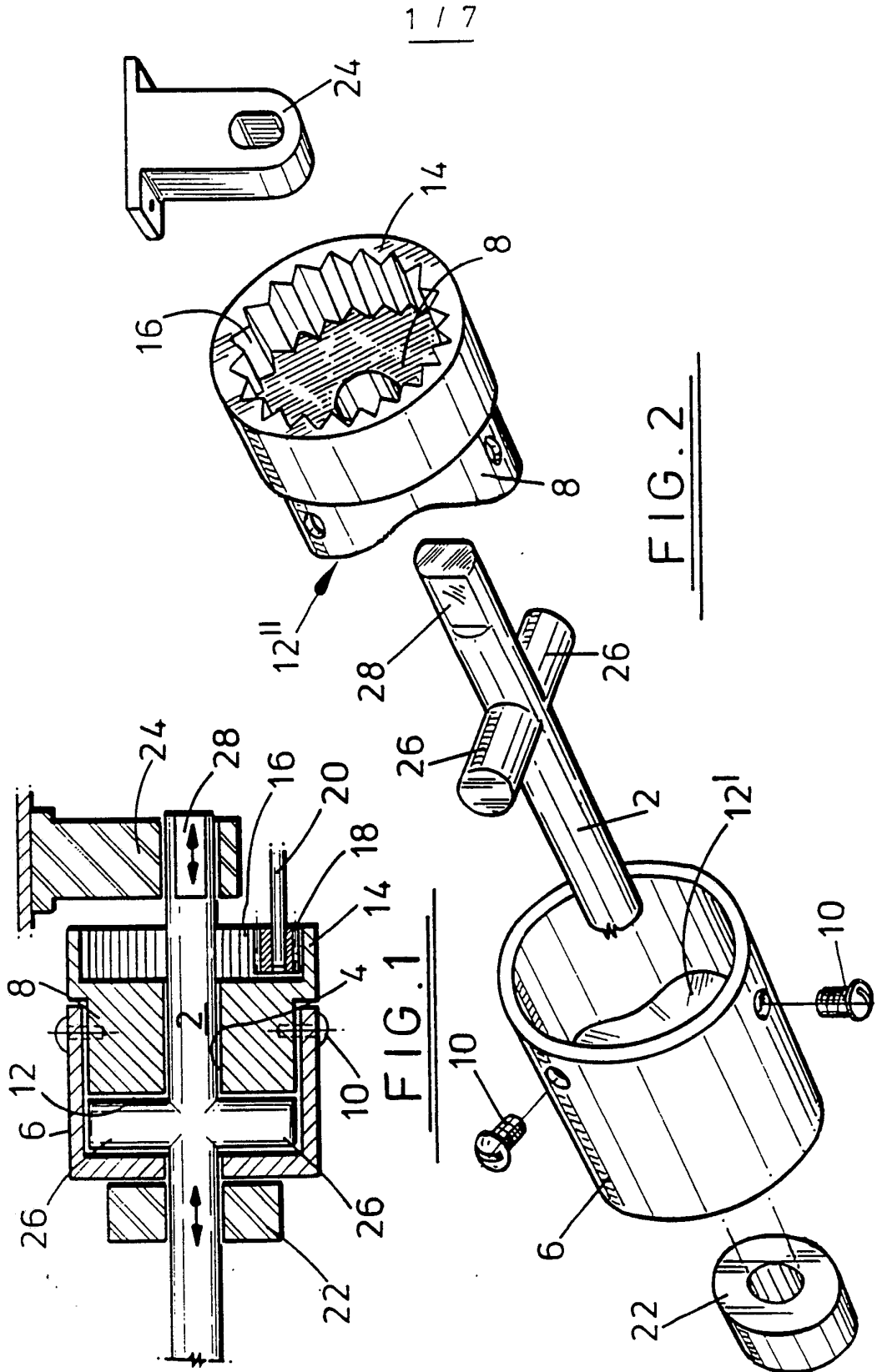

FIG. 2

FIG. 1

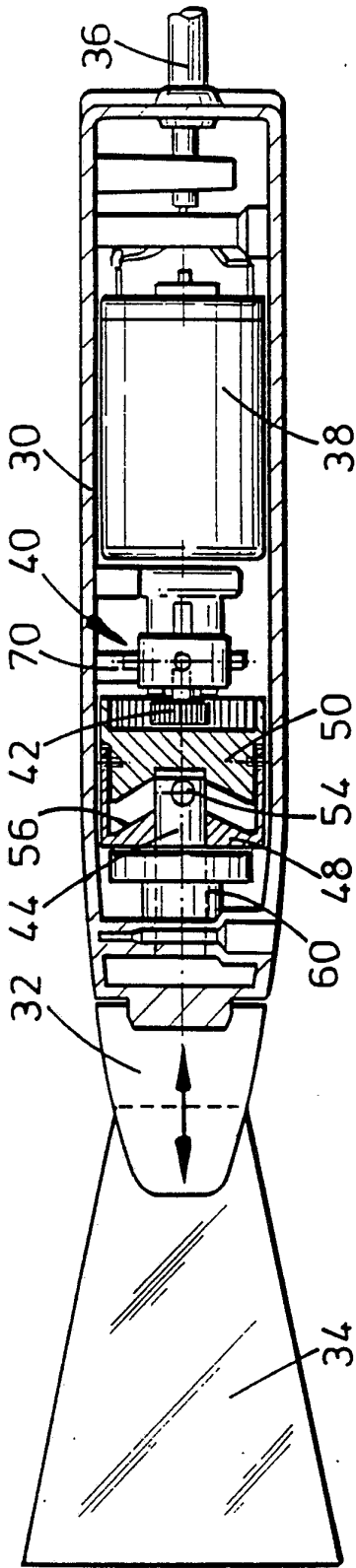

FIG. 3

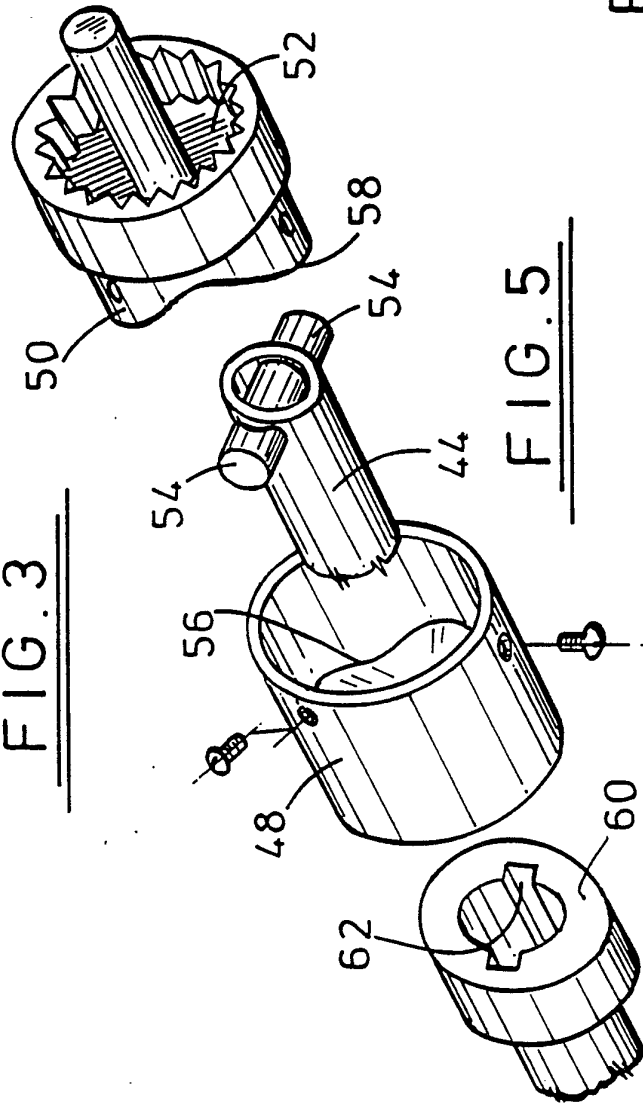

FIG. 5

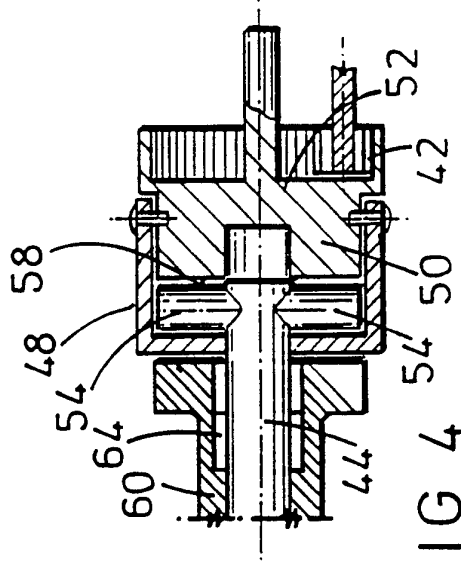

FIG. 4

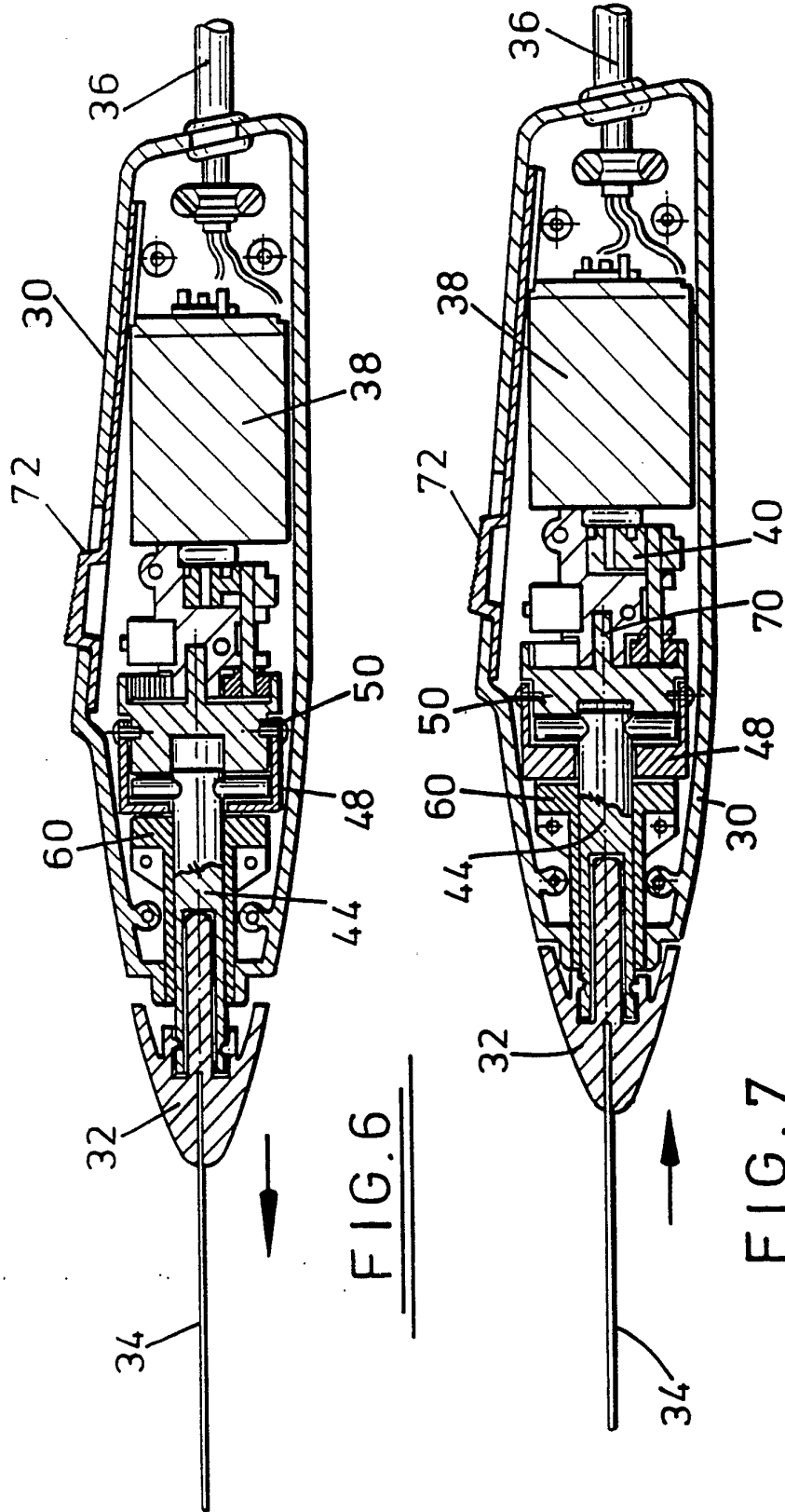

FIG. 6

FIG. 7

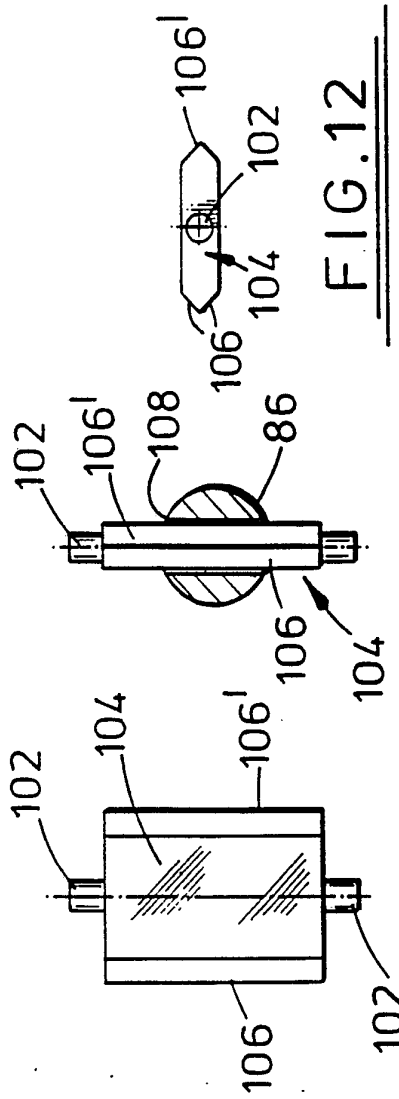

FIG. 11

FIG. 12

FIG. 10

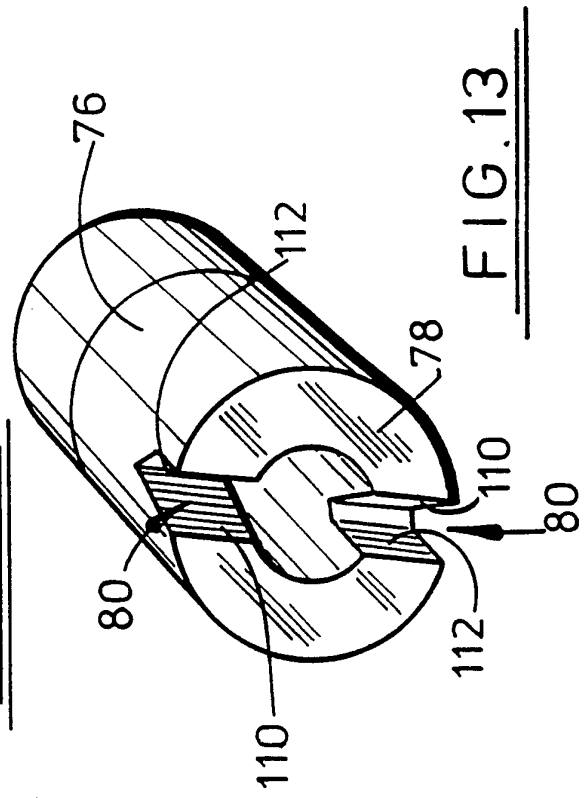

FIG. 13

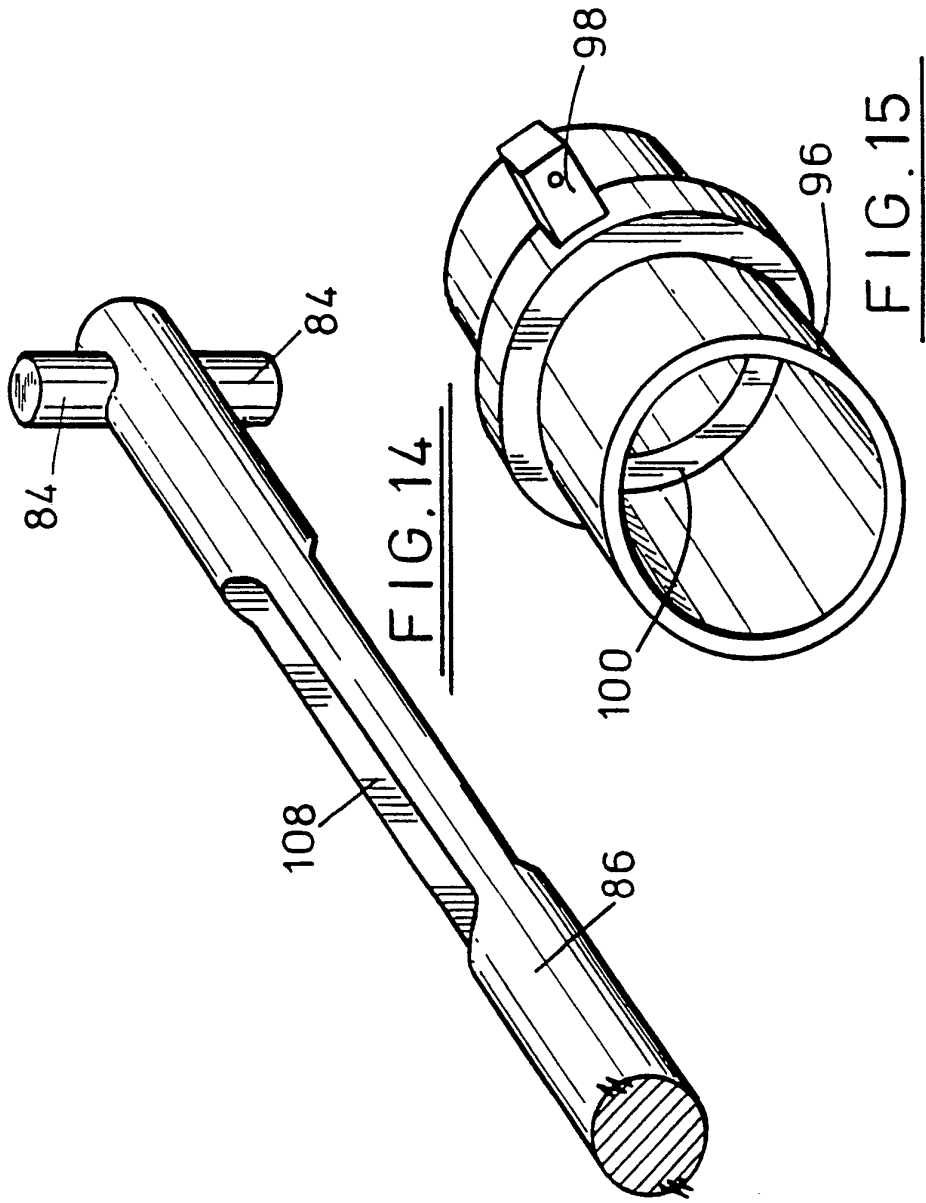

FIG. 14

FIG. 15

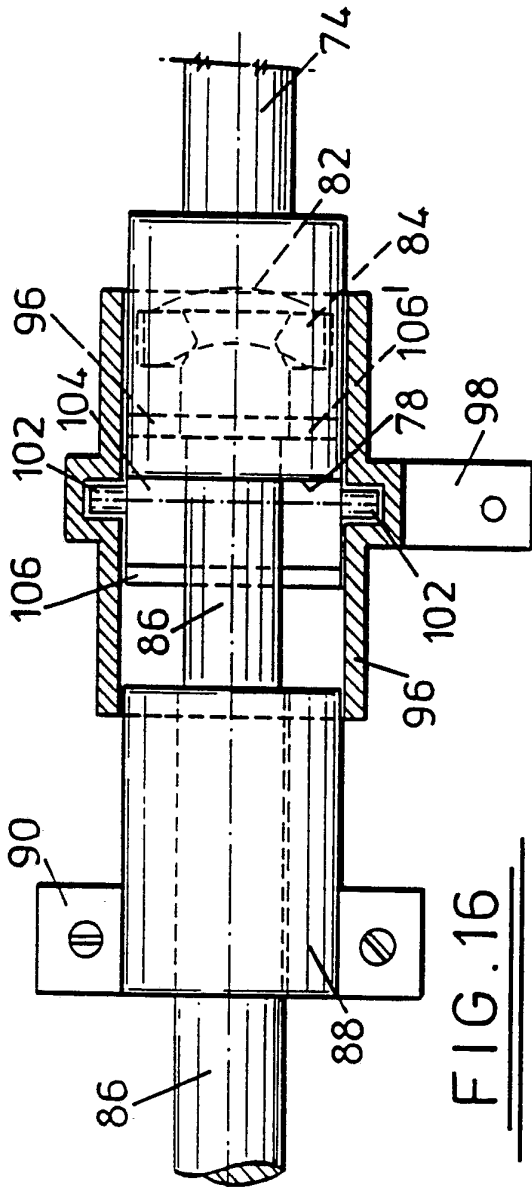

FIG. 16

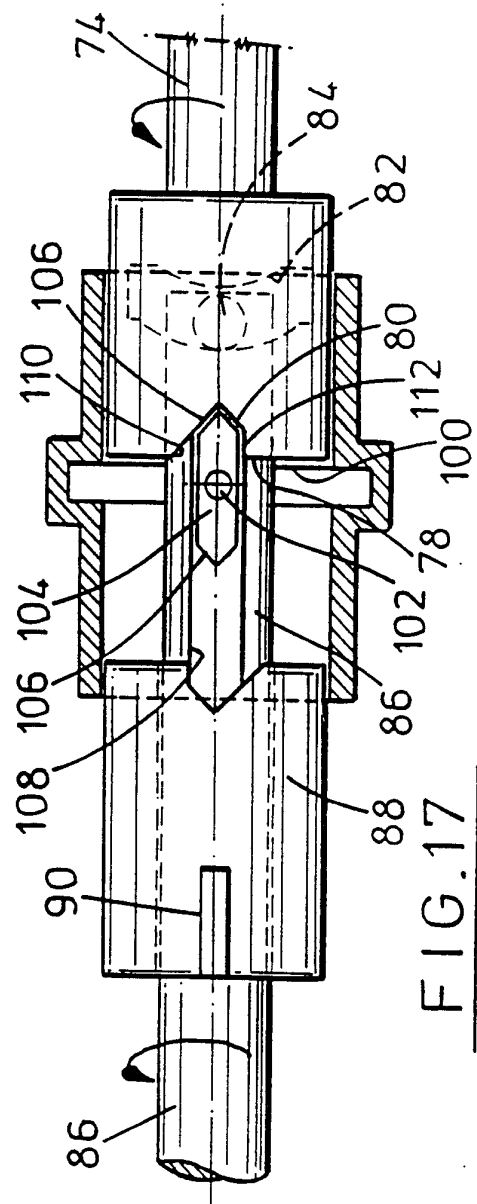

FIG. 17

INTERNATIONAL SEARCH REPORT

International Application No

PCT/GB 92/02352

I. CLASSIFICATION OF SUBJECT MATTER (if several classification symbols apply, indicate all) ⁶		
According to International Patent Classification (IPC) or to both National Classification and IPC Int.Cl. 5 B25D11/10; B25D16/00		
II. FIELDS SEARCHED		
Minimum Documentation Searched ⁷		
Classification System	Classification Symbols	
Int.Cl. 5	B25D	
Documentation Searched other than Minimum Documentation to the Extent that such Documents are Included in the Fields Searched ⁸		
III. DOCUMENTS CONSIDERED TO BE RELEVANT⁹		
Category ^o	Citation of Document, ¹¹ with indication, where appropriate, of the relevant passages ¹²	Relevant to Claim No. ¹³
X	FR,A,775 120 (SCHMID & WEZEL) 20 December 1934	1-3, 10
Y	see page 1, line 50 - page 2, line 8; figures ---	4, 5
Y	GB,A,186 142 (KESSLER) 20 September 1922 see page 2, line 28 - line 41; figures ---	4
Y	GB,A,612 866 (WODACK ELECTRIC TOOL) 18 November 1948 see page 2, line 68 - line 106; figures ---	5
A	GB,A,2 219 958 (FISHER) 28 December 1989 cited in the application see page 8, paragraph 1; figures 20,22 --- -/--	1
<p>^o Special categories of cited documents :¹⁰</p> <p>"A" document defining the general state of the art which is not considered to be of particular relevance</p> <p>"E" earlier document but published on or after the international filing date</p> <p>"L" document which may throw doubts on priority claim(s) or which is cited to establish the publication date of another citation or other special reason (as specified)</p> <p>"O" document referring to an oral disclosure, use, exhibition or other means</p> <p>"P" document published prior to the international filing date but later than the priority date claimed</p> <p>"T" later document published after the international filing date or priority date and not in conflict with the application but cited to understand the principle or theory underlying the invention</p> <p>"X" document of particular relevance; the claimed invention cannot be considered novel or cannot be considered to involve an inventive step</p> <p>"Y" document of particular relevance; the claimed invention cannot be considered to involve an inventive step when the document is combined with one or more other such documents, such combination being obvious to a person skilled in the art.</p> <p>"&" document member of the same patent family</p>		
IV. CERTIFICATION		
Date of the Actual Completion of the International Search	Date of Mailing of this International Search Report	
12 MAY 1993	7 8. 05. 93	
International Searching Authority	Signature of Authorized Officer	
EUROPEAN PATENT OFFICE	WEIAND T.	

III. DOCUMENTS CONSIDERED TO BE RELEVANT (CONTINUED FROM THE SECOND SHEET)		
Category °	Citation of Document, with indication, where appropriate, of the relevant passages	Relevant to Claim No.
A	CH,A,113 785 (MÜLLER) 16 February 1926 see claim 1; figures ---	1
A	US,A,2 474 056 (LARSEN) 21 June 1949 see figures ---	1
A	DE,B,1 190 860 (ANSBACHER MASCHINENBAU) 8 April 1965 see column 3, line 47 - column 4, line 2; figure -----	6-9

**ANNEX TO THE INTERNATIONAL SEARCH REPORT
ON INTERNATIONAL PATENT APPLICATION NO.**

GB 9202352
SA 67857

This annex lists the patent family members relating to the patent documents cited in the above-mentioned international search report.
The members are as contained in the European Patent Office EDP file on
The European Patent Office is in no way liable for these particulars which are merely given for the purpose of information. 12/05/93

Patent document cited in search report	Publication date	Patent family member(s)	Publication date
FR-A-775120		None	
GB-A-186142		None	
GB-A-612866		None	
GB-A-2219958	28-12-89	US-A- 5042592	27-08-91
CH-A-113785		None	
US-A-2474056		None	
DE-B-1190860		None	