

(12) STANDARD PATENT
(19) AUSTRALIAN PATENT OFFICE

(11) Application No. **AU 2013324530 B2**

(54) Title
Lid construction for breathing apparatus

(51) International Patent Classification(s)
A61M 16/16 (2006.01) **E05D 3/00** (2006.01)
B65D 43/16 (2006.01) **E05D 7/10** (2006.01)

(21) Application No: **2013324530** (22) Date of Filing: **2013.09.23**

(87) WIPO No: **WO14/051436**

(30) Priority Data

(31) Number	(32) Date	(33) Country
61/705,340	2012.09.25	US

(43) Publication Date: **2014.04.03**

(44) Accepted Journal Date: **2018.04.05**

(71) Applicant(s)
Fisher & Paykel Healthcare Limited

(72) Inventor(s)
Miller, Jeremy Livingston;Kat, Arjen David

(74) Agent / Attorney
AJ PARK, L 22 1 Willis St, WELLINGTON, ACT, 6011, AU

(56) Related Art
US 8006691 B2
US 2008/0302361 A1



(51) International Patent Classification:

A61M 16/16 (2006.01) B65D 43/16 (2006.01)
E05D 7/10 (2006.01) E05D 3/00 (2006.01)

(21) International Application Number:

PCT/NZ2013/000175

(22) International Filing Date:

23 September 2013 (23.09.2013)

(25) Filing Language:

English

(26) Publication Language:

English

(30) Priority Data:

61/705,340 25 September 2012 (25.09.2012) US

(71) Applicant: FISHER & PAYKEL HEALTHCARE LIMITED [NZ/NZ]; 15 Maurice Paykel Place, East Tamaki, Auckland, 2013 (NZ).

(72) Inventors: MILLER, Jeremy, Livingston; 15 Maurice Paykel Place, East Tamaki, Auckland, 2013 (NZ). KAT, Arjen, David; 15 Maurice Paykel Place, East Tamaki, Auckland, 2013 (NZ).

(74) Agents: BROWN, Hadleigh, R et al.; A J Park, PO Box 949, Wellington, 6140 (NZ).

(81) Designated States (unless otherwise indicated, for every kind of national protection available): AE, AG, AL, AM, AO, AT, AU, AZ, BA, BB, BG, BH, BN, BR, BW, BY, BZ, CA, CH, CL, CN, CO, CR, CU, CZ, DE, DK, DM, DO, DZ, EC, EE, EG, ES, FI, GB, GD, GE, GH, GM, GT, HN, HR, HU, ID, IL, IN, IS, JP, KE, KG, KN, KP, KR, KZ, LA, LC, LK, LR, LS, LT, LU, LY, MA, MD, ME, MG, MK, MN, MW, MX, MY, MZ, NA, NG, NI, NO, NZ, OM, PA, PE, PG, PH, PL, PT, QA, RO, RS, RU, RW, SA, SC, SD, SE, SG, SK, SL, SM, ST, SV, SY, TH, TJ, TM, TN, TR, TT, TZ, UA, UG, US, UZ, VC, VN, ZA, ZM, ZW.

(84) Designated States (unless otherwise indicated, for every kind of regional protection available): ARIPO (BW, GH, GM, KE, LR, LS, MW, MZ, NA, RW, SD, SL, SZ, TZ, UG, ZM, ZW), Eurasian (AM, AZ, BY, KG, KZ, RU, TJ, TM), European (AL, AT, BE, BG, CH, CY, CZ, DE, DK, EE, ES, FI, FR, GB, GR, HR, HU, IE, IS, IT, LT, LU, LV, MC, MK, MT, NL, NO, PL, PT, RO, RS, SE, SI, SK, SM, TR), OAPI (BF, BJ, CF, CG, CI, CM, GA, GN, GQ, GW, KM, ML, MR, NE, SN, TD, TG).

Published:

— with international search report (Art. 21(3))

(54) Title: LID CONSTRUCTION FOR BREATHING APPARATUS

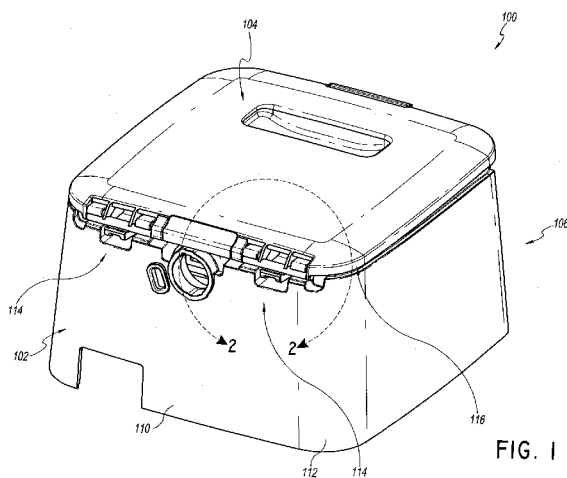

FIG. 1

(57) Abstract: A breathing assistance apparatus has a lid and latch assembly configured for one-handed operation. The apparatus also includes a hinge assembly that separates when over-rotated but that reengages upon closing of the lid onto the main body of the apparatus.



LID CONSTRUCTION FOR BREATHING APPARATUS

BACKGROUND OF THE INVENTION

Field of the Invention

[0001] The present invention generally relates to respiratory devices. More particularly, the present invention relates to respiratory devices in which respiratory gases are supplied at a positive pressure after passing over a surface of liquid in a reservoir.

Description of the Related Art

[0002] CPAP treatment of obstructive sleep apnea involves the delivery of pressurized, breathable gas, usually air, to a user's airways using a conduit and a user interface, such as a mask. The gas pressures employed for CPAP typically range from about 4 cm H₂O to about 28 cm H₂O at flow rates of up to about 180 L/min (measured at the user interface), depend upon the requirements of the user. The pressurized gas acts as a pneumatic splint for the airway of the user. As such, the pressurized gas reduces the likelihood of collapsing of the airway.

SUMMARY OF THE INVENTION

[0003] CPAP machines include an airflow generator to supply the pressurized gas and many CPAP machines include a heated water bath or other source of water for humidification of the pressurized gas. CPAP machines often are used in bedrooms or other sleeping quarters and are placed on nightstands, for example. As such, reducing the footprint of CPAP machines is desirable. In addition, given the limited space of nightstand tops, CPAP machines often are pushed as close to a wall as possible.

[0004] Because of the cramped spaces in which CPAP machines are used, easy manipulation of a lid or other component used to enclose a water reservoir or the like is desired. Preferably, the lid or other such component can be easily pivoted about hinges. More preferably, the hinges are configured to be generally flush with, or recessed into, the adjoining outer surfaces. Even more preferably, the hinges provide a restraint against forces generated by air pressure within the machine (e.g., vertical forces with a generally horizontal lid) while allowing detachment of the lid when the lid is overextended during opening.

[0005] Moreover, to improve the ability to access the water reservoir, the lid preferably carries a latch mechanism such that a user can open the lid with a single hand. In other words, the latch can be operated and the lid can be opened with a single hand and, preferably, with the single hand in a single position. Such configurations are a welcomed
5 improvement over configurations requiring one hand to operate the latch and another hand to subsequently raise the lid.

[0005a] In some configurations, breathing assistance apparatus comprising: a lid and a main body, the lid and the main body selectively enclosing a cavity configured to hold a body of liquid; and at least one hinge assembly comprising at least one post mounted
10 to the lid and at least one support mounted to the main body, wherein the at least one support comprises a recess configured to receive at least a portion of the post, the at least one hinge assembly adapted to provide restraint against air pressure within the apparatus in use, wherein, when the lid is in an open position, the lid can be separated from the main body with application of a sufficient force without breakage of either the at least one support or the at
15 least one post; wherein the at least one hinge assembly comprises a guide structure and cam structure, the guide structure and the cam structure configured to cause sliding movement of the at least one post during rotation of the post, wherein the guide structure comprises a recess configured to receive the cam structure such that the cam structure and the guide structure engage each other and resist detachment of the lid from the main body when the lid
20 is in an at least partially closed position, and wherein when the lid is in the open position, the guide structure is sufficiently spaced from the cam structure such that the lid can be separated from the main body with application of the sufficient force; and wherein the guide structure comprises a guide surface, wherein in use the guide surface contacts the cam structure to move the lid from a detached state to an attached state relative to the main body via the
25 sliding movement of the at least one post as a result of closing motion of the lid.

[0005b] In some configurations, the breathing assistance apparatus further comprises a release assembly.

[0005c] In some configurations, the release assembly comprises a button member.

[0006] In some configurations, a breathing assistance apparatus comprises a lid and a main body with the lid and the main body selectively enclosing a cavity. The lid comprises a button member and at least one hinge assembly.

5 [0007] In some configurations, the lid further comprises a component adapted to be engaged with one or more fingertips while the button member is depressed.

[0008] In some configurations, the button member is spring biased away from the at least one hinge assembly.

[0009] In some configurations, the at least one hinge assembly allows pivotal movement of the lid relative to the main body.

10 [0010] In some configurations, the hinge assembly comprises at least one post and at least one support, the supports overlying the post and the post being positioned inboard of an outer perimeter of the lid.

[0011] Preferably, the hinge assembly comprises a clip extending along at least an axial length of the post, the clip being positioned on an opposite side of the post from the supports such that the post is captured between the clip and the supports.

15 [0012] In some configurations, the at least one hinge assembly comprises a guide structure and cam structure, the guide structure and the cam structure configured to cause sliding movement of the post during rotation of the post.

[0013] In some configurations, the guide structure comprises a guide surface, wherein in use the guide surface contacts the cam structure to move the lid from a detached state to an attached state relative to the main body via the sliding movement of the post as a result of closing motion of the lid.

[0014] Preferably, the sliding movement only occurs when the lid is moved from a disengage state to an engaged state with respect to the main body.

25 [0015] Preferably, the sliding movement of the post is substantially horizontal with the supports being positioned at least vertically above the post with the lid in the closed position.

[0016] In some configurations, the at least one support defines an opening that permits the at least one post to pass through the opening such that in use the lid can be moved from a detached state to an attached state relative to the main body.

30

[0017] In some configurations, a method of opening a lid of a breathing apparatus comprises moving a button member toward an engagement component to unlatch the lid and then rotating the lid to an opened position without the user having to reposition a hand.

[0018] In some configurations, a method of engaging a lid on a main body of a breathing apparatus comprises placing a post alongside at least one support member with the lid in an open position, pivoting the lid toward a closed position such that at least one engaging structures formed on the lid and at least one engaging structure formed on the main body cause the lid to translate into an engaged structure with the lid being pivotable while in the engaged structure.

BRIEF DESCRIPTION OF THE DRAWINGS

[0019] These and other features, aspects and advantages of the present invention will be described with reference to the following drawings.

[0020] Figure 1 is a rear perspective view of a breathing assistance apparatus that is arranged and configured in accordance with certain features, aspects and advantages of the present invention.

[0021] Figure 2 is an enlarged rear top perspective view of a hinge of the breathing assistance apparatus of Figure 1 with a lid in a closed position.

[0022] Figure 3 is an enlarged front perspective view of the hinge of Figure 2 showing the lid in an opened position.

[0023] Figure 4 is a sectioned perspective view of the hinge of Figure 2 showing the lid in a partially closed position.

[0024] Figure 5 is a front perspective view of the lid of the breathing assistance apparatus of Figure 1, which lid is arranged and configured in accordance with certain features, aspects and advantages of the present invention.

[0025] Figure 6 is a rear bottom perspective view of a latch member of the lid of Figure 5.

[0026] Figure 7 is a rear bottom perspective view of the latch member of Figure 6 shown assembled to the lid.

[0027] Figures 8A-8D are side views of a guide structure of the hinge of Figure 2 in several positions from opened to closed.

DETAILED DESCRIPTION OF THE PREFERRED EMBODIMENTS

5 [0028] Figure 1 illustrates a breathing assistance apparatus 100 that is arranged and configured in accordance with certain features, aspects and advantages of the present invention. The apparatus 100 comprises a main body 102 and a lid 104. Together, the main body 102 and the lid 104 define a housing 106 that encloses, or generally encases, a reservoir, tub, tank or other body of liquid (not shown) within a cavity.

10 [0029] The illustrated body 102 comprises at least one outer surface 110. In the illustrated configuration, the body 102 comprises four generally planar outer surfaces 110 that are connected by rounded corners 112. Other configurations are possible.

[0030] The lid 104 is connected to the body 102 with hinge assemblies 114. In the illustrated configuration, the lid 104 is connected to a rear of the main body 102 using
15 two hinge assemblies. The lid 104 can be connected to other surfaces. In addition, the lid 104 can be connected to the main body 102 using as few as one hinge assembly 114 or more than two hinge assemblies 114. Preferably, the hinge assemblies 114 are constructed such that, with the lid 104 in the closed position (e.g., as shown in Figure 1), the hinge assemblies 114 are generally flush with or recessed into the rear outer surface 110. In some
20 configurations, the hinge assemblies 114 are constructed such that the hinge assemblies do not protrude rearward of the rear outer surface 110. In some configurations, some of the hinge features may protrude very slightly from one or more surrounding surface of the rear outer surface or other surrounding portion of the apparatus. In some configurations, the lid 104 comprises an outer perimeter 116 and the hinge assemblies 114 do not protrude
25 significantly outward of the outer perimeter 116 of the lid 104.

[0031] With reference to Figure 2, the hinge assemblies 114 comprise at least one post 120 and at least one support 122. Preferably, the at least one post 120 is mounted such that the post is recessed and located inside of the outer perimeter 116 of the lid. The illustrated configuration comprises a single post 120 that is connected to two supports 122.
30 In some configurations, the at least one post 120 is mounted to the lid 104 while the at least

one support 122 is mounted to the main body 102. In some configurations, the at least one post 120 can be mounted to the main body 102 while the at least one support 122 can be mounted to the lid 104.

5 [0032] The at least one post 120 can be secured to the lid 104 using one or more standoffs 124. In the illustrated construction, the standoffs 124 are positioned between the two supports 122. The standoffs reduce the deflection of the post 120 in the region of the supports 122. In some configurations, the portion 126 of the post 120 extending between the standoffs 124 can be omitted. In the illustrated configuration, however, the portion 126 of the post 120 can be secured by a clip 130. The clip 130 can have a recess that accommodates
10 the post 120 or any other suitable configuration.

[0033] A force generated by the clip 130 on the post 120 in the illustrated configuration is opposed by forces generated by the supports 122, for example. The clip 130 can contact an opposite side of the post 120 relative a contact region between the supports 122 and the post 120. In some configurations, the clip 130 can be configured to deflect away
15 from the post 120 during assembly of the post 120 and the clip 130. For example, the clip 130 can be a deflectable finger that extends rearward from the main body 102. The supports 122 can have a recess that defines a rearwardly-opening mouth that receives at least a portion of a circumference of the post 120. Accordingly, movement of the post 120 in the directions shown by the arrow can result in attachment and detachment of the post 120 relative to the
20 supports 122 and the clip 130. The rearwardly-opening mouth of the supports 122 also results in a structure that overlies the post 120 such that vertical movement of the post 120 relative to the supports 122 is not possible with the post 120 fully received within the mouths of the supports 122. As such, the lid 104 is unlikely to separate from the main body 102 during therapy.

25 [0034] With reference to Figure 3, the lid 104 and the main body 102 can include structures that guide the post 120 and the clip 130 and supports 122 into connection. In some configurations, the structures facilitate movement of the at least one post 120 into the mouth of the supports 122 and into engagement with the clip 130 when the lid 104 is brought toward the closed position on the main body 102. In the illustrated configuration, two guide

structures 140 are positioned outboard of the two supports 122. Other configurations also are possible.

[0035] With reference to Figure 4, the guide structure 140 comprises a recess 142 that receives a cam structure 144. The cam structure 144 is received within the recess 142 such that, with the lid 104 moved to the fully closed position on the main body 102, the cam structure 144 does not prevent the lid 104 from fully closing. The cam structure 144 tapers toward a point with a sloping surface 146 such that the thickness of the cam structure 144 increases from back to front while the guide structure has an opposing surface 150. The sloping surface 146 and the opposing surface 150 engage each other such that the sloping surface 146 and the opposing surface 150 resists movement of the lid 104 relative to the main body 102 in the detachment direction (see Figure 2) when the lid 104 is in an at least partially closed position.

[0036] Moreover, as the lid 104 is rotated toward a closed position (e.g., Figure 1), the sloping surface 146 and the opposing surface 150 act to draw the lid 104 forward into the attachment position (e.g., the at least one post 120 connected to the supports 122 and the clip 130). Thus, rotation of the lid 104 can result in the hinge assemblies 114 being operatively connected from a detached state. In some configurations, the difference in thicknesses of the sloping surface 146 and the opposing surface 150 from initial contact to fully closed is substantially the same as a distance from the outer surface of the post 120 and the first contact with the supports 122 such that as the sloping and opposing surfaces 146, 150 are moved into full engagement along their lengths, the post 120 is pulled into position within the supports 122 and the clip 130.

[0037] Notably, with the lid 104 in the open position (e.g., Figure 3) relative to the main body 102, sufficient space exists between the sloping surface 146 and the opposing surface 150 such that the lid 104 can be separated from the main body 102 with the application of force. Advantageously, such a construction allows separation between the lid 104 and the main body 102 by disconnection of the posts 120 from the supports 122 and the clips 130. Such a separation can protect the apparatus 100 from damage resulting from forces that result from over-opening of the lid or from possible misuse of the apparatus 100. Accordingly, the ability to separate the lid 104 from the main body 102 can protect the

apparatus 100 from permanent damage. As discussed above, the lid 104 can be easily reconnected by placing the posts 120 alongside the supports 122 and rotating the lid 104 toward a closed position, which results in the sloping surface 146 of the cam structure 144 and the opposing surface 150 of the guide structure drawing the components back together.

5 **[0038]** With reference now to Figure 5, a release and handle assembly 160 of the lid 104 will be described. As illustrated, the release and handle assembly 160 comprises at least one button member 162 that is mounted on the lid 104. In some configurations, the button member 162 is mounted for movement toward and away from the hinge assemblies 162. In some configurations, the button member 162 can be mounted along a side of the lid 104 that is adjacent to the side of the lid 104 having the hinge assemblies 162. In the 10 illustrated configuration, the button member 162 is mounted on an opposing side of the lid 104 relative to the hinge assemblies 114 and capable of movement toward and away from the hinge assemblies 114.

[0039] The button member 162 is illustrated in Figure 6. The button member 15 comprises an exterior surface 164, which is best shown in Figure 5. The exterior surface 164 is sufficiently large for contact with a finger or thumb. As also illustrated in Figure 5, the lid 104 can comprise a component 166 that is used to raise the lid 104. In the illustrated configuration, the component 166 is a recessed region that has a wall 170 extending generally parallel with the exterior surface 164. Preferably, the recessed region 166 is sufficiently large 20 as to accommodate at least tips of fingers. In some configurations, the component 166 is one or more lip, ridge, protrusion, recess or the like. Accordingly, the component 166 (e.g., having the wall 170) and the exterior surface 164 can allow a simple squeezing action to accomplish both an unlatching of the button member 162 as well as providing a grasping action to allow movement of the lid 104 away from the main body 102.

25 **[0040]** With reference again to Figure 6, the illustrated button member 162 comprises two outer posts 172. The posts 172 are sized and configured to engage with biasing members, such as compression springs or the like, for example but without limitation. The posts 172 are received within corresponding housings 174 that are formed in the lid 104. The housings 174 can contain the biasing members and the posts 172 can slide into and out 30 of the housings 174 against the biasing force of the biasing members.

[0041] The illustrated button member 162 also comprises at least one tab 176. In the illustrated configuration, the button member 162 comprises two tabs 176. The tabs 176 are bayonet shaped with a barb 180 at the end. As shown in Figure 7, the tabs 176 can engage a structure 182 formed in the lid 104. Thus, the tabs 176 in cooperation with the structure reduce the likelihood of the button member 162 coming out of a recess of the lid 104 while allowing inward depression of the button member 162 relative to the lid 104.

[0042] The structure 182 also comprises a passage 184 that receives a finger 186 mounted to, or formed on, the button member 162. The passage 184 facilitates generally only linear translation of the button member 162 relative to the lid 104. In other words, the passage 184 receives the finger 186 and the finger 186 is generally limited by the passage 184 to substantially linear movement.

[0043] The finger 186 supports a locking post 190. The locking post 190 can engage with a structure formed on the main body 102. In some configurations, the locking post 190 engages with a structure formed on an inner surface of the main body 102 such that the depression of the button member 162 results in separation between the locking post 190 and the structure with which it normally engages. Releasing of the button member 162 results in the biasing members moving the locking post 190 into position for reengagement with the structure with which it normally engages.

[0044] Figures 8A-8D illustrate the lid 104 in several positions relative to the main body 102. Figure 8A illustrates the lid 104 in a first opened position. Figures 8B and 8C illustrate the lid 104 in progressively further closed positions relative to the first opened position of Figure 8A. Figure 8D illustrates the lid 104 in a closed position. In particular, Figures 8A-8D further illustrate the interaction between the sloping surface, or cam surface, 146 of the cam structure 144 and the opposing surface (also referred to as a guide surface or cam follower surface) 150 of the lid recess 142 as the lid 104 moves from an opened position to a closed position. As described herein, the cam structure 144 and the recess 142 can interact to move the lid 104 from a detached position relative to the main body 102 to an attached position relative to the main body 102 when the lid 104 is moved from an opened position to a closed position.

[0045] As described herein, the support 122 includes the recess 200 comprising the mouth 202, which opens in a rearward direction in the illustrated arrangement. Preferably, the recess 200 is elongate in shape and extends in a generally fore-aft direction. In the illustrated arrangement, the recess 200 is generally or substantially horizontal or aligned with a bottom support surface of the main body 102 such that the recess 200 is generally or substantially horizontal when the apparatus 100 is rested on a flat surface. The recess 200 includes upper and lower guide surfaces 204 that extend forwardly from the mouth 202 to an end surface 206. As described herein, the support 122 also assists in retaining the lid 104 on the main body 102 in response to forces within the housing 106 (e.g., forces resulting from internal pressure) tending to separate the lid 104 from the main body 102. Thus, the upper portion of the end surface 206 and/or the upper guide surface 204 can form a retention surface that contacts the post 120 to retain the lid 104, or at least a portion of the lid 104 near the support 122 and/or hinge 114 (e.g., a rearward portion), on the main body 102 in response to forces tending to separate the lid 104 from the main body 102.

[0046] In the illustrated arrangement, the end surface 206 is curved (e.g., semi-circular) in shape from a side view and connects the upper guide surface 204 and the lower guide surface 204. The illustrated support 122 is elongate in a lateral or side-to-side direction and, thus, defines a substantially semi-cylindrical shape in three dimensions. However, for convenience, the hinge 114, guide structure 140 and cam structure 144 may be described herein in the context of the side views of Figures 8A-8D in two-dimensional terms. It will be appreciated that the described structures also have a width dimension relative to the apparatus 100 or a depth dimension relative to the side view of Figures 8A-8D.

[0047] The illustrated end surface 206 is defined by a curve having a radius 208 from a center point 210 (or an axis in three dimensions). The recess 200 can have a longitudinal axis 212 that extends along a length of the recess 200 generally from the mouth 202 to the end surface 206 and, in the illustrated configuration, passes through the center point 210. The axis 212 can be aligned with or parallel to one or both of the upper and lower guide surfaces 204 or can be centrally-located between the guide surfaces 204 (such as in the event of a tapered recess, for example and without limitation). In the illustrated configuration, the axis 212 is generally or substantially horizontal (or parallel to a bottom

surface of the main body 102). However, in other configurations, the axis 212 could be non-horizontal or angled relative to the bottom surface of the main body 102).

[0048] As described herein, the post 120 preferably is cylindrical in shape or circular in shape from a side view, as illustrated in Figures 8A-8D. The post 120 defines a center point 214 (or an axis in three dimensions) and a radius 216. Preferably, the radius 216 of the post 120 is substantially equal to the radius 208 of the end surface 206 such that the post 120 can be snugly positioned against the end surface 206 and restrained in a vertical direction within recess 200 with the center points 210, 214 substantially aligned or coaxial with one another.

[0049] Preferably, the cam surface or sloping surface 146 of the cam structure 144 is positioned or oriented relative to the end surface 206 and/or center point 210 such that the post 120 is moved along the axis 212 of the recess 200 toward the end surface 206 as the lid 104 is moved from the opened toward the closed position. In the illustrated arrangement, a first distance 220 is defined between a first point or location 222 on the sloping surface 146 and the center point 210 and a second distance 224 is defined between a second point or location 226 on the sloping surface 146 and the center point 210. Preferably, the first point 222 is located on an initial portion of the sloping surface 146 and the second point 226 is located on a subsequent portion of the sloping surface 146 such that the opposing surface 150 will contact the first point 222 before the second point 226 as the lid 104 is moved from an opened position to a closed position. The first point 222 can be at or near the location that is first contacted by the opposing surface 150 during closing of the lid 104 and the second point 226 can be at or near the furthest location along the sloping surface 146 contacted by the opposing surface 150 when the lid 104 is in the closed position. The first distance 220 preferably is smaller than the second distance 224, which causes the movement of the post 120 along the axis 212 of the recess 200 as the lid 104 is moved from an opened position to a closed position and the opposing surface 150 moves along the sloping surface 146 in a direction from the first point 222 towards the second point 226.

[0050] A distance 228 traveled by the center point 214 of the post 120 within the recess 200 when the lid 104 is closed preferably is substantially equal to a difference 230 between the second distance 224 and the first distance 220. The distance 228 can be less than

an overall length of the recess 200 because the post 120 can be at least partially located within the recess 200 prior to being drawn to the end surface 206 by the guide structure 140. In other arrangements, the distance 228 could be substantially equal to a length of the recess 200. Although the distances described immediately above are in relation to the center points 210 and 214, the distances similarly could be measured relative to other points on locations on the recess 200 (e.g., end surface 206) and post 120, respectively, if desired, such as in the context of non-circular (or non-cylindrical) recess or post shapes.

[0051] Figure 8A illustrates the lid 104 in a first open position relative to the main body 102, which may be a fully opened position, such as when initiating a process of reattachment of the lid 104. As illustrated, the opposing surface 150 is clear of the sloping surface 146 such that rearward movement (e.g., detachment) of the lid 104 is permitted. Advantageously, such an arrangement reduces the likelihood of permanent damage resulting from excessive opening forces applied to the lid 104. Figure 8B illustrates the lid 104 in a second open position that is further towards a closed position relative to the first open position of Figure 8A. In Figure 8B, the opposing surface 150 remains clear of the sloping surface 146. That is, a vertical gap exists between a bottom of the opposing surface 150 and a top of the sloping surface 146.

[0052] Figure 8C illustrates the lid 104 in a third open position that is further towards a closed position relative to the positions of Figures 8A and 8B. In the position of Figure 8C, a leading portion or engagement portion 232 of the opposing surface 150 is engaged with or contacts an initial portion of the sloping surface 146, which may be at or near the first point or location 222. In the illustrated arrangement, the post 120 is spaced away from the end surface 206 of the recess 200. Figure 8D illustrates the lid 104 in a position that is further towards a closed position than the positions of Figures 8A-8C. The position of Figure 8D can be a fully closed position of the lid 104. In the illustrated arrangement, at least the leading portion or engagement portion 232 of the opposing surface 150 is engaged with or contacts a subsequent portion of the sloping surface 146 spaced from the initial portion. The subsequent portion may be at or near the second point or location 226. Preferably, the post 120 is snugly positioned against the end surface 206 in the position

of Figure 8D. Thus, preferably, a distance between the engagement surface 232 and the center point 214 is preferably substantially equal to the second distance 224.

[0053] As described herein, the interaction of the guide structure 140 and the cam structure 144 as illustrated in Figures 8A-8D may occur only during a reattachment or engagement procedure for the lid 104. In normal opening and closing movement, sliding of the post 120 (or significant sliding of the post 120) within the recess 200 may not occur. Advantageously, such an arrangement reduces wear by reducing the amount of sliding movement between components during normal use. However, other arrangements are possible in which the sliding movement of the post 120 occurs more often than only during engagement of the lid 104, such as during normal opening and closing of the lid 104.

[0054] Although the illustrated opposing surface 150 has a similar size and shape as the sloping surface 146 and extends along a substantial portion of the sloping surface 146 when the lid 104 is in the closed position, other arrangements are also possible. For example, the opposing surface 150 could be a smaller surface, such as a cam follower surface, defining an engagement portion 232 that contacts only a point or small length of the sloping surface 146 in any one position. The engagement portion 232 could be rotatable such that it rolls along the sloping surface 146, if desired. Moreover, as disclosed herein, the illustrated arrangements could be reversed such that the cam surface or sloping surface 146 is carried by the lid 104 and the opposing surface 150 (or cam follower with engagement portion 232) is carried by the main body 102.

[0055] Unless the context clearly requires otherwise, throughout the description and the claims, the words “comprise”, “comprising”, and the like, are to be construed in an inclusive sense as opposed to an exclusive or exhaustive sense, that is to say, in the sense of “including, but not limited to”.

[0056] Reference to any prior art in this specification is not, and should not be taken as, an acknowledgement or any form of suggestion that that prior art forms part of the common general knowledge in the field of endeavour in any country in the world.

[0057] The invention may also be said broadly to consist in the parts, elements and features referred to or indicated in the specification of the application, individually or collectively, in any or all combinations of two or more of said parts, elements or features.

[0058] Where, in the foregoing description reference has been made to integers or components having known equivalents thereof, those integers are herein incorporated as if individually set forth.

5 [0059] It should be noted that various changes and modifications to the presently preferred embodiments described herein will be apparent to those skilled in the art. Such changes and modifications may be made without departing from the spirit and scope of the invention and without diminishing its attendant advantages. It is therefore intended that such changes and modifications be included within the scope of the invention.

WHAT IS CLAIMED IS:

1. A breathing assistance apparatus comprising:

a lid and a main body, the lid and the main body selectively enclosing a cavity configured to hold a body of liquid; and

5 at least one hinge assembly comprising:

at least one post mounted to the lid and at least one support mounted to the main body, wherein the at least one support comprises a recess configured to receive at least a portion of the post, the at least one hinge assembly adapted to provide restraint against air pressure within the apparatus in use,

10 wherein, when the lid is in an open position, the lid can be separated from the main body with application of a sufficient force without breakage of either the at least one support or the at least one post;

wherein the at least one hinge assembly comprises a guide structure and cam structure, the guide structure and the cam structure configured to cause sliding movement of the at least one post during rotation of the post, wherein the guide structure comprises a recess configured to receive the cam structure such that the cam structure and the guide structure engage each other and resist detachment of the lid from the main body when the lid is in an at least partially closed position, and wherein when the lid is in the open position, the guide structure is sufficiently spaced from the cam structure such that the lid can be separated from the main body with application of the sufficient force; and

20 wherein the guide structure comprises a guide surface, wherein in use the guide surface contacts the cam structure to move the lid from a detached state to an attached state relative to the main body via the sliding movement of the at least one post as a result of closing motion of the lid.

2. The apparatus of claim 1, further comprising a release member.

3. The apparatus of claim 2, wherein the release member comprises a button member.

30

4. The apparatus of Claim 3, wherein the lid further comprises a component adapted to be engaged with one or more fingertips while the button member is depressed.

5. The apparatus of any one of Claims 3 or 4, wherein the button member is spring-biased away from the at least one hinge assembly.

6. The apparatus of any one of claims 3 to 5, wherein the button member is spring biased away from the at least one hinge assembly.

10 7. The apparatus of any one of the preceding claims wherein the at least one hinge assembly allows pivotal movement of a lid relative to the main body.

8. The apparatus of any one of the preceding claims, wherein the at least one hinge assembly allows pivotal movement of the lid relative to the main body.

15

9. The apparatus of any one of the preceding claims, wherein the hinge assembly comprises a clip extending along at least an axial length of the at least one post, the clip being positioned on an opposite side of the at least one post from the at least one support such that the at least one post is captured between the clip and the at least one support.

20

10. The apparatus of any one of the preceding claims, wherein the hinge assembly comprises a clip extending along at least an axial length of the at least one post, the clip being positioned on an opposite side of the at least one post from the at least one support such that the at least one post is captured between the clip and the at least one support.

25

11. The apparatus of any one of the preceding claims, wherein the sliding movement only occurs when the lid is moved from a disengaged state to an engaged state with respect to the main body.

12. The apparatus of any one of the preceding claims, wherein the sliding movement of the at least one post is substantially horizontal with the supports being positioned at least vertically above the at least one post with the lid in the closed position.

5 13. The apparatus of any one of the preceding claims, wherein the at least one support defines an opening that permits the at least one post to pass through the opening such that in use the lid can be moved from a detached state to an attached state relative to the main body.

10 14. The apparatus of any one of the preceding claims, further comprising a reservoir, tub, or tank or other body of liquid enclosed within the cavity.

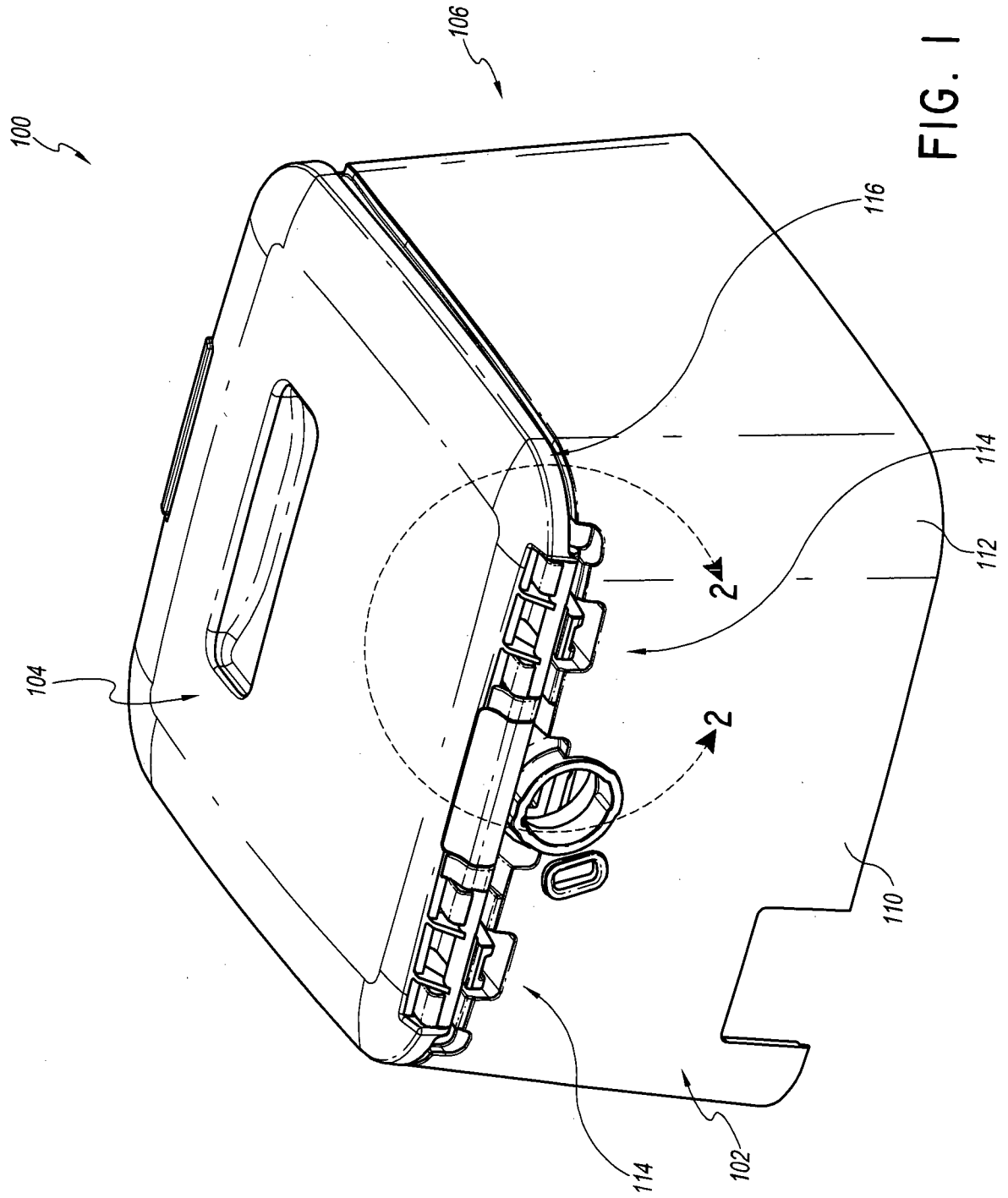

FIG. 1

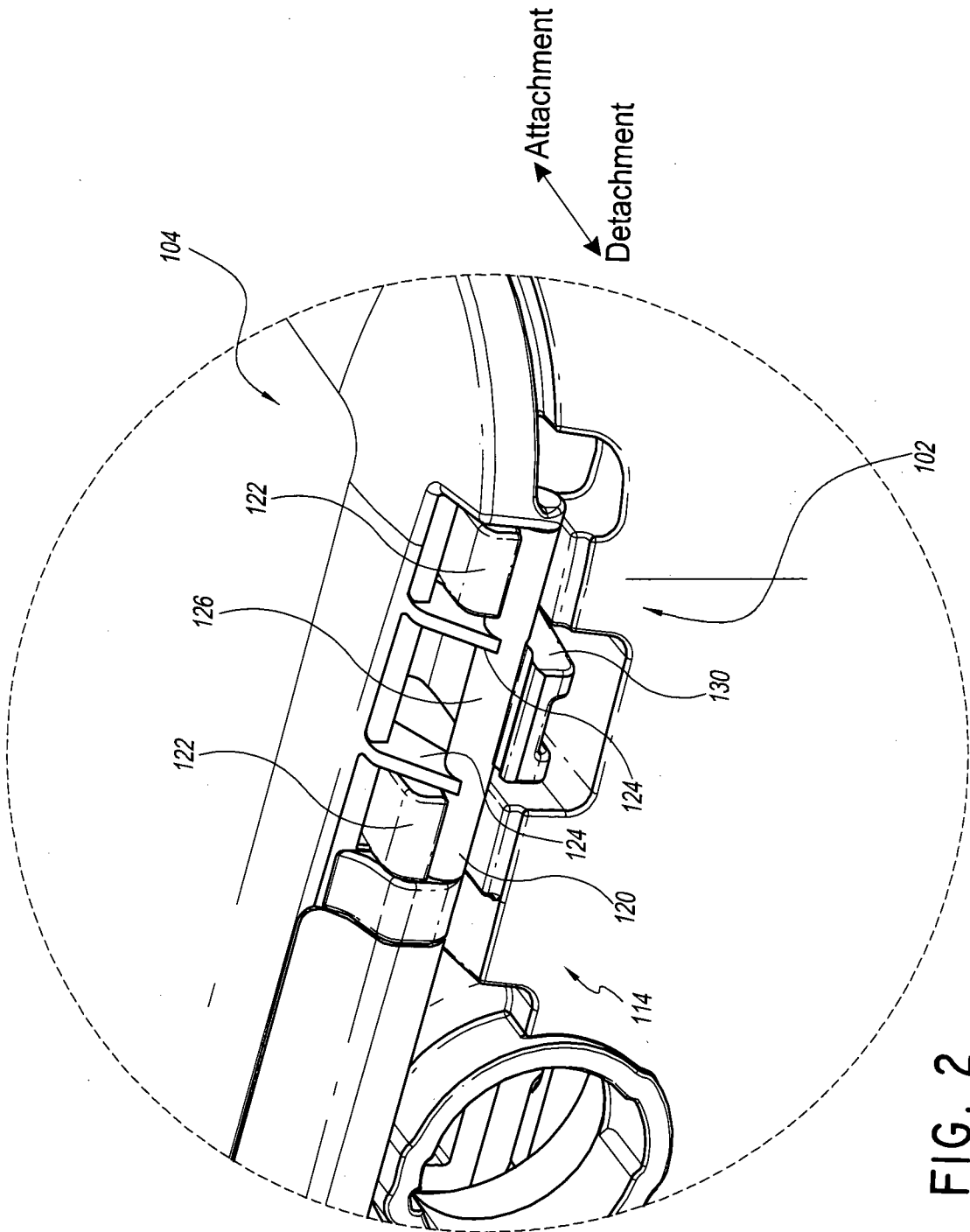

FIG. 2

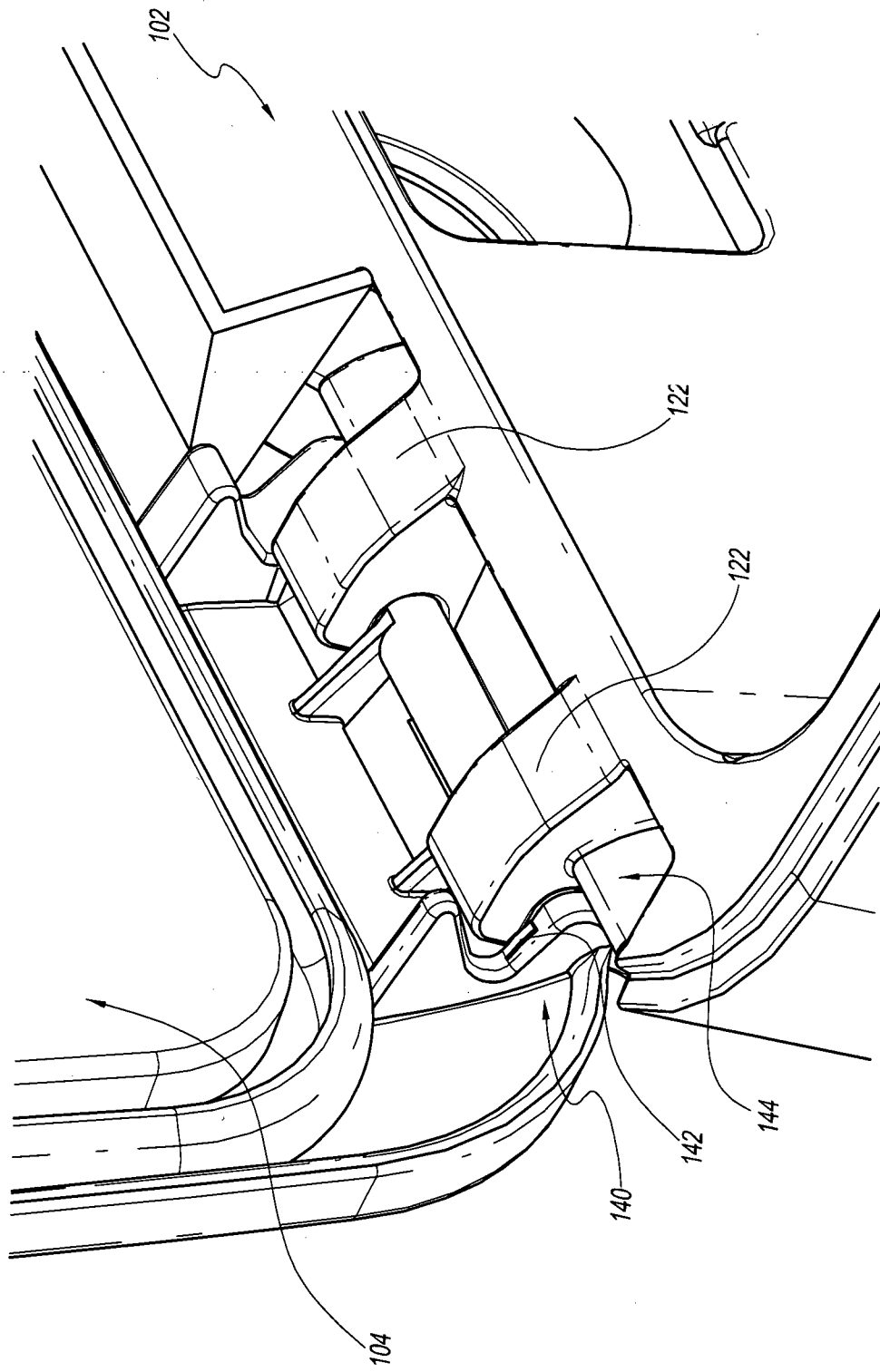

FIG. 3

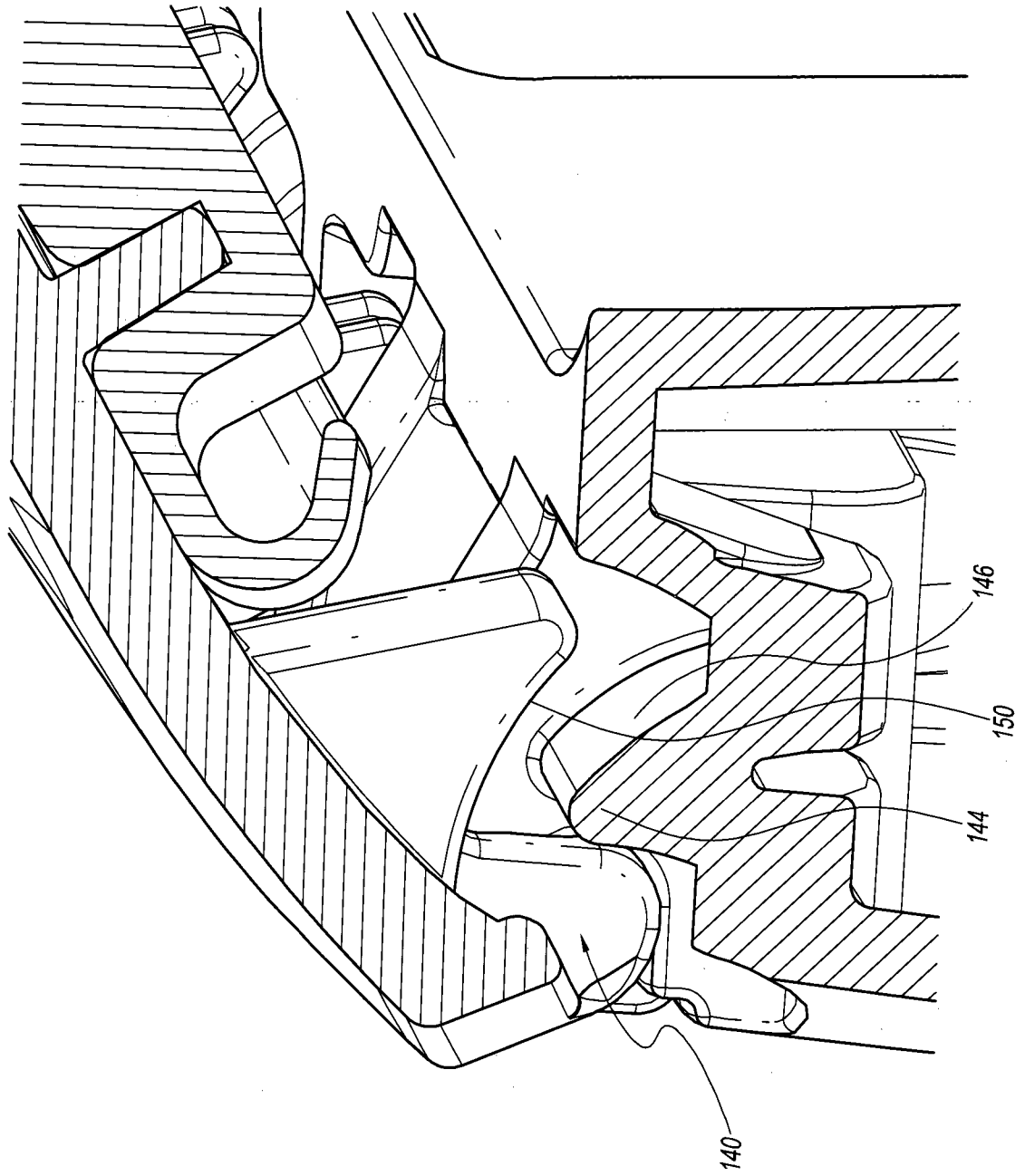

FIG. 4

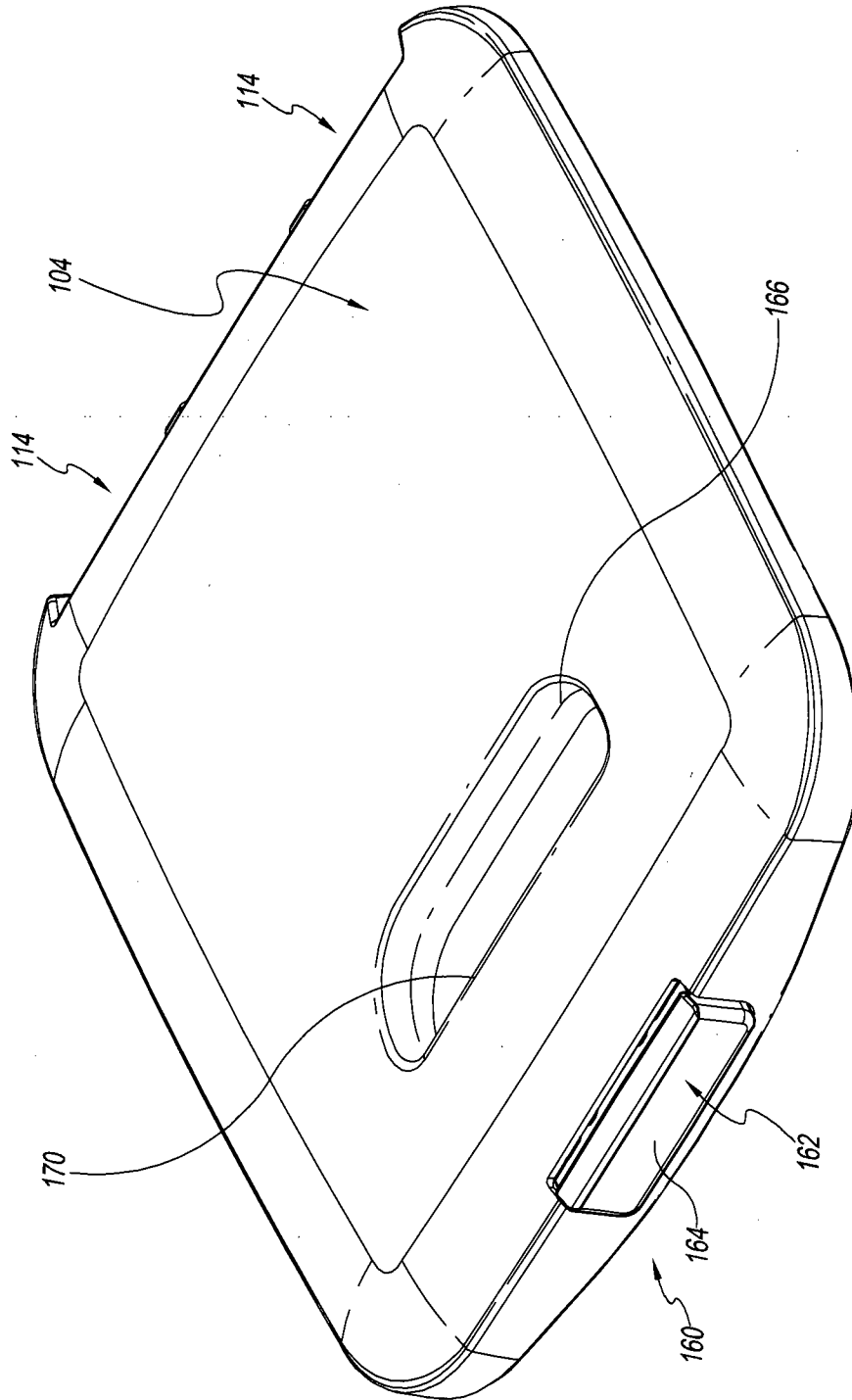

FIG. 5

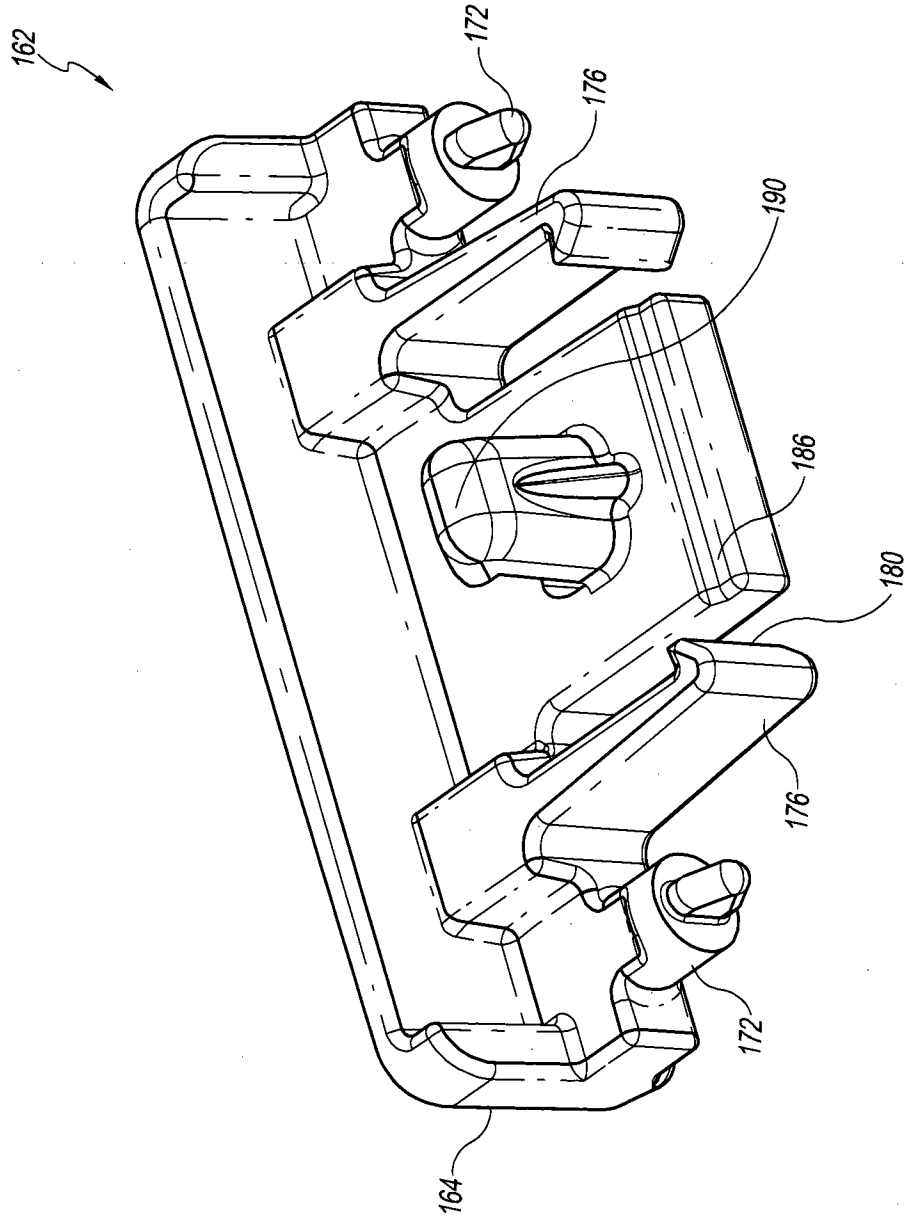

FIG. 6

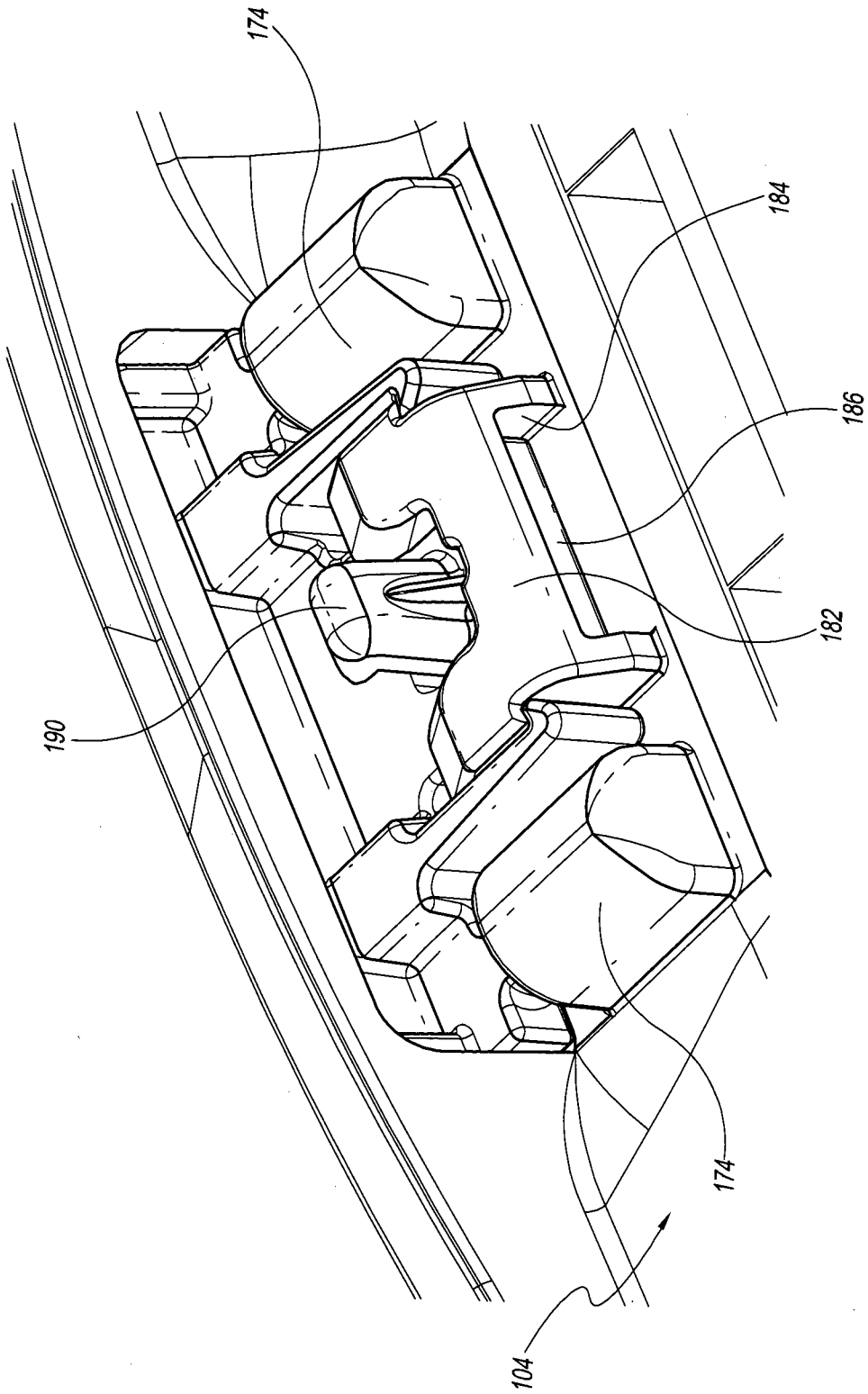

FIG. 7

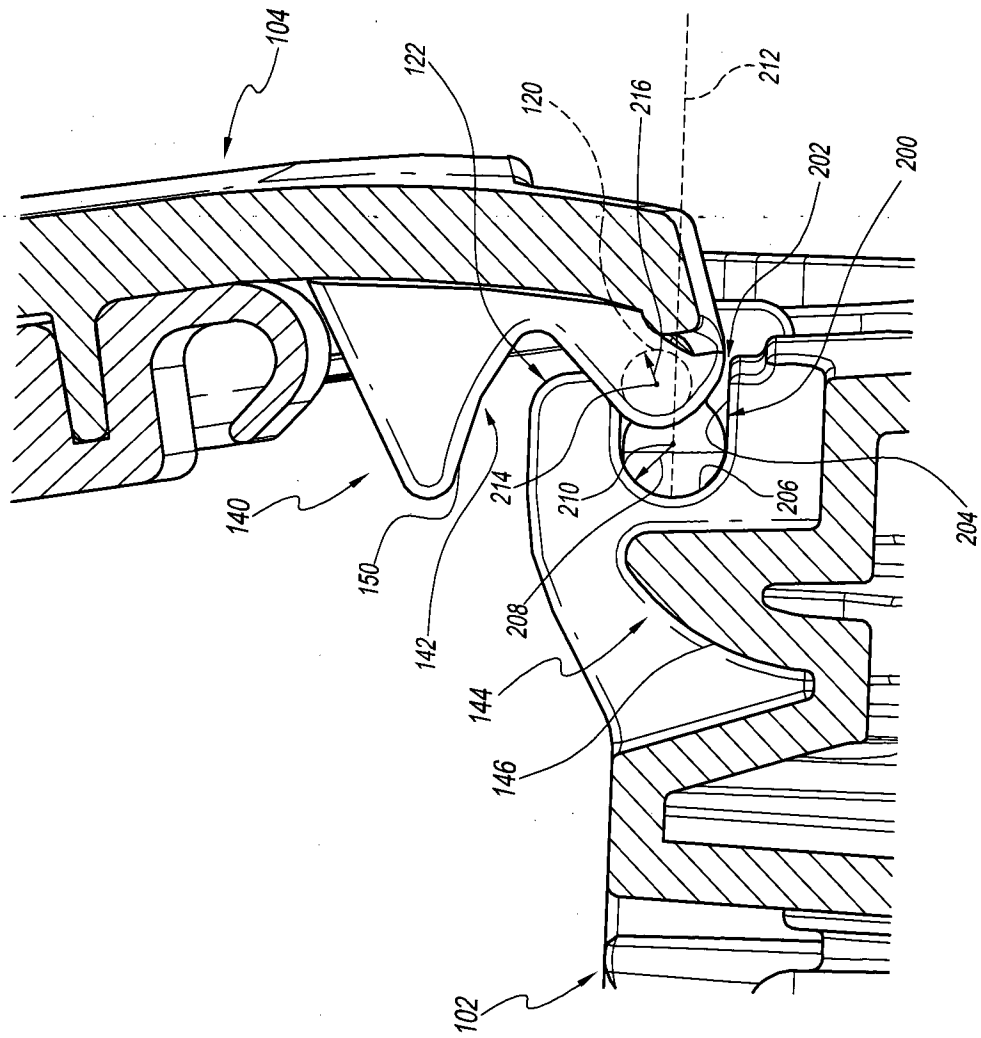

FIG. 8A

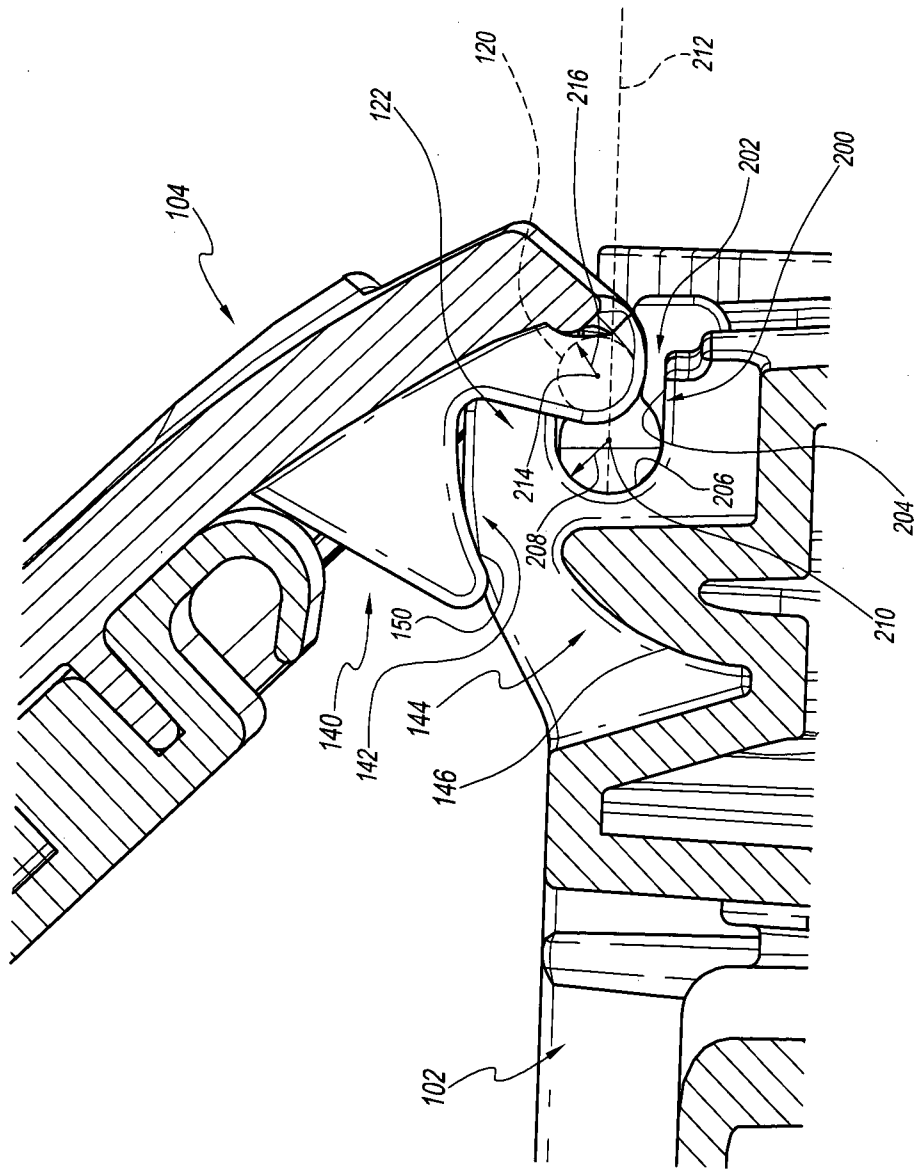

FIG. 8B

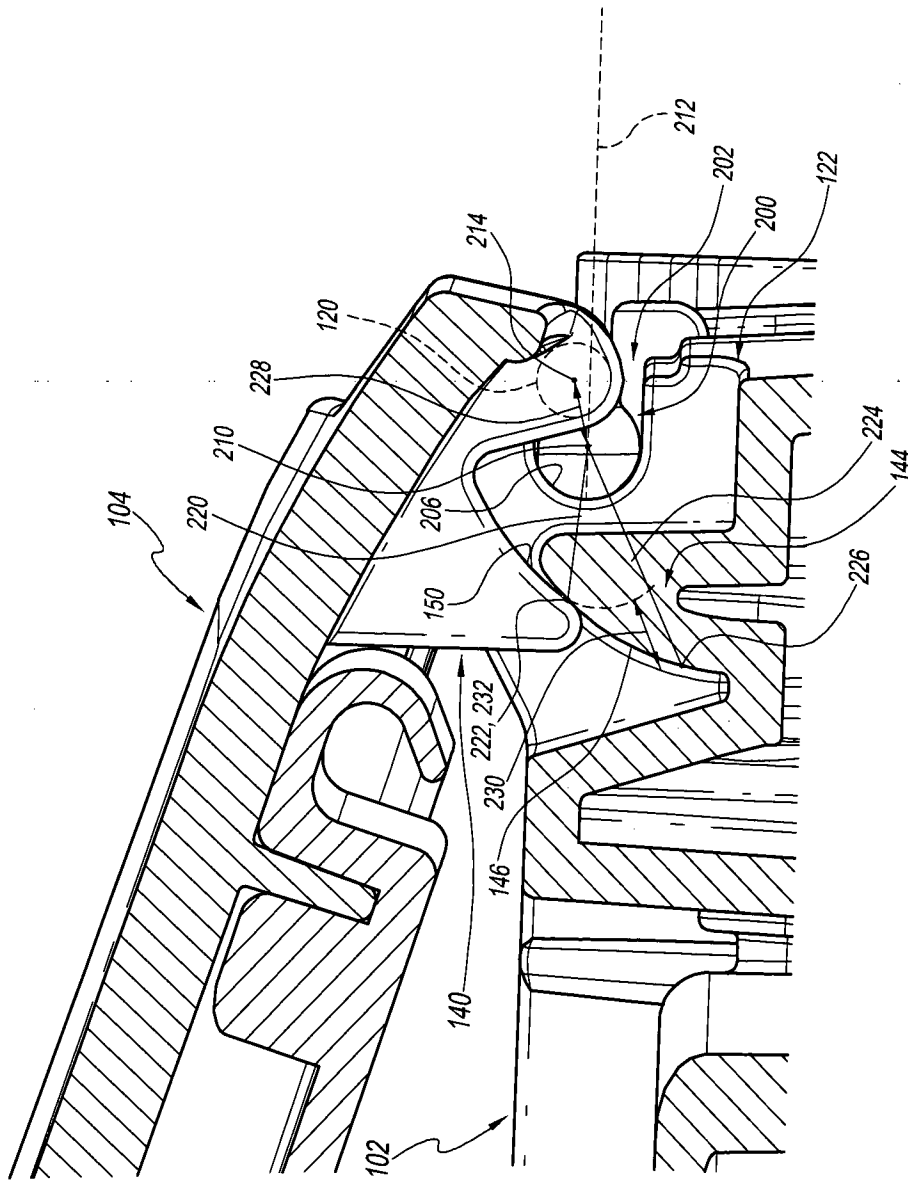

FIG. 8C

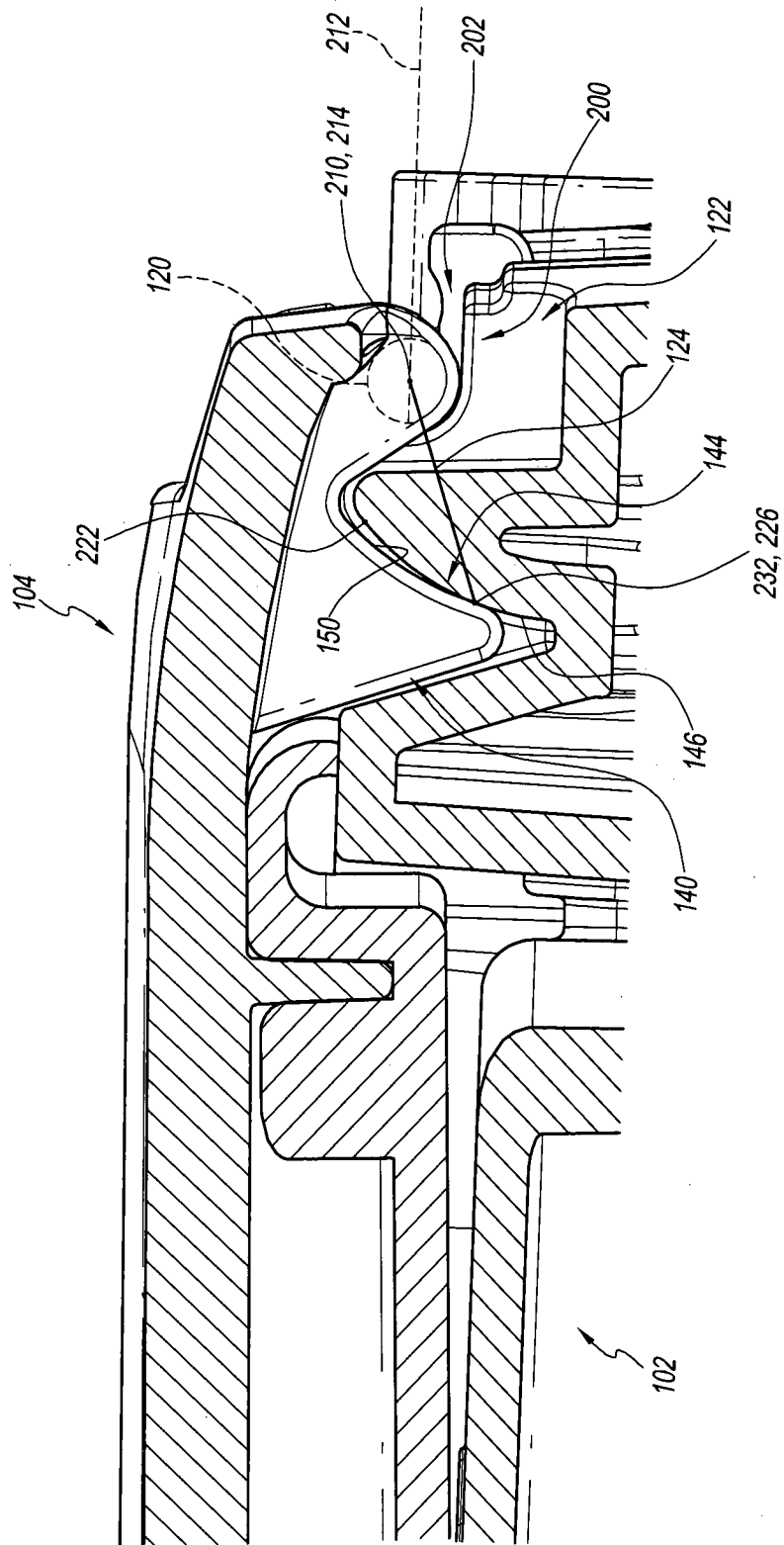

FIG. 8D