

(12) STANDARD PATENT
(19) AUSTRALIAN PATENT OFFICE

(11) Application No. **AU 2016200301 B2**

(54) Title
FENCE POST INSULATOR FOR ELECTRIFIABLE PLASTIC COATED WIRE

(51) International Patent Classification(s)
H01R 9/16 (2006.01)

(21) Application No: **2016200301** (22) Date of Filing: **2016.01.19**

(30) Priority Data

(31) Number	(32) Date	(33) Country
14/835,012	2015.08.25	US

(43) Publication Date: **2017.03.16**

(43) Publication Journal Date: **2017.03.16**

(44) Accepted Journal Date: **2021.05.06**

(71) Applicant(s)
John Wall, Inc.

(72) Inventor(s)
Wall, John R.

(74) Agent / Attorney
Spruson & Ferguson, GPO Box 3898, Sydney, NSW, 2001, AU

(56) Related Art
FR 2299707 A1

ABSTRACT

An insulator for holding an electrifiable wire includes a base, a first connecting portion provided on a first end of the base, and a second connecting portion provided on a second end of the base. The first connecting portion and the second connecting portion may be movable between a first, open position and a second, closed position.

FENCE POST INSULATOR FOR ELECTRIFIABLE PLASTIC COATED WIRE

BACKGROUND OF THE INVENTION

Field of the Invention

[0001] This disclosure relates generally to insulator clips and, more particularly, to fence post insulators for electrifiable plastic coated wire.

Description of Related Art

[0002] Current fence post insulators used today are configured to support an electrifiable or conducting material for electric fences. The insulators are typically secured to a fence post or structure using screws, nails, staples, and other fastening members. To secure the insulators to the fence post or structure, an individual is required to hold both the insulator and the fastening element to attach the insulator to the fence post or structure. Since the individual must use both hands to align separate elements, this can often be a difficult and lengthy process for an individual who needs to install a large quantity of insulators around an enclosed area. It also becomes difficult to run the electrifiable wire through the insulator after the insulator has been installed on the fence post or structure. To ease the installation of the electrifiable wire into the insulator, current insulators include an open aperture that permits the electrifiable wire to be inserted therein using an interference fit. Typically, the aperture remains open on the insulator permitting the electrifiable wire to be inadvertently pulled out of the insulator. In the event an object, such as a fenced-in animal, contacts the electrifiable wire or fence post, the electrifiable wire may be pulled out of the open aperture of the insulator.

[0003] U.S. Patent No. 6,489,569 to Thomson, the disclosure of which is incorporated in its entirety by reference, discloses a typical fence post insulator. The insulator is fastened to a fence post or structure using a plurality of nails. After the insulator has been installed, an electrifiable wire is pressed into the open aperture of the insulator past an interference fit to hold the electrifiable wire in the insulator. After installation of the wire, however, the aperture remains open. The aperture is not closed to retain the electrifiable wire in the insulator. Therefore, the electrifiable wire is capable of becoming loose and falling out of the insulator.

[0004] Many current electric fence insulators are designed and manufactured for semi-permanent installations. These insulators are lightweight to reduce the cost of manufacturing and rely on the psychological barrier of an electrified barrier to keep an animal in an enclosed area.

Typically, an electrifiable twine (polywire) or even lightweight steel wire is used in the insulators and can create a maintenance issue that requires daily inspections and repairs.

[0005] In recent years, a new electrifiable plastic coated fence wire has become widely used in the equine market worldwide because of its safety factor to animals and reduced likelihood of entanglement. Therefore, this long-lasting, permanent fencing material requires a rugged, functional, and uniquely designed insulator to match the permanency of the material the insulator holds. In view of the foregoing, a need exists for a fence post insulator that is easily attached to an electrifiable wire and to a fence post or structure. A further need exists for a fence post insulator that effectively and securely retains an electrifiable wire within the insulator.

SUMMARY OF THE INVENTION

[0006] Accordingly, and generally, a fence post insulator for electrifiable plastic coated wire is provided to address and/or overcome some or all of the deficiencies and drawbacks associated with existing fence post insulators.

[0007] In a first aspect, an insulator for holding an electrifiable wire may include a base, a first connecting portion provided on a first end of the base, and a second connecting portion provided on a second end of the base. The first connecting portion and the second connecting portion may be movable between a first, open position and a second, closed position.

[0008] The first connecting portion may include a substantially C-shaped end. The second connecting portion may include a substantially C-shaped end. The base may be made of a flexible material. The base may be movable from an arcuate first position to a substantially planar second position. A first aperture may be defined in the first connecting portion. A second aperture may be defined in the second connecting portion. The first aperture may include a first seat surface. The second aperture may include a second seat surface. The base may be substantially circular. The insulator may be formed as a monolithic unit.

[0009] In a second aspect, a method of retaining an electrifiable wire in an insulator may include inserting an electrifiable wire into an aperture defined by a first connecting portion and a second connecting portion of the insulator, and rotating the first connecting portion and the second connecting portion towards one another to close the aperture. The method may also include pressing one of the first connecting portion and the second connecting portion against a base of the insulator to cause the first connecting portion and the second connecting portion to rotate towards one another. The method may also include gripping the first connecting portion

and the second connecting portion to manually rotate the first connecting portion and the second connecting portion towards one another.

[0010] These and other features and characteristics of the fence post insulator, as well as the method of installing the fence post insulator, will become more apparent upon consideration of the following description and the appended claims with reference to the accompanying drawings, all of which form a part of this specification, wherein like reference numerals designate corresponding parts in the various figures. It is to be expressly understood, however, that the drawings are for the purpose of illustration and description only and are not intended as a definition of the limits of the invention. As used in the specification and the claims, the singular form of “a”, “an”, and “the” include plural referents unless the context clearly dictates otherwise.

BRIEF DESCRIPTION OF THE DRAWINGS

[0011] **FIG. 1** is a side perspective view of a fence post insulator including an electrifiable wire installed therein according to an aspect of this disclosure;

[0012] **FIG. 2** is a rear perspective view of the fence post insulator of **FIG. 1**;

[0013] **FIG. 3** is a front view of the fence post insulator of **FIG. 1**;

[0014] **FIG. 4** is a side view of the fence post insulator of **FIG. 1** in a first, open position;

[0015] **FIG. 5** is a side view of the fence post insulator of **FIG. 1** in a second, closed position;

[0016] **FIG. 6** is a rear view of the fence post insulator of **FIG. 1**;

[0017] **FIG. 7** is a bottom view of the fence post insulator of **FIG. 1**; and

[0018] **FIG. 8** is a cross-sectional view of the fence post insulator of **FIG. 1** along line A-A of **FIG. 7**.

DETAILED DESCRIPTION OF THE PREFERRED EMBODIMENT

[0019] For purposes of the description hereinafter, the terms “upper”, “lower”, “right”, “left”, “vertical”, “horizontal”, “top”, “bottom”, “lateral”, and “longitudinal”, and derivatives thereof shall relate to the invention as it is oriented in the drawing figures. However, it is to be understood that the invention may assume alternative variations and step sequences, except where expressly specified to the contrary. It is also to be understood that the specific devices and processes illustrated in the attached drawings, and described in the following specification, are simply exemplary aspects of the invention. Hence, specific dimensions and other physical characteristics related to the aspects disclosed herein are not to be considered as limiting.

[0020] The present disclosure is directed to, in general, a fence post insulator for electrifiable wire and a method of installing electrifiable wire into the fence post insulator. Certain preferred and non-limiting aspects of the components of the fence post insulator are illustrated in **FIGS. 1-8**. Although the following description describes the fence post insulator in use with a fence post, it is also to be understood that the insulator may be used on alternative materials such as wood, steel, piping, plastic, or composite posts.

[0021] With reference to **FIGS. 1-8**, a fence post insulator **2** (hereinafter referred to as “insulator **2**”) is described. The insulator **2** includes a base **4** (also referred to as a spark guard), a first connecting portion **6**, and a second connecting portion **8**. The base **4**, first connecting portion **6**, and second connecting portion **8** may be formed and manufactured as a single, monolithic structure or assembled as separate individual components that are welded, fastened, or adhesively connected to one another. In one aspect, the base **4** may have a generally circular shape. The base **4** may be made of a substantially flexible material, such as plastic. Plastic provides strength, flexibility, and acceptance of UV stabilizers for the insulator **2**. Further, the insulator **2** may be formed from plastic that is different from the plastic used to coat an electrifiable wire **20** held in the insulator **2** to reduce friction when sliding the electrifiable wire **20** through the insulator **2**, thereby reducing wear and tear on the insulator **2** when under tension. As shown in **FIG. 4**, in a first, open position of the insulator **2**, the base **4** may be biased into a curved position. As shown in **FIG. 5**, in a second, closed position of the insulator **2**, the base **4** may be snapped into a substantially straight, planar configuration. The installation and use of the insulator **2** will be described in greater detail below.

[0022] In one aspect, the first connecting portion **6** and the second connecting portion **8** are substantially identical to one another. It is also contemplated that the dimensions and shape of the connecting portions **6, 8** may differ slightly from one another. The connecting portions **6, 8** are generally rectangular in shape and include a substantially C-shaped opening **10a, 10b** provided on an inner surface thereof. The openings **10a, 10b** are configured to receive an electrifiable wire **20** (shown in **FIG. 1**) to hold to a fence post. In one aspect, the electrifiable wire **20** may be a 12.5 gauge, high tensile strength wire. Current insulator clips are more light weight and designed to hold lighter weight wire, which is easily dislodged from the fence post upon an animal or object contacting the wire. The current insulator **2** is configured to receive and hold a larger electrifiable wire, which is more difficult for an animal or object to dislodge from a

fence post. In the first, open position of the insulator **2**, the openings **10a**, **10b** are positioned apart from one another to define a passageway **11** to permit the electrifiable wire **20** to be inserted therethrough. In the second, closed position of the insulator **2**, the openings **10a**, **10b** may abut one another to close the passageway **11** to prevent the electrifiable wire **20** from falling or pulling out of the openings **10a**, **10b**. As shown in **FIG. 5**, when the insulator **2** is in the second closed position, the openings **10a**, **10b** may be configured to form a closed circular opening. It is also contemplated that the openings **10a**, **10b** may not abut one another in the second, closed position, but instead they may leave a small gap between one another. This gap may be small enough to prevent the electrifiable wire **20** from being pulled out of the insulator **2**. However, it is preferred that the openings **10a**, **10b** abut one another to close the opening to restrict moisture from contacting the electrifiable wire **20**, which could become a conductor for electrical shorting.

[0023] The connecting portions **6**, **8** may also define a central aperture **12a**, **12b** to receive a fastening member (not shown) to fasten the insulator **2** to a fence post. The fastening member may be a nail, screw, bolt, staple, pin, or any other suitable fastener to hold the insulator **2** to a fence post. In one aspect, the fastening member may be a shouldered, self-tapping attaching screw for the fence post, which may be used on wood, steel, or plastic. The central apertures **12a**, **12b** may be circular in shape and extend from a front surface of each respective connecting portion **6**, **8** to a rear surface of each respective connecting portion **6**, **8**. In one aspect, the upper edges of the central apertures **12a**, **12b** may be chamfered to assist in directing the fastening members into the central apertures **12a**, **12b**. Although the central apertures **12a**, **12b** may not be chamfered by providing a squared-off edge entrance and exit for the central apertures **12a**, **12b**, this may result in damage to the tensioned electrifiable wire **20** through impact or contraction and expansion. Each central aperture **12a**, **12b** may also include a seat **13a**, **13b** configured to catch and support a head or portion of a fastening member to limit the length of the fastening member that is inserted into the fence post. A plurality of side apertures **14a-14d** may also be defined in the connecting portions **6**, **8**. Two of the apertures **14a**, **14d** may extend into the connecting portions **6**, **8**, but not so far as to extend into the central apertures **12a**, **12b**. Two of the apertures **14b**, **14c** may extend from a first side of each respective connecting portion **6**, **8** into a portion of the respective connecting portion **6**, **8** closer to the center of the insulator **2**, but not so far as to extend into the opening formed by the connecting portions **6**, **8**. The same type of

apertures **14a-14d** may also be provided on a second side of the insulator **2**. The apertures **14a-14d** may be provided to reduce the material needed to manufacture and form the insulator **2**. The apertures **14b, 14c** may be configured so as not to extend into the opening defined by the connecting portions **6, 8** so that dust, cob webs, and other debris is not permitted to deposit in the opening defined by the connecting portions **6, 8**, which can cause the electrifiable wire **20** to short out.

[0024] With reference to **FIGS. 4** and **5**, a method of installing one electrifiable wire **20** into the insulator **2** and a method of fastening the insulator **2** to a fence post is described. Initially, the insulator **2** may be formed/manufactured into a first open position (shown in **FIG. 1**). In the first, open position, the openings **10a, 10b** of the connecting portions **6, 8** are positioned apart from one another to create the passageway **11**. The individual will then insert the electrifiable wire **20** through the passageway **11** into the openings **10a, 10b**. The electrifiable wire **20** may be freely inserted through the passageway **11** so as not to contact the sides of the openings **10a, 10b** or the openings **10a, 10b** may be positioned close enough together to create an interference fit with the electrifiable wire **20**.

[0025] After the electrifiable wire **20** has been inserted into the openings **10a, 10b**, the individual may press either the first connecting portion **6** or the second connecting portion **8** against the base **4** to cause the connecting portions **6, 8** to rotate inwardly in a rotational direction **R** (shown in **FIG. 4**). As the connecting portions **6, 8** are pressed, the base **4** is flattened into a substantially straight, planar orientation to snap together the openings **10a, 10b** of the connecting portions **6, 8**. The openings **10a, 10b** are brought into abutment with one another to close the electrifiable wire **20** inside of the insulator **2**. When the openings **10a, 10b** are brought into abutment, the passageway **11** is closed to retain the electrifiable wire **20** in the insulator **2**. After the connecting portions **6, 8** have been rotated to retain the electrifiable wire **20** in the insulator **2**, the insulator **2** may be fastened to the fence post by inserting fastening members through the central apertures **12a, 12b** of the connecting portions **6, 8**. This method may be repeated for each insulator **2** to form a fenced-in area. By retaining the electrifiable wire **20** in the insulator **2** before fastening the insulator **2** to the fence post, the individual can properly visualize the position of and orient the insulator **2** and electrifiable wire **20** on the fence post at a desired position. Unlike current insulators that need to be removed from the fence post to re-adjust the

position of the electrifiable wire **20** on the fence post, the insulator **2** of the present disclosure may be properly positioned prior to fastening the insulator **2** on the fence post.

[0026] In an alternative aspect, after the electrifiable wire **20** has been inserted into the openings **10a**, **10b**, the individual may instead grip both connecting portions **6**, **8** and rotate the connecting portions **6**, **8** inwardly in a rotational direction **R** (shown in **FIG. 4**). As the connecting portions **6**, **8** are rotated, the base **4** is flattened into a substantially straight, planar orientation to snap together the openings **10a**, **10b** of the connecting portions **6**, **8**. The openings **10a**, **10b** are brought into abutment with one another to close the electrifiable wire **20** inside of the insulator **2**. When the openings **10a**, **10b** are brought into abutment, the passageway **11** is closed to retain the electrifiable wire **20** in the insulator **2**. In a further alternative aspect, instead of rotating the connecting portions **6**, **8** by hand, the individual can position the insulator **2** on the fence post and fasten the insulator **2** to the fence post by inserting fastening members through the central apertures **12a**, **12b**. As the fastening members are inserted further into the central apertures **12a**, **12b**, the connecting portions **6**, **8** are rotated in rotational direction **R** against the fence post. As the connecting portions **6**, **8** are rotated, the openings **10a**, **10b** are brought into abutment to retain the electrifiable wire **20** in the insulator **2**. Using this method, an individual may simultaneously fasten the insulator **2** to the fence post and retain the electrifiable wire **20** in the insulator **2**. After the insulator **2** has been fastened to the fence post, a small gap may be established between the base **4** and the fence post. In one aspect, the distance defined by the gap between the base **4** and the fence post may be approximately 0.025 inches. By defining this small gap, the insulator **2** may be provided on a plurality of different fence posts that may have variable surfaces. The base **4** may also be slightly flexible to allow play in the base **4** to adapt to the variable surfaces of the different fence posts. In one aspect, the base **4** may be angled 2 degrees relative to the fence post.

[0027] While various aspects of the insulator were provided in the foregoing description, those skilled in the art may make modifications and alterations to these aspects without departing from the scope and spirit of the invention. For example, it is to be understood that this disclosure contemplates that, to the extent possible, one or more features of any aspect may be combined with one or more features of any other aspect. Accordingly, the foregoing description is intended to be illustrative rather than restrictive. The invention described hereinabove is defined by the

appended claims and all changes to the invention that fall within the meaning and the range of equivalency of the claims are to be embraced within their scope.

[0028] In this specification, the terms “comprise”, “comprises”, “comprising” or similar terms are intended to mean a non-exclusive inclusion, such that a system, method or apparatus that comprises a list of elements does not include those elements solely, but may well include other elements not listed.

[0029] The reference to any prior art in this specification is not, and should not be taken as, an acknowledgement or any form of suggestion that the prior art forms part of the common general knowledge.

THE INVENTION CLAIMED IS:

1. An insulator for holding an electrifiable wire, comprising:
a base;
a first connecting portion provided on a first end of the base; and a
second connecting portion provided on a second end of the base,
wherein the first connecting portion and the second connecting portion are
movable between a first, open position and a second, closed position so that, upon
providing pressure on at least one of the first connecting portion and the second
connecting portion, the first connecting portion and the second connecting portion are
snapped together to retain the electrifiable wire within the insulator.
2. The insulator as claimed in claim 1, wherein:
the first connecting portion comprises a substantially C-shaped end; and
the second connecting portion comprises a substantially C-shaped end.
3. The insulator as claimed in claim 1, wherein the base is made of a flexible
material.
4. The insulator as claimed in claim 1, wherein the base is movable from an
arcuate first position to a substantially planar second position.
5. The insulator as claimed in claim 1, further comprising:
a first aperture defined in the first connecting portion; and
a second aperture defined in the second connecting portion.
6. The insulator as claimed in claim 5, wherein:
the first aperture comprises a first seat surface; and
the second aperture comprises a second seat surface.
7. The insulator as claimed in claim 1, wherein the base is substantially
circular.

8. The insulator as claimed in claim 1, wherein the insulator is formed as a monolithic unit.

9. A method of retaining an electrifiable wire in an insulator, comprising:

a. inserting an electrifiable wire into an aperture defined by a first connecting portion and a second connecting portion of the insulator; and

b. applying pressure to at least one of the first connecting portion and the second connecting portion to snap the first connecting portion and the second connecting portion towards one another to close the aperture.

10. The method as claimed in claim 9, further comprising pressing one of the first connecting portion and the second connecting portion against a base of the insulator to cause the first connecting portion and the second connecting portion to rotate towards one another.

11. The method as claimed in claim 9, further comprising gripping the first connecting portion and the second connecting portion to manually rotate the first connecting portion and the second connecting portion towards one another.

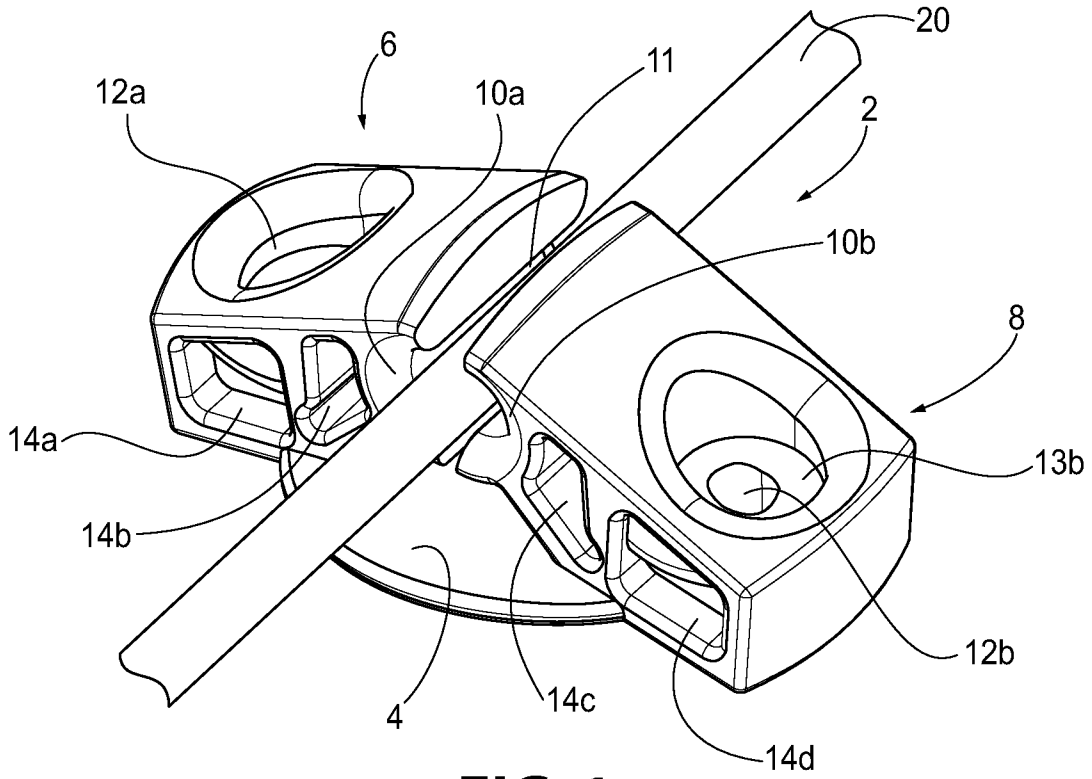

FIG. 1

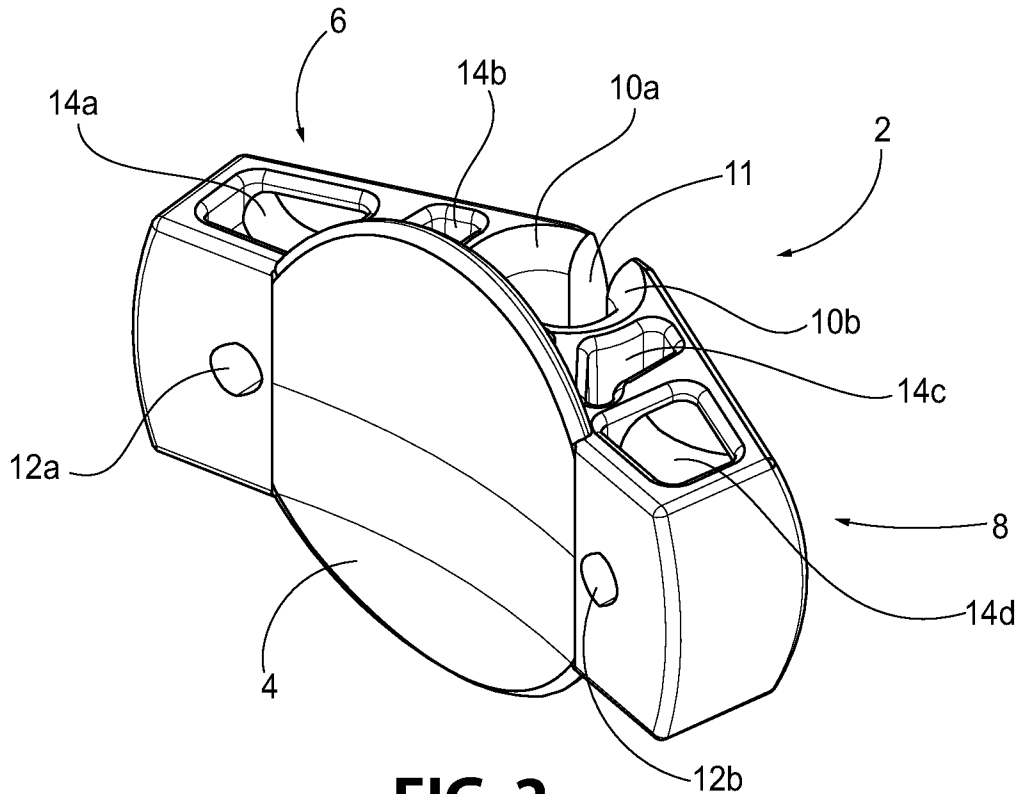

FIG. 2

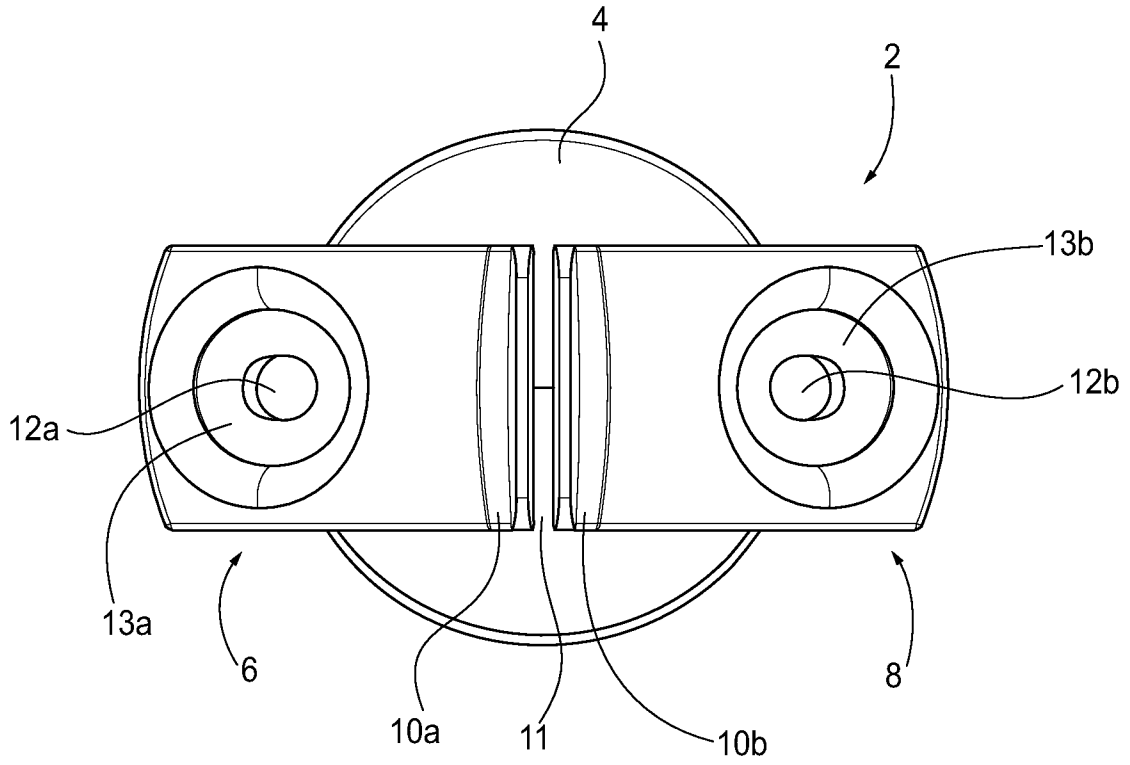

FIG. 3

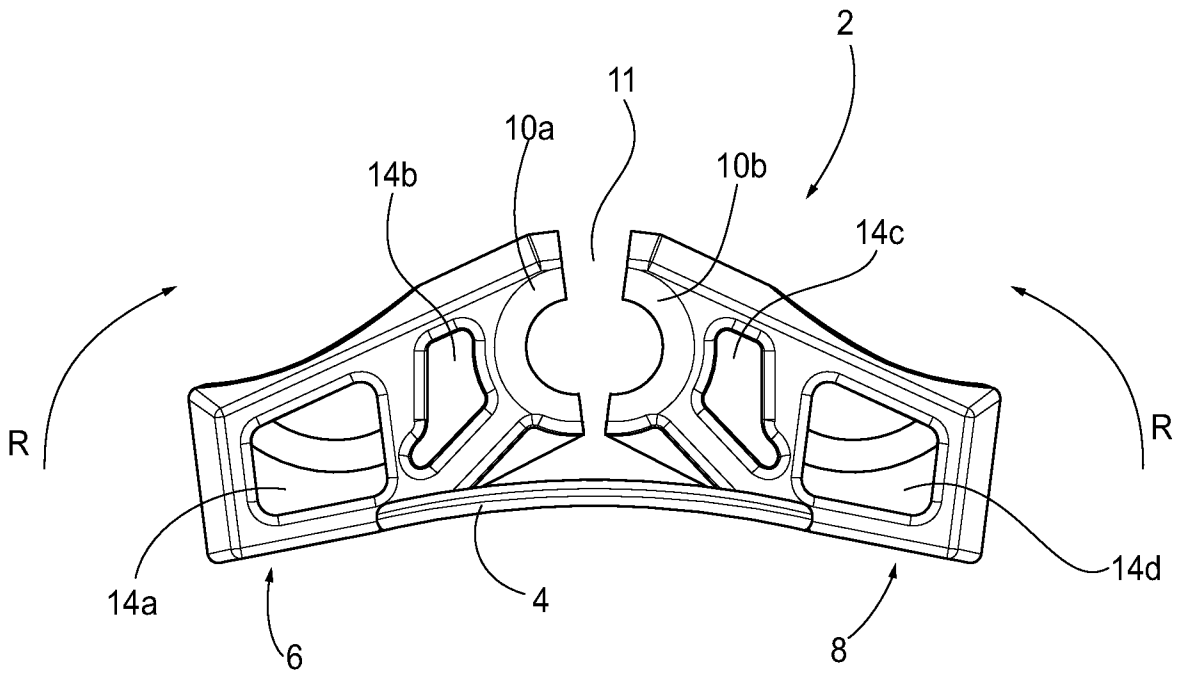

FIG. 4

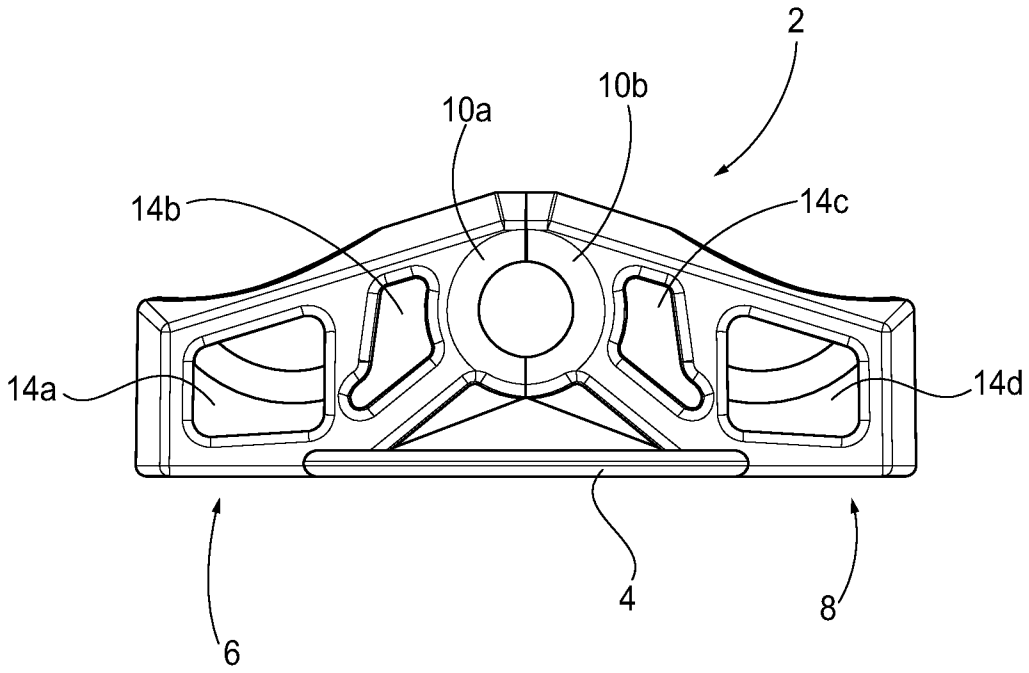

FIG. 5

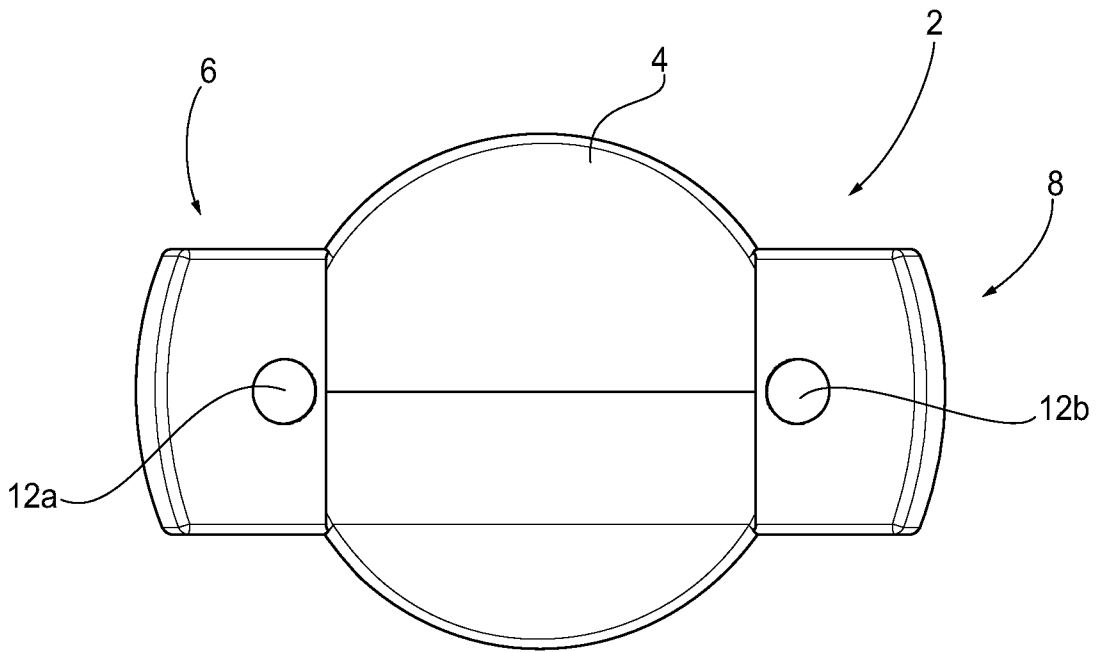

FIG. 6

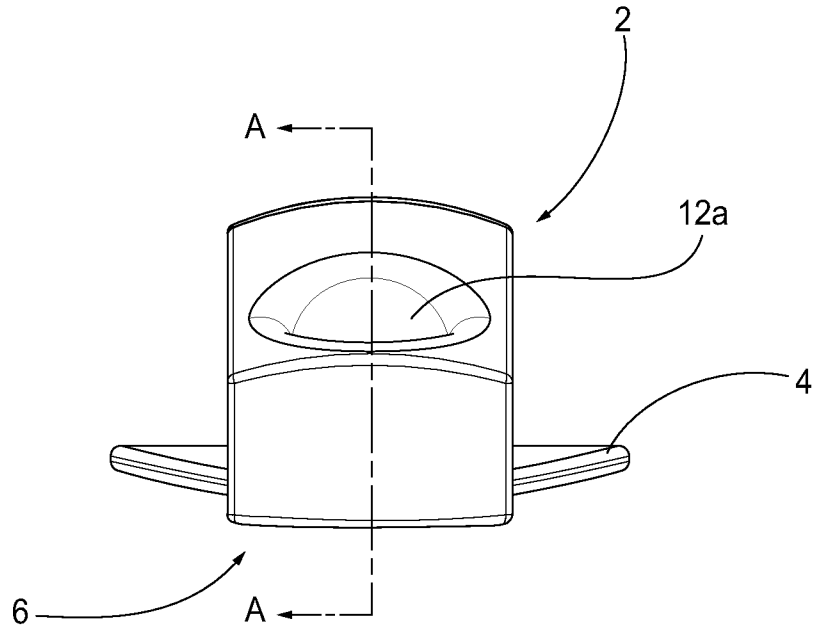

FIG. 7

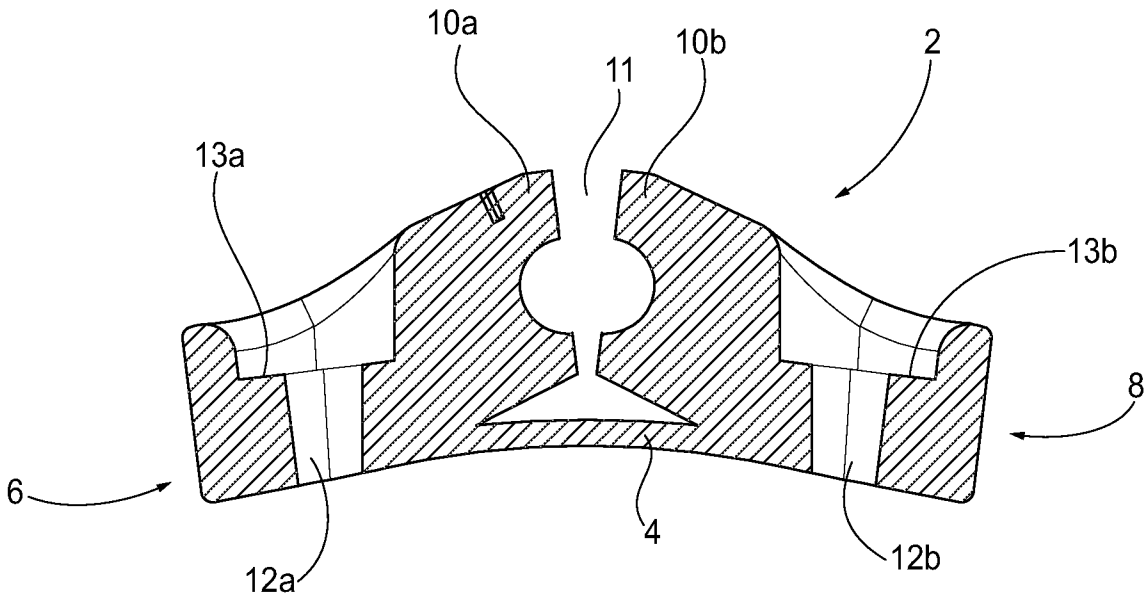

FIG. 8