



US00D720561S

(12) **United States Design Patent**
Burden

(10) **Patent No.:** **US D720,561 S**

(45) **Date of Patent:** **** Jan. 6, 2015**

(54) **CHEST OF DRAWERS**

(71) Applicant: **Ian James Burden**, Sovereign Islands (AU)

(72) Inventor: **Ian James Burden**, Sovereign Islands (AU)

(**) Term: **14 Years**

(21) Appl. No.: **29/491,929**

(22) Filed: **May 27, 2014**

(30) **Foreign Application Priority Data**

Nov. 27, 2013 (AU) 14887/2013

(51) **LOC (10) Cl.** **06-04**

(52) **U.S. Cl.**
USPC **D6/671**

(58) **Field of Classification Search**
USPC D6/663, 664, 664.1, 665, 667, 671,
D6/671.1, 671.2; 312/138.1, 204, 224,
312/237, 257.1, 249.4, 330.1
See application file for complete search history.

(56) **References Cited**

U.S. PATENT DOCUMENTS

D164,614 S * 9/1951 Wallace et al. D6/671
D189,041 S * 10/1960 Knusen D6/671

D197,071 S * 12/1963 Smith D6/671
D267,378 S * 12/1982 Mower et al. D6/665
D397,559 S * 9/1998 Zaidman D6/671.1
D471,735 S * 3/2003 Draheim et al. D6/671
D542,056 S * 5/2007 Puente et al. D6/671
D560,926 S * 2/2008 Draheim D6/671
D560,927 S * 2/2008 Draheim D6/671
D560,928 S * 2/2008 Draheim D6/671
D632,507 S * 2/2011 Sweeney D6/671
D653,051 S * 1/2012 Lin D6/671
D663,136 S * 7/2012 Thompson D6/671

* cited by examiner

Primary Examiner — Mimosa De

(74) *Attorney, Agent, or Firm* — Dykema Gossett PLLC

(57) **CLAIM**

The ornamental design for a chest of drawers, as shown and described.

DESCRIPTION

FIG. 1 is a front view of a chest of drawers showing my new and ornamental design,
FIG. 2 is a rear view thereof,
FIG. 3 is a left side view thereof,
FIG. 4 is a right side view thereof,
FIG. 5 is a top view thereof; and,
FIG. 6 is a bottom view thereof.

1 Claim, 3 Drawing Sheets

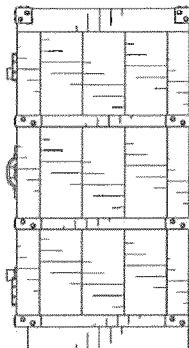
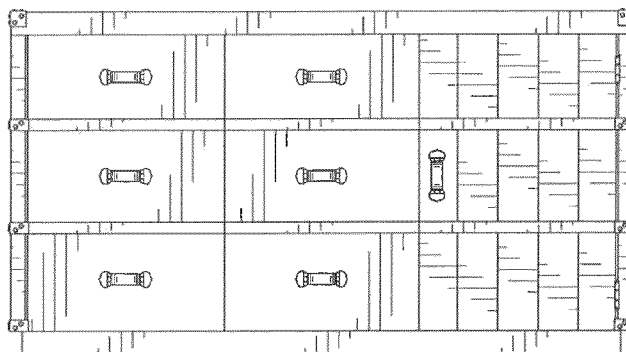

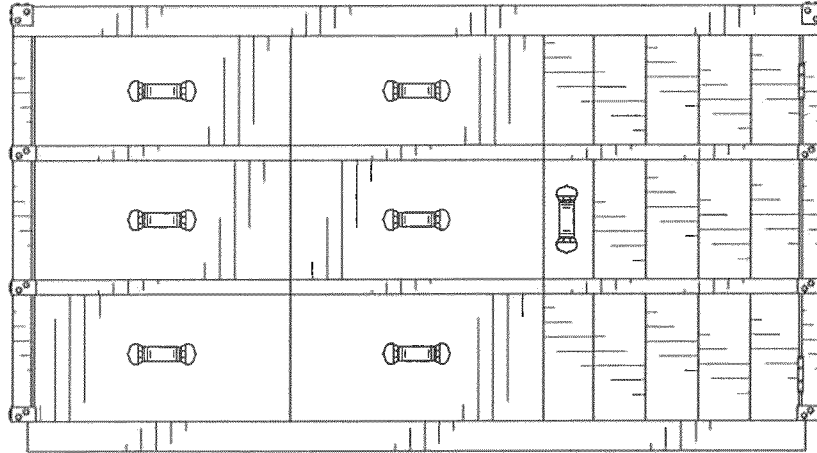

FIG. 1

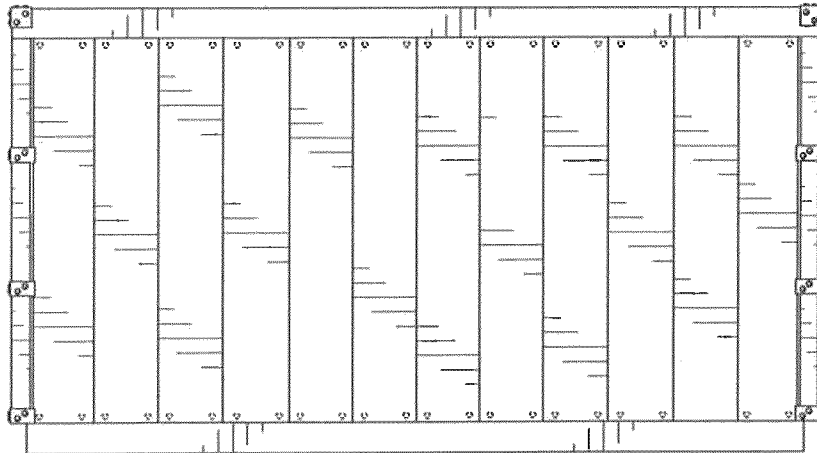

FIG. 2

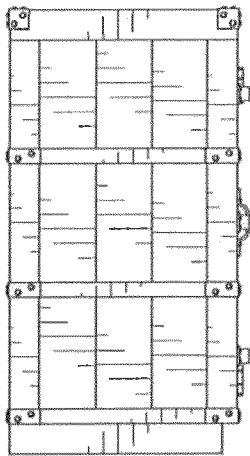

FIG. 3

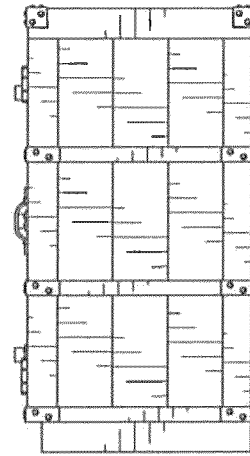

FIG. 4

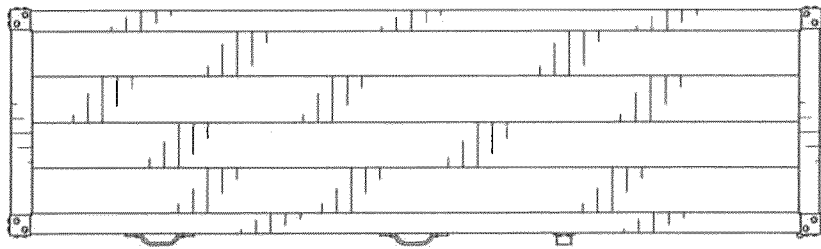

FIG. 5

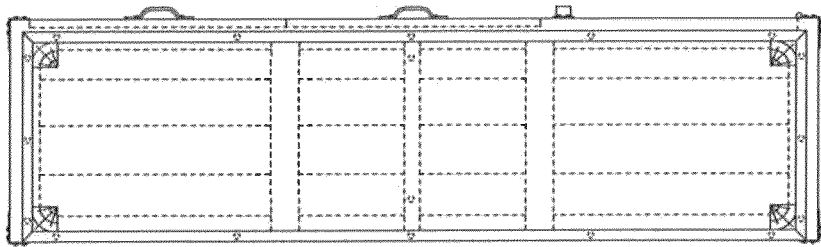

FIG. 6