



US 20160143404A1

(19) **United States**
(12) **Patent Application Publication**
Wright

(10) **Pub. No.: US 2016/0143404 A1**
(43) **Pub. Date: May 26, 2016**

(54) **SIMULATED CROSS PENDANT AND JEWELRY**

(52) **U.S. Cl.**
CPC *A44C 25/005* (2013.01); *A44C 25/001* (2013.01)

(71) Applicant: **Stacy Wright**, La Verne, CA (US)

(72) Inventor: **Stacy Wright**, La Verne, CA (US)

(21) Appl. No.: **14/555,571**

(22) Filed: **Nov. 26, 2014**

(57) **ABSTRACT**

A simulated cross pendant connected to a piece of jewelry, said simulated cross pendant having: a main body having a vertical member and a traverse member, and a mounting member, where the simulated cross pendant is displayed in a rotated position at an angle α . The simulated cross pendant can have a vertical member and a traverse portion that engage to form the shape of a letter "L," and the main body can have the letters "O", "V", and "E". The combination of the letters spell the word LOVE. The simulated cross pendant can have a rotated position simulating the position of a cross when carried over the shoulder of a person.

Publication Classification

(51) **Int. Cl.**
A44C 25/00 (2006.01)

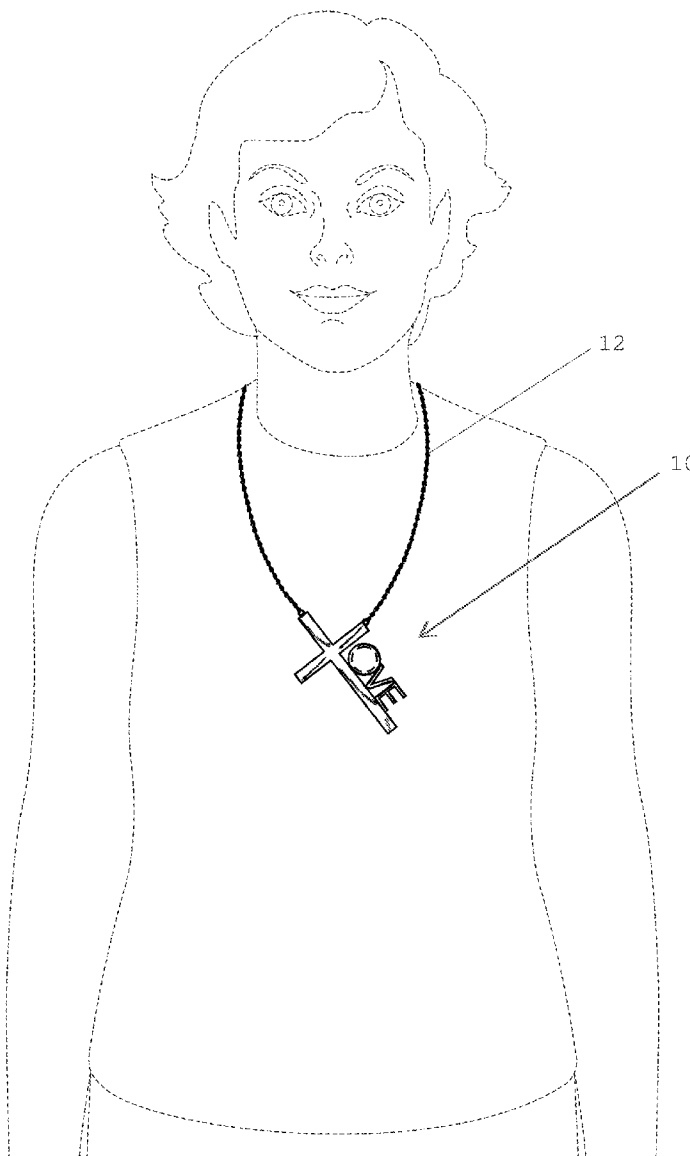

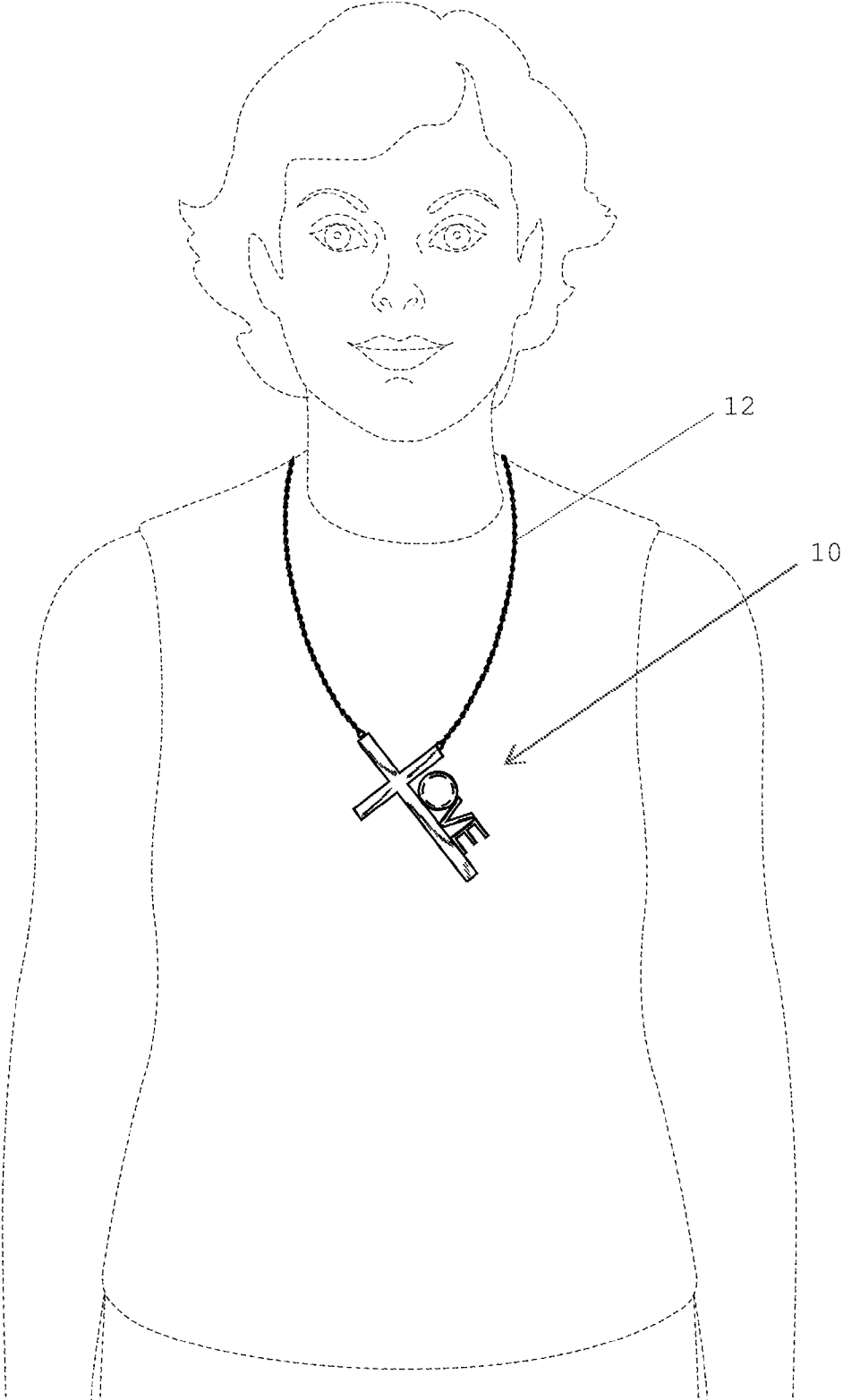

FIG. 1

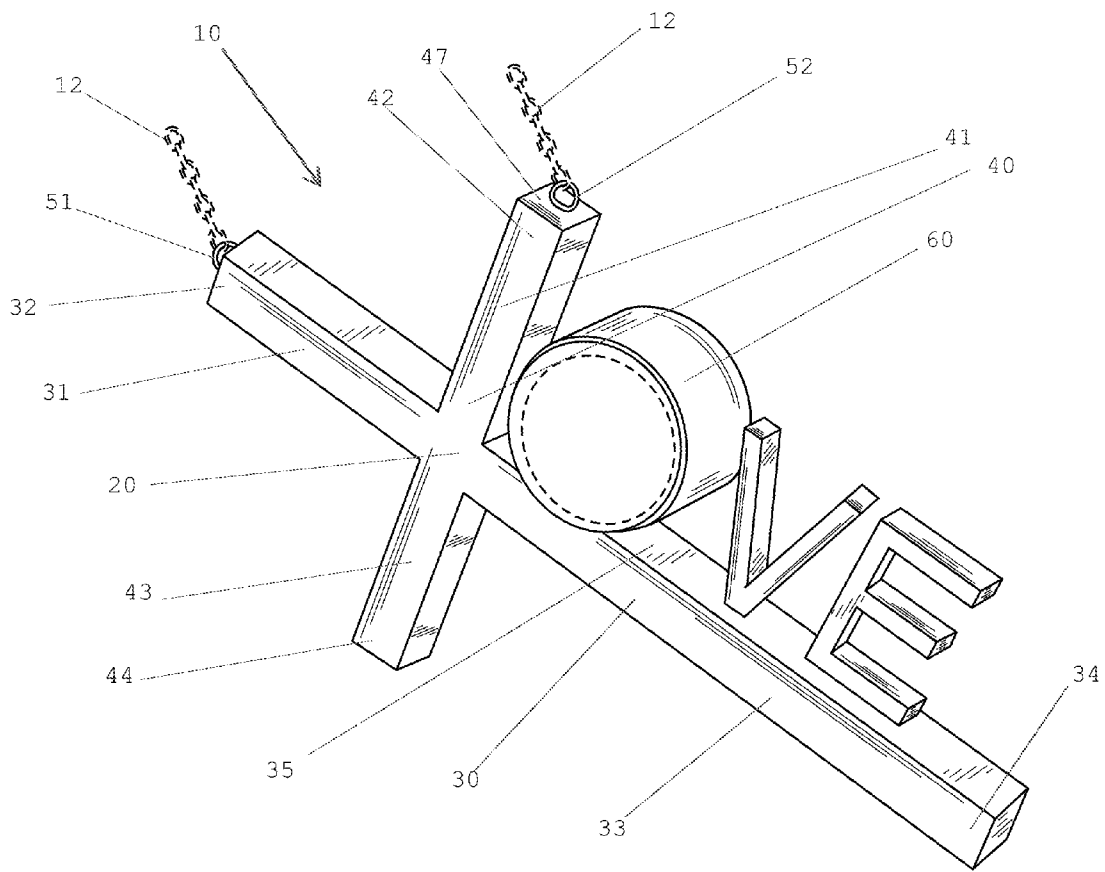

FIG. 2

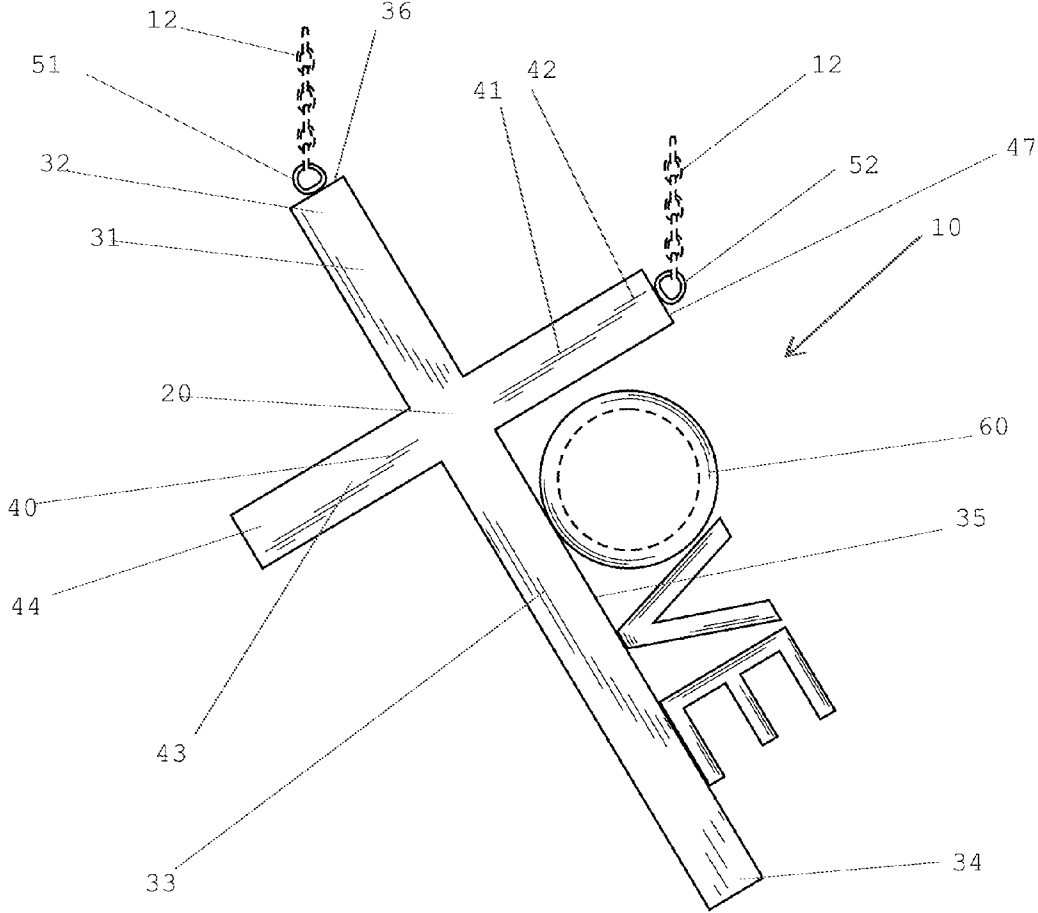

FIG. 3

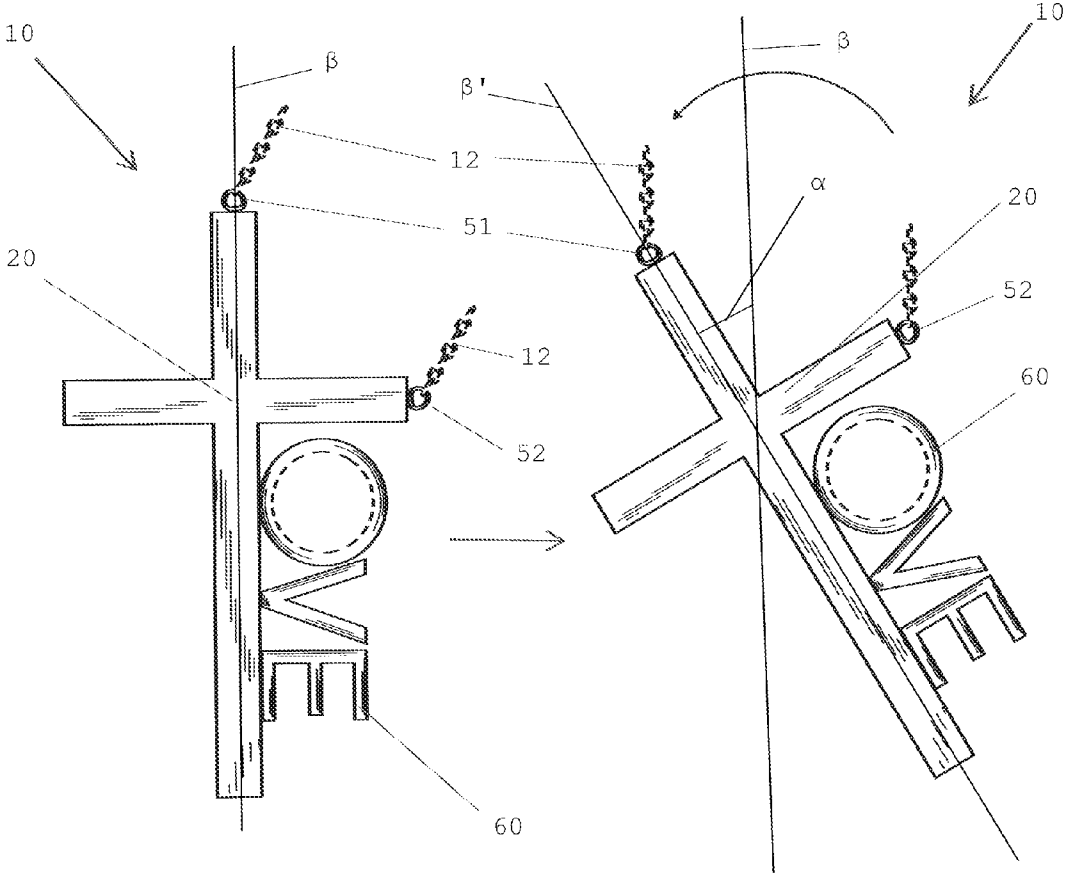

FIG. 4

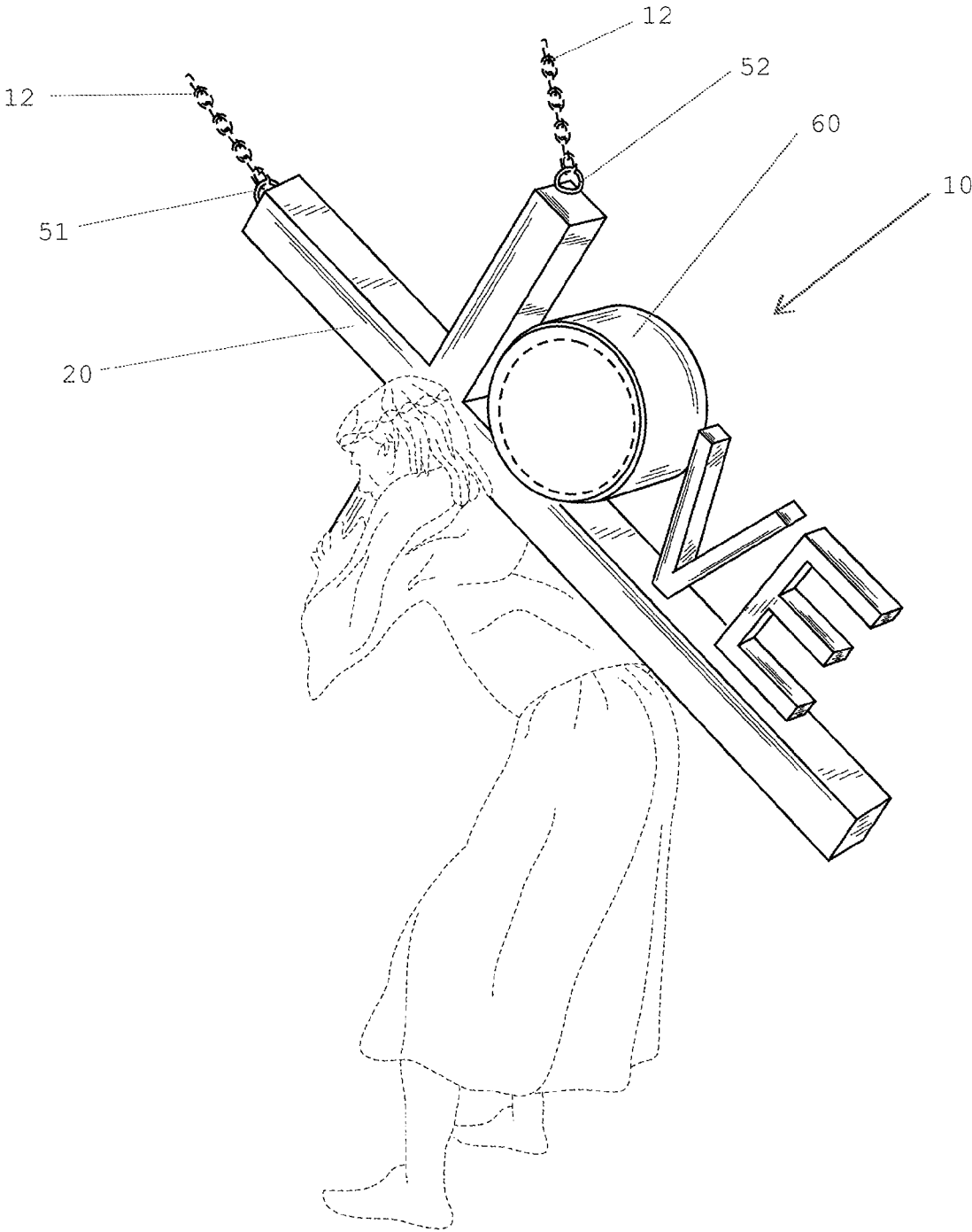

FIG. 5

SIMULATED CROSS PENDANT AND JEWELRY

BACKGROUND

[0001] The present disclosure relates to the field of religious articles, namely, articles of jewelry for those adhere to the Christian denomination. Ornamental jewelry has long been constructed of various materials, shapes and sizes according to various themes. Religious jewelry is well known in the art. In Christianity, jewelry in the shape of a cross is common to display or symbolize the crucifixion of Jesus.

SUMMARY OF THE INVENTION

[0002] The present disclosure pertains to a simulated cross pendant connected to a piece of jewelry, said simulated cross pendant having: a main body having a vertical member and a traverse member, and a mounting member, where the simulated cross pendant is displayed in a rotated position at an angle α . One aspect of the disclosure is the simulated cross pendant where the main body has a letter. Another aspect of the disclosure is the simulated cross pendant where the vertical member has a bottom portion and the traverse portion has a first portion, the bottom portion of the vertical member and the first portion of the traverse member engage to form the shape of a letter "L". Another aspect of the disclosure is the simulated cross pendant where the main body has the letters "O", "V", and "E". Another aspect of the disclosure is the simulated cross pendant where the letter "L" and the letters "O", "V", and "E" are positioned to display the word "LOVE". Another aspect of the disclosure is the simulated cross pendant where the main body has a jewel.

[0003] Another aspect of the disclosure is the simulated cross pendant where the mounting member having a first mounting member and a second mounting member. Another aspect of the disclosure is the simulated cross pendant where the first mounting member engages the vertical member and the second mounting member engages the traverse member. Another aspect of the disclosure is the simulated cross pendant where the vertical member has a top portion and the traverse member has a first portion, the first mounting member engages the top portion of the vertical member and the second mounting member engages the first portion of the traverse member. Another aspect of the disclosure is the simulated cross pendant where the vertical member has a top end and the traverse member comprises a first end, where the first mounting member engages the top end of the vertical member and the second mounting member engages the first end of the traverse member. Another aspect of the disclosure is the simulated cross pendant of where the vertical member has a top peripheral surface and the traverse member comprises a side peripheral surface, where the first mounting member engages the top peripheral surface of the vertical member and the second mounting member engages the side peripheral surface of the traverse member.

[0004] Another aspect of the disclosure is the simulated cross pendant where the piece of jewelry is a necklace. Another aspect of the disclosure is the simulated cross pendant where the rotated position of the simulated cross pendant simulates the position of a cross when carried over the shoulder of a person. Another aspect of the disclosure is the simulated cross pendant where the person is Jesus.

BRIEF DESCRIPTION OF THE DRAWINGS

[0005] The accompanying drawings, which are incorporated herein and form part of the specification, illustrate various embodiments of the present invention and together with the description, further serve to explain the principles of the invention and to enable a person skilled in the pertinent art to make and use the invention. In the drawings, like reference numbers indicate identical or functionally similar elements. A more complete appreciation of the invention and many of the attendant advantages thereof will be readily obtained as the same becomes better understood by reference to the following detailed description when considered in connection with the accompanying drawings, wherein:

- [0006] FIG. 1 is a side view of a simulated cross pendant according to an exemplary embodiment.
- [0007] FIG. 2 is a perspective view of a simulated cross pendant according to an exemplary embodiment.
- [0008] FIG. 3 is a front view of a simulated cross pendant according to an exemplary embodiment.
- [0009] FIG. 4 is a front view of a simulated cross pendant according to an exemplary embodiment.
- [0010] FIG. 5 is a perspective view of a simulated cross pendant according to an exemplary embodiment.

DETAILED DESCRIPTION

[0011] In the following detailed description, reference is made to the accompanying drawings which form a part hereof and in which is shown by way of illustration specific embodiments in which the invention may be practiced. These embodiments are described in sufficient detail to enable those skilled in the art to practice the invention, and it is to be understood that other embodiments may be utilized and that structural or logical changes may be made without departing from the scope of the present invention. The following detailed description is, therefore, not to be taken in a limiting sense, and the scope of the present invention is defined by the appended claims.

[0012] The present disclosure pertains to a simulated cross pendant **10** capable of being incorporated into a piece of jewelry **12**, as shown in FIG. 1. While the simulated cross pendant **10** is described herein as a pendant for purposes of simplicity, the simulated cross pendant **10** can be any ornamental piece or member capable of being incorporated or engaged into a piece of jewelry **12**, for example, without limitation, the simulated cross pendant **10** can be a pendant, charm, trinket, or the like.

[0013] As shown in FIG. 2, the simulated cross pendant **10** can have a main body **20** and at least one mounting member. The main body **20** can have the shape of a cross having a vertical member **30** or post and a traverse member **40** where the vertical member **30** and traverse member **40** engage at substantially **90** degrees thereby forming a cross shape having a top portion. As shown in FIGS. 2-3, the vertical member **30** can have a top portion **31** having a top end **32**, a side peripheral surface **35**, a top peripheral surface **36**, and a bottom portion **33** having a bottom end **34**. The traverse member **40** can have a first portion **41** having a first end **42**, a second portion **43** having a second end **44** and a side peripheral surface **47**.

[0014] The mounting member allows for the simulated cross pendant **10** to be engaged to the jewelry **12**. In one embodiment, the simulated cross pendant **10** can be releasably and/or slideably engaged to the jewelry **12**. The mount-

ing member can be any mechanism for mounting or incorporating a pendant into or onto a piece of jewelry 12.

[0015] While the jewelry 12 is preferably a necklace, as shown in FIG. 1, the jewelry 12 can be, for example, without limitation, an eyelet, clasp, clip, or the like. The jewelry 12 can be any type of jewelry 12 for displaying a pendant, for example, without limitation, necklace, bracelet, anklet, ring, pendant, earrings, tie tack, barrette, shirt studs, cuff links, money clip, button cover, pin, broach, or the like.

[0016] The mounting member can engage the main body 20 at any location on the main body 20. In one embodiment, the simulated cross pendant 10 has a first mounting member 51 and a second mounting member 52. The first mounting member 51 and second mounting member 52 can engage the main body 20 at any location of the main body 20. As shown in FIGS. 2-3, for example, without limitation, the first mounting member 51 can engage the main body 20 at the top end 32 of the vertical member 30 and the second mounting member 52 can engage the main body 20 at the first end 42 of the traverse member 40. In one embodiment, the first mounting member 51 can engage the main body at the top peripheral surface 36 of the vertical member 30 and the second mounting member 52 can engage the main body 20 at the side peripheral surface 47 of the traverse member 40.

[0017] In one embodiment, as shown in FIG. 4, upon using the simulated cross pendant 10 with a piece of jewelry 12, the simulated cross pendant 10 rotates forming an angle α between the longitudinal axis β of the vertical member 30 in the non-rotated position to the longitudinal axis β' of the vertical member 30 in the rotated position. While the angle α is preferably approximately 30 degrees, the angle α can be any angle between and including 1 and 89 degrees, for example, without limitation, 5, 10, 15, 20, 25, 30, 35, 40, 45, 50, 55, 60, 65, 70, 75, 80 and 85 degrees. By way of example, without limitation, where the jewelry 12 is a chain, such as a necklace, bracelet, anklet, or the like, the chain engages the first mounting member 51 positioned at the top end 32 of the vertical member 30 and engages the second mounting member 52 positioned at the second end 44 of the traverse member 40, thereby allowing for the simulated cross pendant 10 to hang on the chain at an angle α .

[0018] By the simulated cross pendant 10 being positioned at angle α , the simulated cross pendant 10 simulates the position of a cross when carried over the shoulder of a person, as shown in FIG. 5. In Christianity, Jesus carried a cross over his shoulder similar to that depicted in FIG. 5 while walking on the road to Golgotha prior to his crucifixion. By positioning the simulated cross pendant 10 in a rotated orientation, the viewer is reminded of this historical event which in turn can remind the viewer of Jesus.

[0019] In one embodiment, the simulated cross pendant 10 simulates a cross used as an emblem of Christianity.

[0020] In one embodiment, the simulated cross pendant 10 has at least one letter 60 engaged to the main body 20. While the at least one letter 60 can engage the main body 20 at any location, the at least one letter 60 preferably engage the side peripheral surface 37 of the vertical member 30. In one embodiment, where the simulated cross pendant 10 has a plurality of letters 60, the letters 60 are "O", "V", and "E". The letters 60 "O", "V", and "E" can be positioned in a manner that reads "OVE." In one embodiment, as shown in FIGS. 2-3, the bottom portion 33 of the vertical member 30 and the first portion 41 of the traverse member 40 engage in a manner to form the shape of the letter "L". In one embodi-

ment, where the letters 60 read "OVE," the combination of the "L" formed by the engagement of the bottom portion 33 and the first portion 41 with the letters 60 "OVE" display or form the word "LOVE".

[0021] In one embodiment, the simulated cross pendant 10 is a piece of jewelry. The simulated cross pendant 10 can be made of precious metals, for example, without limitation, gold, silver, platinum, or the like. Jewels or rhinestones can be incorporated into the simulated cross pendant 10 at any position, for example, without limitation, the main body 20, letters 60, or the like.

[0022] As used herein, the singular forms "a", "an" and "the" are intended to include the plural forms as well, unless expressly stated otherwise. It will be further understood that the terms "includes," "comprises," "including" and/or "comprising," when used in this specification, specify the presence of stated features, integers, steps, operations, elements, and/or components, but do not preclude the presence or addition of one or more other features, integers, steps, operations, elements, components, and/or groups thereof. It will be understood that when an element is referred to as being "connected" or "coupled" to another element, it can be directly connected or coupled to the other element or intervening elements may be present. As used herein, the term "and/or" includes any and all combinations of one or more of the associated listed items.

[0023] The foregoing has described the principles, embodiments, and modes of operation of the present disclosure. However, the disclosure should not be construed as being limited to the particular embodiments described above, as they should be regarded as being illustrative and not as restrictive. It should be appreciated that variations may be made in those embodiments by those skilled in the art without departing from the scope of the present disclosure.

[0024] Modifications and variations of the present invention are possible in light of the above teachings. It is therefore to be understood that the invention may be practiced otherwise than as specifically described herein.

What is claimed is:

1. A simulated cross pendant connected to a piece of jewelry, said simulated cross pendant comprising:
 - a main body comprising a vertical member and a traverse member, and a mounting member,
 where the simulated cross pendant is displayed in a rotated position at an angle α .
2. The simulated cross pendant of claim 1 the main body further comprising a letter.
3. The simulated cross pendant of claim 1 wherein the vertical member further comprises a bottom portion and the traverse portion further comprises a first portion, the bottom portion of the vertical member and the first portion of the traverse member engage to form the shape of a letter "L".
4. The simulated cross pendant of claim 3, the main body further comprising the letters "O", "V", and "E".
5. The simulated cross pendant of claim 4, wherein the letter "L" and the letters "O", "V", and "E" are positioned to display the word "LOVE".
6. The simulated cross pendant of claim 1, the main body further comprising a jewel.
7. The simulated cross pendant of claim 1, the mounting member comprising a first mounting member and a second mounting member.

8. The simulated cross pendant of claim 7, wherein the first mounting member engages the vertical member and the second mounting member engages the traverse member.

9. The simulated cross pendant of claim 7, the vertical member further comprises a top portion and the traverse member further comprises a first portion, the first mounting member engages the top portion of the vertical member and the second mounting member engages the first portion of the traverse member.

10. The simulated cross pendant of claim 7, the vertical member further comprises a top end and the traverse member comprises a first end, wherein the first mounting member engages the top end of the vertical member and the second mounting member engages the first end of the traverse member.

11. The simulated cross pendant of claim 7, the vertical member further comprises a top peripheral surface and the traverse member comprises a side peripheral surface, wherein the first mounting member engages the top peripheral surface of the vertical member and the second mounting member engages the side peripheral surface of the traverse member.

12. The simulated cross pendant of claim 1, wherein the piece of jewelry is a necklace.

13. The simulated cross pendant of claim 1, wherein the rotated position of the simulated cross pendant simulates the position of a cross when carried over the shoulder of a person.

14. The simulated cross pendant of claim 13, wherein the person is Jesus.

* * * * *