



(86) Date de dépôt PCT/PCT Filing Date: 2000/11/16
 (87) Date publication PCT/PCT Publication Date: 2001/06/14
 (45) Date de délivrance/Issue Date: 2006/08/22
 (85) Entrée phase nationale/National Entry: 2002/05/16
 (86) N° demande PCT/PCT Application No.: US 2000/042210
 (87) N° publication PCT/PCT Publication No.: 2001/042116
 (30) Priorités/Priorities: 1999/11/19 (US60/166,434);
 1999/11/22 (US60/167,052); 2000/05/09 (US09/568,876)

(51) Cl.Int./Int.Cl. *B65H 31/00* (2006.01),
B65H 39/06 (2006.01)
 (72) Inventeurs/Inventors:
 MIDDELBERG, NEAL J., US;
 GUBERSKI, JAMES M., US;
 DEROME, GERARD A., JR., US;
 TUCCI, VINCENZO, US;
 BENNETT, ROBERT BRADLEY, US
 (73) Propriétaire/Owner:
 BOWE BELL + HOWELL COMPANY, US
 (74) Agent: ROBIC, ROBIC & ASSOCIES/ASSOCIATES

(54) Titre : APPAREIL ET PROCEDE DE DISTRIBUTION PAR ECHELONNEMENT AVEC ORIENTATION A ANGLE DROIT

(54) Title: RIGHT ANGLE STAGER APPARATUS AND METHOD

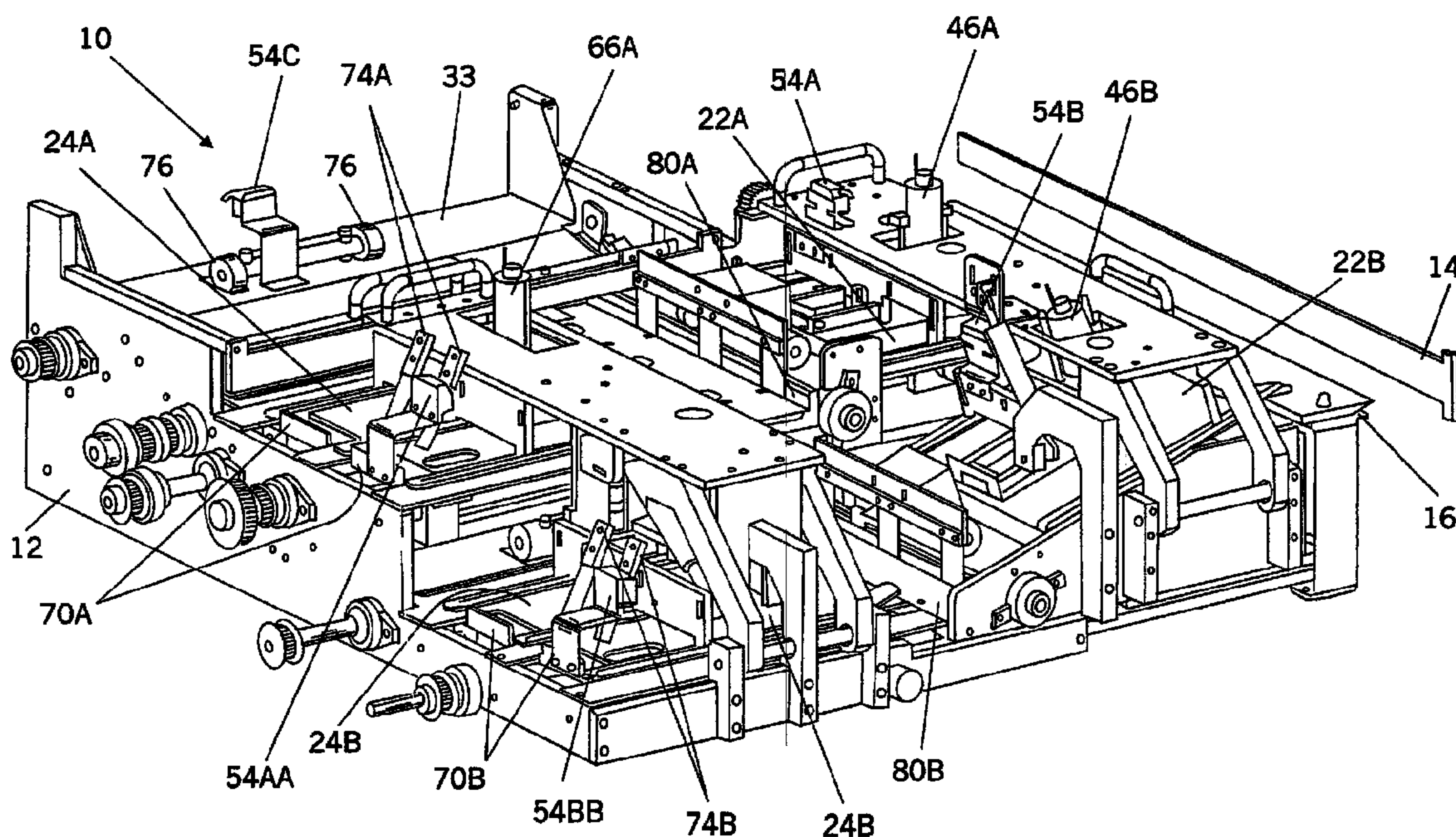

(57) **Abrégé/Abstract:**

A right-angle sheet stager apparatus (10) for merging multiple input sheet streams into a single output sheet stream includes one or more input channels and an output channel. Each input channel includes a transport surface and a staging surface (24A, 24B). Each transport surface communicates with its corresponding staging surface (24A, 24B) at a transitional member interposed between the transport surface (22A) and the staging surface (24A, 24B). Each transitional member includes an upper surface disposed at an elevation greater than an elevation of the corresponding staging surface (24A, 24B). The output channel (30) includes an output surface (32), and is oriented in a right-angle relation with respect channels and communicates with the input channels at a merger location. The stager apparatus (10) permits a sheet from the transport surface (22A) to enter the staging surface and overlap with a preceding sheet already present on that staging surface, prior to the preceding sheet's complete exit from the staging surface.

(12) INTERNATIONAL APPLICATION PUBLISHED UNDER THE PATENT COOPERATION TREATY (PCT)

(19) World Intellectual Property Organization
International Bureau(43) International Publication Date
14 June 2001 (14.06.2001)

PCT

(10) International Publication Number
WO 01/42116 A3(51) International Patent Classification⁷: B65H 31/00

(21) International Application Number: PCT/US00/42210

(22) International Filing Date:
16 November 2000 (16.11.2000)

(25) Filing Language: English

(26) Publication Language: English

(30) Priority Data:
60/166,434 19 November 1999 (19.11.1999) US
60/167,052 22 November 1999 (22.11.1999) US
09/568,876 9 May 2000 (09.05.2000) US

(71) Applicant (for all designated States except US): BELL & HOWELL MAIL AND MESSAGING TECHNOLOGIES COMPANY [US/US]; Pinnacle Park, 4401 Silicon Drive, Durham, NC 27709 (US).

(72) Inventors; and

(75) Inventors/Applicants (for US only): MIDDELBERG, Neal, J. [US/US]; 6022 Splitrock Trail, Apex, NC 27502 (US). GUBERSKI, James, M. [US/US]; 109 Merrimont

Way, Holly Springs, NC 27540 (US). DEROME, Gerard, A., Jr. [US/US]; 100 Windswept Lane, Cary, NC 27511 (US). TUCCI, Vincenzo [US/US]; 3326 Herritage Place, Raleigh, NC 27604 (US). BENNETT, Robert, Bradley [US/US]; 5327 Willow Cry Lane, Raleigh, NC 27613-5635 (US).

(74) Agent: WILSON, Jeffrey, L.; Jenkins & Wilson, P.A., Suite 1400 University Tower, 3100 Tower Boulevard, Durham, NC 27707 (US).

(81) Designated States (national): AE, AG, AL, AM, AT, AU, AZ, BA, BB, BG, BR, BY, BZ, CA, CH, CN, CR, CU, CZ, DE, DK, DM, DZ, EE, ES, FI, GB, GD, GE, GH, GM, HR, HU, ID, IL, IN, IS, JP, KE, KG, KP, KR, KZ, LC, LK, LR, LS, LT, LU, LV, MA, MD, MG, MK, MN, MW, MX, MZ, NO, NZ, PL, PT, RO, RU, SD, SE, SG, SI, SK, SL, TJ, TM, TR, TT, TZ, UA, UG, US, UZ, VN, YU, ZA, ZW.

(84) Designated States (regional): ARIPO patent (GH, GM, KE, LS, MW, MZ, SD, SL, SZ, TZ, UG, ZW), Eurasian patent (AM, AZ, BY, KG, KZ, MD, RU, TJ, TM), European patent (AT, BE, CH, CY, DE, DK, ES, FI, FR, GB, GR, IE, IT, LU, MC, NL, PT, SE, TR), OAPI patent (BF, BJ, CF, CG, CI, CM, GA, GN, GW, ML, MR, NE, SN, TD, TG).

[Continued on next page]

(54) Title: RIGHT ANGLE STAGER APPARATUS AND METHOD

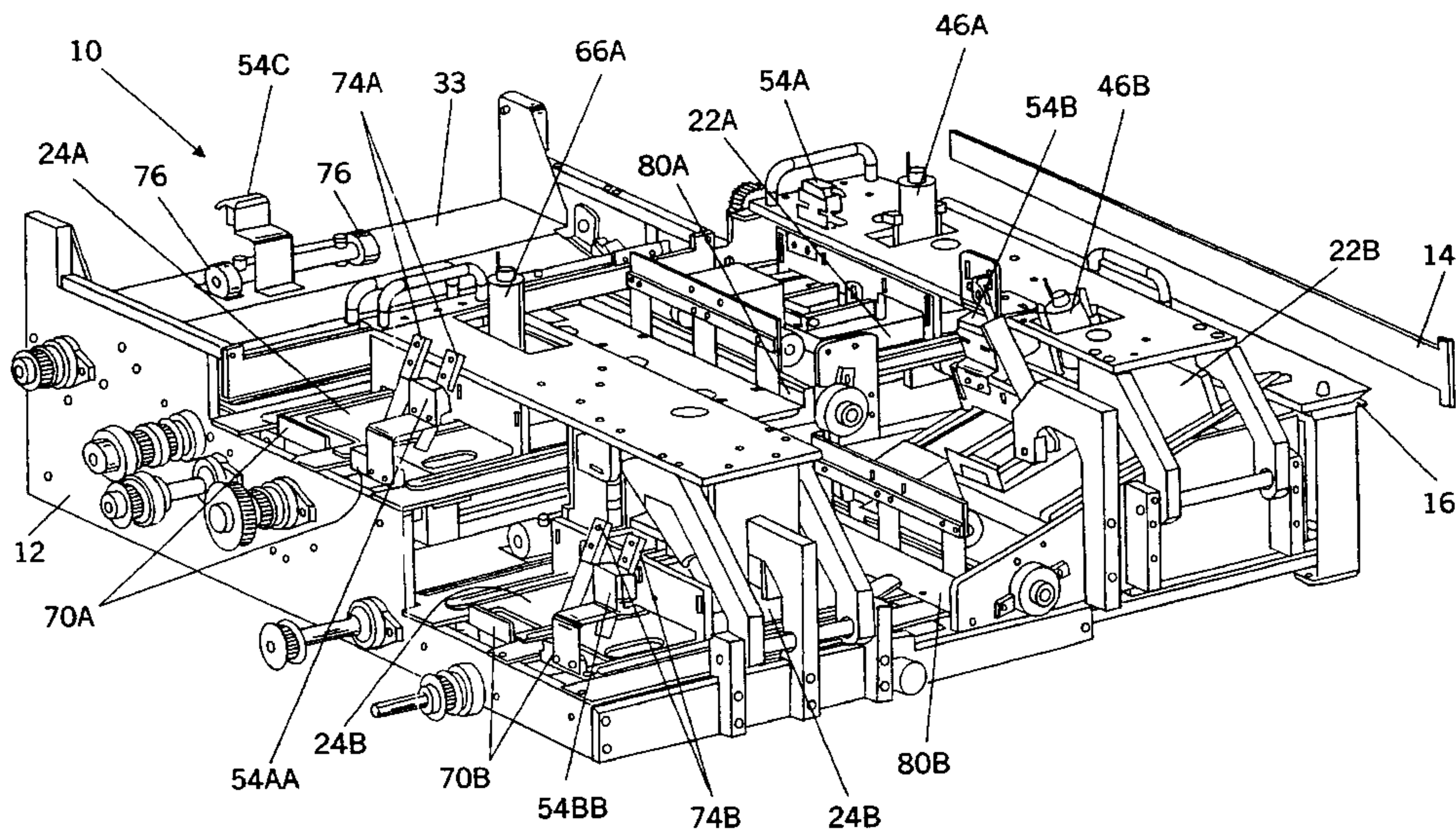

(57) Abstract: A right-angle sheet stager apparatus (10) for merging multiple input sheet streams into a single output sheet stream includes one or more input channels and an output channel. Each input channel includes a transport surface and a staging surface (24A, 24B). Each transport surface communicates with its corresponding staging surface (24A, 24B) at a transitional member interposed between the transport surface (22A) and the staging surface (24A, 24B). Each transitional member includes an upper surface disposed at an elevation greater than an elevation of the corresponding staging surface (24A, 24B). The output channel (30) includes an output surface (32), and is oriented in a right-angle relation with respect channels and communicates with the input channels at a merger location. The stager apparatus (10) permits a sheet from the transport surface (22A) to enter the staging surface and overlap with a preceding sheet already present on that staging surface, prior to the preceding sheet's complete exit from the staging surface.

WO 01/42116 A3

WO 01/42116 A3



Published:

— *with international search report*

For two-letter codes and other abbreviations, refer to the "Guidance Notes on Codes and Abbreviations" appearing at the beginning of each regular issue of the PCT Gazette.

(88) Date of publication of the international search report:

10 January 2002

-1-

Description

RIGHT ANGLE STAGER APPARATUS AND METHOD

Technical Field

10 The present invention is directed to the handling of one or more streams of documents and, more particularly, is directed to the high-throughput staging of documents and right-angle turning of document streams.

Background Art

15 Staging devices are utilized in a wide variety of document handling and mail processing operations. Such operations can involve a number of different modules or stations that perform specific tasks, such as accumulating, folding, printing, shearing, merging, envelope stuffing, and combinations thereof. These operations often require that sheets be physically turned 90 degrees at some point on the sheet path, yet still demand that a commercially acceptable level of throughput be maintained. Examples of systems in which sheets must be physically turned in order to effect a change in conveying direction are
20 disclosed in U.S. Patent Nos. 5,362,039 and 5,439,208.

25 In some of these operations, two or more sheet streams must be merged into a single stream. One example is the processing of two-up material, which can typically be provided on a 17 inch continuous roll. The width of the roll is such that two 8.5 x 11 inch printed pages are disposed in adjacent relation to each other. Several side-by-side pairs of such pages are contained in succession along the length of the roll.

A staging module is typically used whenever an application requires that one or more sheets in one or more process streams be paused or held for a certain period of time while other operations are performed, initialized, or reset.

-2-

In operations such as those briefly described above, the use of a staging module can be useful for assisting in the synchronization of the various operations being conducted on the sheets. Unfortunately, a conventional staging module can slow down throughput to an unacceptable level. This is because a sheet residing in a conventional staging module must completely exit the staging area before the next sheet in the sheet stream can enter therein. As a result, some document handling systems that could benefit from the use of a staging module avoid such use altogether. Throughput is further slowed in conventional operations that require sheets to be physically rotated at some point along the process path.

It would therefore be advantageous to provide a sheet stager apparatus that is capable of permitting a high level of throughput and is consequently useful in a wide variety of document handling and mail processing operations without impeding such operations. It would be further advantageous to provide a high-throughput stager apparatus that has the additional ability of turning the sheet path 90 degrees without requiring sheets to be physically turned, thereby eliminating the need for a separate conventional sheet turning module.

Disclosure of the Invention

The present invention provides a right-angle sheet stager apparatus for merging multiple input sheet streams into a single output sheet stream. In one embodiment according to the present invention, the stager apparatus comprises a plurality of input channels. Each input channel includes a transport surface and a staging surface. Each staging surface is disposed downstream of its corresponding transport surface. One of the staging surfaces is disposed at an elevation different from an elevation of one of the other staging surfaces. An output channel includes an output surface. The output channel is oriented in a right-angle relation with respect to the input channels and communicates with the input channels at a merger location.

In another embodiment according to the present invention, a right-angle sheet stager apparatus comprises a plurality of input channels. Each input channel includes a transport surface, a staging surface, and a transitional

-3-

member interposed between the transport surface and the staging surface. Each staging surface is disposed downstream of its corresponding transport surface. One of the transitional members includes an upper surface disposed at an elevation greater than an elevation of its corresponding staging surface. An output channel includes an output surface. The output channel is oriented in a right-angle relation with respect to the input channels and communicates with the input channels at a merger location.

10 In yet another embodiment according to the present invention, a right-angle sheet stager apparatus comprises an inside input path including an inside transport surface and an inside staging surface. The inside staging surface has an elevation and communicates with the inside transport surface at an inside interface location. The inside interface location includes an upper surface having an elevation greater than the elevation of the inside staging surface. An outside input path includes an outside transport surface and an outside staging surface communicating with the outside transport surface at an outside interface location. The outside staging surface has an elevation different from the elevation of the inside staging surface. The outside interface location includes an upper surface having an elevation greater than the elevation of the outside staging surface. An output path includes an output surface. The output path is oriented in a right-angle relation with respect to the inside and outside input paths, and communicates with the inside and outside input paths at a merger location.

20

In a further embodiment according to the present invention, a right-angle sheet stager apparatus for merging multiple input sheet streams into a single output sheet stream comprising:

- (a) a plurality of means for transporting a plurality of sheet streams along a plurality of different respective input paths;
- (b) a plurality of means for staging sheets of the respective sheet streams, each staging means communicating with a corresponding one of the transporting means at a transitional

30

-3a-

location disposed between each staging means and corresponding transporting means, wherein the sheets are staged in each staging means at an elevation different than an elevation of the other staging means; and

- (c) means for directing sheets received and staged at the plurality of staging means into a single output sheet stream along an output path, wherein the output path is substantially perpendicular to each of the plurality of input paths.

10 In a further embodiment according to the present invention, a right-angle sheet stager apparatus for merging multiple input sheet streams into a single output sheet stream, the right angle sheet stager apparatus comprising:

- a) a plurality of input channels, each input channel including an input surface and terminating at a staging surface wherein each staging surface is disposed at different elevations;

- (b) an output channel including an output surface, the output channel oriented in a substantially right-angle relation with respect to the input channels and communicating with the input channels at a merger location; and

20 (c) means for driving a first sheet staged on one of the staging surfaces toward the output channel after a second sheet being fed into the staging surface from its corresponding input surface has moved into an overlapping relation with the first sheet.

In yet another embodiment according to the present invention, a right-angle sheet stager apparatus for merging multiple input sheet streams into a single output sheet stream, the right angle sheet stager apparatus comprising:

- a) a plurality of input channels, each input channel including an input surface and terminating at a staging surface wherein each staging surface is

30 disposed at different elevations;

-3b-

- (b) an output channel including an output surface, the output channel oriented in a substantially right-angle relation with respect to the input channels and communicating with the input channels at a merger location; and
- (c) means for driving a first sheet received at the merger location from a first one of the staging surfaces along the output surface after a second sheet received from a second one of the staging surfaces has moved into an overlapping relation with the first sheet.

10 In yet another embodiment according to the present invention, a right-angle sheet stager apparatus comprising:

- (a) an input channel including a transport surface and a staging surface, the transport surface communicating with the staging surface at a transitional member interposed between the transport surface and the staging surface, the transitional member having an upper surface disposed at an elevation greater than an elevation of the staging surface; and
- (b) an output channel oriented in a substantially right-angle relation with respect to the input channel.

20

In yet another embodiment according to the present invention, a document handling apparatus comprising:

- (a) an input path structure including an input surface and a first document moving device disposed in operative engagement with the input surface;
- (b) an output path structure oriented perpendicularly with respect to the input path structure and including an output surface;
- (c) a staging and document turning assembly interposed between the input path structure and the output path structure and including a staging surface and a second document moving

30

device, wherein the staging surface defines an interface between the input surface and the output surface, and the second document moving device is disposed in operative engagement with the staging surface and is oriented perpendicularly with respect to the first document moving device; and

d) means for driving a first sheet staged on the staging surface toward the output surface after a second sheet being fed onto the staging surface from the input surface has moved into an overlapping relation with the first sheet.

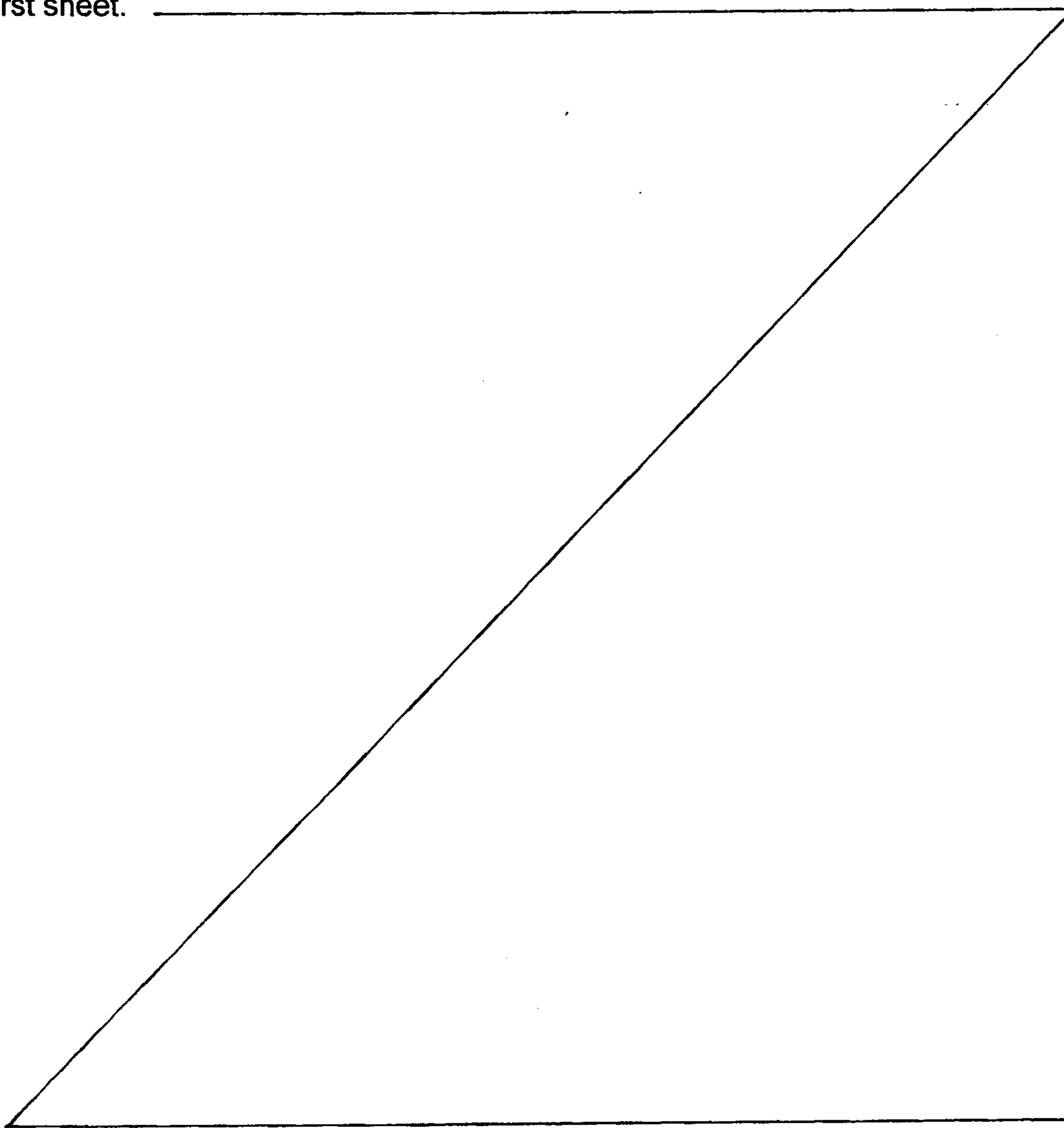

5 The present invention also provides a method for merging multiple input
sheet streams into a single output sheet stream oriented at a right angle with
respect to the input sheet streams. The method comprises the following steps.
A staging area is provided and includes a plurality of staging surfaces disposed
at different elevations. A plurality of sheets are fed in a plurality of input sheet
streams into the staging area, wherein each input sheet stream communicates
10 with a corresponding one of the staging surfaces. A sheet outfeed area is
provided and includes an output surface in communication with each of the
staging surfaces. A first sheet is staged on a first one of the staging surfaces.
The first sheet is brought into contact with a sheet driving mechanism. The
sheet driving mechanism is activated to transport the first sheet towards the
15 outfeed area. A second sheet is permitted to enter the first staging surface and
to overlap with the first sheet prior to transportation of the entire first sheet out
of the staging area. The method can further comprise the step of permitting a
plurality of sheets to enter the first staging surface and accumulate thereon
prior to transportation of the first sheet out of the staging area.

20 In another method for merging multiple input sheet streams into a single
output sheet stream oriented at a right angle with respect to the input sheet
streams, a staging area includes a plurality of staging surfaces disposed at
different elevations and each staging surface includes a sheet driving element
operatively associated therewith. A plurality of sheets are fed in a plurality of
25 input sheet streams into the staging area. Each input sheet stream
communicates with a corresponding one of the staging surfaces. A sheet
outfeed area is provided, and includes an output surface in communication with
each of the staging surfaces. A first sheet is staged on a first one of the
staging surfaces, and a second sheet is staged on a second one of the staging
30 surfaces. The first sheet is brought into contact with the sheet driving element
of the first staging surface, and the second sheet is brought into contact with
the sheet driving element of the second staging surface. The sheet driving

element of the first staging surface is activated to transport the first sheet towards the outfeed area in a direction substantially perpendicular to at least one of the input sheet streams. The sheet driving element of the second staging surface is also activated to transport the second sheet towards the outfeed area in a direction substantially perpendicular to at least one of the input sheet streams. The first and second sheets are then merged into a single output stream substantially perpendicular to at least one of the input sheet streams.

The method can further comprise the step of causing a subsequent sheet to enter the first staging surface and to overlap with the first sheet prior to transportation of the first sheet out of the staging surface. The method can also comprise the step of permitting a plurality of sheets to enter the first staging surface and accumulate thereon prior to transportation of the first sheet out of the staging area.

The method can still further comprise the step of causing sheets from one or more of the input sheet streams to overlap at merger location.

Accordingly, it is an object of the present invention to provide a right-angle sheet stager apparatus that is capable of achieving higher levels of throughput than conventional staging devices.

It is another object of the present invention to provide a sheet stager apparatus in which sheets are permitted to overlap in the staging area and thereby increase throughput.

It is a further object of the present invention to provide a sheet stager apparatus in which tight control over the flow of the sheet streams is maintained even at the higher level of throughput achieved by the stager apparatus.

It is yet another object of the present invention to provide a high-throughput stager apparatus which also functions to turn the direction of the sheet stream path 90 degrees without causing the individual sheets to be physically rotated.

Some of the objects of the invention having been stated hereinabove, and which are achieved in whole or in part by the present invention, other

-6-

objects will become evident as the description proceeds when taken in connection with the accompanying drawings as best described hereinbelow.

Brief Description of the Drawings

5 Figure 1 is a perspective view of a right-angle stager apparatus according to the present invention;

Figure 2 is a perspective view of the stager apparatus of Figure 1 with the main structural framework removed;

10 Figure 3 is another perspective view of the stager apparatus of Figure 1, with portions of the main structural framework and some of the sheet-driving components removed;

Figure 4 is a front elevation view of the stager apparatus of Figure 1 with the main structural framework partially cut away to show the staging surfaces;

Figure 5 is a perspective view of a configuration of nip rollers utilized in the present invention;

15 Figure 6 is a side elevation view of a transitional member according to an alternative embodiment of the present invention;

Figures 7 - 13 are schematic diagrams illustrating examples of how sheet streams can be processed in accordance with the present invention.

Detailed Description of the Invention

20 Referring in particular to Figures 1, 2 and 3, a right angle stager apparatus according to the present invention is generally designated **10**. Many of the operative components pertinent to the present invention are mounted within a main structural framework **12** of stager apparatus **10**. Stager apparatus **10** includes one or more input channels situated downstream of a cutting mechanism **14** or some other appropriate input feed device. Beginning
25 at a threshold surface **16**, the input channels define separate input paths for cut sheets. In the exemplary embodiment shown in Figures 1-4, stager apparatus **10** is adapted to process two-up sheets and accordingly includes two input channels: an inside channel generally designated **20A** (as shown only in
30 Figures 2 and 3) and an outside channel generally designated **20B** (as shown

-7-

only in Figures 2 and 3). Each input channel **20A,20B** includes a transport surface and a staging surface. Accordingly, inside channel **20A** includes an inside transport surface **22A** and an inside staging surface **24A**. Likewise, outside channel **20B** includes an outside transport surface **22B** and an outside staging surface **24B**. The input paths terminate at a staging area defined in part by inside staging surface **24A** and outside staging surface **24B**.

An output channel generally designated **30** (shown in Figures 2 and 3) provides an output path oriented at a right angle to the input paths. Output channel **30** includes an output surface **32** disposed beneath an upper guide plate **33** and a merger location **34** (as best shown in Figure 3) at which the separate streams of sheets exiting from the staging area merge into a single output stream. Output channel **30** further includes a post-staging surface interposed between each respective staging surface **24A,24B** and merger location **34**. Thus, in the exemplary two-up design presently being described, an inside post-staging surface **36A** and an outside post-staging surface **36B** are employed. One or more of post-staging surfaces **36A,36B** can be inclined in order to effect a smooth transition from differently elevated staging surfaces **24A,24B** to output surface **32**.

Referring specifically to Figure 2, each transport surface **22A,22B** includes mechanisms for driving sheets forwardly along their respective input paths. In the preferred embodiment, a constantly rotating drive roller **42A** is disposed below inside transport surface **22A** proximate to a hole or slot **44A** on inside transport surface **22A**. A vertically reciprocative actuator **46A** is disposed directly above drive roller **42A**, and includes a solenoid **48A** and roller bearing **49A**. One or more pairs of input nip rollers **52A** are disposed at the downstream end of inside transport surface **22A**. As shown in Figure 5, each pair of input nip rollers **52A** includes an upper roller **52A'** disposed generally above inside transport surface **22A** and a lower roller **52A''** disposed generally below inside transport surface **22A**. In addition, an optical sensor **54A**, preferably of the photocell type, is provided. Optical sensor **54A** is disposed either above inside transport surface **22A** as shown in Figure 1 or on inside transport surface **22A** as shown in Figure 2. Reed switches or other types of

-8-

sensors could be substituted for optical sensor **54A**, as is understood by those skilled in the art.

Inside staging surface **24A** can include sheet driving mechanisms similar to those of inside transport surface **22A**. Thus, in the preferred embodiment shown in Figures 1 and 2, inside staging surface **24A** includes a drive roller **62A** disposed below a hole or slot **64A** of inside staging surface **24A**; an actuator **66A** with a solenoid **68A** and roller bearing **69A** disposed above drive roller **62A**; one or more pairs of take-away nip rollers **72A**; and an optical sensor **54AA** or other type of sensor. Take-away nip rollers **72A** have a configuration analogous to that of input nip rollers **52A** shown in Figure 5. Drive roller **62A**, actuator **66A**, and take-away nip rollers **72A** are disposed at a right angle with respect to the sheet driving mechanisms of inside transport surface **22A**. In addition, inside staging surface **24A** includes stop members **70A** defining the terminus of the inside input path.

One or more vertically disposed sheet guides **74A** are disposed above inside staging surface **24A**, as shown in Figure 1. Preferably, the operative component of each sheet guide **74A** is a highly flexible, polymeric strip. Sheet guides **74A** constructed of polymeric material are elastic enough to yield in the direction of sheet flow and recover to the original, vertical position after a sheet has passed, yet have enough stiffness to perform the sheet guiding function. Such sheet guides **74A** are therefore believed to be superior to conventional metallic guides, which are prone to plastic (i.e., inelastic and non-recoverable) deformation and frequent replacement.

Outside channel **20B** preferably includes transport components analogous to those used in the design of inside channel **20A**. Accordingly, outside transport surface **22B** includes a drive roller **42B** disposed below outside transport surface **22B** proximate to a hole or slot **44B** on outside transport surface **22B**; a vertically reciprocative actuator **46B**, including a solenoid **48B** and roller bearing **49B**, disposed directly above drive roller **42B**; one or more pairs of input nip rollers **52B** disposed at the downstream end of outside transport surface **22B**; and an optical sensor **54B** or other type of sensor. In addition, outside staging surface **24B** includes a drive roller **62B**

disposed below a hole or slot **64B** of outside staging surface **24B**; an actuator **66B**, including a solenoid **68B** and roller bearing **69B**, disposed above drive roller **62B**, one or more pairs of take-away nip rollers **72B**; an optical sensor **54BB** or other type of sensor; stop members **70B** defining the terminus of the
5 outside input path; and vertically disposed, polymeric sheet guides **74B** disposed above outside staging surface **24B** (see Figure 1). Input nip rollers **52B** and take-away nip rollers **72B** have a configuration similar to that of input nip rollers **52A** shown in Figure 5.

Output channel **30** includes one or more pairs of exit nip rollers **76** which
10 can be of the same general design as input nip rollers **52A,52B** and take-away nip rollers **72A,72B**. Output channel **30** likewise includes an optical sensor **54C** or other type of sensor. Output channel **30** can have either a left or right hand orientation with respect to input channels **20A** and **20B**. In addition, a second output channel (not shown) can be provided on the side of the staging
15 area opposite to that of output channel **30**. In this manner, one or more of the sheet streams entering the staging area could be caused to turn either left or right upon the appropriate programming of stager apparatus **10**.

The operative driving components of stager apparatus **10**, including drive rollers **42A,42B,62A,62B** and nip rollers **52A,52B,72A,72B,76** can be
20 powered by means of conventional transmission and motor devices (not specifically referenced herein). In addition, it is preferable that stager apparatus **10** operate under the control of a computer or other electronic control and monitoring device (not shown). Accordingly, drive rollers **42A,42B,62A,62B**, actuators **46A,46B,66A,66B** and optical sensors
25 **54A,54AA,54B,54BB,54C** should all be wired to the electronic device to enable transmission of electronic control and monitoring signals or other data. Optionally, nip rollers **52A,52B,72A,72B,76** can also be wired for communication with the electronic control device for monitoring purposes.

Referring to Figures 2 and 4, in order to improve control over the sheets
30 traveling through the various paths of stager apparatus **10**, it is preferable that each of nip rollers **52A,52B,72A,72B,76** be provided as a roller set consisting of two pairs of opposing rollers, and each roller set be employed for each

-10-

respective surface 22A,22B,24A,24B,32. Moreover, as illustrated in the representative case of input nip rollers 52A in Figure 5, each of the two pairs of nip rollers 52A,52B,72A,72B,76 is preferably connected at their respective lower rollers by a common axle. Thus, in Figure 5, lower rollers 52A'' are
5 connected through a lower axle 78. In this manner, each of the two pairs of nip rollers 52A,52B,72A,72B,76 rotate at the same speed, thereby imparting equal force to sheets through two points of contact to prevent sheets from twisting or deviating from their proper paths. Finally, Figure 5 also shows that upper rollers 52A' can optionally be connected through an upper axle 79. As an
10 alternative, upper axle 79 could serve as the fixed, common axle on which upper rollers 52A' are forced to rotate at the same speed.

In order to achieve the high speed at which stager apparatus 10 operates, it is also preferable that many of the surfaces on which the sheets travel be disposed at different elevations with respect to each other. Hence,
15 outside transport surface 22B can be inclined with respect to inside transport surface 22A, such that the average or effective elevation of outside transport surface 22B is different than the elevation of inside transport surface 22A. In the embodiment shown in Figures 1-4, outside transport surface 22B is inclined downwardly and hence effectively lower than inside transport surface 22A.
20 Additionally, outside staging surface 24B is disposed at a lower elevation than that of inside staging surface 24A, such that sheets traveling in different paths are staged at different elevations. In the two-up design exemplified herein and as best shown in Figure 4, this configuration is preferably implemented by transporting the sheets staged on outside staging surface 24B across
25 extended-length outside post-staging surface 36B. In this configuration, outside post-staging surface 36B extends underneath inside staging surface 24A and inside post-staging surface 36A.

In addition to utilizing differently elevated input paths, the corresponding transport surfaces 22A,22B and staging surfaces 24A,24B in each input path
30 can be differently elevated. This is implemented through the use of inside and outside transitional members 80A and 80B situated at the respective interfaces of corresponding transport surfaces 22A,22B and staging surfaces 24A,24B.

-11-

In the preferred embodiment, each transitional member **80A,80B** has an elongate edge **82A,82B** over which sheets travel. Each elongate edge **82A,82B** is disposed at a higher elevation than its corresponding staging surface **24A,24B**, such that sheets exiting from transport surfaces **22A,22B** pass over transitional members **80A,80B** and enter respective staging surfaces **24A,24B** at a lower elevation. In the embodiment shown in Figure 2, the downstream end of each transport surface **22A,22B** is substantially flush with elongate edge **82A,82B** of transitional member **80A,80B**, and thus transport surface **22A,22B** is disposed at a higher elevation than that of associated staging surface **24A,24B**.

In an alternative embodiment shown in Figure 6, inside transport surface **22A** could be disposed at the same elevation as inside staging surface **24A** (or could even be disposed at a lower elevation with respect to inside staging surface **24A**), in which case inside transitional member **80A** could include a ramp **84** in order to provide a smooth transition from inside transport surface **22A** to inside staging surface **24A**. Ramp **84** ensures that each sheet exiting inside transitional member **80A** is at a higher elevation than inside staging surface **24A**. Similarly, outside transitional member **80B** could be equipped with ramp **84** in the manner shown in Figure 6.

The operation of stager apparatus **10** will now be described with particular reference to Figure 2. For clarity, it will be assumed that a roll or contiguous stack of two-up sheet material is to be processed. Accordingly, a two-channel apparatus can be employed, such as stager apparatus **10** in the exemplary configuration described above. It will be understood that the individual sheets cut and formed from the two-up material can constitute printed or graphic pages, and that stager apparatus **10** can handle both portrait and landscape configurations. It will be further understood that at some point upstream of stager apparatus **10**, the two-up material is cut longitudinally to separate it into two separate sheet streams, and is also cut transversely such as by cutting mechanism **14**.

The two sheet streams are advanced to input channels **20A** and **20B** from an upstream location. As the sheet streams pass onto transport surfaces

-12-

22A and **22B** to an appropriate distance, optical sensors **54A** and **54B** will be triggered. If an input feed device such as cutting mechanism is to be employed, the triggering of optical sensors **54A** and **54B** causes the sheet streams to pause, and cutting mechanism **14** is activated to shear the sheet streams and thereby define the respective trailing edges of individual, side-by-side sheets. Based on the input from optical sensors **54A** and **54B**, the electronic control system will send signals to activate actuators **46A** and **46B**, displacing solenoids **48A** and **48B** downwardly. Roller bearings **49A** and **49B** force sheets into contact with drive rollers **42A** and **42B** which causes the sheets to advance to input nip rollers **52A** and **52B**. Input nip rollers **52A** and **52B** drive the sheets over transitional members **80A** and **80B** and into the staging area. As the sheets pass onto their respective staging surfaces **24A** and **24B**, which are disposed along different elevational positions, the sheets will trigger optical sensors **54AA** and **54BB**. Stop members **70A** and **70B** prevent further forward movement of the sheets.

The sheets present on staging surfaces **24A** and **24B** can be held in the staging area for as long a period of time as required by the particular job being performed and by the downstream operations required. Such downstream operations can include accumulating, printing, scanning, folding, envelope inserting and sealing, or any other suitable processing step as can be appreciated by those of skill in the art. Because all of the optical sensors and many of the driving mechanisms are controlled by the electronic controller, the interface between staging apparatus **10** and the various upstream and downstream modules can be synchronized and programmed according to the needs of the user.

At the desired time, one or both of the sheets on staging surfaces **24A** and **24B** are advanced at a right angle with respect to input channels **20A** and **20B** toward post-staging surfaces **36A** and **36B** and eventually output surface **32** of output channel **30**. This is accomplished by activating one or both actuators **66A,66B** of staging surfaces **24A,24B** in a manner analogous to that of actuators **46A** and **46B** of transport surfaces **22A** and **22B**, and also through the operation of take-away nip rollers **72A** and **72B**. As the sheets exit staging

surfaces **24A** and **24B**, sheets from staging surface **24B** pass beneath staging surface **24A**, and the sheets from the two staging surfaces converge into a single output stream at merger location **34** and pass over output surface **32** to downstream processes with the assistance of exit nip rollers **76**. As each sheet passes over output surface **32**, optical sensor **54C** detects its presence and can be used to modify the activation timing of the various driving mechanisms of stager apparatus **10**, as well as the timing of upstream and downstream modules.

In conventional staging devices, each sheet must completely exit its staging surface prior to the introduction of a subsequent sheet onto that staging surface. When constructed in accordance with the present invention, however, stager apparatus **10** permits overlapping of sheets at staging surfaces **24A** and **24B** (i.e., stage overlapping) and/or merger location **34** (i.e., exit overlapping). As a result, a significantly higher throughput is achieved.

Overlapping is accomplished through the use of differently elevated surfaces, and also preferably through the use of the nip rollers configured as described above and illustrated in Figure 5. Hence, as a first sheet on staging surface **24A** or **24B** starts to exit therefrom, a subsequent second sheet can start to exit transport surface **22A** or **22B**, pass over higher elevated transitional member **80A** or **80B** and enter into an overlapping relation with the first sheet. Such overlapping does not impair the operation of stager apparatus **10**, and the sheet streams flow from inside channels **20A** and **20B** to outside channel **30** in a rapid, yet controlled, manner. Moreover, the use of differently elevated staging surfaces **24A** and **24B** permits a sheet from one staging surface **24A** or **24B** to overlap with a sheet from another staging surface **24B** or **24A** at the merger location **34** without impairing the operation of stager apparatus **10**.

The desired percentage of overlap among sheets permitted by stager apparatus **10** can be programmed. Moreover, stager apparatus **10** can be programmed to permit 100% overlap of a selected number of sheets on either or both staging surfaces **24A** and **24B**. As a result, stager apparatus **10** can not only perform the combined functions of staging and turning, but also the function of accumulating.

-14-

Figures 7 - 13 illustrate some examples of how stager apparatus **10** allows flexibility in the control of sheets as sheets exit the staging area and merger location **34**. Ejection of each sheet from each staging surface **24A** and **24B** is independently controlled by the electronic controller. This flexibility in control allows all material accumulation modes required by downstream devices to be supported. Such material accumulation modes can be dictated by the way the material is programmed (i.e., A to Z versus Z to A, and horizontal programming versus vertical programming) or the ways the individual sheets within the same set (e.g., a four-page document) are accumulated (i.e., over-accumulating versus under-accumulating). As regards horizontal programming, the modes supported include both inside-first and outside-first modes.

Figure 7 illustrates a control method characterized by A to Z ordering, inside-first programming, and exit gapping. In Figure 7, sheets **1**, **2**, **3** and **4** are initially provided on a length of two-up material and can be part of a 4-page document (i.e., page 1 of 4, page 2 of 4, page 3 of 4, and page 4 of 4) to be processed as a single document and mailed out in a single envelope. Sheet **1** enters inside input channel **20A** towards the staging area in the direction generally indicated by arrow **A**, and sheet **2** enters outside input channel **20B** in the same direction adjacent to inside input channel **20A**. Sheet **3** subsequently follows sheet **1** as part of the same sheet stream, and sheet **4** likewise follows sheet **2** adjacent to sheet **3**. Sheets **1 - 4** are then conveyed towards output channel **30** in the direction generally indicated by arrow **B**. If desired, sheets **1 - 4** can be respectively staged in the staging area for predetermined time periods prior to being conveyed towards output channel **30**.

It can be seen that if sheets **1 - 4** enter stager apparatus in a portrait orientation, stager apparatus **10** can turn the respective sheet streams 90 degrees without physically turning sheets **1 - 4** themselves. As a result, sheets **1 - 4** can be merged into a single output stream in a predetermined order and in a landscape orientation. Alternatively, it will be understood that stager apparatus **10** can be configured to receive an input of one or more sheet

streams in which sheets are initially in the landscape orientation, such that the sheets will be turned, merged, and then outputted in the portrait orientation.

In the example illustrated by Figure 7, sheet **1** leads sheet **2** and sheet **3** leads sheet **4** in the output stream (hence, inside-first programming is implemented). Moreover, stager apparatus **10** is programmed to process each sheet **1 - 4** with 0% overlap and accordingly to dump each sheet **1 - 4** separately. This control method is thus further characterized by exit gapping.

In order to increase the rate at which stager apparatus **10** processes sheet material, stager apparatus **10** can be programmed to implement exit overlapping in a variety of ways, as illustrated below with reference to Figures 8-13.

Figure 8 illustrates a control method characterized by A to Z ordering, inside-first programming, and exit overlapping with under-accumulation. At merger location **34**, sheet **1** is permitted to overlap onto sheet **2** and sheet **3** is subsequently permitted to overlap onto sheet **4**, such that sheet **2** accumulates under sheet **1** and sheet **4** accumulates under sheet **3**. Still, sheet **1** leads sheet **2** and sheet **3** leads sheet **4** in the output stream.

Figure 9 illustrates a control method characterized by A to Z ordering, inside-first programming, and exit overlapping with over-accumulation. At merger location **34**, sheet **3** is permitted to overlap onto sheet **2**.

Figure 10 illustrates a control method characterized by Z to A ordering, inside-first programming, and exit overlapping with under-accumulation. Sheet **4** is permitted to overlap onto sheet **3** and sheet **2** is subsequently permitted to overlap onto sheet **1**, such that sheet **3** accumulates under sheet **4** and sheet **1** accumulates under sheet **2**. Sheet **4** leads sheet **3** and sheet **2** leads sheet **1** in the output stream.

Figure 11 illustrates a control method characterized by Z to A ordering, inside-first programming, and exit overlapping with over-accumulation. At merger location **34**, sheet **2** is permitted to overlap onto sheet **3**.

Figure 12 illustrates a control method characterized by Z to A ordering, outside-first programming, and exit overlapping with over-accumulation. Sheet **4** leads sheet **3** and sheet **2** leads sheet **1** in the output stream. At merger

-16-

location **34**, sheet **3** is permitted to overlap onto sheet **4** and sheet **1** is permitted to overlap onto sheet **2**.

Figure 13 illustrates a control method characterized by A to Z ordering, vertical programming, and 100% stager overlapping with over-accumulation.

5 In this example, inside input channel **20A** and outside input channel **20B** process entirely independent sets of sheets. For example, sheets **1.1** and **1.2** could comprise a first document to be mailed to a first recipient while sheets **2.1** and **2.2** could comprise a different, second document to be mailed to a second recipient. Sheets **1.1** and **1.2** exit merger location **34** first, with sheet

10 **1.2** 100% overlapped with sheet **1.1**. Subsequently, sheet **2.2** is 100% overlapped with sheet **2.1**.

It will be understood that stager apparatus **10** can be programmed to cause both stage overlapping and exit overlapping in order to further increase the rate at which stager apparatus **10** processes sheet material.

15 It will also be understood that the present invention is not limited to the processing of two-up material as described by way of example hereinabove. On the contrary, the present invention is equally applicable to operations involving more than two input paths and their associated sheet streams, as well as a single input path and sheet stream. Such other applications fall within the

20 scope of the present invention and accompanying claims.

It will be further understood that various details of the invention may be changed without departing from the scope of the invention. Furthermore, the foregoing description is for the purpose of illustration only, and not for the purpose of limitation--the invention being defined by the claims.

-17-

CLAIMS

What is claimed:

1. A right-angle sheet stager apparatus for merging multiple input sheet streams into a single output sheet stream, the apparatus comprising:

- 5 (a) a plurality of input channels, each input channel including a transport surface for transporting sheets and a staging surface for staging sheets, each staging surface disposed downstream of its corresponding transport surface and one of the staging surfaces disposed at an elevation different from an elevation of
10 one of the other staging surfaces; and
- (b) an output channel including an output surface, the output channel oriented in a substantially right-angle relation with respect to the input channels and communicating with the input channels at a merger location.

15 2. The apparatus according to claim 1 further comprising a plurality of transitional members, each transitional member interposed between one of the transport surfaces and a corresponding one of the staging surfaces.

20 3. The apparatus according to claim 2 wherein each transitional member includes an elongate edge transversely disposed with respect to a direction of sheet travel along the input channel.

4. The apparatus according to claim 3 wherein the elongate edge of one of the transitional members is disposed at an elevation greater than the elevation of its corresponding staging surface.

25 5. The apparatus according to claim 3 wherein the elongate edge of one of the transitional members is disposed at an elevation greater than an elevation of its corresponding transport surface.

6. The apparatus according to claim 1 wherein each transport surface is disposed in adjacent relation to the other transport surfaces.

30 7. The apparatus according to claim 1 wherein each staging surface is disposed in a stepped relation to the other staging surfaces.

-18-

8. The apparatus according to claim 1 wherein one of the transport surfaces has an average elevation different from an average elevation of one of the other transport surfaces.

5 9. The apparatus according to claim 1 wherein one of the transport surfaces has an average elevation different from the elevation of its corresponding staging surface.

10 10. The apparatus according to claim 1 further comprising a plurality of transport drive mechanisms for advancing sheets across the transport surfaces to the staging surfaces, wherein each transport drive mechanism is operatively disposed at a corresponding one of the transport surfaces.

11. The apparatus according to claim 10 wherein each transport drive mechanism includes a roller disposed below an opening of the corresponding transport surface.

15 12. The apparatus according to claim 11 further comprising a plurality of actuators for urging sheets residing on the transport surfaces against the transport drive mechanisms, wherein each actuator is operatively disposed above the opening of the corresponding transport surface.

13. The apparatus according to claim 12 wherein each actuator includes a reciprocative solenoid.

20 14. The apparatus according to claim 10 wherein each transport drive mechanism is in electrical communication with an electronic control device.

25 15. The apparatus according to claim 1 further comprising a plurality of pairs of transport nip rollers, each pair of transport nip rollers including an upper roller disposed above the transport surface and a lower roller disposed below the transport surface.

16. The apparatus according to claim 1 wherein each transport surface includes a sensor in electrical communication with an electronic control device and adapted to indicate the presence of a sheet on the transport surface.

30 17. The apparatus according to claim 1 further comprising a plurality of stop members, each stop member disposed proximate to an end of a

corresponding one of the staging surfaces opposite to its corresponding transport surface.

18. The apparatus according to claim 1 further comprising a plurality of staging drive mechanisms for advancing sheets across the staging surfaces to the output channel, each staging drive mechanism operatively disposed at
5 a corresponding one of the staging surfaces.

19. The apparatus according to claim 18 wherein each staging drive mechanism includes a roller disposed below an opening of the corresponding staging surface.

10 20. The apparatus according to claim 19 further comprising a plurality of actuators for urging sheets residing on the staging surfaces against the staging drive mechanisms, each actuator operatively disposed above the opening of the corresponding staging surface.

15 21. The apparatus according to claim 20 wherein each actuator includes a reciprocative solenoid.

22. The apparatus according to claim 18 wherein each staging drive mechanism is in electrical communication with an electronic control device.

20 23. The apparatus according to claim 1 wherein each staging surface includes a pair of take-away nip rollers disposed proximate to a leading edge of the staging surface, each pair of take-away nip rollers including an upper roller disposed above the staging surface and a lower roller disposed below the staging surface.

25 24. The apparatus according to claim 23 wherein each staging surface includes at least two pairs of take-away nip rollers, and the lower roller of one of the pairs of take-away nip rollers rotates on the same axle and at the same rotational velocity as the lower roller of the other pair of take-away nip rollers.

30 25. The apparatus according to claim 1 wherein each staging surface includes a sensor in electrical communication with an electronic control device and adapted to indicate the presence of a sheet on the staging surface.

-20-

26. The apparatus according to claim 1 further comprising a plurality of post-staging surfaces, each post-staging surface interposed between one of the staging surfaces and the merger location.

5 27. The apparatus according to claim 1 wherein the output surface includes a pair of exit rollers including an upper roller disposed above the output surface and a lower roller disposed below the output surface.

28. The apparatus according to claim 1 wherein the output surface includes a sensor in electrical communication with an electronic control device and adapted to indicate the presence of a sheet on the output surface.

10 29. A right-angle sheet stager apparatus for merging multiple input sheet streams into a single output sheet stream, the apparatus comprising:

15 (a) a plurality of input channels, each input channel including a transport surface, a staging surface and a transitional member interposed between the transport surface and the staging surface, each staging surface disposed downstream of its corresponding transport surface, wherein one of the transitional members includes an upper surface disposed at an elevation greater than an elevation of its corresponding staging surface; and

20 (b) an output channel including an output surface, the output channel oriented in a right-angle relation with respect to the input channels and communicating with the input channels at a merger location.

25 30. The apparatus according to claim 29 wherein one of the transport surfaces is disposed at an elevation greater than the elevation of its corresponding staging surface.

31. The apparatus according to claim 29 wherein an upper surface of one of the transitional members is greater than an elevation of its corresponding transport surface.

30 32. A right-angle sheet stager apparatus for merging multiple input sheet streams into a single output sheet stream, the sheet stager apparatus comprising:

-21-

- 5 (a) an inside input path including an inside transport surface and an inside staging surface, the inside staging surface having an elevation and communicating with the inside transport surface at an inside interface location, the inside interface location including an upper surface having an elevation greater than the elevation of the inside staging surface;
- 10 (b) an outside input path including an outside transport surface and an outside staging surface communicating with the outside transport surface at an outside interface location, the outside staging surface having an elevation different from the elevation of the inside staging surface, the outside interface location including an upper surface having an elevation greater than the elevation of the outside staging surface; and
- 15 (c) an output path including an output surface, the output path oriented in a right-angle relation with respect to the inside and outside input paths and communicating with the inside and outside input paths at a merger location.

20 33. The apparatus according to claim 32 wherein the inside transport surface has an elevation greater than the elevation of the inside staging surface and the outside transport surface has an elevation greater than the elevation of the outside staging surface.

25 34. The apparatus according to claim 32 wherein the elevation of the upper surface of the inside interface location is greater than an elevation of the inside transport surface and the elevation of the upper surface of the outside interface location is greater than an elevation of the outside transport surface.

35. A right-angle sheet stager apparatus for merging multiple input sheet streams into a single output sheet stream comprising:

- 30 (a) a plurality of means for transporting a plurality of sheet streams along a plurality of different respective input paths;
- (b) a plurality of means for staging sheets of the respective sheet streams, each staging means communicating with a corresponding one of the transporting means at a transitional

-22-

location disposed between each staging means and corresponding transporting means, wherein the sheets are staged in each staging means at an elevation different than an elevation of the other staging means; and

- (c) means for directing sheets received and staged at the plurality of staging means into a single output sheet stream along an output path, wherein the output path is substantially perpendicular to each of the plurality of input paths.

36. The apparatus according to claim 35 wherein the sheets received by each staging means are staged in the staging means at an elevation lower than an elevation of the corresponding transitional location.

10

37. A right-angle sheet stager apparatus for merging multiple input sheet streams into a single output sheet stream, the right angle sheet stager apparatus comprising:

- a) a plurality of input channels, each input channel including an input surface and terminating at a staging surface wherein each staging surface is disposed at different elevations;

- (b) an output channel including an output surface, the output channel oriented in a substantially right-angle relation with respect to the input channels and communicating with the input channels at a merger location; and

20

- (c) means for driving a first sheet staged on one of the staging surfaces toward the output channel after a second sheet being fed into the staging surface from its corresponding input surface has moved into an overlapping relation with the first sheet.

38. A right-angle sheet stager apparatus for merging multiple input sheet streams into a single output sheet stream, the right angle sheet stager apparatus comprising:

- a) a plurality of input channels, each input channel including an input surface and terminating at a staging surface wherein each staging surface is disposed at different elevations;

30

- (b) an output channel including an output surface, the output channel oriented in a substantially right-angle relation with respect to the input channels and communicating with the input channels at a merger location; and

-23-

(c) means for driving a first sheet received at the merger location from a first one of the staging surfaces along the output surface after a second sheet received from a second one of the staging surfaces has moved into an overlapping relation with the first sheet.

39. A right-angle sheet stager apparatus comprising:

- (a) an input channel including a transport surface and a staging surface, the transport surface communicating with the staging surface at a transitional member interposed between the transport surface and the staging surface, the transitional member having an upper surface disposed at an elevation greater than an elevation of the staging surface; and
- (b) an output channel oriented in a substantially right-angle relation with respect to the input channel.

40. A document handling apparatus comprising:

- (a) an input path structure including an input surface and a first document moving device disposed in operative engagement with the input surface;
- (b) an output path structure oriented perpendicularly with respect to the input path structure and including an output surface;
- (c) a staging and document turning assembly interposed between the input path structure and the output path structure and including a staging surface and a second document moving device, wherein the staging surface defines an interface between the input surface and the output surface, and the second document moving device is disposed in operative engagement with the staging surface and is oriented perpendicularly with respect to the first document moving device; and

d) means for driving a first sheet staged on the staging surface toward the output surface after a second sheet being fed onto the staging surface from the input surface has moved into an overlapping relation with the first sheet.

-24-

41. A method for merging multiple input sheet streams into a single output sheet stream oriented at a right angle with respect to the input sheet streams comprising the steps of:

- 5 (a) providing a staging area including a plurality of staging surfaces disposed at different elevations;
- (b) feeding a plurality of sheets in a plurality of input sheet streams into the staging area, wherein the sheets of each input sheet stream are transported onto a corresponding one of the staging surfaces;
- 10 (c) providing a sheet outfeed area including an output surface in communication with each of the staging surfaces;
- (d) staging a first sheet on a first one of the staging surfaces;
- (e) bringing the first sheet into contact with a sheet driving mechanism;
- 15 (f) activating the sheet driving mechanism to transport the first sheet towards the outfeed area; and
- (g) permitting a second sheet to enter the first staging surface and to overlap with the first sheet prior to transportation of the entire first sheet out of the staging area.

20 42. The method according to claim 41 comprising the step of permitting a plurality of sheets to enter the first staging surface and accumulate thereon prior to transportation of the first sheet out of the staging area.

25 43. The method according to claim 41 comprising the steps of staging a third sheet on a second one of the staging surfaces, causing the first sheet and the third sheet to merge into a single output sheet stream at a merger location disposed downstream of the staging area, and permitting the first and third sheets to enter into an overlapping relation at the merger location.

30 44. The method according to claim 41 comprising the steps of causing the first sheet and the second sheet to merge into a single output sheet stream at a merger location disposed downstream of the staging area, and permitting the first and second sheets to enter into an overlapping relation at the merger location.

-25-

45. A method for merging multiple input sheet streams into a single output sheet stream oriented at a right angle with respect to the input sheet streams comprising the steps of:

- 5 (a) providing a staging area including a plurality of staging surfaces disposed at different elevations, wherein each staging surface includes a sheet driving element operatively associated therewith;
- 10 (b) feeding a plurality of sheets in a plurality of input sheet streams into the staging area, wherein the sheets of each input sheet stream are transported onto a corresponding one of the staging surfaces;
- (c) providing a sheet outfeed area including an output surface in communication with each of the staging surfaces;
- (d) staging a first sheet on a first one of the staging surfaces;
- 15 (e) staging a second sheet on a second one of the staging surfaces;
- (f) bringing the first sheet into contact with the sheet driving element of the first staging surface;
- (g) bringing the second sheet into contact with the sheet driving element of the second staging surface;
- 20 (h) activating the sheet driving element of the first staging surface to transport the first sheet towards the outfeed area in a direction substantially perpendicular to at least one of the input sheet streams; and
- 25 (i) activating the sheet driving element of the second staging surface to transport the second sheet towards the outfeed area in a direction substantially perpendicular to at least one of the input sheet streams.

30 46. The method according to claim 46 comprising the step of causing a subsequent sheet to enter the first staging surface and to overlap with the first sheet prior to transportation of the first sheet out of the staging surface.

-26-

47. The method according to claim 46 comprising the step of permitting a plurality of sheets to enter the first staging surface and accumulate thereon prior to transportation of the first sheet out of the staging area.

5 48. The method according to claim 45 comprising the step of merging the first and second sheets into a single output sheet stream at a merger location.

49. The method according to claim 48 comprising the step of permitting the first and second sheets to overlap at the merger location.

10 50. The method according to claim 49 comprising the steps of transporting a third sheet from the first staging surface towards the outfeed area, transporting a fourth sheet from the second staging surface towards the outfeed area, merging the third and fourth sheets at the merger location, and permitting the third and fourth sheets to overlap at the merger location.

15 51. The method according to claim 45 comprising the steps of transporting a third sheet from the first staging surface towards the outfeed area, merging the second and third sheets at the merger location, and permitting the second and third sheets to overlap at the merger location.

20 52. The method according to claim 45 comprising the steps of transporting a third sheet from the first staging surface towards the outfeed area, transporting a fourth sheet from the second staging surface towards the outfeed area, merging the third and fourth sheets at the merger location, and permitting the third and fourth sheets to overlap at the merger location.

25 53. The method according to claim 45 comprising the steps of transporting a third sheet from the first staging surface towards the outfeed area, merging the first and third sheets at the merger location, and permitting the first and third sheets to overlap at the merger location.

30 54. The method according to claim 53 comprising the steps of transporting a fourth sheet from the second staging surface towards the outfeed area, merging the second and fourth sheets at the merger location, and permitting the second and fourth sheets to overlap at the merger location.

FIG. 2

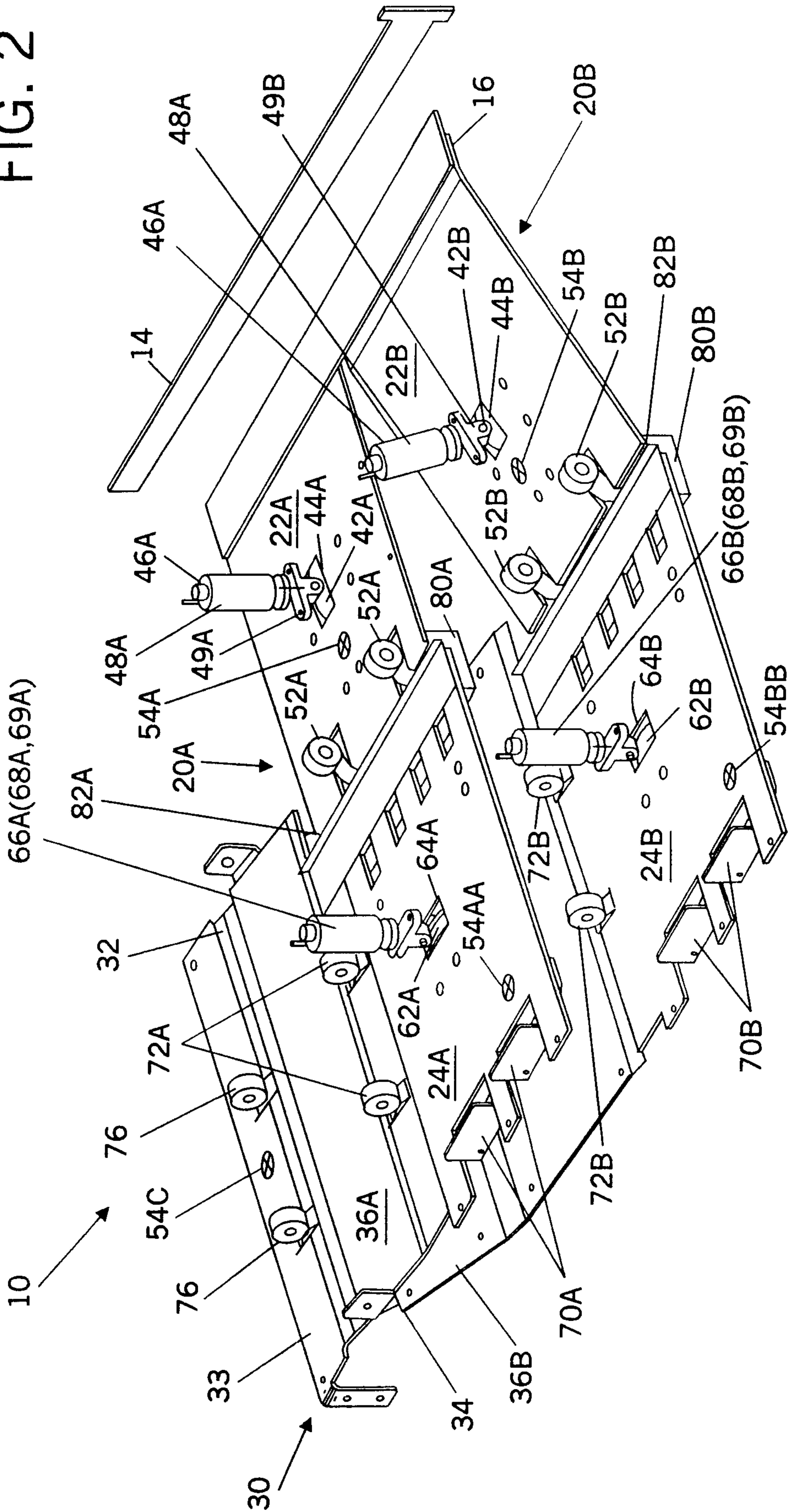

FIG. 3

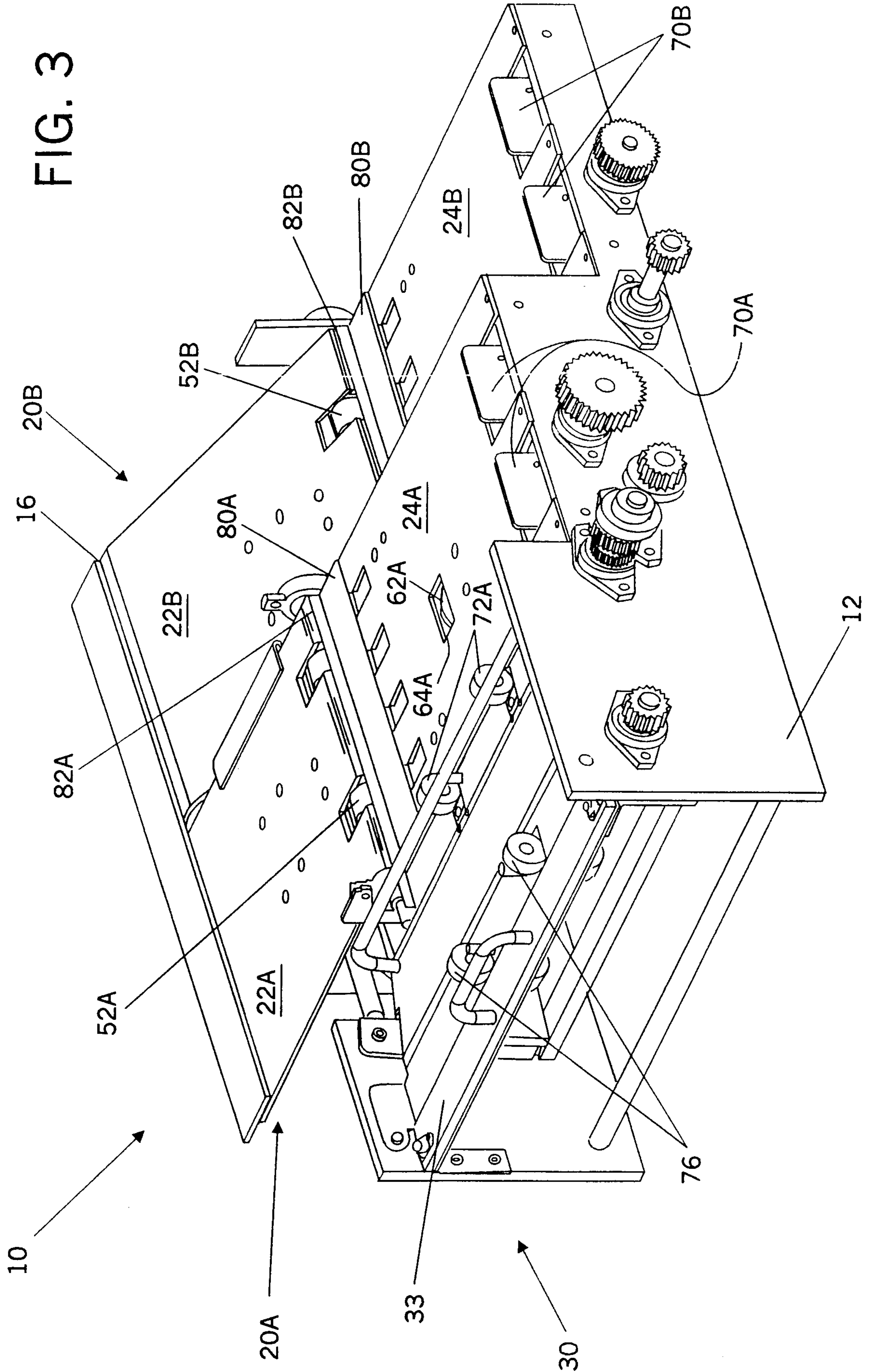

FIG. 4

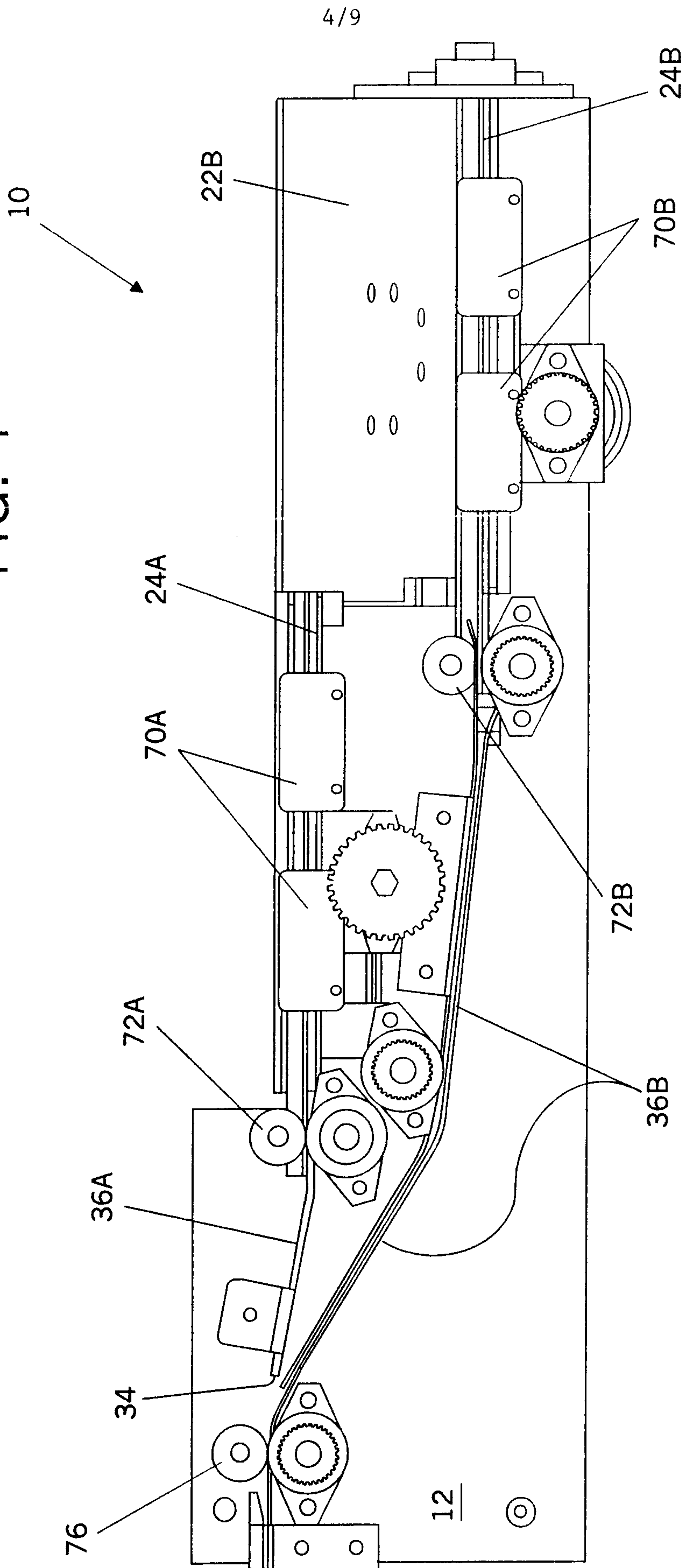

FIG. 5

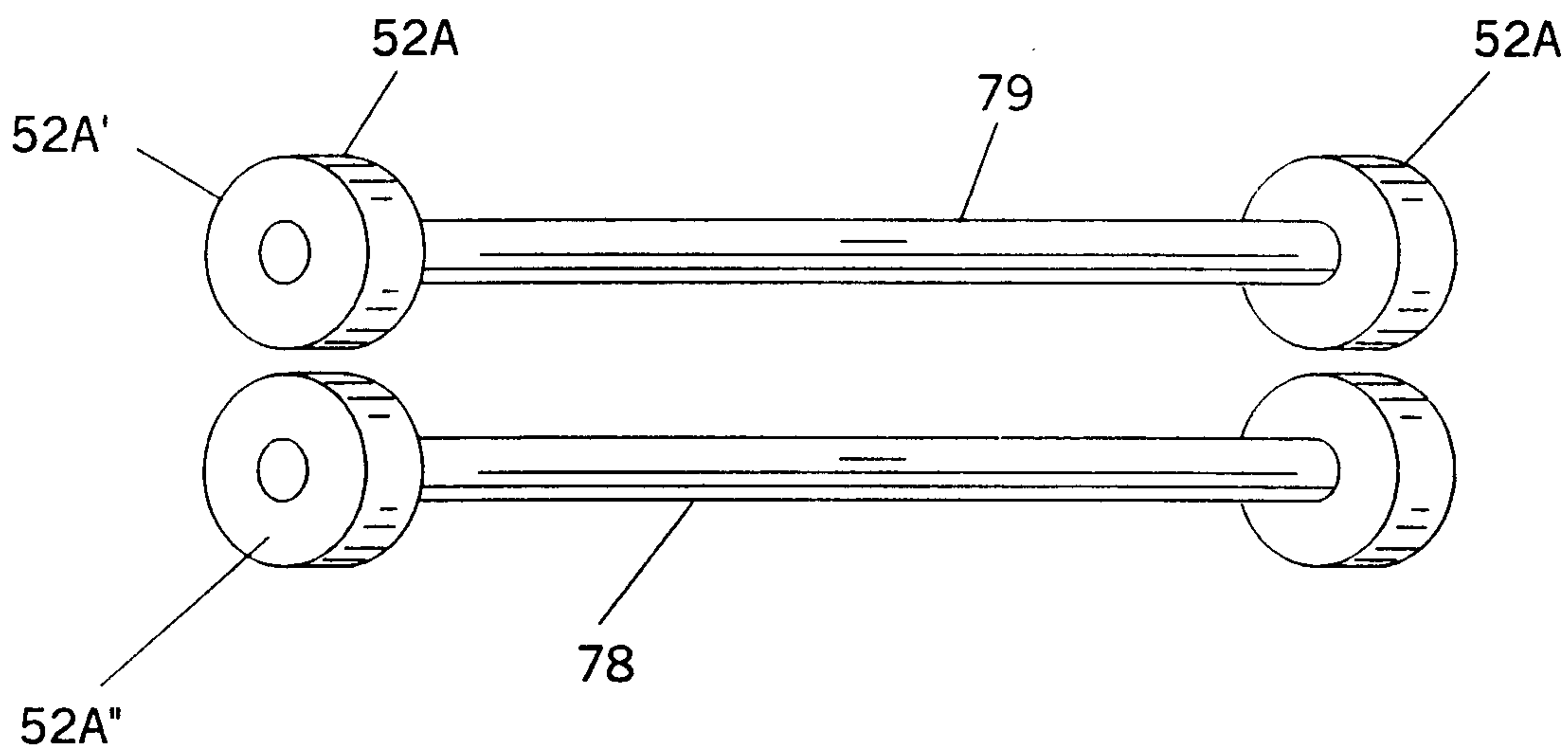
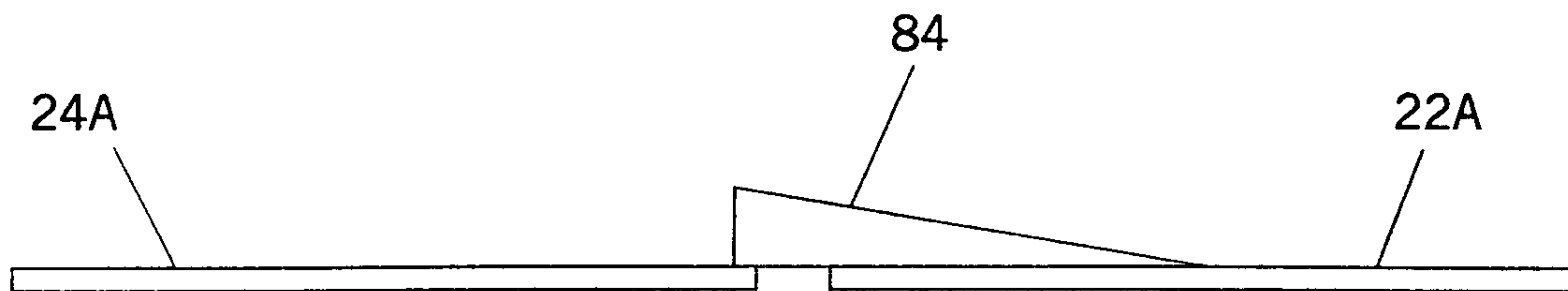

FIG. 6



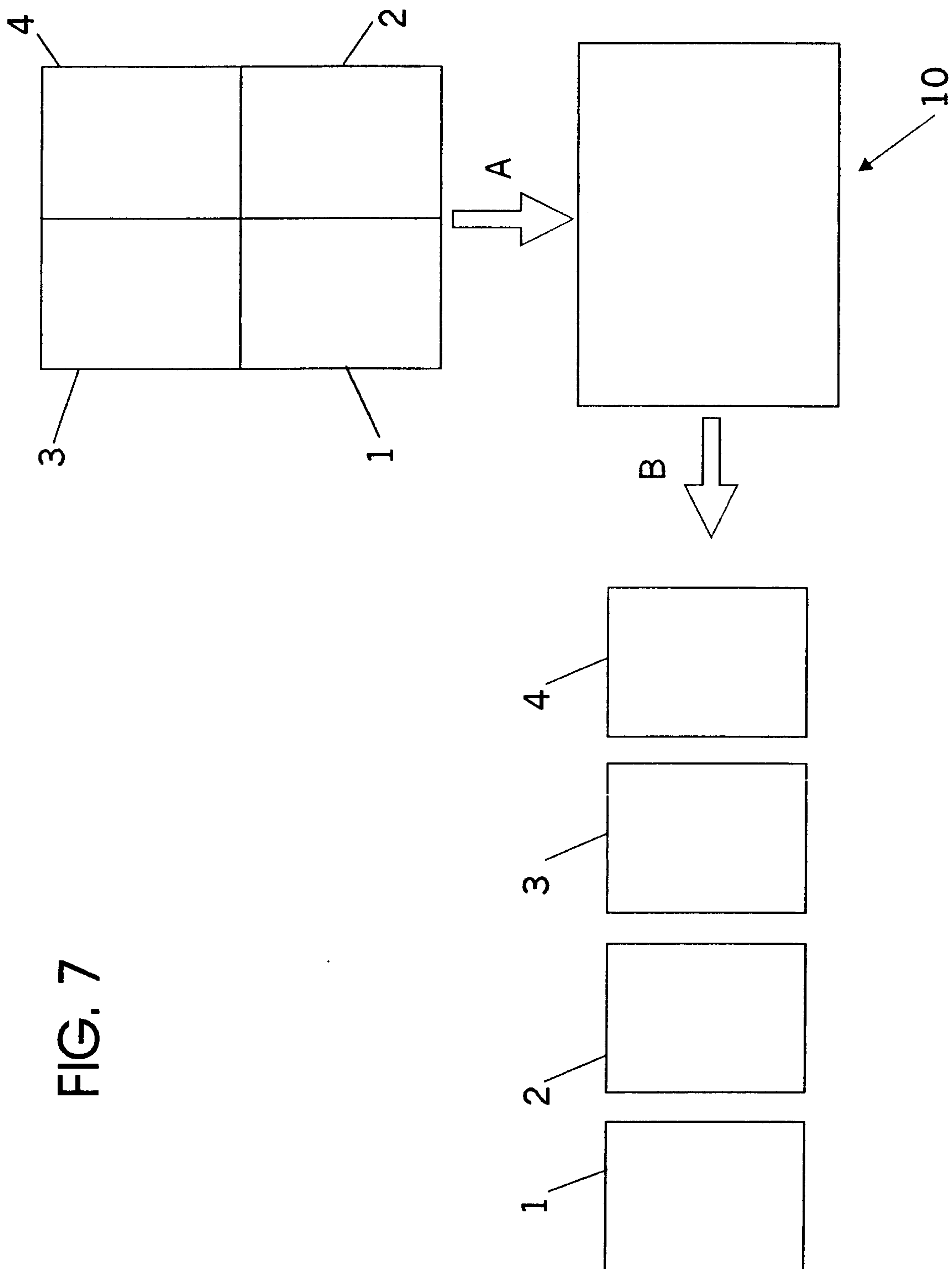

FIG. 7

7/9

FIG. 8

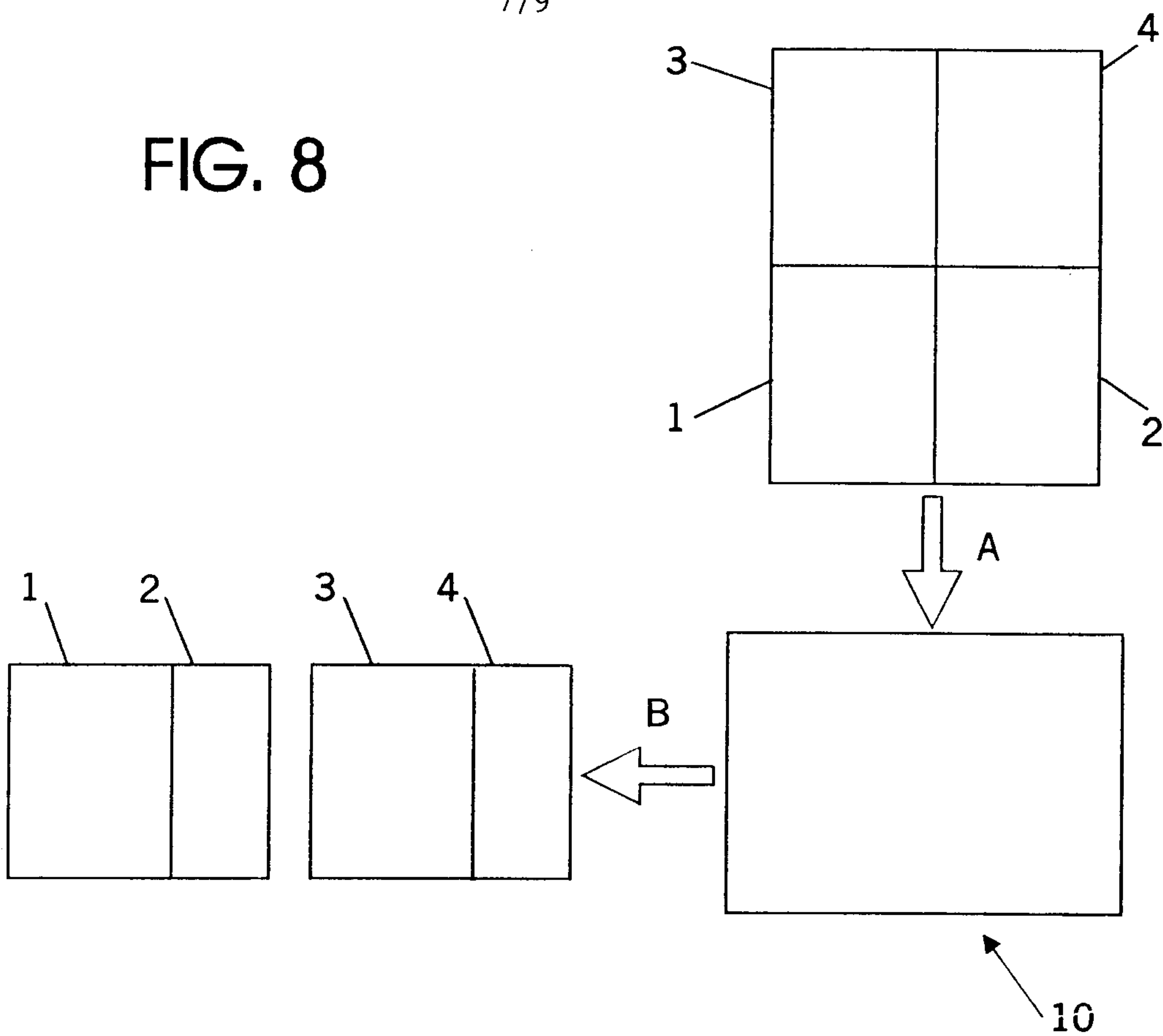

FIG. 9

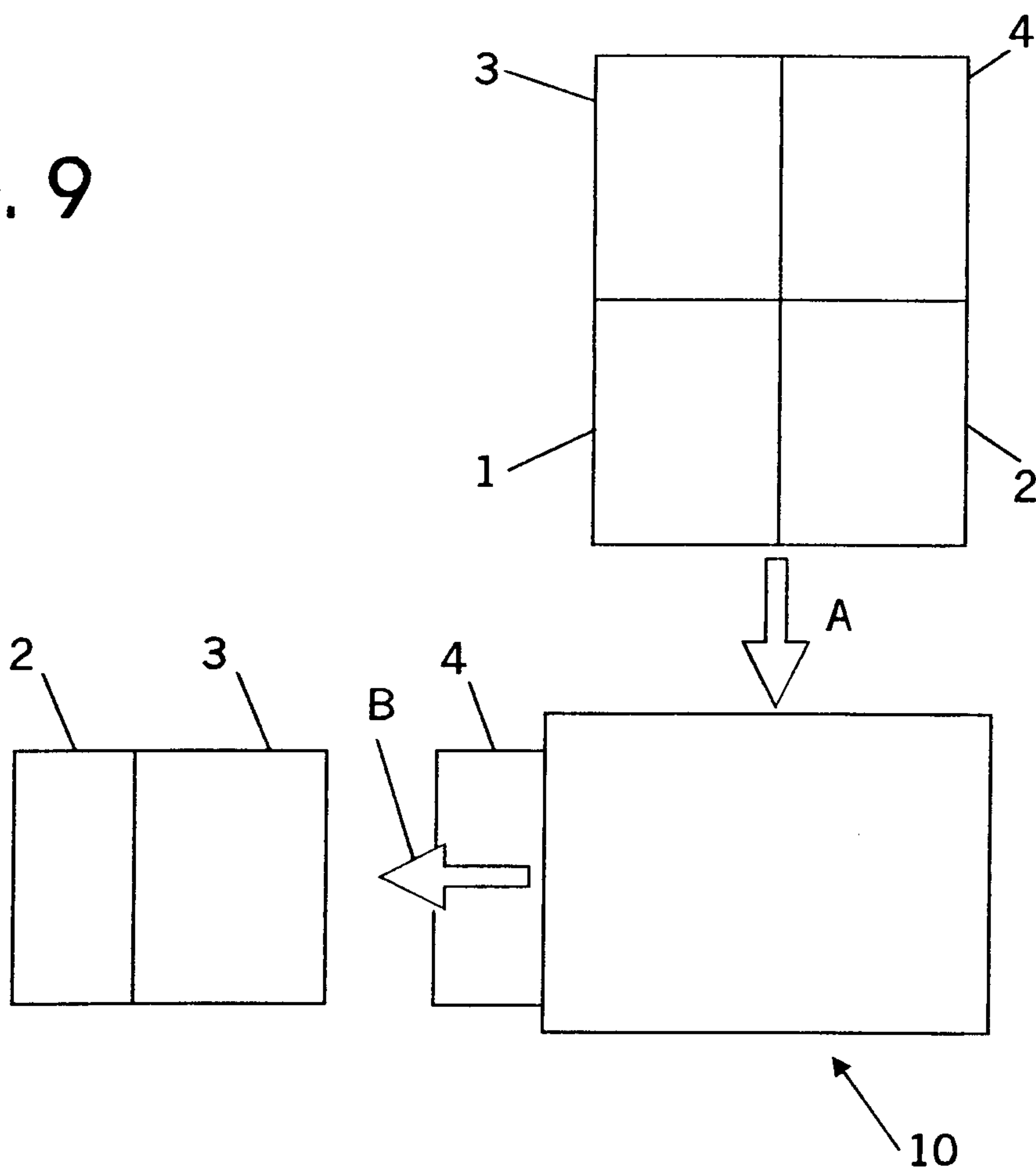

FIG. 10

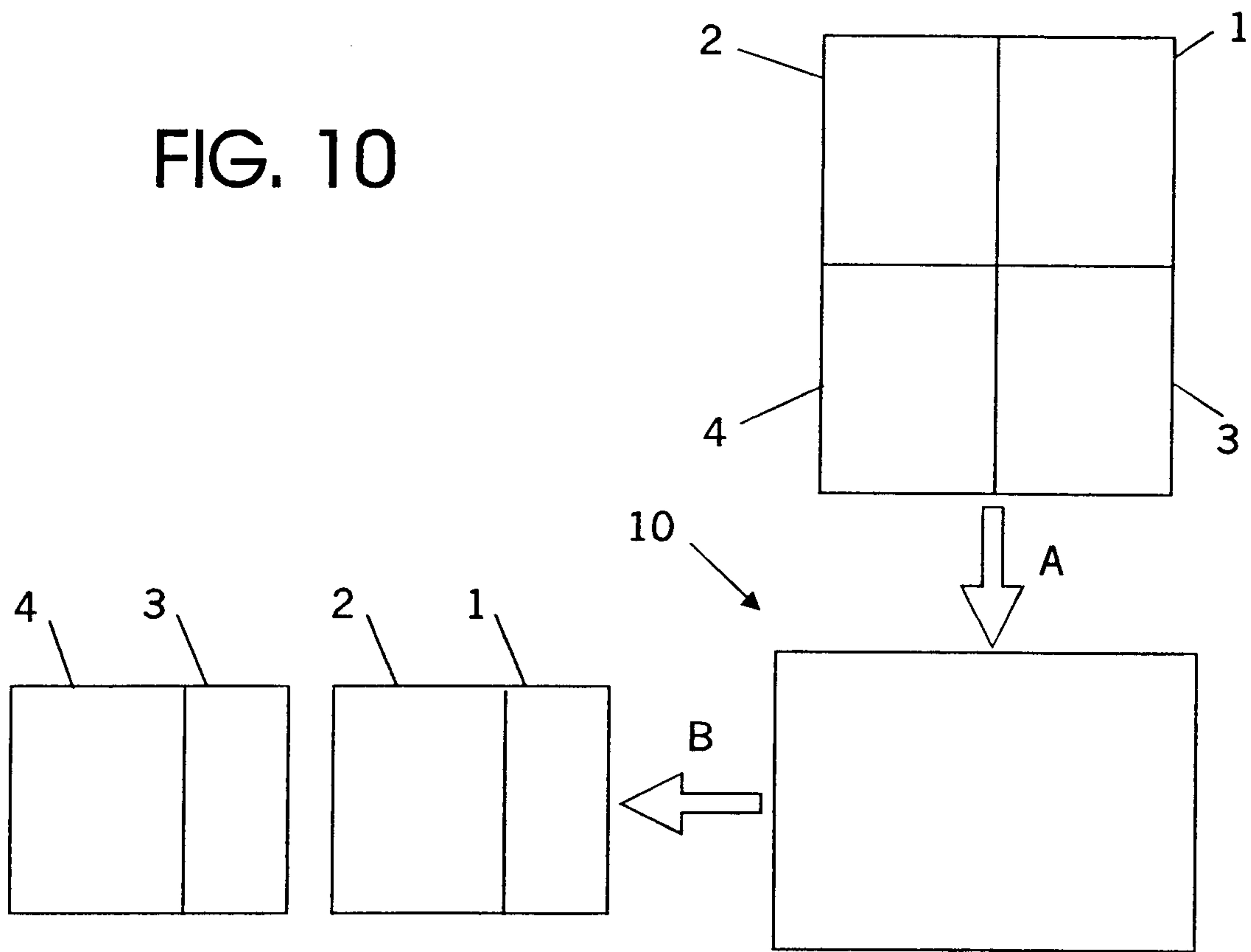

FIG. 11

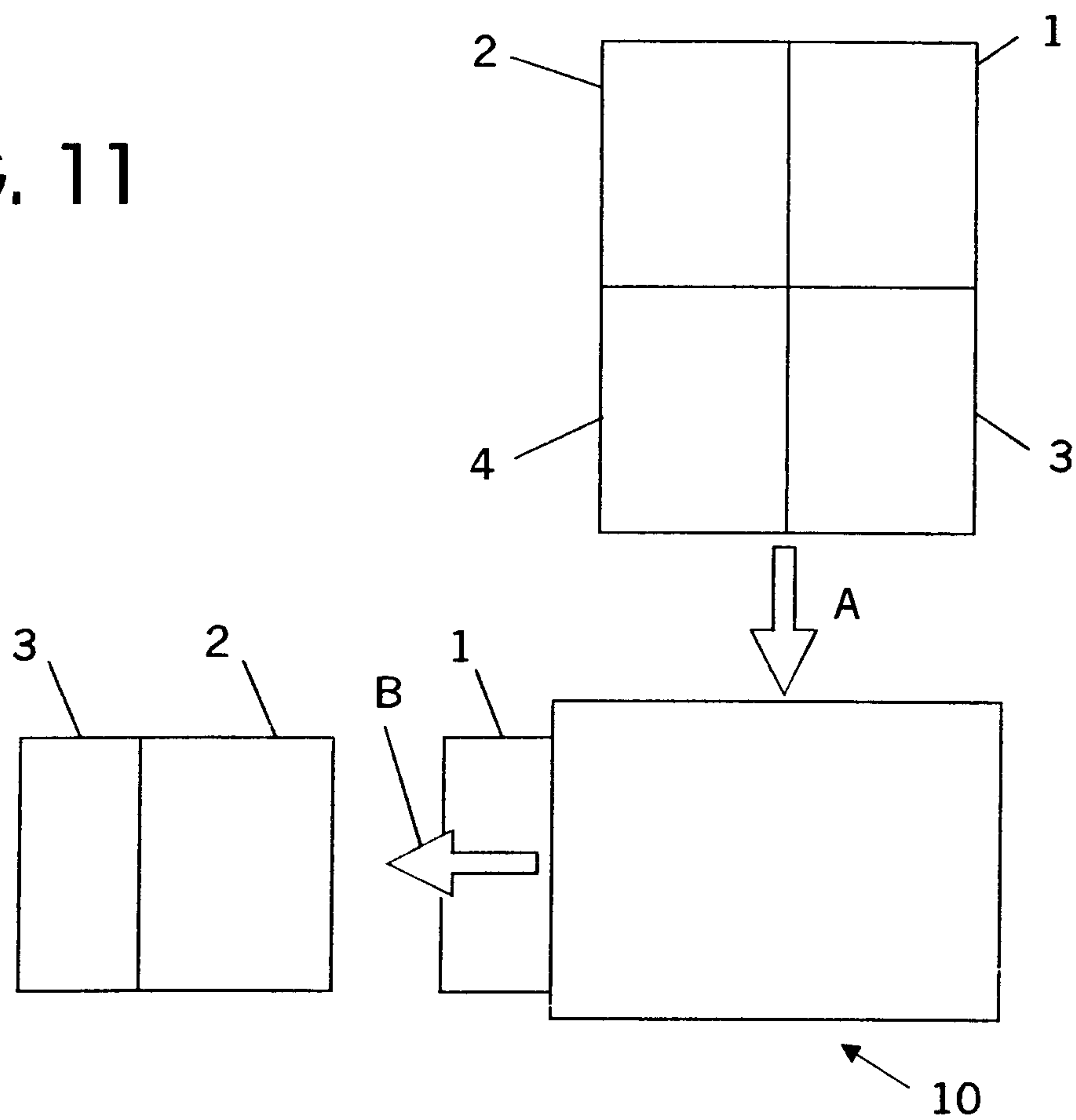

FIG. 12

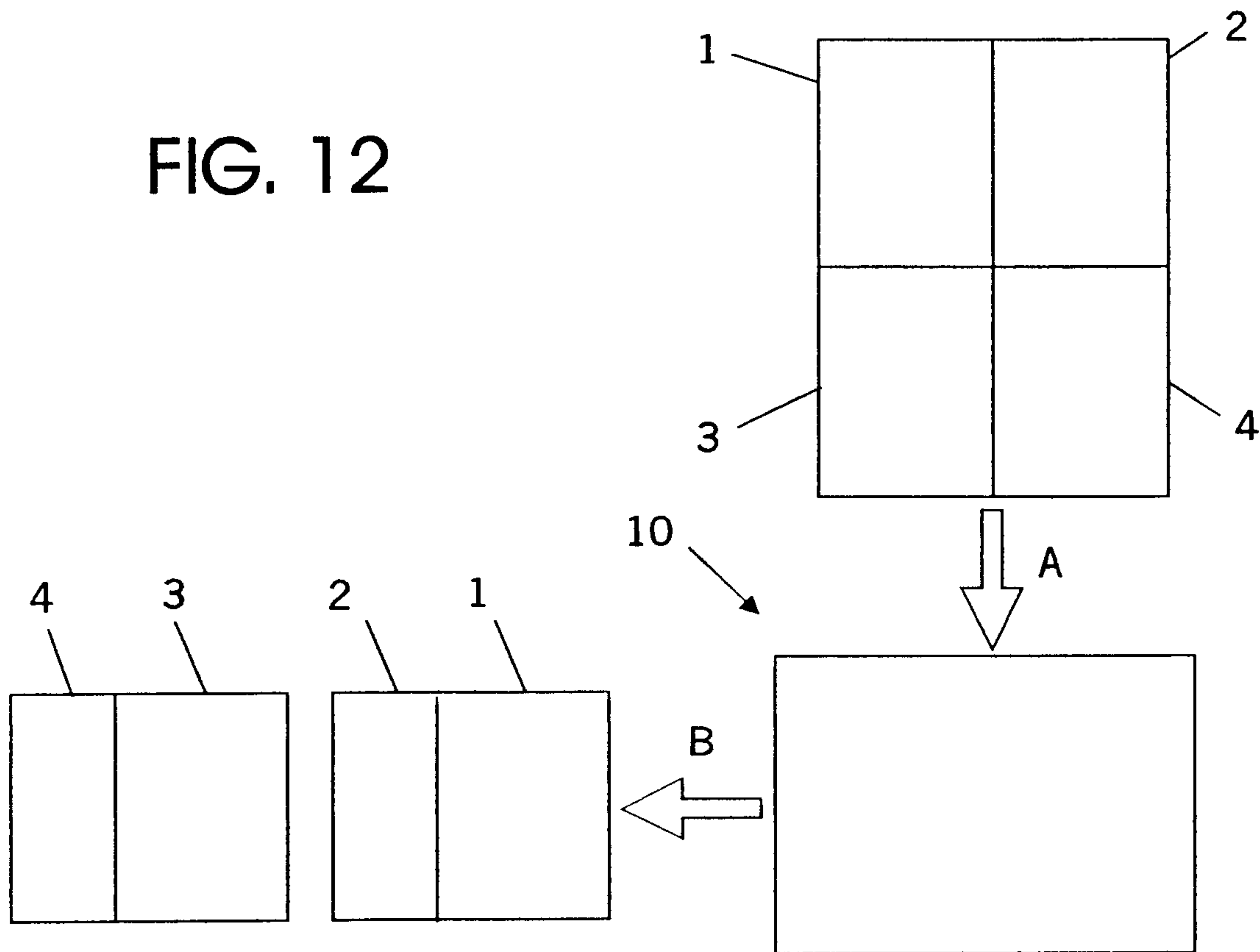

FIG. 13

