



US 20080257345A1

(19) **United States**(12) **Patent Application Publication**
Snyder et al.(10) **Pub. No.: US 2008/0257345 A1**(43) **Pub. Date: Oct. 23, 2008**(54) **ANTISTATIC MEDICATION DELIVERY
APPARATUS****Publication Classification**(75) Inventors: **Sarah Bruce Snyder**, Waterloo
(CA); **James N. Schmidt**, London
(CA)(51) **Int. Cl.**
A61M 15/00 (2006.01)(52) **U.S. Cl.** **128/203.15**Correspondence Address:
BRINKS HOFER GILSON & LIONE
P.O. BOX 10395
CHICAGO, IL 60610 (US)(57) **ABSTRACT**(73) Assignee: **Trudell Medical International**(21) Appl. No.: **12/075,470**(22) Filed: **Mar. 11, 2008**

An aerosol medication delivery apparatus include a holding chamber having an input end and an output end and defining an interior space. In one embodiment, the holding chamber is antistatic and is made of a plastic material having a surface resistivity of between about 10E10 and about 10E12 ohm/sq. In another embodiment, a component, such as a backpiece or mouthpiece, separate from the holding chamber, is antistatic and is made of a material having a surface resistivity of between about 10E10 and about 10E12 ohm/sq. The component is connected to the holding chamber, which may or may not be antistatic. In one embodiment, the component is made of an elastomeric material. In one embodiment, at least a portion of the holding chamber and/or component is see-through. Various methods for introducing an aerosol into the holding chamber at the input end thereof and inhaling the aerosol through the output end are also provided.

Related U.S. Application Data

(63) Continuation of application No. 10/821,260, filed on Apr. 8, 2004, now Pat. No. 7,360,537.

(60) Provisional application No. 60/463,288, filed on Apr. 16, 2003.

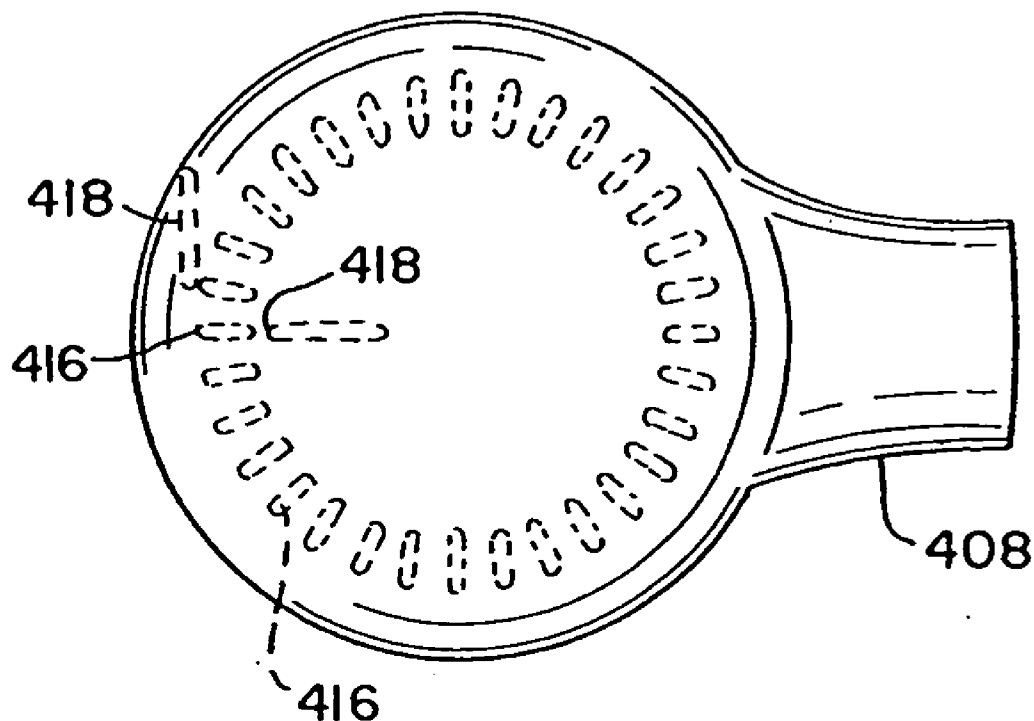

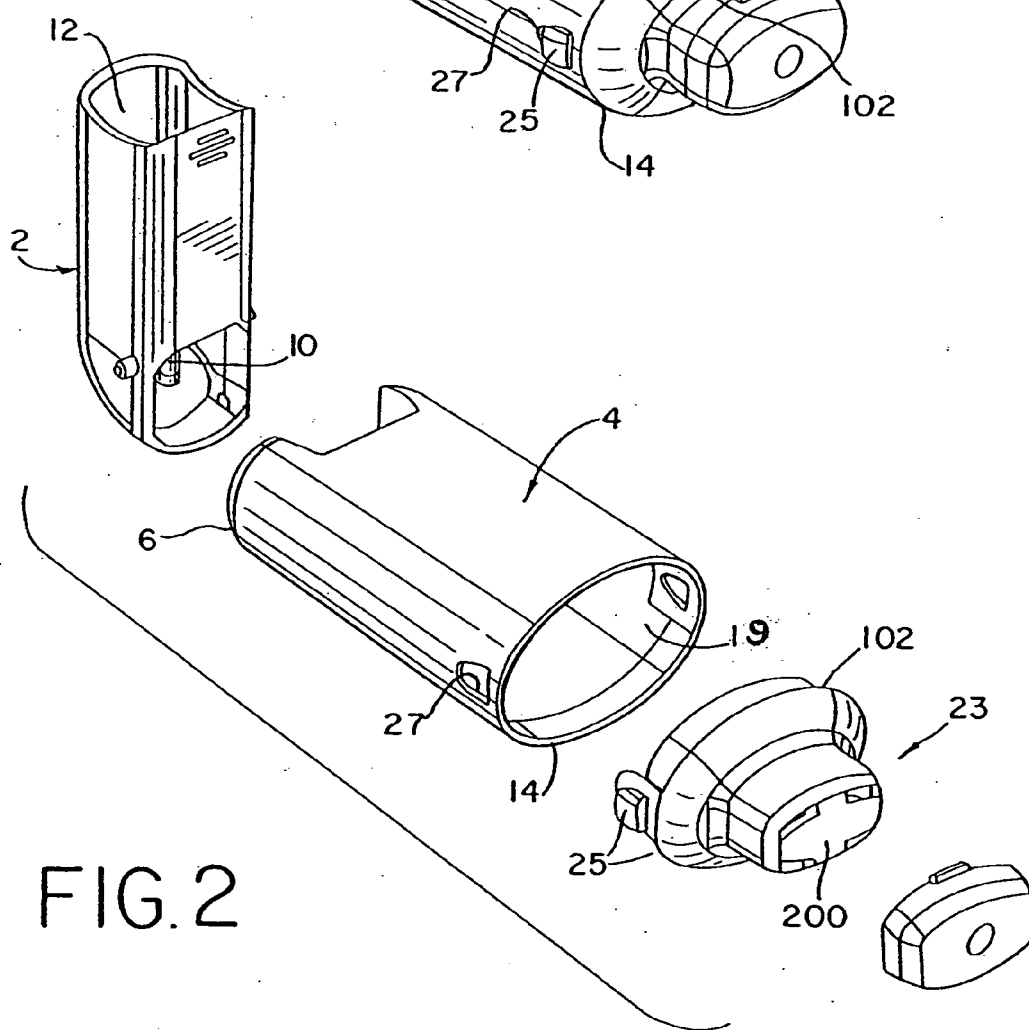
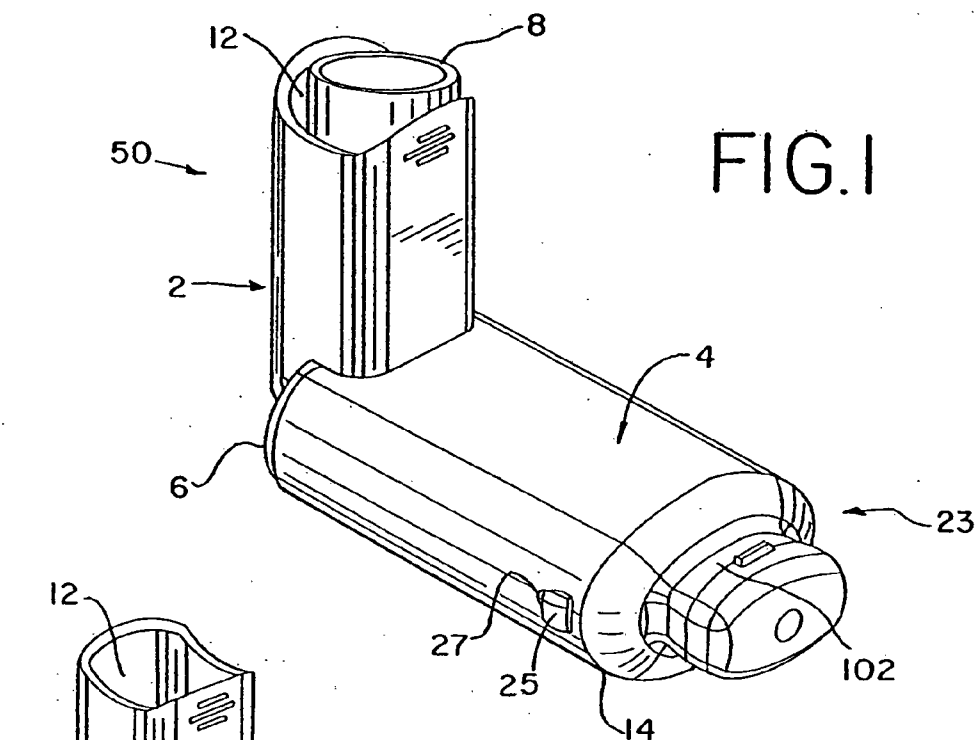

FIG. 3

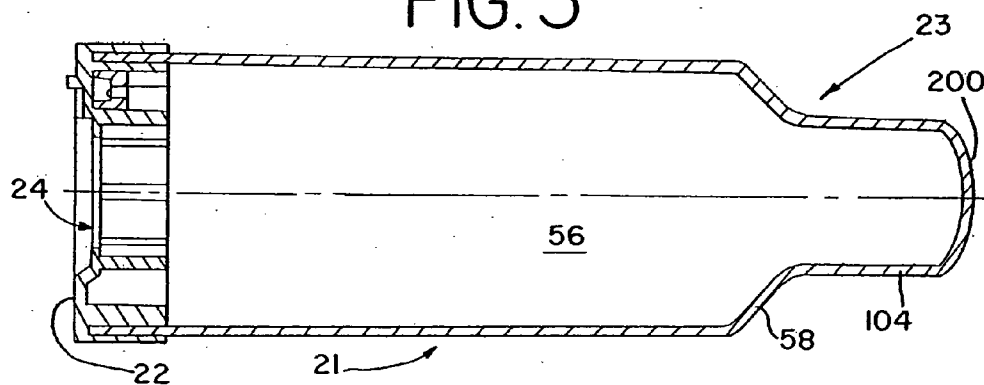

FIG. 4

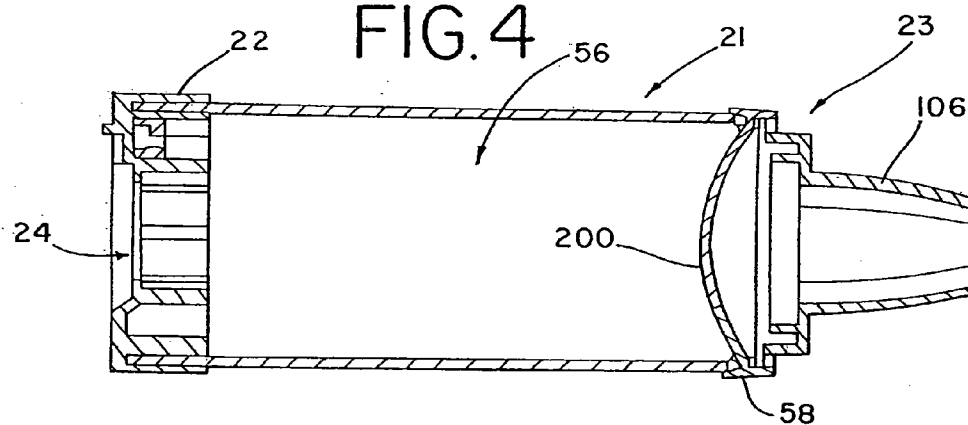
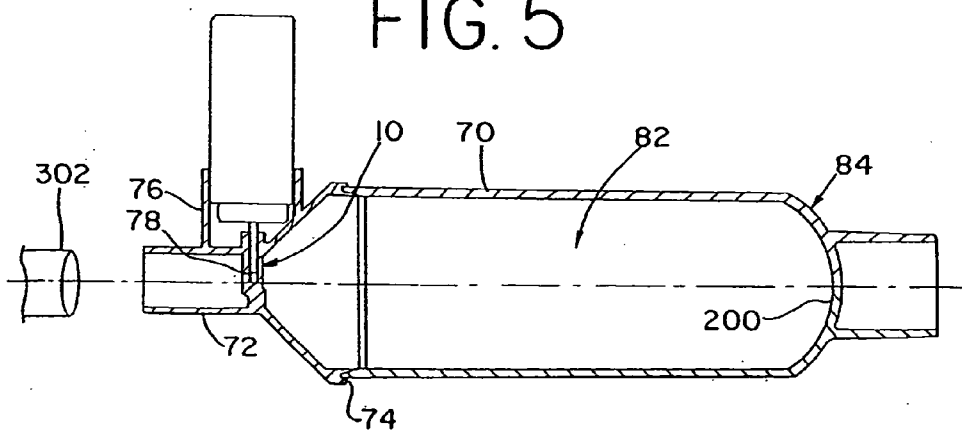
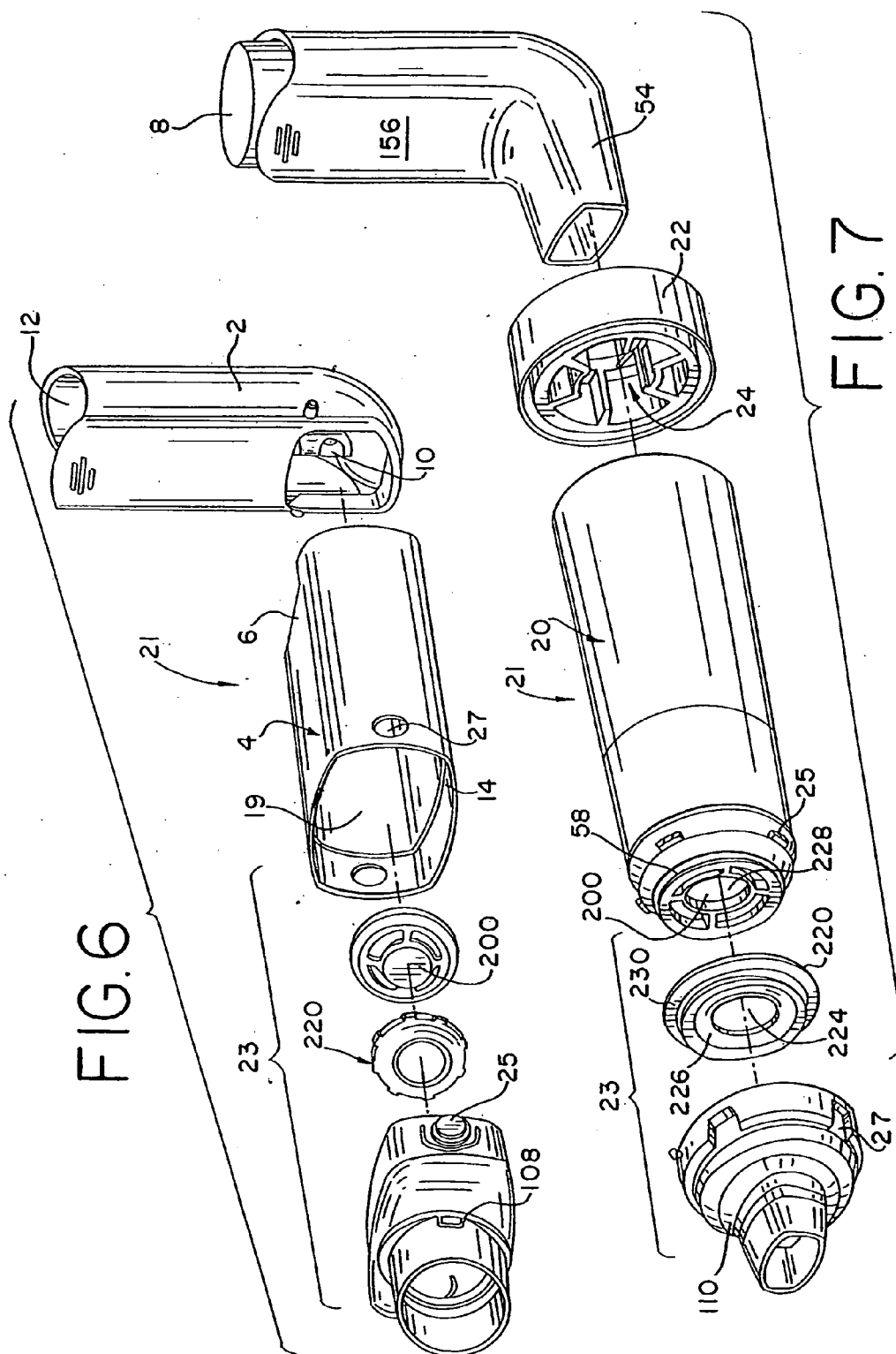

FIG. 5





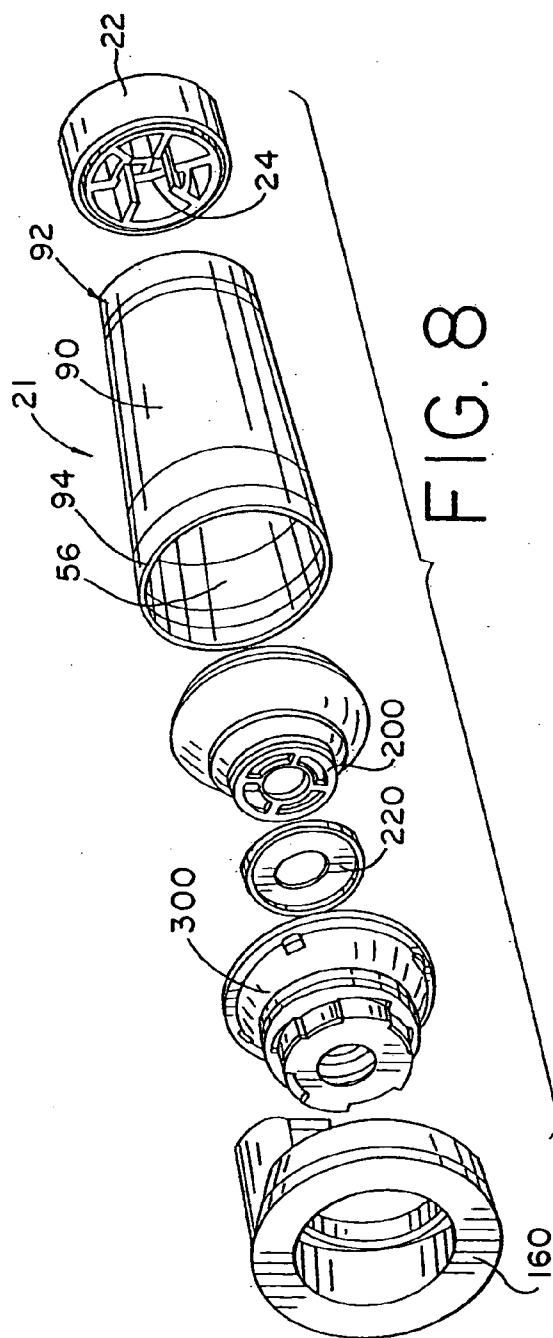

FIG. 8

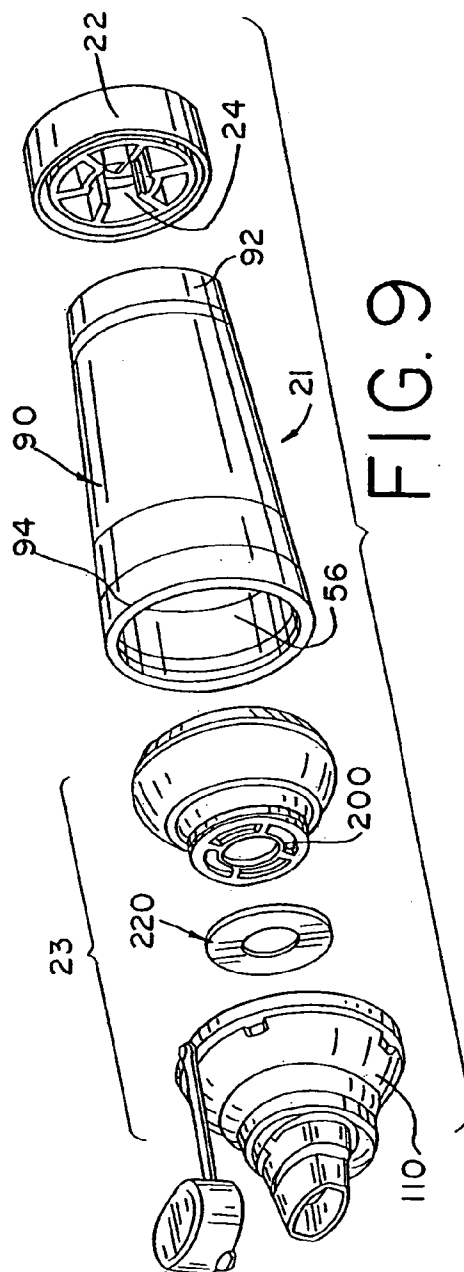

FIG. 9

FIG. 10

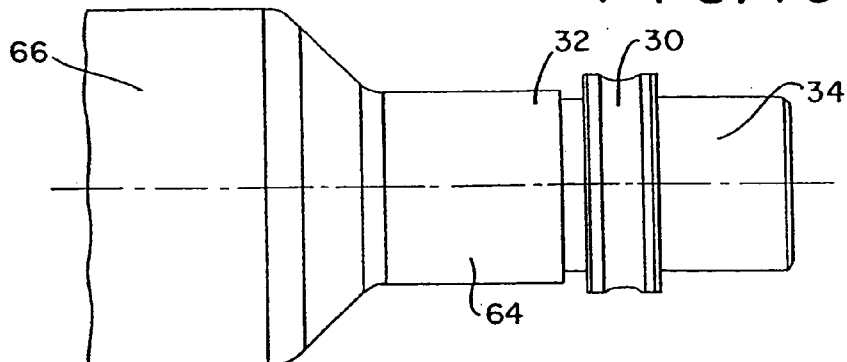

FIG. II

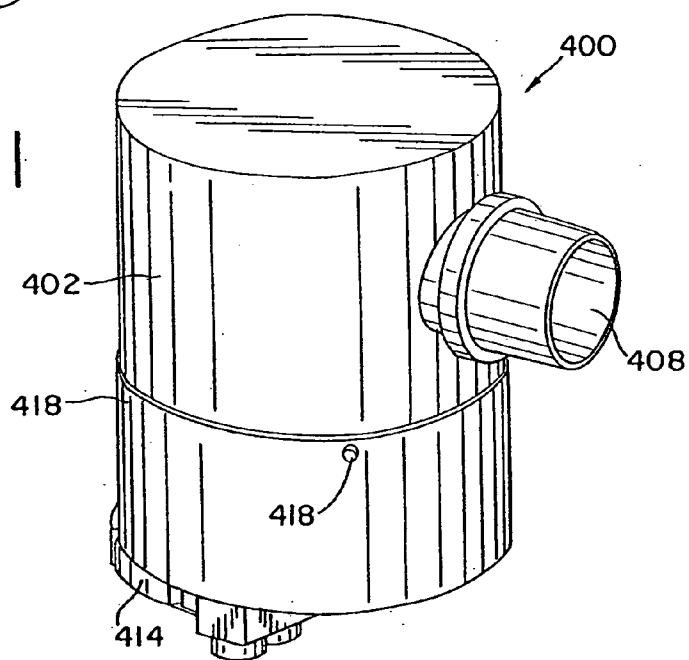

FIG. 12

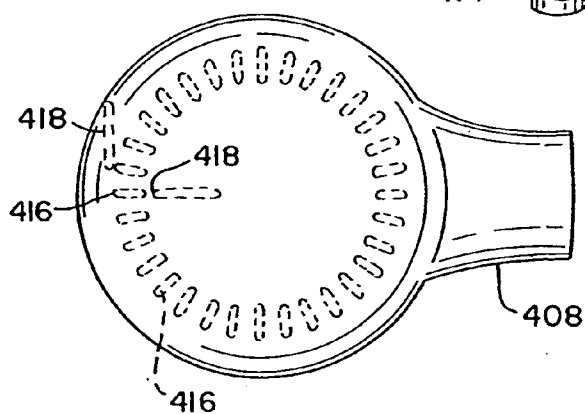

FIG. 13

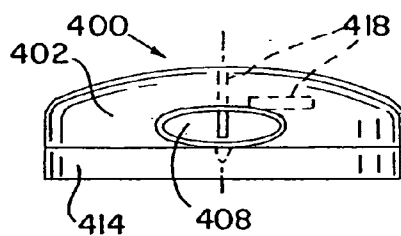

FIG. 14

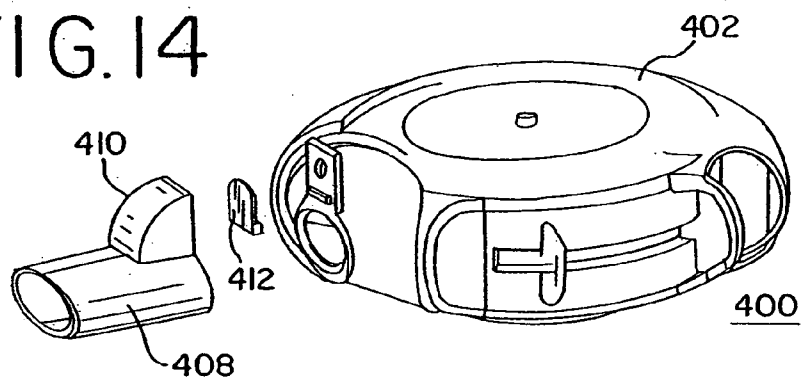

FIG. 15

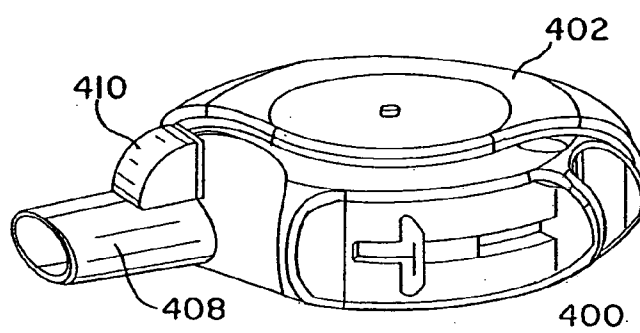
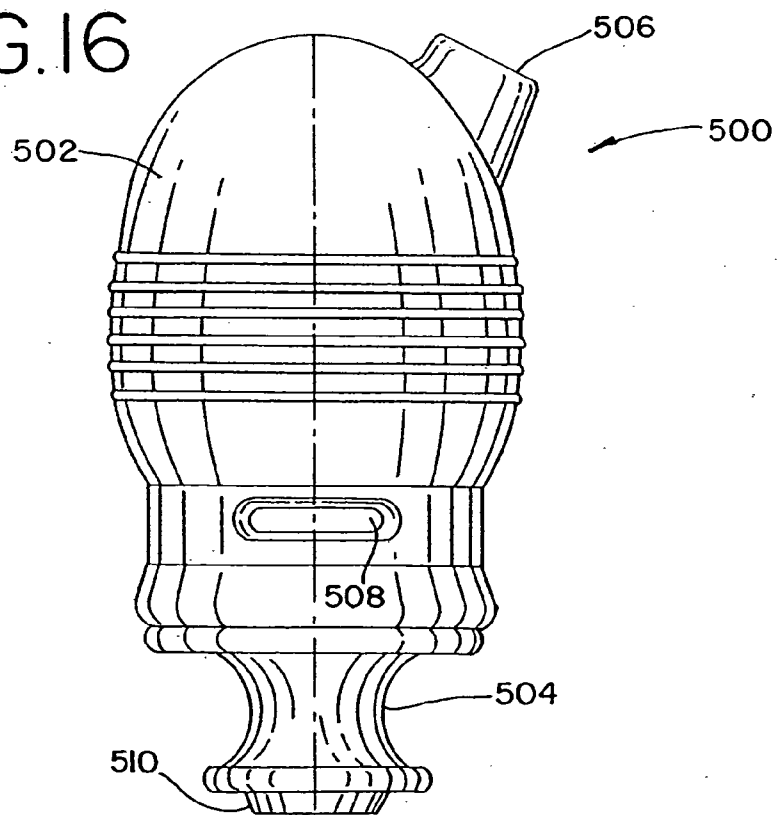

FIG. 16



ANTISTATIC MEDICATION DELIVERY APPARATUS

[0001] This application is a continuation of U.S. application Ser. No. 10/821,260, filed Apr. 8, 2004, which claims the benefit of U.S. Provisional Application Ser. No. 60/463,288, filed Apr. 16, 2003, the entire disclosures of which are hereby incorporated herein by reference.

BACKGROUND

[0002] The present invention relates to a medication delivery apparatus, and in particular, to an antistatic medication delivery apparatus.

[0003] Medication delivery systems are used, in general, to administer medication to a user. For example, aerosol delivery systems are configured to deliver a medication in aerosol form to the lungs of the user. Other systems deliver the medication to the nasal passageways of the user. Some systems use a pressurized metered-dose inhaler (pMDI), which typically includes a container in which medication particles are stored under pressure, and an actuator used to dispense the medication from the container.

[0004] In other systems, a holding chamber or spacer is connected to one of the container or actuator, as shown for example in U.S. Pat. No. 6,293,279, which is hereby incorporated herein by reference. The holding chamber reduces the need for the user to coordinate activation of the pMDI canister with inhalation, helps reduce the delivery of nonrespirable medication particles from the canister, and helps reduce the impaction of medication particles in the user's oropharynx and upper airway. In some configurations, shown for example in the U.S. Pat. No. 6,293,279 and U.S. Pat. No. 5,881,718, the apparatus can be provided with one or both of an inhalation and exhalation valve(s) at an output end of the chamber. The output end is typically configured with a mouthpiece, which is received in the mouth of the user, or with a mask, which is placed over the mouth and nose of the user.

[0005] Often, holding chamber devices are made of various plastics, such as polypropylene or polycarbonates. However, plastic materials typically have relative high surface resistivities, typically greater than $10E12$ ohm/sq. As such, the interior of the chamber can become electrostatically charged, thereby causing some of the medication particles in the aerosol to deposit on the walls and/or other parts attached to or forming part of the holding chamber. As disclosed in U.S. Pat. No. 6,435,176, for example, one solution to this problem is to provide a spacer made of metal or other materials having resistivities below $10E9$ ohm. However, metal spacers or holding chambers, made for example of stainless steel or aluminum, are relatively expensive to manufacture and are heavy and more difficult to handle. In addition, metal spacers or holding chambers do not allow the user or caregiver to visualize the delivery of medication from the chamber. Likewise, many plastics, if formed with antistatic additives, such as metal fibers, are not see-through and can obstruct a view of the interior of the chamber. In addition, plastic components having an antistatic surface coating can tend to degrade and lose their antistatic properties over time, e.g., within about a year.

[0006] Another solution is to periodically wash a plastic holding chamber with a detergent. However, such a solution can be cumbersome. Accordingly, the need remains for an

improved holding chamber made of plastic, preferably clear, having inherent substantially permanent antistatic properties.

SUMMARY

[0007] By way of introduction, various preferred embodiments of an aerosol medication delivery apparatus include a holding chamber having an input end and an output end and defining an interior space. In one embodiment, the holding chamber is antistatic and is made of a plastic material having a surface resistivity of less than about $10E12$ ohm/sq, and preferably between about $10E10$ and about $10E12$ ohm/sq. In one preferred embodiment, at least a portion of the holding chamber is see-through. In addition, the antistatic properties are substantially permanent.

[0008] In another embodiment, a component, separate from the holding chamber, is antistatic and is made of a material having a surface resistivity of between about $10E10$ and about $10E12$ ohm/sq. The component is connected, directly or indirectly, to the holding chamber, which may or may not be antistatic. In one preferred embodiment, the component is a backpiece connected to an input end of the holding chamber. In one embodiment, the backpiece is made of an elastomeric material. In another embodiment, the component includes a mouthpiece connected to the output end of the holding chamber.

[0009] In other aspects, various methods are provided that include introducing an aerosol into the holding chamber at the input end thereof and inhaling the aerosol through the output end.

[0010] The various embodiments provide significant advantages over other holding chamber devices. For example, both the holding chamber and component, such as the backpiece, can be made of various plastic and/or elastomeric materials, which are relatively light weight and inexpensive to manufacture. At the same time, one or more of the holding chamber and components can be made antistatic, such that the medication particles in the aerosol are less likely to be attracted to the interior surface of the holding chamber or components, thereby providing improved consistency in the amount of medication delivered to the patient without pre-treating the delivery apparatus. In addition, the plastic material can be made see-through, such that the user or caretaker can monitor and visualize the interior of the holding chamber and/or component. Moreover, the antistatic properties are substantially permanent, such that they do not degrade over time.

[0011] The foregoing paragraphs have been provided by way of general introduction, and are not intended to limit the scope of the following claims. The presently preferred embodiments, together with further advantages, will be best understood by reference to the following detailed description taken in conjunction with the accompanying drawings.

BRIEF DESCRIPTION OF THE DRAWINGS

[0012] FIG. 1 is a perspective view of a first embodiment of an aerosol medication delivery system.

[0013] FIG. 2 is an exploded perspective view of the aerosol medication delivery system shown in FIG. 1.

[0014] FIG. 3 is a side cross-sectional view of an alternative embodiment of a holding chamber.

[0015] FIG. 4 is a side cross-sectional view of an alternative embodiment of a medication delivery system.

[0016] FIG. 5 is a side cross-sectional view of an alternative embodiment of a medication delivery system.

[0017] FIG. 6 is an exploded perspective view of an alternative embodiment of a medication delivery system.

[0018] FIG. 7 is an exploded perspective view of an alternative embodiment of a medication delivery system.

[0019] FIG. 8 is an exploded perspective view of an alternative embodiment of a medication delivery system.

[0020] FIG. 9 is an exploded perspective view of an alternative embodiment of a medication delivery system.

[0021] FIG. 10 is a partial side view of an output end of an alternative embodiment of a holding chamber.

[0022] FIG. 11 is a perspective view of one embodiment of a dry powder inhaler.

[0023] FIG. 12 is a top view of an alternative embodiment of a dry powder inhaler.

[0024] FIG. 13 is an end view of the dry powder inhaler shown in FIG. 12.

[0025] FIG. 14 is an exploded perspective view of an alternative embodiment of a dry powder inhaler.

[0026] FIG. 15 is a perspective view of the dry powder inhaler shown in FIG. 14.

[0027] FIG. 16 is a side view of a nasal inhaler.

DETAILED DESCRIPTION OF THE PRESENTLY PREFERRED EMBODIMENTS

[0028] Referring to FIGS. 1, 2 and 6, one preferred embodiment of an aerosol medication delivery system 50 includes a pressurized metered dose inhaler (pMDI) holding portion 2, or dispenser (sometimes referred to as an actuator boot), coupled to a chamber housing 4, otherwise referred to as a holding chamber, at an input end 6 thereof. A medication container 8, for example a pMDI canister, is disposed in a cavity 12 formed in the dispenser, with a stem of the canister being inserted into a well 10 formed in the bottom of the dispenser. Preferably, the dispenser 2 is pivotally connected to the chamber housing 4 so that the dispenser 2 can be pivoted and translated for storage inside the chamber housing when the device is not in use. The term “medication” or “medicament” and variations thereof as used herein means any substance used in therapy, for example in the treatment of asthma.

[0029] In various alternative embodiments shown in FIGS. 3, 4 and 7-9, the apparatus includes a backpiece 22 secured to a holding chamber 20, 90 at an input end 52, 94 thereof. The backpiece 22, which is preferably formed as a separate component from the holding chamber, includes an opening 24 shaped to receive a mouthpiece portion 54 of a separate pMDI dispenser 156, which holds the container 8. Various configurations of chamber housings and dispensers are shown in U.S. Pat. Nos. 6,293,279, 5,012,803 and 5,012,804, the entire disclosures of which are hereby incorporated herein by reference. It should be understood that a holding chamber can also be used in conjunction with medication delivery containers other than a pMDI container, including for example and without limitation nasal sprayers, dry powder inhalers and nebulizer systems.

[0030] In yet another embodiment, shown in FIG. 5, the apparatus includes a holding chamber 70 that can be introduced into the inspiratory flow path of a ventilator circuit 302. The apparatus includes a backpiece member 72, configured with a pMDI receptacle 76, which is connected to the input end 79 of the holding chamber. The receptacle 76 is configured as a cylindrical housing shaped to receive the pMDI

container and includes a well 10 formed at the bottom of the receptacle shaped to receive a pMDI valve stem 78. A discharge opening 80 is formed in the receptacle and communicates with the well 10, thereby allowing the aerosol, and medication, to be introduced into an interior 32 of the holding chamber through the backpiece 72 and input end 74 of the holding chamber.

[0031] In all of the embodiments, the chamber housing 4, 20, 70 defines an interior space 19, 56, 82 and further includes an output end 14, 58, 84, 94, through which the medication is dispensed to the user. The holding chamber 20 can have a substantially circular cross section as shown for example in FIG. 7, or the holding chamber 4 can have other shapes, for example a substantially oval cross-section as shown in FIG. 1 or an elliptical or rectangular cross-section (not shown). In addition, the holding chamber 20 can have a substantially constant cross-section, for example forming a cylinder as shown in FIG. 7, or the holding chamber 20 can be tapered, such that the cross-sectional area gradually increases from the input end 92 to the output end 94 as shown in FIGS. 8 and 9, or decreases along the same path (not shown).

[0032] As shown in the embodiments of FIGS. 1-3 and 6-8, the output end 14, 58, 84, 94 includes a downstream portion 23 that is configured with a mouthpiece 102, 104, 106, 108, 110. The mouthpiece 102, 106, 108, 110 can be formed as a separate component that is releasably secured to a main housing 21 with one or more fastening elements 25, 27, as shown for example in FIGS. 1, 2, and 4-8. For example, the fastening elements can be configured as tabs 25 and recesses 24 in one preferred embodiment, which provides a snap-fit between the main housing 21 and the downstream portion 23. As shown in FIG. 3, the mouthpiece 104 can alternatively be formed integrally with the housing.

[0033] The term “component” as used herein means any part, member, device, or feature that forms part of the medication delivery apparatus, and includes without limitation, the chamber housing, the backpiece, the mouthpiece, the output end, various adapters, baffle members, actuators, valve assemblies, tubes or conduits, masks, and the like, and portions thereof, which are incorporated into the system. The terms “connected” and “secured,” and variations thereof, as used herein, means that one or more members are associated or coupled to each other, either directly or indirectly (for example with intervening members).

[0034] In one alternative embodiment, shown in FIG. 10, an adapter 30 includes an input end 32 configured as an insert portion that is fitted in an opening formed in an output end 64 of a chamber housing 66. Conversely, the input end 32 can be fitted over or around an end portion of the chamber housing. In one embodiment, the adapter includes a narrow orifice, as disclosed for example in U.S. Provisional Patent Application Ser. No. 60/377,528, filed May 3, 2002 and entitled “Aerosol Medication Delivery Apparatus With Narrow Orifice,” the entire disclosure of which is hereby incorporated herein by reference. The adapter further includes an output end 34 that, in one preferred embodiment, is shaped to be received in the mouth of the user. For example, the output end 34 can have an outer circular cross-section, or it can be elliptical, oval, obround or any other shaped suitable for insertion into the mouth of the user. Alternatively, an additional mouthpiece (not shown) can be fitted in or around the output end.

[0035] In yet another alternative embodiment, shown in FIG. 9, a mask 160 is fitted in or around, i.e. a connector member 300, secured to the output end of the holding cham-

ber. The mask **160** is shaped to be disposed over the face, preferably including the mouth and nose, of the user. In yet another alternative embodiment, a nasal applicator (not shown), provided for example with prongs, can be fitted into or around the output end. In yet another embodiment, a patient interface element, such as an endotracheal tube, can be fitted to one or more of the output end of the holding chamber or adapter.

[0036] In all of the embodiments, shown for example in FIGS. 1-9, the output end **14**, **58**, **84**, **94** of the holding chamber **4**, **20**, **70**, **90** can be configured with a baffle member **200**. The baffle member **200** is preferably curved, and can have one or more concave or convex surfaces facing toward and away from the input end of the holding chamber. Of course, it should be understood that the baffle member **200** can be flat, or have other non-curved shapes. In addition, it should be understood that the apparatus can be configured without a baffle formed at the output end of the holding chamber.

[0037] As shown in FIGS. 6-9, the output end of the holding chamber can be configured with one or both of an inhalation and exhalation valve **220**. In one embodiment, shown in FIG. 7, the valve **220** includes a central open area **224** having a peripheral edge portion **226** that seats on a valve seat formed on a center baffle portion **228** of the baffle member **200**. The valve is displaced from the seat during inhalation. An outer peripheral portion **230** of the valve is seated on a second valve seat and is displaced therefrom during exhalation. Of course, it should be understood that other valve configurations, such as a duckbill valve, can also be used.

[0038] The valve member **220** is preferably made of a flexible material, including for example and without limitation a silicone, a thermoplastic elastomer, rubber, Ethylene-Propylene-Diene-Monomer (EPDM) or Berfluodelaastomers (FFKN).

[0039] Preferably, the adapter **30** and the chamber housing **4**, **20**, **70**, **90** are made of a hard antistatic plastic, for example by injection molding. Typically, plastics have a surface resistivity of greater than $10E12$ ohm/sq. Antistatic materials have a surface resistivity of between about $10E10$ ohm/sq and about $10E12$ ohm/sq. Static dissipative materials have a surface resistivity of between about $10E6$ ohm/sq. and about $10E12$ ohm/sq. Conductive materials have a surface resistivity of between about $10E1$ ohm/sq and about $10E6$ ohm/sq. Metals typically have a surface resistivity of between about $10E-1$ to about $10E-5$ ohm/sq. Surface resistivity as set forth herein is measured pursuant to ASTM test D257.

[0040] In various embodiments, the chamber housing **4**, **20**, **70**, **90**, adapter **30**, mouthpiece **102**, **106**, **108**, **110**, and/or backpiece **22**, **72** are made of one or more of a polypropylene, polycarbonate, polystyrene, nylon, ABS, high density polyethylene (HDPE), acetal, PBT, PETG, various thermoplastic elastomers, and/or combinations thereof. For example, the components can be made of various PermaStat® compounds available from the RTP Company, having a place of business at 580 East Front Street, Winona, Minn., 55987. Of course, it should be understood that materials other than PermaStat® compounds are suitable. In any event, the materials preferably have a surface resistivity of less than about $10E12$ ohm/sq, more preferably between about $10E1$ and about $10E12$ ohm/sq, more preferably between about $10E6$ and about $10E12$ ohm/sq, more preferably between about $10E10$ and about $10E12$ ohm/sq, and most preferably between about $10E10$ and about $10E11$ ohm/sq.

[0041] In various exemplary embodiments, and without limitation, the chamber housing **4**, **20**, **70**, **90**, adapter **30**, mouthpiece **102**, **106**, **108**, **110**, and backpiece **22**, **72** can be made from one or more of a PermaStat® 100 series polypropylene material, a PermaStat® 200 series Nylon (PA6, PA6/6 or P12) material, a PermaStat® 300 series polycarbonate material, a PermaStat® 400 series polystyrene (PS) material, a PermaStat® 600 series Acrylonitrile Butadiene Styrene (ABS) material, a PermaStat® 700 series high density polyethylene (HDPE) material, a PermaStat® 800 series Acetal (POM) material, a PermaStat® 1000 series polybutylene Terephthalate (PBT) material, a PermaStat® 1100 series polyethylene Terephthalate Glycol modified (PETG) material, a PermaStat® 1200 series polyurethane thermoplastic elastomer material, a PermaStat® 1500 series polyester thermoplastic elastomer, a PermaStat® 1800 series acrylic (PMMA) material, a PermaStat® 2500 series polycarbonate/ABS alloy material, a PermaStat® 2700 series Styrenic thermoplastic elastomer (TES) material, a PermaStat® 2800 series Olefinic thermoplastic elastomer (TEO) materials, or a PermaStat® 4700 series polytrimethylene Terephthalate (PTT) material, all being permanently anti-static and having a surface resistivity between about $10E10$ and about $10E11$ ohms/sq with electrical shock discharge (ESD) protection. PermaStat® compounds are colorable and retain the transparency of the host resin. Such compounds are further free of carbon black, and are non-sloughing, meaning they do not release conductive contaminants. The compounds are further formulated to meet MIL-PRF-81705D static decay requirements. Since the compound is compounded into the molded material, the component is more robust and can function in all humidity levels. The term "plastic" as used herein includes thermoplastic elastomer materials.

[0042] Preferably, the chamber housing **4**, **20**, **70**, mouthpiece **102**, **106**, **108**, **110** and adapter **30** are made of an RTP 199 X 95281 S Nat/Clear, available from the RTP Company. Another suitable material is the RTP 199 X 95281 U Nat/Clear material, which is a high temperature material, also available from RTP Company.

[0043] Preferably, the backpiece **22**, **72** is made of one or more of the elastomeric materials, or other elastomers available from RTP, including for example the RTP 1200 series Polyurethane elastomers, the 1500 series copolyester elastomers, the 2700 series styrenic elastomers and/or the 2800 series olefinic elastomers. It should be understood that the backpiece **22**, **72** also can be made of non-elastomeric materials. In addition, it should be understood that the holding chamber **4**, **20**, **70**, **90**, and various components, including without limitation, the adapter, mouthpiece and backpiece can be made of materials that are not antistatic, having for example surface resistivities of greater than $10E12$ ohm/sq. Therefore, for example, the delivery apparatus may be configured with only the holding chamber **4**, **20**, **70**, **90** being antistatic, only one or more of the various components being antistatic, such as the backpiece, mouthpiece and/or adapter but not the holding chamber, or all of the components including the holding chamber being antistatic.

[0044] Preferably, the antistatic material is substantially clear, such that at least a portion of the various components, including without limitation the holding chamber, backpiece, mouthpiece and adapters, are see-through such that the user can monitor the interior of the delivery apparatus. In this way, the term "clear" simply means see-through, and includes materials that are completely transparent, as well as materials

that are opaque or shaded, so long as an object is visible on the other side of the material. For example, by providing one or more see-through components, various visual flow indicators can be seen. Such visual indicators are shown for example in U.S. Provisional Application 60/382,227, filed May 21, 2002, the entire disclosure of which is hereby incorporated herein by reference. In addition, the antistatic properties associated with various afore-described materials are substantially permanent, and will not dissipate over time.

[0045] In other embodiments, the holding chamber **4**, **20**, **70**, **90**, and other components, including for example and without limitation the adapter **30**, mouthpiece **102**, **106**, **108**, **110** and backpiece **22**, **72**, are made of various thermoplastics using various levels of additives, including without limitation, stainless steel fibers, carbon fibers and carbon powder. It should be understood that an antistatic coating also can be applied to the chamber housing and components, such as the adapter, mouthpiece and backpiece to achieve the desired resistivities.

[0046] In operation, the user actuates the dispenser **2**, **156** or other device, so as to discharge a medication, preferably in aerosol form, through the input end **6**, **52**, **74** and introduce the medication into the interior space **19**, **56**, **82** of the holding chamber **4**, **20**, **70**, **90**, or chamber housing. The medication is thereafter delivered to the user, for example by inhalation through the output end **14**, **58**, **84** of the holding chamber, by way of one or more of a mouthpiece, mask or endotracheal tube. The antistatic properties of the holding chamber and backpiece reduce the likelihood that the medication particles will be attracted thereto.

[0047] Referring to FIGS. **10-15**, exemplary powder medication delivery systems, or dry powder inhalers **400** are shown. Each inhaler **400** includes a holding chamber **402** and a mouthpiece **408**. The inhaler shown in FIGS. **14** and **15**, further includes a visual flow indicator **412** mounted within a viewing port area **410**. The flow indicator moves within the port area to provide a visual cue to the patient or caretaker that the inhalation flow is adequate to properly administer the medication to the patient. Various aspects of the inhaler are further disclosed and shown in U.S. Provisional Patent Application Ser. No. 60/382,227, filed May 21, 2002, the entire disclosure of which is hereby incorporated herein by reference.

[0048] Referring to the inhaler in FIGS. **11-13**, the inhaler **400** includes a holding chamber **402** and a mouthpiece **408**, which can be separate from (FIG. **11**) or integral with (FIGS. **12-13**) the holding chamber. The inhaler further includes a medicament holding cassette **414**, which has a plurality of holding portions **416** that hold a plurality of dose of medication, each of which can be subsequently exposed to the interior of the holding chamber. One or more air entry passageways **418** are directed at the holding portions **416** and fluidize the medication within the holding chamber, wherein it can be subsequently inhaled through the mouthpiece. Various aspects of the inhaler are further disclosed and shown in U.S. Pat. No. 6,116,239, the entire disclosure of which is hereby incorporated herein by reference.

[0049] It should be understood that any or all of the various components of the inhalers **400**, including the holding chambers **402**, mouthpieces **408**, air intake passageways **418**, cassettes **414**, and/or holding portions **416**, can be made of one or more of the various antistatic materials described herein.

[0050] Various nasal inhalers **500**, an example of which is shown in FIG. **16**, may also include one or more of a holding

chamber **502** having an input end **510** and an output end formed as an outlet **506**, an actuator (not shown) and an adapter **504**, one or more of which may be made of the various antistatic materials described herein. One or more inlet valves **508** may be provided in the holding chamber **502**. Various exemplary nasal inhalers and applicators are disclosed for example in U.S. patent application Ser. No. 09/834,037, filed Apr. 11, 2001, and U.S. patent application Ser. No. 10/121,931, filed Apr. 12, 2002, the entire disclosures of which is hereby incorporated herein by reference.

[0051] Although the present invention has been described with reference to preferred embodiments, those skilled in the art will recognize that changes may be made in form and detail without departing from the spirit and scope of the invention. As such, it is intended that the foregoing detailed description be regarded as illustrative rather than limiting and that it is the appended claims, including all equivalents thereof, which are intended to define the scope of the invention.

1-46. (canceled)

47. A medication delivery apparatus comprising:

an holding chamber comprising a plastic material having a surface resistivity of between about 10E10 and about 10E12 ohm/sq, wherein said holding chamber has an input end and an output end spaced apart along a longitudinal axis;

a patient interface communicating with said output end, said patient interface and said holding chamber defining a flow path for an inhalation flow;

a viewing port located adjacent said flow path; and

a visual flow indicator visible through said viewing port and moveable between at least an at-rest position and an inhalation position so as to provide a visual cue about said inhalation flow.

48. The medication delivery apparatus of claim **47** further comprising a one-way valve disposed adjacent said output end, said one-way valve moveable between an open position allowing said inhalation flow and a closed position.

49. The medication delivery apparatus of claim **47** wherein said viewing port is coupled to said patient interface.

50. The medication delivery apparatus of claim **49** wherein said viewing port and said patient interface are integrally formed.

51. The medication delivery apparatus of claim **47** wherein said patient interface comprises a plastic material having a surface resistivity of between about 10E10 and about 10E12 ohm/sq.

52. The medication delivery apparatus of claim **47** wherein said viewing port comprises a see-through plastic material having a surface resistivity of between about 10E10 and about 10E12 ohm/sq.

53. The medication delivery apparatus of claim **47** wherein said plastic material comprises a polypropylene material.

54. The medication delivery apparatus of claim **47** wherein said plastic material is selected from the group consisting of polypropylene, polycarbonate, polystyrene, nylon, acrylonitrile butadiene styrene, high density polyethylene, acetal, polybutylene terephthalate, and polyethylene terephthalate glycol.

55. The medication delivery apparatus of claim **47** wherein said surface resistivity of said plastic material is between about 10E10 and about 10E11 ohm/sq.

56. A method of delivering a medication comprising:

introducing a medication into a holding chamber through an input end of said holding chamber, wherein said holding chamber comprises a plastic material having a surface resistivity of between about $10E10$ and about $10E12$ ohm/sq;

moving said medication through said holding chamber from said input end to an output end spaced from said input end along a longitudinal axis;

moving said medication from said output end to a patient interface;

inhaling said medication through said patient interface;

moving a visual indicator from an at-rest position to an inhalation position simultaneously with said inhaling said medication through said patient interface; and

viewing said visual indicator through a viewing port.

57. The method of claim **56** wherein said moving said medication from said output end to said patient interface comprises moving said medication through a one-way valve disposed adjacent said output end.

58. The method of claim **56** wherein said viewing port is coupled to said patient interface.

59. The method of claim **58** wherein said viewing port and said patient interface are integrally formed.

60. The method of claim **56** wherein said patient interface comprises a plastic material having a surface resistivity of between about $10E10$ and about $10E12$ ohm/sq.

61. The method of claim **56** wherein said viewing port comprises a see-through plastic material having a surface resistivity of between about $10E10$ and about $10E12$ ohm/sq.

62. The method of claim **56** wherein said plastic material comprises a polypropylene material.

63. The method of claim **56** wherein said plastic material is selected from the group consisting of polypropylene, polycarbonate, polystyrene, nylon, acrylonitrile butadiene styrene, high density polyethylene, acetal, polybutylene terephthalate, and polyethylene terephthalate glycol.

64. The method of claim **56** wherein said surface resistivity of said plastic material is between about $10E10$ and about $10E11$ ohm/sq.

* * * * *